

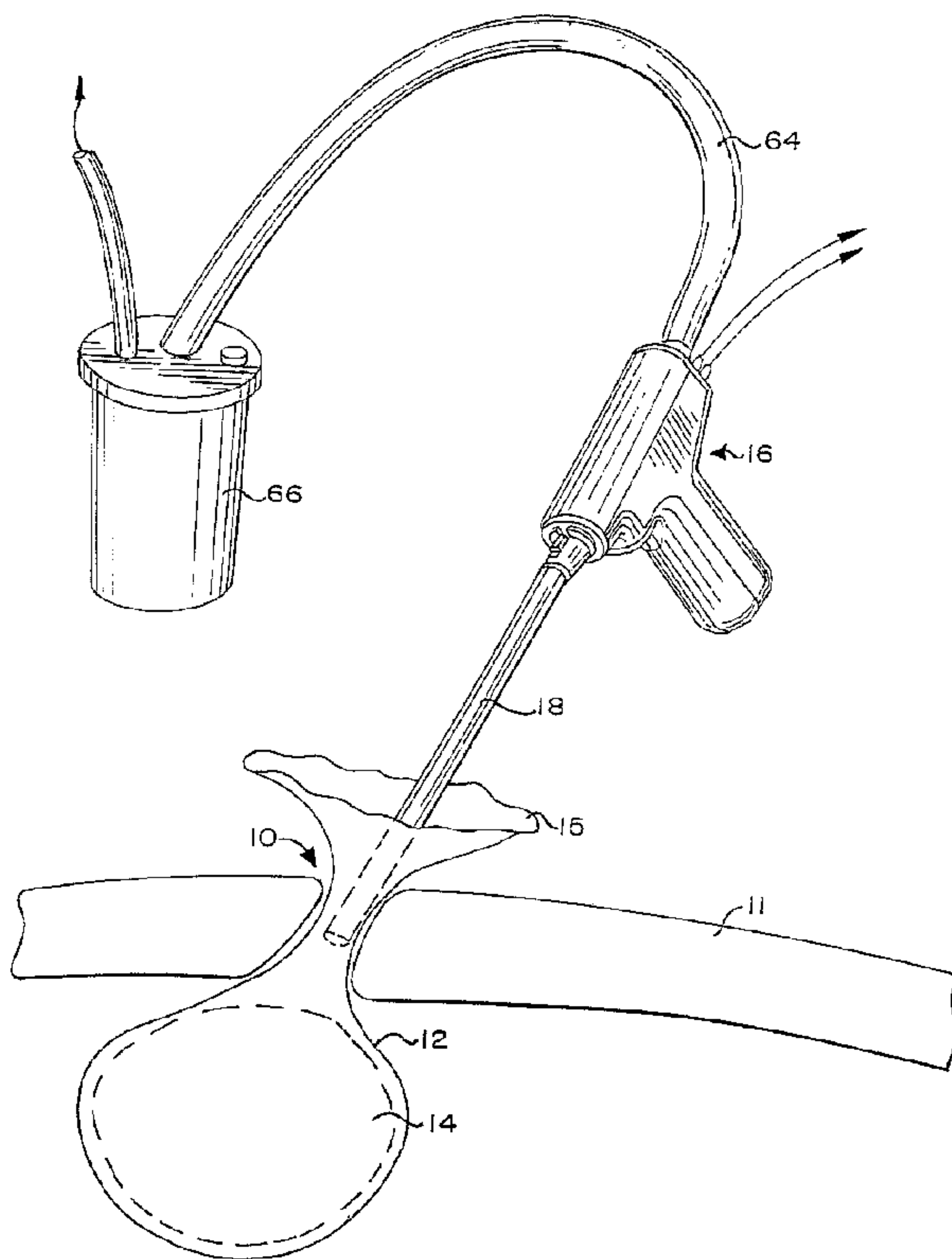

(86) Date de dépôt PCT/PCT Filing Date: 1996/02/06  
 (87) Date publication PCT/PCT Publication Date: 1996/08/15  
 (45) Date de délivrance/Issue Date: 2001/10/30  
 (85) Entrée phase nationale/National Entry: 1997/08/08  
 (86) N° demande PCT/PCT Application No.: US 96/01547  
 (87) N° publication PCT/PCT Publication No.: WO 96/24296  
 (30) Priorité/Priority: 1995/02/10 (08/386,970) US

(51) Cl.Int.<sup>6</sup>/Int.Cl.<sup>6</sup> A61B 17/20, A61B 17/36, A61M 5/32  
 (72) Inventeur/Inventor:  
 HOOVEN, Michael D., US  
 (73) Propriétaire/Owner:  
 ENABLE MEDICAL CORPORATION, US  
 (74) Agent: FINLAYSON & SINGLEHURST

(54) Titre : PROCEDE ET APPAREIL DESTINE A MORCELER ET A RETIRER UN TISSU D'UN PATIENT  
 (54) Title: APPARATUS AND METHOD FOR MORSELATING AND REMOVING TISSUE FROM A PATIENT



(57) **Abrégé/Abstract:**

This invention is a method for morcelating and removing the morcelated tissue through a small incision comprising in general inserting a tissue container into the body cavity of a patient through an incision, placing resected tissue in the vessel, inserting a morcelator having a rotatable electrode thereon through the incision and into the vessel, morcelating the tissue and removing the tissue from the containment vessel and the body. An apparatus for morcelating and removing tissue through a small incision within the body cavity of a patient is also disclosed and may comprise a tissue container having an inner chamber for containing resected tissue, and a morcelator having a proximal end and a distal end carrying an electrode wherein the distal end is insertable into the body cavity and containment vessel for morcelating resected tissue.

APPARATUS AND METHOD FOR  
MORSELATING AND REMOVING TISSUE FROM A PATIENT

ABSTRACT OF THE INVENTION

5 A method for morselating and removing the morselated  
tissue through a small incision comprising in general  
inserting a tissue container into the body cavity of a  
patient through an incision, placing resected tissue in  
the vessel, inserting a morselator having a rotatable  
electrode thereon through the incision and into the  
vessel, morselating the tissue and removing the tissue  
from the containment vessel and the body. An apparatus  
for morselating and removing tissue through a small  
10 incision within the body cavity of a patient is also  
disclosed and may comprise a tissue container having an  
inner chamber for containing resected tissue, and a  
morselator having a proximal end and a distal end carrying  
an electrode wherein the distal end is insertable into the  
15 body cavity and containment vessel for morselating  
resected tissue.

Attorney Docket No. HOOV101PCT

**APPARATUS AND METHOD FOR  
MORSELATING AND REMOVING TISSUE FROM A PATIENT**

**INVENTOR: MICHAEL D. HOOVEN**

5       The present invention relates generally to apparatus and methods for removing tissue from the body of a human patient. More particularly, the present invention concerns novel apparatus and methods for morselating and removing body tissue through a relatively small incision in the patient.

10       **BACKGROUND OF THE INVENTION**

15       So-called minimally invasive surgery has become increasingly popular in a variety of surgical procedures. Minimally invasive surgery typically involves introducing surgical devices into a patient through small access incisions, in contrast to obtaining full and open access to the surgical site through large incisions.

20       Briefly, minimally invasive surgery is typically carried out through one or more relatively small incisions, which are usually between approximately ½ and 1½ inches in length, and through which an entry tube or trocar is placed. Optical and medical instruments are inserted through the trocar(s) to allow the physician to view the surgical area and to target the organ or tissue that is the subject of the surgery, and then to carry out  
25       the desired surgical procedure. Because of the relatively small diameter of the trocar(s), however, withdrawal of the target tissue therethrough can be difficult, particularly if the tissue is dense or muscular, such as a kidney, uterus or uterine myoma.

30       One previously accepted technique for removing such tissue required manually cutting the tissue into smaller pieces within the body cavity, which pieces were then



removed through the trocar by graspers. This procedure, however, in addition to being very tedious and time consuming, also suffers from a number of other possible drawbacks, including possible excessive bleeding, possible  
5 accidental cutting of other tissue and possible contamination of the abdominal cavity with target tissue.

A morselation device is described in U.S. Patent No. 5,290,303. That device uses an inner rotating tube and an  
10 outer stationary sheath, the inner tube extends beyond the sheath and has a tapered end for severing tissue. A further outer tube or shield may also be used over the sheath. This device may be used with a tissue bag, such as shown in U.S. Patent No. 5,037,379. The tissue to be  
15 morselated may be placed in the bag and the device inserted into the bag to carry out the morselation within the pouch.

One of the concerns with the device shown in the '303 patent is possible puncture of the pouch by the rotating  
20 tube, with accompanying potential contamination of the anatomical space, as well the time consuming insertion and placement of a new pouch within the body cavity. Although the bag disclosed in the '379 patent has two layers, including a puncture resistant inner layer, the above-mentioned concern is still present. In addition, the  
25 multi-layer construction with a higher strength inner container may make folding and insertion of the pouch into the abdominal cavity more cumbersome.

More recently, in U.S. Patent No. 5,304,124, an  
30 apparatus and method were disclosed for removing a uterine myoma. In that method, a tube is inserted through the trocar and into the myoma. A wire loop, which may energized by radio frequency energy, is located at the distal end of the tube to cauterize the tissue as the tube is inserted into the myoma, resulting in a core of tissue  
35 being located within the tube. A separate morselator is then inserted into the tube to cut up the tissue (such as

by rotary blades, laser, or a rotary whip), and the morselated tissue is then evacuated. Although such a procedure may be an advance over a purely manual procedure, this procedure is still relatively complicated, requiring separate steps and apparatus to core and to morselate the tissue.

In addition, the procedure described in the '124 patent, when utilized with radio frequency ("RF") energy, uses a separate grounding or return electrode or antenna in contact with the skin of the patient, for example, that the patient lies on. As is well known in the art, such an application of RF energy has certain shortcomings. It requires the energy to travel between the electrodes, a relatively long distance through the body, with possible adverse effect on other body tissue. It also may result in accidental injury to non-target tissue, for example, if the active electrode is inadvertently brought into contact with non-target tissue. Also, this patent discloses a relatively complex mechanism to sever the tissue core from the myoma.

Accordingly, it is a general object of the present invention to provide apparatus and methods for removing target tissue through a trocar, which apparatus and method are more simplified and/or easier to use than the apparatus and method described above, and reduces the risk of accidental injury to non-target tissue.

#### GENERAL SUMMARY OF THE INVENTION

As set forth in the appended claims, the present invention is generally embodied in apparatus and methods for morselating and/or removing target tissue from the body cavity of a patient, such as through the relatively small incision(s) that are typically used in minimally invasive surgical procedures.

More particularly, the present invention is generally embodied in a morselator, a tissue container for containing resected tissue to be morselated, and their



5 methods of use. In general, the morselator of the present invention may comprise an elongated shaft having an inner tube and an outer tube extending between proximal and distal end portions. At least one of the tubes is rotatable and an electrode surface is carried by the rotatable tube(s) in proximity to the distal end thereof.

10 The foregoing apparatus may be used for removing tissue from within a body cavity of a patient by inserting the distal end through an incision in the patient, energizing and rotating the electrode and advancing the electrode into the resected tissue in order to morselate it. The morselated tissue is then removed through the lumen of the inner tube.

15 Preferably a second electrode of opposite polarity is used with the first mentioned electrode, with one of the terminals being a RF energy active electrode and the other being a RF energy return electrode, to morselate tissue therebetween. The additional electrode may be located, in one embodiment, at the distal end of the shaft or, when  
20 the morselator is used to morselate tissue within a resected tissue container, the additional electrode may be defined within the container, such as by a conductive inner surface of the container or by having the additional electrode otherwise disposed within the container.

25 In accordance with further aspects of the present invention, the combination of a resected tissue container and a morselator may be provided for morselating resected tissue within the body cavity of a patient. In such a combination, the tissue container is insertable through an  
30 incision into a body cavity of a patient. The container defines an interior chamber for containing the resected tissue. The morselator has a proximal end portion and a distal end portion. One electrode is carried on the distal end portion and is operable to assist in the morselation upon insertion through an incision and into  
35 the resected tissue container. A second electrode of

opposite polarity also is disposed in the container. In this combination, the resected tissue container contains the resected tissue and helps protect surrounding tissue from inadvertent or undesirable contact with the electrodes or RF energy associated therewith.

In accordance with another aspect of the present invention, a tissue container is provided for containing resected tissue during morselation. The tissue container is comprised of a flexible wall which defines an inner chamber adapted to be received within a body cavity of a patient. The wall comprises a non-conductive outer surface and a conductive inner surface, which inner surface also may serve as an electrode of opposite polarity when only one type of electrode (e.g., active or return) is carried on the morselator.

The above is only a summary of the present invention in certain of its more general aspects. Accordingly, for a more complete understanding of these and other features and advantages of the present invention, reference should be made to the following detailed description.



**BRIEF DESCRIPTION OF THE DRAWINGS**

The present invention is set forth in greater detail in the following description of the attached drawings, of which:

5           Figure 1 is an overall perspective representation of the present invention, including morselator extending into a tissue container in a small incision in the body cavity of a patient.

10           Figure 2 is an overall perspective representation of apparatus embodying the present invention and that may be used in practicing the method of the present invention, including a tissue container, hand-held morselator, and specimen collection jar.

15           Figure 2a is a cross-sectional view of the tissue container of Figure 2.

            Figure 3 is a perspective view of the morselator shown in Figures 1 and 2 and embodying the present invention.

20           Figure 4 is a cross-sectional view of the apparatus of Figure 3.

            Figure 5 is a cross-sectional view of a multiple-tube elongated shaft portion of the apparatus of Figures 3 and 4.

25           Figure 5a is a perspective view of an inner tube of the multiple-tube shaft shown in Figure 5.

            Figure 5b is a perspective view of the distal end of the multiple-tube elongated shaft shown in Figure 5

30           Figures 6a - 6g are perspective views of different configurations of the distal end of the multiple-tube elongated shaft shown in Figure 5.

            Figure 7a is a cross-sectional view of an elongated shaft for removable attachment as part of a morselator.

            Figure 7b is a cross-sectional view of the shaft of Figure 7a taken along lines 7b-7b of Figure 7a.

35           Figure 8 is a perspective view of snap collar employed in the apparatus of Figures 7a-7b.



Figure 9 is a perspective view of a main collar employed in the apparatus of Figures 7a-7b.

Figure 10 is a perspective view of an outer tube guide employed in the apparatus of Figures 7a-7b.

DETAILED DESCRIPTION OF THE DRAWINGS

The present invention is particularly useful in morselating and removing tissue from a body cavity of a patient through relatively small incisions, such as those employed in so-called minimal invasive surgery.

An initial description of the method of use may aid in understanding the apparatus of the present invention. In minimally invasive surgery, one or more relatively small incisions 10 are normally made in the patient. As is well known in the art, particularly in abdominal surgery, these incisions are typically made by first inflating the abdominal cavity to raise the skin away from the underlying organs. The skin is then grasped, and a trocar, which may have a puncture tip, is inserted through the skin and peritoneal membrane 11 and into the abdominal cavity forming a relatively small access incision or opening through the skin. Surgical instruments, optical fiber devices, light sources and the like may then be inserted through the trocars to carry out the desired surgical procedure on whatever target tissue is involved. Although described generally in terms of abdominal surgery, the method and apparatus of the present invention are not limited to a specific type or location of surgery.

The method of the present invention is typically carried out after the surgery, such as that described above, has been carried out, and the target tissue has been resected. The target or resected tissue may be any organ, tumor, growth, or other tissue, although it is contemplated that the present invention is particularly useful for tissue that is especially dense or muscular, such as a uterus or kidney, and unsuited for simple withdrawal through a trocar, or for tissue that may be infectious or malignant. Similarly, the present invention is not limited to any particular technique or apparatus for the resection of the target tissue.

Referring to Figures 1 and 2, in accordance with one aspect of the present invention, at least a portion of a



tissue container such as a flexible bag or pouch 12, is inserted through the incision 10 and into the patient's body cavity. It is anticipated that in most procedures the entire bag or pouch 12 will initially be inserted into the body cavity by rolling or folding it and inserting it through the trocar located in the incision. The resected tissue 14 is then placed into the bag or pouch. The bag or pouch may be located entirely within body cavity or the lip or marginal edge 15 of the bag or pouch may then be pulled through the incision, for example after removal of the trocar, to allow the bag or pouch to be held or gripped by the surgeon during the morselating.

Morselator 16 of the present invention is then inserted through incision 10 into the bag or pouch 12. When the bag or pouch has been inserted into the body cavity, and the lip 15 of the bag or pouch is withdrawn or pulled up through the small incision 10 and externalized, the distal end 17 of elongated shaft 18 of the morselator 16 is inserted through the lip or opening 15 of the bag or pouch 12 and through the incision to the resected tissue 14. A rotating electrode on the distal end of the shaft morselates the resected tissue by coring it or slicing it while it remains within the portion of the bag or pouch 12 that is within the body cavity. As used herein, morselating means cutting, coring, slicing, chopping or any other way of sub-dividing tissue into smaller pieces. The morselated tissue is then removed, such as by suction through the shaft.

Turning now to the illustrated morselator employed in and embodying the present invention, Figure. 3 is a perspective view of the preferred morselator 16 shown in Figures 1 and 2. For the purposes of this description and the claims, the morselator 16 may also be referred to generically as an "electrosurgical device".

As shown in Figure 3, the morselator 16 includes, in addition to the elongated shaft 18, a hand piece 20 at the proximal end 21 of the elongated shaft for gripping by the

surgeon and for mounting the elongated shaft 18 and the controls for the morselator. Referring first to the elongated shaft, which is also shown in Figures 5-5b, the shaft is made up of a stationary outer tube 22 and an inner tube 24 rotatably received within the outer tube. The elongated shaft may be permanently attached to the hand piece, with the entire morselator being disposable or reusable. Alternatively, as discussed later, the elongated shaft may be disposable and removably attachable to a reusable hand piece.

As shown in Figures 4 and 5, the inner tube extends from the distal end 17 of the elongated shaft 18, through nose 26 of hand piece 20 and terminates in a proximal suction connection fitting 28 on the hand piece. The outer tube 22 extends from the distal end 17 of the shaft 18 to a proximal tube collar 30, which is fixedly attached to the nose of the hand piece.

The inner tube 24 has an inner tube collar 32 attached at the proximal end portion of the inner tube. The inner tube collar is received within and preferably keyed or otherwise attached in rotationally locked engagement with an inner body sleeve 34 mounted in the hand piece 20. A keyed arrangement between the inner tube collar and the inner body sleeve permits easy removal and disposal of the inner tube and reuse of the hand piece. Alternatively, the inner tube collar may be permanently attached or bonded to the inner body sleeve 34, and the entire morselator may be disposable or resterilizable.

Although not necessarily preferred, the inner tube 24 may be axially movable relative to the outer tube 22, and spring loaded, such as by a compressed spring (not shown) between inner tube collar and the nose 26, to bias the inner tube to a position where the distal end of the inner tube extends slightly beyond the distal end of the outer tube. As a result, when an axial force is exerted on the distal end of the inner tube, such as when it contacts the tissue container, the inner tube is forced back into the



outer tube. This feature may prevent unnecessary damage to the electrodes at the distal end of the inner tube and to the tissue container.

5 The inner and outer tubes are preferably made of a substantially electrically non-conductive material, such as a fiber glass-epoxy composite or a polymer. Alternatively, the walls of the inner and outer tubes may have a metal core for strength and be coated with a substantially non-conductive or insulating material. The diameter and thickness of the inner and outer tubes may be selected depending on the desired procedure and/or target tissue involved. For morselating dense or muscular tissue, fiberglass epoxy inner and outer tube walls of approximately .007 inches thick have been found suitable. Because of their thinness, the tubes are shown simply as lines in Figures 4 and 5.

10 For morselating resected tissue, a pair of electrode surfaces 36 of opposite polarity are preferably provided at the distal end 17 of the shaft 18. In the illustrated embodiment, the electrode surfaces are provided at the distal end of thin conductive metal strips 38 that extend along and are bonded to the outer surface of inner tube 24. The distal ends of these strips, which provide the electrode surfaces, terminate in proximity to the distal ends of the inner and outer tubes, although they may extend slightly beyond the distal end of the inner and outer tubes, be recessed slightly between the inner and outer tubes, or terminate at the distal end and still function satisfactorily.

20 The conductive strips 38, such as aluminum or stainless steel strips or foil, may be placed on the tube wall by, for example, bonding the strips to the tube or manufacturing the tube in such a way that the strips 38 are located inside the wall of the tube, and the strips exposed at the distal end. The outer tube 22, which may be made completely of insulating material or have an interior surface of non-conductive material, insulates the

electrical conductors on the inner tube from surrounding tissue, and the insulating material on the inner wall of the inner tube insulates the conductors from any tissue within the inner tube. ("Insulating" and "non-conducting" are used interchangeably in this description.)

5

The present invention, however, is not limited to the use of conductive strips to transmit electrical energy from the proximal to the distal end of the elongated shaft. Any type of conductor or conductive material can be used. Thin and relatively wide conductive strips are preferred, however, for delivering high power RF energy to the electrode surfaces because they allow a maximum amount of current to be carried along the length of the inner tube without unduly increasing the spacing between and/or wall thickness of the tubes. Thin conductors are also ideal for RF energy because the high frequency current travels primarily on the surface of a conductor, so a thin conductor with a large surface area, such as the thin strips 38 in Figure 5a, offers what is believed to be the best possible combination of current carrying capability and minimal tube wall spacing and/or wall thickness. Further, the conductive strips conduct RF energy much more efficiently than a wire of the same cross-section since a thin strip conductor has a much larger surface area than a wire of the same cross-section.

10

15

20

25

Referring to the hand piece 20 of the morselator 16, shown in Fig. 3 and in vertical cross-section in Figure 4, the hand piece 20 includes a lower handle portion 40 for the surgeon to grip and an upper body portion 42 to mount the elongated shaft 18. The hand piece also includes the controls for the morselator. The body portion 42 of the morselator includes a motor 44, which is preferably a lower power-consumption high torque motor such as the type commonly used in electric screwdrivers, for rotating the inner tube 24 of the elongated shaft 18. In order to rotate the inner tube, the motor 44 is connected to a drive gear 48 that mates with a driven gear 46 which is

30

35



connected to the inner body sleeve 34. As explained above, the inner body sleeve 34 is rotationally locked to the inner tube 24 through collar 32. Accordingly, when the motor 44 is engaged, it causes the inner body sleeve 34 and inner tube 24 to rotate. In the preferred embodiment, only the inner tube rotates. It is within the scope of this invention, however, for the outer tube to rotate, and the inner tube to remain stationary or for both tubes to rotate.

The handle portion 40 of the hand piece 40 of the morselator 16 not only includes a grip 50 for the surgeon to hold while using the morselator, but also may include a battery pack 52 and a switch or trigger 54 to turn the morselator on and off. The battery pack 52 may be rechargeable for a reusable handle or a one-time use battery for a disposable handle. To turn the morselator on and off, the battery pack 52 is electrically coupled to the motor 44 via the switch 54, which is preferably in the form of a trigger.

The switch 54 also serves to the couple RF contacts 56 to tube contacts 58 on the inner body sleeve 34. Tube contacts 58 are in the form of spaced-apart rings. Each ring is in electrical contact through the inner body sleeve, with one of the conductor strips on the inner tube. Brushes or sliding contacts 60 are in direct contact with the rings. One of the brushes is directly coupled to one of the RF contacts. The other brush is coupled to the other RF contact through a circuit controlled by switch 54.

Therefore, when the switch 54 is turned on or the trigger is depressed, it completes the circuit from the battery pack 54 to the motor 44 and activates the motor 44, which causes the gear assembly to turn, and, the inner body sleeve 34 and the inner tube 24 to rotate. Additionally, when the switch is turned on or the trigger depressed, it completes the circuit between at least one of the RF contacts 56 and the tube contacts 58, allowing

RF electrical energy to flow from the RF contacts 56 to the conductors (see e.g. Figure 5a) located on the surface of the inner tube 24, and to the electrode surfaces 36 at the distal end of the morselator 16.

5 Preferably, morselated tissue is removed through the morselator 16 via an inner tube lumen 62 extending between the distal 17 and proximal 21 ends of the morselator. A suction source or apparatus (not shown) may be used to suction the tissue and remove it from the body cavity. 10 More specifically, the suction apparatus is coupled to connection fitting or tube 28, which communicates with proximal end 21 of the inner tube 24 of the morselator 16, and is used to suction the morselated tissue therethrough. The suction apparatus may include a suction tube 64 15 coupled to a specimen collection canister 66, which is then coupled to the suction source. The suction may be manually controlled by the surgeon, or the morselator 16 also could include a suction control (not shown), such as a rocker switch or similar mechanism, to allow the suction 20 control to operate at the same time or in timed relation with the motor and/or RF energy activation. Alternately, other devices such as a grasping instrument or a myoma screw could be used to pull the morselated tissue up through the inner tube of the morselator while the tissue 25 is being morselated.

The morselator of the present invention preferably uses an RF energy source of the type well known in the field. As commonly known in the field, such a radio frequency energy source may provide high voltage 30 electrical current at a frequency between 100 KHz and 1 MHz. The energy source can use either an RF monopolar or a bipolar RF energy source. In the present invention, however, because of the small surface area (the end edge of strip 38, for example) of the electrodes it is 35 particularly desirable to use RF monopolar power source, with one of the electrodes connected to the monopolar



terminal of a typical RF energy power supply and the other electrode attached to the return.

For morselating tissue there are various configurations of electrodes, as shown in Figures 5b and 6a - 6g, that can be used in the present invention. It is understood that these are merely examples of different configurations and that other configurations, modifications, and variations would be readily apparent to one skilled in the art and are intended to be included within this application. In each configuration shown in Figures 5b and 6a - 6g, at least one electrode is active and can be electrically coupled to a source of electrical energy, such as for example a RF monopolar current source, via one of the RF contacts 56 and a conductor such as conductive strip 38. One or more of the other electrodes is electrically coupled to a ground/return circuit, such as a monopolar ground return, via the other RF contact 56. Alternatively, bipolar energy could be used.

Figures 6a - 6d show the distal end 17 of the elongated shaft 18 wherein, both electrodes are located between the inner tube 24 and the outer tube 22 and can be carried by the inner tube 24. Figure 6a shows two arcuate or half-circle type electrodes 68, 69. These electrodes may be, for example, wires or strips. One electrode would be electrically coupled to ground/return, and the other would be electrically coupled to a monopolar active current. The embodiment shown in Figure 6b utilizes a different configuration with wire electrodes 70, 71 on the outside of the inner tube 24. These electrodes may be in the shape of wire loops. The wires extend slightly beyond the distal end of the inner tube. As a result, the inner tube 24 may be recessed slightly in relation to the outer tube 22 with the ends of the wires 70, 71 just flush with the end of the outer tube 22. As in the embodiment in Figure 6a, one electrode would be electrically coupled to ground/return, and one would be electrically coupled to a monopolar active current. In the embodiment in Figure 6c,

solid metal portions or strips 72, 73 are used instead of wires. These metal portions may be located on opposite sides of the inner tube and extend beyond the distal end of the shaft, and may also be electrically coupled to ground/return and a monopolar active current, respectively. In the embodiment shown in Figure 6d, there are four electrodes 74, 75, 76, 77 wherein two electrodes 80, 82 would be electrically coupled to ground/return, and two electrodes 81, 83 electrically coupled to a monopolar active current.

In the embodiment shown in Figures 6e and 6f, a different configuration is shown where one electrode is located between the inner tube 24 and the outer tube 22 while the end surface and/or outer surface of the outer tube 22 functions as the other electrode. Specifically, Figure 6e shows a scoop type wire 75 which could be electrically coupled to a monopolar active current. The outer surface of the outer tube 22 is covered with a conductive material and acts as the other electrode, which can be electrically coupled to ground/return. In the embodiment shown in Figure 6f, a single electrode 80, which may be a wire, strip, or simply the exposed end of a conductive tube, extends around the distal end of the inner tube and may be electrically coupled to a monopolar active current, with the ground/return electrode being the outer surface of the outer tube 22.

It may be necessary in some instances to have a portion of the side of the elongated shaft adjacent to the tissue to be removed. In those circumstances, the tissue can be shaved using the embodiment shown in Figure 6g. In this embodiment, the inner and outer tubes 24, 22 are slotted at a distal side port, and a wire or strip electrode 82 extends the length of the side port and may be electrically coupled to a monopolar active current and function as a cutting edge as the inner tube 24 rotates inside the outer tube 22 to shave any tissue within the cutout portion of the tubes. Again, the edge surface or



outer surface of the outer tube 22 is conductive and may be electrically coupled to ground/return. In all of these electrode configurations, the outer tube 22 may be covered with a conductive coating and used to provide a ground/return path.

Alternatively, the elongated shaft may be a single rotatable tube with a pair of electrodes of opposite polarity at the distal end. For example, a solid metal tube could be employed with an electrode of selected polarity carried at the distal end and a conductor extending along the length of the tube between the proximal end and the electrode at the distal end portions. Of course, to avoid short circuiting, the conductor would need to be insulated from the metal tube. In this alternative, the distal end of the metal tube itself could act as the other electrode of opposite polarity, and the tube body would function as the conductor between the proximal and distal end portions. In a single tube arrangement, various other combinations of conductive and non-conductive materials also could be used, such as a tube wall of non-conductive material with a pair of electrodes at the distal end and a pair of conductors extending along the tube body. Also, the wall of the tube could have three layers with non-conductive inner and outer surfaces and a metal core therebetween with the distal end of the metal core forming the other electrode and the core itself being a conductor.

Turning now to a more detailed description of the tissue container that may be used in accordance with the present invention, the container may be of various shapes, sizes or materials without departing from the present invention. As noted above, however, the tissue container is preferably in the form of a flexible bag or pouch 12. The bag or pouch 12 generally has side wall 84, bottom wall 86, and marginal edge or lip 15 defining the opening into the bag or pouch. The walls of the bag or pouch are preferably sufficiently flexible to allow the bag or pouch

to be flattened or folded or rolled for insertion through a trocar or a relatively small incision into the body cavity.

5 In use in the preferred embodiment, the tissue is morselated by the rotating action of the inner tube and electrode and by pushing the distal end of the shaft against the bottom of the tissue container to sever the morselated tissue from the remainder of the resected tissue. Accordingly, the tissue container should be  
10 mechanically strong enough to withstand the force and abrasion caused by a morselator, as well as the local heating caused by electrodes. For this reason, it is preferred that the walls of the vessel be made as thick as possible, yet not so thick that the vessel cannot be  
15 folded or rolled up to fit through a trocar.

To insulate and protect surrounding tissue, the walls of the pouch or bag should be of a substantially non-conductive or electrically insulating material. High thermal resistance silicone rubber or fabric reinforced  
20 silicone rubber in the range of 0.010 - 0.015 inches thickness has the desired characteristics of flexibility, strength and non-conductivity, and is the preferred material. It is expected, however, that other materials may also be suitable and the present invention, in its  
25 broader respects, is not limited to a particular material for the tissue container.

As described briefly above, the preferred morselator may have both active and ground electrodes located on the shaft. Alternatively, only one electrode may be located  
30 on the shaft and the cooperating electrode be in the form of conductive surface on the inside of the tissue container. For the latter application, the tissue container preferably has a non-conductive outer surface, such as silicone, and a conductive inner surface such as  
35 a flexible metallic film or foil, such as aluminum or stainless steel foil. With proper attachment, the



conductive inner surface can act as the ground/return electrode for RF energy application.

5 Alternatively, the tissue container may contain a separate conductor or an electrode there within, such as a wire or strip electrode of opposite polarity, to assist in morselating the resected tissue. The separate electrode could also be electrically coupled to active or ground/return and operate in conjunction with the electrode on the morselator for creating the needed cutting action.

10 As described briefly above, the inner and outer tubes 24 and 22 forming the elongated shaft may be removably attachable to the hand piece for disposability. Figures 7a-7b and 8-10 depict aspects of a snap-lock arrangement for removable inner and outer tubes. In Figure 7a, outer tube 22 is attached or bonded to an outer tube collar 88. One end of outer tube collar 88 is received within outer tube guide 90, which is bonded to main collar 92, which is bonded to snap collar 94. Inner tube collar 96 is bonded to the inner tube 24 and held in spaced relationship from the outer tube collar by outer tube spacer 98 and from the snap collar by inner tube spacer 100. This construction allows the inner tube to rotate relative to the outer tube and both tubes to be snapped into a receiving nose collar that interfits with spring arms 102 of the snap collar. In such an embodiment, the inner tube could be rotationally locked to inner tube sleeve by a keyed fitting, such as a mating spline and groove or the like. Electrical contact with the contacts on the tube sleeve could be achieved by slidable spring contacts. Also, outer tube spacer 98 and/or inner tube spacer 100 could be in the form of a spring to allow relative axial movement between the inner and outer tubes.

25 The features and method of the present invention have been described in connection with the accompanying drawings for the purposes of illustration and not limitation. It is intended that this application include

those modifications, variations and additions that would be readily apparent to one of ordinary skill upon reading this description. Accordingly, for ascertaining the scope of the present invention, reference must be made to the  
5 appended claims.



## What Is Claimed Is:

1. Apparatus for morselating tissue within a body cavity of a patient comprising:

5 an elongated shaft comprising an outer tube, an inner tube disposed within said outer tube, a proximal end portion, and a distal end portion, said inner and outer tubes being open at their distal ends;

at least one of said inner and outer tubes being rotatable; and

10 at least one electrode surface carried by a rotatable one of said tubes in proximity to the distal end of said tube and being rotatable therewith.

2. The apparatus of Claim 1 further comprising an additional electrode surface carried by said elongated shaft at said distal end portion wherein said one and additional electrode surfaces define electrodes of opposite polarity for transmission of energy and morselation of tissue therebetween.

3. The apparatus of Claim 2 wherein said one and said additional electrode surfaces are carried on said inner tube.

4. The apparatus of Claim 2 wherein said additional electrode surface is carried on said outer tube.

5. The apparatus of Claim 1 further comprising an electrical conductor extending between said at least one electrode surface and said proximal end portion of the tube on which it is carried.

6. The apparatus of Claim 5 wherein said electrical conductor comprises a relatively wide and thin strip of conductive material.

7. The apparatus of Claim 5 in which the tube on which said electrode is carried comprises a wall defined by inner and outer layers of non-conductive material, and said conductor is located therebetween.

8. The apparatus of Claim 3 further comprising a pair of electrical conductors carried by said inner tube, each conductor extending between one of said electrode surfaces and the proximal end portion of said inner tube.

9. The apparatus of Claim 8 wherein said conductors are in the form of relatively thin and wide strips carried on the outer surface of said inner tube.

10. The apparatus of Claim 9 wherein the outer tube has a non-conductive inner surface.

11. The apparatus of Claim 1 wherein at least the surface of said inner and outer tubes is comprised of non-conductive material.

12. The apparatus of Claim 4 wherein said outer tube comprises a wall including non-conductive inner and outer surfaces and an electrical conductor therebetween extending between said additional electrode surface and the proximal end portion of said outer tube.

13. The apparatus of Claim 2 further comprising a radio frequency power source having a monopolar active terminal and a return terminal, and said at least one electrode surface is in electrical communication with one of said terminals and the said additional electrode surface is in electrical communication with the other of said terminals.

14. The apparatus of Claim 1 wherein the inner and outer tubes are relatively axially movable.



15. The apparatus of Claim 1 further comprising a hand piece located at the proximal end of said shaft.

16. The apparatus of Claim 15 further comprising a motor disposed within said hand piece and operable to rotate said rotatable tube or tubes and said apparatus further comprising a power supply disposed in said hand piece and operatively connected to said motor.

17. The apparatus of Claim 16 wherein said elongated shaft is removable from said hand piece.

18. Apparatus for morselating tissue within a body cavity of a patient comprising:

an elongated tube having proximal and distal end portions and defined by a wall;

a pair of spaced-apart electrode surfaces carried at the distal end of tube; and

a pair of electrical conductors extending between one of said electrode surfaces and the proximal end of said tube.

19. Apparatus for morselating resected tissue within a body cavity of a patient, said apparatus comprising, in combination:

a tissue container insertable through an incision into a body cavity of a patient, said container defining an interior chamber for containing therein the resected tissue that is to be morselated;

a morselator having a proximal end portion, a distal end portion and an electrode of selected polarity carried on the distal end portion and operable to assist in morselating resected tissue, said distal end portion being insertable through an incision into the body cavity and into said tissue container for morselating the resected tissue therewithin; and

a second electrode disposed within the tissue container of opposite polarity to the first-mentioned electrode.

20. The apparatus of Claim 19 wherein said tissue container

includes an interior surface comprised of a substantially conductive material and defines the second electrode.

21. The apparatus of Claim 20 wherein said tissue container comprises an exterior surface of substantially non-conductive material.

22. The apparatus of Claim 19 wherein said morselator further comprises an elongated shaft having proximal and distal end portions and at the first mentioned and the second electrodes are carried on said distal end portion, one or both of said electrodes being rotatable to morselate resected tissue and wherein said tissue container is defined by a wall comprising at least an inner surface of non-conductive material.

23. The apparatus of Claim 22 wherein said elongated shaft comprises inner and outer coaxial tubes, said inner tube being rotatable and both of said electrodes being carried on said inner tube.

24. The apparatus of Claim 22 wherein said elongated shaft comprises inner and outer coaxial tubes, said tubes being relatively rotatable and one of said electrodes being carried on the inner tube and the second electrode is carried on the outer tube.

25. The apparatus of Claim 18 further comprising a drive unit carried at the proximal end of said tube and including a motor selectively operable to rotate said tube and a pair of connectors in electrical communication with said conductors for connection to a radio frequency power supply.

26. The apparatus of Claim 18 wherein said wall comprises non-conductive inner and outer surfaces and said pair of electrical conductors are located between said non-conductive surfaces.



FIG. 1

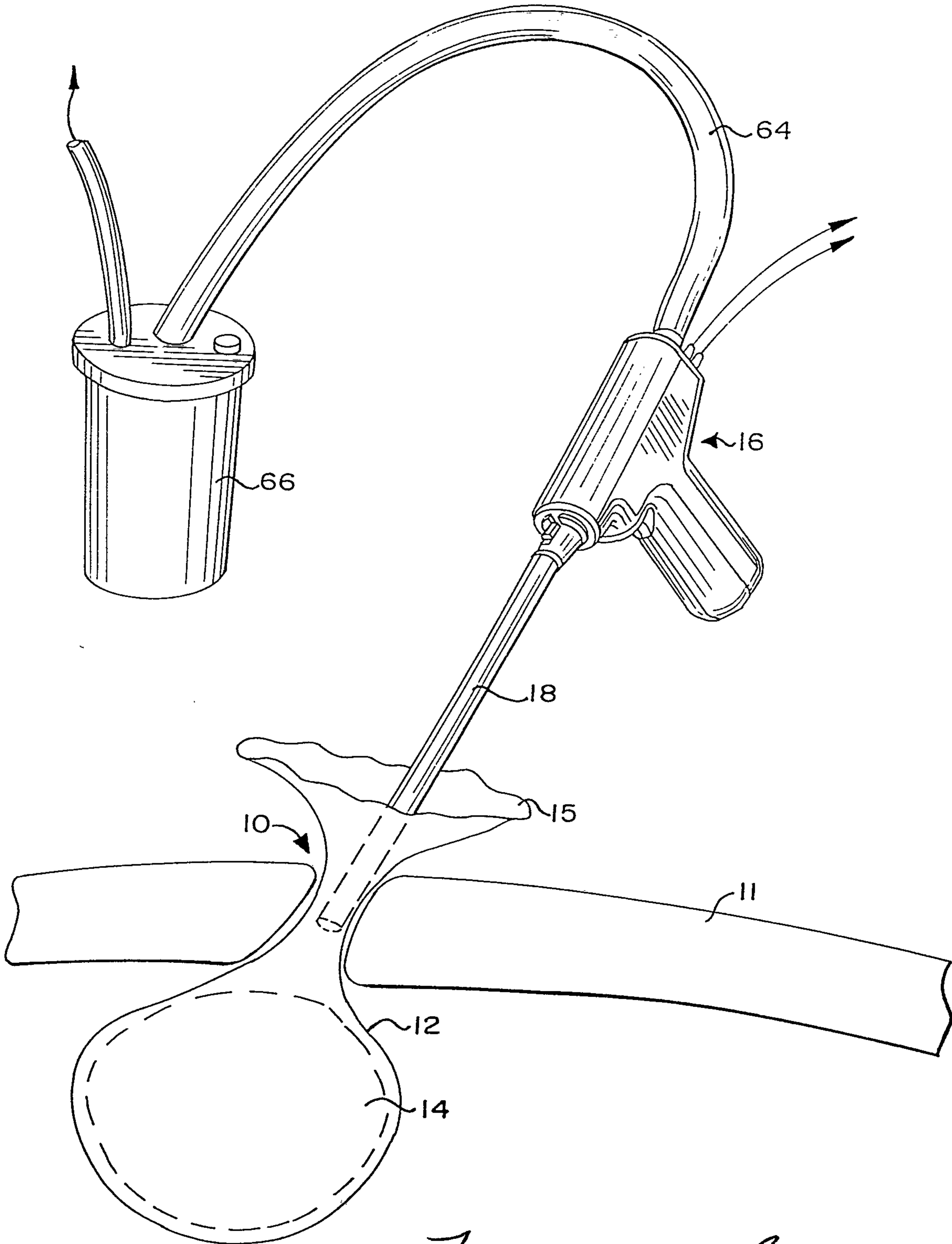

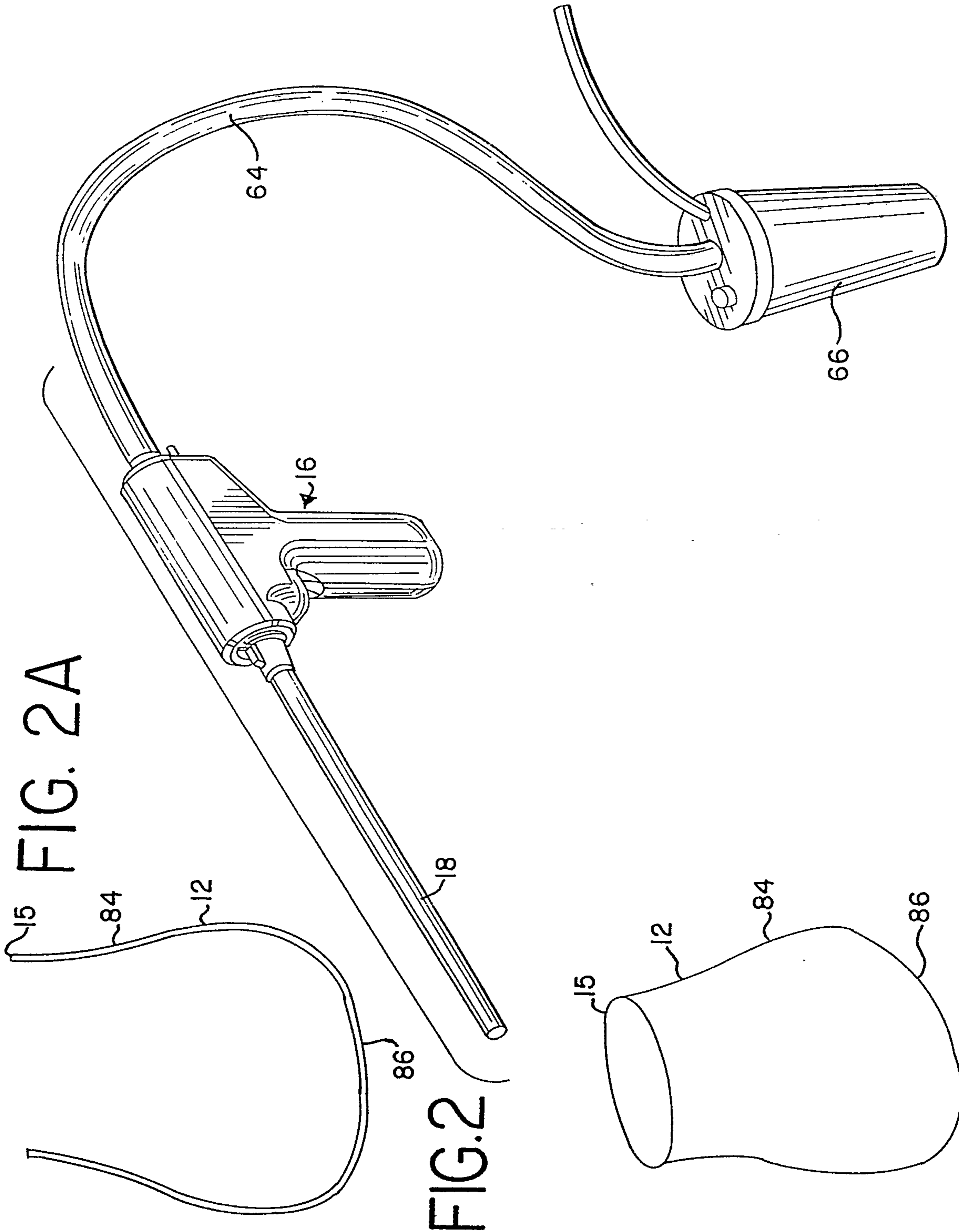

FIG. 2A

FIG. 2



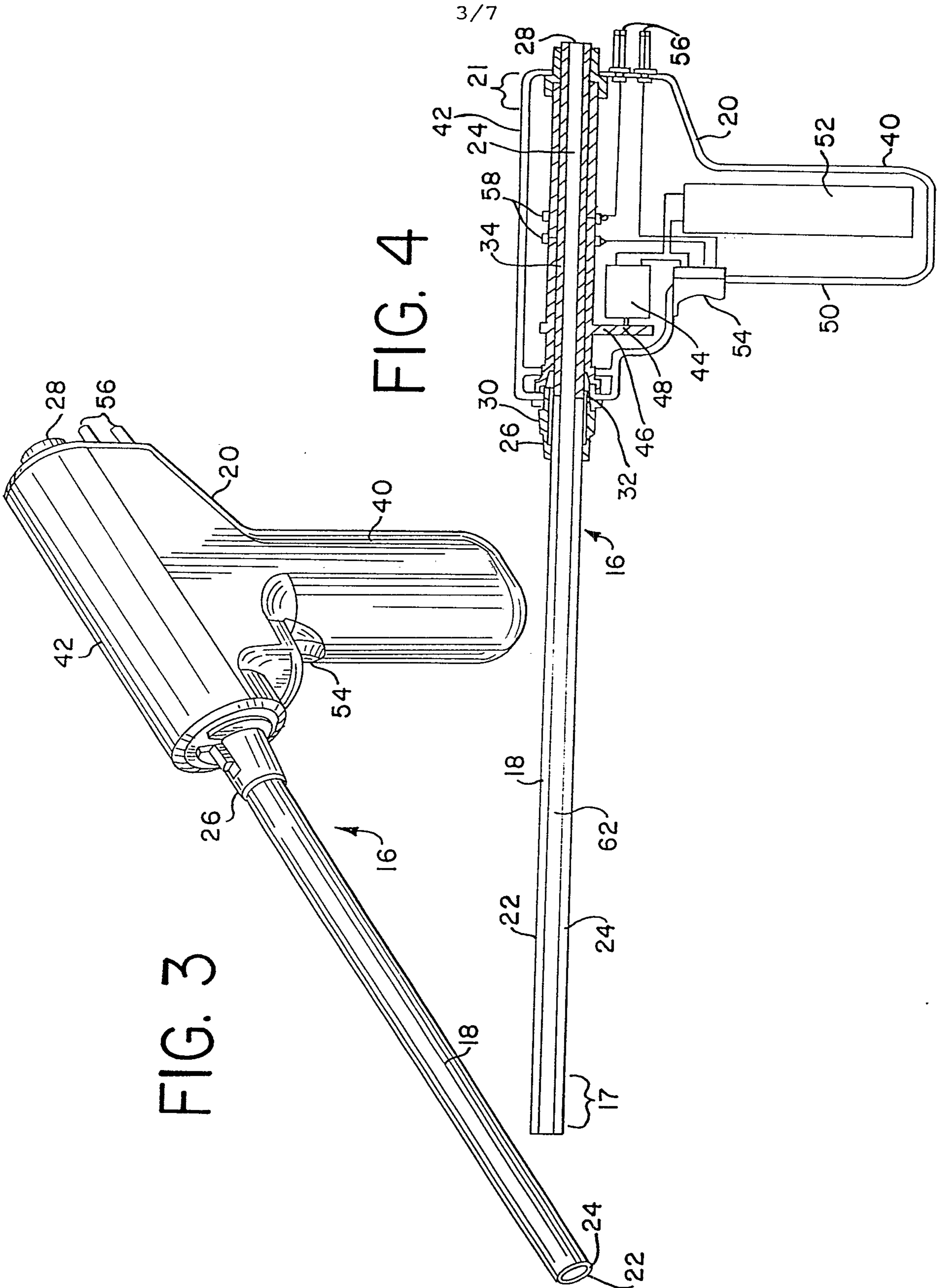

FIG. 3

FIG. 4

Fenlayson & Singlehurst  
PATENT AGENTS

FIG. 5

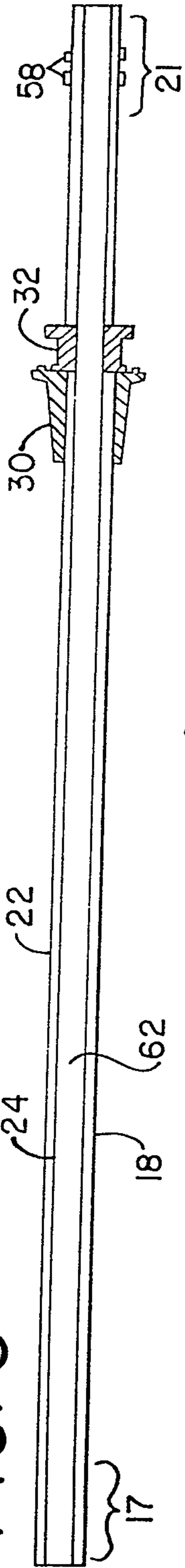

FIG. 5b

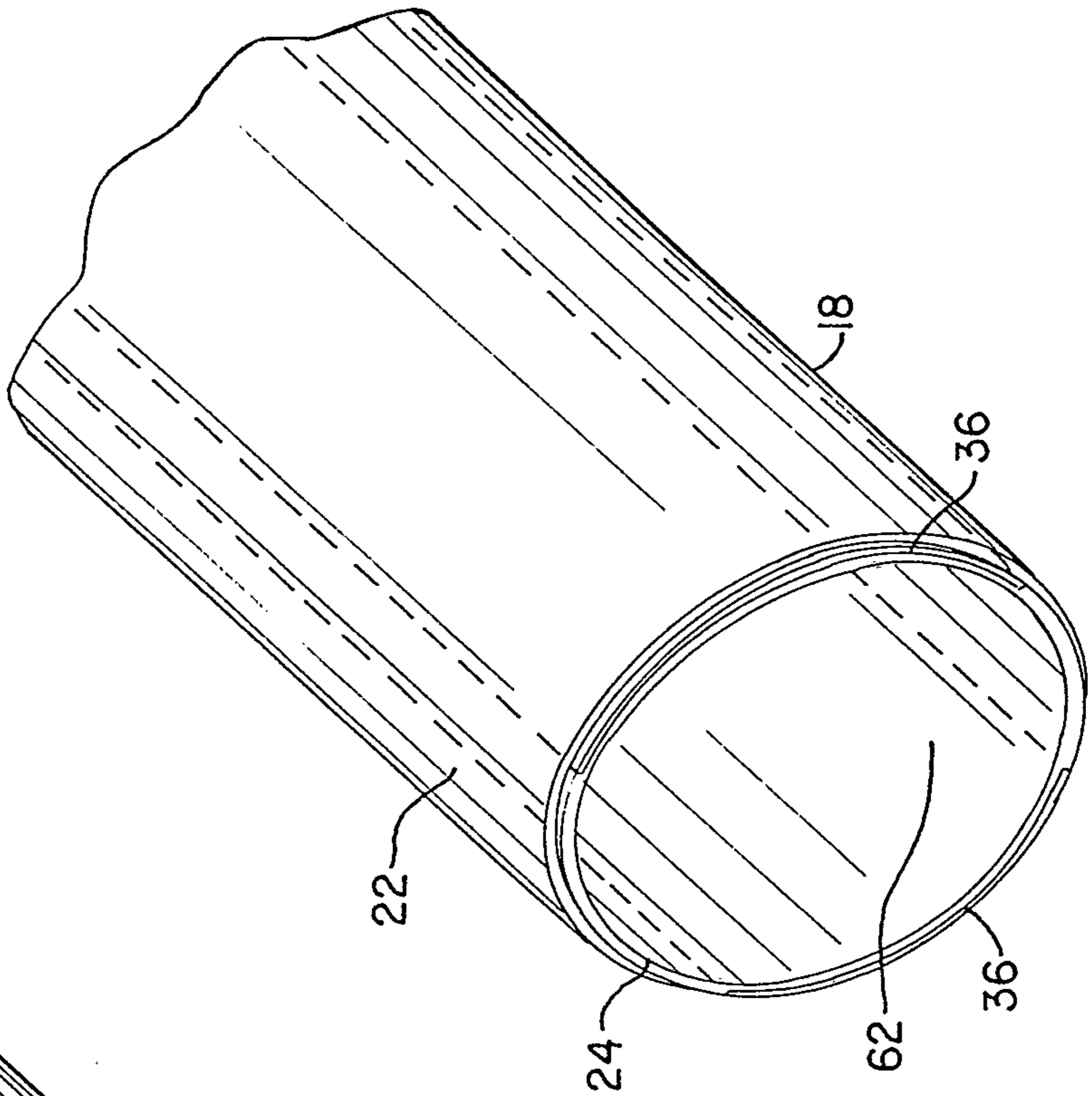
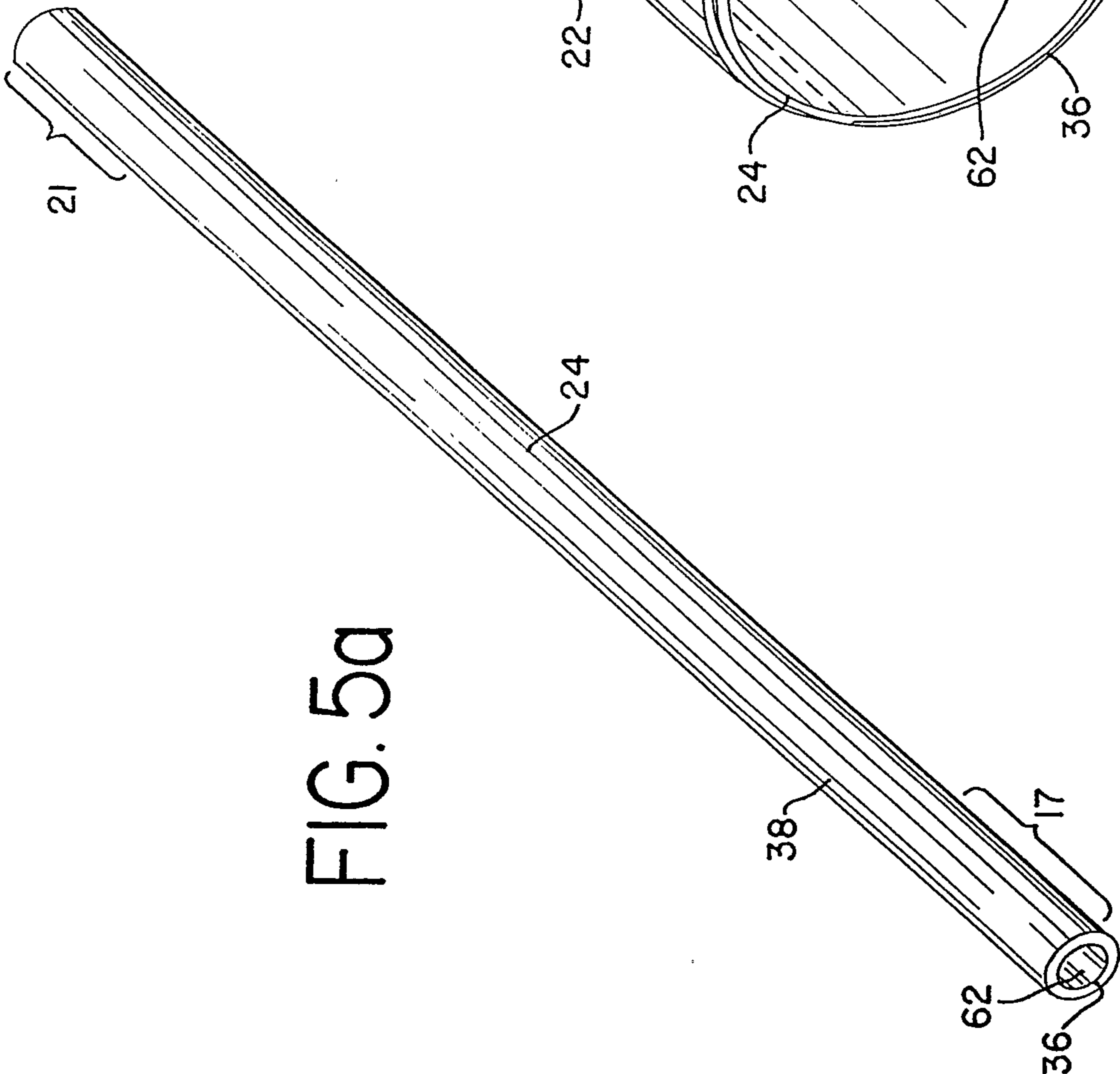

FIG. 5a



*Feulayon + Benglerherst*  
 PATENT AGENTS



FIG. 6a

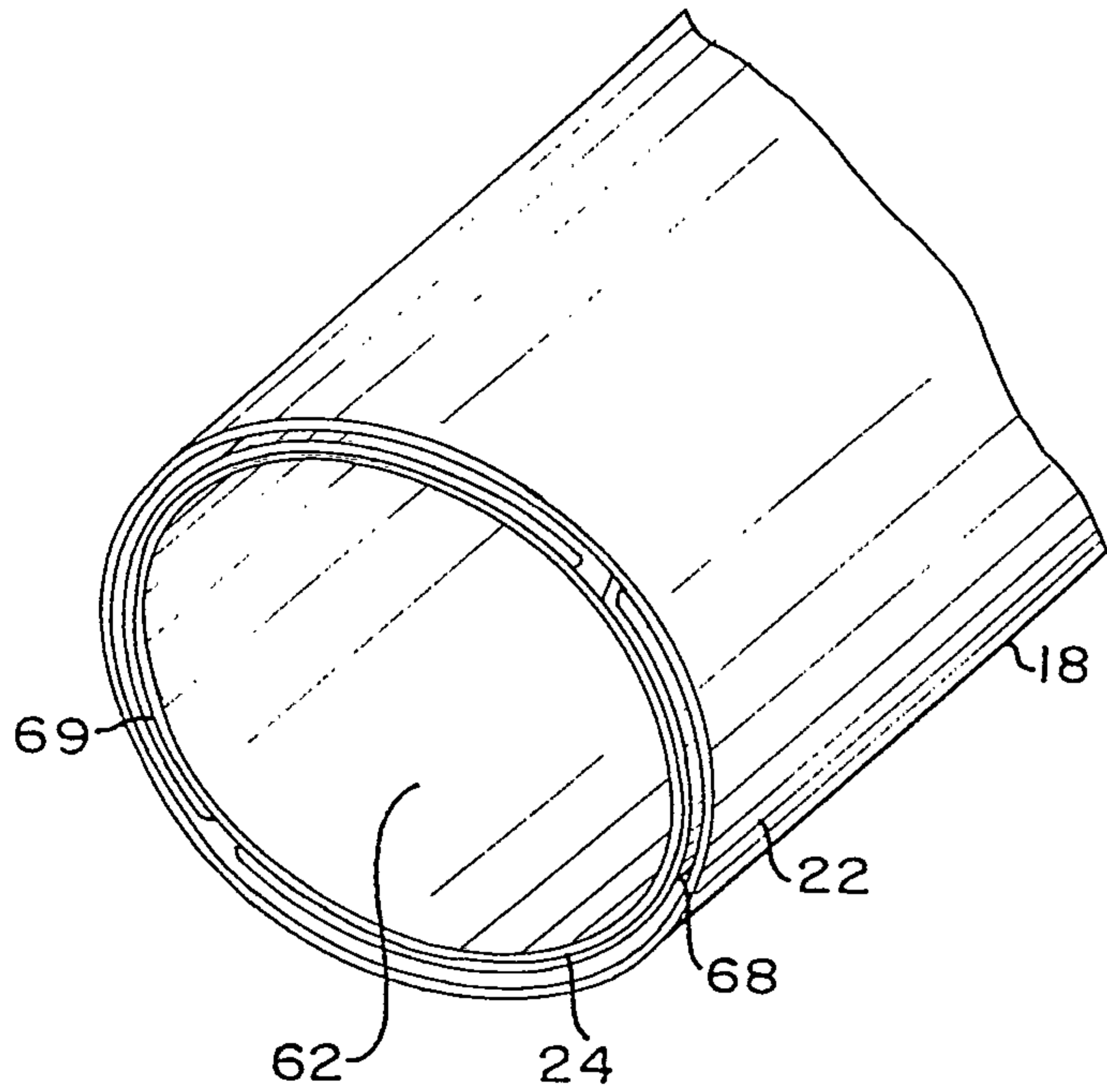

FIG. 6b

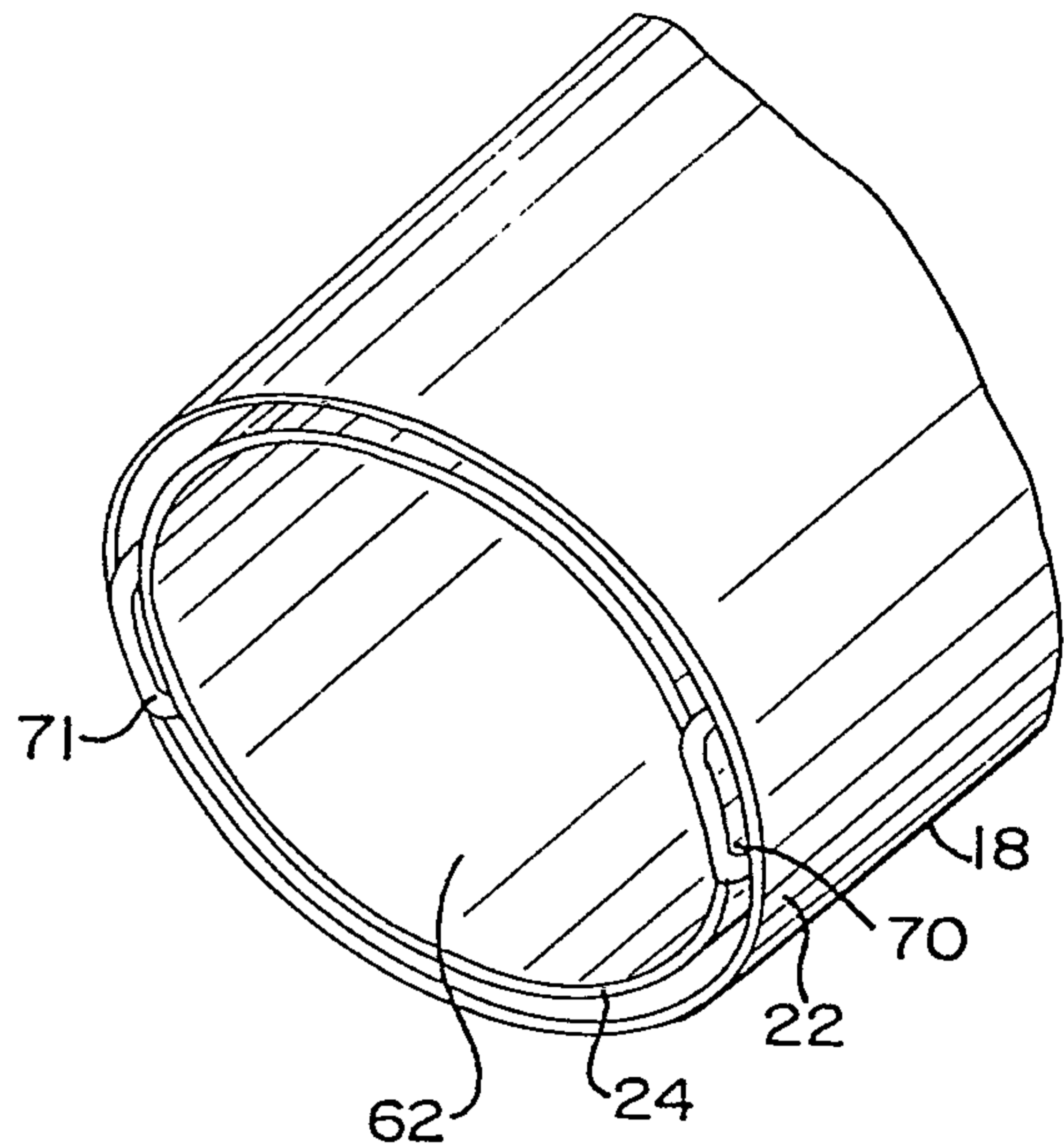

FIG. 6c

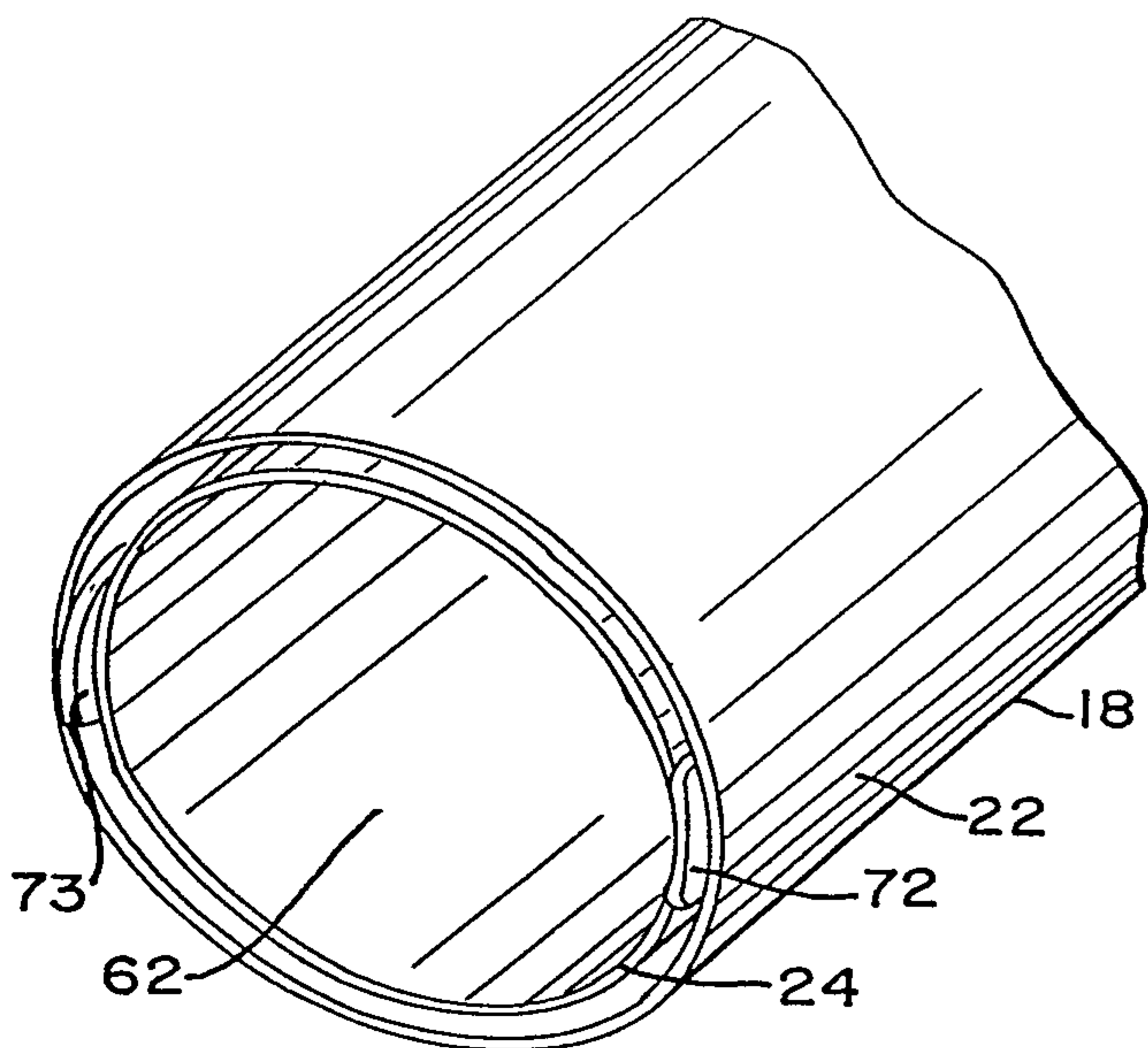

FIG. 6d

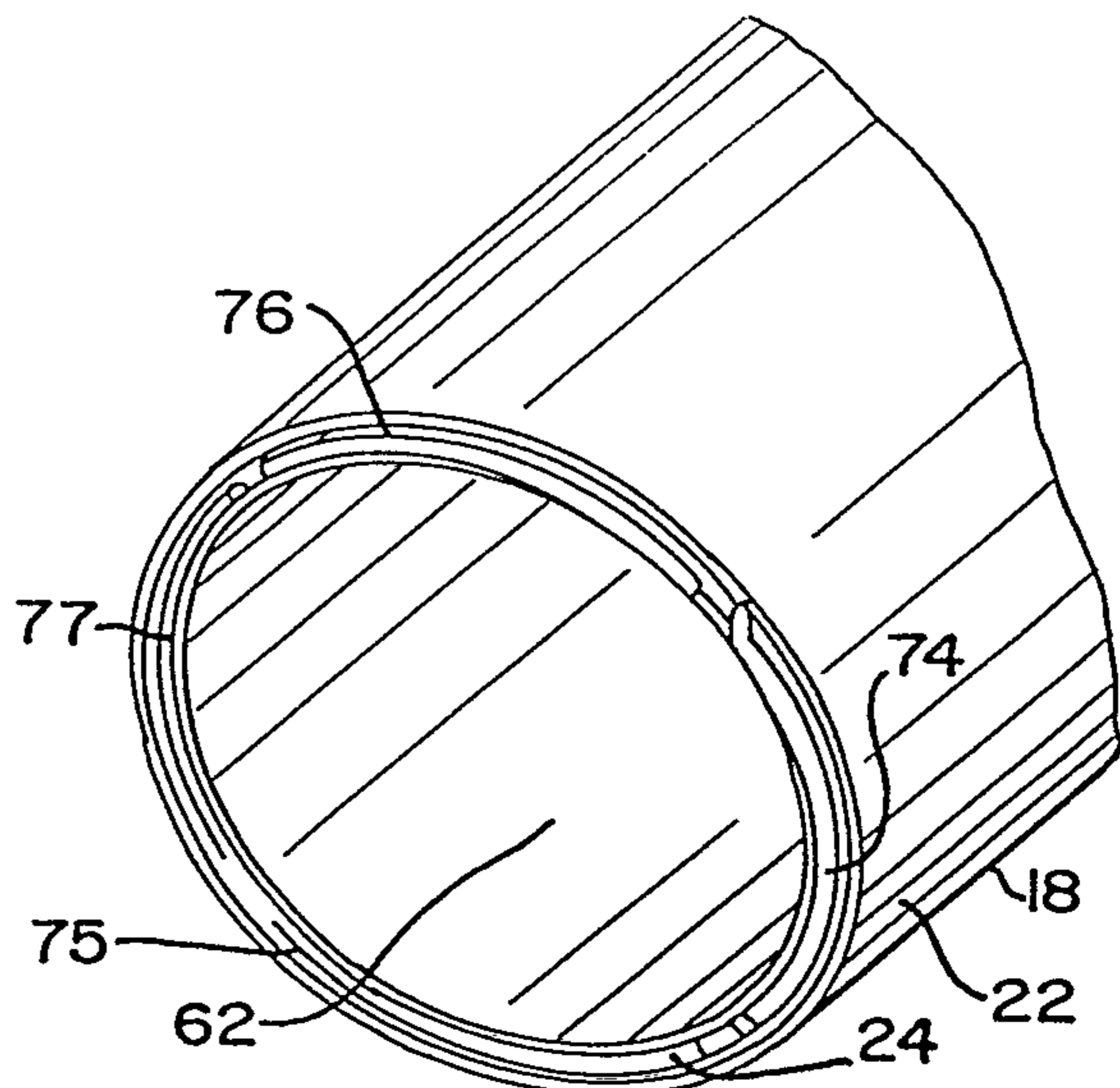

FIG. 6e

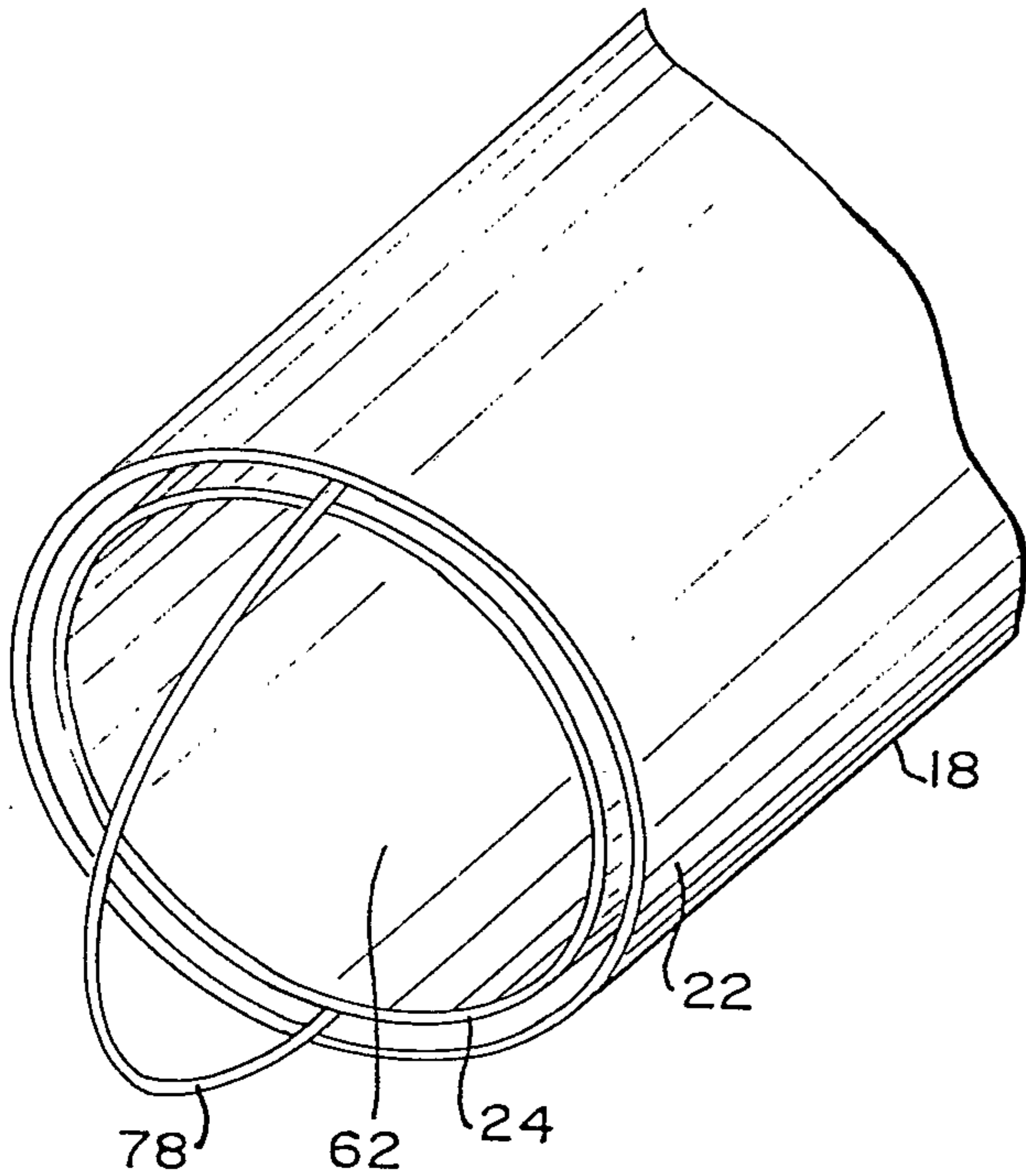

FIG. 6f

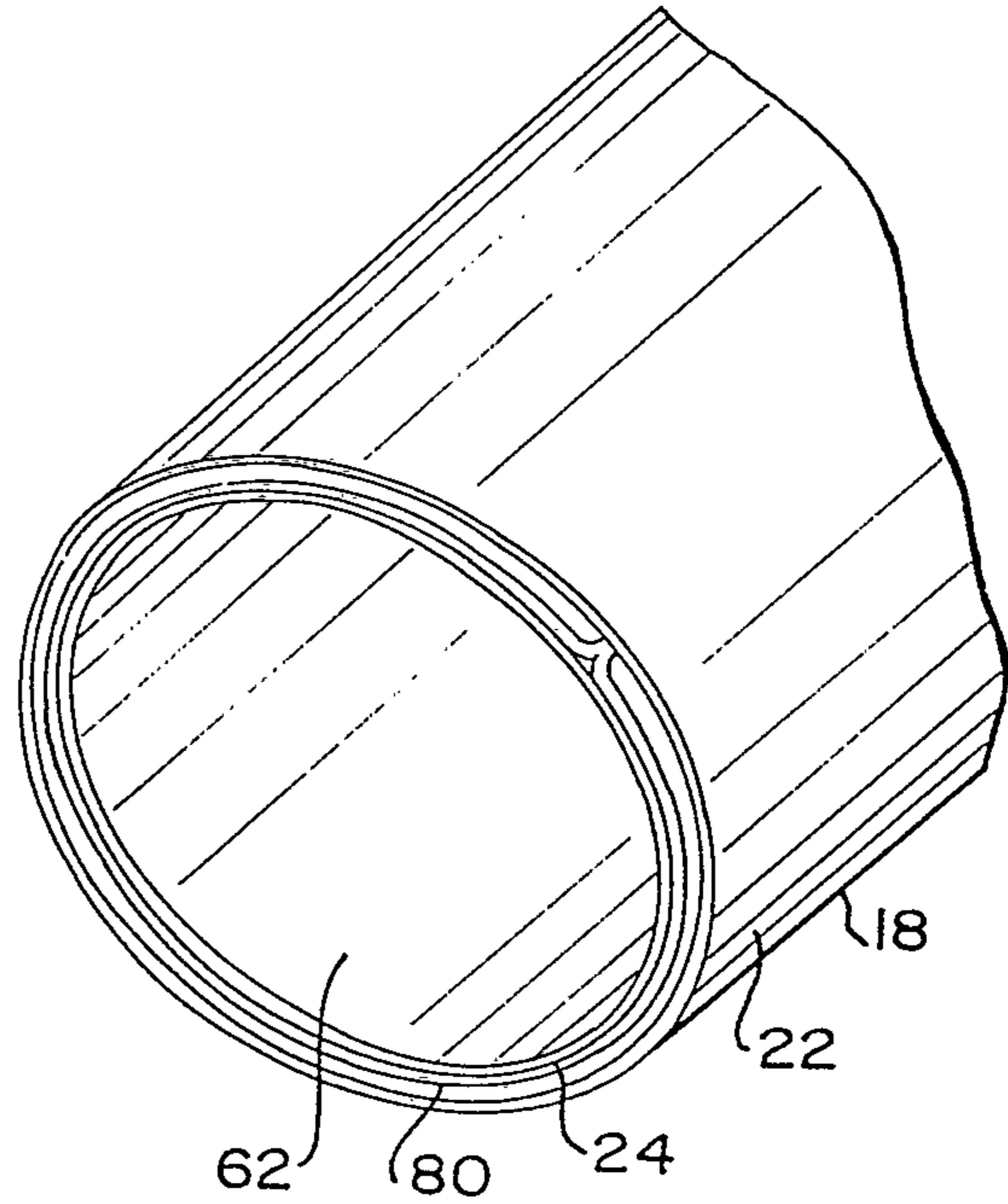
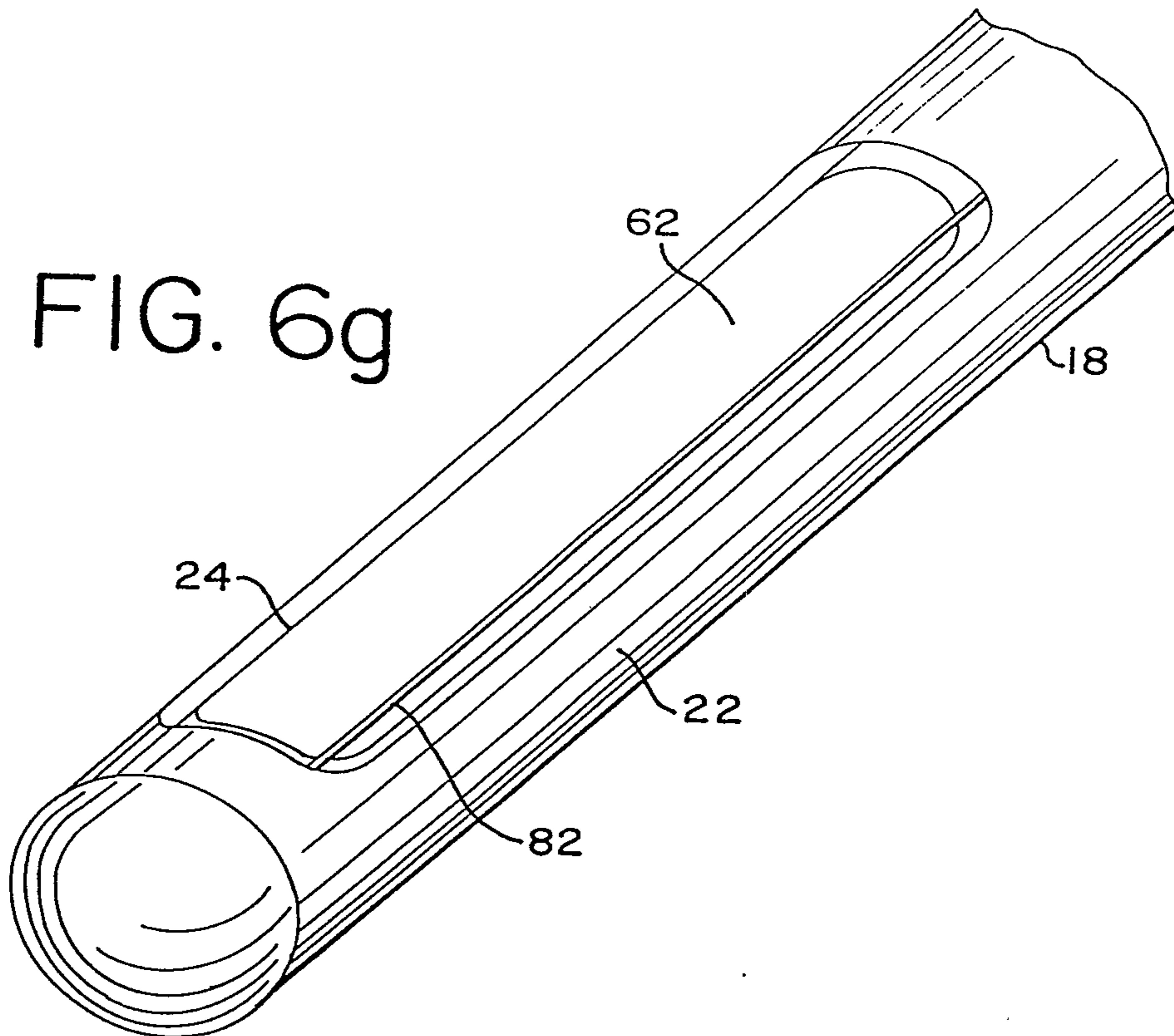

FIG. 6g





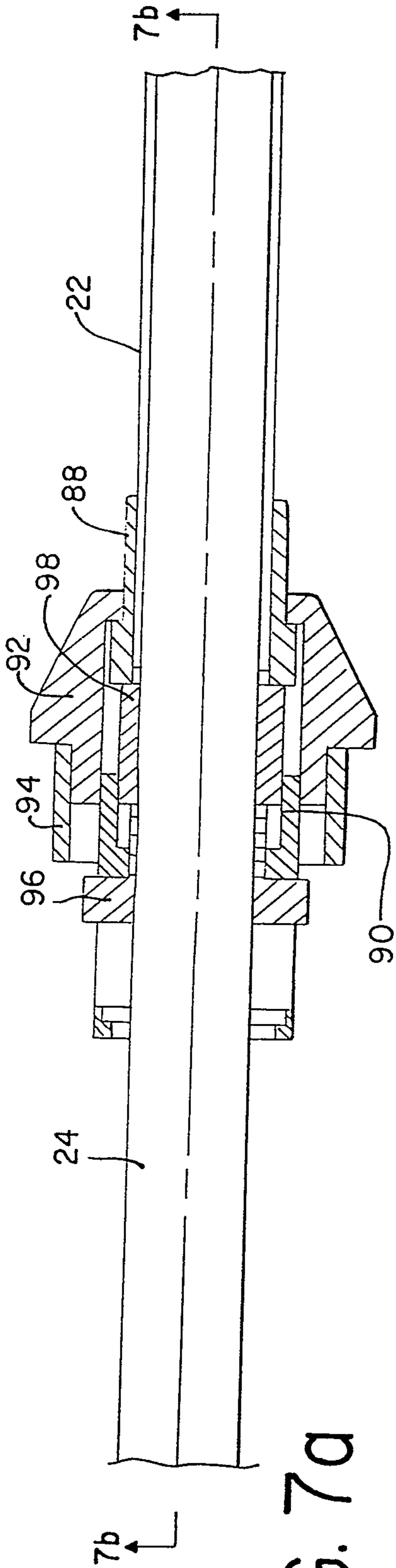

FIG. 7a

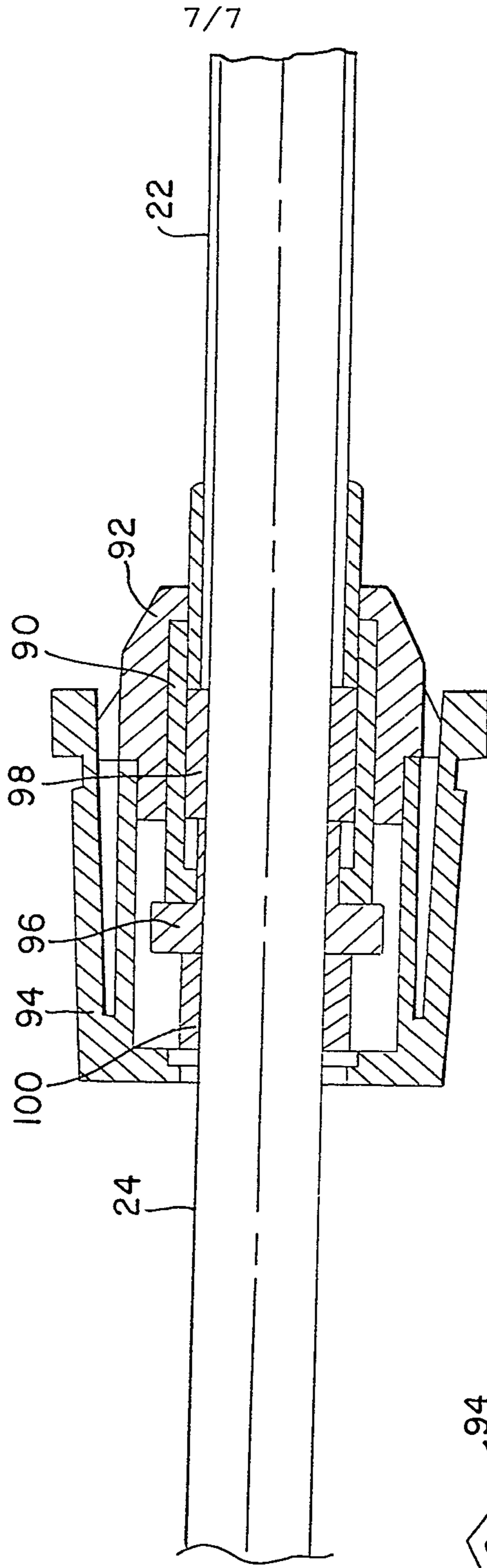

FIG. 7b

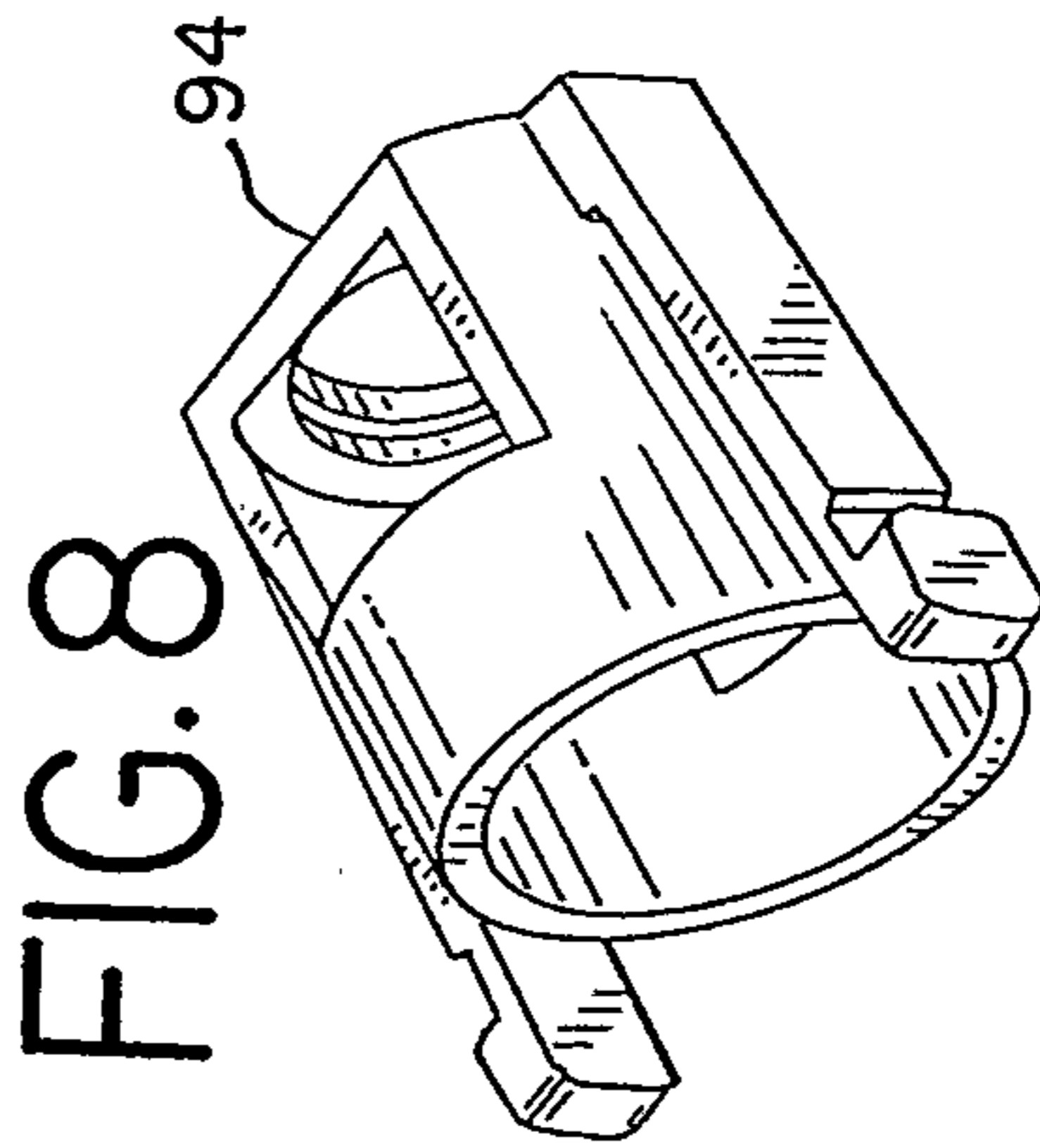

FIG. 8

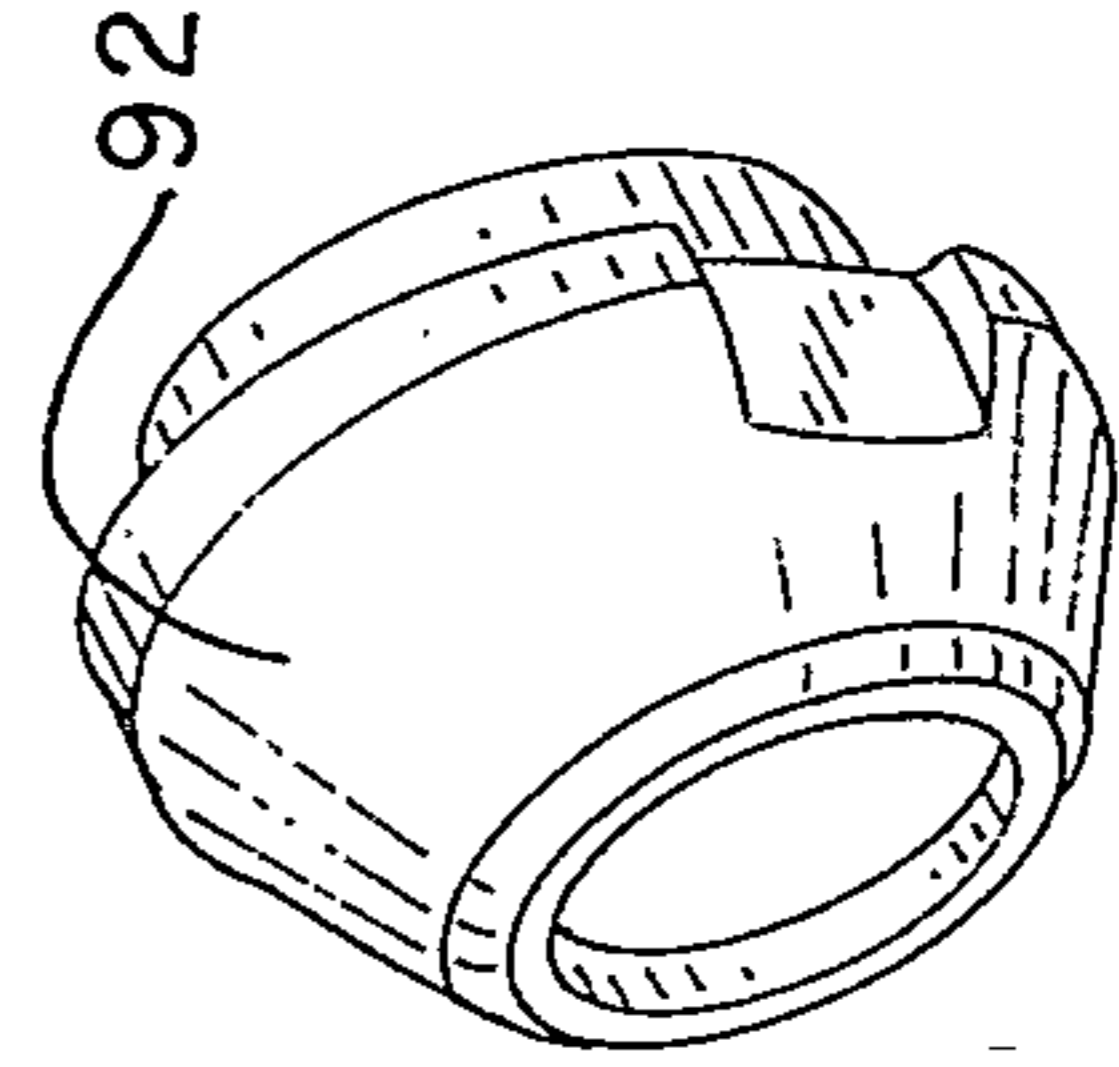

FIG. 9

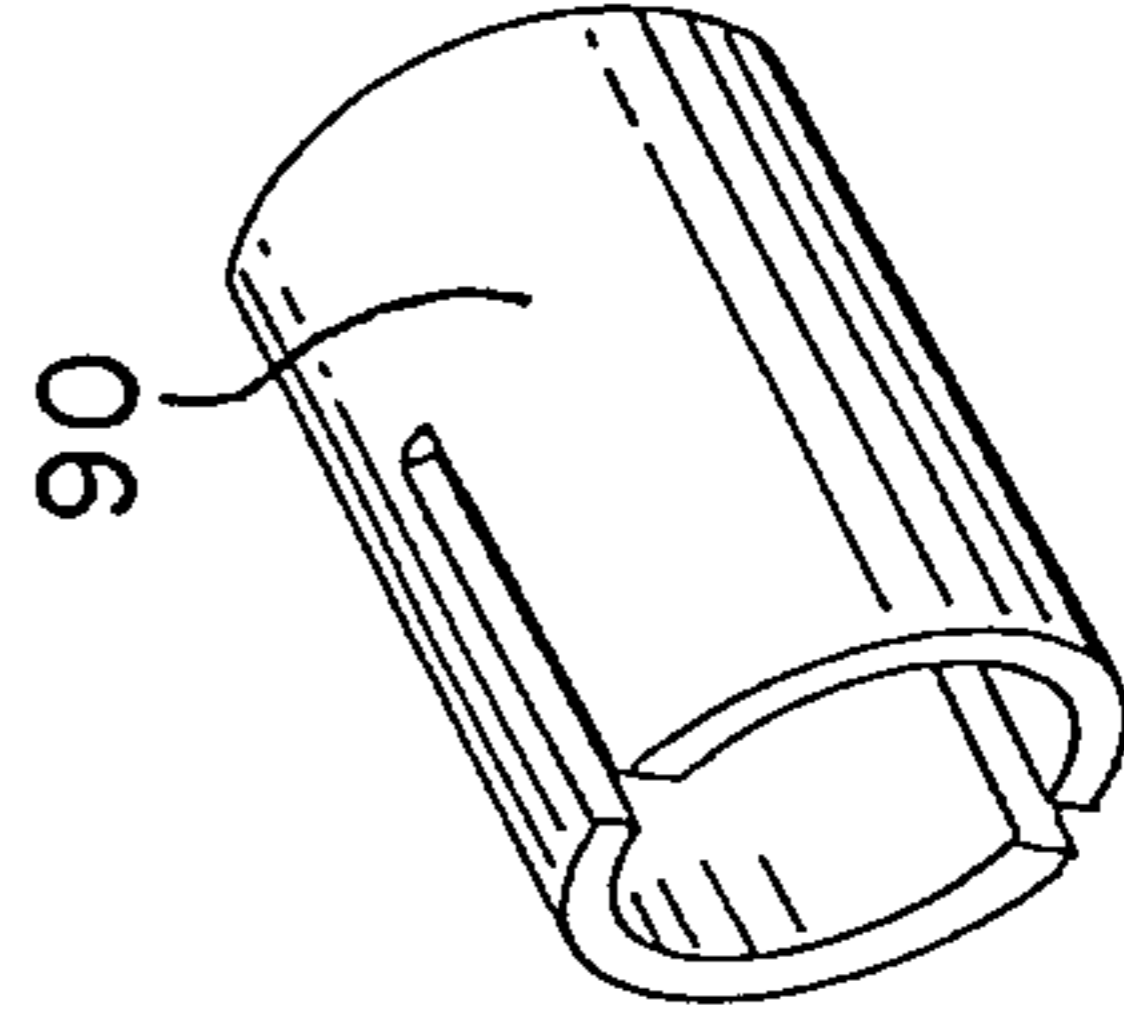

FIG. 10

