



US 20180139433A1

(19) **United States**(12) **Patent Application Publication****Fink et al.**(10) **Pub. No.: US 2018/0139433 A1**(43) **Pub. Date: May 17, 2018**(54) **COMPACT CAMERA DESIGN TO MINIMIZE PARALLAX EFFECTS**(71) Applicant: **VideoStitch Inc.**, San Francisco, CA (US)(72) Inventors: **Alexander Fink**, San Jose, CA (US); **Nicolas Burtsey**, Mountain View, CA (US); **George Haber**, Los Altos Hills, CA (US); **Stéphane Valente**, Paris (FR)**H04N 5/247** (2006.01)**G02B 7/02** (2006.01)**G02B 13/06** (2006.01)**H04N 5/232** (2006.01)(52) **U.S. Cl.**CPC **H04N 13/0022** (2013.01); **H04N 5/265** (2013.01); **H04N 5/23238** (2013.01); **G02B 7/021** (2013.01); **G02B 13/06** (2013.01); **H04N 5/247** (2013.01)(21) Appl. No.: **15/872,344**(22) Filed: **Jan. 16, 2018****Related U.S. Application Data**

(63) Continuation of application No. 15/007,599, filed on Jan. 27, 2016, now Pat. No. 9,883,159, which is a continuation-in-part of application No. 14/982,191, filed on Dec. 29, 2015, now Pat. No. 9,843,725.

Publication Classification(51) **Int. Cl.****H04N 13/00** (2018.01)**H04N 5/265** (2006.01)

(57)

ABSTRACT

An apparatus comprising a plurality of lenses and a frame. The plurality of lenses may be arranged to provide coverage for an omnidirectional field of view of a scene surrounding the apparatus and each have an optical axis directed to provide coverage for a respective area of the omnidirectional field of view. The frame may be configured to hold the plurality of lenses. At least a first one of the lenses and at least a second one of the lenses are neighboring lenses. An orientation of at least two of the neighboring lenses is configured to control parallax effects when the omnidirectional field of view is recorded using the plurality of lenses. The parallax effects are controlled by configuring the optical axes of the neighboring lenses to not line in the same plane.

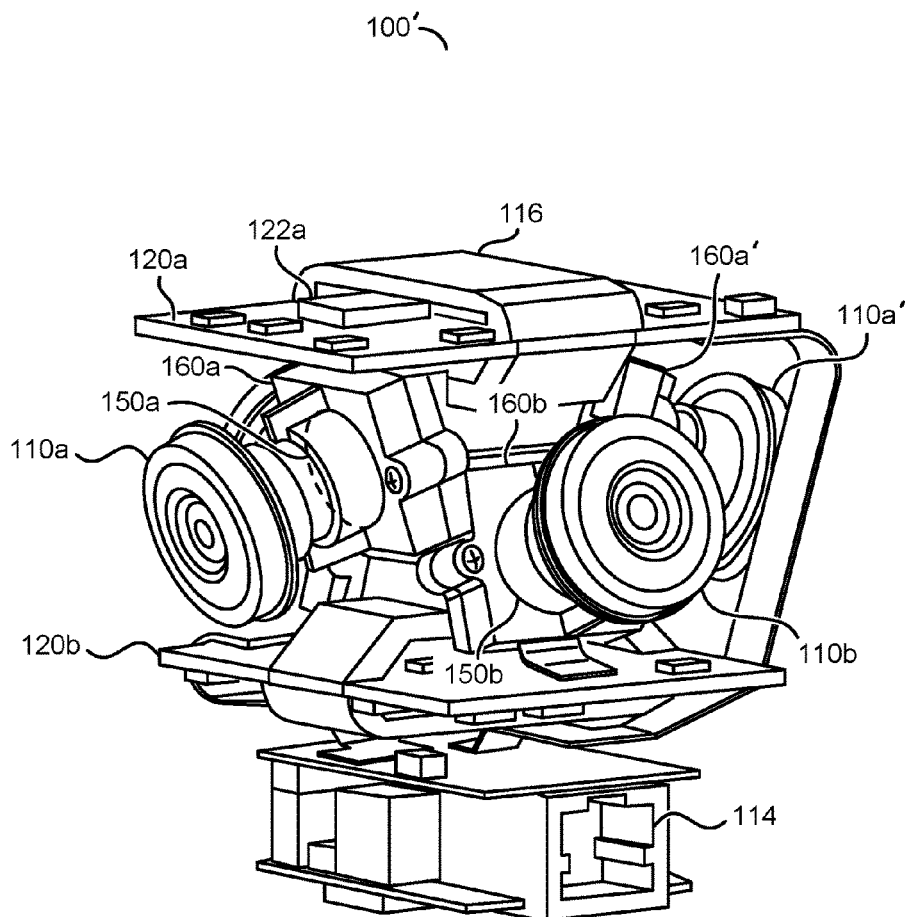

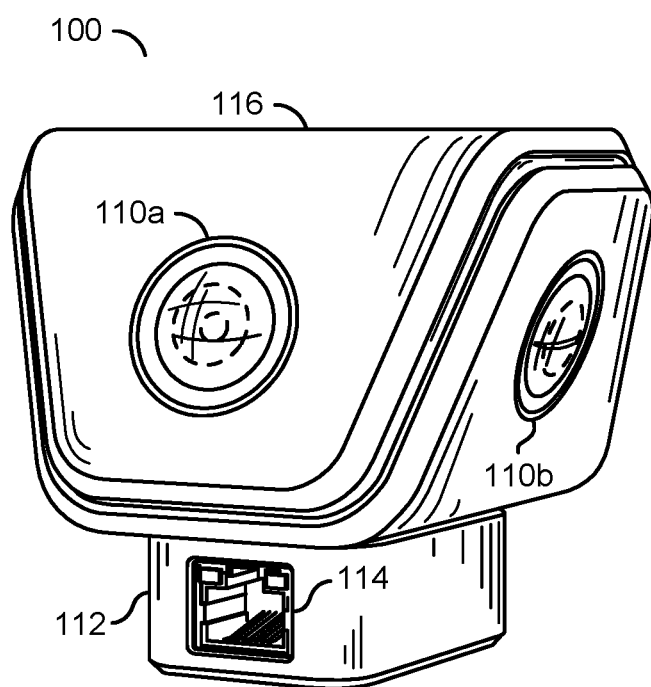
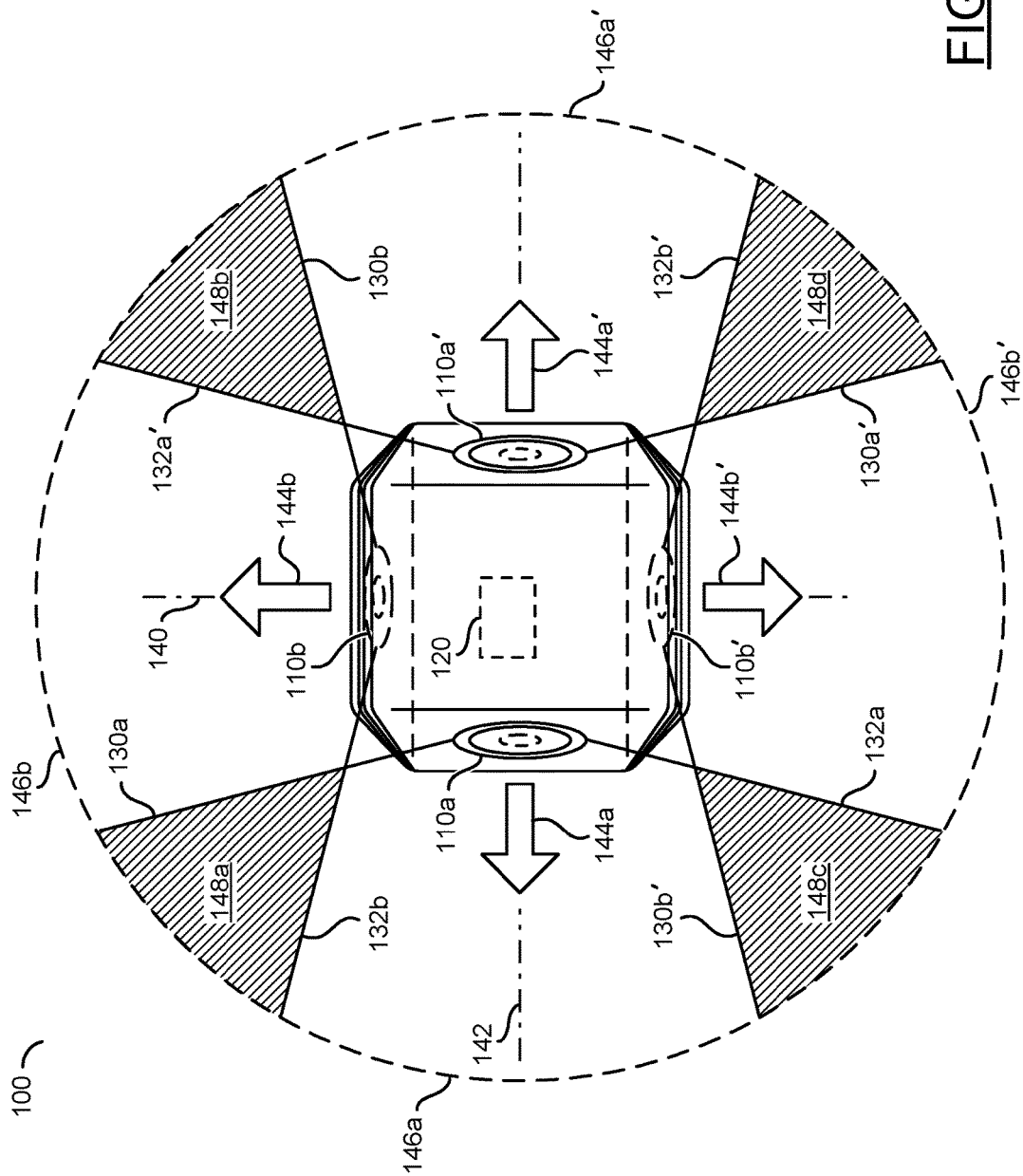

FIG. 1



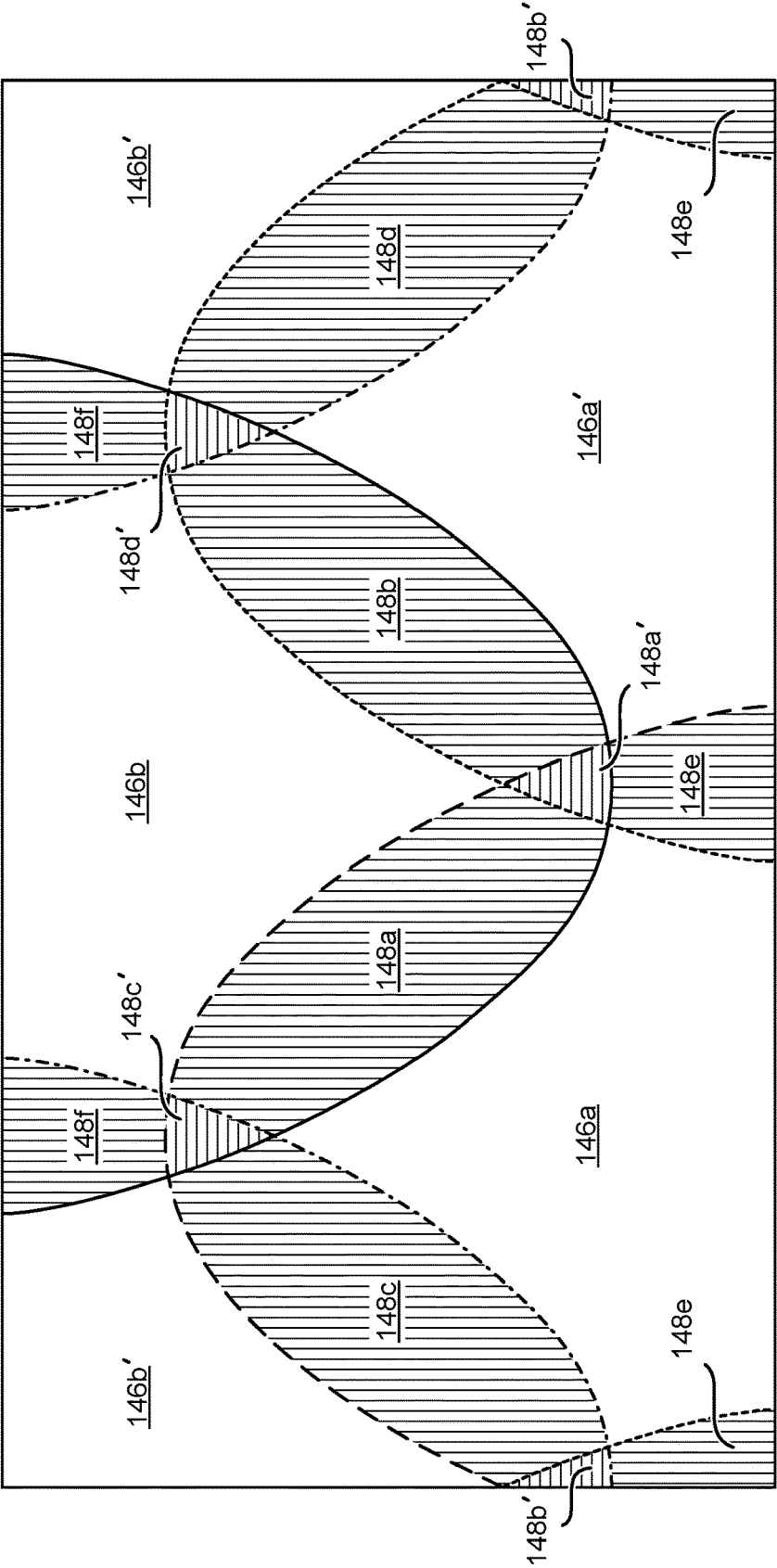

FIG. 3

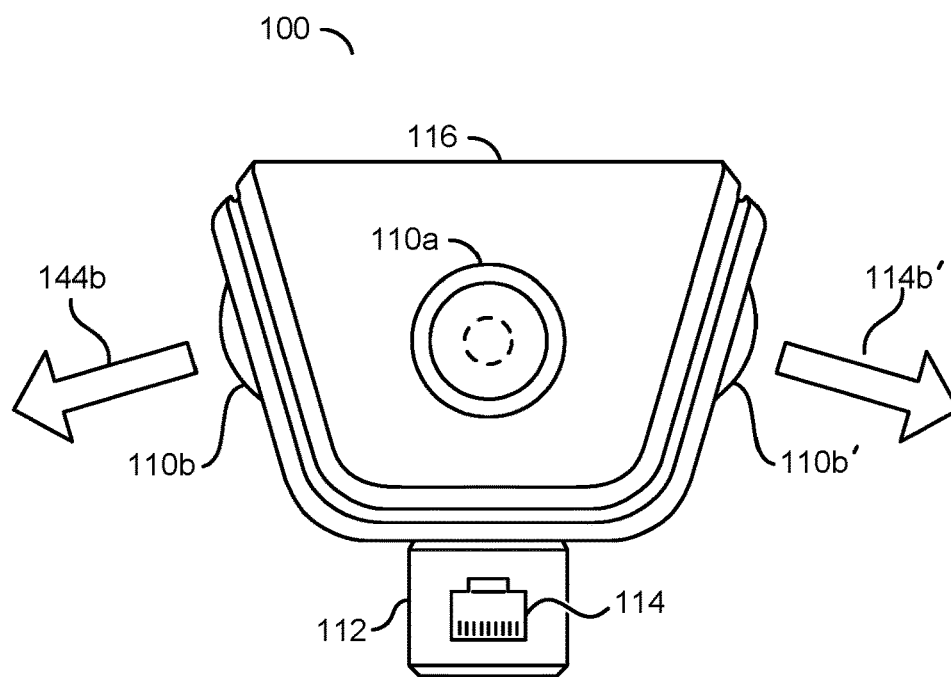

FIG. 4

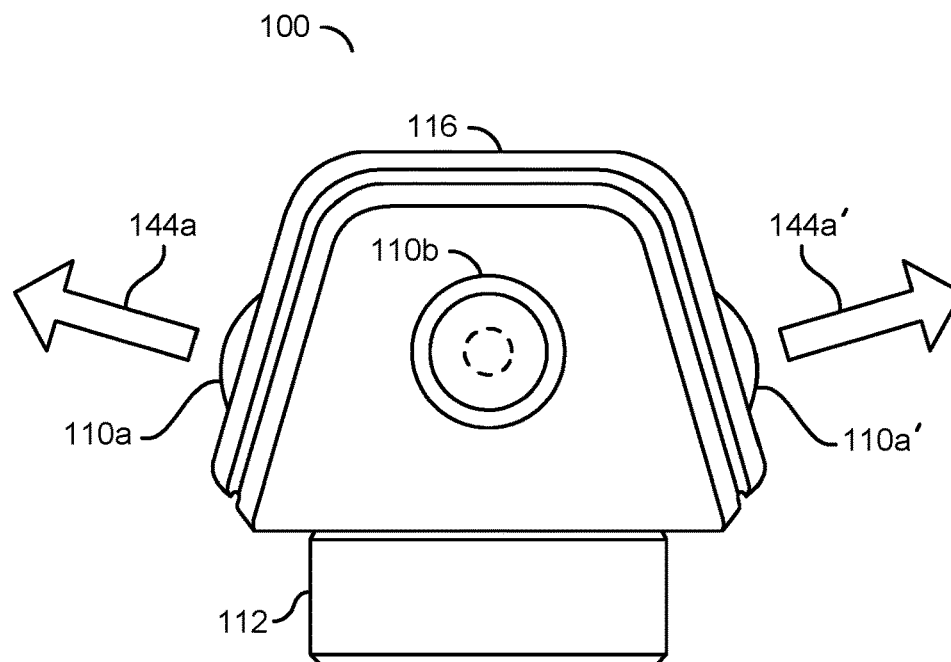

FIG. 5

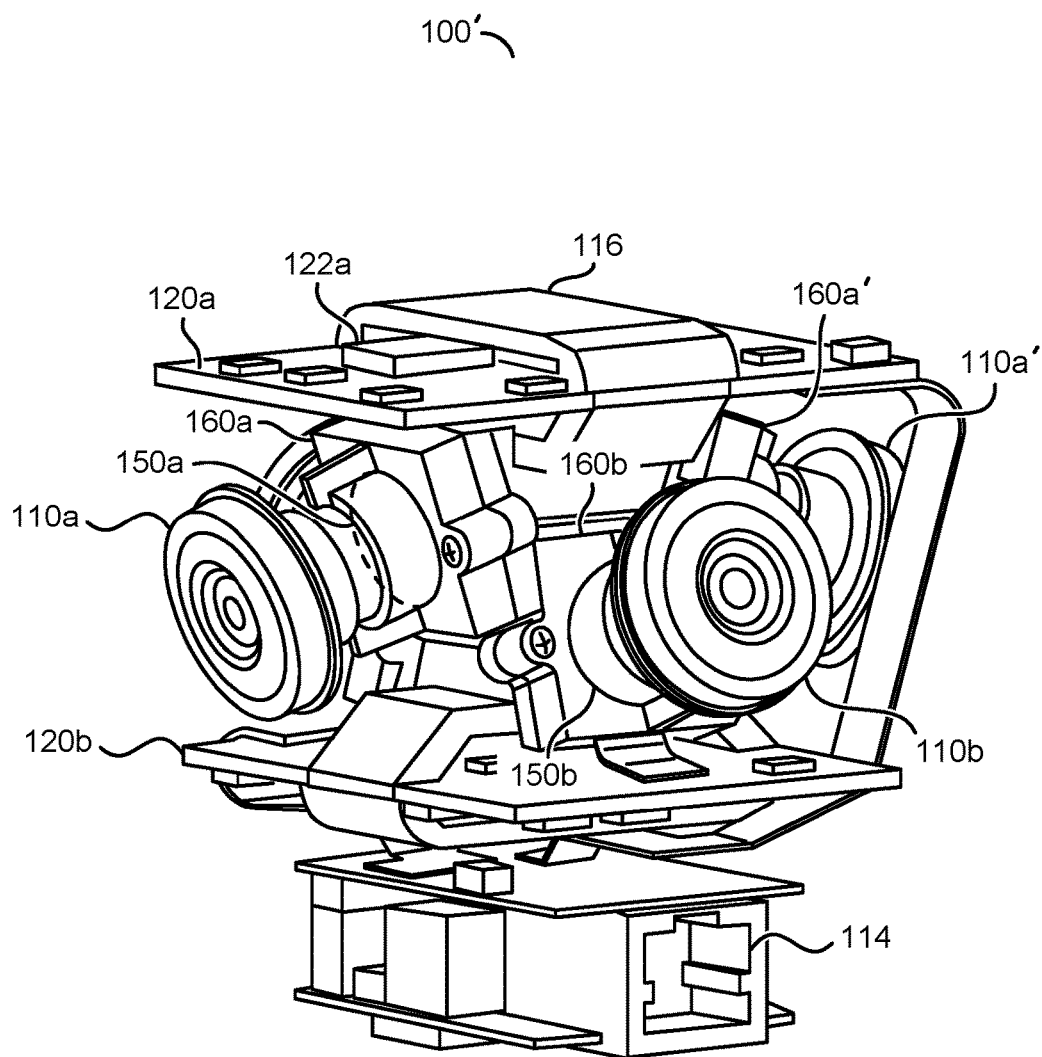

FIG. 6

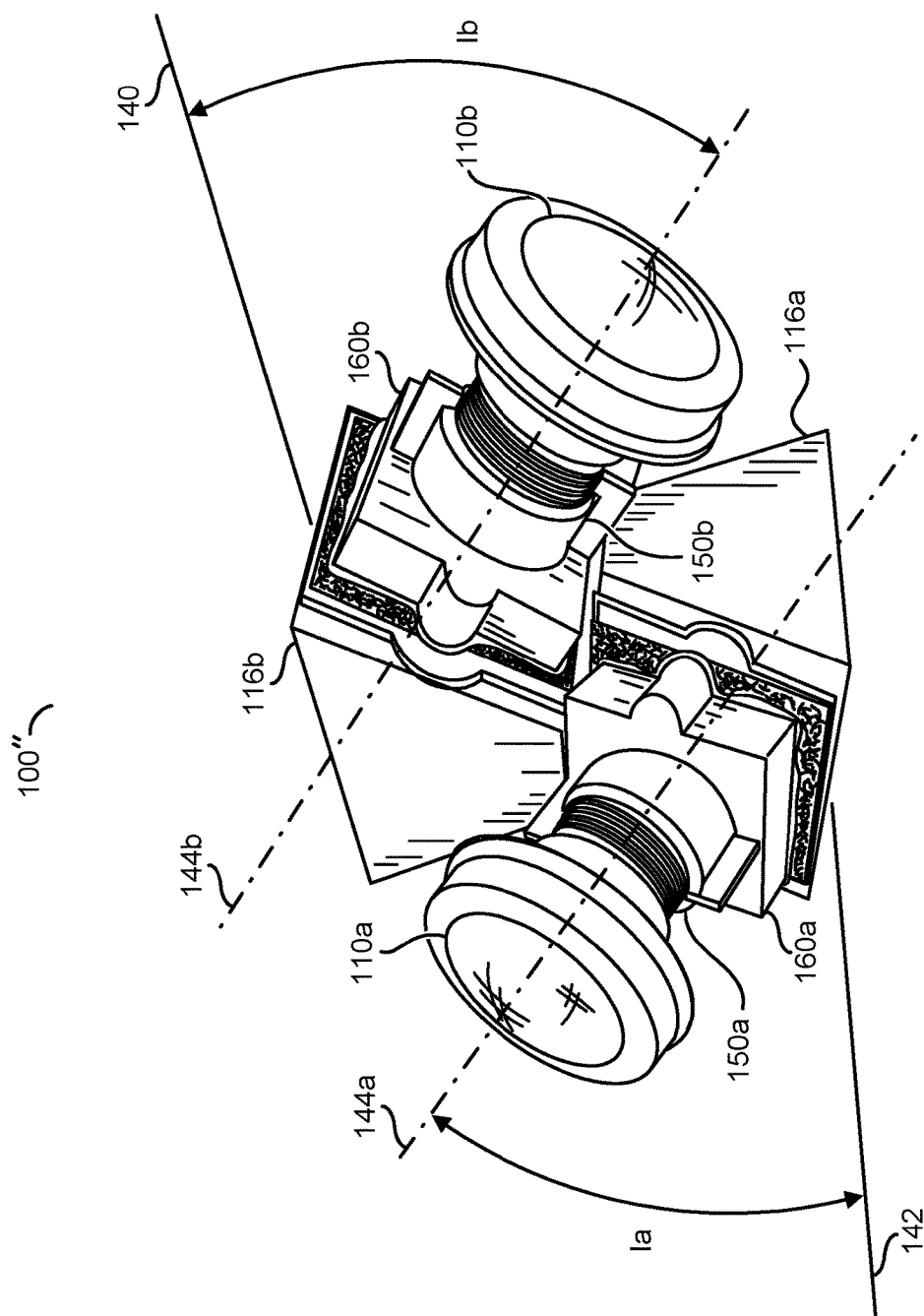

FIG. 7

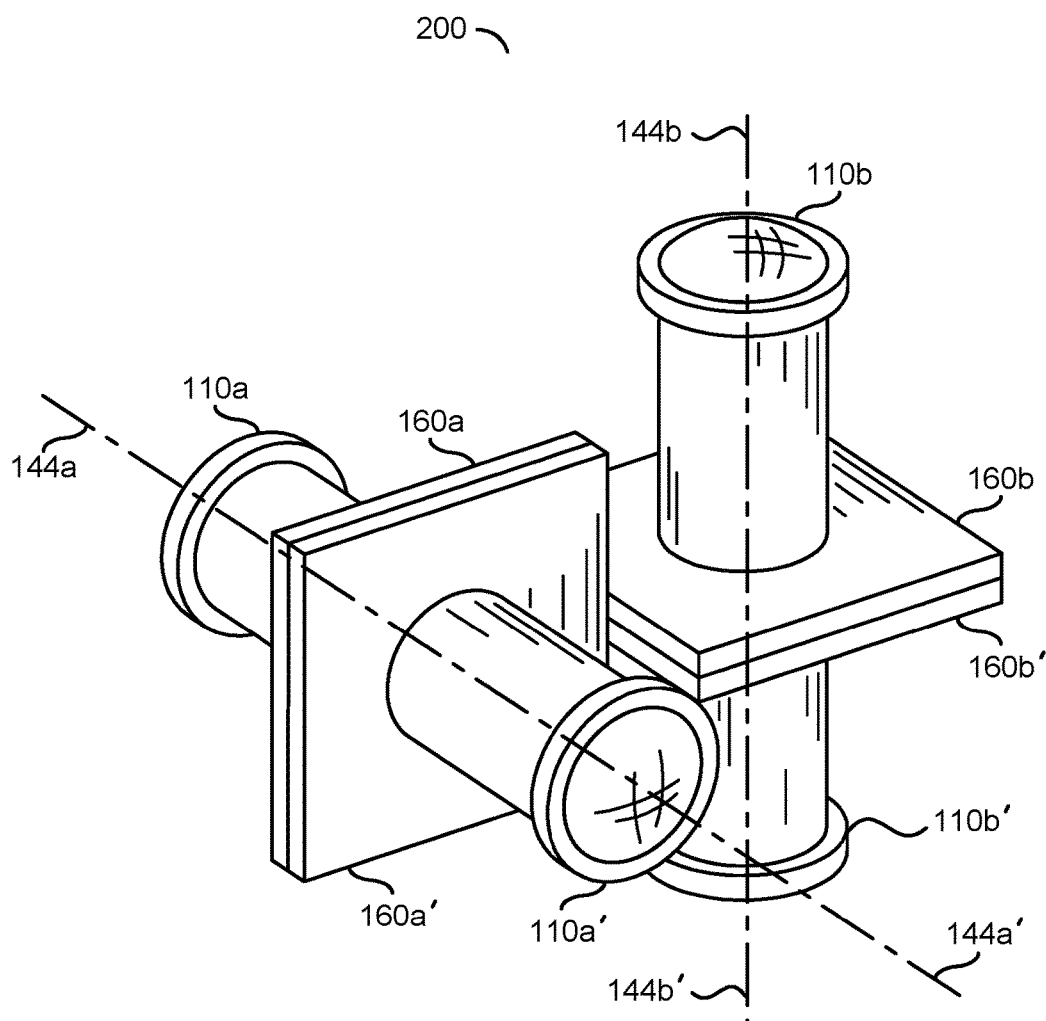

FIG. 8

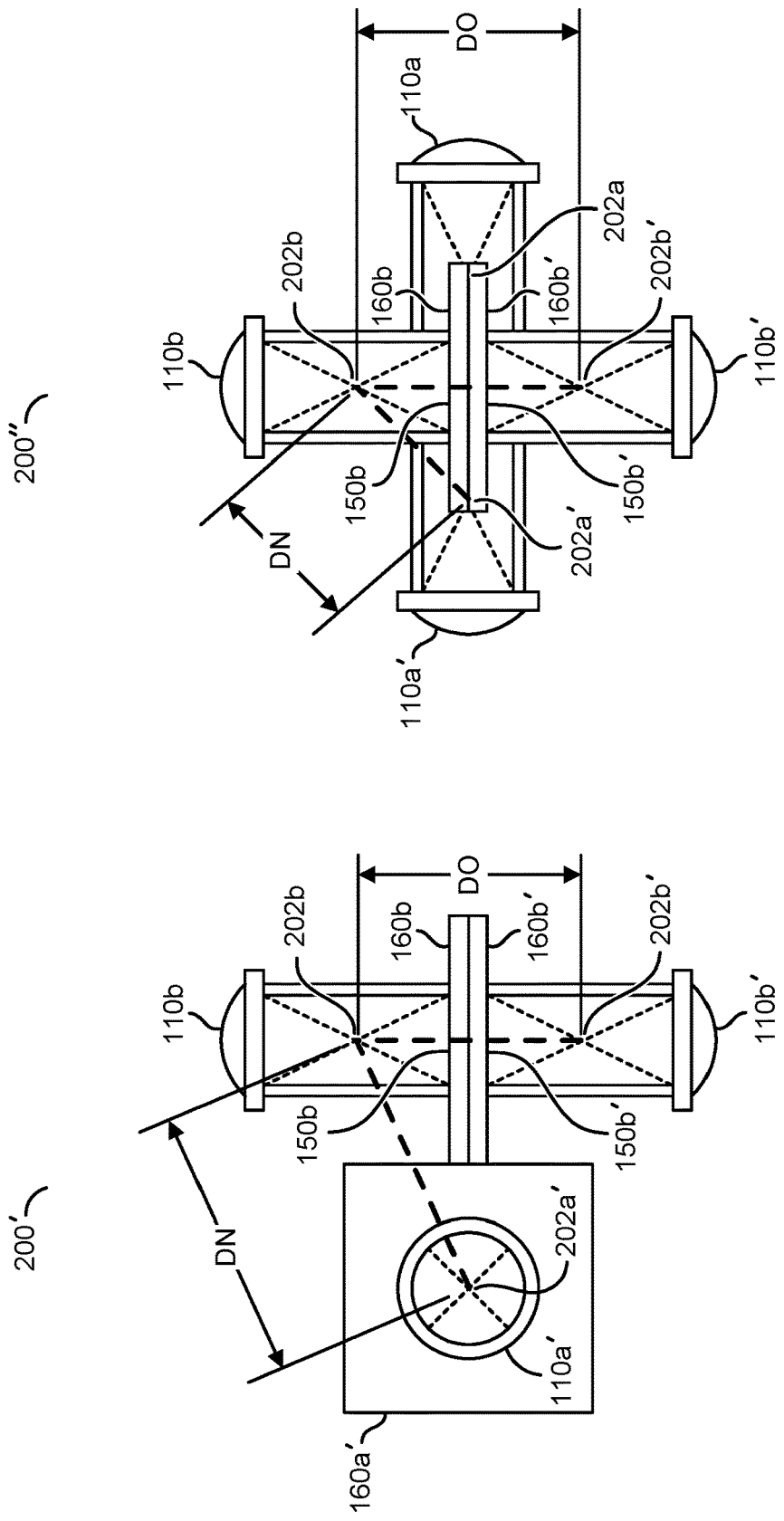

FIG. 10

FIG. 9

FIG. 11

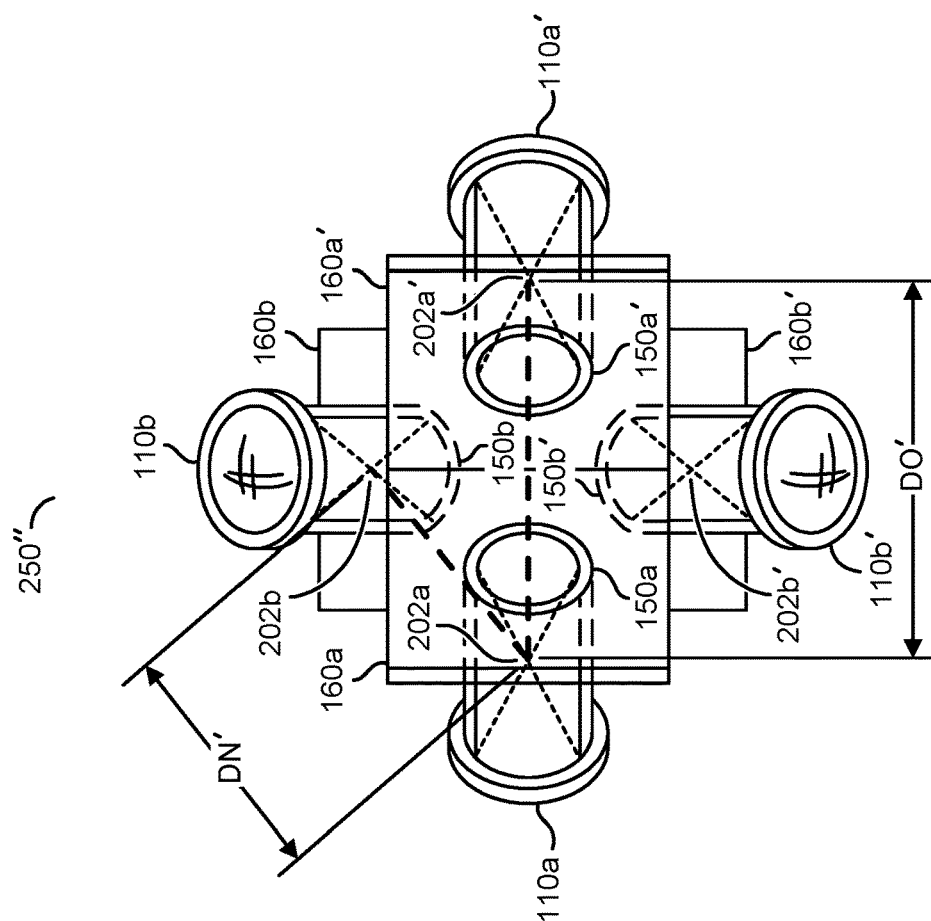

FIG. 12

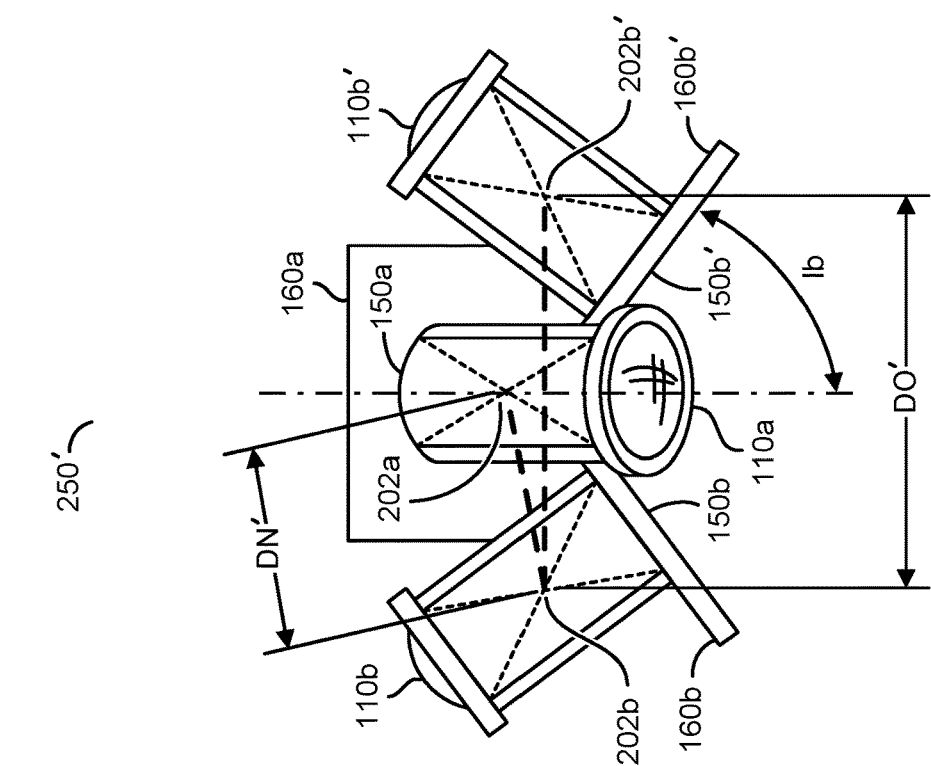

FIG. 13

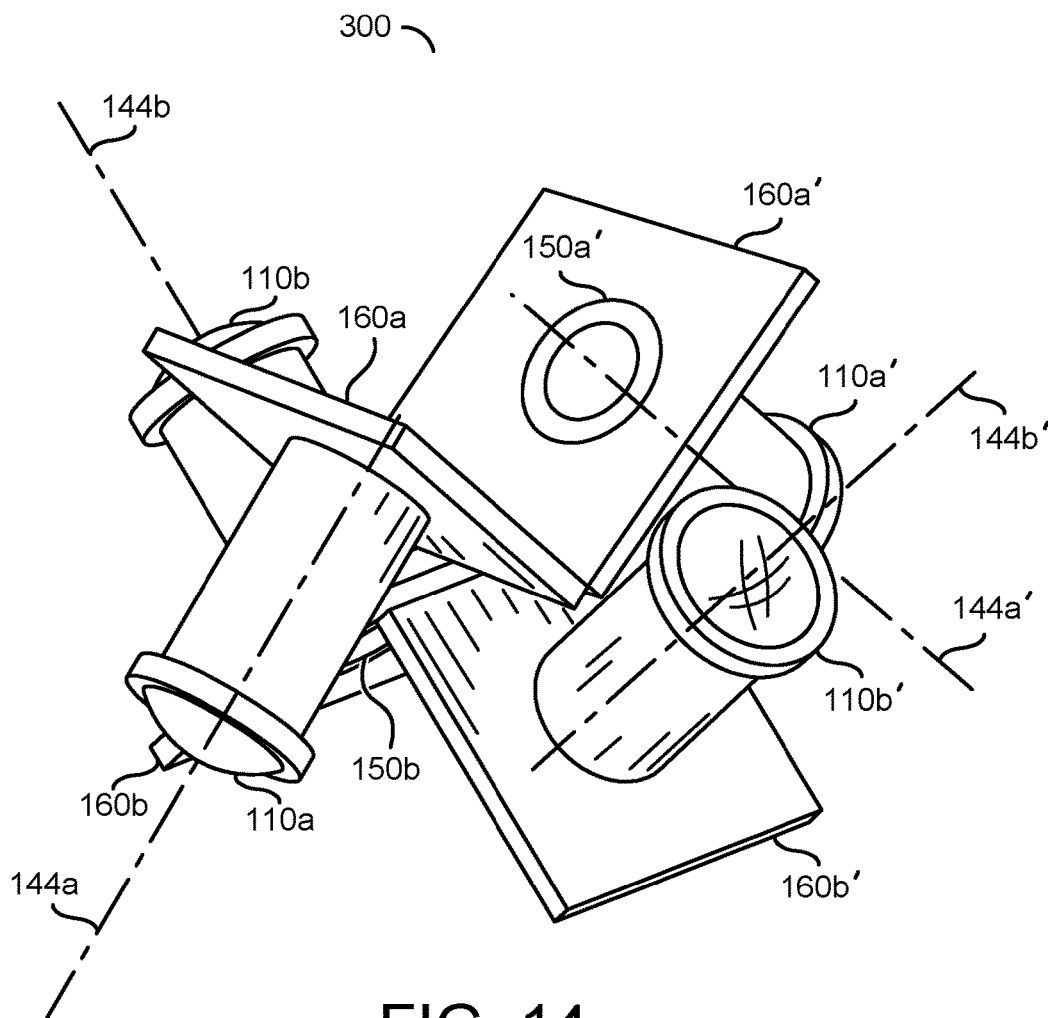

FIG. 14

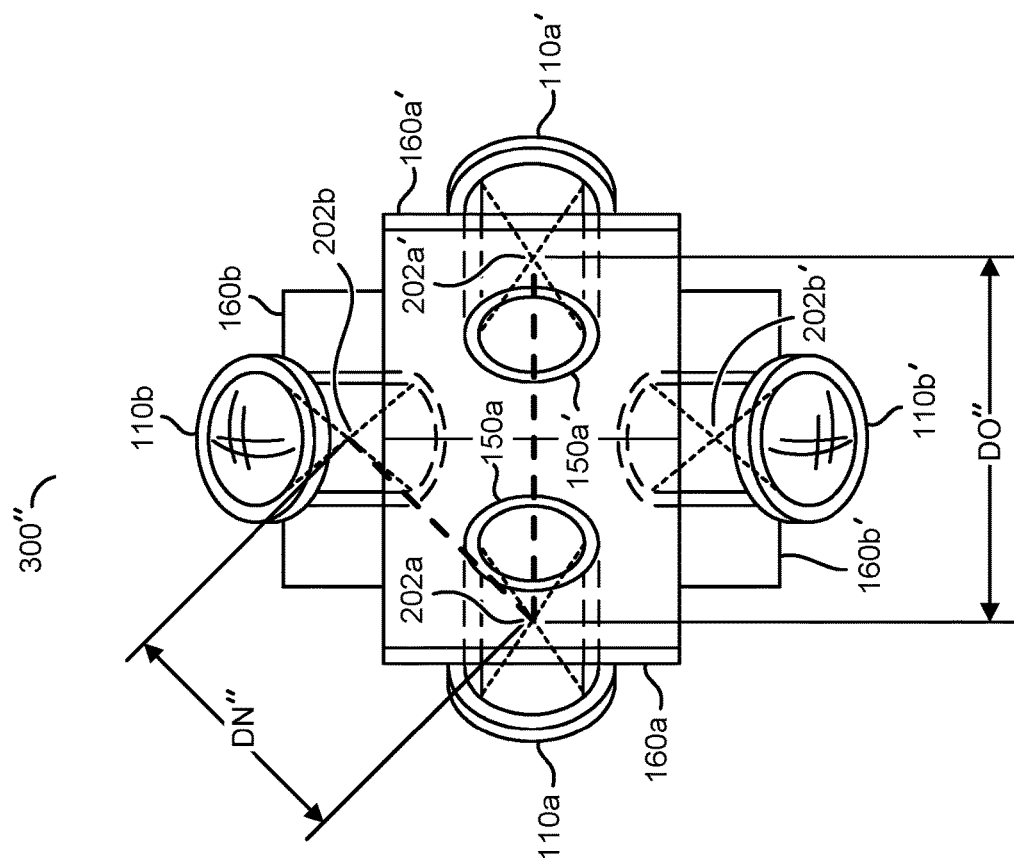

FIG. 15

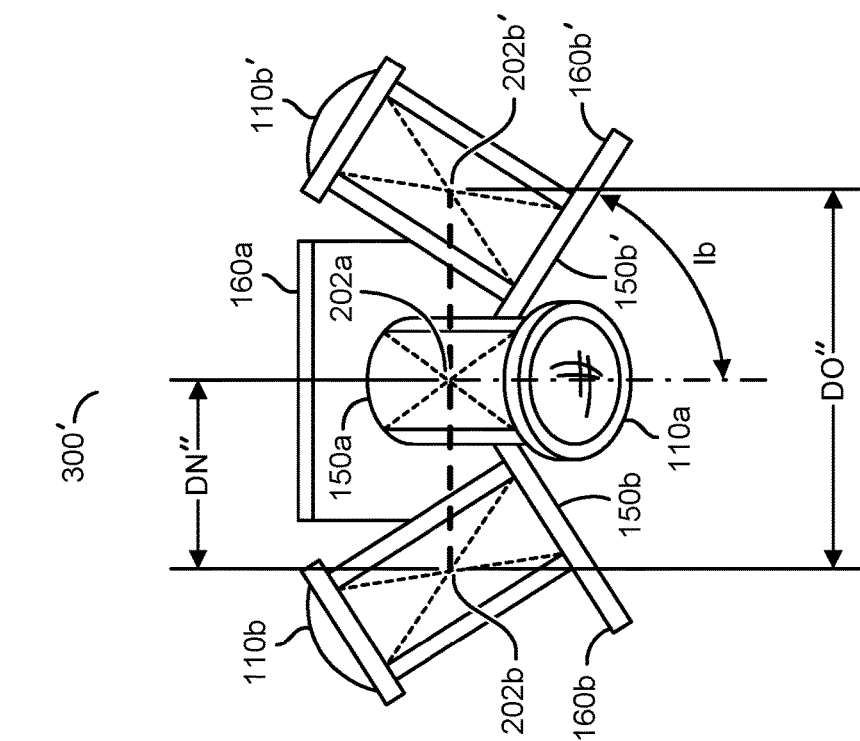

FIG. 16

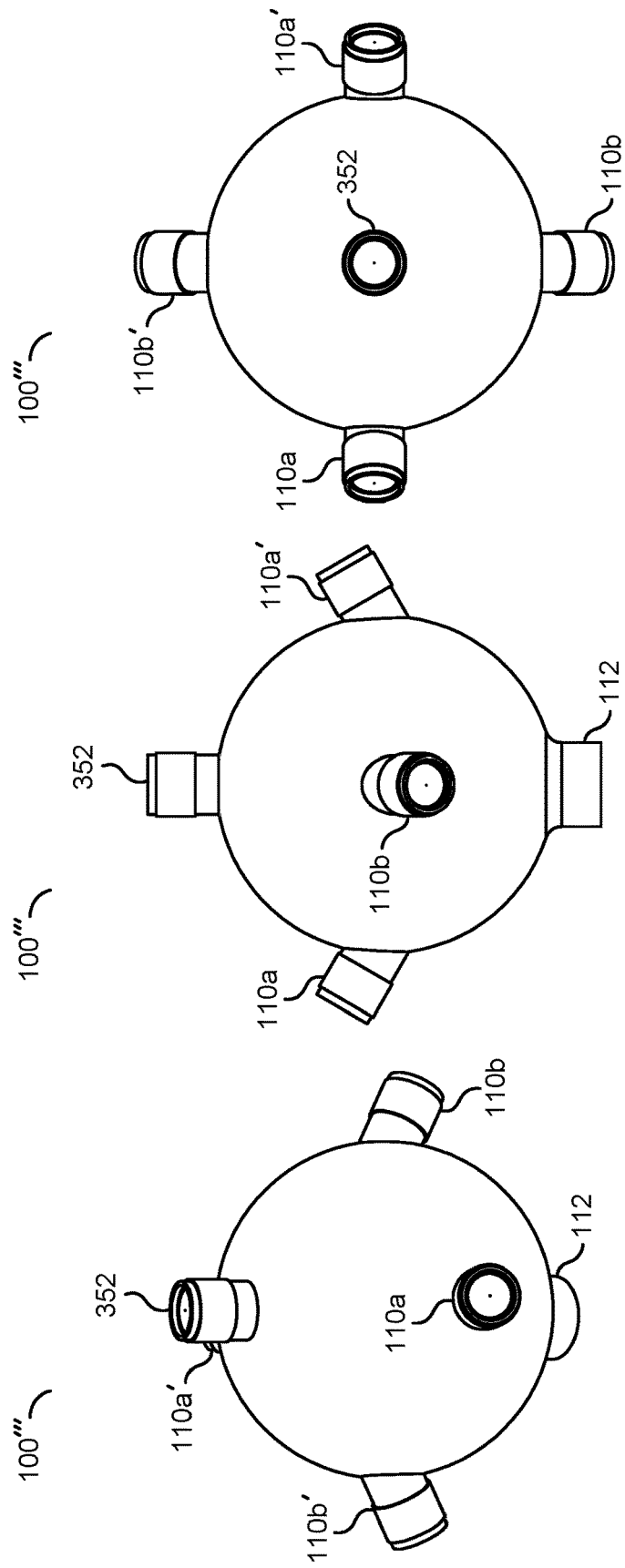

FIG. 17

FIG. 18

FIG. 19

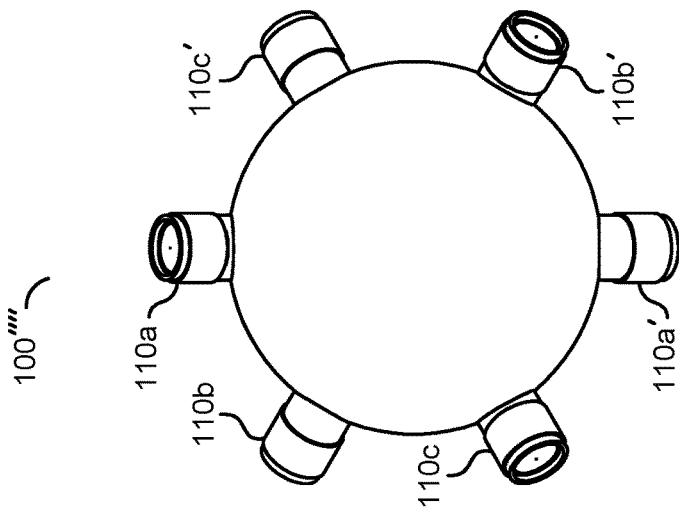

FIG. 22

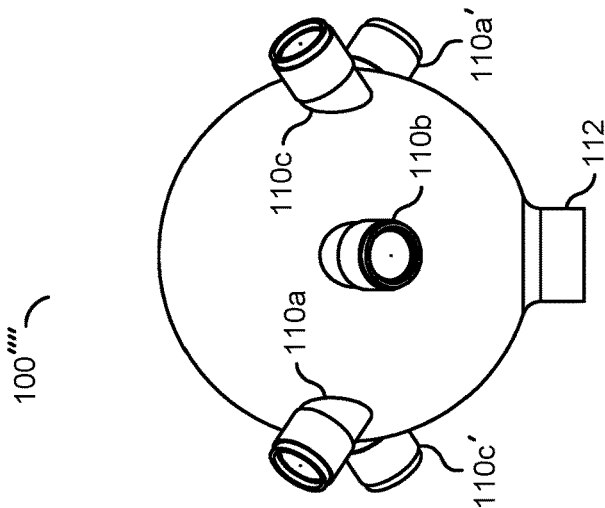

FIG. 21

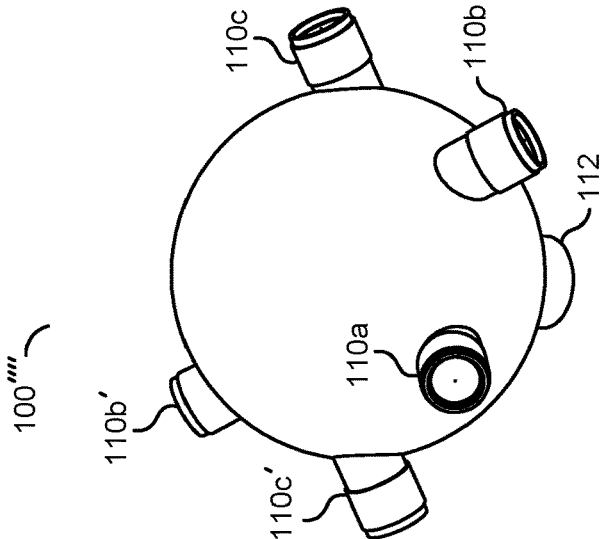

FIG. 20

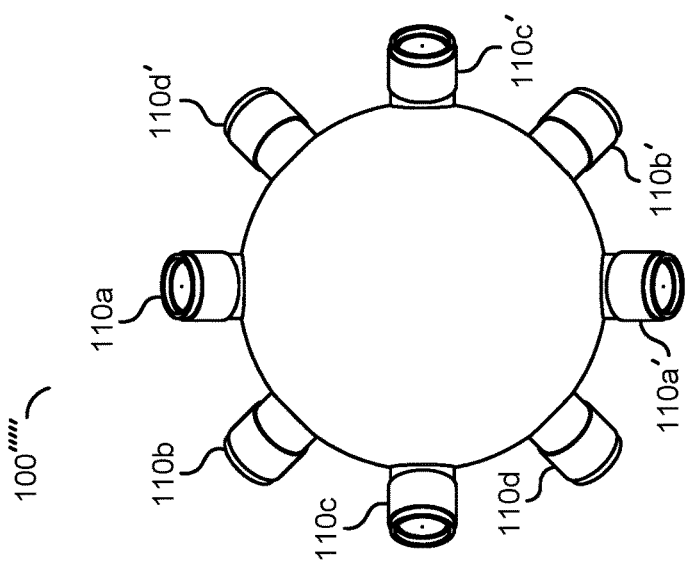

FIG. 23

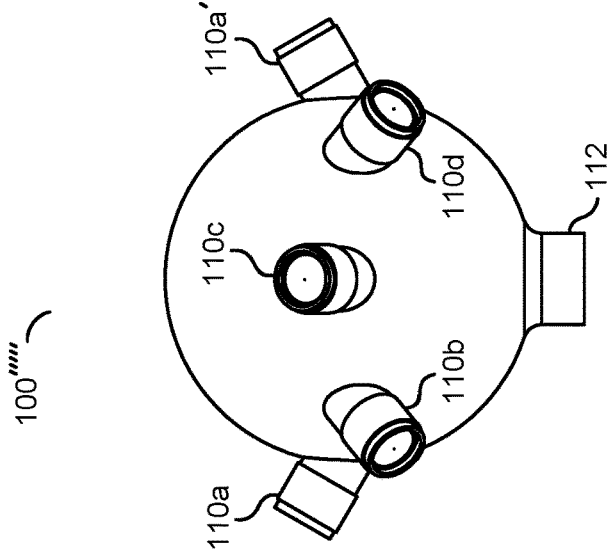

FIG. 24

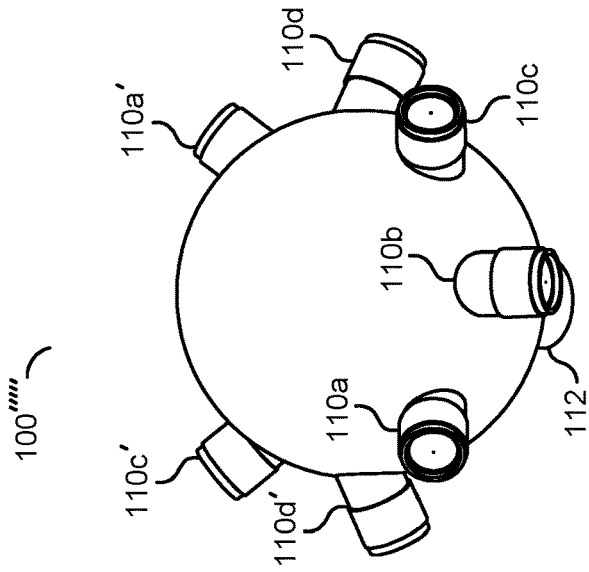

FIG. 25

COMPACT CAMERA DESIGN TO MINIMIZE PARALLAX EFFECTS

[0001] This application relates to U.S. Serial No. 15/007,599, filed Jan. 27, 2016, which relates to U.S. Ser. No. 14/982,191, filed Dec. 29, 2015, now U.S. Pat. No. 9,843,725, which relates to U.S. Ser. No. 14/982,236, filed Dec. 29, 2015, now U.S. Pat. No. 9,787,896, each of which are hereby incorporated by reference in their entirety.

FIELD OF THE INVENTION

[0002] The invention relates to an optical assembly generally and, more particularly, to a method and/or apparatus for implementing an optical assembly for an omnidirectional camera that may minimize parallax effects.

BACKGROUND

[0003] Conventional omnidirectional cameras (also known as virtual reality cameras, spherical cameras, panorama cameras, immersive video cameras, or 360 cameras) present design challenges. The purpose of omnidirectional cameras is to capture video in all directions surrounding the camera (i.e., 360 degrees in each axis). The video captured represents a complete view of a scene surrounding the person watching the video. A user typically uses a head-mounted display or an interactive video player to view the captured video on playback. The video orientation can be changed in any direction during playback.

[0004] The video provides the user with a spherical field of view of the scene surrounding the omnidirectional camera. A single lens cannot capture an entire spherical field of view. Conventional solutions include placing a convex mirror in front of the lens or capturing images from multiple lenses for several separate video signals. Using a mirror only provides a 360 degree horizontal coverage, while losing the top and bottom of the spherical field of view. When using multiple lenses, the multiple images are stitched together into a 360 degree intermediate representation. The multiple images need to have sufficient overlap so that overlapping areas can be blended together to offer a continuous and smooth representation of the scene surrounding the camera.

[0005] When multiple images are stitched together, the parallax of objects viewed by different cameras can create artifacts on the blended/overlapping areas. The parallax occurs because the objects are viewed differently (i.e., at different relative positions) by each camera. Blending artifacts are visible when viewing the spherical field of view and create a distraction from the user experience.

[0006] To avoid parallax related artifacts, two theoretical alternative conditions may be implemented. In one theoretical implementation for reducing parallax related artifacts, all objects are viewed (e.g., captured images) at a sufficient distance (e.g., theoretically an infinite distance). Viewing the objects at the sufficient distance may nullify the parallax related artifacts. However, an infinite viewing distance is not realistic in real camera implementations. In another theoretical implementation, a center of projection (e.g., a focal point, an optical center and/or convergence point) of all cameras share the same physical location. The center of projection may be a point at which initially collimated rays of light meet after passing through a convex lens. Generally, multiple cameras sharing the same location for the centers of projection may not be physically possible, because the center of projection of each camera is located somewhere

between a lens and a sensor of the camera inside each camera module. The volume of space physically occupied by the cameras should intersect so that the respective focal points coincide (or at least be close to one another).

[0007] It would be desirable to implement an omnidirectional camera to minimize parallax effects.

SUMMARY

[0008] The invention concerns an apparatus comprising a plurality of lenses and a frame. The plurality of lenses may be arranged to provide coverage for an omnidirectional field of view of a scene surrounding the apparatus and each have an optical axis directed to provide coverage for a respective area of the omnidirectional field of view. The frame may be configured to hold the plurality of lenses. At least a first one of the lenses and at least a second one of the lenses are neighboring lenses. An orientation of at least two of the neighboring lenses is configured to control parallax effects when the omnidirectional field of view is recorded using the plurality of lenses. The parallax effects are controlled by configuring the optical axes of the neighboring lenses to not line in the same plane.

BRIEF DESCRIPTION OF THE FIGURES

[0009] Embodiments of the invention will be apparent from the following detailed description and the appended claims and drawings in which:

[0010] FIG. 1 is a diagram illustrating an example embodiment of an omnidirectional camera;

[0011] FIG. 2 is a diagram illustrating a top view of the example omnidirectional camera embodiment;

[0012] FIG. 3 is a diagram illustrating overlapping areas captured by the example omnidirectional camera embodiment;

[0013] FIG. 4 is a diagram illustrating a side view of the example omnidirectional camera;

[0014] FIG. 5 is a diagram illustrating another side view of the example omnidirectional camera;

[0015] FIG. 6 is a diagram illustrating a perspective view of an example assembly of an omnidirectional camera;

[0016] FIG. 7 is a diagram illustrating angles of inclination and optical axes of lenses of an omnidirectional camera;

[0017] FIG. 8 is a diagram illustrating an example arrangement of lenses for reducing parallax effects;

[0018] FIG. 9 is a diagram illustrating a side view of the arrangement of the lenses;

[0019] FIG. 10 is a diagram illustrating an alternate side view of the arrangement of the lenses;

[0020] FIG. 11 is a diagram illustrating an example inclined arrangement of lenses for reducing parallax effects;

[0021] FIG. 12 is a diagram illustrating a side view of the example inclined arrangement of lenses;

[0022] FIG. 13 is a diagram illustrating a top view of the example inclined arrangement of lenses;

[0023] FIG. 14 is a diagram illustrating an example aligned incline arrangement of lenses for reducing parallax effects;

[0024] FIG. 15 is a diagram illustrating a side view of the example aligned incline arrangement of lenses;

[0025] FIG. 16 is a diagram illustrating a top view of the example aligned incline arrangement of lenses;

[0026] FIG. 17 is a diagram illustrating a perspective view of an example spherical omnidirectional camera;

[0027] FIG. 18 is a diagram illustrating a side view of the example spherical omnidirectional camera;

[0028] FIG. 19 is a diagram illustrating a top view of the example spherical omnidirectional camera;

[0029] FIG. 20 is a diagram illustrating a perspective view of an example 6-lens spherical omnidirectional camera;

[0030] FIG. 21 is a diagram illustrating a side view of the example 6-lens spherical omnidirectional camera;

[0031] FIG. 22 is a diagram illustrating a top view of the example 6-lens spherical omnidirectional camera;

[0032] FIG. 23 is a diagram illustrating a perspective view of an example 8-lens spherical omnidirectional camera;

[0033] FIG. 24 is a diagram illustrating a side view of the example 8-lens spherical omnidirectional camera; and

[0034] FIG. 25 is a diagram illustrating a top view of the example 8-lens spherical omnidirectional camera.

DETAILED DESCRIPTION OF THE EMBODIMENTS

[0035] Embodiments of the invention include providing a camera that may (i) capture a spherical field of view, (ii) minimize parallax effects, (iii) be implemented without mirrors, (iv) reduce a volume of the omnidirectional camera, (v) implement an arrangement such that centers of projection of neighboring lenses are close to a common location, (vi) capture image data for video processors, (vii) implement an arrangement of lenses such that optical axes of neighboring lenses that have a largest area of overlap do not intersect, (viii) implement a compact design and/or (ix) be implemented using a plurality of lenses.

[0036] Referring to FIG. 1, a diagram of a camera 100 is shown in accordance with an embodiment of the invention. The camera 100 may be an omnidirectional camera. The omnidirectional camera 100 is shown having a first lens 110a, a second lens 110b, a neck 112, an interface 114 and a frame 116. The embodiment shown in FIG. 1 shows the lenses 110a and 110b. More lenses may be implemented. Each of the lenses (e.g., 110a, 110b, etc.) of the omnidirectional camera 100 may be part of a subset of the lenses. The omnidirectional camera 100 may implement two subsets of lenses. For example, the lens 110a may be part of one subset of the lenses and the lens 110b may be part of another subset of the lenses. Generally, a lens in one subset (e.g., the lens 110a) is a neighboring lens of a lens in the other subset (e.g., the lens 110b). For example, the lens 110a and the lens 110b may be neighboring lenses.

[0037] The frame (or casing) 116 may be configured to secure (or hold) the lenses 110a and 110b (and other additional lenses). For example, the lenses (e.g., 110a, 110b, etc.) may be arranged to provide coverage for a spherical field of view of a scene surrounding the omnidirectional camera 100. In another example, the frame 116 may comprise a cover and a core (e.g., a solid core) inside the camera 100 configured to secure the lenses 110a and 110b (and other additional lenses). In some embodiments, the lenses may each cover a field of view that when stitched together provide a scene surrounding the camera 100 in all directions. The neck 112 may provide a mounting interface. For example, a bottom of the neck 112 may provide mechanical connections to mount the camera 100 on a tripod (or other type of stand).

[0038] The omnidirectional camera 100 may reduce (e.g., minimize) parallax effects between lenses by making respective focal points of the lenses (e.g., centers of projection)

closer to a common location. In an example, each of the lenses 110a-110a' and 110b-110b' includes a lens barrel. The lens barrels may be entangled (or interwoven). The centers of projection of the lens barrels may be closer to a common location by entangling the lens barrels. The assembly 100 may be implemented without mirrors. Implementing the assembly 100 without mirrors may reduce a fragility of the assembly 100.

[0039] In an example implementation, four cameras may be implemented (e.g., one camera associated with the lens 110a, another camera associated with the lens 110b and two other cameras not shown from the perspective illustrated in FIG. 1). The assembly 100 may pair opposite cameras two by two, set them back to back, and assemble both pairs orthogonally. The cameras may be tilted to further minimize the distances of the centers of projection from one camera to the other (e.g., move closer to a common location). Generally, the neighboring lenses (e.g., the lens 110a and the lens 110b) may be arranged to reduce the amount of distance between the centers of projection since neighboring lenses may capture a largest amount of overlapping regions in a final stitched view (e.g., the spherical field of view). The largest overlapping regions may cause the greatest amount of artifacts due to parallax effects.

[0040] Referring to FIG. 2, a top view of the omnidirectional camera 100 is shown. The top view of the omnidirectional camera 100 shows the lenses 110a-110a' (e.g., the lenses 110a-110a' and 110b-110b' in one subset of the lenses), the lenses 110b and 110b' (e.g., the lenses 110a-110a' and 110b-110b' in another subset of the lenses) and a block (or circuit) 120. The circuit 120 may comprise various electronic components and/or one or more video processors. For example, the lenses 110a, 110a', 110b and/or 110b' may capture raw data (e.g., light) that may be converted into video frames and processed by the one or more video processors. The configuration of the circuit 120 may be varied according to the design criteria of a particular implementation.

[0041] The top view of the omnidirectional camera 100 shows lines extending from the lenses 110a, 110a', 110b, and 110b'. The lines 130a and 132a are shown extending from the lens 110a. The lines 130a and 132a may represent a range of a field of view of the lens 110a. The lines 130a' and 132a' are shown extending from the lens 110a'. The lines 130a' and 132a' may represent a range of a field of view of the lens 110a'. The lines 130b and 132b are shown extending from the lens 110b. The lines 130b and 132b may represent a range of a field of view of the lens 110b. The lines 130b' and 132b' are shown extending from the lens 110b'. The lines 130b' and 132b' may represent a range of a field of view of the lens 110b'. The lines 130a, 130a', 130b, 130b', 132a, 132a', 132b and/or 132b' may be representative examples. The field of view of each of the lenses 110a-110a' and 110b-110b' may be larger than shown. For example, the lenses 110a-110a' and 110b-110b' may be fish-eye lenses capable of capturing a field of view that is nearly 180 degrees when projected onto a horizontal plane.

[0042] The top view of the omnidirectional camera 100 shows an axis 140 and an axis 142. The axis 140 and the axis 142 are shown in a 90 degree configuration. The axis 140 and the axis 142 may represent a horizontal plane. The top view of the omnidirectional camera 100 shows an arrow 144a, an arrow 144a', an arrow 144b and an arrow 144b'. The arrows 144a-144a' and 144b-144b' may each represent

an optical axis. In FIG. 2, the optical axes **144a-144a'** and **144b-144b'** are shown projected onto the horizontal plane represented by the axis **140** and the axis **142**.

[0043] Each of the optical axes **144a-144a'** and **144b-144b'** may be an axis extending through the center of a corresponding one of the lenses **110a-110a'** and **110b-110b'**. For example, the lens **110a** may have the optical axis **144a**, the lens **110a'** may have the optical axis **144a'**, the lens **110b** may have the optical axis **144b** and the lens **110b'** may have the optical axis **144b'**. The lenses **110a-110a'** and **110b-110b'** may be capable of capturing an area having a 180 degree field of view (e.g., fish-eye lenses).

[0044] Areas **146a**, **146a'**, **146b** and **146b'** are shown surrounding the omnidirectional camera **100**. The areas **146a**, **146a'**, **146b** and **146b'** may be associated with one of the lenses **110a-110a'** and **110b-110b'** (e.g., respective areas). The respective area **146a** may be the field of view of the lens **110a** ranging from the line **130a** to the **132a**. The respective area **146a'** may be the field of view of the lens **110a'** ranging from the line **130a'** to the **132a'**. The respective area **146b** may be the field of view of the lens **110b** ranging from the line **130b** to the **132b**. The respective area **146b'** may be the field of view of the lens **110b'** ranging from the line **130b'** to the **132b'**. The respective areas **146a-146a'** and **146b-146b'** are shown projected onto the horizontal plane defined by the axes **140** and **142**. For example, portions of the respective areas **146a-146a'** and **146b-146b'** may extend above and/or below the lenses **110a-110a'** and **110b-110b'**.

[0045] The respective areas **146a-146a'** and **146b-146b'** captured by each of the lenses **110a-110a'** and **110b-110b'** may be based on the respective optical axes **144a-144a'** and **144b-144b'** (e.g., the optical axes **144a-144a'** and **144b-144b'** may point to a center of the respective areas **146a-146a'** and **146b-146b'** captured by the lenses **110a-110a'** and **110b-110b'**). Generally, the optical axes **144a-144a'** and **144b-144b'** may be arranged to provide coverage for a spherical field of view of a scene surrounding the omnidirectional camera **100**. The spherical field of view may be comprised of the respective areas **146a-146a'** and **146b-146b'**.

[0046] The lens **110a** is shown pointed in a direction along the optical axis **144a** along the axis **142**. Similarly, the lens **110a'** is shown pointed in a direction along the optical axis **144a'** along the axis **142**. In general, the lens **110a** and the lens **110a'** point in opposite directions along the axis **142** (e.g., the optical axis **144a** and the optical axis **144a'** point in opposite directions when projected on the horizontal plane defined by the axis **140** and the axis **142**). For example, the lens **110a** and the lens **110a'** may be considered an opposite lens pair. The lenses **110a** and **110a'** in the opposite lens pair may be one subset of the lenses held by the frame **116** (e.g., each opposite lens pair may be a subset of the lenses).

[0047] The lens **110b** is shown pointed in a direction along the optical axis **144b** along the axis **140**. Similarly, the lens **110b'** is shown pointed in a direction along the optical axis **144b'** along the axis **140**. In general, the lens **110b** and the lens **110b'** point in opposite directions along the axis **140** (e.g., the optical axis **144b** and the optical axis **144b'** point in opposite directions when projected on the horizontal plane defined by the axis **140** and the axis **142**). For example, the lens **110a** and the lens **110a'** may be considered

an opposite lens pair. The lenses **110b** and **110b'** in the opposite lens pair may be one subset of the lenses held by the frame **116**.

[0048] In some embodiments, the lens **110a** may be neighboring lenses with the lens **110b** and neighboring lenses with the lens **110b'**. Similarly, the lens **110b** may be neighboring lenses with the lens **110a** and neighboring lenses with the lens **110a'**, the lens **110b'** may be neighboring lenses with the lens **110a** and neighboring lenses with the lens **110a'**, and the lens **110a'** may be neighboring lenses with the lens **110b** and neighboring lenses with the lens **110b'**. The neighboring lenses (e.g., the lens **110b** and the lens **110a'**) may be adjacent to each other. The adjacent lenses may be lenses (e.g., the lenses **110a** and **110b**) whose distance is smaller than, or equal to, any pair of lenses of the omnidirectional camera **100** with respect to one of the lenses (e.g., the lenses **110a** and **110b** have a distance that is smaller than the distance between the lenses **110a** and **110a'** and equal to the distance between the lenses **110a** and **110b'**). For example, with respect to the lens **110a**, the adjacent (neighboring) lenses are **110b** and **110b'** (e.g., the distance from the lens **110a** and **110b** and **110a** and **110b'** is equal and less than a distance to the lens **110a'**).

[0049] The optical axis of the neighboring lenses may be implemented in a 90 degree configuration (e.g., orthogonal) when the optical axes **144a-144a'** and **144b-144b'** of the lenses **110a-110a'** and **110b-110b'** are projected onto the horizontal plane represented by the axis **140** and the axis **142**. However, an angle between opposite lenses (e.g., lenses **110a** and **110a'**, or the lenses **110b** and **110b'**) may be larger (e.g., if the lenses **110a** and **110a'** or **110b** and **110b'** are tilted in relation to each other). The particular orientation of the optical axes **144a-144a'** and the optical axes **144b-144b'** and/or the lenses **110a-110a'** and the lenses **110b-110b'** may be varied to meet the design criteria of a particular implementation.

[0050] The lenses **110b** and **110b'** may be an opposite lens pair (e.g., one of the subsets of the lenses of the omnidirectional camera **100**). The opposite lens pair **110b-110b'** may be horizontally opposite lenses. Similarly, the opposite lens pair **110a-110a'** may be horizontally opposite lenses. Horizontally opposite lenses may be two lenses (e.g., the lens **110b** and the lens **110b'** and/or the lens **110a** and the lens **110a'**) having orientations 180 degree apart when projected onto the horizontal plane. In the example shown in FIG. 2, the optical axis **144a** and the optical axis **144a'** are shown projected onto the horizontal plane defined by the axis **140** and the axis **142**.

[0051] Generally, the respective areas **146a-146a'** and **146b-146b'** of the spherical field of view captured by the neighboring lenses (e.g., the lenses **110a** and **110b**, the lenses **110a** and **110b'**, the lenses **110a'** and **110b**, etc.) have a large amount of overlap (e.g., an overlap of approximately 45 degrees (or in the range of 40-45 degrees) of horizontal field of view). The large amount of overlap may cause artifacts due to parallax effects after the video stitching operations are performed to create the spherical field of view on video signals captured using the lenses **110a-110a'** and **110b-110b'**. The large amount of overlap may result in significant artifacts (e.g., artifacts that are distracting to a user viewing the spherical field of view). Generally, the arrangement of the lenses **110a-110a'** and **110b-110b'** are

arranged to reduce the parallax effects caused by the different perspectives of the overlapping areas captured by the neighboring lenses.

[0052] Overlapping areas **148a-148d** are shown. The overlapping areas **148a-148d** may illustrate examples of the overlapping areas of neighboring lenses. The overlapping area **148a** is shown between the line **130a** associated with the lens **110a** and the line **132b** associated with the lens **110b**. The overlapping area **148a** may comprise portions of the respective area **146a** and the respective area **146b**. The overlapping area **148a** may be the overlap between the neighboring lenses **110a** and **110b**. The overlapping area **148b** is shown between the line **130b** associated with the lens **110b** and the line **132a'** associated with the lens **110a'**. The overlapping area **148b** may comprise portions of the respective area **146b** and the respective area **146a'**. The overlapping area **148b** may be the overlap between the neighboring lenses **110b** and **110a'**. The overlapping area **148c** is shown between the line **130b'** associated with the lens **110b'** and the line **132a** associated with the lens **110a**. The overlapping area **148c** may comprise portions of the respective area **146a** and the respective area **146b'**. The overlapping area **148c** may be the overlap between the neighboring lenses **110a** and **110b'**. The overlapping area **148d** is shown between the line **130a'** associated with the lens **110a'** and the line **132b'** associated with the lens **110b'**. The overlapping area **148d** may comprise portions of the respective area **144a'** and the respective area **146b'**. The overlapping area **148d** may be the overlap between the neighboring lenses **110a'** and **110b'**.

[0053] Other overlapping areas may exist. For example, an overlapping area may exist with respect to the opposite lens pair **110a-110a'**. In another example, an overlapping area may exist with respect to the opposite lens pair **110b-110b'**. Generally, the overlapping area with respect to the opposite lens pairs (e.g., the lens pairs **110a-110a'** and/or **110b-110b'**) may be small compared to the overlapping areas **148a-148d**. The size of the overlapping areas **148a-148d** may varied according to the design criteria of a particular implementation. Generally, reducing an amount of the overlapping areas **148a-148d** reduces visual artifacts when viewing the spherical field of view.

[0054] Referring to FIG. 3, overlapping areas captured by the example omnidirectional camera **100** are shown. The respective areas **146a-144a'** and **146b-146b'** are shown. The respective areas **146a-146a'** and **146b-144b'** in FIG. 3 are shown in an arrangement similar to how a stitched together video signal would appear for the spherical field of view when projected onto a two-dimensional surface using an equirectangular projection. Various overlapping areas are shown.

[0055] The overlapping areas **148a-148d** of the neighboring lenses are shown. The overlapping area **148a** is shown as part of the coverage of the respective areas **146a** and **146b**. The overlapping area **148b** is shown as part of the coverage of the respective areas **146b** and **144a'**. The overlapping area **148c** is shown as part of the coverage of the respective areas **146a** and **144b'**. The overlapping area **148d** is shown as part of the coverage of the respective areas **144a'** and **144b'**.

[0056] Some of the overlapping areas correspond to overlapping areas of the opposite lens pairs (e.g., the opposite lens pair **110a-110a'** and the opposite lens pair **110b-110b'**). Overlapping areas **148e** are shown as part of the coverage of

the respective areas **146a** and **144a'** corresponding to the opposite lens pair **110a-110a'**. Overlapping areas **148f** are shown as part of the coverage of the respective areas **146b** and **144b'** corresponding to the opposite lens pair **110b-110b'**.

[0057] Some of the overlapping areas correspond to overlapping areas between three of the lenses **110a-110a'** and **110b-110b'**. An overlapping area **148a'** comprises the respective areas **146a**, **144a'** and **146b** (e.g., the overlapping area **148a'** comprises the overlapping areas **148a**, **148b** and **148e**). An overlapping area **148a'** comprises the respective areas **146a**, **144a'** and **144b'** (e.g., the overlapping area **148b'** comprises the overlapping areas **148c**, **148d** and **148e**). An overlapping area **148c'** comprises the respective areas **146a**, **146b** and **144b'** (e.g., the overlapping area **148c'** comprises the overlapping areas **148a**, **148c** and **148f**). An overlapping area **148d'** comprises the respective areas **144a'**, **146b** and **144b'** (e.g., the overlapping area **148d'** comprises the overlapping areas **148b**, **148d** and **148f**). The respective areas **146a-146a'** and **146b-144b'**, the overlapping areas **148a-148f** and the overlapping areas **148a'-148d'** shown in FIG. 3 are a representative example. The various sizes of the respective areas **146a-146a'** and **146b-144b'**, the overlapping areas **148a-148f** and the overlapping areas **148a'-148d'** may be varied according to the design criteria of a particular implementation.

[0058] Generally, the overlapping areas between neighboring lenses (e.g., the overlapping areas **148a-148d**) are larger than the overlapping areas between the lens pairs (e.g., **148e-148f**). Since the overlapping areas between neighboring lenses (e.g., the overlapping areas **148a-148d**) are larger than the overlapping areas between the lens pairs (e.g., **148e-148f**), reducing an amount of the overlapping areas **148a-148d** may have a greater impact on reducing the parallax effects than reducing the amount of the overlapping areas **148e-148f**.

[0059] Referring to FIG. 4, a first side view of the omnidirectional camera **100** is shown. The direction of the optical axis **144b** of the lens **110b** and the direction of the optical axis **144b'** of the lens **110b'** are shown at a slightly downward angle. The slightly downward angle of the optical axes **144b-144b'** of the lenses **110b-110b'** may allow the lenses of the omnidirectional camera **100** to provide coverage for the spherical (or omnidirectional) field of view of the scene surrounding the camera **100**. In some embodiments, the lenses **110b-110b'** may capture a portion of the scene surrounding the camera **100** in all directions. The slightly downward angle of the optical axes **144b-144b'** may allow the lenses **110b-110b'** to capture the respective areas **146b-146b'** of the spherical field of view on two sides and below the omnidirectional camera **100**.

[0060] The lenses **110b** and **110b'** may be part of one subset of the lenses of the camera **100**. In the embodiment shown in FIG. 4, the lenses **110b** and **110b'** may be opposite lenses on the camera **100** (e.g., an opposite lens pair). The optical axis **144b** of the lens **110b** and the optical axis **144b'** of the lens **110b'** may intersect (e.g., at a location in the frame **116**). The respective areas **146b-146b'** of the spherical field of view captured by the lenses **110b** and **110b'** may have a slight amount of overlap. Since there is a slight overlap of the respective areas **146b-144b'**, there may be a small amount of artifacts due to parallax effects between the opposite lenses **110b** and **110b'**. Generally, reducing parallax effects caused by the opposite lenses **110b** and **110b'** is less

important than reducing parallax effects caused by the neighboring lenses (e.g., the lens 110b with respect to the lenses 110a and 110a' and/or the lens 110b' with respect to the lenses 110a and 110a').

[0061] Referring to FIG. 5, a second side view of the omnidirectional camera 100 is shown. The direction of the optical axis 144a of the lens 110a and the direction of the optical axis 144a' of the lens 110a' are shown at a slightly upward angle. The slightly upward angle of the optical axes 144a-144a' of the lenses 110a-110a' may allow the lenses of the omnidirectional camera 100 to provide coverage for the spherical (or omnidirectional) field of view of the scene surrounding the camera 100. In some embodiments, the lenses 110a-110a' may capture a portion of the scene surrounding the camera 100 in all directions. The slightly upward angle of the optical axes 144a-144a' may allow the lenses 110a-110a' to capture the respective areas 146a-146a' of the spherical field of view on two sides and above the omnidirectional camera 100.

[0062] The lenses 110a and 110a' may be part of one subset of the lenses of the camera 100. In the embodiment shown in FIG. 5, the lenses 110a and 110a' may be opposite lenses on the camera 100 (e.g., an opposite lens pair). The optical axis 144a of the lens 110a and the optical axis 144a' of the lens 110a' may intersect (e.g., at a location in the frame 116). The respective areas 146a-146a' of the spherical field of view captured by the lenses 110a and 110a' may have a slight amount of overlap. Since there is a slight overlap of the respective areas 146a-146a', there may be a small amount of artifacts due to parallax effects between the opposite lenses 110a and 110a'. Generally, reducing parallax effects caused by the opposite lenses 110a and 110a' is less important than reducing parallax effects caused by the neighboring lenses (e.g., the lens 110a with respect to the lenses 110b and 110b' and/or the lens 110a' with respect to the lenses 110b and 110b').

[0063] A combination of one subset of the lenses (e.g., the lenses 110a-110a') and another subset of the lenses (e.g., the lenses 110b-110b') may provide coverage for a spherical field of view and reduce parallax effects when the spherical field of view is reduced using the lenses 110a-110a' and 110b-110b'. The lenses 110a-110a' may provide coverage for respective areas 146a-146a' above the omnidirectional camera 100 and on two sides of the omnidirectional camera 100. The lenses 110b-110b' may provide coverage for respective areas 146b-146b' below the omnidirectional camera 100 and on the two other sides of the omnidirectional camera 100. By capturing the respective areas 146a-146a' and 146b-146b' from the lenses 110a-110a' and 110b-110b' as video frames, converting the video frames into video files and stitching the video files together, a spherical field of view may be generated.

[0064] Referring to FIG. 6, a perspective view of an example assembly of the omnidirectional camera 100' is shown. The example assembly of the omnidirectional camera 100' may comprise one subset of lenses (e.g., the opposite lens pair 110a-110a'), another subset of lenses (e.g., the opposite lens pair 110b-110b'), the interface 114, the frame 116 and/or the circuits 120a-120b. The frame 116 is shown as a unibody design assembly.

[0065] The circuits 120a-120b may implement components configured to provide power, connections (e.g., traces, data buses, etc.), signals, and/or logic for the operation of the omnidirectional camera 100'. In an example, one circuit may

be configured to operate with one of the opposite lens pairs (e.g., the circuit 120a may operate with the subset of lenses comprising the lens 110a and the lens 110a', and the circuit 120b may operate with the subset of lenses comprising the lens 110b and the lens 110b'). In another example, the circuits 120a-120b may operate with each of the lenses 110a-110a' and 110b-110b'. The implementation of the circuits 120a-120b may be varied according to the design criteria of a particular implementation.

[0066] The circuit 120a is shown comprising a block (or circuit) 122a. The circuit 122a may be a video processor. Similarly, the circuit 120b may comprise a video processor 122b. Other components may be implemented on the circuits 120a-120b (e.g., a communication block, an audio codec block, a memory, etc.).

[0067] The lens 110a is shown having a sensor 150a. The lens 110b is shown having a sensor 150b. Similarly the other lenses may have respective sensors (e.g., the lens 110a' may have an associated sensor 150a' and the lens 110b' may have an associated sensor 150b'). Each of the lenses 110a-110a' and 110b-110b' may have a respective base 160a-160a' and 160b-160b'. The bases 160a-160a' and 160b-160b' may contain the respective sensors 150a-150a' and 150b-150b' and/or other logic. For example, the base 160a, the sensor 150a and the lens 110a may be a capture device. Similarly, the base 160a', the sensor 150a' and the lens 110a' may be a capture device, the base 160b, the sensor 150b and the lens 110b may be a capture device and the base 160b', the sensor 150b' and the lens 110b' may be a capture device.

[0068] Implementation of the sensor 150a may be representative of the implementation of the sensors 150a, 150a', 150b and/or 150b'. The sensor 150a may receive light from the lens 110a (e.g., the lens 110a may focus light on the sensor 150a). The sensor 150a may be configured to convert light to pixel data (e.g., image data). For example, the sensor 150a may be implemented as an array (e.g., a photosensor with a color filter array) configured to detect an intensity and/or color of incoming light.

[0069] The pixel data (e.g., raw image data) from the sensor 150a may be used to generate video frames. The video frames may be a number of images generated by the sensor 150a in response to the light captured by the lens 110a over time. The video frames may be in an uncompressed (e.g., raw) format. The uncompressed format may be a Bayer format, a red/clear/clear/clear (RCCC) format, a red/green/blue/clear (RGBC) format, RGB format, YUV format, etc. The sensor 150a may provide video frames to the circuit 120a for processing by the video processor 122a.

[0070] The processors 122a-122b may be configured to process and/or encode the uncompressed video frames captured by the sensors 150a-150a' and 150b-150b' to create video streams that are encoded versions of the video frames. Each of the processors 122a-122b may be configured to present one of the video streams to a communication block of the circuits 120a-120b for output via the interface 114. For example, the interface 114 may receive power for the omnidirectional camera 100' from an external source and/or transmit video streams generated by the omnidirectional camera 100' to an external source.

[0071] The bases 160a-160a' and 160b-160b' may provide structural support for the respective lenses 110a-110a' and 110b-110b' (e.g., provide an attachment to the frame 116). The base 160a is shown tilted slightly downward. The base 160b is shown tilted slightly upward. In an example, the

bases **160a-160a'** and **160b-160b'** may be configured to aim a direction of the optical axes **144a-144a'** and **144b-144b'**. In some embodiments, the bases **160a-160a'** and **160b-160b'** may be in a fixed direction (e.g., not moveable). In some embodiments, the bases **160a-160a'** and **160b-160b'** may be moveable (e.g., tilted, rotated, etc.). In some embodiments, the direction of the tilt of the bases **160a-160a'** and **160b-160b'** may be in the same direction for opposite lens pairs (e.g., the subset of lenses **110a-110a'** are both tilted in the same downward direction and the subset of lenses **110b-110b'** are both tilted in the same upward direction). The implementation of the bases **160a-160a'** and **160b-160b'** may be varied according to the design criteria of a particular implementation.

[0072] Referring to FIG. 7, angles of inclination and optical axes of lenses of the omnidirectional camera **100** are shown. The omnidirectional camera **100** is shown having a dual-frame assembly. A frame **116a** comprises one subset of the lenses **110a-110a'** (e.g., one opposite pair of lenses) and a frame **116b** comprises another subset of the lenses **110b-110b'**. The frame **116a** is shown having a design allowing the subset of the lenses **110a-110a'** to be tilted upwards. The frame **116b** is shown having a design allowing the subset of the lenses **110b-110b'** to be tilted downwards. The configuration of the frames **116a** and **116b** may be varied according to the design criteria of a particular implementation.

[0073] The base **160a** is shown attached to the frame **116a**. The base **160a** is shown directing the lens **110a** along the axis **142**. The optical axis **144a** is shown extending through a center of the lens **110a**. One component of the optical axis **144a** may extend in the direction of the axis **142**. The lens **110a** and the base **160a** are shown tilted upward. An angle of inclination (e.g., I_a) is shown between the axis **142** and the optical axis **144a** of the lens **110a**. The angle of inclination I_a may be an amount that the lens **110a** is tilted.

[0074] The base **160b** is shown attached to the frame **116b**. The base **160b** is shown directing the lens **110b** along the axis **140**. The optical axis **144b** is shown extending through a center of the lens **110b**. One component of the optical axis **144b** may extend in the direction of the axis **140**. The lens **110b** and the base **160b** are shown tilted downward. An angle of inclination (e.g., I_b) is shown between the axis **140** and the optical axis **144b** of the lens **110b**. The angle of inclination I_b may be an amount that the lens **110b** is tilted.

[0075] To reduce parallax effects when the spherical field of view is recorded, the optical axes of the neighboring lenses (e.g., the optical axes **144a** and **144b** of the neighboring lenses **110a** and **110b** shown in FIG. 7) may be configured to not intersect. For example, the optical axes **144a** and **144b** are not coplanar. The optical axes **144a** and **144b** of the neighboring lenses **110a** and **110b** are shown not intersecting. The optical axes **144a** and **144b** are not intersecting because the optical axis **144a** extends in a direction along the axis **142** and the optical axis **144b** extends in a direction along the axis **140**, the bases **160a** and **160b** are tilted to direct the optical axes **144a** and **144b** in vertically opposite directions and/or because the bases **160a** and **160b** are displaced in reference to each other.

[0076] Various orientations and/or arrangements may be implemented to ensure the optical axes of the neighboring lenses do not intersect. In an example, the subsets of the lenses **110a-110a'** and **110b-110b'** are shown positioned orthogonally in reference to each other. In another example, the subsets of the lenses **110a-110a'** and **110b-110b'** are

shown displaced in reference to each other (e.g., the frame **116b** is shown above the frame **116a**. In yet another example, the subsets of the lenses **110a-110a'** and **110b-110b'** are tilted in vertically opposite directions (e.g., the opposite pair of lenses **110a-110a'** are both tilted upward and the opposite pair of lenses **110b-110b'** are both tilted downward). A combination of the orientations and/or arrangements used for ensuring the optical axes of the neighboring lenses do not intersect may be varied according to the design criteria of a particular implementation.

[0077] Referring to FIGS. 8-16, example arrangements and/or orientations of the capture devices of the omnidirectional camera **100** are shown. The example arrangements may show a stylized camera model representing a simplified version of the omnidirectional camera **100** for illustrative purposes. The stylized camera model may comprise the lenses **110a-110a'** and **110b-110b'**, the sensors **150a-150a'** and **150b-150b'** and the camera sensor support bases **160a-160a'** and **160b-160b'**. Centers of projection of each of the lenses **110a-110a'** and **110b-110b'** are also shown. The lens **110a** may have a center of projection **202a**. The lens **110a'** may have a center of projection **202a'**. The lens **110b** may have a center of projection **202b**. The lens **110b'** may have a center of projection **202b'**.

[0078] The center of projection may be a center point (e.g., a focal point) between a lens and a respective sensor. In an example, the center of projection **202a'** may be at a center point between a center of the lens **110a'** and the center of the sensor **150a'**, the center of projection **202b** may be at a center point between a center of the lens **110b** and the center of the sensor **150b** and the center of projection **202b'** may be at a center point between a center of the lens **110b'** and the center of the sensor **150b'**. Similarly, the center of projection **202a** may be a center point between a center of the lens **110a** and the center of the sensor **150a**. For example, the centers of projection **202a-202a'** and **202b-202b'** may be located at a central point in a respective lens barrel. The centers of projection **202a-202a'** and **202b-202b'** may change as the length of the lens barrel changes (e.g., the lenses **110a-110a'** and **110b-110b'** extend and/or retract to zoom in/out).

[0079] The centers of projection **202a-202a'** and **202b-202b'** may change based on the optical characteristics of the lenses **110a-110a'** and **110b-110b'**. In an example, the centers of projection **202a-202a'** and **202b-202b'** may not be exactly halfway between the lenses **110a-110a'** and **110b-110b'** and the sensors **150a-150a'** and **150b-150b'**.

[0080] A distance (e.g., H) may be a measurement between the center of projection and the back of the base (e.g., including the thickness of the base). A distance (e.g., B) may be a measurement of a width of the base. A thickness (e.g., T) may be a measurement of the thickness of the bases **160a-160a'** and **160b-160b'**. The distances H , B and T may be equal for each of the lenses **110a-110a'** and **110b-110b'**.

[0081] Referring to FIG. 8, an example arrangement of lenses **110a-110a'** and **110b-110b'** for reducing parallax effects **200** is shown. The example arrangement of lenses **110a-110a'** and **110b-110b'** for reducing parallax effects **200** may implement an orientation/arrangement where the neighboring lenses are displaced and orthogonal in reference to each other. One subset of the lenses (e.g., the opposite pair **110a-110a'**) is shown placed adjacent to the other subset of the lenses (e.g., the opposite pair **110b-110b'**). For example, the opposite pairs **110a-110a'** and **110b-110b'** may be orthogonally on top of (or adjacent to) each other.

[0082] The bases **160a-160a'** of the lenses **110a-110a'** are shown back-to-back. The back-to-back arrangement of the bases **160a-160a'** allows the optical axes **144a-144a'** of the lenses **110a-110a'** to extend in opposite directions. The bases **160b-160b'** of the lenses **110b-110b'** are shown back-to-back and orthogonal to the bases **160a-160a'**. The back-to-back arrangement of the bases **160b-160b'** allows the optical axes **144b-144b'** of the lenses **110b-110b'** to extend in opposite directions. The orthogonal arrangement of the bases **160a-160a'** and **160b-160b'** with respect to each other may allow the lenses **110a-110a'** and **110b-110b'** to capture respective areas **146a-146a'** and **146b-144b'** that provide coverage for the spherical field of view.

[0083] By displacing the subset of lenses **110a-110a'** and the subset of lenses **110b-110b'** with respect to each other and arranging the subset of lenses **110a-110a'** and the subset of lenses **110b-110b'** to be orthogonal with respect to each other may reduce parallax effects and allow full coverage for the spherical field of view. In general, the optical axes **144a-144a'** do not intersect with the optical axes **144b-144b'**.

[0084] Referring to FIG. 9, a side view of the arrangement of the lenses **200'** is shown. The center of projection is shown for each of the lenses **110a'**, **110b** and **110b'** in the side view **200'**. The lens **110a'** may have the center of projection **202a'**. The lens **110b** may have the center of projection **202b**. The lens **110b'** may have the center of projection **202b'**. Similarly, the lens **110a** may have the center of projection **202a** (e.g., not shown in the side view **200'**).

[0085] A distance (e.g., DO) between the centers of projection **202b-202b'** of the opposite pair of lenses **110b-110b'** is shown. A distance (e.g., DN) between the center of projection **202a'** of the lens **110a'** in one subset of the lenses **110a-110a'** and the center of projection **202b** of the lens **110b** in another subset of the lenses **110b-110b'** is shown (e.g., one example of a distance between the centers of projection of neighboring lenses). The distance DO may be the same for the distance between the centers of projection **202a-202a'** of the opposite pair of lenses **110a-110a'**. The distance DN may be the same for the various combinations of neighboring lenses (e.g., a distance between the centers of projection **202a** and **202b**, a distance between the centers of projection **202a** and **202b'** and a distance between the centers of projection **202a'** and **202b'**).

[0086] Referring to FIG. 10, an alternate side view **200''** of the arrangement of the lenses is shown. The distance DN is shown between the center of projection **202b** of the lens **110b** and the center of projection **202a'** of the lens **110a'**.

[0087] Parallax effects may be reduced by positioning the centers of projection of the lenses **110a-110a'** and **110b-110b'** (e.g., the centers of projection **202a**, **202a'**, **202b** and/or **202b'**) close to a common location (e.g., reduce a distance between the centers of projection **202a**, **202a'**, **20b** and/or **202b'**). Reducing the distances DN and DO may bring the centers of projection **202a**, **202a'**, **202b** and/or **202b'** closer to the common location. Generally, reducing the distance DN may be more effective for reducing parallax effects than reducing the distance DO.

[0088] In the example arrangement of lenses **110a-110a'** and **110b-110b'** for reducing parallax effects **200**, an equation representing the distance DN may be:

$$DN = \sqrt{2H^2 + B^2} \quad (1)$$

[0089] In the example arrangement of lenses **110a-110a'** and **110b-110b'** for reducing parallax effects **200**, an equation representing the distance DO may be:

$$DO = 2H \quad (2)$$

[0090] Depending on the actual size of the lenses **110a-110a'** and **110b-110b'** and the bases **160a-160a'** and **160b-160b'**, the example arrangement of lenses for reducing parallax effects **200** may be advantageous. In an example, where H=600 mm and B=1355 mm, DN may be 1599 mm and DO may be 1200 mm. Similar measurements may be determined based on various dimensions of the design criteria of a particular implementation.

[0091] Referring to FIG. 11, an example inclined arrangement of lenses for reducing parallax effects **250** is shown. The example inclined arrangement of lenses for reducing parallax effects **250** may implement an orientation/arrangement where the neighboring lenses are displaced and orthogonal in reference to each other and the neighboring lenses are tilted in vertically opposite directions with respect to each other. One subset of the lenses (e.g., the opposite pair **110a-110a'**) is shown placed adjacent to the other subset of the lenses (e.g., the opposite pair **110b-110b'**). One subset of the lenses (e.g., the opposite pair **110a-110a'**) is shown tilted downward. Another subset of the lenses (e.g., the opposite pair **110b-110b'**) is shown tilted upward.

[0092] The example inclined arrangement of lenses for reducing parallax effects **250** may bring the directly neighboring camera focal points (e.g., the centers of projection for the neighboring lenses) closer to each other. Although the distance between the focal points of opposite cameras (e.g., the centers of projection of the opposite pairs) is increased, the distance between the centers of projection of directly neighboring cameras continues to decrease with the inclination.

[0093] The bases **160a-160a'** of the lenses **110a-110a'** are shown back-to-back along one edge (e.g., the bottom edge of the bases **160a-160a'**) and tilted away from each other along the opposite edge (e.g., the top edge of the bases **160b-160b'**). The back-to-back and tilted arrangement of the bases **160a-160a'** allows the optical axes **144a-144a'** of the lenses **110a-110a'** to extend in opposite directions and provide coverage for areas **146a-146a'** of the spherical field of view below the omnidirectional camera **100**. The bases **160b-160b'** of the lenses **110b-110b'** are shown back-to-back along one edge (e.g., the top edge of the bases **160b-160b'**) and tilted away from each other along the opposite edge (e.g., the bottom edge of the bases **160b-160b'**). The back-to-back and tilted arrangement of the bases **160b-160b'** allow the optical axes **144b-144b'** of the lenses **110b-110b'** to extend in opposite directions and provide coverage for areas **146b-144b'** of the spherical field of view above the omnidirectional camera **100**. The orthogonal arrangement of the bases **160a-160a'** and **160b-160b'** with respect to each other may allow the lenses **110a-110a'** and **110b-110b'** to capture respective areas **146a-146a'** and **146b-144b'** that provide coverage for the spherical field of view.

[0094] By displacing the subset of lenses **110a-110a'** and the subset of lenses **110b-110b'** with respect to each other and arranging the subset of lenses **110a-110a'** and the subset of lenses **110b-110b'** to be orthogonal with respect to each other (e.g., when projected on a horizontal plane) may reduce parallax effects and allow coverage for the spherical field of view. By tilting the subset of lenses **110a-110a'** and

the subset of lenses **110b-110b'** in vertically opposite directions, the parallax effects may be further reduced. In general, the optical axes **144a-144a'** do not intersect with the optical axes **144b-144b'**.

[0095] Referring to FIG. 12, a side view of the example inclined arrangement of lenses **250'** is shown. A center of projection (e.g., **202a**, **202b** and **202b'**) is shown for each of the lenses **110a**, **110b** and **110b'** in the side view **250'**. Similarly, the lens **110a'** may have the center of projection **202a'** (e.g., not shown in the side view **250'**).

[0096] The distance **DO'** between the centers of projection **202b-202b'** of the opposite pair of lenses **110b-110b'** is shown. The distance **DN'** between the center of projection **202a** of the lens **110a** in one subset of the lenses **110a-110a'** and the center of projection **202b** of the lens **110b** in another subset of the lenses **110b-110b'** is shown (e.g., one example of a distance between the centers of projection of neighboring lenses). The distance **DO'** may be the same for the distance between the centers of projection **202a-202a'** of the opposite pair of lenses **110a-110a'**. The distance **DN'** may be the same for the various combinations of neighboring lenses (e.g., a distance between the centers of projection **202a'** and **202b'**, a distance between the centers of projection **202a'** and **202b**, and a distance between the centers of projection **202a** and **202b'**).

[0097] The angle of inclination **Ib** is shown. The angle **Ib** may represent an amount of upward incline for the opposite pair of lenses **110b-110b'**. Similarly, there may be the angle of inclination **Ia** representing the amount of downward incline for the opposite pair of lenses **110a-110a'**. The distance **DN'** is shown slightly above the distance **DO'** (e.g., the centers of projection **202a**, **202a'**, **202b** and **202b'** are not all on the same horizontal plane).

[0098] Referring to FIG. 13, a top view of the example inclined arrangement of lenses **250''** is shown. The distance **DN'** is shown between the center of projection **202b** of the lens **110b** and the center of projection **202a** of the lens **110a**. The distance **DO'** is shown between the center of projection **202a** of the lens **110a** and the center of projection **202a'** of the lens **110a'**. The optical axes of the neighboring lenses may be orthogonal when projected onto a horizontal plane.

[0099] Tilting the lenses **110a**, **110a'**, **110b** and/or **110b'** (e.g., adjusting the angle of inclination **Ia** and/or **Ib**) may reduce the distances between the centers of projection **202a**, **202a'**, **202b** and/or **202b'**. For an example, the distance **DN'** in the arrangement **250** may be smaller than the distance **DN** in the arrangement **200**. In an example, the distance **DO'** in the arrangement **250** may be larger than the distance **DO** in the arrangement **200**. However, to reduce parallax effects, reducing the distance between neighboring lenses (e.g., the distance **DN** and/or **DN'**) may have a greater importance than reducing the distance between the opposite lens pairs (e.g., the distance **DO** and/or **DO'**). In the example inclined arrangement of lenses for reducing parallax effects **250**, the angle of inclination may be **I** (e.g., the angle **Ib** shown in FIG. 12). In the example inclined arrangement of lenses for reducing parallax effects **250**, an equation representing the distance **DN'** may be:

$$DN' = \sqrt{2\left(\frac{B}{2}\sin(I) + H\cos(I)\right)^2 + 4\left(-\frac{B}{2}\cos(I) + (H - T)\sin(I)\right)^2} \quad (3)$$

In the example inclined arrangement of lenses for reducing parallax effects **250**, an equation representing the distance **DO'** may be:

$$DO' = B \sin(I) + 2H \cos(I) \quad (4)$$

[0100] Equations (3) and (4) provide calculations where the bases **160a-160a'** and **160b-160b'** of opposite pairs are in contact with each other, and that both subsets of the lenses **110a-110a'** and **110b-110b'** are in contact with each other. For example, in FIG. 12, the top side of the base **160b** may be in contact with the top side of the base **160b'**. Depending on the actual size of the lenses **110a-110a'** and **110b-110b'** and the bases **160a-160a'** and **160b-160b'**, the example inclined arrangement of lenses for reducing parallax effects **250** may be advantageous for reducing the parallax effects between the neighboring lenses. In an example, where **H=600 mm**, **B=1355 mm** and **T=100 mm**, **DN'** may be **1304 mm** and **DO'** may be **1807 mm**. Other measurements may be determined based on various dimensions of the design criteria of a particular implementation.

[0101] Referring to FIG. 14, an example aligned incline arrangement of lenses for reducing parallax effects **300** is shown. The example aligned inclined arrangement of lenses for reducing parallax effects **300** may implement an orientation/arrangement where the neighboring lenses are displaced and orthogonal in reference to each other and the neighboring lenses are tilted in vertically opposite directions with respect to each other and the centers of projection of the lenses are aligned in a horizontal plane. One subset of the lenses (e.g., the opposite pair **110a-110a'**) is shown placed adjacent to the other subset of the lenses (e.g., the opposite pair **110b-110b'**). One subset of the lenses (e.g., the opposite pair **110a-110a'**) is shown tilted downward. Another subset of the lenses (e.g., the opposite pair **110b-110b'**) is shown tilted upward.

[0102] The bases **160a-160a'** of the lenses **110a-110a'** are shown back-to-back along one edge (e.g., the bottom edge of the bases **160a-160a'**) and tilted away from each other along the opposite edge (e.g., the top edge of the bases **160b-160b'**). The back-to-back and tilted arrangement of the bases **160a-160a'** allow the optical axes **144a-144a'** of the lenses **110a-110a'** to extend in opposite directions and provide coverage for areas **146a-146a'** of the spherical field of view below the omnidirectional camera **100**. The bases **160b-160b'** of the lenses **110b-110b'** are shown back-to-back along one edge (e.g., the top edge of the bases **160b-160b'**) and tilted away from each other along the opposite edge (e.g., the bottom edge of the bases **160b-160b'**). The back-to-back and tilted arrangement of the bases **160b-160b'** allows the optical axes **144b-144b'** of the lenses **110b-110b'** to extend in opposite directions and provide coverage for areas **146b-146b'** of the spherical field of view below the omnidirectional camera **100**. The orthogonal arrangement of the bases **160a-160a'** and **160b-160b'** with respect to each other may allow the lenses **110a-110a'** and **110b-110b'** to capture respective areas **146a-146a'** and **146b-146b'** that provide coverage for the spherical field of view.

[0103] By displacing the subset of lenses **110a-110a'** and the subset of lenses **110b-110b'** with respect to each other and arranging the subset of lenses **110a-110a'** and the subset of lenses **110b-110b'** to be orthogonal with respect to each other may reduce parallax effects and allow coverage for the spherical field of view. By tilting the subset of lenses **110a-110a'** and the subset of lenses **110b-110b'** in vertically

opposite directions, the parallax effects may be further reduced. Tilting the subset of lenses **110a-110a'** and the subset of lenses **110b-110b'** such that the centers of projection of the lenses are in a common horizontal plane may further reduce the parallax effects. In general, the optical axes **144a-144a'** do not intersect with the optical axes **144b-144b'**.

[0104] Referring to FIG. 15, a side view of the example aligned incline arrangement of lenses **300'** is shown. The centers of projection (e.g., **202a**, **202b** and **202b'**) are shown for each of the lenses **110a**, **110b** and **110b'** in the side view **300'**. Similarly, the lens **110a'** may have the center of projection **202a'** (e.g., not shown in the side view **250'**).

[0105] The distance **DO''** between the centers of projection **202b-202b'** of the opposite pair of lenses **110b-110b'** is shown. The distance **DN''** between the center of projection **202a** of the lens **110a** in one subset of the lenses **110a-110a'** and the center of projection **202b** of the lens **110b** in another subset of the lenses **110b-110b'** is shown (e.g., one example of a distance between the centers of projection of neighboring lenses). The distance **DO''** may be the same for the distance between the centers of projection **202a-202a'** of the opposite pair of lenses **110a-110a'**. The distance **DN''** may be the same for the various combinations of neighboring lenses (e.g., a distance between the centers of projection **202a'** and **202b**, a distance between the centers of projection **202a'** and **202b'** and a distance between the centers of projection **202a** and **202b'**). The distance **DN''** is shown in line with the distance **DO''**. For example, the centers of projection **202a**, **202a'**, **202b** and **202b'** are all on the same horizontal plane.

[0106] Referring to FIG. 16, a top view of the example aligned incline arrangement of lenses **300''** is shown. The distance **DN''** is shown between the center of projection **202b** of the lens **110b** and the center of projection **202a** of the lens **110a**. The distance **DO''** is shown between the center of projection **202a** of the lens **110a** and the center of projection **202a'** of the lens **110a'**. The optical axes of the neighboring lenses are orthogonal when projected onto a horizontal plane.

[0107] Tilting the lenses **110a**, **110a'**, **110b** and/or **110b'** may reduce the distances between the centers of projection **202a**, **202a'**, **202b** and **202b'**. Tilting the lenses **110a**, **110a'**, **110b** and/or **110b'** such that the centers of projection **202a**, **202a'**, **202b** and/or **202b'** all lie on (or close to) a common horizontal plane may further reduce the distances between the centers of projection **202a**, **202a'**, **202b** and/or **202b'**. For an example, the distance **DN''** in the arrangement **300** may be smaller than the distance **DN'** in the arrangement **250**. In an example, the distance **DO''** in the arrangement **300** may be larger than the distance **DO'** in the arrangement **250**. However, to reduce parallax effects, reducing the distance between neighboring lenses (e.g., the distance **DN**, **DN'** and/or **DN''**) may have a greater importance than reducing the distance between the opposite lens pairs (e.g., the distance **DO**, **DO'** and/or **DO''**).

[0108] The example aligned incline arrangement of lenses for reducing parallax effects **300** goes further in removing the vertical parallax between the lenses **110a-110a'** and **110b-110b'**, by arranging the lenses **110a-110a'** and **110b-110b'** so that the respective centers of projection **202a**, **202a'**, **202b** and **202b'** are all located in a common horizontal plane. In an example, the example aligned incline arrangement of lenses for reducing parallax effects **300** may be arranged by inclining the lenses **110a-110a'** and **110b-110b'** appropri-

ately. In another example, the aligned incline arrangement of lenses for reducing parallax effects **300** may be arranged by sliding the lenses **110a-110a'** and **110b-110b'** along the camera optical axes **144a-144a'** and **144b-144b'** until the respective centers of projection **202a**, **202a'**, **202b** and **202b'** reach the common horizontal plane.

[0109] The vertical parallax may be null if:

$$-\frac{B\cos(I)}{2} + (H-T)\sin(I) = 0 \quad (5)$$

Equation (5) may be rewritten as:

$$\tan(I) = \frac{B}{2(H-T)} \quad (6)$$

[0110] Using equation (6), the appropriate angle **I** to zero-out the vertical parallax and/or the appropriate height **H** of the lenses **110a-110a'** and **110b-110b'** may be found. When equation (5) is satisfied, the analytical distance **DN''** between neighboring cameras becomes:

$$DN'' = \sqrt{2} \left(\text{abs} \left(\frac{B}{2} \sin(I) + H \cos(I) \right) \right) \quad (7)$$

and the distance **DO''** between the opposite lens pairs remains the same as in equation (4).

[0111] There may be two limitations on possible values for the angles **I**. One limitation for the possible values for the angles **I** may be the volumes occupied by the camera chambers (e.g., the lens barrel), which may prevent particular angles. When the volumes occupied by the lens barrel is a problem, shifting the lenses **110a-110a'** and **110b-110b'** on the horizontal plane to split the bases **160a-160a'** and **160b-160b'** apart may be a solution to allow the centers of projection **202a**, **202a'**, **202b** and **202b'** to be aligned on a common horizontal plane. For example, in FIG. 16, splitting the bases **160a-160a'** and **160b-160b'** apart may result in a space between the bases **160a-160a'** and **160b-160b'**. Splitting the bases **160a-160a'** and **160b-160b'** apart may result in an increase in the distances of the centers of projection **202a**, **202a'**, **202b** and **202b'**. However, there would still be the benefits of no vertical parallax.

[0112] Another limitation of the possible values for the angles of inclination **I** may be the field of views (e.g., the respective areas **146a-146a'** and **146b-146b'** covered) of the various lenses **110a-110a'** and **110b-110b'**. The angles **I** may be selected to still have overlap to ensure coverage of a full panorama (e.g., the spherical field of view), despite the inclination angles **I**.

[0113] In the example aligned incline arrangement of lenses for reducing parallax effects **300**, the angle of inclination may be **I** (e.g., the angle **Ib** shown in FIG. 15). Depending on the actual size of the lenses **110a-110a'** and **110b-110b'** and the bases **160a-160a'** and **160b-160b'**, the example aligned incline arrangement of lenses for reducing parallax effects **300** may be advantageous for reducing the parallax effects between the neighboring lenses. In an example, where **H**=600 mm, **B**=1355 mm and **T**=100 mm, **DN''** may be 1275 mm and **DO''** may be 1802 mm. Other

measurements may be determined based on various dimensions of the design criteria of a particular implementation.

[0114] Referring to FIG. 17, a perspective view of an example spherical omnidirectional camera 100''' is shown. The example spherical omnidirectional camera 100''' may comprise the lenses 110a-110a' and 110b-110b' and the neck 112. The example spherical omnidirectional camera 100''' may further comprise a lens 352. The lenses 110a-110a' may be one opposite lens pair. The lenses 110b-110b' may be another opposite lens pair.

[0115] Referring to FIG. 18, a side view of the example spherical omnidirectional camera 100''' is shown. The lenses 110a-110a' and 110b-110b' are shown arranged around a middle of the spherical omnidirectional camera 100'''. In an example, the lenses 110a-110a' are shown tilted upwards. In an example, the lenses 110b-110b' are shown tilted downwards. The opposite lens pair 110a-110a' and the opposite lens pair 110b-110b' may be tilted in opposite directions. Tilting the opposite lens pairs 110a-110a' and 110b-110b' in opposite directions may reduce the parallax effects by bringing the centers of projection of the lenses 110a-110a' and 110b-110b' closer to a common location. Other arrangements of the lenses 110a-110a' and 110b-110b' may be implemented to reduce parallax effects for the spherical omnidirectional camera 100'''.

[0116] Referring to FIG. 19, a top view of the example spherical omnidirectional camera 100''' is shown. The lens 352 may be a supplemental lens. The lens 352 may not be part of a subset of the lenses 110a-110a' and 110b-110b'. In the example shown in FIGS. 17-19, the supplemental lens 352 may capture an additional field of view above the example spherical omnidirectional camera 100'''. In an example, the supplemental lens 352 may provide an additional perspective (e.g., to provide perspective data for a 3D video signal). A location of the supplemental lens 352 may be varied according to the design criteria of a particular implementation.

[0117] Referring to FIG. 20, a perspective view of an example 6-lens spherical omnidirectional camera 100'''' is shown. The example 6-lens spherical omnidirectional camera 100'''' may comprise the lenses 110a-110a', the lenses 110b-110b' and the lenses 110c-110c' and the neck 112. The lenses 110a-110a' may be one opposite lens pair. The lenses 110b-110b' may be another opposite lens pair. The lenses 110c-110c' may be yet another opposite lens pair.

[0118] Referring to FIG. 21, a side view of the example 6-lens spherical omnidirectional camera 100'''' is shown. The lenses 110a-110a', 110b-110b' and 110c-110c' are shown arranged around a middle of the 6-lens spherical omnidirectional camera 100'''. In an example, the lens 110a is shown tilted upwards and the lens 110a' is shown tilted downwards. In an example, the lens 110b is shown tilted downwards and the lens 110b' is shown tilted upwards. In an example, the lens 110c is shown tilted upwards and the lens 110c' is shown tilted downwards. Generally, the lenses 110a-110a', 110b-110b' and 110c-110c' are tilted in alternating directions around the 6-lens spherical omnidirectional camera 100'''. Tilting the lenses in each of the opposite lens pairs 110a-110a', 110b-110b' and 110c-110c' in opposite directions may reduce the parallax effects by bringing the centers of projection of the lenses 110a-110a', 110b-110b' and 110c-110c' closer to a common location. Other arrangements of the lenses 110a-110a', 110b-110b' and 110c-110c'

may be implemented to reduce parallax effects for the 6-lens spherical omnidirectional camera 100''''.

[0119] Referring to FIG. 22, a top view of the example 6-lens spherical omnidirectional camera 100'''' is shown. Adding additional lens pairs may reduce parallax effects between the lenses 110a-110a', 110b-110b' and 110c-110c'. For an example, additional lens pairs may allow a creation of a 3D video signal by providing enough information to generate a depth map. The amount of tilt of each of the lenses 110a-110a', 110b-110b' and/or 110c-110c' may be varied according to the design criteria of a particular implementation.

[0120] Referring to FIG. 23, a perspective view of an example 8-lens spherical omnidirectional camera 100''''' is shown. The example 8-lens spherical omnidirectional camera 100''''' may comprise the lenses 110a-110a', the lenses 110b-110b', the lenses 110c-110c' and the lenses 110d-110d' and the neck 112. The lenses 110a-110a' may be one opposite lens pair. The lenses 110b-110b' may be another opposite lens pair. The lenses 110c-110c' may be yet another opposite lens pair. The lenses 110d-110d' may be another opposite lens pair.

[0121] Referring to FIG. 24, a side view of the example 8-lens spherical omnidirectional camera 100''''' is shown. The lenses 110a-110a', 110b-110b', 110c-110c' and 110d-110d' are shown arranged around a middle of the 8-lens spherical omnidirectional camera 100'''. In an example, the lenses 110a-110a' are shown tilted upwards. In an example, the lenses 110b-110b' are shown tilted downwards. In an example, the lenses 110c-110c' are shown tilted upwards. In an example, the lenses 110d-110d' are shown tilted downwards. Generally, the lenses 110a-110a', 110b-110b', 110c-110c' and 110d-110d' are tilted in alternating directions around the 8-lens spherical omnidirectional camera 100'''. Tilting the opposite lens pairs 110a-110a', 110b-110b', 110c-110c' and 110d-110d' in opposite directions may reduce the parallax effects by bringing the centers of projection of the lenses 110a-110a', 110b-110b', 110c-110c' and 110d-110d' closer to a common location. Other arrangements of the lenses 110a-110a', 110b-110b', 110c-110c' and 110d-110d' may be implemented to reduce parallax effects for the 8-lens spherical omnidirectional camera 100'''''.

[0122] Referring to FIG. 25, a top view of the example 8-lens spherical omnidirectional camera 100''''' is shown. Adding additional lens pairs may reduce parallax effects between the lenses 110a-110a', 110b-110b', 110c-110c' and 110d-110d'. For an example, additional lens pairs may allow a creation of a 3D video signal by providing enough information to generate a depth map. The amount of tilt of each of the lenses 110a-110a', 110b-110b', 110c-110c' and/or 110d-110d' may be varied according to the design criteria of a particular implementation.

[0123] The terms “may” and “generally” when used herein in conjunction with “is(are)” and verbs are meant to communicate the intention that the description is exemplary and believed to be broad enough to encompass both the specific examples presented in the disclosure as well as alternative examples that could be derived based on the disclosure. The terms “may” and “generally” as used herein should not be construed to necessarily imply the desirability or possibility of omitting a corresponding element.

[0124] While the invention has been particularly shown and described with reference to embodiments thereof, it will

be understood by those skilled in the art that various changes in form and details may be made without departing from the scope of the invention.

1. An apparatus comprising:
 - a plurality of lenses (i) arranged to provide coverage for an omnidirectional field of view of a scene surrounding the apparatus and (ii) each having an optical axis directed to provide coverage for a respective area of said omnidirectional field of view; and
 - a frame configured to hold said plurality of lenses, wherein (i) at least a first one of said lenses and at least a second one of said lenses are neighboring lenses, (ii) an orientation of at least two of said neighboring lenses is configured to control parallax effects when said omnidirectional field of view is recorded using said plurality of lenses and (iii) said parallax effects are controlled by configuring said optical axes of said neighboring lenses to not lie in the same plane.
2. The apparatus according to claim 1, wherein said frame is configured as a unibody design.
3. The apparatus according to claim 1, wherein said frame comprises (i) a first base comprising said first one of said lenses and (ii) a second base comprising said second one of said lenses.
4. The apparatus according to claim 1, wherein the parallax effects are controlled by positioning a center of projection of each of said plurality of lenses close to a common location.
5. The apparatus according to claim 4, wherein at least said first one of said lenses and said second one of said lenses are tilted to reduce a distance between said centers of projection of said first one of said lenses and said second one of said lenses and said common location.
6. The apparatus according to claim 4, wherein said center of projection of one of said plurality of lenses represents a focal point of a camera.
7. The apparatus according to claim 1, wherein said apparatus comprises an optical assembly configured to capture raw data for a plurality of video processors.
8. The apparatus according to claim 1, wherein said first one of said lenses and said second one of said lenses are at least one of (a) positioned orthogonally in reference to each other, (b) tilted in vertically opposite directions and (c) displaced in reference to each other.
9. The apparatus according to claim 1, wherein a distance between a center of projection of said first one of said lenses and a center of projection of said second one of said lenses is less than a distance between centers of projection of one of said plurality of lenses opposite to said first one of said lenses.
10. The apparatus according to claim 9, wherein said distance between said center of projection of said first one of said lenses and said center of projection of said second one of said lenses decreases based on an angle of inclination.
11. The apparatus according to claim 1, wherein centers of projection for said plurality of lenses are all located in a common horizontal plane.
12. The apparatus according to claim 1, wherein said omnidirectional field of view is recorded by performing video stitching operations on video signals captured using said plurality of lenses.

13. The apparatus according to claim 12, wherein said parallax effects cause visual artifacts at overlapping areas of said video signals after performing said video stitching operations.

14. The apparatus according to claim 1, wherein (i) said first one of said lenses and a third one of said lenses are aimed in opposite directions along a first axis and (ii) said second one of said lenses and a fourth one of said lenses are aimed in opposite directions along a second axis.

15. The apparatus according to claim 1, wherein each of said plurality of lenses comprises a video camera.

16. The apparatus according to claim 1, wherein said respective area covered by said first one of said lenses and said respective area covered by said second one of said lenses has an overlapping area.

17. An apparatus comprising a plurality of lenses arranged to:

(A) provide coverage for an omnidirectional field of view of a scene surrounding the apparatus, wherein (i) each of said plurality of lenses has an optical axis directed to provide coverage for a respective area of said omnidirectional field of view and (ii) any two of said plurality of lenses are considered neighboring lenses when said respective areas covered by said neighboring lenses have an overlapping area; and

(B) control parallax effects associated with said overlapping area when said omnidirectional field of view is captured using said plurality of lenses, wherein said parallax effects are controlled by configuring said optical axes to not lie in the same plane for said neighboring lenses that have a largest size of said overlapping area.

18. The apparatus according to claim 17, wherein said neighboring lenses that have a largest size of said overlapping area are two of said lenses having a distance less than or equal to any other pair of said lenses.

19. An apparatus comprising:

a plurality of lenses arranged to provide coverage for an omnidirectional field of view of a scene surrounding the apparatus;

a first base configured to hold (i) a first of said plurality of lenses and (ii) a second of said plurality of lenses; and

a second base configured to hold (i) a third of said plurality of lenses and (ii) a fourth of said plurality of lenses, wherein (i) said first and second lenses are positioned horizontally opposite on a first axis, (ii) said third and fourth lenses are positioned horizontally opposite on a second axis (iii) said first axis and said second axis are orthogonal with respect to each other and (iv) an orientation of said first lens, said second lens, said third lens and said fourth lens is configured to control parallax effects when said omnidirectional field of view is captured using said plurality of lenses.

20. The apparatus according to claim 19, wherein (i) said horizontally opposite position comprises two of said lenses having an orientation 180 degrees apart when projected to a horizontal plane.

* * * * *