



US 20200079415A1

(19) **United States**(12) **Patent Application Publication**
DeLanghe et al.(10) **Pub. No.: US 2020/0079415 A1**(43) **Pub. Date: Mar. 12, 2020**(54) **WHEELED DEVICE FOR SNOWMOBILE SKI**(52) **U.S. Cl.**CPC **B62B 13/08** (2013.01); **B62M 2027/025**
(2013.01); **B62B 13/18** (2013.01); **B62M**
27/02 (2013.01)(71) Applicant: **Caliber, Inc.**, Burnsville, MN (US)(72) Inventors: **Ernest J. DeLanghe**, Burnsville, MN
(US); **Steven W. Potter**, Prior Lake,
MN (US); **Paul Dathe**, Plymouth, MN
(US); **Gregory Joseph Wright**, Milaca,
MN (US); **Randall Seurer**, Lonsdale,
MN (US)

(57)

ABSTRACT

A device for attaching to a ski of a snowmobile includes first and second spaced apart legs. Each leg has a ski engaging portion proximate a second end that is configured to engage a bottom surface of the ski proximate outer edges thereof. The device includes at least one wheel attached to the first and second legs between the first end and the second end and a cross bar that attaches the first and second legs proximate first ends thereof. The device includes a lever arm extending from the cross bar between the first and second legs wherein the lever arm is configured to be angularly positionable relative to the first and second spaced apart legs. A handle is attached to a distal end of the lever arm and has a surface configured to engage a tip end or a ski handle of the ski. The device includes a retaining member attached to the handle that is configured to engage the ski handle, wherein when the ski engaging portions engage a bottom surface of the ski and the retaining member engages the ski handle, the ski is elevated and the at least one wheel engages the ground surface such that the skis do not contact the ground surface as the snowmobile is moved.

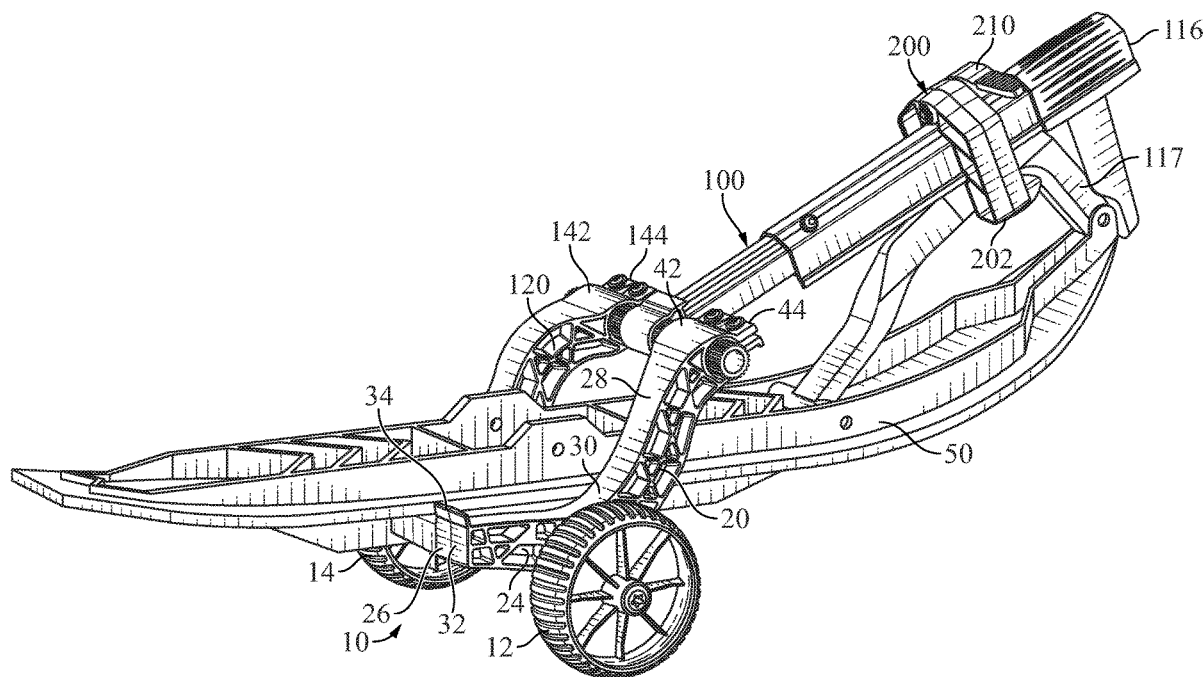
(21) Appl. No.: **16/677,343**(22) Filed: **Nov. 7, 2019****Related U.S. Application Data**(63) Continuation of application No. 16/106,974, filed on
Aug. 21, 2018, now Pat. No. 10,486,729.(60) Provisional application No. 62/548,648, filed on Aug.
22, 2017.**Publication Classification**(51) **Int. Cl.****B62B 13/08** (2006.01)**B62M 27/02** (2006.01)**B62B 13/18** (2006.01)

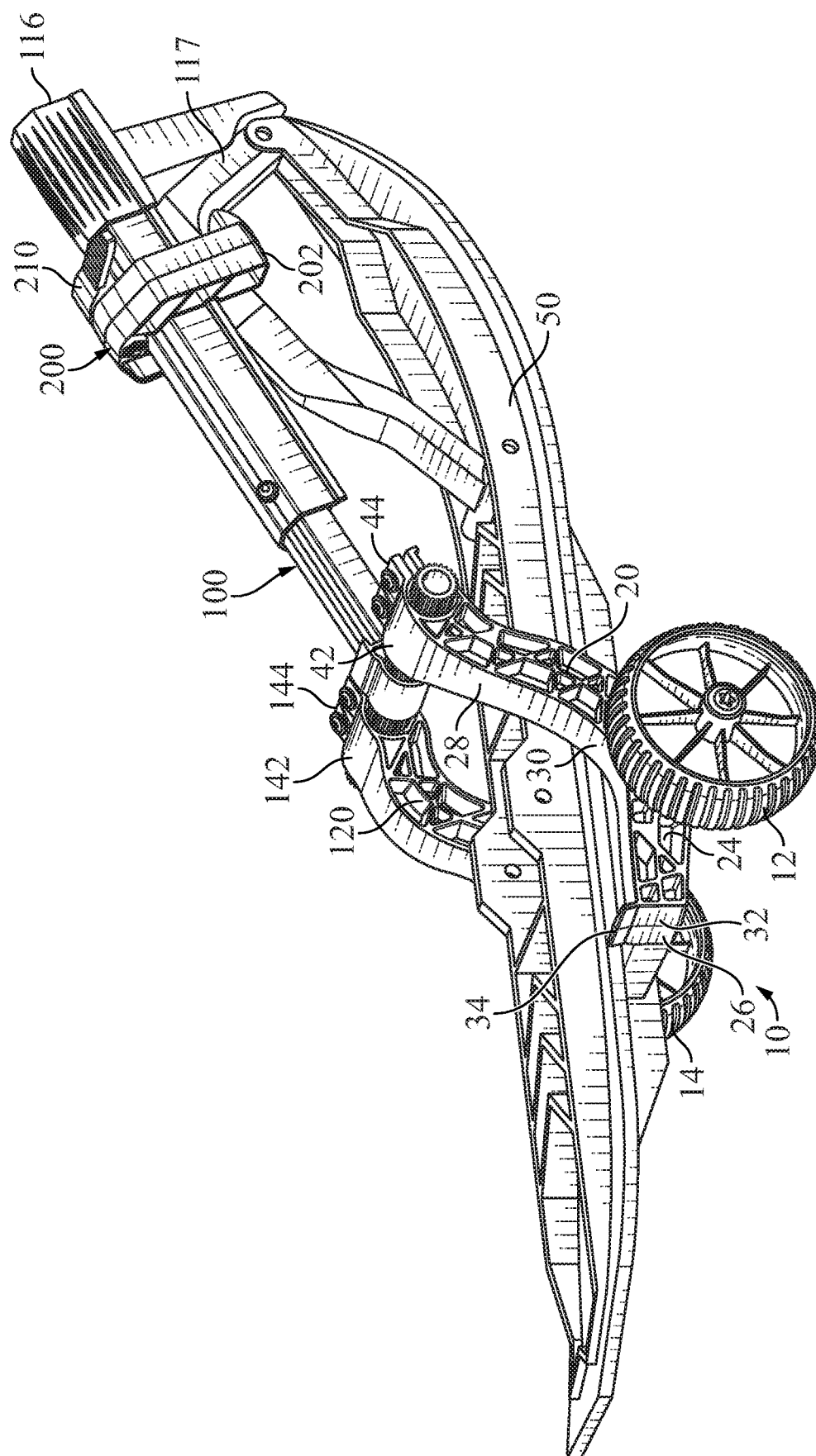

FIG. 1

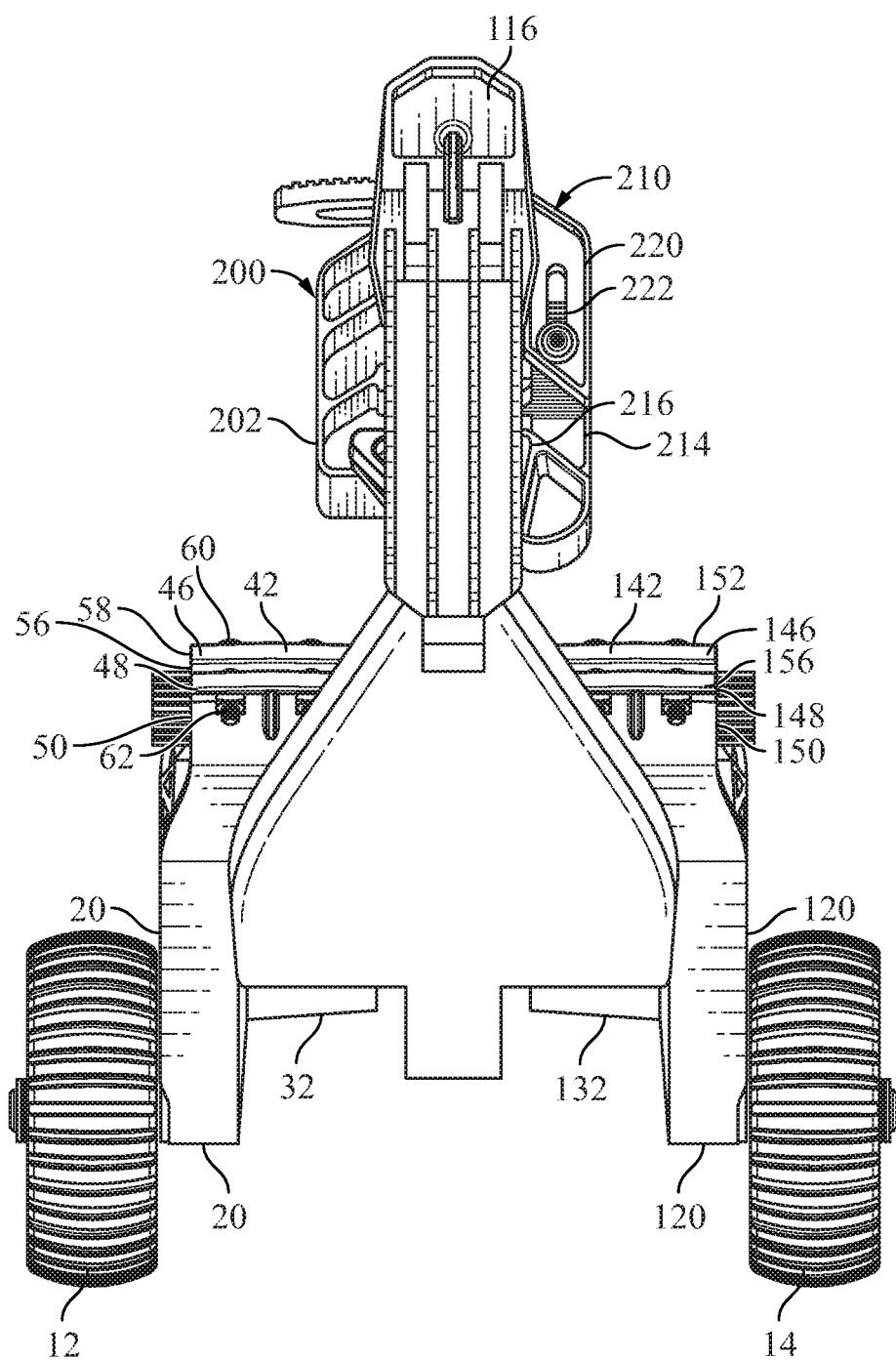

FIG. 2

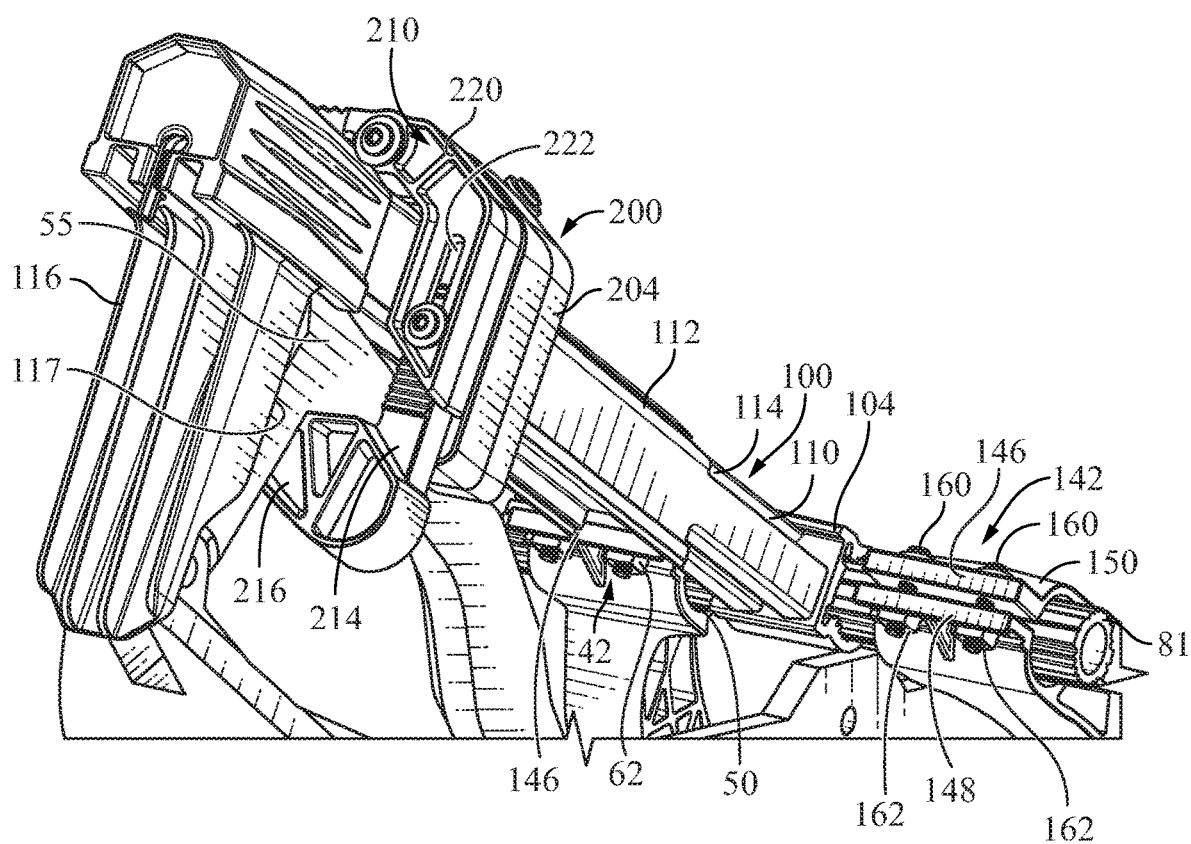

FIG. 3

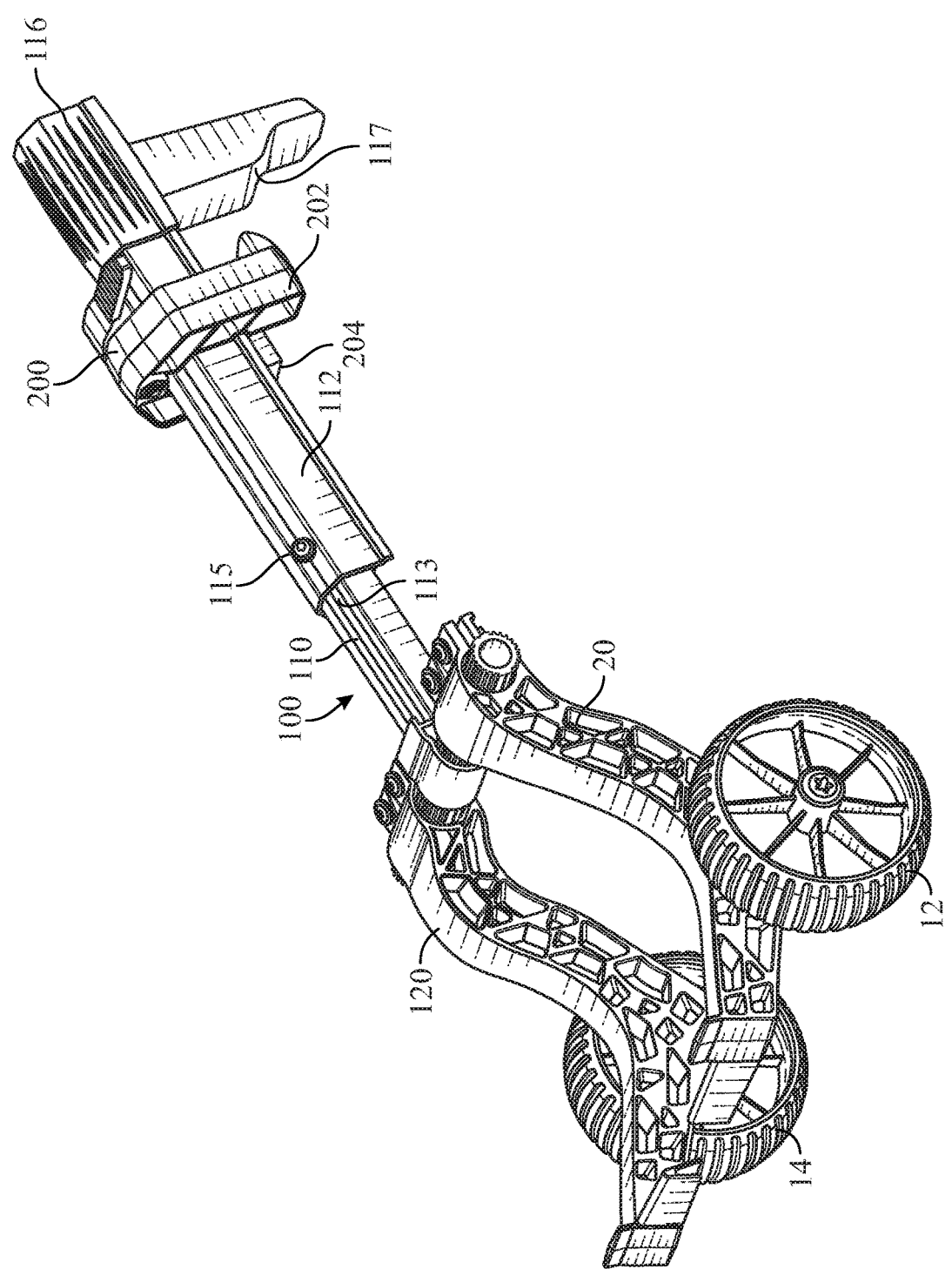

FIG. 4

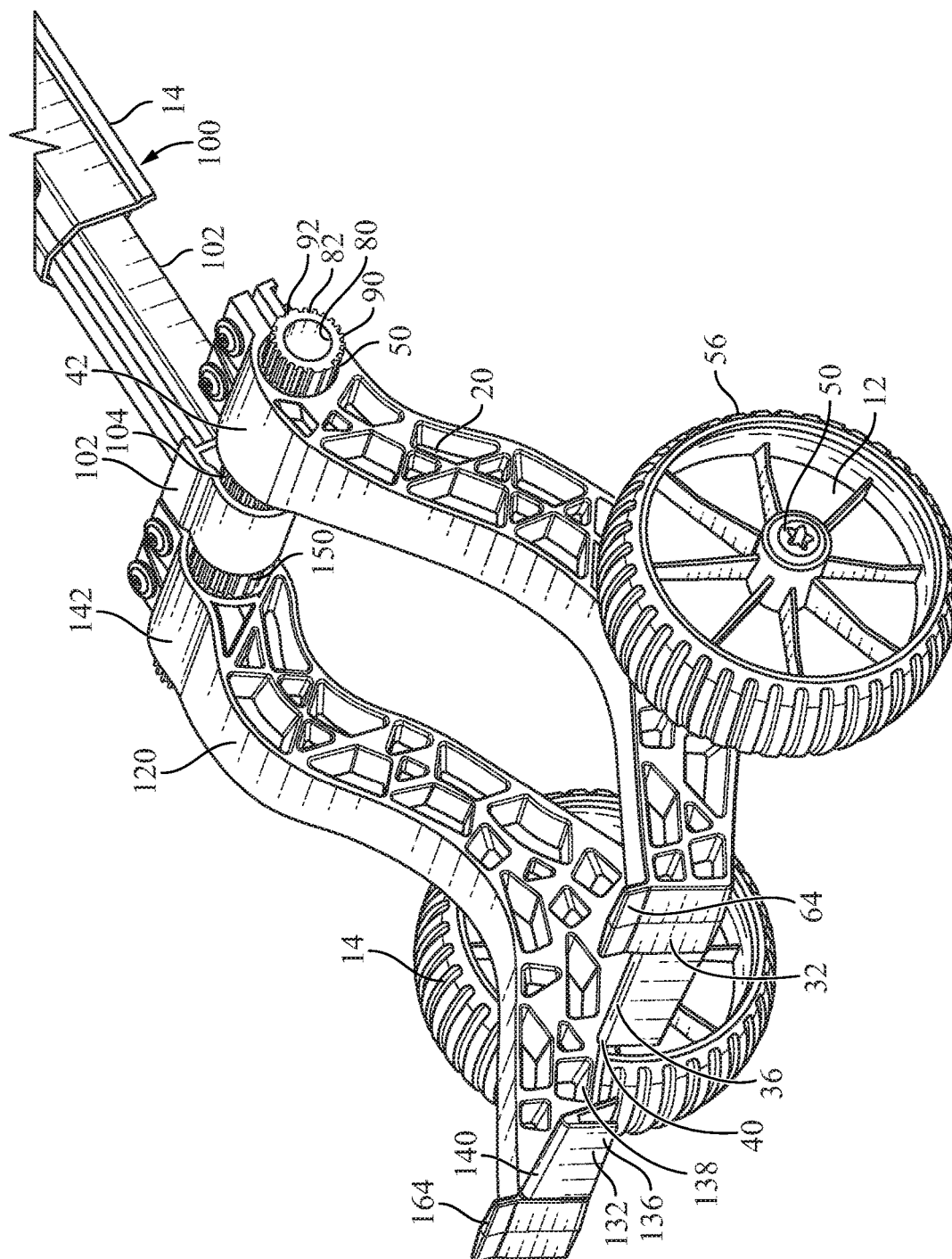

FIG. 5

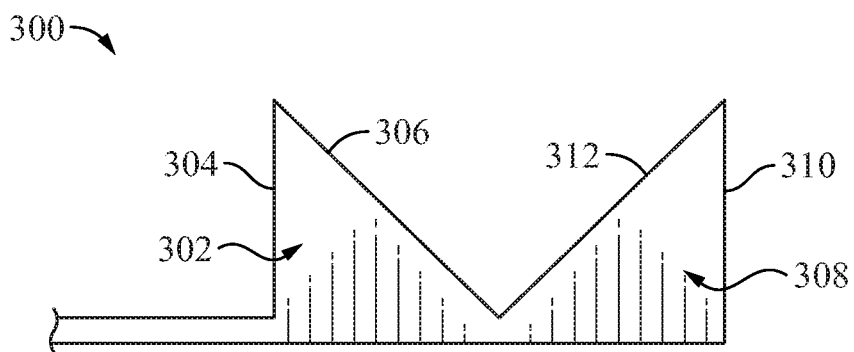

FIG. 6

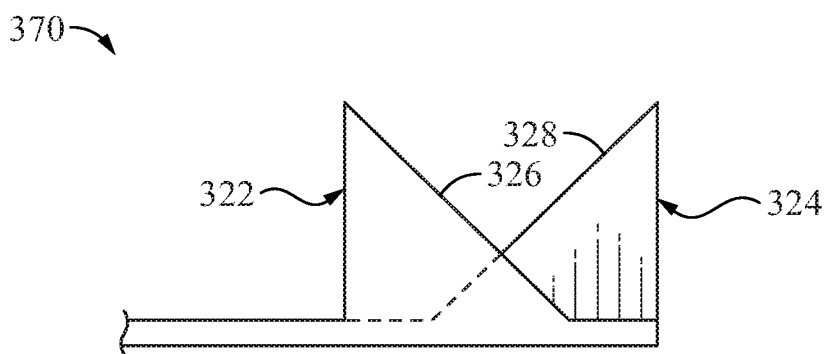

FIG. 7

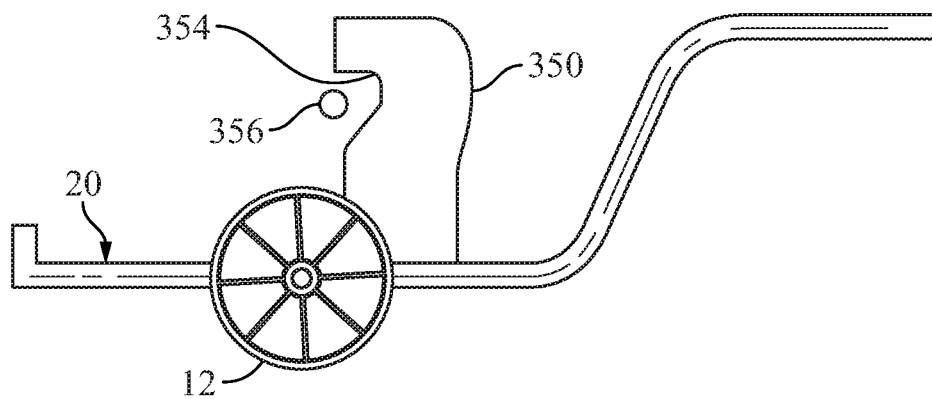

FIG. 8

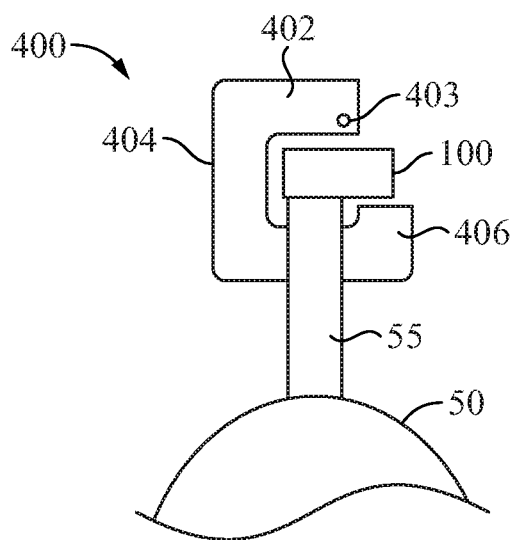

FIG. 9

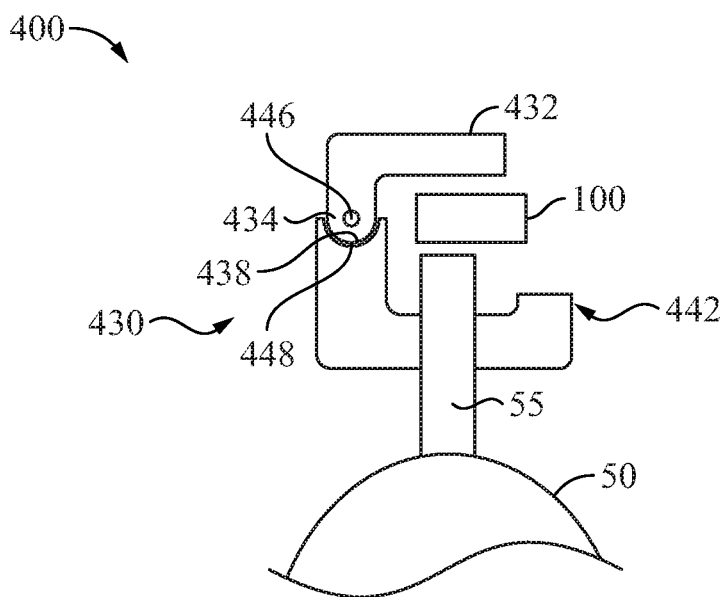

FIG. 10

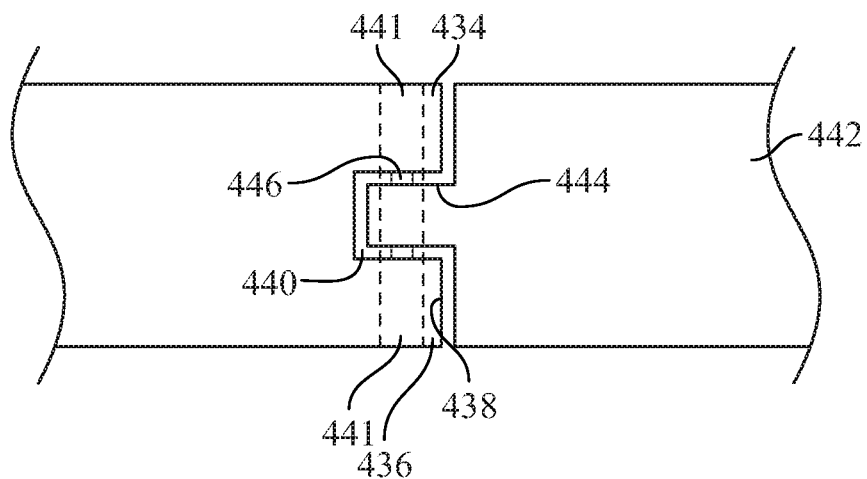

FIG. 10A

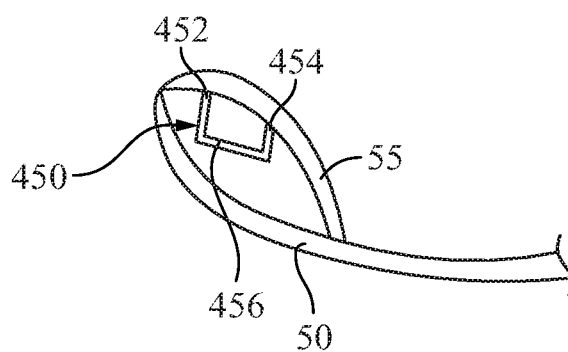

FIG. 11

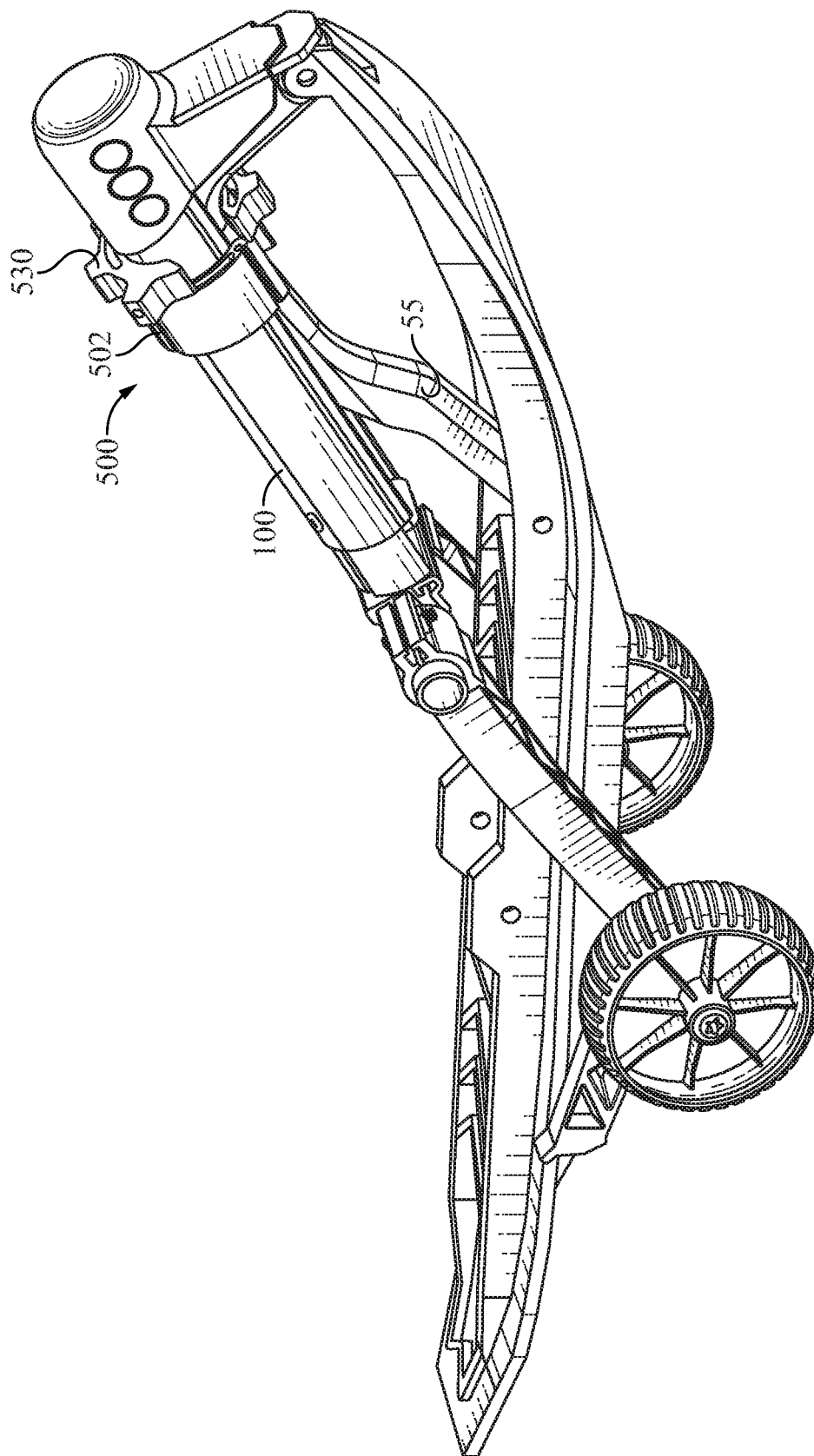

FIG. 12

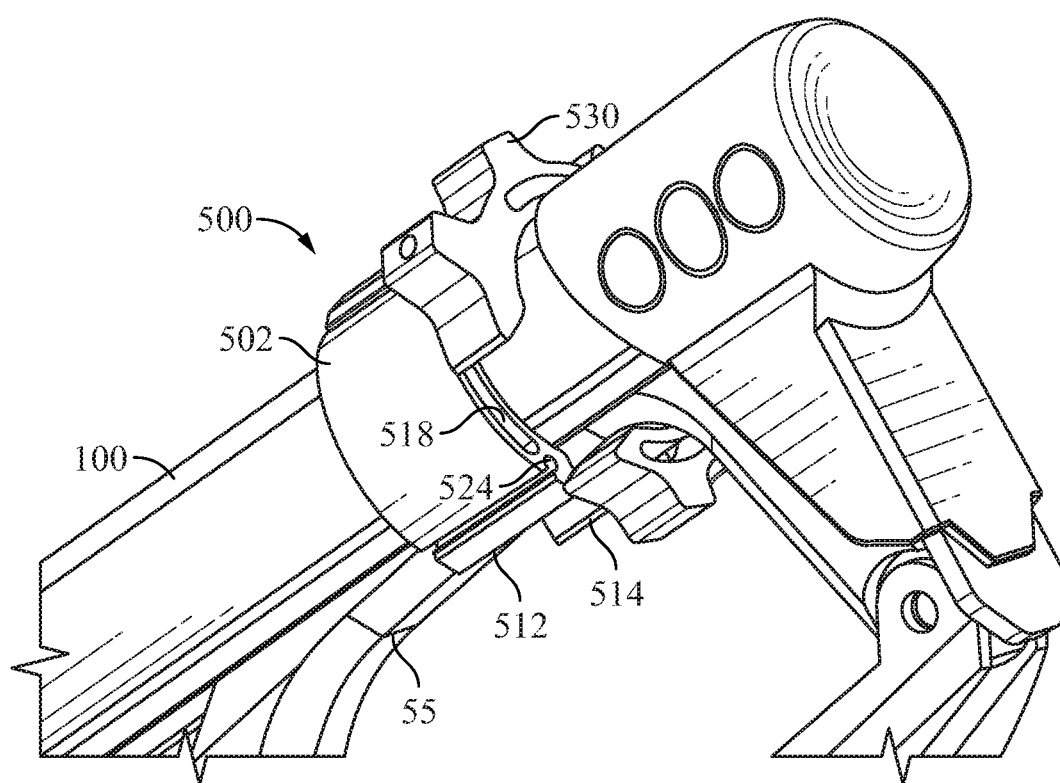

FIG. 13

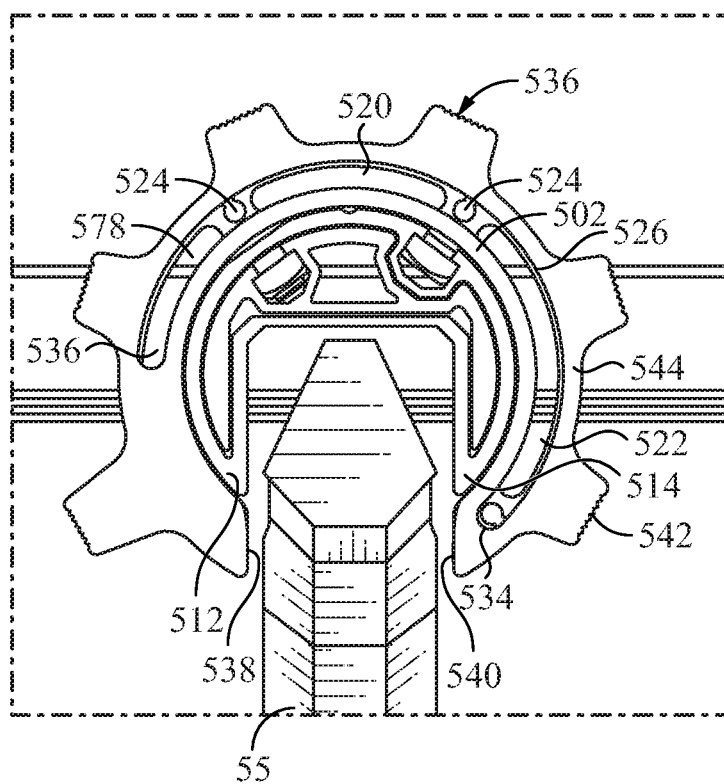

FIG. 14

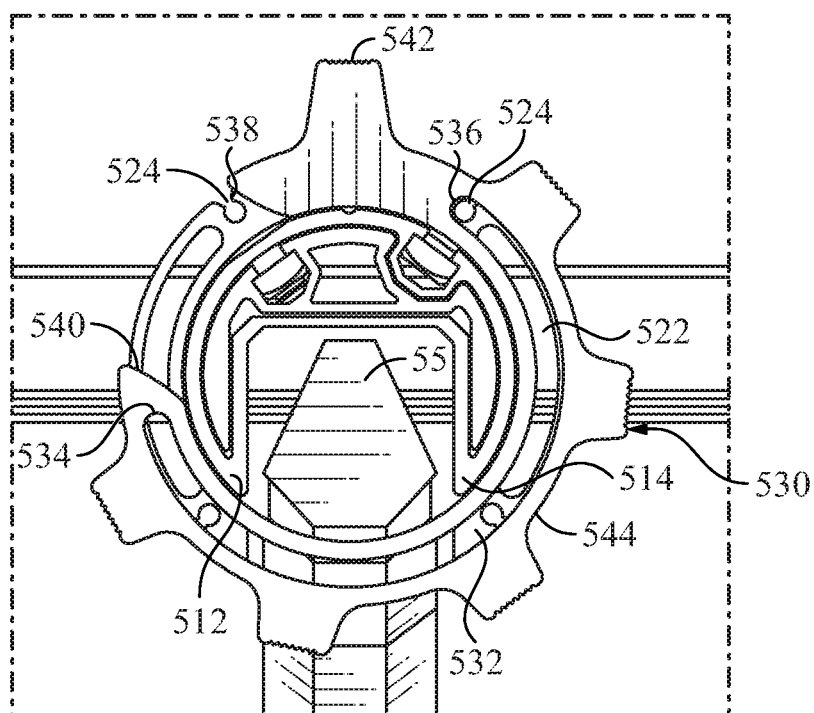

FIG. 15

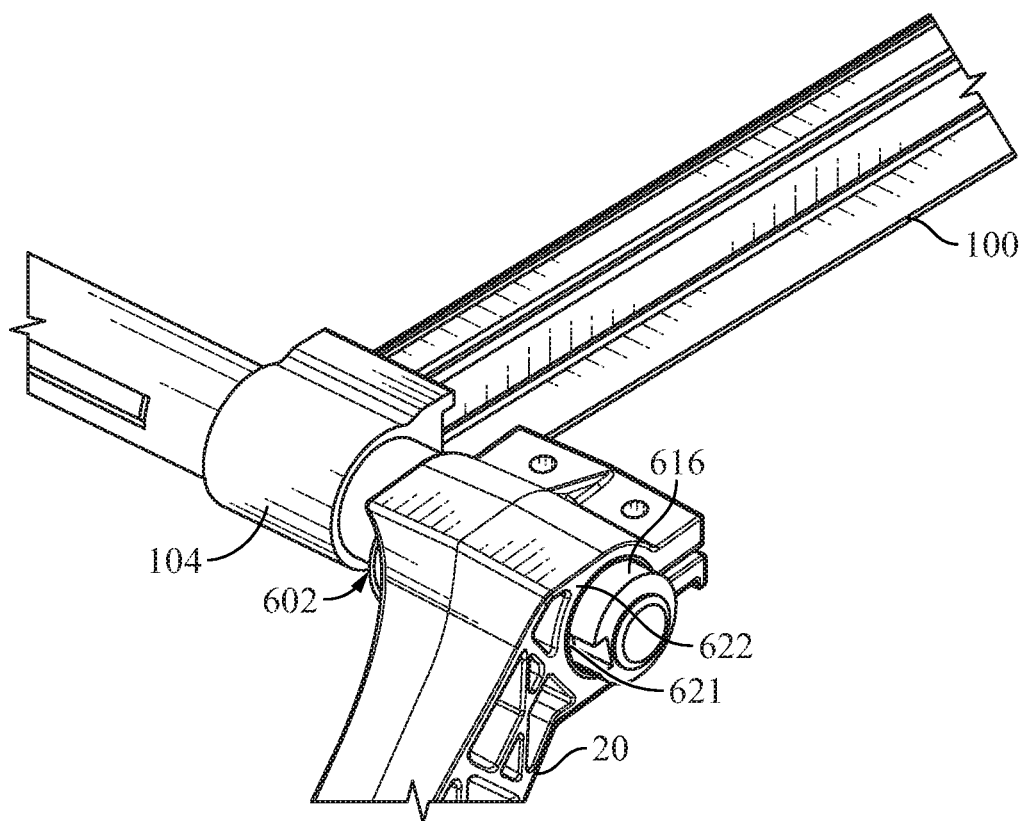

FIG. 16

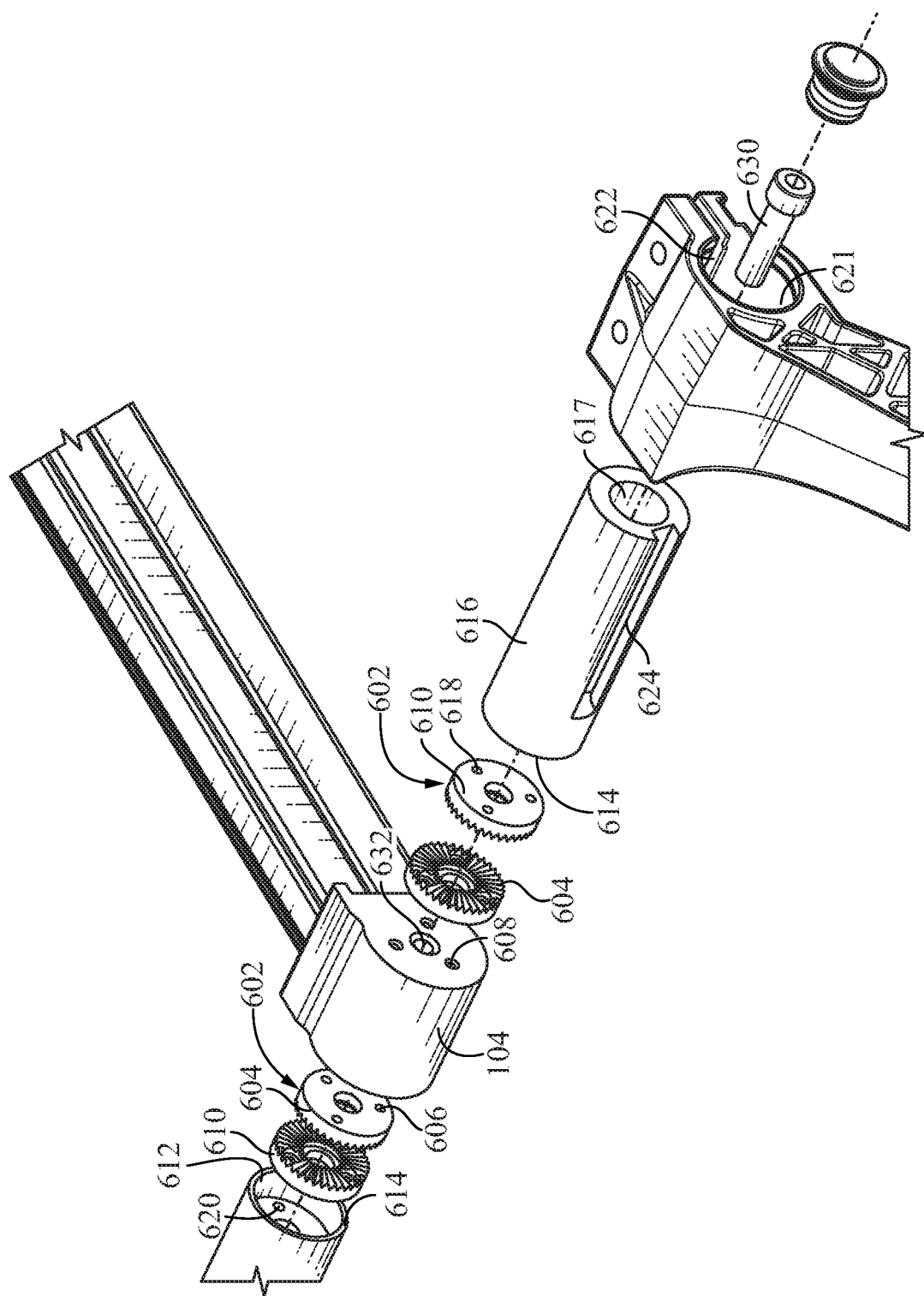

FIG. 17

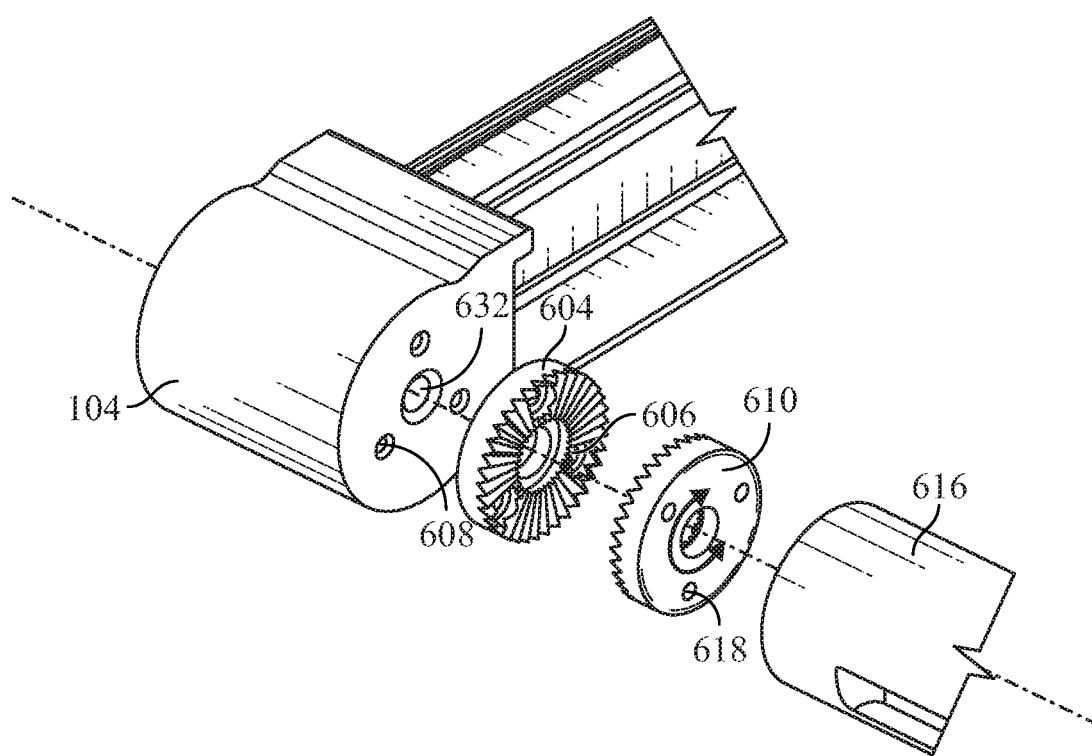

FIG. 18

WHEELED DEVICE FOR SNOWMOBILE SKI

CROSS REFERENCE TO RELATED APPLICATION(S)

[0001] The present disclosure claims the benefit of U.S. Provisional Patent Application Ser. No. 62/548,648 entitled WHEELED DEVICE FOR SNOWMOBILE SKI that was filed on Aug. 22, 2017, the contents of which is incorporated by reference in its entirety.

BACKGROUND

[0002] The present disclosure relates to a device for attaching to a snowmobile ski. More particularly, the present disclosure relates to a wheeled device for attaching to a ski of a snowmobile to more easily move the snowmobile over a snow-free or ice-free surface.

[0003] Snowmobiles are vehicles configured to travel over snow and ice. Snowmobiles have tracks, typically with spaced apart lugs configured to penetrate snow and grip ice to propel the vehicle as the track is moved in a loop that is powered by an engine. Snowmobiles have skis located at the front of the vehicle to grip into snow and ice where the skis are used to steer the vehicle. In order to effectively grip the snow and ice, the skis can have carbide runners that penetrate snow and grip ice.

[0004] While the skis with carbide runners are effective to steer the snowmobile over snow and ice, the skis with carbide runners are not efficient in moving the snowmobile over land or other dry surfaces, such as a floor of a building or a bed of a truck or trailer. When moving a snowmobile over or other dry surfaces, the skis have a tendency of sliding or skidding, which adversely affects the ability to steer the snowmobile. Additionally, the carbide runners and along with the skis can excessively wear over a short period of time when traveling over dry surfaces.

SUMMARY

[0005] An aspect of the present disclosure relates to a device for attaching to a ski of a snowmobile where the device includes first and second spaced apart legs. Each leg has a ski engaging portion proximate a second end that is configured to engage a bottom surface of the ski proximate outer edges thereof. The device includes at least one wheel attached to the first and second legs between the first end and the second end and a cross bar that attaches the first and second legs proximate first ends thereof. The device includes a lever arm extending from the cross bar between the first and second legs wherein the lever arm is configured to be angularly positionable relative to the first and second spaced apart legs. A handle is attached to a distal end of the lever arm and has a surface configured to engage a tip end or a ski handle of the ski. The device includes a retaining member attached to the handle that is configured to engage the ski handle, wherein when the ski engaging portions engage a bottom surface of the ski and the retaining member engages the ski handle, the ski is elevated and the at least one wheel engages the ground surface such that the skis do not contact the ground surface as the snowmobile is moved.

[0006] Another aspect of the present disclosure relates to a device for attaching to a ski of a snowmobile where the device includes first and second spaced apart legs. Each leg has a ski engaging portion proximate a second end that is

configured to engage a bottom surface of the ski proximate outer edges thereof. The device includes at least one wheel attached to the first and second legs between the first end and the second end and a cross bar that attaches the first and second legs proximate first ends thereof. The device includes a lever arm extending from the cross bar between the first and second legs wherein the lever arm is configured to be angularly positionable relative to the first and second spaced apart legs. The device includes a retaining member attached to the lever arm and configured to engage the ski handle, wherein when the ski engaging portions engage a bottom surface of the ski and the retaining member engages the ski handle, the ski is elevated and the at least one wheel engages the ground surface such that the skis do not contact the ground surface as the snowmobile is moved.

BRIEF DESCRIPTION OF THE DRAWINGS

[0007] FIG. 1 is a perspective view of a wheeled device engaging a ski of a snowmobile.

[0008] FIG. 2 is a front view of the wheeled device engaging the ski of the snowmobile.

[0009] FIG. 3 is a perspective view of a front portion of the wheeled device engaging a front portion of the ski of the snowmobile.

[0010] FIG. 4 is a perspective view of the wheeled device.

[0011] FIG. 5 is another perspective view of the wheeled device.

[0012] FIG. 6 is schematic view of a carbide retaining member on an arm of the wheeled device

[0013] FIG. 7 is a schematic view of another embodiment of a carbide retaining member on an arm of the wheeled device.

[0014] FIG. 8 is a schematic view of a stop attached to the arms.

[0015] FIG. 9 is a schematic view of a hook for a ski pivotally attached to a lever arm.

[0016] FIG. 10 is schematic view of a hook with a side pivot.

[0017] FIG. 10a is a side view of the hook with side pivot as illustrated in FIG. 10.

[0018] FIG. 11 is a schematic view of a bracket attached to a ski handle.

[0019] FIG. 12 is a perspective view of the wheeled device with a twisting retaining mechanism.

[0020] FIG. 13 is an enlarged view of the twisting retaining mechanism.

[0021] FIG. 14 is a front view of the retaining mechanism in an open position.

[0022] FIG. 15 is a front view of the retaining mechanism in a closed position.

[0023] FIG. 16 is a perspective view of the wheeled device with a Hirth joint.

[0024] FIG. 17 is a partial exploded view of the wheeled device.

[0025] FIG. 18 is an exploded view of the Hirth joint.

DETAILED DESCRIPTION

[0026] A wheeled device for removably attaching to a ski of a snowmobile is generally illustrated in FIGS. 1-5 at 10. The device 10 is configured to be secured to a ski 50 of a snowmobile and raise the ski 50 above ground level such that the ski 50 is supported in an elevated position by a plurality of wheel 12 and 14. With the device 10 secured to

the ski 50 and the plurality of wheels 12 and 14 engaging the ground surface, the snowmobile can be driven to a selected location, without causing damage to the ski 50 or carbide runners (not shown) on the ski. While FIG. 1 illustrates a wheeled device 10 secured to a single ski 50, it is understood that a second device 10 would be secured to a second ski (not shown) such that the snowmobile can be steered on dry land or other dry surfaces using the wheels 12 and 14 on the device 10.

[0027] The device 10 is assembled utilizing a plurality of part that are secured together with common tools, such as a hex key, which is commonly referred to as an Allen wrench. Because the device 10 can be easily assembled, it can be shipped in a compact, disassembled state. Further, the devices 10 can be assembled to be mirror images of each other, making the securing the device 10 to the skis easier. As the device 10 can be installed on either ski, only one device 10 will be discussed an illustrated going forward.

[0028] The device 10 includes a left arm 20 and a right arm 120 that are substantially mirror images of each other. The left arm 20 includes a substantially flat portion 24 proximate a back end 26 that transitions to an arcuate, upwardly angled portion 28 through an arcuate middle portion 30.

[0029] The arms are typically molded from a polymeric material such that the arms have a monolithic or unitary construction. However, other materials of construction can also be utilized, including an aluminum tube that can be bent to a desired configuration or cut and welded into a desired configuration. Additional materials of construction include steel plate, an aluminum I-beam and steel insert with a polymeric over-mold.

[0030] The left arm 20 includes a ski engaging member 32 that extends inwardly from a location proximate the back end 26. The ski engaging member 32 has an upper surface 34 that is configured to engage a bottom surface 52 of the ski 50. As illustrated, the ski engaging member 32 includes a substantially vertical portion 36 and an angled portion 38 connected with an arcuate portion 40 that includes the upper surface 34.

[0031] The left arm 20 includes a clamp 42 proximate a front end 44. The clamp 42 includes a top member 46 and a bottom member 48 that define a clamping bore 50. The top member 46 includes a front portion 52 having one or more bores and the bottom member 48 includes a similar front portion 56 having one or more bores, where the bores align and accept a bolt 60 such that as the bolt 60 threadably engages a nut 62, the bore 50 constricts and secures a cross bar 80 therein.

[0032] The arm 20 includes a through bore (not shown) in the arcuate middle portion that accepts a bolt 52 that is also positioned through a bore in a hub 54 of a wheel 12 such that the bolt 52 is an axle about which the wheel 12 rotates. In other embodiments, the wheel is attached to a bracket extending below the arms 20 and 120, which can provide additional clearance between the ski and the ground surface. Additionally, a single wheel can be attached to the brackets below the arms 20 and 120, to provide additional clearance and in some instances improved maneuvering capabilities.

[0033] The arm 20 includes a tab 64 proximate an outer edge of the arm 20 and proximate the back end 26. The tab 64 is configured to engage an outer edge of the ski 50 to prevent lateral movement of the ski on the device 10. The tab 64 as illustrated has a smooth surface for engaging the

carbide of the ski. However, the tab 64 can be knurled or have grip tape applied thereto to increase the grip between the carbide on the ski and the tab 64. In other embodiments, a vertical surface proximate the tab 64 has a layer of compressible material, such as rubber, to provide a bumper between the arms 20 and the ski as the ski is positioned on the device 10.

[0034] Referring to FIG. 6, another tab is illustrated at 300. The tab 300 has a left tooth 302 having a substantially vertical surface 304 and an angled surface 306 extending upwardly therefrom. The tab 300 includes a right tooth 308 that is substantially the mirror image of the tooth 302. The right tooth 308 has a substantially vertical surface 310 and an angled surface 312. The angled surfaces 306 and 308 form a “V” shaped channel that accept and center the carbide on the tab 300 as the ski is positioned on the device 10.

[0035] Referring to FIG. 7, another configuration of a tab 320 is illustrated. The tab 320 includes raised left and right teeth 322 and 324. The left tooth 322 includes an angled surface 326 that overlaps with an angled surface 328 on the right tooth 324 to form opposing surfaces that engage the carbide on the ski. The teeth 322 and 324 may slightly flex to ensure the carbide is retained therebetween.

[0036] Referring to FIG. 8, in another embodiment, an optional stop 350 is attached to the arms 20 and 120. The stop 350 is located proximate the wheel 12 and includes an indentation 354 configured to engage a cross brace 356 on the ski. The engagement of the cross brace 356 with indentation 354 prevents the ski from moving excessively forward on the device 10.

[0037] The arm 120 is the mirror image of the arm 20. Similar portions and features of the arm 120 to that of the arm 20 are given a reference character that is one hundred higher than the portions and features of the arm 20. For instance, the substantially flat portion of the arm 120 is given reference character 124 while the substantially flat portion of the arm 20 is given reference character 24.

[0038] The cross bar 80 is constructed from a rigid material, such as a metal, and has a plurality of teeth 82 extending from a first end 86 to a second end 88. The cross bar 80 includes raised flat portions 90 and 92 extending from the first end 86 to the second end 88. An exemplary, but non-limiting, material of construction for the cross bar 80 is aluminum because it is lightweight and strong.

[0039] A mounting bracket 102 attached to a lever arm 100 is positioned over the cross bar 80. The mounting bracket 102 has a bore 104 having a complimentary configuration to that of the cross bar 80, where grooves in the bore 104 accept the teeth 82 in the cross bar 80 and channels in the bore accept the raised flat portions 90 and 92. The engagement of the teeth 82 with the grooves and the raised flat portions 90, 92 with the channels allows the mounting bracket 102 to slide over the cross bar 80 while preventing rotational movement of the lever arm 100 above the cross bar 80. The clamps 42 and 142 of the arms 20 and 120 are positioned about the cross bar 80 proximate ends 79 and 81 and on opposite sides of the lever arm 100.

[0040] The lever arm 100 is rotated with the cross bar 80 within the clamps 42 and 142 to a selected location relative to the left and right arms 20 and 120, respectively, to provide a proper configuration for a particular ski. The bolts 60 and 160 threadably engage the nuts 62 and 162 in each of the clamps 42 and 142 to constrict the clamping bores 50 and

150 about the cross bar **80** to secure the lever arm **100** in a selected position relative to the arms **20** and **120**.

[0041] The lever arm **100** includes a back member **110** secured to the mounting bracket **104** and a front member **112** in sliding engagement with the back member **110**. The back member **110** includes left and right channels **109** and **111** that engage left and right slides **113** and **114** in the front member **112** which allows the front member to move along the length of the back member **110** to adjust a length of the lever arm **100** while preventing rotational movement of the front member **112** about the back member **110**. The back member **110** is secured to the front member **112** with a set screw to retain the lever arm **100** at a selected length for a particular ski.

[0042] The lever arm **100** include a handle portion **116** at a distal end of the front member **112**. The handle portion **116** provides a gripping surface for moving the front member **112** relative to the back member **110** to adjust the length of the lever arm **100**. The handle portion **116** also includes a surface **117** configured to engage a ski tip and/or a ski handle **55**.

[0043] The device **10** includes a substantially “U” shaped guide **200** attached to the front member **112**. The guide **200** includes left and right portions **202** and **204** that extend below the lever arm **100**. The left and right portions **202** and **204** prevent lateral movement of the ski handle **55** when the device is installed on the ski **50**.

[0044] The device also includes a hook member **210** attached to the guide **200**. The hook member **210** include a substantially “J” shaped moveable member **212** that include a vertical portion **214** and a portion **216** extending from the vertical portion **214**. The portion **216** is configured to engage the ski handle **55**.

[0045] The hook member **210** include a mounting portion **220** that attaches to the guide **200** and has a channel **222** configured to accept the vertical portion **214** such that a location of the portion **216** can be adjusted relative to the lever arm **100** to compensate for differently configured skis and/or ski handles.

[0046] Referring to FIG. 9, another configuration a hook member is illustrated at **400**. The hook member **400** includes a top portion **402** that pivotally attaches to the lever arm **100** with a pivot pin **403**. The hook member **400** includes a middle portion **404** extending from the top portion **402** and a hook portion **406** extending from the middle portion **404**. To attach the hook member **400** to the ski handle **55**, the ski **50** is lifted upward and the hook member **400** is rotated about the pivot pin **403** until the hook portion **406** is below the ski handle **55**, at which time the ski is lowered to engage the hook portion **406** with the ski handle **55**.

[0047] FIG. 10 illustrates another embodiment of a hook member at **430**. The hook member includes a mounting member **432** that is attached to the lever arm **100**. The mounting member **432** has spaced apart tabs **434** and **436** at a distal end **438** that define a gap **440**. The tabs **434** and **436** have arcuate convex surfaces **438** and aligned apertures **441**.

[0048] The hook member **430** includes a retaining portion **442** having a tab **444** at a proximal end that is configured to be positioned in the gap **440**. The tab **444** has an aperture that aligns with the apertures **441** in the tabs **434** and **436** such that a pivot pin **446** can be positioned therein to pivotally attach the retaining portion **442** to the mounting member **432**. The retaining portion **442** has arcuate concave

surfaces **448** that are positioned proximate the convex surfaces **438** and allow the retaining portion to pivot about the pivot pin **442**.

[0049] To attach the retaining portion **442** to the ski **50**, the ski **50** is lifted to a selected position and the retaining portion **442** is pivoted about the pivot pin **442** until the retaining portion **442** is beneath the ski handle **55**. The ski **50** is then lowered to cause the ski handle **55** to engage the retaining portion **442**.

[0050] Referring to FIG. 11, a U shaped bracket **450** is attached to the ski handle **55**. The bracket **450** limits sliding movement of the attaching mechanism of the device **10** to the ski handle **55** to be between points **452** and **454** of connection with the ski handle **55**. As such a strap can be positioned between the points **452** and **454** and a middle portion **456** to attached the ski handle **55** to the lever arm **100**. In one embodiment a hook and loop fastening system is attached to the strap, such as that sold under the VEL-CRO® trademark.

[0051] Referring back to FIGS. 1-5, the device **10** is positioned about the ski **50** by first positioning the arms **20** and **120** over the top of the ski handle **55** such that the ski engaging members **32** and **132** are located below the ski **50** where the ski engaging members **32** and **132** are spaced apart to allow a stabilizing bar **56** of the ski **50** to be located therebetween. With the ski engaging member **32** and **132** located below the ski **50**, the ski **50** is raised by grasping the ski handle **55** and lift the ski **50**. With the ski **50** elevated, the device is move along the ski **50** until the wheels **12** and **14** are located below the junction of the steering mechanism with ski **50** so that the wheels **12** and **14** are aligned with the steering mechanism.

[0052] The lever arm **100** is then lowered with manual force so that the portion **216** of the substantially “J” shaped member **212** is located within the space between the ski handle **55** and the ski **50**. The ski **50** is then released, resulting in the portion **216** engaging the ski handle **55** and the weight of the ski (and snowmobile) causes the ski engaging members **32** and **132** are raised to engage the bottom of the ski **50** through a lever action where the wheels **12** and **14** act as the fulcrum.

[0053] The length of the lever arm **100** can be adjusted by moving the front member **112** over the back arm **110** such that the surface **117** of the handle portion **116** engages the ski tip and/or the ski handle **55**. A bolt or set screw **115** is then utilized to retain the lever arm **100** at the selected length.

[0054] The surface **117** of the handle **116** engaging the ski tip and/or ski handle **55** prevents the ski **50** from moving forward on the device. Further the left and right portions **202** and **204** on the guide **200** prevent lateral movement of the ski handle **55** and, therefore, the ski **50** on the device **10**.

[0055] With the device **10** secured on both skis **50** on the snowmobile, the track and wheels **12** and **14** are used to move the snowmobile to a selected location without damaging the skis and/or carbide runners

[0056] The device **10** removed from the ski **50** by lifting the ski handle **55** to remove weight of the ski (and snowmobile) from the device **10**. The portion **216** of the substantially “J” shaped member **212** is displaced from the ski handle **55** and the device **10** is rolled on the wheels **12** and **14** off of the ski **50**.

[0057] Referring to FIGS. 12-15, the wheeled device is illustrated with a ski having a ski handle **55** where the device has a twisting or rotating retaining mechanism **500**. A

member of the retaining mechanism **500** is rotated in one direction to accept the ski handle **55** and is rotated in an opposite direction to retain the ski handle **55**.

[0058] The retaining mechanism **500** includes a collar **502** that is frictionally secured to the lever arm **100**. The collar **502** is arcuate in configuration and includes a first end **512** and a second end **514** separated by a gap.

[0059] The collar **502** includes a left arcuate slot **518** and top arcuate slot **520** and a right arcuate slot **522** that extend from a front surface to a back surface. The collar **502** include a plurality of bore shaped channels **524** that interrupt an outer surface **526** of the collar **502**.

[0060] The slots **518**, **520** and **522** along with the channels **524** provide sufficient flexibility to the collar **502** such that as manual force is place on the collar **502** and the lever arm **100**, the ends **512** and **514** spread apart to position the collar **502** about the lever arm **100**. With the collar positioned about the lever arm **100**, the ends **512** and **514** come closer together to frictionally secure the collar **502** to the lever arm **100**.

[0061] The retaining mechanism **500** includes a retaining member **530** that is movably coupled to the collar **502** such that the retaining member **530** is positionable between an open position as illustrated in FIG. **14** and a closed position as illustrated in FIG. **15**. The retaining member **530** has an arcuate configuration with left and right ends **538** and **540** separated by a gap.

[0062] The retaining member **530** has a slot **532** extending from a first end **534** to a second end **536**. A pin (not shown) or other retaining device is positioned through the slot **532** and into the collar **502** to retain the member **530** to the collar **502** while allowing the retaining member to move relative to the collar **502**.

[0063] The retaining member **530** includes a plurality of raised members **542** on an outer surface **544** that provide a gripping surface to better enable the movement of the retaining member **530** from the open position to the closed position, as illustrated in FIGS. **14** and **15**, respectively.

[0064] Referring to FIGS. **16-18**, another embodiment of the wheeled device is illustrated at **600**. The wheeled device **600** utilizes a plurality of Hirth joints **602** instead of the clamps **42** and **142** to position the lever arm **100** relative to the arms **20** and **120**. First portions **604** of the Hirth joints **602** are secured to opposite sides of the mounting bracket **104** with a plurality of bolts positioned through apertures **606** in the first portions **604** and into threaded bores **608** in the mounting bracket **104**.

[0065] Second portions **610** of the Hirth joint are positioned within cavities **612** in an inner end **614** of a shaft **616**. The second portions **610** are secured to the shafts **616** with bolts that are positioned through apertures **618** in the second portions and threadable engage bores **620** in the shafts.

[0066] With the first and second portions **604** and **610** secured to the mounting bracket **104** and the shafts **616**, the arms **20** and (not shown) are positioned over the shafts **616** such that a key **621** in a clamping bore **622** engages a key slot **624** in the shaft **616** such that the arm **20** does not rotate relative to the shaft **616**.

[0067] A bolt **630** is positioned through a through bore **617** in the shaft and into a threaded bore **632** in the mounting bracket **104**. The lever arm **100** is positioned into a selected angular position relative to the arm **20** and the bolt is tightened such that radial teeth in the first portion **604**

engages the radial teeth in the second portion **610** to retain the lever arm **100** and the arm **20** in the selected configuration.

[0068] To change the radial position of the lever arm **100** relative to the arm **20**, the bolt **630** is loosened to disengage the radial teeth in the first and second portion **604** and **610** to allow the lever arm to pivotally move to a second radial position. When in the second radial position, the bolt **630** is retightened to secure the first and second portions **604**, **610** together. As such, the Hirth joint allows the lever arm **100** to be radially positioned relative to the arm **20** to adapt to any configuration of the ski **50**.

[0069] The key and the key slot **624** allow the arm **20** to move relative to the shaft to adapt the position of the arms **20**, **120** to the width of the ski **50**. To move the arms **20**, **120**, bots in the clamping members **640** are loosened to expand the clamping bore. The arms **20**, **120** can move relative to the shafts **616**.

[0070] The bolts are then tightened to constrict the clamping bore and retain the arms **20**, **120** in a selected position on the shafts **616**. As such, the width of the arms **20**, **120** and the configuration of the lever arm **100** relative to the arms **20**, **120** can be adjusted to accommodate most if not all skis of a snowmobile.

[0071] Although the present invention has been described with reference to preferred embodiments, workers skilled in the art will recognize that changes may be made in form and detail without departing from the spirit and scope of the invention.

1. A device for attaching to a ski of a snowmobile, the device comprising:

first and second spaced apart legs, each leg having a first end and a second end, wherein each leg includes a ski engaging portion proximate the second end that is configured to engage a bottom surface of the ski proximate outer edges thereof;

at least one wheel attached to the first and second legs between the first end and the second end;

a cross bar attaching the first and second legs proximate the first ends;

a lever arm extending from the cross bar between the first and second legs wherein the lever arm is configured to be angularly positionable relative to the first and second spaced apart legs;

a handle attached to a distal end of the lever arm, the handle having a surface configured to engage a tip end or a ski handle of the ski; and

a retaining member attached to the handle and configured to engage the ski handle, wherein when the ski engaging portions engage a bottom surface of the ski and the retaining member engages the ski handle, the ski is elevated and the at least one wheel engages the ground surface such that the skis do not contact the ground surface as the snowmobile is moved.

2. The device of claim 1, wherein each leg of the first and second legs further comprises an upwardly extending tab configured to engage side surfaces of the ski and to limit lateral movement of the ski on the device.

3. The device of claim 1, wherein the upwardly extending tab has a plurality of sloped surfaces configured to engage a carbide on the ski.

4. The device of claim 1, wherein each of the first and second legs comprises a clamping member proximate the first end, where the clamping member comprises:

- a top member;
 - a bottom member, wherein the top member and the bottom member define a clamping bore into which the cross bar is positioned; and
 - at least one securing mechanism that is configured to position the clamp into a first position where the clamp engages the cross bar to fix the angular position of the lever arm relative to the first and second legs and wherein the securing mechanism is configured to position the clamp in a second position wherein the cross bar and the lever arm can rotate within the clamping bore.
5. The device of claim 4, wherein the at least one securing mechanism comprises a plurality of spaced apart bolts and nuts.
6. The device of claim 4, wherein the cross bar comprises a plurality of teeth, the plurality of teeth being configured to be positioned with the clamp/
7. The device of claim 1, wherein each arm comprises a first portion of a Hirth joint non-rotatably secured thereto.
8. The device of claim 7, wherein the cross bar comprises a second portion of a Hirth joint non-rotatably secured to opposing ends thereof.
9. The device of claim 8, and further comprising a securing mechanism configured to position and retain the first and second portion in a first position where the first and second portions of the Hirth joint are non-rotatably secured to each other and a second position where the first and second portions of the Hirth joint are rotatable relative to each other.
10. The device of claim 1, wherein the retaining member comprises a monolithic member comprising:
- a downwardly extending portion; and
 - a lateral portion extending from the downwardly extending portion wherein the lateral portion is configured to engage the ski handle.
11. The device of claim 1, wherein the retaining member comprises:
- a first portion attached to the handle; and
 - a second portion hingedly attached to the first portion wherein the second portion is positionable into a first position wherein the second portion engages the ski handle and a second position where the second portion is displaced from the ski handle.
12. The device of claim 1, wherein the retaining member comprises:
- a first portion non-rotatably attached to the handle, the first portion having a first channel configured to accept a portion of the ski handle; and
 - a second portion rotatably secured to the first portion, the second portion having a second channel configured to pass the ski handle therethrough, wherein the second portion is positionable into a first position where the first and second channels are aligned such that the portion of the ski handle is positionable within the first channel and a second position wherein a portion of the second portion covers an entrance to the first portion to retain the ski handle to the retaining member.

13. The device of claim 1, wherein the at least one wheel comprises:

- a first wheel rotatably attached to the first leg; and
- a second wheel rotatably attached to the second leg.

14. A device for attaching to a ski of a snowmobile, the device comprising:

- first and second spaced apart legs, each leg having a first end and a second end, wherein each leg includes a ski engaging portion proximate the second end that is configured to engage a bottom surface of the ski proximate outer edges thereof;
- a first wheel rotatable attached to the first leg, between the first end and the second end thereof;
- a second wheel rotatable attached to the second leg, between the first end and the second end thereof;
- a cross bar attaching the first and second legs proximate the first ends;
- a lever arm extending from the cross bar between the first and second legs wherein the lever arm is configured to be angularly positionable relative to the first and second spaced apart legs; and
- a retaining member attached to the lever arm and configured to engage the ski handle, wherein when the ski engaging portions engage a bottom surface of the ski and the retaining member engages the ski handle, the ski is elevated and the at least one wheel engages the ground surface such that the skis do not contact the ground surface as the snowmobile is moved.

15. The device of claim 14, wherein each leg of the first and second legs further comprises an upwardly extending tab configured to engage side surfaces of the ski and to limit lateral movement of the ski on the device.

16. The device of claim 14, wherein the upwardly extending tab has a plurality of sloped surfaces configured to engage a carbide on the ski.

17. The device of claim 14, wherein each of the first and second legs comprises a clamping member proximate the first end, where the clamping member comprises:

- a top member;
- a bottom member, wherein the top member and the bottom member define a clamping bore into which the cross bar is positioned; and
- at least one securing mechanism that is configured to position the clamp into a first position where the clamp engages the cross bar to fix the angular position of the lever arm relative to the first and second legs and wherein the securing mechanism is configured to position the clamp in a second position wherein the cross bar and the lever arm can rotate within the clamping bore.

18. The device of claim 17, wherein the at least one securing mechanism comprises a plurality of spaced apart bolts and nuts.

19. The device of claim 17, wherein the cross bar comprises a plurality of teeth, the plurality of teeth being configured to be positioned with the clamp/

20. The device of claim 14, wherein each arm comprises a first portion of a Hirth joint non-rotatably secured thereto.

* * * * *