



(11) **EP 3 152 294 B1**

(12) **EUROPEAN PATENT SPECIFICATION**

(45) Date of publication and mention of the grant of the patent:
10.03.2021 Bulletin 2021/10

(51) Int Cl.:
G01N 15/10 (2006.01) G01N 15/14 (2006.01)
G01N 21/64 (2006.01)

(21) Application number: **15803911.5**

(86) International application number:
PCT/US2015/033907

(22) Date of filing: **03.06.2015**

(87) International publication number:
WO 2015/187783 (10.12.2015 Gazette 2015/49)

(54) **FLOW CYTOMETER SIGNAL PEAK IDENTIFICATION EMPLOYING DYNAMIC THRESHOLDING**

DURCHFLUSSZYTOMETERSIGNALSPITZENWERTIDENTIFIZIERUNG MITTELS DYNAMISCHEM SCHWELLENWERT

IDENTIFICATION DE CRÊTES DE SIGNAUX DE CYTOMÉTRIE DE FLUX UTILISANT UN SEUILLAGE DYNAMIQUE

(84) Designated Contracting States:
AL AT BE BG CH CY CZ DE DK EE ES FI FR GB GR HR HU IE IS IT LI LT LU LV MC MK MT NL NO PL PT RO RS SE SI SK SM TR

- **TENENT, Erica Dawson**
Broomfield, Colorado 80020 (US)
- **ROWLEN, Kathy L.**
Longmont, Colorado 80503 (US)

(30) Priority: **05.06.2014 US 201462008345 P**

(74) Representative: **Vigand, Philippe et al**
Novagraaf International SA
Chemin de l'Echo 3
1213 Onex - Genève (CH)

(43) Date of publication of application:
12.04.2017 Bulletin 2017/15

(73) Proprietor: **Essen Instruments, Inc.**
Ann Arbor, MI 48108 (US)

(56) References cited:
WO-A2-2014/062719 CA-A1- 2 796 489
US-A1- 2006 259 253 US-A1- 2008 021 674
US-A1- 2010 284 016 US-A1- 2011 024 615
US-A1- 2011 089 328 US-A1- 2011 089 328
US-A1- 2011 256 631 US-A1- 2013 171 683
US-A1- 2013 171 683 US-A1- 2013 252 237
US-B1- 7 069 191

(72) Inventors:

- **SMOLAK, Andrew W.**
Golden, Colorado 80403 (US)
- **FRAIKIN, Jean-Luc**
Toronto, Ontario M6R 2J4 (CA)

EP 3 152 294 B1

Note: Within nine months of the publication of the mention of the grant of the European patent in the European Patent Bulletin, any person may give notice to the European Patent Office of opposition to that patent, in accordance with the Implementing Regulations. Notice of opposition shall not be deemed to have been filed until the opposition fee has been paid. (Art. 99(1) European Patent Convention).

Description**CROSS-REFERENCE TO OTHER APPLICATIONS**

[0001] This application claims the benefit of U.S. provisional patent application serial no. 62/008,345 entitled "FLOW CYTOMETER SIGNAL PEAK IDENTIFICATION EMPLOYING DYNAMIC THRESHOLDING" filed June 5, 2014.

FIELD OF THE INVENTION

[0002] The present invention relates generally to the processing of data signal traces output by a flow cytometer instrument, and more particularly, to the identification of signal peaks within data signal traces output by a flow cytometer instrument.

BACKGROUND OF THE INVENTION

[0003] Flow cytometry is an analytical technique used in a number of applications to measure physical and/or chemical properties of biological or nonbiological particles as they flow in a sample fluid, often an aqueous liquid medium, through an investigation cell (also referred to herein as a flow cell). Flow through the cell may be investigated by a variety of techniques, including subjecting the flow to electrical, acoustic and/or optical signals in measuring and analyzing responses to detect and evaluate particles in the sample.

[0004] When attempting to evaluate whether or not a particular particle is present in a sample fluid, one or more fluorescent stains or dyes may be added to the sample fluid. The dyes or stains are selected to fix on the particle of interest and to fluoresce when exposed to excitation light within a particular range of wavelengths. The fluorescent response light from the sample fluid may be detected by one or more photodetectors of the flow cytometry instrument, which in turn, generate one or more electrical signal data traces in which the voltage level at a particular instant in time indicates the level of fluorescent response light received by the detector from the sample fluid at that time. By identifying peaks in the signal data traces, an evaluation may be made regarding the presence of the target particle in the sample fluid. However, identifying valid signal peaks in signal data traces of a flow cytometer instrument can be challenging, particularly where two or more stains or dyes are used in the flow cytometry investigation which may result in cross-talk among signal data traces corresponding with a fluorescent response resulting from each stain or dye.

[0005] US 2008/021674 A1 discloses methods for enhancing the analysis of particle detection comprising measuring a first electromagnetic radiation signal provided by a particle, comparing by cross-correlation the electromagnetic radiation signal emitted by the particle, and further applying an analytical filter to the cross-correlation events, thereby enhancing the analysis of the particle

emission.

[0006] WO 2014/062719 A2 discloses cell detection systems, fluidic devices, structures and techniques related to particle and cell sorting and detection in fluid, for example sorting specific subpopulations of cell types. A method for verification of sorting of particles includes receiving a first detection signal that is associated with optical characteristics of a particle in a first channel. A sorting channel of a plurality of second channels is determined based on the first detection signal, thereby determining the sorting of the particle into the sorting channel based on the optical characteristics of the particle. A sorting signal for sorting the particle from the first channel into the sorting channel is transmitted. A second detection signal is received that is associated with the presence of the particle in the sorting channel. The sorting of the particle from the first channel into the sorting channel is verified based on the second detection signal.

20 SUMMARY OF THE INVENTION

[0007] Accordingly, a method, according to claim 14, of evaluating particle attributes in a sample fluid subjected to flow cytometry investigation in a flow cytometer instrument by processing time series signal data traces output by a flow cytometer instrument, and a flow cytometer system according to claim 1 are provided. In the methods and systems, data points comprising time series signal data traces corresponding with detection during the flow cytometry investigation of light from the sample fluid in one or more wavelength ranges indicative of the presence of one or more particle attributes in the sample fluid are batch-processed using a batch-specific signal peak threshold determined as a function of a batch-specific noise characteristic to identify signal peaks in the batch of data points indicative of the presence of the one or more particle attributes in the sample fluid.

[0008] In one aspect, a method of evaluating particle attributes in a sample fluid subjected to flow cytometry investigation in a flow cytometer instrument may include processing flow cytometry investigation response data generated by the flow cytometer instrument. The response data may comprise a time series signal data trace corresponding with detection during the flow cytometry investigation of light from the sample fluid in a wavelength range that is indicative of the presence of a particle attribute in the sample fluid. The processing may comprise separately batch processing a plurality of different time interval batches of data points of the time series signal data trace. The batch processing of each batch of data points may comprise: (1) determining a batch-specific noise characteristic for the batch of data points; (2) determining a batch-specific signal peak threshold for the batch of data points as a function of the batch-specific noise characteristic; and (3) identifying signal peaks in the batch of data points indicative of the presence of the particle attribute in the sample fluid using threshold criteria including the batch-specific signal peak threshold.

[0009] In one particular implementation of the method where the flow cytometry investigation involves two stains or dyes and hence two fluorescent responses of differing wavelength ranges, the time series signal data trace may comprise a first time series signal data trace, the particle attribute may comprise a first particle attribute, the light may comprise first light from the sample fluid in a first wavelength range that is indicative of the presence of the first particle attribute, the response data may further comprise a second time series signal data trace corresponding with detection during the flow cytometry investigation of second light from the sample fluid in a second wavelength range that is indicative of the presence of a second particle attribute in the sample fluid, and the method may further comprise separately batch processing a plurality of different time interval batches of data points of the second time series signal data trace. Time intervals of each successive batch of data points of the second time series signal data trace may correspond in time with time intervals of each successive batch of data points of the first time series signal data trace. The batch processing of each batch of data points of the second time series signal data trace may comprise: (1) determining a batch-specific noise characteristic for the batch of data points of the second time series signal data trace; (2) determining a batch-specific signal peak threshold for the batch of data points of the second time series signal data trace as a function of the batch-specific noise characteristic for the batch of data points of the second time series signal data trace; and (3) identifying signal peaks in the batch of data points of the second time series signal data trace indicative of the presence of the second particle attribute in the sample fluid using threshold criteria including the batch-specific signal peak threshold.

[0010] In another aspect, a method of processing time series signal data traces output by a flow cytometer instrument may include selecting a batch of data points from each of a first and a second time series signal data trace output by the flow cytometer instrument. The first time series signal data trace may comprise a first plurality of data points corresponding with detection by the flow cytometer instrument of light in a first wavelength range that is indicative of the presence of a first particle attribute in a sample fluid subjected to flow cytometry investigation in the flow cytometer instrument, and the second time series signal data trace may comprise a second plurality of data points corresponding with detection by the flow cytometer instrument of light in a second wavelength range that is indicative of the presence of a second particle attribute in the sample fluid. The method may also include separately processing each batch of selected data points from each of the first and second time series signal data traces. The batch-processing of each batch of data points may comprise: (1) determining a batch-specific noise characteristic for the batch of data points; (2) determining a batch-specific signal peak threshold for the batch of

data points as a function of the batch-specific noise characteristic; and (3) identifying signal peaks in the batch of data points indicative of the presence of one of the first particle attribute or the second particle attribute in the sample fluid using threshold criteria including the batch-specific signal peak threshold. The method may also include comparing times of occurrence of the identified signal peaks in the separately batch processed batches of data points of the first and the second time series signal data traces, and recording as the presence of a target particle a temporal coincidence of identified signal peaks in the batches of data points of the first and the second time series signal data traces.

[0011] In a further aspect, a flow cytometer system may include a flow cytometer instrument operable to output flow cytometry investigation response data. The response data may comprise a time series signal data trace corresponding with detection during the flow cytometry investigation of light from the sample fluid in a wavelength range that is indicative of the presence of a particle attribute in the sample fluid. The flow cytometer instrument may also include a processor operable to receive the flow cytometry response data output by the flow cytometer instrument. The processor may be further operable to separately batch process a plurality of different time interval batches of data points of the time series signal data trace to: (1) determine a batch-specific noise characteristic for the batch of data points; (2) determine a batch-specific signal peak threshold for the batch of data points as a function of the batch-specific noise characteristic; and (3) identify signal peaks in the batch of data points indicative of the presence of the particle attribute in the sample fluid using threshold criteria including the batch-specific signal peak threshold.

[0012] In one particular implementation of the system where the flow cytometry investigation involves two stains or dyes and hence two fluorescent responses of differing wavelength ranges, the time series signal data trace may comprise a first time series signal data trace, the particle attribute may comprise a first particle attribute, the light may comprise first light from the sample fluid in a first wavelength range that is indicative of the presence of the first particle attribute, the response data may further comprise a second time series signal data trace corresponding with detection during the flow cytometry investigation of light from the sample fluid in a second wavelength range that is indicative of the presence of a second particle attribute in the sample fluid, and the processor may be further operable to separately batch process a plurality of different time interval batches of data points of the second time series signal data trace. Time intervals of each successive batch of data points of the second time series signal data trace may correspond in time with time intervals of each successive batch of data points of the first time series signal data trace. The processor may separately batch processes the plurality of different time interval batches of data points of the second time series signal data trace to: (1) determine

a batch-specific noise characteristic for the batch of data points of the second time series signal data trace; (2) determine a batch-specific signal peak threshold for the batch of data points of the second time series signal data trace as a function of the batch-specific noise characteristic for the batch of data points of the second time series signal data trace; and (3) identify signal peaks in the batch of data points of the second time series signal data trace indicative of the presence of the second particle attribute in the sample fluid using threshold criteria including the batch-specific signal peak threshold.

[0013] Various refinements exist of the features noted in relation to the various aspects of the present invention. Further features may also be incorporated in the various aspects of the present invention. These refinements and additional features may exist individually or in any combination, and various features of the various aspects may be combined. These and other aspects and advantages of the present invention will be apparent upon review of the following Detailed Description when taken in conjunction with the accompanying figures.

DESCRIPTION OF THE DRAWINGS

[0014]

FIGS. 1A-1B are perspective and side views of one embodiment of a flow cytometer instrument.

FIGS. 2A-2B are perspective and top views of one embodiment of a flow cytometer internal assembly that may be included within the flow cytometer instrument of FIGS. 1A-1B.

FIG. 3 is a flow diagram depicting the steps of one embodiment of a method of evaluating particle attributes in a sample fluid subjected to flow cytometry investigation in a flow cytometer.

FIG. 4 is a scatter plot of peak heights for a first time series signal data trace versus peak heights for a second time series signal data trace.

FIGS. 5A-5B are plots of exemplary corrected first and second time series signal data traces following removal of cross-talk.

FIG. 6A is a time series plot showing a batch of 10,000 data points from a first time series signal data trace and a batch of 10,000 data points from a second time series signal data trace over corresponding time intervals.

FIG. 6B is a histogram plot for the first time series signal data trace shown in FIG. 6A.

FIG. 7 is a block diagram of one embodiment of a flow cytometer system.

DETAILED DESCRIPTION

[0015] FIGS. 1A-1B show a flow cytometer 100 that includes flow cytometry componentry contained within a protective enclosure 102. Fluid samples may be introduced into the flow cytometer 100 for flow cytometry in-

vestigation through a sample inlet 104. The flow cytometer 100 includes support pads 106 on which the weight of the enclosure 102 and contents within the enclosure 102 are supported. Advantageously, the support pads 106 may be of a material that provides significant vibration isolation to the enclosure 102, and to contents within the enclosure 102, from ambient environment vibrations that may be transmitted through a shelf, table or other surface on which the flow cytometer 100 may be situated during use. The support pads 106 may, therefore, provide a vibration isolation structure that provides a vibration propagation barrier to the enclosure 102 and contents within the enclosure 102. For example, the support pads 106 may be of a polymeric composition that provides a vibration decomposing effect. Example polymeric compositions include thermoplastic and thermoset polymer compositions.

[0016] FIGS. 2A-2B show an example flow cytometer internal assembly 180 that may be disposed within the enclosure 102 of the flow cytometer 100. The internal assembly 180 includes a flow optical system assembly including support platform 200 and a number of flow cytometry optical components supported by the support platform 200, with the optical components having fixed relative positioning configured for performing flow cytometry investigations of sample fluids. The flow cytometry optical system assembly is supported by a support structure including three rigid support members 202 and vibration isolation mounts (not shown in FIGS 2A-2B) that are supported by the support members 202, and on which the entire weight of the support platform 200 and components supported by the support platform 200 are supported during flow cytometry investigation operations.

[0017] The flow cytometry optical components supported by the support platform 200 include a light source in the form of a laser unit 206, a flow cell unit 208 and a light detection system including a dichroic mirror unit 210 and two light detector units 212, for example which may include photomultiplier tubes. During operation of a flow cytometry investigation of sample fluid flowing through an investigatory flow path of a flow cell of the flow cell unit 208, light from the laser unit 206 travels along a first optical path to the flow cell. The first optical path includes a mirror unit 214 that includes a mirror that reflects light from the laser unit 206 to direct that light through a focusing lens 216 to focus light in the vicinity of the investigatory flow path within the flow cell of the flow cell unit 208. Light from the investigatory flow path of the flow cell is directed along a second optical path from the flow cell to the dichroic mirror unit 210 for detection by the light detectors 212. The second optical path includes a focusing lens unit 218 and a spatial lens unit 220 between the flow cell unit 208 and the dichroic mirror unit 210. A dichroic mirror within the dichroic mirror unit 210 splits the light between light that passes through the dichroic mirror and is directed toward light detector 212a and light that is reflected by the dichroic mirror and is directed toward light detector 212b. Bandpass filters 222 may be dis-

posed in the optical paths to the light detectors 212 to pass a narrow light including a wavelength or band of wavelengths targeted for detection by the respective light detectors 212a, 212b.

[0018] During operation of the flow cytometer 100 to perform a flow cytometry investigation of a fluid sample, the fluid sample to be investigated may be introduced into the flow cytometer through the sample inlet 104. The sample fluid is conducted to an inlet (not shown in FIGS. 2A-2B) to the flow cell unit 208. The sample fluid flows through the investigatory fluid path in the flow cell unit 208 and exits the flow cell unit 208 through a sample exit 226. Sample fluid introduced into the flow cell unit 208 through the sample fluid inlet flows through a transparent section of the flow cell unit 208 where it is subjected to incident light from the laser unit 206 and exits through the sample exit 226. The investigatory flow path passes through the transparent section. The transparent section may, for example, be made of a quartz crystal material. Between the sample inlet 104 of the flow cytometer 100 and the inlet to the flow cell unit 208, the fluid sample passes through a fluid path (not shown) that includes a flow meter 232 where the flow rate of the fluid sample may be measured for data collection purposes as part of a feedback control mechanism for controlling the fluid sample flow rate to the flow cell unit 208. In the flow cell unit 208, a sheath fluid is introduced around the fluid sample flow before the fluid sample flows through the transparent section for investigation. The sheath fluid is introduced into the flow cell unit 208 through a sheath fluid inlet (not shown in FIGS. 2A-2B). Prior to introduction of the sheath fluid into the flow cell unit 208, the sheath fluid passes through a fluid path (not shown in FIGS. 2A-2B) that includes a flow sensor 234 for monitoring of the sheath fluid flow rate to the flow cell unit 208 and for use for feedback control to control the flow rate of the sheath fluid to the flow cell unit 208. The flow sensors 232 and 234 are conveniently supported on the support platform 200.

[0019] FIG. 3 illustrates steps that may be included in a method of evaluating particle attributes in a sample fluid subjected to flow cytometry investigation in a flow cytometer instrument such as flow cytometer 100 of FIGS. 1A-1B having a flow cytometer internal assembly 180 such as depicted in FIGS. 2A-2B.

[0020] The method 300 may be initiated with step 310 in which a flow cytometry investigation is performed on a sample fluid. In this regard, a flow cytometer 100 such as depicted in FIGS. 1A-1B may be used to perform the flow cytometry investigation. Performance of the flow cytometry investigation may involve directing the sample fluid through a flow cell in which the sample fluid is subjected to an excitation light from at least one light source, and detecting separately response light in at least two different wavelength ranges emitted from the sample fluid in the flow cell. In this regard, the sample fluid may be directed through a flow cell unit 208 of a flow cytometer internal assembly 180 such as depicted in FIGS. 2A-2B

with the laser unit 206 light source providing the excitation light to the flow cell unit 208 via the mirror unit 214 and focusing lens 216 in the first optical path, and the detectors 212a, 212b separately detecting the response light emitted from the sample fluid and directed thereto from the flow cell unit 208 via focusing lens unit 218, the spatial lens unit 220, and the dichroic mirror 210.

[0021] Step 310 may be undertaken at various times in relation to one or more other steps of the method 300. For example, in some implementations, step 310 may be undertaken immediately prior to undertaking other steps of the method 300, in some implementations, step 310 may be undertaken contemporaneously with undertaking one or more other steps of the method 300, and, in some implementations, step 310 may be undertaken well in advance of undertaking other steps of the method 300.

[0022] In step 320, flow cytometry response data resulting from the flow cytometry investigation is received. In this regard, the flow cytometry response data may be received from the optical detector(s) 212a, 212b of the flow cytometry internal assembly 180 at a processor (not shown in FIGS. 2A-2B) that may be included within a flow cytometer such as depicted in FIGS. 1A-1B and/or at a processor that is part of a separate computer system that is in communication (e.g. via a wired connection such a universal serial bus connection, a parallel port connection, an Ethernet connection or the like or a wireless connection such as a WiFi data connection, a cellular data connection, or the like).

[0023] The flow cytometry response data may comprise one or more time series signal data traces. Each time series signal data trace may comprise a plurality of data points corresponding with detection during the flow cytometry investigation of light from the sample fluid in a wavelength range that is indicative of the presence of a particle attribute in the sample fluid. In one implementation, there may be first and second times series signal data traces, with the first time series signal data trace comprising a first plurality of data points corresponding with detection during the flow cytometry investigation of first light from the sample fluid in a first wavelength range that is indicative of the presence of a first particle attribute in the sample fluid and the second time series signal data trace comprising a second plurality of data points corresponding with detection during the flow cytometry investigation of second light from the sample fluid in a second wavelength range that is indicative of the presence of a second particle attribute in the sample fluid. In this regard, the first particle attribute may comprise presence of nucleic acid and the second particle attribute may comprise presence of protein. Thus, the first time series signal data trace may be referred to herein as the nucleic acid channel or N-channel and the second time series signal data trace may be referred to herein as the protein channel or P-channel. The first light may comprise light in the first wavelength range that is a fluorescent emission of a first fluorescent stain, and the second light may comprise light in a second wavelength range that is a fluorescent emis-

sion of a second fluorescent stain.

[0024] In step 330, cross-talk is removed from the first and second time series signal data traces. In one implementation, the removal of cross-talk may proceed in accordance with steps 332, 334 and 336, and, as depicted in FIG. 3, the step 330 of removing cross-talk may be undertaken prior to proceeding with subsequent steps of method 300. In other implementations, all or some part of the step 330 of removing cross-talk (e.g., one or more of steps 332, 334, 336) may be undertaken contemporaneously with one or more subsequent steps of method 300 (e.g., contemporaneously with step 350 of separate batch processing of each batch of data points as described hereinbelow). Regardless of when the step 330 of cross-talk removal occurs, cross-talk removal generally involves reducing 332 the magnitude of each data point comprising the first time series signal data trace in accordance with a correlated percentage of a magnitude of the second time series signal data trace and reducing 334 the magnitude of each data point comprising the second time series signal data trace in accordance with a correlated percentage of a magnitude of the first time series signal data trace. The correlated percentage of the magnitude of the first time series signal data trace may comprise a first empirically derived cross-talk percentage, and the correlated percentage of the magnitude of the second time series signal data trace may comprise a second empirically derived cross-talk percentage.

[0025] Referring to FIG. 4, one manner of deriving 336 the respective first and second cross-talk percentages may, for example, involve processing a single-stain sample fluid appropriate for nucleic acid detection through a flow cytometer instrument to obtain N-channel data, and also processing a single-stain sample fluid appropriate for protein detection through a flow cytometer instrument to obtain P-channel data. As depicted in the scatter plot 400 of FIG. 4, peak heights for the N-channel data may then be plotted versus peak heights for the P-channel data, and respective N-channel and P-channel best fit lines 410, 420 through the origin may be calculated from the N-channel peak height and P-channel peak height data. The slope of the N-channel best fit line 410 yields the ratio of peak heights and thus the N-to-P cross-talk percentage (3.16% for the exemplary data plotted in FIG. 4), and the slope of the P-channel best fit line 420 yields the ratio of peak heights and thus the P-to-N cross-talk percentage (15.9% for the exemplary data plotted in FIG. 4). The step 336 of deriving the cross-talk percentages may take place prior to the steps 332, 334 of reducing the magnitudes of the data points comprising the first and second times series signal data traces. In this regard, the cross-talk percentage derivation step 336 may be undertaken for a particular model instrument intended for investigating a particular category of particle (e.g. a flu virus) so that the respective cross-talk percentages can be provided as a parameter that may be included within such models of flow cytometer instrument at the time of manufacture or entered by a user prior to use of the in-

strument in the field.

[0026] FIG. 5A depicts an exemplary corrected N-channel signal data trace 502 in which cross-talk has been removed using a N-to-P cross-talk correction percentage of 5%. In this regard, the N-to-P cross-talk percentage may be derived in a manner such as described herein in connection with FIG. 4 using a purified influenza A virus particle sample fluid having a single stain appropriate for nucleic acid detection.

[0027] FIG. 5B depicts an exemplary corrected P-channel signal data trace 504 in which cross-talk has been removed using a P-to-N cross-talk correction percentage of 26%. In this regard, the P-to-N cross-talk percentage may be derived in a manner such as described herein in connection with FIG. 4 using a purified influenza A virus particle sample fluid having a single stain appropriate for protein detection.

[0028] Referring again to FIG. 3, in step 340 of method 300, one or more batches of data points are selected from the response data for subsequent batch processing. In an implementation where there are first and second time series signal data traces included in the response data, successive batches of data points that correspond in time (e.g., batches that represent the same time interval of their respective trace) may be selected from among the first plurality of data points comprising the first time series signal data trace and the second plurality of data points comprising the second time series signal data trace. More than one batch of data points may be selected from each time series signal data trace for subsequent batch processing, with each batch of data points that is selected from a plurality of data points comprising a particular trace being selected from a different time interval of its respective trace. In selecting the batch(es) of data points, a predetermined number of data points may be chosen from each plurality of data points comprising a time series signal data trace. The predetermined number of data points is chosen to provide a window of the respective time series signal data trace from which the data points are selected having a time period over which baseline drift is limited. In this regard, it has been found that a predetermined number of about 10,000 data points may be appropriate.

[0029] In step 350, each batch of data points is separately processed. In one implementation, the separate batch processing of each batch of data points may proceed in accordance with steps 352, 354, 356 and 358. In step 352, a batch-specific noise characteristic is determined for the batch of data points. In step 354, a batch-specific signal peak threshold is determined for the batch of data points as a function of the batch-specific noise characteristic. In step 356, signal peaks in the batch of data points indicative of the presence of a particle attribute in the sample fluid are identified using threshold criteria including the batch-specific signal peak threshold. In step 358, an assessment is made as to whether the identified signal peaks within the batch of data points are anomalous. An anomalous peak may, for example,

be one with a height that exceeds the batch-specific signal peak threshold by too much as well one that is either too wide or too narrow when compared with appropriate maximum and minimum peak width filters.

[0030] Step 352 in which a batch-specific noise characteristic is determined for the batch of data points may involve determining an asymmetric Gaussian distribution fit to a portion of a histogram of the data points of the batch. In this regard, the portion of the histogram asymmetrically excludes high magnitude data points relative to low magnitude data points. In one implementation, the portion of the histogram may include data points of magnitude up to an added increment above a base magnitude corresponding with an identified maximum for the histogram and may exclude data points of magnitude larger than the added increment above the base magnitude. Further, the portion of the histogram may include data points of magnitude down to a subtracted increment below the base magnitude and may exclude data points smaller than the subtracted increment below the base magnitude, with the added increment being smaller than the subtracted increment. To further provide desired asymmetry, the subtracted increment may be at least two times as larger or more than the added increment.

[0031] In one implementation, the subtracted increment may be no smaller than three times a unit increment that is equal to a magnitude difference between the base magnitude and a half-magnitude that is smaller than the base magnitude and corresponds with a half number frequency on the histogram relative to a number frequency of the base magnitude. The base magnitude may, for example, correspond to a mean value μ of the data points of the distribution, the magnitude difference between the base magnitude and the half magnitude may correspond to a standard deviation of the data points of the distribution, and the added and subtracted increments may, for example, be based on the standard deviation σ of the data points of the distribution. In one implementation, the added increment may be 1σ and the subtracted increment may be 5σ .

[0032] Additionally, the histogram may comprise a series of data bins, with each data bin containing all data points in the batch within a fixed range of magnitudes. In this regard, the base magnitude may correspond with a magnitude within the range of the bin that includes a maximum number frequency of data points of all the bins, the data points may have a magnitude expressed in volts and the range of each bin may be no larger than 0.03 volts. In one implementation, the series of data bins may include at least one-hundred of the data bins.

[0033] Step 354 in which a batch-specific signal peak threshold is determined as a function of the batch-specific noise characteristic may involve setting the signal peak threshold based on the mean μ of the asymmetric Gaussian distribution fit plus an increment. For example, the batch-specific signal peak threshold may be set to be the greater of the mean μ of the asymmetric Gaussian distribution fit plus three times the standard deviation σ of

the asymmetric Gaussian distribution fit or the mean μ of the asymmetric Gaussian distribution fit plus 0.05V, whichever is greater (e.g., signal peak threshold is no smaller than $\mu + 3\sigma$ or $\mu + 0.05V$). Additionally, in one specific implementation, the batch-specific signal peak threshold may be set to be the greater of the mean μ of the asymmetric Gaussian distribution fit plus five times the standard deviation σ of the asymmetric Gaussian distribution fit or the mean μ of the asymmetric Gaussian distribution fit plus 0.1V, whichever is greater (e.g., signal peak threshold is no smaller than $\mu + 5\sigma$ or $\mu + 0.1V$). Basing the batch-specific signal peak threshold on the mean μ of the asymmetric Gaussian distribution fit plus a fixed voltage may be applied where the standard deviation σ of the asymmetric Gaussian distribution fit is particularly small and would lead to a signal peak threshold that would eliminate most, if not all, signal peaks if the signal peak threshold is based upon mean μ plus some multiple of the standard deviation σ of the asymmetric Gaussian distribution fit.

[0034] By way of example, FIG. 6A shows a representative batch of 10,000 data points from the nucleic acid channel trace 602 and the protein channel trace 604 plotted versus time. Respective signal peak thresholds 612, 614 for the nucleic acid channel trace 602 and the protein channel trace 604 are indicated by the horizontal dashed lines, with the signal peak threshold 612 for the nucleic acid channel trace 602 being slightly lower than the signal peak threshold 614 for the protein channel trace 604 in the illustrated example. In other situations, the nucleic acid channel trace 602 signal peak threshold 612 may be slightly or significantly more than the protein channel trace 604 signal peak threshold 614 or the nucleic acid channel trace 602 signal peak threshold 612 may significantly less than the protein channel trace 604 signal peak threshold 614. A clipping threshold 616 is shown by the horizontal line at 9.5V. The clipping threshold may be used to identify peaks that are anomalous because their height exceeds the applicable signal peak threshold 612, 614 by too much. Three signal peaks 622A-622C are marked by circles in the nucleic acid channel trace 602 that correspond in time with three signal peaks 624A-624C marked by circles in the protein channel trace 604. A single clipped peak 626 in the protein channel 604 is also shown.

[0035] FIG. 6B shows a histogram 630 for a time series signal data trace such as the nucleic acid channel trace 602 of FIG. 6A, showing a clear normally distributed noise peak 640. The asymmetric Gaussian distribution fit is also shown referenced by numeral 642, and integer multiples of the standard deviation σ away from the mean μ are indicated by the vertical dashed lines. As depicted, less than the entire range of the histogram 600 has been used in computing the asymmetric Gaussian distribution fit 642. In this regard, data points with a voltage below a subtracted increment from the mean μ (e.g., below $\mu - 5\sigma$) and above an added increment from the mean μ (e.g., above $\mu + 1\sigma$) have been excluded in computing

the asymmetric Gaussian distribution fit 642.

[0036] Referring again to FIG. 3, in step 356, signal peaks are identified in each batch of data points. The signal peaks may be identified by comparing the voltage values of the data points in each batch with the appropriate signal peak threshold for such batch. For example, the data points in the nucleic acid channel trace 602 may be compared with the batch-specific signal peak threshold 612 for the nucleic acid channel trace 602 with consecutive points exceeding the batch-specific signal peak threshold 612 being considered to comprise a signal peak in the nucleic acid channel trace 602 indicative of the presence of a particular nucleic acid particle in the sample fluid. Likewise, the data points in the protein channel trace 604 may be compared with the batch-specific signal peak threshold 614 for the protein channel trace 604 with consecutive points exceeding the batch-specific signal peak threshold 614 being considered to comprise a signal peak in the protein channel trace 604 indicative of the presence of a particular protein particle in the sample fluid.

[0037] In step 358 of the method 300, an assessment is made as to whether or not an identified peak is an anomalous peak. In one implementation of the method 300, step 358 may not be included in which case no assessment is made as to whether any of the identified peaks are anomalous. In implementations of the method 300 including step 358, each data point comprising an identified peak in the batches of data points is compared with an anomaly threshold. One example of an anomaly threshold is the clipping threshold 616 shown in FIG. 6A. Other examples of anomaly thresholds include minimum and maximum peak widths. If the data point(s) comprising an identified peak exceed the anomaly threshold, such identified peak is considered to be anomalous (e.g., considered a clipped peak where the anomaly threshold is a clipping threshold). Anomalous peaks may be rejected as peaks considered indicative of the presence of a particle attribute and excluded from further consideration in the method 300. For example, each of the corresponding in time signal peaks 622A-622C, 624A-624C depicted in FIG. 6A are considered signal peaks because they exceed their respective nucleic acid channel trace 602 and protein channel trace 604 signal peak thresholds 612, 614 without exceed the clipping threshold 616; whereas, the clipped peak 626 is considered anomalous because it also exceeds the clipping threshold 616 in addition to the signal peak threshold 614 for the protein channel trace 604.

[0038] In step 370, a comparison is made between times of occurrence of non-anomalous identified signal peaks in the separately batch-processed batches of data points from the first signal data trace and the second signal data trace over the same time interval. In step 372, the non-anomalous signal peaks that coincide in time may be recorded as the presence of a target particle in the sample fluid. For example, each of the corresponding in time signal peaks 622A-622C, 624A-624C depicted in

FIG. 6A may be recorded as the presence of a target particle (e.g., an influenza virus) since non-anomalous signal peaks indicating the presence of a first particle attribute (e.g., a nucleic acid) and a second particle attribute (e.g. a protein) in the sample fluid have temporal coincidence.

[0039] In step 374, for each batch of data points that is separately batch processed in step 350, an update is made to a set of collective statistics for the time series signal data trace(s). The collective statistics that are updated include characteristics of the identified signal peaks from multiple batches. For example, the characteristics of the identified signal peaks may comprise one or more of a start point associated with an identified peak, an end point associated with an identified peak, a width of an identified peak, a maximum value of an identified peak, a time of the maximum value of an identified peak, an indicator of whether an identified peak was anomalous, and a count of the number of coinciding in time signal peaks recorded as the presence of the target particle.

[0040] In step 380, a concentration of the target particle may be calculated based on the collective statistics (e.g., the updated count of the number of coinciding in time signal peaks recorded as the presence of the target particle) and a measured flow rate of the sample fluid to the flow cell. In this regard, when conducting the flow cytometry investigation, the flow rate of sample fluid through the flow cell may be maintained at or below a desired maximum flow rate in order to help facilitate the accurate identification of target particles in accordance with the method 300. Although other maximum flow rates may be appropriate, in one implementation the maximum flow rate may be 1000 nanoliters/minute.

[0041] In step 382, results of the flow cytometry investigation may be displayed. In this regard, the results may include the calculated concentration of the target particle. The results that are displayed may also include the collected statistics. In one implementation, the results may be displayed contemporaneous to the flow cytometry investigation (e.g., by displaying the results on a display screen of the flow cytometer instrument and/or a display of a computer system interfaced with the flow cytometer instrument).

[0042] FIG. 7 is a block diagram representation of one embodiment of a flow cytometer system 700. The flow cytometer system 700 includes flow cytometer instrument 710, a processor 720, a memory 730 and a display device 740. The flow cytometer instrument 710 may, for example, comprise a flow cytometer instrument 100 having a flow cytometer internal assembly 180 within an enclosure 102 such as depicted and described in connection with FIGS. 1A-1B and 2A-2B. Regardless of its configuration, the flow cytometer instrument 710 is operable to output flow cytometry investigation response data 750, where the response data 750 comprises one or more time series signal data traces corresponding with detection during the flow cytometry investigation of light from

the sample fluid in one or more wavelength ranges indicative of the presence of one or more particle attributes in a sample fluid being undergoing flow cytometry investigation. The response data 750 may be stored in the memory 730. The processor 720 is operable to receive the flow cytometry response data 750 output by the flow cytometer instrument 710. In this regard, the processor 720 may receive the response data 750 directly from the flow cytometer instrument 710 as it is output and/or from the memory 730 where the response data 750 has been stored. The processor 720 is operable to process the response data 750 to evaluate particle attributes in the sample fluid (e.g., to identify the presence of nucleic acid and protein attributes indicative of a target particle such as an influenza virus). The processor 720 may process the response data 750 by performing one or more of the steps of a method 300 such as depicted and described in connection with FIG. 3. In this regard, the processor may comprise a general purpose microprocessor, and computer executable program code 760 may be stored on the memory 730 and executed by the processor 720 to accomplish processing of the response data 750. It may also be possible for the processor 720 to comprise one or more application specific integrated circuits (ASICs) and/or field programmable gate arrays (FPGAs) in combination with a general purpose microprocessor that together accomplish processing of the response data 750 or one or more ASICs and/or FPGAs without a general purpose microprocessor that accomplish processing of the response data 750. Results 770 of the processing of the response data 750 accomplished by the processor 720 may be displayed on the display device 740. The results 770 may be displayed as the flow cytometry investigation is ongoing and/or after it is completed. The results 770 may also be stored in the memory 730 and/or on a non-volatile data storage device 780 (e.g. a hard disc, an optical disc, a flash memory, etc.) that may be included in the flow cytometry system 700. In addition to storing the results 770, the non-volatile data storage device may also store the response data 750 (e.g., in raw and cross-talk corrected forms) and/or the computer executable program code 760. In one implementation such as depicted, the processor 720, memory 730, display device 740 and data storage device 780 comprise a computer system 790 separate from the flow cytometer instrument 710 and interfaced therewith for communication therebetween. In this regard, the computer system 790 may, for example, comprise a laptop, desktop, notebook, or touch pad computing device, and may have additional components not depicted such as a keyboard, mouse and/or touch screen/pad input device. In other implementations, one or more of the processor 720, memory 730, display device 740, and data storage device 780 may be incorporated within the flow cytometer instrument 710.

[0043] Deviations may be made from the specific embodiments disclosed in the specification without departing from the scope of the invention. For example, at least some of the functionalities performed by many of the

processes, devices and modules etc. discussed herein may be performed by other modules, devices, processes, etc. The illustrations and discussion herein has only been provided to assist the reader in understanding the various aspects of the present disclosure.

[0044] Furthermore, the various utilities disclosed herein (e.g., the method of evaluating particle attributes in a sample fluid subjected to flow cytometry investigation in a flow cytometer instrument) are not limited to being used in the context of the specific flow cytometer instrument described herein.

[0045] A computer program (also known as a program, software, software application, script, or code) used to provide the functionality described herein (such as to provide one or more steps of the method of evaluating particle attributes in a sample fluid subjected to flow cytometry investigation in a flow cytometer instrument) may be written in any form of programming language, including compiled or interpreted languages, and may be deployed in any form, including as a stand-alone program or as a module, component, subroutine, or other unit suitable for use in a computing environment. A computer program does not necessarily correspond to a file in a file system. A program can be stored in a portion of a file that holds other programs or data (e.g., one or more scripts stored in a markup language document), in a single file dedicated to the program in question, or in multiple coordinated files (e.g., files that store one or more modules, sub-programs, or portions of code). A computer program can be deployed to be executed on one computer or on multiple computers that are located at one site or distributed across multiple sites and interconnected by an information flow network.

[0046] The block diagrams, processes, protocols and logic flows described in this specification can be performed by one or more programmable processors executing one or more computer programs to perform functions by operating on input data and generating output. The processes and logic flows can also be performed by, and apparatus can also be implemented as, special purpose logic circuitry, e.g., an FPGA (field programmable gate array) or an ASIC (application-specific integrated circuit). Processors suitable for the execution of a computer program include, by way of example, both general and special purpose microprocessors, and any one or more processors of any kind of digital computer. Generally, a processor will receive instructions and data from a read-only memory or a random access memory or both. Generally, the elements of a computer are a processor for performing instructions and one or more memory devices for storing instructions and data. The techniques described herein may be implemented by a computer system configured to provide the functionality described.

[0047] While this disclosure contains many specifics, these should not be construed as limitations on the scope of the disclosure or of what may be claimed, but rather as descriptions of features specific to particular embodiments of the disclosure. Certain features that are de-

scribed in this specification in the context of separate embodiments and/or arrangements can also be implemented in combination in a single embodiment. Conversely, various features that are described in the context of a single embodiment can also be implemented in multiple embodiments separately or in any suitable subcombination, within the scope of the appended claims.

[0048] Additionally, the foregoing description of the present invention has been presented for purposes of illustration and description. Furthermore, the description is not intended to limit the invention to the form disclosed herein. Consequently, variations and modifications commensurate with the above teachings, and the scope of the invention is defined by the claims.

Claims

1. A flow cytometer system comprising:

a flow cytometer instrument operable to output flow cytometry investigation response data, the response data comprising a time series signal data trace corresponding with detection during the flow cytometry investigation of light from the sample fluid in a wavelength range that is indicative of the presence of a particle attribute in the sample fluid; and

a processor operable to receive the flow cytometry response data output by the flow cytometer instrument, the processor being further operable to separately batch process a plurality of different time interval batches of data points of the time series signal data trace to:

determine a batch-specific noise characteristic for said batch of data points;
determine a batch-specific signal peak threshold for said batch of data points as a function of the batch-specific noise characteristic; and
identify signal peaks in said batch of data points indicative of the presence of the particle attribute in the sample fluid using threshold criteria including the batch-specific signal peak threshold.

2. A system according to Claim 1, wherein:

the time series signal data trace comprises a first time series signal data trace, the particle attribute comprises a first particle attribute and the light comprises first light from the sample fluid in a first wavelength range that is indicative of the presence of the first particle attribute; the response data further comprises a second time series signal data trace corresponding with detection during the flow cytometry investigation

of light from the sample fluid in a second wavelength range that is indicative of the presence of a second particle attribute in the sample fluid; and

the processor is further operable to separately batch process a plurality of different time interval batches of data points of the second time series signal data trace, wherein time intervals of each successive batch of data points of the second time series signal data trace correspond in time with time intervals of each successive batch of data points of the first time series signal data trace, and wherein said processor separately batch processes the plurality of different time interval batches of data points of the second time series signal data trace to:

determine a batch-specific noise characteristic for said batch of data points of the second time series signal data trace;
determine a batch-specific signal peak threshold for said batch of data points of the second time series signal data trace as a function of the batch-specific noise characteristic for said batch of data points of the second time series signal data trace; and
identify signal peaks in said batch of data points of the second time series signal data trace indicative of the presence of the second particle attribute in the sample fluid using threshold criteria including the batch-specific signal peak threshold.

3. A system according to Claim 2, wherein said first particle attribute comprises presence of nucleic acid and the second particle attribute comprises presence of protein; and, wherein said processor is further operable to:

compare times of occurrence of the identified signal peaks in said separately batch-processed batches of data points of the first and the second time series signal data traces; and,
record as the presence of a target particle a temporal coincidence of identified signal peaks in the batches of data points of the first and the second time series signal data traces.

4. A system according to any one of Claims 2-3, wherein the first light comprises light in a first wavelength range that is a fluorescent emission of a first fluorescent stain, wherein the second light comprises light in a second wavelength range that is a fluorescent emission of a second fluorescent stain, and wherein said processor is further operable to:

remove cross-talk from data points of a said batch, wherein said processor is operable to re-

move said cross-talk contemporaneously with said separate batch processing of the said batch or to remove said cross-talk prior to said separate batch processing of the said batch; and, in the case of the said batch being data points of the first time series signal data trace, remove from data points comprising the said batch a correlated percentage of a magnitude of the second time series signal data trace; and in the case of the said batch being data points of the second time series signal data trace, remove from data points comprising the said batch a correlated percentage of a magnitude of the first time series signal data trace, wherein the correlated percentage of the first time series signal data trace comprises a first empirically derived cross-talk percentage associated with a particular model of flow cytometer instrument intended for investigating a particular category of particle, and wherein the correlated percentage of the second time series signal data trace comprises a second empirically derived cross-talk percentage associated with a particular model of flow cytometer instrument intended for investigating the particular category of particle.

- 5. A system according to any one of Claims 1-4, wherein said processor is further operable in said batch processing to:

update a set of collective statistics for the time series signal data trace including characteristics of the identified signal peaks from multiple batches.

- 6. A system according to Claim 5, wherein the characteristics of the identified signal peaks comprise one or more of a start point associated with an identified peak, an end point associated with an identified peak, a width of an identified peak, a maximum value of an identified peak, a time of the maximum value of an identified peak, and an indicator of whether an identified peak was anomalous.

- 7. A system according to any one of Claims 1-6, wherein said processor is further operable in said batch processing to:

assess whether an identified peak is an anomalous peak; and reject anomalous peaks as peaks indicative of presence of the particle attribute; wherein said processor is operable to assess whether an identified peak is an anomalous peak by, for each data point above the batch-specific signal peak threshold, comparing a value of the data point with an anomaly threshold that is greater than the batch-specific signal

peak threshold, wherein data points having values above the anomaly threshold are considered to comprise an anomalous peak.

- 8. A system according to any one of Claims 1-7, wherein to determine a batch-specific noise said processor is operable to:

determine an asymmetric Gaussian distribution fit to a portion of a histogram of the data points of the batch, wherein the portion of the histogram asymmetrically excludes high magnitude data points relative to low magnitude data points.

- 9. A system according to Claim 8, wherein:

the portion of the histogram includes data points of magnitude up to an added increment above a base magnitude corresponding with an identified maximum for the histogram and excludes data points of magnitude larger than the added increment above the base magnitude; the portion of the histogram includes data points of magnitude down to a subtracted increment below the base magnitude and excludes data points smaller than the subtracted increment below the base magnitude; and the added increment is smaller than the subtracted increment.

- 10. A system according to Claim 9, wherein the subtracted increment is at least two times as large as the added increment,

wherein the subtracted increment is no smaller than three times a unit increment that is equal to a magnitude difference between the base magnitude and a half-magnitude that is smaller than the base magnitude and corresponds with a half number frequency on the histogram relative to a number frequency of the base magnitude, and

wherein the histogram comprises a series of data bins, wherein each said data bin contains all data points in the batch within a fixed range of magnitudes and the base magnitude corresponds with a magnitude within the range of a said bin that includes a maximum number frequency of data points of all said bins.

- 11. A system according to any one of Claims 8-10, wherein the batch-specific signal peak threshold is not smaller than the mean of the asymmetric Gaussian distribution fit plus three times the standard deviation of the asymmetric Gaussian distribution fit.

- 12. A system according to any one of Claims 1-11, wherein the flow cytometer instrument further comprises:

a flow cell;

at least one light source;
 a fluid pressurizing device operable to pressurize the sample fluid to direct the sample fluid through the flow cell where the sample fluid is subjected to an excitation light from said at least one light source; and
 one or more photodetectors operable to separately detect at least two different response light wavelengths emitted from the sample fluid in the flow cell.

13. A system according to any one of Claims 1-12, wherein said processor is operable to perform said batch processing contemporaneous to investigation of the sample fluid in the flow cell, further comprising a display device, wherein said processor is further operable to display results of said batch processing on said display device contemporaneous to investigation of the sample fluid in the flow cell, and wherein the results include a concentration of particles calculated using collective statistics and a measured flow rate of the sample fluid in the flow cell.

14. A method of evaluating particle attributes in a sample fluid subjected to flow cytometry investigation in a flow cytometer instrument, the method comprising: processing flow cytometry investigation response data generated by the flow cytometer instrument, the response data comprising a time series signal data trace corresponding with detection during the flow cytometry investigation of light from the sample fluid in a wavelength range that is indicative of the presence of a particle attribute in the sample fluid, the processing comprising separately batch processing a plurality of different time interval batches of data points of the time series signal data trace, said batch processing of each said batch of data points comprising:

determining a batch-specific noise characteristic for said batch of data points;
 determining a batch-specific signal peak threshold for said batch of data points as a function of the batch-specific noise characteristic; and
 identifying signal peaks in said batch of data points indicative of the presence of the particle attribute in the sample fluid using threshold criteria including the batch-specific signal peak threshold.

15. A method according to Claim 14, wherein:
 the time series signal data trace comprises a first time series signal data trace, the particle attribute comprises a first particle attribute and the light comprises first light from the sample fluid in a first wavelength range that is indicative of the presence of the first particle attribute;

the response data further comprises a second time series signal data trace corresponding with detection during the flow cytometry investigation of second light from the sample fluid in a second wavelength range that is indicative of the presence of a second particle attribute in the sample fluid; and
 the method further comprises:
 separately batch processing a plurality of different time interval batches of data points of the second time series signal data trace, wherein time intervals of each successive batch of data points of the second time series signal data trace correspond in time with time intervals of each successive batch of data points of said first time series signal data trace, said batch processing of each said batch of data points of the second time series signal data trace comprising:

determining a batch-specific noise characteristic for said batch of data points of the second time series signal data trace;
 determining a batch-specific signal peak threshold for said batch of data points of the second time series signal data trace as a function of the batch-specific noise characteristic for said batch of data points of the second time series signal data trace; and
 identifying signal peaks in said batch of data points of the second time series signal data trace indicative of the presence of the second particle attribute in the sample fluid using threshold criteria including the batch-specific signal peak threshold.

16. A method according to Claim 14 or Claim 15, wherein said batch processing further comprises:
 updating a set of collective statistics for the time series signal data trace including characteristics of the identified signal peaks from multiple batches, wherein the characteristics of the identified signal peaks comprise one or more of a start point associated with an identified peak, an end point associated with an identified peak, a width of an identified peak, a maximum value of an identified peak, a time of the maximum value of an identified peak, and an indicator of whether an identified peak was anomalous.

17. A method according to any one of Claims 14-16, wherein said determining a batch-specific noise characteristic comprises:
 determining an asymmetric Gaussian distribution fit to a portion of a histogram of the data points of the batch, wherein the portion of the histogram asymmetrically excludes high magnitude data points relative to low magnitude data points, and wherein:

the portion of the histogram includes data points

of magnitude up to an added increment above a base magnitude corresponding with an identified maximum for the histogram and excludes data points of magnitude larger than the added increment above the base magnitude; the portion of the histogram includes data points of magnitude down to a subtracted increment below the base magnitude and excludes data points smaller than the subtracted increment below the base magnitude; and the added increment is smaller than the subtracted increment, wherein the subtracted increment is at least two times as large as the added increment.

18. A method according to any one of Claims 14-17, wherein the flow cytometer instrument is the flow cytometer system of either Claim 12 or Claim 13 and the method comprises flowing the sample fluid through the flow cell and subjecting the sample fluid to the excitation light.

Patentansprüche

1. Durchflusszytometersystem umfassend:

ein Durchflusszytometer zum Ausgeben von Antwortdaten einer Durchflusszytometrie-Untersuchung, wobei die Antwortdaten eine Zeitreihen-Signaldatenspur umfassen, die mit dem Nachweis bei der Durchflusszytometrie-Untersuchung von Licht korrespondiert, das von der Probenflüssigkeit in einem Wellenlängenbereich ausgeht, der auf das Vorhandensein eines Partikelattributs in der Probenflüssigkeit hindeutet; und einen Prozessor zum Empfangen der von dem Durchflusszytometer ausgegebenen Antwortdaten der Durchflusszytometrie, wobei der Prozessor weiter dafür ausgelegt ist, eine Vielzahl von unterschiedlichen Zeitintervallstapeln mit Datenpunkten der Zeitreihen-Signaldatenspur separat stapelweise zu verarbeiten zum:

Bestimmen einer stapelspezifischen Rauschcharakteristik für den Stapel mit Datenpunkten;

Bestimmen eines stapelspezifischen Schwellenwerts der Signalspitze für den Stapel mit Datenpunkten als Funktion der stapelspezifischen Rauschcharakteristik; und

Identifizieren von Signalspitzen in dem Stapel mit Datenpunkten, die auf das Vorhandensein des Partikelattributs in der Probenflüssigkeit hindeuten, unter Verwendung von Schwellenwertkriterien, die den stapel-

spezifischen Schwellenwert der Signalspitze enthalten.

2. System nach Anspruch 1, wobei:

die Zeitreihen-Signaldatenspur eine erste Zeitreihen-Signaldatenspur umfasst, wobei das Partikelattribut ein erstes Partikelattribut umfasst und das Licht erstes Licht umfasst, das von der Probenflüssigkeit in einem ersten Wellenlängenbereich ausgeht, der auf das Vorhandensein des ersten Partikelattributs hindeutet; die Antwortdaten weiter eine zweite Zeitreihen-Signaldatenspur umfassen, die mit dem Nachweis bei der Durchflusszytometrie-Untersuchung von Licht korrespondiert, das von der Probenflüssigkeit in einem zweiten Wellenlängenbereich ausgeht, der auf das Vorhandensein eines zweiten Partikelattributs in der Probenflüssigkeit hindeutet; und

der Prozessor weiter dafür ausgelegt ist, eine Vielzahl von unterschiedlichen Zeitintervallstapeln mit Datenpunkten der zweiten Zeitreihen-Signaldatenspur separat stapelweise zu verarbeiten, wobei Zeitintervalle von jedem aufeinanderfolgenden Stapel mit Datenpunkten der zweiten Zeitreihen-Signaldatenspur zeitlich mit Zeitintervallen von jedem aufeinanderfolgenden Stapel mit Datenpunkte der ersten Zeitreihen-Signaldatenspur korrespondiert, und wobei der Prozessor die Vielzahl von unterschiedlichen Zeitintervallstapeln mit Datenpunkten der zweiten Zeitreihen-Signaldatenspur separat stapelweise verarbeitet zum:

Bestimmen einer stapelspezifischen Rauschcharakteristik für den Stapel mit Datenpunkten der zweiten Zeitreihen-Signaldatenspur;

Bestimmen eines stapelspezifischen Schwellenwerts der Signalspitze für den Stapel mit Datenpunkten der zweiten Zeitreihen-Signaldatenspur als Funktion der stapelspezifischen Rauschcharakteristik für den Stapel mit Datenpunkten der zweiten Zeitreihen-Signaldatenspur; und Identifizieren von Signalspitzen in dem Stapel mit Datenpunkten der zweiten Zeitreihen-Signaldatenspur, die auf das Vorhandensein des zweiten Partikelattributs in der Probenflüssigkeit hindeuten, unter Verwendung von Schwellenwertkriterien, die den stapelspezifischen Schwellenwert der Signalspitze enthalten.

3. System nach Anspruch 2, wobei das erste Partikelattribut das Vorhandensein von Nukleinsäure umfasst und das zweite Partikelattribut das Vorhan-

densein von Protein umfasst; und
wobei der Prozessor weiter ausgelegt ist zum:

Vergleichen der Zeitpunkte des Auftretens der identifizierten Signalspitzen in den separat stapelweise verarbeiteten Stapeln mit Datenpunkten der ersten und der zweiten Zeitreihen-Signaldatenspur; und
Aufzeichnen als Vorhandensein eines Zielpartikels einer zeitlichen Koinzidenz der identifizierten Signalspitzen in den Stapeln mit Datenpunkten der ersten und der zweiten Zeitreihen-Signaldatenspur.

4. System nach einem der Ansprüche 2 bis 3, wobei das erste Licht in einem ersten Wellenlängenbereich umfasst, welches eine Fluoreszenzemission eines ersten Fluoreszenzfarbstoffs ist, wobei das zweite Licht in einem zweiten Wellenlängenbereich umfasst, welches eine Fluoreszenzemission eines zweiten Fluoreszenzfarbstoffs ist, und wobei der Prozessor weiter ausgelegt ist zum:

Entfernen von Übersprechen aus Datenpunkten eines Stapels, wobei der Prozessor dafür ausgelegt ist, das Übersprechen gleichzeitig mit der separaten stapelweisen Verarbeitung des Stapels zu entfernen oder das Übersprechen vor der separaten stapelweisen Verarbeitung des Stapels zu entfernen; und
für den Fall, dass der Stapel Datenpunkte der ersten Zeitreihen-Signaldatenspur umfasst, aus den Datenpunkten, die den Stapel umfassen, einen korrelierten Prozentsatz einer Größe der zweiten Zeitreihen-Signaldatenspur zu entfernen; und
für den Fall, dass der Stapel Datenpunkte der zweiten Zeitreihen-Signaldatenspur umfasst, aus den Datenpunkten, die den Stapel umfassen, einen korrelierten Prozentsatz einer Größe der ersten Zeitreihen-Signaldatenspur zu entfernen, wobei der korrelierte Prozentsatz der ersten Zeitreihen-Signaldatenspur einen ersten empirisch abgeleiteten Prozentsatz für Übersprechen umfasst, der einem bestimmten Durchflussszytometermodell zugeordnet ist, das für die Untersuchung einer bestimmten Kategorie von Partikeln bestimmt ist, und wobei der korrelierte Prozentsatz der zweiten Zeitreihen-Signaldatenspur einen zweiten empirisch abgeleiteten Prozentsatz für Übersprechen umfasst, der einem bestimmten Durchflussszytometermodell zugeordnet ist, das für die Untersuchung der bestimmten Kategorie von Partikeln bestimmt ist.

5. System nach einem der Ansprüche 1 bis 4, wobei der Prozessor weiter ausgelegt ist, in der stapelwei-

sen Verarbeitung, zum:

Aktualisieren eines Satzes von kollektiven Statistiken für die Zeitreihen-Signaldatenspur einschließlich Eigenschaften der identifizierten Signalspitzen von mehreren Stapeln.

6. System nach Anspruch 5, wobei die Eigenschaften der identifizierten Signalspitzen einen oder mehrere umfassen von einem Startpunkt, der einer identifizierten Spitze zugeordnet ist, einem Endpunkt, der einer identifizierten Spitze zugeordnet ist, einer Breite einer identifizierten Spitze, einem Maximalwert einer identifizierten Spitze, einem Zeitpunkt des Maximalwerts einer identifizierten Spitze und einem Indikator, ob eine identifizierte Spitze anomal war.

7. System nach einem der Ansprüche 1 bis 6, wobei der Prozessor weiter ausgelegt ist, in der stapelweisen Verarbeitung, zum:

Beurteilen, ob eine identifizierte Spitze eine anomale Spitze ist; und

Ablehnen von anomalen Spitzen als Spitzen, die auf das Vorhandensein des Partikelattributs hindeuten;

wobei der Prozessor dafür ausgelegt ist zu beurteilen, ob eine identifizierte Spitze eine anomale Spitze ist, indem er für jeden Datenpunkt oberhalb des stapelspezifischen Schwellenwerts der Signalspitze einen Wert des Datenpunktes mit einem Anomalieschwellenwert vergleicht, der größer ist als der stapelspezifische Schwellenwert der Signalspitze, wobei Datenpunkte mit Werten oberhalb des Anomalieschwellenwerts als eine anomale Spitze umfassend angesehen werden.

8. System nach einem der Ansprüche 1 bis 7, wobei der Prozessor zum Bestimmen eines stapelspezifischen Rauschens ausgelegt ist zum:

Bestimmen einer asymmetrischen Gaußschen Verteilungsanpassung an einen Abschnitt eines Histogramms der Datenpunkte des Stapels, wobei der Abschnitt des Histogramms asymmetrisch Datenpunkte hoher Größe im Verhältnis zu Datenpunkten geringer Größe ausschließt.

9. System nach Anspruch 8, wobei:

der Abschnitt des Histogramms Datenpunkte einer Größe bis zu einem addierten Inkrement über einer Basisgröße umfasst, die einem identifizierten Maximum für das Histogramm entspricht, und Datenpunkte mit einer größeren Größe als das addierte Inkrement über der Basisgröße ausschließt;

der Abschnitt des Histogramms Datenpunkte einer Größe bis zu einem subtrahierten Inkrement

- unter der Basisgröße umfasst und Datenpunkte, die kleiner als das subtrahierte Inkrement unter der Basisgröße sind, ausschließt; und das addierte Inkrement kleiner ist als das subtrahierte Inkrement. 5
- 10.** System nach Anspruch 9, wobei das subtrahierte Inkrement mindestens zweimal so groß ist wie das addierte Inkrement, wobei das subtrahierte Inkrement nicht kleiner als das Dreifache eines Einheitsinkrements ist, das gleich einer Größendifferenz zwischen der Basisgröße und einer Halbgröße ist, die kleiner als die Basisgröße ist und einer halben Zahlenhäufigkeit auf dem Histogramm im Verhältnis zu einer Zahlenhäufigkeit der Basisgröße entspricht, und wobei das Histogramm eine Reihe von Datengruppen umfasst, wobei jede Datengruppe alle Datenpunkte in dem Stapel innerhalb eines festen Größensbereichs enthält und die Basisgröße einer Größe innerhalb des Bereichs einer Gruppe entspricht, die eine maximale Zahlenhäufigkeit von Datenpunkten aller Gruppen enthält. 10
- 11.** System nach einem der Ansprüche 8 bis 10, wobei der stapelspezifische Schwellenwert der Signalspitze nicht kleiner ist als der Mittelwert der asymmetrischen Gaußschen Verteilungsanpassung plus das Dreifache der Standardabweichung der asymmetrischen Gaußschen Verteilungsanpassung. 15
- 12.** System nach einem der Ansprüche 1 bis 11, wobei das Durchflusszytometer weiter umfasst:
- eine Durchfluss-Messzelle; 20
 - zumindest eine Lichtquelle; 25
 - eine Fluiddruckvorrichtung zum Beaufschlagen mit Druck der Probenflüssigkeit, um die Probenflüssigkeit durch die Durchfluss-Messzelle zu leiten, wo die Probenflüssigkeit einem Anregungslicht von der zumindest einen Lichtquelle ausgesetzt wird; und 30
 - einen oder mehrere Fotodetektoren zum separaten Erkennen von mindestens zwei unterschiedlichen Wellenlängen des Antwortlichts, das von der Probenflüssigkeit in der Durchfluss-Messzelle ausgesendet werden. 35
- 13.** System nach einem der Ansprüche 1 bis 12, wobei der Prozessor ausgelegt ist zum Durchführen der stapelweisen Verarbeitung gleichzeitig mit der Untersuchung der Probenflüssigkeit in der Durchfluss-Messzelle, das weiter eine Anzeigevorrichtung umfasst, wobei der Prozessor weiter ausgelegt ist zum Anzeigen von Ergebnissen der stapelweisen Verarbeitung auf der Anzeigevorrichtung gleichzeitig mit der Untersuchung der Probenflüssigkeit in der Durchfluss-Messzelle, und wobei die Ergebnisse ei-
- ne Konzentration von Partikeln enthalten, die unter Verwendung von kollektiven Statistiken und einer gemessenen Durchflussmenge der Probenflüssigkeit in der Durchfluss-Messzelle berechnet wird. 40
- 14.** Verfahren zum Auswerten von Partikelattributen in einer Probenflüssigkeit, die einer Durchflusszytometrie-Untersuchung in einem Durchflusszytometer unterzogen wird, wobei das Verfahren umfasst:
- Verarbeiten der Antwortdaten der Durchflusszytometrie-Untersuchung, welche von dem Durchflusszytometer erzeugt werden, wobei die Antwortdaten eine Zeitreihen-Signaldatenspur umfassen, die mit dem Nachweis bei der Durchflusszytometrie-Untersuchung von Licht korrespondiert, das von der Probenflüssigkeit in einem Wellenlängenbereich ausgeht, der auf das Vorhandensein eines Partikelattributs in der Probenflüssigkeit hindeutet, wobei die Verarbeitung die separate stapelweise Verarbeitung einer Vielzahl von unterschiedlichen Zeitintervallstapeln mit Datenpunkten der Zeitreihen-Signaldatenspur umfasst, wobei die stapelweise Verarbeitung von jedem der Stapel mit Datenpunkten umfasst: 45
 - Bestimmen einer stapelspezifischen Rauschcharakteristik für den Stapel mit Datenpunkten; 50
 - Bestimmen eines stapelspezifischen Schwellenwerts der Signalspitze für den Stapel mit Datenpunkten als Funktion der stapelspezifischen Rauschcharakteristik; 55
 - und
 - Identifizieren von Signalspitzen in dem Stapel mit Datenpunkten, die auf das Vorhandensein des Partikelattributs in der Probenflüssigkeit hindeuten, unter Verwendung von Schwellenwertkriterien, die den stapelspezifischen Schwellenwert der Signalspitze enthalten. 60
- 15.** Verfahren nach Anspruch 14, wobei:
- die Zeitreihen-Signaldatenspur eine erste Zeitreihen-Signaldatenspur umfasst, wobei das Partikelattribut ein erstes Partikelattribut umfasst und das Licht erstes Licht umfasst, das von der Probenflüssigkeit in einem ersten Wellenlängenbereich ausgeht, der auf das Vorhandensein des ersten Partikelattributs hindeutet; die Antwortdaten weiter eine zweite Zeitreihen-Signaldatenspur umfassen, die mit dem Nachweis bei der Durchflusszytometrie-Untersuchung von zweitem Licht korrespondiert, das von der Probenflüssigkeit in einem zweiten Wellenlängenbereich ausgeht, der auf das Vorhan-

densein eines zweiten Partikelattributs in der Probenflüssigkeit hindeutet; und wobei das Verfahren weiter umfasst: separaten stapelweises Verarbeiten einer Vielzahl von unterschiedlichen Zeitintervallstapeln mit Datenpunkten der zweiten Zeitreihen-Signaldatenspur, wobei Zeitintervalle von jedem aufeinanderfolgenden Stapel mit Datenpunkten der zweiten Zeitreihen-Signaldatenspur zeitlich mit Zeitintervallen von jedem aufeinanderfolgenden Stapel mit Datenpunkten der ersten Zeitreihen-Signaldatenspur korrespondieren, wobei das stapelweise Verarbeiten jedes Stapels mit Datenpunkten der zweiten Zeitreihen-Signaldatenspur umfasst:

Bestimmen einer stapelspezifischen Rauschcharakteristik für den Stapel mit Datenpunkten der zweiten Zeitreihen-Signaldatenspur;

Bestimmen eines stapelspezifischen Schwellenwerts der Signalspitze für den Stapel mit Datenpunkten der zweiten Zeitreihen-Signaldatenspur als Funktion der stapelspezifischen Rauschcharakteristik für den Stapel mit Datenpunkten der zweiten Zeitreihen-Signaldatenspur; und

Identifizieren von Signalspitzen in dem Stapel mit Datenpunkten der zweiten Zeitreihen-Signaldatenspur, die auf das Vorhandensein des zweiten Partikelattributs in der Probenflüssigkeit hindeuten, unter Verwendung von Schwellenwertkriterien, die den stapelspezifischen Schwellenwert der Signalspitze enthalten.

16. Verfahren nach Anspruch 14 oder Anspruch 15, wobei das stapelweise Verarbeiten weiter umfasst:

Aktualisieren eines Satzes von kollektiven Statistiken für die Zeitreihen-Signaldatenspur mit Eigenschaften der identifizierten Signalspitzen von mehreren Stapeln, wobei die Eigenschaften der identifizierten Signalspitzen einen oder mehrere umfassen von einem Startpunkt, der einer identifizierten Spitze zugeordnet ist, einem Endpunkt, der einer identifizierten Spitze zugeordnet ist, einer Breite einer identifizierten Spitze, einem Maximalwert einer identifizierten Spitze, einem Zeitpunkt des Maximalwerts einer identifizierten Spitze und einem Indikator, ob eine identifizierte Spitze anomal war.

17. Verfahren nach einem der Ansprüche 14 bis 16, wobei das Bestimmen einer stapelspezifischen Rauschcharakteristik umfasst:

Bestimmen einer asymmetrischen Gaußschen Verteilungsanpassung an einen Abschnitt eines Histogramms der Datenpunkte des Stapels, wobei der Abschnitt des Histogramms asymmetrisch Datenpunk-

te hoher Größe im Verhältnis zu Datenpunkten geringer Größe ausschließt, und wobei:

der Abschnitt des Histogramms Datenpunkte einer Größe bis zu einem addierten Inkrement über einer Basisgröße umfasst, die einem identifizierten Maximum für das Histogramm entspricht, und Datenpunkte mit einer größeren Größe als das addierte Inkrement über der Basisgröße ausschließt;

der Abschnitt des Histogramms Datenpunkte einer Größe bis zu einem subtrahierten Inkrement unter der Basisgröße umfasst und Datenpunkte, die kleiner als das subtrahierte Inkrement unter der Basisgröße sind, ausschließt; und das addierte Inkrement kleiner als das subtrahierte Inkrement ist, wobei das subtrahierte Inkrement mindestens zweimal so groß ist wie das addierte Inkrement.

18. Verfahren nach einem der Ansprüche 14 bis 17, wobei das Durchflusszytometer das Durchflusszytometersystem nach Anspruch 12 oder Anspruch 13 ist und das Verfahren das Durchfließen der Probenflüssigkeit durch die Durchfluss-Messzelle und das Bestrahlen der Probenflüssigkeit mit dem Anregungslicht umfasst.

Revendications

1. Système de cytomètre en flux comprenant :

un instrument de cytomètre en flux utilisable pour délivrer des données de réponse d'examen de cytométrie de flux, les données de réponse comprenant une trace de données de signal en série temporelle correspondant à la détection, lors de l'examen de cytométrie de flux, d'une lumière provenant du fluide échantillon dans une gamme de longueurs d'onde indiquant la présence d'un attribut de particule dans le fluide échantillon ; et

un processeur utilisable pour recevoir les données de réponse de cytométrie de flux délivrées par l'instrument de cytomètre en flux, le processeur étant en outre utilisable pour traiter séparément par lots une pluralité de lots d'intervalles de temps différents de points de données de la trace de données de signal en série temporelle pour :

déterminer une caractéristique de bruit spécifique au lot pour ledit lot de points de données ;

déterminer un seuil de crête de signal spécifique au lot pour ledit lot de points de données en fonction de la caractéristique de

bruit spécifique au lot ; et
 identifier des crêtes de signal dans ledit lot
 de points de données indiquant la présence
 de l'attribut de particule dans le fluide
 échantillon en utilisant des critères de seuil
 comportant le seuil de crête de signal spé-
 cifique au lot.

2. Système selon la revendication 1, dans lequel :

la trace de données de signal en série tempo-
 relle comprend une première trace de données
 de signal en série temporelle, l'attribut de parti-
 cule comprend un premier attribut de particule
 et la lumière comprend une première lumière
 provenant du fluide échantillon dans une pre-
 mière gamme de longueurs d'onde indiquant la
 présence du premier attribut de particule ;
 les données de réponse comprennent en outre
 une deuxième trace de données de signal en
 série temporelle correspondant à la détection,
 lors de l'examen de cytométrie de flux d'une lu-
 mière provenant du fluide échantillon dans une
 deuxième gamme de longueurs d'onde indi-
 quant la présence d'un deuxième attribut de parti-
 cule dans le fluide échantillon ; et
 le processeur est en outre utilisable pour traiter
 séparément par lots une pluralité de lots d'inter-
 valles de temps différents de points de données
 de la deuxième trace de données de signal en
 série temporelle, dans lequel des intervalles de
 temps de chaque lot successif de points de don-
 nées de la deuxième trace de données de signal
 en série temporelle correspondent dans le
 temps à des intervalles de temps de chaque lot
 successif de points de données de la première
 trace de données de signal en série temporelle,
 et dans lequel ledit processeur traite séparé-
 ment par lots la pluralité de lots d'intervalles de
 temps différents de points de données de la
 deuxième trace de données de signal en série
 temporelle pour :

déterminer une caractéristique de bruit spé-
 cifique au lot pour ledit lot de points de don-
 nées de la deuxième trace de données de
 signal en série temporelle ;
 déterminer un seuil de crête de signal spé-
 cifique au lot pour ledit lot de points de don-
 nées de la deuxième trace de données de
 signal en série temporelle en fonction de la
 caractéristique de bruit spécifique au lot
 pour ledit lot de points de données de la
 deuxième trace de données de signal en
 série temporelle ; et
 identifier des crêtes de signal dans ledit lot
 de points de données de la deuxième trace
 de données de signal en série temporelle

indiquant la présence du deuxième attribut
 de particule dans le fluide échantillon en uti-
 lisant des critères de seuil comportant le
 seuil de crête de signal spécifique au lot.

3. Système selon la revendication 2, dans lequel ledit
 premier attribut de particule comprend la présence
 d'un acide nucléique et le deuxième attribut de parti-
 cule comprend la présence d'une protéine ; et,
 dans lequel ledit processeur est en outre utilisable
 pour :

comparer les temps d'occurrence des crêtes de
 signal identifiées dans lesdits lots traités sépa-
 rément par lots de points de données des pre-
 mière et deuxième traces de données de signal
 en série temporelle ; et,
 enregistrer, comme présence d'une particule ci-
 ble, une coïncidence temporelle de crêtes de
 signal identifiées dans les lots de points de don-
 nées des première et deuxième traces de don-
 nées de signal en série temporelle.

4. Système selon l'une quelconque des revendications
 2 et 3, dans lequel la première lumière comprend
 une lumière dans une première gamme de longueurs
 d'onde qui est une émission fluorescente d'une pre-
 mière tache fluorescente, dans lequel la deuxième
 lumière comprend une lumière dans une deuxième
 gamme de longueurs d'onde qui est une émission
 fluorescente d'une deuxième tache fluorescente, et
 dans lequel ledit processeur est en outre utilisable
 pour :

supprimer une intermodulation de points de
 données dudit lot, dans lequel ledit processeur
 est utilisable pour supprimer ladite intermodula-
 tion en même temps que ledit traitement sépa-
 rément par lots dudit lot ou pour supprimer ladite
 intermodulation avant ledit traitement séparé-
 ment par lots dudit lot ; et,
 dans le cas où ledit lot est constitué de points
 de données de la première trace de données de
 signal en série temporelle, supprimer, de points
 de données comprenant ledit lot, un pourcenta-
 ge corrélé d'une amplitude de la deuxième trace
 de données de signal en série temporelle ; et
 dans le cas où ledit lot est constitué de points
 de données de la deuxième trace de données
 de signal en série temporelle, supprimer, de
 points de données comprenant ledit lot, un pour-
 centage corrélé d'une amplitude de la première
 trace de données de signal en série temporelle,
 dans lequel le pourcentage corrélé de la premiè-
 re trace de données de signal en série tempo-
 relle comprend un premier pourcentage d'inter-
 modulation dérivé empiriquement associé à un
 modèle particulier d'un instrument de cytomètre

- en flux destiné à examiner une catégorie particulière de particules, et dans lequel le pourcentage corrélé de la deuxième trace de données de signal en série temporelle comprend un deuxième pourcentage d'intermodulation dérivé empiriquement associé à un modèle particulier d'un instrument de cytomètre en flux destiné à examiner la catégorie particulière de particules. 5
5. Système selon l'une quelconque des revendications 1 à 4, dans lequel ledit processeur est en outre utilisable dans ledit traitement par lots pour : mettre à jour un ensemble de statistiques collectives pour la trace de données de signal en série temporelle comportant des caractéristiques des crêtes de signal identifiées provenant de lots multiples. 10 15
6. Système selon la revendication 5, dans lequel les caractéristiques des crêtes de signal identifiées comprennent un ou plusieurs parmi un point de départ associé à une crête identifiée, un point d'arrivée associé à une crête identifiée, une largeur d'une crête identifiée, une valeur maximale d'une crête identifiée, un temps de la valeur maximale d'une crête identifiée, et un indicateur permettant de savoir si une crête identifiée était anormale. 20 25
7. Système selon l'une quelconque des revendications 1 à 6, dans lequel ledit processeur est en outre utilisable dans ledit traitement par lots pour : 30
- évaluer si une crête identifiée est une crête anormale ; et
rejeter les crêtes anormales comme des crêtes indiquant la présence de l'attribut de particule ; dans lequel ledit processeur est utilisable pour évaluer si une crête identifiée est une crête anormale en comparant, pour chaque point de données au-dessus du seuil de crête de signal spécifique au lot, une valeur du point de données avec un seuil d'anomalie qui est supérieur au seuil de crête de signal spécifique au lot, dans lequel les points de données ayant des valeurs supérieures au seuil d'anomalie sont considérés comme comprenant une crête anormale. 35 40 45
8. Système selon l'une quelconque des revendications 1 à 7, dans lequel, pour déterminer un bruit spécifique au lot, ledit processeur est utilisable pour : déterminer un ajustement de distribution gaussienne asymétrique à une partie d'un histogramme des points de données du lot, dans lequel la partie de l'histogramme exclut asymétriquement des points de données à grande amplitude par rapport à des points de données à faible amplitude. 50 55
9. Système selon la revendication 8, dans lequel :
- la partie de l'histogramme inclut des points de données d'une amplitude vers le haut pour un incrément ajouté au-dessus d'une amplitude de base correspondant à un maximum identifié pour l'histogramme et exclut des points de données d'une amplitude supérieure à l'incrément ajouté au-dessus de l'amplitude de base ; la partie de l'histogramme inclut des points de données d'une amplitude vers le bas pour un incrément soustrait en dessous de l'amplitude de base et exclut des points de données inférieurs à l'incrément soustrait en dessous de l'amplitude de base ; et l'incrément ajouté est inférieur à l'incrément soustrait.
10. Système selon la revendication 9, dans lequel l'incrément soustrait est au moins deux fois plus important que l'incrément ajouté, dans lequel l'incrément soustrait n'est pas inférieur à trois fois un incrément unitaire qui est égal à une différence d'amplitude entre l'amplitude de base et une demi-amplitude qui est inférieure à l'amplitude de base et qui correspond à une fréquence de moitié de nombre sur l'histogramme par rapport à une fréquence de nombre de l'amplitude de base, et dans lequel l'histogramme comprend une série de cellules de données, dans lequel chacune desdites cellules de données contient tous les points de données du lot dans une gamme fixe d'amplitudes et l'amplitude de base correspond à une amplitude dans la gamme d'une desdites cellules qui comporte une fréquence maximale de nombre de points de données de toutes lesdites cellules.
11. Système selon l'une quelconque des revendications 8 à 10, dans lequel le seuil de crête de signal spécifique au lot n'est pas inférieur à la moyenne de l'ajustement de distribution gaussienne asymétrique plus trois fois l'écart-type de l'ajustement de distribution gaussienne asymétrique.
12. Système selon l'une quelconque des revendications 1 à 11, dans lequel l'instrument de cytomètre en flux comprend en outre :
- une cellule de flux ;
au moins une source de lumière ;
un dispositif de pressurisation de fluide utilisable pour pressuriser le fluide échantillon pour diriger le fluide échantillon à travers la cellule de flux où le fluide échantillon est soumis à une lumière d'excitation provenant de ladite au moins une source de lumière ; et
un ou plusieurs photodétecteurs utilisables pour détecter séparément au moins deux longueurs d'onde de lumière de réponse différentes émises par le fluide échantillon dans la cellule de

flux.

13. Système selon l'une quelconque des revendications 1 à 12, dans lequel ledit processeur est utilisable pour effectuer ledit traitement par lots en même temps que l'examen du fluide échantillon dans la cellule de flux, comprenant en outre un dispositif d'affichage, dans lequel ledit processeur est en outre utilisable pour afficher des résultats dudit traitement par lots sur ledit dispositif d'affichage en même temps que l'examen du fluide échantillon dans la cellule de flux, et dans lequel les résultats comportent une concentration de particules calculée en utilisant des statistiques collectives et un débit mesuré du fluide échantillon dans la cellule de flux.

14. Procédé d'évaluation d'attributs de particules dans un fluide échantillon soumis à un examen de cytométrie de flux dans un instrument de cytomètre en flux, le procédé comprenant :
le traitement de données de réponse d'examen de cytométrie de flux générées par l'instrument de cytomètre en flux, les données de réponse comprenant une trace de données de signal en série temporelle correspondant à la détection, lors de l'examen de cytométrie de flux d'une lumière provenant du fluide échantillon dans une gamme de longueurs d'onde indiquant la présence d'un attribut de particule dans le fluide échantillon, le traitement comprenant le traitement séparément par lots d'une pluralité de lots d'intervalles de temps différents de points de données de la trace de données de signal en série temporelle, ledit traitement par lots de chacun dudit lot de points de données comprenant :

la détermination d'une caractéristique de bruit spécifique au lot pour ledit lot de points de données ;

la détermination d'un seuil de crête de signal spécifique au lot pour ledit lot de points de données en fonction de la caractéristique de bruit spécifique au lot ; et

l'identification de crêtes de signal dans ledit lot de points de données indiquant la présence de l'attribut de particule dans le fluide échantillon en utilisant des critères de seuil comportant le seuil de crête de signal spécifique au lot.

15. Procédé selon la revendication 14, dans lequel :

la trace de données de signal en série temporelle comprend une première trace de données de signal en série temporelle, l'attribut de particule comprend un premier attribut de particule et la lumière comprend une première lumière provenant du fluide échantillon dans une première gamme de longueurs d'onde indiquant la présence du premier attribut de particule ;

les données de réponse comprennent en outre une deuxième trace de données de signal en série temporelle correspondant à la détection, lors de l'examen de cytométrie de flux d'une deuxième lumière provenant du fluide échantillon dans une deuxième gamme de longueurs d'onde indiquant la présence d'un deuxième attribut de particule dans le fluide échantillon ; et le procédé comprend en outre :

le traitement séparément par lots d'une pluralité de lots d'intervalles de temps différents de points de données de la deuxième trace de données de signal en série temporelle, dans lequel des intervalles de temps de chaque lot successif de points de données de la deuxième trace de données de signal en série temporelle correspondent dans le temps à des intervalles de temps de chaque lot successif de points de données de ladite première trace de données de signal en série temporelle, ledit traitement par lots de chacun dudit lot de points de données de la deuxième trace de données de signal en série temporelle comprenant :

la détermination d'une caractéristique de bruit spécifique au lot pour ledit lot de points de données de la deuxième trace de données de signal en série temporelle ;

la détermination d'un seuil de crête de signal spécifique au lot pour ledit lot de points de données de la deuxième trace de données de signal en série temporelle en fonction de la caractéristique de bruit spécifique au lot pour ledit lot de points de données de la deuxième trace de données de signal en série temporelle ; et

l'identification de crêtes de signal dans ledit lot de points de données de la deuxième trace de données de signal en série temporelle indiquant la présence du deuxième attribut de particule dans le fluide échantillon en utilisant des critères de seuil comportant le seuil de crête de signal spécifique au lot.

16. Procédé selon la revendication 14 ou la revendication 15, dans lequel ledit traitement par lots comprend en outre :

la mise à jour d'un ensemble de statistiques collectives pour la trace de données de signal en série temporelle comportant des caractéristiques des crêtes de signal identifiées provenant de lots multiples, dans lequel les caractéristiques des crêtes de signal identifiées comprennent un ou plusieurs parmi un point de départ associé à une crête identifiée, un point d'arrivée associé à une crête identifiée, une largeur d'une crête identifiée, une valeur maximale d'une crête identifiée, un temps de la valeur maximale d'une crête identifiée, et un indicateur permet-

tant de savoir si une crête identifiée était anormale.

17. Procédé selon l'une quelconque des revendications 14 à 16, dans lequel ladite détermination d'une caractéristique de bruit spécifique au lot comprend :
- 5
- la détermination d'un ajustement de distribution gaussienne asymétrique à une partie d'un histogramme des points de données du lot, dans lequel la partie de l'histogramme exclut asymétriquement des points de données à grande amplitude par rapport à des points de données à faible amplitude, et dans lequel :
- 10

la partie de l'histogramme inclut des points de données d'une amplitude vers le haut pour un incrément ajouté au-dessus d'une amplitude de base correspondant à un maximum identifié pour l'histogramme et exclut des points de données d'une amplitude supérieure à l'incrément ajouté au-dessus de l'amplitude de base ;

15

20

la partie de l'histogramme inclut des points de données d'une amplitude vers le bas pour un incrément soustrait en dessous de l'amplitude de base et exclut des points de données inférieurs à l'incrément soustrait en dessous de l'amplitude de base ; et

25

l'incrément ajouté est inférieur à l'incrément soustrait, dans lequel l'incrément soustrait est au moins deux fois plus important que l'incrément ajouté.

30

18. Procédé selon l'une quelconque des revendications 14 à 17, dans lequel l'instrument de cytomètre en flux est le système de cytomètre en flux selon la revendication 12 ou la revendication 13, et le procédé comprend l'écoulement du fluide échantillon à travers la cellule de flux et la soumission du fluide échantillon à la lumière d'excitation.
- 35

40

45

50

55

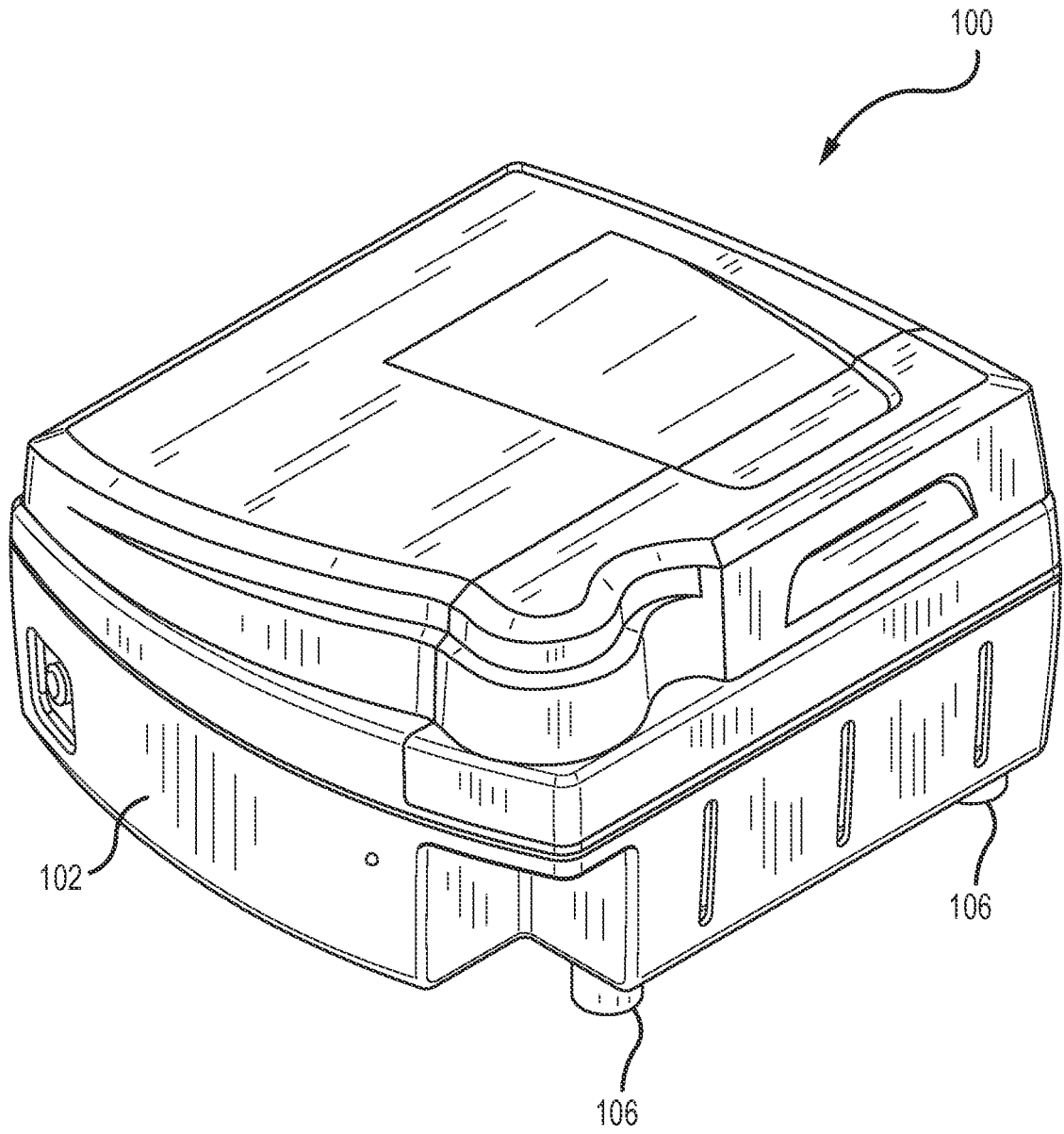

FIG.1A

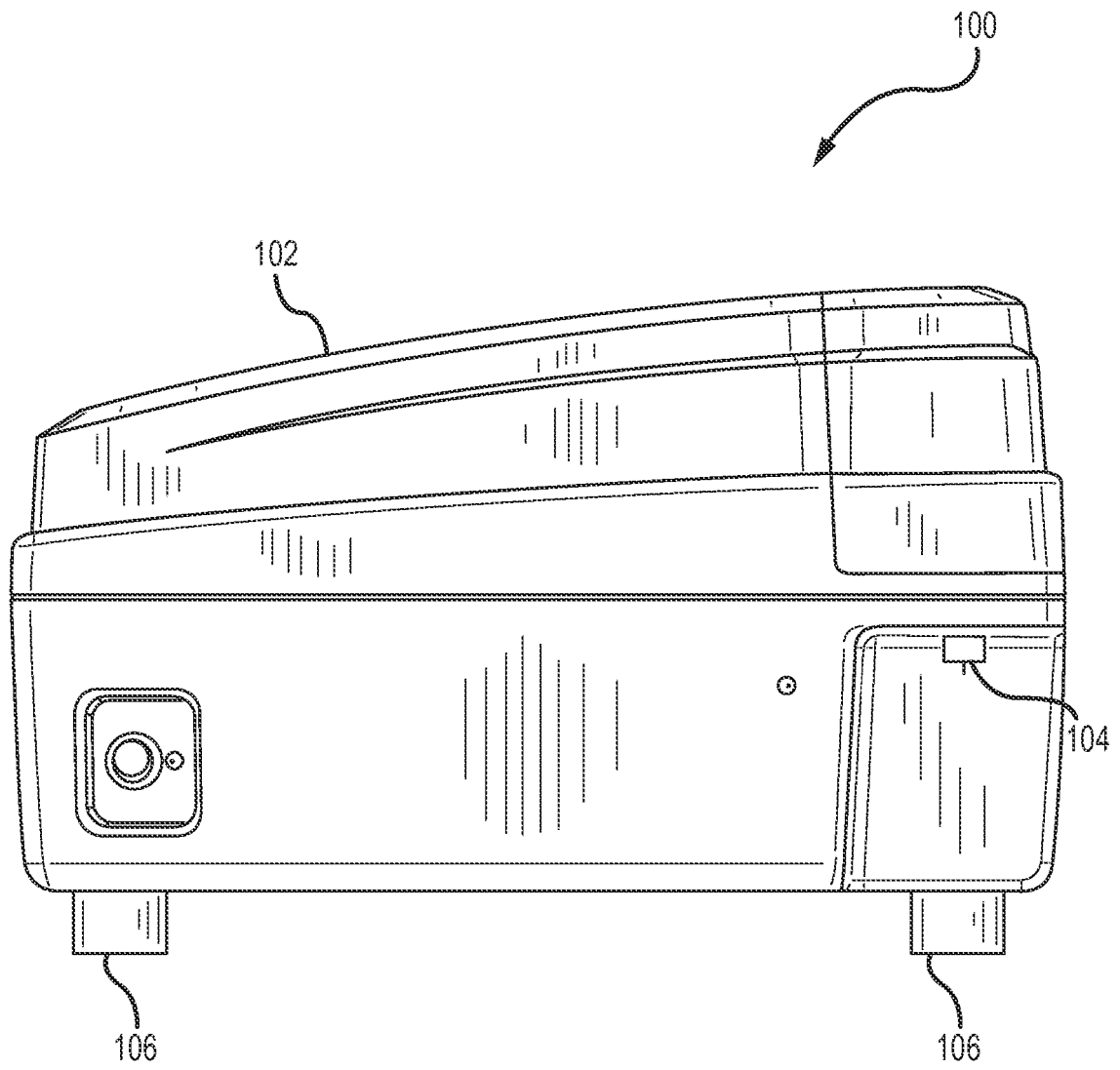

FIG.1B

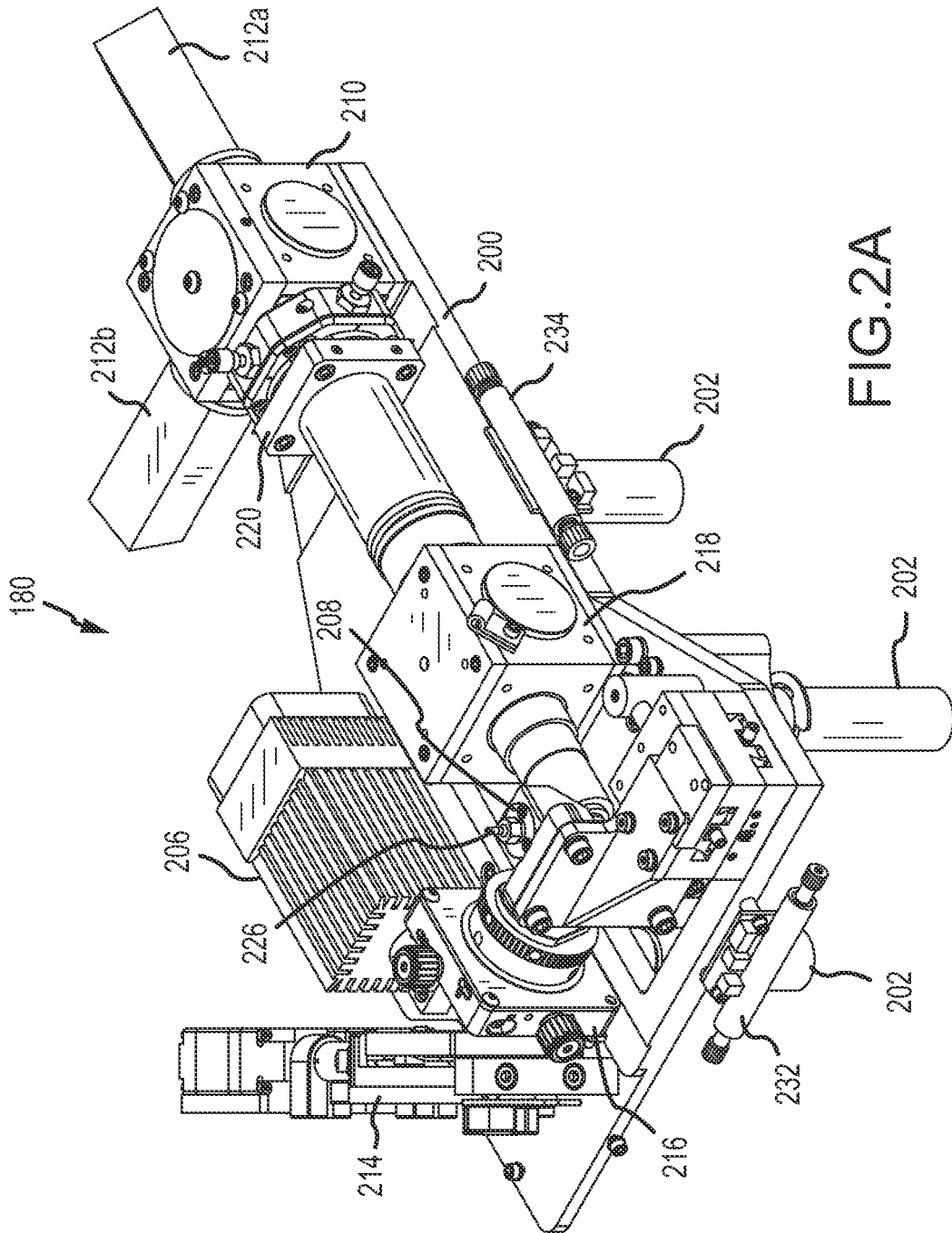

FIG.2A

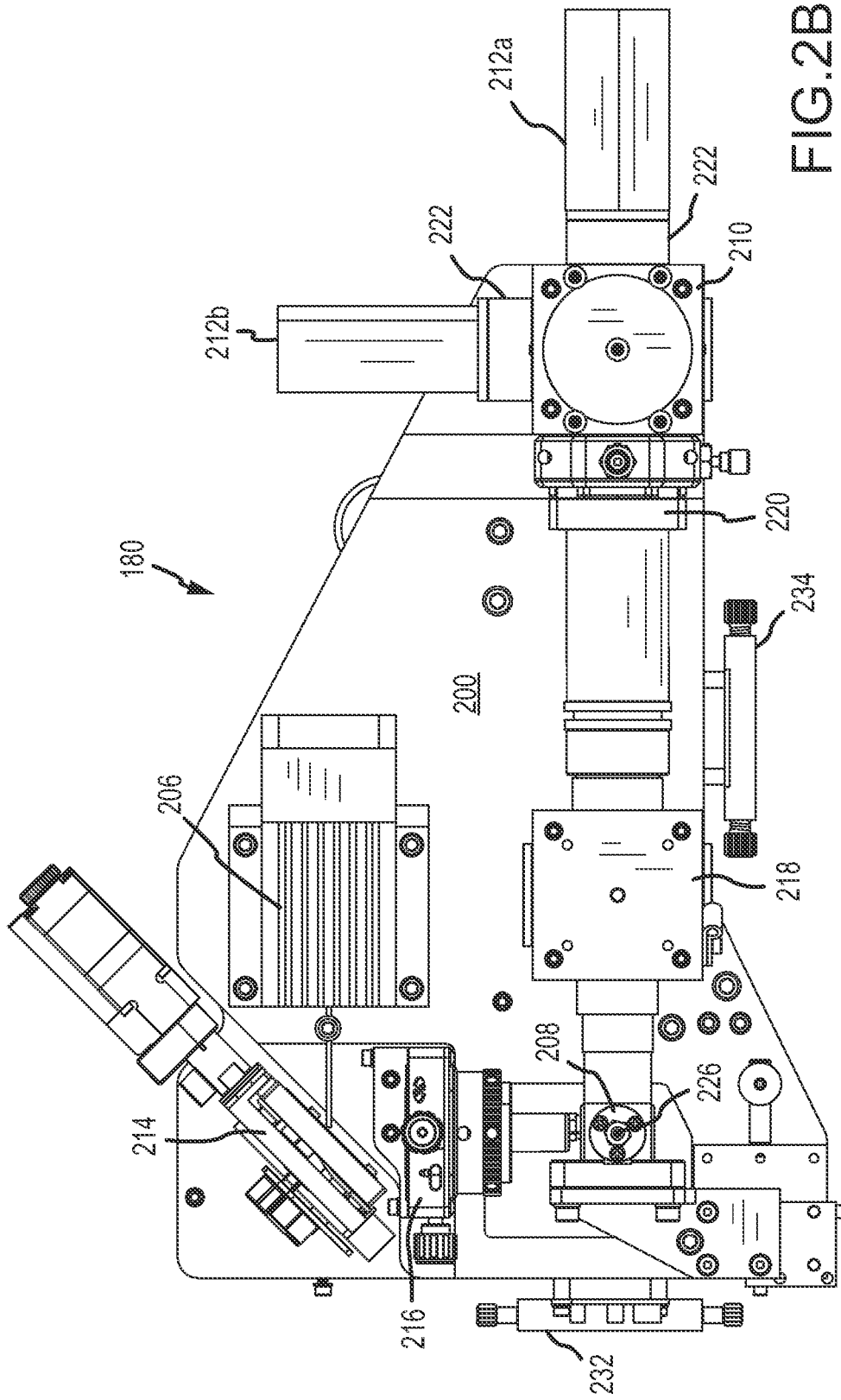

FIG. 2B

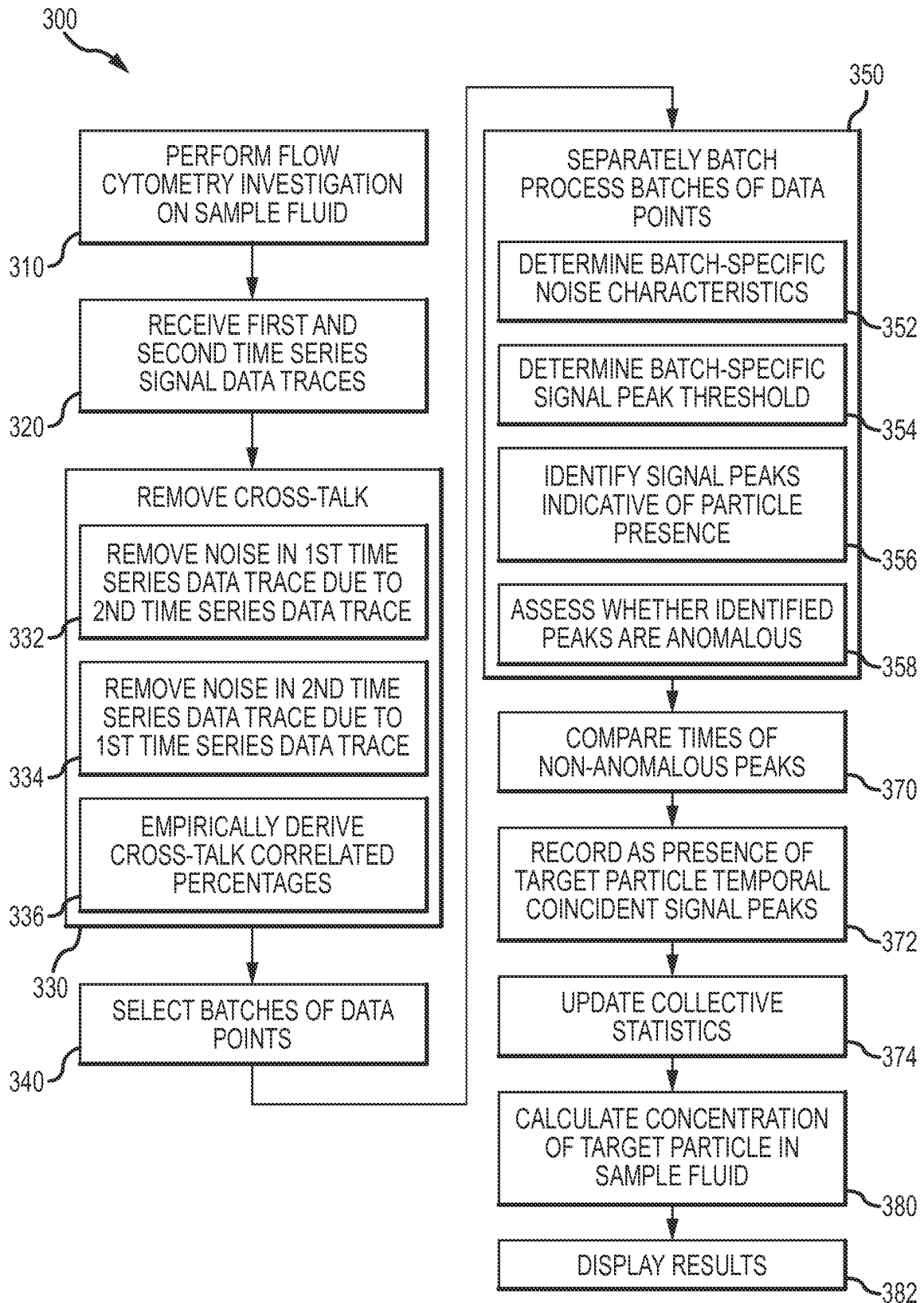

FIG.3

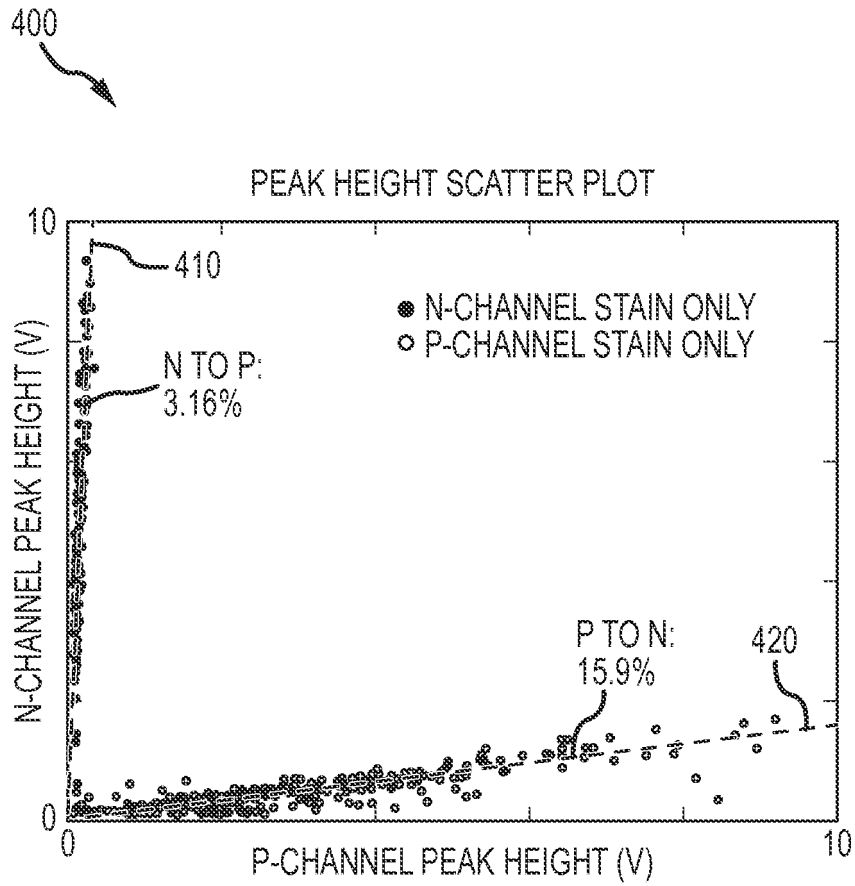

FIG.4

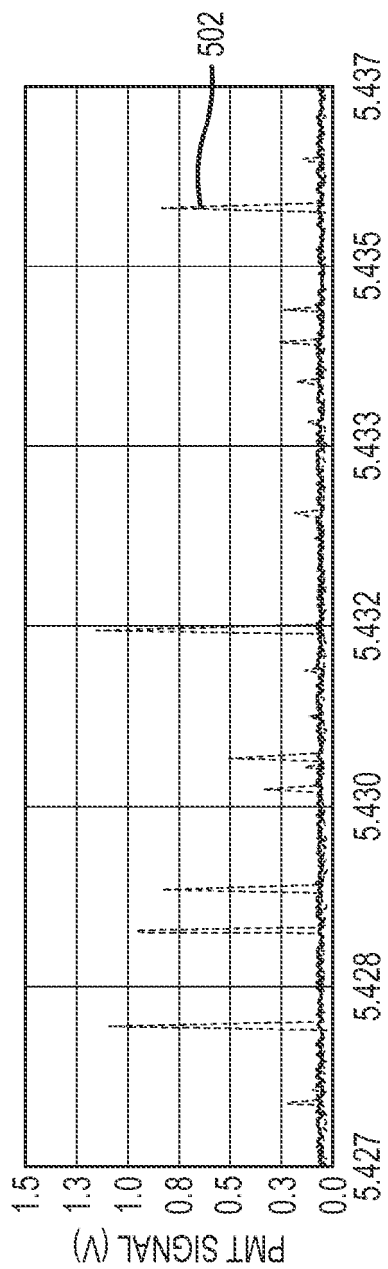

FIG.5A

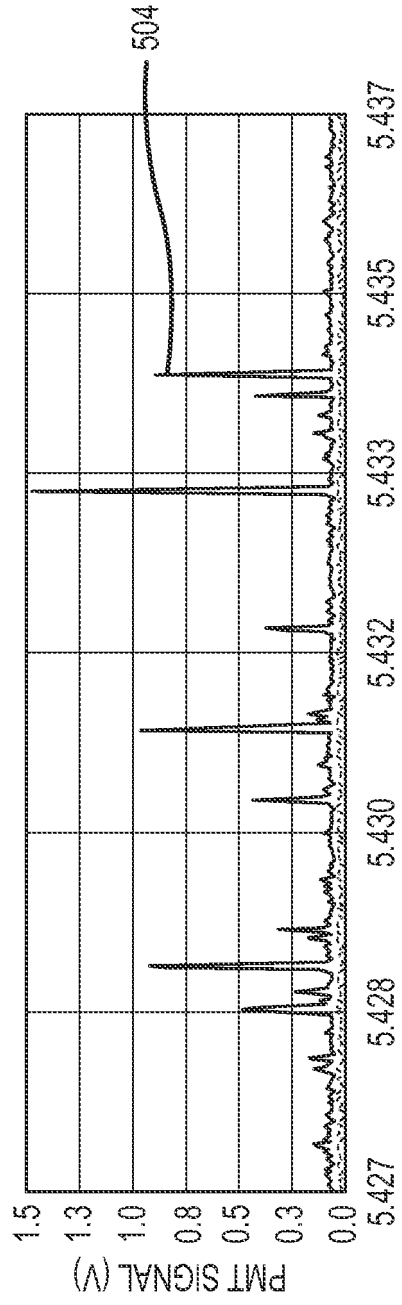

FIG.5B

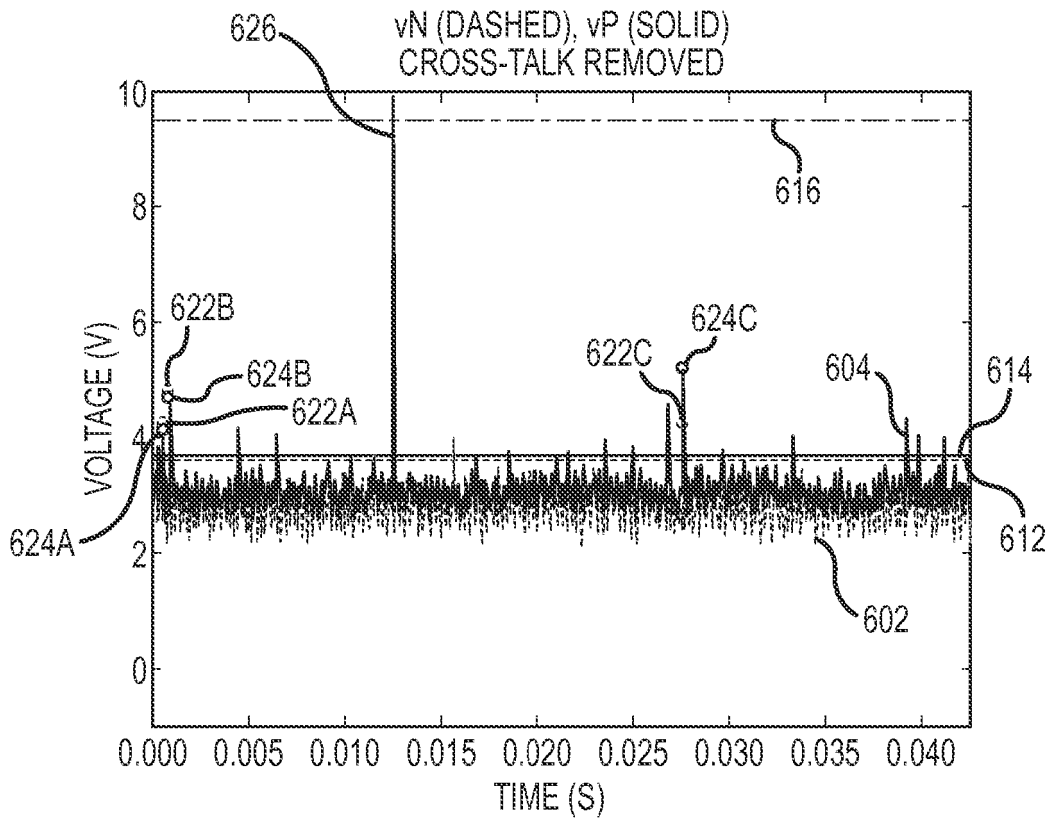

FIG.6A

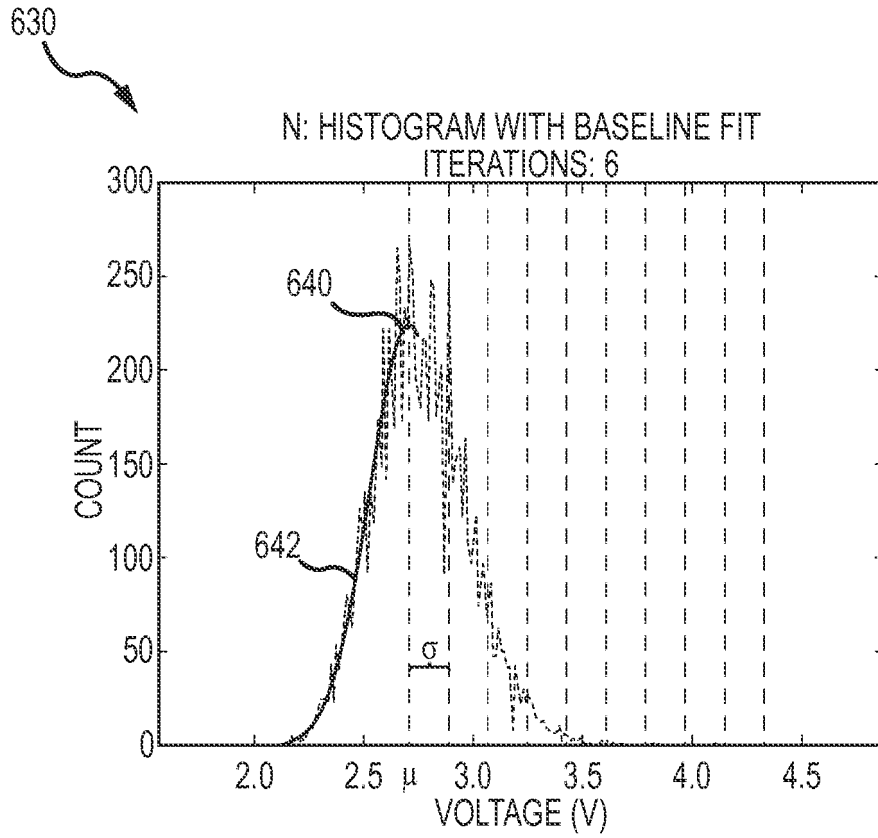

FIG. 6B

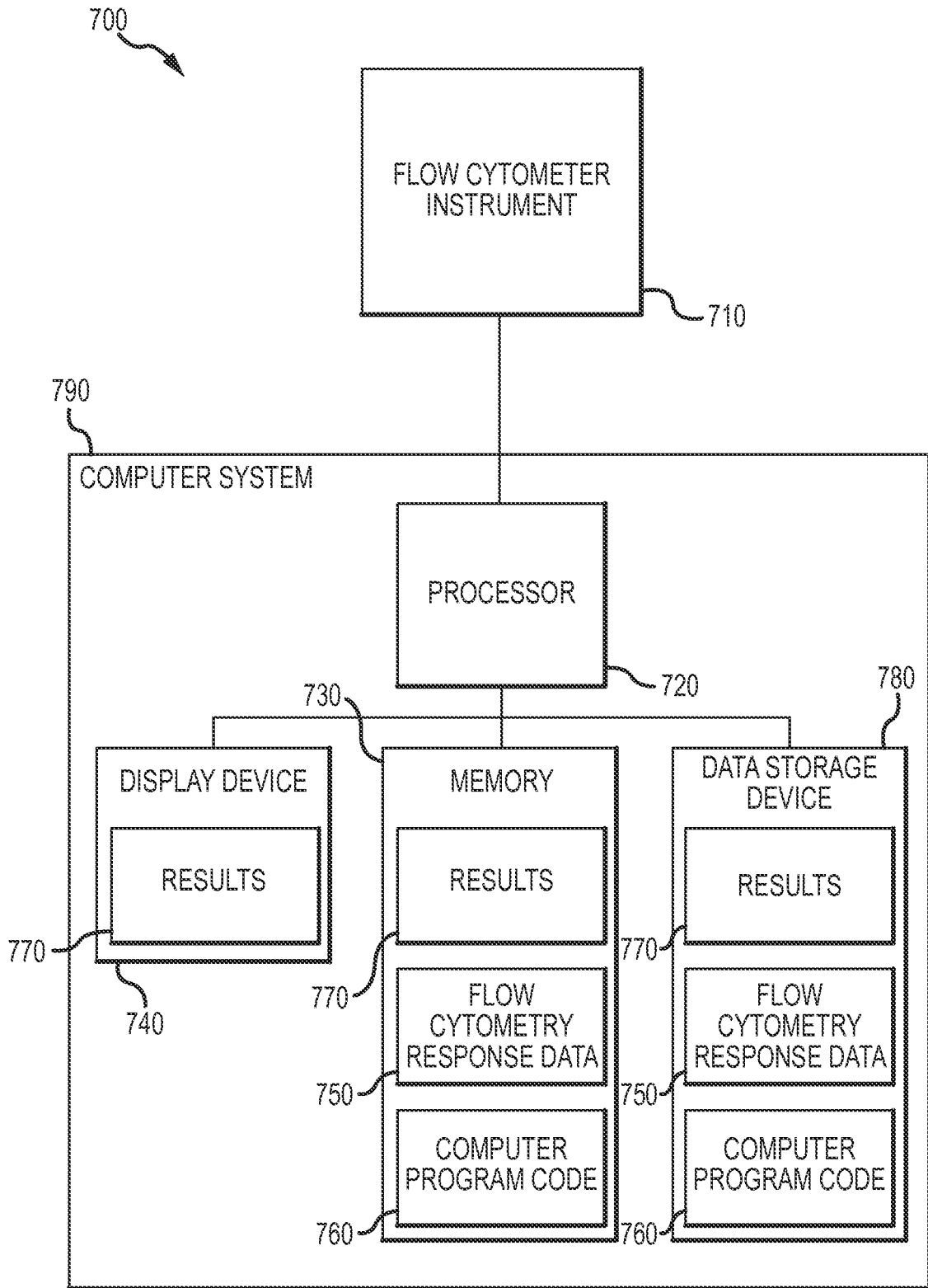

FIG.7

REFERENCES CITED IN THE DESCRIPTION

This list of references cited by the applicant is for the reader's convenience only. It does not form part of the European patent document. Even though great care has been taken in compiling the references, errors or omissions cannot be excluded and the EPO disclaims all liability in this regard.

Patent documents cited in the description

- US 62008345 [0001]
- US 2008021674 A1 [0005]
- WO 2014062719 A2 [0006]