



(11) **EP 3 055 559 B1**

(12) **EUROPEAN PATENT SPECIFICATION**

(45) Date of publication and mention of the grant of the patent:  
**23.09.2020 Bulletin 2020/39**

(51) Int Cl.:  
**F03D 13/00** <sup>(2016.01)</sup> **F03D 80/30** <sup>(2016.01)</sup>  
**F03D 9/25** <sup>(2016.01)</sup>

(21) Application number: **14789151.9**

(86) International application number:  
**PCT/DK2014/050311**

(22) Date of filing: **03.10.2014**

(87) International publication number:  
**WO 2015/051800 (16.04.2015 Gazette 2015/15)**

(54) **LIGHTNING CURRENT TRANSFER SYSTEM AND WIND TURBINE USING THE LIGHTNING CURRENT TRANSFER SYSTEM**

BLITZSTROMÜBERTRAGUNGSSYSTEM UND WINDTURBINE MIT DEM  
BLITZSTROMÜBERTRAGUNGSSYSTEM

SYSTÈME DE TRANSFERT DE COURANT DE Foudre ET ÉOLIENNE UTILISANT LE SYSTÈME  
DE TRANSFERT DE COURANT DE Foudre

(84) Designated Contracting States:  
**AL AT BE BG CH CY CZ DE DK EE ES FI FR GB  
GR HR HU IE IS IT LI LT LU LV MC MK MT NL NO  
PL PT RO RS SE SI SK SM TR**

(30) Priority: **07.10.2013 DK 201370560**

(43) Date of publication of application:  
**17.08.2016 Bulletin 2016/33**

(73) Proprietor: **Vestas Wind Systems A/S  
8200 Aarhus N (DK)**

(72) Inventors:  
• **SØGAARD, Morten Bagger**  
**DK-8200 Århus N (DK)**  
• **HANSEN, Anders Niels**  
**DK-8870 Langå (DK)**  
• **LYNGBY, Claus Grøn**  
**DK-8740 Brødstrup (DK)**

- **HENRIKSEN, Niels Martin**  
**DK-8330 Beder (DK)**
- **HAASTRUP, Benjamin**  
**DK-8200 Aarhus N (DK)**
- **CHRISTENSEN, Carsten**  
**DK-8200 Aarhus N (DK)**
- **CHRISTENSEN, Jesper Lykkegaard**  
**DK-8200 Aarhus N (DK)**
- **AHLMANN, Martin**  
**DK-8200 Aarhus N (DK)**

(74) Representative: **Vestas Patents Department**  
**Hedeager 42**  
**8200 Aarhus N (DK)**

(56) References cited:  
**WO-A1-2010/125160 DE-A1- 4 436 197**  
**DE-A1- 4 445 899 DE-A1-102004 010 104**

**EP 3 055 559 B1**

Note: Within nine months of the publication of the mention of the grant of the European patent in the European Patent Bulletin, any person may give notice to the European Patent Office of opposition to that patent, in accordance with the Implementing Regulations. Notice of opposition shall not be deemed to have been filed until the opposition fee has been paid. (Art. 99(1) European Patent Convention).

## Description

### Technical Field

**[0001]** The invention relates to a lightning current transfer system adapted for usage in a wind turbine having a hub rotatably supported relative to a generator in a nacelle of the wind turbine and a plurality of blades pivotably connected with the hub. The invention also relates to a wind turbine in which the lightning current transfer system is implemented.

### Description of the Related Art

**[0002]** Due to their size, wind turbines are prone to lightning strikes. The height of wind turbines overshoots by far surrounding trees and buildings in order to efficiently convert wind power into electric energy. If lightning strikes the tip of a blade of a wind turbine, the current flows in an uncontrolled manner through the blade, the blade bearings, the hub, the hub bearings, the generator shaft, the generator and the tower into the ground. Due to the high current values, there is a high risk that the bearings and electrical generators are damaged by the high voltages and currents flowing through the bearings and the generators. Therefore, efforts have been made to avoid damages in the turbine generators and the generator shaft bearings by offering a current path with lower impedance around the sensitive areas.

**[0003]** DE4445899 describes a lightning protection system for a wind turbine where there is a path to discharge lightning currents between the blades and ground. DE102004010104 describes a wind turbine with a lightning protection system where lightning current is discharged via a roller and a ring.

**[0004]** JP 05/060053A suggests a lightning protection system which guides the lightning energy from the hub to the nacelle through a slip ring device so as to avoid a lightning discharge path through the shaft bearings and the generators. This slip ring device consists of a disk which is mounted at the hub and which rotates with the hub. Carbon brushes mounted at the nacelle establish an electrically conductive path between the hub and the nacelle.

**[0005]** This solution has, however, the disadvantage that it does not consider that in modern wind turbines, the blades are pivotably connected to the hub through bearings in order to allow blade pitch control. These bearings may also be damaged by a high current flow. Therefore, efforts have been made in order to provide a short, low impedance connection between the root of the blade and the nacelle.

**[0006]** A solution for this problem is shown in the international patent application WO 2005/050008A1 disclosing a lightning current transfer unit which is collectively usable for a wide variety of turbine types. These turbines use a lightning current transfer unit (LCTU) that provides lightning current transfer from a blade band at the blade

root to a nacelle lightning ring. The hub is relatively small compared to the nacelle so that the blade band and nacelle lightning ring can be positioned in opposition to each other. This situation is illustrated in figures 1 and 2. Figure 1 shows a wind turbine W with a nacelle 3 containing the generator (not shown) sitting on the wind turbine tower 4. The blades 1 supported by the hub 2 are connected through a generator shaft with the turbine generators in the nacelle 3. Within the blade 1, a blade lightning protection system 5 is provided in the form of a down conductor with thick conductive cables guiding the lightning power through the blades to the root of the blades 1. From there, the lightning current is transferred via the hub 2, the nacelle 3, and the tower 4 into ground G.

**[0007]** Figures 2A and 2B show a more detailed view of the encircled section I in figure 1. In Figure 2A, reference numeral 1 designates a blade, numeral 2 designates the hub, numeral 2A designates the spinner (the cover/housing of the hub), numeral 3 designates the nacelle, numeral 3A designates the front plate of the nacelle and reference numeral 6 designates the generator shaft which connects the hub 2 with the generator (not shown) in the nacelle 3. The lightning current transfer unit comprises a blade band 1A that is mounted at the root of the blade 1 and which is connected with the cables of the blade lightning protection system 5. Moreover, the LCTU comprises a lightning ring 3B which is mounted at the nacelle front plate 3A. The hub 2 is relatively small compared to the nacelle 3 so that the blade band 1A and the nacelle lightning ring 3B are positioned to face each other. That is, the diameter D1 of the hub 2 is smaller than the diameter D2 of the nacelle 3 so that the blade band 1A can rotate inside of the nacelle perimeter dimensions D2. This dimensional relationship allows the positioning of a compact connecting device 7 which electrically connects the blade band 1A which is rotatable around a blade axis 9, and the nacelle lightning ring 3B which rotates relative to the connecting device 7 around the hub axis 8. The hub 2 and the connecting device 7 are collectively enclosed by a fibre glass cover to which it is referred as the spinner 2A.

**[0008]** The connecting device 7 in figure 2A comprises a bracket 7D, to which one end of two fibre glass profiles 7B and 7C are mounted. At the other ends of the fibre glass profiles 7B and 7C, contact elements 7A and 7F are mounted respectively. A cable 7E connects the contact elements 7A and 7F. It has to be noted that figure 2A shows a small gap between contact elements 7A/7F and blade band 1A and lightning ring 3B, respectively, for illustration purposes. In operation, these contacts are sliding contacts. Bending forces of the fibre glass profiles 7B and 7C push the contact elements 7A and 7F against the blade band 1A and the lightning ring 3B to ensure a low impedance connection between the blade 1 and the nacelle 3 even if contact element 7F is rotating relative to the lightning ring 3B around axis 8 and the blade band 1A is rotating relative to the contact 7A around axis 9. When lightning strikes a blade 1, the lightning current is

guided through the cable 5 of the blade lightning protection system to the blade band 1A, through the contact 7A, the connection cable 7E, the contact element 7F to the lightning ring 3B which is mounted to the nacelle front plate 3A which is grounded through a cable 3D with ground G.

**[0009]** A detailed view of the connecting device 7 is given in figure 3 which again shows the mounting bracket 7D, the glass fibre profiles 7C and 7B, the contact elements 7A and 7F and the cable 7E that electrically connects the contact elements 7A and 7F. Due to the elasticity and a pretension, the contact elements 7A and 7F are forced against the blade band and the lightning ring, to establish a point of low impedance between the blade band 1A and the lightning ring 3B.

**[0010]** Figure 2B shows a front view of figure 2A along axis 8 and illustrates the arrangement of the connecting devices 7 with regard to three blades 1. Each blade 1 is provided with a blade band 1A and each blade band is contacted with a respective connecting device 7 so that three connecting devices are necessary. Each connecting device 7 is also in contact with the lightning ring 3B illustrated in figure 2B as a dashed line. The contour of the lightning ring 3B is within the perimeter of the spinner 2A.

**[0011]** A simplified 3-dimensional illustration of the hub 2 and the spinner 2A is shown in figure 4. The spinner 2A has four openings, wherein the openings 2A-1, 2A-2 and 2A-3 are intended for feeding through the three blades and the fourth opening 2A-4 is used to allow a connection of the hub 2 with the generator shaft 6. The hub 2 includes four flanges 2-1, 2-2, 2-3 and 2-4 wherein the flanges 2-1, 2-2 and 2-3 are intended to mount a respective blade and flange 2-4 is intended to mount the generator shaft. Reference numerals 7-1, 7-2 and 7-3 symbolize three connecting devices as illustrated in figure 3. The spinner opening 2A-4 is larger than the other openings in order to allow a connection of the connecting devices 7-1, 7-2 and 7-3 with the lightning ring at the nacelle through opening 2A-4. Figure 4 illustrates three connecting devices 7-1, 7-2 and 7-3, one for each blade 1.

**[0012]** In recent times, there is a growing demand for larger wind turbines with pitch controllable blades, which leads to a larger hub so that finally, the blade band rotates outside of the nacelle perimeter. This has two consequences. At first, the v-shape of the contact element 7 is no longer possible because it is not possible to place the blade band 1A opposite to the lightning ring 3B. Second, this also leads to an increased length of the connecting cable leading to higher impedance. A consequence of this is that the distance of the lightning protection system to sensitive parts like bearings and generators has to be increased in order to avoid discharges into the bearings and the generator.

**[0013]** It is therefore an object of this invention to provide a lightning current transfer system for large wind turbines which can use most of the parts of the lightning

current transfer system of smaller wind turbines and which is maintainable in situ.

## Summary of Invention

**[0014]** The object is achieved by a wind turbine as claimed in claim 1.

**[0015]** This arrangement has the advantage that the lightning current transfer system can be used for larger wind turbines with larger hubs wherein the blade band rotates outside of the nacelle perimeter. Moreover, this lightning current transfer system can be designed so that many of the parts of the lightning current transfer system for smaller wind turbines can be used and implemented for larger wind turbines in a new assembly. The lightning current transfer system of the present invention basically splits the integral connecting device of the state-of-the-art as described with reference to figure 3 into two separate contact devices which also allow an increase of the respect distance (separation distance) to sensitive parts like bearings and generator parts. Another advantage is that the lightning ring can be mounted to the spinner and the second contact device are mountable to the nacelle which means that a plurality of second contact devices can be used on the nacelle side so that lightning current can be distributed over several contact points which reduces the current magnitude in one contact so that wear can also be reduced. This also adds redundancy and safety to the nacelle side lightning current transfer system in comparison to the prior art according to figures 2-4. In the case that lightning strikes a wind turbine with a lightning current transfer system according to the state of the art, current flows only through one contact point into the nacelle and increases therefore load and wear of the contact device in a lightning current transfer system of the prior art.

**[0016]** In one embodiment, the blade band and the first contact device are configured to be mounted outside the spinner and the connecting device for connecting the first contact device with the lightning ring is configured to be mounted inside the spinner.

**[0017]** This configuration allows on one hand larger respect distances (separation distances) between the first contact device/connecting device and bearings or other sensitive parts. On the other hand, connecting cables (connecting device) between the first contact device and the lightning ring can be made shorter so as to reduce the impedance between these points.

**[0018]** In another embodiment, the first contact device of the lightning current transfer system comprises a first mounting element mountable to the spinner, a first elastic non-conducting profile mounted to the first mounting element and a first contact element mounted at the first elastic non-conducting profile, wherein the first contact device is configured so that the first contact element faces the blade band and the first elastic non-conducting profile pushes the first contact element against the blade band.

**[0019]** This embodiment has the advantage that the

first contact element and the first elastic non-conducting profile of well-established preexisting lightning current transfer system like that illustrated in figures 2a and 3 can be reused. The first mounting element is designed to serve as a combination of a bracket (fixture for the first elastic non-conducting profile) and a cover which protects the first contact device against the environment because the first mounting element is mounted outside the spinner. According to a further embodiment, the first contact element comprises a conductive rod and a sliding element, wherein the conductive rod extends through a hole of the sliding element so that an end surface of the conductive rod and a surface of the sliding element collectively form a contact area for slidingly contacting the blade band. Thus, an electrical contact with small friction forces with the blade band can be established. Moreover, contact elements of established lightning current transfer units can be implemented in this invention, saving manufacturing costs.

**[0020]** In order to reduce the frictional forces of the sliding contact, the sliding element may be provided with a chamfered edge. This also improves ice sliding ability in case that icing occurs. The sliding area of the sliding element may have the shape of a hexagon with an edge of the hexagon in a moving direction of the sliding element so as to reduce friction in a sliding direction, in particular in case of a contaminated blade band surface.

**[0021]** In order to reduce friction and wear of the sliding element, the sliding element may be made of Nylatron.

**[0022]** In one embodiment, the second contact device comprises a second mounting element one end thereof being mountable to a front plate of the nacelle so that the second mounting element protrudes therefrom, a second elastic non-conducting profile mounted at one end to another end of the second mounting element, an extension bracket mounted at the second elastic non-conducting profile, and a second contact element mounted at the extension bracket, wherein the second contact device is configured so that the contact element may extend through a hole in a nacelle front cover so as to face the lightning ring mounted at the spinner, and the second elastic non-conducting profile pushes the second contact element against the lightning ring.

**[0023]** In this embodiment, the second contact device, the elastic non-conducting profile and the second contact element of existing well-established lightning current transfer units can be used. Moreover, the first elastic non-conducting profile may have the same structure as the second elastic non-conducting profile and the first contact element may have the same structure as the second contact element so that the respective elements are interchangeable on one hand and can also be used for older well-established lightning current transfer systems like that illustrated in figures 2a and 3. Moreover, the structure of the second contact device is configured to be mounted inside of the nacelle cover so that the second contact element can protrude through a small hole in the nacelle front cover to establish an electric contact with

the lightning ring at the spinner. Moreover, bending forces of the pre-tensed second elastic non-conducting profile ensure that the contact element is pressed against the lightning ring for making a low impedance contact.

**[0024]** In order to add redundancy and to decrease the lightning current through each second contact, at least two second contact devices and more preferably, four second contact devices are used in a nacelle.

**[0025]** In one embodiment, the first mounting element comprises a fibre glass console acting as a fastening bracket for the first elastic non-conducting profile and a cover for protection of the first contact element. As the first contact device is mounted outside the spinner, the contact element is exposed to environment influences. The construction of the first contact device allows a protection of the contact element from environmental conditions.

**[0026]** In another embodiment, the second mounting element is a stainless steel bracket bridging the distance between the mechanically robust nacelle front plate and the nacelle front cover. Thus, the bracket can also be used as a tread for service personnel.

**[0027]** In a further embodiment, the first elastic non-conducting profile and a second elastic non-conducting profile are fibre glass profiles. Fibre glass is a very robust, elastic and non-conductive material which can provide and transmit bending forces so as to establish a safe electrical contact between the contact elements on one side and the blade band and/or the lightning ring on the other side.

**[0028]** In one embodiment thereof, the nacelle includes an inspection hatch in the nacelle front plate cover for inspecting the lightning ring. Thus, service can be provided in-situ.

### Short description of the Figures

**[0029]** In the following, embodiments, examples, advantages and implementations of the invention will be explained in more detail by means of the accompanying figures. It is noted that all described and/or illustrated features alone or in arbitrary combination are basically subject matter of the invention, independently of the summary in the claims or the references in the claim. Also, the content of the claims is considered to be part of the description. In the figures show

Figure 1: Schematically a wind turbine;

Figure 2A: An enlarged view of the region I of figure 1 according to the state of the art;

Figure 2B: A front view of figure 2A;

Figure 3: A connection part of the lightning current transfer system according to the state of the art;

Figure 4: A schematic 3-dimensional view of a hub

and a spinner according to the state of the art;

Figure 5: A schematical drawing of a lightning current transfer system according to the present invention mounted at a nacelle and a spinner;

Figure 6: A 3-dimensional view of an isolated lightning current transfer unit according to the present invention;

Figure 7: A 3-dimensional view of a second contact device according to the present invention; and

Figure 8: A 3-dimensional view of the first contact device of the present invention.

### Detailed Description of embodiments

**[0030]** This invention has been made in order to provide a lightning current transfer system which can be used for wind turbines which are larger than the previous wind turbine constructions. In such larger wind turbines, the blades and the hub are increased in size so that the part of the lightning current transfer unit which is responsible for collecting the lightning current from the root of the blade rotates with the hub beyond the perimeter of the nacelle. Moreover, this invention has been made in order to allow at least partially the usage of lightning current transfer units according to the state-of-the-art. Moreover, all parts of the lightning current transfer unit of this invention shall be exchangeable in-situ and shall also reduce wear due to the lightning current.

**[0031]** Figure 5 gives an overview of the lightning current transfer system according to the present invention. In figure 5, reference numeral 20 designates a hub, reference numeral 10 designates a blade, reference numeral 60 designates a shaft which connects the hub 20 with a generator (not shown) within the nacelle 30, and reference numeral 20A designates a spinner (aerodynamic housing of the hub 20). Figure 5 illustrates that the hub 20 is directly connected with the shaft 60 which in turn may be directly connected with the generator so as to implement a direct drive system. This invention is, however not restricted to such configurations. It is also possible to interpose a gearbox between the hub and the generator to convert a low speed rotational movement of the hub into a high speed rotational movement of a high speed shaft that drives the generator. The gearbox may be directly mounted to the hub or may be interposed between a low speed shaft from the hub and a high speed shaft from the generator. Therefore, in more general terms, the hub is rotatably supported relative to the generator.

**[0032]** The lightning current transfer system includes the blade band 10A, the lightning ring 80, the blade part contact device 70 (also referred to as a first contact device 70) and nacelle side contact device 30B (also referred to as a second contact device 30B). Blade part

contact device 70 includes the blade part sliding contact 70B (also referred to as first contact element 70B), a non-conductive elastic glass fibre arm 70C (also referred to as first non-conductive elastic glass fibre profile 70C) and a first mounting element 70A which fixes the glass fibre profile 70C to the spinner 20A and protects at the same time the sliding contact 70B that is mounted at the glass fibre arm 70C against environment. An electrical connection 75 inside the spinner 20A connects the sliding contact 70B with the lightning ring 80 which is mounted at the back side of the spinner 20A so as to face sliding contacts (also referred to as second contact element) of the nacelle contact device 30B (second contact device 30B). Rotation axes 8 and 9 indicate the same rotating capabilities of the spinner/hub and the blade are as described in figure 2A.

**[0033]** In general, the same reference numerals designate the same technical features in the figures and an omitted description of a particular reference number may be found in a description of a previous figure. Moreover, the dimensions and proportions in the figures have only illustrative character and are not intended to reflect a scale model. It is further noted that figure 5 shows a small gap between contact elements 70B/30B and blade band 10A and lightning ring 80, respectively, for illustrative purposes. In operation, these contacts are sliding contacts and no gaps are visible.

**[0034]** It has to be noted that the lightning current transfer system according to this specification is exemplarily illustrated in form of sliding contacts that provide a low impedance connection. Thereby, the term "low impedance" is intended to describe an impedance for a lightning current transfer path that is lower than alternative lightning current transfer paths, so that the lightning current transfer can be controlled. In particular embodiments of this invention, the low impedance connection is provided with sliding contacts. This invention is, however, not restricted to sliding contacts. Moreover, the low impedance contacts may also be implemented as a spark gap-that is the electrical connection between the blade band 10A and the first contact element may a spark gap and/or the electrical connection between the lightning ring 80 and the second contact device 30B may be a spark gap, rather than sliding contacts. In summary, a contact for a lightning current transfer has to be distinguished from a low energy (low voltage) electrical contact. The claimed contacts for lightning current transfer have to be electrically conductive for potential differences above several thousand volts due to the high voltages of lightning. Nevertheless, some embodiments also use contacts which are conductive at lower voltages (potential differences). Another implicit requirement of the claimed contacts is that their material can withstand very high current flow of up to several hundred thousand amperes.

**[0035]** The nacelle side contact device 30B is mounted to front plate 30A of the nacelle 30.

**[0036]** If a lightning strikes the blade 10, the lightning current is guided through cables within the blade 10 to a

blade band 10A. The elastic glass fibre arm 70C presses the sliding contact 70B against the blade band 10A so as to ensure a conductive connection even if the blade 10 is pivoting/pitching around the axis 9. The lightning current is further guided through the cable 75 to the lightning ring 80 which is mounted on the nacelle side of the spinner 20A. The nacelle contact device 30B also includes a sliding contact element which guides the lightning current from the lightning ring 80 to the grounded front plate 30A of the nacelle 30. The routing of the lightning current through the cables of the blade, the spinner and the nacelle to the ground inherently includes a voltage drop along the cable. The larger the wind turbine, the higher is the risk that the current jumps from the desired current path to unwanted structural elements and continues through the shaft and main bearings. In order to prevent the current to jump from the desired current path to unwanted structural elements, a minimum respect distance needs to be kept to these structural elements. The larger the wind turbine, the larger these respect distances have to be. The positioning of the blade side contact device 70 outside of the spinner increases the respect distance so that the required respect distance can be fulfilled.

**[0037]** Figure 6 shows the isolated lightning current transfer system 100 according to the present invention. Figure 6 shows the lightning ring 80 that is mounted via lightning ring brackets 81 to the spinner (not shown in figure 6). The lightning ring 80 may be composed of several stainless steel segments which are fixed together with the lightning ring brackets 81. Figure 6 shows 10 lightning ring segments and ten lightning ring brackets 81. This number is, however, only used for illustrative purposes. Less than 10 stainless steel segments are possible and also more than 10 stainless steel segments are possible. Preferably, twelve stainless steel segments are used which leads to a manageable size of the segments which can be comfortably handled for in-situ maintenance from the nacelle, for instance, if a lightning ring segment has to be changed due to wear.

**[0038]** Figure 6 also shows the blade band 10A which is a stainless steel plate, for instance, having a size of 4,000 x 80 x 3 mm. The stainless steel plate may be bolted and glued onto each blade. Attachment holes are positioned at each end of the blade band 10A. Further two holes may be positioned in an intermediate region of the blade band in order to fit the plate to the blade. The intermediate holes also serve as attachment points for the current transferring cable that run inside each blade. Since two contact points may be implemented in the blade band 10A, the lightning current is divided if the blade pitch angle causes the contact element in the first mounting element 70A to be positioned between the two intermediate holes. Dividing the current reduces the needed respect distance and reduces also the wear of the blade band 10A.

**[0039]** Moreover, figure 6 shows four nacelle contact device 30B (second contact device 30B) that are in sliding

contact with the lightning ring 80. The blade side contact element inside the composite console 70A is connected with the lightning ring 80 via cable 75.

**[0040]** The nacelle side contact device 30B (second contact device 30B) is shown in more detail in figure 7. Figure 7 shows a bracket 30B-1, a fibre glass profile 30B-2, an extension bracket 30B-3, and a contact element 30B-5, which is intended for slidingly contact with the lightning ring 80 which is mounted via bracket 81 to the spinner. The contact element 30B-5 is grounded to a cable 30B-4 which is grounded to the nacelle main structure.

**[0041]** The bracket 30B-1 fixes the fibre glass profile 30B-2 to the nacelle front plate and bridges the distance between the grounded nacelle front plate and the nacelle front cover (not illustrated). One end of the fibre glass profile 30B-2 is fixed to the bracket 30B-1 and at the other end of the fibre glass profile 30B-2, the extension bracket 30B-3 is mounted, which bridges a certain distance through the nacelle front cover (not shown) to the lightning ring 80. The contact element 30B-5 is mounted to the extension bracket 30B-3 so that it is located outside the nacelle in front of the lightning ring 80. The nacelle side contact device 30B is configured so that the fibre glass profile 30B-2 can be provided with pretension so that the contact element 30B-5 is pressed against the lightning ring 80.

**[0042]** The contact element 30B-5 may be designed in accordance with the international patent application WO 2005/05008, for instance, illustrated in figure 8 thereof. The contact element 30B-5 basically may comprise a contact rod extending through a sliding pad. The rod preferably makes the electric contact to the rotating lightning ring 80 and the pad surrounding the rod ensures a low friction slide on the contact surface. The contact rod may be fixed to extension bracket 30B-3 by screwing a bolt into a threaded hole in the back side of the contact rod. In this description, to the combination of the contact rod and the sliding pad, it is collectively referred to as the contact element. The nacelle side contact element 30B-5 (second contact element 30B-5) and the spinner side contact element 70B (first contact element 70B, see figure 5 or 8) may have the same structure or may be different. For instance, figure 3 showing the lightning current transfer unit according to the state-of-the-art shows two different shapes of contact elements. Contact element 7A making the contact with the blade band 1A is a circular disk. The contact element 7F making the contact with the lightning ring 3B has a hexagonal structure with edges in a relative moving direction. Similarly, the contact element 30B-5 in figure 7 may have a disk form or a hexagonal form.

**[0043]** The contact rod may be made from an electric conductive material such as copper, aluminum, bronze, graphite, silver or composites thereof. Preferably, bronze is used. The pad may be made of a low friction material such as nylon, acetal, Vesconite or glass filled nylon. Preferably, Nylatron is used for the sliding pad. In order

to improve the sliding properties and adaptability to ice layers on the lightning ring 80, the contact element 30B-5 may be provided with a chamfered edge.

**[0044]** Figure 8 shows a detailed view of the spinner side contact device 70 (first contact device 70) for providing contact with the blade band 10A. The spinner side contact device 70 comprises a (first) mounting element 70A to which a fibre glass profile 70C is mounted via a bracket 71. A contact element 70B-1 is mounted with a threaded bolt 70B-2 to the fibre glass profile 70C. A cable 75-1 is electrically connected with the bolt 70B-2 in order to make an electrical connection with the contact element 70B-1. The cable 75-1 is electrically connected with a lightning current transfer profile 75-2, which electrically connects the cable 75-1 with the connection bus 75-3. The lightning current transfer profile 75-2 is fixed to the fibre glass console 70 with a rubber fixture 70A1. The connection bus 75-3 connects the lightning current transfer profile 75-2 with the lightning ring 80 which is mounted to the spinner in front of the nacelle. To the cable 75-1, the lightning current transfer profile 75-2 and the connection bus 75-3, it is collectively referred to as the connecting device 75, for instance, in figures 5 and 6. To the blade side contact element including the contact element 70B-1 and the bolt 70B-2, it is collectively referred to as the first contact element 70B (see for instance figure 5). The structure of the first contact element 70B may be the same as the nacelle side contact element 30B-5 as explained with figure 7.

**[0045]** The first mounting element fibre glass console 70A is fixed to the spinner at each blade to support the contact with the respective blade band 10A by means of threaded washers 70A3. The exposed part of the cable 75-1, the lightning current transfer profile 75-2 and the fibre glass profile 70C may be protected from environment by a cover (not shown in figure 8, indicated in figure 6). The first mounting element fibre glass console 70A comprises a fibre glass console used as a mounting bracket and a cover protecting the contact elements.

**[0046]** The fibre glass console may be 8mm thick and acts as a fastening bracket for the fibre glass profile 70C. It may be bolted onto the hub cover (spinner) at 4 points. Its non-conductivity enables it to be relatively large as to distribute the stresses over a larger area of the hub cover (spinner).

**[0047]** The entire mounting element 70C (console including cover) can be dismantled from outside the hub by removing the four hub bolts and an additional bolt providing connection of the lightning current transfer profile 75-2 with the connection bus 75-3. Fibre glass profile 70C is provided with a pretension so that the contact element 70B-1 is pressed against the blade band 10A so as to ensure controlled lightning current transfer between the pitching blade and the lightning ring 80, i.e. a controlled high conductivity connection at least for very high voltages of more than 10,000 Volts.

**[0048]** In conclusion, this invention has been made in order to provide a lightning current transfer system for

larger wind turbines in which parts of well-known technology can be reused, wherein the lightning wear of the parts is reduced and all parts are exchangeable in-situ.

## Claims

1. A wind turbine (W) having a hub (20) rotatably supported relative to a generator in a nacelle (30), a plurality of blades (10) pivotably connected with the hub (20) and a lightning current transfer system (100), wherein the hub (20) is covered by a spinner (20A), the lightning current transfer system comprising
  - a blade band (10A) mounted to a root of the blade (10);
  - a lightning ring (80) mounted to the spinner (20A) facing the nacelle (30);
  - a first contact device (70) mounted to the spinner (20A) for providing lightning current transfer from the blade band (10A);
  - a connecting device (75) connecting the first contact device (70) with the lightning ring (80); and
  - a second contact device (30B) mounted to the nacelle (30) for providing lightning current transfer from the lightning ring (80);
 wherein the hub (20) has a radial extension (D1) so that the blade band (10A) rotates outside a perimeter of the nacelle (30).
2. The wind turbine according to claim 1, wherein:
  - the blade band (10A) and the first contact device (70) are mounted outside the spinner (20A); and
  - the connecting device (75) is mounted inside the spinner (20A).
3. The wind turbine according to claim 1 or claim 2, wherein the first contact device (70) comprises:
  - a first mounting element (70A) mounted to the spinner (20A);
  - a first elastic non-conducting profile (70C) mounted to the first mounting element (70A); and
  - a first contact element (70B) mounted at the first elastic non-conducting profile (70C);
 wherein the first contact device (70) is configured so that the first contact element (70B) faces the blade band (10A) and the first elastic non-conducting profile (70C) pushes the first contact element (70B) against the blade band (10A).
4. The wind turbine according to claim 3, wherein the first contact element (70B) comprises:
  - a conductive rod; and
  - a sliding element (70B-1),

- wherein the conductive rod extends through a hole of the sliding element so that an end surface of the conductive rod and a surface of the sliding element collectively form a contact area for slidingly contacting the blade band (10A).
5. The wind turbine according to claim 4, wherein the sliding element (70B-1) has a chamfered edge.
6. The wind turbine according to any one of the claims 1-5, wherein the second contact device (30B) comprises:
- a second mounting element (30B-1) mounted at one end to a front plate (30A) of the nacelle (30) thereby protruding therefrom;
  - a second elastic non-conducting profile (30B-2) mounted at one end to another end of the second mounting element (30B-1);
  - a second contact element mounted at the second elastic non-conducting profile (30B-1), wherein the second contact device (30B) is configured so that the contact element faces the lightning ring (80) and the second elastic non-conducting profile (30B-2) pushes the second contact element against the lightning ring (80).
7. The wind turbine according to claim 3 and 6, wherein the first elastic non-conducting profile (70C) has the same structure as the second elastic non-conducting profile (30B-2) so that these elements are interchangeable.
8. The wind turbine according to claim 7, wherein the first contact element (70B) has the same structure as the second contact element so that these elements are interchangeable.
9. The wind turbine according to any one of the preceding claims comprising at least two second contact device (30B), preferably four second contact device (30B).
10. The wind turbine according to any one of the claims 3 - 9, wherein the first mounting element (70A) comprises:
- a fibre glass console acting as a fastening bracket for the first elastic non-conducting profile (70C); and
  - a cover for protecting the first contact element (70B).
11. The wind turbine according to any one of the claims 7 - 10, wherein the second mounting element (30B-1) is a stainless steel bracket.
12. The wind turbine according to any one of the claims
- 3 11, wherein the first elastic non-conducting profile (70C) and/or the second elastic non-conducting profile (30B-2) is a fibre glass profile.
- 5 13. The wind turbine according to claim 1, wherein the nacelle (30) includes an inspection hatch for in situ inspecting the lightning ring (80).
- 10 **Patentansprüche**
1. Windkraftanlage (W), die eine Nabe (20) aufweist, die in Bezug auf einen Generator in einer Gondel (30) drehbar gestützt ist, eine Vielzahl von Blättern (10), die schwenkbar mit der Nabe (20) verbunden sind, und ein Blitzstromübertragungssystem (100), wobei die Nabe (20) mit einer Nabenhaube (20A) abgedeckt ist, wobei das Blitzstromübertragungssystem Folgendes umfasst:
- ein Blattband (10A), das an einer Wurzel des Blatts (10) befestigt ist;
  - einen Blitzring (80), der an der Nabenhaube (20A) zur Gondel (30) zeigend befestigt ist;
  - eine erste Kontaktvorrichtung (70), die zum Bereitstellen von Blitzstromübertragung von dem Blattband (10A) an der Nabenhaube (20A) befestigt ist;
  - eine Verbindungsvorrichtung (75), die die erste Kontaktvorrichtung (70) mit dem Blitzring (80) verbindet; und
  - eine zweite Kontaktvorrichtung (30B), die zum Bereitstellen von Blitzstromübertragung von dem Blitzring (80) an der Gondel (30) befestigt ist;
- wobei die Nabe (20) eine radiale Erweiterung (D1) aufweist, so dass das Blattband (10A) außerhalb eines Umfangs der Gondel (30) dreht.
2. Windkraftanlage nach Anspruch 1, wobei:
- das Blattband (10A) und die erste Kontaktvorrichtung (70) außerhalb der Nabenhaube (20A) befestigt sind; und
  - die Verbindungsvorrichtung (75) innerhalb der Nabenhaube (20A) befestigt ist.
3. Windkraftanlage nach Anspruch 1 oder Anspruch 2, wobei die erste Kontaktvorrichtung (70) Folgendes umfasst:
- ein erstes Befestigungselement (70A), das an der Nabenhaube (20A) befestigt ist;
  - ein erstes elastisches nichtleitendes Profil (70C), das an dem ersten Befestigungselement (70A) befestigt ist; und
  - ein erstes Kontaktelement (70B), das an dem ersten elastischen nichtleitenden Profil (70C)



- befestigt ist;  
wobei die erste Kontaktvorrichtung (70) so ausgelegt ist, dass das erste Kontaktelement (70B) zu dem Blattband (10A) zeigt und das erste elastische nichtleitende Profil (70C) das erste Kontaktelement (70B) gegen das Blattband (10A) drückt.
4. Windkraftanlage nach Anspruch 3, wobei das erste Kontaktelement (70B) Folgendes umfasst:
- einen leitenden Stab; und  
ein gleitendes Element (70B-1),  
wobei sich der leitende Stab durch ein Loch des gleitenden Elements so erstreckt, dass eine Endoberfläche des leitenden Stabs und eine Oberfläche des gleitenden Elements gemeinsam eine Kontaktfläche für gleitende Kontaktbildung mit dem Blattband (10A) bilden.
5. Windkraftanlage nach Anspruch 4, wobei das gleitende Element (70B-1) einen abgeschrägten Rand aufweist.
6. Windkraftanlage nach einem der Ansprüche 1 - 5, wobei die zweite Kontaktvorrichtung (30B) Folgendes umfasst:
- ein zweites Befestigungselement (30B-1), das an einem Ende an einer Stirnplatte (30A) der Gondel (30) befestigt ist und dabei daraus vorsteht;  
ein zweites elastisches nichtleitendes Profil (30B-2), das an einem Ende an einem anderen Ende des zweiten Befestigungselements (30B-1) befestigt ist;  
ein zweites Kontaktelement, das an dem zweiten elastischen nichtleitenden Profil (30B-1) befestigt ist,  
wobei die zweite Kontaktvorrichtung (30B) so ausgelegt ist, dass das Kontaktelement zum Blitzring (80) zeigt und das zweite elastische nichtleitende Profil (30B-2) das zweite Kontaktelement gegen den Blitzring (80) drückt.
7. Windkraftanlage nach Anspruch 3 und 6, wobei das erste elastische nichtleitende Profil (70C) die gleiche Struktur aufweist wie das zweite elastische nichtleitende Profil (30B-2), so dass diese Elemente untereinander austauschbar sind.
8. Windkraftanlage nach Anspruch 7, wobei das erste Kontaktelement (70B) die gleiche Struktur aufweist wie das zweite Kontaktelement, so dass diese Elemente untereinander austauschbar sind.
9. Windkraftanlage nach einem der vorstehenden Ansprüche, umfassend mindestens zwei zweite Kontaktvorrichtungen (30B), vorzugsweise vier zweite Kontaktvorrichtungen (30B).
10. Windkraftanlage nach einem der Ansprüche 3 - 9, wobei das erste Befestigungselement (70A) Folgendes umfasst:
- eine Glasfaserkonsole, die als Befestigungshalterung für das erste elastische nichtleitende Profil (70C) wirkt; und  
eine Abdeckung zum Schützen des ersten Kontaktelements (70B).
11. Windkraftanlage nach einem der Ansprüche 7 - 10, wobei das zweite Befestigungselement (30B-1) eine Edelstahlhalterung ist.
12. Windkraftanlage nach einem der Ansprüche 3 - 11, wobei das erste elastische nichtleitende Profil (70C) und/oder das zweite elastische nichtleitende Profil (30B-2) ein Gasfaserprofil ist.
13. Windkraftanlage nach Anspruch 1, wobei die Gondel (30) eine Inspektionsluke zur Vor-Ort-Inspektion des Blitzrings (80) einschließt.

#### Revendications

1. Éolienne (W) possédant un moyeu (20) soutenu de manière rotative par rapport à un générateur dans une nacelle (30), une pluralité de pales (10) reliées de façon pivotante au moyeu (20) et un système de transfert de courant de foudre (100), dans laquelle le moyeu (20) est couvert par un carénage (20A), le système de transfert de courant de foudre comprenant  
une bande de pale (10A) montée sur un pied de la pale (10) ;  
un anneau parafoudre (80) monté sur le carénage (20A) faisant face à la nacelle (30) ;  
un premier dispositif de contact (70) monté sur le carénage (20A) pour fournir un transfert de courant de foudre à partir de la bande de pale (10A) ;  
un dispositif de connexion (75) connectant le premier dispositif de contact (70) à l'anneau parafoudre (80) ;  
et  
un second dispositif de contact (30B) monté sur la nacelle (30) pour fournir un transfert de courant de foudre à partir de l'anneau parafoudre (80) ;  
dans laquelle le moyeu (20) a une extension radiale (D1) de telle sorte que la bande de pale (10A) tourne à l'extérieur d'un périmètre de la nacelle (30).
2. Éolienne selon la revendication 1, dans laquelle :
- la bande de pale (10A) et le premier dispositif de contact (70) sont montés à l'extérieur du ca-

- rénage (20A) ; et  
le dispositif de connexion (75) est monté à l'intérieur du carénage (20A).
3. Éolienne selon la revendication 1 ou la revendication 2, dans laquelle le premier dispositif de contact (70) comprend :
- un premier élément de montage (70A) monté sur le carénage (20A) ;  
un premier profilé non conducteur élastique (70C) monté sur le premier élément de montage (70A) ; et  
un premier élément de contact (70B) monté au niveau du premier profilé non conducteur élastique (70C) ;  
dans laquelle le premier dispositif de contact (70) est configuré de telle sorte que le premier élément de contact (70B) fait face à la bande de pale (10A) et que le premier profilé non conducteur élastique (70C) pousse le premier élément de contact (70B) contre la bande de pale (10A).
4. Éolienne selon la revendication 3, dans laquelle le premier élément de contact (70B) comprend :
- une tige conductrice ; et  
un élément coulissant (70B-1),  
dans laquelle la tige conductrice s'étend à travers un trou de l'élément coulissant de telle sorte qu'une surface d'extrémité de la tige conductrice et une surface de l'élément coulissant forment collectivement une zone de contact pour mettre en contact de manière coulissante la bande de pale (10A).
5. Éolienne selon la revendication 4, dans laquelle l'élément coulissant (70B-1) a un bord chanfreiné.
6. Éolienne selon l'une quelconque des revendications 1 à 5, dans laquelle le second dispositif de contact (30B) comprend :
- un second élément de montage (30B-1) monté au niveau d'une extrémité sur une plaque avant (30A) de la nacelle (30) faisant ainsi saillie à partir de celle-ci ;  
un second profilé non conducteur élastique (30B-2) monté à une extrémité sur une autre extrémité du second élément de montage (30B-1) ;  
un second élément de contact monté au niveau du second profilé non conducteur élastique (30B-1),  
dans laquelle le second dispositif de contact (30B) est configuré de telle sorte que l'élément de contact fait face à l'anneau parafoudre (80) et que le second profilé non conducteur élastique (30B-2) pousse le second élément de contact contre l'anneau parafoudre (80).
7. Éolienne selon la revendication 3 et 6, dans laquelle le premier profilé non conducteur élastique (70C) a la même structure que le second profilé non conducteur élastique (30B-2) de telle sorte que ces éléments sont interchangeables.
8. Éolienne selon la revendication 7, dans laquelle le premier élément de contact (70B) a la même structure que le second élément de contact de telle sorte que ces éléments sont interchangeables.
9. Éolienne selon l'une quelconque des revendications précédentes comprenant au moins deux seconds dispositifs de contact (30B), de préférence quatre seconds dispositifs de contact (30B).
10. Éolienne selon l'une quelconque des revendications 3 à 9, dans laquelle le premier élément de montage (70A) comprend :
- une console en fibre de verre faisant office de support de fixation du premier profilé non conducteur élastique (70C) ; et  
une enveloppe pour protéger le premier élément de contact (70B).
11. Éolienne selon l'une quelconque des revendications 7 à 10, dans laquelle le second élément de montage (30B-1) est un support en acier inoxydable.
12. Éolienne selon l'une quelconque des revendications 3 à 11, dans laquelle le premier profilé non conducteur élastique (70C) et/ou le second profilé non conducteur élastique (30B-2) est un profilé en fibre de verre.
13. Éolienne selon la revendication 1, dans laquelle la nacelle (30) inclut une trappe de visite pour une visite in situ de l'anneau parafoudre (80).

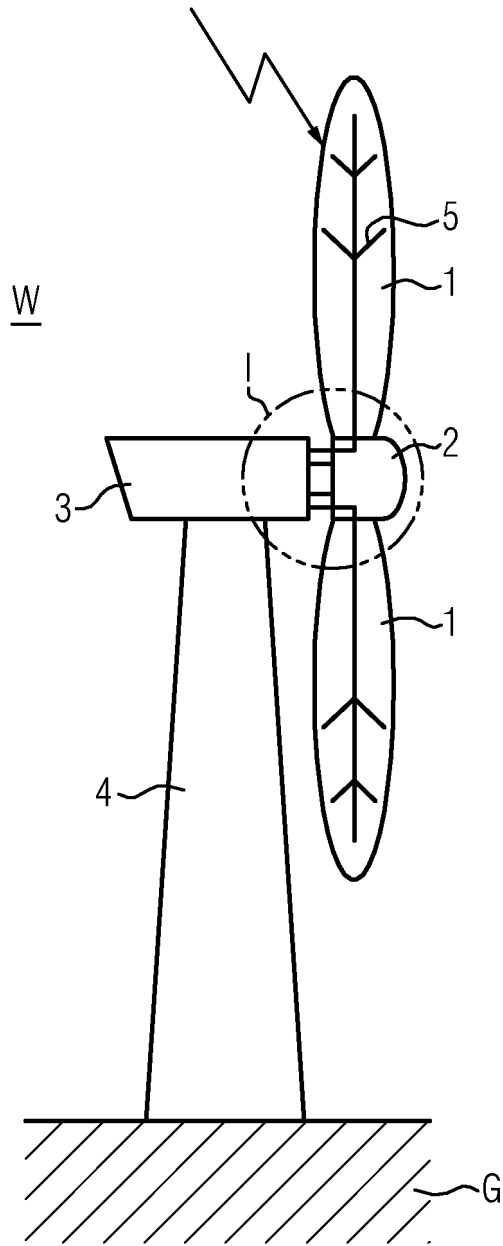
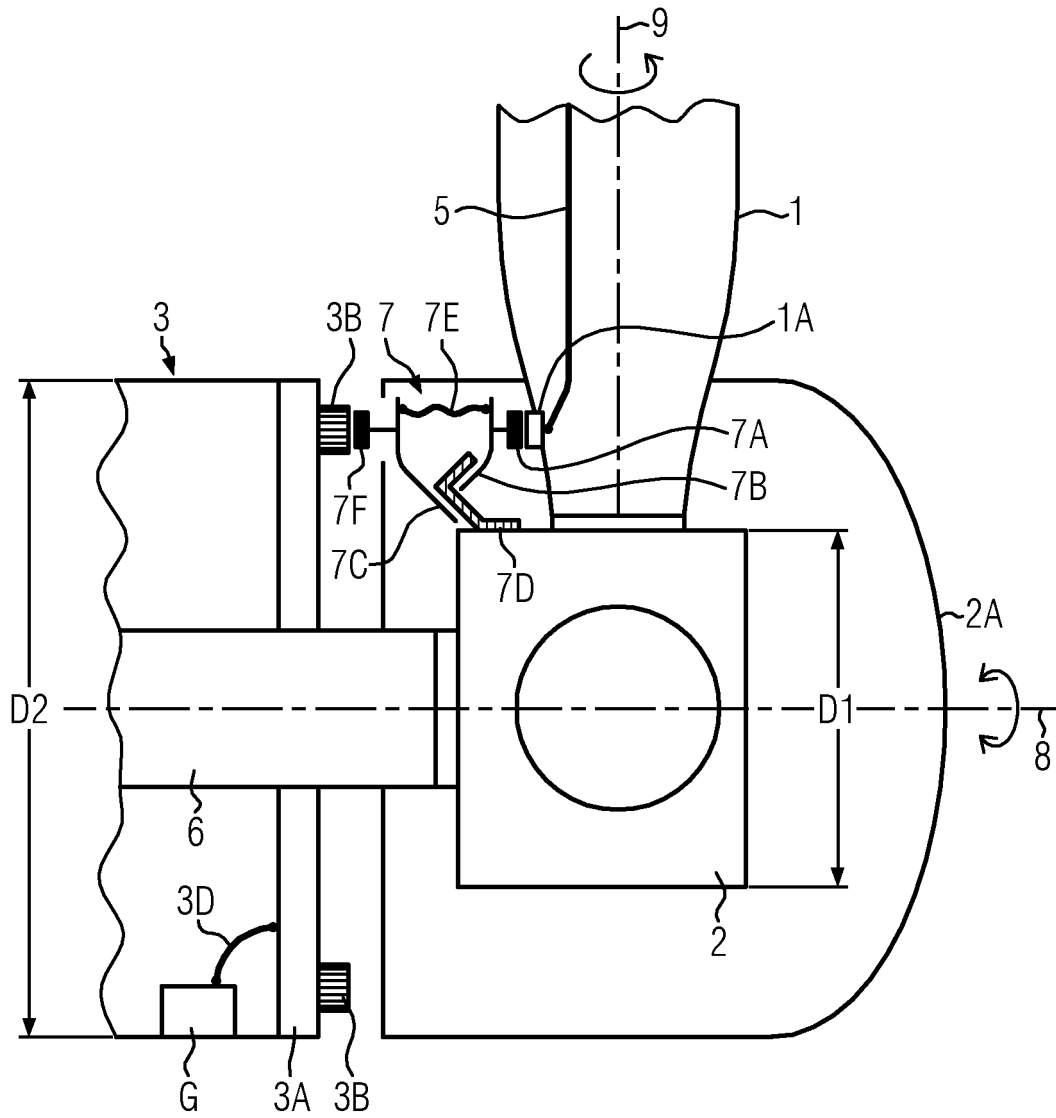

FIG. 1



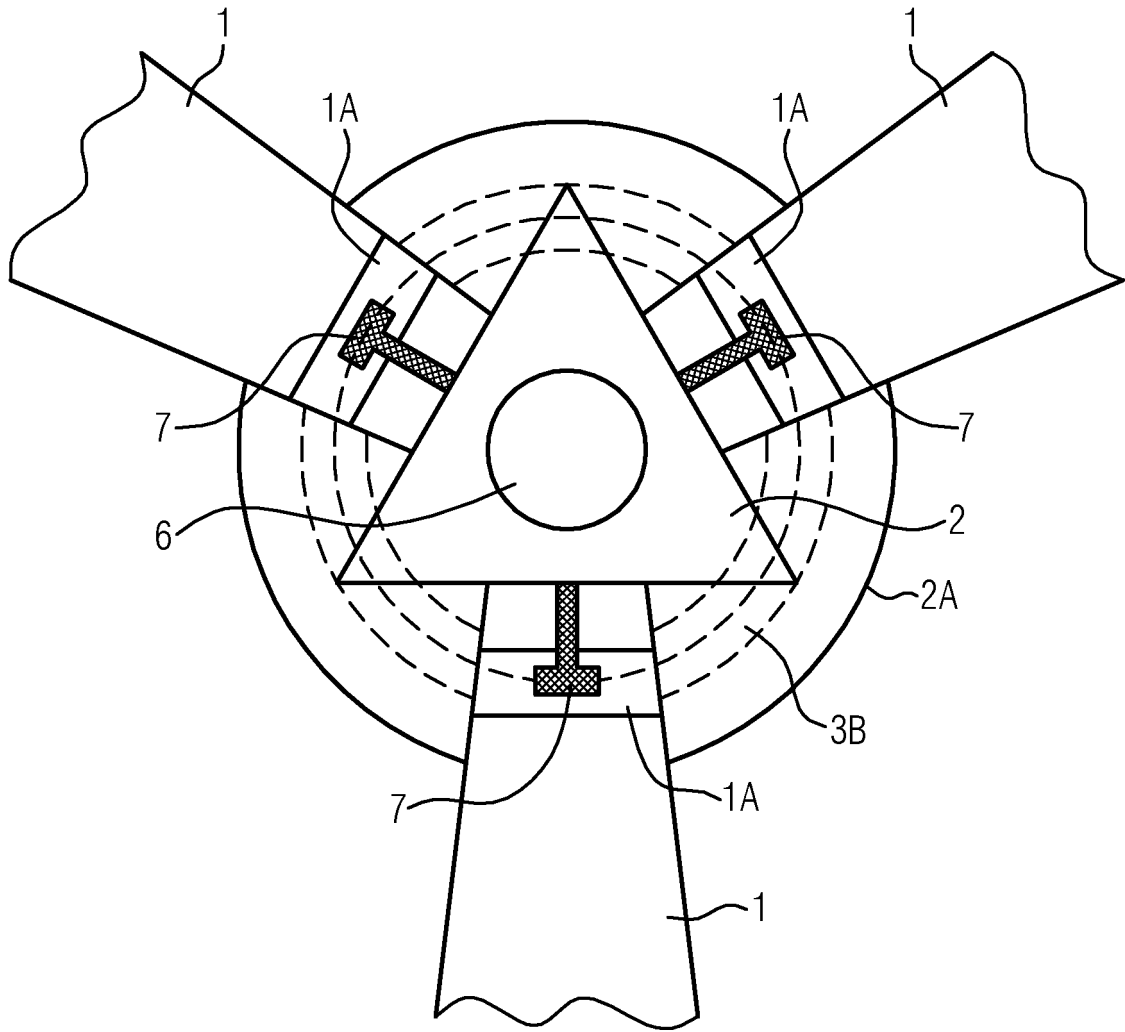
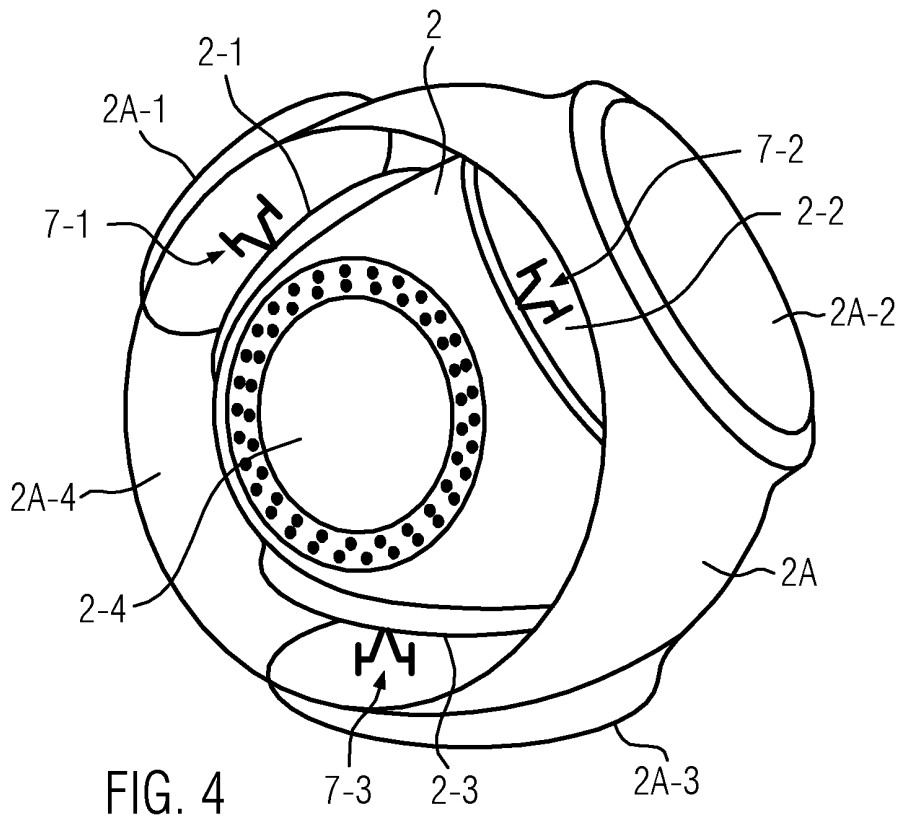
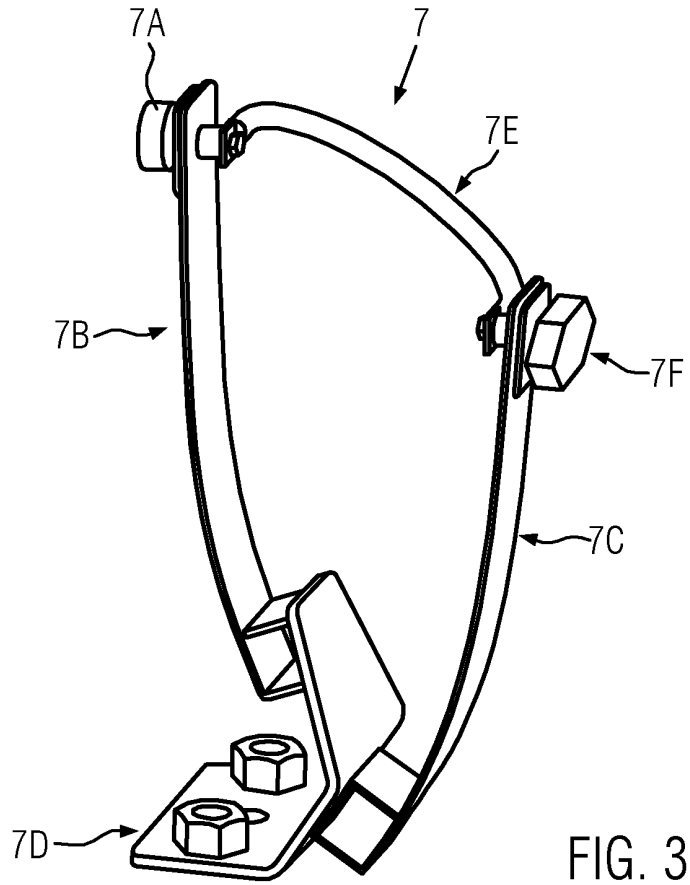

FIG. 2B



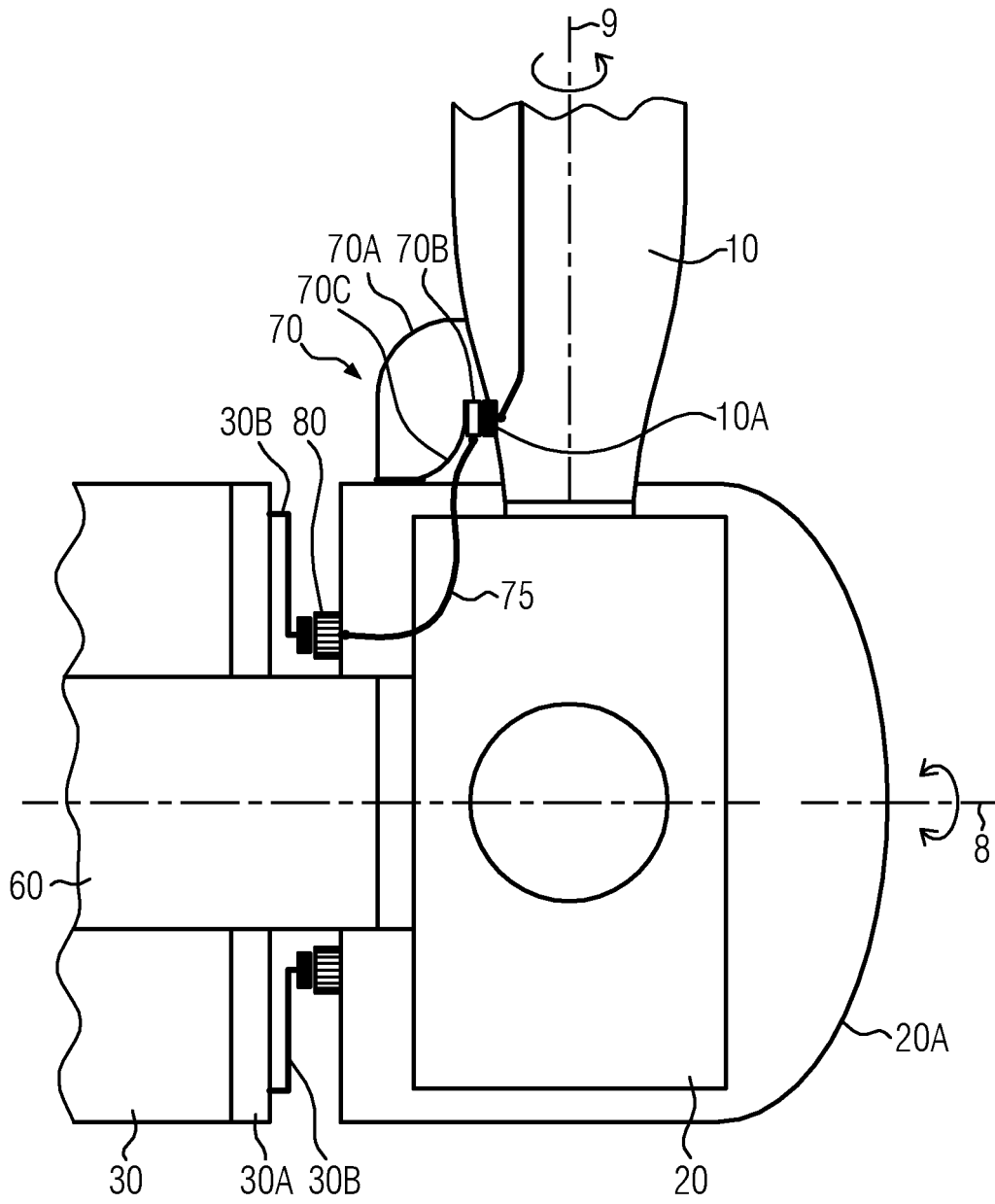

FIG. 5

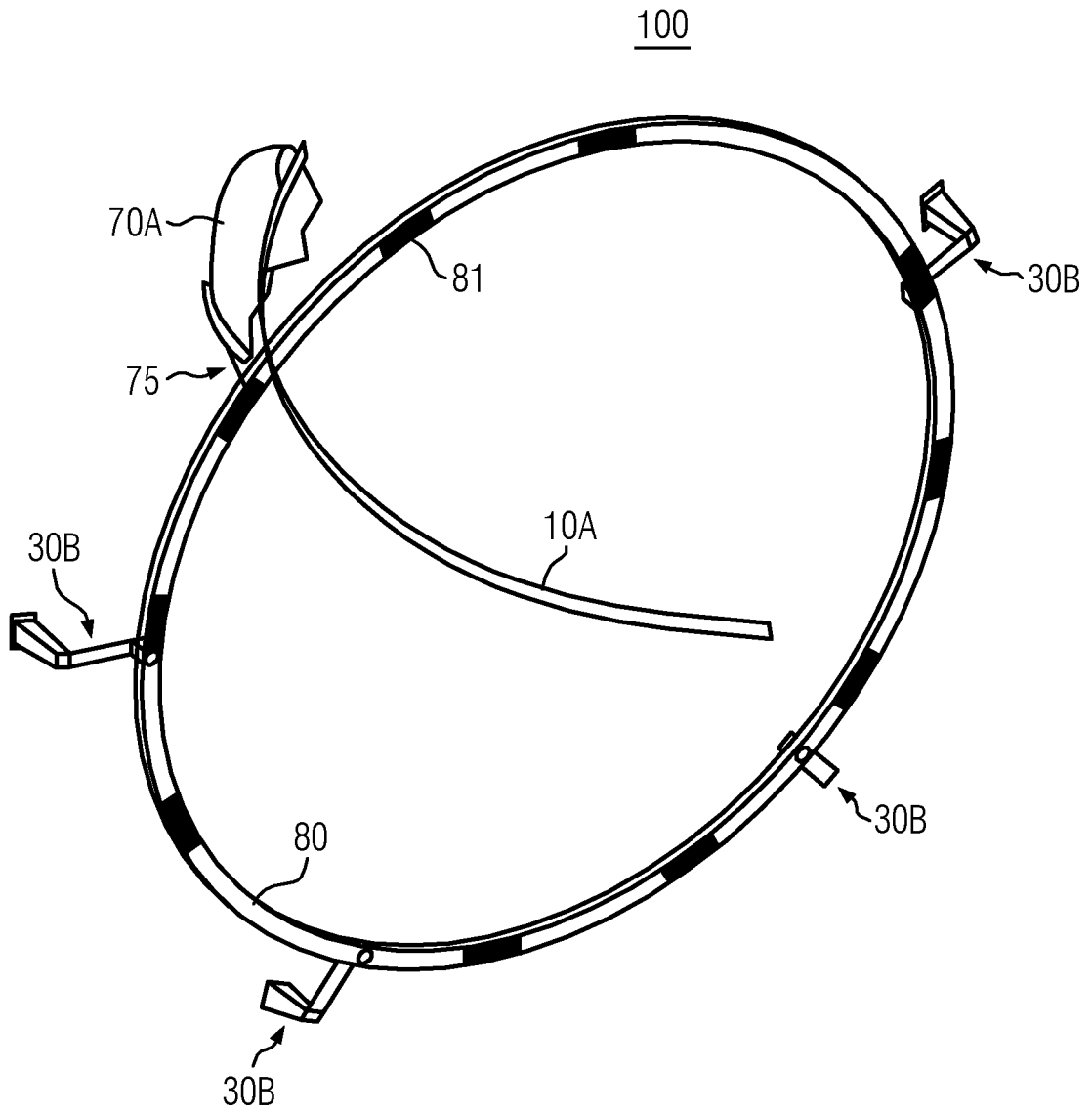

FIG. 6



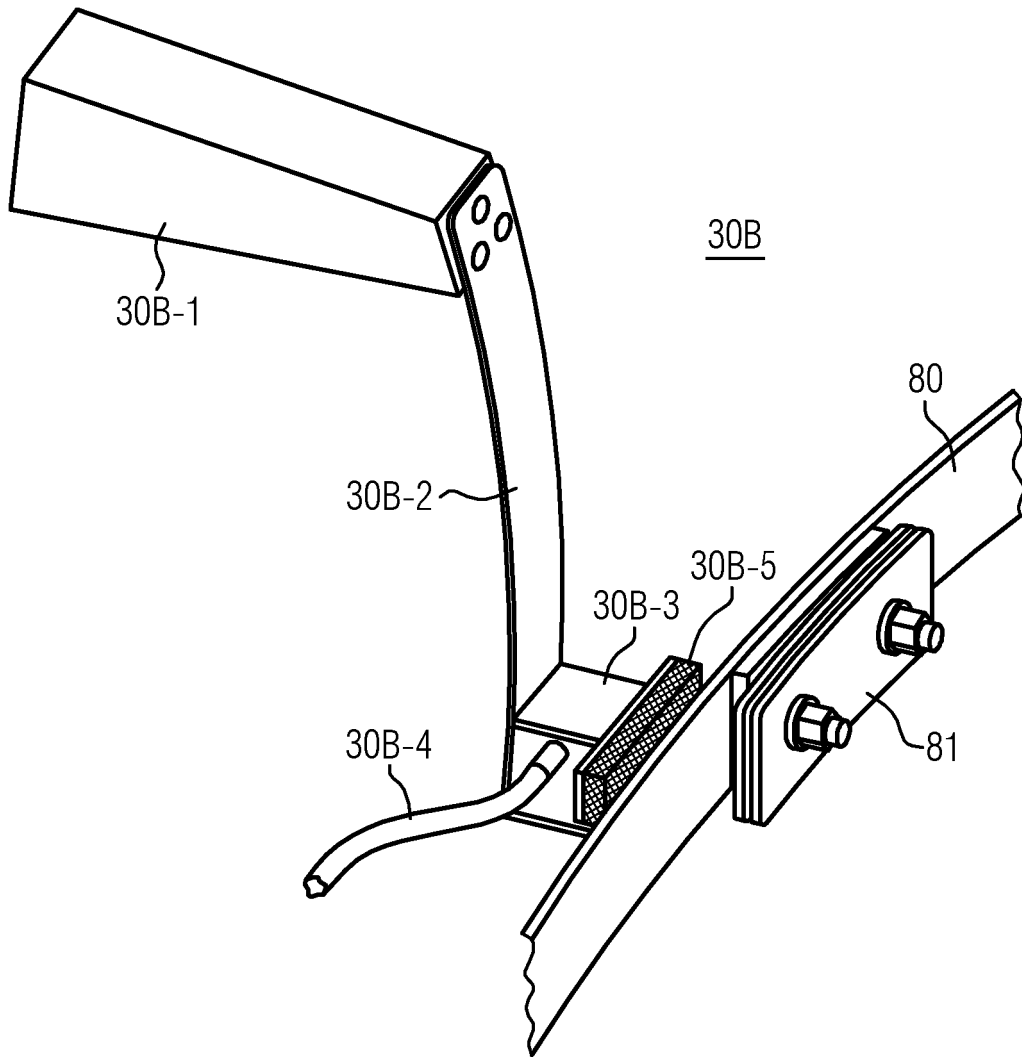

FIG. 7

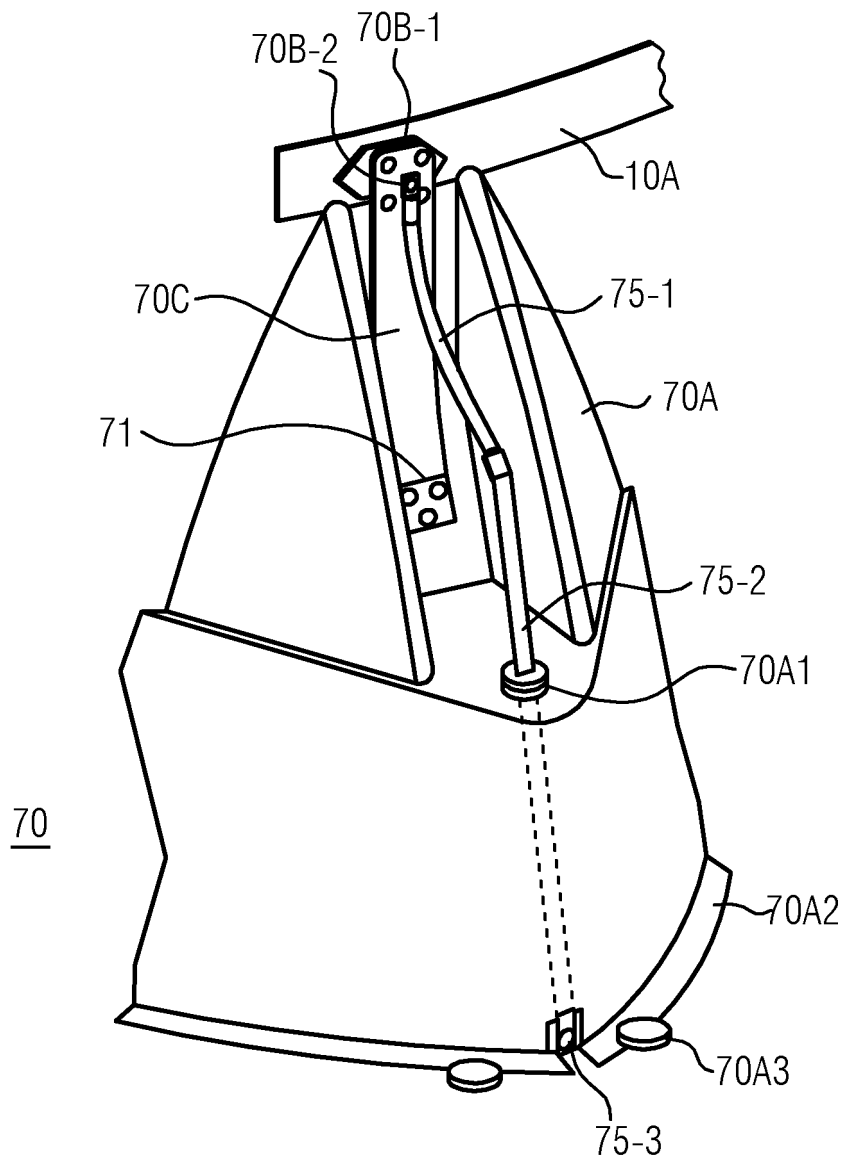

FIG. 8

**REFERENCES CITED IN THE DESCRIPTION**

*This list of references cited by the applicant is for the reader's convenience only. It does not form part of the European patent document. Even though great care has been taken in compiling the references, errors or omissions cannot be excluded and the EPO disclaims all liability in this regard.*

**Patent documents cited in the description**

- DE 4445899 [0003]
- DE 102004010104 [0003]
- JP 5060053 A [0004]
- WO 2005050008 A1 [0006]
- WO 200505008 A [0042]