

233,678

TOY CONSTRUCTION PIECE

Edward Henry Harvey, The Verne, Moor Common,
Lane End, England

Filed Sept. 12, 1972, Ser. No. 288,324

Claims priority, application Great Britain Mar. 16, 1972

Term of patent 14 years

Int. Cl. D21-01

U.S. Cl. D34-15 GG

FIG. 1

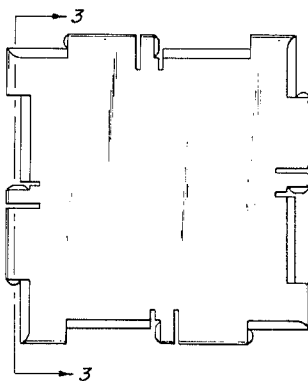

FIG. 2

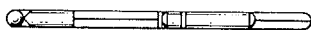

FIG. 3

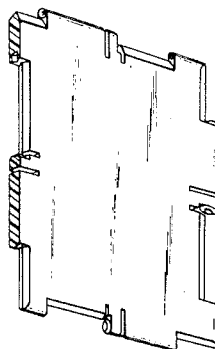

FIG. 1 is a top plan view of a toy construction piece showing my new design;

FIG. 2 is an elevational view thereof; and,

FIG. 3 is a perspective view thereof partially in section taken on line 3-3 of FIG. 1.

I claim:

The ornamental design for a toy construction piece, as shown.

References Cited

UNITED STATES PATENTS

2,776,521 1/1957 Zimmerman 46-30

FOREIGN PATENTS

914,264 1/1963 Great Britain 46-30
605,437 5/1960 Italy 46-31

JOEL STEARMAN, Primary Examiner

C. A. RADEMAKER, Assistant Examiner