



US 20210076572A1

(19) **United States**

(12) **Patent Application Publication**
Lam et al.

(10) **Pub. No.: US 2021/0076572 A1**

(43) **Pub. Date: Mar. 18, 2021**

(54) **A POWER TOOL AND A DRIVING MECHANISM FOR USE IN A POWER TOOL**

Publication Classification

(71) Applicant: **TTI (MACAO COMMERCIAL OFFSHORE) LIMITED**, Grande, Macau (CN)

(51) **Int. Cl.**
A01G 3/037 (2006.01)
A01G 3/033 (2006.01)

(72) Inventors: **Chin Hung Ricky Lam**, HK (CN); **Yu Wang**, Guangdong (CN); **Jeff Nesom**, Guangdong (CN)

(52) **U.S. Cl.**
CPC *A01G 3/037* (2013.01); *A01G 3/0255* (2013.01); *A01G 3/0335* (2013.01)

(21) Appl. No.: **16/612,007**

(57) **ABSTRACT**

(22) PCT Filed: **May 9, 2017**

A driving mechanism for use in a power tool and a power tool comprising the driving mechanism in connection with a motor and an operation member. The driving mechanism includes a sliding member arranged to drive the operation member, the sliding member is arranged to move between a first sliding position and a second sliding position along a longitudinal axis during an operation of the power tool so as to drive the operation member to move between a first operation position and a second operation position respectively.

(86) PCT No.: **PCT/CN2017/083573**

§ 371 (c)(1),
(2) Date: **Nov. 13, 2019**

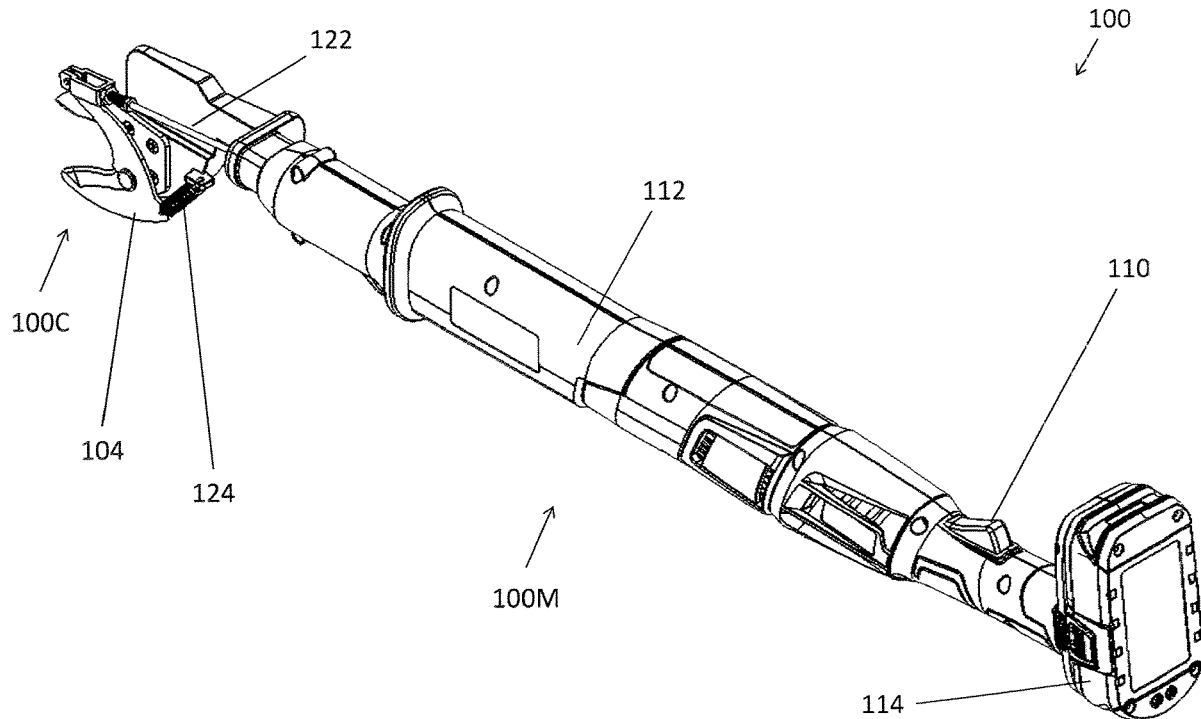

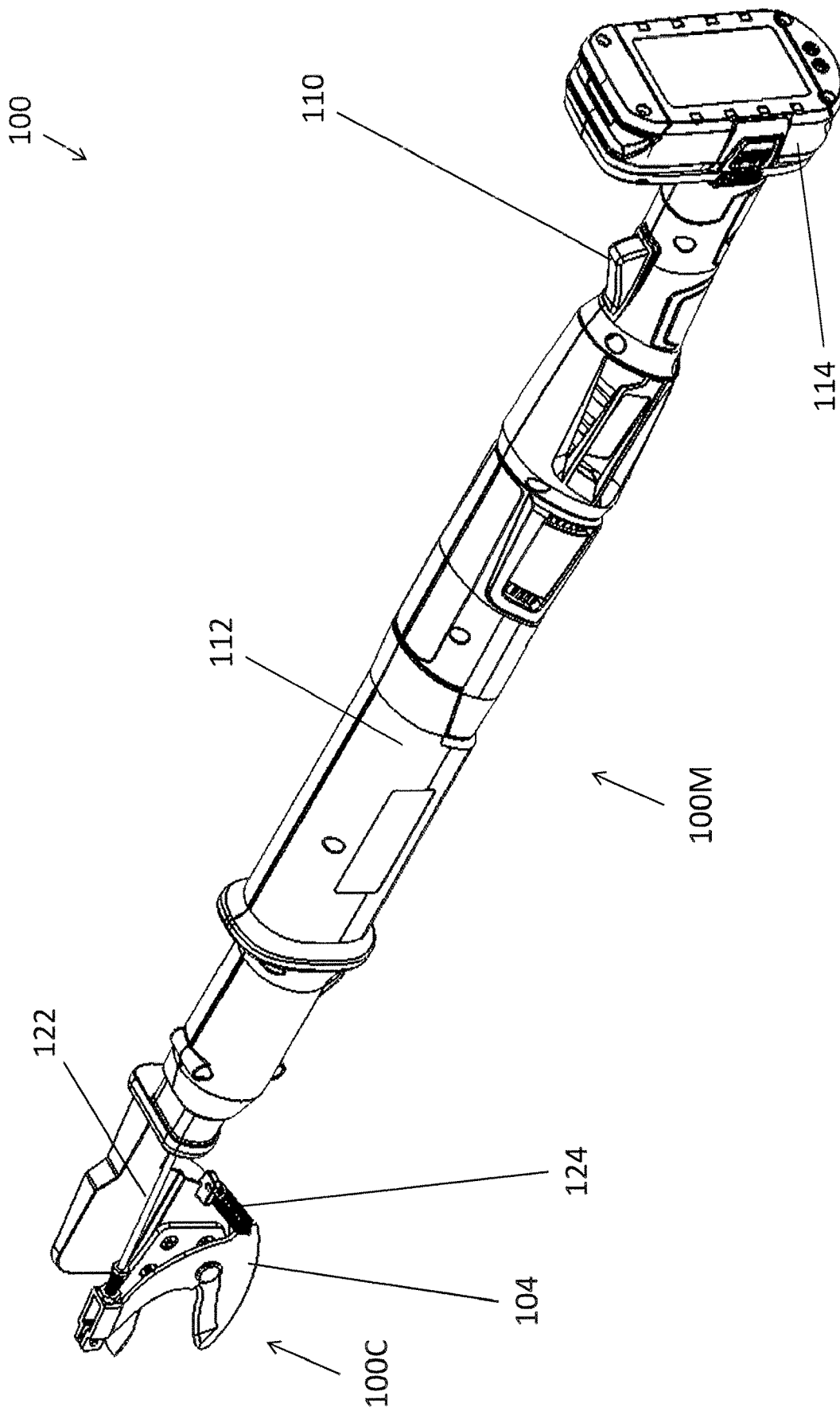

FIG. 1

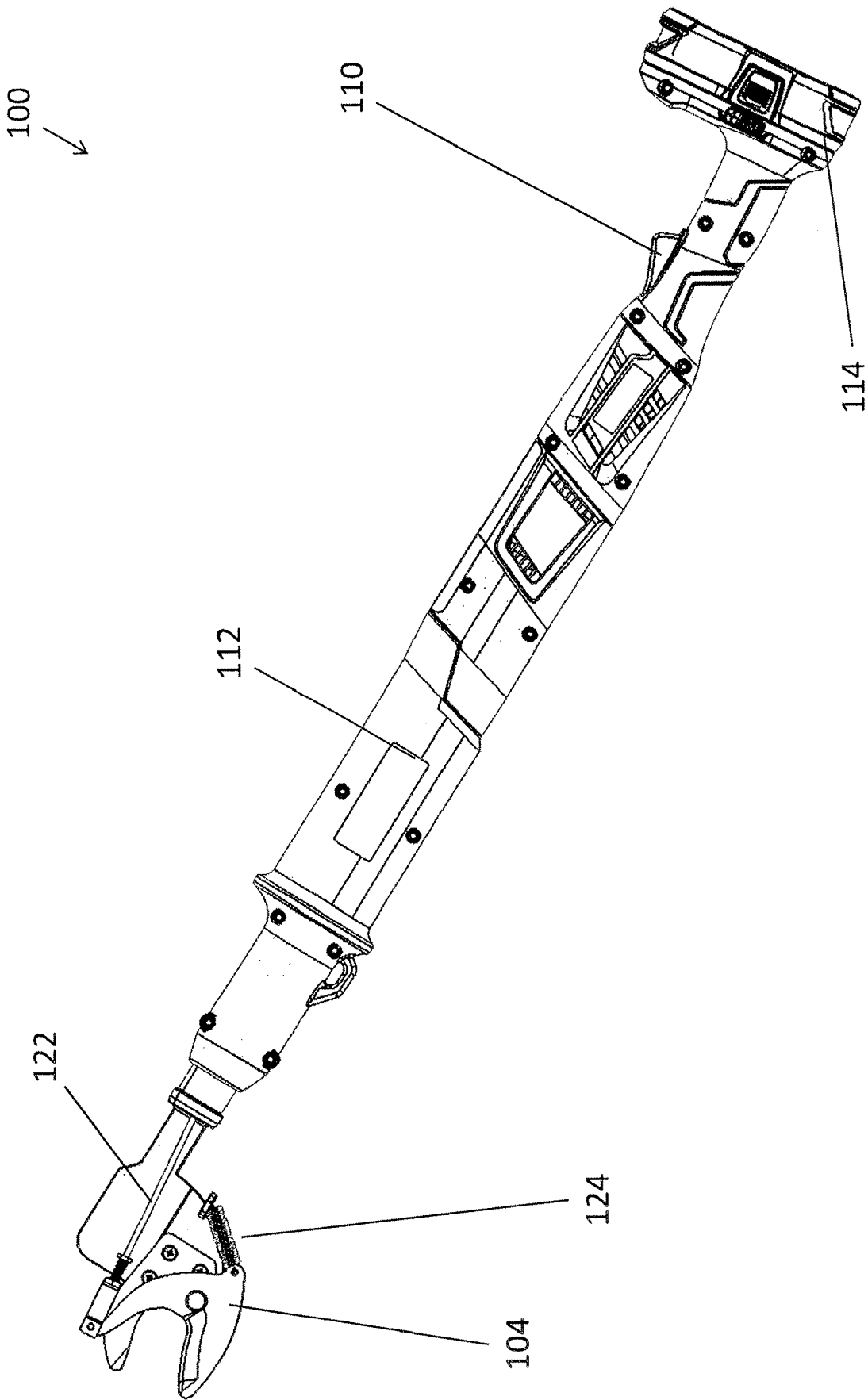

FIG. 2

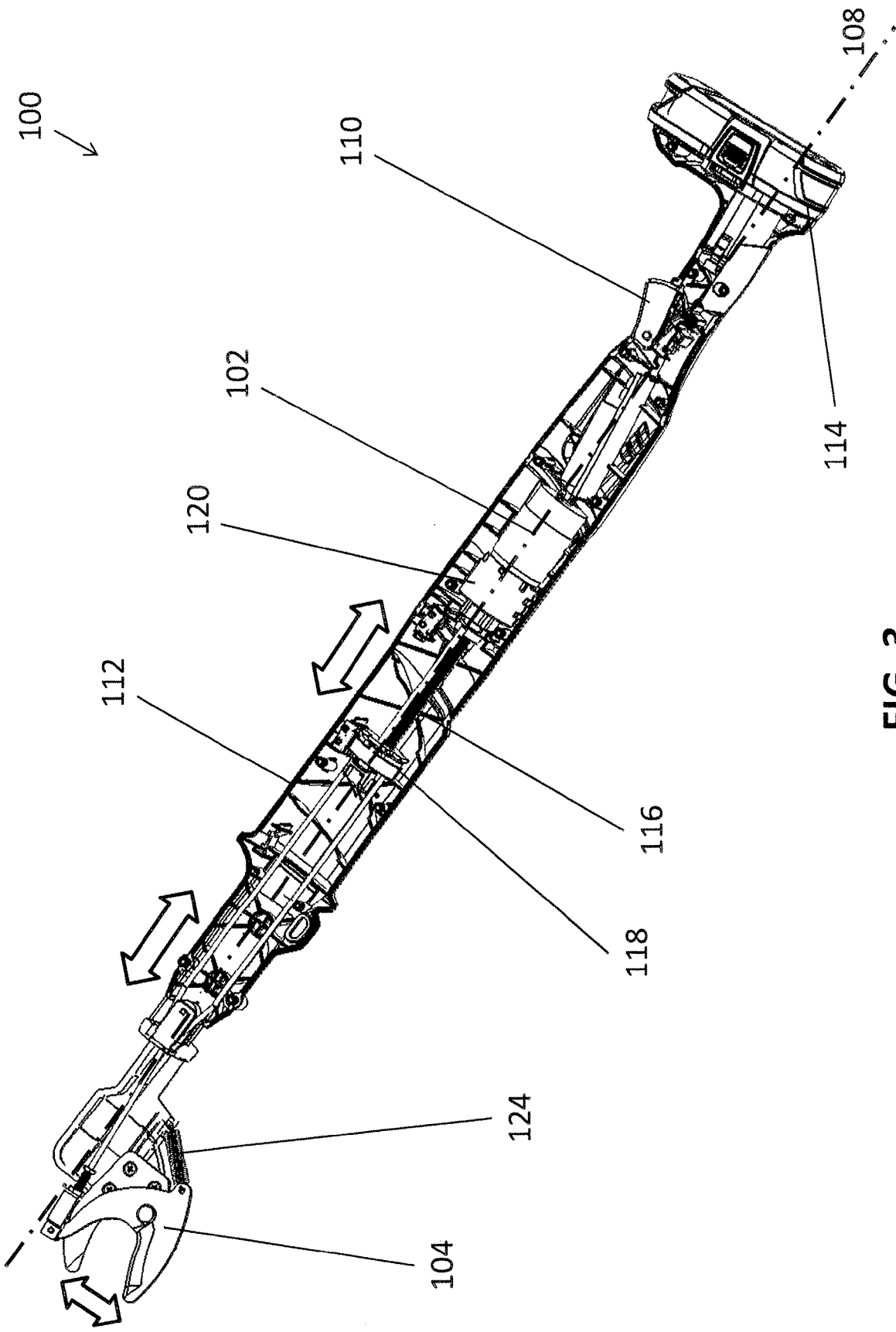

FIG. 3

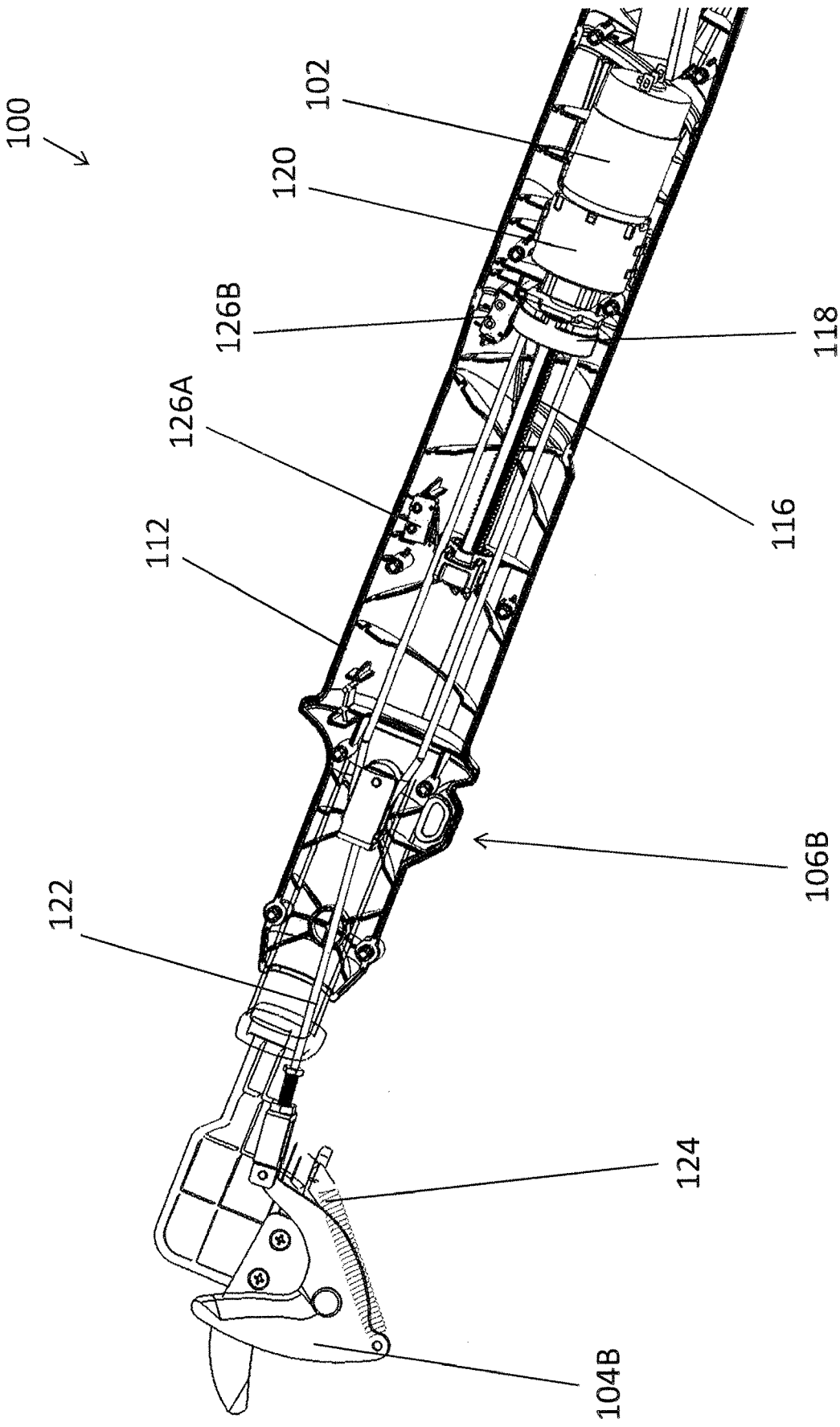

FIG. 4A

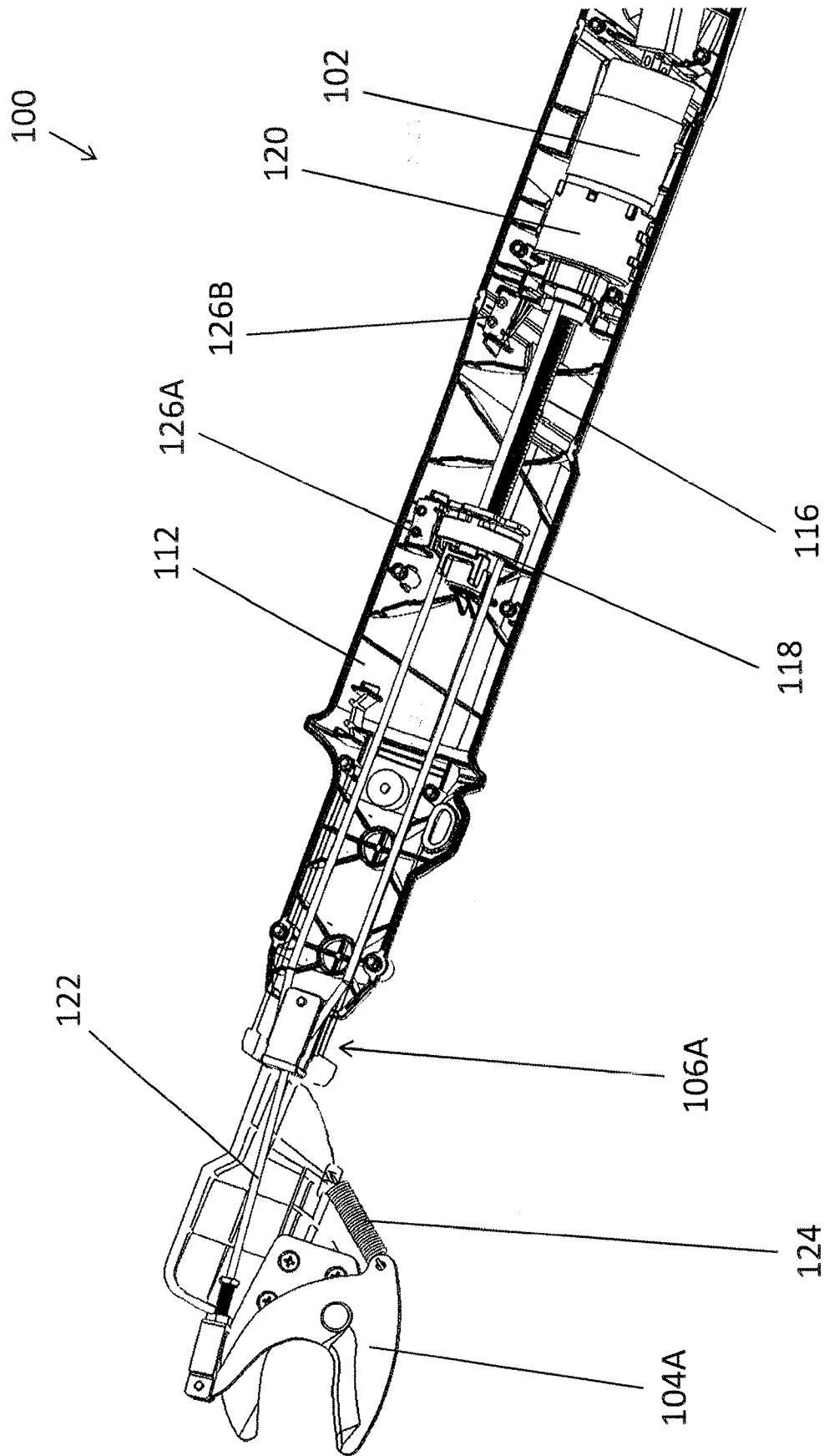

FIG. 4B

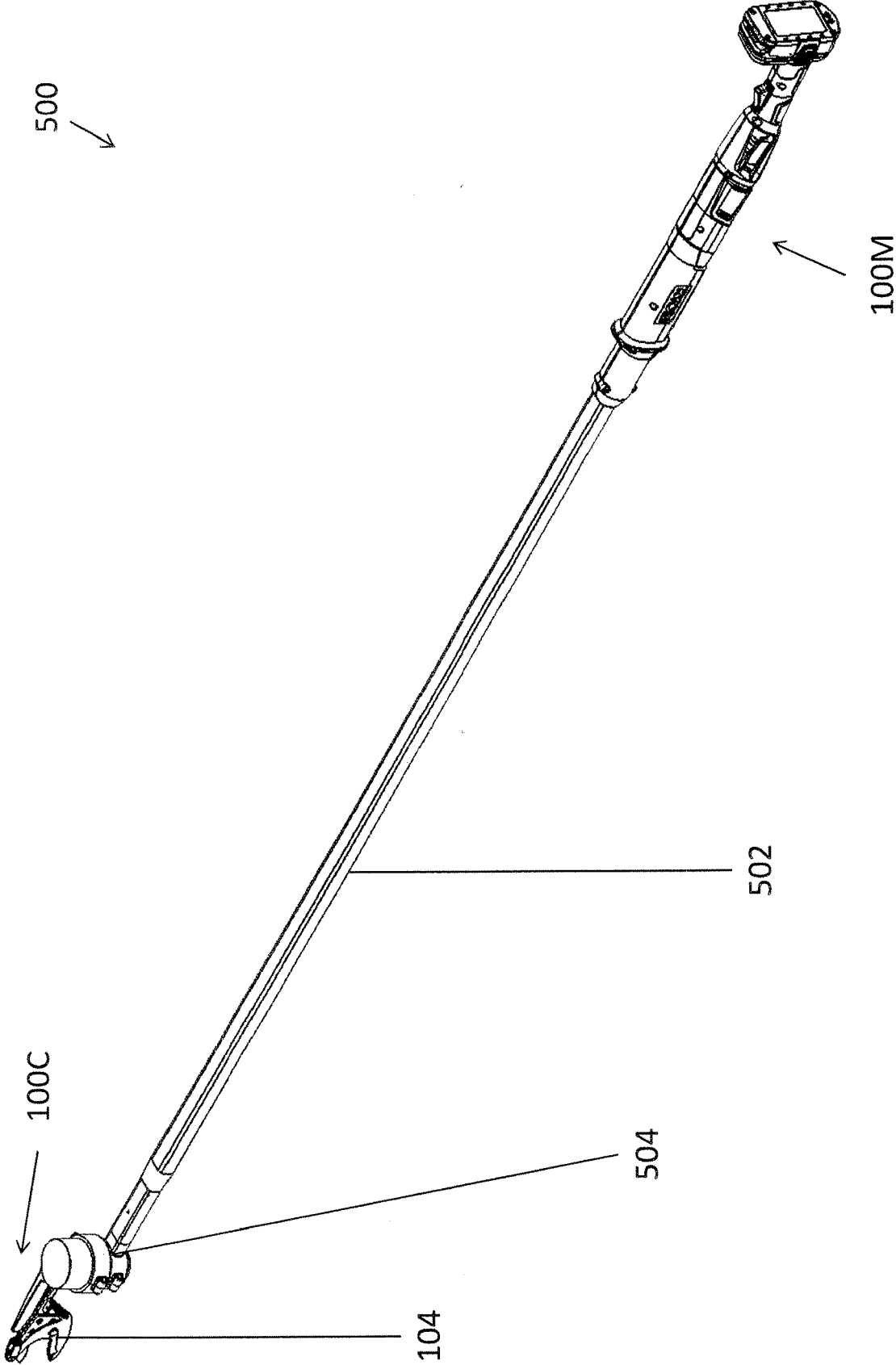

FIG. 5

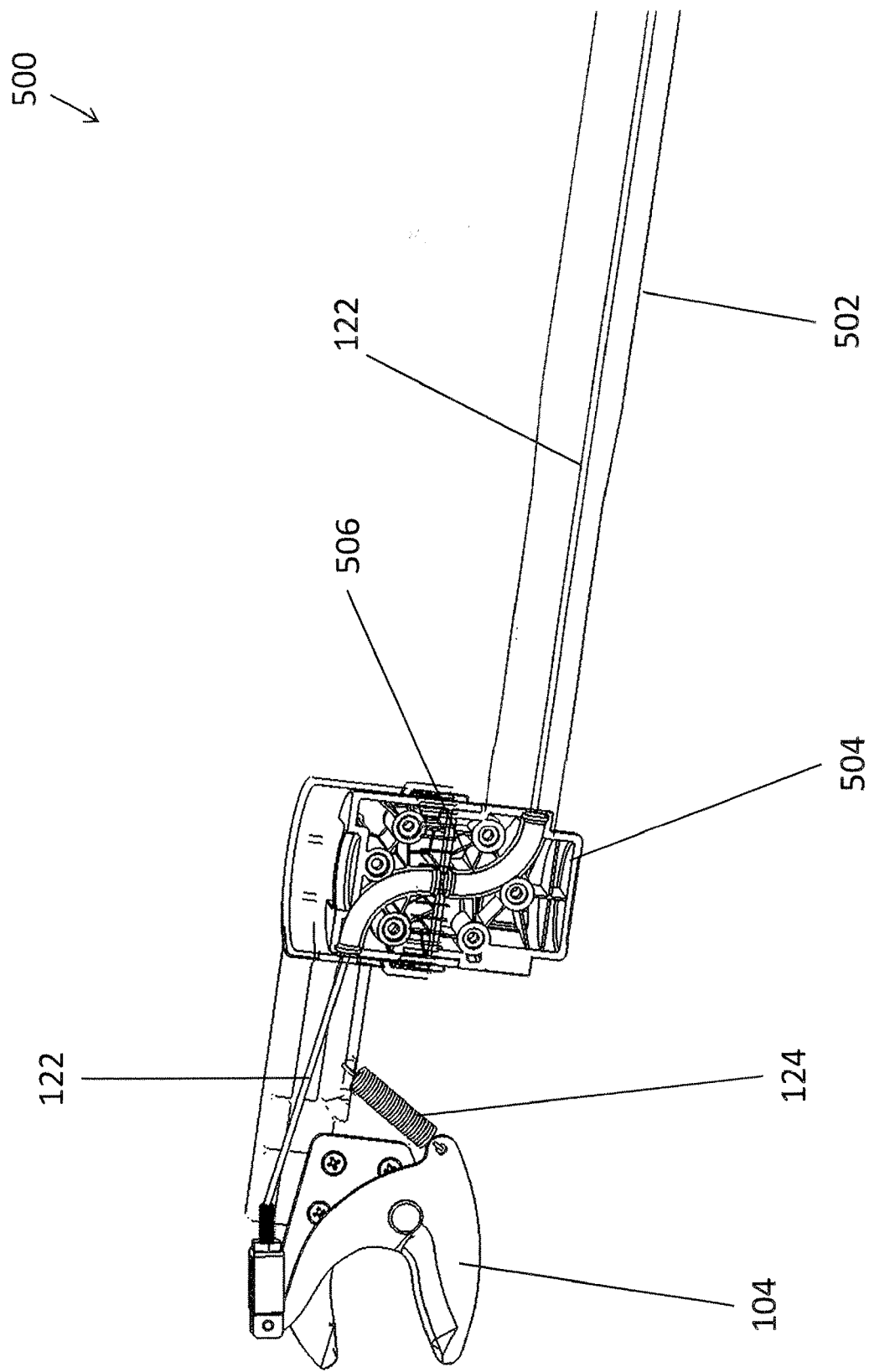

FIG. 6

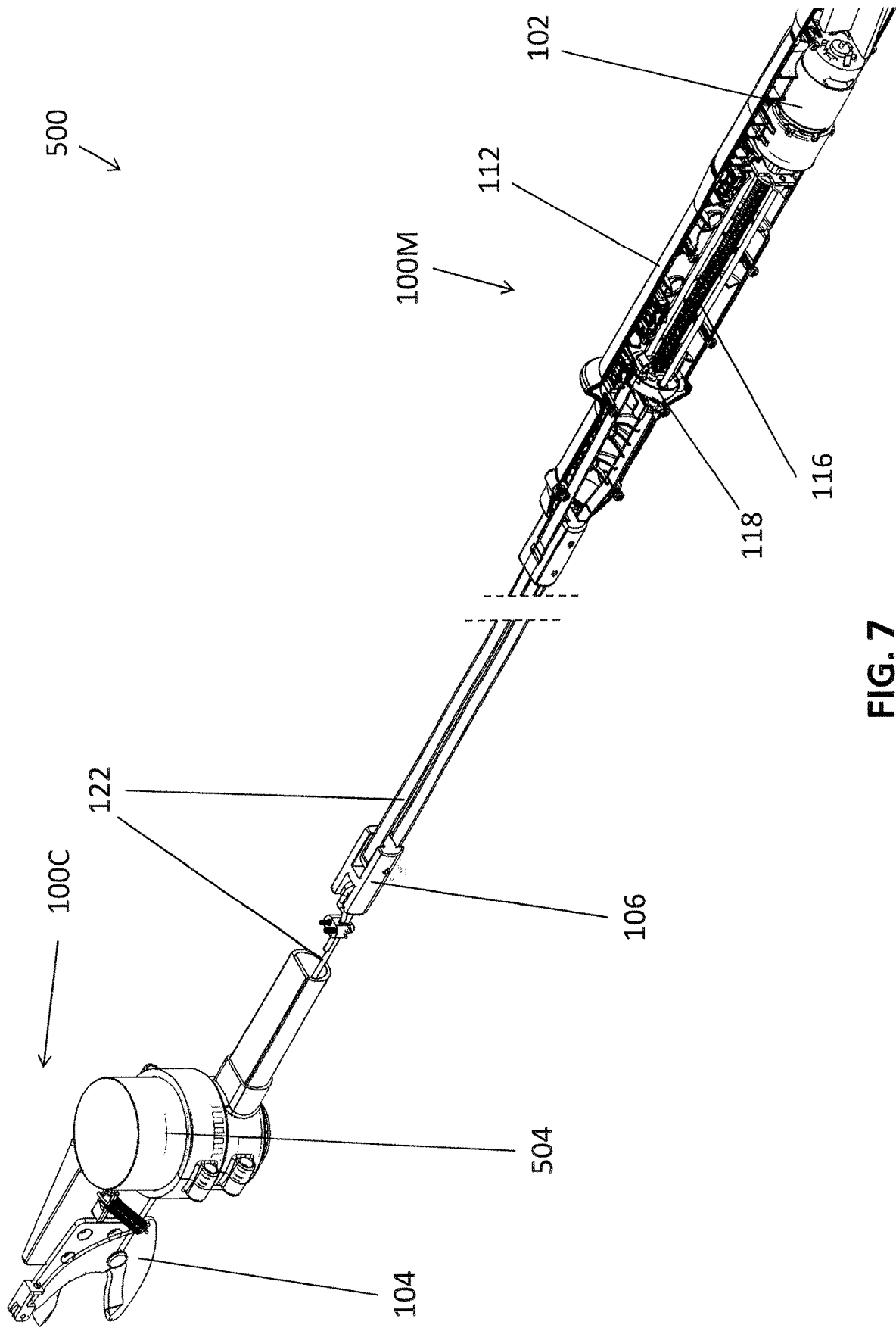

FIG. 7

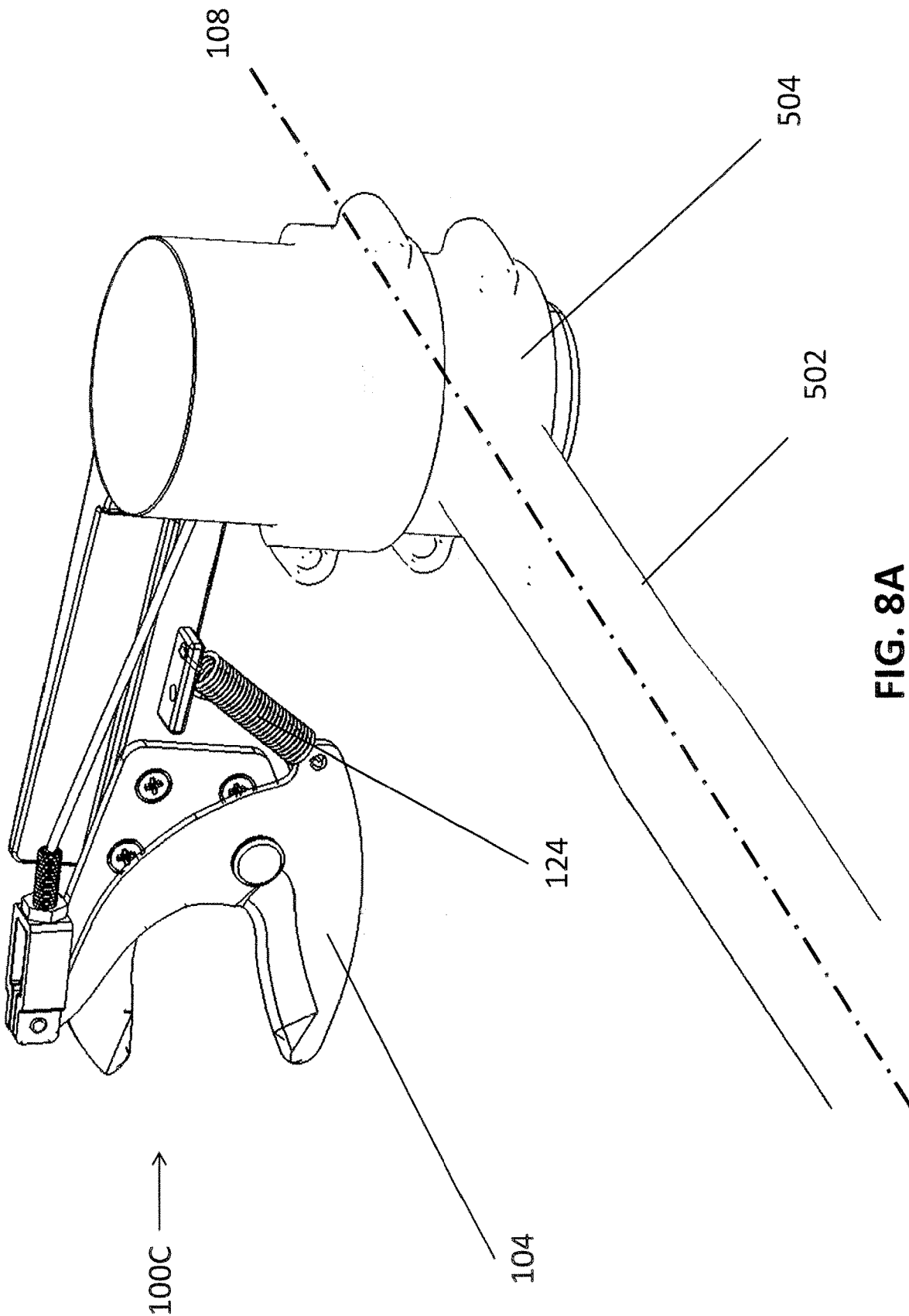

FIG. 8A

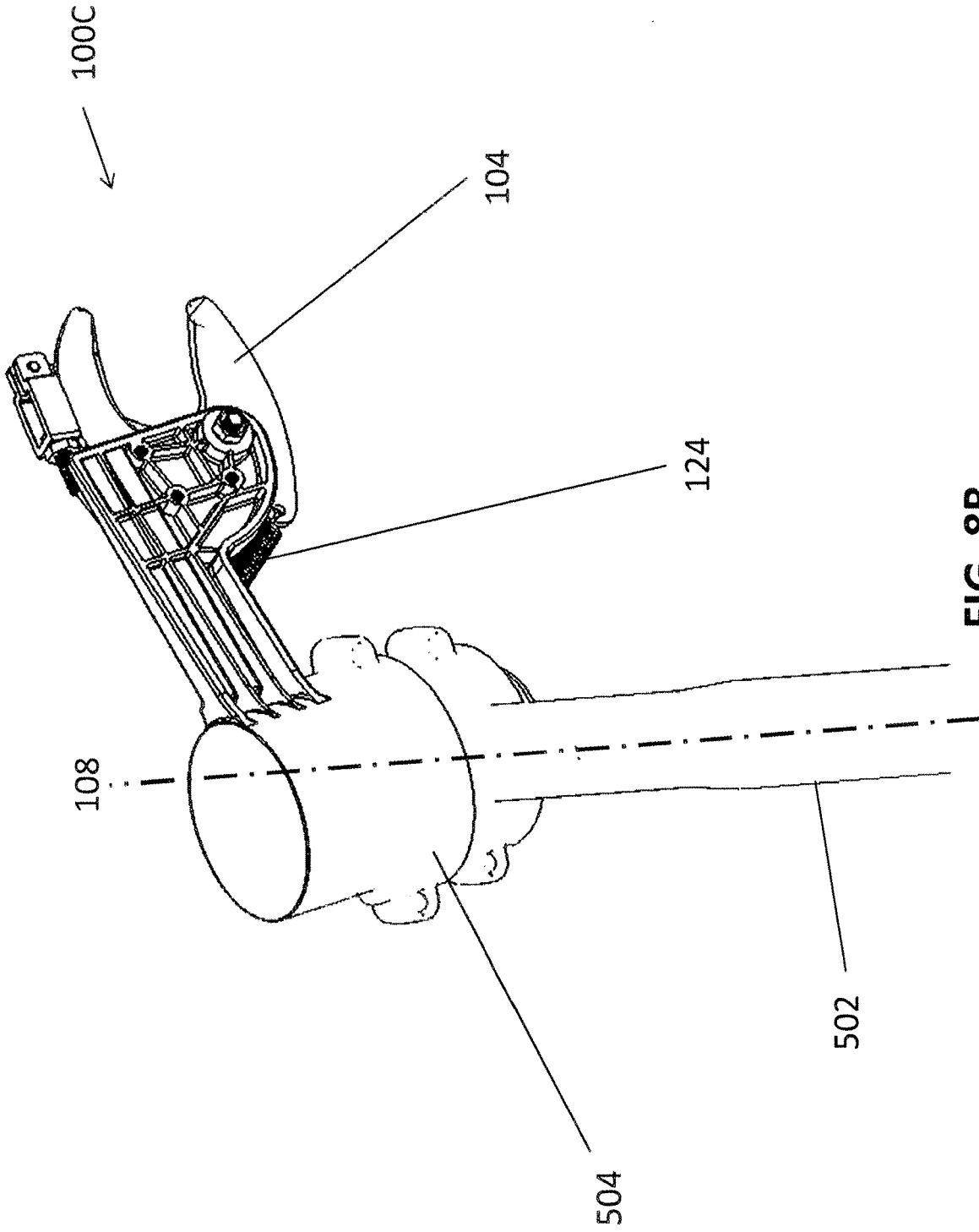

FIG. 8B

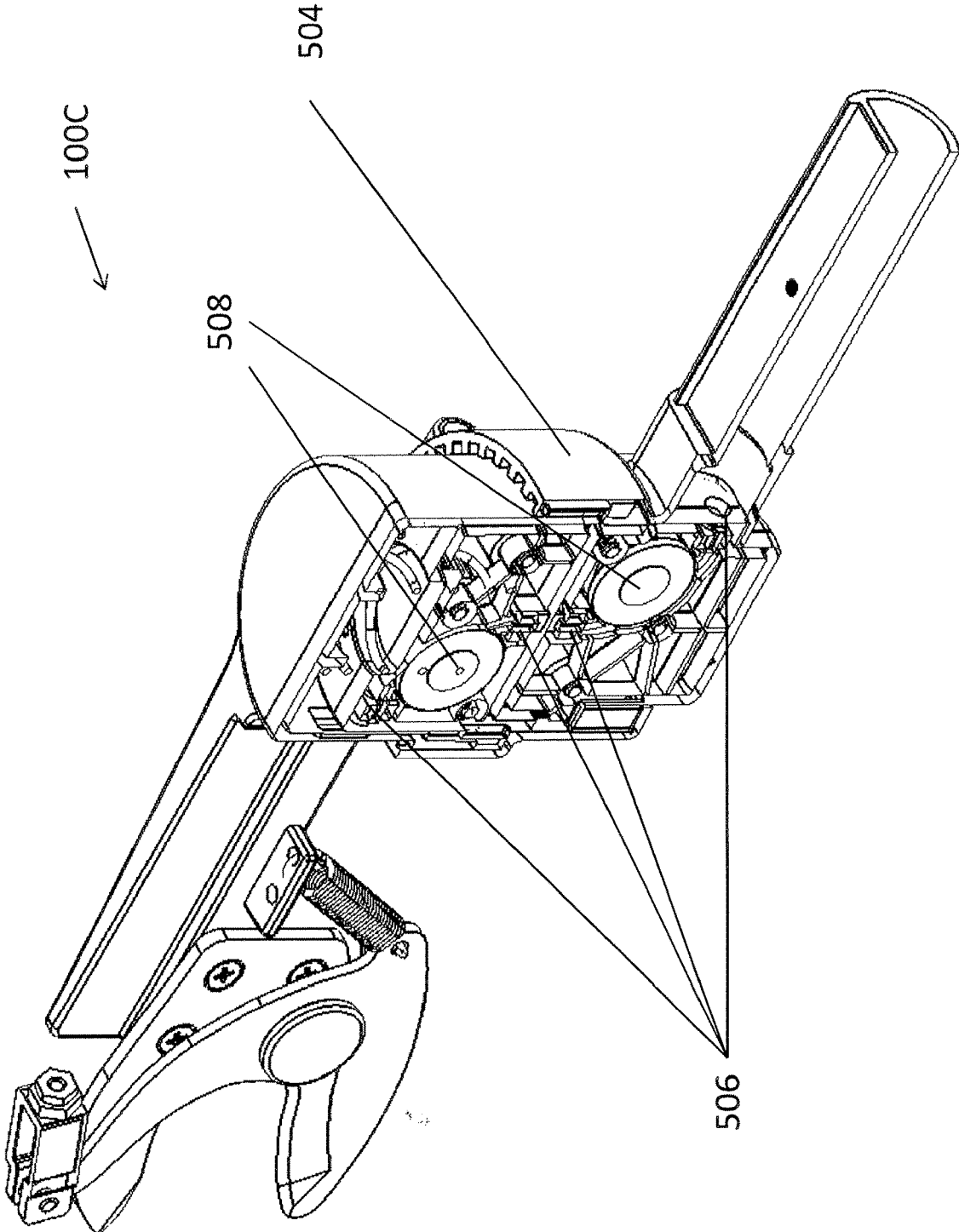

FIG. 9A

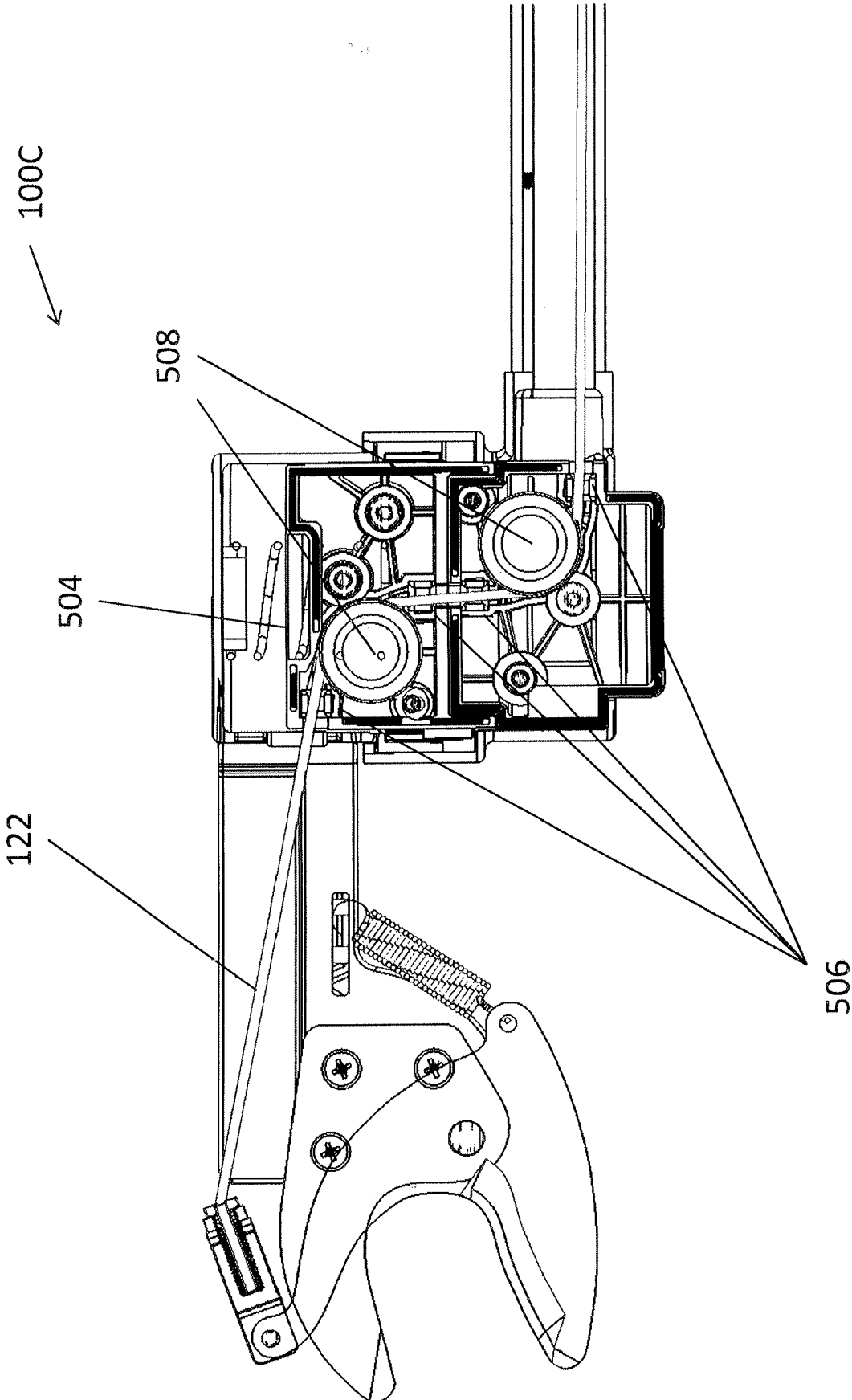

FIG. 9B

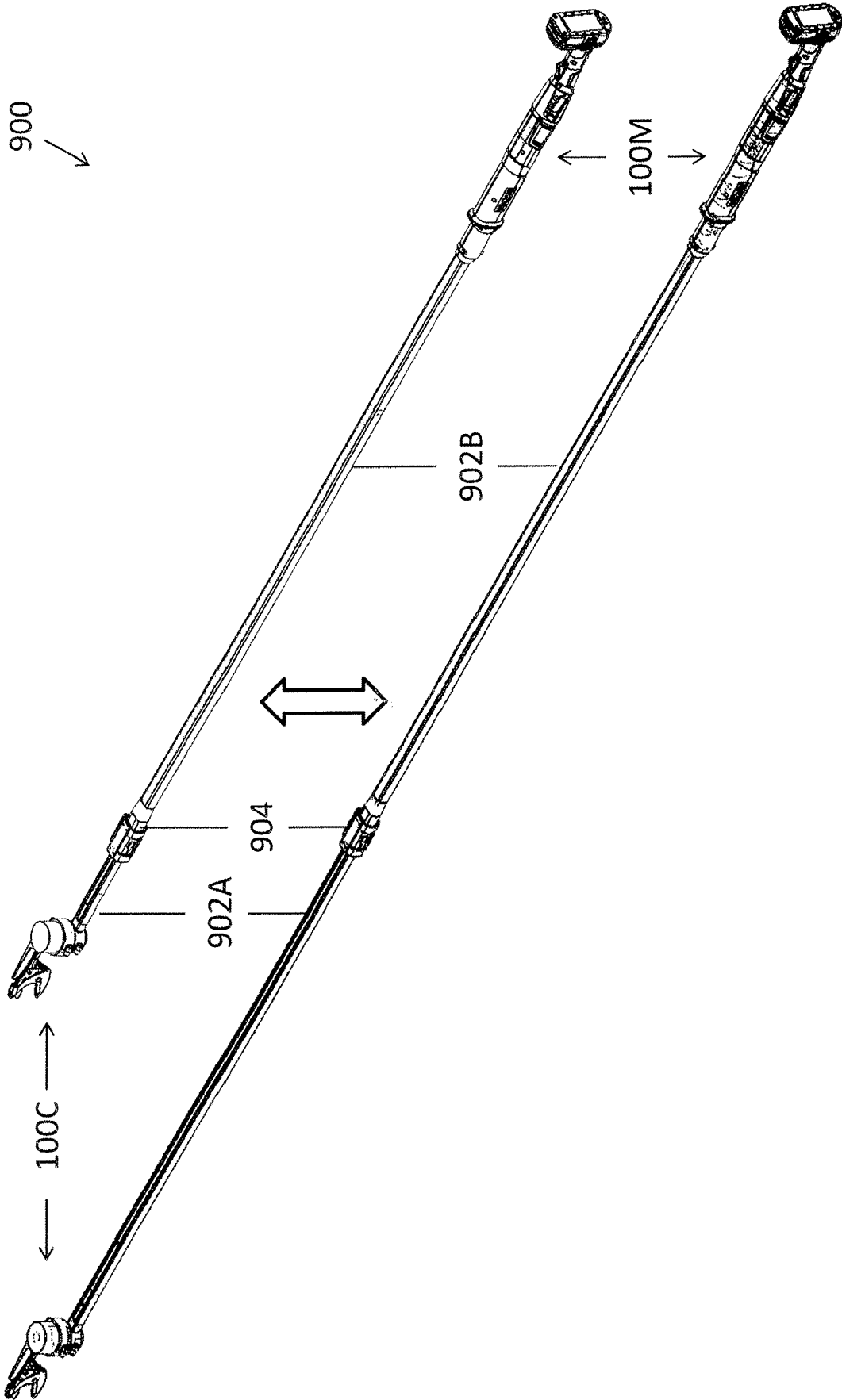

FIG. 10

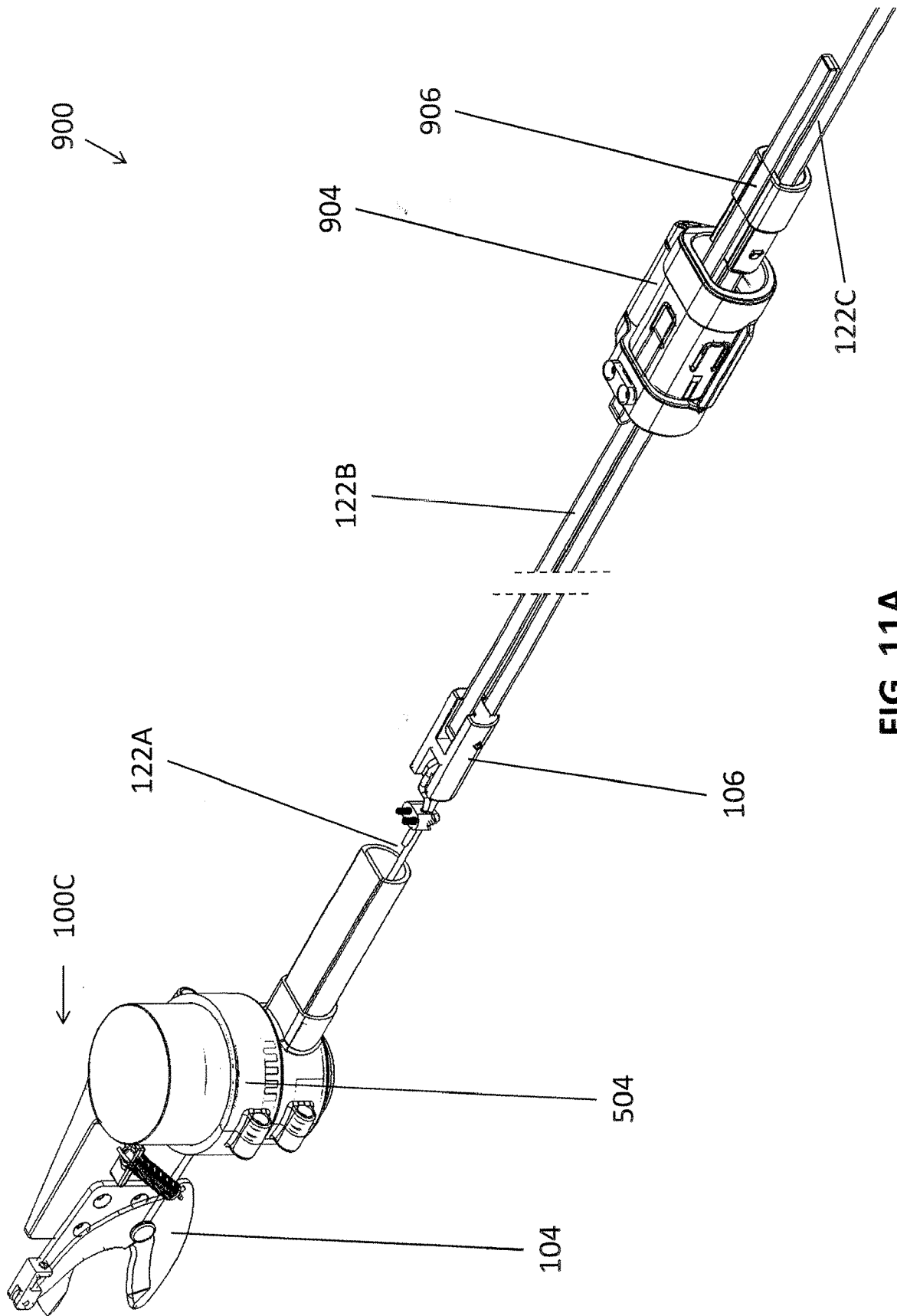

FIG. 11A

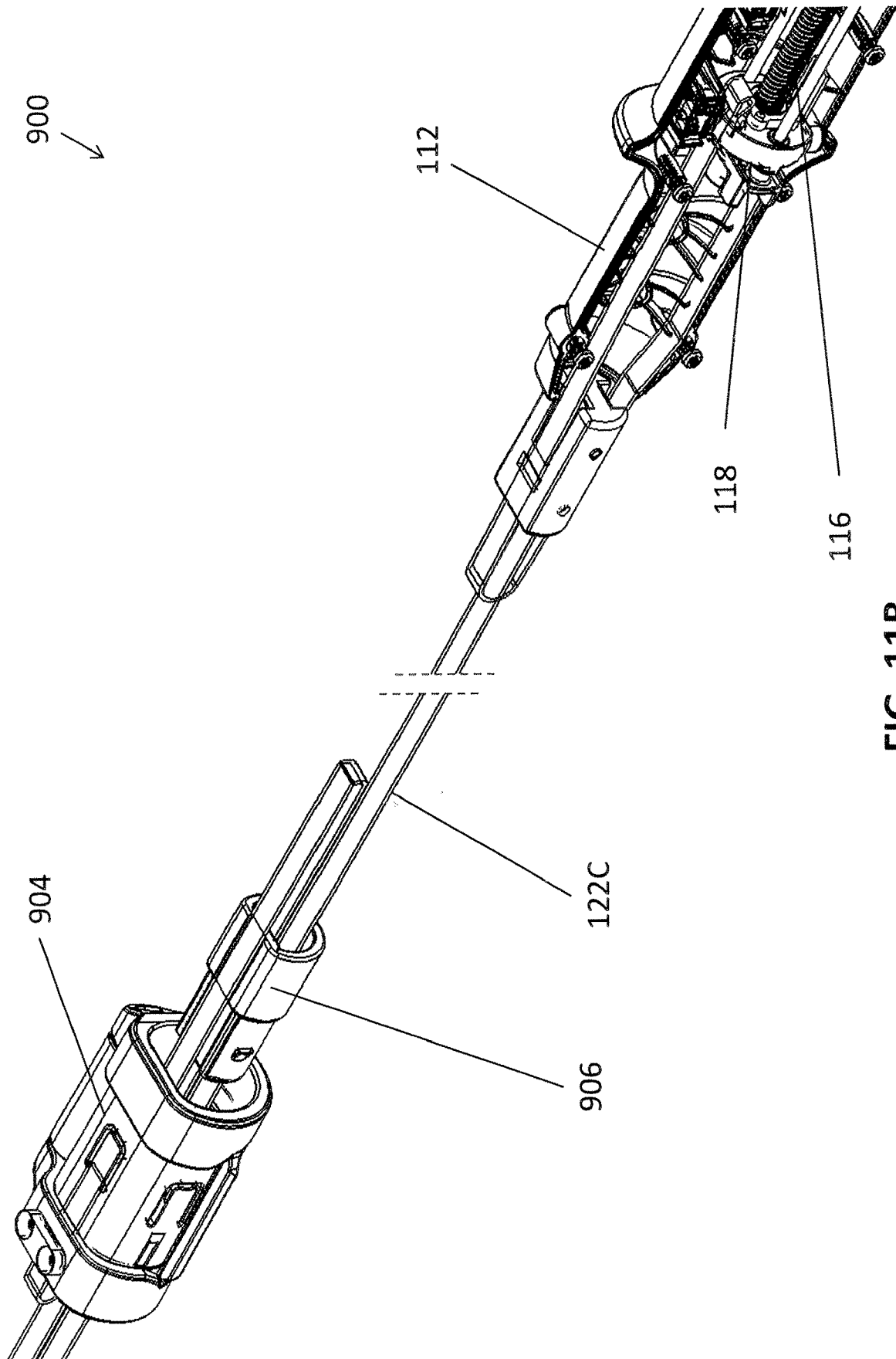

FIG. 11B

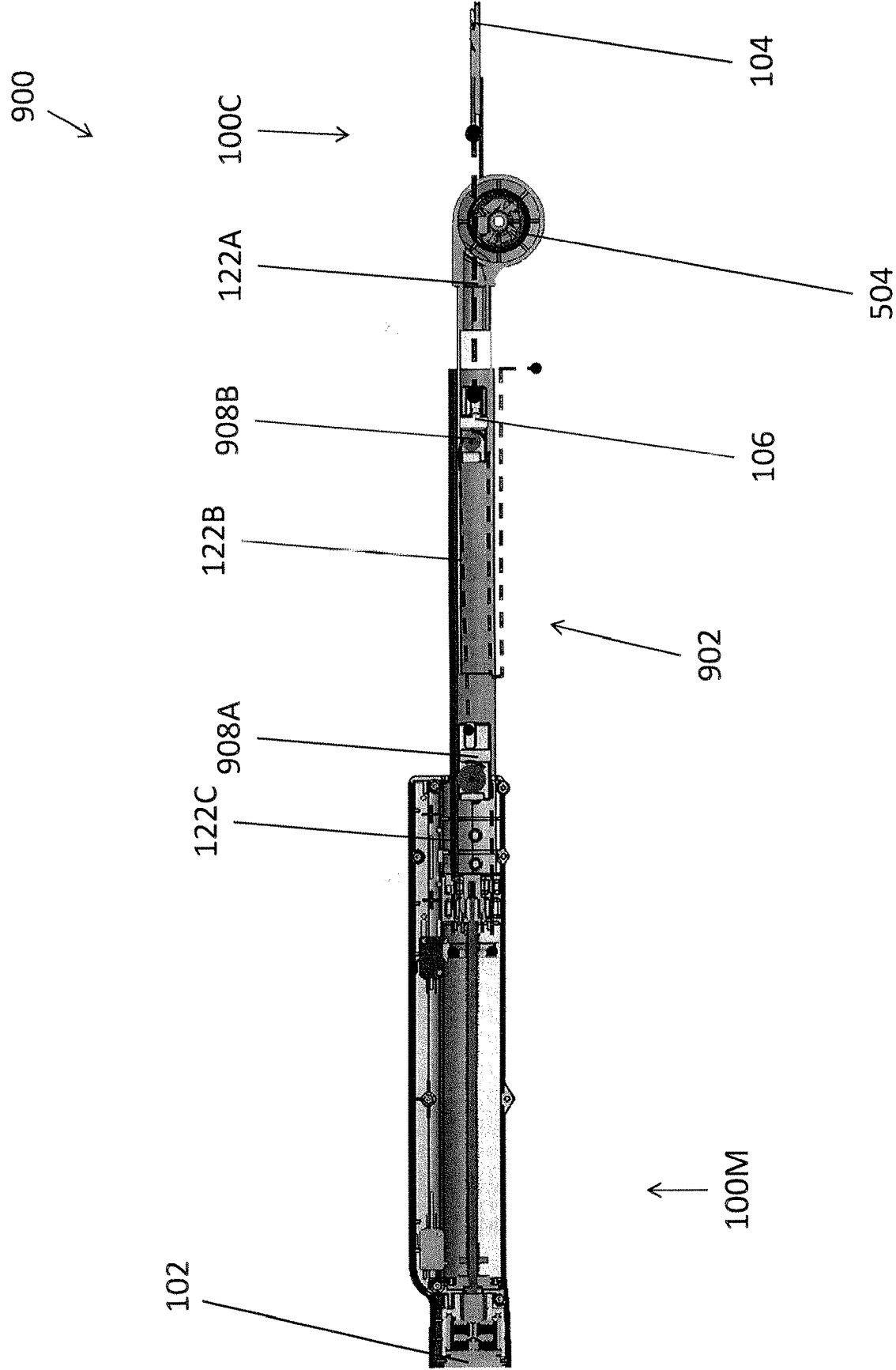

FIG. 12

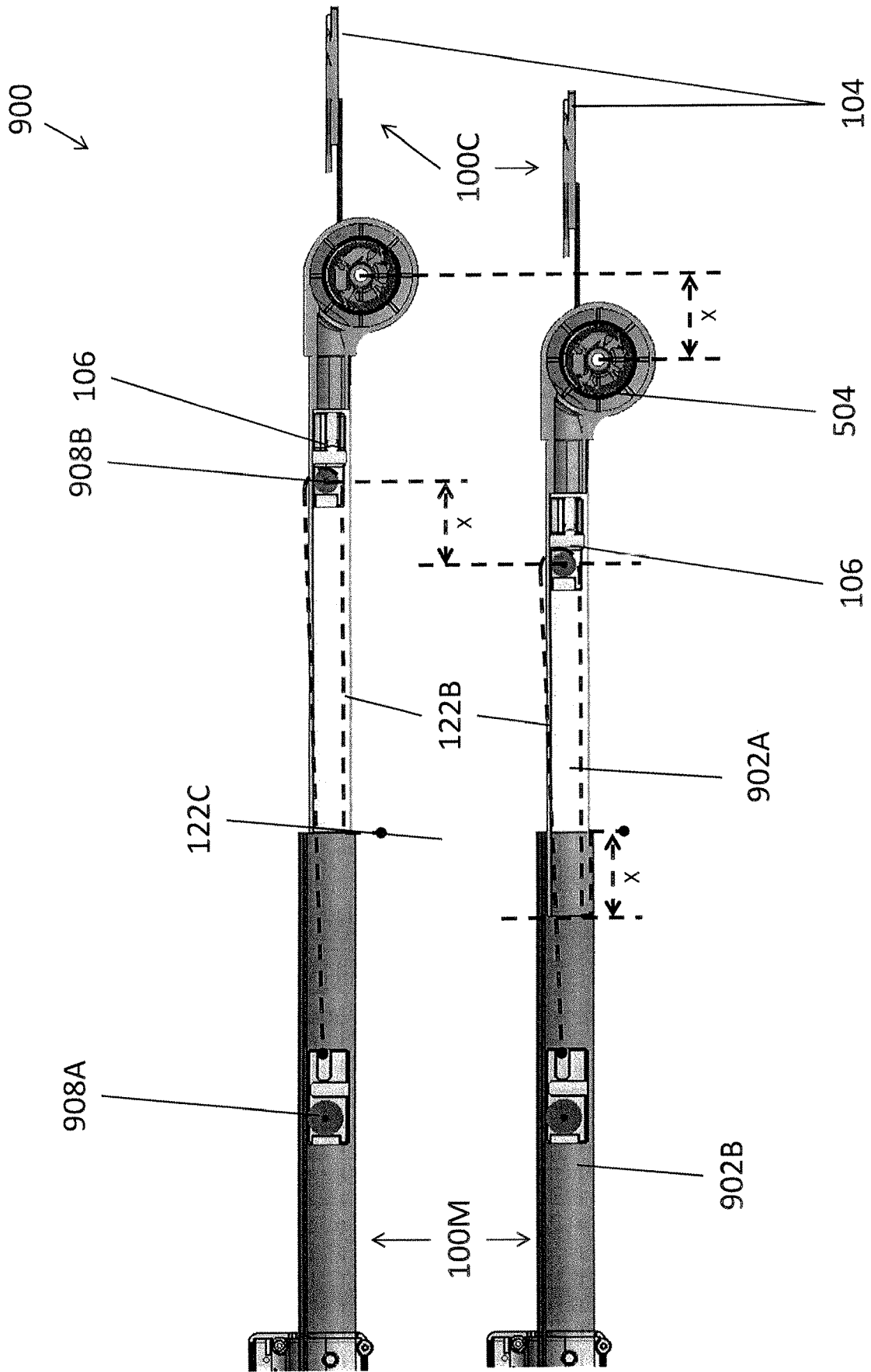

FIG. 13

A POWER TOOL AND A DRIVING MECHANISM FOR USE IN A POWER TOOL

[0001] This application is a National Stage Patent Application of PCT/CN2017/083573, filed on May 9, 2017, the disclosure of which is incorporated by reference herein in its entirety.

TECHNICAL FIELD

[0002] The present invention relates to a power tool and a driving mechanism for use in a power tool, and particularly, although not exclusively, to an electric tree lopper.

BACKGROUND

[0003] Maintenance of trees and bushes usually involve cutting and trimming of the branches and twigs from time to time. To facilitate the maintenance work, a user may perform these trimming operations with the help of cutting tools such as a lopper. Although the some of the tools may be specially design to be manually operated, these heavy duty tools may cause fatigue to the user after prolonged operations.

SUMMARY OF THE INVENTION

[0004] In accordance with a first aspect of the present invention, there is provided a driving mechanism for use in a power tool, comprising a sliding member arranged to drive an operation member of the power tool, wherein the sliding member is arranged to move between a first sliding position and a second sliding position along a longitudinal axis during an operation of the power tool so as to drive the operation member to move between a first operation position and a second operation position respectively.

[0005] In an embodiment of the first aspect, the sliding member is driven by a motor.

[0006] In an embodiment of the first aspect, the driving mechanism further comprises a screw and a nut rotatably connected to the screw, wherein the screw is arranged to rotate with respect to a rotational axis parallel to the longitudinal axis so as to drive the nut to move along the longitudinal axis.

[0007] In an embodiment of the first aspect, the sliding member is the nut.

[0008] In an embodiment of the first aspect, the sliding member is fixedly connected to the nut.

[0009] In an embodiment of the first aspect, the screw is driven by a motor.

[0010] In an embodiment of the first aspect, the driving mechanism further comprises at least one intermediate connecting member arranged to connect the sliding member to the operation member.

[0011] In an embodiment of the first aspect, the at least one intermediate connecting member include at least one of a string, a rope, a strand, a chain, a belt and a cable.

[0012] In an embodiment of the first aspect, the driving mechanism further comprises at least one pulley arranged to cooperate with the at least one intermediate connecting member.

[0013] In an embodiment of the first aspect, the at least one pulley is arranged to increase, a reduction ratio of the driving mechanism.

[0014] In an embodiment of the first aspect, the power tool includes a telescopic structure, and wherein the at least one

pulley is arranged to maintain an operational tension in the intermediate connecting member when the telescopic structure extends or retracts.

[0015] In an embodiment of the first aspect, the driving mechanism further comprises a resilient member arranged to restore the operation member from the first operation position to the second operation position.

[0016] In an embodiment of the first aspect, the operation member is arranged to move to the second operation position upon an actuation of the power tool is released.

[0017] In an embodiment of the first aspect, the driving mechanism further comprises at least one position sensor arranged to detect the sliding member positioned at the first sliding position and/or the second sliding position.

[0018] In an embodiment of the first aspect, the at least one position sensor is at least one electrical switch.

[0019] In an embodiment of the first aspect, the driving mechanism further comprises an adjustment mechanism arranged to selectively fix the operation member at a plurality of angles with respect to the longitudinal axis.

[0020] In an embodiment of the first aspect, the operation member includes a movable blade arranged to move between an open position and a close position.

[0021] In an embodiment of the first aspect, the first operation position and the second position are the close position and the open position respectively.

[0022] In an embodiment of the first aspect, the power tool is a pruner or a topper.

[0023] In accordance with a second aspect of the present invention, there is provided a power tool comprising a driving mechanism in connection with a motor and an operation member, wherein the driving mechanism includes a sliding member arranged to drive the operation member, the sliding member is arranged to move between a first sliding position and a second sliding position along a longitudinal axis during an operation of the power tool so as to drive the operation member to move between a first operation position and a second operation position respectively.

[0024] In an embodiment of the second aspect, the sliding member is driven by the motor.

[0025] In an embodiment of the second aspect, the power tool further comprises a screw and a nut rotatably connected to the screw, wherein the screw is arranged to rotate with respect to a rotational axis parallel to the longitudinal axis so as to drive the nut to move along the longitudinal axis.

[0026] In an embodiment of the second aspect, the sliding member is the nut.

[0027] In an embodiment of the second aspect, the sliding member is fixedly connected to the nut.

[0028] In an embodiment of the second aspect, the screw is driven by the motor.

[0029] In an embodiment of the second aspect, the power tool further comprises at least one intermediate connecting member arranged to connect the sliding member to the operation member.

[0030] In an embodiment of the second aspect, the at least one intermediate connecting member include at least one of a string, a rope, a strand, a chain, a belt and a cable.

[0031] In an embodiment of the second aspect, the power tool further comprises at least one pulley arranged to cooperate with the at least one intermediate connecting member.

[0032] In an embodiment of the second aspect, the at least one pulley is arranged to increase a reduction ratio of the driving mechanism.

[0033] In an embodiment of the second aspect, the power tool includes a telescopic structure arranged to extend and retract so as to respectively move the operation member away from and towards the motor along the longitudinal axis.

[0034] In an embodiment of the second aspect, the at least one pulley is arranged to maintain an operational tension of the intermediate connecting member when the telescopic structure extends or retracts.

[0035] In an embodiment of the second aspect, the driving mechanism further comprises a resilient member arranged to restore the operation member from the first operation position to the second operation position.

[0036] In an embodiment of the second aspect, the operation member is arranged to move to the second operation position upon an actuation of the power tool is released.

[0037] In an embodiment of the second aspect, the power tool further comprises at least one position sensor arranged to detect the sliding member positioned at the first sliding position and/or the second sliding position.

[0038] In an embodiment of the second aspect, the at least one position sensor is at least one electrical switch.

[0039] In an embodiment of the second aspect, the power tool further comprises an adjustment mechanism arranged to selectively fix the operation member at a plurality of angles with respect to the longitudinal axis.

[0040] In an embodiment of the second aspect, the operation member includes a movable blade arranged to move between an open position and a close position.

[0041] In an embodiment of the second aspect, the first operation position and the second position are the close position and the open position respectively.

[0042] In an embodiment of the second aspect, the power tool is a pruner or a lopper.

[0043] In an embodiment of the second aspect, the power tool is battery-powered.

BRIEF DESCRIPTION OF THE DRAWINGS

[0044] Embodiments of the present invention will now be described, by way of example, with reference to the accompanying drawings in which:

[0045] FIG. 1 is a perspective view of a power tool in accordance with one embodiment of the present invention;

[0046] FIG. 2 is a side view of the power tool of FIG. 1;

[0047] FIG. 3 is a side view of the power tool of FIG. 2, wherein the internal components of the main body of the power tool is exposed;

[0048] FIGS. 4A and 4B are side views of the power tool of FIG. 1, wherein the movable blade is moved to a close and an open position respectively;

[0049] FIG. 5 is a perspective view of a power tool in accordance with one embodiment of the present invention;

[0050] FIG. 6 is a side view of the power tool of FIG. 5, wherein the internal of the adjustable mechanism of the cutting head is exposed;

[0051] FIG. 7 is a perspective view of the power tool of FIG. 5, wherein the internal intermediate connecting members of the power tool is exposed;

[0052] FIGS. 8A and 8B are perspective views of the power tool of FIG. 5 with the cutting head being fixed at ± 90 degrees with respect to the longitudinal axis of the power tool;

[0053] FIGS. 9A and 9B are cross-sectional views of the cutting head of the power tool in accordance with an alternative embodiment of the present invention;

[0054] FIG. 10 is a perspective view of a power tool in accordance with one embodiment of the present invention, wherein the overall length of the power tool is adjusted differently;

[0055] FIGS. 11A and 11B are perspective views of the power tool of FIG. 9, wherein the internal intermediate connecting members of the power tool is exposed; and

[0056] FIGS. 12 and 13 are perspective views of a power tool in accordance with one embodiment of the present invention.

DESCRIPTION OF THE PREFERRED EMBODIMENT

[0057] With reference to FIGS. 1 to 3, there is provided an example embodiment of a power tool 100 comprising a driving mechanism in connection with a motor 102 and an operation member 104, wherein the driving mechanism includes a sliding member 106 arranged to drive the operation member 104, the sliding member 106 is arranged to move between a first sliding position 106A and a second sliding position 106B along a longitudinal axis 108 during an operation of the power tool 100 so as to drive the operation member 104 to move between a first operation position 104A and a second operation position 104B respectively.

[0058] In this embodiment, the power tool 100 may be used as a pruner or a lopper. The power tool 100 has an operation member which includes a movable blade 104 for cutting elongated objects such as branches and twigs. In addition, the lopper may be battery-powered. When in use, a user may actuate the lopper 100 by pressing a switch 110 provided on the housing 112 of the power tool 100 to control the movable blade 104. The blade 104 may be selectively opened and closed so as to cut the objects.

[0059] Preferably, the battery assembly 114 may be installed at a proximal end of the power tool 100 in which the handle. or a gripping portion of the main body 100M may also be provided at such end. For example, the battery assembly 114 may be installed to the power tool 100 by inserting a portion of the battery assembly 114 within a cavity within the gripping portion. On the other hand, the blade 104 or the cutting head 100C is provided at the distal end of the power tool 100. This may be advantageous in that the center of gravity of the power tool 100 is kept closed to the user when in used, as the battery assembly usually contributes a relatively large portion of weight of the entire power tool 100, therefore the power tool 100 is suitable for handheld operations.

[0060] The power tool 100 may be provided with an electric motor 102 arranged to drive the movable blade or the operation member 104 through a driving mechanism. Preferably, the driving mechanism is arranged to transmit the mechanical movements and forces from the motor 102 to the blade 104. In addition, the power tool 100 may be provided with a housing 112 arranged to accommodate the motor 102 and the driving mechanism. Referring to FIGS. 1 and 2, the housing 112 is preferably arranged between the

battery **114** and the operation member **104**. A power switch **110** may be provided on the housing **112** around the gripping portion for a user to activate the power tool **100** by pressing the power switch **110**.

[0061] With reference to FIG. 3, there is provided an example embodiment of the driving mechanism which comprises a sliding member **106** for driving the operation member **104** of the power tool **100**. The driving mechanism further comprises a screw **116** and a nut **118** rotatably connected to the screw **116**, and the sliding member **106** is fixedly connected to the nut **118**. Preferably, the screw **116** is driven by a motor **102** and therefore the connected sliding member **106** is also driven by the motor **102**.

[0062] Alternatively, the screw **116** and nut **118** combination may be replaced by different substituted mechanical structures, which may include a bolt, a stud or a threaded pin, etc. In addition, the screw **116** may be driven by the motor **102** via a gear box **120** or a transmission mechanism.

[0063] With reference to FIGS. 4A and 4B, the motor **102** is arranged to drive the sliding member **106** and thereby the operation member **104**, preferably by driving the screw **116** connected or engaged to the motor **102**. By moving the sliding member **106** between first and second sliding positions **106A/106B**, the operation member **104** driven by the sliding member **106** moves between first and second operation positions **104A/104B**, which respectively correspond to an open position and the close position of the movable blade **104**.

[0064] The screw **116** is configured to rotate with respect to a rotational axis so as to drive the nut **118** to move along the rotational axis. The nut **118** is fixedly connected to the sliding member **106**, therefore the nut **118** forces the sliding member **106** to move in the similar direction, i.e. along the rotational axis of the screw **116**. In this example embodiment, the rotational axis and the longitudinal axis **108** of the power tool **100** share the same axis. In some alternative embodiments, the sliding member **106** may be arranged to move along a longitudinal axis **108** which is parallel to the rotational axis of the screw **116** but not the same axis as such rotational axis.

[0065] Preferably, the driving mechanism comprises at least one intermediate connecting member **122** arranged to connect the sliding member **106** to the operation member **104**. This may include a string, a rope, a strand, a chain, a belt, a cable and/or a rigid structure such as a shaft or a rod.

[0066] Alternatively, the sliding member **106** is the nut **118** and the operation member **104** may be directly connected to and driven by the nut **118**.

[0067] Referring to FIG. 4A, the power tool **100** is configured in a first operation condition in which the operation member **104** moved to a second operation position **104B**, i.e. the movable blade **104** is closed. The nut **118** is moved to a position proximate or adjacent to the motor **102**, thereby moves the sliding member **106** to the second sliding position **106B**. As the movable blade is pivotably connected to the other fixed blade structure, the sliding member **106** may pull the movable blade to the close position via the intermediate connecting member **122** or the cable therebetween.

[0068] Optionally, the driving mechanism may further comprise a resilient member **124** arranged to restore the operation member **104** from the second operation position **104B** (or the close position) to the first operation position **104A** (or the open position). When the movable blade moves to the close position, the resilient member **124** such as a

spring is extended. Referring to FIG. 4A, when the actuation of the power tool too is released, the driving force applied to the nut **118** and the sliding member **106** no longer exists, therefore the spring **124** may force the movable blade **104** to the open position. At the same time, the sliding member **106** is forced to move from the second sliding position **106B** to the first sliding position **106A** due to the restoring force of the loaded spring **124**.

[0069] Alternatively, the motor **102** is further arranged to restore the operation member **104** from the second operation position **104B** with a reversed motion, i.e. by rotating the screw **116** in an opposite direction so as to force the nut **118** and thus the sliding member **106** to move from the second sliding position **106B** to the first sliding position **106A**. However, in such configuration, the intermediate member has to be a rigid one such that the sliding member **106** may “push” the operation member **104** so as to move the movable blade to the open position.

[0070] Optionally or additionally, the power tool **100** may be provided with at least one position sensor **126** arranged to detect the sliding member **106** positioned at the first sliding position **106A** and/or the second sliding position **106B**. For example, the at least one position sensor **126** includes at least one electrical switch. With reference also to FIGS. 3, 4A and 4B, two electrical switches **126** may be installed in the housing **112** for detecting whether the nut **118** is adjacent to the positions of the switches **126**. For example, when the nut **118** is driven to a position as shown in FIG. 4A, the first switch **126A** may be actuated which indicates that the sliding is now in the first sliding position **106A**. Similarly, when the nut **118** is driven to a position as shown in FIG. 4B, the second switch **126B** may be actuated which indicates that the sliding is now in the second sliding position **106B**. Based on different controlling mechanism, the power tool **100** may be designed to respond differently in response to the detection of the abovementioned operation states, such as to stop or slow down the driving motion of the motor **102**, or to reverse the driving direction of the motor **102**.

[0071] Alternatively, different number of sensors or switches may be installed to detect the sliding member **106** at the two sliding positions or different number of positions according to different design and controlling requirements.

[0072] With reference to FIG. 5, there is provided an alternative embodiment of the present invention. In this embodiment, the power tool **500** includes a substantially extended structure in which an extension pole/tube **502** is provided between the main body **100M** and the cutting head **100C**. Advantageously, a user may use such power tool **100** to cut an object which is in a distance from the position of the user.

[0073] With reference to FIGS. 6 and 7, an intermediate connecting member **122** such as a cable may be used to connect the operation member **104** and the sliding member **106** disposed in the main body **100M** of the power tool **100**. Preferably, the cable **122** runs through the internal cavity of the extension tube **502**, such that the cable may be well protected from external damages.

[0074] Optionally, the power tool **100** further comprises an adjustment mechanism **504** arranged to selectively fix the operation member **104** at a plurality of angles with respect to the longitudinal axis **108**. Referring to also to FIGS. 8A and 8B, the cutting head **100C** (or the operation member **104**) may be tilted at ± 90 degrees with respect to the

extension tube **504** which is substantially align with the longitudinal axis **108**. For example, the adjustment mechanism **504** may be provided with a pivotable head and a locking member such that a user may selectively fix the cutting head **100C** at any desired angle, preferably between a range of ± 180 degrees with respect to the extension tube.

[0075] Preferably, the adjustment mechanism **504** may include two portions which may be pivotably coupled with each other. In addition, detent structures may be provided in the adjustment mechanism **504**, which may facilitate fixing the cutting head **100C** at certain selected number of angles.

[0076] Since the connection between the sliding member **106** and the operation member **104** is facilitated by the intermediate connecting member **122**, and there is no substantial limitation on the length of the cable, therefore the overall length of the power tool **100** may be flexibly designed by including extension tubes with different length as desired by the user and/or the manufacturer.

[0077] In addition, the adjustment mechanism **504** may be provided with a hidden conduit **506** which allows the cable running through, therefore the entire cable **122** may be hidden from the external environment. The hidden conduit **126** includes two connected portions each provided in a respective portion of the adjustment mechanism **504**, therefore the cable is hidden and substantially not affected when the cutting head is fixed in different angles.

[0078] With reference to FIGS. **9A** and **9B**, there is provided an alternative embodiment of the cutting head **100C** of the power tool **500**. In this embodiment, the adjustment mechanism **504** does not include a hidden conduit for routing the cable **122**, However eyelets or apertures **506** may be provided within the body of the adjustment mechanism **504** along the route of the cable **122**, therefore the cable **122** may pass through the adjustment mechanism **504**. As shown in the Figure, each portion is provided with two apertures **506**.

[0079] In addition, in each of the two connected portions of the adjustment mechanism **504**, there is provided a pulley **508** arranged to facilitate the routing and moving of the cable **122**. Preferably, the pulley **508** is disposed between the two apertures **506** within each portion of the adjustment mechanism **504**. The pulley **508** may be configured with a deep slot so as to make sure that the cable **122** may not come off from the pulley **508** when cutting head **100C** is adjusted in different angles and/or during the operation in which the cable **122** may move back and forth. The pulleys **508** may also help reducing friction generated on the surface of the cable **122** and therefore may reduce wear on the cable **122**.

[0080] With reference to FIG. **10**, there is provided an alternative embodiment of the present invention. In this embodiment, the power tool **900** includes a substantially extended structure in which an extension pole/tube **902** is provided between the main body and the cutting head. In addition, the power tool **900** includes a telescopic structure. A user may adjust the overall length of the extension pole by extending or retracting the telescopic tube **902** so as to move the operation member **104** away from or towards the motor **102**/the main body **100M** along the longitudinal axis **108**.

[0081] In this embodiment, the telescopic structure or the extension pole **902** comprises two connected portions. The cutting head **100C** may be fixed to the first portion **902A** of the extension pole and the main body **100M** of the power tool may be fixed to the second portion **902B** of the extension pole, and the two portions of the extension pole

902 may be connected with an extension locking member **904**. Preferably, the first portion (or an inner tube) **902A** may be partly inserted in the second portion (or an outer tube) **902B** of the extension pole, and the relative position of the two portions may be releasably locked by the extension locking member **904**.

[0082] Similar to the previous embodiment, the movable blade **104**, the sliding member **106** and/or the driven nut **118** may be connected through one or more cables **122** or belt. Additionally, intermediate cable fixing member **906** may be used to connect multiple cables or belts **122** between the nut **118** and the sliding member **106**. Referring to FIGS. **11A** and **11B**, the movable blade **104** is connected to the sliding member **106** with a cable **122A**, the sliding member **106** is connected to the intermediate cable fixing member **906** with a first belt **122B** and the intermediate cable fixing member **906** is connected to the nut **118** through a second belt **122C**. In addition, the first belt **122B** may be arranged in a "folded" configuration in which an operational tension between the sliding member **106** and the intermediate cable fixing member **906** is maintained when the telescopic structure extends or retracts.

[0083] Optionally, the driving mechanism may comprise at least one pulley arranged to cooperate with the at least one intermediate connecting member **122**. With reference to FIG. **12**, the pulley may increase a reduction ratio of the driving mechanism. For example., when the nut **118** is driven to move with a distance of d , the sliding member **106** moves with a distance of $d/2$ to the same direction due to the folded configuration of the belt.

[0084] Preferably, the pulley **908** may also maintain an operational tension in the intermediate connecting member **122** when the telescopic structure extends or retracts. With reference to FIG. **13**, the operation of the telescopic structure is illustrated. The belt **122B** is fixedly connected to a first pulley **908A** which is directly driven by the nut **118** at one end, and the other end is connected to the outer tube **902B** of the telescopic pole. The belt **122B** is routed through the second pulley **908B** adjacent to the cutting head **100C**, therefore the second pulley **908B** operates as the sliding member **106**. When the extension pole **902** retracts (by x as shown in the Figure), a portion of the belt **122B** (of a length of x) is forced to run between the sidewalls of the inner tube **902A** and the outer tube **902B** near the end being fixed to the outer tube, therefore maintaining the operational tension between the pulleys **908**.

[0085] Alternatively, the cables or belts **122** may be connected to simpler structures with a similar "folding" configuration but without any wheels or cable rollers so as to simply the components used in the power tool too.

[0086] These embodiments may be advantageous in that the power tool is provided with a driving mechanism which may be used in a tree lopper. The driving mechanism may be modified with different connections members such that the power tool may be adjusted to suit different operation requirements and occasions. In addition, extension tubes of different length or telescopic extensions may be included in the power tool to work with the driving mechanism without substantially changing the main body and the cutting head of the lopper.

[0087] It will be appreciated by persons skilled in the art that numerous variations and/or modifications may be made to the invention as shown in the specific embodiments without departing from the spirit or scope of the invention as

broadly described. The present embodiments are, therefore, to be considered in all respects as illustrative and not restrictive.

[0088] Any reference to prior art contained herein is not to be taken as an admission that the information is common general knowledge, unless otherwise indicated.

1-40. (canceled)

41. A power tool comprising:

an operation member;

a motor arranged to drive the operation member through a driving mechanism; and

the driving mechanism, in connection with the motor and the operation member, wherein the driving mechanism includes a sliding member arranged to be driven by the motor to move between a first sliding position and a second sliding position along a longitudinal axis during operation of the power tool so as to drive the operation member to move between a first operation position and a second operation position;

wherein the power tool further comprises:

at least one position sensors arranged to detect when the sliding member is positioned at the first sliding position and/or the second sliding position, and

a control mechanism arranged to control the power tool to respond in response to the detection.

42. The power tool of claim 41, wherein the control mechanism is arranged to slow down a driving motion of the motor in response to the detection.

43. The power tool of claim 41, wherein the control mechanism is arranged to stop a driving motion of the motor in response to the detection.

44. The power tool of claim 41, wherein the control mechanism is arranged to reverse a driving direction of the motor in response to the detection.

45. The power tool of claim 41, wherein the driving mechanism further includes:

a screw; and

a nut rotatably connected to the screw and the sliding member is fixedly connected to the nut;

wherein the screw is arranged to rotate with respect to a rotational axis parallel to the longitudinal axis so as to drive the nut to move along the longitudinal axis.

46. The power tool of claim 45, wherein the motor is arranged to drive the screw so as to drive the sliding member to move between the first sliding position and the second sliding position.

47. The power tool of claim 41, further comprising:

at least one intermediate connecting member arranged to connect the sliding member to the operation member,

wherein the at least one intermediate connecting member include at least one of: a string, a rope, a strand, a chain, a belt, and a cable.

48. The power tool of claim 47, further comprising: at least one pulley arranged to cooperate with the at least one intermediate connecting member.

49. The power tool of claim 48, wherein the at least one pulley is arranged to increase a reduction ratio of the driving mechanism.

50. The power tool of claim 47, further comprising:

a telescopic structure arranged to selectively extend and retract so as to respectively move the operation member away from and towards the motor along the longitudinal axis.

51. The power tool of claim 50, wherein the at least one pulley is arranged to maintain an operational tension of the intermediate connecting member when the telescopic structure extends or retracts.

52. The power tool of claim 41, wherein the driving mechanism further comprises a resilient member arranged to provide a restoring force to restore the operation member from the second operation position to the first operation position.

53. The power tool of claim 45, wherein the at least one position sensors include:

a first position sensor arranged to detect the sliding member positioned at the first sliding position, the first position sensor is a first electrical switch arranged to be actuated by the nut when the sliding member is positioned at the first sliding position; and

a second position sensor arranged to detect the sliding member positioned at the second sliding position, the second position sensor is a second electrical switch arranged to be actuated by the nut when the sliding member is positioned at the second sliding position.

54. The power tool of claim 41, further comprising an adjustment mechanism arranged to selectively fix the operation member at a plurality of angles with respect to the longitudinal axis.

55. The power tool of claim 41, wherein the operation member includes a movable blade arranged to move between an open position, which corresponds to the first operation position, and a close position, which corresponds to the second operation position.

56. The power tool of claim 41, wherein the power tool is a pruner or a lopper.

57. The power tool of claim 41, wherein the power tool is battery-powered.

58. The power tool of claim 41, wherein the power tool includes a gripping portion at a proximal end, and the operation member is arranged at a distal end, wherein the gripping portion includes a cavity for insertion of a portion of a battery assembly.

* * * * *