



US007841342B2

(12) **United States Patent**
Dhuper et al.

(10) **Patent No.:** **US 7,841,342 B2**
(45) **Date of Patent:** ***Nov. 30, 2010**

(54) **INTERFACE ACCESSORY FOR USE WITH AN AEROSOL INHALATION SYSTEM**

(75) Inventors: **Sunil Kumar Dhuper**, Old Westbury, NY (US); **Herbert Fred D'Alo**, Madison, CT (US)

(73) Assignee: **Aeon Research and Technology, Inc.**, Hewlett, NY (US)

(*) Notice: Subject to any disclaimer, the term of this patent is extended or adjusted under 35 U.S.C. 154(b) by 891 days.

This patent is subject to a terminal disclaimer.

3,903,884 A *	9/1975	Huston et al.	128/200.18
4,210,155 A	7/1980	Grimes	
4,463,755 A	8/1984	Suzuki	
4,470,412 A	9/1984	Nowacki et al.	
4,637,528 A	1/1987	Wachinski et al.	
4,641,644 A	2/1987	Andersson et al.	
4,649,912 A *	3/1987	Collins	128/202.13
4,823,784 A *	4/1989	Bordoni et al.	128/200.14
4,951,661 A	8/1990	Sladek	
4,953,545 A	9/1990	McCarty	
5,012,803 A	5/1991	Foley et al.	
5,020,530 A	6/1991	Miller	
5,263,485 A	11/1993	Hickey	
5,277,175 A *	1/1994	Riggs et al.	128/200.21

(21) Appl. No.: **11/623,221**

(22) Filed: **Jan. 15, 2007**

(65) **Prior Publication Data**
US 2007/0137644 A1 Jun. 21, 2007

Related U.S. Application Data

(63) Continuation-in-part of application No. 11/414,737, filed on Apr. 27, 2006, which is a continuation-in-part of application No. 11/121,688, filed on May 3, 2005, now Pat. No. 7,445,006.

(51) **Int. Cl.**
A61M 15/00 (2006.01)
A61M 16/00 (2006.01)

(52) **U.S. Cl.** **128/203.15**; 128/203.12; 128/200.24

(58) **Field of Classification Search** 128/200.24, 128/203.12, 203.25, 204.18, 205.25, 206.12, 128/206.21; 239/338

See application file for complete search history.

(56) **References Cited**

U.S. PATENT DOCUMENTS

3,057,347 A 10/1962 McGee

(Continued)

Primary Examiner—Justine R Yu
Assistant Examiner—Annette F Dixon
(74) *Attorney, Agent, or Firm*—Leason Ellis LLP

(57) **ABSTRACT**

An aerosol inhalation system includes a single source of gas and a Y-connector having a first port in fluid communication with the gas source via a conduit. The system also has an accessory having a main conduit body that fluidly connected to the Y-connector via a conduit to permit gas from the single source to flow through the main conduit body. The accessory includes a patient interface conduit that delivers aerosolized medication to a mouth of the patient. A nebulizer is sealingly and removably disposed within the main conduit body and includes a gas inlet port that is fluidly connected to the Y-connector to permit gas from the single source to flow into the nebulizer to create the aerosolized medication that is delivered into the main conduit body and to the patient through the patient interface conduit.

25 Claims, 4 Drawing Sheets

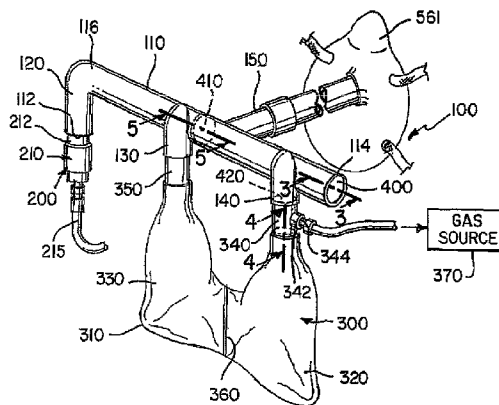

U.S. PATENT DOCUMENTS							
			6,772,754	B1 *	8/2004	Mendenhall	128/200.14
5,287,849	A	2/1994	Piper et al.	6,776,160	B2	8/2004	Wang
5,349,946	A	9/1994	McComb	6,799,423	B2	10/2004	Piekarski
5,385,140	A	1/1995	Smith	6,929,003	B2	8/2005	Blacker et al.
5,388,571	A	2/1995	Roberts et al.	6,976,488	B2	12/2005	Halperin
5,479,920	A *	1/1996	Piper et al.	6,994,083	B2	2/2006	Foley et al.
			128/204.23	7,036,500	B2	5/2006	Niles et al.
5,482,031	A	1/1996	Lambert	7,080,643	B2	7/2006	Grychowski et al.
5,546,930	A *	8/1996	Wikefeldt	7,131,439	B2	11/2006	Blacker et al.
			128/201.13	7,191,776	B2	3/2007	Niles et al.
5,586,551	A *	12/1996	Hilliard	7,290,541	B2	11/2007	Ivri et al.
			128/203.29	7,445,006	B2 *	11/2008	Dhuper et al.
5,613,489	A	3/1997	Miller et al.				128/203.12
5,617,844	A	4/1997	King	2002/0017302	A1	2/2002	Fukunaga et al.
5,640,951	A	6/1997	Huddart et al.	2002/0121275	A1	9/2002	Johnson et al.
5,727,542	A	3/1998	King	2002/0129814	A1	9/2002	Sladek
5,738,087	A	4/1998	King	2003/0010336	A1	1/2003	Vito
5,752,502	A	5/1998	King	2003/0209246	A1	11/2003	Schroeder et al.
5,791,340	A	8/1998	Schleufe et al.	2004/0011364	A1	1/2004	Dhuper et al.
5,813,423	A	9/1998	Kirchgeorg	2004/0024372	A1	2/2004	Grogan
5,848,587	A	12/1998	King	2004/0084048	A1 *	5/2004	Stenzler et al.
							128/206.12
5,865,172	A	2/1999	Butler et al.	2004/0123974	A1	7/2004	Marler et al.
6,039,042	A	3/2000	Sladek	2004/0226563	A1	11/2004	Xu et al.
6,041,777	A	3/2000	Faithfull et al.	2004/0234610	A1 *	11/2004	Hall et al.
							424/489
6,078,730	A	6/2000	Huddart et al.	2005/0028811	A1	2/2005	Nelson et al.
6,116,233	A	9/2000	Denyer et al.	2005/0092325	A1	5/2005	Dionne
6,192,884	B1	2/2001	Vann et al.	2005/0247313	A1 *	11/2005	Niles et al.
							128/203.16
6,340,023	B2 *	1/2002	Elkins	2006/0231090	A1	10/2006	King
			128/200.21	2006/0231091	A1 *	10/2006	Camarillo
6,363,932	B1	4/2002	Forchione et al.	2006/0260607	A1 *	11/2006	Dhuper et al.
							128/200.21
6,390,090	B1	5/2002	Piper	2007/0062531	A1	3/2007	Fisher
6,427,685	B1	8/2002	Ray	2007/0137644	A1	6/2007	Dhuper et al.
6,450,163	B1	9/2002	Blacker et al.	2008/0087280	A1 *	4/2008	Dhuper et al.
							128/200.23
6,494,202	B2	12/2002	Farmer				
6,550,476	B1	4/2003	Ryder				
6,622,725	B1	9/2003	Fisher et al.				
6,748,945	B2	6/2004	Grychowski et al.				

* cited by examiner

FIG. 1

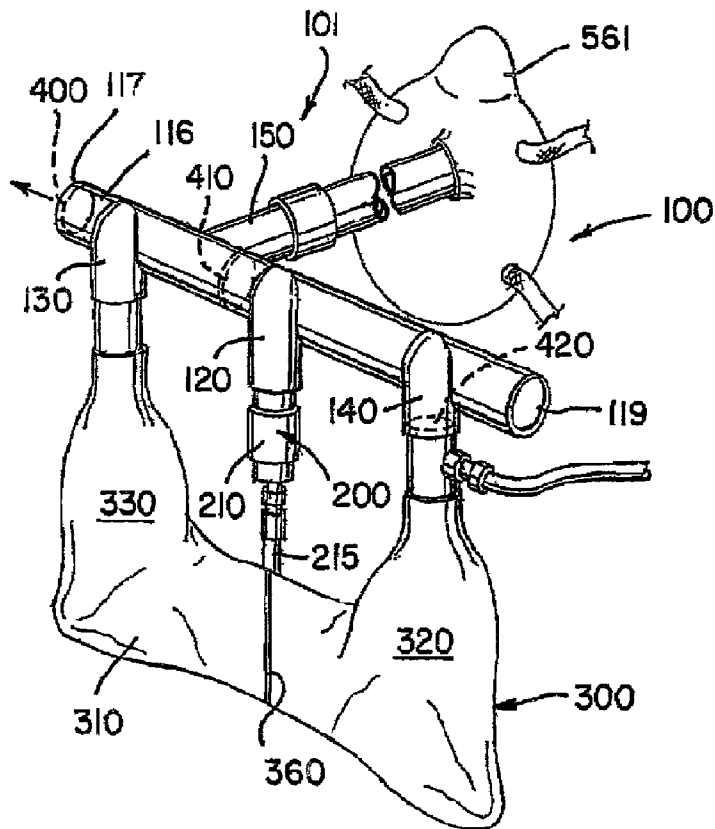
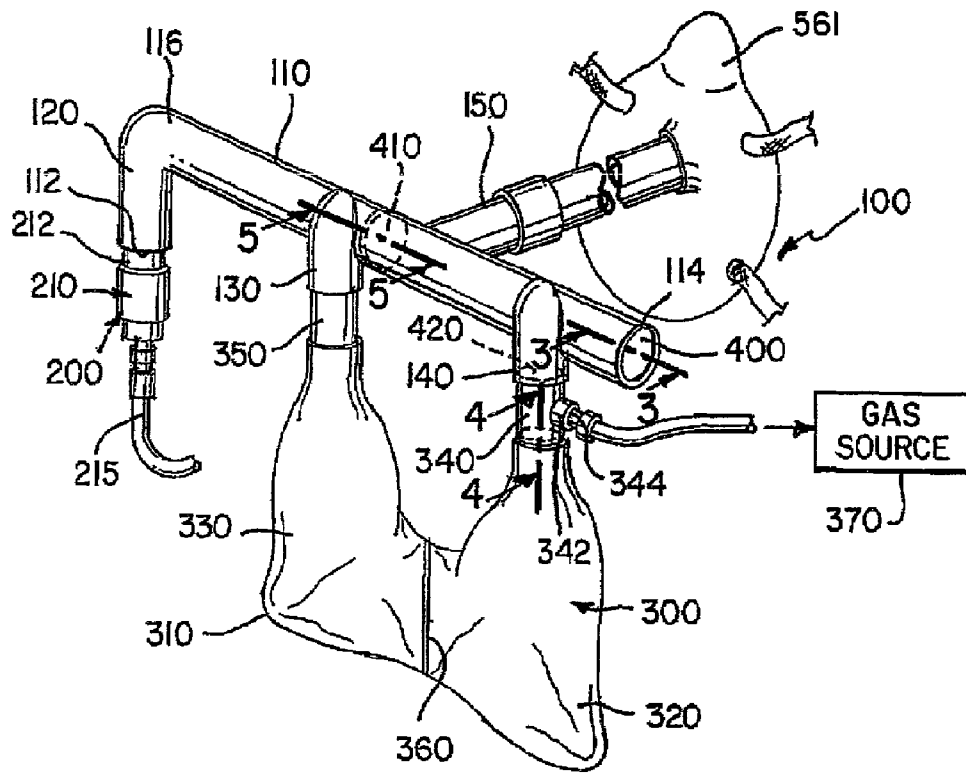

FIG. 2

FIG. 3

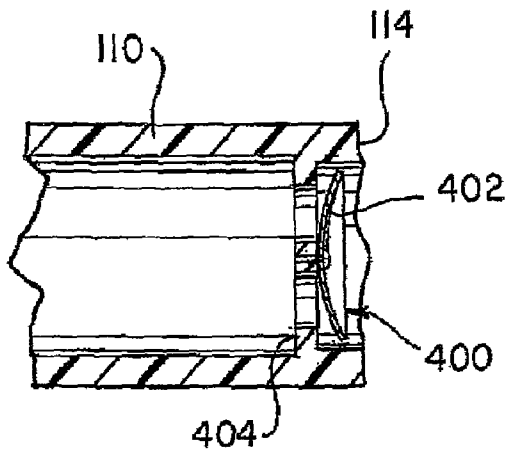

FIG. 4

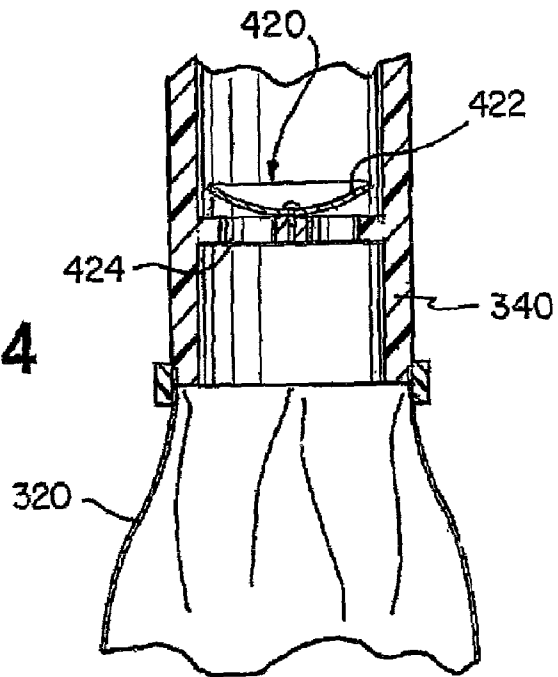

FIG. 5

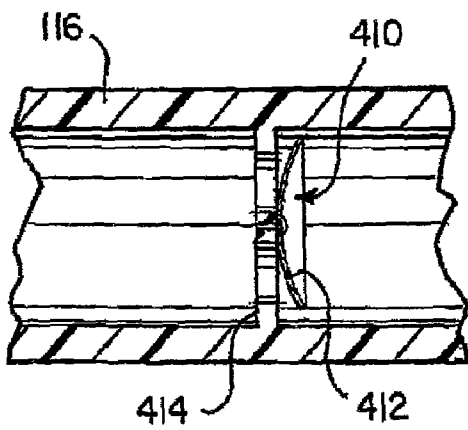
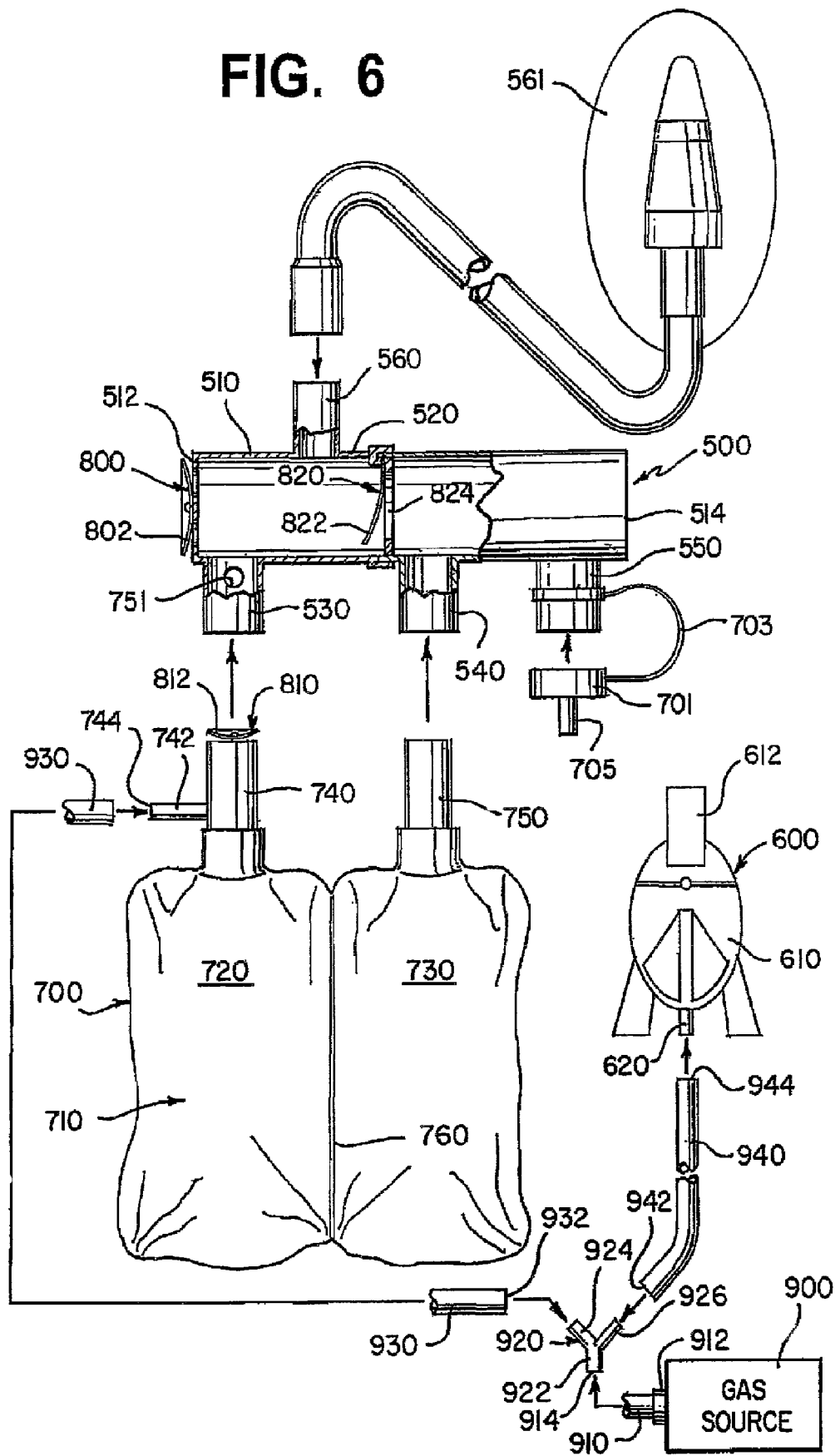
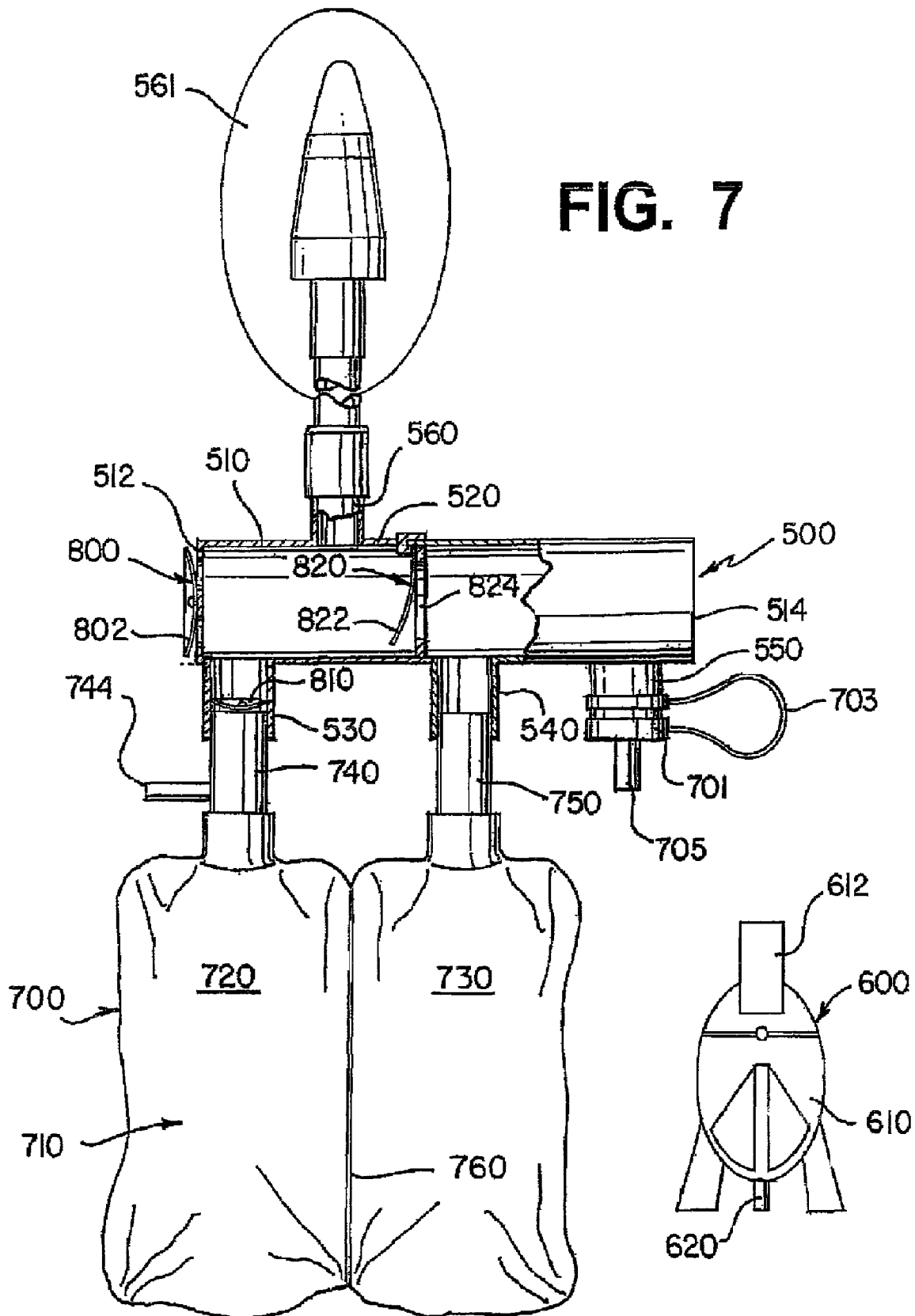

FIG. 6





1

INTERFACE ACCESSORY FOR USE WITH AN AEROSOL INHALATION SYSTEM

CROSS-REFERENCE TO RELATED APPLICATION

The present application is a continuation-in-part of U.S. patent application Ser. No. 11/414,737 filed Apr. 27, 2006, which is a continuation-in-part of U.S. patent application Ser. No. 11/121,688, filed May 3, 2005, (now U.S. Pat. No. 7,445,006, issued on Nov. 4, 2008), each of which is hereby incorporated by reference in its entirety.

TECHNICAL FIELD

The present invention relates to inhalation equipment and more particularly, relates to aerosol inhalation systems including an interface (accessory) for use in the system between a conventional part of the inhalation equipment, such as a generator and the patient to provide in a number of applications a completely closed system that ensures that the medication delivered to the patient has a fixed concentration over time.

BACKGROUND

Aerosol inhalation equipment is commonly used as a means to deliver medication in all aerosolized form to a patient. Aerosolized medication is typically used to treat patients with respiratory conditions, such as asthma or chronic obstructive pulmonary disease (COPD). For example, inhalation equipment is a common means for delivering medication to counter certain ailments of a patient population, including reactive airway disease, asthma, cystic fibrosis, etc.

It is generally accepted that effective administration of medication as aerosol depends on the delivery system and its position in relation to the patient. Aerosol particle deposition is influenced by particle size, ventilatory pattern, and airway architecture and effective medication response is also influenced by the dose of the medication used.

An aerosol delivery system includes three principal elements, namely a generator, a power source, and an interface. Generators include small volume nebulizers (SVN), large volume nebulizers (LVN), metered dose inhalers (MDI), and dry powder inhalers (DPI). The power source is the mechanism by which the generator operates or is actuated and includes compressed gas for SVN and LVN and self-contained propellants for MDI. The interface is the conduit between the generator and the patient and includes spacer devices/accessory devices with mouthpieces or face masks. Depending on the patient's age (ability) and coordination, various interfaces are used in conjunction with SVN and MDI in order to optimize drug delivery.

A SVN is a jet nebulizer that is powered by a compressed gas source. The medication is displaced tip a capillary tube from the nebulizer's reservoir and is dispersed continuously as aerosolized particles. The aerosolized particles are spontaneously inhaled by the patient or delivered in conjunction with positive-pressure breaths. Typically, for patients greater than 3 years who are spontaneously breathing without an artificial airway and are able to cooperate, a mouthpiece with an extension reservoir should be used. For patients unable to negotiate a mouthpiece, typically children under 3 years, a face mask should be used.

An MDI is essentially a pressurized canister that contains a medication and propellant. Actuation of the MDI results in

2

the ejection of one dose of medication as aerosolized particles, which can be spontaneously inhaled by the patient or delivered in conjunction with positive-pressure breaths. A spacer device/accessory device should be used with an MDI. A spacer device enhances delivery by decreasing the velocity of the particles and reducing the number of large particles. A spacer device with a one-way valve, i.e., holding chamber, eliminates the need for the patient to coordinate actuation and inhalation and optimizes drug delivery. A spacer device without valves requires coordination between inhalation and actuation. The MDI with spacer device and face mask is appropriate for patients, typically less than 3 years, unable to use a mouthpiece.

A DPI is a breath-actuated device that uses a gelatin capsule containing, a single dose of medication and a carrier substance to aid in the dispersion of the drug. The capsule is inserted into the device and punctured. The patient's inspiratory flow disperses the dry particles and draws them into the lower airways. In spontaneously breathing patients, this device is appropriate in patients who are able to achieve a certain inspiratory flow, such as equal to or greater than 50 L/min. This will typically correspond to children about 6 years or greater.

A LVN can be used to deliver a dose of medication continuously over a period of time. A LVN is powered by a compressed gas source, and a face mask is typically used as the interface.

The two primary means for delivering aerosolized medication to treat a medical condition is an MDI or a nebulizer. MDI medication (drug) canisters are typically sold by manufacturers with a boot that includes a nozzle, an actuator, and a mouthpiece. Patients can self-administer the MDI medication using the boot alone but the majority of patients have difficulty in synchronizing the actuation of the MDI canister and patient inhalation and improve the delivery and improve the delivery of medication by decreasing oropharyngeal deposition of the aerosol drug.

Many valved chambers of this type are commercially available. Examples of such spacers include but are not limited to those structures disclosed in U.S. Pat. Nos. 4,470,412; 5,012,803; 5,385,140; 4,637,528; 4,641,644; 4,953,545; and U.S. patent application publication No. 2002/0129814. These devices are expensive and may be suitable for chronic conditions that require frequent use of MDI inhalers provided the cost and labor involved in frequent delivery of medication is acceptable to the patient. However, under acute symptoms, such devices may fail to serve the purpose and lead to an inadequate delivery of medication.

Aerosol delivery systems that use standard small volume nebulizers are commonly used in acute conditions as they are cheap and overcome the inhalation difficulties associated with actuation of MDI and synchronization of inhalation by the patient. Nebulizers are fraught with numerous problems as well. The medication dose used is about 10 times of that used with an MDI and hence the increased cost without any added proven clinical benefit. Secondly, the majority of the nebulized medication is wasted during exhalation. Thirdly, the time taken to deliver the medication is several times that of an MDI and the labor cost of respiratory therapist may outweigh the benefits of nebulizers compared with MDIs. Breath actuated nebulizers(s) with reservoir have been designed to overcome the medication waste. An example of this type of device is found in U.S. Pat. No. 5,752,502. However, these devices are expensive and still have all the other problems associated with nebulizer use alone. Other examples of aerosol inhalation devices can be found in U.S. Pat. No. 4,210,

155, in which there is a fixed volume mist accumulation chamber for use in combination with a nebulizer and a TEE connection.

Problems with prior art devices include that the devices significantly waste medication, they provide a non-uniform concentration of delivered medication, they are expensive, and they are difficult to use. Many of these devices are commercially available in which the nebulizer is directly attached to the TEE connector without any mixing chamber. All of the aforementioned devices can be used with either an MDI or a nebulizer but not both, and hence, face the difficulty associated with either system alone. Other devices have tried to overcome the above problems by incorporating a mixing chamber in the device with adaptability to be used with an MDI or standard nebulizer. U.S. patent application publication No. 2002/0121275 disclosed a device having the above characteristics, however, this device is plagued with problems that are typical to those types of devices. As with other conventional devices, the disclosed device, like the other ones, fails to incorporate some of the key features necessary for enhanced aerosol delivery.

In general, each of the prior art devices suffers from the following deficiencies: (1) the entrained airflow in the device interferes with the MDI plume as well as the plume generated by a nebulizer resulting in increased impaction losses of aerosol generated by either an MDI or nebulizer; (2) the device does not have the ability to deliver a desired fraction of inspired oxygen to a hypoxic patient and simultaneously deliver aerosol medication with either a metered dose inhaler (MDI) or a nebulizer; (3) the device can not deliver a (as with a desired density to improve aerosol delivery and a desired fraction of inspired oxygen to a hypoxemic patient; (4) the device does not have the ability to deliver different density gases with a desired fraction of inspired oxygen simultaneously while retaining the ability to deliver aerosol medication at the same time with either an MDI or a nebulizer; (5) the device does not have the ability to deliver a mixture of multiple gases to a patient and simultaneously maintain a desired fraction of inspired oxygen; (6) the device does not serve as a facemask for delivering varying concentrations of inspired oxygen from room air to 100% but serves solely as an aerosol delivery device; (7) the device does not have a reservoir chamber—either as a bag or as a large volume tubing to store nebulized medication that is otherwise wasted during exhalation (The holding chamber of this type of device varies from 90 cc to 140 cc and is not enough to serve as a reservoir for the volume of nebulized medication generated during exhalation is wasted); (8) there is no mechanism in the device to prevent entrainment of room air which forms the bulk of volume during inhalation (the fraction of inspired oxygen and the density of the gas mixture inhaled by the patient may vary with every breath with the device depending on the volume of entrained room air which may vary with each breath); (9) the device does not have any valve system to prevent exhaled carbon dioxide from entering the holding chamber—rebreathing of carbon dioxide from the holding chamber on subsequent inhalation can be extremely detrimental to a patient and extremely dangerous under certain clinical conditions; (10) the device does not have the capability of delivering medication with an MDI and a nebulizer simultaneously; and (11) the device has a fixed volume-holding chamber which makes the device extremely large and cumbersome to deliver medication.

What is needed in the art and has heretofore not been available is a system that overcomes the above deficiencies and incorporates functionality to make the device a compact user friendly, economical, and multipurpose aerosol device

for both acute and chronic use with either an MDI or a nebulizer or with both devices simultaneously as warranted by the patient's clinical circumstances.

SUMMARY

According to one embodiment, an aerosol inhalation system includes a single source of gas and a Y-connector having a first port in fluid communication with the gas source via a first conduit and second and third ports. The system also has an accessory having a main conduit body that includes a first leg, a second leg, and a third leg, all of which are in fluid communication with the main conduit section. The first leg, is fluidly connected to the second port of the Y-connector via a second conduit to permit gas from the single source to flow through the first leg, the accessory including a patient interface conduit that delivers aerosolized medication to a mouth of the patient.

A nebulizer is sealingly and removably disposed within the third leg and includes a gas inlet port that is fluidly connected to the third port of the Y-connector to permit gas from the single source to flow into the nebulizer to create the aerosolized medication that is delivered into the main conduit body and to the patient through the patient interface conduit.

According to another embodiment, an aerosol inhalation system includes a single source of gas and a Y-connector having a first port in fluid communication with the gas source via a first conduit and second and third ports. The system further includes an accessory having a main conduit body that includes a first leg, a second leg, and a third leg, all of which are in fluid communication with the main conduit section. The first leg is fluidly connected to the second port of the Y-connector via a second conduit that is connected to the second port and a gas port associated with the first leg to permit gas from the single source to enter and flow through the first leg. The accessory also includes a patient interface conduit that delivers aerosolized medication to a mouth of the patient.

A nebulizer is sealingly and removably disposed within the third leg and includes a gas inlet port that is fluidly connected to the third part of the Y-connector to permit gas from the single source to flow into the nebulizer to create the aerosolized medication that is delivered into the main conduit body and to the patient through the patient interface conduit. The gas port has a first inner diameter and the gas inlet port of the nebulizer has a second inner diameter which is greater than the first inner diameter.

Further aspects and features of the exemplary aerosol inhalation system disclosed herein can be appreciated from the appended Figures and accompanying written description.

BRIEF DESCRIPTION OF THE DRAWINGS FIGURES

The foregoing and other features of the present invention will be more readily apparent from the following detailed description and drawings of the illustrative embodiments of the invention wherein like reference numbers refer to similar elements and in which:

FIG. 1 is a perspective view of an accessory for use in an aerosol inhalation system according to a first embodiment;

FIG. 2 is a perspective view of an accessory for use in an aerosol inhalation system according to a second embodiment;

FIG. 3 is a partial cross-sectional view taken along the line 3-3 of FIG. 1;

FIG. 4 is a partial cross-sectional view taken along the line 4-4 of FIG. 1;

5

FIG. 5 is a partial cross-sectional view taken along the line 5-5 of FIG. 1;

FIG. 6 is a side elevation view, in cross-section, of an accessory for use in an aerosol inhalation system according to a third embodiment with the parts thereof being exploded; and

FIG. 7 is a side elevation view, in cross-section, of the accessory of FIG. 6 with the parts of the system of FIG. 6 being attached to one another.

DETAILED DESCRIPTION OF PREFERRED EMBODIMENTS

Now turning to FIGS. 1 and 3-5 in which an accessory or interface element 100 according to one exemplary embodiment and for use in an aerosol delivery system is illustrated. As described below, the accessory 100 is intended for use with a nebulizer or an MDI or another piece of aerosol inhalation equipment. The accessory 100 is defined by a body 110 that can be formed of any, number of different materials, including a plastic material or a metal. The accessory 100 is essentially a hollow body 110 that has a first end (inlet end) 112 and an opposing second end (outlet end) 114. The accessory 100 is intended to act as a fluid connector in that it is fluidly attached to another piece of equipment, such as a facemask, that is directly coupled to the patient's mouth, as well as being fluidly attached to an actuable device that generates the aerosol particles (aerosolized medication) that are delivered to the patient.

In the illustrated embodiment, the body 110 has a main section 116 that includes a number of arms or feet that extend outwardly therefrom, with the inlet end 112 being formed at the end of a first leg 120 that is formed at a right angle to the main section 116. The main section 116 includes a second leg 130 that extends outwardly therefrom between the first leg 120 and the outlet end 114 and a third leg 140 that is located between the outlet end 114 and the second leg 130. The third leg 140 is located proximate the outlet end 114, while the second leg 130 is closer to the first leg 120. The first, second and third legs 120, 130, 140 are thus tubular structures that are in fluid communication with the interior of the tubular main section 116 and are open at their opposite distal ends to receive an object (such as a conduit or connector) or a fluid, etc.

The main section 116 includes a fourth leg 150 that extends outwardly from the main section 116 and is in fluid communication with the interior of the main section 116. Like the other legs, the fourth leg 150 is a tubular structure that is open at its distal end for an attachment to an object (conduit). In the illustrated embodiment, the first, second and third legs 120, 130, 140 extend outwardly from all underside of the tubular main section 116, while the fourth leg 150 extends outwardly from the opposite top side of the tubular main section 116. The fourth leg 150 is located between the second and third legs 130, 140.

The main section 116 is the part of the accessory 100 that is intended to be connected to equipment that is placed over the patient's nose and mouth. Thus, the main section 116 (main conduit) is the principal pathway for fluid, such as air and the aerosol particles, to either enter the patient in the case of aerosol particles and air or to be discharged from the patient as in the case of exhaled gases, such as carbon dioxide.

The first leg 120 serves as a poll or connector for mating with a device 200 that generates a gas flow that is intended to be breathed in by the patient. For example, the device 200 can be in the form of a nebulizer or even an MDI or the like. In the illustrated embodiment, the device is in the form of a nebu-

6

lizer 200 that is fluidly connected to a gas source via a nebulizer conduit 215. The nebulizer 200 is fluidly and sealingly connected to the first leg 120 so that the gas and aerosolized particles generated by the nebulizer 200 are delivered into the interior of the main section 116 of the accessory 100. Any number of techniques can be used to couple the nebulizer 200 to the first leg 120, such as threading, snap-fitting, functionally, etc., the two together.

In one embodiment, the accessory 100 is intended for use with a nebulizer, generally indicated at 200, and therefore includes a holding chamber 300 into which the aerosol particles can be stored prior to the patient inhaling. The holding chamber 300 is preferably formed as a member that is collapsible and expandable depending upon whether gas is being delivered thereto or being evacuated therefrom. The holding chamber 300 thus can have a number of different structures that have a variable dimension, such as a variable length or a variable width. In one embodiment, the holding chamber 300 is defined by a bellows-type structure that can either expand or collapse/constrict depending upon the force applied. As with other accessories of this type, the holding chamber 300 is intended to receive and store the aerosol particles prior to the patient inhaling them by means of the accessory 100 and the facemask.

In the illustrated embodiment, the holding chamber 300 is in the form of an expandable/collapsible bag (reservoir bag) or similar type structure. According to one aspect of the present invention, the holding chamber 300 is in the form of a bi-furcated bag or the like 310 as shown in FIG. 1. More specifically, the bag 310 is bi-furcated and has two independent distinct compartments, namely a first compartment 320 and a second compartment 330. Since the two compartments 320, 330 are distinct from one another (no fluid communication therebetween) the bag 310 has a first port 340 that forms an entrance and is in fluid communication with the first compartment 320, as well as a second port 350 that forms all entrance and is in fluid communication with the second compartment 330. A separating wall or membrane 360 is formed as part of the bag 310 and serves to divide the bag 310 into the first and second compartments 320, 330. The body of the bag 310, as well as the separating wall 360, is preferably formed of a flexible material, such as a fabric that permits the bag 310 to either expand as when fluid enters the bag 310 or contract (collapse) as when the fluid is evacuated from the bag 310. The first port 340 is formed on one side of the separating wall 360, while the second port 350 is formed on the other side of the separating wall 360. Both the first and second ports 340, 350 are typically defined by a hollow stem or boss.

The first port 340 includes a complementary fastening feature that permits it to be sealingly attached to the third leg 140 of the accessory 100, and similarly, the second port 350 includes a complementary fastening feature that permits it to be sealingly attached to the second leg 130. For example, the first and second fastening features can be in the form of threads that mate with complementary threads that are part of the legs 140, 130, respectively. Other fastening means, such as locking means or mechanical fits, such as a frictional fit, can likewise be used so long as the accessory 100, and in particular, the second and third legs 130, 140, are sealingly attached to the bag 310. While, the fastening features can be in the form of threads, it still be appreciated that in many applications and embodiments, the third and second legs 140, 130 and the first and second ports 340, 350 simply mate with one another via a frictional interface fit between two complementary stems.

The first port 340 of the bag 310 also preferably includes a gas inlet port 342 that extends outwardly therefrom and is

constructed to attach to a gas source **370**. More specifically, the gas inlet port **342** is in fluid communication with and provides an entrance into the first port **340** and is in the form of a tubular structure that has a distal end **344**. The end **344** is meant to be attached to the gas source **370** by any number of techniques, including using a gas conduit, such as tubing or the like, that extends from the gas source **370** to the gas inlet port **342**. The gas source **370** is preferably connected to a control system or regulator or the like that permits the flow rate of the gas source **370** to be carefully controlled and varied by means, such as valve assemblies and the like that are associated therewith (e.g., valve assembly within the gas conduit).

The gas source **370** can hold any number of different types of gases that are intended for inhalation by the patient through the accessory **100**.

The accessory **100** includes a number of different valve assemblies that are positioned within the body **110**. More specifically, a first valve assembly **400** is disposed within the open second end **114** of the main section **116** and in the illustrated embodiment the first valve assembly **400** functions as an exhalation valve. The first valve assembly **400** includes a valve element **402** which is positionable between an open position and a closed position and which can be any number of different types of valve structures so long as they function in the intended manner and provide the desired results. The valve **402** typically seats against a valve seat **404** that is formed at the second end **114** when the valve **402** is closed. The illustrated valve **402** is a one-way flap valve that presses against the valve seat **404** on inhalation and completely occludes the open second end **114** to prevent any room air entrainment (i.e., not allowing, the air from the atmosphere to enter into the main section **116** on inhalation). On exhalation, the flap valve **402** moves away from the flap valve seat **404** for the air exhaled by the patient to escape into the atmosphere from the main section **116** by flowing through the fourth leg **150** from a mask or the like and then through the main section **116** and through the opening formed at the second end **104**. The open second end **104** is the only means for the exhaled air to escape as will be appreciated below since the four legs **120**, **130**, **140**, **150** are connected to devices, are capped or otherwise not open.

A second valve assembly **410** is provided and functions as an inhalation valve in that the valve moves between an open position and a closed position depending upon whether the patient is inhaling or exhaling. The second valve assembly **410** is disposed within the body **110** and in particular, the second valve assembly **410** is disposed within the main section **116** at a location between the second leg **130** and the fourth leg **150** such that when the second valve assembly **410** is in an open position, fluid can flow from both the first leg **110** and the nebulizer **200**, as well as from the second leg **130** and the second compartment **330** of the bag **310**, and into the fourth leg **150** where it can flow into the patient's mask and into the patient's respiratory system.

The second valve assembly **410** includes a valve element **412** that can be any number of different types of valve structures so long as they function in the intended manner and provide the desired results. As shown in FIG. 5, the valve **412** typically seats against a valve seat **414** that is formed within the main section **116** when the valve **412** is closed. The illustrated valve **412** is a one-way flap valve that presses against the valve seat **414** on exhalation and completely occludes the main section **116** to prevent any exhaled air to flow from the mask and fourth leg **150** and into either the second compartment **330** of the bag **310** or the first leg **120**. On inhalation, the flap valve **412** moves away from the flap

valve seat **414** to permit the gas from the nebulizer **200** and/or gas stored in the second compartment **330** of the bag **310** to flow into and through the main section **116** and into the fourth leg **150** where it flows into the mask to the patient.

As in FIG. 4, a third valve assembly **420** is provided and is disposed in the third leg **140** or it can be provided in the stem that defines the first port **340** that is associated with the bag **310**. The third valve assembly **420** functions as an inhalation valve in that the valve moves between an open position and a closed position depending upon whether the patient is inhaling or exhaling.

The third valve assembly **420** includes a valve element **422** that can be any number of different types of valve structures so long as they function in the intended manner and provide the desired results. The valve **422** typically seats against a valve seat **424** that is formed within either the third leg **140** or first port **340** when the valve **422** is closed. The illustrated valve **422** is a one-way flap valve that presses against the valve seat **424** on exhalation and completely occludes the third leg **140** or first port **340** to prevent any exhaled air to flow from the mask and fourth leg **150** and into either the first compartment **320** of the bag **310**. On inhalation, the flap valve **422** moves away from the flap valve seat **424** to permit the gas from the first compartment **320** of the bag **310** to flow into and through the main section **116** and into the fourth leg **150** where it flows into the mask to the patient.

While the two compartments **320**, **330** of the bag **310** are illustrated as having equal or about equal volumes it will be appreciated that the bag **310** can be constructed so that one of the compartments **320**, **330** has a greater volume. For example, the first compartment **320** that serves as the nebulizer holding compartment can have a greater volume than the second compartment **330** which receives the supplemental gas to backup the nebulized medication holding chamber.

The first leg **120** is intended to be fluidly attached to the device that generates the aerosol particles (medication) that is delivered to the patient and preferably, as illustrated, the first leg **120** is fluidly connected to the nebulizer **200**. More specifically, a connector **212** of a conduit (tube) **210** of the nebulizer **200** is sealingly attached to the first leg **120** so that the nebulized medication is delivered thoroughly the conduit **210** and into the interior of the first leg **120** and when the second valve element **412** is open, the nebulized medication (aerosol particles) travels the length through the first leg **120** and a portion of the main section **516** and through the opening defined by the valve seat **414** and into the fourth leg **150** and then into the equipment (facemask) that delivers the medication to the patient. This is the sequence of events when the patient inhales. Conversely, when the patient exhales, the second valve element **412** closes; however, the nebulizer **200** continues to deliver the nebulized medication through the first leg **120** into the interior of the main section **116**. Since the second valve element **412** is closed when the patient exhales prior to the next inhalation the nebulized medication can not flow past the valve assembly **410** and into the fourth leg **150** but instead flows through the second leg **130** through the second port **350** and into the second compartment **330** of the bag **310**.

The second compartment **330** of the bag **310** is therefore intended to act as a main reservoir bag in that the second compartment **330** receives and holds the nebulized medication until the patient inhales. The second compartment **330** of the bag **310** thus expands until the patient inhales at which time the second valve element **412** opens and the inhalation of the patient draws the nebulized medication out of the second compartment **330** into the main section **116** and then into the fourth leg **150** where it is delivered to the patient.

There are some circumstances where an insufficient amount of nebulized medication is present in the second compartment **330** of the bag **310**. This may result because the flow rate of the nebulizer **200** is insufficient for the patient as when the patient has a greater body weight than the flow rate setting of the nebulizer **200**. When this does occur, the patient experiences a very uncomfortable feeling in that the patient will experience an insufficient air flow to the lungs and therefore will begin to breathe more deeply and rapidly. In other words, the patient may begin feeling as though they need to gasp for air to breathe.

The present invention overcomes such potential deficiency in air flow to the patient by providing the first compartment **320** in the bag **310** which acts as a supplemental air source for the patient due to the first compartment **320** being attached to a supplemental gas source, generally indicated at **370**. Preferably, the gas source **370** connects to the stem of the first port **340** as shown in the figures; however, it is possible for the gas source **370** to be directly connected to the first compartment **320** of the bag **310**. In any event, the gas source **370** is directly and fluidly connected to the first compartment **320** and therefore, the gas is delivered into the first compartment **320**. As with the flow of nebulized medication into the second compartment **330**, the flow of the gas source **370** into the first compartment **320** causes the first compartment **320** to expand as the bag **310** is filled with gas.

It will be appreciated that the gas source **370** serves as a supplemental gas since gas stored in the first compartment **320** is in selective fluid communication with the main section **116** and therefore, can flow to the patient under certain circumstances as discussed below. In other words, if there is insufficient gas in the form of nebulized gas in the second compartment **330**, when the patient inhales, then the patient will not experience the above described breathing problems since the first compartment **320** is open to the patient through, the main section **116** and therefore the patient can inhale the supplemental gas that is present in the first compartment **320** to make up for any shortfall in gas in the second compartment **330**.

The gas source **370** typically has an associated valve assembly (not shown) that is external to the system and is typically at the gas source **370** for controlling the flow rate of the gas source **370** into the first compartment **320**. The valve assembly is preferably an adjustable valve that controls the flow rate of the supplemental gas into the first compartment **320**. Any number of different valve mechanisms are suitable for this type of application and typically include an adjustable part, such as a dial, that permits the physician to easily alter and change the flow characteristics. For example, the valve mechanism can include an adjustable member that when manipulated either sequentially closes or opens the opening, formed in the conduit that delivers the supplemental gas to the first compartment **320**.

Thus, the physician can initially set the valve at one setting which the physician believes will provide a sufficient supplemental gas flow into the first compartment **320** based on the physicians past experiences and based on certain characteristics of the patient, such as the size and weight of the patient. For example, when the patient is a large adult or even a large child, the flow rate of the nebulized medication into the second compartment **330**, even when it is set at a maximum flow rate, may not be sufficient and therefore, this could result in the patient receiving a low level of air and feeling the above noted discomfort. The gas source **370** thus supplements the gas flow of the nebulizer **200** and makes up for any deficiency so that the patient breaths smoothly throughout the procedure.

When setting the valve, the physician will keep in mind that it may not be desirable to set the flow rate of the supplemental gas at too high a value since this will result in the first bag compartment **320** expanding and also, results in the supplemental gas source **370** mixing with the nebulized medication as the patient inhales, thereby causing a decrease in the inhaled concentration of the medication. As mentioned before, it is desirable to try to keep as fixed as possible the concentration of the inhaled medication. Since the first compartment **320** is fluidly connected to the main section **116** via the third leg **140** and is fluidly connected to the first valve assembly **400**, any excess build up of supplemental gas in the first compartment **320** can be vented through the first valve **402** each time the patient exhales since the second valve assembly **410** closes when the patient exhales and the supplemental gas can not flow past the second valve assembly **410** toward the other legs and the second compartment **330** of the bag **310**.

In the event that the initial setting of the valve is not optimal in that the too much supplemental gas is being delivered to the first bag compartment **320** or too little supplemental gas is being delivered to the first bag compartment **320**, the physician simply needs to make the necessary adjustment to the valve to either immediately reduce or increase, respectively, the supplemental gas flow into the first bag compartment **320**. This can be done by simply turning or otherwise manipulating the valve. It is also very easy for the physician to determine whether the flow rate of the supplemental gas source **370** is optimal since the physician can observe the bag **310** and more particularly, can observe whether either the first bag compartment **320**, the second compartment **330** or both compartments **320**, **330** appear to be excessively collapsed (thus indicating an increase in flow rate is needed) or excessively expanded or extended (thus indicating a decrease in flow rate is needed). The physician can simply and immediately alter the flow rate and thus, the accessory **100** is tailored to be used with a whole range of different types of patients, from small infants up to large adults.

A supplemental gas valve assembly is preferably provided for controlling the flow of the supplemental gas out of the first compartment **320** and into the third leg **140** and more particularly, to permit flow of the supplemental gas from the first bag compartment **320** into the third leg **140**, through the main section **116** and ultimately to the patient when the patient inhales and conversely, preventing the flow of supplemental gas from the first bag compartment **320** into the third leg **140** when the patient exhales. It will also be appreciated that when valve assembly closes during exhalation, the exhaled air that includes waste gases is not permitted to flow into the first bag compartment **320** where it could then be drawn into the patient at the next annihilation movement of the patient.

Now referring to FIG. **2** in which another embodiment of an accessory **101** is illustrated. The accessory **101** is similar to the accessory **100** and therefore, like elements are numbered alike. In the accessory **101**, the first leg **120** no longer is formed at one end of the main section **116** but rather is formed in the middle of the main section between the fourth leg **150** and the second leg **130** which is located closer to one end of the main section **116**. In this design, the first leg **120** is closer to the fourth leg **150** and since the first leg **120** is still fluidly connected to the nebulizer **200**, the length of the gas flow path from the nebulizer **200** to the face mask is less in this embodiment than in the embodiment of FIG. **1** due to the relative positions of the first and fourth legs **120**, **150**.

Since the first leg **120** is not formed at the end of the main section **116** in this embodiment, the main section **116** has an

open end **117** and a closed end **119**. The second leg **130** is located proximate the open end **117**.

As shown the first leg **120** is disposed between the second valve assembly **410** and the second leg **130** and in particular, the first leg **120** communicates with the interior of the main section **116** at a location that is near the second valve element **412**. It will be appreciated that in this embodiment, the nebulizer **200** is located in front of/downstream from the gas flow from the second compartment **330** of the bag **310** and the present applicants have discovered that the placement of the nebulizer **200** in this location results in improved performance and improved drug delivery since the aerosolized medication is located closer to the face mask as measured along the gas flow path. In addition, this location for the nebulizer **200** permits the gas flow from the second compartment **330** of the bag **110** to assist in carrying the aerosolized medication to the fourth leg **150** and into the patient's mask or the like. In other words, the gas flow from the second compartment **330** acts to entrain the aerosolized medication that is flowing, through the first leg **120** from the nebulizer **200**.

The first valve **400** is located in the open end **117** of the section **116**.

The operation of the components is the same in this embodiment as in the other embodiments. For example, the valve assemblies **400**, **410**, **420** operate the same or similar in both embodiments. The first leg **120** is positioned close to the second valve assembly **410** such that once the valve element **412** opens upon inhalation, the gas and aerosolized medication from the nebulizer **200** flows through the valve element **412** and into the fourth leg **150** to the patient.

It will also be appreciated that in each of the embodiments of FIGS. **1** and **2**, the first leg **120** can be capped or otherwise sealed as when nebulizer **200** is not used with the respective accessory. In this design, the bag **310** can serve as a means for delivering a gas, such as oxygen or helix, etc., to the patient. In particular, gas source **370** provides gas that is routed through the first compartment **320** of the bag **310** and into the main section **116** and then into the fourth leg **150** to the face mask.

Referring now to FIGS. **6-7** in which yet another embodiment of the present invention is illustrated. In this embodiment, an accessory **500** is illustrated and is similar in construction to the accessories **100** and **300**; however, as described below, there are several key differences.

As with the other accessories, the accessory **500** is intended for use with a nebulizer or an MDI or another piece of aerosol inhalation equipment. The accessory **500** is defined by a body **510** that can be formed of a number of different materials, including plastics or even metals. The accessory **500** is essentially a hollow body **510** that has a first end **512** and an opposite closed second end **514**. The accessory **500** is intended to act as a fluid connector in that it is fluidly connected to another piece of equipment, such as a facemask, that is directly coupled to the patient's mouth, as well as being fluidly attached to an actuatable device that generates the aerosol particles (aerosolized medication) that are delivered to the patient.

In the illustrated embodiment, the body **510** has a main section **520** that includes a number of arms or feet that extend outwardly therefrom. More specifically, a first leg **530** is formed at or proximate the first end **512** of the body **510**, a second leg **540** is formed in an intermediate region of the body **510** and a third leg **550** is formed at or proximate the second end **514**. In other words, the second leg **540** is formed between the first and third legs **530**, **550**. The first, second and third legs **530**, **540**, **550** are tubular structures that are in fluid communication with the interior of the tubular main section

520 and are open at their opposite distal ends to receive an object (such as a conduit or connector, etc.) or a fluid, etc.

The main section **520** also includes a fourth leg **560** that extends outwardly from the main section **520** and is also in fluid communication with the interior of the main section **520**. Like the other legs, the fourth leg **560** is a tubular structure that is open at its distal end for attachment to an object, such as a mask or mouthpiece or the like, generally indicated at **561**. In the illustrated embodiment, the first, second and third legs **530**, **540**, **550** extend from an underside of the main section **520**, while the fourth leg **560** extends from a top side of the main section; however, this is merely an exemplary arrangement, and the relative positions of the legs can be varied, including having the legs be disposed at less than 90 degrees from one another. The fourth leg **560** is located between the first and second legs **530**, **540**.

The main section **520** is part of an accessory that is intended to be connected to equipment that is placed over the patient's nose and mouth, thus, the main section **520** (main conduit) is the principal pathway for fluid to either enter the patient in the case of aerosol particles and air (or other fluid) or to be discharged from the patient as in the case of exhaled gases, such as carbon dioxide.

Unlike the embodiments shown in FIGS. **1** and **2**, the accessory **500** is intended to be connected to a single gas source, as opposed to two separate gas sources. More specifically, the second end **514** is a closed end of the main section and the third leg **550** serves as a port or connector for mating with a device **600** that generates a gas flow that is intended to be breathed in by the patient. For example, the device **600** can be in the form of a nebulizer or even an MDI or the like. In the illustrated embodiments the device **600** is shown exploded from the main section **520** and is in the form of a nebulizer body **610** that includes the medication to be delivered and has a leg **612** that is sized and shaped to be received into the third leg **550**. The leg **612** is thus a hollow tubular structure that is matingly and frictionally received and held within the third leg **550** when it is opened. FIG. **7** shows a removable cap **701** disposed within the third leg **550**; however, when the nebulizer **600** is to be connected to the main section **520**, the cap **701** is simply removed from the third leg **550** so as to fully open up the third leg **550**. The nebulizer **600** is thus slidingly inserted into the third leg **550** and can later be removed therefrom.

In addition to having a compartment for holding the medication to be aerosolized, the nebulizer body **610** has a conduit **620** that is intended to be fluidly connected to a source of gas for creating the aerosolized medication. For example, a gas conduit (tube) can be connected to a free end of the conduit **620** for providing gas to the nebulizer **600**.

The cap **701** can be attached to the third leg **550** by means of a flexible strap **703** or the like so that when the cap **701** is removed from the third leg **550**, the cap **701** can simply hang from the third leg **550**, thereby reducing the chances that it might be misplaced, etc. The cap **701** has a nipple **705** or the like that is a hollow conduit that includes a bore or thorough hole that extends completely through the cap **701**, thereby permitting fluid communication between the exterior and the interior of the third leg **550**, and thus, the interior of the main section **520**.

As with the other embodiments, the accessory **500** is intended for use with the nebulizer **600** and therefore includes a holding chamber **700** into which the aerosol particles can be stored prior to the patient inhaling. The holding chamber **700** is preferably formed as a member that is collapsible and expandable depending upon whether gas is being delivered thereto or being evacuated therefrom. The holding chamber

13

700 thus can have a number of different structures that have a variable dimensions such as a variable length or a variable width. In one embodiment the holding chamber **700** is defined by a bellows-type structure that can either expand or collapse/constrict depending upon the force applied. As with other accessories of this type, the holding chamber **700** is intended to receive and store the aerosol particles prior to the patient inhaling them by means of the accessory **500** and the face-mask.

In the illustrated embodiment, the holding chamber **700** is in the form of an expandable/collapsible bag (reservoir bag) or similar type structure. According to one aspect of the present invention, the holding chamber **700** is in the form of a bi-furcated bag or tube like **710** as shown in FIG. 6. More specifically, the bag **710** is bi-furcated and has two independent distinct compartments namely a first compartment **720** and a second compartment **730**. Since the two compartments **720**, **730** are distinct from one another (no fluid communication therebetween), the bag **710** has a first connector **740** that forms all entrance and is in fluid communication with the first compartment **720**, as well as a second connector **750** that forms an entrance and is in fluid communication the second compartment **730**. A separating wall or membrane **760** is formed as part of the bag **710** and serves to divide the bag **710** into the first and second compartments **720**, **730**. The body of the bag **710**, as well as the separating wall **760**, is preferably formed of a flexible material, such as a fabric that permits the bag **710** to either expand as when fluid enters the bag **710** or contract (collapse) as when the fluid is evacuated from the bag **710**. The first connector **740** is formed on one side of the separating wall **760**, while the second connector **750** is formed on the other side of the separating wall **760**. Both the first and second connector **740**, **750** are typically defined by a hollow stem or boss.

The first connector **740** includes a complementary fastening feature that permits it to be sealingly attached to the first leg **530** of the accessory **500**, and similarly, the second connector **750** includes a complementary fastening feature that permits it to be sealingly attached to the second leg **540**. For examples the first and second fastening features can be in the form of threads that mate with complementary threads that are part of the legs **530**, **540**, respectively. Other fastening means, such as locking means or mechanical fits, such as a frictional fit, can likewise be used so long as the accessory **500**, and in particular, the second and third legs **530**, **540**, are sealingly attached to the bag **710**. While, the fastening features can be in the form of threads, it will be appreciated that in many applications and embodiments, the third and second legs **530**, **540** and the first and second connectors **740**, **750** simply mate with one another via a frictional interface fit between two complementary stems.

The first connector **740** of the bag **710** also preferably includes a gas inlet port **742** that extends outwardly therefrom and is constructed to attach to a gas source. More specifically, the gas inlet port **742** is in fluid communication with and provides an entrance into the first connector **740** and is in the form of a tubular structure that has a distal end **744**. The end **744** is meant to be attached to the gas source by any number of techniques, including using a gas conduit, such as tubing or the like, that extends from the gas source to the gas inlet port **742**. The gas source is preferably connected to a control system or regulator or the like that permits the flow rate of the gas source to be carefully controlled and varied by means, such as valve assemblies and the like that are associated therewith (e.g., valve assembly within the gas conduit).

14

The gas source can hold any number of different types of gases that are intended for inhalation by the patient through the accessory **500**.

In addition, the first leg **530** can contain a supplemental gas inlet port or connector **751** that extends outwardly therefrom and can be fluidly attached to a supplemental gas source. The gas inlet port **751** is formed so that it is above the first connector **740** when the first connector **740** is inserted into the first leg **530** so that the gas inlet port **751** does not interfere with the reception of the first connector **740** into the first leg **530**.

The second connector **750** is similar to the first connector **740** and is in the form of a tubular connector that is both sized and shaped to fit intimately within the second leg **540**. For example, the second connector **750** can be frictionally fit into and held within the second leg **540** as by slidingly engaging the second connector **750** within the second leg **540**. The lengths of the first and second connectors **740**, **750** are preferably the same.

The accessory **500** includes a number of different valve assemblies that are positioned within the body **510**. More specifically, a first valve assembly **800** is disposed within the open first end **512** of the main section **520** and in the illustrated embodiment, the first valve assembly **800** functions as an exhalation valve. The first valve assembly **800** includes a valve element **802** which is positionable between an open position and a closed position and which can be any number of different types of valve structures so long as they function in the intended manner and provide the desired results. The valve **802** typically seats against a valve seat that is formed at the first end **512** when the valve **802** is closed, the illustrated valve **802** is a one-way flap valve that presses against the valve seat on inhalation and completely occludes the open first end **512** to prevent any room air entrainment (i.e., not allowing the air from the atmosphere to enter into the main section **520** on inhalation). On exhalation, the flap valve **802** moves away from the flap valve seat for the air exhaled by the patient to escape into the atmosphere from the main section **520** by flowing through the fourth leg **560** from a mask or the like and then through the main section **520** and through the opening formed at the first end **512**. The open first end **512** is the only means for the exhaled air to escape as will be appreciated below.

A second valve assembly **810** is provided and functions as a first inhalation valve in that the valve moves between an open position and a closed position depending upon whether the patient is inhaling or exhaling. The second valve assembly **810** is disposed within the first leg **530** when the holding chamber is attached thereto and in particular, the second valve assembly **810** includes a valve element **812** that is disposed at the free distal end of the connector **740**.

The second valve assembly **810** includes a valve element **812** that can be any number of different types of valve structures so long as they function in the intended manner and provide the desired results. The valve **812** typically seats against a valve seat that is formed at the distal end of the connector **740**. The illustrated valve **812** is a one-way flap valve that presses against the valve seat on exhalation and completely occludes the first leg **530** to prevent any exhaled air to flow from the mask through the main section **520** and into the first compartment **710**. The valve element **812** is thus positioned so that the gas inlet port **742** is disposed between the valve element **812** and the first compartment **710**. Thus, the closing of the valve element **812** prevents exhaled gas from flowing into the gas inlet port **742**.

It will be appreciated that instead of incorporating the valve element **812** into the connector **740**, the valve element **812**

can be directly incorporated into the first leg 530 such that it still selectively permits fluid flow from the first compartment 710 and from the gas inlet port 742.

The valve element 812 is thus positioned so that the gas inlet port 742 is disposed between the valve element 812 and the first compartment 710. Thus, the closing of the valve element 812 prevents exhaled gas from flowing, into the gas inlet port 742.

A third valve assembly 820 is provided and functions as a second inhalation valve in that the valve moves between an open position and a closed position depending upon whether the patient is inhaling or exhaling. The third valve assembly 820 is disposed within the main section 520 and in particular, the third valve assembly 820 is disposed within the main section 520 between the first and second legs 530, 540. In addition, the third valve assembly 820 is disposed between the fourth leg 560 and the second leg 540.

The third valve assembly 820 includes a valve element 822 that can be any number of different types of valve structures so long as they function in the intended manner and provide the desired results. The valve 822 typically seats against a valve seat 824 that is formed within the main section 520. The illustrated valve 822 is a one-way flap valve that presses against the valve seat 824 on exhalation and completely occludes the main section 530 to prevent any exhaled air to flow from the mask through the main section 520 and into the first compartment 710.

Both the first and second inhalation valves 812, 822 close when the patient exhales and conversely open when the patient inhales. Thus, when the patient exhales and the valves 812, 822 close, the exhaled gas travels down the fourth leg 560 into the main section 520; however none of the first, second and third legs 530, 540, 550 are accessible and therefore, the exhaled gas must flow to the exhalation valve 802, which is open and thus, the exhaled gas flows out of the main section 820.

While the two compartments 720, 730 of the bag 710 are illustrated as having equal or about equal volumes, it will be appreciated that the bag 710 can be constructed so that one of the compartments 720, 730 has a greater volume. For example, the first compartment 720 that serves as the nebulizer holding compartment can have a greater volume than the second compartment 730 which receives the supplemental gas to backup the nebulized medication holding chamber.

In this embodiment, there is a single main gas source as opposed to the two gas sources of the previous embodiments. A single main gas source 900 is provided and a first conduit section 910 is connected at a first end 912 to the gas source 900, while an opposite second end 914 is connected to a conduit adapter or connector 920. The connector 920 is a Y connector in that it has a first leg 922 that is connected to the second end 914 of the conduit 910, as well as second and third legs 924, 926, respectively. Fluid flow (gas from source 900) is thus delivered into the first leg 922 and then split into two flow paths, namely, those defined by the second and third legs 924, 926. A second conduit section 930 is connected at a first end 932 to the second leg 924 and a separate third conduit section 940 is connected at a first end 942 to the third leg 926. An opposite second end 934 of the second conduit section 900 is connected to the gas inlet port 742 to deliver (as from the source 900 into the first compartment 710 and/or into the main section 520 by traveling through the first leg 530. An opposite second end 944 of the third conduit section 940 is connected to either the nipple 705 that is part of the cap 701 or the conduit 620 of the nebulizer body 610 depending upon whether the nebulizer 600 is installed in the third leg 550 or whether the cap 701 is installed in the third leg 550. In either

instance, gas flows through the second conduit section 930 and into the third leg 530. When it is desired to deliver aerosolized medication to the patient, then the nebulizer 600 is installed in the third leg 550 and the second conduit section 930 is connected to the conduit 620 to permit gas to flow from main gas source 900 to the nebulizer 600 where the medication is aerosolized.

The use of a single main gas source 900 compared to two separate gas sources (as in the other embodiments) provides a number of advantages. First, the use of a single source is more economical and simpler in design since only one supply of gas is needed. Consequently, less space is consumed since only one gas tank is needed. In addition, since only one gas is used, the flow rates and the formulations for the patient can be more easily controlled and monitored.

When operating the accessory 500 with the nebulizer 600, the nebulizer 600 is inserted into the third leg 550. The second leg 540 remains capped for most applications and the gas input (conduit 620) of the nebulizer 600 becomes the third port of the accessory 600. The second and third legs 540, 550 are constructed as gas inlet ports that utilize gas tubing.

In accordance with one aspect of the present invention the dimensions of the gas inlet port 742 and the conduit 620 of the nebulizer 600 are carefully selected to optimize the performance of the nebulizer 600. In particular, the gas inlet port 742 is constructed so that it has dimensions (e.g., diameter) less than the dimensions of the conduit 620 of the nebulizer 600. For example, the spray hole for commercially available nebulizers 600 ranges from about 0.022 inches to about 0.025 inches. The resultant flows in the tubing (port 742 and conduit 620) are as follows when using 15 LPM (liters per minute) O₂ (the maximal measurable flow for commercially available flowmeters for air and oxygen). For example, the diameter for port 742 is identified as P1 and can have a diameter of between about 0.020 inches and 0.025 inches and the diameter for conduit 620 (nebulizer spray hole) is identified as P3 and can have a diameter of between about 0.022 inches and 0.025 inches. However, in the various exemplary embodiments, the size of the port 742 is less than the size of the conduit 620 (nebulizer spray hole). The ratio for the two openings determines the ratio of the two gas flows through the port 742 and conduit 620.

If $P1 > P3$, then more than half of the flow will go through the gas tubing to the gas inlet port 742. The nebulizer 1100 will receive less than 7.5 LPM of flow. If P1 is substantially greater than P3, then the flow to the nebulizer 1100 will be much less than 7.5 LPM. Since most single treatment nebulizers require 8 LPM to 12 LPM to work optimally, this condition is less than ideal. If $P1 = P3$, then half of the flow will go through the tubing to the port 742. The nebulizer 1100 will receive 7.5 LPM of flow. Since most single treatment nebulizers require 8 LPM to 12 LPM to work optimally, this condition is less than ideal although the nebulizer 600 will be useable.

If $P1 < P3$, then more than half of the flow will go through the tubing to port (conduit) 620. This nebulizer receive more than 7.5 LPM of flow. Since most single treatment nebulizers 600 require 8 LPM to 12 LPM to work optimally, this condition is ideal as long as $P1 > P3$ but not when P1 is substantially greater than P3 since the flow to the nebulizer will approach 15 LPM and the tubing disconnect from port 620 due to back pressure. For the case, where $P1 > P3$ within about 20%, we observe that the nebulizer 600 will see approximately 20% more than half the flow. Thus, the nebulizer 600 would receive a flow of about 9 LPM which is within most nebulizer optimal operating parameters.

Thus, for the given total flow to the system, the ratios of the flows through P1 and P3 are dependent on the ratios of the (r^4) of the two holes, where r is the radius of the opening. Thus, the flow through port 742/the flow through port 620 is equal or approximately equal to $[(\text{radius port } 742)^4]/[(\text{radius port } 620)^4]$. The spray hole (conduit 620) for commercially available nebulizers range from about 0.022 inches to about 0.025 inches. So, if port 742 has a radius of about 0.020 inches, this allows for flow ranging from 8.5 LPM to about 11 LPM. It will also be appreciated that the above optimization techniques for the sizing of the ports 742, 620 is not limited to the situation where the (as is air, but instead, other gases, such as helix which is very much less dense, can be used. If the port 742 had the same dimensions as the conduit 620, the greater part of the gas would flow through port 742 and consequently, the nebulizer 600 would not get sufficient gas flow. Since the gas is lighter than Ox, even less gas would go to the nebulizer 600. When helix is used, the flow rate can be set at 16.5 LPM using a flow meter designed for use with helix. Since helix gas requires a higher flow rate than oxygen to nebulize the same dose output, higher flows have to be set up with the helix flow meters. Otherwise, correction factors have to be used in order to determine the correct reading that corresponds to 16.5 LPM. Flows of 10 LPM to 14 LPM are recommended for nebulizer operation.

Flows through the second and third conduit sections 930, 940 to the ports 742, 620, respectively, determine the resultant flow to the nebulizer 600. This is in part due to ratios of the hole sizes stated above. Once the flow window for port 610 (the nebulizer 600) has been determined to be within about 8 LPM to about 12 LPM, optimal operation for mobilization is assured. Port 742 can be used to dilute a given gas used (such as oxygen or premixed helix, through ports 742, 620). This is done by using the original gas with the Y tubing and then opening port 742 to outside air or by using a second gas source to deliver air at a fixed rate. Alternatively, another gas could be used through port 742 and in one embodiment, anesthesia gas can be introduced into the port 742.

It will be appreciated that the above dimensions are merely exemplary and the components can have dimensions that lie outside the above ranges so long as the desired results, as discussed above, are achieved.

Having described embodiments of the invention with reference to the accompanying drawings it is to be understood that the invention is not limited to those precise embodiments, and that various changes and modifications may be effected therein by one skilled in the art without departing from the scope or spirit of the invention as defined in the appended claims.

What is claimed is:

1. An aerosol inhalation system comprising:
a single source of gas;

a Y-connector having a first port in fluid communication with the gas source via a first conduit and second and third ports;

an accessory having a main conduit body that includes a first leg, a second leg, and a third leg, all of which are in fluid communication with the main conduit section, the first leg being fluidly connected to the second port of the Y-connector via a second conduit to permit gas from the single source to flow through the first leg, the accessory including a patient interface conduit that is adapted to deliver aerosolized medication to a mouth of the patient; a nebulizer sealingly and removably disposed within the third leg, the nebulizer including a gas inlet port that is fluidly connected to the third port of the Y-connector to permit gas from the single source to flow into the nebu-

lizer to create the aerosolized medication that is delivered into the main conduit body and to the patient through the patient interface conduit; and

a holding chamber having a first compartment and a second compartment separated from the first compartment, with the first compartment being sealingly and fluidly coupled to the first leg and the second compartment being sealingly and fluidly coupled to the second leg, wherein the holding chamber is defined by a reservoir bag with the first and second compartments defined therein and separated from one another by a bi-furcating wall, the reservoir bag being formed of an expandable/collapsible material.

2. The system of claim 1, further including:

an arrangement of valves such that when the patient exhales, the first, second and third legs are sealingly closed off from the patient interface conduit resulting in exhaled air being delivered to a first end of the main conduit body that is selectively open when the patient exhales and conversely, when the patient inhales, the first, second and third legs are opened to the main conduit body resulting in the aerosolized medication being delivered through the main conduit body to the patient interface conduit and to the patient.

3. The accessory of claim 2, wherein the arrangement of valves includes an exhalation valve that is disposed at the first end of the main conduit body, the exhalation valve moving between an open position when the patient exhales, thereby opening the main conduit body to atmosphere and a closed position when the patient inhales.

4. The accessory of claim 3, wherein the exhalation valve comprises a one way valve.

5. The accessory of claim 2, wherein the arrangement of valves includes a first inhalation valve that is in communication with the first leg and a second inhalation valve that is disposed within the main conduit body between the first and second legs, each inhalation valve moving between an open position when the patient inhales, thereby opening at least one of the first, second and third legs to the patient interface conduit and a closed position when the patient exhales.

6. The accessory of claim 5, wherein each of the inhalation valves comprises a one way valve.

7. The accessory of claim 2, wherein the holding chamber has a supplemental fluid port associated therewith which is in fluid communication with the first leg for introducing a gas into the first leg and into the first compartment of the holding chamber, the supplemental fluid port having a first inner diameter and the gas inlet port of the nebulizer has a second inner diameter which is greater than the first inner diameter.

8. The accessory of claim 7, wherein the second inner diameter is at least 10% greater than the first inner diameter.

9. The accessory of claim 7, wherein the second inner diameter is between about 10% to about 20% greater than the first inner diameter.

10. The accessory of claim 7, wherein the gas is oxygen and the first and second inner diameters are selected so that the nebulizer receives a flow rate between about 8 LPM (liters per minute) to about 12 LPM.

11. The accessory of claim 7, wherein the gas is heliox and the first and second inner diameters are selected so that the nebulizer receives a flow rate of about 16.5 LPM.

12. The accessory of claim 1, wherein each of the first, second and third legs is a tubular structure.

13. The accessory of claim 1, wherein the reservoir bag includes a first connector that is in communication with the first compartment and a second connector that is in communication with the second compartment, the first connector

19

being slidably and sealingly received within the first leg and the second connector being slidably and sealingly received with the second leg.

14. The accessory of claim 13, wherein the first connector includes a supplemental fluid port that permits introduction of a fluid into the first connector and into the first compartment of the reservoir bag and an inhalation valve disposed at an end of the first connector, the inhalation valve opening when the patient inhales to provide communication between the supplemental fluid port and the main conduit body.

15. The accessory of claim 14, wherein the first leg includes a fluid port that is in communication with the main conduit body, the fluid port being disposed between the inhalation valve at the end of the first connector and an entrance into the main conduit body.

16. The accessory of claim 15, wherein the first connector comprises a tubular structure that is received within a tubular structure of the first leg such that the inhalation valve is contained within the first leg below the fluid port but above the supplemental fluid port.

17. The accessory of claim 1, wherein the main conduit body is formed of first and second sections that are coupled together to form a unitary structure, the first section including the first leg and the second section including the second and third legs.

18. An aerosol inhalation system comprising:

a single source of gas;

a Y-connector having a first port in fluid communication with the gas source via a first conduit and second and third ports;

an accessory having a main conduit body that includes a first leg, a second leg, and a third leg, all of which are in fluid communication with the main conduit section, the first leg being fluidly connected to the second port of the Y-connector via a second conduit that is connected to the second port and a first gas inlet port associated with the first leg to permit gas from the single source to enter and flow through the first leg, the accessory including a patient interface conduit that is adapted to deliver aerosolized medication to a mouth of the patient;

a nebulizer sealingly and removably disposed within the third leg, the nebulizer including a second gas inlet port that is fluidly connected to the third port of the Y-connector to permit gas from the single source to flow into the nebulizer to create the aerosolized medication that is delivered into the main conduit body and to the patient through the patient interface conduit, wherein the first gas inlet port has a first inner diameter and the second gas inlet port of the nebulizer has a second inner diameter which is greater than the first inner diameter; a holding chamber having a first compartment and a second compartment separated from the first compartment, with the first compartment being sealingly and fluidly coupled to the first leg and the second compartment being sealingly and fluidly coupled to the second leg, wherein the holding chamber is defined by a reservoir bag with the first and second compartments defined therein and separated from one another by a bi-furcating wall, the reservoir bag being formed of an expandable/collapsible material; and an arrangement of valves including a first inhalation valve, a second inhalation valve, and an exhalation valve, the first inhalation valve being associated with the first leg so as to control the flow of the gas through the first gas inlet port and into the main conduit body, the second inhalation valve being located within the main conduit body between the first leg and the third leg so as to control the flow of gas

20

through the second gas inlet port and into the main conduit body, wherein inhalation by the patient results in the first and second inhalation valves assuming open positions to permit gas to flow to the patient, the exhalation valve opening when the patient exhales, while the inhalation valves are closed, thereby preventing flow of gas to the patient.

19. The accessory of claim 18, wherein the second inner diameter is at least 10% greater than the first inner diameter.

20. The accessory of claim 18, wherein the second inner diameter is between about 10% to about 20% greater than the first inner diameter.

21. The accessory of claim 18, wherein the second inner diameter is at least 20% greater than the first inner diameter.

22. The accessory of claim 18, wherein the gas is oxygen and the first and second inner diameters are selected so that the nebulizer receives a flow rate between about 8 LPM (liters per minute) to about 12 LPM.

23. A method of delivering aerosolized medication to a patient comprising the steps of:

connecting a single source of gas to a first port of a Y-connector via a first conduit, the Y-connector having second and third ports;

providing an accessory having a main conduit body that includes a first leg and a second leg, both of which are in fluid communication with the main conduit section, the accessory having a patient interface conduit that is adapted to deliver aerosolized medication to a mouth of the patient;

connecting the first leg to the second port of the Y-connector via a second conduit to permit gas from the single source to flow through the first leg and into the main conduit body;

disposing a nebulizer within the third leg and connecting a first gas inlet port of the nebulizer to the source of gas via a third conduit that is connected to the third port of the Y-connector to permit gas from the single source to flow into the nebulizer to create the aerosolized medication that is delivered into the main conduit body and to the patient through the patient interface conduit

attaching a holding chamber to the first and second legs of the main conduit body, the holding chamber having a first compartment and a second compartment separated from the first compartment, with the first compartment being sealingly and fluidly coupled to the first leg and the second compartment being sealingly and fluidly coupled to the second leg; and

providing an arrangement of valves including a first inhalation valve, a second inhalation valve, and an exhalation valve, the first inhalation valve being associated with the first leg so as to control the flow of the gas into the main conduit body, the second inhalation valve being located within the main conduit body between the first leg and the third leg so as to control the flow of gas into the main conduit body, wherein the first compartment is located on one side of the second inhalation valve, while the second compartment is located on the other side of the second inhalation valve such that gas flowing from the nebulizer flows into the main conduit body and enters the second compartment when the second inhalation valve is closed due to the relative locations of the second inhalation valve in the main conduit body and the second leg that forms an entrance to the second compartment;

21

wherein the holding chamber is defined by a reservoir bag with the first and second compartments defined therein and separated from one another by a bi-furcating wall, the reservoir bag being formed of an expandable/collapsible material.

24. The method of claim **23**, wherein the step of connecting the first leg to the second port of the Y-connector via a second conduit comprises the step of connecting the second conduit to a second gas inlet port that is associated with the first leg, and the method further includes the step of:

22

selecting an inner diameter of the second gas inlet port such that it is less than an inner diameter of the first gas inlet port.

25. The method of claim **24**, wherein the gas is oxygen and the inner diameter of the second gas inlet port and the inner diameter of the first gas inlet port are selected so that the nebulizer receives a flow rate between about 8 LPM (liters per minute) to about 12 LPM.

* * * * *