



US 20080281481A1

(19) **United States**
(12) **Patent Application Publication**
Abramson et al.

(10) **Pub. No.: US 2008/0281481 A1**
(43) **Pub. Date: Nov. 13, 2008**

(54) **ROBOTIC VACUUM CLEANER**

7,079,923, which is a continuation of application No. 10/007,103, filed on Dec. 4, 2001, now Pat. No. 7,167,775.

(76) Inventors: **Shai Abramson**, Pardesia (IL);
Shalom Levin, Atlit (IL); **Ran Zaslavsky**, Kfar Saba (IL)

(30) **Foreign Application Priority Data**

Sep. 26, 2001 (IL) 145680

Correspondence Address:
LATHROP & GAGE LC
2345 GRAND AVENUE, SUITE 2800
KANSAS CITY, MO 64108 (US)

Publication Classification

(51) **Int. Cl.**
G05D 1/00 (2006.01)
(52) **U.S. Cl.** **701/23**

(21) Appl. No.: **12/181,869**

(57) **ABSTRACT**

(22) Filed: **Jul. 29, 2008**

An autonomous robot, that is for example, suitable for operations such as vacuuming and surface cleaning includes a payload configured for vacuum cleaning, a drive system including a steering system, a navigation system, and a control system for integrating operations of the aforementioned systems.

Related U.S. Application Data

(63) Continuation of application No. 11/487,850, filed on Jul. 17, 2006, which is a continuation of application No. 10/360,092, filed on Feb. 7, 2003, now Pat. No.

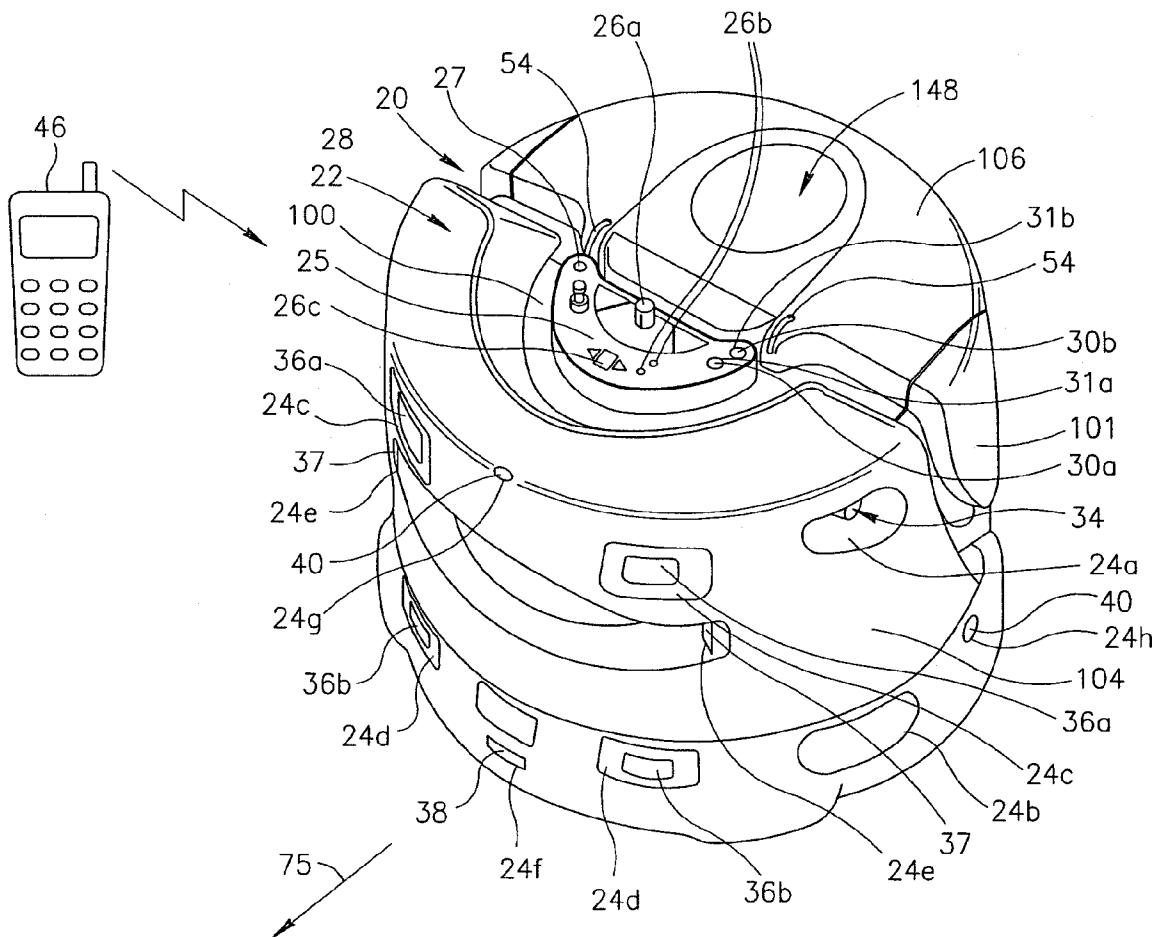

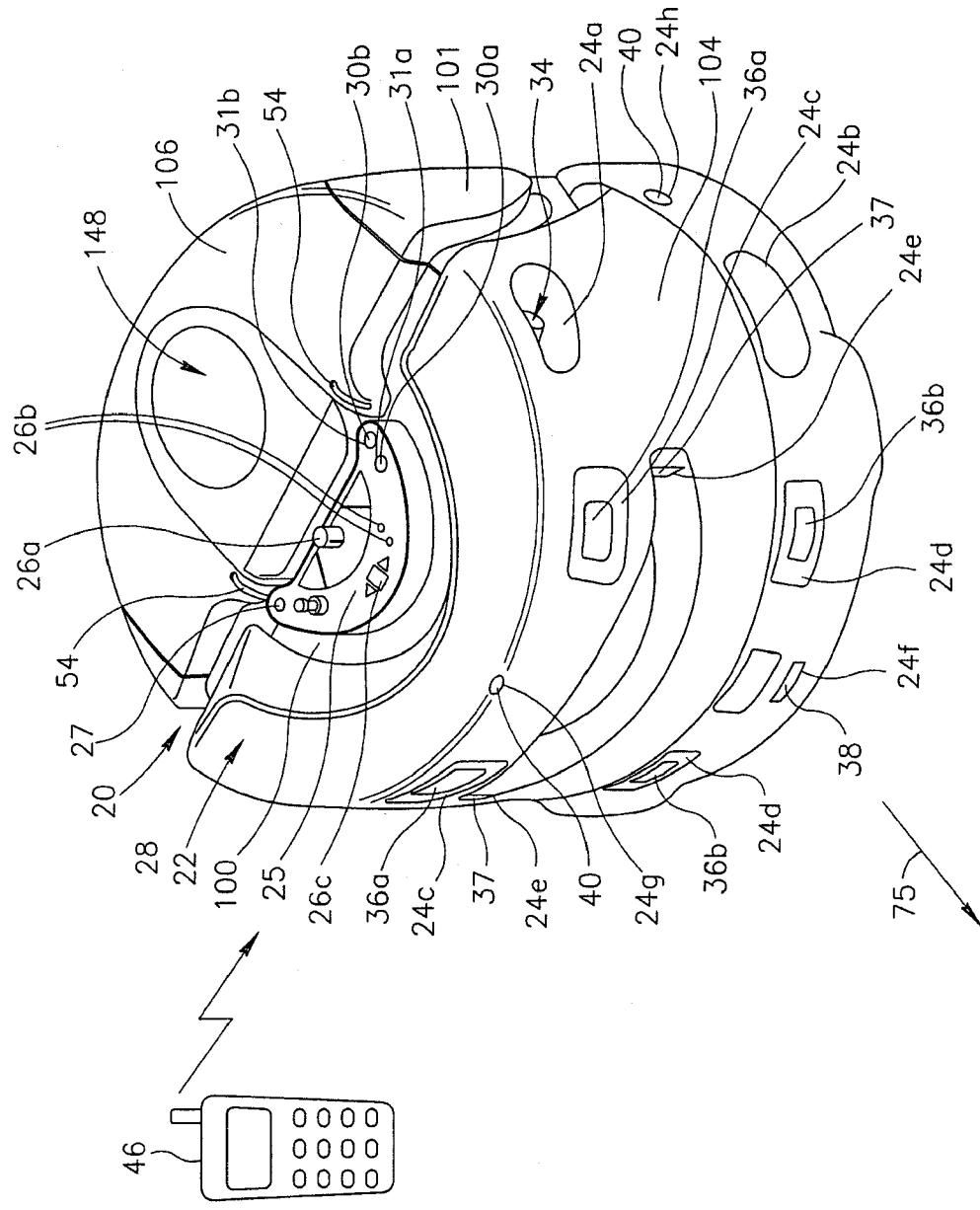

FIG.1

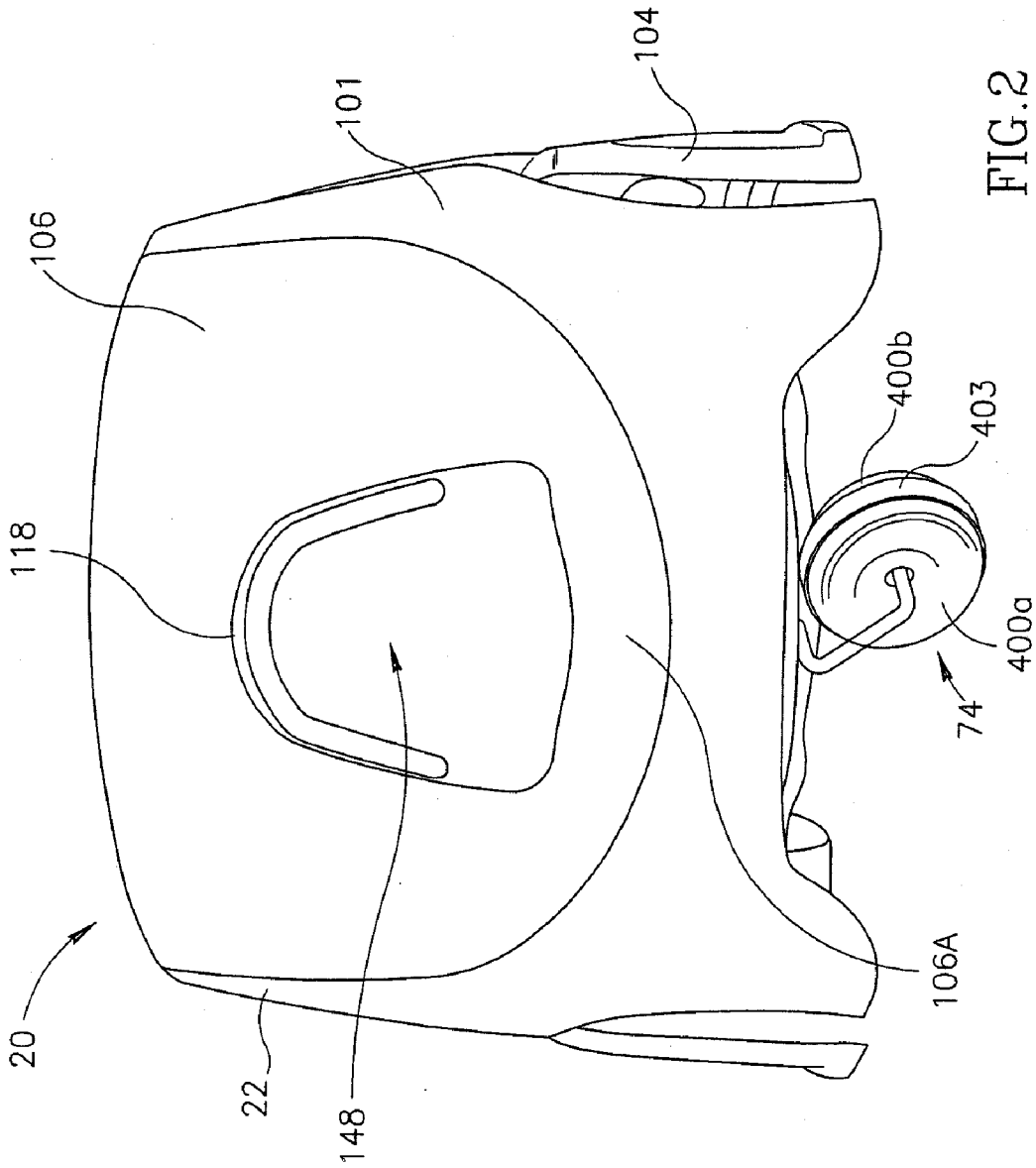

FIG. 2

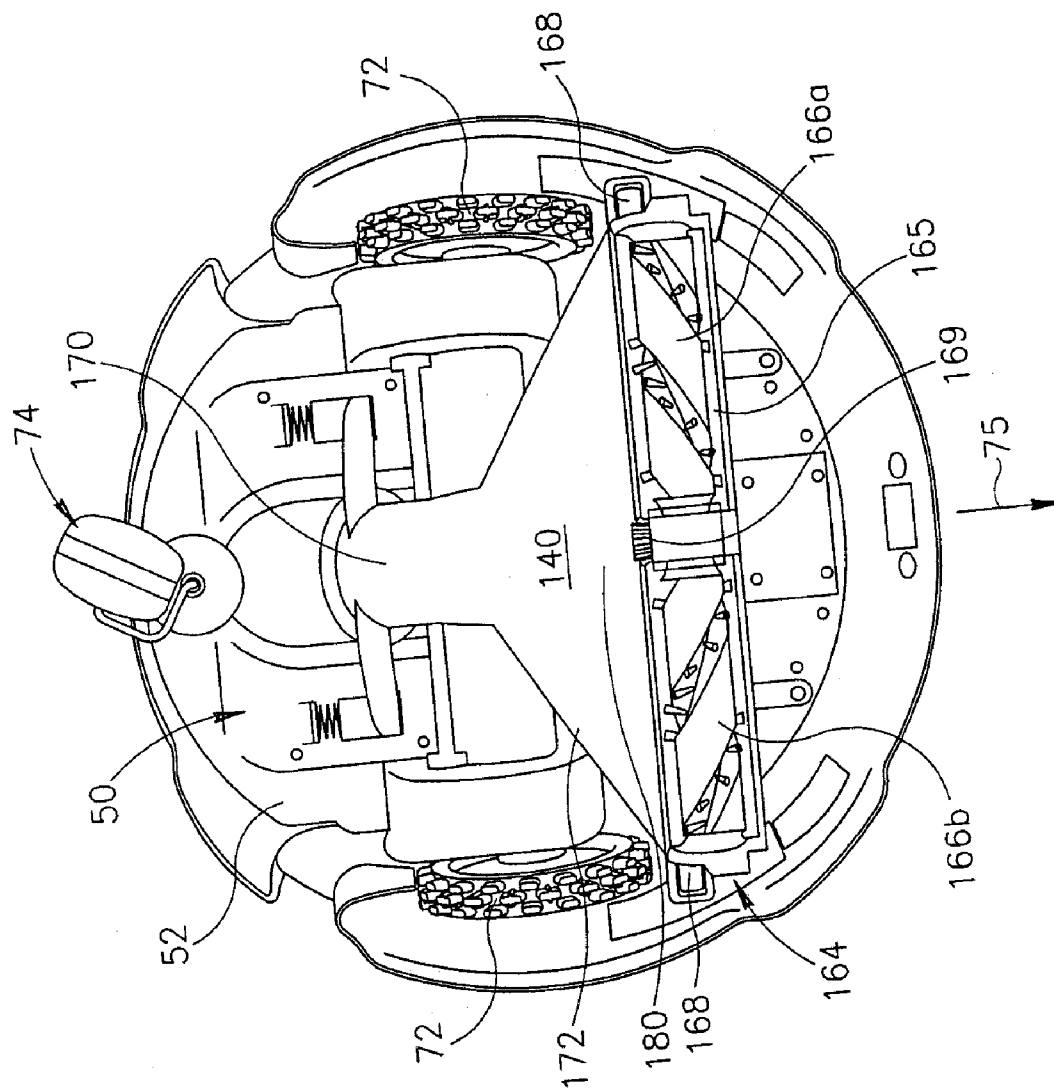

FIG.3A

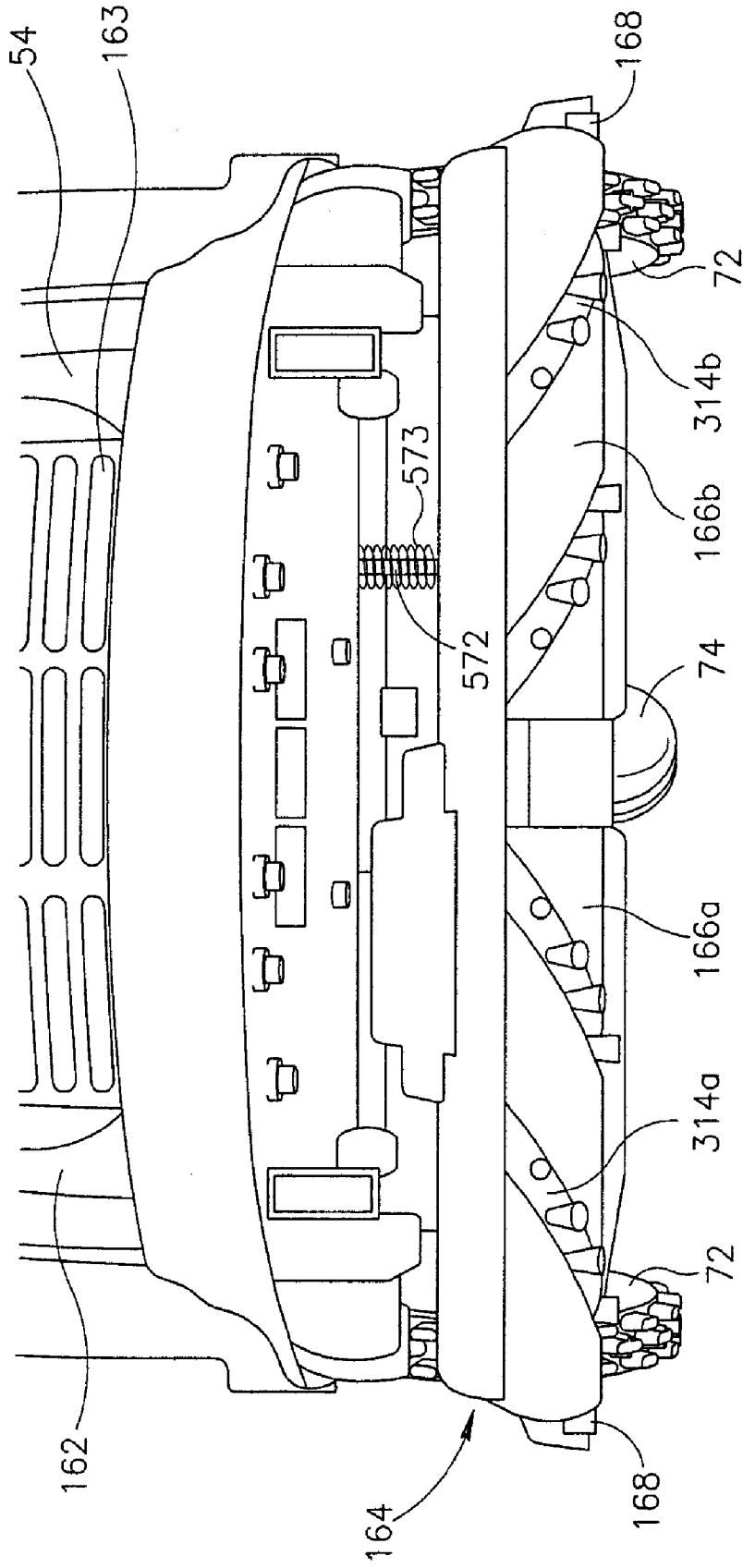

FIG.3B

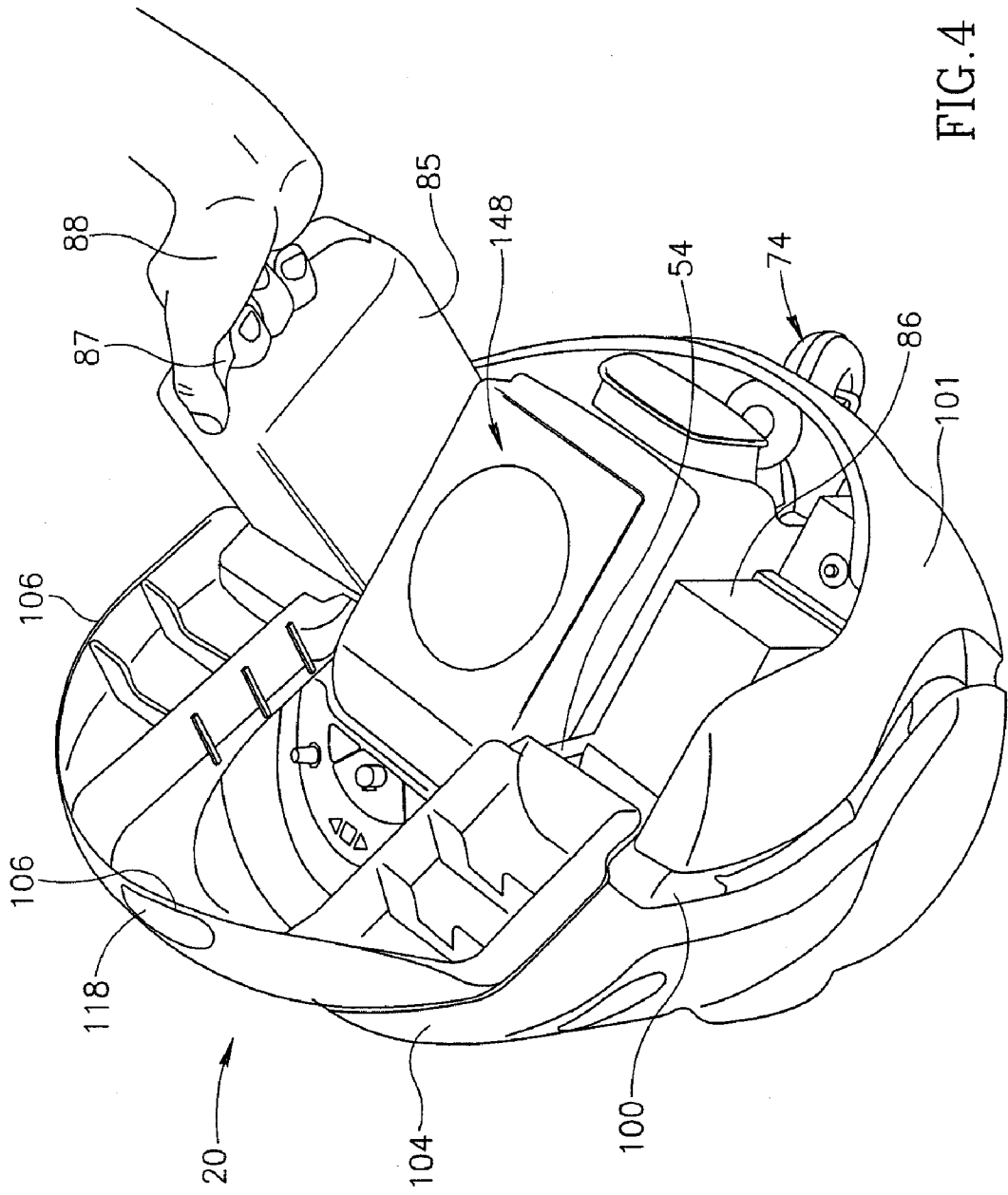

FIG. 4

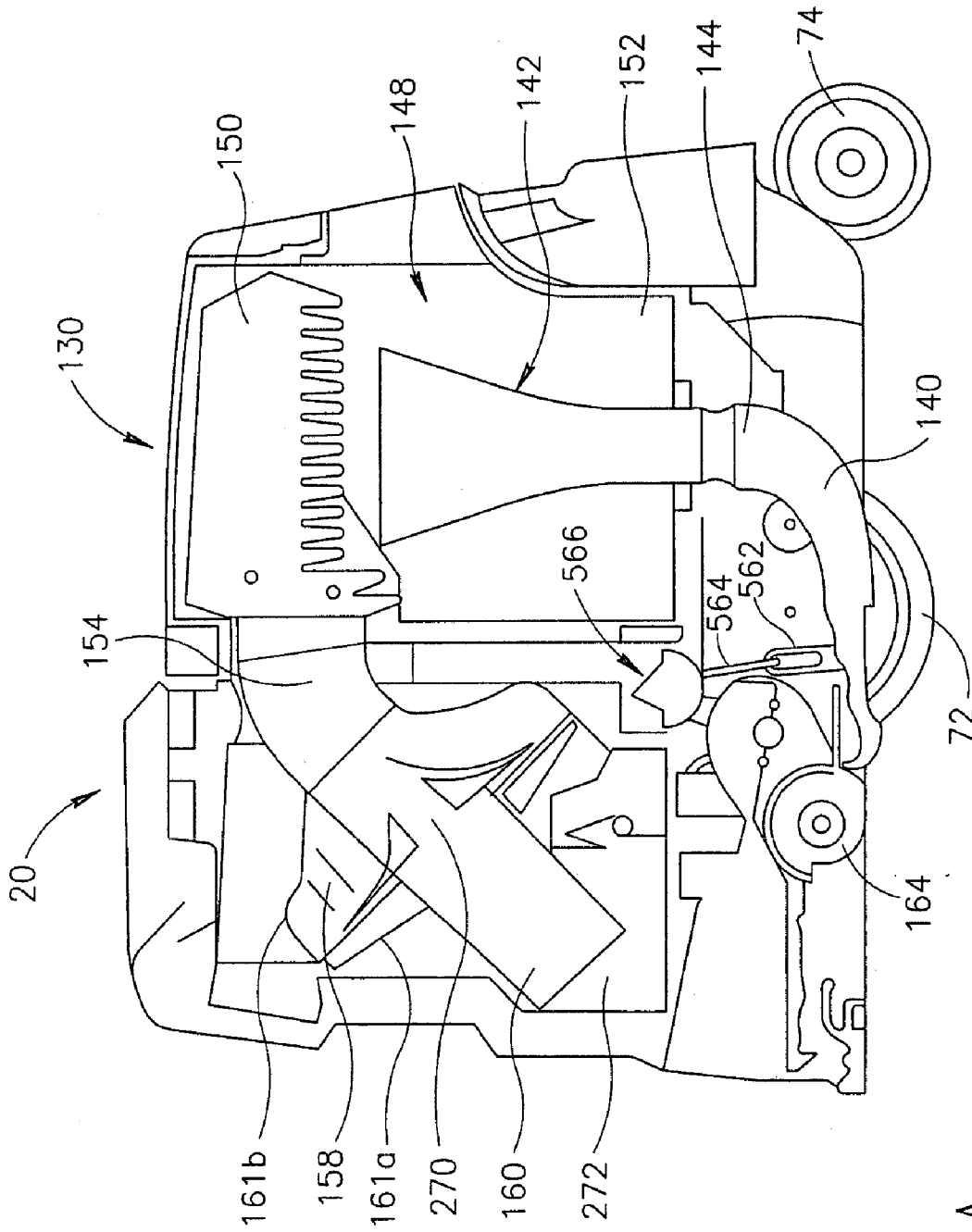

FIG. 5A

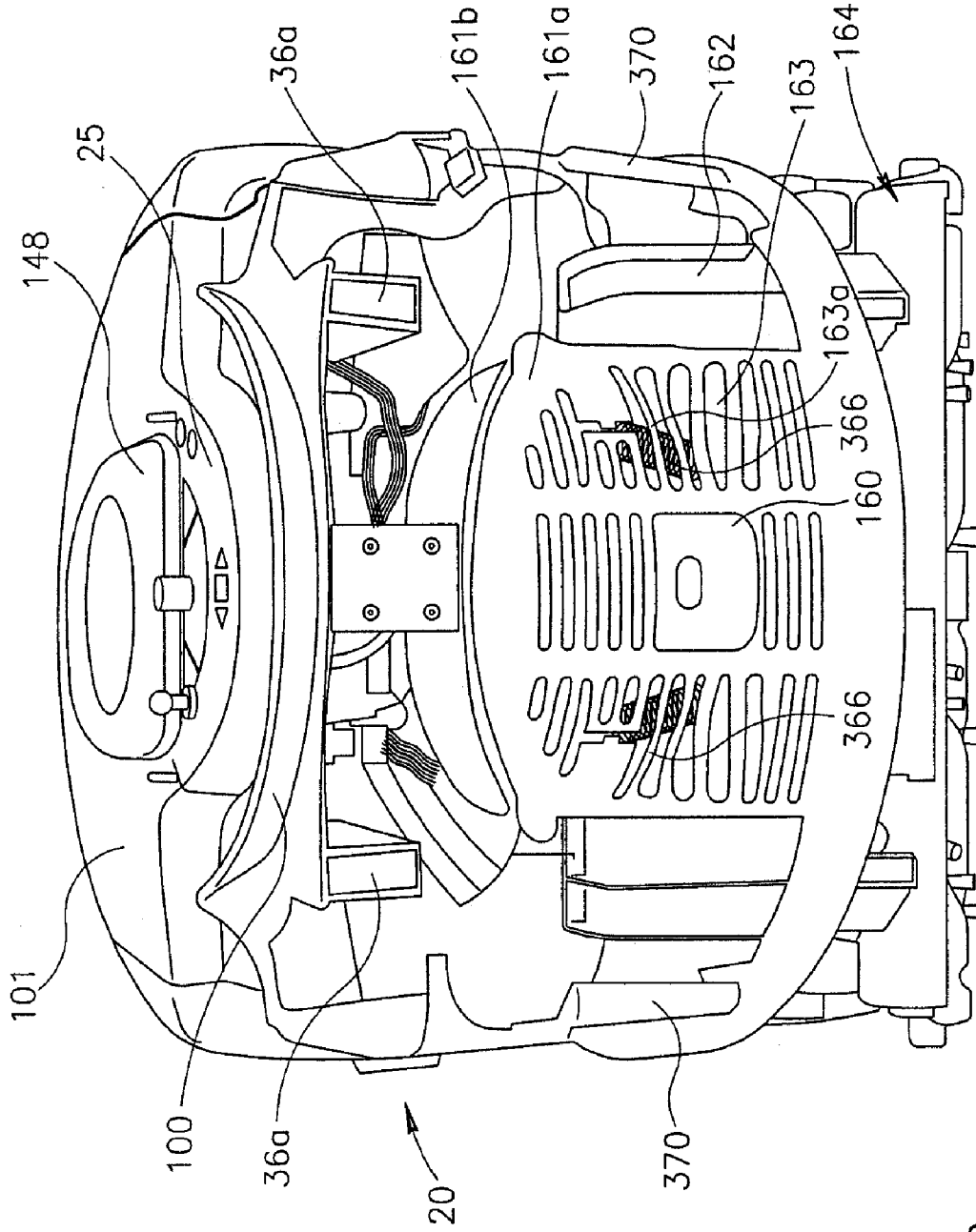

FIG. 5B

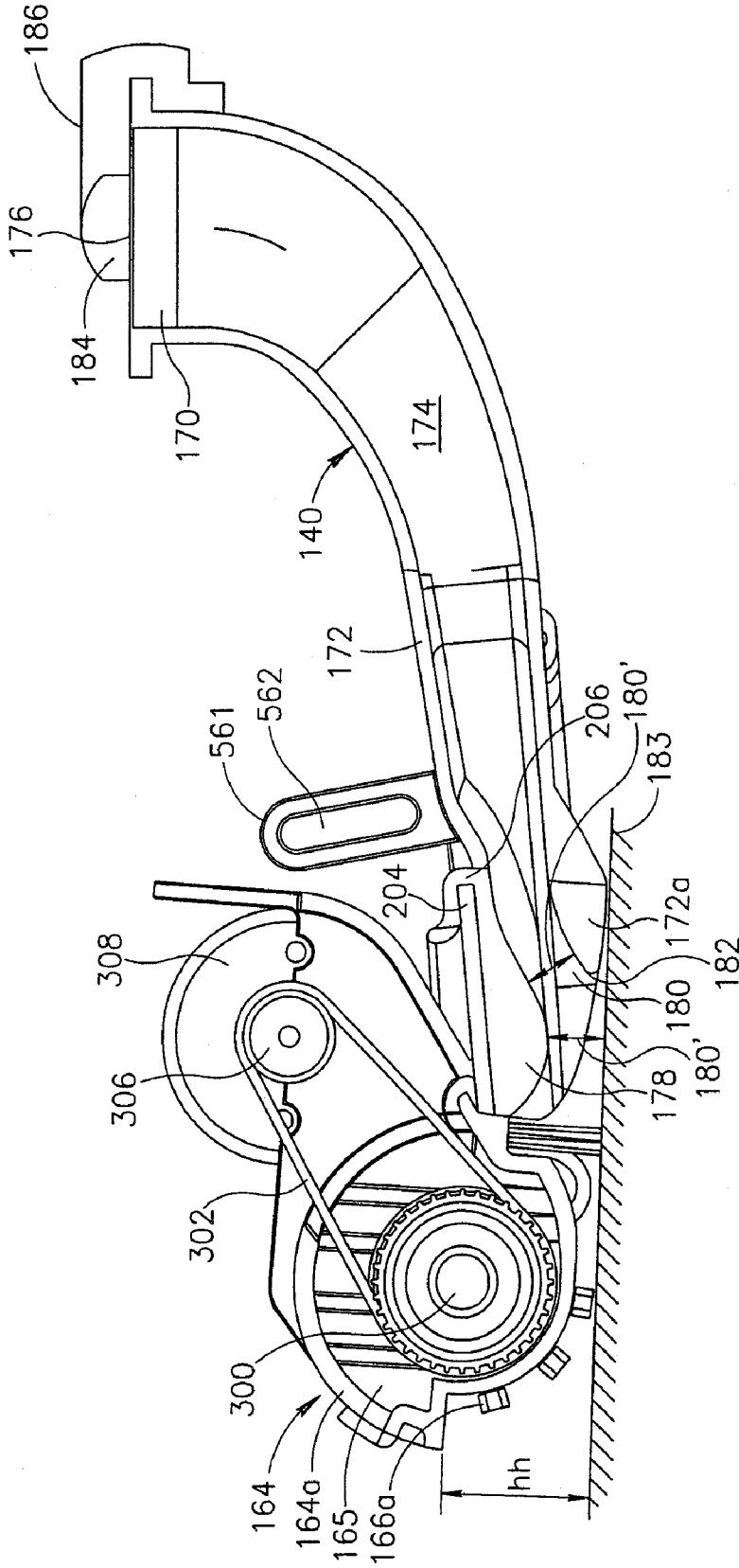

FIG. 6A

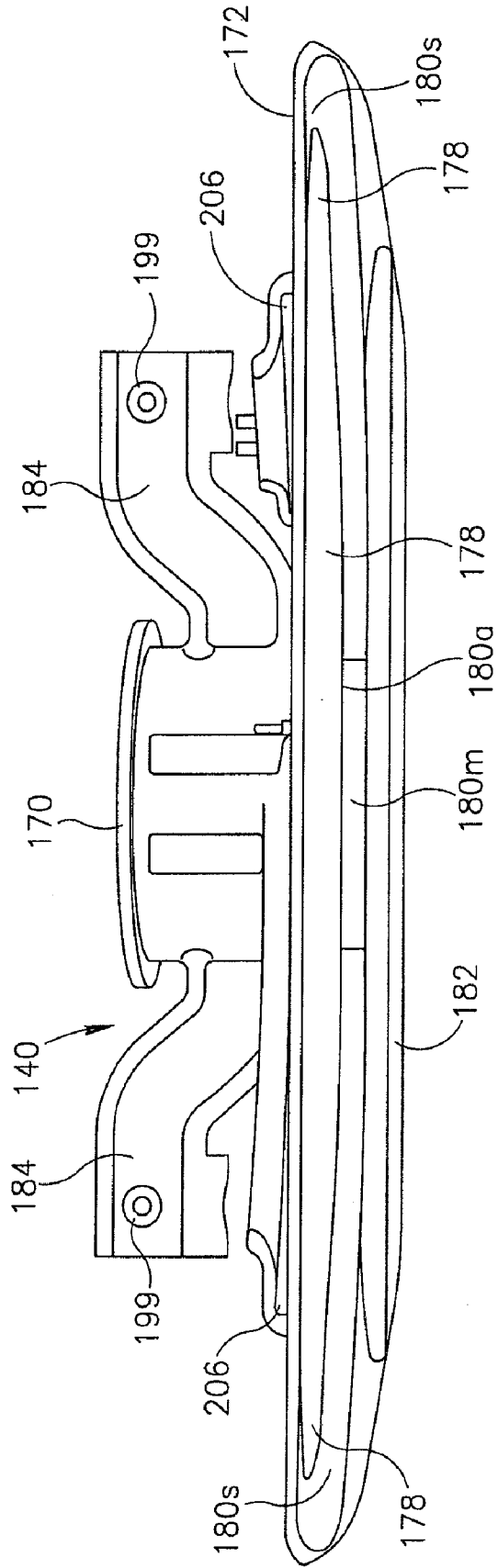

FIG. 6B

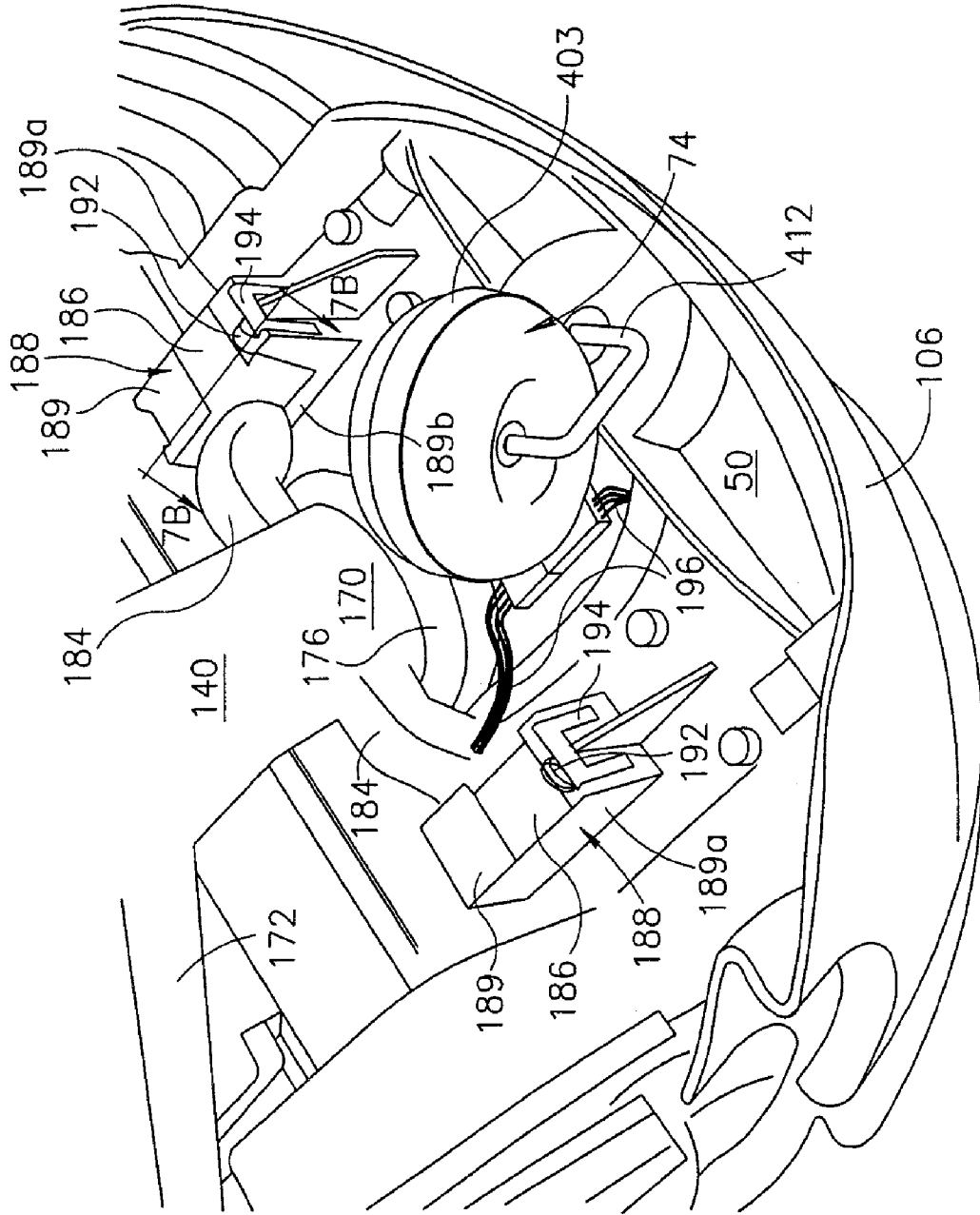

FIG. 7A

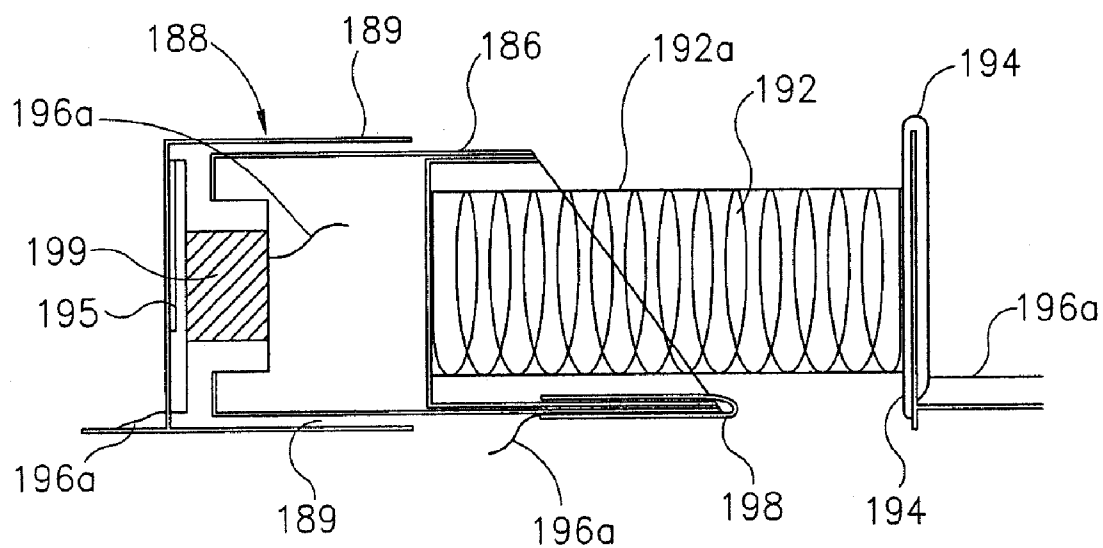

FIG. 7B

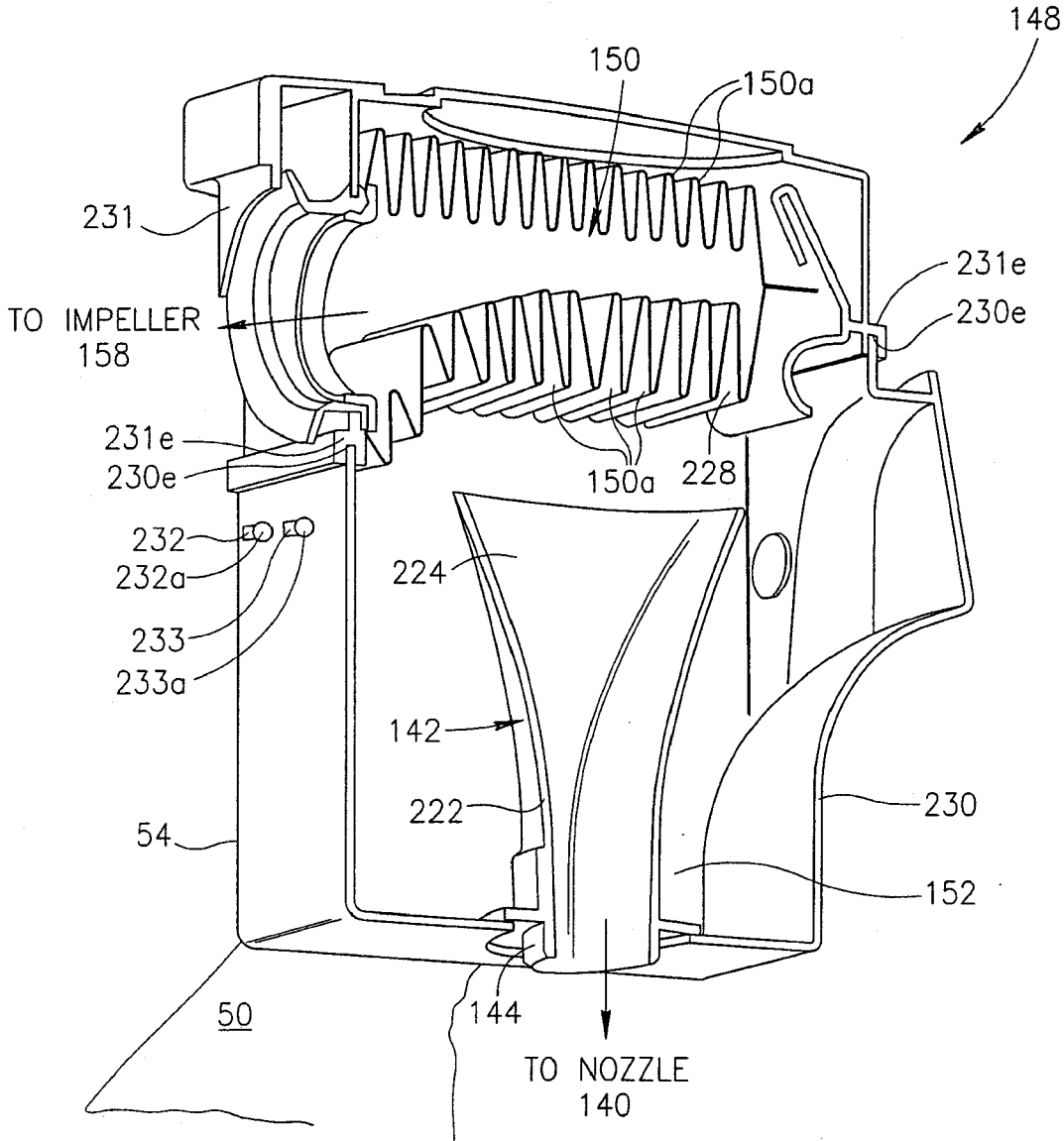

FIG. 8

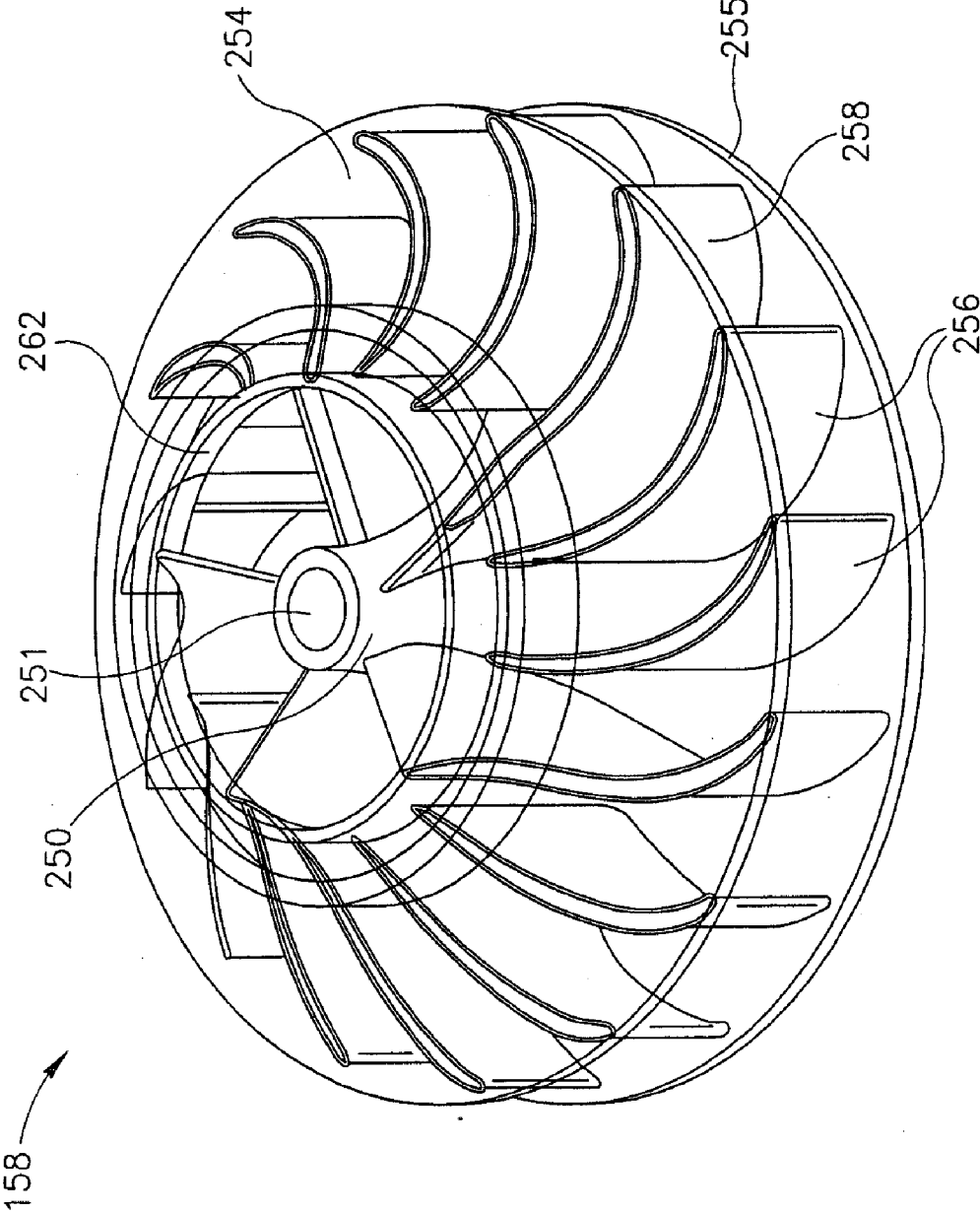

FIG. 9A

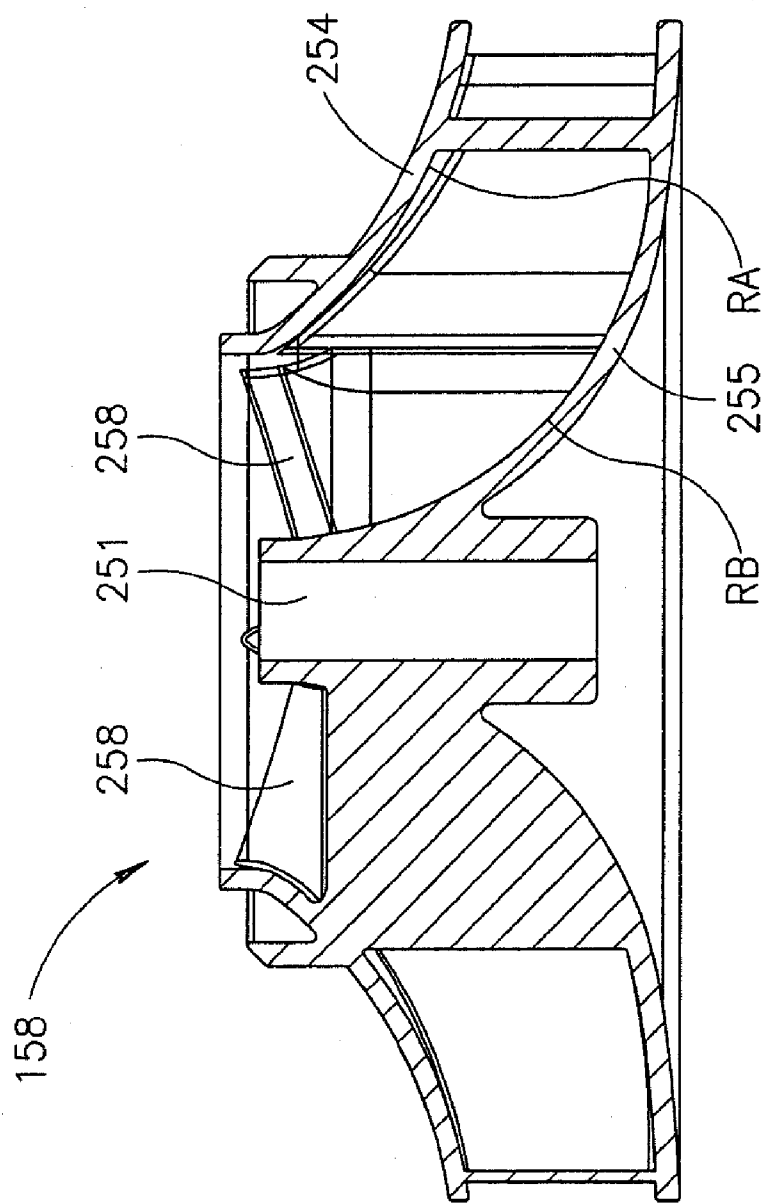

FIG. 9B

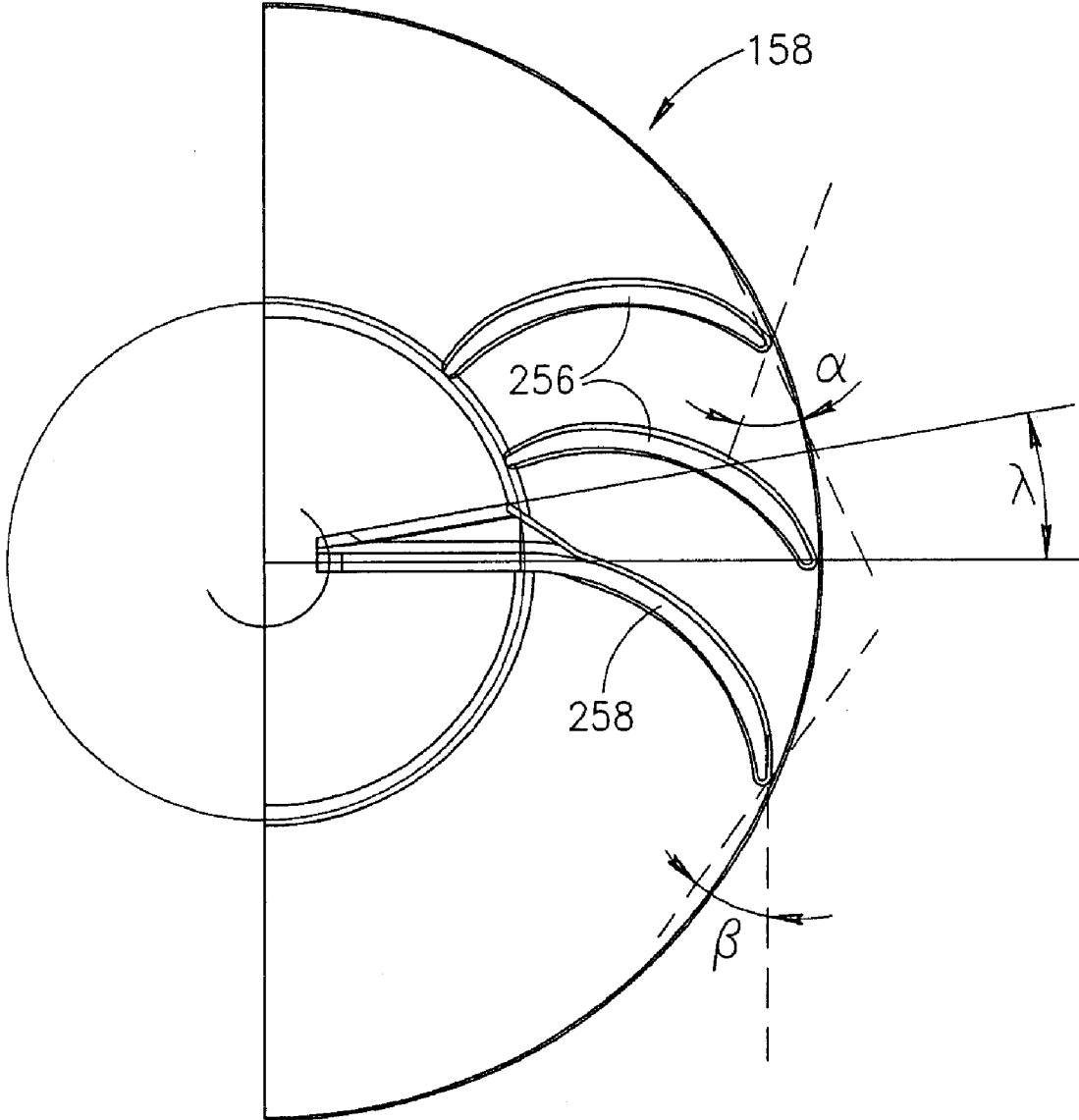

FIG.9C

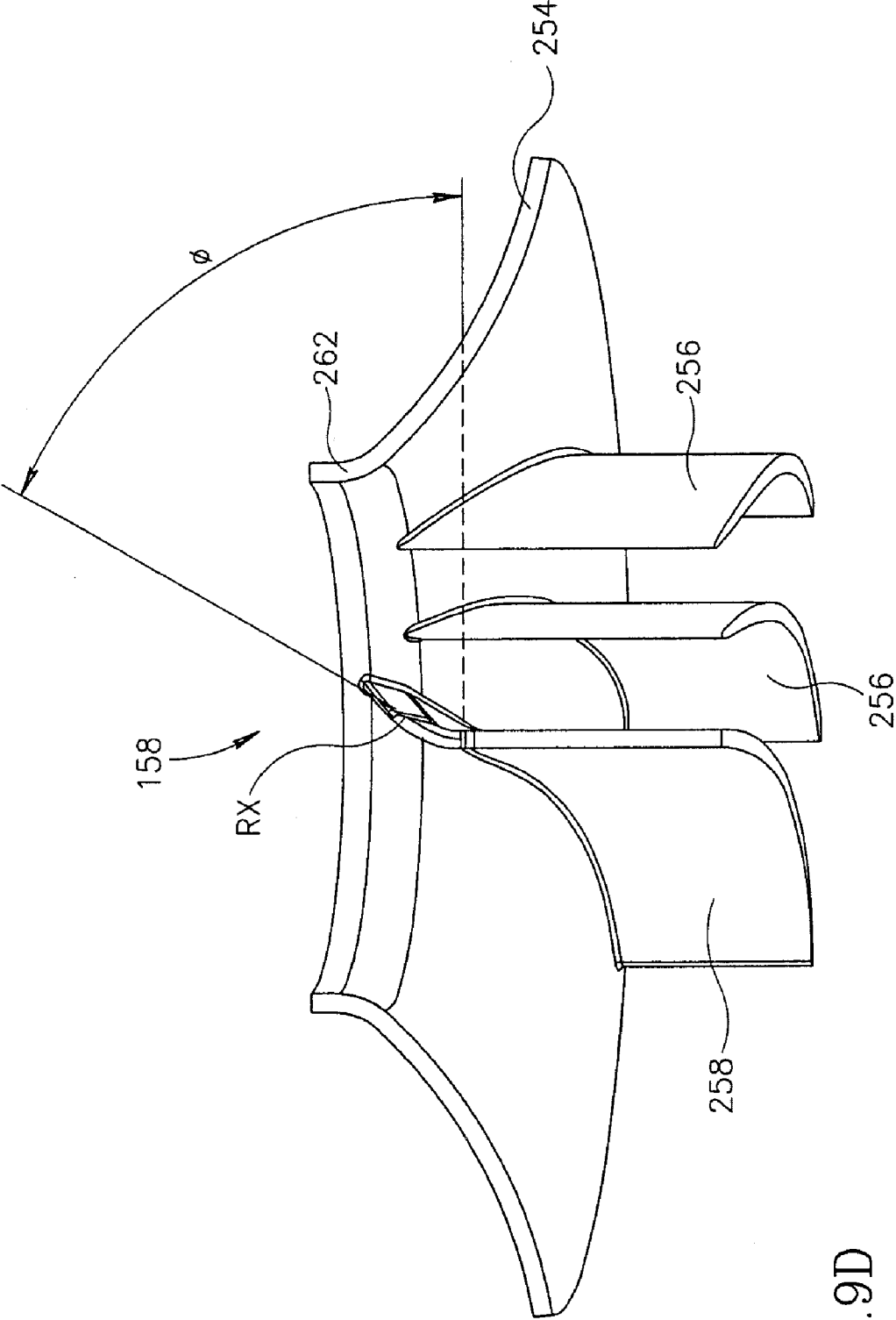

FIG. 9D

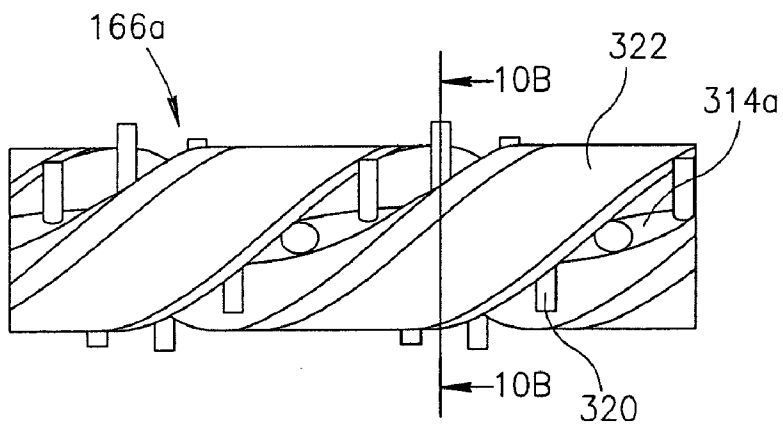

FIG. 10A

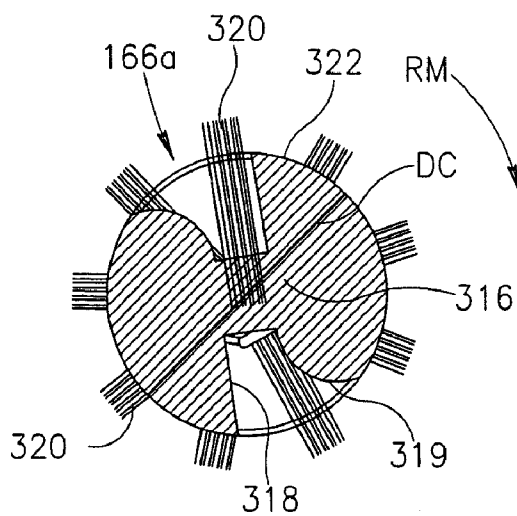

FIG. 10B

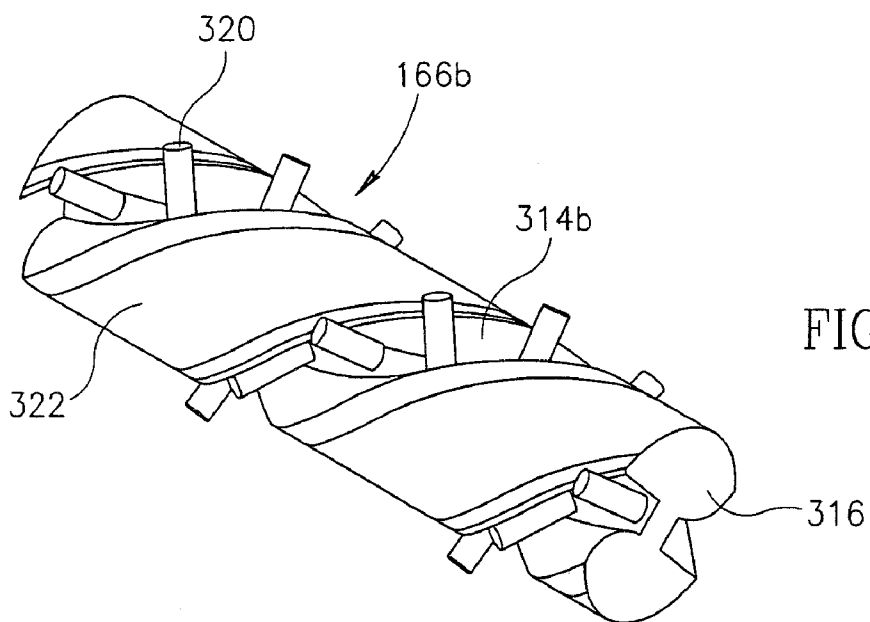

FIG. 10C

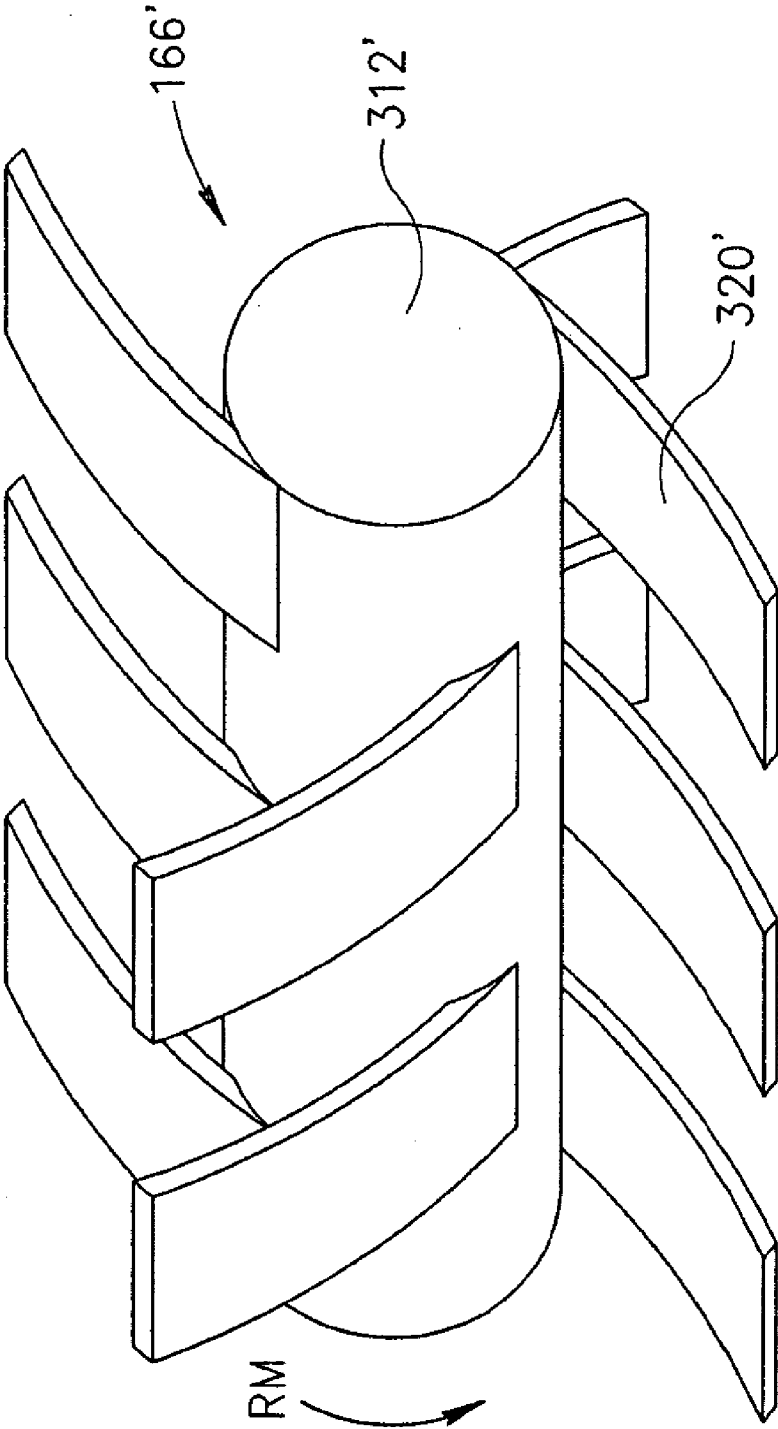

FIG.11

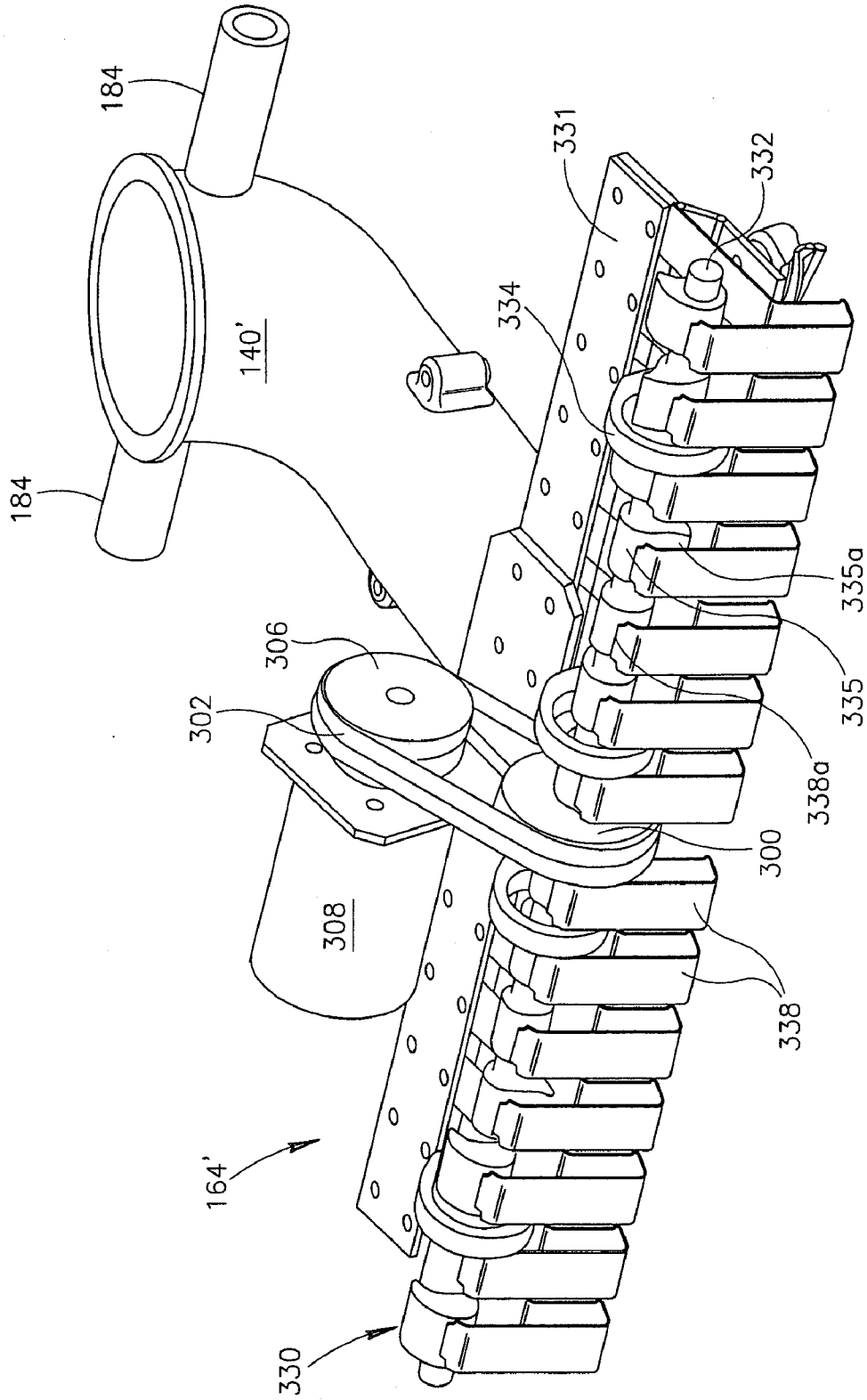

FIG.12A

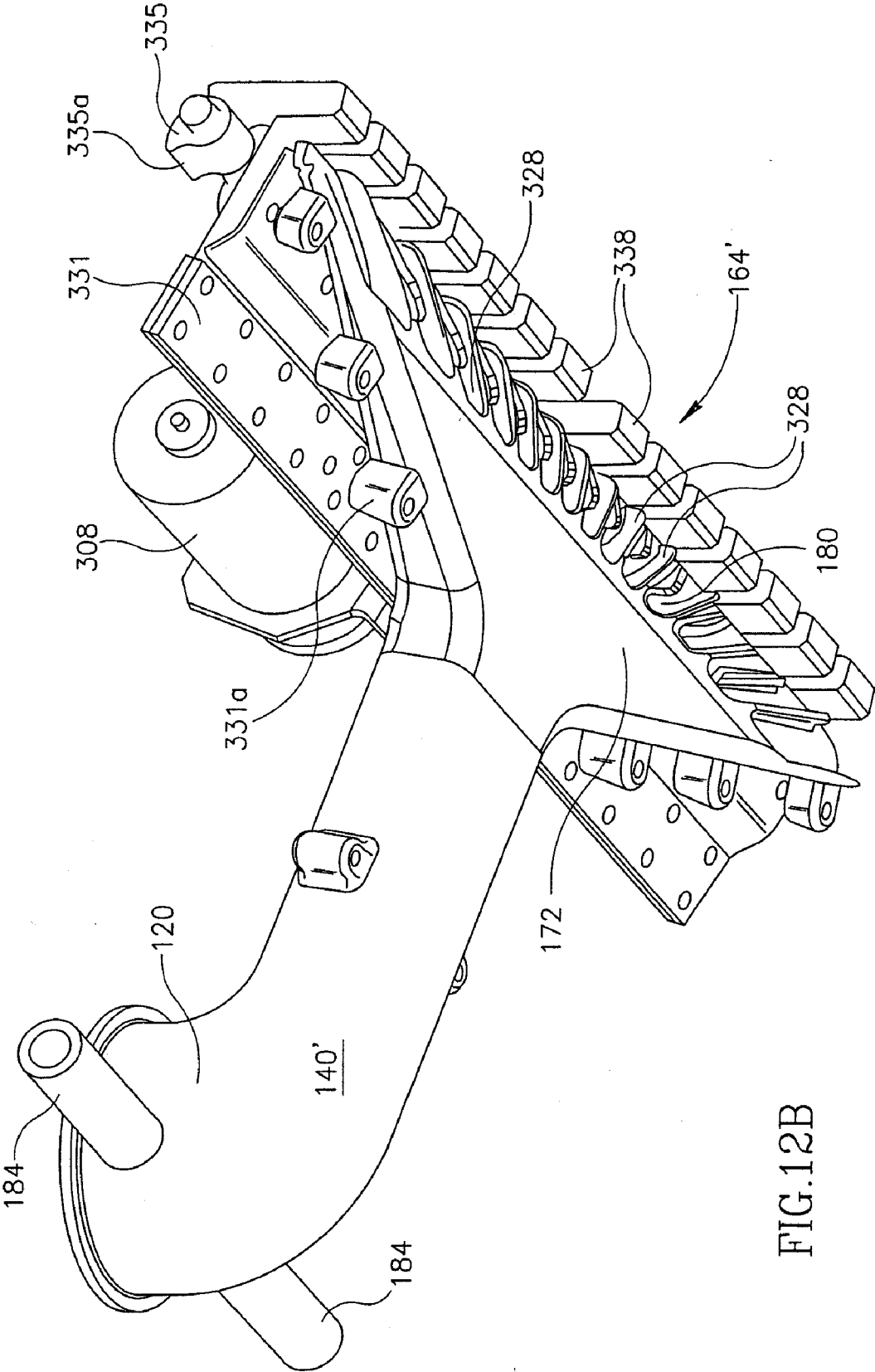

FIG.12B

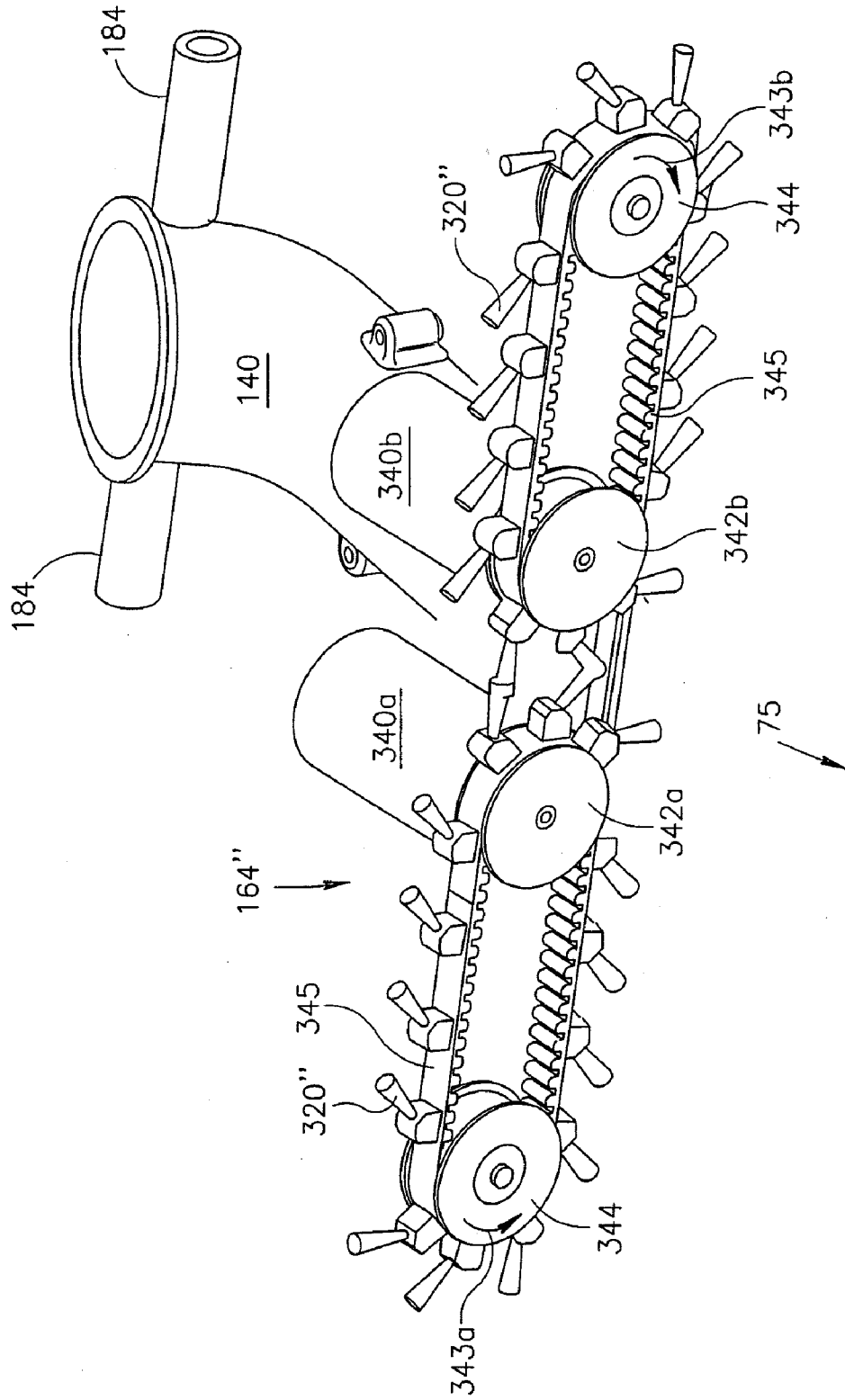

FIG.12C

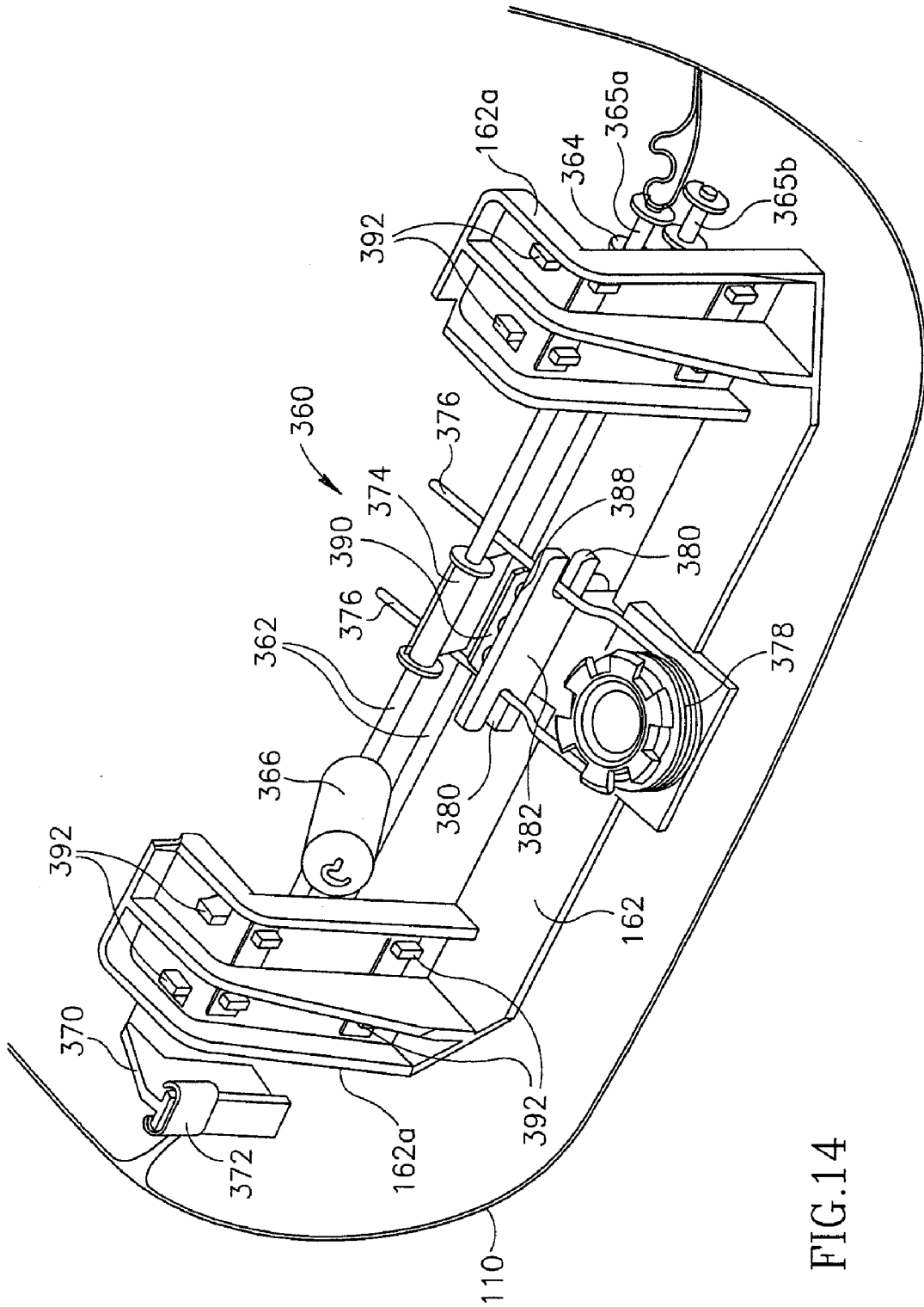

FIG.14

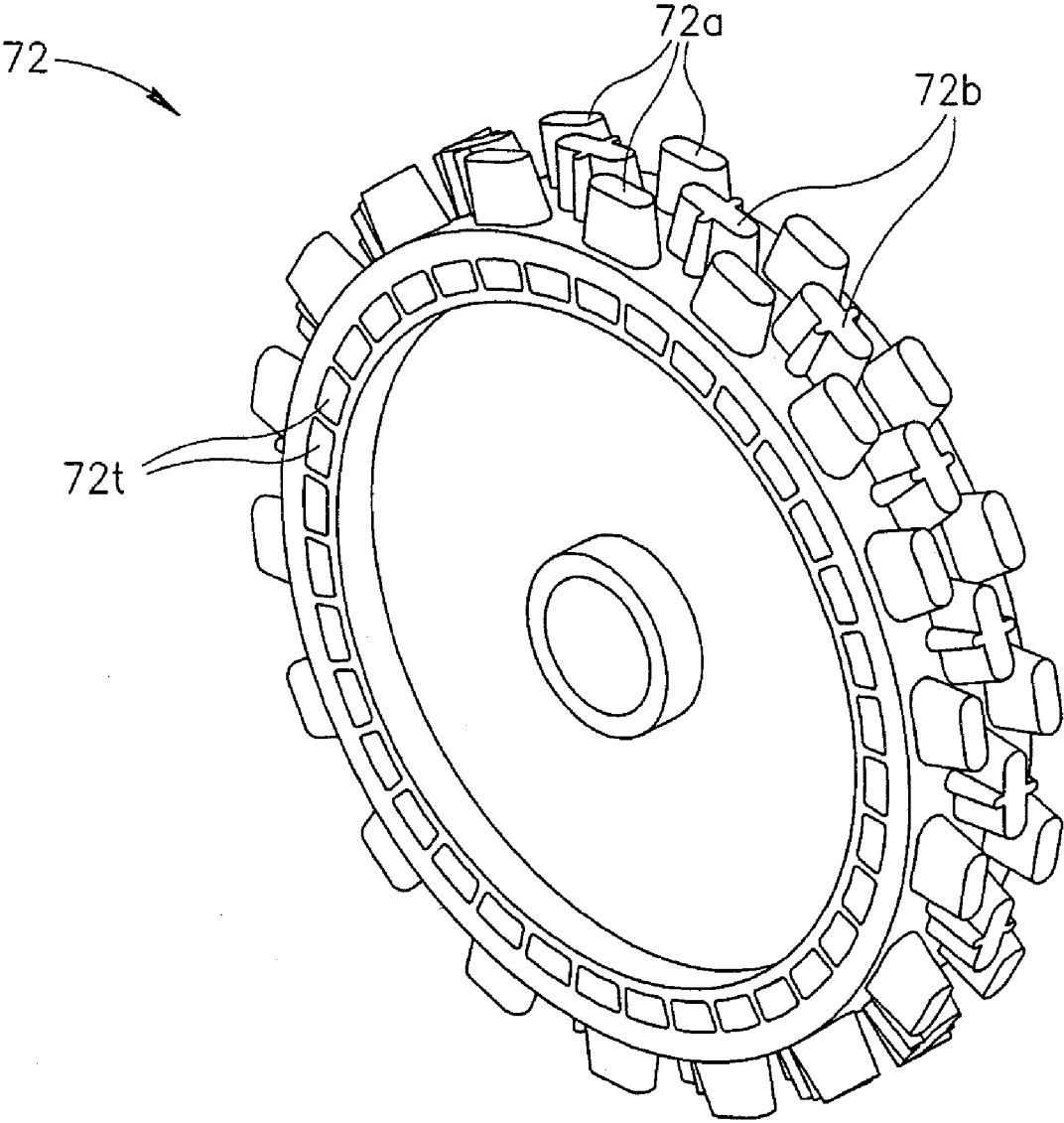

FIG.15

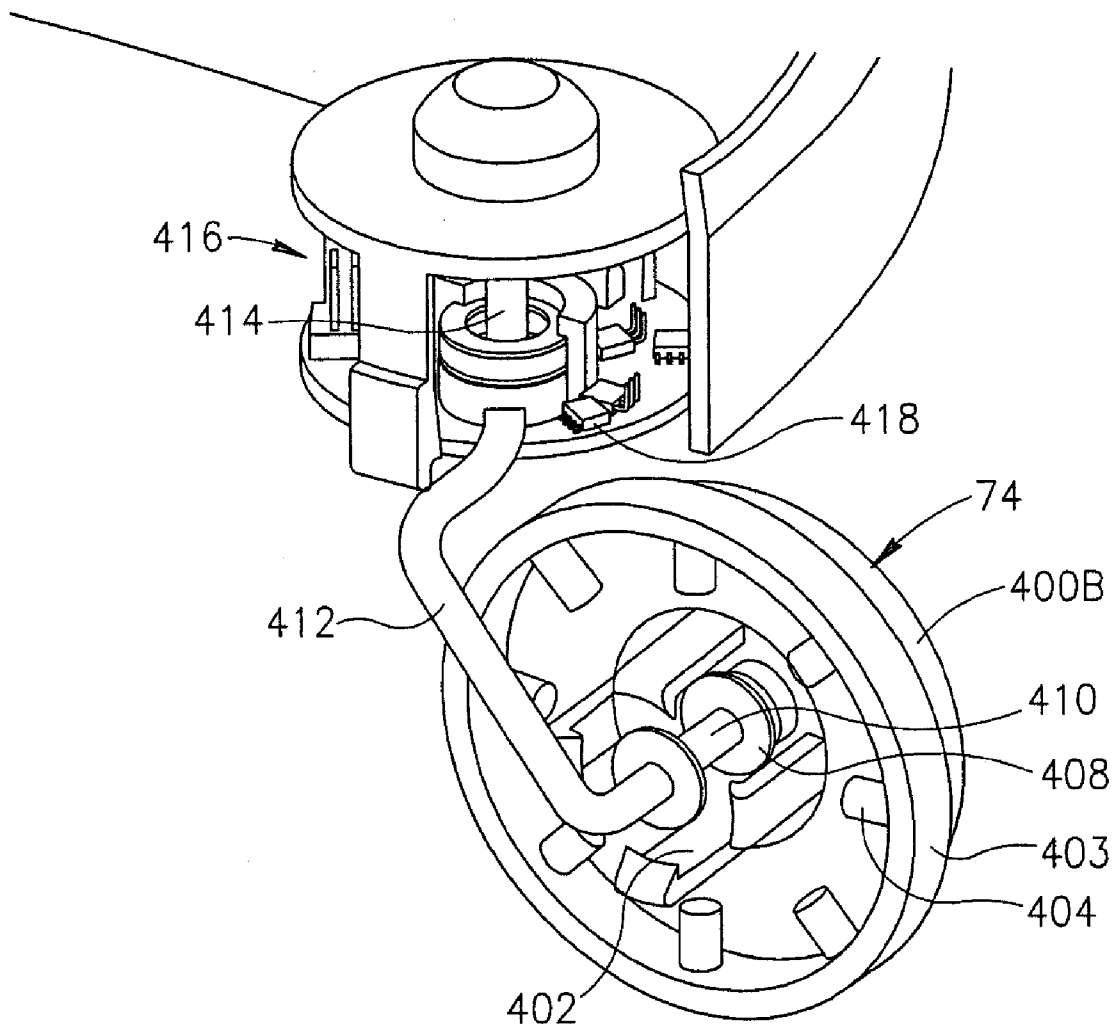

FIG.16

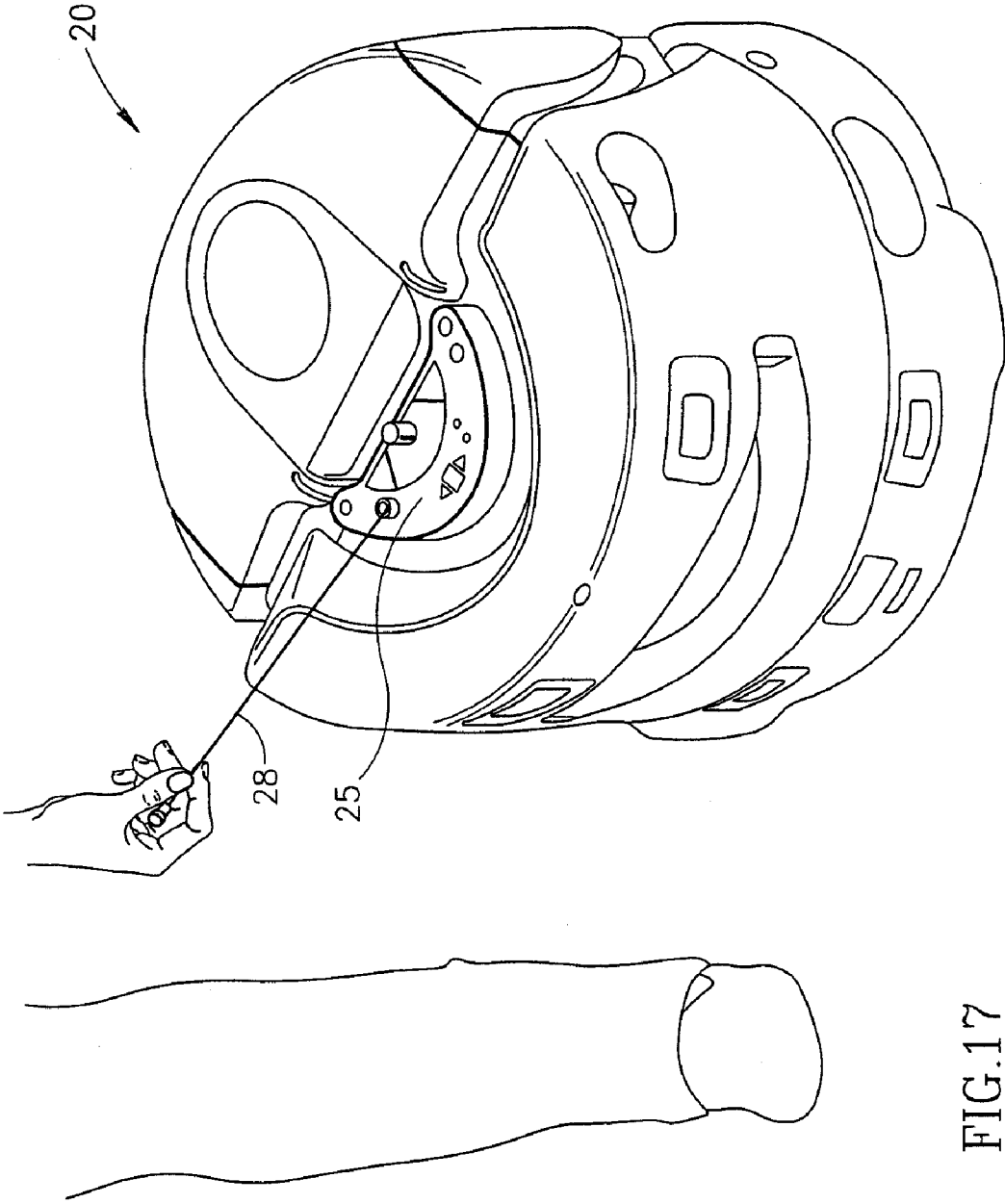

FIG.17

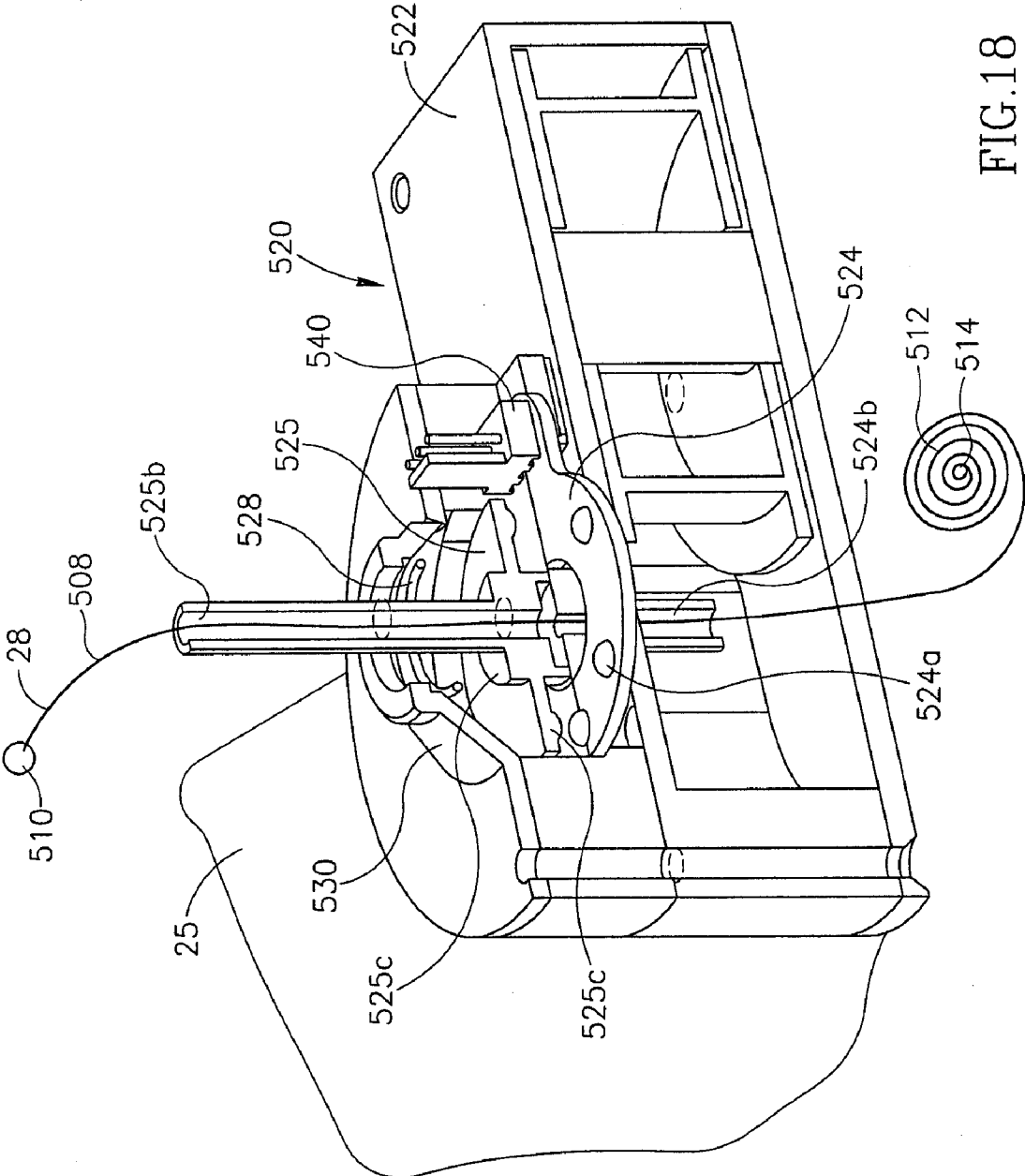

FIG.18

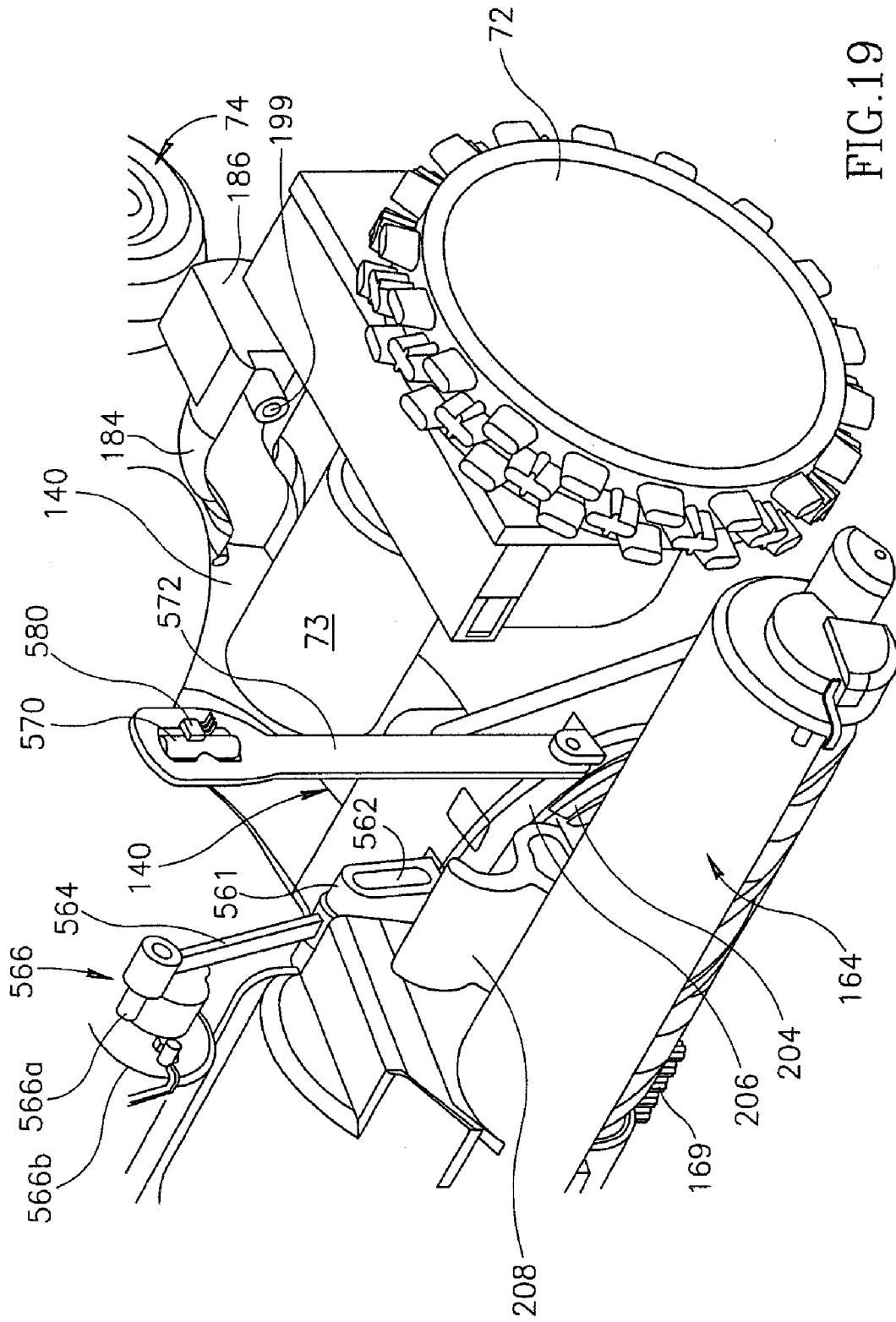

FIG. 19

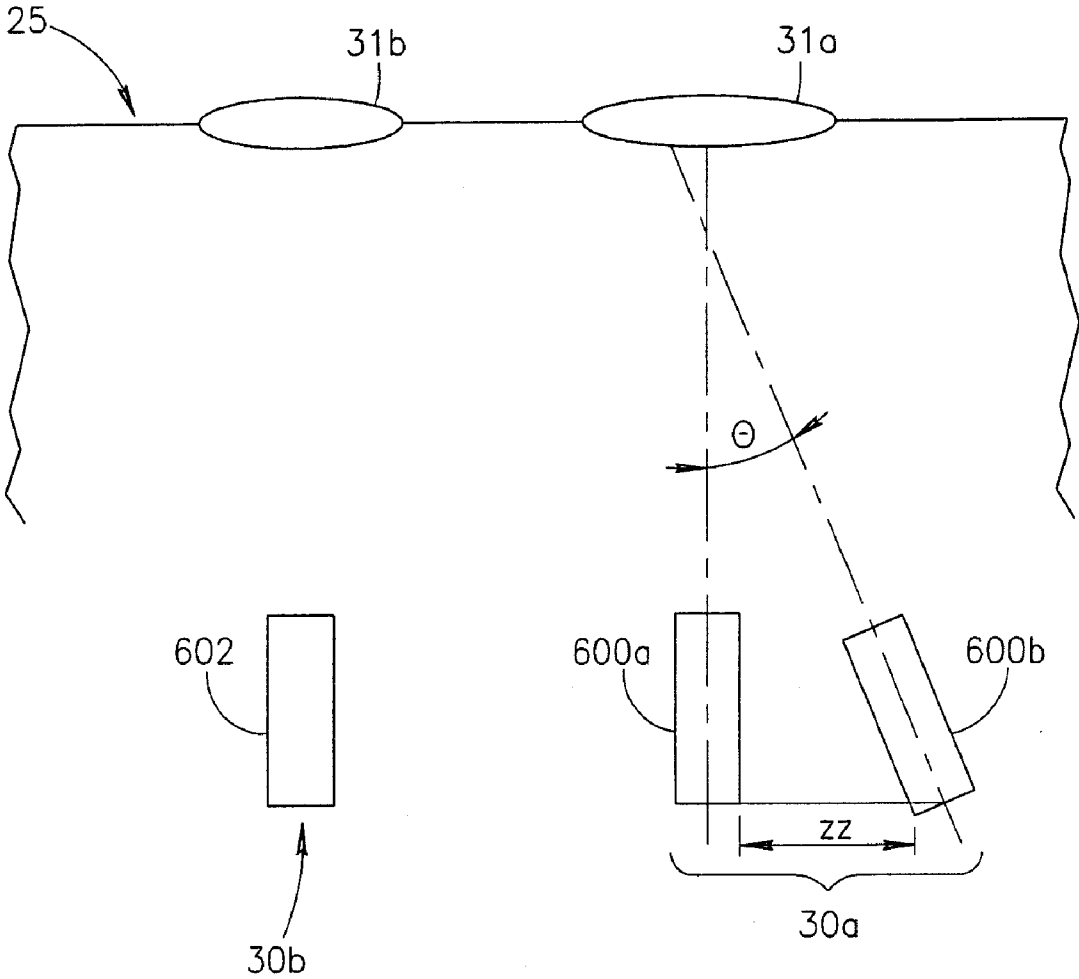

FIG.20

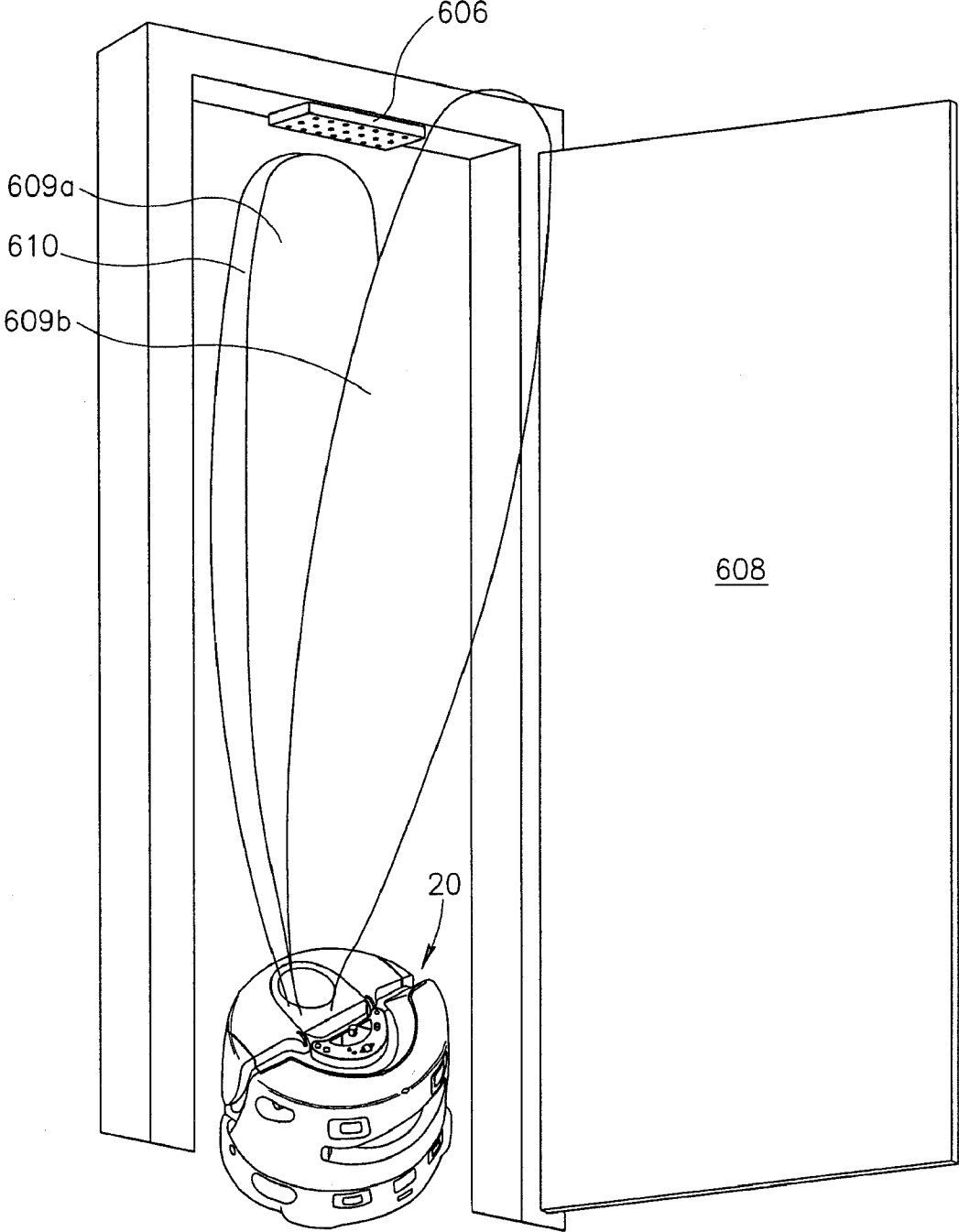

FIG. 21A

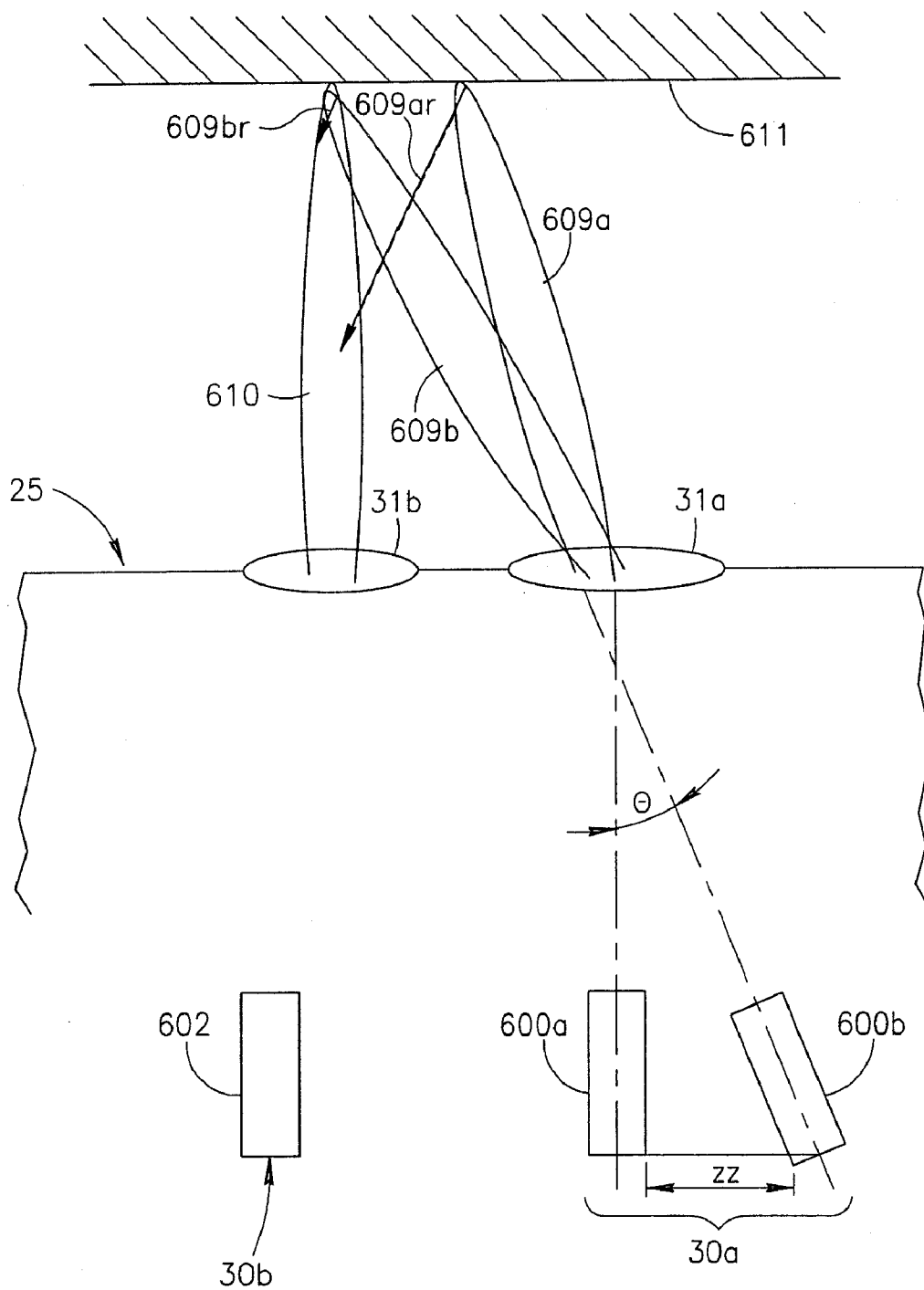

FIG.21B

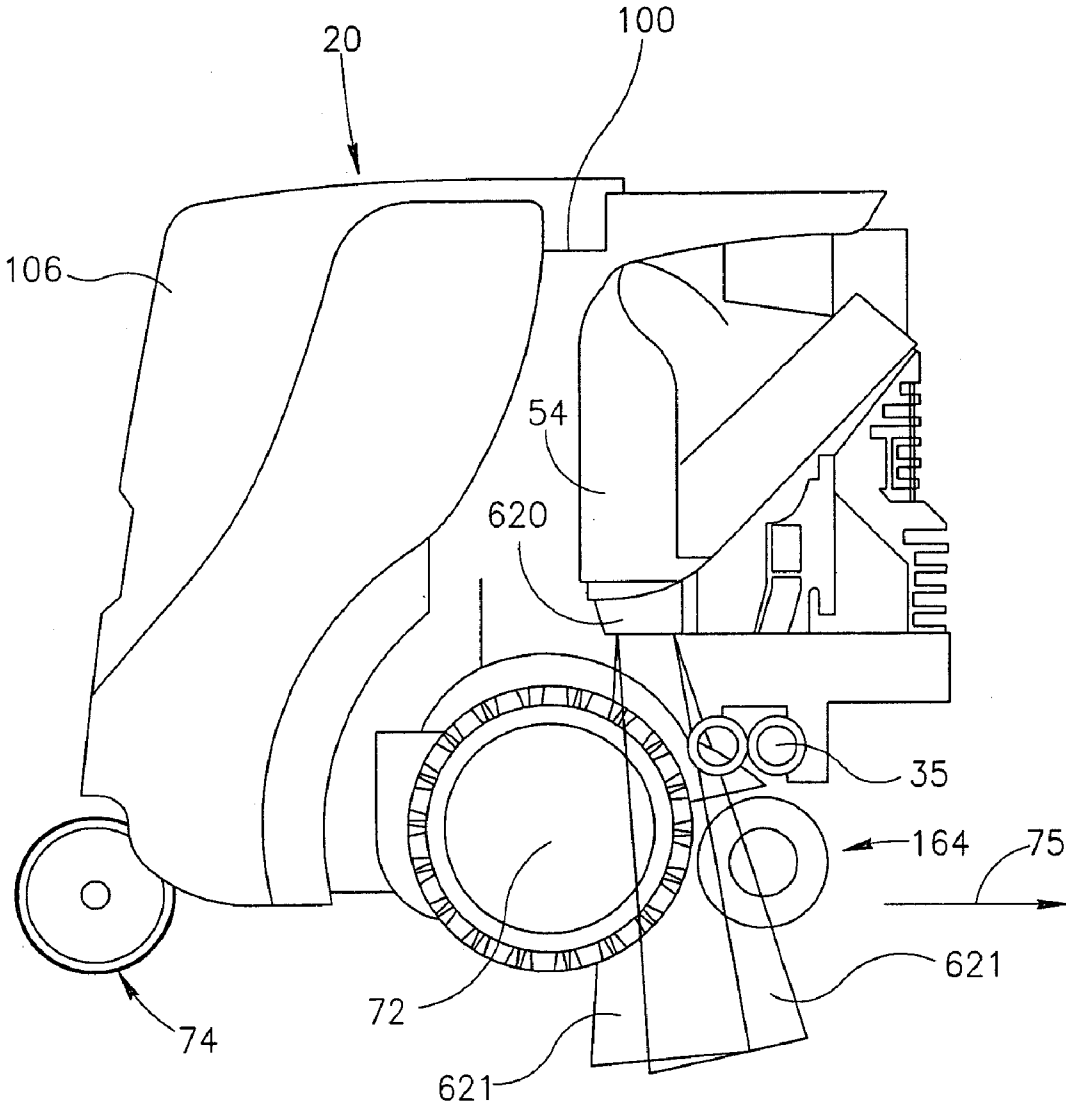

FIG. 22A

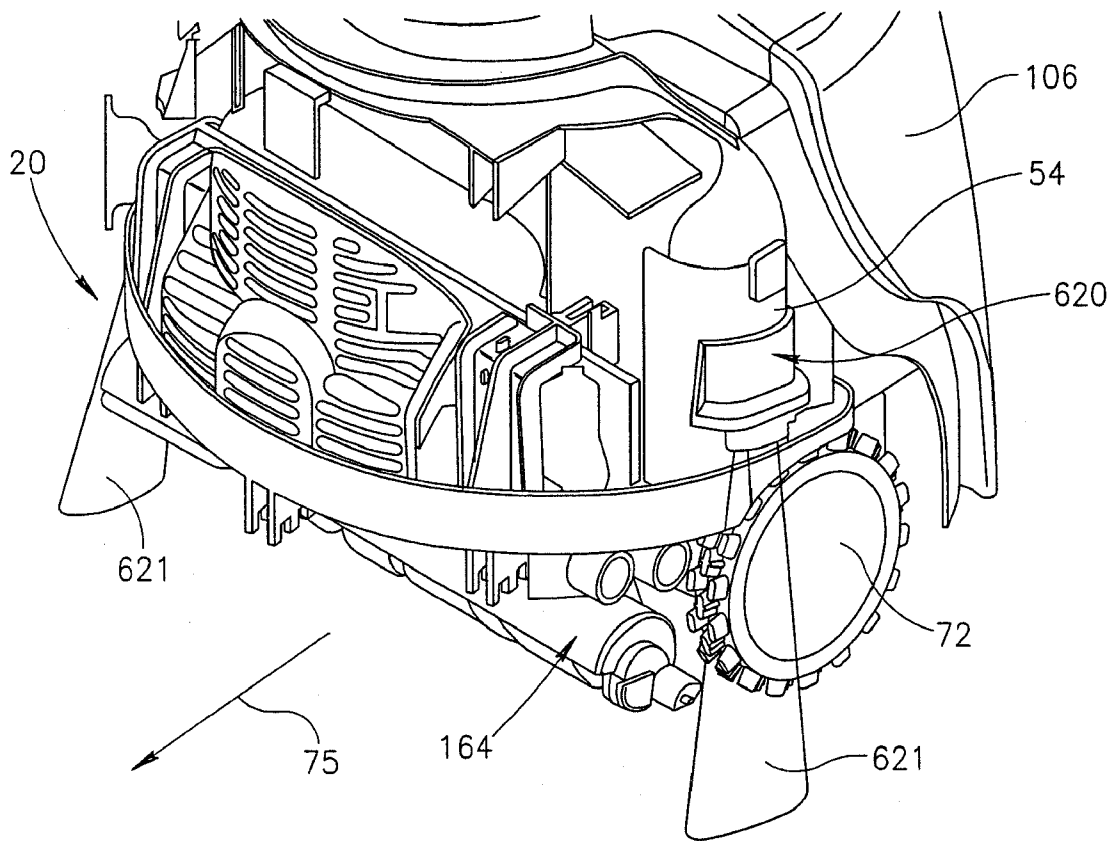

FIG.22B

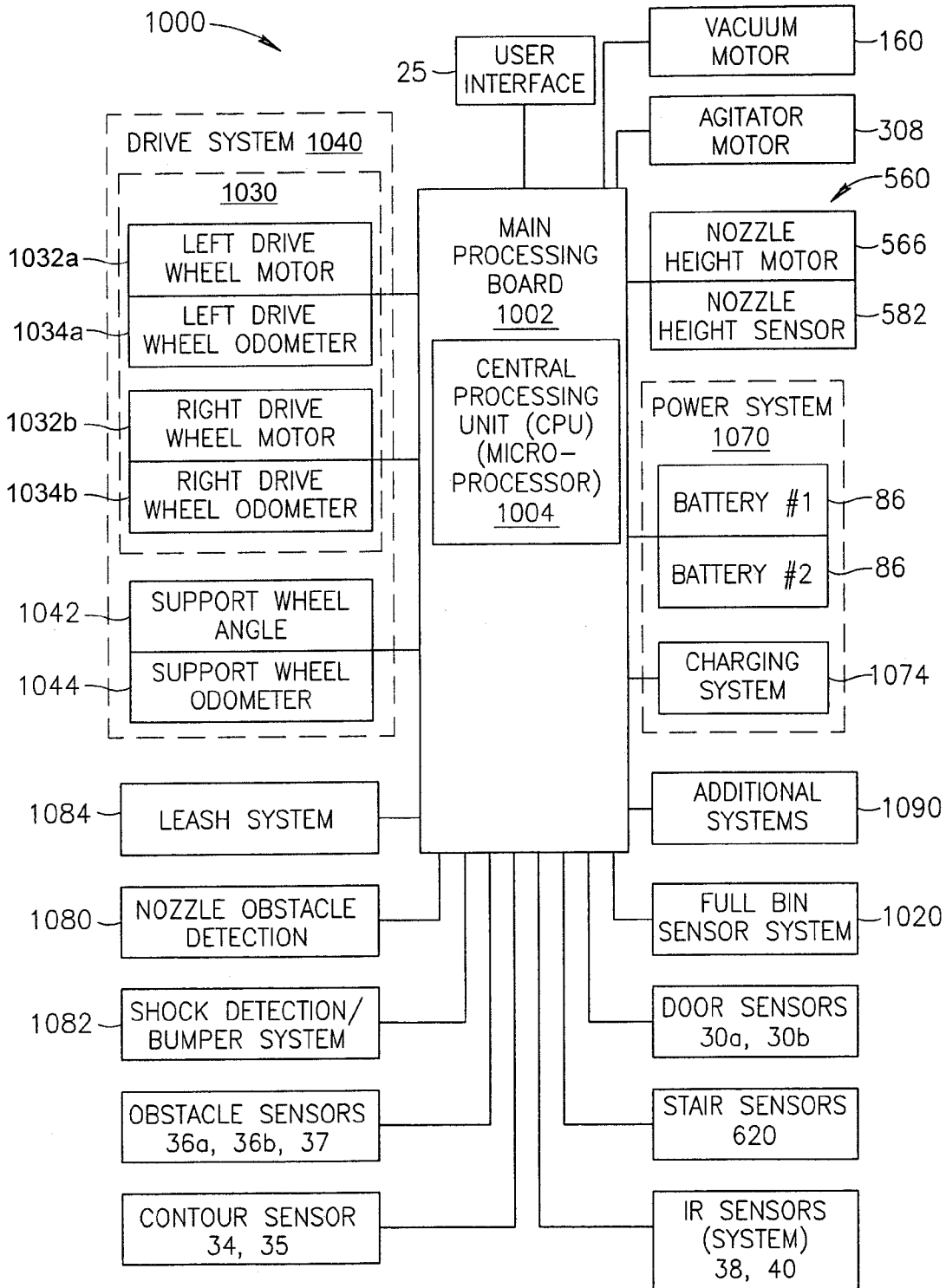

FIG. 23

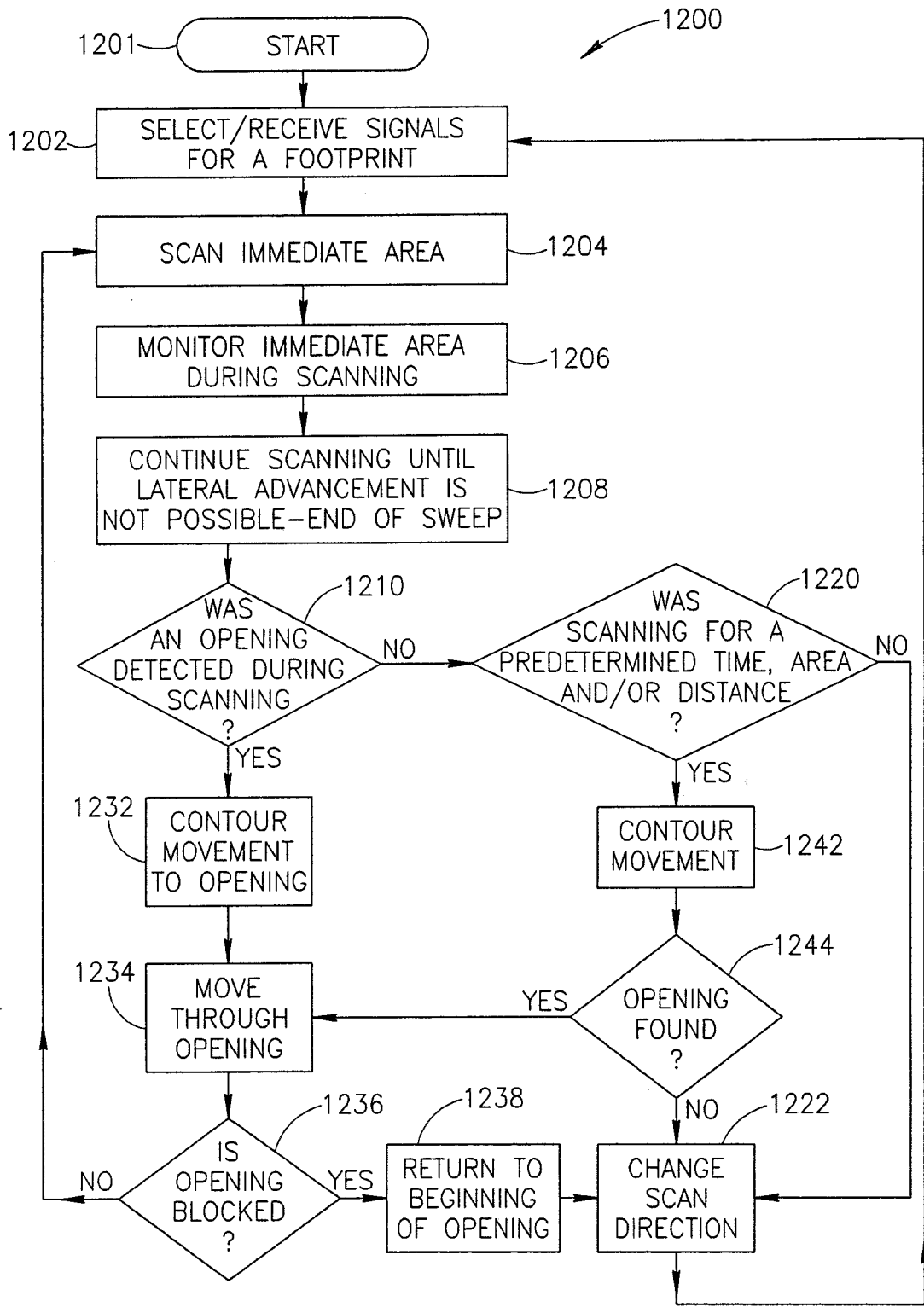

FIG.24A

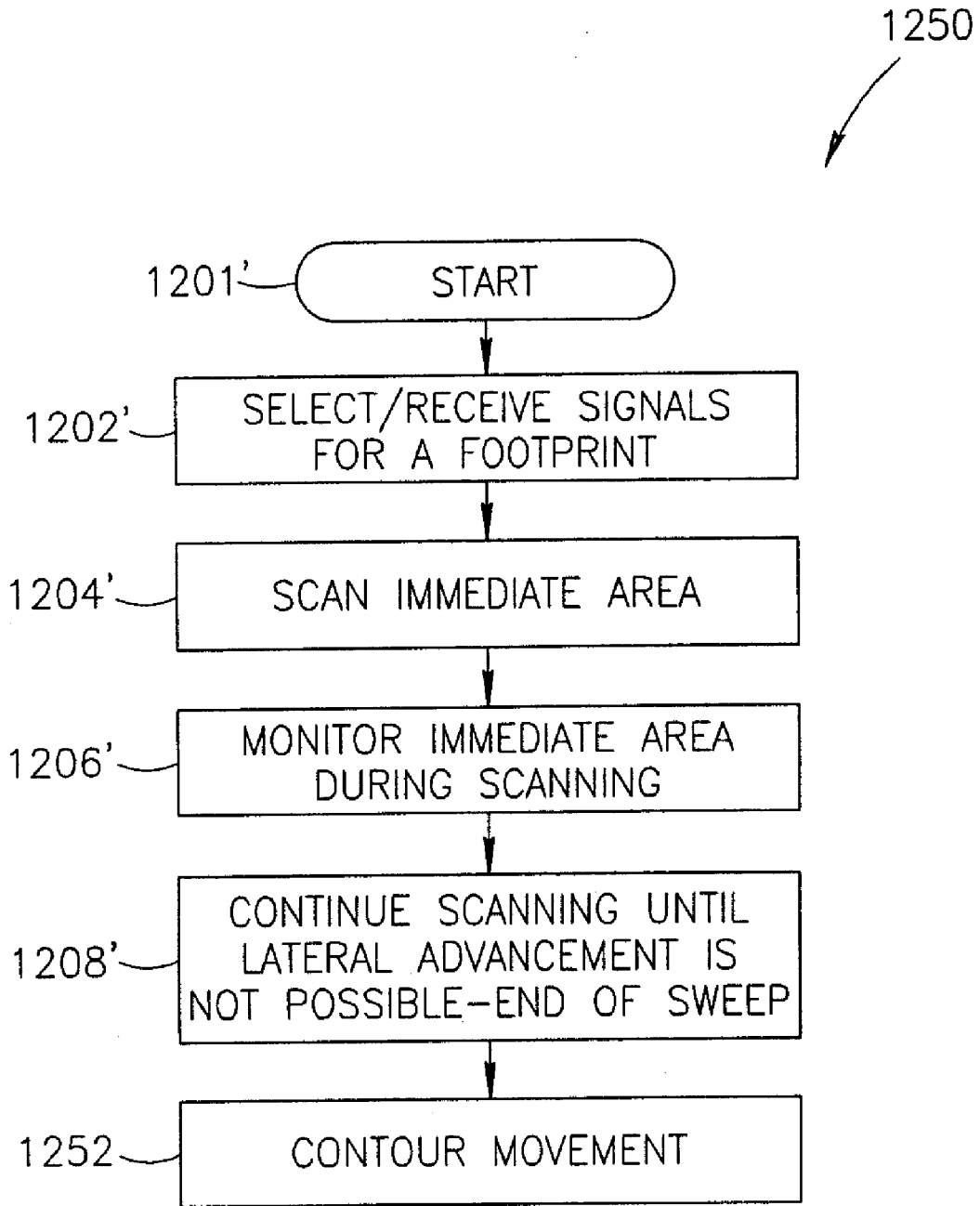

FIG.24B

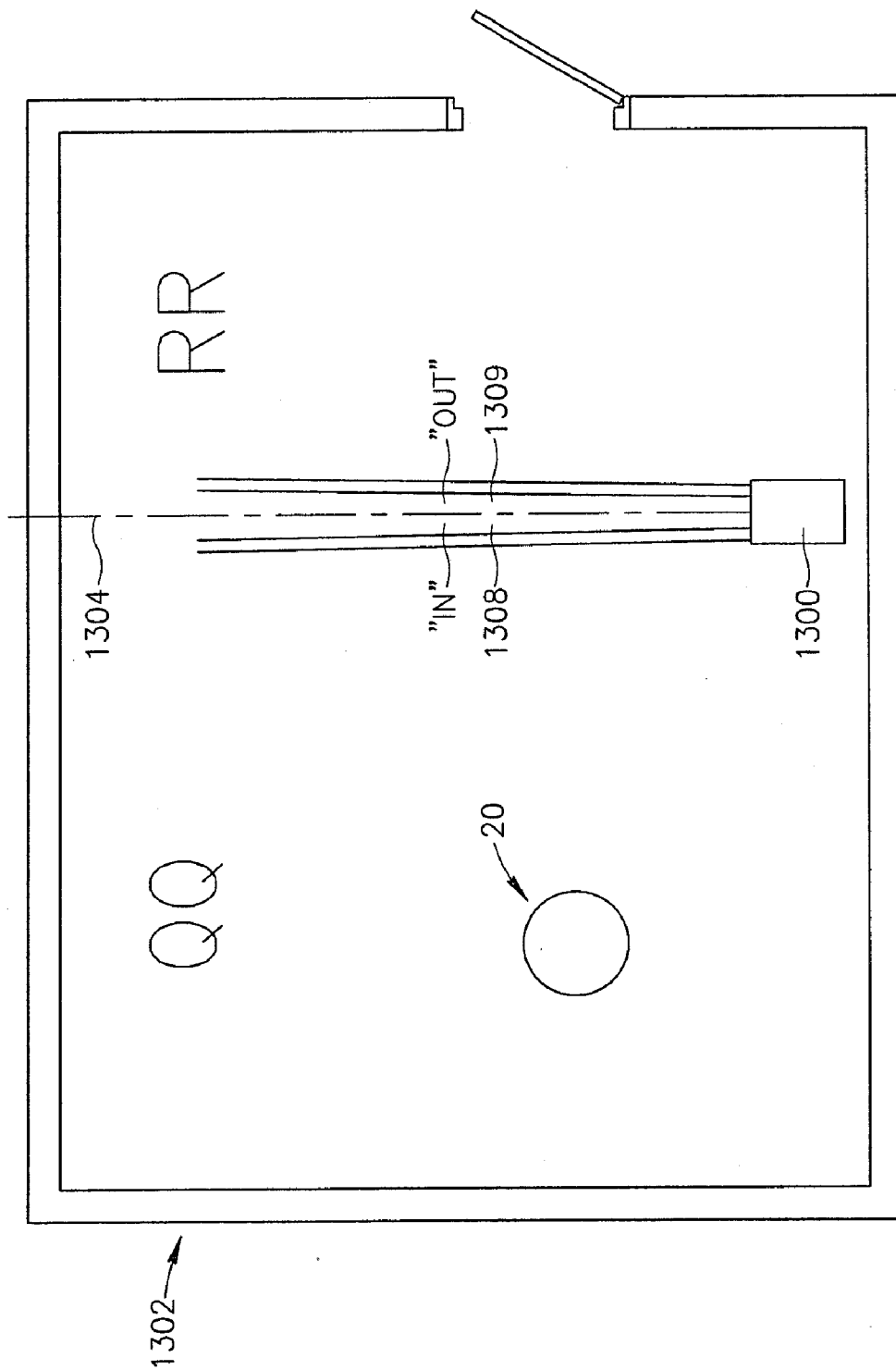

FIG.25

ROBOTIC VACUUM CLEANER

RELATED APPLICATIONS

[0001] This application is a continuation of U.S. patent application Ser. No. 11/487,850, filed Jul. 17, 2006, which is a continuation of U.S. patent application Ser. No. 10/362,092, filed Feb. 7, 2003, now, U.S. Pat. No. 7,079,923, which is a continuation of U.S. patent application Ser. No. 10/007,103, filed Dec. 4, 2001, now, U.S. Pat. No. 7,167,775. The aforementioned applications are incorporated by reference in their entirety herein.

TECHNICAL FIELD

[0002] The present invention is related to robotic and other automated devices and in particular to robotic and automated vacuum cleaning and other similar devices.

BACKGROUND

[0003] Robotics is a rapidly advancing field of technology. Today, for example, robots appear in manufacturing production lines, operating rooms, swimming pools, and warehouses. With the advance of this technology, robots are and will continue to perform more tasks that were one thought to be only performable by humans.

[0004] However, one factor limiting the development of mobile robots is their ability to move freely, absent motion restrictors such as tracks, guides, rails or the like, within a closed or working area, while providing complete coverage over portions of the closed or working area. Moreover, work over these desired or needed areas should be in an efficient manner, with some control over the travel path, so as not to be repetitious or random, and therefore, wasteful of energy.

[0005] Motion restrictive mechanisms, such as tracks, guides, rails or the like are disadvantageous, as they are unaesthetic, and expensive to install and maintain. Additionally, they present a workplace and/or pedestrian hazard, as they protrude from, or are indented, into floors or the like. This may lead to injuries, should a person not be mindful of them.

[0006] Another limiting factor is that robots for area coverage required boundaries, so as not to operate in undesired areas. These boundaries have been either tracks, rails, guides, or other motion restrictors, whose disadvantages have been detailed above, or markers, typically in the form of signs or other mechanisms, protruding from the ground, walls or ceilings, that also present safety hazards as detailed above. Moreover, these signs or other boundary mechanisms are expensive to install and maintain, as they must be precisely positioned and constantly watched by workers to maintain the integrity of the boundaries.

[0007] Additionally, it is desired to extend the uses of robots from commercial uses, as detailed above, to domestic uses. In doing so, the person who employs these domestic use robots will have increased free or leisure time, as they will be free from performing domestic tasks. One such robot is disclosed in commonly owned U.S. Pat. No. 6,255,793, that is incorporated by reference herein.

SUMMARY

[0008] The present invention improves on the contemporary art by providing systems and methods for operating an autonomous machine, typically a robot, for performing tasks, for example, vacuum cleaning. The apparatus of the present

invention includes embodiments in the form of autonomous robots adapted for indoor or confined area coverage, that can be placed in a position within a room or the like and activated, such that the entire room will ultimately be covered and, for example, be vacuumed, surface cleaned or the like. These embodiments can function in ordinary rooms or areas with minimal, if any, room set up or preparation time. The apparatus can move between various surfaces, such as hard floors and carpets, without human intervention to change brushes, nozzles or the like. Additionally, these embodiments can avoid obstacles and cover the room or designated area with minimal repetition from predetermined amounts of energy.

[0009] An embodiment of the invention includes an apparatus for autonomous vacuum cleaning comprising, a payload configured for vacuum cleaning, a drive system including a steering system, a navigation system, and a control system. The control system includes a processor, e.g., a microprocessor, that is configured for integrating operations of the payload, drive system and navigation system.

[0010] Another embodiment of the invention is directed to an apparatus for autonomous operation over an area comprising a drive system and a controller in communication with the drive system. This controller includes a processor, for example, a microprocessor, programmed to: provide at least one scanning pattern for a first portion of the area; analyze the first portion for an opening to a second portion of the area; and signal the drive system to move along a path at least proximate the periphery of the first portion to and through the opening to the second area.

[0011] Another embodiment is directed to an apparatus for autonomous operation over an area comprising a drive system and a controller in communication with the drive system. The controller includes a processor, for example, a microprocessor, programmed to: provide at least one scanning pattern for a portion of the area from a first point; signal the drive system to move along a path at least proximate the periphery of the scanned portion to a second point, the second point at a different location than the first point; and provide at least one scanning pattern for a portion of the area from the second point.

[0012] Another embodiment is directed to a method for area coverage by an autonomous machine, such as a robot or the like. This method includes scanning a first portion of the area in accordance with at least one scanning pattern, analyzing this first portion for an opening to a second portion of the area, and moving along a path at least proximate to the periphery of the first portion to and through the opening to a second portion of the area.

[0013] Another embodiment is directed to a method for area coverage by an autonomous machine, such as a robot or the like. This method includes scanning a portion of the area in accordance with at least one scanning pattern, from a first point; moving along a path at least proximate the periphery of the scanned portion to a second point, the second point at a different location than the first point; and scanning a portion of the area in accordance with at least one scanning pattern, from the second point. In this method moving along the path to the second point can be either a movement of a predetermined length (distance) or the length or distance of travel can be determined dynamically.

BRIEF DESCRIPTION OF THE DRAWINGS

[0014] Attention is now directed to the attached drawings, wherein like reference numerals or characters indicate corresponding or like components. In the drawings:

[0015] FIG. 1 is a perspective view of the apparatus of an embodiment of the present invention;

[0016] FIG. 2 is a rear view of the apparatus of FIG. 1;

[0017] FIG. 3A is a bottom view of the apparatus of FIG. 1;

[0018] FIG. 3B is a front view of the apparatus of FIG. 1 with the bumper section removed;

[0019] FIG. 4 is a perspective view of the apparatus of FIG. 1 with the handle section lifted;

[0020] FIG. 5A is a cross section of the apparatus of FIG. 1;

[0021] FIG. 5B is a front perspective view of the apparatus of FIG. 1 with the cover section removed;

[0022] FIG. 6A is a cross sectional view of the nozzle and agitator unit of an embodiment of the present invention;

[0023] FIG. 6B is a front view of the nozzle of FIG. 6A;

[0024] FIG. 7A is a bottom view of the rear portion of the apparatus;

[0025] FIG. 7B is a cross-sectional view along line 7B-7B of FIG. 7A;

[0026] FIG. 8 is a cross sectional view of an embodiment of a filtration unit of the apparatus and a portion of the apparatus;

[0027] FIG. 9A is a perspective view of an embodiment of an impeller of the apparatus;

[0028] FIG. 9B is a cross sectional view of the impeller of FIG. 9A;

[0029] FIGS. 9C and 9D are sectional views of the impeller of FIG. 9A;

[0030] FIG. 10A is a sectional view of a rotating member of the apparatus;

[0031] FIG. 10B is a cross-sectional view of the rotating member of FIG. 10A, taken along line 10B-10B;

[0032] FIG. 10C is a sectional view of a rotating member of the apparatus;

[0033] FIG. 11 is a perspective view of an alternate embodiment of a rotating member, typically a brush, for the agitator unit of the present invention;

[0034] FIGS. 12A and 12B are top and bottom views of an alternate nozzle and agitator unit for the present invention;

[0035] FIG. 12C is a perspective view of an alternate agitator unit of the present invention;

[0036] FIG. 13 is a view of the bumper section of the cover and the shock detection system, in accordance with an embodiment of the invention;

[0037] FIG. 14 is a perspective view of the shock detection system of FIG. 13;

[0038] FIG. 15 is a perspective view of a drive wheel;

[0039] FIG. 16 is a sectional view of the support wheel assembly;

[0040] FIG. 17 is a perspective view of the apparatus in operation using the leash;

[0041] FIG. 18 is a cross sectional view of the leash assembly;

[0042] FIG. 19 is a perspective view of the nozzle height adjustment system;

[0043] FIG. 20 is diagram of a door sensing system;

[0044] FIGS. 21A and 21B are diagrams of the door sensing system in operation with the apparatus of the invention;

[0045] FIGS. 22A and 22B are diagrams of a stair sensing system in operation with the apparatus of the invention;

[0046] FIG. 23 is a schematic diagram of the control system for the apparatus of the invention;

[0047] FIGS. 24A and 24B are flow diagrams of an example navigation process used by the apparatus of the invention; and

[0048] FIG. 25 is a diagram of a system for confining the apparatus in accordance with the present invention.

DETAILED DESCRIPTION OF THE DRAWINGS

[0049] FIGS. 1, 2 and 3A show the apparatus 20 of the present invention in an exemplary configuration as a robotic vacuum cleaner. The apparatus 20 includes a cover 22, formed of sections 100, 101, 104 and 106 (detailed below), with openings 24a-24g in the bumper section (bumper) 104. There is also a control panel (user interface) 25, supported on the main sections 100, 101. This control panel 25 includes various control knobs 26a, indicators 26b (Light Emitting Diodes (LED) or the like), 26c (LED Display or the like), as well as a socket 27 for receiving a cord (plug end or the like) for charging the apparatus 20 in an electrical outlet or the like. A leash 28 also extends from this control panel 25.

[0050] The apparatus 20 includes sensors, that are part of sensing systems. Door detection sensors 30a, 30b in openings 31a, 31b are on or near the control panel 25 on the upper side of the apparatus 20. The front side of the apparatus 20 includes contour sensors 34, 35 (FIG. 13) for lateral obstacle and wall detection, in openings 24a and 24b (FIG. 13), frontal obstacle detection sensors 36a, 36b in openings 24c and 24d, corner sensors 37, in openings 24e, a shelf detection sensor 38 in opening 24f and remote control sensors 40 in upper opening 24g and lateral openings 24h (see also FIG. 13). These sensors 40 receive signals, typically infrared (IR) light signals, from a remote controller 46 or a coded transmitter 1300, as shown in FIG. 25 and detailed below.

[0051] The apparatus 20 is formed of multiple systems, including a power system, drive (motion) system, navigation system, payload, or vacuuming system, bumper system, sensing (including obstacle detecting) systems, all coupled to a control system 1000 (FIG. 23), allowing for autonomous operation. This autonomous operation includes for example, vacuum cleaning or vacuuming, and other surface cleaning operations and movement therefore, by the apparatus 20. The apparatus 20 also includes numerous other systems, shown and detailed below.

[0052] Turning also to FIG. 3B, the apparatus 20 is formed of a chassis 50, having a base 52 and an extending portion 54 (FIG. 4), for supporting the components and systems (detailed herein). The chassis 50 rests on drive wheels 72 and a support wheel 74. The drive wheels 72 are typically limited to a single degree of freedom and are "active", with each drive wheel 72 controlled by conventional axial drive mechanisms 73 (motors, etc.—FIG. 19). The support wheel 74, is "passive", and typically has multiple degrees of freedom, as it is used for position, distance and orientation control of the apparatus 20 (shown in FIG. 16 and detailed below). This support wheel 74 is for example, a castor wheel, as detailed in FIG. 16 below.

[0053] In normal operation, the drive wheels 72 are forward of the support wheel 74, such that the apparatus 20 moves in the direction of the arrow 75, this arrow indicating the "forward" direction. Accordingly, for description purposes of this document, the terms "forward" and "front" will refer to direction or orientation from the support wheel 74 to the drive wheels 72, while the terms "rear" and "backward" will refer to the direction or orientation opposite of arrow 75, the direction from the drive wheels 72 to the support wheel 74 (and associated electronics). Drive wheels 72 are driven independently of each other, so as to allow for steering (turning and directional changes), and define the steering system 1030

(FIG. 23). These drive wheels 72 (forming the steering system 1030) couple with the support wheel 74, to form the drive system 1040 (FIG. 23). The steering system 1030 and drive system 1040 couple with the control system 1000. Additionally, the drive wheels 72 and support wheel 74 couple with the navigation system (processed through the microprocessor 1004 in FIG. 23).

[0054] Turning also to FIG. 4, battery housings 85 (only one shown), envelope batteries 86, typically 12 volt batteries, typically rechargeable, or other similar power source(s) that provide power to the apparatus 20. The battery housings 85 include handles 87, for ease in placement and removal of the batteries 86 (by a user 88) into and out of the apparatus 20. The housings 85, typically at their bottom sides, include electrical plugs (not shown) for receipt in correspondingly configured sockets (not shown) on the chassis 50, or vice versa, or other suitable paired electrical contacts. The sockets couple with power distribution electronics, to provide power to all components and systems of the apparatus 20, as well as the control system 1000. The batteries 86 and associated electronics and circuitry (detailed above) form the power system 1070 (FIG. 23) for the apparatus 20.

[0055] There is also a charging system 1074 (FIG. 23) formed by a charging module (not shown), and associated circuitry. The charging module is electrically coupled to the batteries 86. The charging module is also connected to the socket 27 or port, that can connect with an electrical line, that plugs into a conventional wall socket or the like, to provide electricity to the charging module and ultimately to the batteries.

[0056] The cover 22 is typically formed in sections 100, 101, 104, 106. There are two underlying or main sections 100, 101, mounted to the extending portion 54 of the chassis 50 in a fixed manner, overlapped in the front of the apparatus 20 by a bumper section (or bumper) 104 and in the rear of the apparatus 20 by a handle section 106. The handle section 106 includes openings 108, 118 where the filtration unit 148 (FIG. 8) is viewable and a handle 106a is formed from the handle opening 118.

[0057] The bumper section 104 is pivotally mounted on the apparatus 20 as it mounts (along its inner wall 110) to the bumper member 360, as shown in FIGS. 13 and 14 and detailed below. This mounting suspends the bumper section 104, allowing it to absorb impacts for the apparatus 20. This bumper section 104 covers an arc of approximately 200 degrees (front and sides). Accordingly, this bumper section can handle frontal and lateral impacts to the apparatus 20 as well as impacts from points along the top of the apparatus 20. This bumper section 104 forms part of the shock detection or bumper system 1082 (FIGS. 13, 14 and 23) and detailed below.

[0058] The handle section 106 is pivotally mounted to the extending portion 54 of the chassis 50. This section 106 includes an opening 118, that when the apparatus 20 is in a use position, snap-fits into the main section 100. The opening 118 is dimensioned such that the filtration unit 148 (FIG. 8), can be viewed. When the apparatus 20 is in the non-use position, the lower portion of the section 106 is pivoted upward, whereby it is a handle 106a, allowing the apparatus 20 to be carried by the user.

[0059] Turning additionally to FIGS. 5A and 5B, there is detailed the payload 130 of the apparatus 20. The payload 130 will be discussed along with other components from other systems, that are explained herein below. The payload 130,

for example, is a vacuum cleaning system, and includes a nozzle 140 that connects to a tube 142, through a duct 144. The tube 142 extends into, and is typically part of, a filtration unit 148 (also in FIG. 3), that includes filter elements 150 and a particle collection area 152.

[0060] A conduit 154 connects the filtration unit 148 to an impeller chamber 156, that houses an impeller 158, that is rotated by a motor 160. The impeller chamber 156, that houses the impeller 158 and motor 160, is typically formed of shells 161a, 161b joined by mechanical fasteners, adhesives or other conventional arrangements, and a support member 162 (attached to the chassis 50), along a rim 162r. The support member 162 includes a vent 163, formed of bars 163a, the vent 163 open to the ambient environment. This allows for air intake for suction (in the direction toward the, impeller 158, or downstream for purposes of this document). This arrangement forms a flow path for particles, that is considered to be indirect, since the filtration unit 148 is before the impeller 158, in the particle flow path.

[0061] An agitator unit 164 is at the base of the nozzle 140. This agitator unit 164 includes a cover 164a, typically includes a compartment 165 for accommodating rotating members 166a, 166b, and is positioned upstream of the nozzle 140. The rotating members 166a, 166b are typically brushes or the like, whose rotation is controlled by a conventional rotator motor 308. The agitator unit 164 may include rollers 168 or the like for contact with the surface or ground 183, and may be mounted onto the chassis 50 in a manner, so as to contact the ground or surface 183, providing resistance to it, and adjust to various levels in accordance with the contour of the ground or surface. There may also be a static brush portion 169 intermediate the rotating members 166a, 166b.

[0062] The cover 164a, for example, at its front, begins at a height hh off of the ground 183 (for example, approximately 2 to 4 cm), exposing the rotating members 166a, 166b, so as to be an "open brush". This "open brush" construction, allows obstacles to be agitated by the rotating members 166a, 166b and suctioned away for enhanced cleaning and obstacle free movement of the apparatus 20. These rotating members 166a, 166b in this construction can assist with drive movements.

[0063] Turning also to FIGS. 6A and 6B, the nozzle 140 includes a neck 170 and a body 172, that form an inner cavity 174 for particles (e.g., debris, etc.) to pass through. At one end, the neck 170 terminates in an opening 176 for attachment to the tube 142 of the filtration unit 148. The other end extends to an outwardly tapered portion of the body 172. The body 172 terminates in a lip 178, that is typically rounded, with an opening 180. This opening 180 includes a first, and typically upper edge 180a, and is narrow at its middle 180m or mid-section and wide at the sides 180s, as a result of the tapering (upward, away from the ground 183) of the lip 178, so as to have uniform airflow into the nozzle opening 180.

[0064] The body 172 also includes sidewalls 172a, that border a cut-out edge 182. This cut-out edge 182 defines a second, typically lower, edge of the opening 180, and provides for ground clearance and greater maneuverability. The horizontal orientation of the nozzle body 172, coupled with the lip 178 extending beyond the cutout edge 182, allows a flow cavity to be formed with the floor or surface 183. This cavity is of a constant vertical aperture with respect to the opening 180, as indicated by typically equal lengths 180'. This constant vertical aperture maintains acceleration of the airflow into the nozzle opening 180 and nozzle body 172.

Additionally, the cavity, coupled with the shape of the rotating members **166a**, **166b** creates a horizontal acceleration channel with horizontal air flow for particulates (debris, etc.) into the nozzle **140**.

[0065] Turning also to FIGS. 7A and 7B, arms **184** extend laterally from the neck **170** and terminate in blocks **186**. The blocks **186** are mounted in boxes **188**, with receiving portions **189**, outer sidewalls **189a** and inner (cut-out) sidewalls **189b**. As detailed in FIG. 7B, the blocks **186** are forced into the receiving portions **189** by biasing members (typically flexible), for example, springs **192**, that extend inside the blocks **186** and can be covered with an electrically insulative sheath **192a** tube or the like, and frictionally retain the blocks **186** in the boxes **188**. The springs **192** can also be made of nonconducting material, for example, plastics or non-conducting metals (to avoid a short circuit between the plates **194**, **198** and the spring **192**, detailed below). This arrangement provides the blocks **186** with the ability for pivotal movement therein, ultimately allowing the nozzle **140** to pivot about the boxes **188**.

[0066] The boxes **188** include electrical contacts **194**, **195**, typically metal sheets, plates, or the like, in communication with wiring **196** (from wire leads **196a**) linked to the control system **1000**. The blocks **186** include a metal plate **198** at one end and a metal stub **199** (also FIG. 6B) at the other end (along the arm **184**), also connected by the wiring **196**. The plates **194**, **198** between the respective boxes **188** and the blocks **186**, form “normally open” contacts, while the respective plates **195** of boxes **188**, and stubs **199** form “normally closed” contacts. This series of contacts and associated electronics defines a nozzle obstacle detection system **1080** (FIG. 23).

[0067] In operation, the open contact (plates **194**, **198**) and the closed contact (plate **195** and stub **199**) are registered with the control system **1000**. Should the nozzle **140**, upon its movement encounter a hard object, obstacle, or the dragging force becomes too great, the nozzle **140** will move. If the force is great enough, and movement of the nozzle **140** closes any of the normally open contacts, such that the plate **198** physically contacts the plate **194**, and/or opens the physical contact between the plate **195** and the stub **199**, a signal, typically indicating a closed or open circuit respectively (from the initially open and closed circuits, respectively), will be sent to the control system **1000**.

[0068] With the requisite signal sent to the control system **1000**, the control system **1000** will signal the nozzle/rotating member height mechanism **560**, to raise the nozzle **140** (and the rotating members **166a**, **166b** attached thereto) over the obstacle. With the nozzle **140** and rotating members **166** having cleared the obstacle, travel of the apparatus **20** continues as normal. Alternately, the control system **1000** can be programmed to signal the drive system **1040** to cease operation immediately. (This is also true for other drive system stoppages throughout this document, that are not specifically detailed).

[0069] The nozzle **140** is typically made of resilient materials, such as plastic (HDPE, PVC, Nylon, etc.) and is easily separable from both the base **52** of the chassis **50** and the agitator unit **164**. The nozzle **140** typically snaps into the base **54** with the agitator unit **164** snapping into the nozzle **140**, in a “tools free” manner. For example, the agitator unit **164** snaps into the nozzle **140** as edges **204** of the agitator fit into slots **206** on the nozzle **140** (FIGS. 6A, 6B and 19). This engagement is held together by a resilient clip **208** on the

agitator unit **164** having a spike (not shown) on its lower surface, that engages a correspondingly configured opening (not shown) on the nozzle **140**, holding the nozzle **140** and agitator unit **164** together. This snap-together arrangement allows for different nozzles to be placed onto the apparatus **20**. These different nozzles are designed for the specific type of particulate and surface that the apparatus **20** is to be operated on.

[0070] Turning also to FIG. 8, the tube **142** is formed of a neck **222** and an outwardly tapered head portion **224**. The head portion **224** is typically of a diameter larger than the neck **222**, and is of a configuration to push particles around the filter element **150** (having pleats **150a**), that is open on its lateral sides and above it. This results in air circulation along the pleats **150a**, that causes a self-cleaning effect, resulting in longer life for the filter element **150**. Pressure loss is minimized due to reduced blockage of the material forming the filter element **150**.

[0071] This filtration unit **148** is a box-like article of a transparent material, such as plastic or the like, to allow for full bin sensing (detailed below) and inspection by viewing. It can be easily removed, by lifting, from the apparatus **20**, when the handle section **106** is lifted (as shown in FIG. 4). It typically separates into two pieces **230**, **231** (allowing for emptying of dirt held therein), that when placed together along edges **230e**, **231e**, lock in a frictional engagement. A fist piece **230** forms the bottom of the unit **148**, with its inner side serving as the particle collection area **152** or dirt cup.

[0072] The preferred material for the filter **150** is a material having a permeability of approximately 100 CFM per square foot.

[0073] Proximate the filtration unit **148** and within the apparatus **20** is a light transmitter **232** and a light receiver **233**, that coupled with the requisite electronics, form a full bin sensing system **1020** (FIG. 23). The transmitter **232** and receiver **233** communicate with the filtration unit **148** through openings **232a**, **233a** in the extending portion **54** of the chassis **50** that borders the filtration unit **148**. The light transmitter **232** and light receiver **233**, with associated electronics, couple to the control system **1000**. A “full bin” is sensed when dirt has accumulated in the filtration unit **148** to a point where light transmitted from the transmitter **232** can not be detected by the receiver **233**. A signal is then sent from the control system **1000**, for example, to an indicator light **26b** indicating a full bin. (The filtration unit **148** can be removed and emptied as detailed above).

[0074] FIGS. 9A-9D show the impeller **158** in detail. The impeller **158** is constructed to pull particulates downstream upon rotation by the motor **160**. The impeller **158** includes a central member **250**, typically conical in shape, with a bore **251** therein for accommodating a motor shaft **270** or the like and plates **254**, **255**, with two types of blades **256**, **258** therebetween. The upper plate **254** for example, has a radius of curvature RA of approximately 53 mm, while the conical portion **250** defining the lower plate **255** has a radius of curvature RB, for example, of approximately 39 mm.

[0075] These blades **256**, **258** include short blades **256**, that typically extend from at least proximate the ends of the plates **254**, **255** to a point before the conical contour of the central member **250**, and longer twisted blades **258**, that extend from at least proximate the ends of the plates **254**, **255** to the conical contour of the central member **250**. The upper plate **254** includes an opening **262** to receive portions of the twisted blades **258**.

[0076] Blades **256**, **258** are typically arranged in threes, with typically two arced (or short) blades **256** between each twisted blade **258**. There are typically five series of these three blade arrangements (two short blades and one twisted blade). Arced blades **256** are typically curved, so as to have exit angles α , typically 30 ± 5 degrees, while twisted blades **258** typically are curved such that exit angles β beta. are typically 30 ± 5 degrees. These twisted blades include an upper blade twist angle λ along the conical portion **250** of for example, approximately 10 degrees, and an input angle Φ of approximately 60 degrees, and a radius of curvature R_X of for example, approximately 9 mm.

[0077] The blades **256**, **258** are typically arced in the same direction, between the plates **254**, **255**. This configuration of blades **256**, **258** provides for high impeller efficiency of approximately 60%. (This efficiency is defined by the output airflow divided by the motor input power). The impeller **158** is typically an integral, one piece structure, made of hard plastic, such as HDPE, PVC, Nylon. It is typically made by techniques such as injection molding or the like.

[0078] The motor **160** is typically an 80 watt standard motor, or other similar motor. It includes a shaft **270** extending therefrom, to which the impeller **158** attaches. This motor **160** is electrically connected to the power system **1070**, and can operate at relatively low RPMs, for example here, the motor **160** may operate at approximately 7500 RPM. By operating at low RPMs, the motor operates at a low noise level and is energy efficient. The motor **160** is held on a motor support **272** (FIG. 5A), that may be incorporated into the support member **162**.

[0079] Turning to FIGS. 6A and 10A-10C, the agitator unit **164** includes rotating members **166a**, **166b**, typically brushes. These rotating members **166a**, **166b** are joined together by a pulley **300**, attached thereto, that is received in a belt **302**. The other end of the belt **302** is received by a shaft **306** of a motor (agitator motor) **308**, that rotates the shaft **306**, the motor **308** operated by the control system **1000**.

[0080] Speed of the rotating members **166a**, **166b** (i.e., brushes) can be changed according to surface type, detected by the method detailed below and signaled to the control system **1000** that signals the motor **308**, or manually entered into the control system **1000** by the user (typically via the remote controller **46** or through the user interface **25**). For example, the rotating members **166a**, **166b** or brush speed may be approximately 3000 RPM on carpet, and about 500 RPM on hard floors. The low RPM on hard floors is to eliminate particles from escaping under the nozzle **140** due to their high energy. This problem does not exist in carpets since there is not a gap between the nozzle **140** and the carpet.

[0081] One method for defining or detecting the surface type is by measuring the load on the motor **308** that drives the rotating members **166a**, **166b** (brushes). This is due to a difference in load on the motor **308** between hard floors and medium to deep (e.g. medium to deep pile) carpets. These loads are signaled to the control system **1000**, that processes this information and signals the motor **308** to rotate the rotating members, at the above described speeds for hard floors and carpets, respectively.

[0082] When on deep carpets, the height of the rotating members **166a**, **166b** is relative to the position of the drive wheels **72**, so that in deep carpets (e.g., deep pile carpets) a noticeable height can be measured as the drive wheels **72** sink in the carpet, while the rotating members **166a**, **166b**, float on the carpet. Accordingly, the control system **1000** can detect

that deep carpet is the surface over which the apparatus **20** is traveling, as detailed below. Based on this height detection, the control system **1000** can signal the motor **308** to the aforementioned speeds. For example, greater heights with respect to the surface **183** are indicative of carpets, and thus, the control system **1000** signals the motor **308** to rotate the rotating members **166a**, **166b** at the high speed, of approximately 3000 RPM. Alternately, lower heights with respect to the surface **183** are indicative of hard floors, and thus, the control system **1000** signals the motor **308** to rotate the rotating members **166a**, **166b** at the low speed, of approximately 500 RPM.

[0083] These two surface detection mechanisms typically operate dynamically and "on the fly". They are typically sufficient in detecting most surfaces. However, the aforementioned surface detection mechanisms may be of lesser accuracy with respect to low or low pile carpets.

[0084] Accordingly, the motor **308** and rotating members **166a**, **166b**, as coupled with the control system **1000**, can also serve as a third surface detection mechanism. This system is particularly effective in detecting these low or low pile carpets. This is done in the microprocessor **1004**, that will analyze the load on the motor **308** for the rotating members **166a**, **166b** as a function of resistance provided by the surface being traversed. This detection mechanism involves a short shut down of the motor **308**, for example, approximately 0.5 seconds. Accordingly, rotation of the rotating members **166a**, **166b** ceases. If the surface or ground provides resistance to the rotating members **166a**, **166b**, this resistance and resulting movement (rotation) of the rotating members **166a**, **166b**, will result in a back electromotive/electromagnetic force (EMF) on the motor **308**, that is measured as a voltage. These measurements are sent to the control system **1000**, that signals the motor **308**.

[0085] For example, where back EMF is low to negligible, the surface being traversed is most likely a hard floor, whereby the control system **1000** will signal the motor **308** to rotate the rotating members **166a**, **166b**, at a slow speed, typically approximately 500 RPM for hard floors, as detailed above. Alternately, where back EMF is large, the surface being traversed is most likely a carpet, such as the low or low pile carpet, whereby the control system **1000** will signal the motor **308** to rotate the rotating members **166a**, **166b**, at a high speed, typically approximately 3000 RPM for carpets, as detailed above.

[0086] Turning to FIGS. 10A-10C, the rotating members **166a**, **166b** will be described with respect to a single rotating member **166a**, that is exemplary of both rotating members **166a**, **166b**. Accordingly, all components of both rotating members **166a**, **166b** are the same and are numbered as such, except for grooves **314a**, **314b**, that are the same in construction, but are numbered differently to illustrate operational principles, as detailed below. The rotating members **166a**, **166b** both include a core **316** of diameter DC and a helical groove **314a**, **314b**, respectively, that extends into the core **316**. Diameter DC is typically large, for example, approximately 30 mm, resulting in a typically large perimeter of approximately 10 cm, so as not to allow fringes or other carpet or rug fragments to wrap around the core **316**. The grooves **314a**, **314b** include a leading edge **318**, that is preferably straight and at least substantially parallel with respect to the vertical, and a trailing edge **319** that is preferably rounded. (The leading edge **318** and trailing edge **319** of the grooves **314a**, **314b** are referred to as such, in accordance with the

preferred rotational direction of the rotating members **166a**, **166b**, indicated by arrow RM.)

[0087] Bristles **320**, anchored into the core **316** of the rotating member **166a**, **166b**, by conventional fastening techniques, extend from the core **316**, through the groove **314a**, **314b** to slightly beyond the outer surface **322** of the rotating member **166a**, **166b**. By resting in the grooves **314a**, **314b** and the grooves **314a**, **314b** dimensioned as detailed herein, the bristles **320** can bend, so as not to inhibit torque on the rotating members **166a**, **166b**. These bristles **320** are typically made of nylon or the like.

[0088] The rotating members **166a**, **166b** are connected to the pulley **300** at an orientation where the respective grooves **314a**, **314b** form a "V", such that these grooves **314a**, **314b** spiral outward from the center of the apparatus **20**. This orientation of the grooves **314a**, **314b**, coupled with their construction, the diameter of the core **316**, bristle **320** arrangement in the grooves **314a**, **314b** and length, moves dirt toward the center or inward into the nozzle **140**. These rotating members **166a**, **166b** are also detachable, and can be replaced with other suitable brushes or the like.

[0089] Alternately, as shown in FIG. 11, there is an alternate rotating member **166'**, typically a brush with a core **312'**, that is attached to the agitator unit **164** as detailed above. The rotating member **166'** is similar in all aspects to the rotating members **166a**, **166b**, except where indicated. The rotating member **166'** is formed of resilient members **320'**, for example, of hard plastic, rubber or the like, embedded therein or attached thereto. Upon rotation of the brush, the rotating members **320'** strike the surface with a force sufficient to agitate or bring up particulates. These members **320'** can also bend, so as to keep torque on the rotating member **166'** at suitable levels for proper operation.

[0090] FIGS. 12A and 12B detail alternate embodiments of the nozzle **140'** and for the agitator unit **164'**. All components are the same as those in the nozzle **140** and agitator unit **164** detailed above, except where indicated. In the nozzle **140'**, there are protrusions **328** at the nozzle opening **180**, to make airflow uniform at the nozzle opening **180**. In the agitator unit **164'**, the rotating members have been replaced by a clapping unit **330**. The clapping unit **330** attaches to the nozzle **140** by a plate **331**, via screw mechanisms **331a** or the like. This clapping unit **330** includes the pulley **300** attached to a rod **332**, on which are connected wheels **334** and cams **335** with lips **335a**, that upon rotation of the rod, move clips **338**, by lifting their flanges **338a**, up and down, typically at different times (although all at the same time is also suitable), to create agitation of particulates for suction.

[0091] FIG. 12C details another alternate embodiment agitator unit **164''**. Here, there are two motors **340a**, **340b**, that typically rotate cams **342a**, **342b** in opposite directions, as indicated by the arrows **343a**, **343b**. However, the same direction for rotation is also permissible. Non-motorized cams **344**, mounted to the apparatus **20** support belts **345** that include bristles **320''**. The belts **345** and bristles **320''** travel in a direction substantially perpendicular to the direction of travel of the apparatus **20** (indicated by arrow **75**). This substantially perpendicular direction of travel is sufficient to create the requisite agitation of particulates for suction as detailed above.

[0092] FIGS. 13 and 14 (in FIG. 14, the support member **162** is partially cut away) detail the shock detection system **1082** (FIG. 23) for the apparatus **20**. This system includes bumper member **360**, having rods **362** received in oppositely

disposed lateral supports **364**, that abut lateral segments **162a**, typically having an inverted "L" shaped contour, on the support member **162**. The rods **362** are hooked to springs **366**, that in turn are hooked to the vent bars **163a** of the support member **162**. The springs **366** pull the rods **362** upward, such that the lateral supports **364** engage the lateral segments **162a**. This attachment provides the ends of the lateral supports **364** with pivotal movement at pivot points **365a**, **365b**, from the lateral segments **162a**. This pivotal movement may occur upon frontal or top impacts to the apparatus **20**. The lateral supports **364** include oppositely disposed protrusions **370** that are received in correspondingly configured tracks **372** on the inner wall **110** of the bumper section **104** (only one shown). The positioning of the bumper member **360** in the apparatus **20** is such that shock detection is provided along an arc of approximately 200 degrees.

[0093] The bumper section **104** is supported at its center of gravity, inhibiting tilting torque from developing during acceleration and deceleration of the apparatus **20**. The linear force on the center of gravity during acceleration, is balanced by the spring **366** force, where the front mounting eliminates any movement during deceleration. Additionally, the bumper section **104** and bumper member **360** are connected such that a static force of approximately 0.26 kilograms (Kg) on the upper and lower ends of the bumper section **104** and increasing to a static force of 1.2 Kg at the center will activate a signal to the control system **1000** that the bumper section **104** has contacted an obstacle and for example, the drive system **1040** must be signaled to cease motion, by the control system **1000**. Typically, the drive system **1040** will stop motion, such that the apparatus **20** has traveled not more than approximately 15 cm from the time of impact with the obstacle.

[0094] The rods **362** are connected by a central member **374**, that rests between arms **376** from a spring **378**. These arms **376**, each rest in grooves **380**, within a guide **382**, and while movable, provide a resistive force against lateral movement of the central member **374**, in the case of side impacts on the apparatus **20**.

[0095] Metal clips or plates (not shown) extend along the inner sides of the lateral supports **364**, and contact metal members (not shown) at the pivot points **365a**, **365b** on the lateral segments **162a**, to form electrical contacts. Arms **376**, also of a metallic material, contact a metal band **388** on a member **390** rearward of the guide **382**. In the case of a front impact of sufficient force (overcoming that of the springs **366**), the bumper member **360** will be moved pivotally. There are also electrical leads **392** throughout this member **360** to which wires or the like are connected for coupling with the electronics of the control system.

[0096] In operation, if at least one of the four electrical contacts at the pivot points **365a**, **365b** is broken, typically as a result of a front, side or top impact to the apparatus **20**, a signal will then be sent to the control system **1000**, that will then, for example, signal the drive system **1040** to cease motion immediately. In the case of a side impact, the bumper member **360** will move laterally, such that this movement causes at least one of the arms **376** to move out of contact with the band **388**. This will also cause a signal to be sent to the control system **1000**, that will then, for example, signal the drive system **1040** to cease motion. Specifically, these pivotal and lateral movements are caused by contact to the bumper section **104** at the front of the apparatus **20**. The bumper member **360** is configured for example, such that movements of approximately 2 mm or greater to the bumper section **104**

or forces as detailed above, will cause these pivotal or lateral movements, to occur, whereby at least one requisite electrical contact is made or broken. This change in electrical contact will result in a signal being sent to the control system 1000, that will signal the drive system 1040 to stop, ceasing motion of the apparatus 20 (as detailed above). Motion ceases within the depression limits of the bumper member 104, that is typically not more than 20 mm.

[0097] FIG. 15 shows a drive wheel 72 (representative of both drive wheels), that typically includes a tread portion 72*t* formed of lateral protrusions 72*a*, defining outer rows, with central “+” shaped protrusions 72*b*, defining an inner row. This provides the drive wheel 72 with increased traction, to minimize slippage along various surfaces, for example, hard floors and carpets. This allows for precise movement of the apparatus 20. The drive wheel 72 at this treaded portion is typically made of a soft rubber or the like.

[0098] The protrusions 72*b* of the inner row are “+” shaped so as to be reinforced laterally, to establish a central point for turning. The protrusions 72*a* of the outer rows are flexible laterally, to smooth the drive path and are flexible laterally allowing for turning with minimal movement of the turning center. The gaps between protrusions 72*a* of the outer rows, improve climbing on carpets, should the carpet be approached from an angle.

[0099] FIG. 16 shows the support wheel 74 in an assembly that with associated electronics forms a portion of the drive system 1040 (FIG. 23) that couples to the control system 1000. The support wheel 74 is, for example, a castor wheel, typically formed of two shells 400*a*, 400*b* (FIG. 2), so as to have a hollow inner chamber 402. For additional traction, there can be a band 403 (FIG. 2), made of rubber or the like, placed around the support wheel 74. Here, there are magnets 404, or other metal objects detectable by magnets or the like. The shells 400*a*, 400*b* also include aligned bores 408 for receiving the axial portion 410 of a movement arm 412 (the other portion of the movement arm 412 being the main portion 414). The support wheel 74 tracks odometry and angles of travel, to signal the control system 1000 for determining direction and orientation of the apparatus 20.

[0100] The movement arm 412, at its main portion 414 is rotatably mounted within a sensor unit 416. This sensor unit 416 includes several, typically three, magnetic field sensors 418, such as hall effect sensors, located over a circle around the arm 412. These sensors 418 send signals to the control system 1000.

[0101] The positions of the magnets 404 in the wheel inner chamber 402, based on the angle with respect to the horizontal, coupled with the rotations of these magnets 404, are utilized by the control system 1000, in an odometer function, to determine total displacement. By monitoring the signal obtained from the magnetic field sensors 418, both the travel distance and the orientation of the castor wheel 74 can be determined (the distance is obtained by counting the number of pulses induced by the traveling magnets 404 where the angle is calculated by comparing the strength of signal between the magnetic field sensors 418).

[0102] Based on these calculations of distance and displacement, the control system 1000 can adjust the steering 1030 and drive 1040 systems accordingly, to properly position the apparatus 20. The control system 1000 with this information can also control the navigation system accordingly.

[0103] Turning to FIGS. 17 and 18, there is the leash 28 as detailed above. The leash 28 is a wire 508 or the like, and includes a balled end 510 and a coiled end 512, typically wrapped around a spring biased roller 514 in the body of the apparatus 20. The wire 508 extends through a mechanical member 520, intermediate its ends.

[0104] The mechanical member 520 includes a body 522, and oppositely disposed ring members 524, 525 with hemispherical protrusions 524*a*, 525*a* resting in each other in alignment. Ring members 524, 525 also include a tubular guide 524*b*, 525*b*. Upper ring member 525 is held in place by a spring 528, that is held in place by the body cover 530 and the neck 525*c* of the ring member 525. This spring 528 allows for movement of the upper ring member 525 when the leash 28 (wire 508) is pulled. A sensor(s) 540, coupled to the control system 1000, connects to the ring members 524, 525 and detects which protrusions 524*a*, 525*a*, were temporarily pulled out of alignment, and signals this back to the control system 1000. The control system 1000 recognizes this direction, and powers the drive wheels 72 accordingly, with the direction and orientation of the apparatus determined by the support wheel 74 and its sensors reporting to the control system 1000.

[0105] Turning now to FIGS. 3B and 19, there is a nozzle height adjusting system 560 (FIG. 23), coupled to the control system 1000, that raises and lowers the nozzle 140, in response to the surface, and in some cases, obstacles detected. The nozzle 140 includes a bracket 561 with an opening 562 therein. This opening 562 is engaged by a rod 564 attached to an adjustment mechanism 566, and with associated electronics, is coupled to the control system 1000. The nozzle 140 is spring mounted, and can be pushed upward, to contact a metal or magnetic portion 570 of a member 572 within a spring 573. The end of the metal member 572 is detected by a magnet (magnetic sensor) 580, for example, a hall effect sensor, that senses a position change for the member 572, and will indicate this change, via signals or the like to the control system 1000, that will signal the adjustment mechanism 566, typically including a motor 566*a*. This motor 566*a* will drive an eccentric member 566*b*, that translates rotation to vertical movement by moving the rod 564, and therefore the nozzle 140 up to the proper position. (The nozzle 140 will move down provided there is open space between the rotating members 166*a*, 166*b*, i.e., brushes, and the surface, as detailed below).

[0106] The nozzle height adjustment system 560, in particular the adjustment mechanism 566, typically functions to set only the minimum height for the nozzle 140 and rotating members 166*a*, 166*b* (i.e., brushes) (since the nozzle 140 is attached to the rotating members 166*a*, 166*b*, they are treated as a single unit-nozzle/rotating members, for purposes of this example description). Accordingly, it can adjust the nozzle 140/rotating members 166*a*, 166*b*, for higher surfaces automatically, since the nozzle 140/rotating members 166*a*, 166*b* can travel freely upward. The minimum height is required to keep the nozzle 140/rotating members 166*a*, 166*b* (i.e., brushes) at a desired height, and therefore reducing the load on the nozzle/rotating members, as induced by the carpet. On hard floors or other surfaces, the rollers 168 maintain the nozzle 140/brushes 166*a*, 166*b* at the correct height.

[0107] The measurement of height for the rotating members 166*a*, 166*b* (i.e., brushes) is also suitable for determining surface types, in particular, carpets versus hard floors or other surfaces. This can be achieved because the brushes 166*a*,

166b and nozzle **140** have a degree of freedom in the upward direction, and therefore, can follow the level or contour of the surface on which they are riding. For example, in carpets, the rollers **168** sink slightly, the brush height in relation to the rollers **168** will be different from this height on a hard floor, and thus the surface type can be determined.

[0108] The various sensors and systems formed by combinations thereof are further detailed below. All of these sensors are electrically coupled to the control system **1000**, that in turn signals the drive system **1040** and drive wheels **72** to operate in various modes, depending upon the obstacle or opening detected.

[0109] Turning also to FIGS. **20**, **21A** and **21B**, door detection sensor **30a** is typically formed of two infra-red (infrared or IR) transmitters **600a**, **600b**, while the other door detection sensor **30b** is typically formed of an IR receiver(s) **602**. The transmitters **600a**, **600b** are positioned at an angle θ , with respect to each other, that is, for example, approximately 20-30 degrees, and at a distance zz from each other, for example, approximately 10 mm. One transmitter, here, transmitter **600a**, and the receiver **602** are typically also tilted approximately 5 degrees (into the plane of the paper). This tilting limits potentially unwanted reflections from horizontal highly reflective surfaces such as metal door frames, mirrors, lights, reflectors, etc., since most of the light energy in these cases will be projected 10 degrees forward rather than returning to the receiver **602**.

[0110] Door or boundary detectors include retro-reflectors **606** (reflectors that reflect light back at approximately the same angle received), typically sticker-like, of which one or more can be placed on the floor proximate the door **608** and/or within the door jamb itself. Should a floor or wall boundary be desired, the retro-reflector **606** may be placed on the floor or wall, and similarly, the retro-reflector **606** may be placed on the ceiling to define the desired wall or floor boundary.

[0111] The transmitters **600a**, **600b**, by being arranged at this angle θ , can detect the desired doors, and entryways for these doors, while distinguishing them from other locations, such as under tables, counters or the like. In operation, the transmitters **600a**, **600b**, emit light beams **609a**, **609b** (illustrated in FIGS. **21A** and **21B** for description purposes). The range for the receiver **602** is also represented by a beam **610** (also, only for description purposes).

[0112] In FIG. **21A**, should a door be detected, the receiver **602**, will detect a reflection of a beam from the corresponding transmitter **600a** (illustrated by overlapping beams **609a**, **610**) off of the retro-reflector **606**, while the receiver **602** will not detect a reflection from the second transmitter **600b**.

[0113] In FIG. **21B**, should an area of lower clearance than a ceiling or door jamb be detected, such as a table **611** or the like, some portions of the light (beams) emitted from both transmitters **600a** and **600b** will be detected by the receiver **602**, as illustrated by the arrows **609ar**, **609br**, being within the range of the receiver beam **610**.

[0114] As these transmitters **600a**, **600b** and receiver **602** are in electronic communication with the control system **1000**, the requisite signals, based on whether or not light, from zero, one or both sensors (transmitters) **600a**, **600b** was received (by the receiver **602**), are sent to the control system **1000**. This control system **1000**, as detailed above, will signal the drive system **1040** (FIG. **23**) ceasing motion of the apparatus **20** or changing direction of the apparatus **20** as per the determined travel (cleaning) pattern, as detailed below.

[0115] Similarly, the transmitters, receivers and reflector(s) can be replaced by any combination of transmitters, receivers and reflectors, provided they function as detailed above.

[0116] Contour sensors **34**, **35**, are typically mounted laterally, at the sides of the apparatus **20** at upper and lower positions. These sensors **34**, **35** are used for detecting walls, furniture and other laterally positioned obstacles. These sensors **34**, **35**, are typically formed of an ultrasonic transmitter and an ultrasonic receiver. These contour sensors are in communication with the control system **1000**, and should a wall, furniture or other lateral obstacle be detected, the control system **1000** will signal the drive system **1040** ceasing motion of the apparatus **20**, as detailed above.

[0117] Obstacle sensors **36a**, **36b**, **37** for detecting obstacles, such as furniture, walls, or other obstacles, are typically arranged so as to cover the front of the apparatus **20**. Here, front obstacle sensors **36a**, **36b** are disposed high and low on the apparatus **20** with respect to each other and in a substantially parallelogram-shaped pattern with respect to each other. The corner sensors **37**, are in a relationship where their signals cross each other. For example, this crossing is typically at an approximately 90 degree orientation. These obstacle sensors **36a**, **36b**, **37** are typically ultrasonic transceivers, but other equivalent sensors are also permissible. These obstacle sensors **36a**, **36b**, **37** are in communication with the control system **1000**, and should an obstacle be detected, will send a signal to the control system **1000** accordingly, that will typically cease motion of the drive system **1040**, as detailed above.

[0118] For example, the obstacle sensors may be units, such as 40 Khz ultrasonic transducers, Part No. 400PT160, from Prowave. These ultrasonic sensors **34**, **35**, **36a**, **36b**, **37** define an array, and function as proximity sensors (of a proximity sensing system), that when coupled with the control system **1000**, can provide a low resolution image of the obstacle path in front of the apparatus **20**.

[0119] Another sensor of the obstacle sensors is a sensor **38**, typically for horizontal object, for example, shelf detection. This sensor **38** typically includes a transmitter portion and a receiver portion, angularly upward (for example an angle of approximately 35 degrees with respect to the horizontal). This sensor **38** is typically a Position Sensing Diode (PSD), formed from infrared transmitting and receiving components, and, for example, may be a Sharp® infra-red sensor unit, Part No. GP 2D1214 from Sharp Electronics, Japan.

[0120] As the aforementioned ultrasonic sensors may not detect all horizontal objects with small vertical portions, this sensor **38** provides the requisite horizontal object detection. It also functions in combination with obstacle sensors **36a**, **36b**, **37** (and the control system **1000**) to create a local map. Should a low obstacle be detected, a signal will be sent to the control system **1000** that will signal the drive system **1040**, ceasing motion of the apparatus **20**, as detailed above.

[0121] Turning to FIGS. **22A** and **22B**, sensors **620** (only one shown) (ranges of each sensor illustrated by beam projections **621**), coupled to the control system **1000**, are for detecting height variances, typically associated with stair detection. These sensors **620** are typically attached on opposite sides of the extending portion **54**, that extends from the chassis **50**. These sensors **620** are typically position sensing diodes (as detailed above). For example, the variance subject to detection would typically occur with stairs, that is about 3 cm from the surface on which the apparatus **20** rides. With this variance detected, the sensors **620** will signal the control

system **1000**, whereby the drive system **1040** will cease motion of the apparatus **20**, as it was too close to stairs or other downward decline in the surface.

[0122] There is also a full bin sensor system **1020** (FIG. 23), formed of a transmitter **232** and receiver **233** positioned proximate to the filtration unit **148** (detailed above). This full bin sensor system **1020** is coupled to the control system **1000**.

[0123] The remote control sensors **40** are typically infrared (infrared or IR) sensors. They are coupled to the control system **1000**, that accepts commands from the remote controller **46**, transmitted in the form of infra-red light. They are positioned frontally and laterally in the apparatus **20** (FIGS. 1 and 13) to receive signals from the remote controller **46** regardless of the position of the apparatus **20**.

[0124] The remote controller **46** is typically an infrared (infrared or IR) remote controller (as detailed above) or the like. This remote controller **46** can signal directly to the control system **1000** (as the remote control sensor **40** is coupled to the control system **1000**) various commands, such as ON/OFF, various travel modes, various cleaning modes and patterns, strengths of cleaning, speed of the apparatus, etc.

[0125] For example, the control system **1000** can be programmed to function in a cleaning mode and pattern, where upon being signaled, typically by the remote controller **46**, the apparatus **20**, will “spot clean.” This involves small precise movements concentrated around a small area for cleaning this small area. This concentrated cleaning may involve high power suction by the apparatus **20** as it travels in small, typically overlapping, circles in a highly repetitious manner around this small area.

[0126] For example, the control system **1000** can be programmed to perform a travel mode, where once signaled, typically by the remote controller **46**, and the signal is received by one of the remote control sensors **40**, the apparatus **20** navigates its way to a point proximate the remote controller **46**, from its present location. This is known as the “call me” function, and typically is a dedicated key on the remote controller **46**, but could also be a code or the like. Navigation and movement to the point proximate the remote controller **46** can be wholly or partially in accordance with the sensors and associated systems and portions of the exemplary navigation program, detailed below (in blocks **1201-1244** of FIG. 24). Navigation back to the point proximate to the remote controller can also be partially or wholly by a beam riding mechanism, where the beam from the remote controller **46** is tracked by the control system **1000** and the apparatus **20** is rotated and maneuvered to the point proximate the remote controller **46**.

[0127] FIG. 23 is a schematic diagram of the control system **1000** of the apparatus **20**. The control system **1000** includes a main processing board **1002**, that includes processing circuitry and other related circuitry, and a processor, such as a microprocessor (MP) **1004**, that for example, serves as the central processing unit (CPU), for this main processing board **1002**. The microprocessor **1004** is preprogrammed as well as having functionalities for receiving programs (typically entered through the remote controller **46** by the user). These programs may be for automatic or manual operation of the apparatus, or combinations thereof. The apparatus **20** can also include storage media (not shown), coupled to the control system **1000** or various components thereof. This storage media stores data, such as scanning patterns for cleaning,

sound samples, mapping functions, travel modes, etc. This microprocessor **1004** can be, for example, a Hitachi H8S2350 processor.

[0128] The navigation system and remote control command processing are through the microprocessor **1004**. Their functions, as well as others are directly integrated into the microprocessor **1004**.

[0129] The control system **1000**, and in particular the main processing board **1002** and accordingly, the microprocessor **1004**, are coupled to various components and systems, as detailed below. All below-listed components and systems include the requisite associated electronics and electronic couplings in order for proper operation with the main processing board **1002** and microprocessor **1004**. This control system **1000** controls power distribution to all systems and components as well as all operations thereof, for example, speeds, on/off, adjustments, positioning, etc. All components mentioned below, controlled by the control system **1000** include the requisite electronics, circuitry, couplings, etc., so as to define systems controlled by the main processing board **1002** and microprocessor **1004** of the control system **1000**.

[0130] The user interface **25** is electronically coupled (with the requisite associated electronics) to the main processing board **1002**, and accordingly, the microprocessor **1004**. This main processing board **1002** (and accordingly the microprocessor **1004**) is also coupled to the door detection sensors **30a**, **30b**, contour sensors **34**, **35**, obstacle sensors, **36a**, **36b**, **37**, Infra-red sensors, e.g., the sensor **38** and remote control sensor **40**, the stair detection sensors **620**, and the full bin sensing system **1020**.

[0131] The main board **1002** and microprocessor **1004** are also coupled to the steering system **1030**, that includes left **1032a** and right **1032b** drive motors and corresponding left **1034a** and right **1034b** odometers, associated with the respective drive wheels **72**. This drive system **1040** also includes the angle sensing system **1042** and odometry system **1044** of the guide wheel **74**. The navigation system also couples to these steering **1030** and drive **1040** systems through the main board **1002**.

[0132] The main board **1002** and microprocessor **1004** also couple to a power system **1070**, that include the batteries **86**, and associated electronics, as well as the charging system **1074**. The main board **1002** and microprocessor **1004** also control power to and thus, speed of the impeller motor **160** and agitator motor **308**. There is also a coupling of the main board **1002**/microprocessor **1004**, with the “normally open” and “normally closed” electrical contacts defining the nozzle obstacle sensor system **1080** (detailed above). Similarly, there is a coupling of the main board **1002**/microprocessor **1004** with the nozzle height adjustment system **560**, including the nozzle height adjustment motor **566** and a nozzle height sensor **582**, as well as the shock detection system **1082**, in particular, the sensors associated therewith (detailed above).

[0133] Additionally, there is a coupling to the leash system **1084**, that controls the leash **28** and associated components, that couples with the other systems, through the main board **1002**/microprocessor **1004**. The main board **1002**/microprocessor **1004** can also couple to additional systems **1090**, that include for example, supplemental proximity sensing systems, supplemental navigation systems, etc.

[0134] FIG. 24A is a flow diagram indicating an example process of navigation and scanning for movement of the apparatus **20** for vacuum cleaning or the like. For example, this process **1200** can be implemented by the microprocessor

1004. It is typically preprogrammed therein, and coupled with the control system **1000** and main board **1002** will be performed by the apparatus **20**.

[0135] Initially the process **1200** begins at a START, block **1201**, typically by activating the apparatus. The control system **1000**, via the microprocessor **1004** selects a footprint (path or scanning pattern) for the movement of the apparatus **20**, at block **1202**. The system always includes a default footprint. Alternately, this footprint can be selected by the user, with the signals corresponding to the desired footprint entered into the control system.

[0136] The control system **1000**, via the microprocessor **1004**, then signals the drive system **1040**. This signal causes operation of the drive system **1040**, where the apparatus **20** scans the immediate area in accordance with the selected footprint, at block **1204**.

[0137] The "footprint" for scanning is the pattern of movement of the apparatus. This pattern is typically triangular, and in particular in isocelises triangles. It can also be rectangular in linear movements. Scanning patterns are typically designed so as to be substantially free of repetition. For example, scanning patterns may be as disclosed in commonly owned U.S. Pat. No. 6,255,793 and PCT Patent Application PCT/IL99/00248 (WO 99/59042), both of these documents incorporated by reference in their entirety herein.

[0138] The area being scanned is then monitored, at block **1206**. Scanning continues until it is detected and signaled to the control system **1000**, that the apparatus can no longer move laterally for scanning, at block **1208**. At block **1208**, the scanning is ended, or the "end of sweep" has been determined.

[0139] At this time, it is then determined, if an opening, suitable in size for the apparatus **20** to enter was detected during scanning (typically by contour sensors **34**, **35**, as shown in FIGS. **1** and **13**), at block **1210**. If an opening of suitable size was not detected during the scan, it is then determined if the apparatus **20** has scanned for a predetermined time, area and/or distance, or combination thereof, at block **1220**. This is in accordance with predetermined policies, typically preprogrammed into the microprocessor **1004**.

[0140] If the scanning did not satisfy the predetermined condition, the scan direction is changed, at block **1222**. The process then returns to block **1202**. Changing of the scanning direction, for example, can involve a turning movement of approximately 45 degrees by the apparatus **20**, with scanning typically employing the same footprint, as was determined at block **1202**. Other turning angles are also permissible, and can be programmed or entered into the control system **1000**, for example, through the remote controller **46**.

[0141] Returning to block **1210**, if an opening was found, a contour movement to the opening is signaled at block **1232**. This contour movement involves the apparatus **20** moving along the sides or periphery (typically defined by the walls of the room or area), or proximate thereto (collectively, the "contour"), of the scanned area to look for the opening, as detected by the contour sensors **34**, **35** (detailed above). Initially, if necessary, prior to the contour movement (based on the position of the apparatus **20** upon reaching the end of sweep), the apparatus **20** moves to a point along or proximate the sides or periphery from where the contour movement (to the opening) will begin. Once the opening is reached, the apparatus **20** is signaled (from the control system **1000**) to enter and move through the opening, at block **1234**, by sensing the contour (by contour sensors **34**, **35**) and following it to

the next area to be cleaned (scanned). It is then determined if the opening is blocked, at block **1236**. If the opening is not blocked, the process returns to block **1204**.

[0142] If the opening is blocked, the apparatus **20** is driven to return to the beginning of the opening at block **1238**, where the scanning direction is changed, as the process returns to block **1222**. With the scanning direction changed, the process returns to block **1202**.

[0143] Returning to block **1220**, if scanning satisfies the predetermined parameters, a contour movement is signaled, at block **1242**. This contour movement involves the apparatus **20** moving along the sides, periphery or proximate thereto, of the scanned area (typically defined by the walls of the room or area) to look for an opening, suitable for passage of the apparatus therethrough, at block **1244**.

[0144] If an opening is found, the apparatus **20** is signaled (from the control system **1000**) to enter and move through the opening, at block **1234**. The process continues from this point (block **1234**) as detailed above.

[0145] If an opening was not found at block **1244**, typically in a predetermined time period or scanned distance traveled (as for example, preprogrammed into the control system **1000**), the process moves to block **1222**, where the scan direction is changed, as detailed above. The process then returns to block **1202**, as detailed above.

[0146] Alternately, the contour movements in blocks **1232** and **1242** can be replaced with point to point navigation, as detailed above. The determination as to whether to make a contour movement or point to point navigation can be programmed into the microprocessor **1004**.

[0147] The above process **1200** repeats for as long as necessary, typically until a time out, power outage or deactivation (turned OFF) by the user.

[0148] FIG. **24B** is a flow diagram indicating another example process of navigation and scanning for movement of the apparatus **20** for vacuum cleaning or the like. For example, this process **1250** can be implemented by the microprocessor **1004**. It is typically preprogrammed therein, and coupled with the control system **1000** and main board **1002** will be performed by the apparatus **20**.

[0149] Here, blocks **1201'**, **1202'**, **1204'**, **1206'** and **1208'** are similar to corresponding blocks **1201**, **1202**, **1204**, **1206** and **1208**, that have been described above, those descriptions applicable here.

[0150] Once block **1208'** is complete, as lateral advancement for the apparatus **20** is no longer possible, here, the apparatus **20** having reached the end of sweep, the process moves to block **1252**. In block **1252**, there is performed a contour movement in accordance with the contour movements detailed above. Additionally, if necessary, prior to the contour movement (based on the position of the apparatus **20** upon reaching the end of sweep), the apparatus **20** moves to a point along or proximate the sides or periphery from where the contour movement will begin.

[0151] This contour movement can be for a predetermined or preset distance. In this case, once the apparatus **20** has moved the predetermined distance of the contour movement, the process returns to block **1201'**, whereby scanning of an area or portion thereof begins again. The process repeats for as long as necessary, typically until a time out, power outage or deactivation (turned OFF) by the user.

[0152] Alternately, this contour movement of block **1252**, in particular its length or distance to be traveled "D", can be determined "on the fly" or dynamically, based on an estimate

of the circumference or perimeter of the room, area, or portion thereof, to be or being scanned, in accordance with following formula:

$$D=[K_1 \cdot d] / \sum L_i / \max \{L_i\} + [K_2 \cdot \max \{L_i\}]$$

[0153] where,

[0154] L_i is the series L_1 to L_n , and L_1 to L_n are the lengths of each straight line portion of the scanned pattern;

[0155] K_1 and K_2 can be, for example, $K_1=0.8$, $K_2=1$, where L_i are measured in meters; and

[0156] d is the diameter of the apparatus, for example, apparatus 20, expressed in meters.

[0157] In accordance with the processes detailed in FIGS. 24A and 24B, the microprocessor 1004 is also programmed for all of the above detailed cleaning and travel modes and combinations thereof. The microprocessor 1004 operates in conjunction with the main board 1002 and control system 1000, for all of these additional cleaning and travel modes. The microprocessor 1004 is also programmed to determine distances traveled for odometers of the drive 72 and support 74 wheels.

[0158] Turning to FIG. 25, there is detailed another function of the invention. Here the apparatus 20 can be confined to specific areas, by the placement of one or more coded transmitters 1300 at various locations in a room. The transmitter 1300 functions as a "virtual" wall.

[0159] Here, the apparatus is operating in a room 1302. It is desired to keep the apparatus 20 in room portion QQ, and not let it travel to room portion RR (separated by broken line 1304 for emphasis only). Accordingly, coded transmitter 1300 is positioned such that its "IN" beam 1308 is on the QQ side of the room 1302, while the "OUT" beam 1309 is on the RR side of the room 1302. Both of these beams 1308 and 1309 are typically of IR light so as to be detectable by the sensors 40. Once detected, signals are sent from the sensors 40 to the control system 1000, that processes these signals and controls the drive system 1040 to maintain the apparatus 20 in the proper portion of the room, here portion QQ.

[0160] While an autonomous robot or machine that functions as a vacuum cleaner has been shown and described above, this is exemplary only. The above-disclosed subject matter can also be applied with and adapted for other robots or

autonomous machines, that perform various tasks, including cleaning, sweeping, polishing, lawnmowing, gardening, earthmoving, etc.

[0161] The methods and apparatus disclosed herein have been described with exemplary reference to specific hardware and/or software. The methods have been described as exemplary, whereby specific steps and their order can be omitted and/or changed by persons of ordinary skill in the art to reduce embodiments of the present invention to practice without undue experimentation. The methods and apparatus have been described in a manner sufficient to enable persons of ordinary skill in the art to readily adapt other commercially available hardware and software as may be needed to reduce any of the embodiments of the present invention to practice without undue experimentation and using conventional techniques.

[0162] While preferred embodiments of the present invention have been described, so as to enable one of skill in the art to practice the present invention, the preceding description is intended to be exemplary only. Moreover, the embodiments and components thereof are exemplary. This description should not be used to limit the scope of the invention, which should be determined by reference to the following claims.

1. An apparatus for autonomous operation over an area comprising:

a drive system; and

at least one sensor in communication with said drive system, said sensor configured for detecting at least one signal for confining said apparatus to operate in a predetermined location within said area.

2. The apparatus of claim 1, wherein said at least one sensor is configured for detecting two signals for confining said apparatus to operate in said predetermined location within said area.

3. The apparatus of claim 2, wherein said two signals include, a first signal corresponding to inside of said predetermined location within said area and a second signal corresponding to outside of said predetermined location within said area.

4. The apparatus of claim 1, wherein said at least one sensor is an infra red light sensor.

* * * * *