



(19) **United States**

(12) **Patent Application Publication**  
**YAMATO**

(10) **Pub. No.: US 2021/0339521 A1**

(43) **Pub. Date: Nov. 4, 2021**

(54) **SHAPED SHEET MANUFACTURING METHOD**

*B32B 5/26* (2006.01)

*B32B 37/10* (2006.01)

(71) Applicant: **ZUIKO CORPORATION**, Settu-shi, Osaka (JP)

(52) **U.S. Cl.**  
CPC ..... *B32B 38/06* (2013.01); *B32B 5/022* (2013.01); *B32B 2555/02* (2013.01); *B32B 37/10* (2013.01); *B32B 5/266* (2021.05)

(72) Inventor: **Shigeaki YAMATO**, Settu-shi, Osaka (JP)

(21) Appl. No.: **17/281,151**

(57) **ABSTRACT**

(22) PCT Filed: **Oct. 24, 2019**

(86) PCT No.: **PCT/JP2019/041790**

§ 371 (c)(1),  
(2) Date: **Mar. 29, 2021**

(30) **Foreign Application Priority Data**

Oct. 24, 2018 (JP) ..... 2018-200202

**Publication Classification**

(51) **Int. Cl.**  
*B32B 38/06* (2006.01)  
*B32B 5/02* (2006.01)

In a shaped sheet manufacturing method, it is possible to reliably shape a first sheet even if the tension of the first sheet is reduced at the time of manufacturing the shaped sheet. In a first step, a first sheet is conveyed along an outer peripheral surface of a first roll having a plurality of recessed parts. In a second step, a second sheet is overlapped with the first sheet and conveyed together with the first sheet so that the first and second sheets are held between the recessed parts of the first roll and projection parts of a second roll. In a third step, the first and second sheets having passed between the first roll and the second roll are bonded to each other. In the second step, the tension of the first sheet is made smaller than the tension of the second sheet.

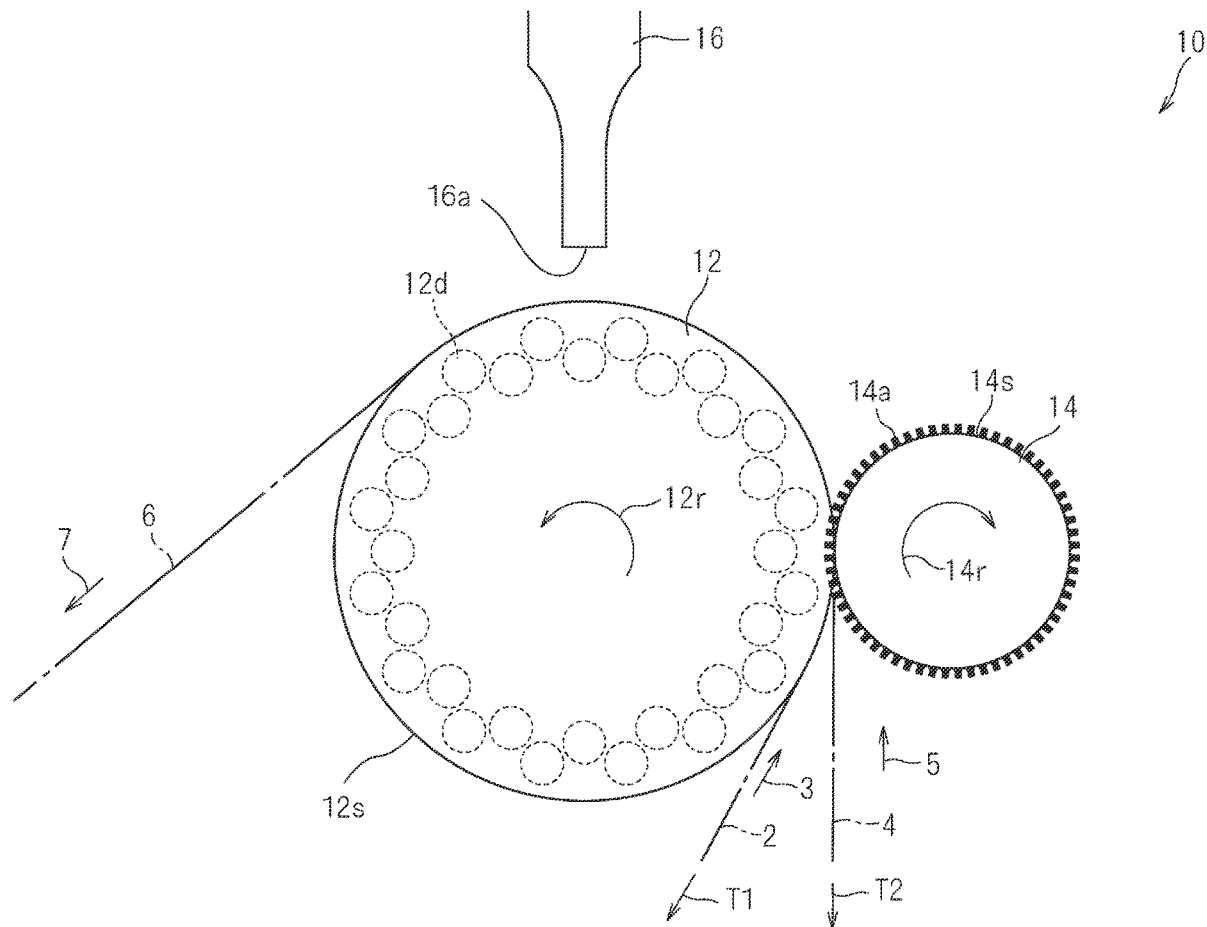

Fig. 1

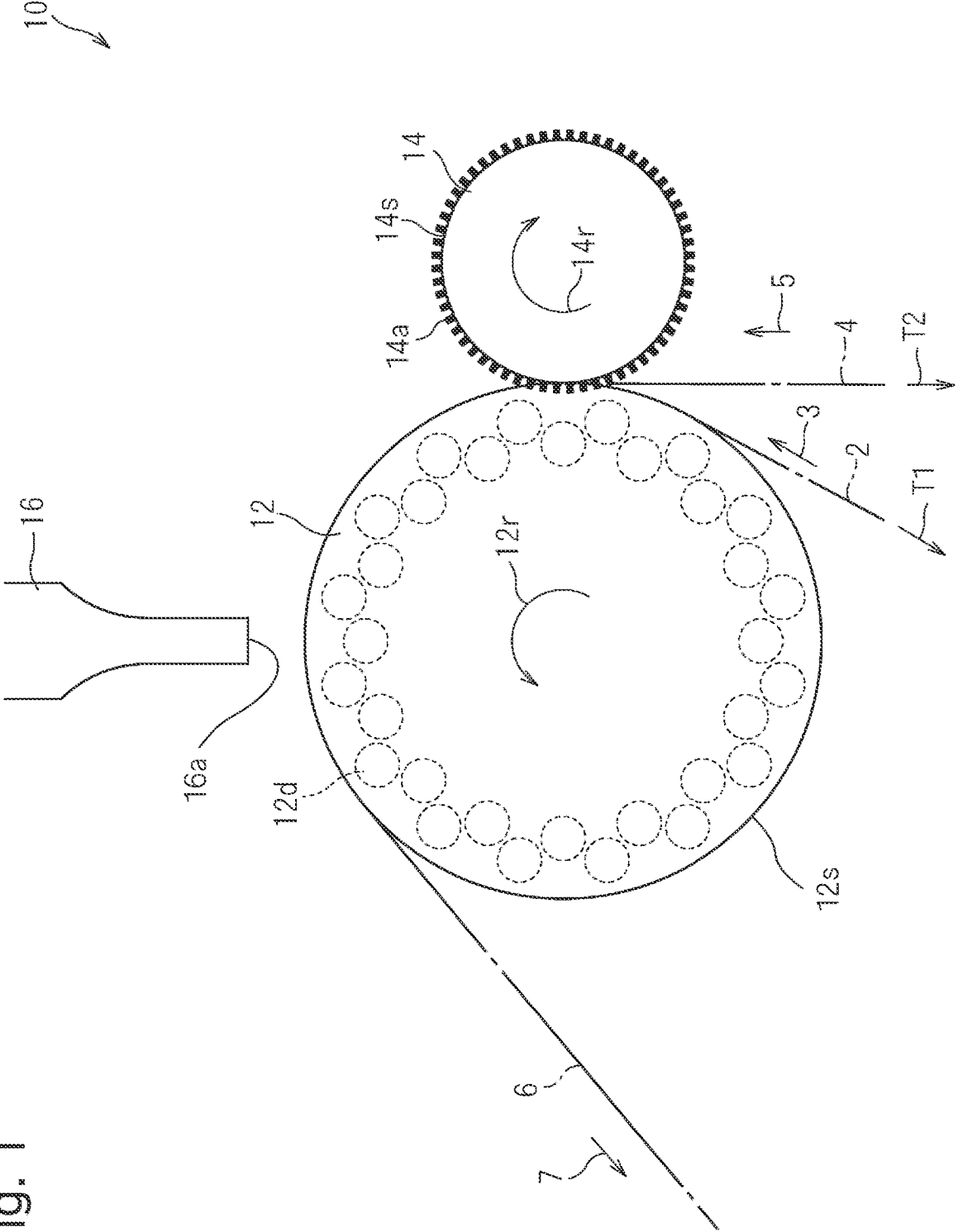

Fig. 2

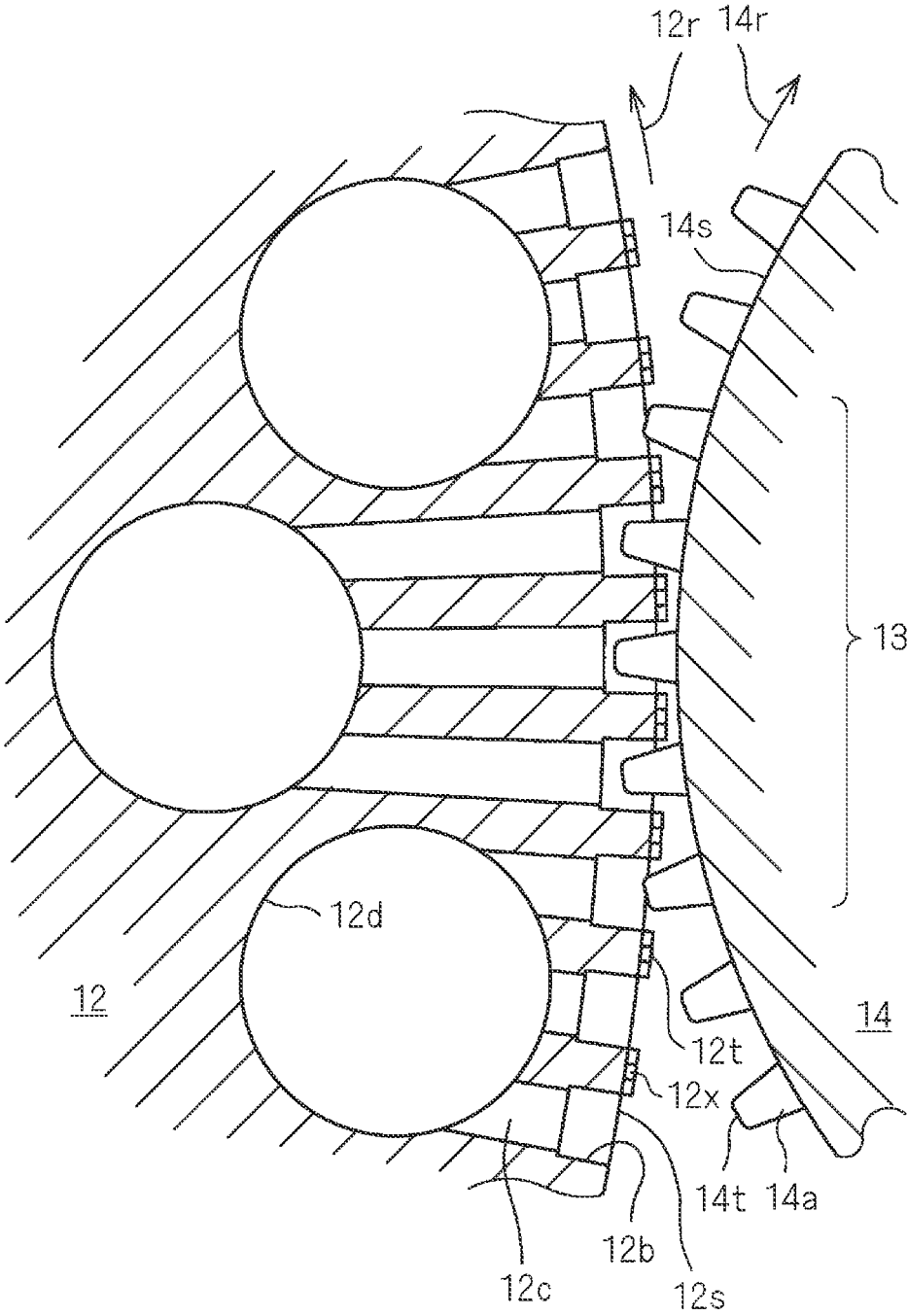



Fig. 4A

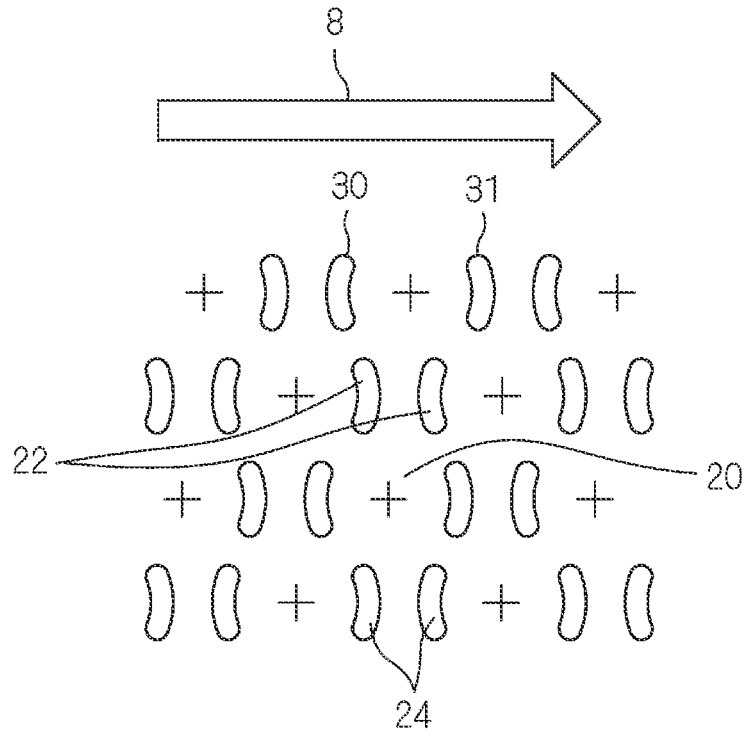

Fig. 4B

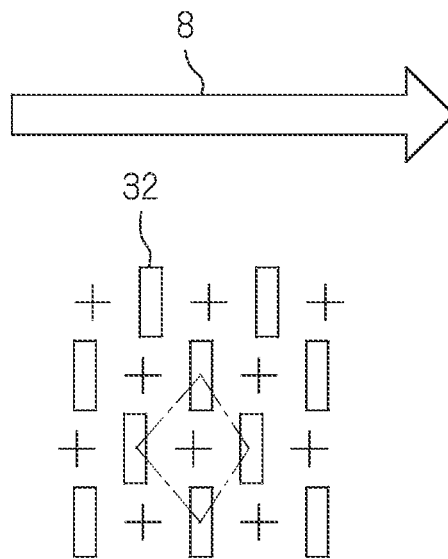

Fig. 5C

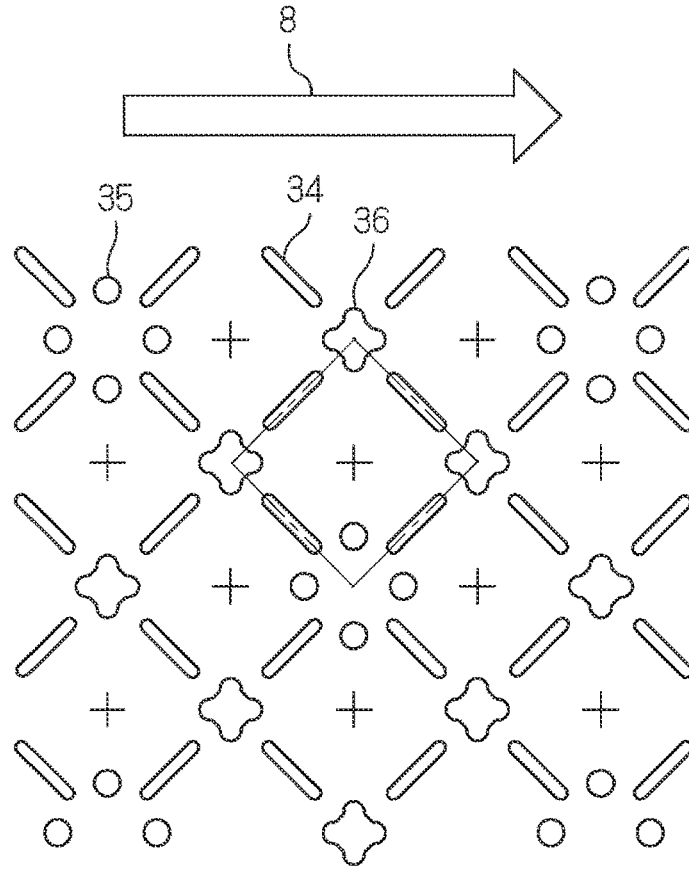

Fig. 5D

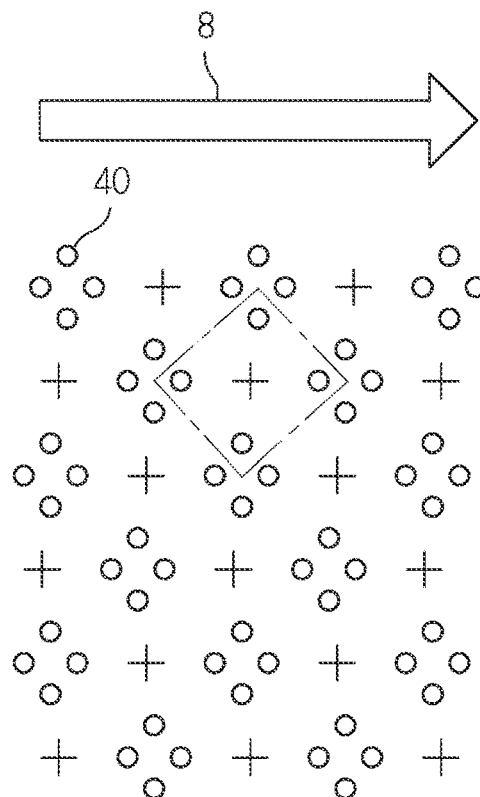

Fig. 6E

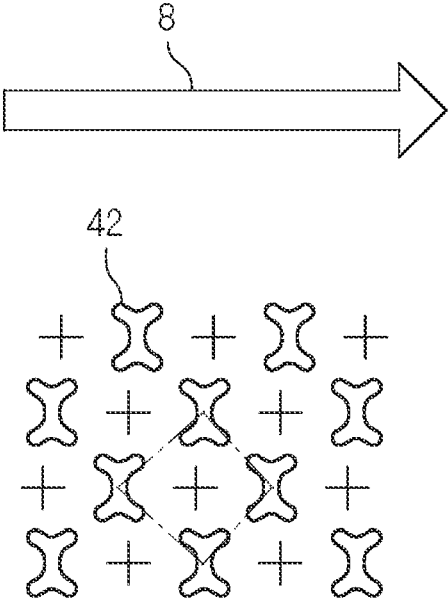

Fig. 6F

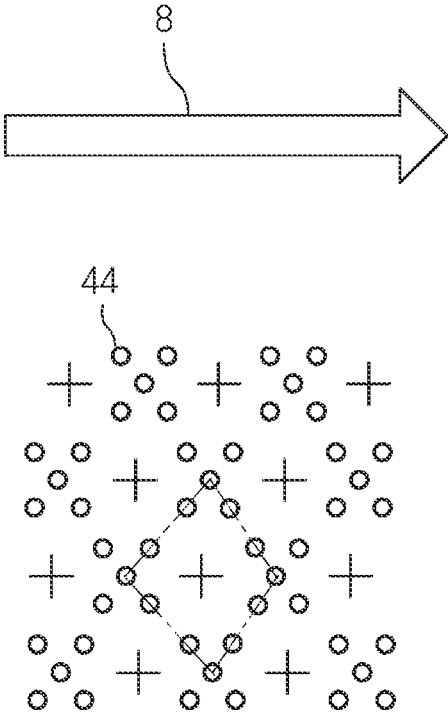

Fig. 7G

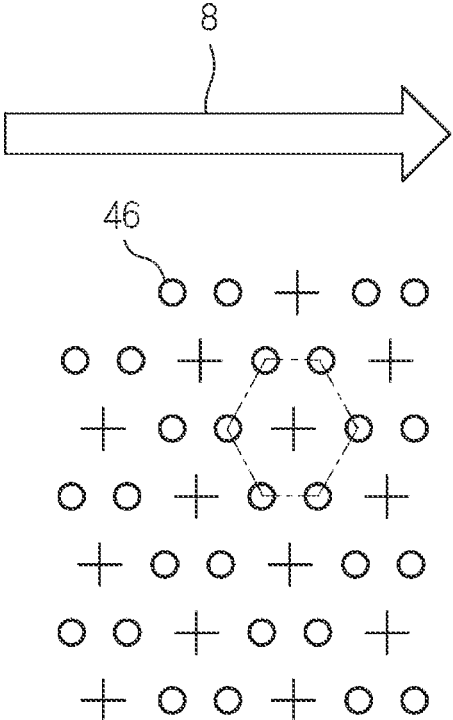

Fig. 7H

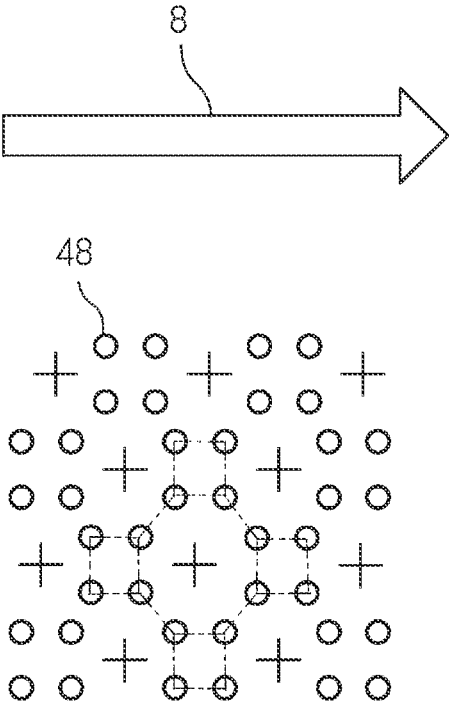



Fig. 8B



Fig. 8A

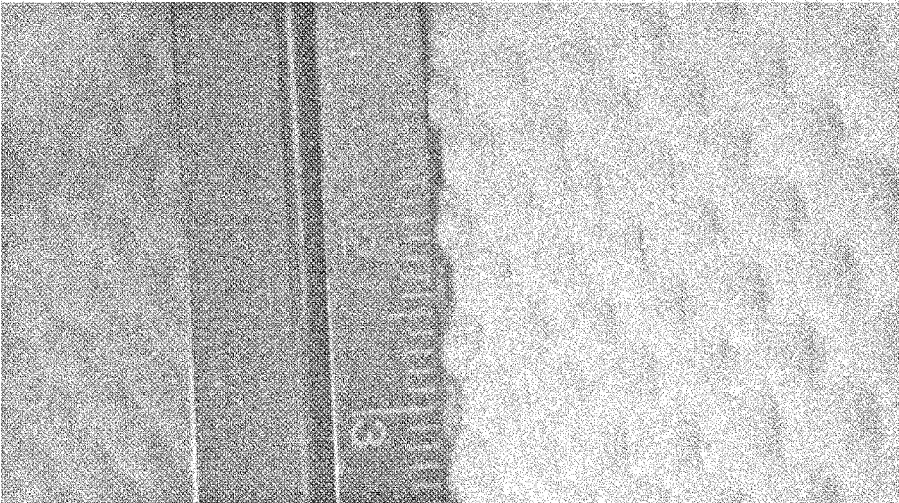

Fig. 9

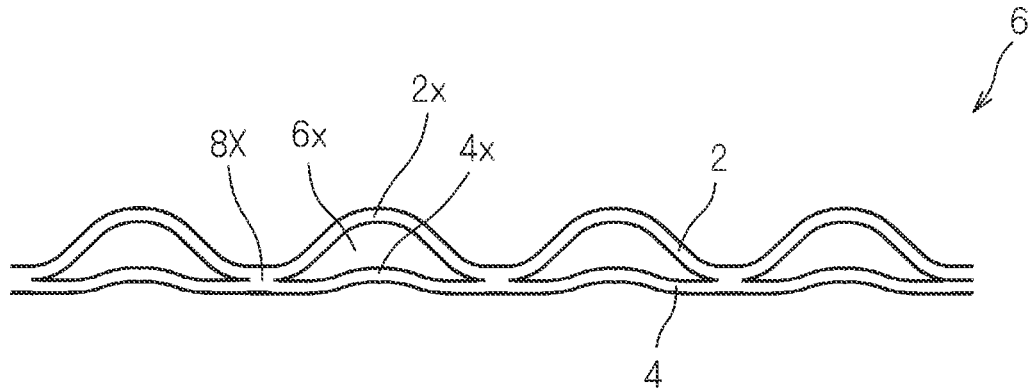

Fig. 10

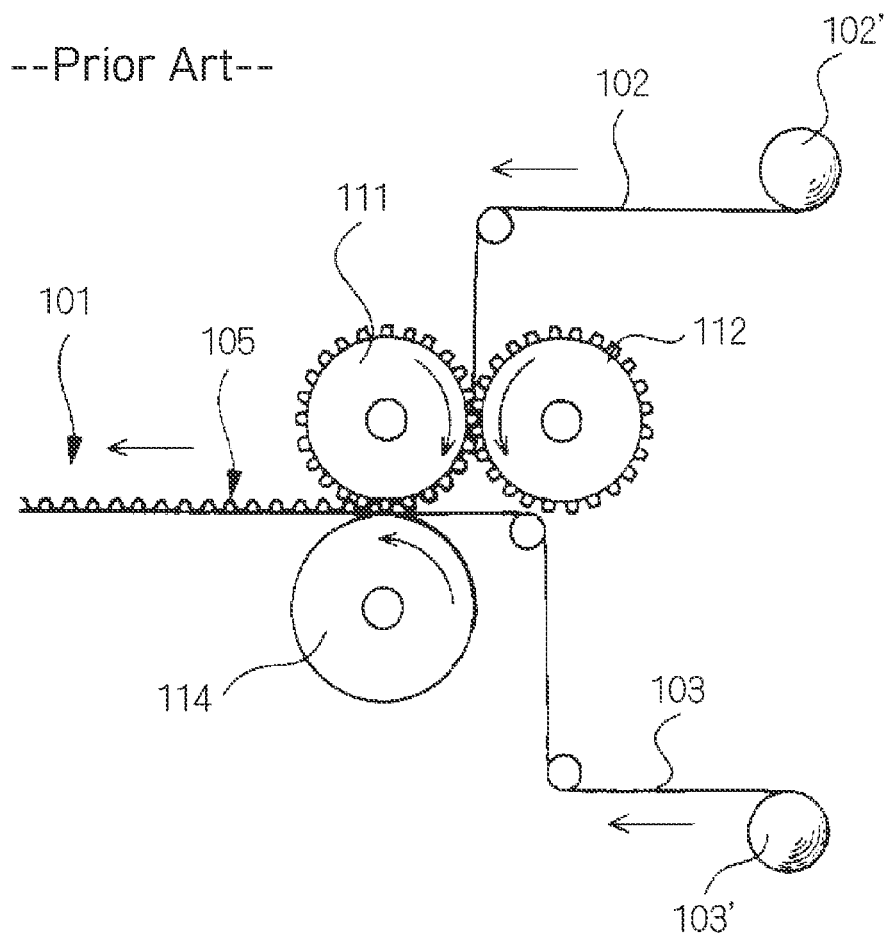
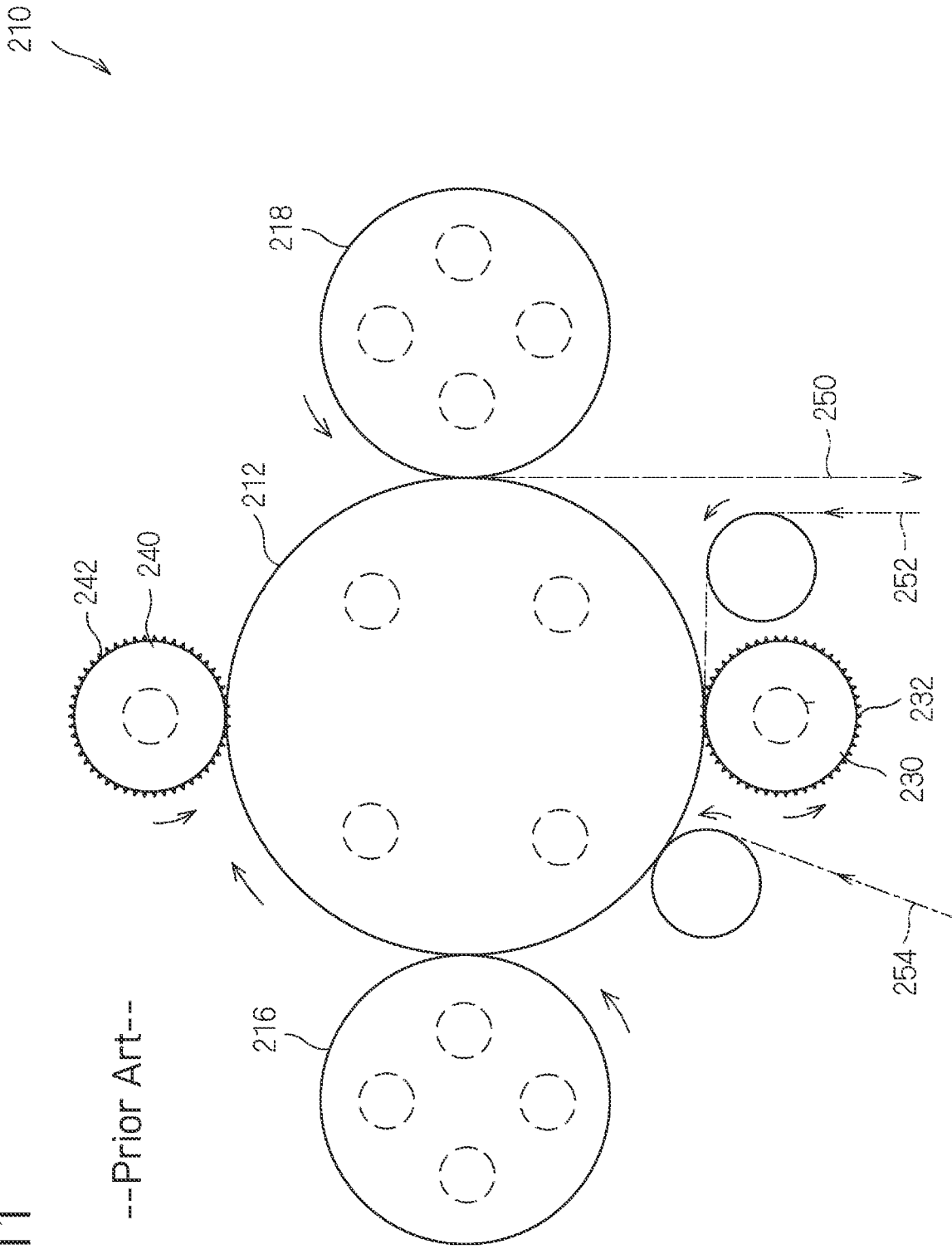

Fig. 11



## SHAPED SHEET MANUFACTURING METHOD

### TECHNICAL FIELD

[0001] The present invention relates to a shaped sheet manufacturing method, and more specifically, relates to a technique of manufacturing a shaped sheet in which protruding parts are formed on at least one of two sheets bonded to each other.

### BACKGROUND ART

[0002] A shaped sheet in which protruding parts are formed on at least one of two sheets bonded to each other is used for, for example, disposable wearable articles such as paper diapers so that the protruding parts are in contact with the skin. The shaped sheet like this is manufactured as follows:

[0003] FIG. 10 is an explanatory view of a method of manufacturing a shaped sheet 101. As shown in FIG. 10, a first sheet 102 sent from a web roll 102' is held between a pair of shaping rolls 111 and 112 where projections and depressions that engage with each other are formed on the outer peripheral surfaces thereof, and the first sheet 102 is shaped. Then, a second sheet 103 sent from a web roll 103' is overlapped with the first sheet 102 biting the projections and depressions on the outer peripheral surface of the one shaping roll 111, and the sheets 102 and 103 are both held between the one shaping roll 111 and an anvil roll 114 and heated, thereby bonding the sheets 102 and 103 to each other. In this way, the shaped sheet 101 where protruding parts 105 are formed on the first sheet 102 is manufactured (for example, see Patent Literature 1).

[0004] FIG. 11 is an explanatory view of a method of manufacturing another shaped sheet 250. As shown in FIG. 11, a shaped sheet manufacturing device 210 is used in which a first and second shaping rolls 230 and 240 having a plurality of projection parts 232 and 242 on the outer peripheral surfaces thereof and a first and second bonding rolls 216 and 218 are disposed around a main roll 212 where a plurality of non-illustrated recessed parts are formed on the outer peripheral surface thereof. First, a first sheet 252 is conveyed along the outer periphery of the main roll 212, and the first sheet 252 is pressed into the recessed parts of the main roll 212 by the projection parts 232 of the first shaping roll 230, thereby shaping the first sheet 252. Then, a second sheet 254 is overlapped with the first sheet 252, held between the main roll 212 and the first bonding roll 216 and heated, thereby bonding the sheets 252 and 254 to each other. Then, the second sheet 254 is pressed into the recessed parts of the main roll 212 by the projection parts 242 of the second shaping roll 240, thereby shaping the second sheet 254. Then, the sheets 252 and 254 are held between the main roll 212 and the second bonding roll 218 and heated, thereby reinforcing the bonding of the sheets 252 and 254 (for example, see Patent Literature 2).

### PRIOR ART LITERATURES

#### Patent Literatures

- [0005] [Patent Literature 1] Japanese Patent No. 4090420  
[0006] [Patent Literature 2] WO 2016/199543

## SUMMARY OF THE INVENTION

### Problem to be Solved by the Invention

[0007] In a case where shaping is performed with the projections and depressions engaging with each other as in Patent Literature 1, the tension of the first sheet 102 is reduced.

[0008] However, when the tension of the first sheet 102 is reduced, there are cases where the parts of the first sheet 102 pressed into the recessed parts of the one shaping roll 111 are caught by the projection parts of the other shaping roll 112 and disengaged from the recessed parts. The disengagement of the first sheet 102 from the recessed parts causes a problem in that it is impossible to bond the first and second sheets 102 and 103 at predetermined places.

[0009] When both the first and second sheets 252 and 254 are shaped as in Patent Literature 2, the second shaping roll 240 that shapes the second sheet 254 is necessary separately from the first shaping roll 230 that shapes the first sheet 252, which makes the device configuration complex.

[0010] In view of such circumstances, a problem to be solved by the present invention is to provide a shaped sheet manufacturing method with which it is possible to reliably shape the first sheet even if the tension of the first sheet is reduced at the time of manufacturing the shaped sheet in which the first and second sheets are bonded to each other and with which it is possible to shape both the first and second sheets without making the device configuration complex.

### Means for Solving the Problem

[0011] To solve the above-mentioned problem, the present invention provides a shaped sheet manufacturing method configured as follows:

[0012] A shaped sheet manufacturing method uses a shaped sheet manufacturing device that is provided with a first roll having a plurality of recessed parts on an outer peripheral surface thereof and a second roll having a plurality of projection parts on an outer peripheral surface thereof and in which the first and second rolls are disposed adjacent to each other and rotate in synchronism and the recessed parts and the projection parts engage with each other with space therebetween. The shaped sheet manufacturing method is provided with: (i) a first step of conveying a first sheet which is a continuous body along the outer peripheral surface of the first roll which is rotating; (ii) a second step of overlapping a second sheet which is a continuous body with the first sheet and conveying the second sheet together with the first sheet so that the first sheet and the second sheet pass between the first roll and the second roll and are held between the recessed parts and the projection parts; and (iii) a third step of bonding to each other the first and second sheets having passed between the first roll and the second roll. In the second step, the tension of the first sheet is made smaller than the tension of the second sheet.

[0013] According to the above-described method, since the parts of the first sheet pressed into the recessed parts are covered with the second sheet and are not in contact with the projection parts, even if the tension of the first sheet is made smaller than the tension of the second sheet, the parts of the first sheet pressed into the recessed parts are never caught by the projection parts and disengaged from the recessed parts.

Consequently, even if the tension of the first sheet is reduced, the first sheet can be reliably shaped.

[0014] The second sheet is shaped in a case where parts or the whole of the parts pressed into the recessed parts by the projection parts remain in the recessed parts when it passes between the first roll and the second roll. In this case, although both the first and second sheets can be simultaneously shaped, it is unnecessary to prepare a roll that shapes the second sheet, separately from the roll that shapes the first sheet. Consequently, it is possible to shape both the first and second sheets without making the configuration of the shaped sheet manufacturing device complex.

[0015] Preferably, in the third step, the first and second sheets are bonded to each other by using a bonder disposed adjacent to the first roll under a condition where parts of the first sheet pressed into the recessed parts by the projection parts remain in the recessed parts.

[0016] In this case, the first sheet can be reliably bonded to the second sheet at predetermined places around the parts pressed into the recessed parts by the projection parts, so that the shape of the shaped sheet is stabilized.

[0017] Preferably, in the second step, the second sheet is overlapped with the first sheet so that the second sheet starts to overlap with the first sheet in an area where the recessed parts and the projection parts engage with each other with space therebetween.

[0018] In this case, since the first and second sheets are not in contact with each other on the upstream side in the conveyance direction of the area where the recessed parts and the projection parts engage with each other with space therebetween, it is easy to adjust the tensions of the first and second sheets independently of each other.

[0019] Preferably, the first and second sheets are non-stretchable non-woven sheets.

[0020] In this case, a shaped sheet suitable for disposable wearable articles can be manufactured.

#### Effects of the Invention

[0021] According to the present invention, even if the tension of the first sheet is reduced at the time of manufacturing the shaped sheet in which the first and second sheets are bonded to each other, it is possible to reliably shape the first and second sheets, and it is possible to shape both the first and second sheets without making the device configuration complex.

#### BRIEF DESCRIPTION OF THE DRAWINGS

[0022] FIG. 1 is a schematic diagram of a shaped sheet manufacturing device (first embodiment).

[0023] FIG. 2 is an enlarged cross-sectional view of a relevant part of the shaped sheet manufacturing device (first embodiment).

[0024] FIGS. 3A to 3D are explanatory views of a shaping process (first embodiment).

[0025] FIGS. 4A and 4B are plan views each showing a bonding pattern (first embodiment).

[0026] FIGS. 5C and 5D are plan views each showing a bonding pattern (first embodiment).

[0027] FIGS. 6E and 6F are plan views each showing a bonding pattern (first embodiment).

[0028] FIGS. 7G and 7H are plan views each showing a bonding pattern (first embodiment).

[0029] FIGS. 8A and 8B show pictures of a shaped sheet (trial product example of the first embodiment).

[0030] FIG. 9 is a cross-sectional view of the shaped sheet (first embodiment).

[0031] FIG. 10 is an explanatory view of the shaped sheet manufacturing method (first conventional example).

[0032] FIG. 11 is an explanatory view of the shaped sheet manufacturing method (second conventional example).

#### MODE FOR CARRYING OUT THE INVENTION

[0033] Hereinafter, an embodiment of the present invention will be described with reference to the drawings.

[0034] <First embodiment> A shaped sheet manufacturing method of the first embodiment will be described with reference to FIGS. 1 to 9.

[0035] FIG. 1 is a schematic diagram of a shaped sheet manufacturing device 10 used for the shaped sheet manufacturing method of the first embodiment. FIG. 2 is an enlarged cross-sectional view of a relevant part of the shaped sheet manufacturing device 10. As shown in FIGS. 1 and 2, the shaped sheet manufacturing device 10 is provided with a first and second rolls 12 and 14 disposed adjacent to each other and a bonder 16 disposed adjacent to the first roll 12.

[0036] The first roll 12 has, on a cylindrical outer peripheral surface 12s, a plurality of recessed parts 12b retracted inward in a radial direction from the outer peripheral surface 12s (see FIG. 2). The second roll 14 has, on a cylindrical outer peripheral surface 14s, a plurality of projection parts 14a projecting outward in a radial direction from the outer peripheral surface 14s. The first and second rolls 12 and 14 rotate in synchronism in directions opposite to each other as indicated by the arrows 12r and 14r, and as shown in FIG. 2, the recessed parts 12b of the first roll 12 and the projection parts 14a of the second roll 14 are configured so as to engage with each other with space therebetween, that is, without being in contact with each other in an engagement area 13. It is preferable that the recessed parts 12b and the projection parts 14a be two-dimensionally arranged at intervals therebetween on the outer peripheral surfaces 12s and 14s of the first and second rolls 12 and 14 so as to simultaneously engage with each other at a plurality of places.

[0037] As shown in FIG. 1, a first sheet 2 which is a continuous body is wound around the outer peripheral surface 12s of the first roll 12, further, a second sheet 4 which is a continuous body is wound on the first sheet 2, and the first and second sheets 2 and 4 are conveyed in the directions indicated by the arrows 3 and 5 with the rotation of the first roll 12. Although detailed later, when the first and second sheets 2 and 4 pass between the first roll 12 and the second roll 14, at least the first sheet 2 is shaped, and then, when passing between the first roll 12 and the bonder 16, the first and second sheets 4 are bonded to each other. A finished shaped sheet 6 is separated from the first roll 12 as indicated by the arrow 7, conveyed to the post-process, and used for, for example, disposable wearable articles such as paper diapers.

[0038] At least the insides of the recessed parts 12b of the first roll 12 may be heated, whereby shaping is more reliably performed. For example, a heater is provided inside the first roll 12 and the periphery of the recessed parts 12b is heated. The heating may be performed on both the first and second rolls 12 and 14.

[0039] As shown in FIG. 2, in the first roll 12, suction flow passages 12c and 12d communicating with the bottoms of

the recessed parts **12b** and seal projections **12x** projecting outward in a radial direction from the outer peripheral surface **12s** are formed. The recessed parts **12b** of the first roll **12** are connected to a negative pressure source through the suction flow passages **12c** and **12d**. Thereby, the first sheet **2** disposed along the outer peripheral surface **12s** of the first roll **12** is sucked and held. The suction flow passages **12c** and **12d** and the seal projections **12x** may be eliminated.

[0040] The projection parts **14a** of the second roll **14** are formed in the shape of, for example, a truncated pyramid where ends **14t** are flat. The shape of the projection parts **14a** of the second roll **14** may be a shape other than the truncated pyramid shape such as a rectangular parallelepiped shape or a cylindrical shape.

[0041] FIG. 1 shows a condition where the bonder **16** as an ultrasonic sealer is retracted from the first roll **12**. When the shaped sheet **6** is manufactured, the parts of the first and second sheets **2** and **4** held between a horn end **16a** of the bonder **16** and the flat surfaces **12t** of the seal projections **12x** of the first roll **12** (see FIG. 2) are ultrasonically bonded. The bonder **16** may be a bonder that performs bonding by other than ultrasonic bonding such as a welder or bonding rolls as in the first and second conventional examples.

[0042] Next, a method of manufacturing the shaped sheet **6** by using the shaped sheet manufacturing device **10** will be described.

[0043] (1) First, the first sheet **2** is conveyed along the outer peripheral surface **12s** of the rotating first roll **12**. This is the first step.

[0044] (2) Then, the first and second sheets **2** and **4** pass between the first roll **12** and the second roll **14**, the second sheet **4** is overlapped with the first sheet **2** so as to be held between the recessed parts **12b** of the first roll **12** and the projection parts **14a** of the second roll **14** and is conveyed together with the first sheet **2**. This is the second step.

[0045] (3) Although detailed later, in the second step, the tension of the first sheet **2** is made smaller than that of the second sheet **4**. For at least the first sheet **2** of the first and second sheets, a shapable sheet is used. The first and second sheets **2** and **4** may be a non-stretchable non-woven fabric or may be air-through non-woven fabric.

[0046] As shown in FIG. 1, by making the second sheet **4** start to overlap with the first sheet **2** in the engagement area **13** where the recessed parts **12b** and the projection parts **14a** engage with each other (see FIG. 2), it is easy to adjust the tensions of the first and second sheets **2** and **4** independently of each other. The second sheet **4** may be made to start to overlap with the first sheet **2** in the engagement area **13** with the second sheet **4** being wound on the second roll **14** on the upstream side of the engagement area **13** in the conveyance direction.

[0047] However, there are cases where the shaped sheet **6** can be manufactured even if the second sheet **4** starts to overlap with the first sheet **2** on the upstream side of the engagement area **13** in the conveyance direction.

[0048] Then, the first and second sheets having passed between the first roll **12** and the second roll **14** are bonded to each other. This is the third process.

[0049] Preferably, in the third step, the first and second sheets are bonded to each other by using the bonder **16** disposed adjacent to the first roll **12** under a condition where the parts of the first sheet **2** pressed into the recessed parts **12b** by the projection parts **14a** remain in the recessed parts **12b**. In this case, the first sheet **2** can be reliably bonded to

the second sheet **4** at predetermined places around the parts pressed into the recessed parts **12b** by the projection parts **14a**, so that the shape of the shaped sheet **6** is stabilized.

[0050] With reference to FIGS. 3A to 3D which are explanatory views conceptually showing the shaping process, description will be further provided.

[0051] As shown in FIG. 3A, the first sheet **2** is wound on the outer peripheral surface **12s** of the first roll **12**, and then, as shown in FIG. 3B, the second sheet **4** is overlapped with the first sheet **2**. In the engagement area **13** where the recessed parts **12b** of the first roll **12** and the projection parts **14a** of the second roll **14** engage with each other (see FIG. 2), parts **2a** and **4a** of the first and second sheets **2** and **4** facing the recessed parts **12b** are pressed into the recessed parts **12b** by the projection parts **14a** engaging with the recessed parts **12b**. Thereby, parts **2b** and **4b** pressed into the recessed parts **12b** are formed on the first and second sheets **2** and **4**.

[0052] At this time, the first and second sheets **2** and **4** deform elastically or plastically. On the downstream side in the conveyance direction of the recessed parts **12b** engaging with the projection parts **14a** (the right side in FIG. 3B), the first and second sheets **2** and **4** have their relative movements limited because they are overlapped with each other; on the other hand, on the upstream side in the conveyance direction of the recessed parts **12b** engaging with the projection parts **14a** (the left side in FIG. 3B), the first and second sheets **2** and **4** hardly or never restrain each other. For this reason, the upstream sides in the conveyance direction of the recessed parts **12b** engaging with the projection parts **14a**, of the first and second sheets **2** and **4** are drawn out and pressed into the recessed parts **12b**.

[0053] When the first roll **12** rotates to convey the first and second sheets **2** and **4**, the projection parts **14a** engaging with the recessed parts **12b** gradually exit from the recessed parts **12b**, so that the first and second sheets **2** and **4** are gradually overlapped with each other around the recessed parts **12b**.

[0054] As shown in FIGS. 1 and 3B, when the tension of the first sheet **2** immediately before being held between the recessed parts **12b** and the projection parts **14a** is  $T_1$  and the tension of the second sheet **4** immediately before being held between the recessed parts **12b** and the projection parts **14a** is  $T_2$ , the tensions of the first and second sheets **2** and **4** are set so that  $T_1 < T_2$ . For example, a known tension adjusting mechanism is provided on the upstream side of the engagement area **13** in the conveyance direction to adjust the tensions  $T_1$  and  $T_2$  so that  $T_1 < T_2$ .

[0055] When  $T_1 = 0$ , the parts **2b** of the first sheet **2** pressed into the recessed parts **12b** remain in the recessed parts **12b** when passing the engagement area **13**. Even when  $T_1 \neq 0$ , if  $T_1$  is small, for example, if  $T_1 \leq 0.05$  N/mm, it is impossible to draw back the first sheet **2** to the upstream side in the conveyance direction against the friction between the first sheet **2** and the first roll **12**. In this case, the parts **2b** of the first sheet **2** pressed into the recessed parts **12b** also remain in the recessed parts **12b**.

[0056] The tension  $T_2$  of the second sheet **4** is made not more than the rupture strength of the first sheet **2**, for example, 0.1 to 2 N/mm. If the tension  $T_2$  of the second sheet **4** overcomes the frictional force between the first and second sheets **2** and **4**, when the projection parts **14a** engaging with the recessed parts **12b** exit from the recessed

parts **12b** thereafter, the parts **4b** of the second sheet **4** pressed into the recessed parts **12b** gradually exit from the recessed parts **12b**.

[0057] If parts **4x** of the second sheet **4** on the downstream side of the projection parts **14a** in the conveyance direction are pulled to be plastically deformed and stretched when pressed into the recessed parts **12b** by the projection parts **14a**, the plastically deformed parts remain stretched even after the projection parts **14a** exit from the recessed parts **12b**. Moreover, when the second sheet **4** is simultaneously pressed into a plurality of recessed parts **12b** adjoining in a direction orthogonal to or intersecting the conveyance direction and the parts between the recessed parts **12b** adjoining in the direction orthogonal to or intersecting the conveyance direction are pulled to be plastically deformed and stretched, the plastically deformed parts remain stretched even after the projection parts **14a** exit from the recessed parts **12b**.

[0058] If the second sheet **4** is plastically deformed and stretched as described above, when passing the engagement area **13**, parts **4c** or the whole of the parts **4b** of the second sheet **4** pressed into the recessed parts **12b** (see FIG. 3B) remain in the recessed parts **12b** even after the projection parts **14a** exit from the recessed parts **12b**, so that a slack occurs at the parts **4a** covering the recessed parts **12b**. The larger the tension T2 is, the more readily the second sheet **4** is plastically deformed when pressed into the recessed parts **12b**. For this reason, the larger the tension T2 is, the larger the slack at the parts **4a** of the second sheet **4** covering the recessed parts **12b**. Even if the second sheet **4** is a non-stretchable non-woven sheet, for example, when it is heated by the first roll **12**, the plastic deformation is promoted, so that a slack is formed at the parts **4a** covering the recessed parts **12b**.

[0059] In a case where the parts **4b** of the second sheet **4** pressed into the recessed parts **12b** (see FIG. 3B) are completely out of the recessed parts **12b** as shown in FIG. 3C when the first and second sheets **2** and **4** pass the engagement area **13**, only the first sheet **2** is shaped. In a case where the parts **4c** or the whole of the parts **4b** of the second sheet **4** pressed into the recessed parts **12b** remain in the recessed parts **12b** as shown in FIG. 3D when the first and second sheets **2** and **4** pass the engagement area **13**, both the first and second sheets **2** and **4** are shaped. In a case where the second sheet **4** is plastically deformed when passing the engagement area **13**, both the first and second sheets **2** and **4** are shaped.

[0060] Since the parts **2b** of the first sheet **2** pressed into the recessed parts **12b** are covered with the second sheet **4** and are not in contact with the projection parts **14a**, even if the tension T1 of the first sheet **2** is made smaller than the tension T2 of the second sheet **4**, the parts **2b** of the first sheet **2** pressed into the recessed parts **12b** are never caught by the projection parts **14a** and disengaged from the recessed parts **12b**. Consequently, even if the tension T1 of the first sheet **2** is reduced, the first sheet **2** can be reliably shaped.

[0061] The second sheet **4** is shaped in a case where parts or the whole of the parts **4b** pressed into the recessed parts **12b** by the projection parts **14a** remain in the recessed parts **12b** when it passes between the first roll **12** and the second roll **14**. In this case, although both the first and second sheets **2** and **4** can be simultaneously shaped, it is unnecessary to prepare a roll that shapes the second sheet **4**, separately from the roll that shapes the first sheet **2**. Consequently, it is

possible to shape both the first and second sheets **2** and **4** without making the configuration of the shaped sheet manufacturing device **10** complex.

[0062] On the shaped sheet **6**, protruding parts are formed on the first sheet **2** correspondingly to the parts **2c** of the first sheet **2** pressed into the recessed parts **12b** by the projection parts **14a** and remain in the recessed parts **12b** (see FIG. 3C).

[0063] FIG. 9 is a cross-sectional view of the shaped sheet **6** manufactured by the above-described method. FIG. 9 conceptually shows an example of the cross section of the shaped sheet **6** under natural conditions where no tension is applied to the first and second sheets **2** and **4**. As shown in FIG. 9, protruding parts **2x** and **4x** protruding to the same side are formed on the first and second sheets **2** and **4**. The protruding parts **2x** of the first sheet **2** are larger than the protruding parts **4x** of the second sheet **4**, and spaces **6x** are formed between the first and second sheets **2** and **4**. The first and second sheets **2** and **4** are bonded to each other at bonded parts **8x**.

[0064] Next, the bonding pattern of the shaped sheet **6** will be described with reference to FIGS. 4A to 7H. In FIGS. 4A to 7H, the arrow **8** indicates the direction in which the first and second sheets **2** and **4** are conveyed (hereinafter, referred to as "flow direction"). The + sign indicates the neighborhood of the center of each protruding part of the first sheet **2** formed on the first sheet **2**. The bonded parts where the first and second sheets are bonded to each other are formed correspondingly to the flat surfaces **12f** of the seal projections **12x** of the first roll **12** (see FIG. 2).

[0065] In the bonding pattern shown in FIG. 4A, a plurality of crescent-shaped bonded parts **30** and **31** curved in directions opposite to each other are alternately arranged at intervals in the flow direction. The protruding parts are formed between the bonded parts **30** and **31** the concave sides of which face each other. A plurality of rows in which the bonded parts **30** and **31** are arranged in the flow direction are shifted in pitch so that areas **20** where the concave sides of the bonded parts **30** and **31** face each other are held between the bonded parts **30** and **31** of pairs **22** and **24** the convex sides of which face each other in the rows on both sides.

[0066] In the bonding pattern shown in FIG. 4B, rectangular bonded parts **32** are arranged at the vertices of a plurality of virtual rectangles one diagonal lines of which are parallel to the flow direction and that are arranged with no space thereamong. The protruding parts are formed inside the virtual rectangles. The chain line shows one of the virtual rectangles.

[0067] In the bonding pattern shown in FIG. 5C, linear bonded parts **34** are arranged on the sides of a plurality of virtual rectangles one diagonal lines of which are parallel to the flow direction and that are arranged with no space thereamong, substantially cross-shaped bonded parts **36** are arranged at three vertices of each virtual rectangle, respectively, and four circular bonded parts **35** are arranged so as to surround the remaining one vertex of each virtual rectangle. The protruding parts are formed inside the virtual rectangles. The chain line shows one of the virtual rectangles.

[0068] In the bonding pattern shown in FIG. 5D, four circular bonded parts **40** are arranged so as to surround the vertices of a plurality of virtual rectangles one diagonal lines of which are parallel to the flow direction and that are

arranged with no space thereamong. The protruding parts are formed inside the virtual rectangles. The chain line shows one of the virtual rectangles.

[0069] In the bonding pattern shown in FIG. 6E, bone-shaped bonded parts 42 are arranged at the vertices of a plurality of virtual rectangles one diagonal lines of which are parallel to the flow direction and that are arranged with no space thereamong. The protruding parts are formed inside the virtual rectangles. The chain line shows one of the virtual rectangles.

[0070] In the bonding pattern shown in FIG. 6F, five circular bonded parts 44 are arranged at and around the vertices of a plurality of virtual rectangles one diagonal lines of which are parallel to the flow direction and that are arranged with no space therebetween. The protruding parts are formed inside the virtual rectangles. The bonded parts 44 surrounding the protruding parts are arranged in a diamond shape. The chain line shows one of the virtual rectangles.

[0071] In the bonding pattern shown in FIG. 7G, circular bonded parts 46 are arranged at the vertices of a plurality of virtual hexagons a pair of facing sides of which are parallel to the flow direction and that are arranged with no space thereamong. The protruding parts are formed inside the virtual hexagons. The chain line shows one of the virtual hexagons.

[0072] In the bonding pattern shown in FIG. 7H, circular bonded parts 48 are arranged at the vertices of a plurality of virtual octagons two pairs of facing sides of which are parallel or vertical to the flow direction. The virtual octagons are arranged with no space thereamong together with a plurality of virtual rectangles facing sides of which are parallel or vertical to the flow direction. The protruding parts are formed inside the virtual octagons. The chain lines show one of the virtual octagons and four virtual rectangles adjoining it.

[0073] FIGS. 8A and 8B show pictures of the shaped sheet 6 manufactured by way of trial by using the shaped sheet manufacturing device 10. For the first and second sheets 2 and 4, a non-woven sheet is used that stretches in a direction vertical to the flow direction, and the first and second sheets 2 and 4 are bonded in the bonding pattern shown in FIG. 4B.

[0074] FIG. 8A shows a picture of the side of the first sheet 2. From FIG. 8A, it is apparent that protruding parts are formed on the first sheet 2. FIG. 8B shows a picture on the side of the second sheet 4. From FIG. 8B, it is apparent that the second sheet 4 is slightly recessed.

[0075] <Summary> As described above, it is possible to reliably shape the first sheet 2 even if the tension T1 of the first sheet 2 is reduced at the time of manufacturing the shaped sheet 6 in which the first and second sheets 2 and 4 are bonded to each other, and it is possible to shape both the first and second sheets 2 and 4 without making the device configuration complex.

[0076] The present invention is not limited to the above-described embodiment and may be variously modified when carried out.

EXPLANATION OF REFERENCE NUMERALS

- [0077] 2 First sheet
- [0078] 2b Pressed-in part
- [0079] 4 Second sheet

- [0080] 4b Pressed-in part
- [0081] 6 Shaped sheet
- [0082] 10 Shaped sheet manufacturing device
- [0083] 12 First roll
- [0084] 12b Recessed part
- [0085] 12s Outer peripheral surface
- [0086] 13 Engagement area
- [0087] 14 Second roll
- [0088] 14a Projection part
- [0089] 14s Outer peripheral surface
- [0090] 16 Bonder

1. A shaped sheet manufacturing method using a shaped sheet manufacturing device comprising: a first roll having a plurality of recessed parts on an outer peripheral surface thereof; and a second roll having a plurality of projection parts on an outer peripheral surface thereof, and in which the first and second rolls are disposed adjacent to each other and rotate in synchronism and the recessed parts and the projection parts engage with each other with space therebetween, the method comprising:

- a first step of conveying a first sheet which is a continuous body along the outer peripheral surface of the first roll which is rotating;
  - a second step of overlapping a second sheet which is a continuous body with the first sheet and conveying the second sheet together with the first sheet so that the first sheet and the second sheet pass between the first roll and the second roll and are held between the recessed parts and the projection parts; and
  - a third step of bonding to each other the first and second sheets having passed between the first roll and the second roll,
- wherein in the second step, a tension of the first sheet is made smaller than a tension of the second sheet.

2. The shaped sheet manufacturing method according to claim 1, wherein in the third step, the first and second sheets are bonded to each other by using a bonder disposed adjacent to the first roll under a condition where parts of the first sheet pressed into the recessed parts by the projection parts remain in the recessed parts.

3. The shaped sheet manufacturing method according to claim 1, wherein in the second step, the second sheet is overlapped with the first sheet so that the second sheet starts to overlap with the first sheet in an area where the recessed parts and the projection parts engage with each other with space therebetween.

4. The shaped sheet manufacturing method according to claim 1, wherein the first and second sheets are non-stretchable non-woven sheets.

5. The shaped sheet manufacturing method according to claim 2, wherein in the second step, the second sheet is overlapped with the first sheet so that the second sheet starts to overlap with the first sheet in an area where the recessed parts and the projection parts engage with each other with space therebetween.

6. The shaped sheet manufacturing method according to claim 2, wherein the first and second sheets are non-stretchable non-woven sheets.

7. The shaped sheet manufacturing method according to claim 3, wherein the first and second sheets are non-stretchable non-woven sheets.

\* \* \* \* \*