



US 20210275235A1

(19) **United States**

(12) **Patent Application Publication**
Moskowitz et al.

(10) **Pub. No.: US 2021/0275235 A1**

(43) **Pub. Date: Sep. 9, 2021**

(54) **SPINAL BONE FUSION SYSTEM**

(71) Applicant: **Moskowitz Family LLC**, Rockville, MD (US)

(72) Inventors: **Nathan C. Moskowitz**, Rockville, MD (US); **Mosheh T. Moskowitz**, Rockville, MD (US); **Ahmnnon D. Moskowitz**, Rockville, MD (US); **Pablo A. Valdivia Y. Alvarado**, Cambridge, MA (US)

(21) Appl. No.: **16/952,241**

(22) Filed: **Nov. 19, 2020**

tinuation of application No. 13/418,323, filed on Mar. 12, 2012, now Pat. No. 9,814,601, which is a continuation-in-part of application No. 13/103,994, filed on May 9, 2011, now Pat. No. 9,603,713, which is a division of application No. 12/054,335, filed on Mar. 24, 2008, now Pat. No. 7,972,363, which is a continuation-in-part of application No. 11/842,855, filed on Aug. 21, 2007, now Pat. No. 7,942,903, which is a continuation-in-part of application No. 11/536,815, filed on Sep. 29, 2006, now Pat. No. 7,846,188, which is a continuation-in-part of application No. 11/208,644, filed on Aug. 23, 2005, now Pat. No. 7,704,279, said application No. 13/418,323 is a continuation-in-part of application No. 13/084,543, filed on Apr. 11,

(Continued)

Related U.S. Application Data

(60) Continuation of application No. 16/160,824, filed on Oct. 15, 2018, now Pat. No. 10,842,542, which is a continuation of application No. 15/397,198, filed on Jan. 3, 2017, now Pat. No. 10,098,678, which is a continuation of application No. 13/418,335, filed on Mar. 12, 2012, now Pat. No. 9,532,821, which is a continuation-in-part of application No. 13/103,994, filed on May 9, 2011, now Pat. No. 9,603,713, which is a division of application No. 12/054,335, filed on Mar. 24, 2008, now Pat. No. 7,972,363, which is a continuation-in-part of application No. 11/842,855, filed on Aug. 21, 2007, now Pat. No. 7,942,903, which is a continuation-in-part of application No. 11/536,815, filed on Sep. 29, 2006, now Pat. No. 7,846,188, which is a continuation-in-part of application No. 11/208,644, filed on Aug. 23, 2005, now Pat. No. 7,704,279, said application No. 13/418,335 is a continuation-in-part of application No. 13/084,543, filed on Apr. 11, 2011, now Pat. No. 8,353,913, which is a division of application No. 11/842,855, filed on Aug. 21, 2007, now Pat. No. 7,942,903, which is a continuation-in-part of application No. 13/401,829, filed on Feb. 21, 2012, now Pat. No. 9,744,052, said application No. 15/397,198 is a con-

Publication Classification

(51) **Int. Cl.**
A61B 17/80 (2006.01)
A61B 17/70 (2006.01)
A61F 2/44 (2006.01)
(52) **U.S. Cl.**
CPC *A61B 17/8042* (2013.01); *A61B 17/7064* (2013.01); *A61B 17/86* (2013.01); *A61F 2/447* (2013.01); *A61B 17/809* (2013.01)

(57) **ABSTRACT**

A bi-directional fixating transvertebral (BDFT) screw/cage apparatus is provided. The BDFT apparatus includes an intervertebral cage including a plurality of internal angled screw guides, a plurality of screw members, and a cage indentation adjacent to the screw guides that independently or supplemented by other screw locking mechanisms prevents the screw members from pulling out of the internal angled screw guides. The internal angled screw guides orient a first screw member superiorly and a second screw member inferiorly. The intervertebral cage is adapted for posterior lumbar intervertebral placement, anterior lumbar intervertebral placement, antero-lateral thoracic intervertebral placement, or anterior cervical intervertebral placement.

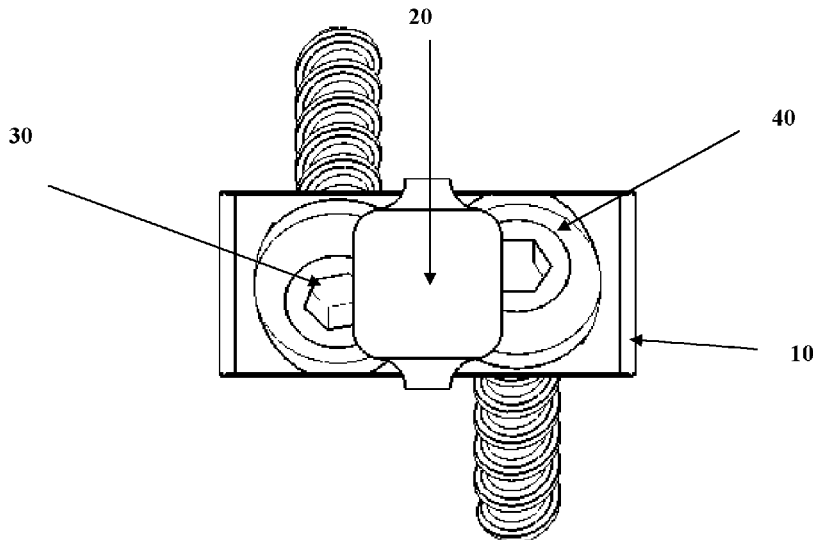

Related U.S. Application Data

2011, now Pat. No. 8,353,913, which is a division of application No. 11/842,855, filed on Aug. 21, 2007, now Pat. No. 7,942,903, which is a continuation-in-part of application No. 13/401,829, filed on Feb. 21, 2012, now Pat. No. 9,744,052, said application No. 15/397,198 is a continuation-in-part of application No. 13/401,829, filed on Feb. 21, 2012, now Pat. No. 9,744,052, which is a continuation-in-part of application No. 13/103,994, filed on May 9, 2011, now Pat. No. 9,603,713, which is a division of application No. 12/054,335, filed on Mar. 24, 2008, now Pat. No. 7,972,363, which is a continuation-in-part of application No. 11/842,855, filed on Aug. 21, 2007, now Pat. No. 7,942,903, which is a continuation-in-part of application No. 11/536,815, filed on Sep. 29, 2006, now Pat. No. 7,846,188, which is a continuation-in-part of application No. 11/208,644, filed on Aug. 23, 2005, now Pat. No. 7,704,279, said application No.

13/401,829 is a continuation-in-part of application No. 13/084,543, filed on Apr. 11, 2011, now Pat. No. 8,353,913, which is a division of application No. 11/842,855, filed on Aug. 21, 2007, now Pat. No. 7,942,903.

- (60) Provisional application No. 61/451,582, filed on Mar. 10, 2011, provisional application No. 61/451,579, filed on Mar. 10, 2011, provisional application No. 61/445,034, filed on Feb. 21, 2011, provisional application No. 60/670,231, filed on Apr. 12, 2005, provisional application No. 61/445,034, filed on Feb. 21, 2011, provisional application No. 61/451,582, filed on Mar. 10, 2011, provisional application No. 61/451,579, filed on Mar. 10, 2011, provisional application No. 61/445,034, filed on Feb. 21, 2011, provisional application No. 61/451,582, filed on Mar. 10, 2011, provisional application No. 61/451,579, filed on Mar. 10, 2011, provisional application No. 61/445,034, filed on Feb. 21, 2011.

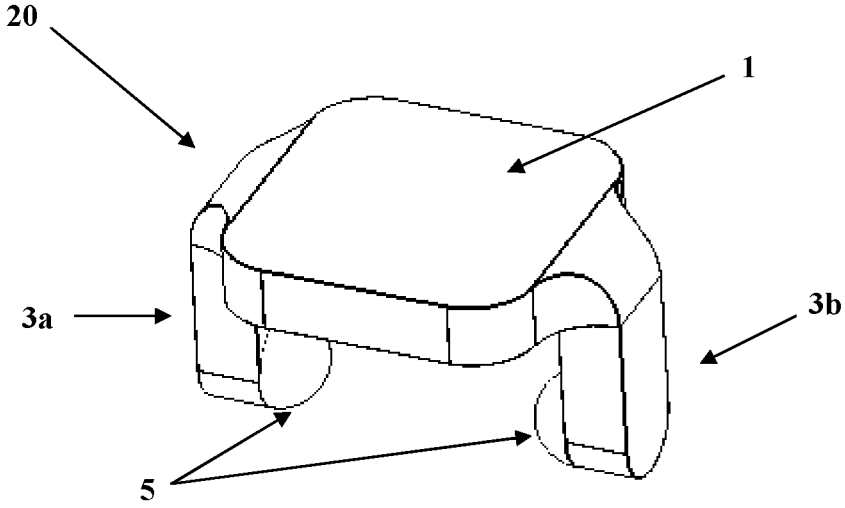

FIG. 1A

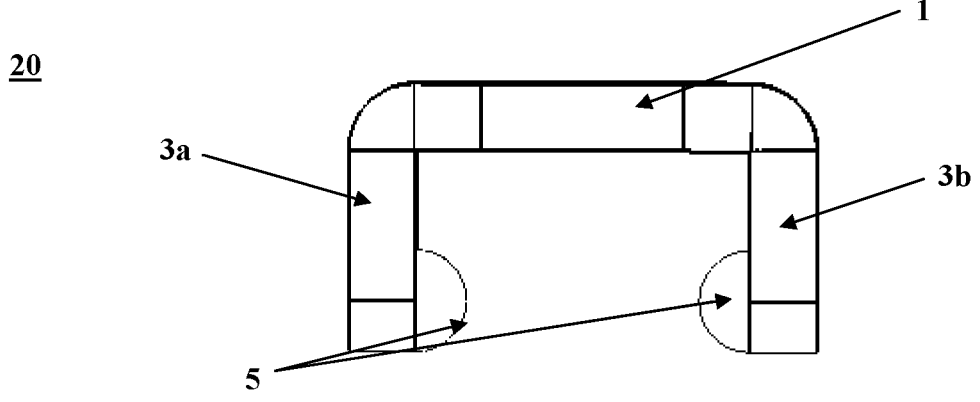

FIG. 1B

20

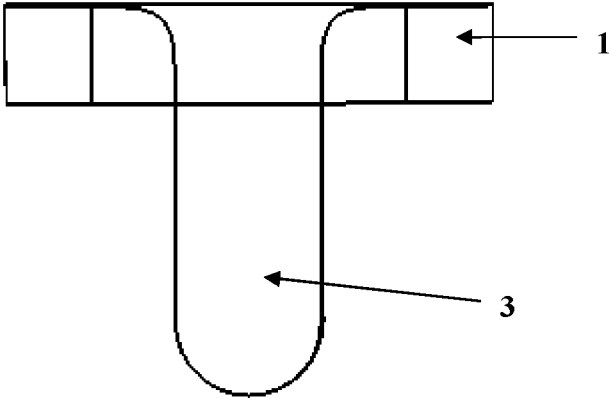

FIG. 1C

30

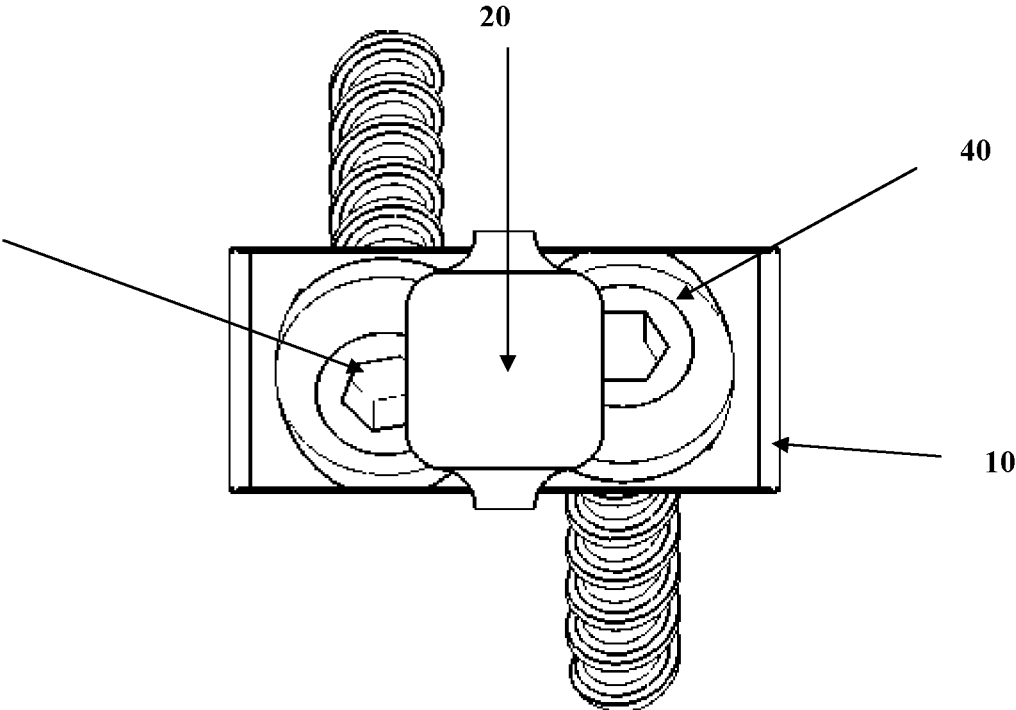

FIG. 2A

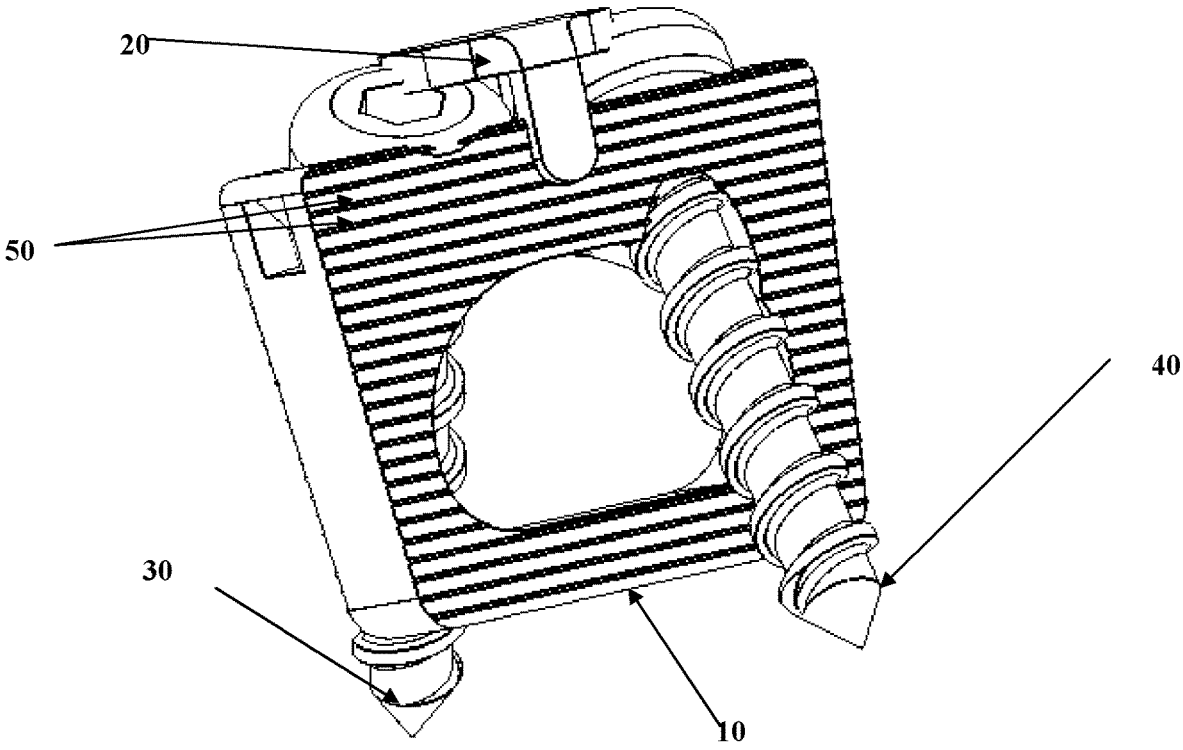

FIG. 2B

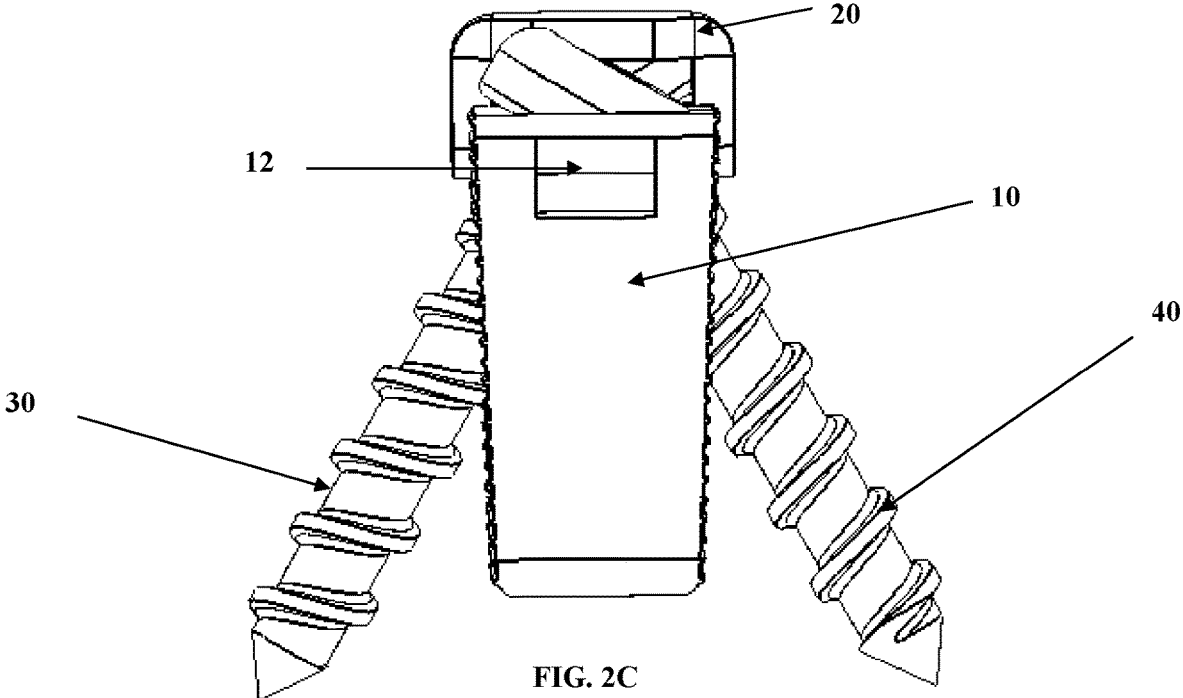

FIG. 2C

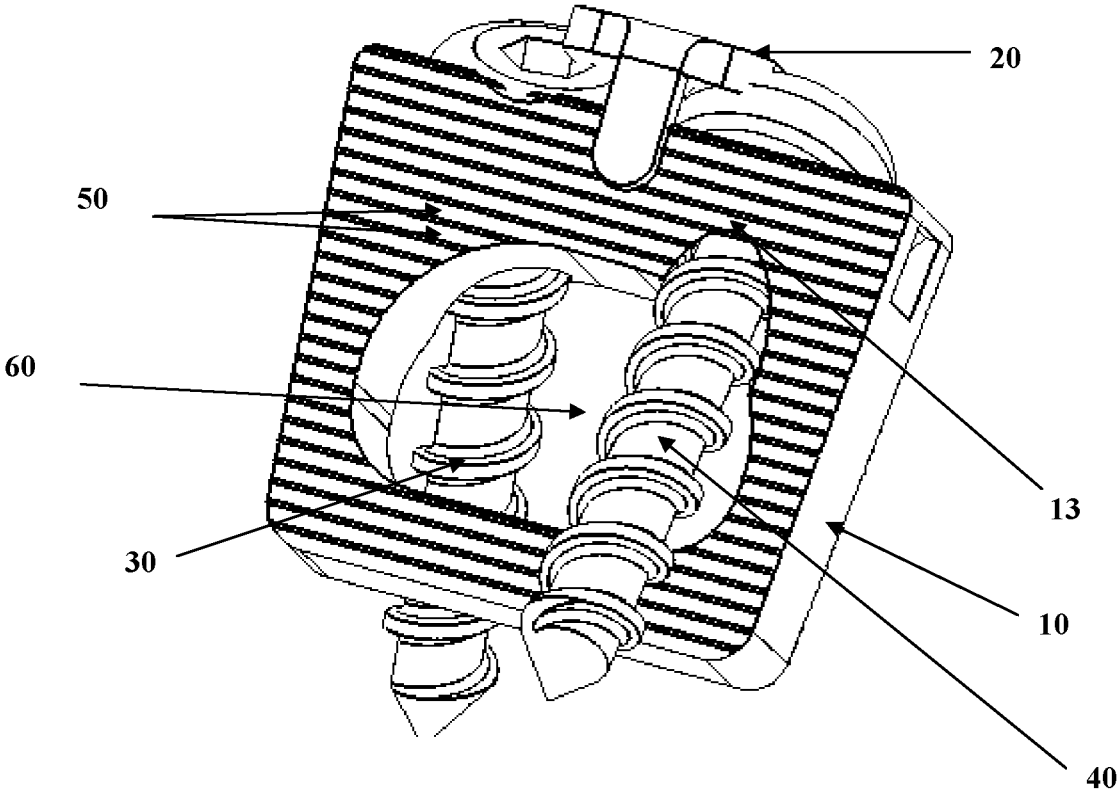

FIG. 2D

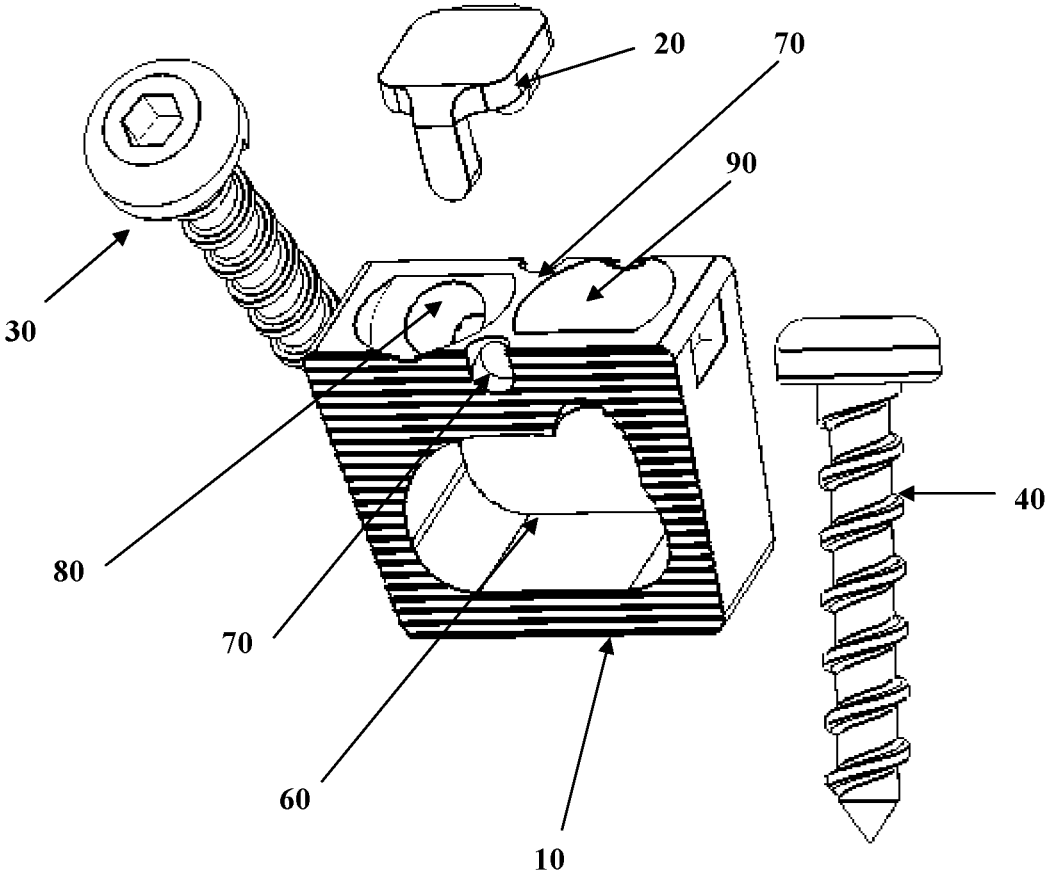

FIG. 2E

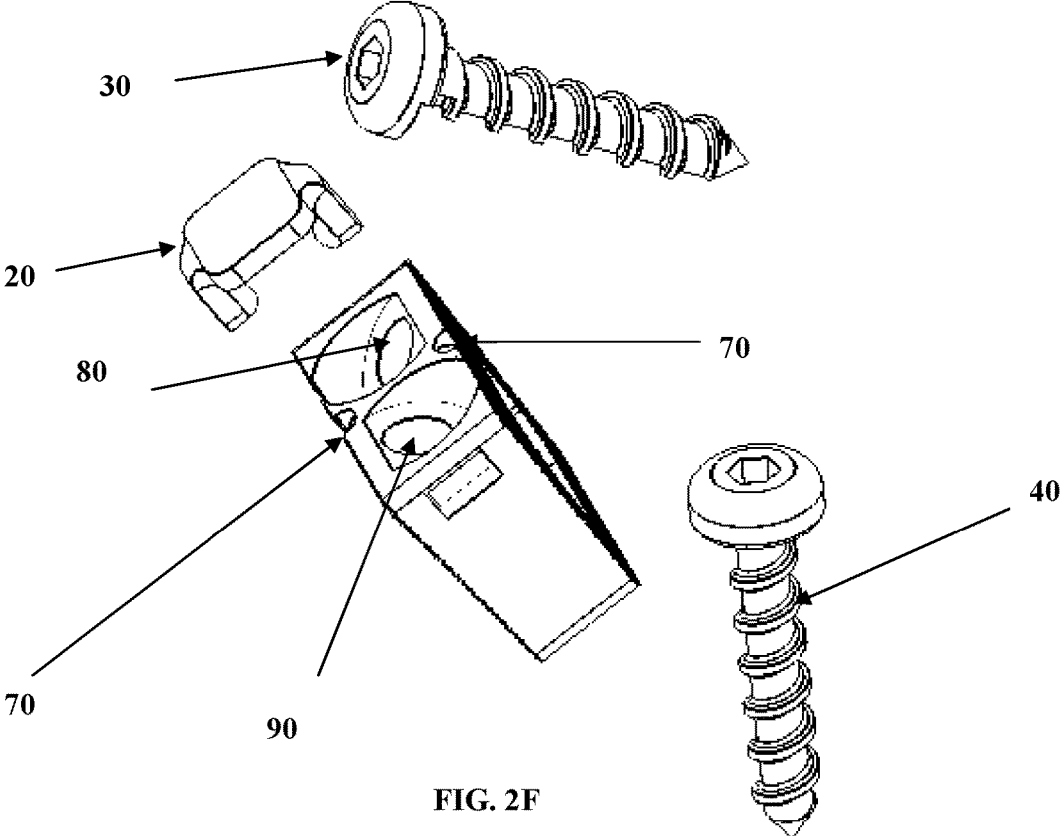

FIG. 2F

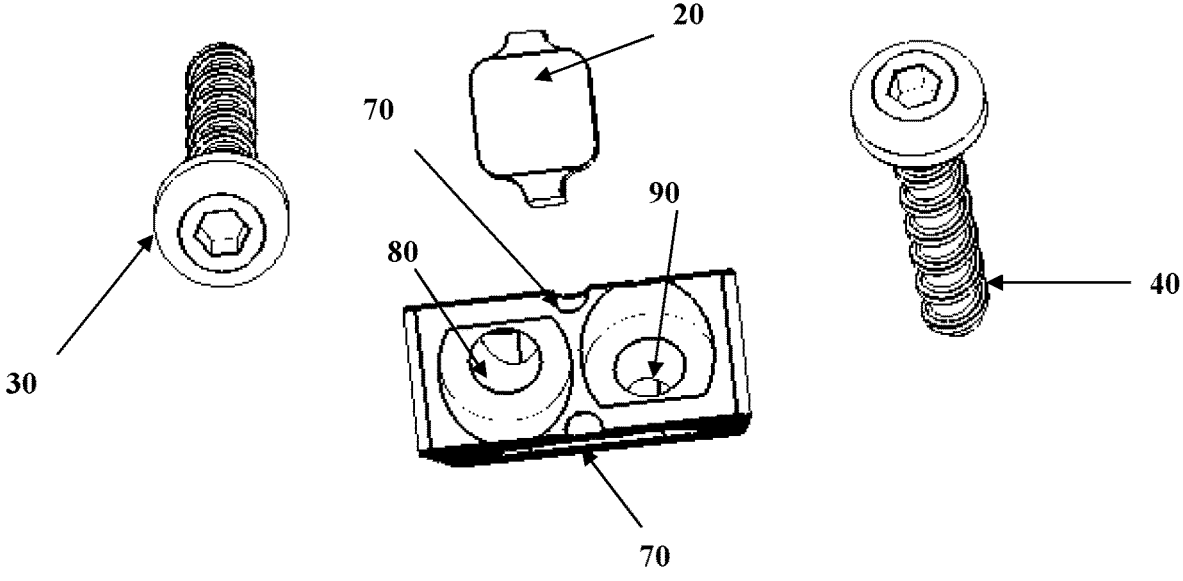

FIG. 2G

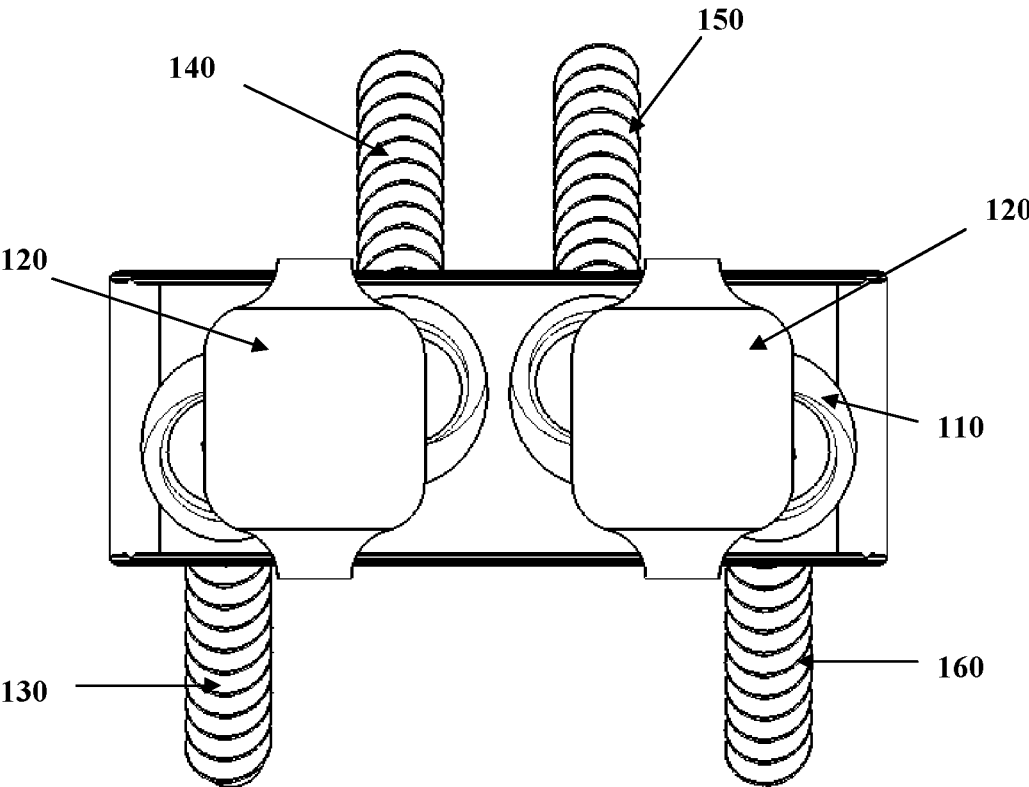

FIG. 3A

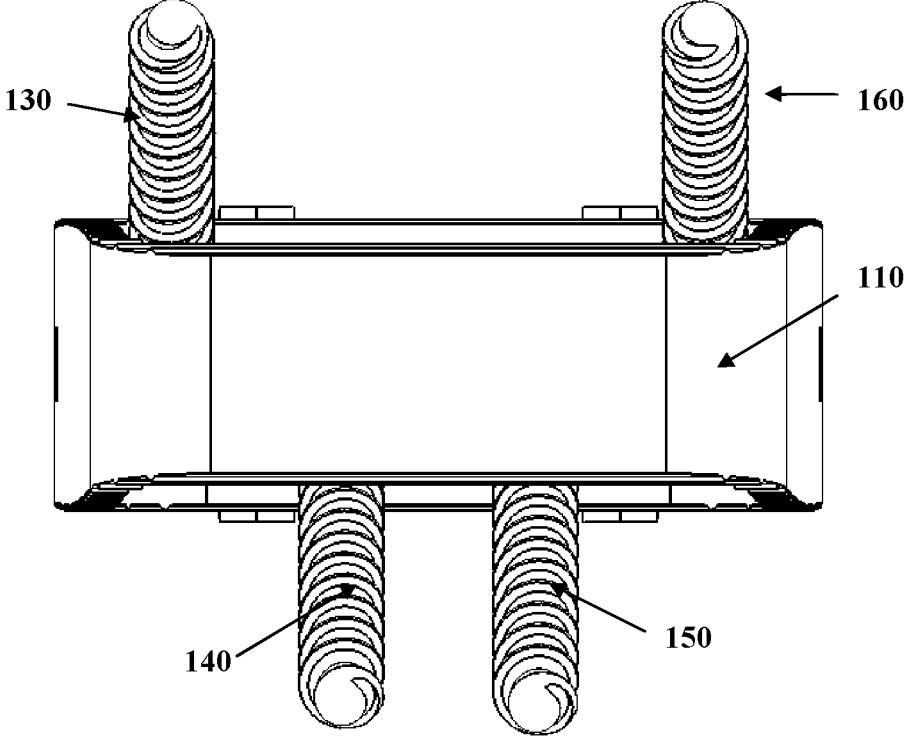

FIG. 3B

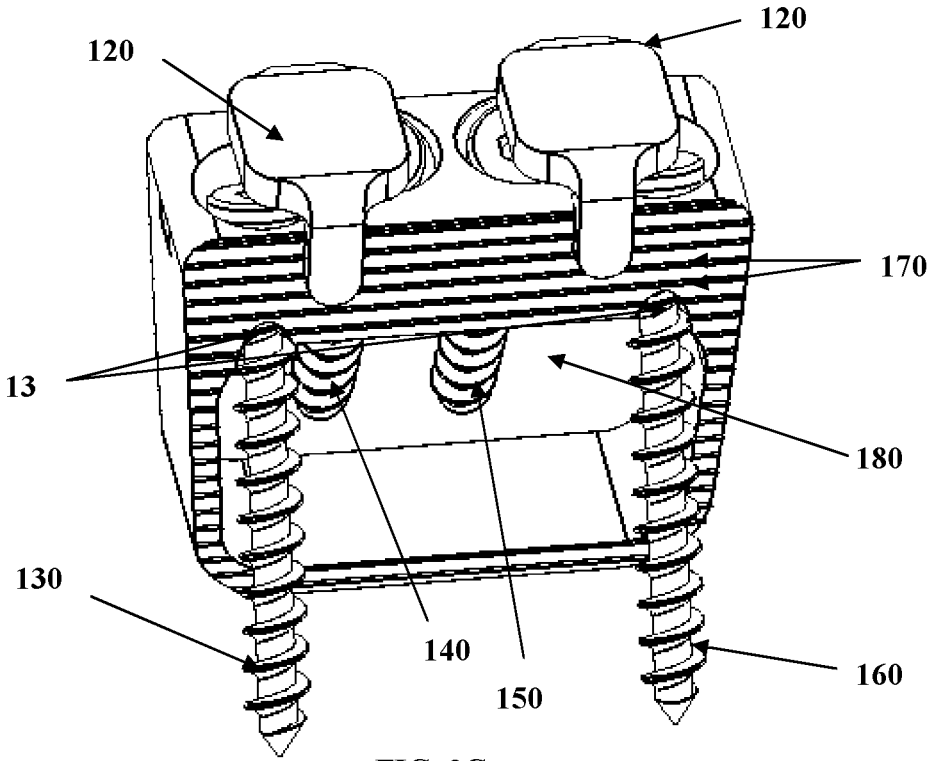

FIG. 3C

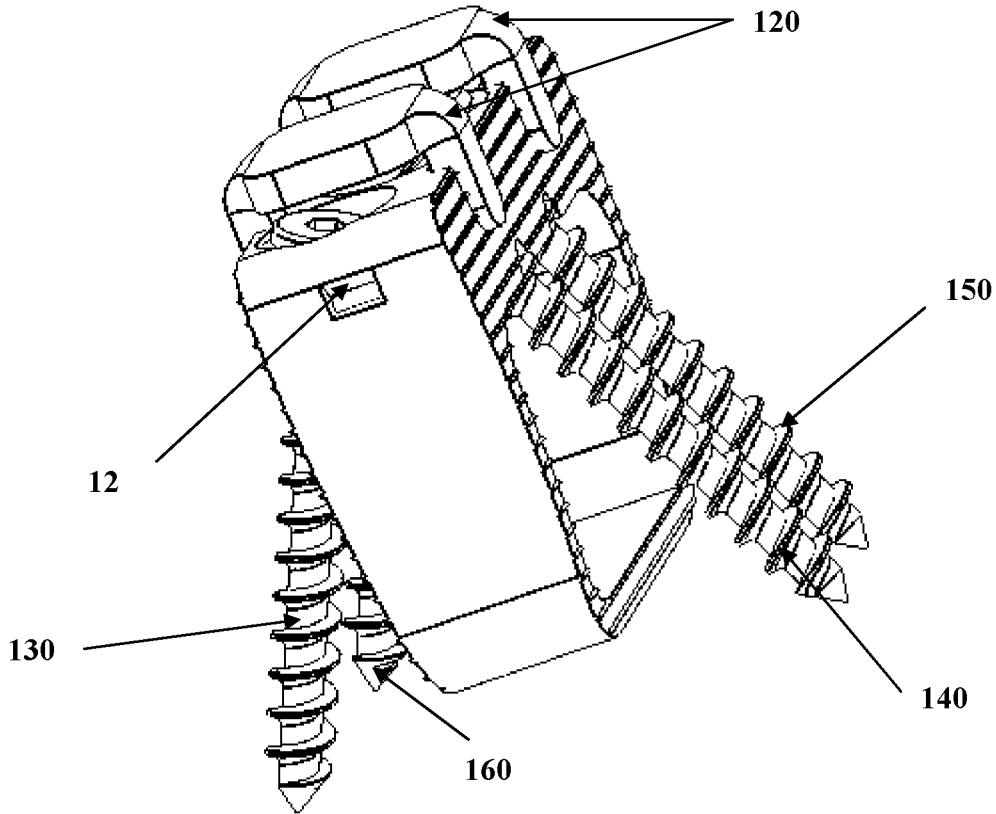

FIG. 3D

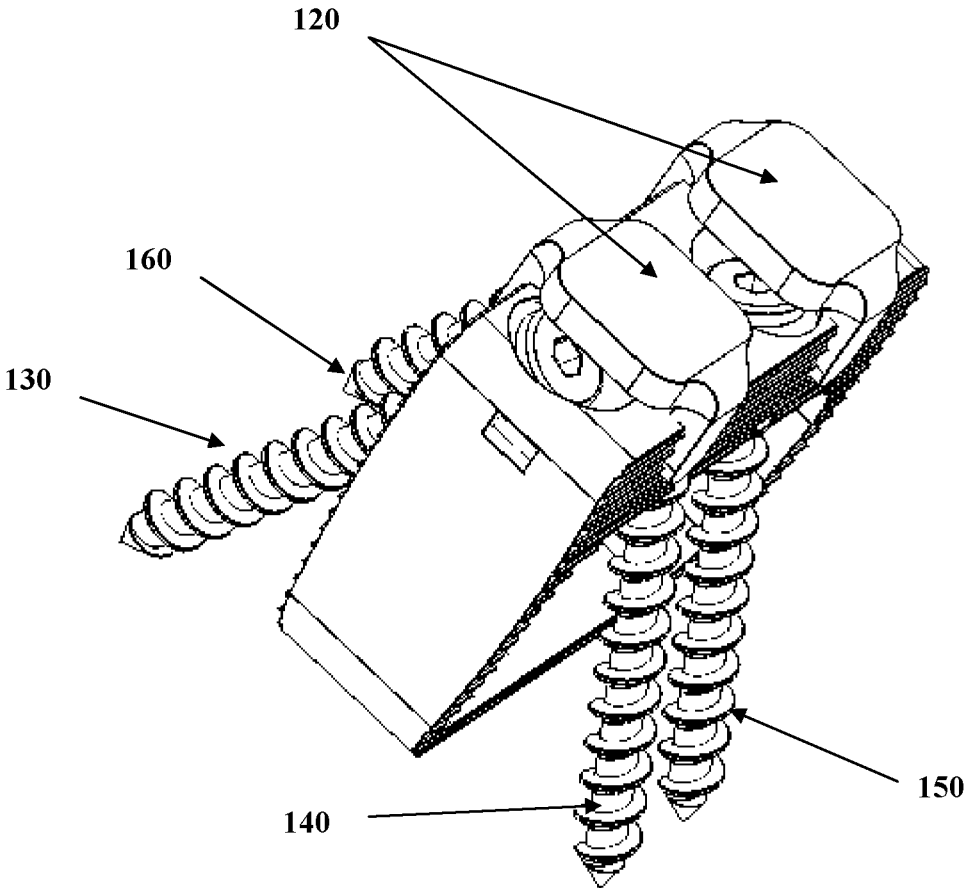

FIG. 3E

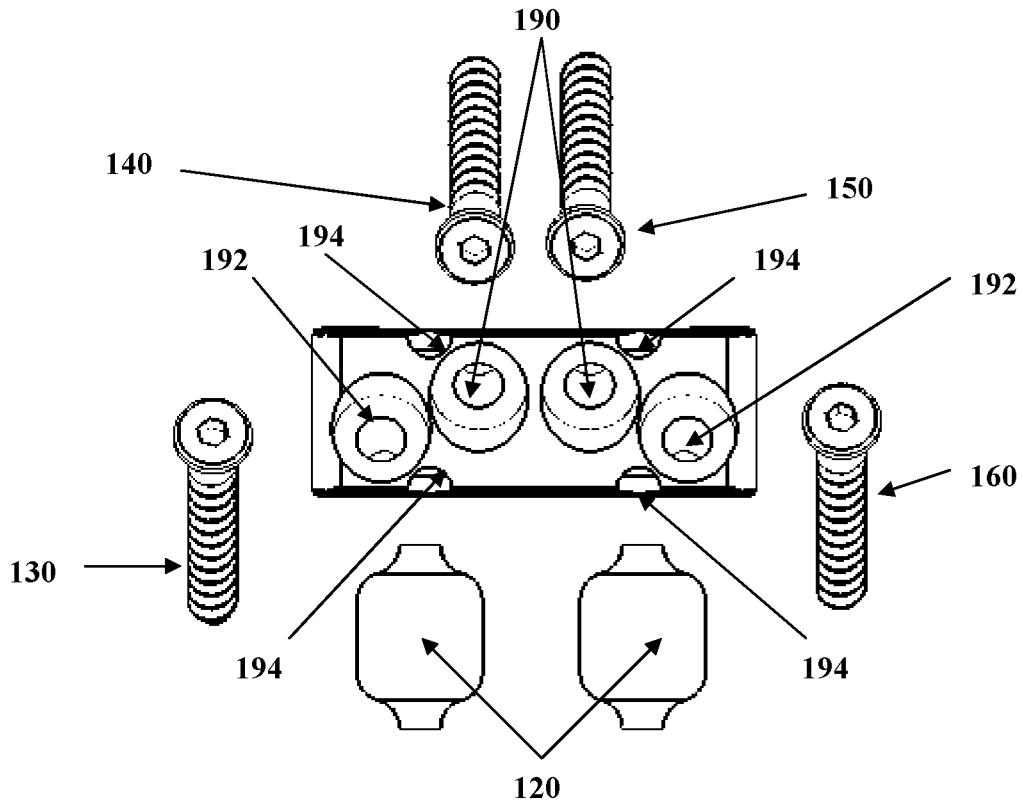

FIG. 3F

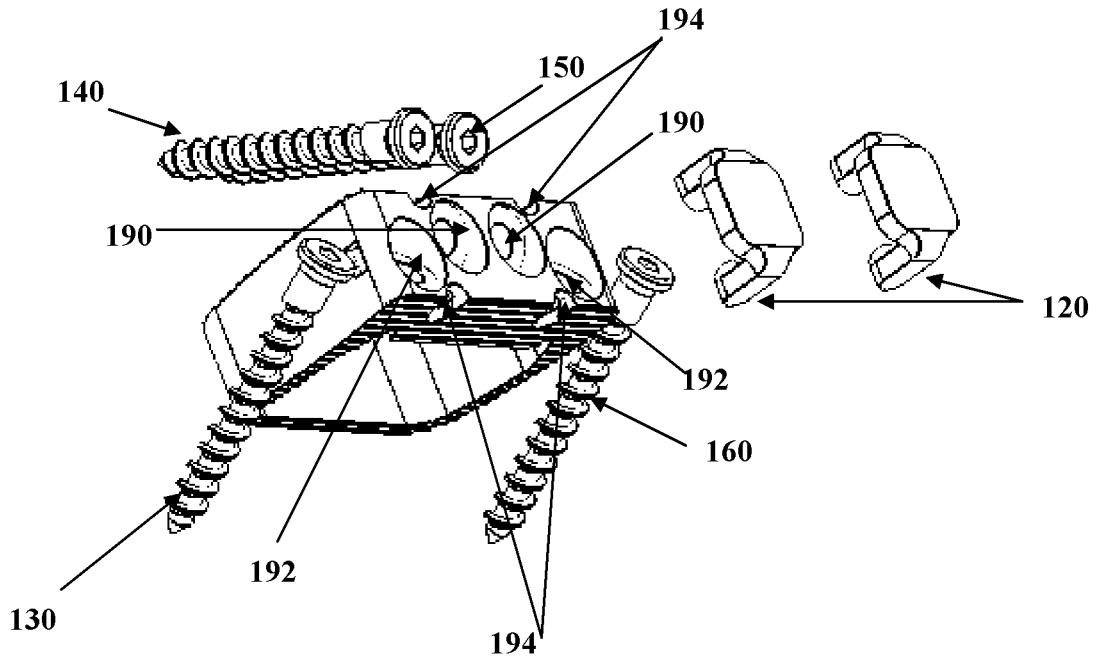
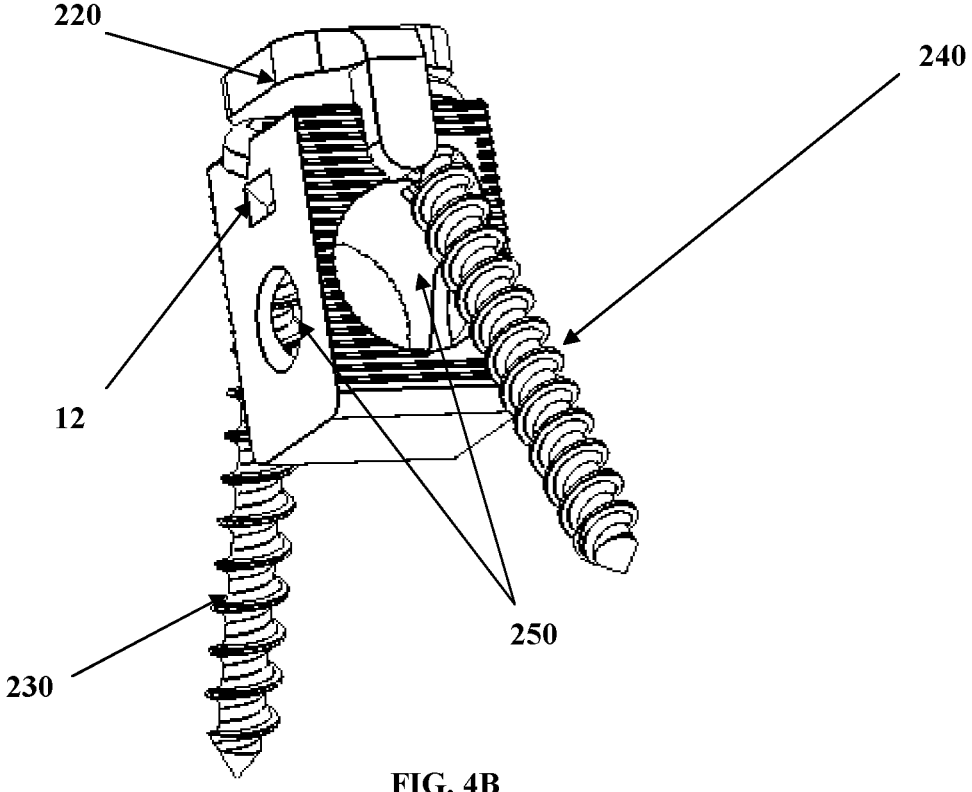
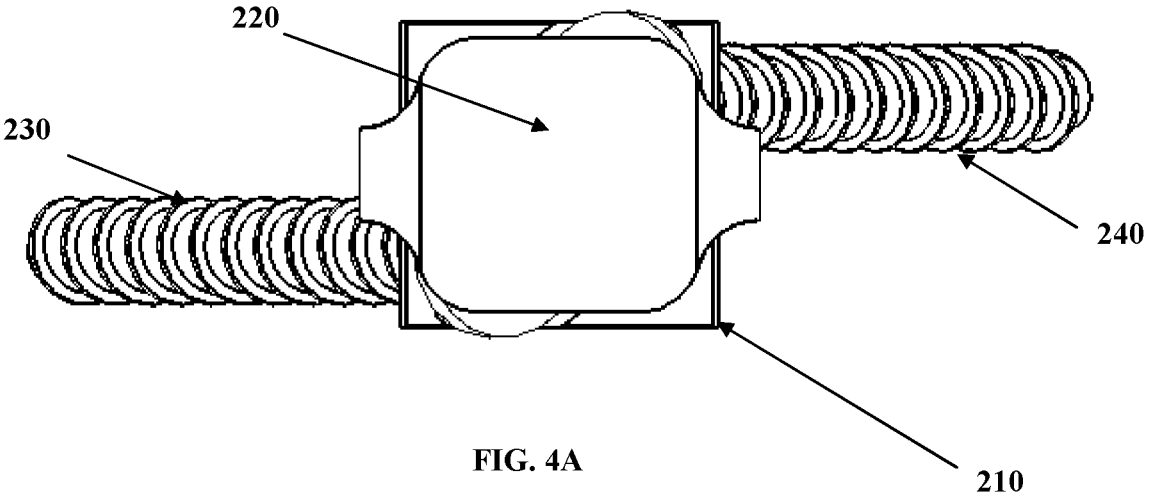

FIG. 3G



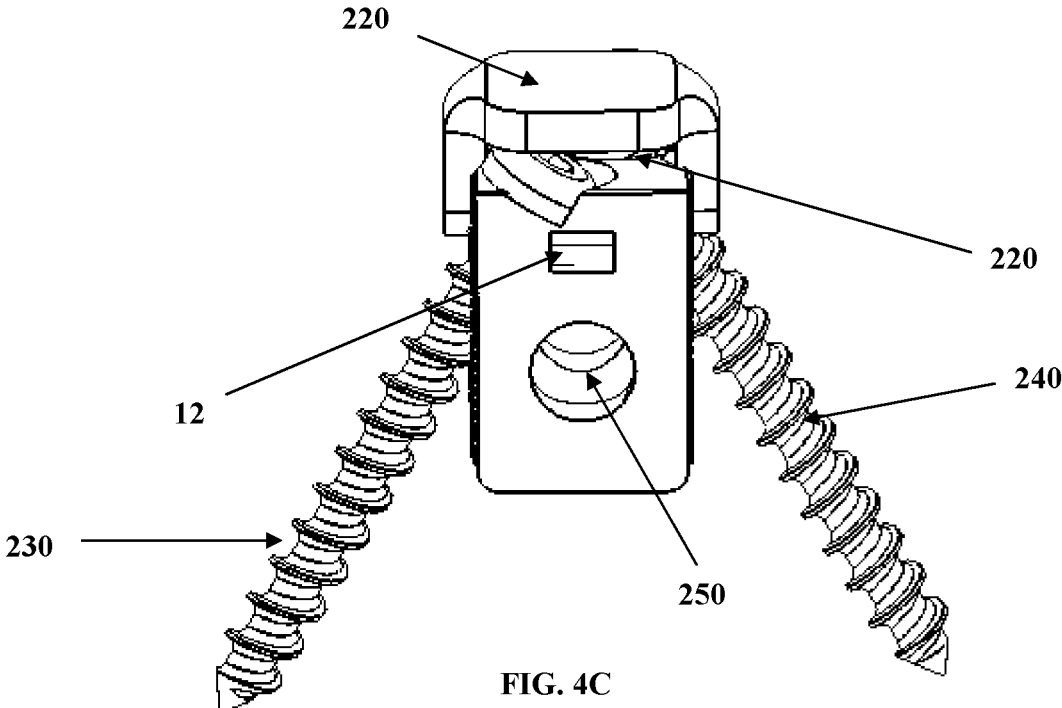

FIG. 4C

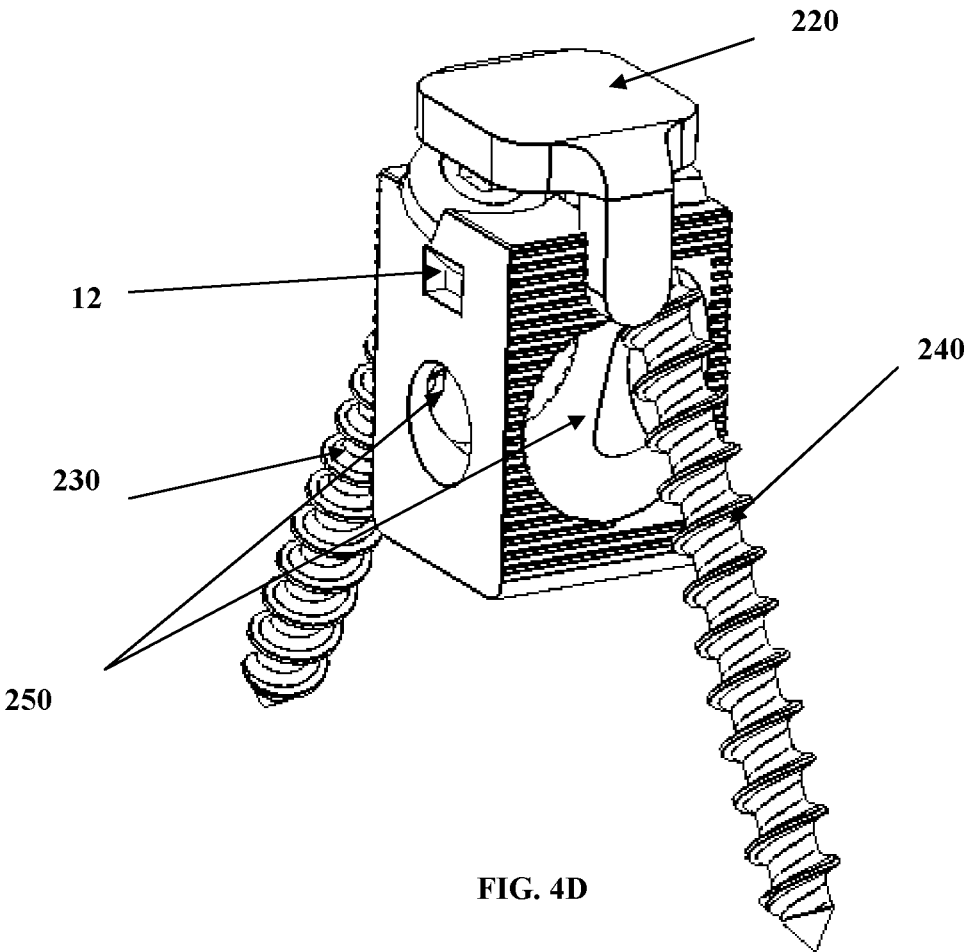

FIG. 4D

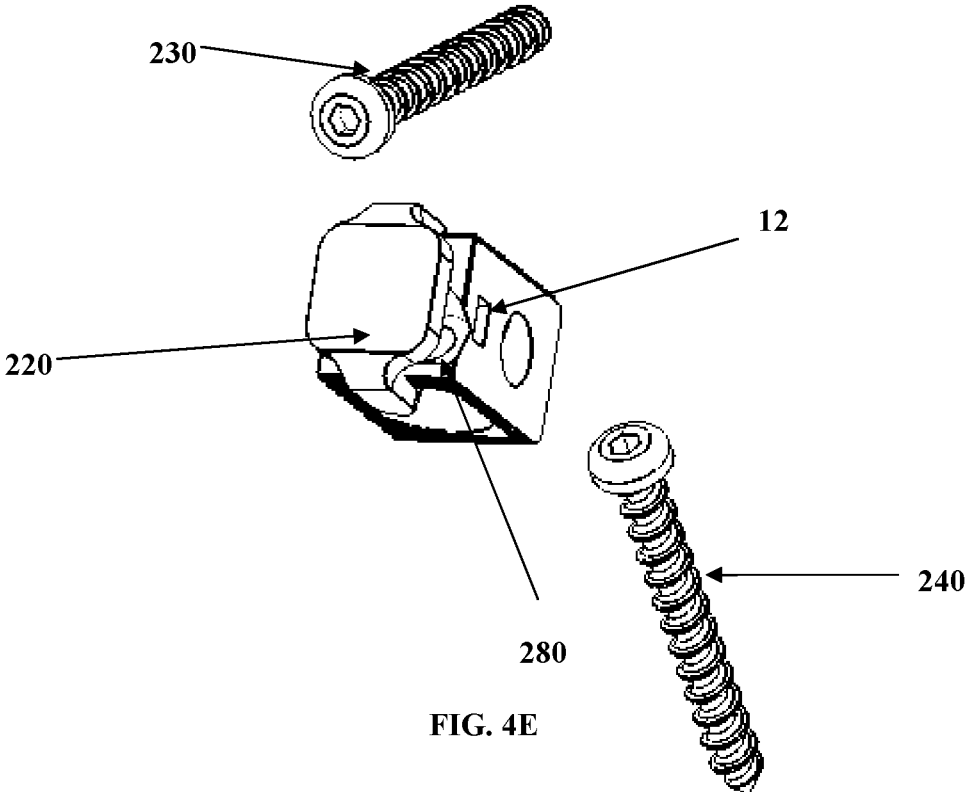

FIG. 4E

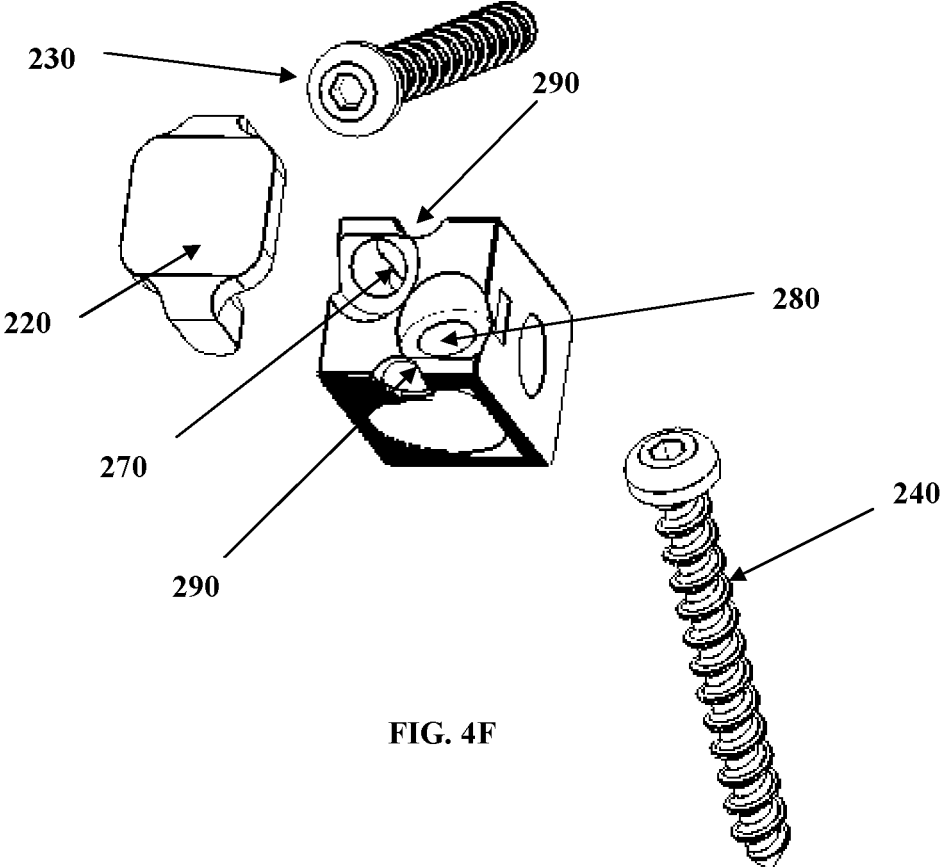

FIG. 4F

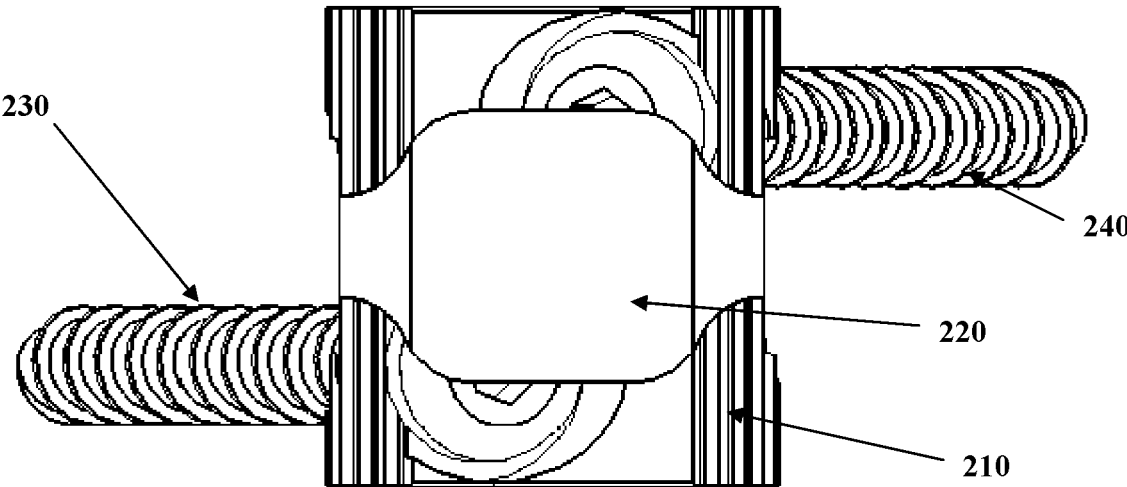
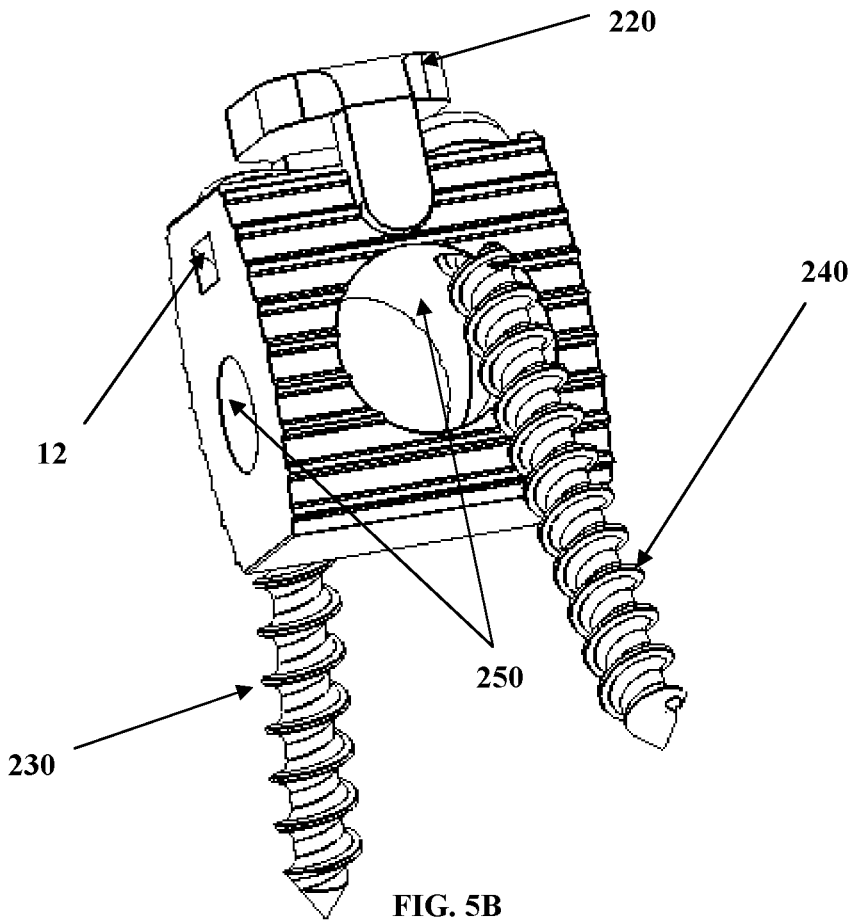

FIG. 5A



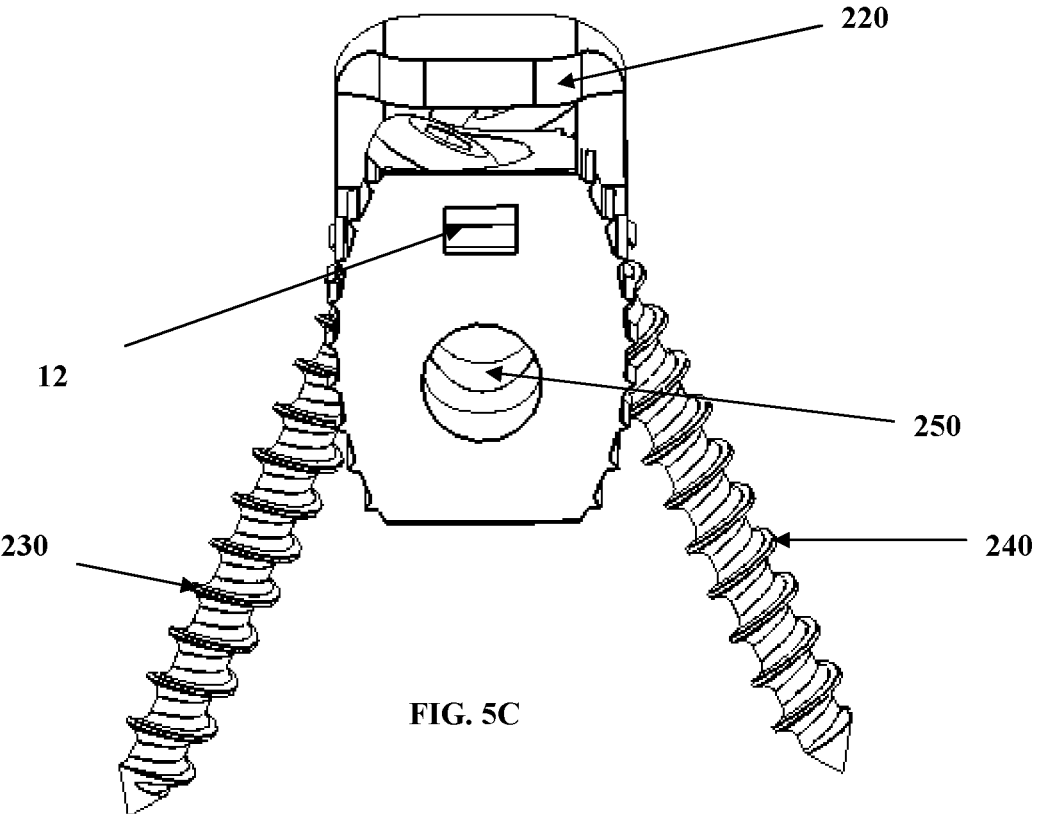

FIG. 5C

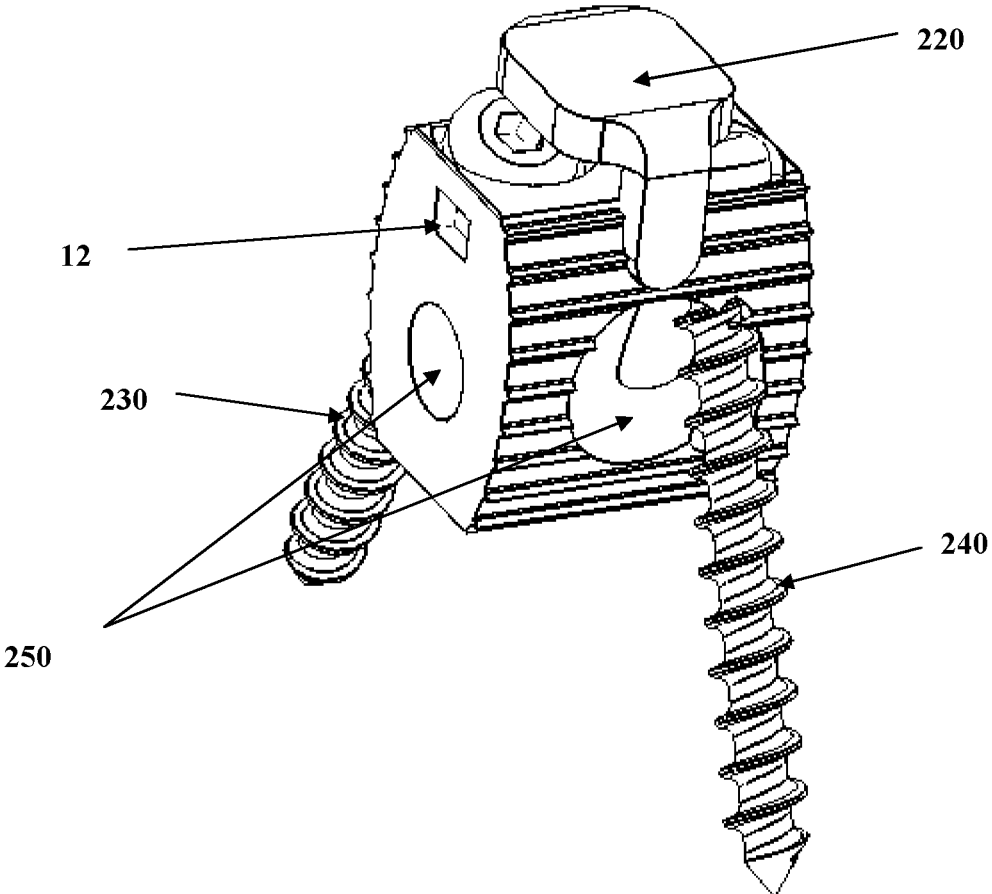

FIG. 5D

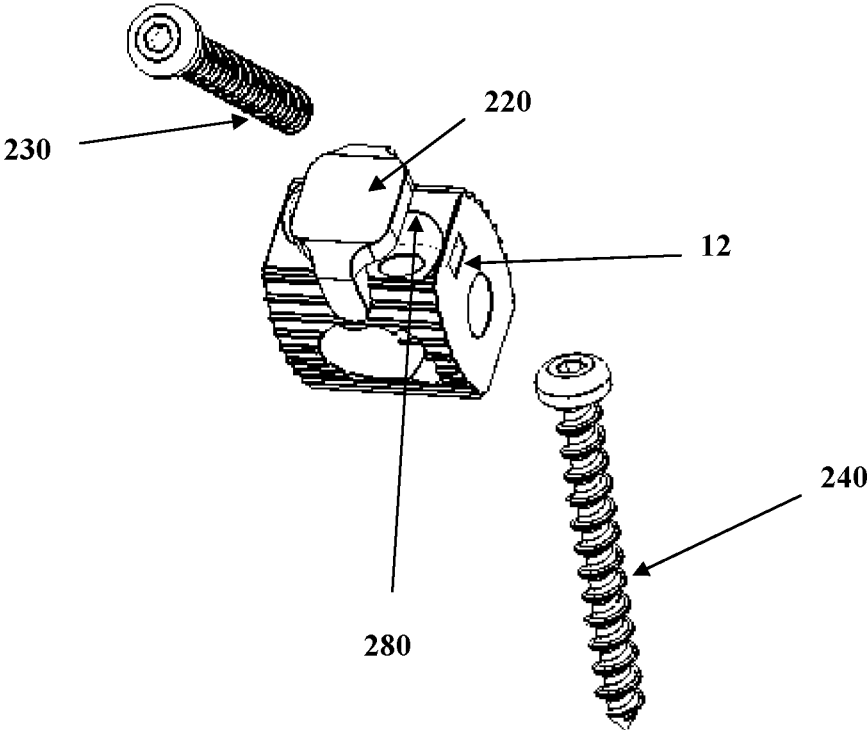

FIG. 5E

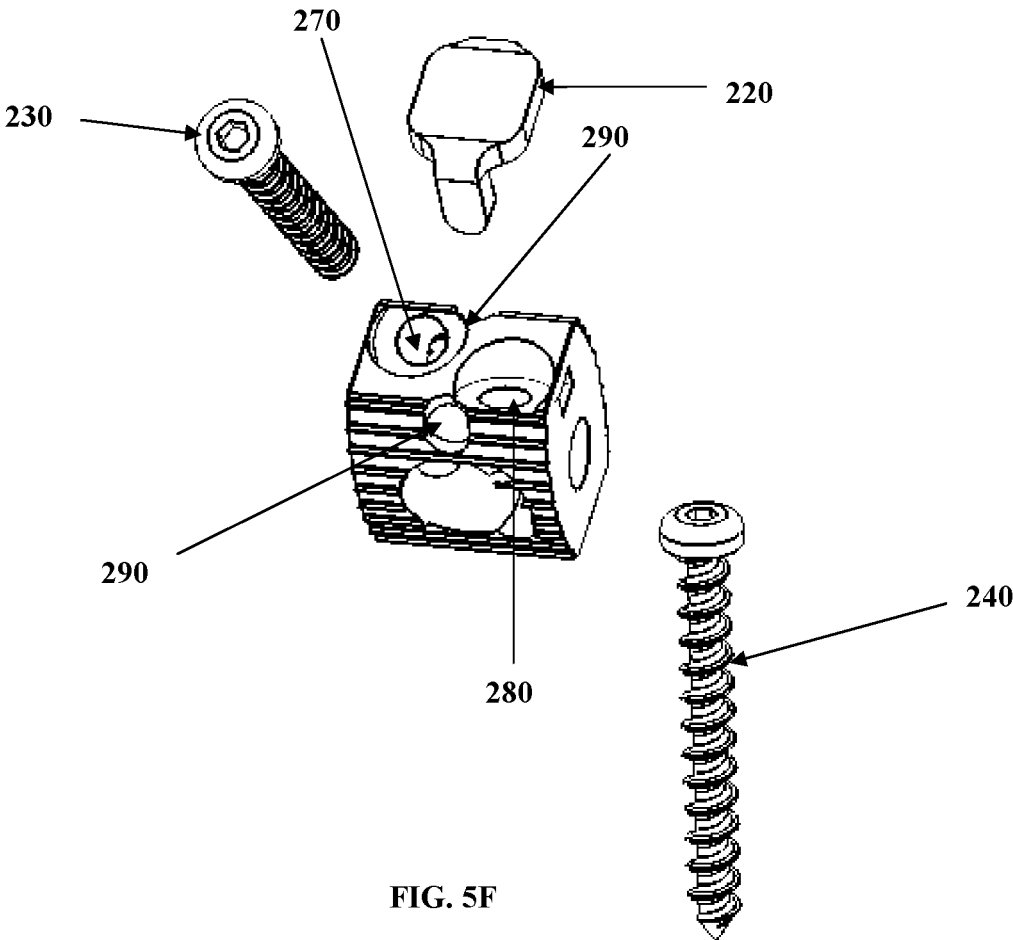

FIG. 5F

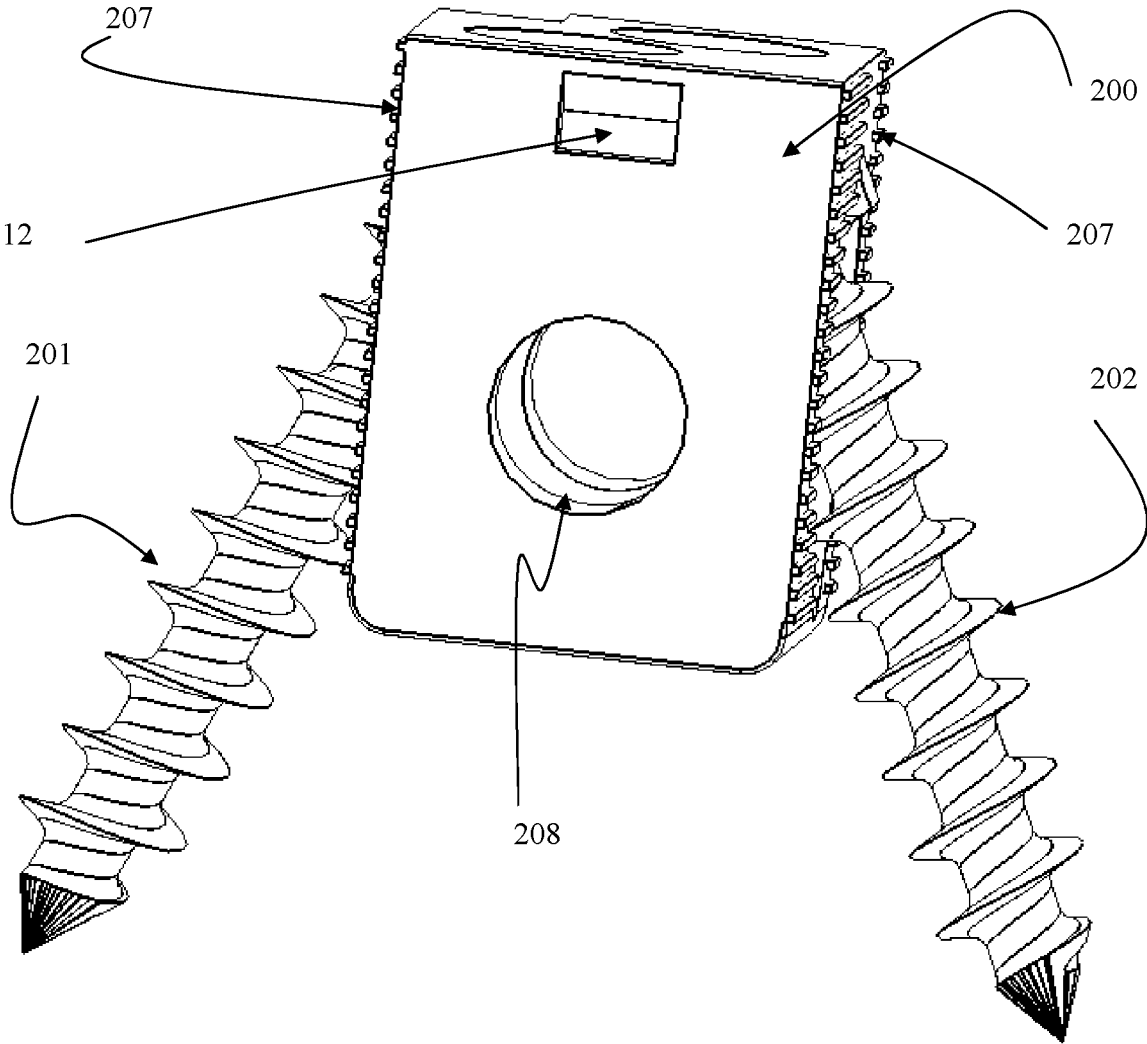

Fig. 6A

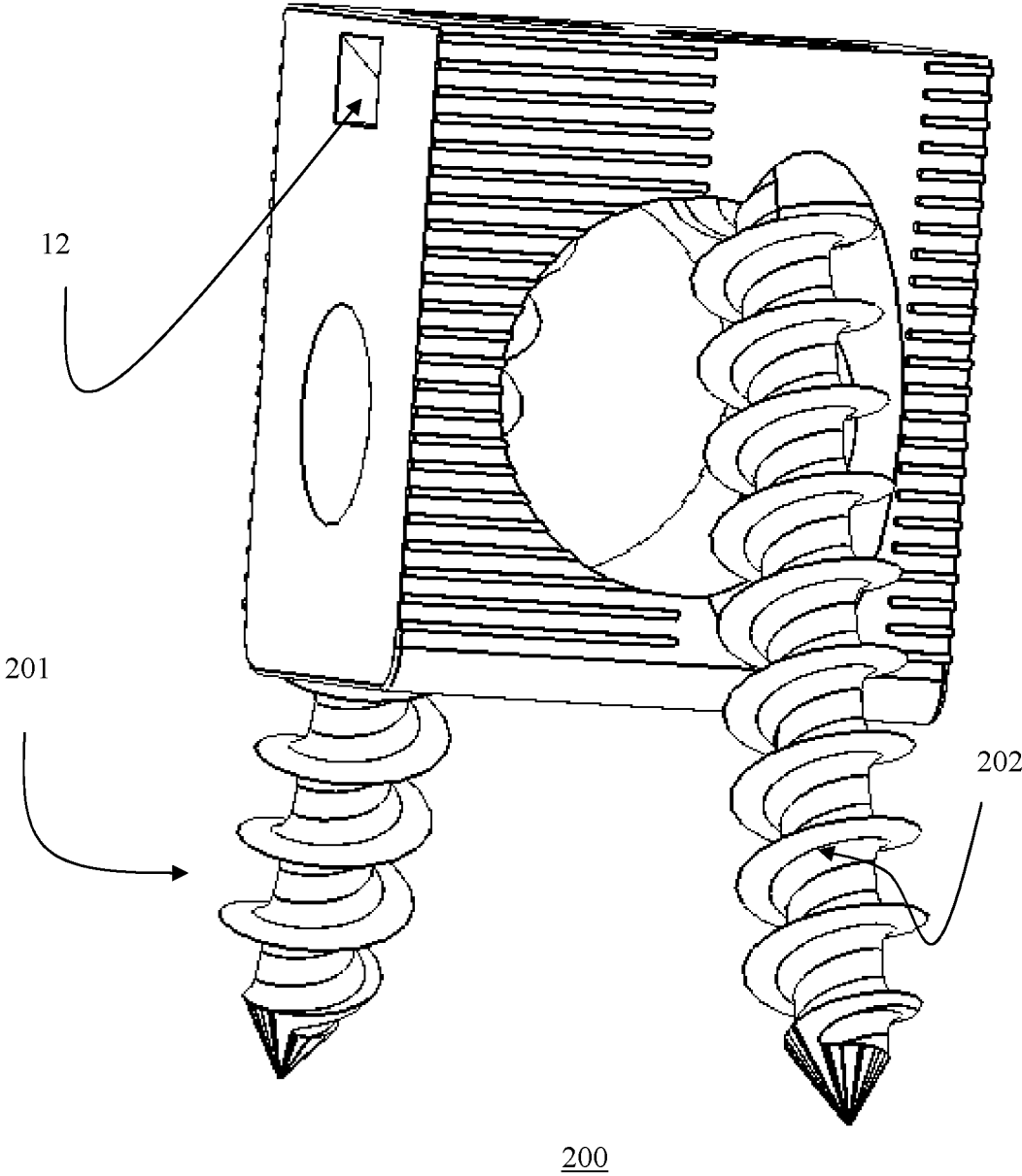

Fig. 6B

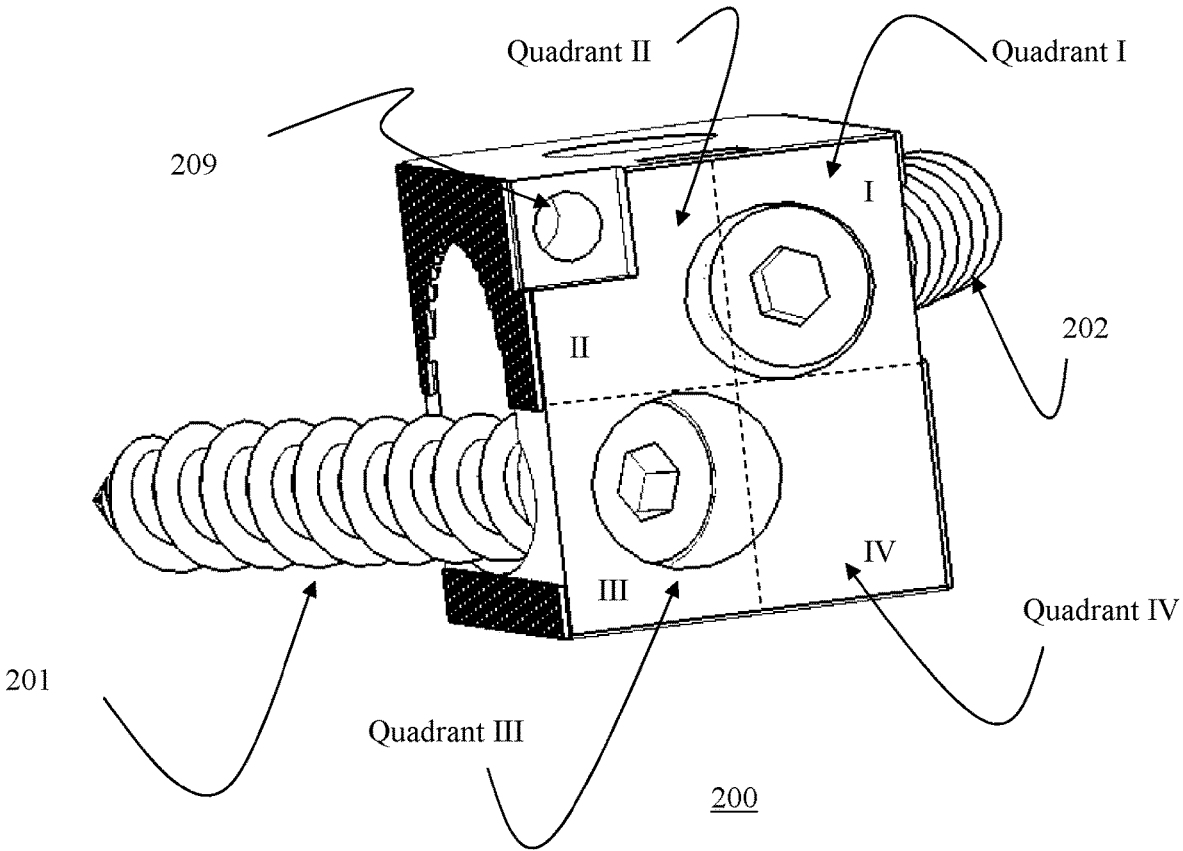

Fig. 6C(i)

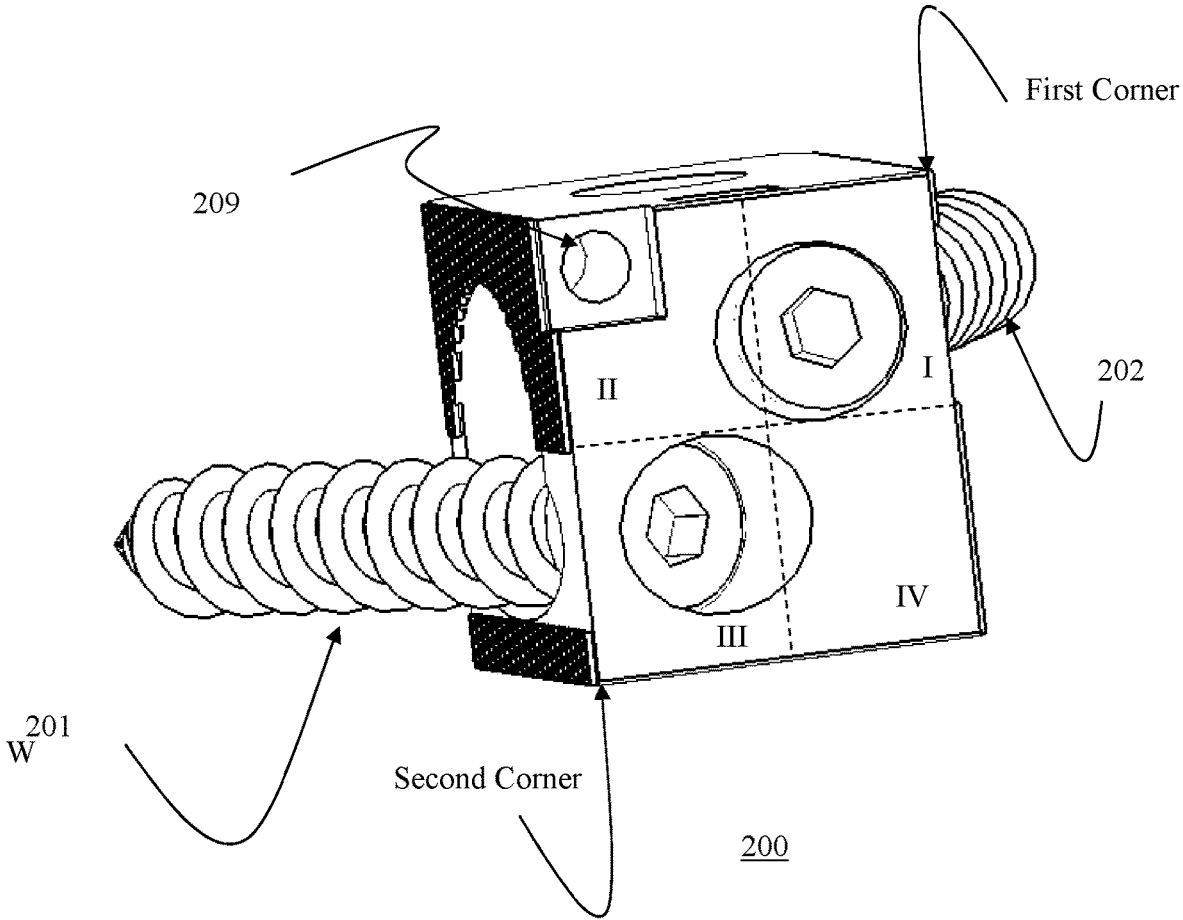

Fig. 6C(ii)

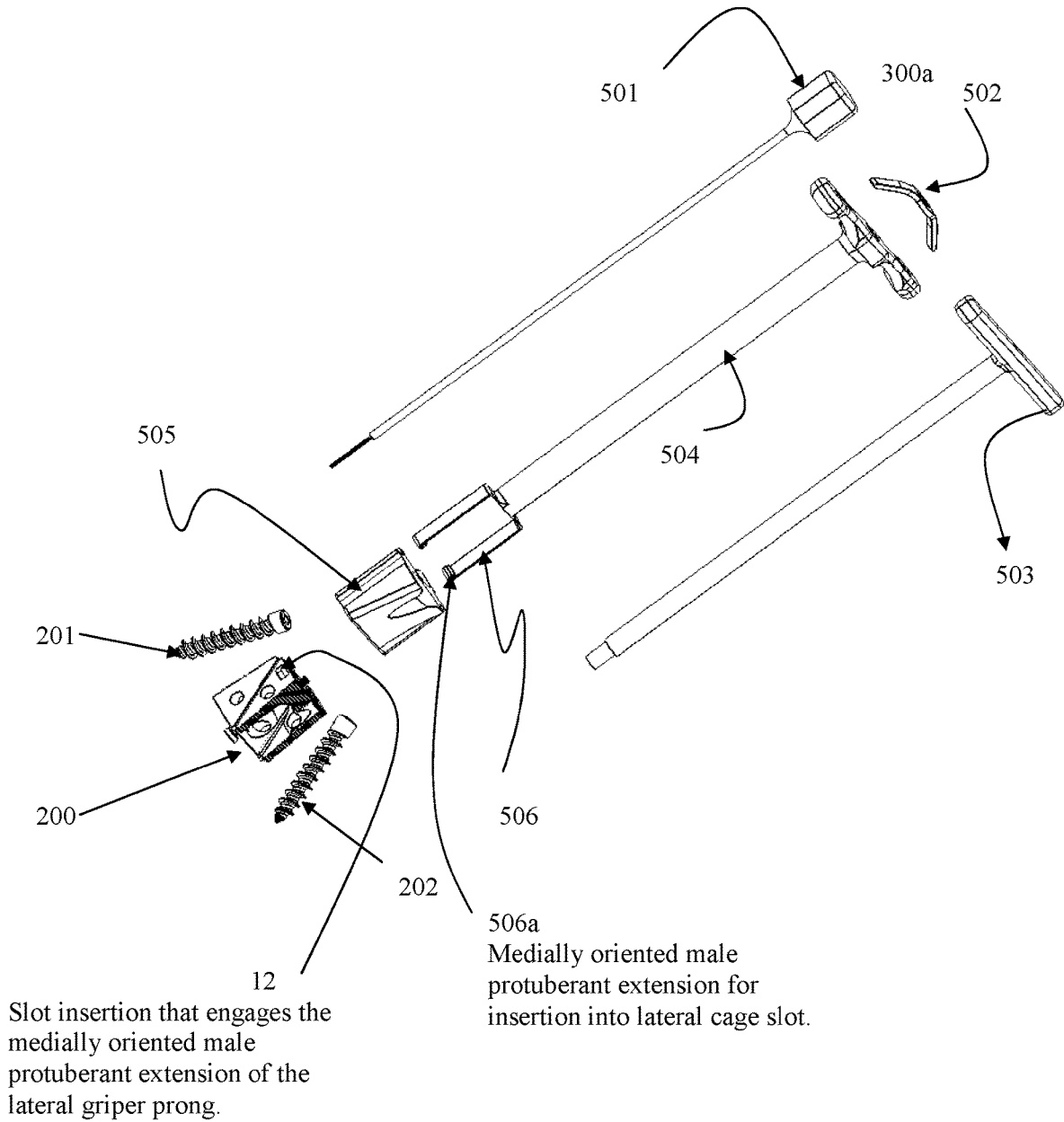

Fig. 6D

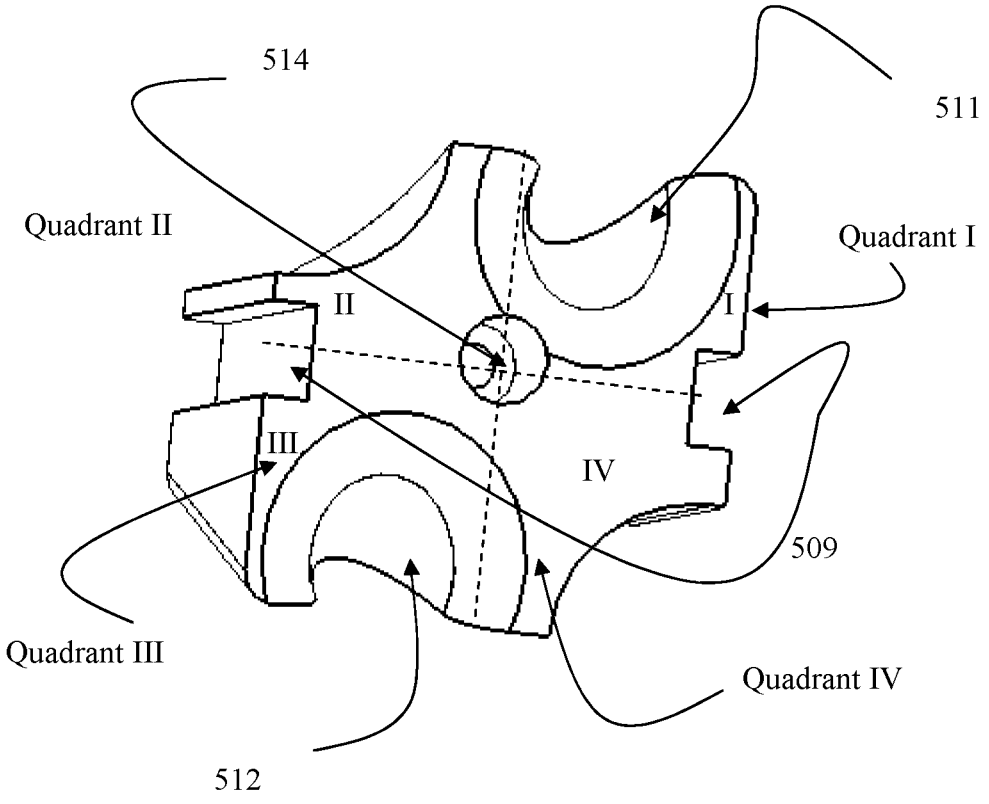

Fig. 6E

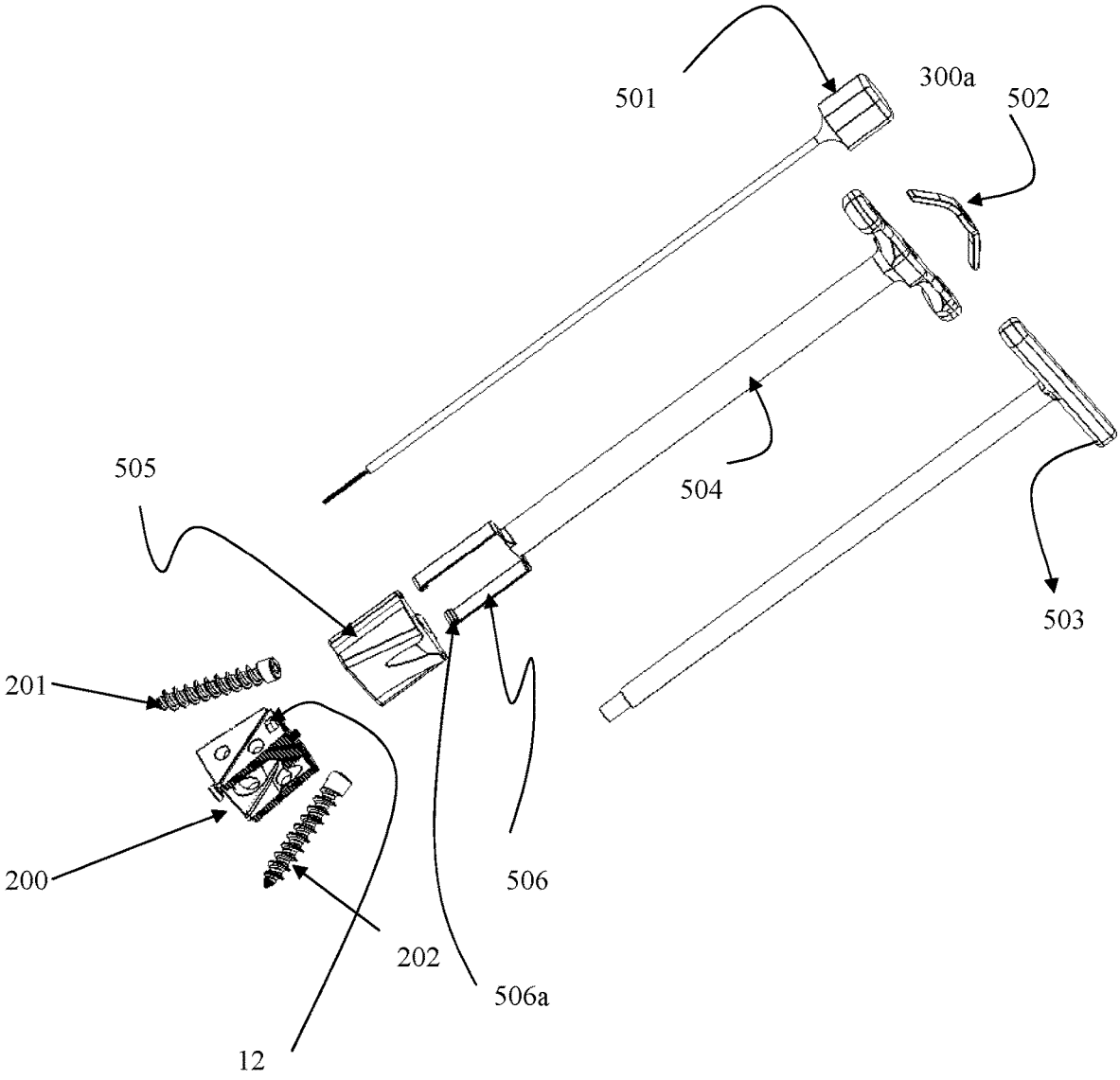

Fig. 6D

SPINAL BONE FUSION SYSTEM

[0001] This application is a Continuation Application of U.S. patent application Ser. No. 16/160,824, filed Oct. 15, 2018, which is a Continuation Application of U.S. patent application Ser. No. 15/397,198, filed Jan. 3, 2017, which is a Continuation of U.S. patent application Ser. No. 13/418,335, filed on Mar. 12, 2012, which is a Continuation-In-Part of application Ser. No. 13/103,994, filed May 9, 2011, now U.S. Pat. No. 9,603,713, which is a Divisional of Ser. No. 12/054,335, filed Mar. 24, 2008, now U.S. Pat. No. 7,972,363, which is a Continuation-In-Part of Ser. No. 11/842,855, filed Aug. 21, 2007, now U.S. Pat. No. 7,942,903, which is a Continuation-In-Part of Ser. No. 11/536,815, filed Sep. 29, 2006, now U.S. Pat. No. 7,846,188, which is a Continuation-In-Part of Ser. No. 11/208,644, filed Aug. 23, 2005, now U.S. Pat. No. 7,704,279.

[0002] Application Ser. No. 13/418,335 is a Continuation-In-Part of Ser. No. 13/084,543, filed Apr. 11, 2011, now U.S. Pat. No. 8,353,913, which is a Divisional of Ser. No. 11,842,855, filed Aug. 21, 2007, now U.S. Pat. No. 7,942,903. application Ser. No. 13/418,335 claims the benefit of priority of 61/451,582, filed Mar. 10, 2011, 61/451,579, filed Mar. 10, 2011, and 61/445,034, filed Feb. 21, 2011 and is a Continuation-In-Part of 13/401,829, filed Feb. 21, 2012, now U.S. Pat. No. 9,744,052. application Ser. No. 11/208,644 claims benefit of 60/670,231, filed Apr. 12, 2005. application Ser. No. 13/401,829 claims benefit of 61/445,034, filed Feb. 21, 2011.

[0003] application Ser. No. 15/397,198 is a Continuation of Ser. No. 13/418,323, filed Mar. 12, 2012, now U.S. Pat. No. 9,814,601, which is a Continuation-In-Part of Ser. No. 13/103,994, filed May 9, 2011, now U.S. Pat. No. 9,603,713, which is a Divisional of Ser. No. 12/054,335, filed Mar. 24, 2008, now U.S. Pat. No. 7,972,363, which is a Continuation-In-Part of Ser. No. 11/842,855, filed Aug. 21, 2007, now U.S. Pat. No. 7,942,903, which is a Continuation-In-Part of Ser. No. 11/536,815, filed Sep. 29, 2006, now U.S. Pat. No. 7,846,188, which is a Continuation-In-Part of Ser. No. 11/208,644, filed Aug. 23, 2005, now U.S. Pat. No. 7,704,279. application Ser. No. 13/418,323 is a Continuation-In-Part of Ser. No. 13/084,543, filed Apr. 11, 2011, now U.S. Pat. No. 8,353,913, which is a Divisional of Ser. No. 11/842,855, filed Aug. 21, 2007, now U.S. Pat. No. 7,942,903. application Ser. No. 13/418,323 claims benefit of 61/451,582, filed Mar. 10, 2011 and claims benefit of 61/451,579, filed Mar. 10, 2011 and is a Continuation-In-Part of Ser. No. 13/401,829, filed Feb. 21, 2012, now U.S. Pat. No. 9,744,052. application Ser. No. 13/401,829 claims benefit of 61/445,034, filed Feb. 21, 2011.

[0004] application Ser. No. 15/397,198 is a Continuation-In-Part of Ser. No. 13/401,829, filed Feb. 21, 2012, now U.S. Pat. No. 9,744,052, which is a Continuation-In-Part of Ser. No. 13/103,994, filed May 9, 2011, now U.S. Pat. No. 9,603,713, which is a Divisional of Ser. No. 12/054,335, filed Mar. 24, 2008, now U.S. Pat. No. 7,972,363, which is a Continuation-In-Part Ser. No. 11/842,855, filed Aug. 21, 2007, now U.S. Pat. No. 7,942,903, which is a Continuation-In-Part Ser. No. 11/536,815, filed Sep. 29, 2006, now U.S. Pat. No. 7,846,188, which is a Continuation-In-Part of Ser. No. 11/208,644, filed Aug. 23, 2005, now U.S. Pat. No. 7,704,279. application Ser. No. 13/401,829 is a Continuation-In-Part of Ser. No. 13/084,543, filed Apr. 11, 2011, now U.S. Pat. No. 8,353,913, which is a Divisional of Ser. No. 11/842,855, filed Aug. 21, 2007, now U.S. Pat. No. 7,942,

903. application Ser. No. 13/401,829 claims benefit of 61/451,582, filed Mar. 10, 2011, 61/451,579, filed Mar. 10, 2011, 61/445,034, filed Feb. 21, 2011.

FIELD OF DISCLOSURE

[0005] The present invention relates to a unique universal bi-directional screw (BDS) system, and in particular its application to the spine, also referred to as bi-directional fixating transvertebral (BDFT) screw/cage constructs which can be used as stand-alone intervertebral devices which combine the dual functions of an intervertebral spacer that can be filled with bone fusion material(s), as well as a bi-directional transvertebral bone fixating/fusion screw apparatus. In the posterior lumbosacral and thoracic spine, intervertebral cage/BDFT screw constructs can be used as stand-alone devices obviating the need for pedicle screw fixation in many but not all cases. In the anterior cervical, thoracic and lumbosacral spine, intervertebral cage/BDFT screw constructs can be used as stand-alone devices obviating the need for anterior or lateral (thoracic and lumbosacral) spinal plating, and/or supplemental posterior pedicle screw fixation.

BACKGROUND

[0006] The history and evolution of instrumented spinal fusion in the entire human spine has been reviewed in related applications Ser. No. 12/054,335, filed on Mar. 24, 2008, Ser. No. 13/084,543, filed on Apr. 11, 2011, Ser. No. 11/842,855, filed on Aug. 21, 2007, Ser. No. 11/536,815, filed on Sep. 29, 2006, and Ser. No. 11/208,644, filed on Aug. 23, 2005, the contents of which are hereby incorporated by reference in their entirety. Conventionally, the majority of posterior cervical and almost all posterior thoracic and lumbosacral fusion surgical techniques are typically supplemented with pedicle screw placement. Conventionally, the majority of anterior cervical spinal fusions, and many antero-lateral thoracic, and anterior or antero-lateral lumbosacral fusions are supplemented with anterior or anterior-lateral spinal plating, and very often, in particular in the thoracic and lumbosacral spine, are supplemented with posterior pedicle screw instrumentation.

[0007] Complications of pedicle screw placement in cervical, thoracic and lumbosacral spine include duration of procedure, significant tissue dissection and muscle retraction, misplaced screws with neural and/or vascular injury, excessive blood loss, need for transfusions, prolonged recovery, incomplete return to work, and excessive rigidity leading to adjacent segmental disease requiring further fusions and re-operations. Recent advances in pedicle screw fixation including minimally invasive, and stereotactic CT image-guided technology, and the development of flexible rods, imperfectly address some but not all of these issues.

[0008] Complications of anterior plating in the cervical spine include potential plate, and/or screw esophageal compression, and misplaced screws leading to neurovascular injury. Complications of anterior or anterior-lateral plating in the anterior lumbar spine include potential devastating injury to the major vessels due to chronic vascular erosion of the major vessels, or acute vascular injuries due to partial or complete plate and/or screw back out. Furthermore, for re-do surgeries, plate removal can be arduous, with potential complications of prolonged esophageal retraction, vascular injury and screw breakage. Recent advances including

diminishing the plate width and/or profile, and absorbable plates, imperfectly address some but not all of these issues.

[0009] Complications of all conventional spinal anterior intervertebral device constructs are their potential for extrusion in the absence of plating. Hence, they are supplemented with anterior plating to prevent extrusion. Complications of posterior lumbosacral intervertebral device construct in the presence or absence of supplemental pedicle screw fixation is device extrusion, and potential nerve root and/or vascular injuries.

SUMMARY

[0010] Herein described are multiple device embodiments which combine in a single stand-alone construct the dual functions of: a) an intervertebral cage spacer which can be filled with bone fusion material maintaining disc height, and, b) a bi-directional fixating/fusion transvertebral body screw apparatus. These embodiments are described for posterior and anterior lumbar (and antero-lateral thoracic) intervertebral placement, and anterior cervical intervertebral placement. The present invention recognizes the aforementioned problems with prior art apparatus and solves these problems by, among other things, complimenting/improving upon the designs illustrated in the aforementioned related applications. The present application provides an advanced and novel bi-directional fixating transvertebral (BDFT) screw/cage apparatus with a vertical hemi-bracket locking screw mechanism which locks two adjacent screws into position, preventing back out by its insertion into novel indentations on the upper superior and inferior sides of the screw box which are aligned with the axial midpoint of the upper surface of the cage between two adjacent internalized cage screw guides/screws. These brackets can be easily snapped into the cage indentations and removed by a bracket tool, for example, as described in U.S. Pat. No. 7,942,903, issued on May 17, 2011. This mechanism can be used not only for these constructs but also with any other device which requires a screw locking mechanism, e.g., anterior cervical and lumbar spinal plates, and other orthopedic/medical devices necessitating screw locking mechanisms. The exemplary embodiments improve the probability of a solid fusion.

[0011] The exemplary embodiments of a bi-directional fixating transvertebral (BDFT) screw/cage apparatus provide as strong or stronger segmental fusion as pedicle screws without the complications arising from pedicle screw placement, which include misplacement with potential nerve and/or vascular injury, violation of healthy facets, possible pedicle destruction, blood loss, and overly rigid fusions. By placing screws across the intervertebral space from vertebral body to vertebral body, engaging anterior and middle spinal columns and not the vertebral bodies via the transpedicular route thereby excluding the posterior spinal column, then healthy facet joints, if they exist, are preserved. Because the present invention accomplishes both anterior and middle column fusion, without rigidly fixating the posterior column, the present invention in essence creates a flexible fusion.

[0012] The present invention recognizes that the very advantage of transpedicular screws which facilitate a strong solid fusion by rigidly engaging all three spinal columns is the same mechanical mechanism whereby complete inflexibility of all columns is incurred thereby leading to increasing rostral and caudal segmental stress which leads to an increased rate of re-operation.

[0013] Transvertebral fusion also leads to far less muscle retraction, blood loss and significant reduction in operating room (O.R.) time. Thus, the complication of pedicle screw pull out, and hence, high re-operation rate associated with the current embodiment of flexible fusion pedicle screws/rods is obviated. The lumbosacral intervertebral cage/BDFT screw constructs can be introduced via posterior, lateral, transforaminal or anterior interbody fusion approaches/surgical techniques. Although one can opt to supplement these constructs with transpedicular screws there would be no absolute need for supplemental pedicle screw fixation with these operative techniques.

[0014] The anterior placement of a bi-directional fixating transvertebral (BDFT) screw/cage apparatus according to the embodiments of the present invention into the cervical and lumbar spine obviates the need for supplemental anterior cervical or anterior lumbar plating. The sole purpose of these plates is to prevent intervertebral device extrusion. This function is completely obviated and replaced by the dual functioning bi-directional fixating transvertebral (BDFT) screw/cage apparatus, according to the present invention. The obvious advantage of this is a significant savings in operative time, and prevention of injuries associated with plating, in particular esophageal, large and small vessel injuries, and spinal cord nerve root injuries.

[0015] Because the embodiments of the bi-directional fixating transvertebral (BDFT) screw/cage apparatus engage a small percentage of the rostral and caudal vertebral body surface area, multi-level fusions can be performed with these devices.

[0016] Conventionally, failed anterior lumbar arthroplasties are salvaged by combined anterior and posterior fusions. Intervertebral cage/BDFT screw constructs may be utilized as a one-step salvage mechanism for failed/extruded anteriorly placed lumbar artificial discs obviating the need for supplemental posterior pedicle screws and/or anterior lumbar plating thereby significantly reducing and/or eliminating co-morbidities associated with these other salvage procedures.

[0017] Likewise, anterior cervical intervertebral cage/BDFT screw construct placement can be used to salvage failed anterior cervical arthroplasties, and re-do fusions without having to supplement with cervical anterior plates, thereby reducing the morbidity of this procedure.

[0018] In addition, if a patient develops a discogenic problem necessitating anterior cervical discectomy and fusion at a level above or below a previously fused and plated segment, the present invention reduces or eliminates the need to remove the prior plate in order to place a new superior plate, because the function of the plate is replaced by the dual functioning intervertebral cervical construct, thereby reducing the operating room time and surgical morbidity of this procedure.

[0019] Furthermore, because of the orientation and length of the BDFT screws within the intervertebral cage/BDFT constructs, multiple level fusions can be easily performed.

[0020] For example, an exemplary embodiment is directed to an intervertebral cage spacer and bi-directional fixating/fusion transvertebral body screw/cage apparatus. The apparatus can include an intervertebral cage for maintaining disc height. The intervertebral cage may include a first internal screw guide and a second internal screw guide which narrow from top to bottom having an approximate angle of 25 degrees. However, the angles can vary up to forty degrees.

The upper superior and inferior walls of the cage bordering the edge of the top of the cage, positioned midway between the two central internal screw guides, have novel indentations for insertion of a vertical screw-locking hemi-bracket. The apparatus may further include a first screw member having a screw with a tapered end and a threaded body disposed within the intervertebral cage, a second screw member with a tapered end and a threaded body disposed within the intervertebral cage, and a vertical hemi-bracket covering the medial-vertical aspect of two adjacent screws which snaps into the indentations of the superior and inferior sides of the cage which are located at a midpoint between the two adjacent internalized screw guides. The locking mechanism may prevent the first screw member and the second screw member from pulling-out of the first internal screw guide and the second internal screw guide. The internal screw guides can be formed to narrow along a length of the screw guide in a direction of descent into the screw guides, thereby providing a preliminary first locking mechanism when the screws engage the screw guides and are countersunk into the top of the cage. The exemplary embodiments of the vertical hemi bracket, which are locked into the cage and cover the screw heads, can provide a secondary additive locking mechanism in combination with the first locking mechanism, thereby definitively preventing screw back out. In other embodiments, only the exemplary embodiments of the vertical hemi bracket, which are locked into the cage and cover the screw heads (or a part of the screw heads), may be provided to function as a primary locking mechanism for definitively preventing screw back out.

[0021] Another exemplary embodiment is directed to an integral intervertebral cage spacer and bi-directional fixating/fusion transvertebral body screw apparatus, including an intervertebral cage having a plurality of internal angled screw guides which are inserted into the posterior lumbosacral disc space on either the left or right, or both sides.

[0022] In order to achieve screw bone penetration in such a constricted space the internalized screw guides/screw must be located very close to each other and must be obliquely, not horizontally or vertically aligned. The intervertebral cage may include a first internal screw guide and a second internal screw guide which narrow from top to bottom having an approximate angle of twenty five degrees. The angles can vary up to forty degrees. The upper superior and inferior walls of the cage bordering the top of the cage, midway between the two central internal screw guides have novel indentations for insertion of a vertical screw-locking hemi-bracket. The apparatus further includes a first screw member having a screw with a tapered end and a threaded body disposed within the intervertebral cage, a second screw member with a tapered end and a threaded body disposed within the intervertebral cage, and a vertical hemi-bracket covering the medial aspect of two adjacent screws which snaps into the superior and inferior sides of the cage which are located at a midpoint between the two adjacent internalized screw guides. This locking mechanism prevents the first screw member and the second screw member from pulling-out of the first internal screw guide and the second internal screw guide. The internal screw guides can be formed to narrow along a length of the screw guide in a direction of descent into the screw guides, thereby providing a preliminary first locking mechanism when the screws engage the screw guides and are countersunk into the top of the cage. The exemplary embodiments of the vertical hemi

bracket, which are locked into the cage and cover the screw heads (or a part of the screw heads), can provide a secondary additive locking mechanism in combination with the first locking mechanism, thereby definitively preventing screw back out. In other embodiments, only the exemplary embodiments of the vertical hemi bracket, which are locked into the cage and cover the screw heads, may be provided to function as a primary locking mechanism for definitively preventing screw back out.

[0023] Another exemplary embodiment is directed to a method of inserting a bi-directional fixating transvertebral (BDFT) screw/cage apparatus between a first vertebral body and a second vertebral body. The method can include measuring a dimension of a disc space between the first vertebral body and the second vertebral body, determining that the disc space is a posterior or lateral lumbar disc space, an anterior lumbar disc space, or an anterior cervical disc space, selecting an intervertebral cage based on the measured dimension of the disc space and based on the determination of the disc space being the posterior lumbar disc space, the lateral lumbar disc space, the anterior lumbar disc space, or the anterior cervical disc space, inserting the selected intervertebral cage into a midline of the disc space until the selected intervertebral cage is flush or countersunk relative to the first vertebral body and the second vertebral body, inserting a first screw member into a first internal screw guide of the selected intervertebral cage, inserting a second screw member into a second internal screw guide of the selected intervertebral cage, screwing the first screw member and the second screw member into the first vertebral body and the second vertebral body respectively, confirming a position and placement of the intervertebral cage relative to the first vertebral body and the second vertebral body, and locking the first screw member and the second screw member in a final position by its final turn when it's flush with the surface of the cage. The vertical hemi bracket when inserted and locked into the cage indentations may cover the medial aspects of the screws and therefore may prevent screw back-out when the screws are in their final resting positions.

[0024] The posterior lumbar BDFT cage screw apparatus is uniquely designed in order to get into the posterior space and obtain proper screw angulations. Two exemplary embodiments are described; one that is rectangular and one that is elliptical and concave mimicking the posterior intervertebral disc space. In both exemplary embodiments, the axes of the internal screw guides are not horizontally or vertically aligned as they are in the cervical embodiment. Their axes must be oblique one to the other, and the screw guides must be very close to one another in order for the screws to achieve proper angulation, trajectory and vertebral body penetration in such a restricted posterior lumbar inter space.

[0025] In the embodiments having an anterior lumbar embodiment four screw design, in order to achieve maximal stability and to prevent subsidence, the lateral two screws penetrate the inferior vertebral body, and the middle two screws project to the superior vertebral body.

[0026] In all BDFT embodiments, the screw angle guides have an approximate twenty five degree angle. However, the angles can go up to forty degrees. The angles can be variable or divergent i.e. two adjacent screws can be angled laterally, medially or divergent with respect to each other i.e. one angled laterally and the other angled medially.

[0027] In all embodiments the screw drill guide narrows such that the screw head is countersunk into the cage and thus it can be locked even in the absence of an additional screw locking mechanism. The screw locking mechanism described herein is yet an additional mechanism guaranteeing the prevention of screw back out/pull out.

BRIEF DESCRIPTION OF THE DRAWINGS

[0028] The accompanying drawings are presented to aid in the description of embodiments of the invention and are provided solely for illustration of the embodiments and not limitation thereof.

[0029] FIG. 1A illustrates a top, perspective (oblique) view of a vertical hemi-bracket screw locking device according to an embodiment of the invention.

[0030] FIG. 1B illustrates a side (anterior-posterior) view of a vertical hemi-bracket screw locking device according to an embodiment of the invention.

[0031] FIG. 1C illustrates a side (lateral) view of a vertical hemi-bracket screw locking device according to an embodiment of the invention.

[0032] FIG. 2A illustrates a top view of an anterior cervical intervertebral cage/BDFT screw construct according to an embodiment of the invention.

[0033] FIG. 2B illustrates a bottom, perspective (bottom isometric) view of an anterior cervical intervertebral cage/BDFT screw construct according to an embodiment of the invention.

[0034] FIG. 2C illustrates a side view of an anterior cervical intervertebral cage/BDFT screw construct according to an embodiment of the invention.

[0035] FIG. 2D illustrates a front, perspective (front isometric) view of an anterior cervical intervertebral cage/BDFT screw construct according to an embodiment of the invention.

[0036] FIG. 2E illustrates a top, perspective, partially exploded (bottom isometric) view of an anterior cervical intervertebral cage/BDFT screw construct according to an embodiment of the invention.

[0037] FIG. 2F illustrates a side, perspective, exploded view of an anterior cervical intervertebral cage/BDFT screw construct with internalized angled screw guides according to an embodiment of the invention.

[0038] FIG. 2G illustrates a top, perspective, exploded (top isometric) view of an anterior cervical intervertebral cage/BDFT screw construct with visualized internalized angled screw guides according to an embodiment of the invention.

[0039] FIG. 3A illustrates a top view of an anterior lumbar intervertebral cage/BDFT screw construct according to an embodiment of the invention.

[0040] FIG. 3B illustrates a bottom view of an anterior lumbar intervertebral cage/BDFT screw construct according to an embodiment of the invention.

[0041] FIG. 3C illustrates a front, perspective view of an anterior lumbar intervertebral cage/BDFT screw construct according to an embodiment of the invention.

[0042] FIG. 3D illustrates a side, perspective view of an anterior lumbar intervertebral cage/BDFT screw construct according to an embodiment of the invention.

[0043] FIG. 3E illustrates a side, perspective view of an anterior lumbar intervertebral cage/BDFT screw construct according to an embodiment of the invention.

[0044] FIG. 3F illustrates a top, partially exploded view of an anterior lumbar intervertebral cage/BDFT screw construct according to an embodiment of the invention.

[0045] FIG. 3G illustrates a perspective, exploded view of an anterior lumbar intervertebral cage/BDFT screw construct according to an embodiment of the invention.

[0046] FIG. 4A illustrates a top view of a posterior lumbar rectangularly designed intervertebral cage/BDFT construct according to an embodiment of the invention.

[0047] FIG. 4B illustrates a front, perspective view of a posterior lumbar rectangularly designed intervertebral cage/BDFT construct according to an embodiment of the invention.

[0048] FIG. 4C illustrates a side, perspective view of a posterior lumbar rectangularly designed intervertebral cage/BDFT construct according to an embodiment of the invention.

[0049] FIG. 4D illustrates a front, perspective view of a posterior lumbar rectangularly designed intervertebral cage/BDFT construct according to an embodiment of the invention.

[0050] FIG. 4E illustrates a top, perspective, partially exploded view of a posterior lumbar rectangularly designed intervertebral cage/BDFT construct according to an embodiment of the invention.

[0051] FIG. 4F illustrates a top, perspective, exploded view of a posterior lumbar rectangularly designed intervertebral cage/BDFT construct according to an embodiment of the invention.

[0052] FIG. 5A illustrates a top view of a posterior lumbar elliptically designed intervertebral cage/BDFT construct according to an embodiment of the invention.

[0053] FIG. 5B illustrates a front, perspective view of a posterior lumbar elliptically designed intervertebral cage/BDFT construct according to an embodiment of the invention.

[0054] FIG. 5C illustrates a side view of a posterior lumbar elliptically designed intervertebral cage/BDFT construct according to an embodiment of the invention.

[0055] FIG. 5D illustrates a front, perspective (front isometric) view of a posterior lumbar elliptically designed intervertebral cage/BDFT construct according to an embodiment of the invention.

[0056] FIG. 5E illustrates a top, perspective, partially exploded view of a posterior lumbar elliptically designed intervertebral cage/BDFT construct according to an embodiment of the invention.

[0057] FIG. 5F illustrates a top, perspective, exploded view of a posterior lumbar elliptically designed intervertebral cage/BDFT construct according to an embodiment of the invention.

[0058] FIG. 6A illustrates a perspective view of an intervertebral cage construct according to an embodiment of the invention.

[0059] FIG. 6B illustrates another perspective view of an intervertebral cage construct according to an embodiment of the invention.

[0060] FIGS. 6C(i) and 6C(ii) illustrate top, perspective view of an intervertebral cage construct according to an embodiment of the invention.

[0061] FIG. 6D illustrates a top, perspective, exploded view of a positioning tool/screw guide/box expander.

[0062] FIG. 6E illustrates a superior oblique perspective view of the positioning tool/drill guide/box expander component.

DETAILED DESCRIPTION OF THE EXEMPLARY EMBODIMENTS

[0063] Aspects of the invention are disclosed in the following description and related drawings directed to specific embodiments of the invention. Alternate embodiments may be devised without departing from the scope of the invention. Additionally, well-known elements of the invention will not be described in detail or will be omitted so as not to obscure the relevant details of the invention.

[0064] The word “exemplary” is used herein to mean “serving as an example, instance, or illustration.” Any embodiment described herein as “exemplary” is not necessarily to be construed as preferred or advantageous over other embodiments. Likewise, the term “embodiments of the invention” does not require that all embodiments of the invention include the discussed feature, advantage or mode of operation.

[0065] With reference to FIGS. 1A-6E, exemplary embodiments of the invention will now be described.

[0066] 1. Exemplary Medical Device

[0067] Referring to FIGS. 1A-6E the above described problems of the conventional art can be solved in the cervical, thoracic and lumbosacral spines by insertion into the denuded intervertebral disc space multiple embodiments of a bi-directional fixating transvertebral (BDFT) screw/cage apparatus.

[0068] For example, FIGS. 1A-1C illustrate three-dimensional views of an exemplary embodiment of a vertical hemi-bracket 20. In this embodiment, the bracket 20 drapes over the screw heads (or at least a portion thereof) of screws 30, 40 (FIGS. 2A-5F) and is secured to (e.g., snaps into or onto) a portion of a cage 10, 110, 210 (FIGS. 2A-5F) thereby preventing screws 30, 40 from backing out of the cage 10, 110, 210. The bracket 20 can include a base 1 with arms 3 attached to the base 1. The arms 3a, 3b can extend away from the base 1 such that cage 10, 110, 210 interposes the arm 3a, 3b when the bracket 20 is engaged with the cage 10, 110, 210. In the illustrated exemplary embodiment, the arms 3 can be attached on opposite sides/ends of the base 1. However, in other embodiments, the arms 3 can be attached anywhere along the base 1. The arms 3 can include, for example, a superior arm 3a and an inferior arm 3b (e.g., a first arm and a second arm). In other embodiments, one or more arms can be provided on either side of the base 1. For example, a first arm (e.g., 3a) can extend from a first side of the base 1 and a second arm (e.g., 3b) can extend from a second side (opposite side) of the base 1. In still other embodiments, a number of arms on the first side of the base 1 can be different from a number of arms on the second side of the base 1. For example, two arms can extend from a first side of the base 1 and a single arm can extend from a second side (opposite side) of the base 1, or two arms from a first side of the base 1 and three arms from a second side (opposite side) of the base 1, etc. Other numbers of arms and arrangements are possible within the spirit and scope of the invention.

[0069] The superior arm 3a and inferior arm 3b can snap onto or snap-lock into the base 1. The superior arm 3a and inferior arm 3b can be resilient or flexible such that the arms 3a, 3b can be secured to the base 1 by the resilient arms

pressing against the sides of the cage 10, 110, 210. The arms 3a, 3b can be secured by frictional forces or by corresponding engaging features formed on a part of the arms 3a, 3b and/or the cage 10, 110, 210.

[0070] For example, a portion of the superior arm 3a and inferior arm 3b can snap-lock into indentations 70, 194, 290 of the superior and inferior walls of the cage 10 (FIGS. 2A-5F), respectively. In an exemplary embodiment, each of the superior arm 3a and inferior arm 3b can include a medial protuberance 5 emanating and projecting from an inferior aspect of one or more of the arms 3a, 3b. The protuberances 5 can snap into corresponding cage indentations 70, 194, 290 (FIGS. 2A-5F), thereby locking the bracket 20 on the cage 20, 110, 210 and preventing screws 30, 40 from backing out of the cage 10, 110, 210. In another example, a portion of the superior arm 3a and inferior arm 3b can engage a portion of ridges 50 formed on the superior and inferior surfaces or edges of the lumbar cage 10.

[0071] FIGS. 2A-2G illustrate three-dimensional views of an embodiment of an exemplary anterior cervical intervertebral cage/BDFT construct 10. In this embodiment, the top portion of the cage 10 has indentations 70 that are on the upper superior and inferior walls midway between the two internalized screw guides/screws 80, 90 (FIGS. 2E-2G). The vertical hemi bracket 20 snaps into these indentations 70.

[0072] The cage 10 also can include indentations or slots 12 on both side surfaces of the cage 10 for insertion of a prong of an implantation tool (see example cage and tool in FIG. 6D); the cage 10 can engage the tool in a similar manner, and more particularly, that engage the distal medial oriented male protuberance of a lateral griper prong of an implantation tool.

[0073] In the illustrated embodiment, the indentations 70 are formed on difference side surfaces from the indentations 12, for example, to avoid interference with the insertion tool accessing the indentations 70 of the cage. However, in other embodiments, the indentations 70 and the indentations 12 can be formed on a same side surface. Also, the indentations 70 can be formed at locations other than midway between the screw guides. The indentations 70 can have a variety of shapes and depths. For example, the indentations 70 can have a shape corresponding to a shape of a medial protuberance 5 emanating and projecting from an inferior aspect of one or more of the arms 3a, 3b. In other embodiments, the size and shape of the indentations 70 can be different from the medial protuberance 5 of the arms 3a, 3b.

[0074] In an exemplary embodiment, a side surface of the cage 10 can be elliptically contoured when viewed from the side (FIG. 1C) to fit into the bi-concave cervical disc space. The embodiment includes two screws 30, 40. A first screw 30 is oriented rostrally (superiorly) and a second screw 40 is oriented caudally (inferiorly). The cage 10 can include a cavity 60 for bone product placement.

[0075] The cage 10 can also include two built in internalized screw/drill guides 80, 90 (e.g., having approximately a 25 degree angulation; in other embodiments, the angulation can be up to 40 degrees), one for each screw 30, 40, which orient the screws 30, 40 bi-directionally in opposite directions (FIGS. 2E-2G). In an embodiment, the cage includes at least one screw guide 80 or 82 having a predetermined trajectory (e.g., preferably having a 25 degree angulation) that may make placement of all screws equally facile, more amenable to multi-level placement, and may diminish the need for external drill guides. In other embodiments, the

cage includes at least two screw guides **80**, **82** having a predetermined trajectory (e.g., preferably having a 25 degree angulation) that may make placement of all screws equally facile, more amenable to multi-level placement, and may diminish the need for external drill guides. In other embodiments, the cage can include a screw guide **80**, **82** having another predetermined trajectory, such as an angulation of substantially 25 degrees (e.g., an angulation ranging from 20 degrees to 30 degrees). In other embodiments, the cage can include a screw guide **80**, **82** having another predetermined trajectory, such as an angulation ranging from 20 degrees to 25 degrees, an angulation ranging from 25 degrees to 30 degrees, an angulation ranging from 25 degrees to 35 degrees, an angulation ranging from 25 degrees to 35 degrees, an angulation ranging from 20 degrees to 40 degrees, an angulation ranging from 25 degrees to 40 degrees, etc. The embodiments of the cage can include one or more screw/drill guides **80**, **82** having different angles and/or different positions within the cage.

[0076] The cage **10** can include a screw guide tunnel exit **13** adjacent to the bone cavity **60** (FIG. 2D). The screw guide tunnel can be configured to narrow along the length of the tunnel in a direction of descent into the cage **10**. One of ordinary skill in the art will recognize that the internalized screw/drill guides **80**, **90** can have different degrees of angulation and/or different positions within the cage **10**. The built in tunnels of the screw guides **80**, **90** provide an important advantage of ensuring that only a single prescribed angled trajectory is possible for transvertebral screw placement. The built in tunnels narrow (cone down) going downward. This facilitates the locking of the screw head to the top of the cage even in the absence of the locking mechanism described herein. Embodiments of the intervertebral cages **10** can be designed with internalized screw/drill guides **80**, **90** with different angles and/or different positions within the cage. The angle and size of the screws **30**, **40** make them amenable to single or multi-level placement. The superior and inferior surfaces or edges of the lumbar cage **10** can include ridges **50** or the like to facilitate integration and fusion with superior and inferior vertebral bodies. Any other method of bone integration may be used, such as, e.g., spikes in varying sizes and geometric arrays.

[0077] The embodiment can include a vertical hemi-bracket **20** which can be, for example, snapped into the superior and inferior upper wall indentations **70** in between the two screws guides **80**, **90** located on top of the cage **10**. The vertical hemi-bracket **20** can be manufactured from a variety of materials, such as titanium. When the screws **30**, **40** are turned, the first screw member **30** and the second screw member **40** are locked in a final position by its final turn when the screw head is flush with the surface of the cage **10**. The narrowing (coning down) of the internal screw guides **80**, **90** acts as an initial preliminary screw locking mechanism by hugging the top of the screw at its junction with the screw head. The vertical hemi-bracket **20** which covers the medial aspect or head of both screws **30**, **40** (or a portion thereof), and when snapped into the cage indentations **70** prevents screw back out or pull out from the tunnels of the cage. These novel exemplary embodiments are quite unique and different from all other conventional screw locking mechanisms.

[0078] FIGS. 3A-3G illustrate three-dimensional views of an exemplary embodiment of an anterior lumbar intervertebral cage/BDFT construct. In this embodiment, the cage

110 includes indentations **194** on the upper superior and inferior walls of the top portion of the cage **110** midway between each of the two adjacent internalized screw guides **190**, **192** (FIGS. 3F-3G). The two vertical hemi-brackets **120** can snap into each of the indentations **194** such that there is one bracket **120**, for each pair of adjacent screws (i.e. one for screws **130**, **140**, and one for screws **150**, **160**). In the embodiment, the screws **130**, **140** and screws **150**, **160** are locked into the tunnels of the cage **110** with the two hemi-brackets **120**. The cage **110** can include additional indentations **12** on both side surfaces for insertion of prongs of an implantation tool. Further, cage **110** can be larger than the cervical cage **10** and also can include an elliptically contoured sidewalls when viewed from the side to fit into the bi-concave lumbar disc space (FIG. 3D). The cage **110** may include four (4) horizontally aligned internalized screw guides **190**, **192** for four (4) screws **130**, **140**, **150**, **160**. The two lateral (left and right) screws **130**, **160** can be oriented inferiorly, and the two middle screws **140**, **150** can be oriented superiorly. The axes of these guides **190**, **192** and screws **130**, **140**, **150**, **160** are not perfectly horizontal with respect to each other. Each lateral screw guide/screw can be obliquely oriented with respect to its adjacent medial screw guide/screw. In this manner, the exemplary embodiments can achieve the proper trajectory for bone penetration along with the precise angle of the screw guides **190**, **192**. The screw guide tunnel exits **13** are illustrated in FIG. 3C and are in continuity (connected) with the enlarged bone cavity **180**. In the embodiment, the orientations of the four screw guides **190**, **192** (and screws **130**, **140**, **150**, **160**) are selected because of their symmetry and inherent stability.

[0079] The cage **110** can include a large cavity **180** for bone product placement. The cage **110** can include four built-in internalized screw/drill guides **190**, **192** (e.g., having an approximate 25 degree angulation; in other embodiments, the angulation can be up to 40 degrees), one for each screw **130**, **140**, **150**, **160**. Other embodiments of the intervertebral cage **110** can be designed with internalized screw/drill guides **190**, **192** with different angles and/or different positions within the cage **110**. The angle and size of the screws **130**, **140**, **150**, **160** make them amenable to single or multi-level placement. The superior and inferior surfaces or edges of the cage **110** can include ridges **170** or the like to facilitate integration and fusion with superior and inferior vertebral bodies. Other bone integration embodiments such as spikes can also be used. In this embodiment, there are no compartmental divisions in the cavity **180** for bone product placement to maximize the quantity of bone for fusion.

[0080] In this embodiment, there is one vertical hemi bracket **120** for two screws **130**, **140**, **150**, **160**. Yet, in other embodiments, one vertical hemi bracket **120** can be provided for each individual screw **130**, **140**, **150**, **160**, or vertical hemi bracket **120** can be provided for two or more screws **130**, **140**, **150**, **160**. The top of the cage **110** can include indentations **194** on the superior and inferior upper sides of the cage **110** that are engaged the vertical hemi bracket **120** (e.g., by snapping a portion of the bracket into the indentation **194**). The bracket **120** can be manufactured from a variety of materials, such as bio-compatible materials, such as titanium.

[0081] In operation, when each of the screws **130**, **140**, **150**, **160** are turned, each of the screws **130**, **140**, **150**, **160** is locked in a final position by a final turn of the screw when the screw head is flush with the surface of the cage **110**. The

narrowing of the internal screw guides **190**, **192** can act as an initial preliminary screw locking mechanism by hugging the top of the screw/screw head interface (e.g., at its junction with the screw head). One vertical hemi-bracket **120** covers the medial aspect (or portion thereof) of the first two screws, **130**, **140**, and another vertical hemi bracket **120** covers the medial aspect (or portion thereof) of the third and fourth screws **150**, **160**. When the brackets are snapped and/or locked into the cage indentations **194**, screw back out or pull out of all four screws can be prevented.

[0082] The internal screw guide tunnels **190**, **192** can be formed to narrow along a length of the screw guide in a direction of descent into the screw guides, thereby providing a preliminary first locking mechanism when the screws **130**, **140**, **150**, **160** engage the screw guides and are countersunk into the top of the cage **110**. The exemplary embodiments of the bracket **120**, which are locked into the cage **110** and cover at least a portion of the screw heads, can provide a secondary additive locking mechanism in combination with the first locking mechanism, thereby definitively preventing screw back out. In other embodiments, only the exemplary embodiments of the bracket **120**, which is locked into the cage **110** and covers the screw heads (or a part of the screw heads), may be provided to function as a primary locking mechanism for definitively preventing screw back out.

[0083] The exemplary embodiments are an evolutionary advance and improvement to the apparatus illustrated in the aforementioned related applications of Applicants, and are quite unique and different from all other conventional locking mechanisms used for other types of anterior lumbar cages.

[0084] For example, a known conventional device has been provided that relates to anterior placed lumbar implants with perforating screws. Such possible conventional devices conceivably may include a horseshoe implant having a plurality of cylindrical holes with smooth inner surfaces and comprise only one stop for the heads of the bone screws to be inserted into them. The placement of five cylindrical holes is oriented within the cage in a non-symmetric manner.

[0085] In comparison, the exemplary embodiments differ in many substantial ways from the conventional devices. For example, the exemplary embodiments provide a symmetric orientation of the screw holes, as well as a screw locking mechanism. The exemplary embodiments also provide an angulation/trajectory (e.g., an approximate twenty five degree angulation/trajectory) for preventing pull-out or back-out of the screws that would make placement of all screws in a manner which would lead to maximum stability of the construct within the vertebral space, and obviate the need for external drill guides, and surgeon trajectory angulation guess work.

[0086] In another possible conventional device, multiple embodiments of lumbar intervertebral implants are presented which include one with internally threaded bore holes, another embodiment with a front plate mounted at the front surface of the implant, and another embodiment with the front plate displaceably configured to move vertically relative to the implant. In addition, such devices may provide preferred borehole axes of 35-55 degrees. These conventional devices may have four screw perforations that are not aligned four in a row. Two of the screw holes are laterally placed on the left, one on top of each other, the top one with a superior trajectory, and the bottom with an inferior trajectory. Likewise, two perforations are placed on

the right, one on top of each other, the top one with a superior trajectory and the bottom one with an inferior trajectory. The disclosed screw locking mechanism is a screw with an external thread matching the internal borehole thread, or spiral springs.

[0087] In comparison, the anterior lumbar construct of the exemplary embodiments differs in many substantial ways from the conventional devices. The exemplary embodiments include a single cage construct with four (4) internalized drill guides arranged horizontally in a row. The lateral screw guides/screws are obliquely oriented with the respect to their adjacent medial screw guides/screws. The middle two screws are oriented superiorly, and the lateral left and right screws are oriented inferiorly. This symmetric alignment of screws and orientations within the superior and inferior vertebral bodies (e.g., two middle superiorly projecting screws, and two laterally projecting inferior screws) make the fixation to the superior and inferior vertebral bodies much more symmetric and thus more stable, thereby preventing subsidence. In an exemplary embodiment, the cage includes a screw guide having a predetermined trajectory (e.g., an approximate trajectory of 25 degrees to 40 degrees) that makes placement of all screws equally facile, more amenable to multi-level placement, and diminishes the need for external drill guides. Furthermore, the exemplary screw locking mechanism is unique and differs substantially from the conventional approach of matching screw/cage threads or spiral springs.

[0088] FIGS. 4A-4F illustrate three-dimensional views of an exemplary embodiment of a posterior lumbar rectangular intervertebral cage/BDFT construct. In this embodiment, the top portion of the cage **210** includes indentations **290** that are positioned on the upper superior and inferior walls midway between the two internalized screw guides **270**, **280** (FIG. 4F). The vertical hemi bracket **220** snaps into these indentations **290**. The cage **210** also includes additional indentations **12** on both side surfaces of the construct for the prong placement of an implantation tool. The screws **230**, **240** perforate and orient in opposing superior and inferior directions.

[0089] The cage **210** can include a cavity **250** for bone product placement. In an exemplary embodiment, a side surface of the cage **210** can be elliptically contoured when viewed from the side (FIG. 4C) to fit into the bi-concave cervical disc space. In an exemplary embodiment, the top and bottom portions of the rectangular cage **210** can be elliptically contoured to naturally fit into the bi-concave intervertebral disc space (FIG.4C). The top portion of the cage can be square-shaped with equal width and length. Also, in contrast to the cervical cage **10** of the previous embodiments, the depth dimension of the cage **210** far exceeds its width. The width is very narrow to prevent nerve root retraction/injury when being placed posteriorly. The cage **210** can also include built-in internalized screw/drill guides **270**, **280** having a predetermined angled trajectory (e.g., having an approximate 25 to 40 degree angulation), and their axes are not horizontal, but oblique one to the other and very close to each other (FIG. 4F). Each screw/drill guides **270**, **280** can occupy one corner of a square, obliquely oriented one to the other (FIGS. 4A and 4F). This is necessary to achieve proper screw angulation, trajectory and bone penetration in a narrow posterior lumbar interspace. One of the screw guides is angled rostrally (superiorly) (e.g., screw guide **270**) and the other caudally (inferiorly)

orly) (e.g., screw guide 280). The intervertebral cages 210 can be designed with internalized screw/drill guides 270, 280 with different angles and/or different positions within the cage 210. Because the tunnel of the screw guide 270, 280 narrows (cones down), when the screw 230, 240 is countersunk on top of the cage 210, the screw 230, 240 can be preliminarily locked, even in the absence of this locking mechanism. The cage 210 can include the narrowing tunnel and/or bracket 220 for preventing backing out of the screws. The angle and size of the screws 230, 240 make them amenable to single or multi-level placement. A screw guide exit tunnel can be formed adjacent to the bone cavity 250. The superior and inferior surfaces or edges can include ridges or the like to facilitate integration and fusion with superior and inferior vertebral bodies. The surfaces can be alternatively or in supplement, have additional bone integration mechanisms, e.g. spikes having various sizes and arrangements. One of these constructs is placed posteriorly into the intervertebral space either on the left side, the right side, or both sides.

[0090] An embodiment can also include a cage 210 which includes a vertical hemi bracket locking mechanism 220 that can be, for example, snapped into the indentations 290 on the upper aspects of the superior and inferior sides of the cage 210. The vertical hemi bracket locking mechanism 220 can be manufactured from a variety of materials, such as bio-compatible materials, such as titanium. In operation, when the screws 230, 240 are turned, each of the first screw member 230 and the second screw member 240 is locked in a final position by a final turn of the screw when the screw head is flush with the surface of the cage 210. The narrowing of the internal screw guides 270, 280 can act as an initial preliminary screw locking mechanism. The vertical hemi-bracket 220 covering the medial aspect (or a portion thereof) of both screws 230, 240 when snapped into the cage indentations 290 can prevent screw back out or pull out.

[0091] These novel exemplary embodiments are quite unique and different from all other conventional screw locking mechanisms.

[0092] FIGS. 5A-5F illustrates three-dimensional views of an exemplary embodiment of a posterior lumbar elliptical intervertebral cage/BDFT construct. In this embodiment, the top portion of the cage 210 includes indentations 290 that are positioned on the upper superior and inferior walls midway between the two internalized screw guides/screws 270, 280 (FIG. 5F). The vertical hemi bracket 220 snaps into these indentations 290. The cage 210 also includes additional indentations 12 on both side surfaces of the construct for the prong placement of an implantation tool. The screws 230, 240 perforate and orient in opposing superior and inferior directions.

[0093] The cage 210 can include a cavity 250 for bone product placement. In an exemplary embodiment, the entire body (or at least the side walls) of the cage 210 is elliptical when viewed from the side (FIG. 5C), as opposed to the top and bottom portions of the rectangular cage 210 described in the previous embodiment (FIG. 4C). Further, in this embodiment, the cage 210 can be contoured to naturally fit into the bi-concave intervertebral disc space (FIG. 5C).

[0094] The cage 210 can also include built-in internalized screw/drill guides 270, 280 having a predetermined angled trajectory (e.g., having an approximate 25-40 degree angulation), and their axes are not horizontal or vertical, but oblique one to the other and very close to each other. Each

screw guide/screw occupies one corner of a square, obliquely oriented one to the other (FIGS. 5A and 5F). In this manner, the exemplary embodiment can achieve proper screw angulation, trajectory, and bone penetration in so narrow a posterior lumbar interspace. One of the screw guides can be angled rostrally (superiorly) (e.g., screw guide 270) and the other caudally (inferiorly) (e.g., screw guide 280). The intervertebral cages 210 can be designed with internalized screw/drill guides 270, 280 with different angles and/or different positions within the cage 210. In an embodiment, the tunnel of the screw guide 270, 280 narrows (cones down) and hugs the screw(s) 230, 240 at the screw-screw head interface such that, when the screw is countersunk on top of the cage 210, the screw(s) 230, 240 can be preliminarily locked, even in the absence of an additional locking mechanism. The exemplary embodiments of the bracket 220, which are locked into the cage 210 and cover at least a portion of the screw heads, can provide a secondary additive locking mechanism in combination with the first locking mechanism provided by the screw guides, thereby definitively preventing screw back out. In other embodiments, only the exemplary embodiments of the bracket 220, which is locked into the cage 210 and covers the screw heads (or a part of the screw heads), may be provided to function as a primary locking mechanism for definitively preventing screw back out. The angle and size of the screws 230, 240 make them amenable to single or multi-level placement. The screw guide exit tunnel 13 adjacent to the bone cavity 250 is illustrated in FIG. 5B. The superior and inferior surfaces or edges can include ridges or the like to facilitate integration and fusion with superior and inferior vertebral bodies. One of these constructs is placed posteriorly into the intervertebral space either on the left side, the right side, or both sides.

[0095] The embodiment can include a cage 210 which includes a vertical hemi bracket locking mechanism 220 that can be, for example, snapped into the indentations 290 on the upper aspects of the superior and inferior sides of the cage 210. The vertical hemi bracket locking mechanism 220 can be manufactured from a variety of materials, such as titanium. When the screws 230, 240 are turned, the first screw member 230 and the second screw member 240 are locked in a final position by its final turn when the screw head is flush with the surface of the cage 210. The narrowing of the internal screw guides 270, 280 act as an initial preliminary screw locking mechanism. The vertical hemi-bracket 220 covering the medial aspect (or a portion thereof) of both screws 230, 240 when snapped into the cage indentations 290 prevent screw back out or pull out.

[0096] The exemplary embodiment of this novel intervertebral cage 210 is an evolutionary compliment to the apparatus illustrated in the aforementioned related applications. The novel cage 210 also is quite unique and different from other conventional locking mechanisms used for other known cervical and lumbar anterior or posterior plate screws. No other conventional posterior lumbar intervertebral cage BDFT/screw constructs are known.

[0097] The embodiments have been described with reference to the exemplary embodiments illustrated in the Figures. One of ordinary skill in the art will recognize that the embodiments are not limited to the illustrated embodiments and any of the features of any of the embodiments can be included in any other embodiment.

[0098] 2. Exemplary Surgical Method

[0099] Exemplary surgical steps for practicing one or more of the forgoing embodiments will now be described.

[0100] Anterior cervical spine placement of the intervertebral cage/BDFT screw construct **10** (FIG. 2) can be implanted via previously described techniques for anterior cervical discectomy and fusion. Some but not all of these techniques include, open, microscopic, closed endoscopic or tubular. Fluoroscopic or any other form of visualized guidance can be used for this procedure.

[0101] After the adequate induction of anesthesia, the patient is placed in a supine position. An incision is made overlying the intended disc space or spaces, and the anterior spine is exposed. A discectomy is performed and the endplates exposed. The disc height is measured and an anterior cervical intervertebral cage of the appropriate disc height, width and depth is selected. The central cavity **60** is packed with bone fusion material, autologous bone graft, allograft, alone or in combination with any commercially available bone fusion promoting product. The cage **10** is then inserted into the midline of the anterior disc space routinely until it is flush or countersunk relative to the vertebral body above and below. The BDFT screws **30, 40** are then inserted into the internalized rostrally (superiorly) and caudally (inferiorly) angled screw guides **80, 90**. A drill with or without a drill guide can be used to prepare for screw placement. This is not absolutely necessary. Because the cage **10** has internalized screw guides **80, 90**, self-drilling/self-tapping screws **30, 40** of the appropriately selected lengths can be directly screwed into the vertebral bodies once placed into the internalized drill-guided angled tunnels. The cage's screw guides **80, 90**, which have internalized tunnels, direct the screws **30, 40** into the superior and inferior vertebral bodies in the predetermined angle of the internalized tunnels. There is no other angled trajectory other than that which is built into the internalized screw guide/tunnel of the cage **10** that the screw **30, 40** can be oriented in. Hence, according to this exemplary embodiment, there is no absolute need for fluoroscopic guidance.

[0102] Once the surgeon is satisfied with the position and placement of the cage **10**, the BDFT screws **30, 40** can then be locked into their final positions. When each of the BDFT screws **30, 40** are turned they penetrate and engage the bone until they are locked in a final position by its final turn when the screw head is flush with the surface of the cage **10**. The vertical hemi bracket **20** is then snapped into the upper superior and inferior cage indentations **70** covering the medial aspect of both screws.

[0103] Anterior or anteriolateral placement of thoracic or lumbar spine intervertebral cage/BDFT screw constructs **110** (FIG. 3) can be implanted via previously described surgical techniques for anterior lumbar discectomy, and transthoracic, anterior-lateral thoracic discectomy. Some but not all of these techniques include, open, microscopic, closed endoscopic or tubular. Fluoroscopic or any other form of visualized guidance can be used for this procedure.

[0104] After the adequate induction of anesthesia and after the anterior spine is exposed a discectomy is performed and the endplates exposed. The disc height is measured and an anterior lumbar (or thoracic) intervertebral cage **110** of the appropriate disc height, width and depth is selected. The central cavity **180** is packed with bone fusion material, autologous bone graft, allograft, alone or in combination with any commercially available bone fusion promoting

product. The cage **110** is then inserted into the midline of the anterior disc space routinely until it is flush or countersunk relative to the vertebral body above and below. The four BDFT screws **130, 140, 150, 160** are then inserted into the two middle internalized rostrally (superiorly) and two lateral, caudally (inferiorly) angled screw guides **190, 192**. A drill with or without a drill guide **190, 192** can be used to prepare for screw placement. This is not absolutely necessary. Because the cage **110** has internalized screw guides **190, 192**, self-drilling/self-tapping screws **130, 140, 150, 160** of the appropriately selected lengths can be directly screwed into the vertebral bodies once placed into the internalized drill-guided angled tunnels. The cage's internalized guides **190, 192**, which have internalized tunnels, direct the screws **130, 140, 150, 160** into the superior and inferior vertebral bodies in the predetermined angle of the internalized tunnels. There is no other angled trajectory other than that which is built into the internalized screw guide/tunnel of the cage **110** that the screw **130, 140, 150, 160** can be oriented in. Hence there is no absolute need for fluoroscopic guidance.

[0105] Once the surgeon is satisfied with the position and placement of the cage **110**, the BDFT screws **130, 140, 150, 160** can then be locked into their final positions. When each of the BDFT screws **130, 140, 150, 160** are turned, they penetrate and engage the bone until they are locked in a final position by its final turn when the screw head is flush with the surface of the cage **110**. One vertical hemi bracket **120** is snapped into its corresponding cage indentations **194** thereby covering the medial aspects of the first two screws **130, 140**, and another vertical hemi bracket **120** is snapped into its respective cage indentations **194** thereby covering the medial aspects of the third and fourth screws **150, 160**.

[0106] Implantation of the posterior lumbar intervertebral cage/BDFT screw constructs **210** (FIGS. 4 and 5) can be performed via previously described posterior lumbar interbody fusion (PLIF) or posterior transforaminal lumbar interbody fusion (TLIF) procedures. The procedures can be performed open, microscopic, closed tubular or endoscopic techniques. Fluoroscopic guidance can be used with any of these procedures.

[0107] After the adequate induction of anesthesia, the patient is placed in the prone position. A midline incision is made for a PLIF procedure, and one or two parallel paramedian incisions or a midline incision is made for the TLIF procedure. For the PLIF procedure, a unilateral or bilateral facet sparing hemi-laminotomy is created to introduce the posterior lumbar construct into the disc space after a discectomy is performed and the space adequately prepared.

[0108] For the TLIF procedure, after unilateral or bilateral dissection and drilling of the inferior articulating surface and the medial superior articulating facet the far lateral disc space is entered and a circumferential discectomy is performed. The disc space is prepared and the endplates exposed.

[0109] The disc height is measured and a posterior lumbar intervertebral cage/BDFT screw construct **210** (FIGS. 4 and 5) of the appropriate disc height, width and depth is selected. The central cavity **250** is packed with bone fusion material, autologous bone graft, allograft, alone or in combination with any commercially available bone fusion promoting product. Then one construct **210** is placed on either right or left sides, or one construct **210** each is placed into left and right sides. The constructs **210** are inserted such they are

flush or countersunk relative to the superior and inferior vertebral bodies. In addition to the central cavities **250** that are packed with bone product, the intervertebral space in between the constructs **210** can also be packed with bone product for fusion.

[0110] The BDFT screws **230**, **240** are then inserted into internalized rostrally (superiorly) and caudally (inferiorly) angled screw guides **270**, **280**. A drill with or without a drill guide can be used to prepare for screw placement. This is not absolutely necessary. Because the cage **210** has internalized screw guides **270**, **280**, self-drilling/self-tapping screws **230**, **240** of the appropriately selected lengths can be directly screwed into the vertebral bodies once placed into the internalized drill-guided/angled tunnels **270**, **280**. The cage's internalized guides **270**, **280**, which have internalized tunnels, direct the screws **230**, **240** into the superior and inferior vertebral bodies in the predetermined angle of the internalized tunnels. There is no other angled trajectory other than that which is built into the internalized screw guide/tunnel **270**, **280** of the cage **210** that the screw **230**, **240** can be oriented in. Hence, unlike posterior placement of pedicle screws there is no absolute need for fluoroscopic or expensive and cumbersome, frameless stereotactic CT guidance.

[0111] Once the surgeon is satisfied with the position and placement of the cage **210**, the BDFT screws **230**, **240** can then be locked into their final positions. When each of the BDFT screws **230**, **240** with ratcheted screw heads are turned, the BDFT screws **230**, **240** penetrate and engage the bone until they are locked in a final position by its final turn when the screw head is flush with the surface of the cage **210**. The vertical hemi bracket **220** is then snapped into the upper superior and inferior cage indentations **290** of the cage **210** covering the medial aspect of both screws **230**, **240** and thus preventing screw back out or pull out.

[0112] The present inventions may provide effective and safe techniques that overcome the problems associated with current transpedicular based cervical, thoracic and lumbar fusion technology, as well as anterior cervical, thoracic and lumbar plating technology, and for many degenerative stable and unstable spinal diseases. These exemplary embodiments may replace much pedicle screw, and anterior plating based instrumentation in many but not all degenerative spine conditions.

[0113] The speed and simplicity of placement of anterior and posterior lumbar intervertebral cage/BDFT screw constructs, and placement of anterior cervical cage/BDFT screw constructs far exceeds that of current pedicle screw and anterior spinal plating technology. Furthermore, these devices have markedly significantly decreased risk of mis-guided screw placement and hence decreased risk of neurovascular injury, and blood loss. The lumbar and cervical intervertebral cage/BDFT screw constructs all would have decreased recovery time, and more rapid return to work time compared to pedicle screw, and plating technology. These devices with great probability lead to similar if not equal fusion rates, with substantially less morbidity, and hence, overall, make them a major advance in the evolution of spinal instrumented technology leading to advances in the compassionate care of the spinal patient.

[0114] FIGS. 6A, 6B, 6C(i), and 5C(ii) illustrate an exemplary embodiment of exemplary cage **200**. These features are shown for example purposes, are not limited to the cage **200**, and can be incorporated into any cage according to any

of the embodiments described herein. As shown in FIGS. 6C(i) and 6C(ii), the screw guides can be positioned within four (4) quadrants I, II, III, IV.

[0115] For example, the intervertebral cage can include a wall having an entry opening of the first integral screw guide and an entry opening of the second integral screw guide, wherein the wall of the cage can include four quadrants delineated by a first axis and a second axis each lying in a plane of the wall, and the first axis is at a right angle with respect to the second axis, wherein the four quadrants include a first quadrant, a second quadrant, a third quadrant, and a fourth quadrant, wherein the first quadrant and the fourth quadrant are opposed to the second quadrant and the third quadrant with respect to the first axis, and the first quadrant and the second quadrant are opposed to the third quadrant and the fourth quadrant with respect to the second axis, wherein the first quadrant is diagonally opposed to the third quadrant, and the second quadrant is diagonally opposed to the fourth quadrant, and wherein one of a majority of an area of the entry opening of the first integral screw guide is in the first quadrant and a majority of an area of the entry opening of the second integral screw guide is in the third quadrant; and the majority of the area of the entry opening of the first integral screw guide is in the second quadrant and the majority of the area of the entry opening of the second integral screw guide is in the fourth quadrant.

[0116] In an embodiment, the intervertebral cage can include a wall having an entry opening of the first integral screw guide and an entry opening of the second integral screw guide, wherein the wall has four quadrants delineated by a first axis and a second axis each lying in a plane of the wall, and the first axis is at a right angle with respect to the second axis, wherein the four quadrants include a first quadrant, a second quadrant, a third quadrant, and a fourth quadrant, wherein the first quadrant and the fourth quadrant are opposed to the second quadrant and the third quadrant with respect to the first axis, and the first quadrant and the second quadrant are opposed to the third quadrant and the fourth quadrant with respect to the second axis, wherein the first quadrant is diagonally opposed to the third quadrant, and the second quadrant is diagonally opposed to the fourth quadrant, and wherein one of a center of the entry opening of the first integral screw guide is in the first quadrant and a center of the entry opening of the second integral screw guide is in the third quadrant; and the center of the entry opening of the first integral screw guide is in the second quadrant and the center of the entry opening of the second integral screw guide is in the fourth quadrant.

[0117] FIG. 6D illustrates an embodiment of an external drill/screw guide-box expander which assists in screw trajectory of the exemplary cage **200**. The cage **200** can be a cage according to any of the embodiments described herein, or an expanding cage, in which case an expanding Allen key component can be used. The device can include, for example, an Allen key **501** (e.g., for an expandable cage), a spring **502**, a handle **503**, a gripper **504** having a gripper prong **506**, which alternatively may include a male protuberance (e.g., a medially oriented mal protuberant extension for insertion into the lateral cage slot **12**), and a screw guide **505**.

[0118] FIG. 6E illustrates a superior oblique view of the screw guide demonstrating insertions or grooves **509** for gripper prong **506** of the gripper **504** in FIG. 6D, built-in trajectory guides **511**, **512** for insertions of screws, and an

opening **514** for an Allen key, in instances in which an expandable cage is being used. In an embodiment, the Allen key may not be present when a non-adjustable cage is being used. In another embodiment, the Allen key may be present even when an adjustable cage is being used, such that the tool is universal to various types of cages.

[0119] The gripper **504** can include gripper prongs (e.g., medially oriented male protuberant extensions) **506** which insert into grooves **509** of the screw guide **505** and lateral slots (e.g., **12**) of a cage, thereby perfectly aligning them.

[0120] Hence, according to the exemplary embodiments, a cage can be provided that has internal screw guides which have no gaps, and furthermore an insertion tool can be provided that has an external screw guide that further precisely guides the screws through the external tool screw guide, then into the internal implant screw guide guaranteeing the precise predetermined angulation of the screws. The combination the internal and external screw guides can create a long tunnel for a screw to enable a predetermined trajectory.

[0121] It is noted that the same trajectory can be provided by only with the internal box screw guides; however, one of ordinary skill will recognize that having the external screw guides as part of the tool further maintains the precise angle trajectory. The screw guide positions within the four (4) quadrants I, II, III, IV conform to the screw guide positions within the four (4) quadrants I, II, III, IV of the screw box.

[0122] With reference to the drawings, it will be understood that an embodiment of the indentations or recesses for the screw holes in any of the exemplary cages can be configured such that the screw heads will rest entirely within a peripheral side of a surface of the top portion of the cage (i.e., top surface). In this embodiment, the direction of the screw tunnel is from an anterior surface to a posterior of the top surface of the cage (i.e., the non-adjacent side).

[0123] In another embodiment, the indentations or recesses for the screw holes can be configured such that the screw heads will rest entirely within the peripheral side of the top surface of the cage. In this embodiment, the screw hole guide passes through the anterior-posterior axis of the top surface. The guides core circumference for the screw thread is surrounded by the lateral wall masses, and surrounded by mass from the front and rear surfaces (i.e., walls) of the cage.

[0124] In yet another embodiment, the indentations or recesses for the screw holes can be configured such that a recess for the screw holes are entirely within the peripheral side of the top surface of the box. In this embodiment, there is a through-hole for a screw which is counter-bored to keep the screw head within an outer surface boundary of the cage and in a direction to prevent the screw from avoiding the front or rear surfaces of the cage.

[0125] In yet another embodiment, the indentations or recesses for the screw holes can be configured such that a recess for the screw holes is entirely within the peripheral side of the front wall of the cage. In this embodiment, the tunnel for the screws is such that when the screw first enters, the screw will be surrounded by mass from the lateral sides and mass from the upper and lower sides of the wall. The screw will exit at the posterior end of the peripheral wall.

[0126] With reference to the drawings, it will be understood that an embodiment of the indentations or recesses for the screw holes can be configured such that a position of the screws is suitable for posterior lumbar screw holes.

[0127] For example, in an embodiment, the screw holes can be diagonal to each other along a transversal line. The transversal line can be defined as the line that would diagonally intersect and bypass the space between the recess for the screw holes.

[0128] In another embodiment, the screw holes can be diagonally opposed and lie on a congruent angle to each other from the intersecting transversal line.

[0129] In another embodiment, the recess for the screw holes can be diagonal and perpendicular to each other within the outer plane.

[0130] In another embodiment, the recess for the screw holes can be diagonal and symmetrically constrained within the outer wall of the cage.

[0131] While the foregoing disclosure shows illustrative embodiments of the invention, it should be noted that various changes and modifications could be made herein without departing from the scope of the invention as defined by the appended claims. The functions, steps and/or actions of the method claims in accordance with the embodiments of the invention described herein need not be performed in any particular order. Furthermore, although elements of the invention may be described or claimed in the singular, the plural is contemplated unless limitation to the singular is explicitly stated.

What is claimed is:

1. A universal, intervertebral combination bone fusion spacer and self-drilling screw apparatus for insertion into a disc space between a first vertebral body and a second vertebral body and fusion of the first vertebral body to the second vertebral body via biological bone fusion and screw fusion, the apparatus comprising:

an intervertebral cage including:

a first integral screw guide having a first predetermined angle; and

a second integral screw guide having a second predetermined angle;

a first screw member disposed in the first integral screw guide at the first predetermined angle and at least partially within the intervertebral cage;

a second screw member disposed in the second integral screw guide at the second predetermined angle and at least partially within the intervertebral cage; and

a screw locking mechanism that secures at least one of the first screw member and the second screw member in one of the first internal screw guide and the second internal screw guide, wherein each of the first internal screw guide and the second internal screw guide is angled to orient the first screw member and the second screw bi-directionally in opposite directions, wherein the first screw member includes a screw head and a threaded body, wherein the second screw member includes a screw head and a threaded body.

2. The apparatus of claim 1, wherein the screw locking mechanism secures the first screw member in the first internal screw guide and the second screw member in the second internal screw guide.

3. The apparatus of claim 1, wherein the first screw member includes a screw head, a tapered end, and a threaded body;

wherein the second screw member includes a screw head, a tapered end, and a threaded body.

4. The apparatus of claim 1, wherein the intervertebral cage includes a plurality of indentations positioned between the first and second screw guides; and

wherein the screw locking mechanism comprises:

a hemi bracket including:

a base; and

a plurality of arms,

the plurality of arms engaging the plurality of indentations to secure the hemi bracket to the intervertebral cage.

5. The apparatus of claim 4, wherein the plurality of indentations comprises:

a superior indentation positioned on an upper superior wall of the cage; and

an inferior indentation positioned on an upper inferior wall of the cage.

6. The apparatus of claim 4, wherein the plurality of arms comprises:

a superior arm including a first medial protuberance; and

an inferior arm including a second medial protuberance, wherein the superior and inferior arms attach to the corresponding superior and inferior indentations via the first and second medial protuberances.

7. The apparatus of claim 5, wherein the superior indentation and the inferior indentation are positioned midway between the first and second screw guides.

8. The apparatus of claim 4, wherein the hemi bracket covers and locks the first and second screws into the first and second integral screw guides and prevents the first and second screws from backing out of the first and second integral screw guides.

9. The apparatus of claim 4, further comprising:

a third screw member having a tapered end and a threaded body disposed within the cage; and

a fourth screw member having a tapered end and a threaded body disposed within the cage, wherein the cage further includes:

a third internal screw guide and a fourth internal screw guide; and

a second hemi bracket that covers and prevents the third screw member from pulling out of the third internal screw guide and the fourth screw member from pulling out of the fourth internal screw guide.

10. The apparatus of claim 9, wherein the second hemi bracket includes:

a base; and

a plurality of arms, the plurality of arms engaging different indentation of the plurality of indentations to secure the second hemi bracket to the intervertebral cage.

11. The apparatus of claim 10, wherein the plurality of indentations comprises:

a superior indentation positioned on an upper superior wall of the cage; and

an inferior indentation positioned on an upper inferior wall of the cage.

12. The apparatus of claim 11, wherein the plurality of arms comprises:

a superior arm including a first medial protuberance; and

an inferior arm including a second medial protuberance, wherein the superior and inferior arms attach to the corresponding superior and inferior indentations via the first and second medial protuberances.

13. The apparatus of claim 1, wherein each of the first integral screw guide and the second integral screw guide

includes a descending narrowing screw guide that narrows in a direction extending from top to bottom.

14. The apparatus of claim 13, wherein the first screw member and the second screw member are disposed in each descending narrowing screw guide and countersunk on top of the intervertebral cage such that each descending narrowing screw guide hugs each respective one of the first screw member and the second screw member to provide a secondary locking mechanism for each of the first screw member and the second screw member that is independent of the screw locking mechanism.

15. The apparatus of claim 4, wherein each of the first integral screw guide and the second integral screw guide includes a descending narrowing screw guide that narrows in a direction extending from top to bottom, and

wherein the first screw member and the second screw member are disposed in each descending narrowing screw guide and countersunk on top of the intervertebral cage such that each descending narrowing screw guide hugs each respective one of the first screw member and the second screw member to provide a secondary locking mechanism for each of the first screw member and the second screw member that is independent of the screw locking mechanism.

16. The apparatus of claim 10, wherein each of the first, second, third, and fourth integral screw guides includes a descending narrowing screw guide that narrows in a direction extending from top to bottom, and

wherein the first, second, third, and fourth screw members are disposed in each respective descending narrowing screw guide and countersunk on top of the intervertebral cage such that each descending narrowing screw guide hugs each respective one of the each of the first, second, third, and fourth screw members to provide a secondary locking mechanism for each of the each of the first, second, third, and fourth screw members that is independent of the screw locking mechanism.

17. A bi-directional fixating transvertebral (BDFT) screw/cage apparatus, comprising:

an intervertebral cage for maintaining disc height, the intervertebral cage including a first internal screw guide, a second internal screw guide, a third internal screw guide, and a fourth internal screw guide, each having a predetermined angled trajectory;

a first screw member, a second screw member, a third screw member, and a fourth screw member, each having a tapered end and a threaded body disposed within the intervertebral cage; and

two vertical hemi bracket screw locking mechanisms that prevent the first screw member, the second screw member, the third screw member, and the fourth screw members from pulling-out of the first internal screw guide, the second internal screw guide, the third internal screw guide, and/or the fourth internal screw guide respectively.

18. The apparatus of claim 17, further comprising:

cage indentations on the upper aspect of superior and inferior cage walls in-between the first and second screws and in between the third and fourth screws,

wherein the vertical hemi brackets snaps into the cage indentations.

19. A method of inserting a bi-directional fixating trans-vertebral (BDFT) screw/cage apparatus between a first vertebral body and a second vertebral body, the method comprising:

measuring a dimension of a disc space between the first vertebral body and the second vertebral body;

determining that the disc space is a posterior lumbar disc space, an anterior lumbar disc space, or an anterior cervical disc space;

selecting an intervertebral cage based on the measured dimension of the disc space and based on the determination of the disc space being the posterior lumbar disc space, the anterior lumbar disc space, or the anterior cervical disc space;

inserting the selected intervertebral cage into a midline of the disc space until the selected intervertebral cage is flush or countersunk relative to the first vertebral body and the second vertebral body;

inserting a first screw member into a first internal screw guide of the selected intervertebral cage;

inserting a second screw member into a second internal screw guide of the selected intervertebral cage;

screwing the first screw member and the second screw member into the first vertebral body and the second vertebral body respectively;

confirming a position and placement of the intervertebral cage relative to the first vertebral body and the second vertebral body; and

locking the first screw member and the second screw member in a final position when the screw head is flush with the surface of the cage and then covering two adjacent screws with a vertical hemi bracket which snaps into the sides of the cage preventing screw back out.

20. The apparatus of claim **1**, wherein each of the first internal screw guide and the second internal screw guide has a 25 degree angulation.

* * * * *