



US 20120145168A1

(19) **United States**

(12) **Patent Application Publication**  
LIN

(10) **Pub. No.: US 2012/0145168 A1**

(43) **Pub. Date: Jun. 14, 2012**

(54) **EXTENSIBLE WIRE-REELING CIGARETTE CLAMP SPECIFICALLY USED IN A CAR**

(52) **U.S. Cl. .... 131/186; 131/190**

(57) **ABSTRACT**

(76) **Inventor: WU-YUAN LIN, Xinzhuang City (TW)**

An extensible wire-reeling cigarette clamp specifically used in a car includes an extensible rod, a reel, a reel slider and a clamping spring. The extensible rod is fixed on a fixing board locked on a bracket of a rear-view mirror of a car, the reel is connected at an end of the extensible rod, the reel slider is connected to a wire in the reel, and the clamping spring is connected with the reel slider. To smoke a cigarette, a smoker in the car only needs to pull the reel slider gently and then the cigarette on the clamping spring can be drawn into the smoker's mouth for smoking. After smoking, the smoker only tugs the reel slider and then the reel can wind the reel slider automatically to its original position. As the smoker smokes without glancing at the cigarette clamp, the safety of driving is assured.

(21) **Appl. No.: 12/963,565**

(22) **Filed: Dec. 8, 2010**

**Publication Classification**

(51) **Int. Cl.**  
*A24F 9/14* (2006.01)  
*A24F 13/08* (2006.01)

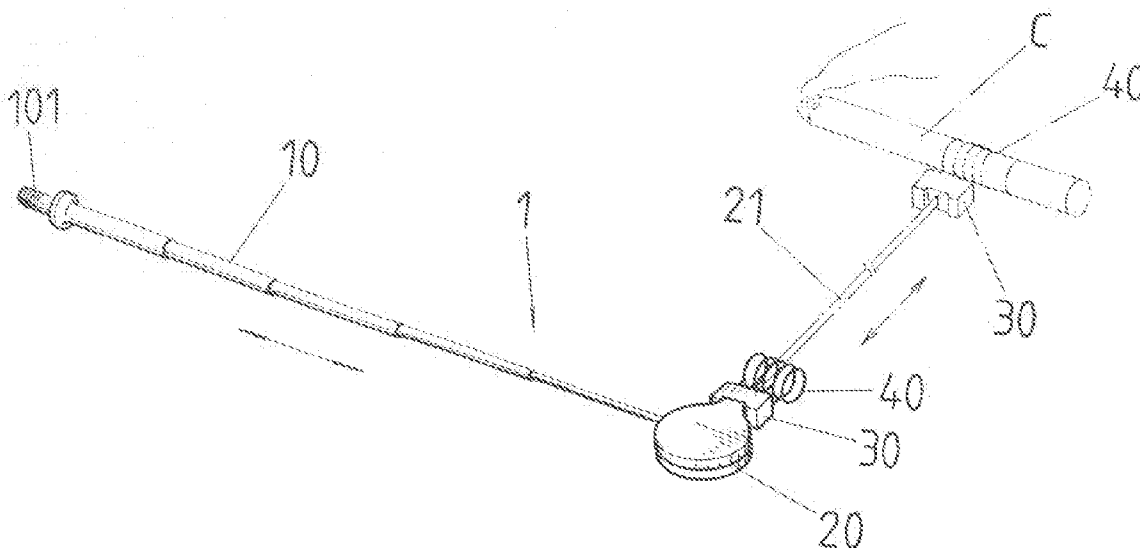

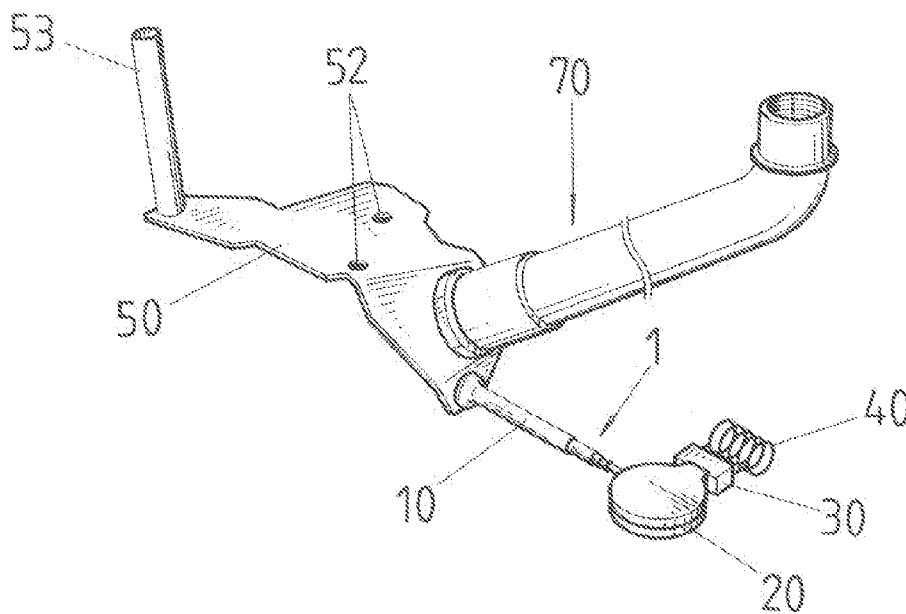

FIG. 1

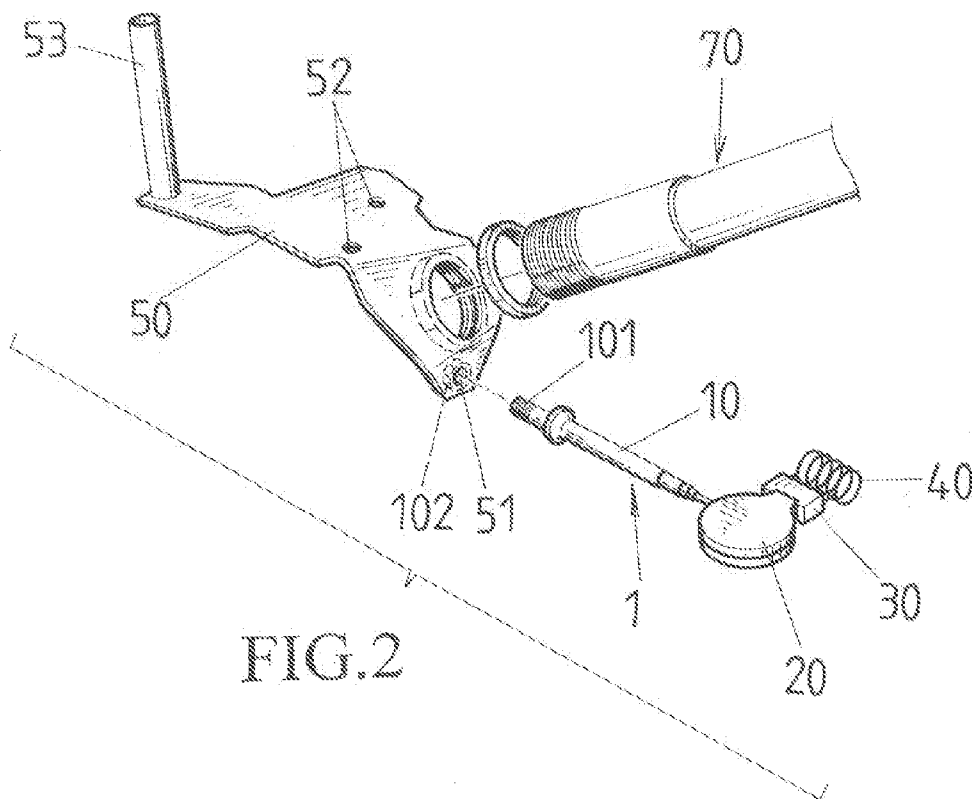

FIG. 2

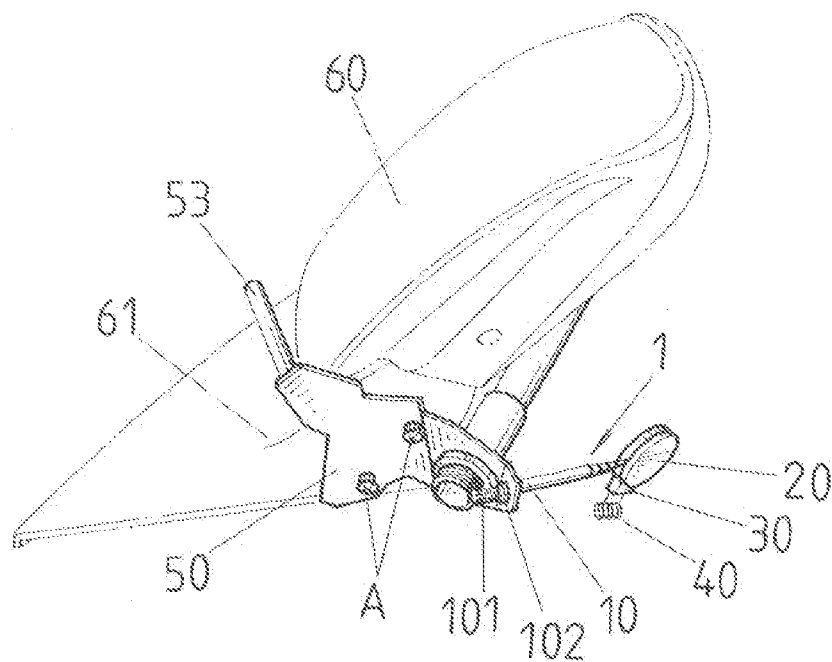

FIG. 3

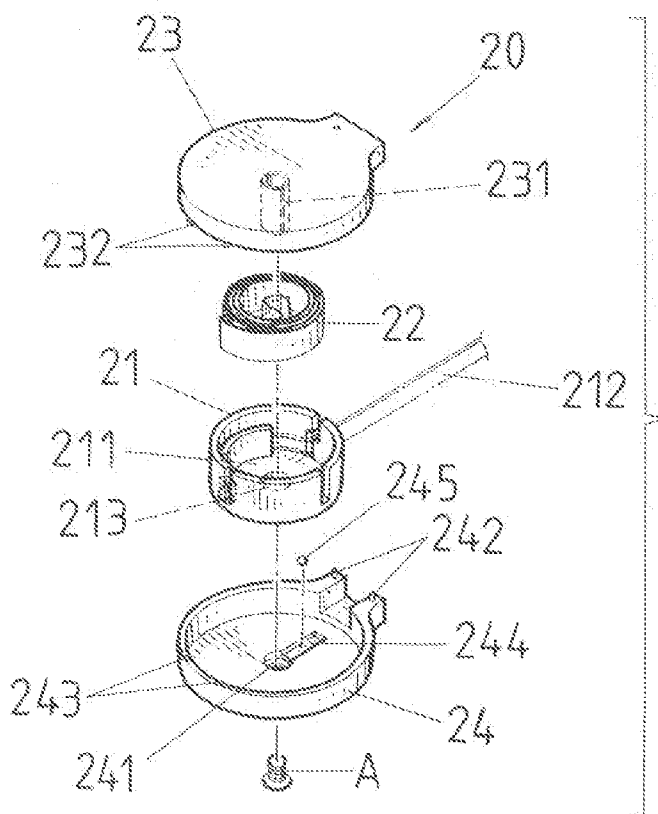

FIG. 4

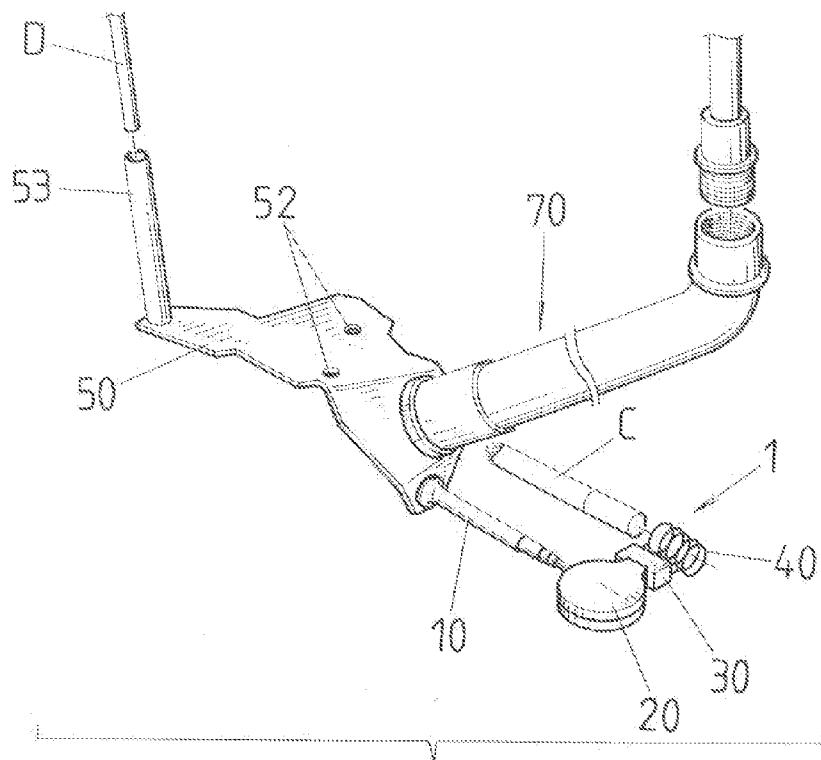

FIG. 5

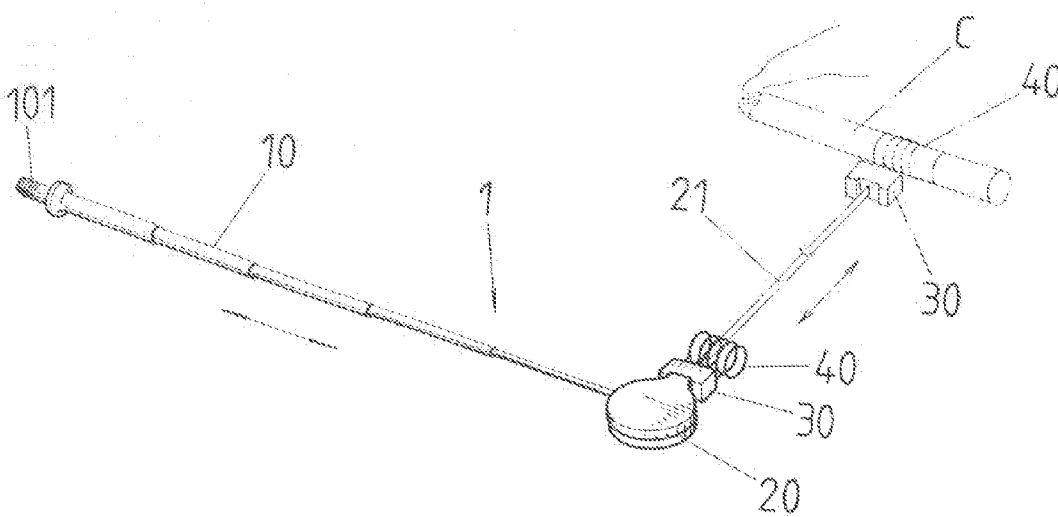

FIG. 6

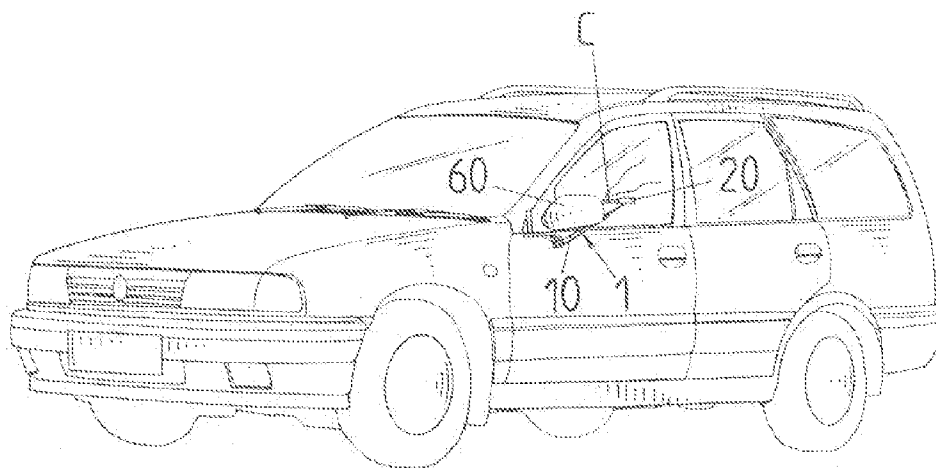

FIG. 7

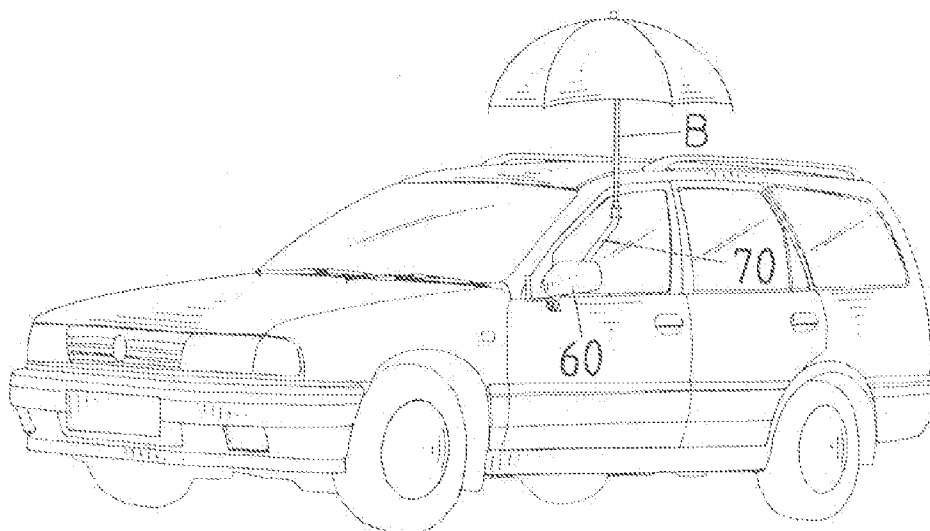

FIG. 8

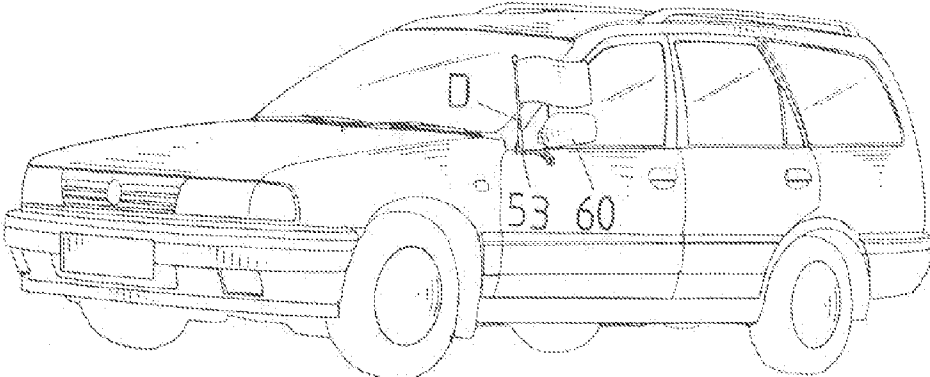

FIG. 9

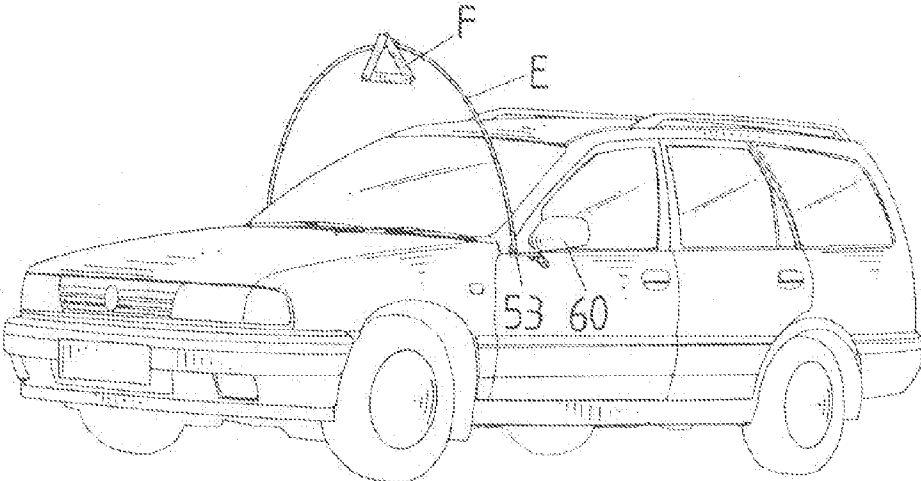

FIG. 10

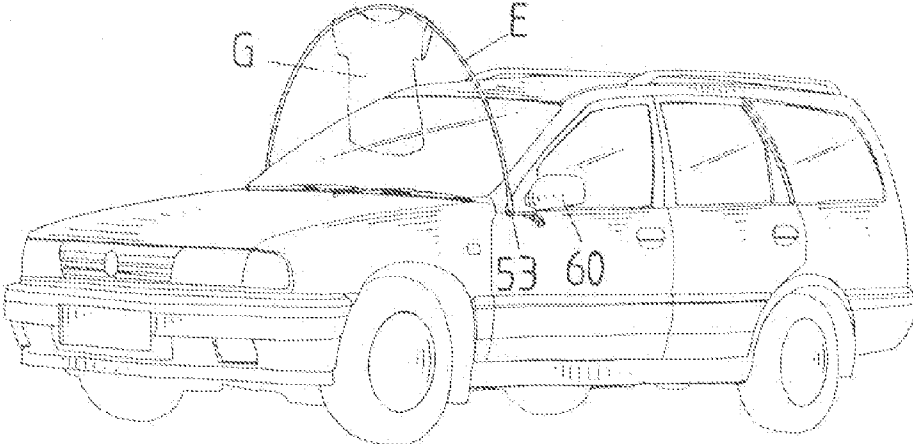

FIG. 11

**EXTENSIBLE WIRE-REELING CIGARETTE CLAMP SPECIFICALLY USED IN A CAR**

**BACKGROUND OF THE INVENTION**

[0001] a) Field of the Invention

[0002] The present invention relates to a cigarette clamp which is installed at an exterior side of an auto body, wherein when a driver or a smoker is to smoke a cigarette in driving, he or she can pull the cigarette clamp at the exterior side of the auto body into his or her mouth for smoking that in addition to that passengers in the car can be kept from passive smoking, safety of driving can be even assured.

[0003] b) Description of the Prior Art

[0004] It is known that when an average cigarette addict is to smoke a cigarette when driving, he or she will usually open a car window and use fingers of one hand to clamp the cigarette outside the car window, in order to keep passengers in the car from passive smoking. However, this smoking method is very dangerous and therefore, from time to time, there are car drivers or smokers who smoked in driving and were injured at fingers or even an entire arm by collision of a car coming from a rear side.

**SUMMARY OF THE INVENTION**

[0005] Accordingly, the primary object of the present invention is to provide a novelty cigarette clamp by which the cigarette addict can smoke in driving for refreshment without causing the passengers in the same car to receive the passive smoking. The cigarette clamp is constituted by an extensible rod, a reel, a reel slider and a clamping spring. The extensible rod is locked on a fixing board at an exterior side of an auto body, the reel is connected at an end of the extensible rod, the reel slider is connected on a wire inside the reel, the clamping spring is connected with the reel slider and a cigarette is clamped on the clamping spring. When a cigarette addict is to smoke in driving, he or she can open a car window and pull the reel slider with fingers to draw the cigarette on the clamping spring into his or her mouth for smoking. After smoking, the cigarette addict can just tug the reel slider again and then the reel will wind the reel slider back to its original position, with that the car window is closed finally. This cigarette clamping method while in driving is able to allow a driver to easily accomplish the operations of smoking and winding back the cigarette, without glancing at the cigarette clamp. Therefore, in addition to that the passengers in the car can be kept from passive smoking, the safety of driving can be even assured.

[0006] To enable a further understanding of the said objectives and the technological methods of the invention herein, the brief description of the drawings below is followed by the detailed description of the preferred embodiments.

**BRIEF DESCRIPTION OF THE DRAWINGS**

[0007] FIG. 1 shows a schematic view of the present invention.

[0008] FIG. 2 shows an exploded view of the present invention.

[0009] FIG. 3 shows a schematic view of the present invention which is installed beneath a rear-view mirror of a car.

[0010] FIG. 4 shows an exploded view of a reel of a cigarette clamp of the present invention.

[0011] FIG. 5 shows an external view of an embodiment of the cigarette clamp of the present invention which clamps a cigarette.

[0012] FIG. 6 shows an external view of an embodiment of the cigarette clamp of the present invention which clamps the cigarette and is extended.

[0013] FIG. 7 shows a schematic view of an embodiment of installation of the extensible wire-reeling cigarette clamp of the present invention.

[0014] FIG. 8 shows a schematic view of an embodiment of the present invention wherein an umbrella stand is installed to put up an umbrella.

[0015] FIG. 9 shows a schematic of an embodiment of the present invention wherein a flag is inserted.

[0016] FIG. 10 shows a schematic view of an embodiment of the present invention wherein a multi-rod movable joint bracket is installed to suspend a triangular warning sign of vehicle fault.

[0017] FIG. 11 shows a schematic view of an embodiment of the present invention wherein a multi-rod movable-joint bracket is installed to hang a piece of wet clothing in air for drying.

**DETAILED DESCRIPTION OF THE PREFERRED EMBODIMENTS**

[0018] Referring to FIGS. 1 and 2, an extensible wire-reeling cigarette clamp 1 of the present invention comprises an extensible rod 10, a reel 20, a reel slider 30 and a clamping spring 40, wherein a bolt 101 at one end of the extensible rod 10 penetrates a bolt hole 51 at an end of a fixing board 50 and is then locked by a nut 102 at a rear end of the fixing board 50 to fix the extensible rod 10, the other end of the extensible rod 10 is connected to the reel 20, a wire 21 in the reel 20 is connected to the reel slider 30 (as shown FIG. 4), and an end of the reel slider 30 is connected with the clamping spring 40 on which a cigarette C can be clamped (as shown in FIGS. 5 and 6). When a driver or passenger in a car is to smoke a cigarette, he or she only needs to pull the reel slider 30 and then the cigarette C can be drawn into his or her mouth for smoking. After smoking, the driver or passenger only needs to tug the reel slider 30 and then the reel 20 can wind the reel slider 30 automatically to its original position that a car window can be opened or the cigarette C can be wound back to its original position to close the car window easily, without glancing at the cigarette clamp 1 by the smoker. In addition, passengers in the car can be even kept from passive smoking.

[0019] Referring to FIG. 3, the fixing board 50 is fixed on a bracket 61 of a rear-view mirror 60 of a car, wherein two screws A are used to penetrate through-holes 52 of the fixing board 50 to be locked into screw holes (not shown in the drawings) of the bracket 61 of the rear-view mirror 60, thereby locking the fixing board 50.

[0020] Referring to FIG. 4, the reel 20 of the present invention is constituted by an inner pulley 21, a clockwork spring 22, an upper lid 23 and a bottom seat 24, wherein an inner slot 211 of the inner pulley 21 can be inserted with the curled clockwork spring 22, an outer circumference of the inner pulley 21 is surrounded by a wire 212, a central rod 231 at a bottom of the upper lid 23 is transfixed into the clockwork spring 22 and a through-hole 213 of the inner pulley 21 and is positioned by locking a screw A at a bottom of the bottom seat 24. The upper lid 23 and the bottom seat 23 are latched and positioned by positioning pins 232, 242 and positioning holes 242, and a groove 244 at a side of a central lock hole 241 of the bottom seat 24 is put with a ball 245 which can roll in a rolling slot at a bottom of the inner pulley 21 (not shown in the drawings).

[0021] Referring to FIG. 5, the clamping spring 40 of the cigarette clamp 1 can clamp a cigarette C and the cigarette clamp 1 is installed outside an auto body. When a cigarette addict in the car is to smoke a cigarette, he or she pulls the reel slider 30 and extends the reel 21 to extend the extensible rod 10 of the cigarette clamp 1 to a proper position, as shown in FIG. 6. In addition, as shown in FIG. 7, the driver in the car pulls the cigarette C into his or her mouth for smoking.

[0022] Referring to FIG. 8, the fixing board 50 of the present invention is installed with an umbrella stand 70 on which an umbrella handle B is fixed to accomplish an operation of putting up an umbrella. On the other hand, as shown in FIG. 9, the fixing board 50 is connected with a tube unit 53 into which a staff D of all kinds of flags can be inserted. Referring to FIGS. 10 and 11, an interior of the tube unit 53 of the fixing board 50 can be inserted with two ends of a multi-rod movable-joint bracket E which forms a semi-circular suspension scaffold after extension. The multi-rod movable-joint bracket E can be hung with a triangular warning sign F of vehicle fault or a piece of wet clothing G like a swimming suit, socks or a towel.

[0023] In conclusion, the present invention is an extensible wire-reeling cigarette clamp that is installed outside an auto body or an ordinary car. The clamping spring of the cigarette clamp can clamp a cigarette and when the smoker in the car is to smoke a cigarette, he or she only needs to pull the reel slider gently, and then the cigarette can be drawn into the smoker's mouth for smoking. After smoking, the smoker only needs to tug the reel slider again and then the clamping spring can be wound back its original position automatically. As the smoker can accomplish smoking almost without glancing at the cigarette clamp, the safety of driving can be assured.

[0024] It is of course to be understood that the embodiments described herein is merely illustrative of the principles of the invention and that a wide variety of modifications thereto may be effected by persons skilled in the art without departing from the spirit and scope of the invention as set forth in the following claims.

What is claimed is:

1. An extensible wire-reeling cigarette clamp specifically used in a car, comprising:

an extensible rod, an end of which is provided with a bolt that is extended into a bolt hole of a fixing board for locking;

a reel, an end of which is connected with the extensible rod and an interior of which is provided with a wire;

a reel slider which is connected to the wire of the reel; and a clamping spring which is connected to the reel slider;

when the fixing board is locked on a bracket of a rear-view mirror of a car and a smoker in the car is to smoke a cigarette, he or she clamping the cigarette on the clamping spring and pulling gently the reel slider that the cigarette is drawn into the smoker's mouth for smoking; after smoking, he or she tugging the reel slider again and then the clamping spring being automatically wound to its original position.

2. The cigarette clamp according to claim 1, wherein the reel is constituted by an inner pulley, a clockwork spring, an upper lid and a bottom seat, with that an inner slot of the inner pulley is inserted with the curled clockwork spring, an outer circumference of the inner pulley is surrounded by the wire, a central rod at a bottom of the upper lid is transfixed into the clockwork spring and a through-hole of the inner pulley to be positioned by locking a screw at a bottom of the bottom seat, and a groove at a side of a central lock hole of the bottom seat is inserted with a ball which rolls in a rolling slot of the inner pulley.

3. The cigarette clamp according to claim 1, wherein the fixing board is installed with an umbrella stand to put up an umbrella or a sunshade.

4. The cigarette clamp according to claim 1, wherein the fixing board is connected with a tube unit into which a flag staff is inserted.

5. The cigarette clamp according to claim 4, wherein an interior of the tube unit of the fixing board is installed with a multi-rod movable-joint bracket.

\* \* \* \* \*