



(51) International Patent Classification:

A24C 5/34 (2006.01) G06T 7/62 (2017.01)
B61L 23/04 (2006.01) G06T 7/00 (2017.01)
G01B 11/02 (2006.01) G06T 7/521 (2017.01)
G01N 21/88 (2006.01) H04N 7/18 (2006.01)

(21) International Application Number:

PCT/US2020/045828

(22) International Filing Date:

12 August 2020 (12.08.2020)

(25) Filing Language:

English

(26) Publication Language:

English

(30) Priority Data:

16/445,620 19 June 2019 (19.06.2019) US

(72) Inventor; and

(71) Applicant: MAHAJAN, Amit, Anil [US/US]; 1545 Aurelia Drive, Cumming, GA 30041 (US).

(72) Inventors: BAGALKOTE, Samir, Shriram; Flat No 21, Building No. B3, Karthikraj Park, Pune, Maharashtra 411061 (IN). JATHAR, Ameya, Anil; B21, Samrat Towers, Lane No. 30, Amba Mata Mandir, Sukh Sagar Nagar Katraj, Pune, Maharashtra 411046 (IN). ALHAT, Vidula, Premanth; Sr. No. 63, Lane No. 4, Salunkhe Vihar Road, Wanwadi, Pune, Maharashtra 411040 (IN). WAROKAR, Nikhil, Subhash; 12/C Adarsh Nagar, Near Ram Mandir Behind Chamat, High School Umred Road, Nagpur, Maharashtra 440009 (IN). ANAND, Deepak; S/O - Baldev Yadav, Village - Bhaluahi, Post Office - Balunganj, Police Station - Dhibra, District - Aurangabad, Bihar 824202 (IN).

(74) Agent: HOLLY, Lynn; Phoenix Innovations LLC, 4010 Morningside Road, Edina, MN 55416 (US).

(81) Designated States (unless otherwise indicated, for every kind of national protection available): AE, AG, AL, AM, AO, AT, AU, AZ, BA, BB, BG, BH, BN, BR, BW, BY, BZ, CA, CH, CL, CN, CO, CR, CU, CZ, DE, DJ, DK, DM, DO, DZ, EC, EE, EG, ES, FI, GB, GD, GE, GH, GM, GT, HN, HR, HU, ID, IL, IN, IR, IS, IT, JO, JP, KE, KG, KH, KN,

(54) Title: INSPECTION AND COSMETIC GRADING SYSTEM AND METHOD

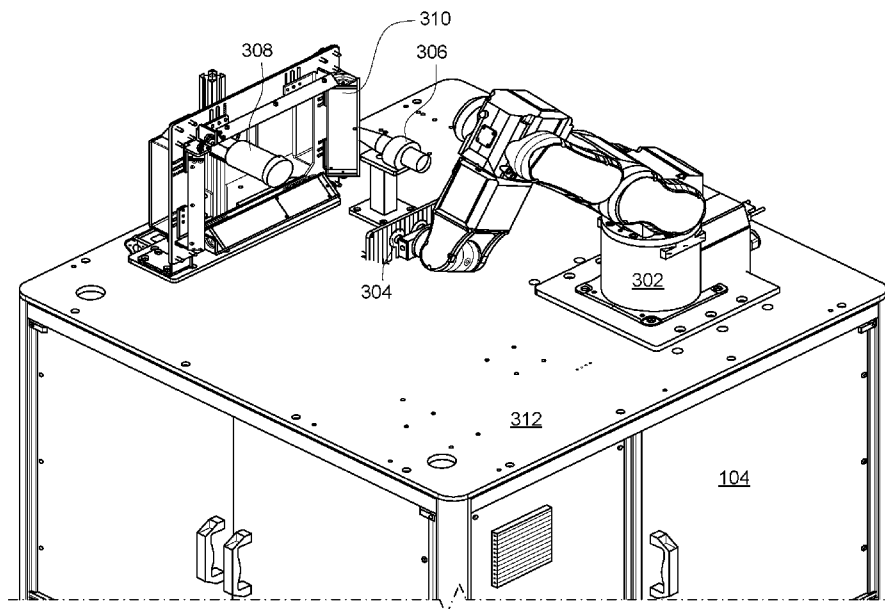

FIG. 3

(57) Abstract: A system and method for inspection and cosmetic grading of objects is provided. Camera and lighting assemblies capture images of an object and create a 2D composite image which is processed by an image processing module with a deep learning machine algorithm to detect surface defects in the object. Detected defects are localized and measured for depth of defect by an advanced optical sensor, providing a 3D representation of defects. A cosmetic grading algorithm determines the cosmetic grade of the object and the optimal path of disposition for the item based on the grade.



KP, KR, KW, KZ, LA, LC, LK, LR, LS, LU, LY, MA, MD, ME, MG, MK, MN, MW, MX, MY, MZ, NA, NG, NI, NO, NZ, OM, PA, PE, PG, PH, PL, PT, QA, RO, RS, RU, RW, SA, SC, SD, SE, SG, SK, SL, ST, SV, SY, TH, TJ, TM, TN, TR, TT, TZ, UA, UG, US, UZ, VC, VN, WS, ZA, ZM, ZW.

(84) Designated States (*unless otherwise indicated, for every kind of regional protection available*): ARIPO (BW, GH, GM, KE, LR, LS, MW, MZ, NA, RW, SD, SL, ST, SZ, TZ, UG, ZM, ZW), Eurasian (AM, AZ, BY, KG, KZ, RU, TJ, TM), European (AL, AT, BE, BG, CH, CY, CZ, DE, DK, EE, ES, FI, FR, GB, GR, HR, HU, IE, IS, IT, LT, LU, LV, MC, MK, MT, NL, NO, PL, PT, RO, RS, SE, SI, SK, SM, TR), OAPI (BF, BJ, CF, CG, CI, CM, GA, GN, GQ, GW, KM, ML, MR, NE, SN, TD, TG).

Declarations under Rule 4.17:

- *as to applicant's entitlement to apply for and be granted a patent (Rule 4.17(ii))*
- *of inventorship (Rule 4.17(iv))*

Published:

- *with international search report (Art. 21(3))*
- *with information concerning request for restoration of the right of priority in respect of one or more priority claims (Rules 26bis.3 and 48.2(b)(vii))*

INSPECTION AND COSMETIC GRADING SYSTEM AND METHOD

RELATED APPLICATIONS

[0001] This application is a PCT application for USPTO Patent Application No. 16/445,620 which is currently pending.

INTRODUCTION

[0002] The presently disclosed technology relates generally to an improved system, method and device for the detection, identification, analysis and grading of surface defects in two and three dimensions.

[0003] Sellers of products with secondary markets may maximize the value of an item by determining an optimal path of disposition (e.g. resale as-is, replace parts and resell, buff and polish and resell, etc.). For items that are in good working order, the cosmetic inspection and analysis aid to determine the optimal path of disposition by assigning a cosmetic grade to an item based upon criteria specified by the seller. For example, an item with very few and small surface defects may be considered a grade A item (resell as-is), while one with severe surface defects may be graded as D, either requiring a part replacement or need some operation, such as buff & polish, for removal of surface defects and preparation for resale. Each path has a different cost to the seller.

[0004] Product specifications that cover a product's appearance, look and feel, colour, texture and superior defect-free surface finish are important cosmetic features. Surface defect inspection is an important part of cosmetic quality checks in smart devices. The traditional method involves manual visual inspections that lacks accuracy and speed of inspection. Visual inspection provides limited information of surface defects such as count and apparent measurement of size of defect in two dimensions. It does not fully characterize a surface defect. In order to fully characterize the defect, determination of depth becomes more important than just a visual assessment. Without information regarding the depth of a defect, it may be impossible to determine whether replacement or processing is the optimal path. For example, a buff and polishing process can't eliminate a defect that cuts the surface to a depth reaching to bulk material and into the product below. Cosmetic grading machines, devices or methods known in the art do not provide the size of defect in three dimensions. The present application

discloses a system and method for determining the true characterization of a defect, and hence the item's optimal dispositional path, and offers other advantages over the prior art.

SUMMARY

[0005] In a preferred embodiment, an object is presented to the system and method disclosed herein. A camera assembly captures a comprehensive set of images of the object from all sides and orientations. A lighting assembly is operatively connected to the camera assembly, with the lighting assembly adjusting itself upon receiving signals from the camera assembly regarding optimal lighting conditions. Image processing software processes the images, stitching together various images to provide a full, two-dimensional view of the object. Image capture and processing software determines the center of the object evaluation area, and other object attributes such as size and color, from an initial image; further images allow the processing software to identify defects; calculate the coordinates of the defect relative to the center of the object; and identify the length and width of each defect. The defect coordinates may be provided to a device handling assembly which then aligns each defect in line with an optical sensor for defect depth measurement. It aligns the defect at a position of highest reflected light intensities and measures the depth at that location. The system may capture the defect details, images and cosmetic grade according to a cosmetic grading scheme and provides the data to an external system for optimal disposition of an item.

[0006] Some embodiments may configure the system components in alternative ways in order to accommodate the evaluation of objects of different sizes, materials, and other properties.

[0007] The features, functions and advantages that have been discussed may be achieved independently in various embodiments of the present disclosure or may be combined with yet other embodiments, further details of which can be seen with reference to the following description and drawings.

BRIEF DESCRIPTION OF THE DRAWINGS

[0008] The accompanying drawings, which are included to provide a further understanding of the disclosed embodiments and are incorporated in and constitute a part of this specification, illustrate exemplary embodiments and together with the description serve to explain the principles of the disclosed embodiments.

- [0009] FIG. 1 illustrates a standalone system for inspecting small objects or items consistent with this disclosure.
- [0010] FIG. 2 illustrates a pair of standalone systems with a conveyor apparatus.
- [0011] FIG. 3 illustrates the system's primary hardware components.
- [0012] FIG. 4 illustrates an exemplary advanced optical sensor.
- [0013] FIG. 5 is a block diagram illustrating exemplary top-level hardware system architecture of a system consistent with this disclosure.
- [0014] FIG. 6 is a block diagram illustrating an exemplary computing device consistent with this disclosure.
- [0015] FIG. 7 illustrates the processes performed by an exemplary image processing system consistent with this disclosure.
- [0016] FIG. 8 is a screen shot of an image defect located by an image processing system.
- [0017] FIG. 9 is a magnified screen shot of the image defect of FIG. 8.
- [0018] FIG. 10 is a screen shot of the raw sensor signal received at the sensor controller.
- [0019] FIG. 11 is a screen shot of the signal of FIG. 10 with respect to encoder values.
- [0020] FIG. 12 illustrates the measurement signal received after baseline subtraction and illustrates the average width of the defect and depth as calculated by the sensor controller.
- [0021] FIG. 13 illustrates the flow of a method performed by a system consistent with this disclosure.
- [0022] FIG. 14 illustrates an exemplary screen shot for monitoring the process as it proceeds.
- [0023] FIG. 15 is a screen shot of a view of a mobile device with defects identified by image processing software.
- [0024] FIG. 16 is an illustration of an alternative embodiment for capturing images in larger objects.

DETAILED DESCRIPTION

[0025] Embodiments of the claimed subject matter will now be described more fully with reference to the accompanying drawings, in which some, but not all embodiments are shown. The subject matter disclosed may be embodied in many different forms and should not be construed as limited to the embodiments set forth herein; rather, these embodiments are provided so that the disclosure may satisfy legal requirements. Like numbers refer to like elements throughout.

[0026] Where possible, any terms expressed in the singular form herein are meant to also include the plural form and vice versa, unless explicitly stated otherwise. Also, as used herein, the term “a” and/or “an” shall mean “one or more,” even though the phrase “one or more” is also used herein. Furthermore, when it is said herein that something is “based on” something else, it may be based on one or more other things as well. In other words, unless expressly indicated otherwise, as used herein “based on” means “based at least in part on” or “based at least partially on.” The terms “objects”, “product” and “items” are used synonymously and interchangeably in this disclosure. A “customer” may be an individual or organization requesting the services of a system and method consistent with this disclosure. A “user” may be the operator of such a system. It should also be understood that while some embodiments describe the methods or products as comprising one or more elements, the methods or elements may also consist of or consist essentially of the elements disclosed herein. The terms “inspection” and “evaluation” are used interchangeably and synonymously in this disclosure.

[0027] An inspection and cosmetic grading system and method may evaluate the surface of an object for defects. The term “surface” as used herein refers to the outside part or uppermost layer or layers of an object, with a depth of at least the depth of a defect, but with no maximum or minimum limits on the depth of the “surface.” The surface may include multiple layers of the same or different material(s). The depth of a surface is defined specifically for each object being evaluated. For example, an iPhone 6 mobile device screen consists of at least 8 layers of material. If a defect cuts through all 8 layers and into the device below, all the layers of the screen and the device below may be considered the surface for the purposes of this disclosure.

Overview

[0028] An inspection and cosmetic grading machine as disclosed herein may comprise four modular subsystems: an image capturing subsystem, image processing module, object/material

handling module, and depth sensing unit. Image capture apparatus includes modular hardware components, such as camera (lens, image sensor), lighting modules and processors that may be interchanged for evaluating products of different sizes, materials and expected size and type of surface defect. Together, an image capture subsystem and image processing module comprise the major components of a machine vision system. Machine vision systems create images by analyzing the light reflected from an object. Lighting techniques (e.g. back lighting, axial diffuse lighting, dark field illumination, bright field illumination, etc.) comprise a light source and its placement with respect to the object and the camera. Choice of lighting techniques also depends on the object being evaluated and the goals of the evaluation.

[0029] An image processing module may involve the use of a processor and memory, with computer-executable instructions which when executed by the processor extract information from an image. Image processing algorithms may acquire information from the camera, pre-process the image for optimization and ensure that the desired features are conspicuous. An algorithm may be designed to locate the specific features that are the subject of the analysis, run measurements and make comparisons. An image processing system may incorporate machine learning and deep learning algorithms to make the comparisons. Trained machine learning and deep learning systems can quickly and accurately identify the type of surface defects consistent with those described herein.

[0030] An object conveyance or handling module may comprise hardware to attach to, or grip, the object in order to position the object in front of the image capturing subsystem in various positions and orientations, either under its own programming or under the direction of feedback from the machine vision or other component. Object handling systems may be any kind of robotic assembly, hard automation or mechanical apparatus suited for a system consistent with this disclosure and the object being evaluated. Robotic assemblies may use any type of effector, for example, a claw, or one or more types of gripper effector such as magnetic, vacuum, slide or other type of gripper depending on the object to be evaluated.

[0031] In preferred embodiments, an advanced optical sensor provides depth measurement for detected defects. An advanced optical sensor may measure displacement from a plane using a sensor comprised of a set of lenses and light, sending a signal to a sensor controller which calculates the depth measurement.

- [0032] In some embodiments the system may further comprise logic programmed to apply a customer's cosmetic grade level or category to an evaluated object. Cosmetic grading categories may be created for objects depending on many factors, including the type of object, the presence of defects, number and/or type of defects or damage to the object, and the ability to repair the item or replace parts within a certain cost or capability range. The rules logic may also provide a dispositional path (e.g. send to salvage, send for repair of screen, send for repair of casing, etc.) for the object. In an embodiment consistent with this disclosure, defects or damage present in and on surfaces may be assessed and the length, width and depth measured. Attributes of defects on an object may determine the cosmetic grade and/or which of several dispositional paths the object may take. Some industries publish standards for the cosmetic grading of an item in order to ensure consistency across products going to secondary markets. For example, the CTIATM, an organization supporting the wireless industry, sets standards for wireless device grading scales which allow any seller in any secondary market of devices to universally identify cosmetic condition and other graded features. The logic for grading rules and categories that support a customer's needs may be programmed into a system and method consistent with this disclosure, either as an internal component or a combination of internal/external with an integration to an external system using application programming interfaces (APIs) or other data transfer method known to those of ordinary skill in the art.
- [0033] In various embodiments described herein, the cosmetic condition of an object surface may be assessed. Examples of smaller objects suitable for this system and method may include mobile phones, watches or other wearables, monitors, television screens, touch screens for medical devices, laptops, tablets, e-readers, portable gaming devices, GPS units, and many more. Surfaces may be comprised of glass, gorilla glass, CRT, LCD, plasma, OELD, plastic, silicone and/or other polymeric materials, as well as many combinations of materials. Embodiments of the system and method are contemplated for objects of all sizes and may be realized by alternative placement of hardware components.
- [0034] FIG. 1 illustrates a standalone system **100** for inspecting small objects or items consistent with this disclosure. In this disclosure, terms related to the "size" of objects may be considered relative terms, with a small system sized to handle small items, a large system sized for larger items, a very large system sized to handle very large items, etc.. In other words, the system and method may be practiced on "small" items, such as watches, mobile phones, tablets, small

television screens, etc. in a system sized for small items; “larger” items, such as a large screen TV in a system sized for larger items, and “very large” items, such as a car, in a system sized for very large items. Regardless of the size of a system, the components remain the same, but may be placed in different configurations and with alternative uses made of some components, but all fall within the embodiments as described herein.

[0035] Referring again to FIG. 1, an inspection and cosmetic grading assembly **100** which may be appropriate for small objects or devices may be comprised of an enclosure **102** housing the system components. The enclosure may be constructed of an opaque, non-reflective material. An enclosure around the assembly allows the highest quality images to be created by the system and may act as a safety barrier for the system and serve to prevent dust and other debris from accumulating on object or component surfaces. A control cabinet **104** may be included to contain servers, controllers, motors, cables, and other system hardware that may be located in close proximity to their respective components. A computing device **106** with access to the graphical user interface to the system’s control software, may be mounted on the enclosure for a user to provide input, observe images or processing screens, or override or otherwise control the system, if desired.

[0036] FIG. 2 illustrates a set of inspection and cosmetic grading units **100** with an external conveyance system **202** which transports an object to a unit for evaluation. A conveyance system may comprise frames supporting rollers, wheels or belts and may be motor powered or manual devices.

[0037] Referring now to FIG. 3, the system’s primary hardware components may reside within the enclosure. Primary hardware components may comprise: an automated object control system (here, a robotic arm **302**) with mounting and gripping device **304**, an optical sensor **306**, a plurality of cameras **308**, and light assemblies **310** (light mountings, lights, light adjustment slide).

[0038] A base plate **312** may provide a mounting area for the system components. An automated object control system **302** may be equipped with various effectors and used for various purposes in an inspection and cosmetic grading system and method. For example, a system for processing small objects may comprise a robotic arm **302** as automated object controller with vacuum or other effector suitable for attaching to, lifting, rotating and flipping the object,

positioning the object in front of a light **310** and camera assembly **308** multiple times in order to get a complete image of all sides and angles of the object. When non-collaborative robotic arms **302** are included in an embodiment, safety features such as automatic stop when enclosure doors are opened, may be built into the system. In some embodiments, vacuum, conveyance, pneumatic and safety subsystems may be included. Enclosures may be equipped with video cameras to allow users to observe the process.

[0039] Referring again to FIG. 3, in certain embodiments, a light assembly **310** may be comprised of a set of lights mounted on a mounting structure. Lighting may be chosen to provide optimal illumination to detect defects on an object surface. Lighting requirements (e.g. distance, color and intensity) may be dependent upon several things, including lighting geometry, light source type, wavelength, surface property of the object to be inspected or measured (e.g. color, reflectivity, texture or materials of construction), object shape, speed of application, the object's distance from the camera and angle of incidence, mechanical constraints and environment considerations. In some embodiments, properties of the object required to make lighting decisions may be determined at the time of evaluation and stored as an object profile record in a database. However, those properties also may be part of an object or device profile provided by the customer via API or other data transfer method prior to evaluation.

[0040] Objectives of lighting **310** selection may be to contrast the features that must be inspected or measured, minimize contrast of features that are of no interest, and remove unwanted variations caused by ambient light and differences between objects that are not relevant to inspection. Some embodiments, therefore, may include an easily removable and replaceable lighting assembly **310** to accommodate lighting determined optimal for a variety of surface material, object and image capture attributes. In a preferred embodiment, a lighting assembly **310** may be provided that is capable of providing multiple lighting techniques, including backlighting, dark field illumination and bright field illumination and others. The lighting controller may receive feedback or indication of optical qualities and measurements and adjust lighting accordingly. Lighting **310** may be adjusted in a particular object orientation to account for differences in object properties, such as differences in construction materials. For example, lighting for a mobile device screen may not provide the conditions required for the device border around the screen and therefore requires adjustment as the object is reoriented for image capture.

- [0041] As was described above, in some embodiments, cameras **308** may be mounted on a camera mount or automated object control system. Cameras and lenses **308** may be selected for their attributes, such as the number of megapixels, their sensor and processor properties, the optical quality of the lens best suited for the desired object to be processed, the expected working distance from the object and the expected defect sizes.
- [0042] An advanced optical sensor **306** allows measurement of displacement, the depth of a defect or the height of a protrusion. As was discussed previously, in addition to length and width, the depth of a defect is required in order to determine the defect character and optimal disposition of an object. In a preferred embodiment, an advanced optical sensor **306** subsystem may be provided to measure displacement, distance and/or position of defects provided by the image processing system. Optical sensors may measure displacement in a variety of surface materials and may filter out interference such as reflections on shiny surfaces. FIG. 4 provides an illustration of an exemplary advanced optical sensor **306**. The sensor may comprise a controller, a light source and a set of lenses **402** that fragment the light into wavelengths and form a conical beam **404**, creating an optical spot **406** used to measure the defect.
- [0043] FIG. 5 is a block diagram illustrating an exemplary top-level hardware system architecture of the disclosed system and method. A computing device **502** provides computational services, a graphical user interface **106** allowing a user access to programming, controls and view of system performance; machine learning and image processing modules, access to all embedded software for hardware component controllers (e.g. camera, lights, and sensors) and communications between components **504**. A Programmable Logic Controller (PLC) **506** performs all tasks related to embedded software control systems, including camera assemblies and controls **308**, lighting **310** and light motion control systems **508**, **510**, **512**, ambient light system **514**, automated object controller **302**, **516** and safety **518** system, depth sensor controller **520** and sensor **306**, object conveyance or feeding **202**, **522**, **524** and **526**. The automated object controller **516** performs automated object motions, movements and object pick, place and handling functions. Ancillary systems **528** may be optional or required subsystems known to those of ordinary skill in the art to support other systems or subsystems, including, for example, pneumatics and vacuum systems in support of conveyance **202**, placement mechanisms or automated object control **302** and sensor **306** and safety systems. In

some embodiments, the PLC **506** and automated object control assembly **516** may be visualized as children or workers to the computing **502** device as parent or manager.

[0044] An exemplary computing device **502** consistent with the system and method of this disclosure is illustrated in FIG. **6**. The computing device **502** may comprise at least a processing device **602**, system memory **604**, an operating system **606**, computer-executable instruction modules which when executed by the computer cause the system to behave consistent with their functions (i.e. automated handling system and controls **302**, **516**, camera system and controls **308**, lighting system and controls **310**, **506**, **510**, **512** and **514**, image processing controls and APIs **608**, machine learning module **610**, advanced optical sensor system and control **306**, **520** and ancillary systems and controls **528**, **612**), input **614** and output **616** devices, graphical user interface subsystem **106** communication services **618** among modules and to outside systems including the PLC **506**, the automated object system **302**, **516** and cosmetic grading logic **620** and external customer systems **622**, if required. A “computing device” **502** may be comprised of many processing devices and memory units on one machine or across many distributed machines with network communications.

[0045] Although no external integrations are required for the disclosed system to perform its functions, the system may be integrated with customer external systems **622**, such as return logistics applications for which inspection and cosmetic grading may be an integral activity. These systems may provide optional object profiles including data, such as object identification, color, size, etc., that may aid in performing inspection and cosmetic grading and returning a grade, dispositional path, or recommendation for repair or replacement parts. Further, the inspection and cosmetic grading system logic may be hosted by an external system and accessed via a communications device.

[0046] FIG. **7** illustrates the processes performed by an exemplary image processing system **608**. Images captured by the camera **308** for all sides and orientations of an object may be processed with image processing **608** software modules. The image processing **608** modules comprise computer-executable instructions which when executed by the processor stitch the various images together to provide a full, two-dimensional view of the object **702**. Image capture and processing modules **608** may serve several functions: (1) determine a coordinate center of the object evaluation area, and other object attributes such as size and color, from an initial image, (2) identify and locate defects **704**, (3) calculate the coordinates of the defect **706** relative to

the center of the object, (4) determine the location of the highest intensity light reflection for each defect **708** and (5) identify the length **712** and width **710** of each defect.

[0047] An initial image, such as the one captured in ambient light **514**, may be used to determine the center of an object's evaluation area. If an object profile comprising color and size information about the object has not been provided by an external system, image processing software may identify the color and size of the object and provide this information to the lighting **310** system which makes automatic adjustments for the optimal lighting conditions. The center of the object may provide the origin, or center point for calculating coordinates of defects, as will be described further below. In some embodiments, this measurement may be used to determine the physical center of an object in order to guide an automated object control **302** system to attach to and pick up the object, place it in front of a camera **308** and align it properly for optimal lighting (e.g. lighting configuration, distance from object and lighting intensity) in conjunction with the lighting system controller **310**, **508**.

[0048] In a preferred embodiment, image processing may identify defects using a deep learning algorithm **610** trained on a large number of images with identifiable defects. For example, 2000 – 3000 images from each side and orientation of the object, with identifiable dents, scratches, and other defects. A trained machine learning system **610** can efficiently locate defects or imperfections and identify them based on a trained set of previously categorized data. Many types of algorithms are available for this purpose, including neural network, convolutional neural network, support vector machines, and others. In an embodiment consistent with this disclosure, deep learning methods are used to separate and classify defects from the background and from dust, lint or reflection or other contaminants or artifacts not related to the surface being processed.

[0049] As is illustrated in FIG. 7, deep learning methods **610** are used to detect the defects from the processed image, calculate the length and width of the defect. Coordinates of the defect location may be calculated relative to the previously determined origin or center of the object. In some embodiments, image processing may also calculate the width **710** and length **712** of the defect and locating the pixel of highest intensity light reflection, with the highest intensity reflection indicating the deepest location in a defect. The image processing subsystem **608** may further identify whether the number or dimensions of defects put the object into a particular pre-defined cosmetic grading category according to the logic provided for cosmetic

grading **624**. Images and results for a particular object may be stored as an object record, along with its unique identification (e.g. serial number, asset ID) in the system database for business history and research. The coordinates of defects determined by the image processing system may be sent to the automated object control subsystem controller which may move and position the object in front of the sensor at the location of the defect. The width **710** and length **712** may be calculated and, depending on criteria, such as the number of defects and their length and width, the maximum reflective light intensity row/column of the defect is located **708** and passed onto the sensor for depth measurement. FIG.s **8** and **9** are screen shots of an image of a defect **706** located by the image processing system. FIG. **9** is a magnified view of the image in FIG. **8**.

[0050] Referring back to FIG. **7**, the coordinates of the defect at its point of highest reflected light intensity may be conveyed to the PLC **506** of the automated object controller **302**. The automated object controller **302** may move the device to the sensor at the cross section of the scratch where the reflected light is at its highest intensity. Sweeping the sensor **306** optical spot perpendicular to the scratch or defect at the point of highest reflected light intensity provides a highly accurate measurement of the displacement; the depth of the scratch, or the height of a protrusion. Signals are sent to the sensor controller **520** which processes the signals for width and depth measurements. FIG. **10** is a screen shot of the raw signal received at the sensor controller. FIG. **11** is a screen shot of the signal with respect to encoder values, and FIG. **12** illustrates the measurement signal received after baseline subtraction and illustrates the average width of the defect and the depth as calculated by the sensor.

Method for Cosmetic Grading

[0051] FIG. **13** illustrates the flow of a method performed by a system consistent with this disclosure. This example describes the evaluation of a handheld cellular device by an inspection and cosmetic grading system. The system is initialized **1302**, with all components in their home position. The device may be conveyed to the machine **1304** by a conveyor **202** or placed directly into the system. The object handling system **302** determines the orientation of the item **1306**; the object may be positioned in front of the camera **308** and light assembly **310** by the automated object control extension **304**. The system determines the optimal lighting and adjusts the lighting assembly accordingly. A series of images may be captured as the automated object control **304** rotates the device to allow the camera to capture images from

multiple angles and positions **1308**. Image processing software, discussed and illustrated in FIG. 7, processes the images and combines them into a comprehensive image of the device **1310**. The combined image may then be fed to a deep learning algorithm **610** which may distinguish scratches, dents, dings and cracks (aka defects) on the surface **1312**. The image processing system **608** provides the automated object control **302** with coordinates for the defect, locates each defect and determines the width and length of the defect and the location of the highest intensity pixel **1314**. If the object is clean or has a limited number of defects, as previously defined by a customer, a cosmetic grade **622** may be assigned with no further evaluation required. However, if the system determines that a depth measurement is required, the defect coordinates may be provided to the automated object controller **516**, which may position the device in front of the sensor **306** at the coordinates of the point of highest intensity **1316**. For each such location, the sensor is swept perpendicular to the scratches at the points of greatest displacement (highest light intensity pixel) **1318**. Signals sent by the sensor to signal processor **520** to determine the width and depth **1320** measurements. This information is added to an item profile and conveyed to the computing device where it is stored with the images for historical record of the product profile and used for defect analysis **1322**. A grade analysis is performed using the product profile with a complete defect record and rules for cosmetic grading **1324**. The system determines and assigns the appropriate grade and disposition for the item **1326**.

[0052] As was illustrated above, an operator may have access to view or control the process through an interactive user interface **106**. The interface may be accessed using the PC, a remote computer, a touch screen located on the inspection machine, by mobile phone, or other device with a network connection. The user or operator may view the process as it proceeds, as is illustrated in FIG. 14. Here, the user may view the item currently under inspection **1402**, including its identifying information, color, make and model and the selected profile for the item. The user may also view the activities **1404** as they progress and the duration of each operation **1406**. Other screens allow the user to input or correct information. For example, if there is an IMEI/color mismatch in an item profile coming from an external system, the user may correct the color using a profile capture screen. FIG. 15 is a screenshot of a view of a mobile device **1502** with defect identified by bounding boxes. The operator may view images **1504** from all sides of the device and verify identification of each type of defect **1506**.

[0053] As was discussed previously, alternative embodiments are contemplated for inspection and cosmetic grading of larger objects. For example, a large screen television, which cannot be picked up and rotated may be made stationary while the camera is held by the automated object control with the subsystems moving around the object in order to capture the required images. FIG. 16 provides an illustration of such an automated object control **302** (here, a robotic arm)/camera **308** and object **1602**. Not shown are the enclosure **102**, the image processing **608** and lighting subsystems **310**, which perform their functionality consistent with earlier described embodiments. Also not shown is the sensor system **306**, which is contemplated in some embodiments to be operatively connected to an automated object control **302**, which receives from the image processing system **608** coordinates for defects and high intensity pixels and may be positioned at the coordinates to measure precise width and depth of a defect. In some embodiments, the automated object control mechanism may replace the camera with the sensor following image processing, measuring depth according to the coordinates provided by the image processing system.

[0054] Still other embodiments of the disclosed system and method may be adapted for use with larger products. For example, a car may be cosmetically graded or evaluated in a drive-in enclosure equipped with an arm **302** that may support the camera and lighting system. The arm may revolve around the vehicle capturing images of the entire vehicle. Image processing may determine the coordinates of a defect and provide the coordinates to the sensor **306** for depth measurement. These examples are not to be considered limiting and are for illustration only. Alternative embodiments may be adapted for the size, or other special requirements for inspecting defects on an object surface, where the embodiments comprise the components disclosed herein in alternative configuration and function.

[0055] The system and method disclosed herein comprises a computing device and various hardware component (i.e. positioning automation, cameras, lighting, sensor) subsystems, each with programmable controllers that provide the logic for each subsystem to perform its role in the system. Users may program the controllers by writing executable code on the computing device and transferring it to the controller.

[0056] A computing device **502** may also be referred to as a computer or server. Software applications, comprised of computer-executable instructions stored in non-transitory memory or non-transitory secondary storage for execution by a processor are operatively configured to

perform the operations as described in the various embodiments. The software applications may correspond with a single module or any number of modules. Modules of a computer system may be made from hardware, software, or a combination of the two. Generally, software modules are program code or instructions for controlling a computer processor to perform a particular method to implement the features or operations of the system. The modules may also be implemented using program products or a combination of software and specialized hardware components. In addition, the modules may be executed on multiple processors for processing a large number of transactions, if necessary or desired.

[0057] Although the computer, computing device or server **502** has been described with various components, it should be noted that such a computer, computing device or server can contain additional or different components and configurations. In addition, although aspects of an implementation consistent with the system disclosed are described as being stored in memory, these aspects can also be stored on or read from other types of computer program products or computer-readable media, such as secondary storage devices, including hard disks, floppy disks, or CD-ROM; a non-transitory carrier wave from the Internet or other network; or other forms of RAM or ROM. Furthermore, it should be recognized that computational resources can be distributed, and computing devices can be client or server computers. Client computers and devices (e.g.) are those used by end users to access information from a server over a network, such as the Internet or a local area network. These devices can be a desktop or laptop computer, a standalone desktop, or any other type of computing device. Servers are understood to be those computing devices that provide services to other machines, and can be (but are not required to be) dedicated to hosting applications or content to be accessed by any number of client computers. Operations may be performed from a single computing device or distributed across geographically or logically diverse locations.

[0058] Communications between subsystems may be driven by computing device executable code by some type of interface, such as ethernet, Bluetooth, USB, or other connection. Remote access by customers or users may be provided by web services or networks. A computing device may transmit network-based services requests to external systems networks via external networks. In various embodiments, external networks may encompass any suitable combination of networking hardware and protocols necessary to establish network-based communications between clients and service provider network. For example, a network may generally comprise

various telecommunications networks and service providers that collectively implement the Internet. A network may also include private networks such as local area networks (LANs) or wide area networks (WANs) as well as public or private wireless networks. For example, both a given client and service provider network may be provisioned within enterprises having their own internal networks. In such an embodiment, a network may include the hardware (e.g., modems, routers, switches, load balancers, proxy servers, etc.) and software (e.g., protocol stacks, accounting software, firewall/security software, etc.) necessary to establish a link between a client and the Internet as well as between the Internet and a service provider network. It is noted that in some embodiments, clients may communicate with server provider network using a private network rather than the public Internet.

[0059] Although the present disclosure has been described in detail, it should be understood that various changes, substitutions and alterations may be made herein without departing from the spirit and scope of the disclosure as defined by the appended claims. Moreover, the scope of the present application is not intended to be limited to the particular embodiments of the process, machine, manufacture, means, methods and steps described in the specification. As one of ordinary skill in the art will readily appreciate from the disclosure, processes, machines, manufacture, means, methods or steps presently existing or later to be developed that perform substantially the same function or achieve substantially the same result as the corresponding embodiments described herein may be utilized according to the present disclosure. Accordingly, the appended claims are intended to include within their scope such processes, machines, manufacture, means, methods or steps.

CLAIMS

What is claimed is:

1. A device for inspecting and evaluating object surface defects, comprising:

a computing device with one or more processors and memory;

an automated control system controlled by a processor, operatively configured to receive instructions from a control module comprising computer- executable instructions which when executed by the processor direct the automated control system interaction with an object comprised of one or more materials;

an image capture subsystem controlled by a processor, operatively configured to determine image capture conditions, direct lighting system adjustments,

capture images of objects and transmit image signals to an image processing module;

a lighting subsystem controlled by a processor and operatively configured to receive and follow instructions from the image capture subsystems regarding lighting conditions, wherein the lighting subsystem makes adjustments to illumination placement and intensity as directed by the image capture subsystem;

an image processing module stored in computing device memory which when executed by a processor performs image processing steps comprising:

(i) receiving a signal from the image capture subsystem (ii) processing the signal to capture an image of an object, (iii) determining the two-dimensional coordinate center of the object evaluation area, (iv) detecting, segmenting and classifying the type of each surface defect

using deep learning algorithms, (v) measuring defect length and width, (vi) determining the point of highest reflective light intensity for each defect

(vii) calculating coordinates for identified defects with respect to the coordinate center of the object evaluation area, (viii) transmitting the coordinates of a defect to the automated object control processor and (iv) storing images and data in memory; and

an optical spot sensor subsystem controlled by a processor and operatively configured to measure the depth or protrusion height displacement of a defect at a surface location identified by the image processing module as the point of greatest displacement highest reflective light intensity, such spot sensor measuring depth when the automated control system aligns the object and optical spot sensor at the defect coordinates calculated by the image processing module with reference to the coordinate center of the object face.

2. The device for inspecting and evaluating object surface defects of claim **1**, wherein the image processing system evaluating the image for defects further comprises a machine learning system comprising one or more deep learning algorithms and large data sets wherein a deep learning algorithm is chosen from the group: neural network, convolutional neural network, and support vector machine algorithms.
3. The device for inspecting and evaluating object surface defects of claim **1** wherein the computing device further comprises a cosmetic grading module comprising computer executable instructions that determine a cosmetic grade and recommended disposition for the object based on the number and type of defects and a severity for a defect determined by the length, width and depth of a defect and further directs the item to the appropriate bin or bucket for shipment to a final

disposition.

4. The device for inspecting and evaluating object surface defects of claim 1, where the computing device further comprises a user interface configured to allow manual input, control and process observation.
5. The apparatus to inspect and evaluate object surface defects of claim 1, wherein the computing device further comprises a communications module providing access to external systems wherein the external systems may provide an object profile comprising identifiable information and attributes for an object.
6. A method for automating determination of a cosmetic grade for an object, comprising:
 - capturing by an image processor, a signal from an image capture subsystem and processing the signal to capture an image of an object;
 - determining, by the image processor, the coordinate location of the object evaluation area physical center and storing the information in a database;
 - transmitting, by the processor, the coordinate location of the object evaluation area physical center to an automated object control system processor;
 - positioning the object, by an automated object controller controlled by the control system processor, in front of a camera in multiple orientations;
 - capturing, by the camera, an image for each of the orientations for which the object was placed by the automated object control system, combining the image for each orientation into a comprehensive image and storing the images in memory;

applying one or more deep learning algorithms to the comprehensive image, the machine deep learning algorithm trained to recognize types of defects expected on the surface of the object and to determine and locate surface defects on the object from the comprehensive image and machine deep learning algorithm;

calculating the coordinates of each identified defect relative to the object evaluation area physical center, the coordinates comprising at least the location of the defect pixel of highest light intensity;

counting the number of defects;

locating the defects on the object and measuring the length and width and of the defects;

measuring the depth of a defect by selecting one method from the group consisting of (i) aligning an advanced optical spot sensor with the defect based on the coordinates of the defect relative to the coordinate center of the object and sweeping the sensor spot across the point of highest reflected light intensity; and (ii) applying a machine learning algorithm trained with data collected from advanced optical spot sensor measurements of depth correlated with reflected light intensity at a surface location on the object.

assigning a cosmetic grade to the object based on applying pre-defined object-specific rules and logic for classifying the cosmetic condition of the object according to an evaluation of the located defects and their measurements; and

conveying the object to its final disposition according to its cosmetic grade.

7. The method for automating determination of a cosmetic grade for an object of claim 6, wherein the locating step performed by one or more deep learning

algorithms and large data sets wherein the deep learning algorithms are chosen from the group: neural network, convolutional neural network, and support vector machine algorithms.

8. The method for automating determination of a cosmetic grade and disposition for an object of claim 6, where the measuring step further comprises an image capturing processing system to measure length and width.
9. A method for inspecting and evaluating the condition of an object by, comprising:
 - capturing, by a processor, an image of an object;
 - determining, by a processor the two-dimensional coordinate center of the object evaluation area;
 - locating, by an image processing module comprising memory, a processor and computer executable instructions stored in memory, which when executed by the processor, (i) perform detection, location, segmentation and classification of defects on the surface of the object; (ii) the point of highest reflected light intensity for each defect; (iii) defect length and width, and (iv) the coordinates for identified defects with respect to the coordinate center of the object evaluation area;
 - measuring the depth of a defect at the point of highest reflected light intensity, wherein depth is measured by selecting one method from the group consisting of: (i) sweeping an advanced optical spot laser sensor perpendicular to the defect at the point of highest reflected light intensity, and generating a vertical displacement signal and (ii) applying a machine learning algorithm trained with data collected

from advanced optical spot sensor measurements of depth correlated with reflected light intensity at a surface location on the object;

collecting and storing the data in memory;

applying a cosmetic grade for the item based on pre-defined rules and logic and an evaluation of the located defects and their measurements.

10. The method for determining the depth of a surface defect claim 9, wherein the computing device further comprises a communications module providing access to external systems.

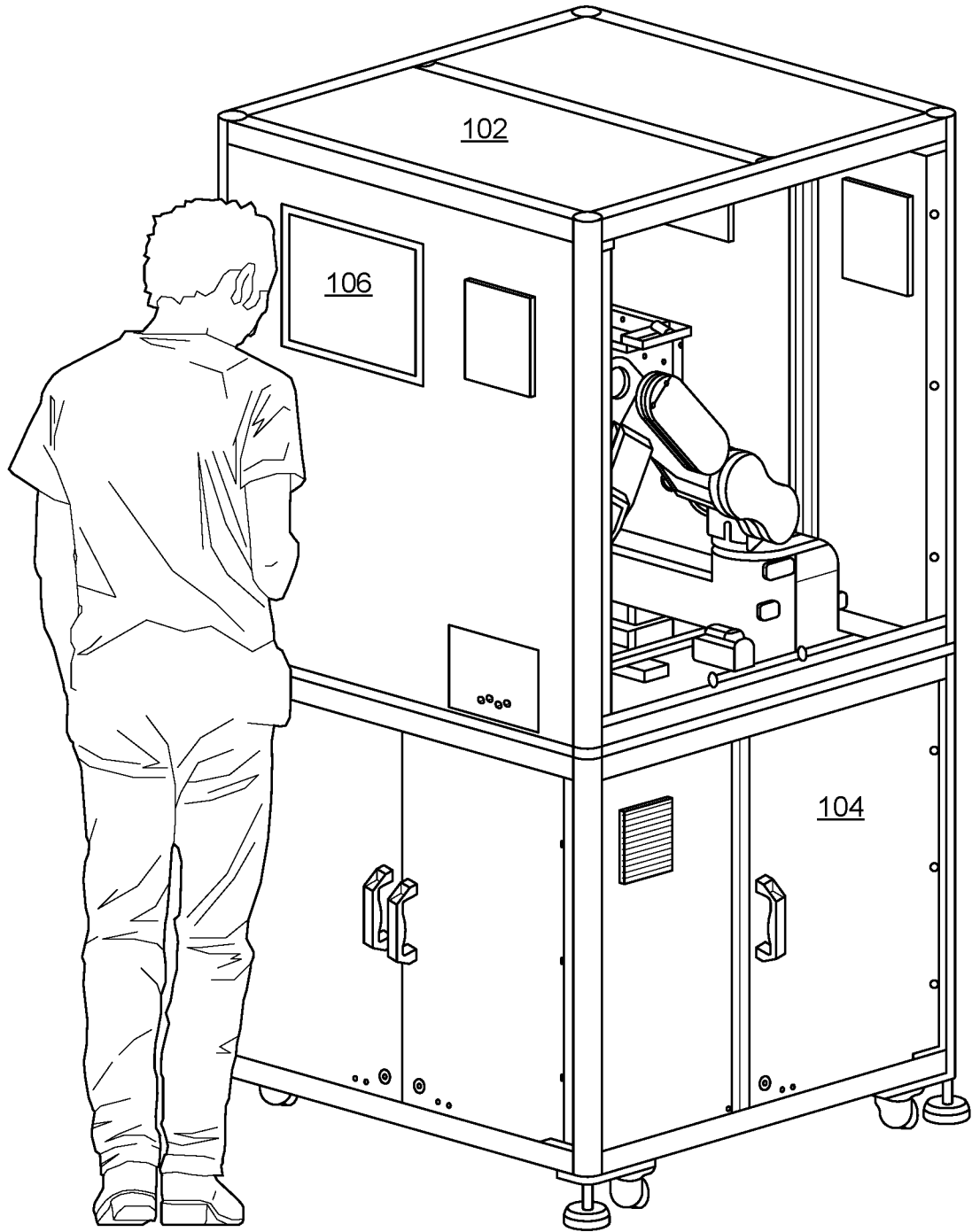

FIG. 1

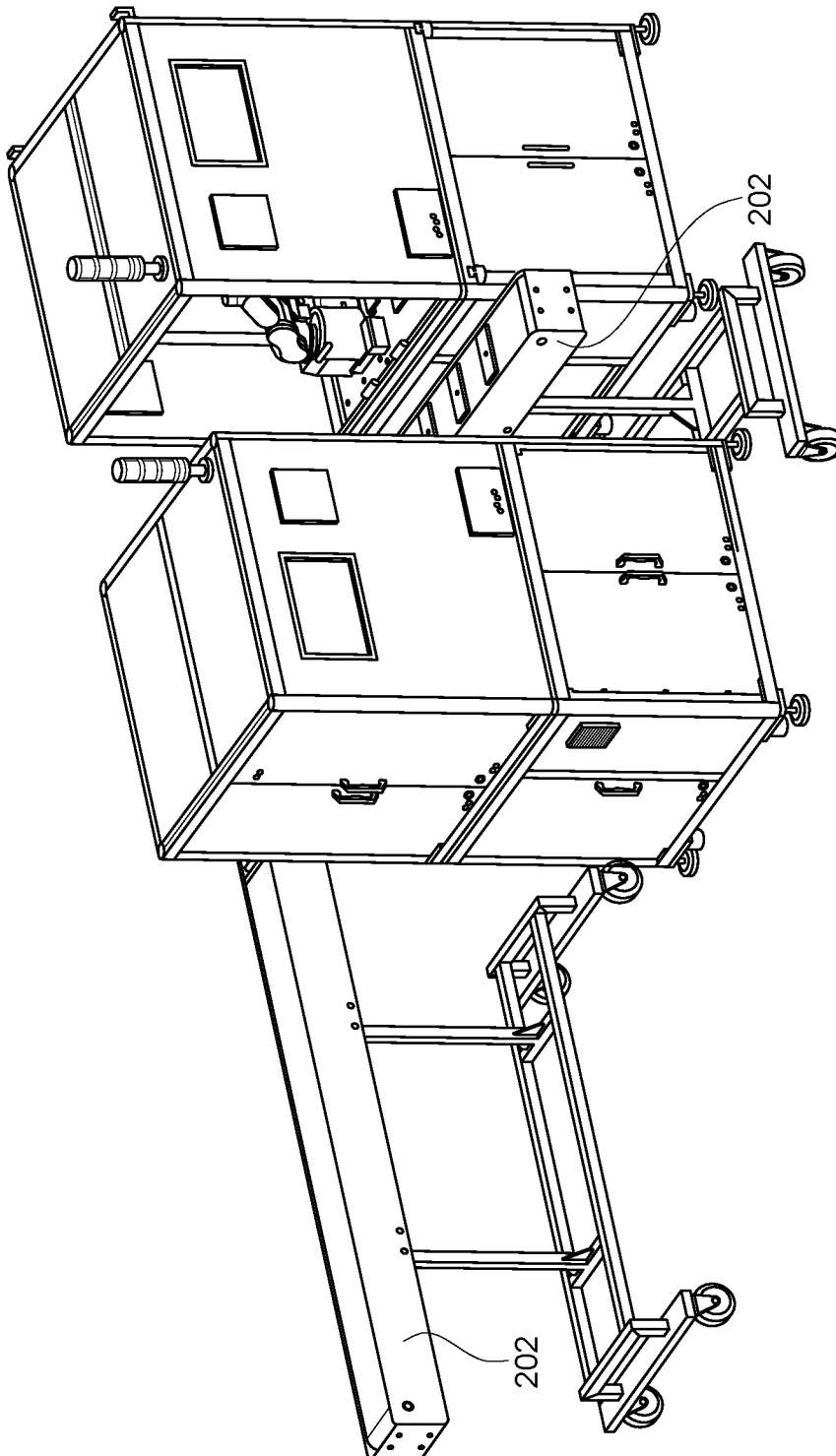

FIG. 2

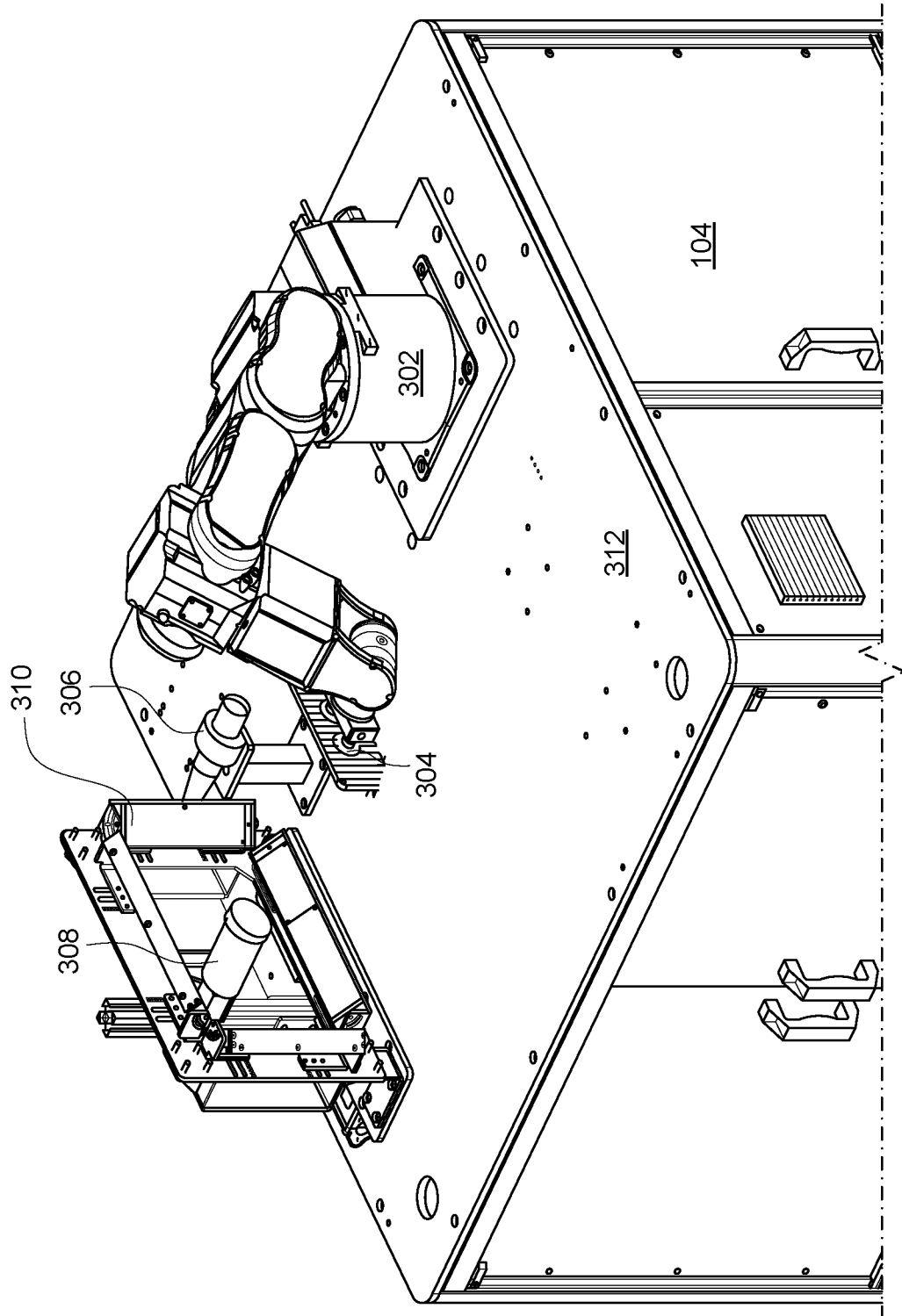

FIG. 3

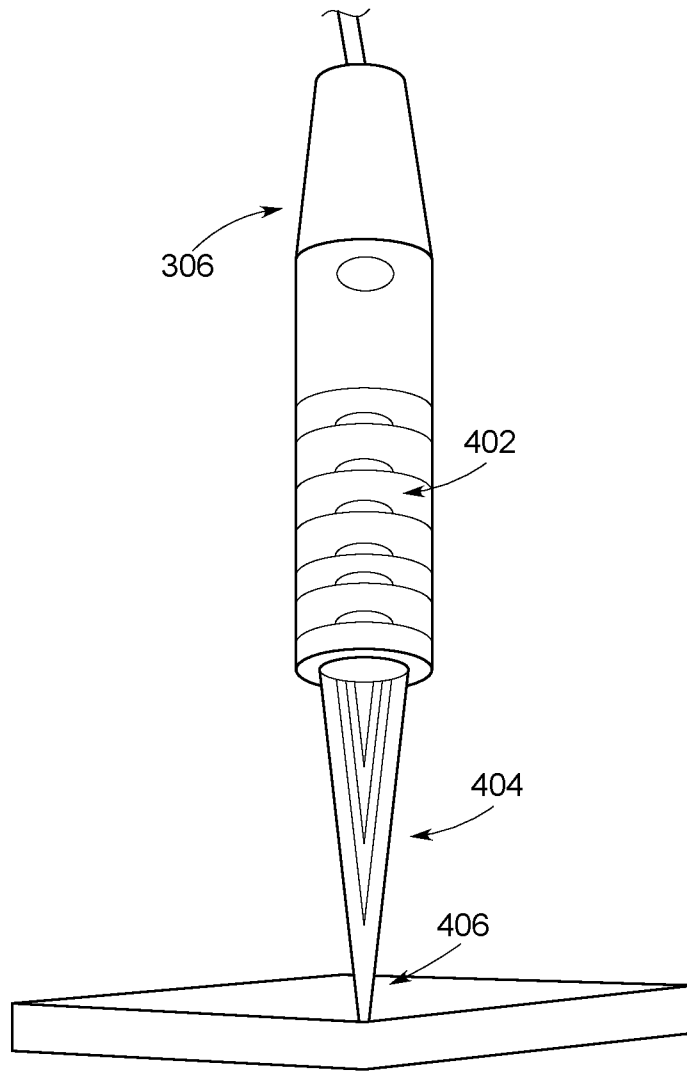

FIG. 4

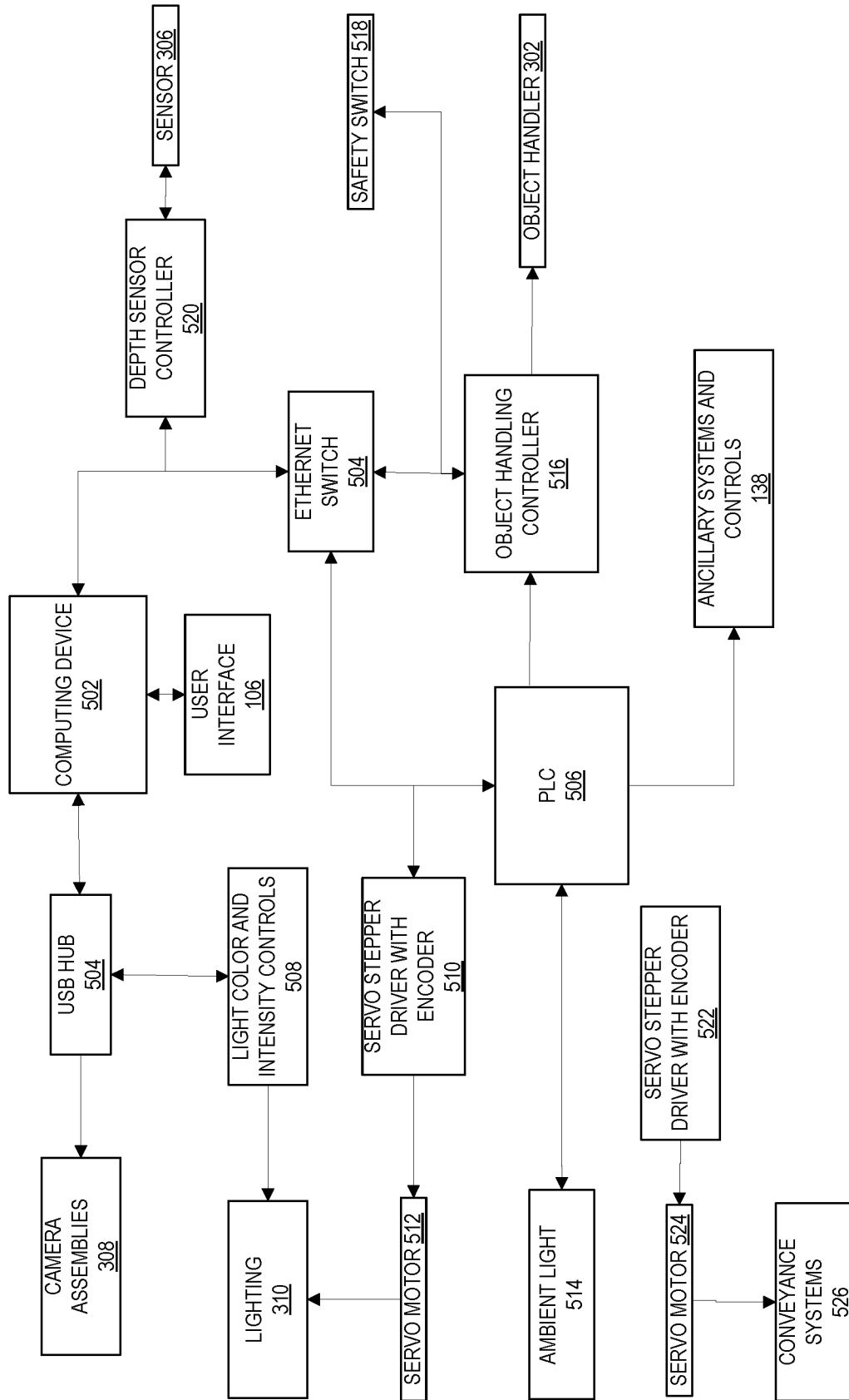

FIG. 5

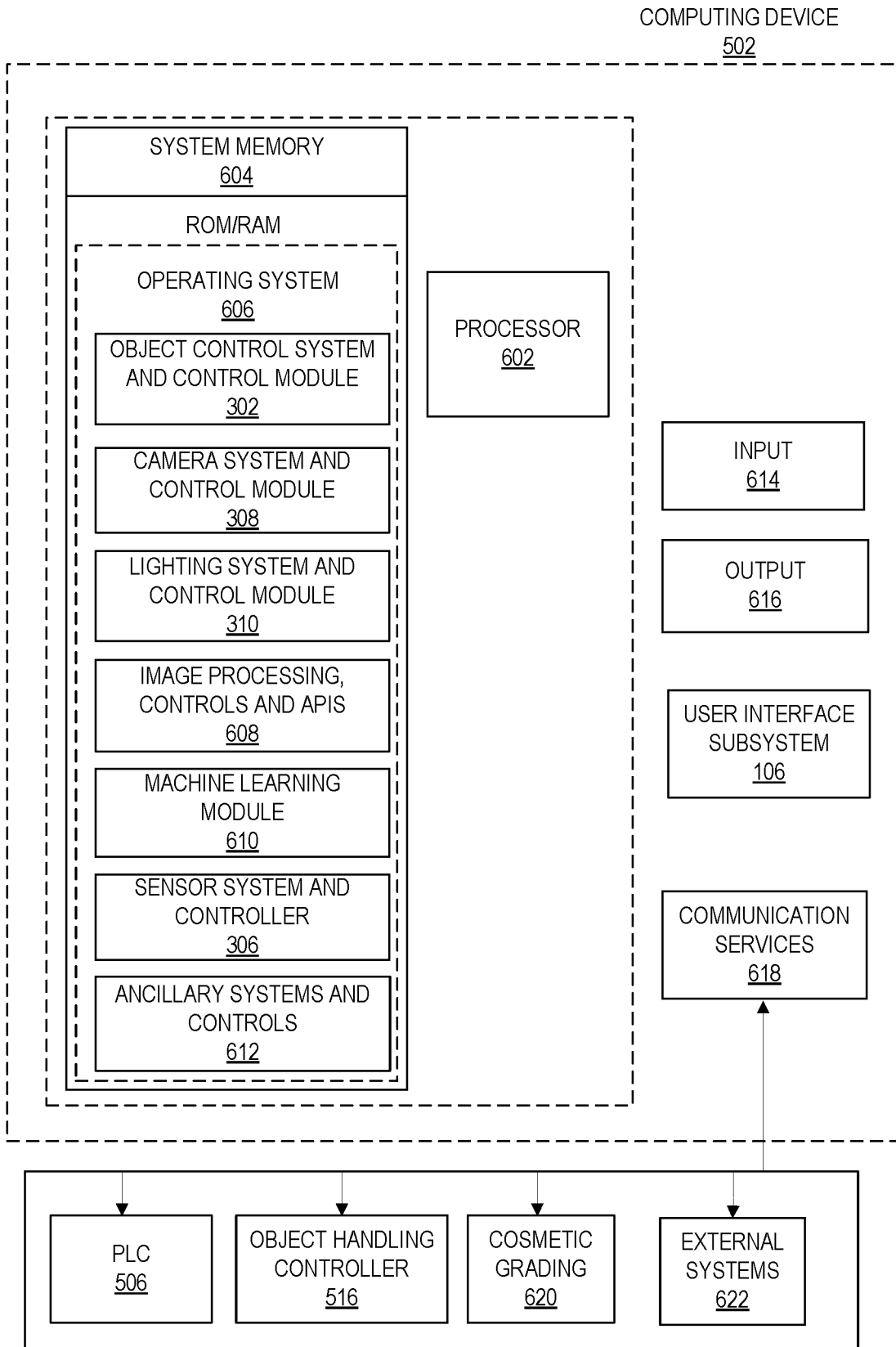

FIG. 6

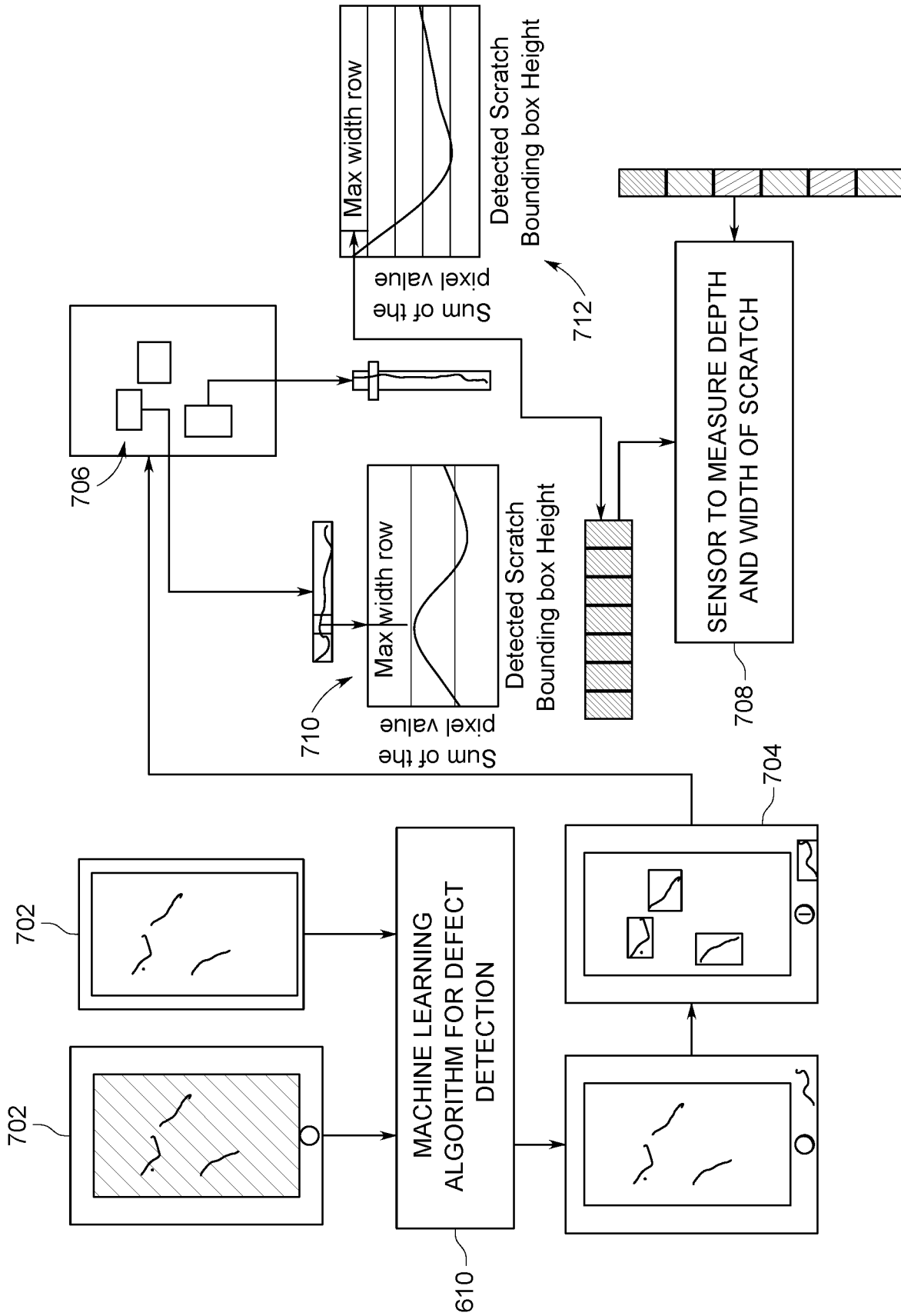

FIG. 7

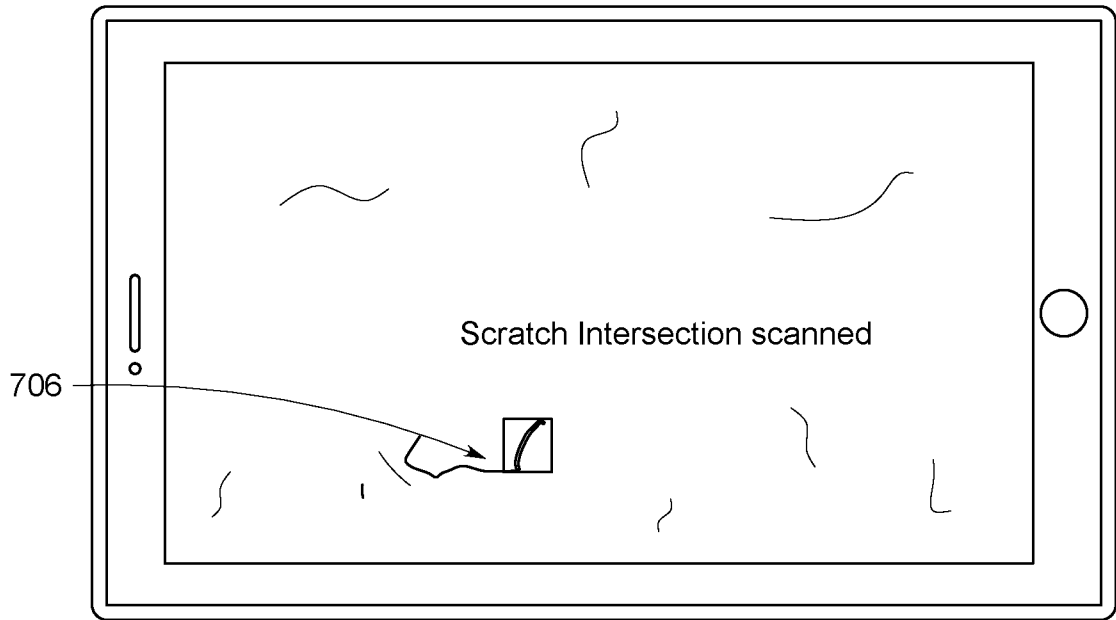

FIG. 8

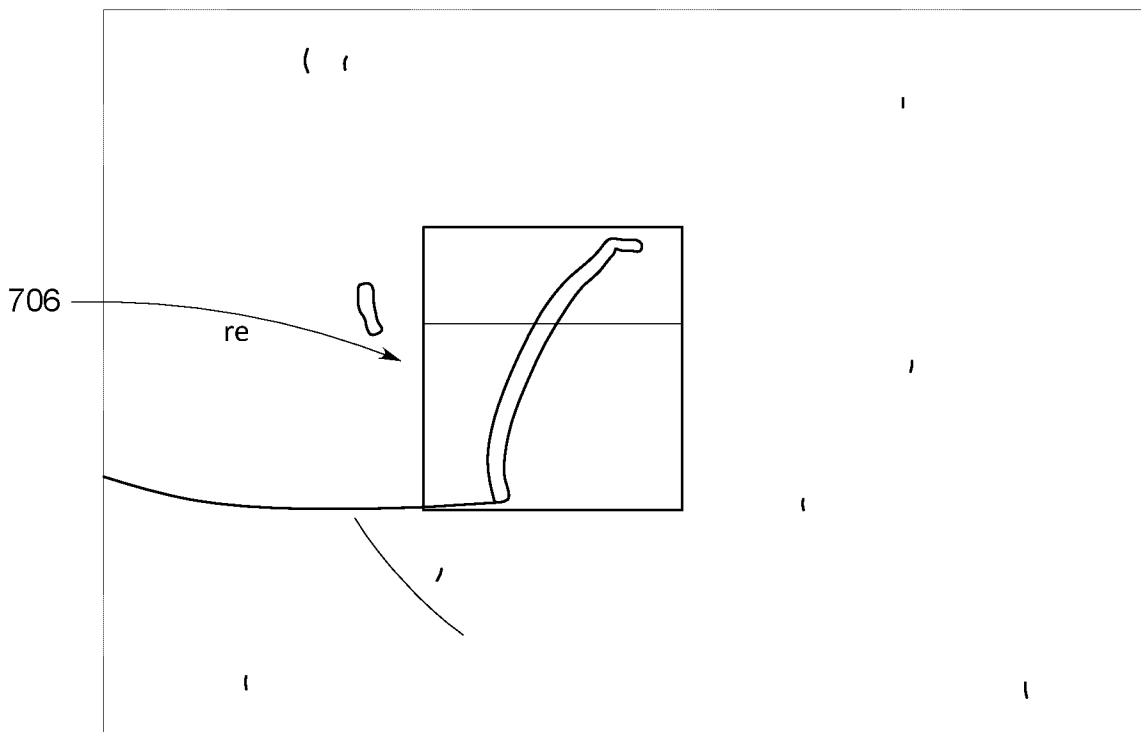

FIG. 9

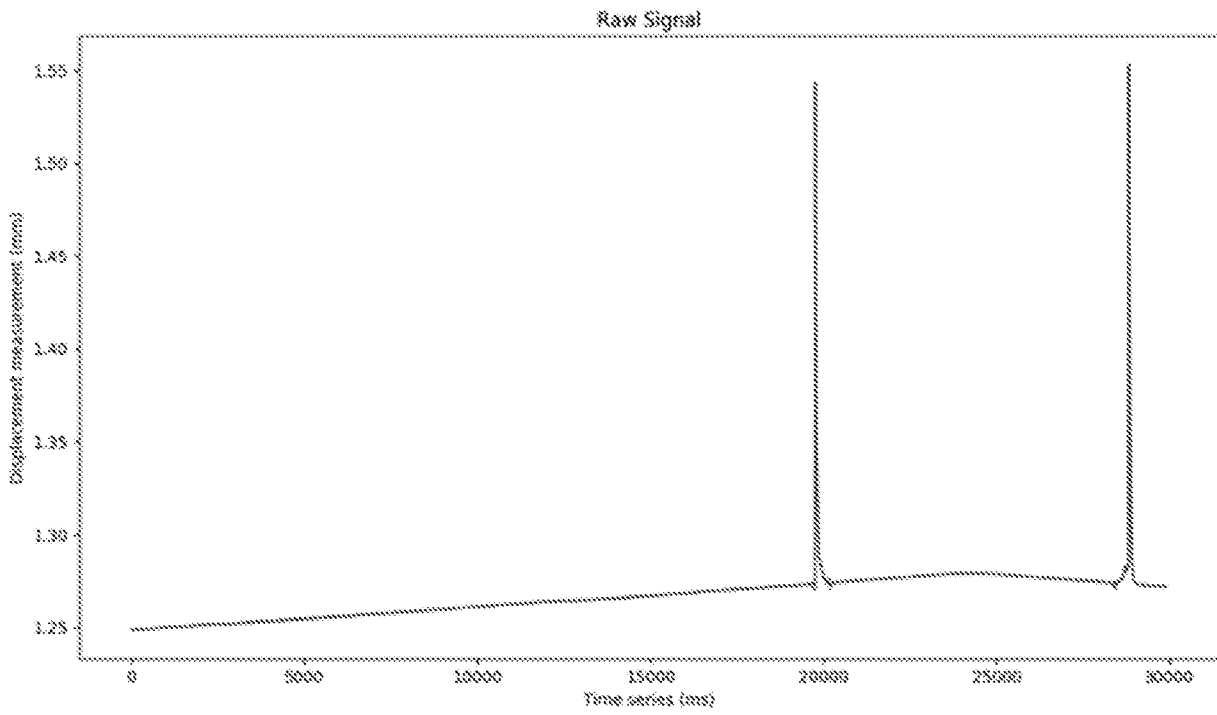

FIG. 10

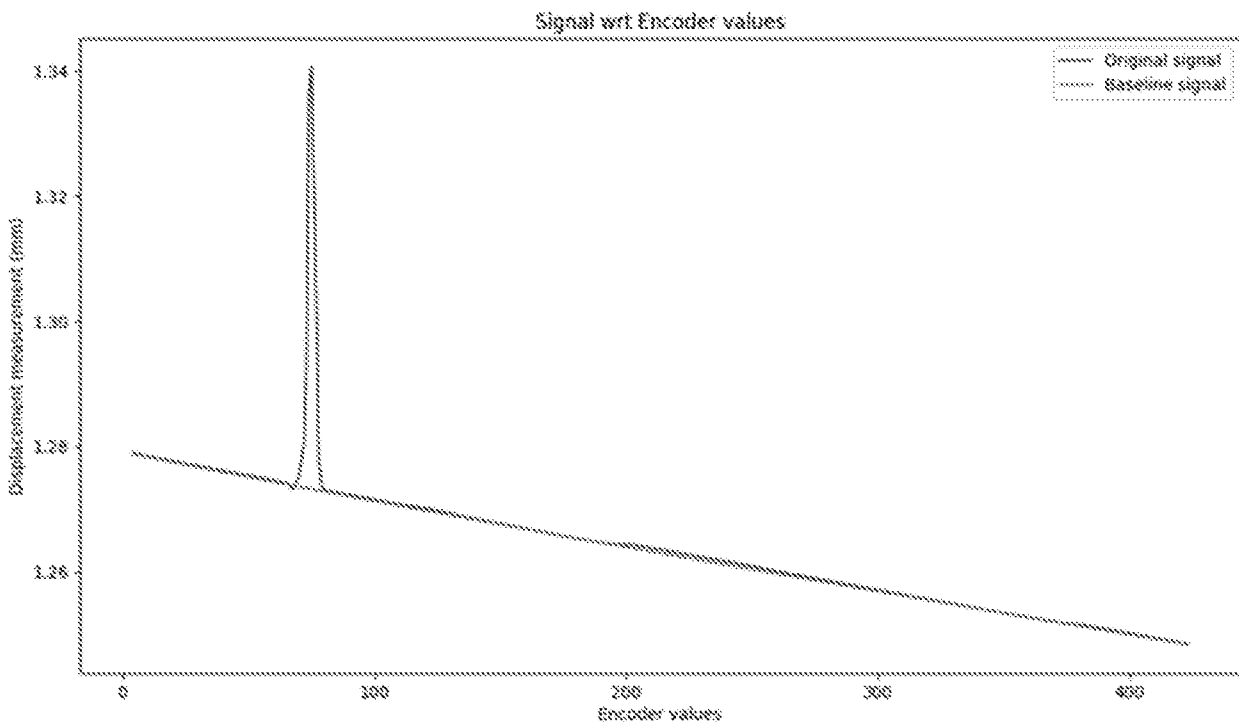

FIG. 11

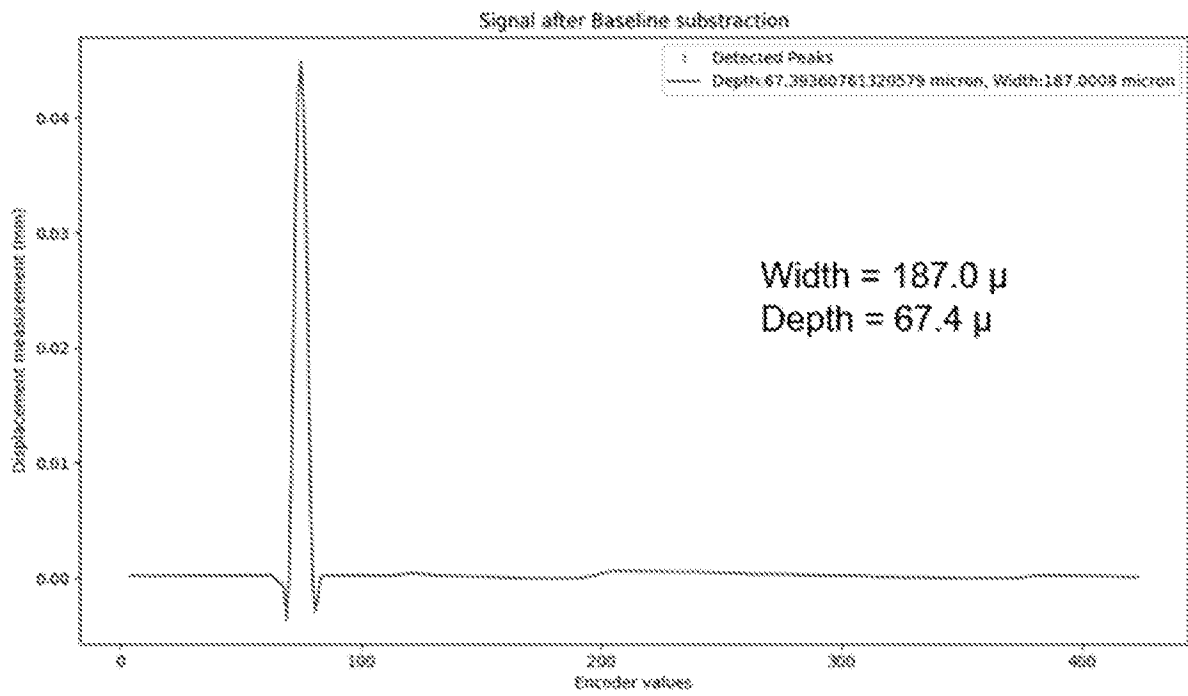

FIG. 12

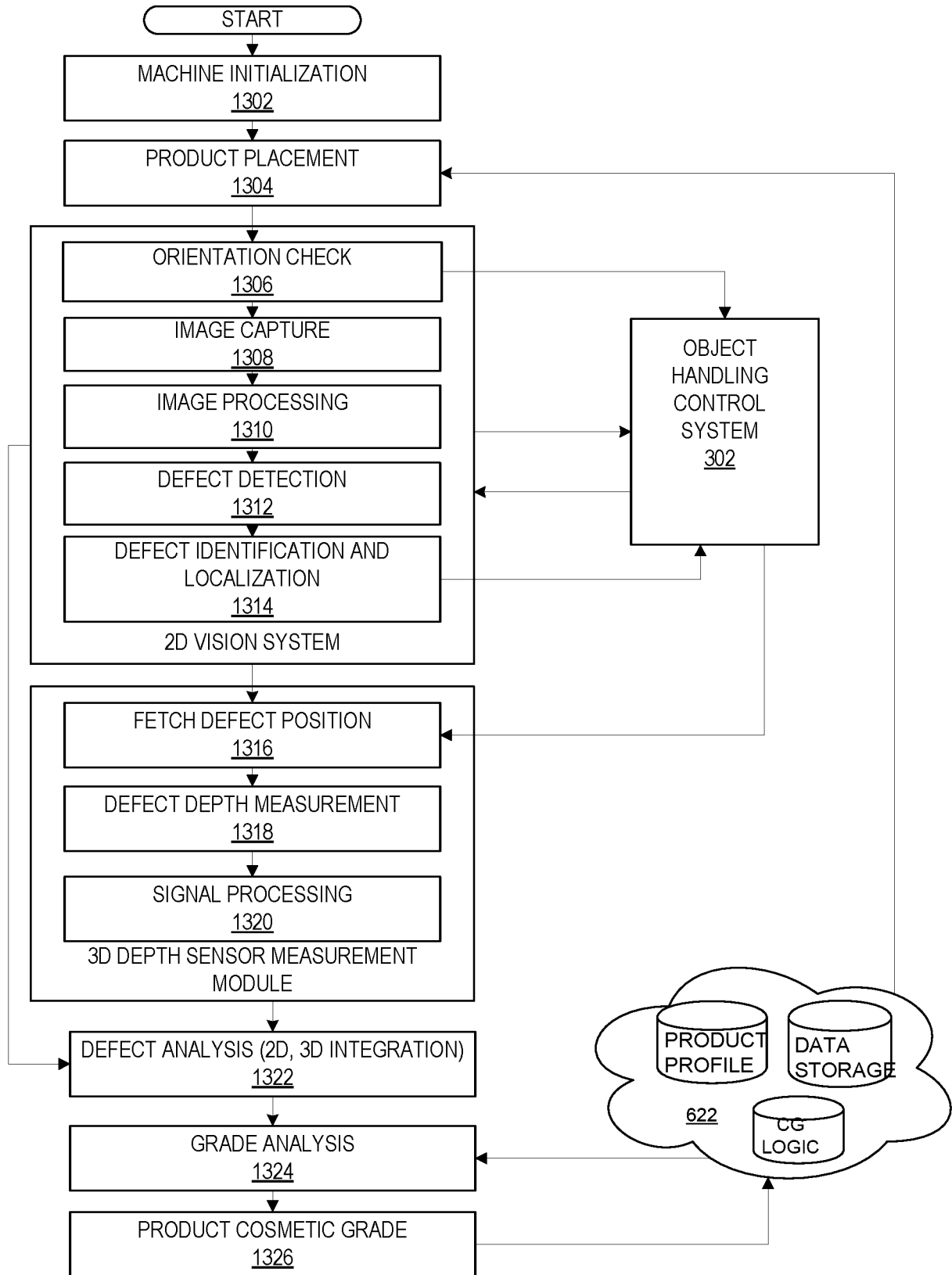

FIG. 13

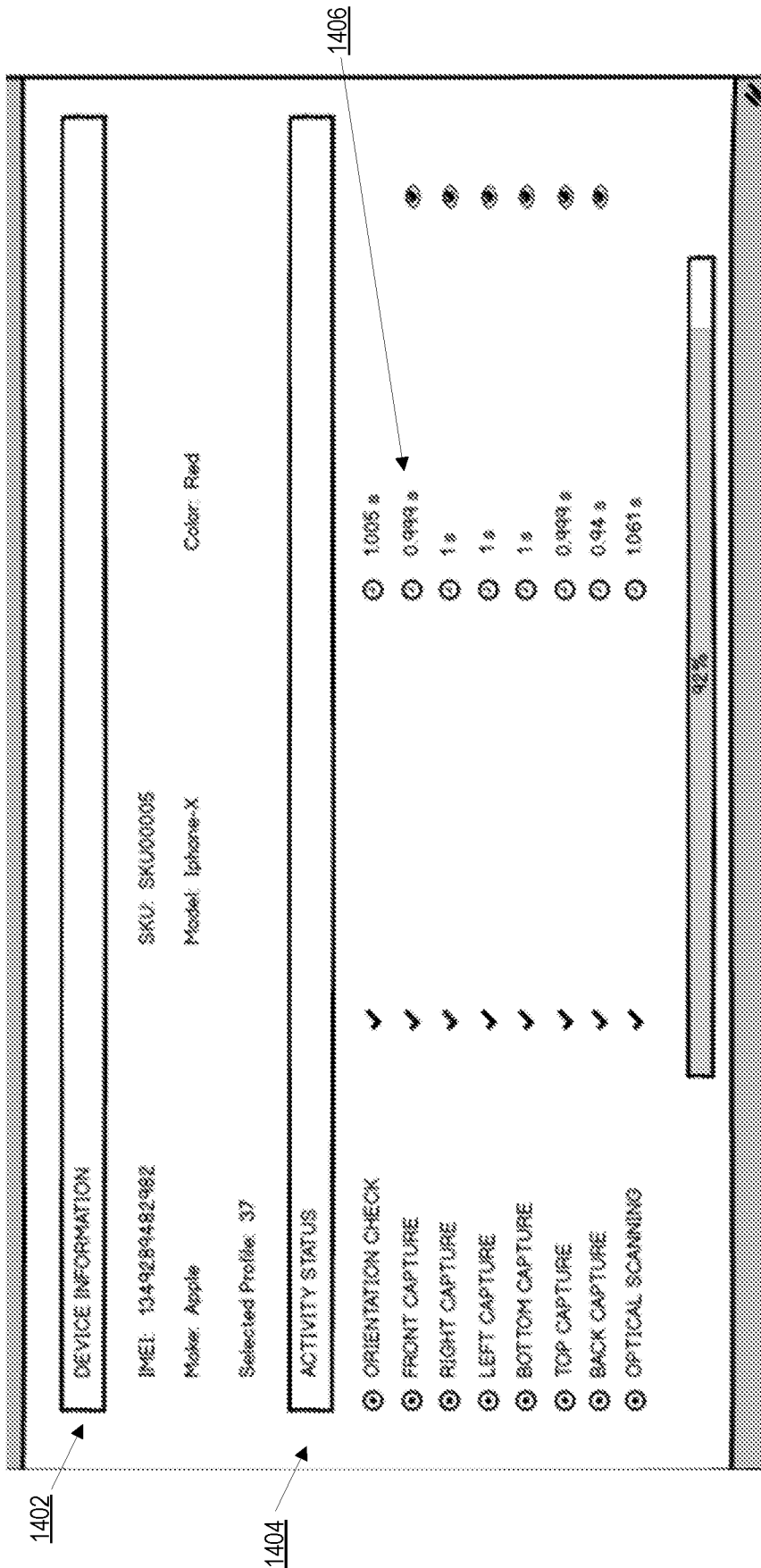

FIG. 14

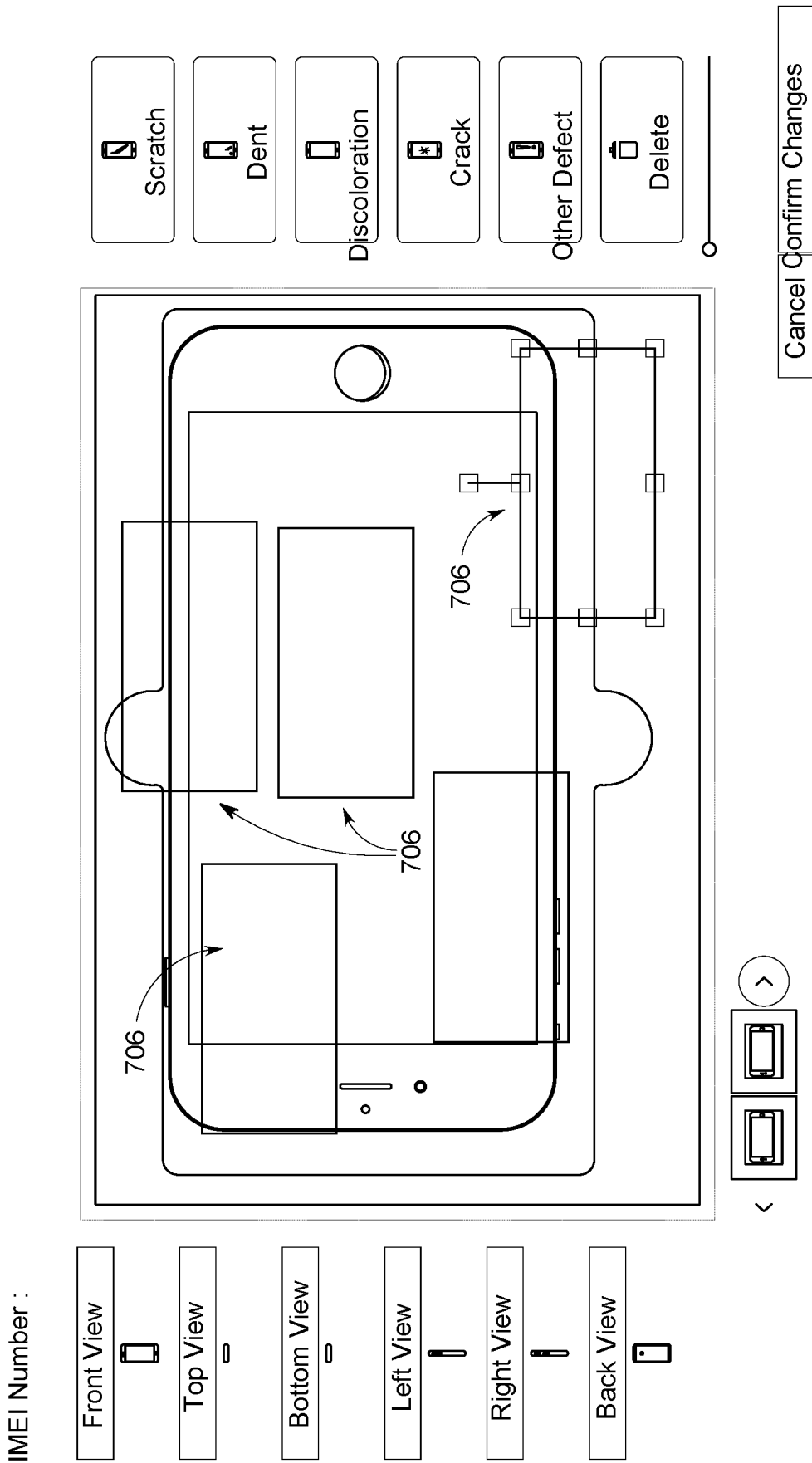

FIG. 15

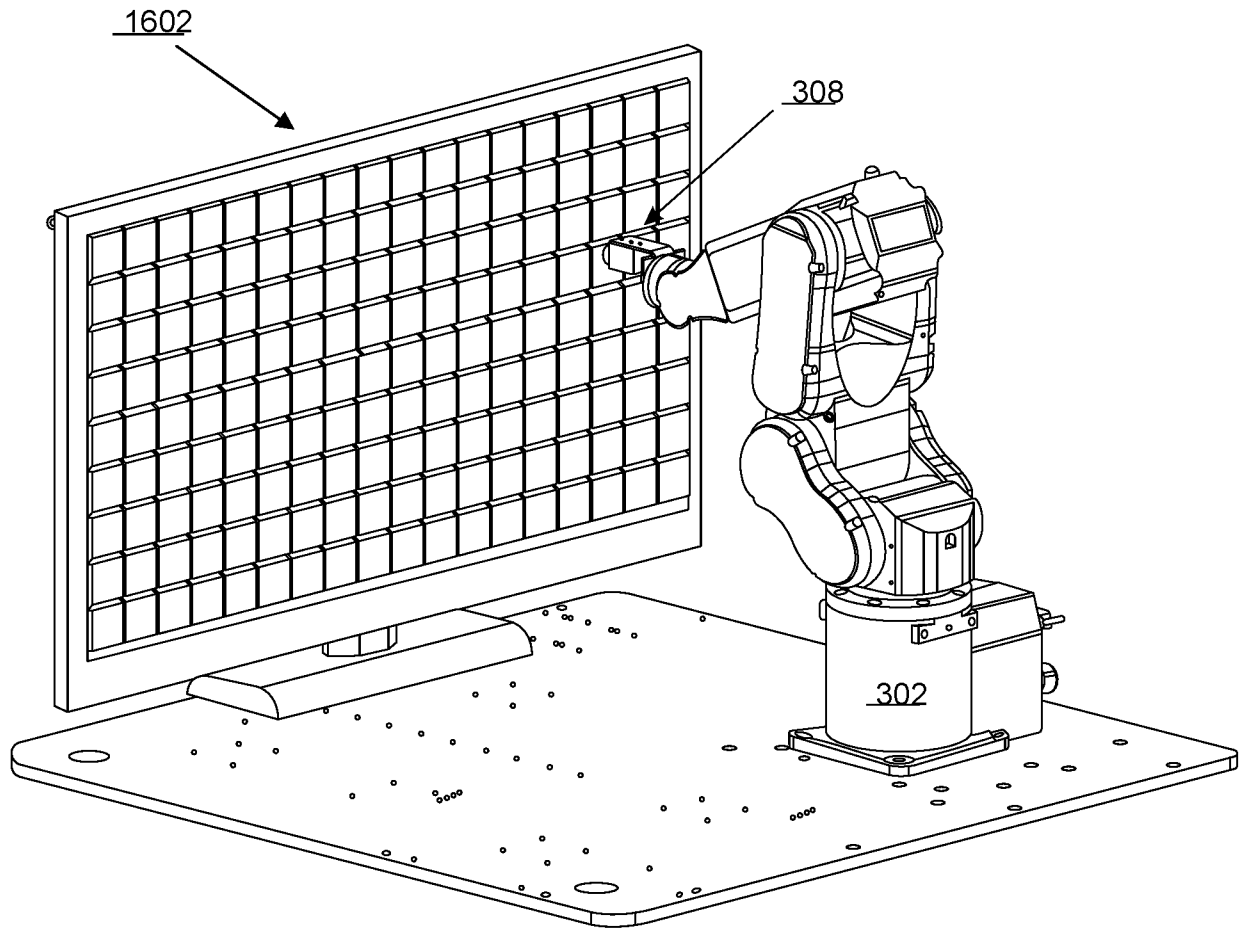

FIG. 16

INTERNATIONAL SEARCH REPORT

International application No.

PCT/US2020/045828

A. CLASSIFICATION OF SUBJECT MATTER

IPC: A24C 5/34; B61L 23/04; G01B 11/02; G01N 21/88; G06T 7/62, 7/00, 7/521; H04N 7/18
 CPC: A24C 5/3412; B61L 23/044, 23/047, 23/048; G01B 11/024

According to International Patent Classification (IPC) or to both national classification and IPC

B. FIELDS SEARCHED

Minimum documentation searched (classification system followed by classification symbols)

CPC: G01N 21/8851, 2021/8874, 2021/8861; G06T 7/62, 7/00002, 7/0002, 7/62, 2207/10152, 2207/20081, 2207/20084, 7/521; G01N 2021/8858

Documentation searched other than minimum documentation to the extent that such documents are included in the fields searched

Electronic data base consulted during the international search (name of data base and, where practicable, search terms used)

US-PGPUB; USPAT; USOCR; FPRS; EPO; JPO; DERWENT; IBM_TDB

C. DOCUMENTS CONSIDERED TO BE RELEVANT

Category*	Citation of document, with indication, where appropriate, of the relevant passages	Relevant to claim No.
A	US 2010/0060902 A1 (WORN SON ET AL.) 11 March 2010 (11.03.2010) , entire document.	1-10
A	US 2016/0116419 A1 (PAVANI) 28 April 2016 (28.04.2016) , entire document.	1-10
A	US 2016/0364851 A1 (KONISHI ET AL.) 15 December 2016 (15.12.2016) , entire document.	1-10
A	US 2018/0213134 A1 (WU ET AL.) 26 July 2018 (26.07.2018) , entire document.	1-10

Further documents are listed in the continuation of Box C. See patent family annex.

* Special categories of cited documents:

"A" document defining the general state of the art which is not considered to be of particular relevance

"D" document cited by the applicant in the international application

"E" earlier application or patent but published on or after the international filing date

"L" document which may throw doubts on priority claim(s) or which is cited to establish the publication date of another citation or other special reason (as specified)

"O" document referring to an oral disclosure, use, exhibition or other means

"P" document published prior to the international filing date but later than the priority date claimed

"T" later document published after the international filing date or priority date and not in conflict with the application but cited to understand the principle or theory underlying the invention

"X" document of particular relevance; the claimed invention cannot be considered novel or cannot be considered to involve an inventive step when the document is taken alone

"Y" document of particular relevance; the claimed invention cannot be considered to involve an inventive step when the document is combined with one or more other such documents, such combination being obvious to a person skilled in the art

"&" document member of the same patent family

Date of the actual completion of the international search

26 August 2020 (26.08.2020)

Date of mailing of the international search report

04 SEP 2020

Name and mailing address of the ISA/US

COMMISSIONER FOR PATENTS MAIL STOP PCT,
ATTN: ISA/US P.O. BOX 1450 ALEXANDRIA, VA
22313-1450, UNITED STATES OF AMERICA

Facsimile No. (571)273-8300

Authorized officer

HARRY KIM

Telephone No. 571-272-4300