



US 20160338719A1

(19) **United States**

(12) **Patent Application Publication** (10) **Pub. No.: US 2016/0338719 A1**

ALLEN, IV et al.

(43) **Pub. Date: Nov. 24, 2016**

(54) **SURGICAL INSTRUMENTS AND METHODS FOR PERFORMING TONSILLECTOMY, ADENOIDECTOMY, AND OTHER SURGICAL PROCEDURES**

(52) **U.S. Cl.**
CPC *A61B 17/3205* (2013.01); *A61B 18/12* (2013.01); *A61B 2017/00424* (2013.01)

(71) Applicant: **COVIDIEN LP**, Mansfield, MA (US)

(57) **ABSTRACT**

(72) Inventors: **JAMES D. ALLEN, IV**, BROOMFIELD, CO (US); **JESSICA E.C. OLSON**, FREDERICK, CO (US); **PURVISH SONI**, DENVER, CO (US); **JASON G. WEIHE**, LONGMONT, CO (US)

An end effector assembly for a surgical instrument includes first and second jaw members, each including a jaw frame, spacer, electrically-conductive plate, and outer housing. The jaw frame includes at least one proximal flange and a distal jaw support extending distally therefrom. The spacer defines a body and a wing disposed on either side of the body. The body defines a channel configured to receive the distal jaw support while each wing defines a slot. The plate defines a tissue-contacting portion and first and second legs extending perpendicularly from the tissue-contacting portion. The tissue-contacting portion is configured to sit atop the body of the spacer. Each of the legs is configured for receipt within the slot defined within one of the wings. The outer housing at least partially surrounds the distal jaw support, spacer, and legs and is configured to retain these components in position relative to one another.

(21) Appl. No.: **14/719,464**

(22) Filed: **May 22, 2015**

Publication Classification

(51) **Int. Cl.**
A61B 17/3205 (2006.01)
A61B 18/12 (2006.01)

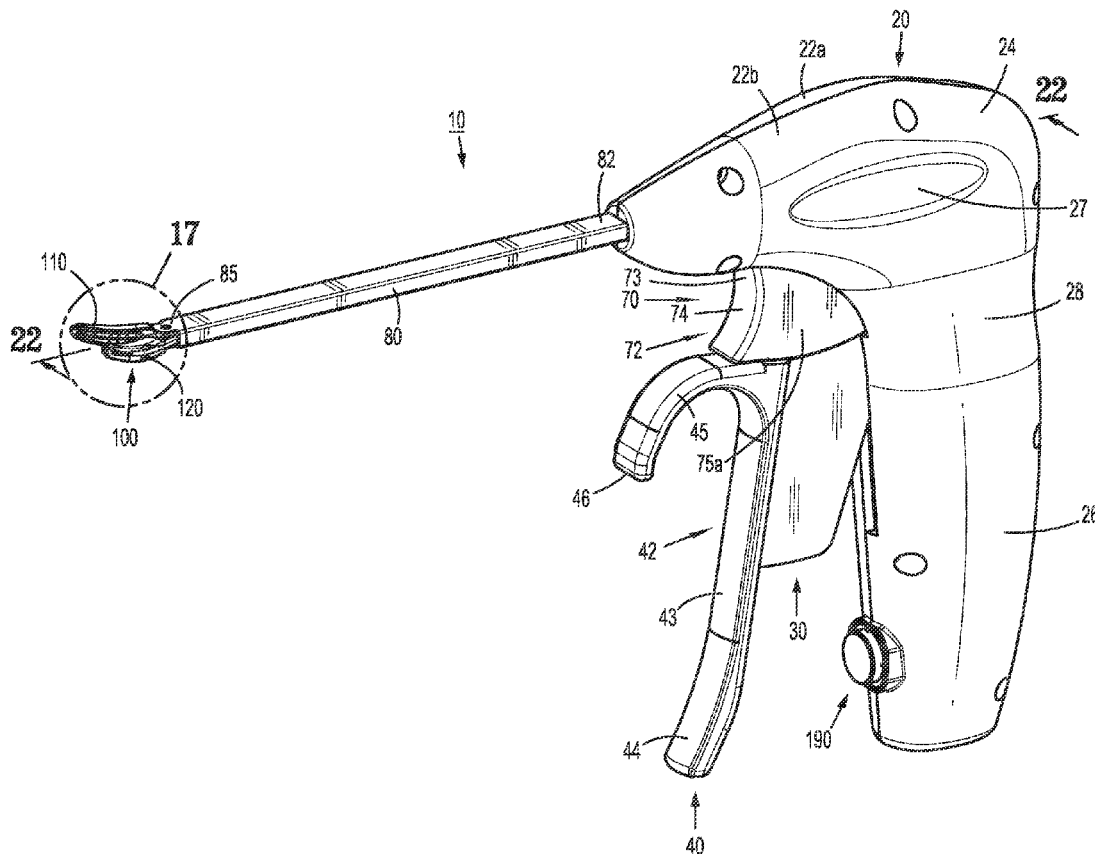

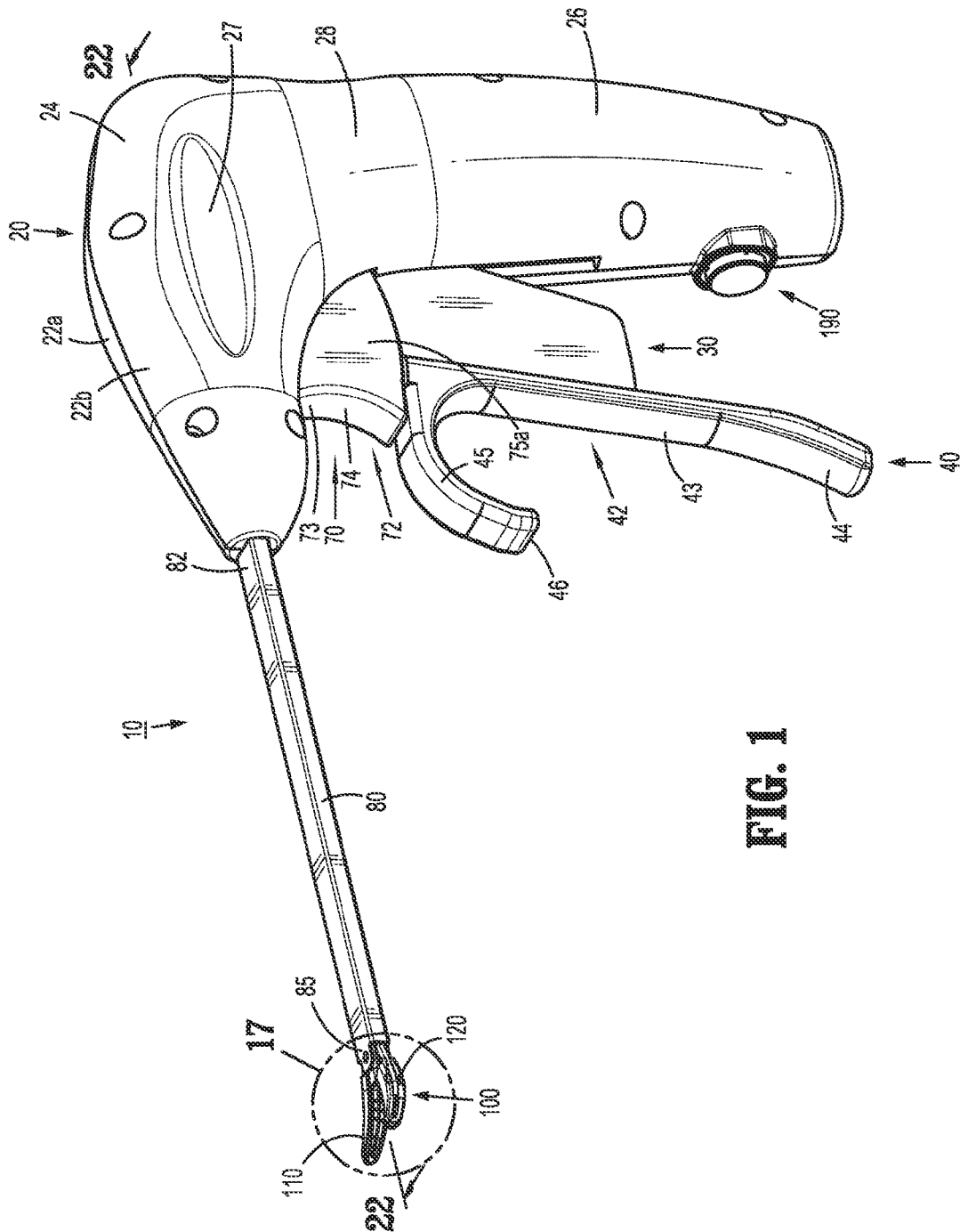

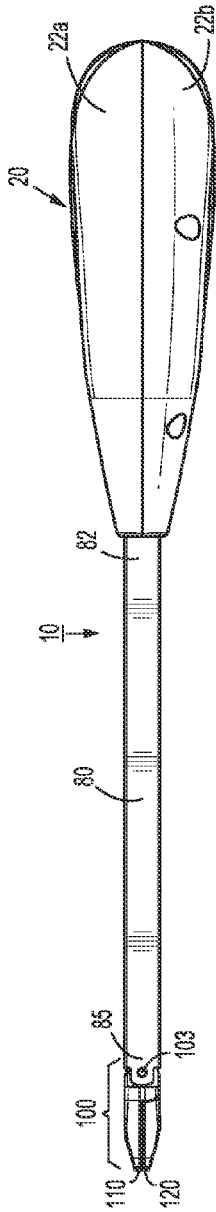

FIG. 2

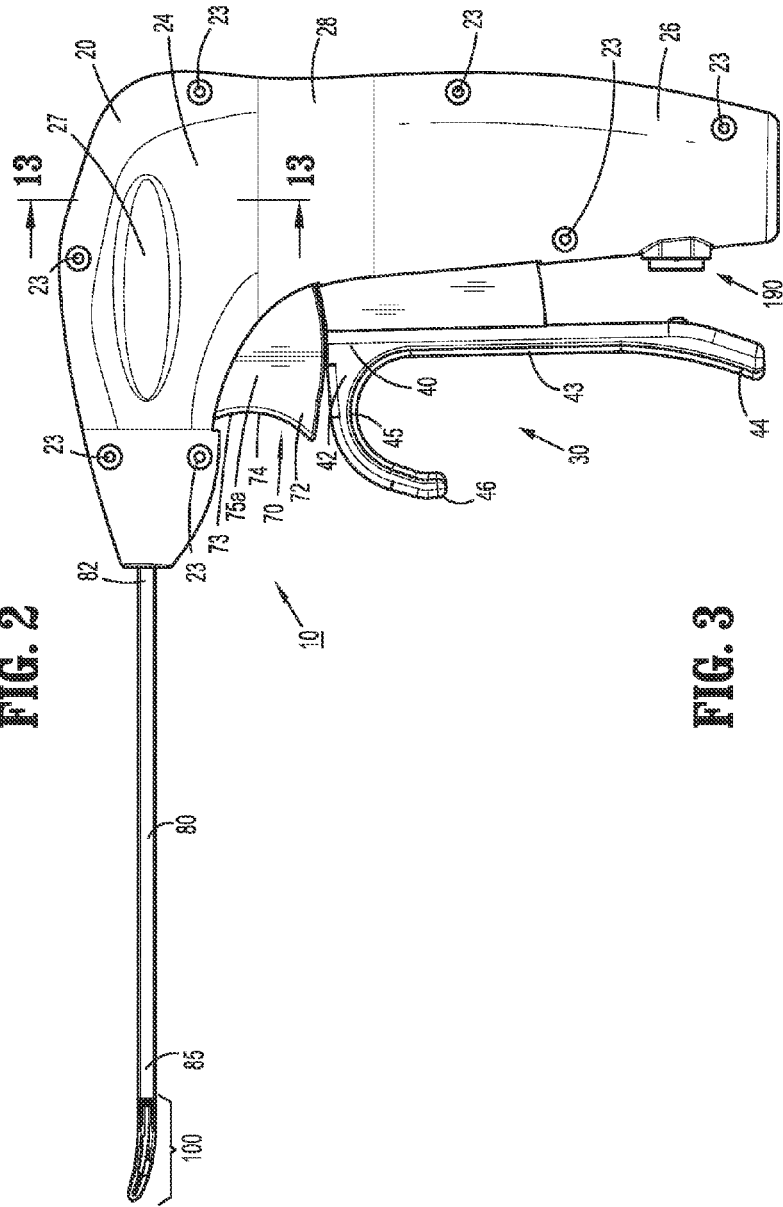
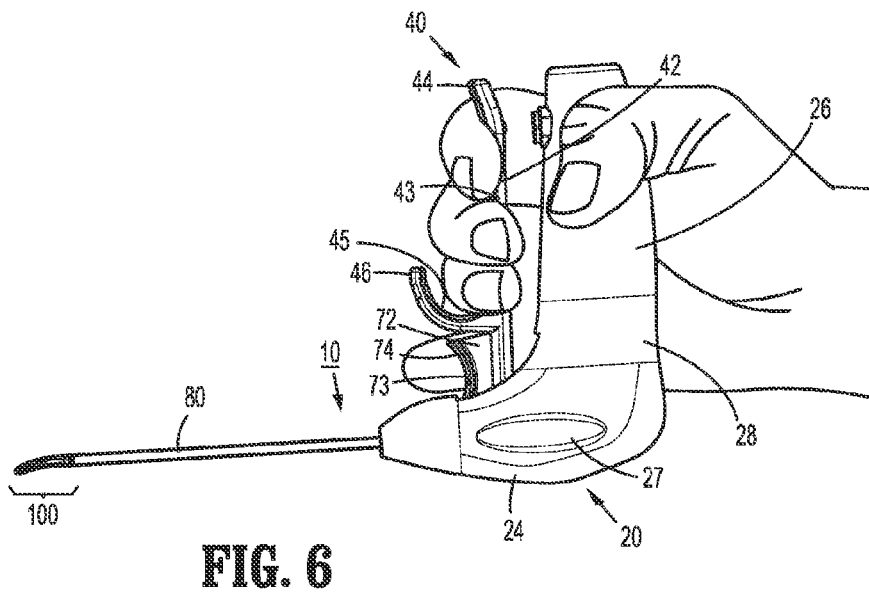
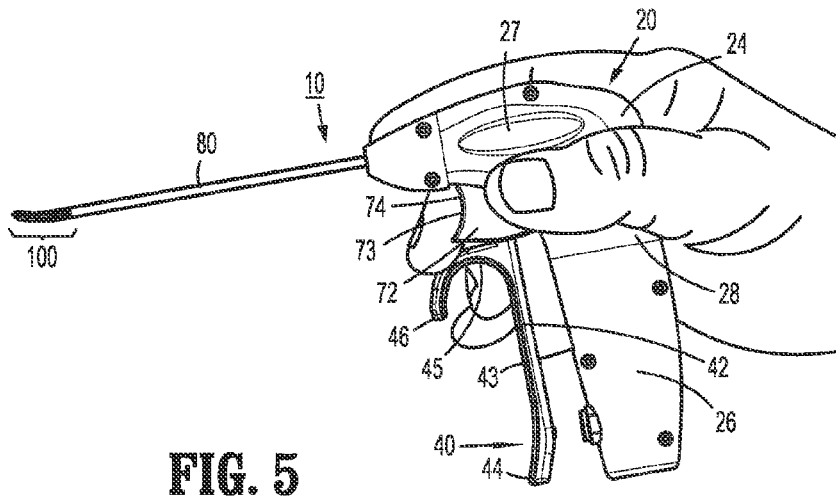
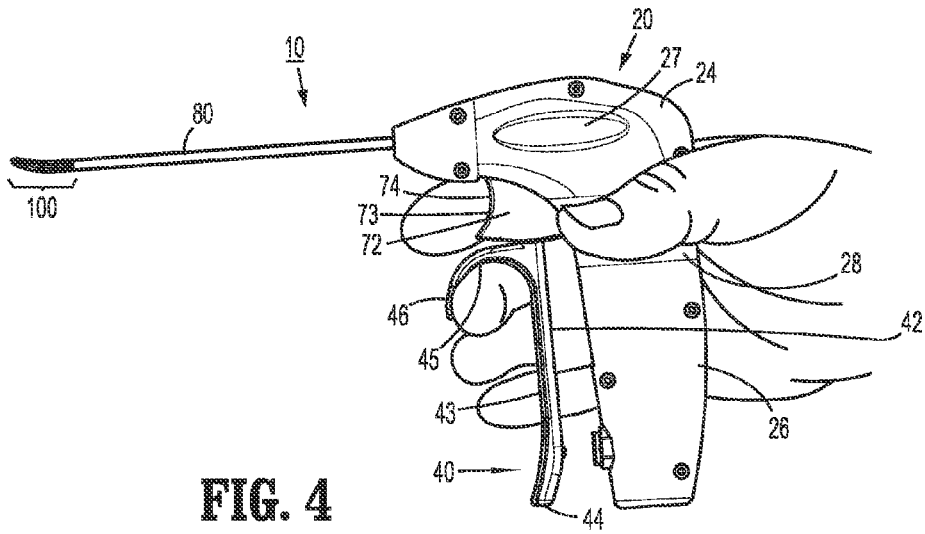

FIG. 3



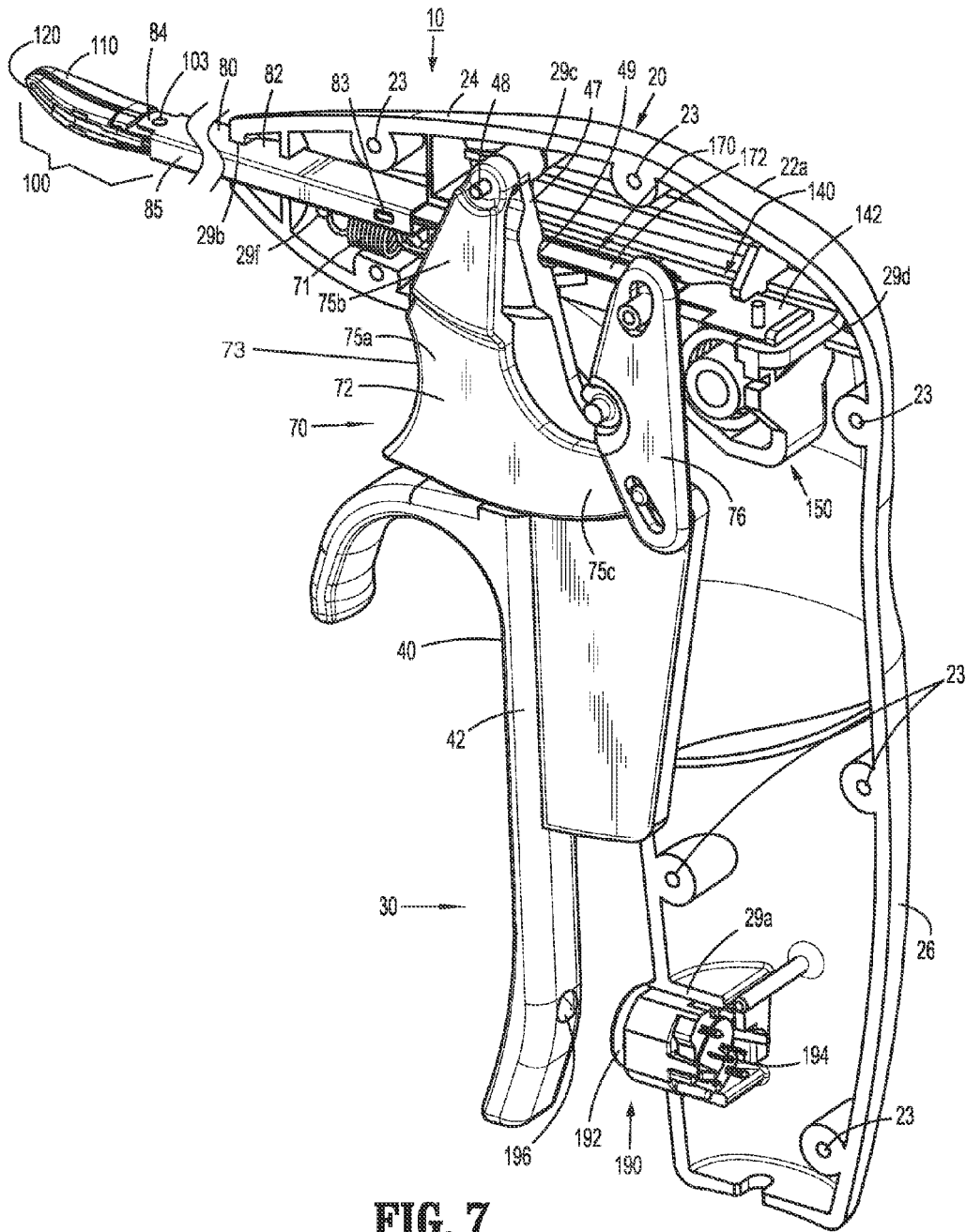

FIG. 7

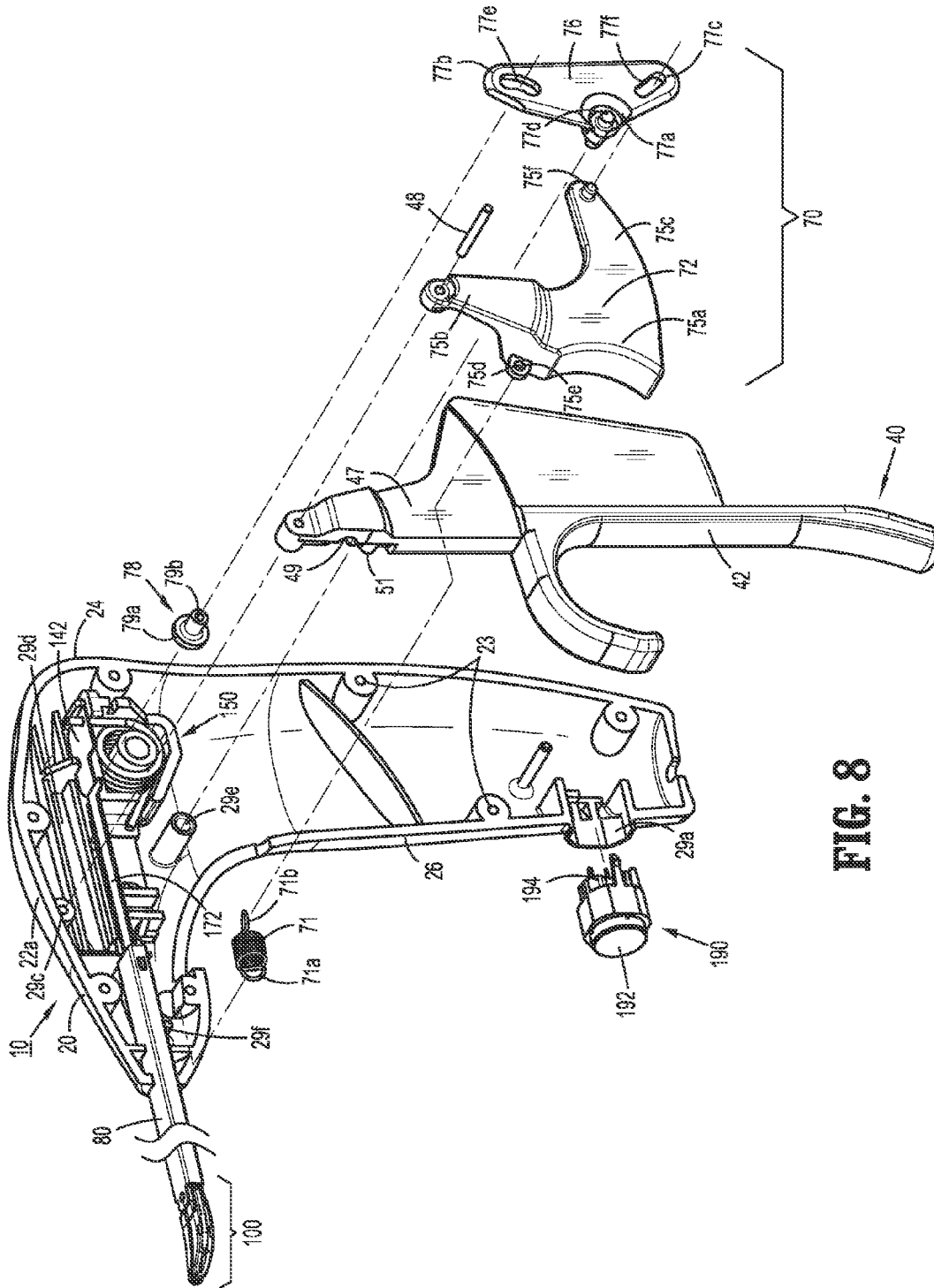

FIG. 8

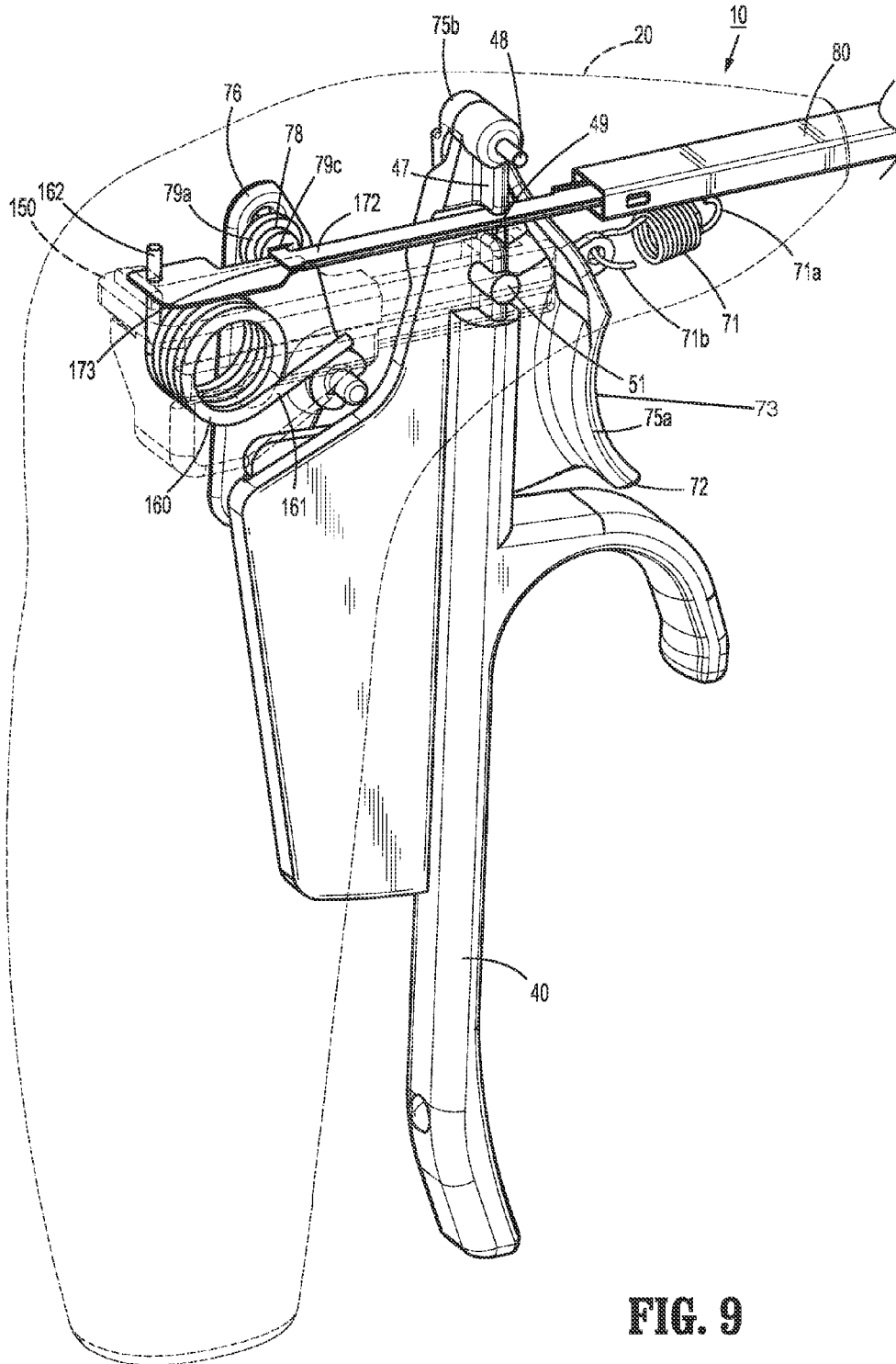

FIG. 9

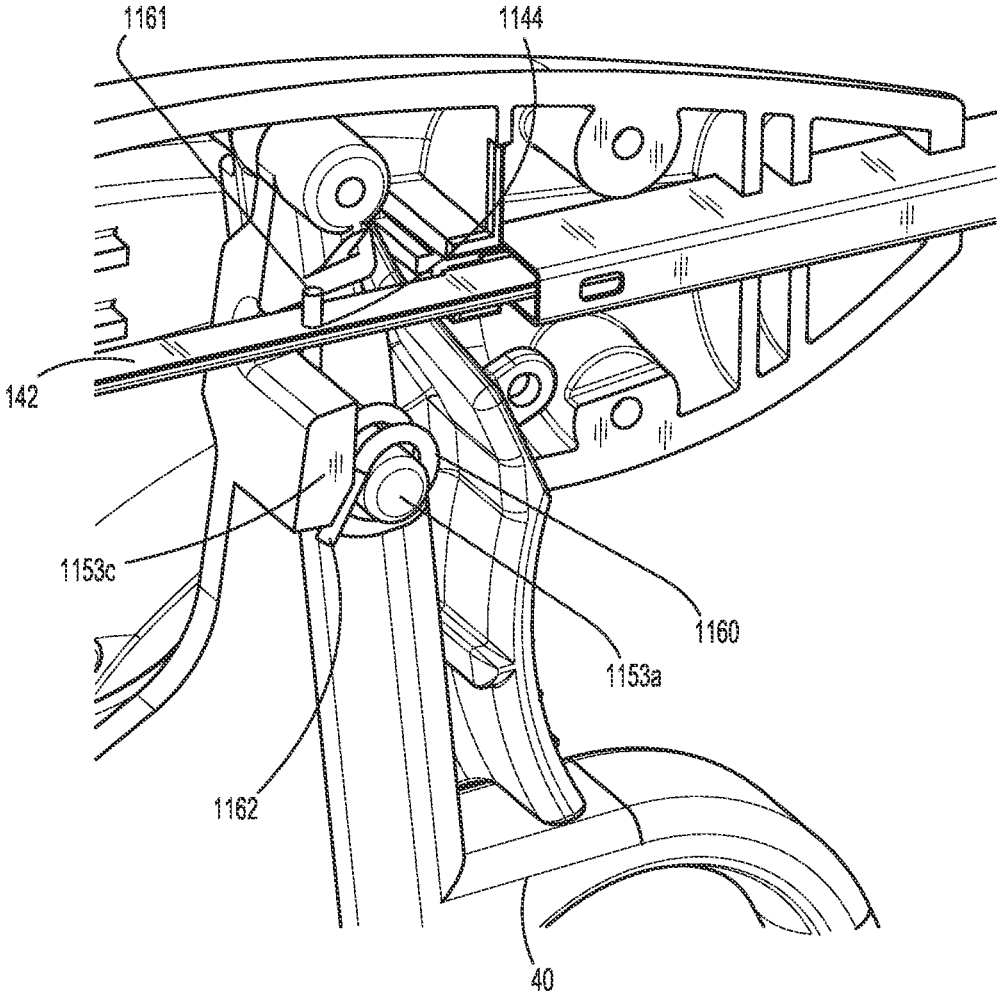

FIG. 9A

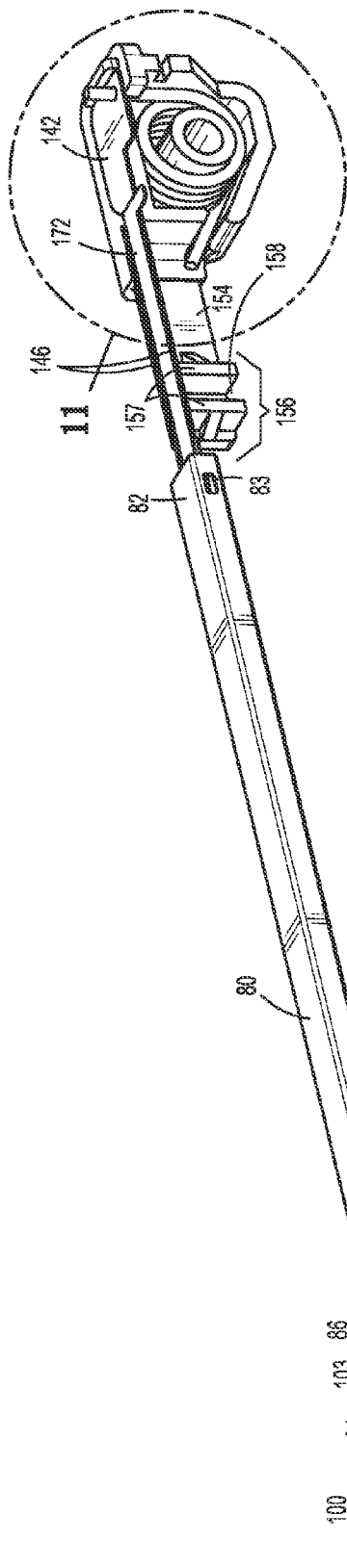

FIG. 10

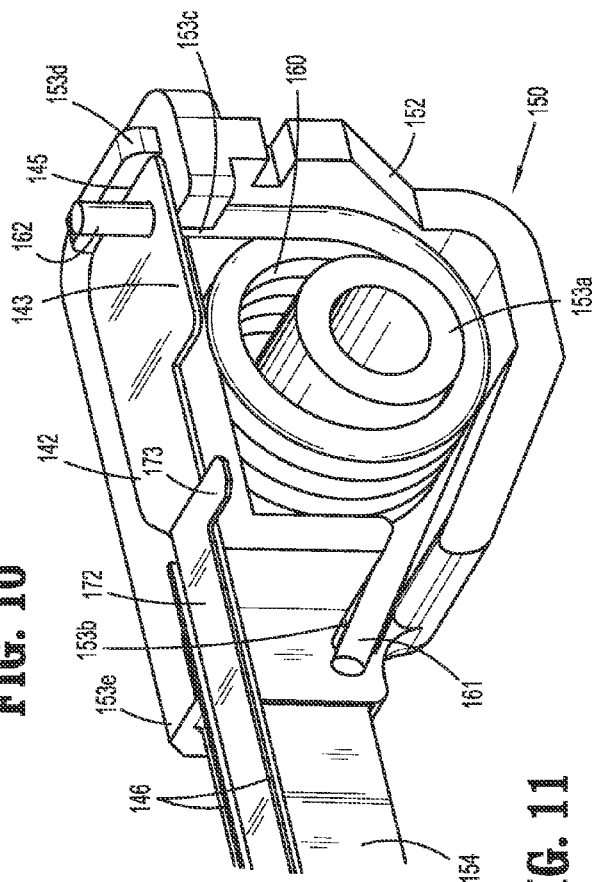

FIG. 11

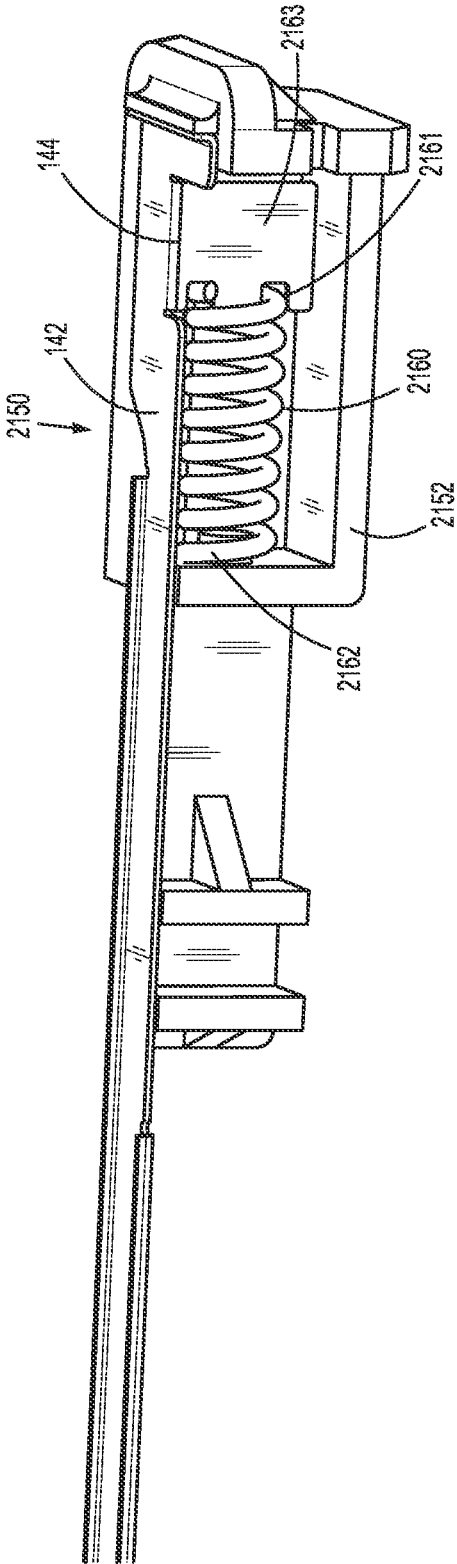

FIG. 11A

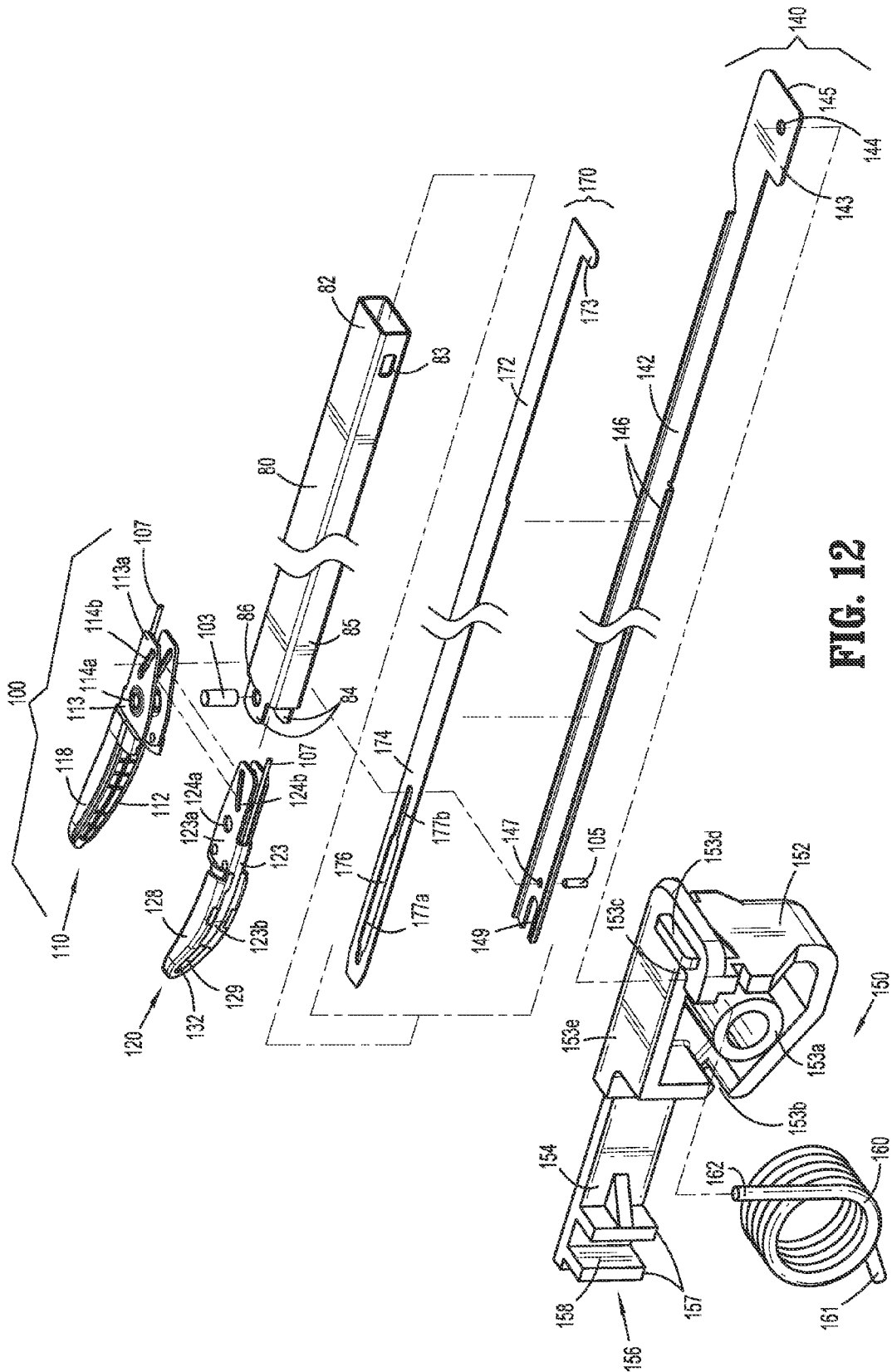

FIG. 12

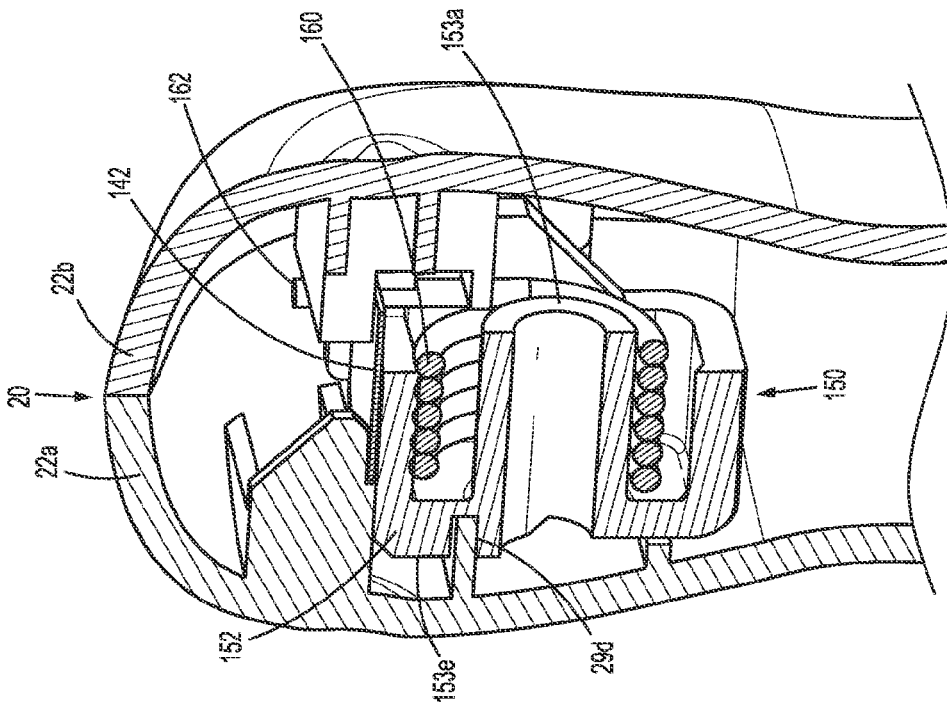

FIG. 13

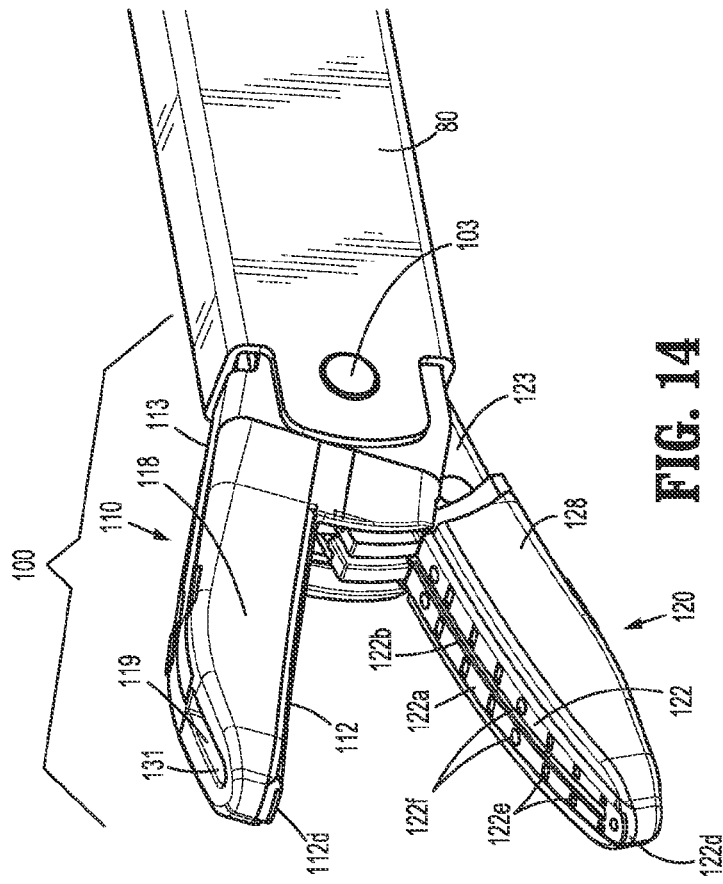

FIG. 14

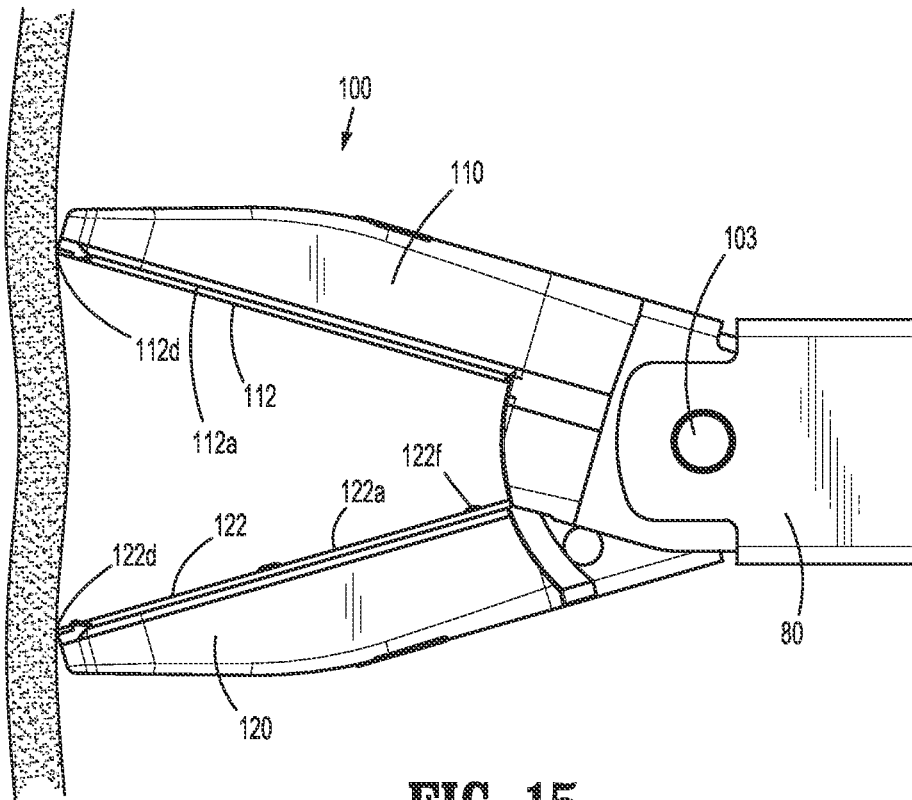

FIG. 15

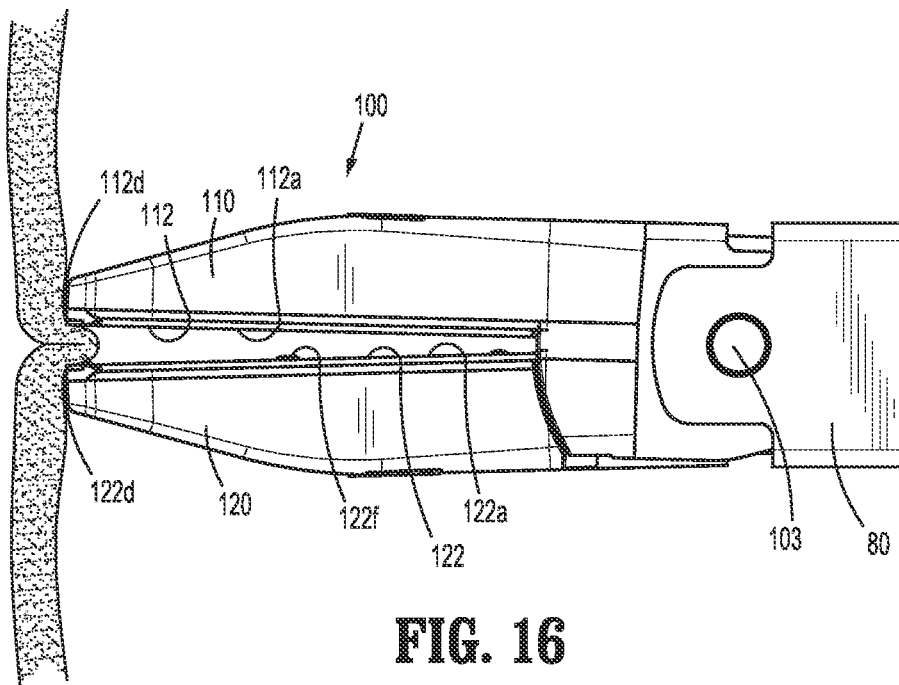

FIG. 16

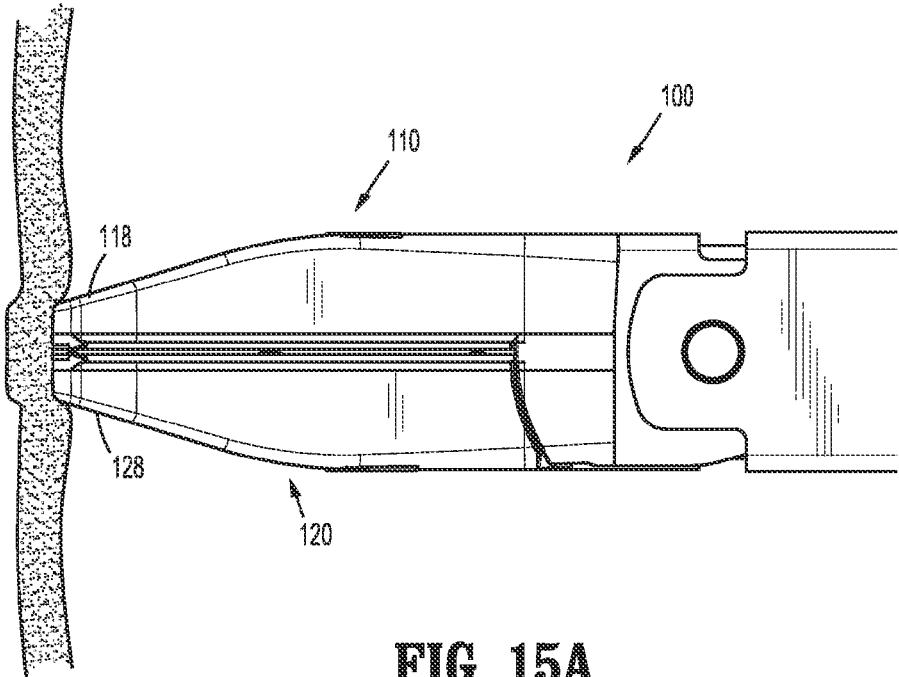

FIG. 15A

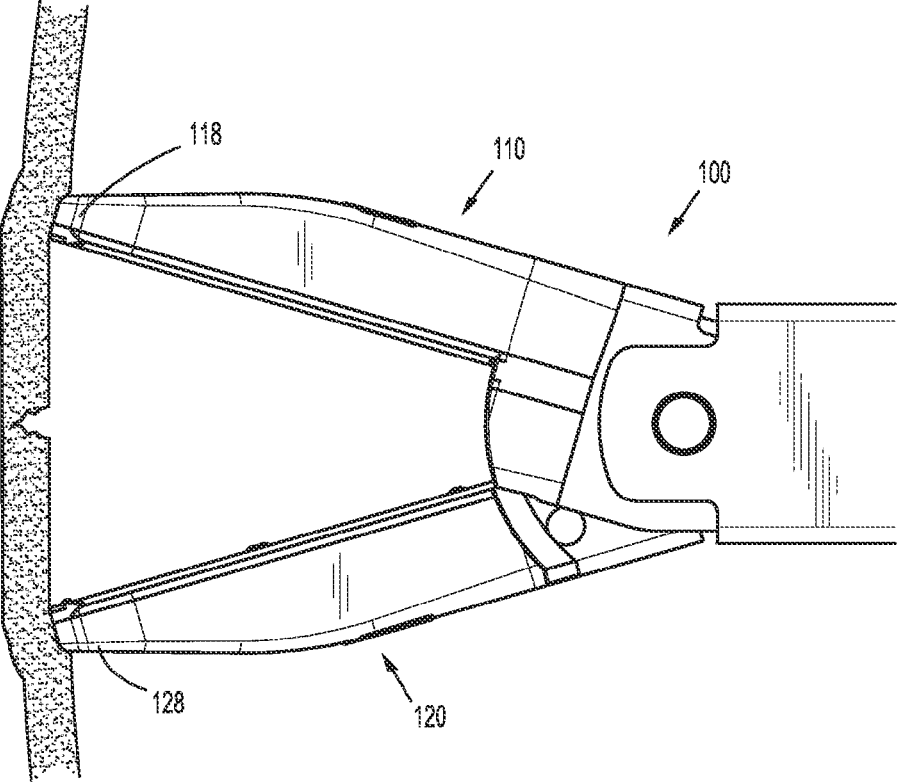
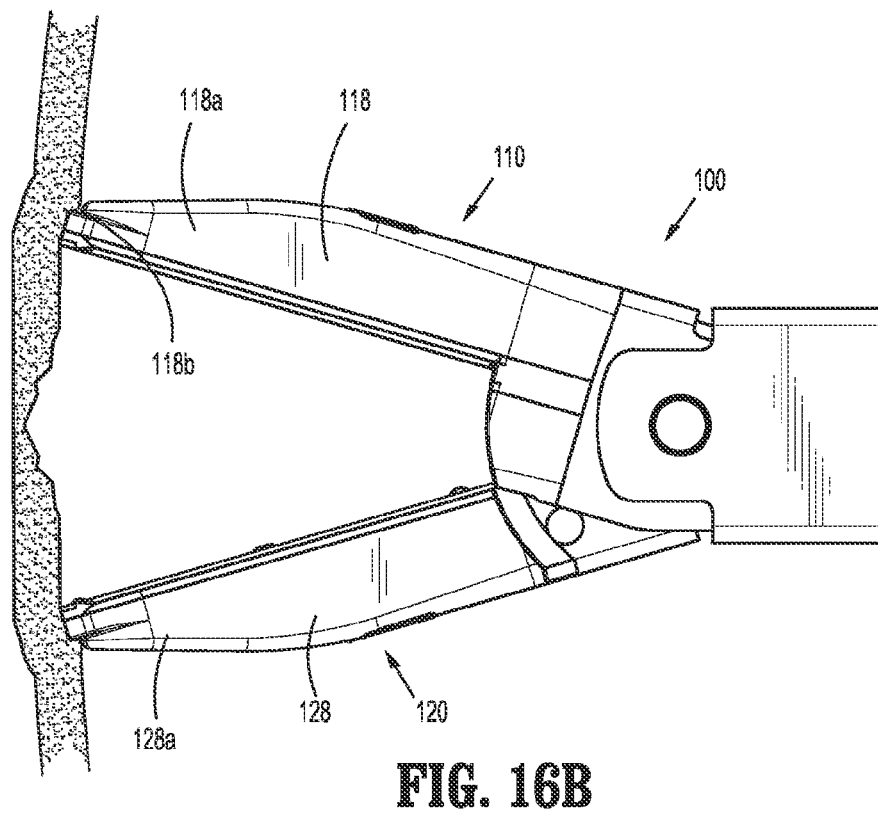
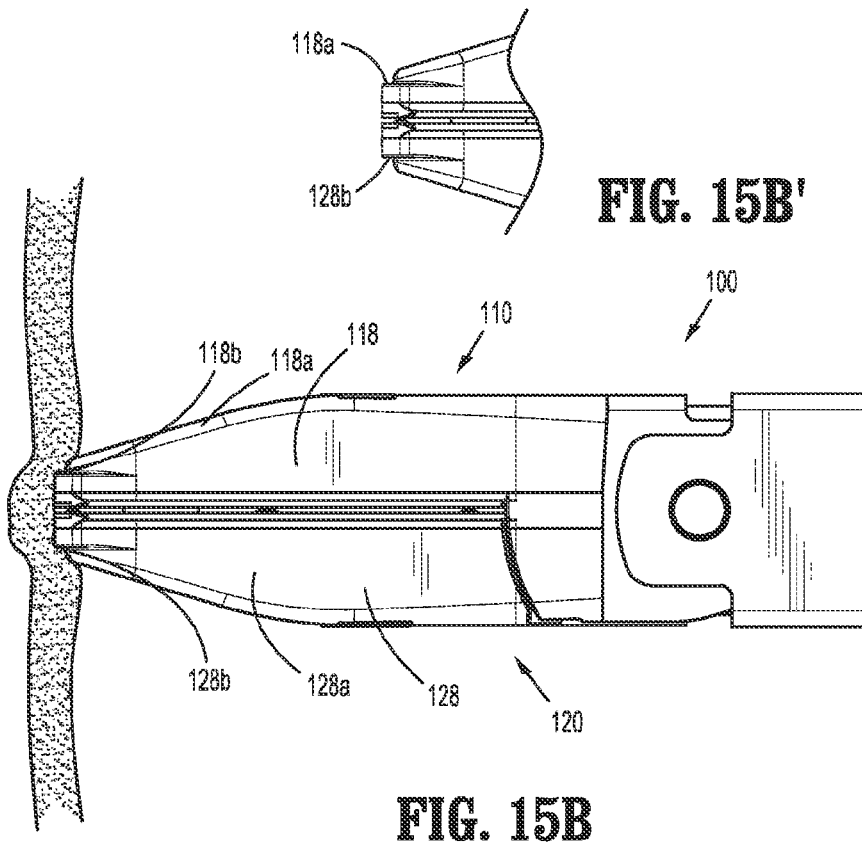

FIG. 16A



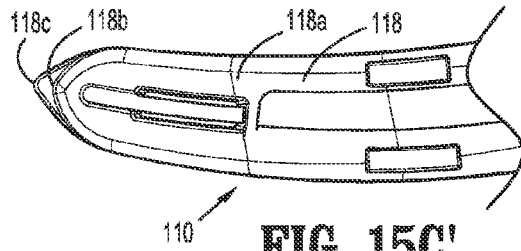

FIG. 15C'

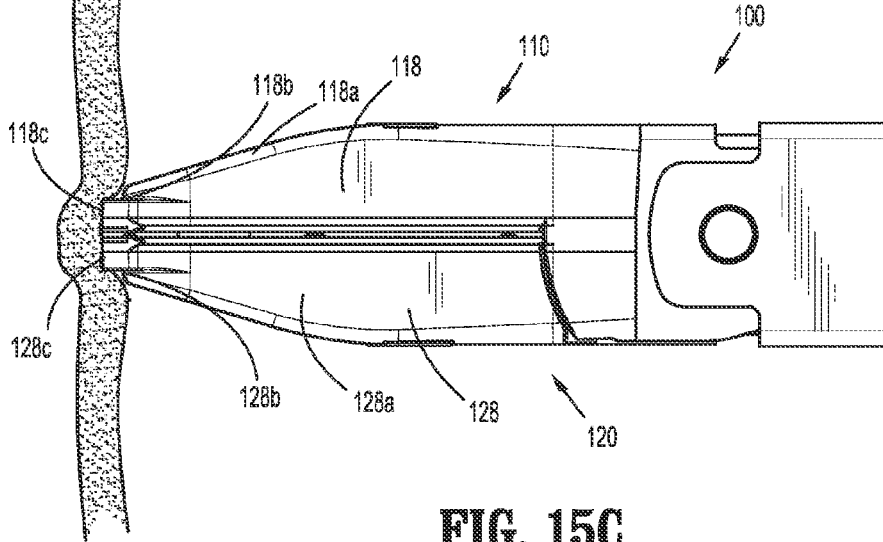

FIG. 15C

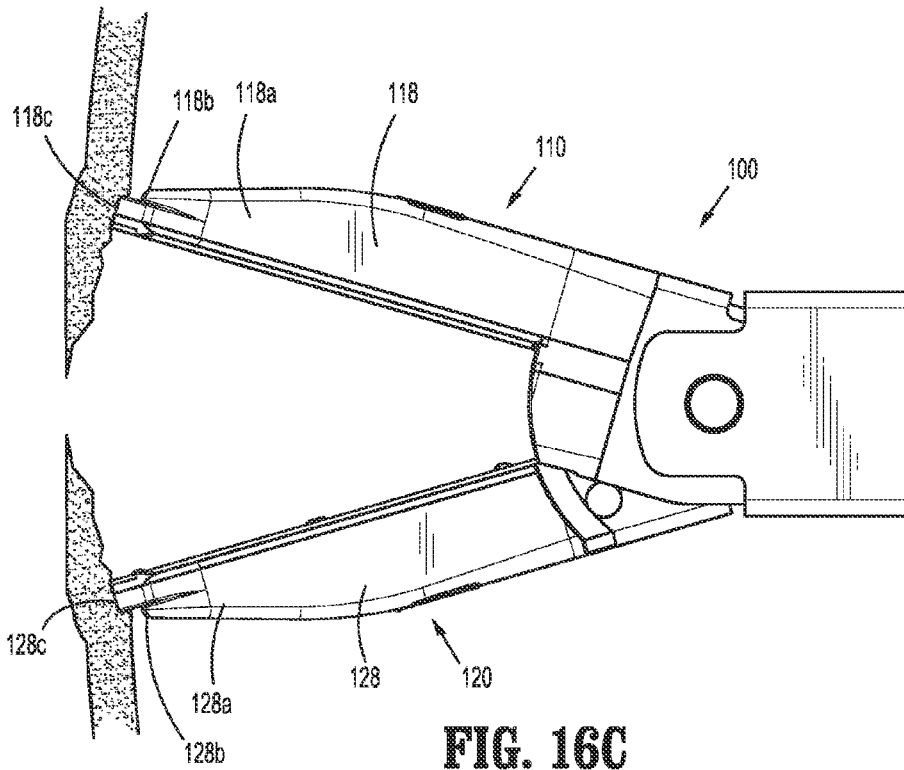
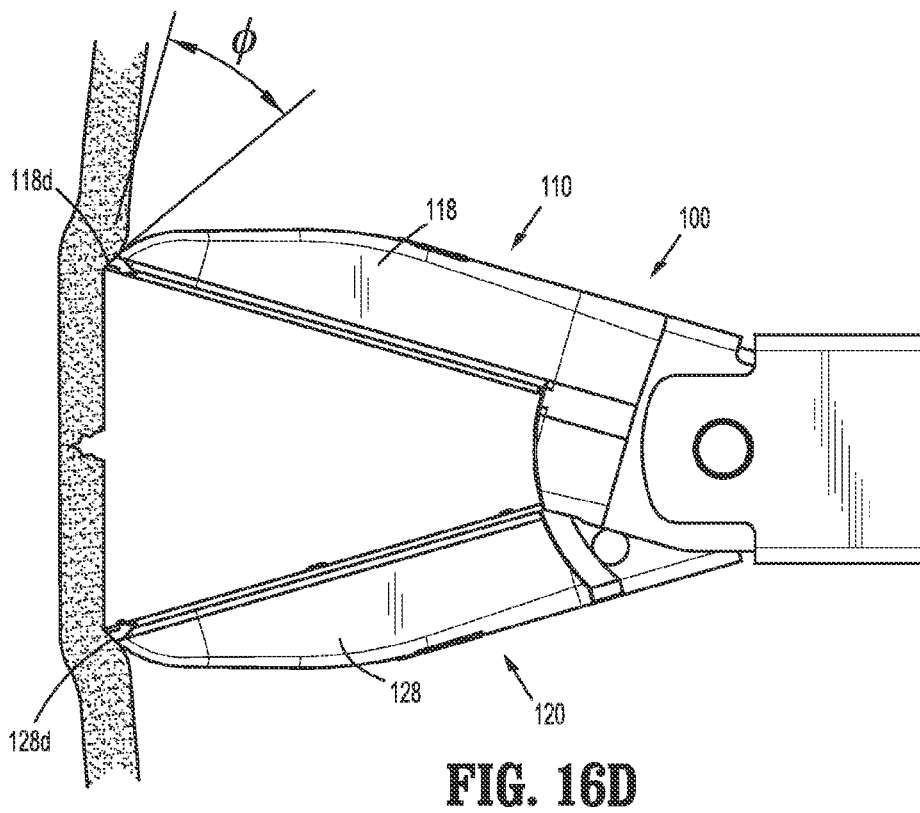
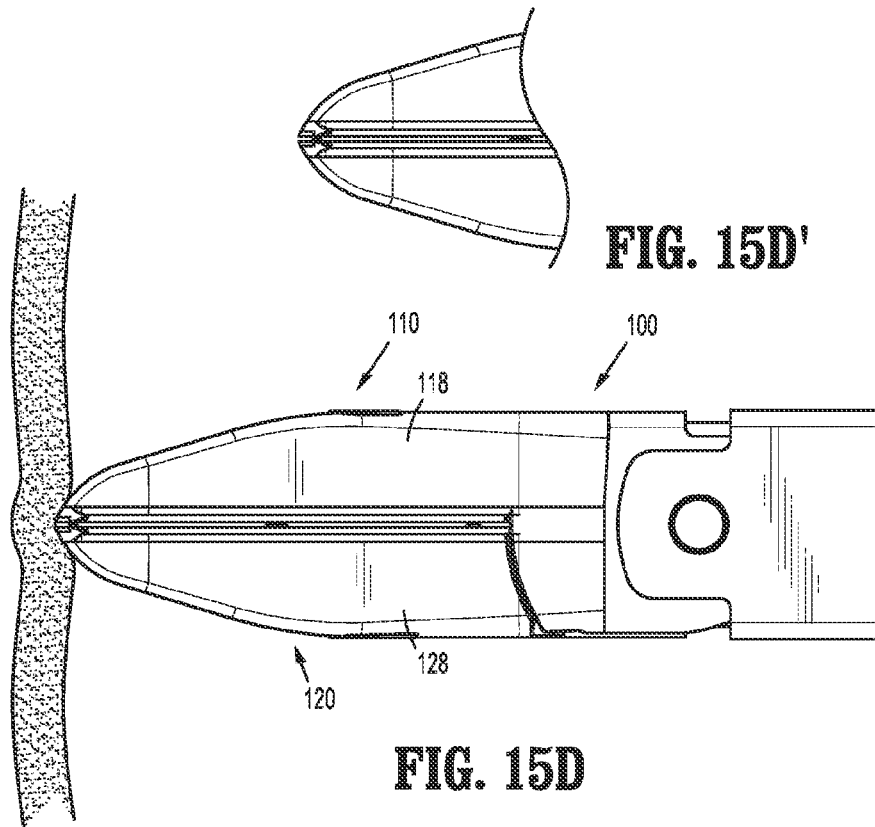
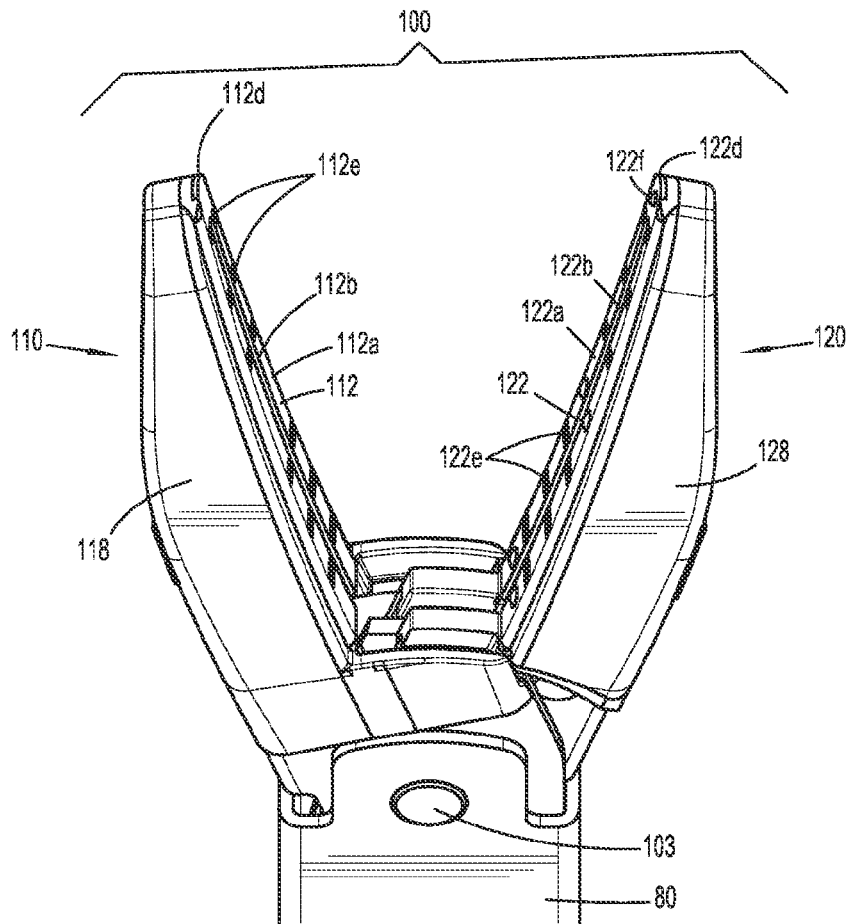
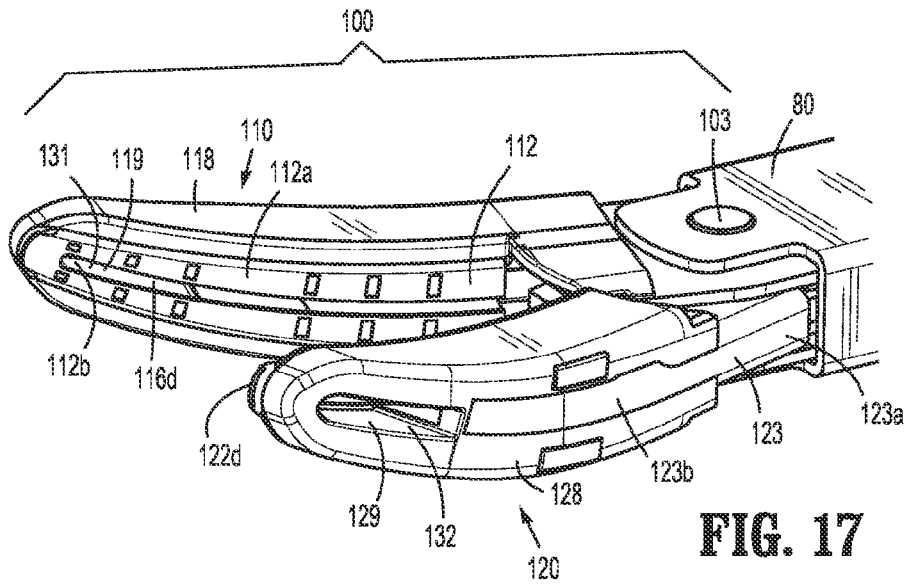

FIG. 16C





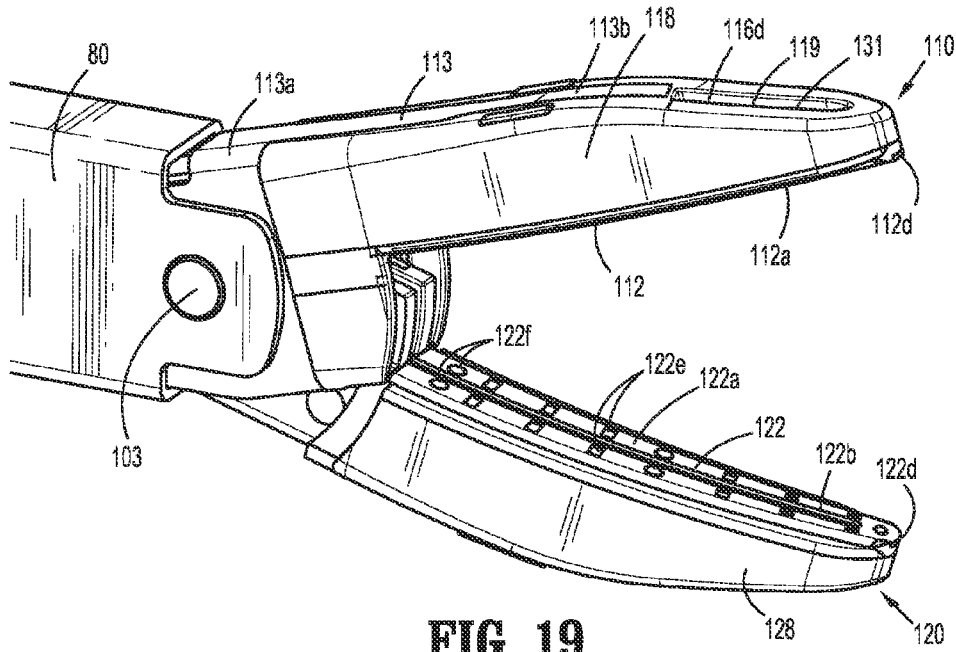

FIG. 19

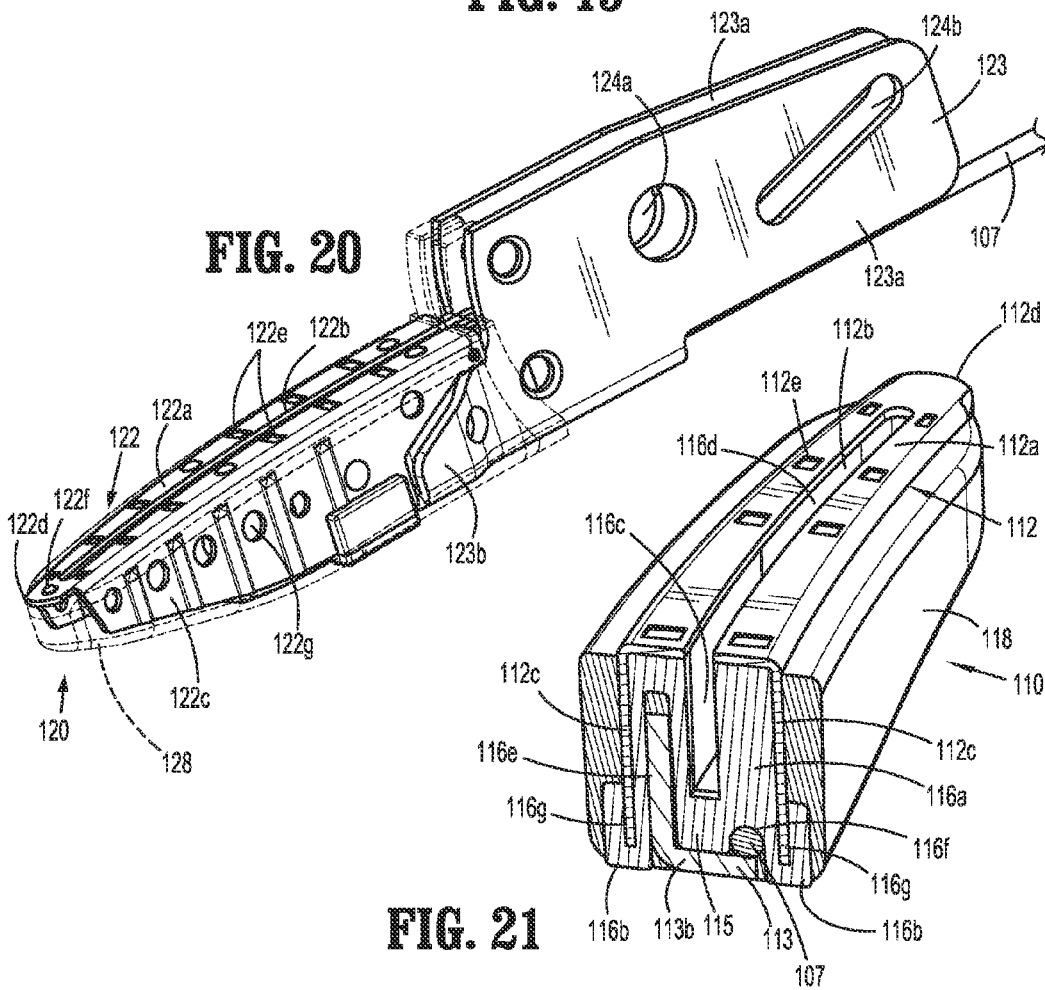

FIG. 20

FIG. 21

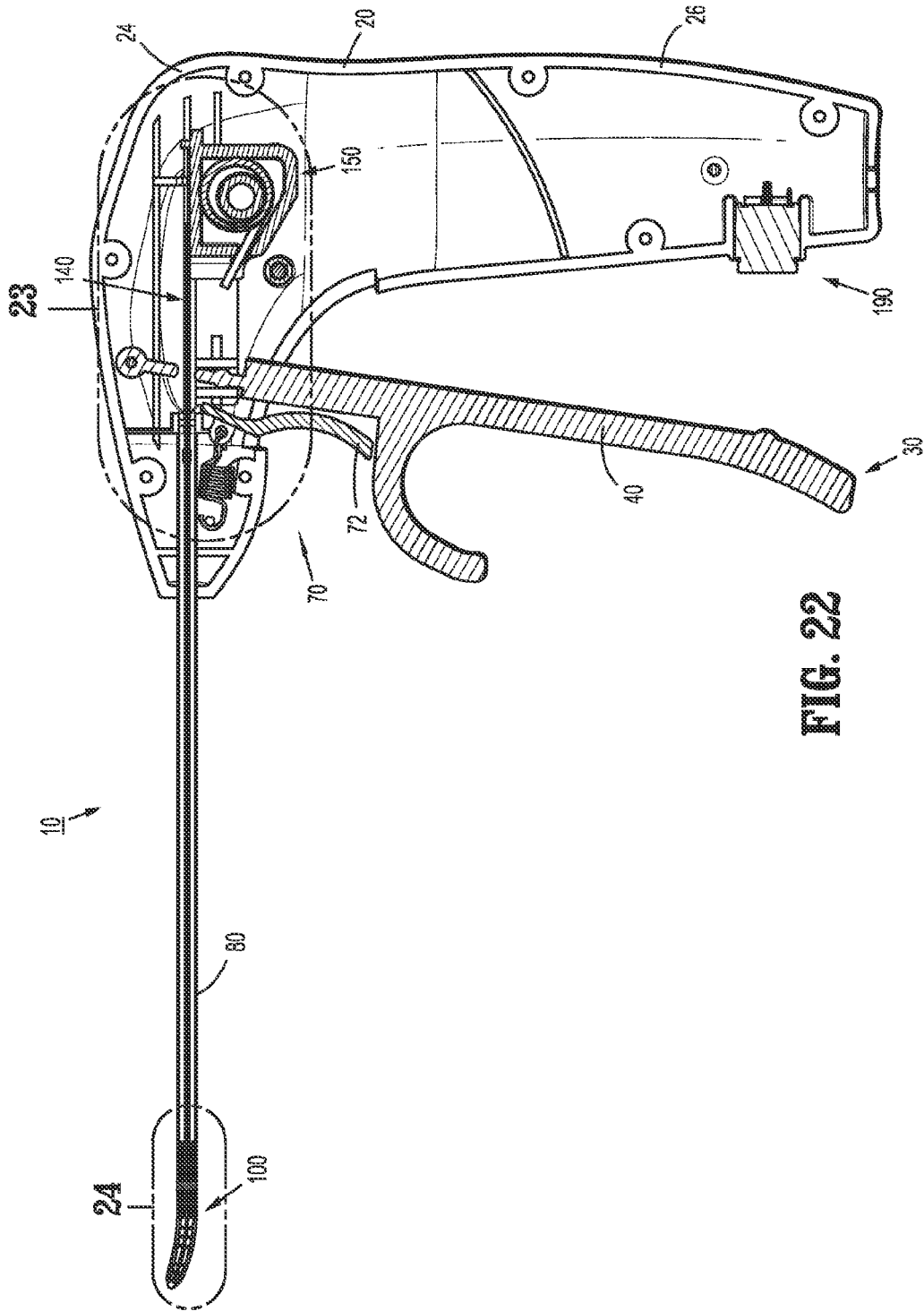

FIG. 22

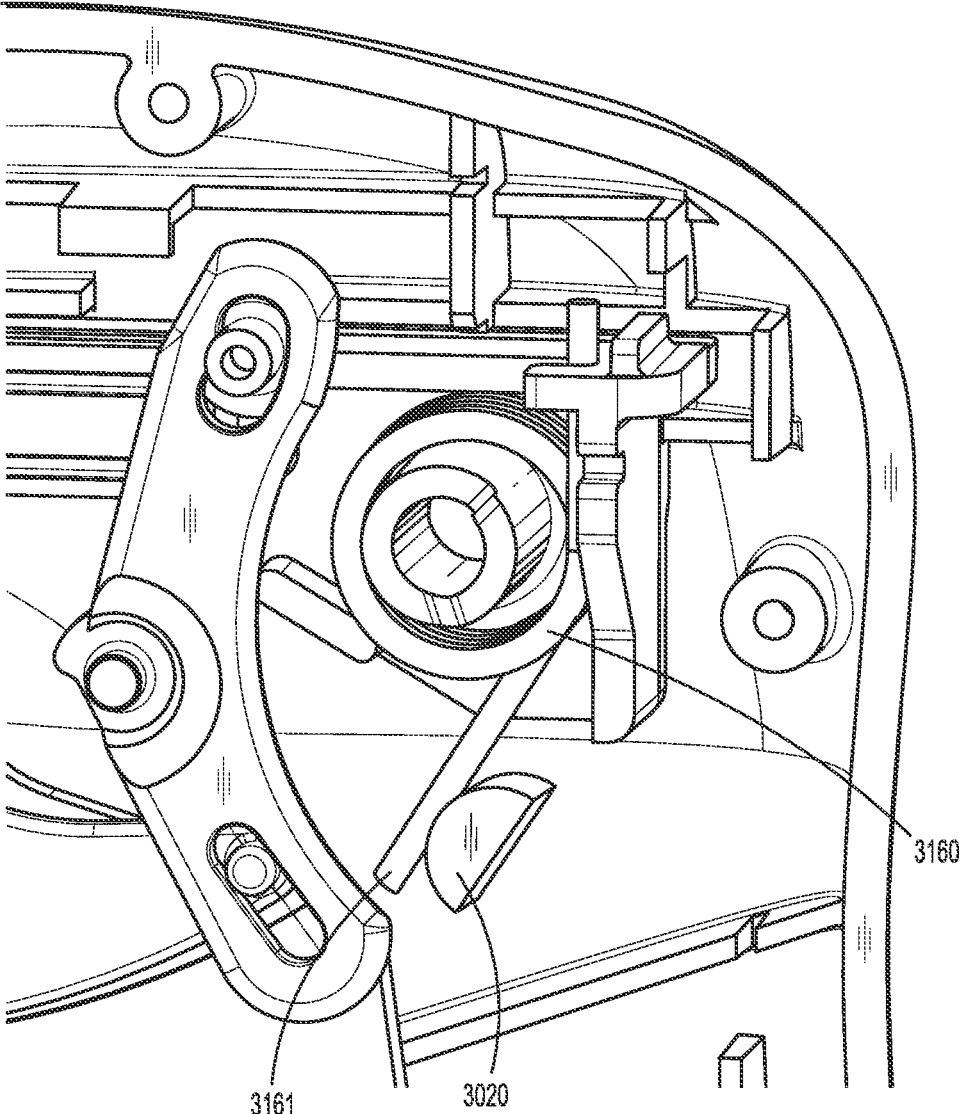

FIG. 22A

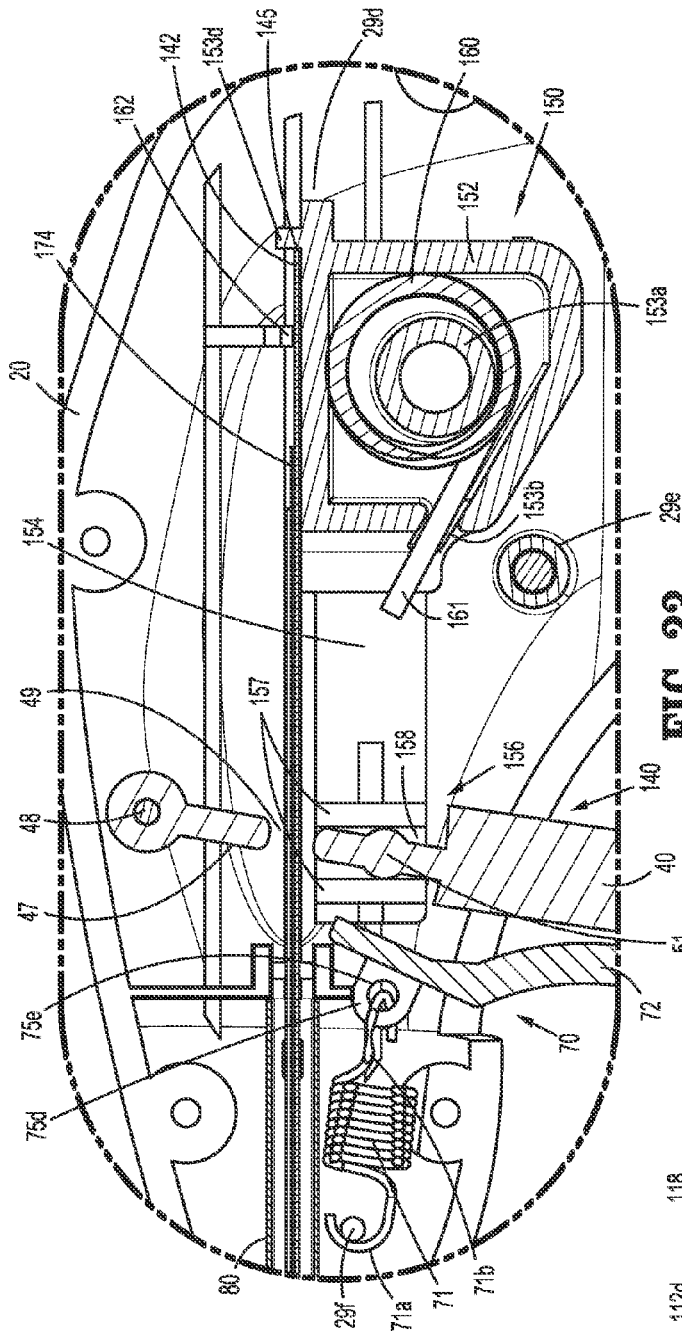

FIG. 23

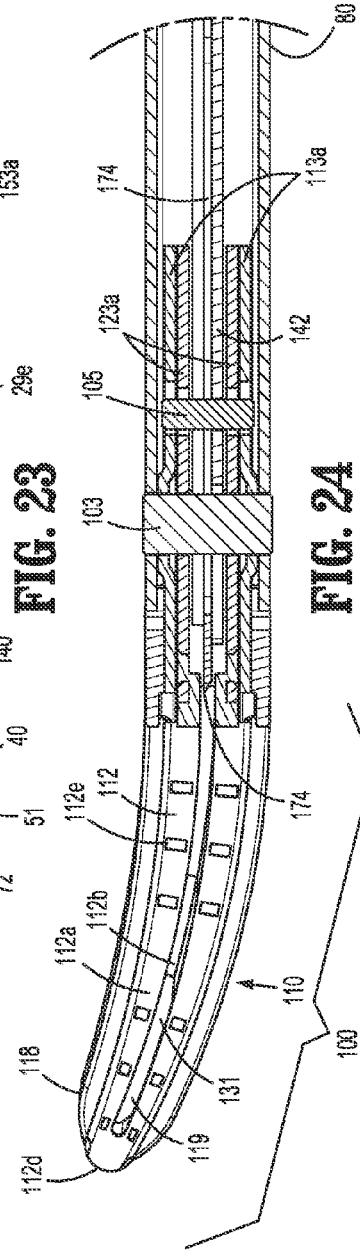

FIG. 24

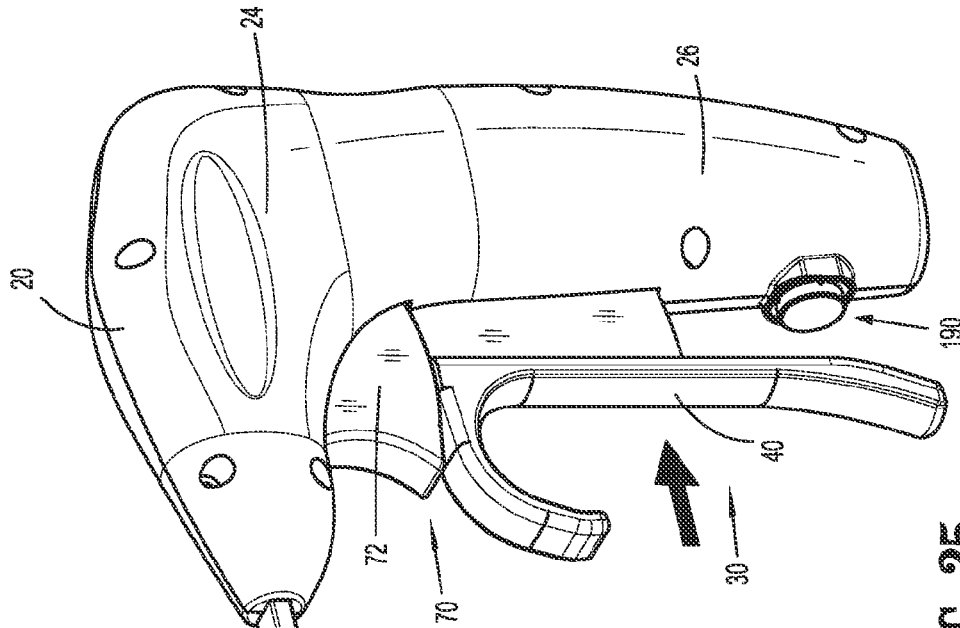

FIG. 25

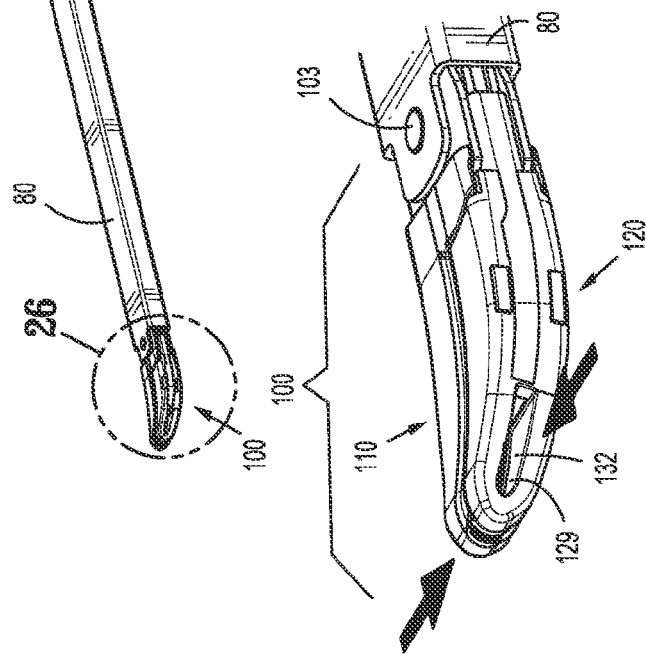

FIG. 26

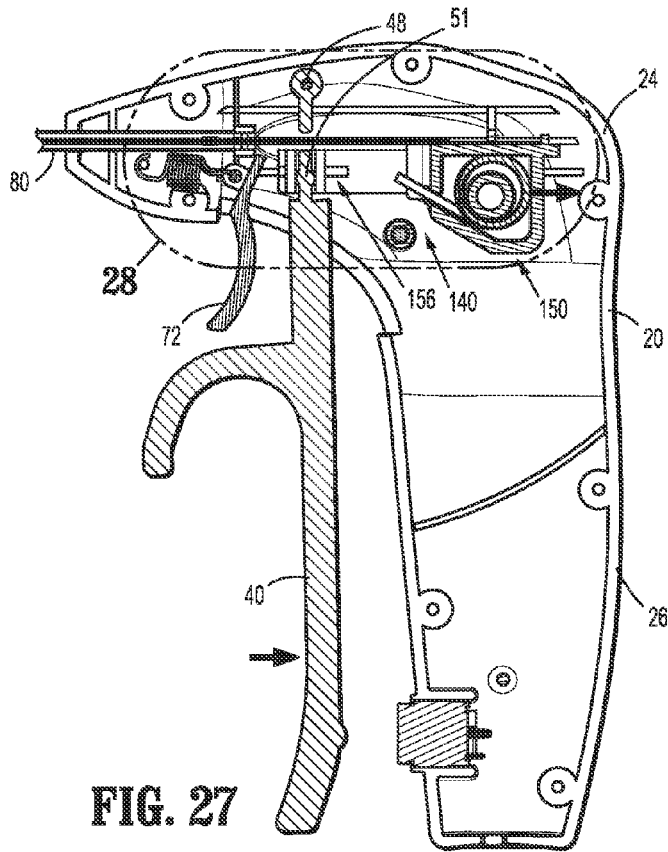

FIG. 27

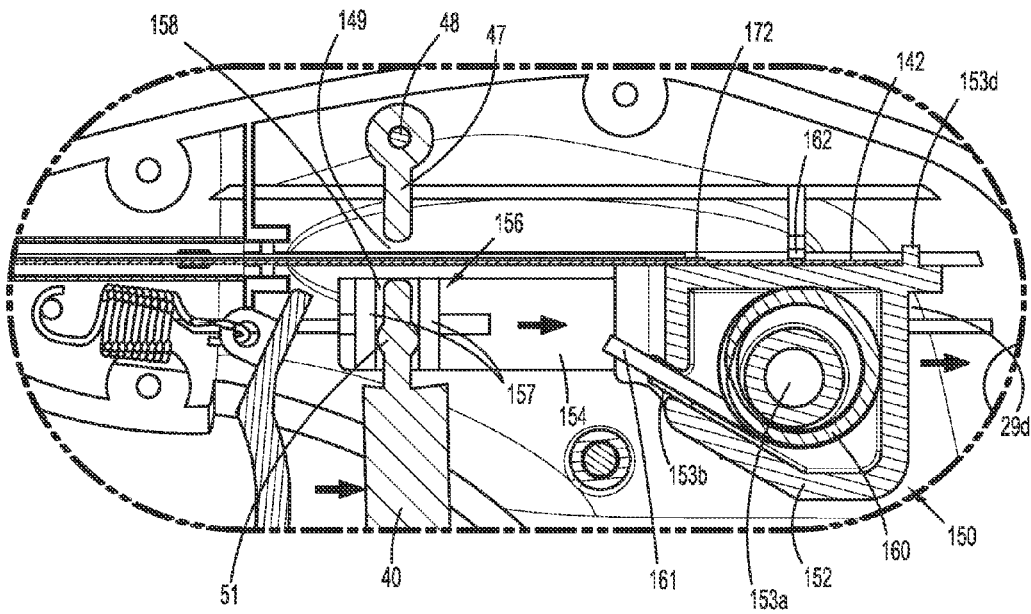

FIG. 28

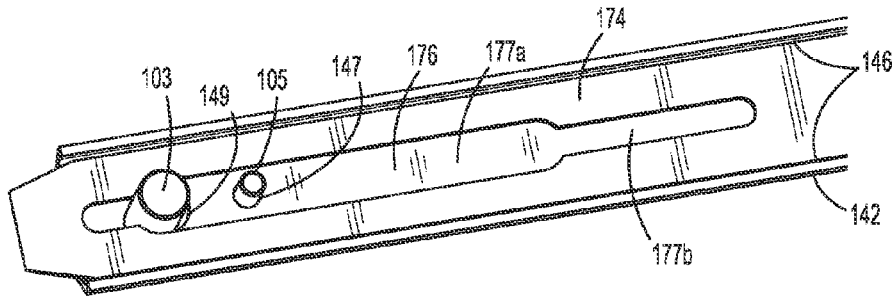

FIG. 29

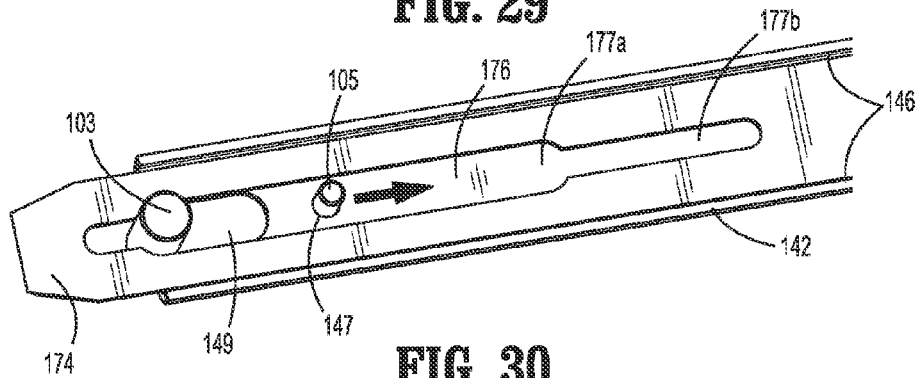

FIG. 30

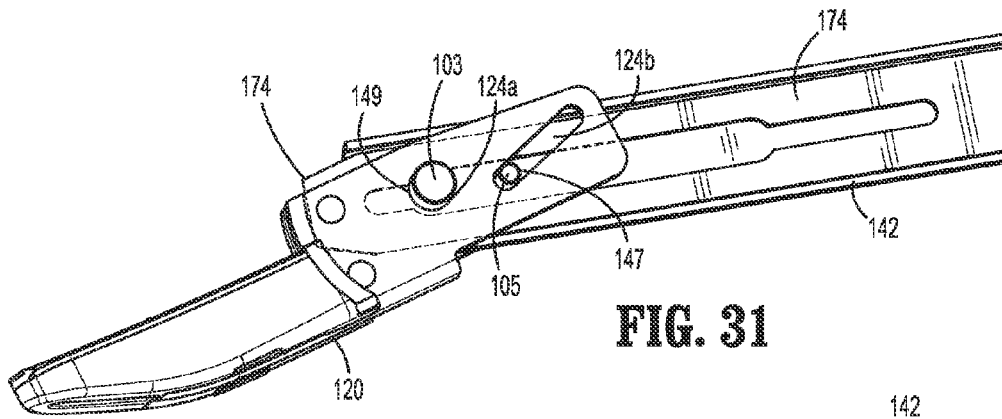

FIG. 31

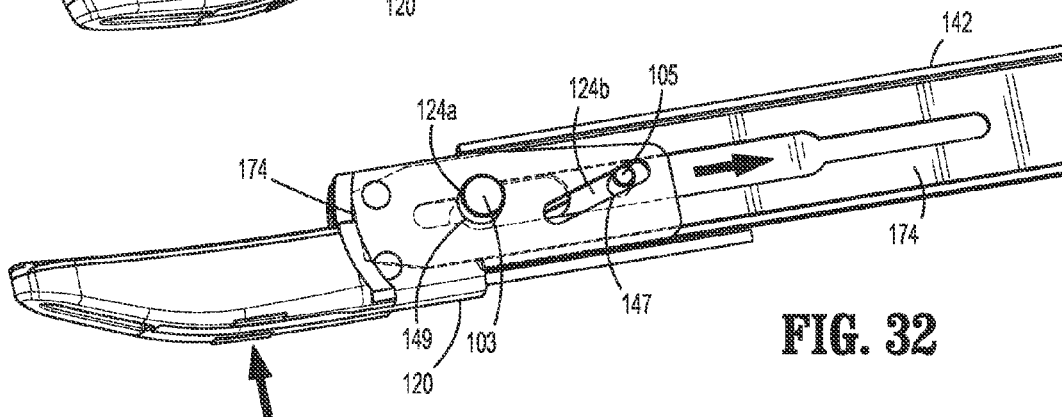
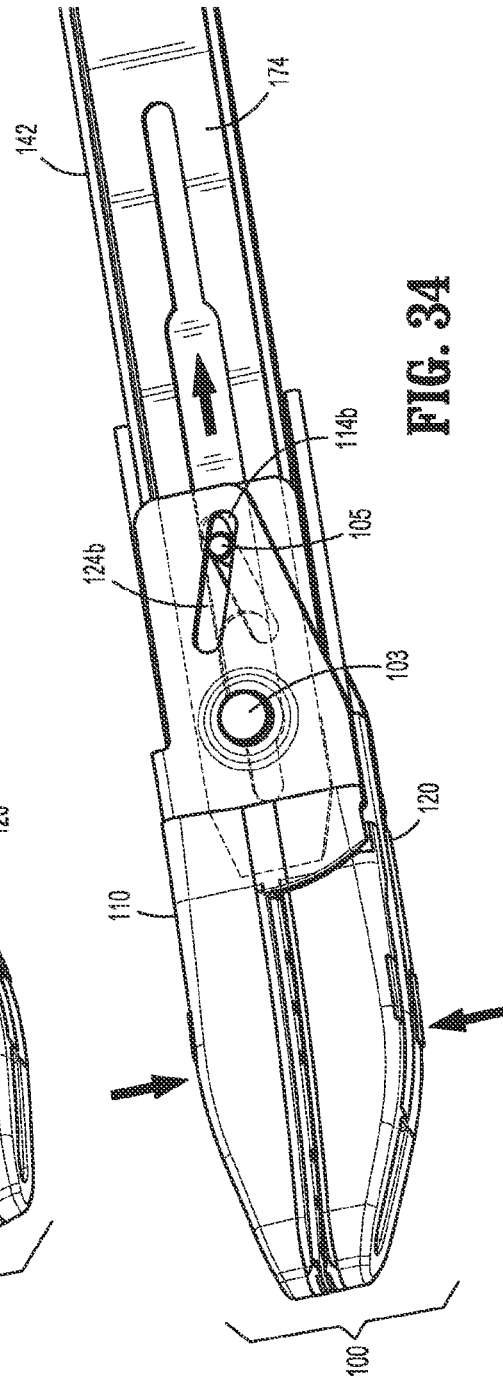
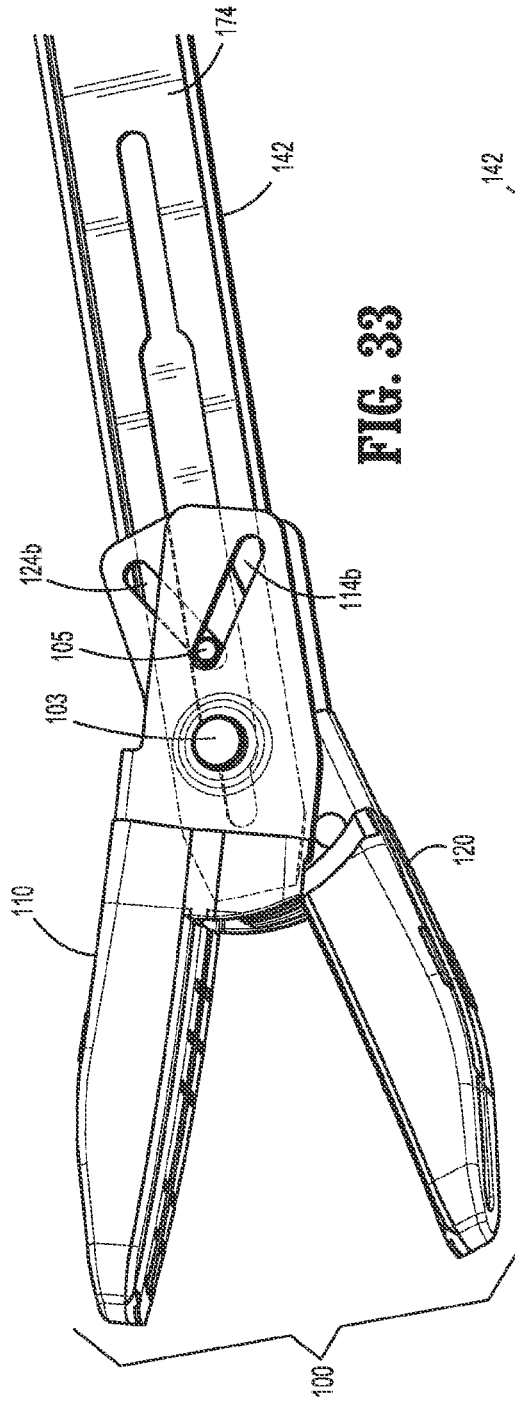

FIG. 32



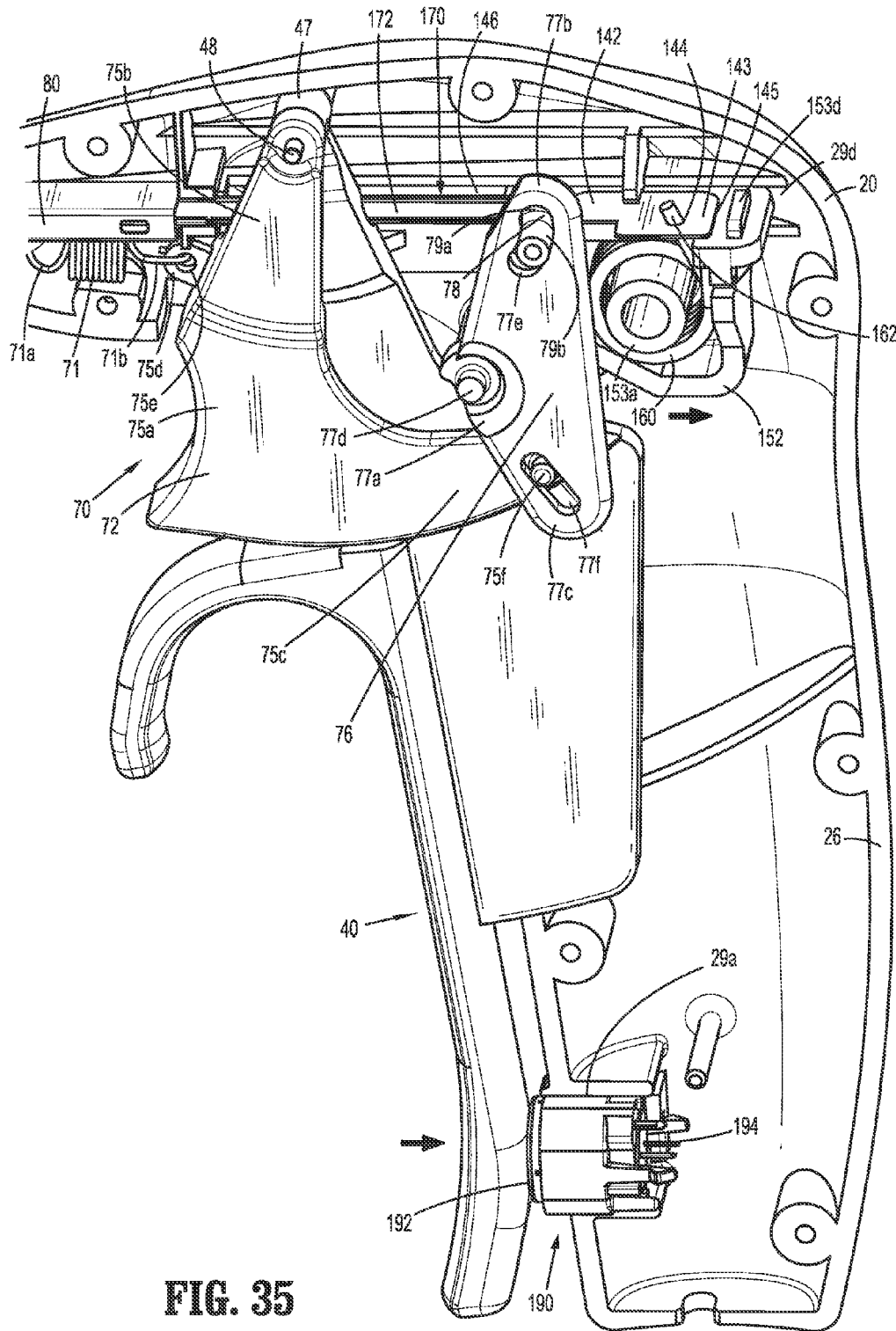

FIG. 35

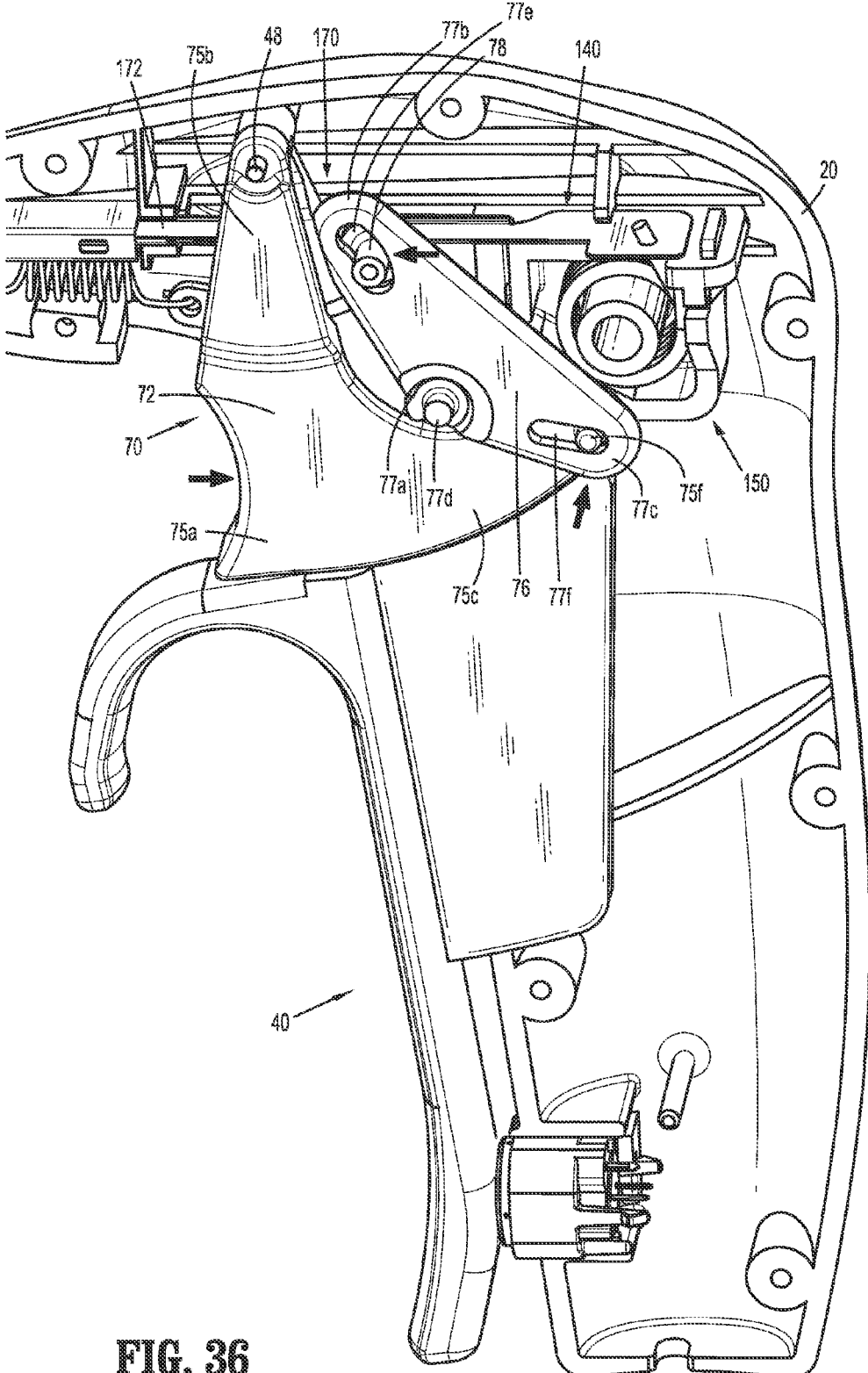

FIG. 36

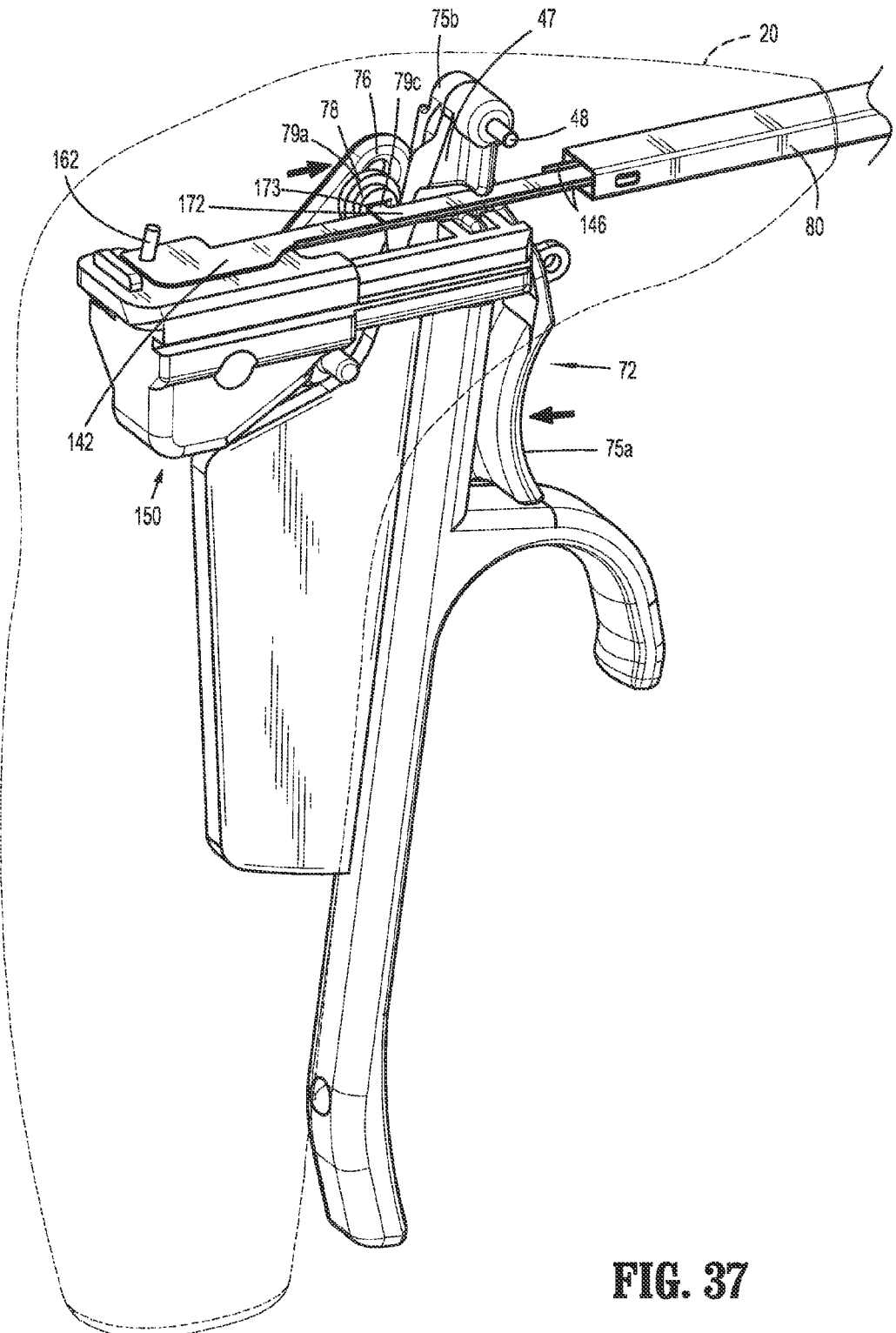

FIG. 37

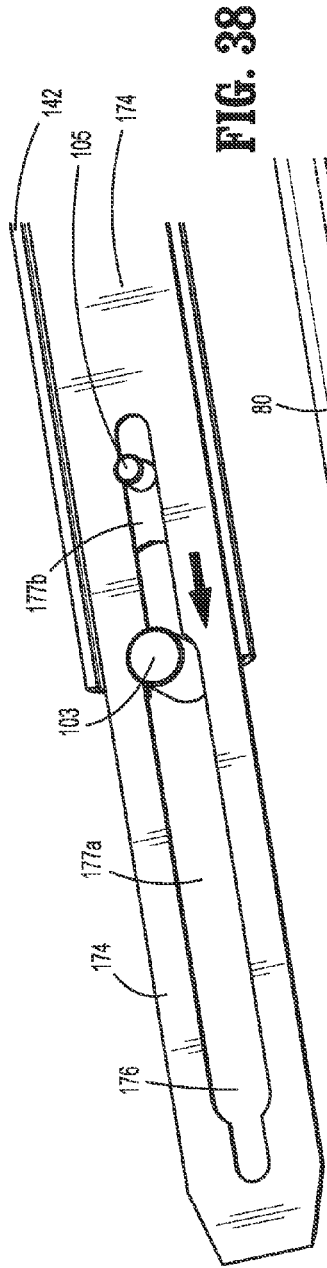

FIG. 38

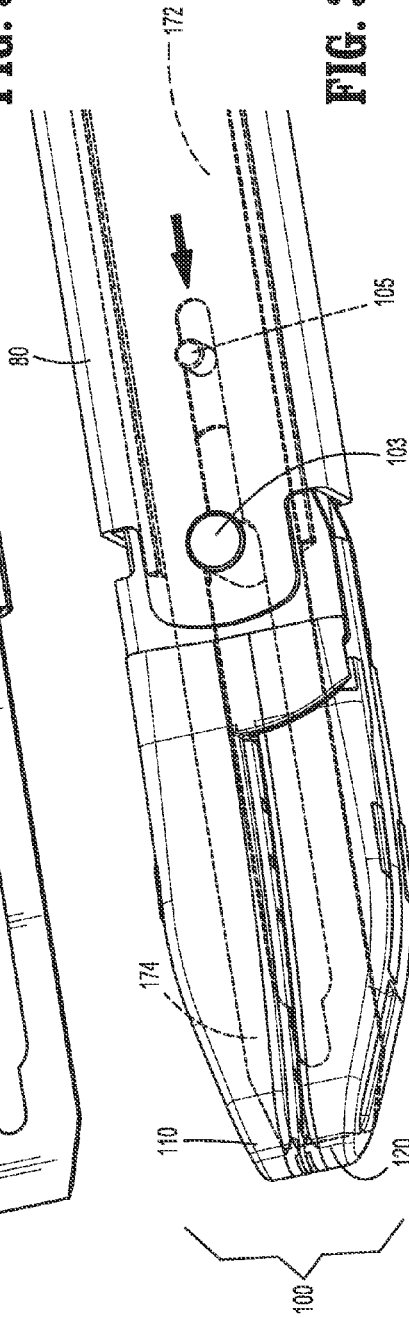

FIG. 39

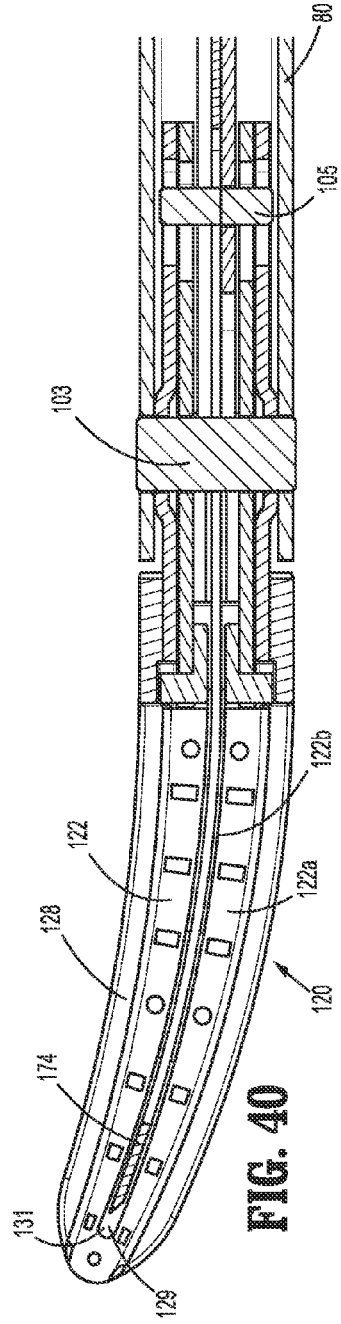

FIG. 40

**SURGICAL INSTRUMENTS AND METHODS
FOR PERFORMING TONSILLECTOMY,
ADENOIDECTOMY, AND OTHER
SURGICAL PROCEDURES**

BACKGROUND

[0001] 1. Technical Field

[0002] The present disclosure relates to surgical instruments and methods and, more particularly, to surgical instrument and methods for performing tonsillectomy, adenoidectomy, and other surgical procedures.

[0003] 2. Background of Related Art

[0004] The tonsils and adenoids are part of the lymphatic system and are generally located in the back of the throat. These parts of the lymphatic system are generally used for sampling bacteria and viruses entering the body and activating the immune system when warranted to produce antibodies to fight oncoming infections. More particularly, the tonsils and adenoids break down the bacteria or virus and send pieces of the bacteria or virus to the immune system to produce antibodies for fighting off infections.

[0005] Inflammation of the tonsils and adenoids (e.g., tonsillitis) impedes the ability of the tonsils and adenoids to destroy the bacteria resulting in a bacterial infection. In many instances, the bacteria remain even after treatment and serve as a reservoir for repeated infections (e.g., tonsillitis or ear infections).

[0006] A tonsillectomy and/or adenoidectomy may be performed when infections persist and antibiotic treatments fail. Persistent infection typically leads to enlarged tonsil tissue which may need to be removed since in many cases the enlarged tissue causes airway obstruction leading to various sleep disorders such as snoring or, in some cases, sleep apnea. Some individuals are also born with larger tonsils that are more prone to cause obstruction. An adenoidectomy may also be required to remove adenoid tissue when ear pain persists, or when nose breathing or function of the Eustachian tube is impaired. Often times, tonsillectomy and adenoidectomy procedures are performed at the same time.

SUMMARY

[0007] As used herein, the term “distal” refers to the portion that is being described which is further from a user, while the term “proximal” refers to the portion that is being described which is closer to a user. Further, to the extent consistent, any of the aspects described herein may be used in conjunction with any or all of the other aspects described herein.

[0008] An end effector assembly for a surgical instrument provided in accordance with the present disclosure includes first and second jaw members, each including a jaw frame, a spacer, an electrically-conductive plate, and an outer housing. The jaw frame includes at least one proximal flange and a distal jaw support extending distally from the at least one proximal flange. The spacer defines a body and a wing disposed on either side of the body. The body defines a channel configured to receive the distal jaw support. Each wing defines a slot. The electrically-conductive plate defines a tissue-contacting portion and first and second legs extending from the tissue-contacting portion in perpendicular orientation relative thereto. The tissue-contacting portion is configured to sit atop the body of the spacer, while each of the first and second legs is configured for receipt within the

slot defined within one of the wings of the spacer. The outer housing at least partially surrounds the distal jaw support, spacer, and first and second legs of the electrically-conductive plate and is configured to retain the distal jaw support, spacer, and electrically-conductive plate in position relative to one another.

[0009] In an aspect of the present disclosure, at least one of the first and second legs of the electrically-conductive plate or the spacer includes a plurality of apertures defined therethrough. In such aspects, a portion of the outer housing extends through each of the apertures to facilitate engagement of the outer housing.

[0010] In another aspect of the present disclosure, a tunnel is defined between the spacer and the distal jaw support. The tunnel is configured to receive a wire for supplying energy to the electrically-conductive plate.

[0011] In yet another aspect of the present disclosure, the spacer is configured to electrically isolate the electrically-conductive plate from the jaw frame. The spacer may be formed from an electrically-insulative material.

[0012] In still another aspect of the present disclosure, the body of the spacer further defines a knife slot extending longitudinally therethrough. The knife slot of the body of the spacer and the channel of the body of the spacer are offset relative to one another and open to opposite surfaces of the body of the spacer.

[0013] In still yet another aspect of the present disclosure, the electrically-conductive plate defines a knife slot disposed in alignment with the knife slot of the body of the spacer.

[0014] In another aspect of the present disclosure, the electrically-conductive plate further includes a distal tip extending distally from the tissue-contacting portion. The distal tip defines an exposed edge configured to facilitate grasping tissue.

[0015] In still another aspect of the present disclosure, the electrically-conductive plate, spacer, and outer housing define lengths greater than that of the distal jaw support so as to extend distally beyond the distal jaw support. More specifically, in aspects, the length of the distal jaw support may be between 50% and 75% of the length each of the electrically-conductive plate, spacer, and outer housing.

[0016] In yet another aspect of the present disclosure, a window is defined through portions of the electrically-conductive plate, spacer, and outer housing that extend distally beyond the distal jaw support.

[0017] In still yet another aspect of the present disclosure, the jaw frame of each of the first and second jaw members includes a pair of spaced-apart proximal flanges. The proximal flanges of the first and second jaw members are coupled to one another to permit pivotable movement of the first and second jaw members between a spaced-apart position and an approximated position.

[0018] In another aspect of the present disclosure, the proximal flanges of the second jaw member are disposed between the proximal flanges of the first jaw member.

[0019] In another aspect of the present disclosure, the first and second jaw members each define lengths and thicknesses that decrease along the lengths thereof in a proximal to distal direction.

[0020] In yet another aspect of the present disclosure, the spacer is overmolded onto the jaw frame via a first overmold. Additionally or alternatively, the jaw housing is

overmolded about the distal jaw support, spacer, and first and second legs of the electrically-conductive plate via a second overmold.

[0021] A method of manufacturing a jaw member of an end effector assembly of a surgical instrument provided in accordance with the present disclosure includes overmolding a spacer onto a jaw support. The spacer includes a body and a wing disposed on either side of the body. Each wing defines a slot. The method further includes positioning an electrically-conductive plate defining a tissue-contacting portion and first and second legs extending from the tissue-contacting portion in perpendicular orientation relative thereto atop the spacer such that the tissue-contacting portion is disposed atop the body of the spacer and the first and second legs are received within the slots defined within the wings. The method further includes overmolding an outer housing about the jaw support, spacer, and first and second legs of the electrically-conductive plate to retain the distal jaw support, spacer, and electrically-conductive plate in position relative to one another.

[0022] In an aspect of the present disclosure, at least one of the first and second legs of the electrically-conductive plate or the spacer includes a plurality of apertures defined therethrough such that, during overmolding of the outer housing about the jaw support, spacer, and first and second legs of the electrically-conductive plate, a portion of the outer housing extends through each of the apertures to facilitate engagement of the outer housing.

[0023] In another aspect of the present disclosure, the method further includes routing a wire through a tunnel defined between the spacer and the jaw support. In such aspects, the method may further include coupling the wire to the electrically-conductive plate.

BRIEF DESCRIPTION OF THE DRAWINGS

[0024] Various aspects and features of the present disclosure described herein with reference to the drawings wherein:

[0025] FIG. 1 is a perspective view of a surgical instrument provided in accordance with the present disclosure with jaw members of the end effector assembly of the surgical instrument disposed in a spaced-apart position;

[0026] FIG. 2 is a top view of the surgical instrument of FIG. 1 with the jaw members disposed in an approximated position;

[0027] FIG. 3 is a side view of the surgical instrument of FIG. 1 with the jaw members disposed in the approximated position;

[0028] FIGS. 4-6 are side views of the surgical instrument of FIG. 1 illustrating various different configurations for operably grasping the surgical instrument;

[0029] FIG. 7 is a rear, perspective view of the surgical instrument of FIG. 1 with the jaw members disposed in the approximated position and a portion of the housing removed to illustrate the internal components thereof;

[0030] FIG. 8 is a front, perspective, partially-exploded view of the surgical instrument of FIG. 1 with the jaw members disposed in the approximated position and a portion of the housing removed to illustrate the internal components thereof;

[0031] FIG. 9 is a rear, perspective view of the handle, trigger, and drive assemblies of the surgical instrument of FIG. 1 with a movable handle of the handle assembly

disposed in an initial position and a trigger of the trigger assembly disposed in an un-actuated position;

[0032] FIG. 9A is a rear, perspective view of a portion of the proximal end of the surgical instrument of FIG. 1 incorporating another configuration of a drive assembly provided in accordance with the present disclosure;

[0033] FIG. 10 is a front, perspective view of the drive assembly, shaft, and end effector assembly of the surgical instrument of FIG. 1;

[0034] FIG. 11 is an enlarged, perspective view of the area of detail indicated as "11" in FIG. 10;

[0035] FIG. 11A is a perspective view of another slider assembly provided in accordance with the present disclosure and configured for use with the surgical instrument of FIG. 1;

[0036] FIG. 12 is a rear, perspective, exploded view of the drive assembly, shaft, and end effector assembly of the surgical instrument of FIG. 1;

[0037] FIG. 13 is a transverse, cross-sectional view taken along section line "13-13" of FIG. 3;

[0038] FIG. 14 is an enlarged, perspective view of the distal end of the surgical instrument of FIG. 1;

[0039] FIG. 15 is a side view of the distal end of the surgical instrument of FIG. 1 with the jaw members disposed in the spaced-apart position adjacent tissue to be grasped;

[0040] FIG. 15A is a side view of the distal end of the surgical instrument of FIG. 1 with the jaw members disposed in the approximated position pressed against tissue to be spread and/or dissected;

[0041] FIG. 15B is a side view of the distal end of the surgical instrument of FIG. 1 incorporating another configuration of jaw members provided in accordance with the present disclosure and disposed in the approximated position pressed against tissue to be spread and/or dissected;

[0042] FIG. 15B' is an enlarged, side view of the distal ends of the jaw members of FIG. 15B;

[0043] FIG. 15C is a side view of the distal end of the surgical instrument of FIG. 1 incorporating yet another configuration of jaw members provided in accordance with the present disclosure and disposed in the approximated position pressed against tissue to be spread and/or dissected;

[0044] FIG. 15C' is a top view of one of the jaw members of FIG. 15C;

[0045] FIG. 15D is a side view of the distal end of the surgical instrument of FIG. 1 incorporating still another configuration of jaw members provided in accordance with the present disclosure and disposed in the approximated position pressed against tissue to be spread and/or dissected;

[0046] FIG. 15D' is an enlarged, side view of the distal ends of the jaw members of FIG. 15D;

[0047] FIG. 16 is a side view of the distal end of the surgical instrument of FIG. 1 with the jaw members disposed in the approximated position grasping tissue at the distal ends thereof;

[0048] FIG. 16A is a side view of the distal end of the surgical instrument of FIG. 1 with the jaw members disposed in the spaced-apart position spreading and/or dissecting tissue;

[0049] FIG. 16B is a side view of the jaw members of FIG. 15B disposed in the spaced-apart position spreading and/or dissecting tissue;

[0050] FIG. 16C is a side view of the jaw members of FIG. 15C disposed in the spaced-apart position spreading and/or dissecting tissue;

[0051] FIG. 16D is a side view of the jaw members of FIG. 15D disposed in the spaced-apart position spreading and/or dissecting tissue;

[0052] FIG. 17 is an enlarged, perspective view of the area of detail indicated as "17" in FIG. 1;

[0053] FIG. 18 is a front, perspective view of the distal end of the surgical instrument of FIG. 1 with the jaw members disposed in the spaced-apart position;

[0054] FIG. 19 is a side, perspective view of the distal end of the surgical instrument of FIG. 1 with the jaw members disposed in the spaced-apart position;

[0055] FIG. 20 is a side, perspective view of one of the jaw members of the surgical instrument of FIG. 1 with a portion thereof removed;

[0056] FIG. 21 is a transverse, cross-sectional view of the jaw member of FIG. 20;

[0057] FIG. 22 is a side, cross-sectional view taken along section line "22-22" of FIG. 1;

[0058] FIG. 22A is a side, cross-sectional view of the proximal end of the surgical instrument of FIG. 1 incorporating another configuration of the torsion spring provided in accordance with the present disclosure;

[0059] FIG. 23 is an enlarged, side, cross-sectional view of the area of detail indicated as "23" in FIG. 22;

[0060] FIG. 24 is an enlarged, side, cross-sectional view of the area of detail indicated as "24" in FIG. 22;

[0061] FIG. 25 is a perspective view of the surgical instrument of FIG. 1 with the movable handle disposed in a compressed position and, accordingly, the jaw members disposed in the approximated position;

[0062] FIG. 26 is an enlarged, perspective view of the area of detail indicated as "26" in FIG. 25;

[0063] FIG. 27 is a side, cross-sectional view of the proximal end of the surgical instrument of FIG. 1;

[0064] FIG. 28 is an enlarged, side, cross-sectional view of the area of detail indicated as "28" in FIG. 27;

[0065] FIG. 29 is a perspective view of the distal end of the drive and knife assemblies of the surgical instrument of FIG. 1 disposed in a position corresponding to the spaced-apart position of the jaw members;

[0066] FIG. 30 is a perspective view of the distal end of the drive and knife assemblies of the surgical instrument of FIG. 1 disposed in a position corresponding to the approximated position of the jaw members;

[0067] FIG. 31 is a perspective view of the distal end of the drive and knife assemblies as shown in FIG. 29 and further including one of the jaw members disposed in the spaced-apart position;

[0068] FIG. 32 is a perspective view of the distal end of the drive and knife assemblies as shown in FIG. 30 and further including one of the jaw members disposed in the approximated position;

[0069] FIG. 33 is a perspective view of the distal end of the drive and knife assemblies as shown in FIG. 29 and further including the jaw members disposed in the spaced-apart position;

[0070] FIG. 34 is a perspective view of the distal end of the drive and knife assemblies shown in FIG. 30 and further including the jaw members disposed in the approximated position;

[0071] FIG. 35 is a top, perspective view of the proximal end of the surgical instrument of FIG. 1 with the movable handle disposed in an activated position and a portion of the housing removed to illustrate the internal components thereof;

[0072] FIG. 36 is a top, perspective view of the proximal end of the surgical instrument of FIG. 1 with the trigger disposed in an actuated position and a portion of the housing removed to illustrate the internal components thereof;

[0073] FIG. 37 is a rear, perspective view of the handle, trigger, and drive assemblies of the surgical instrument of FIG. 1 with the movable handle disposed in the activated position and the trigger disposed in the actuated position;

[0074] FIG. 38 is a perspective view of the distal end of the drive and knife assemblies of the surgical instrument of FIG. 1 with the knife assembly disposed in an extended position;

[0075] FIG. 39 is a perspective view of the distal end of the drive and knife assemblies as shown in FIG. 38 and further including the jaw members disposed in the approximated position; and

[0076] FIG. 40 is a top, cross-sectional view of the distal end of the drive and knife assemblies and including the jaw members, as shown in FIG. 39.

DETAILED DESCRIPTION

[0077] Referring generally to FIGS. 1-12, a surgical instrument provided in accordance with the present disclosure is shown generally identified by reference numeral 10. Instrument 10, as described below, is configured for grasping, treating, and/or dissecting tissue and may find particular applicability for use in performing tonsillectomy and/or adenoidectomy procedures, although use of instrument 10 in various other surgical procedures is also contemplated and within the scope of the present disclosure.

[0078] With reference to FIGS. 1, 7, 8, and 12, instrument 10 generally includes a housing 20, a handle assembly 30, a trigger assembly 70, a shaft 80, an end effector assembly 100, a drive assembly 140, a knife assembly 170, and an energy activation assembly 190. As detailed below, shaft 80 extends distally from housing 20 and supports end effector assembly 100 at distal end 85 thereof, drive assembly 140 operably couples handle assembly 30 with end effector assembly 100 to enable selective manipulation of jaw members 110, 120 of end effector assembly 100, knife assembly 170 is operably coupled with trigger assembly 70 to enable selective translation of a knife blade 174 of knife assembly 170 relative to end effector assembly 100, and energy activation assembly 190 enables energy to be selectively delivered to end effector assembly 100.

[0079] Instrument 10 may also include an electrosurgical cable (not shown) that connects instrument 10 to a generator (not shown) or other suitable power source, although instrument 10 may alternatively be configured as a battery-powered instrument. The electrosurgical cable includes lead wires, e.g., lead wires 107 (FIG. 12), extending therethrough that have sufficient length to extend through housing 20 and shaft 80 in order to operably couple the generator, energy activation assembly 190, and end effector assembly 100 with one another to enable the selective supply of energy to electrically-conductive plates 112, 122 of jaw members 110, 120 of end effector assembly 100, e.g., upon activation of activation switch 194 of energy activation assembly 190.

[0080] Referring to FIGS. 1-7, housing 20 houses the internal working components of instrument 10 and is formed from first and second housing components 22a, 22b configured to engage one another via a plurality of pin-aperture engagements 23 spaced around the perimeter of housing 20. Housing 20 defines a pistol-style configuration having a longitudinally-extending barrel portion 24 and a fixed handle portion 26 that extends from barrel portion 24 in generally perpendicular orientation relative thereto.

[0081] Housing 20, movable handle 40 of handle assembly 30, and trigger 72 of trigger assembly 70 are ergonomically configured to enable operable grasping of instrument 10 in a plurality of different positions. Housing 20, more specifically, defines an elongated indentation 27 within barrel portion 24 on either side thereof, while a waist 28 is recessed annularly about handle portion 26 adjacent the interconnection between handle portion 26 and barrel portion 24. Movable handle 40, more specifically, defines a grasping portion 42 having an elongated proximal leg 43 that extends the length of fixed handle portion 26 of housing 20, a proximal foot 44 disposed at the free end of proximal leg 43 and angled distally relative to proximal leg 43, and an arcuate segment 45 disposed at the opposite end of proximal leg 43 and extending distally therefrom. Arcuate segment 45 culminates in a distal tail 46 and defines a sufficient diameter so as to operably receive a user's finger between distal tail 46 and proximal leg 43. Trigger 72, more specifically, includes a concave trigger surface 73 defining a saddle 74 configured to help retain a user's finger therein.

[0082] With particular reference to FIGS. 4-6, and initially to FIG. 4, in a first operable grasping position, the user's hand is positioned such that the thumb is partially received within waist 28, the tip of the index finger extends across trigger 72 and is partially received within saddle 74, the middle finger extends across movable handle 40 and is positioned adjacent arcuate segment 45 of movable handle 40 between proximal leg 43 and distal tail 46, and the ring finger and pinky are positioned distally of and adjacent to proximal leg 43. In this position, waist 28 inhibits slipping of the thumb, saddle 74 inhibits slipping of the index finger, proximal leg 43 and distal tail 46 retain the middle finger therebetween to enable both proximal and distal movement of movable handle 40, proximal leg 43 provides a surface against which the ring finger and pinky can be utilized to urge movable handle 40 proximally, and proximal foot 44 inhibits slipping of the ring finger and pinky off the free end of movable handle 40.

[0083] Referring to FIG. 5, in a second operable grasping position, the user's hand is positioned such that the index finger is partially received within elongated indentation 27 on the opposite side of housing 20, the middle finger extends transversely across trigger 72 and is partially received within saddle 74, the ring finger extends across movable handle 40 and is positioned adjacent arcuate segment 45 of movable handle 40 between proximal leg 43 and distal tail 46, and the pinky is positioned distally of and adjacent to proximal leg 43. In this position, elongated indentation 27 inhibits slipping of the index finger, saddle 74 inhibits slipping of the middle finger, proximal leg 43 and distal tail 46 retain the ring finger therebetween to enable both proximal and distal movement of movable handle 40, and proximal leg 43 provides a surface against which the pinky can be utilized to urge movable handle 40 proximally.

[0084] Referring to FIG. 6, in a third operable grasping position, the user's hand is positioned such that the thumb is wrapped around a free end of fixed handle portion 26 of housing 20, the index finger and middle finger are positioned proximally of and adjacent the free end of proximal leg 43 of movable handle 40, the ring finger extends across movable handle 40 and is positioned adjacent arcuate segment 45 of movable handle 40 between proximal leg 43 and distal tail 46, and the pinky extends across trigger 72 and is partially received within saddle 74. In this position, proximal foot 44 inhibits slipping of the index finger off the free end of movable handle 40, proximal leg 43 and distal tail 46 retain the ring finger therebetween to enable both proximal and distal movement of movable handle 40, proximal leg 43 provides a surface against which the index and middle fingers can be utilized to urge movable handle 40 proximally, and saddle 74 inhibits slipping of the pinky.

[0085] With reference to FIG. 7, fixed handle portion 26 of housing 20 defines a bay 29a configured to receive and support energy activation assembly 190, which is operable to initiate and terminate the delivery of energy to end effector assembly 100. Energy activation assembly 190 includes a depressible button 192 that is mechanically coupled to a switch 194 mounted within bay 29a of fixed handle portion 26 and is engagable by a button activation post 196 extending proximally from a proximal side of movable handle 40 upon movement of the movable handle 40 to the activated position, as detailed below. Switch 194 is configured to electrically communicate with end effector assembly 100 and the generator (not shown) via suitable electrical wiring, e.g., leads 107 (FIG. 12), extending through housing 20, shaft 80, and/or an external cable (not shown) to enable energy to be supplied from the generator (not shown) to end effector assembly 100 upon activation of switch 194.

[0086] Referring additionally to FIG. 8, barrel portion 24 of housing 20 defines a distal aperture 29b (FIG. 7) configured to receive proximal end 82 of shaft 80 therein, and an engagement feature (not shown) extending inwardly from each of first and second housing components 22a, 22b for receipt within opposed apertures 83 defined through proximal end 82 of shaft 80 for securing proximal end 82 of shaft 80 within barrel portion 24 of housing 20. Shaft 80 extends distally from housing 20 and defines a generally rectangular cross-sectional configuration oriented such that the larger width dimension thereof extends laterally and the smaller height dimension thereof extends vertically. This configuration of shaft 80 relative to the orientation of jaw members 110, 120 (FIG. 7) provides an enhanced "line-of-sight" for visualizing the surgical site adjacent end effector assembly 100. As described in greater detail below, shaft 80 includes a pair of spaced-apart clevis members 84 extending from the top and bottom walls, e.g., the larger width dimension walls, of shaft 80 at distal end 85 thereof, each of which defines an aperture 86 for receiving a pivot pin 103 to operably support end effector assembly 100 at distal end 85 of shaft 80. In this configuration, apertures 86 are vertically-aligned with one another. Shaft 80 further includes, as noted above, opposed apertures 83 defined through the side walls, e.g., the smaller height dimension walls, of shaft 80 at proximal end 82 thereof for receiving engagement features (not shown) extending inwardly from first and second housing components 22a, 22b to secure proximal end 82 of shaft 80 within housing 20.

[0087] Barrel portion 24 of housing further includes a pair of pivot apertures 29c, a longitudinal track 29d (FIG. 13), a pivot boss 29e, and a retention pin 29f. Each pivot aperture 29c is defined on the inwardly-facing surface of one of first and second housing components 22a, 22b (only pivot aperture 29c of first housing component 22a is shown) and is configured to receive pivot pin 48 to pivotably couple movable handle 40 and trigger 72 to housing 20. Longitudinal track 29d (FIG. 13) is defined on the inwardly-facing surface of first housing component 22a and is configured to guide translation of drive assembly 140 relative to housing 20. Pivot boss 29e extends inwardly from first housing component 22a and is configured to pivotably couple linkage 76 of trigger assembly 70 to housing 20. Retention pin 29f extends inwardly from first housing component 22a and is configured to retain a fixed end 71a of biasing member 71 of trigger assembly 70 in fixed position relative to housing 20. The importance of these features of barrel portion 24 of housing 20 will become more apparent in view of the description below.

[0088] Turning to FIGS. 7-13, handle assembly 30 includes a movable handle 40 that is movable relative to fixed handle portion 26 of housing 20 between an initial position, a compressed position, and an activated position, as explained in greater detail below, to impart movement of jaw members 110, 120 of end effector assembly 100 between a spaced-apart position and an approximated position for grasping tissue therebetween and for initiating the supply of energy to end effector assembly 100 for treating grasped tissue. Movable handle 40 includes grasping portion 42, detailed above, which extends from housing 20 adjacent fixed handle portion 26, and flange portion 47, which extends upwardly into housing 20. Flange portion 47 is pivotably coupled within housing 20 at the free end of flange portion 47 via pivot pin 48. Pivot pin 48 is engaged within and extends between pivot apertures 29c of first and second housing components 22a, 22b of housing 20 to permit movable handle 40 to pivot about pivot pin 48 and relative to housing 20 between the initial position, the compressed position, and the activated position. Pivot pin 48 is disposed on one side of, e.g., above, drive assembly 140, while grasping portion 42 of movable handle 40 is disposed on the other side of, e.g., below, drive assembly 140, to provide a mechanical advantage when actuating movable handle 40.

[0089] Flange portion 47 of movable handle 40 further includes a cut-out 49 defined therein and an engagement bulge 51 protruding therefrom. Cut-out 49 is configured to slidably receive drive plate 142 of drive assembly 140 and knife plate 172 of knife assembly 170. Engagement bulge 51 is configured to operably engage flange portion 47 of movable handle 40 with slider assembly 150 of drive assembly 140, as detailed below.

[0090] Drive assembly 140 includes drive plate 142 and slider assembly 150. Drive plate 142 extends distally from housing 20 and through shaft 80 to operably engage end effector assembly 100 such that, as detailed below, translation of drive plate 142 through shaft 80 and relative to end effector assembly 100 pivots jaw members 110, 120 of end effector assembly 100 between the spaced-apart and approximated positions. Slider assembly 150 operably couples flange portion 47 of movable handle 40 with drive plate 142 such that pivoting of movable handle 40 between the initial position and the compressed position pivots jaw members 110, 120 of end effector assembly 100 between the

spaced-apart and approximated positions, while ensuring application of an appropriate closure force or closure force within an appropriate closure force range to tissue grasped between jaw members 110, 120 in the approximated position thereof.

[0091] Slider assembly 150 includes a proximal housing 152, a distal extension 154 extending distally from proximal housing 152, and a mandrel 156 disposed at the distal end of distal extension 154. Proximal housing 152 includes a post 153a configured to receive a torsion spring 160 thereabout, a first slot 153b configured to retain a first leg 161 of torsion spring 160 therein in fixed relation relative thereto, and a second slot 153c configured to operably receive second leg 162 of torsion spring 160 therein. Proximal housing 152 further includes an abutment rib 153d disposed thereon adjacent second slot 153c, and a flange member 153e configured for receipt within longitudinal track 29d (FIG. 13) of first housing component 22a of housing 20.

[0092] Referring briefly to FIG. 11A, another slider assembly 2150 provided in accordance with the present disclosure is similar to slider assembly 150 (FIGS. 10-11) except for the configuration of the proximal housing and spring; thus, only these differences are detailed below. Proximal housing 2152 of slider assembly 2150 is configured to house a compression spring 2160 therein. Compression spring 2160 defines a first end 2161 and a second end 2162. First end 2161 of compression spring 2160 is engaged with a vertical plate. Second end 2162 of compression spring 2160 is engaged with an inner wall of proximal housing 2152. In use, compression spring 2160 functions similar to torsion spring 160 (FIGS. 10-11), as detailed below, except that, rather than being further tensioned via application of a torsional force thereto, compression spring 2160 is further tensioned via application of a compressive force thereto.

[0093] Returning to FIGS. 7-13, mandrel 156, as noted above, is disposed at the distal end of distal extension 154 of slider assembly 150. Mandrel 156 includes a pair of spaced-apart walls 157 defining a channel 158 therebetween. Channel 158 is configured to receive engagement bulge 51 of flange portion 47 of movable handle 40 while permitting vertical sliding of engagement bulge 51 within channel 158. As a result of this configuration, upon pivoting of movable handle 40 between the initial, compressed, and activated positions, engagement bulge 51 is urged into contact with one of the walls 157 defining channel 158 to thereby translate slider assembly 150 within housing 20. The vertical sliding of engagement bulge 51 within channel 158 during such urging ensures that slider assembly 150 is translated longitudinally within and relative to housing 20 despite the arcuate travel of movable handle 40 as movable handle is pivoted about pivot pin 48 relative to housing 20.

[0094] Drive plate 142 includes a flange 143 disposed at the proximal end thereof. Flange 143 defines an aperture 144 configured to receive second leg 162 of torsion spring 160 therein such that translation of second leg 162 of torsion spring 160 relative to housing 20 effects corresponding translation of drive plate 142 relative to housing 20. With respect to slider assembly 2150, vertical plate 2163 is engaged within a slot 2144 defined within drive plate 142 (see FIG. 11A), and functions in a similar manner as detailed below with respect to slider assembly 150. Flange 143 further defines a proximal edge 145 configured to abut abutment rib 153d of proximal housing 152 in a proximal-most position of drive plate 142 relative to slider assembly

150 to inhibit further proximal movement of drive plate 142 relative to slider assembly 150.

[0095] Drive plate 142, as mentioned above, extends distally from housing 20 and through shaft 80 to operably engage end effector assembly 100. Drive plate 142 is oriented similarly to shaft 80, e.g., such that the width of drive plate 142 extends along the width dimension of shaft 80. Drive plate 142 further defines a track edge 146 extending along a portion of each longitudinal side thereof. Track edges 146 are configured to slidably receive knife plate 172, as detailed below. A cam-pin aperture 147 configured to receive a cam pin 105 associated with end effector assembly 100 is defined transversely through drive plate 142 towards the distal end of drive plate 142. A mouth 149 configured to receive a pivot pin 103 associated with end effector assembly 100 is defined at the distal end of drive plate 142.

[0096] With momentary reference to FIG. 9A, as an alternative to providing a slider assembly that operably retains a torsion spring therein for coupling to drive plate 142, a torsion spring 1160 may be operably coupled between movable handle 40 and drive plate 142 without a slider assembly. More specifically, in some embodiments, torsion spring 1160 is mounted about a post 1153a extending transversely from movable handle 40 and includes a first leg 1161 and a second leg 1162. First leg 1161 of torsion spring 1160 is configured for receipt within an aperture 1144 defined through drive plate 142 to operably couple movable handle 40 with drive plate 142, while second leg 1162 of torsion spring 1160 is fixed relative to movable handle 40 via abutment with a protrusion 1153c thereof. In use, torsion spring 1160 operates similarly to torsion spring 160 (FIGS. 10-11) and, thus, a separate description of the use of torsion spring 1160 is omitted as being superfluous.

[0097] With reference to FIGS. 14-21, as mentioned above, end effector assembly 100 is operably supported at distal end 85 of shaft 80 and includes opposing jaw members 110, 120 pivotably coupled to one another and movable relative to one another and shaft 80 between a spaced-apart position and an approximated position for grasping tissue therebetween. Each jaw member 110, 120 includes an electrically-conductive plate 112, 122, a jaw frame 113, 123, a spacer 115 (only spacer 115 of jaw member 110 is shown (FIG. 21)), and an outer housing 118, 128, each of which is detailed below. Jaw members 110, 120 define curved configurations, wherein jaw members 110, 120 bend upwardly from a longitudinal axis of shaft 80, e.g., towards the upper, larger width dimension wall of shaft 80. This configuration facilitates use of instrument 10 in tonsillectomy and adenoidectomy procedures as well as other surgical procedures and allows for increased visualization of the surgical site in these and other procedures. Except where specifically noted otherwise, jaw members 110, 120 define mirror-image configurations of one another.

[0098] Jaw frames 113, 123 of jaw members 110, 120 each include a pair of spaced-apart proximal flanges 113a, 123a and a distal jaw support 113b, 123b. Jaw frames 113, 123 are formed via stamping and made from stainless steel, although other manufacturing processes and/or materials for forming jaw frames 113, 123 are also contemplated. Proximal flanges 113a of jaw member 110 are spaced-apart further than proximal flanges 123a of jaw member 120 so as to allow proximal flanges 123a of jaw member 120 to be positioned between proximal flanges 113a of jaw member 110 during assembly. Further, the proximal flanges 113a, 123a of each

pair define aligned pivot apertures 114a, 124a and aligned cam slots 114b, 124b. Pivot pin 103 of end effector assembly 100 is configured for vertical insertion through apertures 86 of clevis members 84 of shaft 80 and pivot apertures 114a, 124a to pivotably couple jaw members 110, 120 to shaft 80 and one another with jaw members 110, 120 being laterally movable, e.g., along the larger width dimension of shaft 80, between the spaced-apart and approximated positions. Pivot pin 103 is configured to at least partially enter mouth 149 of drive plate 142 to permit drive plate 142 to slide further distally relative to end effector assembly 100 to a position wherein mouth 149 of drive plate 142 at least partially surrounds pivot pin 103.

[0099] The cam slots 114b of proximal flanges 113a of jaw member 110 are oppositely angled relative to the cam slots 124b of proximal flanges 123a of jaw member 120. Cam pin 105 of end effector assembly 100 is configured for insertion through each cam slot 114b, 124b as well as cam-pin aperture 147 of drive plate 142 to operable couple drive plate 142 with jaw members 110, 120 such that translation of drive plate 142 relative to jaw members 110, 120 pivots jaw members 110, 120 about pivot pin 103 and relative to one another and shaft 80 between the spaced-apart and approximated positions.

[0100] With particular reference to FIGS. 19-21, although only the features of jaw member 110 or jaw member 120 are described below and/or illustrated in the figures, it is noted that jaw members 110, 120 defines a mirror-image configurations of one another (unless specifically contradicted herein) and, thus, any description and/or illustration of one jaw member 110, 120 applies similarly to the other jaw member 110, 120.

[0101] Distal jaw support 113b of jaw frame 113 of jaw member 110 extends distally from proximal flange 113a and defines a generally “L-shaped” configuration. Distal jaw support 113b is configured to support electrically-conductive plate 112, spacer 115, and outer housing 118 of jaw member 110 thereon. However, distal jaw support 113b do not extend distally the entire length of jaw member 110. Rather, distal jaw support 113b defines a length of about 50% to about 75% of the lengths of electrically-conductive plate 112, spacer 115, and outer housing 118 such that about 25% to about 50% of the lengths of these components extend distally beyond distal jaw support 113b.

[0102] Spacer 115 of jaw member 110 defines a generally “M-shaped” configuration, is formed from an electrically-insulative material, and is overmolded onto distal jaw support 113b during a first overmold, although other manufacturing processes are also contemplated. Spacer 115 defines a body 116a and a pair of wings 116b surrounding body 116a. Spacer 115 is positioned to electrically-isolate electrically-conductive plate 112 and distal jaw support 113b from one another. A knife slot 116c extends longitudinally through body 116a of spaced 115 and is generally centered relative to body 116a. Knife slot 116c is open only to the top of spacer 115, except for the distal portion thereof, which extends beyond distal jaw support 113b and is open on both the top and bottom sides thereof to provide a window 116d. A support-receiving channel 116e extends longitudinally through body 116a at a position laterally offset relative to knife slot 116c so as to not interfere therewith. Support-receiving channel 116e is open to the bottom of spacer 115 and is configured to receive the upright of the “L-shaped” distal jaw support 113b upon the first overmolding of spacer

115 thereabout. Body **116a** of spacer **115** further defines a tunnel **116f** configured to permit passage of lead wire **107** therethrough.

[0103] The electrically-conductive plate **112**, **122** of each jaw member **110**, **120** defines a generally planar tissue-contacting surface **112a**, **122a**, an elongated slot **112b**, **122b** extending through the respective tissue-contacting surface **112a**, **122a**, a pair of legs **112c**, **122c** extending downwardly from each side of the respective tissue-contacting surface **112a**, **122b**, and a distal edge **112d**, **122d** disposed at the distal end of the respective tissue-contacting surface **112a**, **122a**. Electrically-conductive plates **112**, **122** extend from the proximal heels of jaw members **110**, **120**, e.g., the interface between flanges **113a**, **123a** and the distal portions of jaw members **110**, **120**, to the distal tips of jaw members **110**, **120**. Jaw housing **118** of jaw member **110** includes a pair of proximal tissue stops that extend therefrom about either side of jaw member **120** such that, in conjunction with the positioning of electrically-conductive plates **112**, **122** at the proximal heel of jaw members **110**, **120**, grasping of tissue proximally of electrically-conductive plates **112**, **122** is inhibited.

[0104] Tissue-contacting surfaces **112a**, **122a** define a plurality of spaced-apart recesses **112e**, **122e** therein that facilitate grasping tissue. Tissue-contacting surface **112a** of electrically-conductive plate **112** of jaw member **110** and/or tissue-contacting surface **122a** of electrically-conductive plate **122** of jaw member **120** may further include a plurality of stop members **122f** disposed thereon. Stop members **122f** may be constructed of a heat-resistant ceramic deposited onto the tissue-contacting surfaces **112a**, **122a**, an electrically non-conductive plastic molded onto tissue-contacting surfaces **112a**, **122a**, an electrical conductive material isolated from the respective tissue-contacting surface **112a**, **122a**, or may be formed from and/or manufactured in any other suitable fashion.

[0105] Each wing **116b** of spacer **115** of jaw member **110** defines a slot **116g**, open at the top end thereof, that is configured for receiving one of the legs **112c** of electrically-conductive plate **112**. Wire **107**, which extends through tunnel **116f** defined within spacer **115** is configured to electrical connect to an underside of electrically-conductive plate **112** towards the distal end thereof for enabling the selective supply of energy thereto. Wire **107** is configured to extend proximally through shaft **80** and into housing **20**, ultimately coupling to energy activation assembly **190** (FIG. 7) and/or extending through the cable (not shown) to couple to the generator (not shown).

[0106] Outer housings **118**, **128** are formed about jaw members **110**, **120** via a second overmold process, such that each outer housing **118**, **128** partially encloses respective jaw members **110**, **120** with the exception of a portion of the distal jaw support **113b**, **123b** thereof and the tissue-contacting surface **112a**, **122a** thereof, which remain exposed. Further, legs **112c**, **122c** of electrically-conductive plates **112**, **122** of jaw members **110**, **120** and the spacers **115** (only spacer **115** of jaw member **110** is shown) thereof each define a plurality of fill-apertures **122g** (only fill-apertures **122g** of electrically-conductive plate **122** of jaw member **120** are illustrated) that, upon overmolding of outer housings **118**, **128** about respective jaw members **110**, **120** are filled with the overmolded material forming outer housings **118**, **128** to lock the components of each jaw member **110**, **120** in an assembled condition. Further, outer housings **118**, **128** define

lengths extending along the sides of respective jaw members **110**, **120** and thicknesses that decrease in the proximal-to-distal direction along the lengths thereof. Outer housings **118**, **128** also define windows **119**, **129** that align with and communicate with the windows **116d** of the respective spacers **115** (only spacer **115** of jaw member **110** is illustrated) and the knife slots **112b**, **122b** of the respective electrically-conductive plate **112**, **122** thereof so as to define an opening **131**, **132** extending through the distal portion of each jaw member **110**, **120** transversely relative to the plane defined by the respective tissue-contacting surface **112a**, **122a**.

[0107] With outer housings **118**, **128** formed about jaw members **110**, **120**, respectively, distal edges **112d**, **122d** of electrically-conductive plates **112**, **122** overlap the distal ends of outer housings **118**, **128** such that, as illustrated in FIGS. **15** and **16**, distal edges **112d**, **122d** can be utilized to pinch tissue therebetween. In particular, this configuration enables pinching of planar tissue structures that lack substantial protruding portions that would otherwise enable grasping, such as the tissue wall illustrated in FIGS. **15** and **16**.

[0108] Referring to FIGS. **15A** and **16A**, jaw members **110**, **120** may further be utilized to spread and/or dissect tissue. In order to do so, with jaw members **110**, **120** disposed in the approximated position, end effector assembly **100** may be manipulated such that the distal tips of jaw members **110**, **120** are pressed into contact with tissue to be spread and/or dissected, as shown in FIG. **15A**. Thereafter, jaw members **110**, **120** are moved to the spaced-apart position such that the distal ends of outer housings **118**, **128** of jaw members **110**, **120**, respectively, push tissue in opposite directions, thus spreading and/or dissecting tissue. Various configurations of the distal ends of outer housings **118**, **128** of jaw members **110**, **120** to further facilitate spreading and/or dissecting tissue are detailed below. As also detailed below, drive assembly **140** (FIG. **12**) defines a pre-loaded configuration wherein drive assembly **140** (FIG. **12**) is always under tension, such that backlash upon moving jaw members **110**, **120** from the approximated position back to the spaced-apart position is eliminated. Such a configuration facilitates spreading and/or dissecting tissue by allowing for a more smooth and consistent transition of jaw members **110**, **120** from the approximated position back to the spaced-apart position.

[0109] Turning to FIGS. **15B**, **15B'**, and **16B**, in some embodiments, the distal ends of outer housings **118**, **128** of jaw members **110**, **120** define cut-outs that form shelves **118b**, **128b** between the distal ends of outer housings **118**, **128** and the body portions **118a**, **128a** of housings **118**, **128**, respectively. Shelves **118b**, **128b**, as shown in FIGS. **15B**, **15B'**, and **16B** facilitate the retention of tissue via the distal ends of outer housings **118**, **128**, thus inhibiting slipping of tissue and facilitating spreading and/or dissecting tissue.

[0110] Referring to FIGS. **15C**, **15C'**, and **16C**, in some embodiments, in addition to or as an alternative to including shelves **118b**, **128b**, the distal ends of outer housings **118**, **128** of jaw members **110**, **120** define extensions **118c**, **128c** that are relatively narrow and relatively small-radiused as compared to body portions **118a**, **128a** of housings **118**, **128**. These extensions **118c**, **128c** facilitate pressing the distal ends of jaw members **110**, **120** further into tissue (see FIG. **15C**) to ensure a relatively large contact area of tissue against shelves **118b**, **128b** upon moving jaw members **110**,

120 to the spaced-apart position (see FIG. 16C), thus facilitating the spreading and/or dissecting of tissue.

[0111] With reference to FIGS. 15D, 15D', and 16D, in some embodiments, the distal ends of outer housings 118, 128 of jaw members 110, 120 are cut-back to define angled surfaces 118*d*, 128*d* that define an angle “ ϕ ” relative to the perpendicular extending from the distal ends of jaw members 110, 120 (see FIG. 16D). Angled surfaces 118*d*, 128*d*, similarly as with the previous embodiments, facilitate the pressing of the distal ends of jaw members 110, 120 further into tissue (see FIG. 15D) as well as the retention of tissue while spreading and/or dissecting tissue.

[0112] Referring again to FIGS. 7-12, trigger assembly 70, as mentioned above, is operably coupled to knife assembly 170 to enable selective translation of knife blade 174 of knife assembly 170 relative to end effector assembly 100. Trigger assembly 70 includes trigger 72 and a linkage 76. Trigger 72 includes a grasping portion 75*a* which includes the concave trigger surface 73, a pivot extension 75*b* extending upwardly from grasping portion 75*a*, and a proximal extension 75*c* extending proximally from grasping portion 75*a*. Grasping portion 75*a* also includes a tab 75*d* extending distally therefrom. Tab 75*d* defines an aperture 75*e* configured to retain movable end 71*b* of biasing member 71 therein. As noted above, fixed end 71*a* of biasing member 71 is engaged via retention pin 29*f* of first housing component 22*a* of housing 20. In this manner, biasing member 71 serves to bias trigger 72 distally towards an un-actuated position (FIG. 35).

[0113] Pivot extension 75*b* of trigger 72 is pivotably coupled to housing 20 via pivot pin 48, which is engaged within and extends between pivot apertures 29*c* of first and second housing components 22*a*, 22*b* of housing 20. It is noted that pivot pin 48 is shared by both trigger 72 and movable handle 40; that is, both trigger 72 and movable handle 40 are pivotable about the same point relative to housing 20. Proximal extension 75*c* of trigger 72 includes a post 75*f* that, as detailed below, is operably engaged within cam slot 77*e* of linkage 76.

[0114] Linkage 76 serves to operably couple trigger 72 with knife assembly 170 such that pivoting of trigger 72 from the un-actuated position (FIG. 35) to the actuated position (FIG. 36) advances knife blade 174 relative to end effector assembly 100 to cut tissue grasped between jaw members 110, 120, as detailed below. Linkage 76 defines a generally triangular-shaped configuration including an apex 77*a* pointing in a distal direction and a base defining upper and lower corners 77*b*, 77*c*, respectively. Apex 77*a* includes a peg 77*d* that is configured for receipt within pivot boss 29*e* of first housing component 22*a* to pivotably couple linkage 76 relative to housing 20 about apex 77*a* thereof. A cam slot 77*e*, 77*f* is defined through linkage 76 adjacent upper and lower corners 77*b*, 77*c*, respectively. A coupling pin 78 operably couples cam slot 77*e* with knife plate 172 of knife assembly 170. More specifically, coupling pin 78 includes a cap 79*a* defining a slot 79*c* (FIG. 9) configured to receive finger 173 of knife plate 172 and a rod 79*b* that is operably engaged within cam slot 77*e*. As noted above, post 75*f* of proximal extension 75*c* of trigger 72 is operably engaged within cam slot 77*f*.

[0115] As a result of the above-detailed configuration of trigger assembly 70, pivoting of trigger 72 between the un-actuated and actuated positions (FIGS. 35 and 36, respectively) urges linkage 76 to pivot relative to housing 20

ultimately such that coupling pin 78 is urged to translate longitudinally within and relative to housing 20. As finger 173 of knife plate 172 is engaged with coupling pin 78, such longitudinal translation of coupling pin 78 is imparted to knife plate 172 for translating knife blade 174 between retracted and extended positions (FIGS. 29-34 and 38-40, respectively) relative to end effector assembly 100, as detailed below.

[0116] Knife assembly 170, as noted above, includes a knife plate 172 defining a finger 173 at the proximal end thereof. Knife plate 172 extends distally through housing 20 and shaft 80 atop drive plate 142 and is slidably engaged therewith via receipt of each end of knife plate 172 within track edges 146 of drive plate 142. Knife assembly 170 further includes knife blade 174 integrally formed with or otherwise engaged to knife plate 172 and extending distally therefrom. Knife blade 174 defines a width less than the combined thickness of jaw members 110, 120 at the proximal ends thereof but greater than or equal to the combined thickness of jaw members 110, 120 at the distal ends thereof. Knife blade 174 further defines an elongated opening 176 extending longitudinally therethrough. Elongated opening 176 permits knife blade 174 to be slidably disposed about pivot pin 103 and cam pin 105. More specifically, elongated opening 176 defines a first portion 177*a* having a first width configured to slidably receive pivot pin 103 and a second portion 177*b* having a second width configured to slidably receive cam pin 105 but sufficiently small to inhibit receipt of the larger-diameter pivot pin 103 therein.

[0117] As appreciated in view of the above, handle assembly 30, slider assembly 150 of drive assembly 1450, and trigger assembly 70 enable efficient assembly of instrument 10 in that these components may be operably positioned within housing 20 and relative to one another via a top-down assembly process.

[0118] Turning now to FIGS. 22-40, the use and operation of instrument 10 is described. Initially, as illustrated in FIGS. 22-24, 29, 31, and 33, movable handle 40 is disposed in the initial position and, correspondingly, jaw members 110, 120 are disposed in the spaced-apart position. More specifically, with movable handle 40 in the initial position, engagement bulge 51 is disposed in a distal-most position such that slider assembly 150 is disposed in a distal-most position. With slider assembly 150 disposed in its distal-most position, torsion spring 160 is less-tensioned and second leg 162 of torsion spring 160 retains drive plate 142 in a distal-most position. Torsion spring 160 is less-tensioned but not fully un-tensioned in the initial position of movable handle 40. This configuration maintains a pre-load on drive assembly 140 such that, as noted above, backlash due to the complete removal of tension from torsion spring 160 as jaw members 110, 120 move from the approximated position back to the spaced-apart position is eliminated. Drive plate 142 is inhibited from moving proximally relative to slider assembly 150 in this position due to the abutment of the proximal edge 145 of drive plate 142 with abutment rib 153*d* of proximal housing 152 of slider assembly 150. Further, in this distal-most position of drive plate 142, drive plate 142 maintains cam pin 105 at the distal ends of cam slots 114*b*, 124*b* and, thus, jaw members 110, 120 are maintained in the spaced-apart position.

[0119] Turning for the moment to FIG. 22A, in some embodiments, rather than first leg 161 of torsion spring 160 (FIGS. 10-11) being fixed relative to proximal housing 152

of slider assembly 150, a torsion spring 3160 may be provided including a first leg 3161 that extends through a slot 3153b defined within proximal housing 152 and is positioned to abut a block 3020 mounted within or monolithically formed with housing 20. As a result of this configuration, torsion spring 3160 provides the additional function of biasing slider assembly 150 distally, thereby biasing jaw members 110, 120 towards the spaced-apart position (see FIG. 14). That is, upon movement of movable handle 40 to translate slider assembly 150 proximally (see FIG. 9), first leg 3161 of torsion spring 3160 is maintained in position via its abutment with block 3020, thereby further tensioning torsion spring 3160 such that, upon release of movable handle 40 (FIG. 9), torsion spring 3160 serves to bias slider assembly 150 distally, thereby biasing jaw members 110, 120 towards the spaced-apart position (see FIG. 14). Further, multiple blocks 3020 may be provided at different positions within housing 20 such that, during assembly, first leg 3161 of torsion spring 3160 may be positioned to abut a selected one of the blocks 3020 to achieve a desired biasing force.

[0120] Returning to FIGS. 22-24, 29, 31, and 33, trigger 72 is initially disposed in the un-actuated position and, accordingly, knife blade 174 is disposed in the retracted position. More specifically, in the un-actuated position, trigger 72 is disposed in a distal-most position under the bias of biasing member 71 such that lower corner 77c of linkage 76, which is coupled to trigger 72 via engagement of post 75f within slot 77f, is disposed in a distal-most position. Since upper and lower corners 77b, 77c of linkage 76 are disposed on opposite sides of apex 77a, with lower corner 77c disposed in its distal-most position, upper corner 77b is disposed in a proximal-most position. With upper corner 77b disposed in its proximal-most position, knife plate 172 is likewise disposed in a proximal-most position due to the engagement of pin 78 within slot 77e. The proximal-most position of knife plate 172 corresponds to the retracted position of knife blade 174, wherein knife blade 174 is disposed between flanges 113a, 123a of jaw members 110, 120 but does not extend distally therefrom so as to avoid interference with tissue disposed between jaw members 110, 120. Further, in this position, pivot pin 103 is disposed at the distal end of first portion 177a of opening 176 of knife blade 174 and cam pin 105 is likewise disposed within first portion 177a of opening 176.

[0121] With additional reference to FIGS. 25-28, 30, 32, and 34, in order to move jaw members 110, 120 to the approximated position to grasp tissue therebetween, movable handle 40 is pulled proximally towards fixed handle portion 26 from the initial position (FIG. 22) to the compressed position (FIG. 27). Upon such movement of movable handle 40 to the compressed position, engagement bulge 51 of movable handle 40 is moved proximally relative to housing 20, thereby urging slider assembly 150 proximally through housing 20. Torsion spring 160, in the less-tensioned state, is translated proximally together with slider assembly 150 such that second leg 162 of torsion spring 160 pulls drive plate 142 proximally in connection with the proximal translation of slider assembly 150. In other words, at this point, slider assembly 150 and drive plate 142 move in concert with one another. As drive plate 142 is pulled proximally, cam pin 105 is pulled proximally through cam

slots 114b, 124b such that jaw members 110, 120 are pivoted from the spaced-apart position to the approximated position to grasp tissue therebetween.

[0122] As detailed above, movement of movable handle 40 from the initial position (FIG. 22) to the compressed position (FIG. 27) similarly translates drive plate 142 proximally, thereby moving jaw members 110, 120 to the approximated position to grasp tissue therebetween. Drive plate 142 is still inhibited from moving proximally relative to slider assembly 150 in this position due to the abutment of the proximal edge 145 of drive plate 142 with abutment rib 153d of proximal housing 152 of slider assembly 150.

[0123] At this point, with tissue grasped between jaw members 110, 120, instrument 10 may be utilized as a pliers to maneuver, manipulate, and/or reposition tissue. In particular, as noted above and illustrated in FIGS. 15 and 16, jaw members 110, 120 may be approximated adjacent a wall of tissue to pinch tissue between the distal tips of jaw members 110, 120 to enable maneuvering, manipulating, and/or repositioning thereof.

[0124] Referring to FIG. 35, in order to apply energy to tissue grasped between jaw members 110, 120 to treat tissue, movable handle 40 is compressed further towards fixed handle portion 26 to an activation position, wherein an appropriate closure force or closure force within an appropriate range, is achieved and energy activation is initiated. As movable handle 40 is moved further proximally relative to housing 20 beyond the compressed position, an appropriate closure force or closure force within an appropriate range is imparted to tissue grasped between electrically-conductive plates 112, 122 of jaw members 110, 120 regardless of the thickness or compressibility of tissue or the position of movable handle 40. This is because, upon movement of movable handle 40 from the compressed position towards the activation position, slider assembly 150 is translated proximally while drive plate 142 is maintained in position. In other words, upon movement of movable handle 40 from the compressed position to the activated position, slider assembly 150 and drive plate 142 no longer move in concert with one another. Rather, as detailed below, slider assembly 150 and drive plate 142 are decoupled to permit relative motion therebetween.

[0125] The decoupling of slider assembly 150 and drive plate 142 to permit relative motion therebetween is provided via torsion spring 160. More specifically, upon proximal movement of movable handle 40, a first force is imparted from movable handle 40, through slider assembly 150, first leg 161 of torsion spring 160, the body of torsion spring 160, and second leg 162 of torsion spring 160, to drive plate 142 to urge drive plate 142 in a proximal direction, while a second, opposite force acts on drive plate 142 and, thus, second leg 162 of torsion spring 160 in a distal direction to resist further compression of tissue between jaw members 110, 120. Once the second, opposite force exceeds the spring force of torsion spring 160, proximal movement of slider assembly 150 no longer results in proximal movement of drive plate 142 but, rather, results in further tensioning of torsion spring 160, which absorbs the force imparted thereto from movement of movable handle 40. Thus, once this point has been reached, further proximal translation of slider assembly 150 urges first end 161 of torsion spring 160 proximally, while second opposite force retains second leg 162 of torsion spring 160 in position, thereby further tensioning torsion spring 160. Since second leg 162 of torsion

spring 160 is retained in position, drive plate 142 is likewise retained in position despite the proximal translation of movable handle 40 and slider assembly 150.

[0126] It is noted that, during movement of movable handle 40 from the initial position to the compressed position, as detailed above, the second, opposite force is less than the spring force of torsion spring 160 and, thus, slider assembly 150, first and second legs 161, 162 of torsion spring 160, and drive plate 142 move in conjunction with one another. Further, torsion spring 160 may be configured such that the second, opposite force exceeds the spring force of torsion spring 160 at a force corresponding to a closure pressure on tissue between 3 kg/cm² to 16 kg/cm², as it has been found that closure forces within this range facilitate sealing of tissue grasped between jaw members 110, 120. However, other forces and/or force ranges are also contemplated, e.g., for treating tissue in other manners (coagulating, cauterizing, etc.).

[0127] Continuing with reference to FIG. 35, upon achieving the activation position of movable handle 40, button activation post 196 (FIG. 7) of movable handle 40 contacts depressible button 192 sufficiently so as to depress depressible button 192 into fixed handle portion 26 to activate switch 194. Switch 194, as noted above, is disposed in electrical communication with the generator (not shown) and electrically-conductive plates 112, 122 of jaw members 110, 120, respectively, such that activation of switch 194 initiates the supply of energy to electrically-conductive plates 112, 122 to treat, e.g., coagulate, cauterize, and/or seal, tissue grasped therebetween.

[0128] Referring to FIGS. 36-40, once tissue has been treated or where it is only desired to cut tissue, knife blade 174 may be advanced between jaw members 110, 120 to cut tissue grasped therebetween. In order to advance knife blade 174 from the retracted position to the extended position, trigger 72 is pulled proximally against the bias of biasing member 71 from the un-actuated position to the actuated position. As trigger 72 is pulled proximally, post 75f is pushed proximally to urge linkage 76 to pivot counter-clockwise (from the orientation illustrated in FIG. 36) such that upper corner 77b of linkage 76 is moved distally. Distal movement of upper corner 77b urges pin 78 to translate distally due to the engagement of rod 79b of pin 78 within slot 77e of upper corner 77b of linkage 76. Distal translation of pin 78, in turn, urges knife plate 172 distally due to the engagement of finger 173 of knife plate 172 within cap 79a of pin 78.

[0129] As detailed above, movement of trigger 72 from the un-actuated position to the actuated position urges knife plate 172 distally. More specifically, knife plate 172 is urged distally such that knife blade 174 is advanced distally from the retracted position to the extended position. As knife blade 174 is advanced distally, knife blade 174 enters the knife slots of jaw members 110, 120 defined by the respective knife slots 112b, 122b of electrically-conductive plates 112, 122 and the knife slots 116c of the respective spacers 115 (only spacer 115 of jaw member 110 is illustrated). As can be appreciated, translation of knife blade 174 through the knife slots of jaw members 110, 120 to the extended position thereof divides tissue grasped between jaw members 110, 120.

[0130] Due to the fact that knife blade 174 defines a width greater than or equal to the combined thickness of jaw members 110, 120 at the distal ends thereof, as knife blade

174 is advanced distally through the knife slots, knife blade 174 may extend at least partially through windows 119, 129 and openings 131, 132 of jaw members 110, 120, depending upon the thickness of tissue grasped between jaw members 110, 120 (see FIG. 39). Further, as knife blade 174 is advanced distally, pivot pin 103 and cam pin 105 translate proximally along opening 176 eventually such that cam pin 105 extends through second portion 177b of opening 176. As pivot pin 103 is too large to extend into second portion 177b of opening 176, interference therebetween defines the distal-most extent of travel of knife blade 174. However, other components of knife assembly 170 and/or trigger assembly 70 may additionally or alternatively inhibit the extension of knife blade 174.

[0131] Upon release of trigger 72, trigger 72 and knife plate 172 are returned proximally under the bias of biasing member 71 such that knife blade 174 is returned to the retracted position. Thereafter, movable handle 40 may be returned to the initial position to release the treated and/or divided tissue.

[0132] The various embodiments disclosed herein may also be configured to work with robotic surgical systems and what is commonly referred to as "Telesurgery." Such systems employ various robotic elements to assist the surgeon and allow remote operation (or partial remote operation) of surgical instrumentation. Various robotic arms, gears, cams, pulleys, electric and mechanical motors, etc. may be employed for this purpose and may be designed with a robotic surgical system to assist the surgeon during the course of an operation or treatment. Such robotic systems may include remotely steerable systems, automatically flexible surgical systems, remotely flexible surgical systems, remotely articulating surgical systems, wireless surgical systems, modular or selectively configurable remotely operated surgical systems, etc.

[0133] The robotic surgical systems may be employed with one or more consoles that are next to the operating theater or located in a remote location. In this instance, one team of surgeons or nurses may prep the patient for surgery and configure the robotic surgical system with one or more of the instruments disclosed herein while another surgeon (or group of surgeons) remotely control the instruments via the robotic surgical system. As can be appreciated, a highly skilled surgeon may perform multiple operations in multiple locations without leaving his/her remote console which can be both economically advantageous and a benefit to the patient or a series of patients.

[0134] The robotic arms of the surgical system are typically coupled to a pair of master handles by a controller. The handles can be moved by the surgeon to produce a corresponding movement of the working ends of any type of surgical instrument (e.g., end effectors, graspers, knives, scissors, etc.) which may complement the use of one or more of the embodiments described herein. The movement of the master handles may be scaled so that the working ends have a corresponding movement that is different, smaller or larger, than the movement performed by the operating hands of the surgeon. The scale factor or gearing ratio may be adjustable so that the operator can control the resolution of the working ends of the surgical instrument(s).

[0135] The master handles may include various sensors to provide feedback to the surgeon relating to various tissue parameters or conditions, e.g., tissue resistance due to manipulation, cutting or otherwise treating, pressure by the

instrument onto the tissue, tissue temperature, tissue impedance, etc. As can be appreciated, such sensors provide the surgeon with enhanced tactile feedback simulating actual operating conditions. The master handles may also include a variety of different actuators for delicate tissue manipulation or treatment further enhancing the surgeon's ability to mimic actual operating conditions.

[0136] From the foregoing and with reference to the various figure drawings, those skilled in the art will appreciate that certain modifications can also be made to the present disclosure without departing from the scope of the same. While several embodiments of the disclosure have been shown in the drawings, it is not intended that the disclosure be limited thereto, as it is intended that the disclosure be as broad in scope as the art will allow and that the specification be read likewise. Therefore, the above description should not be construed as limiting, but merely as exemplifications of particular embodiments. Those skilled in the art will envision other modifications within the scope and spirit of the claims appended hereto.

What is claimed is:

1. An end effector assembly for a surgical instrument, comprising:

first and second jaw members, each of the first and second jaw members including:

a jaw frame including at least one proximal flange and a distal jaw support extending distally from the at least one proximal flange;

a spacer defining a body and a wing disposed on either side of the body, the body defining a channel configured to receive the distal jaw support, each wing defining a slot;

an electrically-conductive plate defining a tissue-contacting portion and first and second legs extending from the tissue-contacting portion in perpendicular orientation relative thereto, the tissue-contacting portion configured to sit atop the body of the spacer, each of the first and second legs configured for receipt within the slot defined within one of the wings of the spacer; and

an outer housing at least partially surrounding the distal jaw support, spacer, and first and second legs of the electrically-conductive plate and configured to retain the distal jaw support, spacer, and electrically-conductive plate in position relative to one another.

2. The end effector assembly according to claim 1, wherein at least one of the first and second legs of the electrically-conductive plate or the spacer includes a plurality of apertures defined therethrough, and wherein a portion of the outer housing extends through each of the apertures to facilitate engagement of the outer housing.

3. The end effector assembly according to claim 1, wherein a tunnel is defined between the spacer and the distal jaw support, the tunnel configured to receive a wire for supplying energy to the electrically-conductive plate.

4. The end effector assembly according to claim 1, wherein the spacer is configured to electrically isolate the electrically-conductive plate from the jaw frame.

5. The end effector assembly according to claim 1, wherein the body of the spacer further defines a knife slot extending longitudinally therethrough, the knife slot of the body of the spacer and the channel of the body of the spacer offset relative to one another and open to opposite surfaces of the body of the spacer.

6. The end effector assembly according to claim 5, wherein the electrically-conductive plate defines a knife slot disposed in alignment with the knife slot of the body of the spacer.

7. The end effector assembly according to claim 1, wherein the electrically-conductive plate further includes a distal tip extending distally from the tissue-contacting portion, the distal tip defining an exposed edge configured to facilitate grasping tissue.

8. The end effector assembly according to claim 1, wherein the electrically-conductive plate, spacer, and outer housing define lengths greater than that of the distal jaw support so as to extend distally beyond the distal jaw support.

9. The end effector assembly according to claim 8, wherein the length of the distal jaw support is between 50% and 75% of the length each of the electrically-conductive plate, spacer, and outer housing.

10. The end effector assembly according to claim 8, wherein a window is defined through portions of the electrically-conductive plate, spacer, and outer housing that extend distally beyond the distal jaw support.

11. The end effector assembly according to claim 1, wherein the jaw frame of each of the first and second jaw members includes a pair of spaced-apart proximal flanges, the proximal flanges of the first and second jaw members coupled to one another to permit pivotable movement of the first and second jaw members between a spaced-apart position and an approximated position.

12. The end effector assembly according to claim 11, wherein the proximal flanges of the second jaw member are disposed between the proximal flanges of the first jaw member.

13. The end effector assembly according to claim 1, wherein the first and second jaw members each define lengths and thicknesses that decrease along the lengths thereof in a proximal to distal direction.

14. The end effector assembly according to claim 1, wherein the spacer is overmolded onto the jaw frame via a first overmold.

15. The end effector assembly according to claim 1, wherein the jaw housing is overmolded about the distal jaw support, spacer, and first and second legs of the electrically-conductive plate via a second overmold.

16. A method of manufacturing a jaw member of an end effector assembly of a surgical instrument, comprising:

overmolding a spacer onto a jaw support, the spacer including a body and a wing disposed on either side of the body, each wing defining a slot;

positioning an electrically-conductive plate defining a tissue-contacting portion and first and second legs extending from the tissue-contacting portion in perpendicular orientation relative thereto atop the spacer such that the tissue-contacting portion is disposed atop the body of the spacer and the first and second legs are received within the slots defined within the wings;

overmolding an outer housing about the jaw support, spacer, and first and second legs of the electrically-conductive plate to retain the distal jaw support, spacer, and electrically-conductive plate in position relative to one another.

17. The method according to claim 16, wherein at least one of the first and second legs of the electrically-conductive plate or the spacer includes a plurality of apertures defined

therethrough such that, during overmolding of the outer housing about the jaw support, spacer, and first and second legs of the electrically-conductive plate, a portion of the outer housing extends through each of the apertures to facilitate engagement of the outer housing.

18. The method according to claim **16**, further including routing a wire through a tunnel defined between the spacer and the jaw support.

19. The method according to claim **18**, further including coupling the wire to the electrically-conductive plate.

* * * * *