

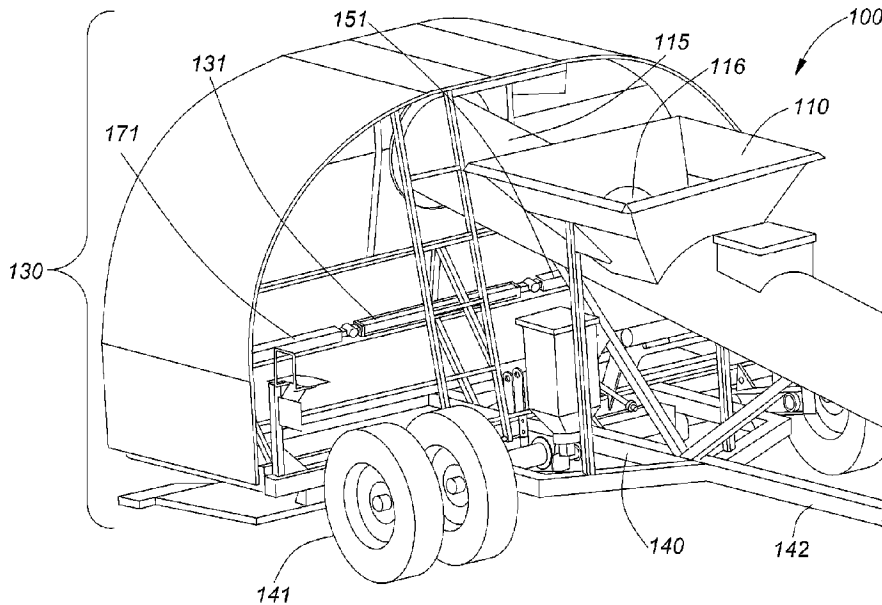

(22) Date de dépôt/Filing Date: 2019/07/29
(41) Mise à la disp. pub./Open to Public Insp.: 2020/04/16
(45) Date de délivrance/Issue Date: 2021/06/22
(30) Priorité/Priority: 2018/10/16 (US62/746,130)

(51) Cl.Int./Int.Cl. *B65B 1/04* (2006.01),
A01F 25/14 (2006.01), *B65B 37/00* (2006.01)
(72) Inventeurs/Inventors:
WIERENGA, JOHN MARVIN, CA;
WIERENGA, LAMBERT, CA;
VANDER LEEST, BRYAN RICHARD, CA
(73) Propriétaire/Owner:
NEERALTA MANUFACTURING INC., CA
(74) Agent: BRION RAFFOUL

(54) Titre : APPAREIL D'ENSACHAGE DU GRAIN EXTENSIBLE ET PROCEDE D'UTILISATION
(54) Title: AN EXPANDABLE GRAIN BAGGING APPARATUS AND METHOD THEREOF



(57) **Abrégé/Abstract:**

The present invention relates to devices and methods for loading grain into a grain bag using a grain bagging apparatus that can expand and contract to accommodate different grain bag sizes. The apparatus is comprised of an expandable grain discharge tunnel. This expandable tunnel comprises a stationary section and a flanking side. The flanking side can expand in an outwardly direction away from the stationary section to increase the overall width of the grain discharge tunnel such that differently sized grain bags can be utilized with a single grain bagging apparatus. The flanking side can be slid in an inwardly direction towards the stationary section into a first position for use with smaller grain bags. In the first position, the apparatus is easier to transport or store. The grain bag can be loaded onto the grain bagging apparatus in a first position and then the expandable grain discharge tunnel can be expanded into the second position.

ABSTRACT

The present invention relates to devices and methods for loading grain into a grain bag using a grain bagging apparatus that can expand and contract to accommodate different grain bag sizes. The apparatus is comprised of an expandable grain discharge tunnel. This expandable tunnel
5 comprises a stationary section and a flanking side. The flanking side can expand in an outwardly direction away from the stationary section to increase the overall width of the grain discharge tunnel such that differently sized grain bags can be utilized with a single grain bagging apparatus. The flanking side can be slid in an inwardly direction towards the stationary section into a first position for use with smaller grain bags. In the first position, the apparatus is easier to
10 transport or store. The grain bag can be loaded onto the grain bagging apparatus in a first position and then the expandable grain discharge tunnel can be expanded into the second position.

**AN EXPANDABLE GRAIN BAGGING APPARATUS AND
METHOD THEREOF**

TECHNICAL FIELD

5 The present invention relates to grain bags. More specifically, the present invention relates to a grain bag loading machine.

BACKGROUND

10 Grain production in the agriculture industry is expanding to feed the world's population. Single farming operations are increasingly producing more and more grain products. Accordingly, convenient grain storage methods are required to store the grain products.

15 Use of grain bags or grain sleeves for storing grains, such as cereal grains, seeds, oilseeds, pulses, and legumes is becoming standard practice. The grain bags are transported as large rolls of flexible material, such as plastic, in which the grain can be stored during the winter months.

20 The grain is loaded into these grain bags using grain bagging machines. The bags are then sealed for storage. One problem with the grain bagging system is that there are multiple sizes of grain bags – ranging from 9 to 12 feet in diameter. Accordingly, the grain bagging machines used to load these grain bags must have grain discharge tunnels with widths that accommodate grain bags that range from 9 feet to 12 feet in diameter. Currently, for a grain farming operation to utilize the various sizes of grain bags, multiple grain bagging machines are required – one for each size of desired grain bag. However, the same grain farming operation may have various field or crop sizes that require different grain bag sizes for storage.

25 Furthermore, to utilize the larger grain bag sizes, such as 12-foot bags, the required grain bagging machine must also be the same width of the bags. Transportation of a wider machine can be more difficult for the operator and dangerous to the public

when traveling on roads and highways. Additionally, storage of larger grain bagging machines can be cumbersome for the operator, especially if multiple size machines are required for a single grain operation.

5 Based on the above, there is therefore a need for methods, devices, and systems which mitigate, if not overcome, the problems with the prior art.

SUMMARY

10 The present invention provides devices and methods for loading grain into a grain bag using a grain bagging apparatus that can expand and contract to accommodate different grain bag sizes. The apparatus is comprised of an expandable grain discharge tunnel. This expandable tunnel comprises a stationary section and a flanking side. The flanking side can expand in an outwardly direction away from the stationary section to increase the overall width of the grain discharge tunnel such that differently sized grain bags can be utilized with a single grain bagging apparatus. The flanking side can be slid in an inwardly direction towards the stationary section into a first position for use with smaller grain bags. In the first position, the apparatus is easier to transport or store. To simplify installation, the grain bag can be loaded onto the grain bagging apparatus in the first position and then the expandable grain discharge tunnel can be expanded into the second position.

20 In a first aspect, the present invention provides an expandable grain discharge tunnel for a grain bagging apparatus, the expandable grain discharge tunnel comprising: a stationary section; a first flank slidably coupled to the stationary section; and a first drive means having a first end and a second end, the first end of the first drive means is coupled to the first flank and the second end of the drive means is coupled to the stationary section; wherein the first drive means is for sliding the first flank in an outwardly direction away from the stationary section to move the expandable grain discharge tunnel from a first position to a second position and the drive means is for sliding the first flank in an inwardly direction towards the stationary section to move the expandable grain discharge tunnel from the second position to the first position; and the expandable grain discharge tunnel is configured to accommodate at least two

5 sizes of grain bags, such that the first position and the second position of the expandable grain discharge tunnel are each configured to couple with one of the at least two sizes of grain bags.

10 In a second aspect, the present invention provides a grain bagging apparatus for loading grain into a grain bag for storage, the grain bagging apparatus comprising an expandable grain discharge tunnel having: a stationary section; a first flank slidably coupled to the stationary section; and a first drive means having a first end and a second end, the first end of the first drive means is coupled to the first flank and the second end of the drive means is coupled to the stationary section; wherein the first drive means is for sliding the first flank in an outwardly direction away from the stationary section to move the expandable grain discharge tunnel from a first position to a second position and the drive means is for sliding the first flank in an inwardly direction towards the stationary section to move the expandable grain discharge tunnel from the second position to the first position; and the expandable grain discharge tunnel is configured to accommodate at least two sizes of grain bags, such that the first position and the second position of the expandable grain discharge tunnel are each configured to couple with one of the at least two sizes of grain bags.

15 In a third aspect, the present invention provides a method of loading a grain bag on a grain bagging apparatus having an expandable grain discharge tunnel, the method comprising the steps of: providing the grain bagging apparatus having the expandable grain discharge tunnel, the expandable grain discharge tunnel is capable of being in a first position and a second position and a width of the expandable grain discharge tunnel is smaller in the first position than in the second position; positioning the grain bag on the expandable grain discharge tunnel while the tunnel is in the first position; and moving the expandable grain discharge tunnel from the first position to the second position.

25 In a further aspect, this document discloses an expandable grain discharge tunnel for a grain bagging apparatus, the expandable grain discharge tunnel comprising: a stationary section; a first flank slidably coupled to the stationary section; and a first

5 drive means having a first end and a second end, the first end of the first drive means
being coupled to the first flank and the second end of the drive means being coupled
to the stationary section; wherein the first drive means slidably transitions the
expandable grain discharge tunnel from a first position to a second position by
sliding the first flank in an outward direction away from the stationary section along
10 a rectilinear path and the first drive means slidably transitions the expandable grain
discharge tunnel from the second position to the first position by sliding the first
flank in an inward direction towards the stationary section along the rectilinear path;
wherein the expandable grain discharge tunnel has a wider width in the second
position than in the first position, such that differently sized grain bags are
15 mountable with the grain discharge tunnel when the grain discharge tunnel is in
different positions.

In still a further aspect, this document discloses a grain bagging apparatus for
loading grain into a grain bag for storage, the grain bagging apparatus comprising an
expandable grain discharge tunnel having: a stationary section; a first flank slidably
20 coupled to the stationary section; and a first drive means having a first end and a
second end, the first end of the first drive means being coupled to the first flank and
the second end of the drive means being coupled to the stationary section; wherein
the first drive means slidably transitions the expandable grain discharge tunnel from
a first position to a second position by sliding the first flank in an outward direction
25 away from the stationary section along a rectilinear path and the first drive means
slidably transitions the expandable grain discharge tunnel from the second position to
the first position by sliding the first flank in an inward direction towards the
stationary section along the rectilinear path; wherein the expandable grain discharge
tunnel has a wider width in the second position than in the first position such that
30 differently sized grain bags are mountable on the grain discharge tunnel.

In another aspect, this document discloses a method of loading a grain bag on a grain
bagging apparatus having an expandable grain discharge tunnel, the method
comprising the steps of: providing the grain bagging apparatus, the grain bagging

5 apparatus having the expandable grain discharge tunnel, the expandable grain discharge tunnel
having a stationary section and at least one flank and the
expandable grain discharge tunnel being configured to have a first position and a
second position and the expandable grain discharge tunnel being configured to
slidably transition from the first position to the second position by sliding the at least
10 one flank in an outward direction away from the stationary section along a rectilinear
path, the grain discharge tunnel having a larger width in the second position than in
the first position; securing the grain bag on the expandable grain discharge tunnel
while the tunnel is in the first position; and slidably transitioning the expandable
grain discharge tunnel from the first position to the second position along the
15 rectilinear path to thereby secure the grain bag around an outer perimeter of the
expandable grain discharge tunnel.

BRIEF DESCRIPTION OF THE DRAWINGS

The present invention will now be described by reference to the following figures, in which identical reference numerals refer to identical elements and in which:

5 **Figure 1** is a rear perspective view of a grain bagging apparatus in a first position according to one aspect of the invention;

Figure 2 is a front perspective view of a grain bagging apparatus in a first position according to one aspect of the invention;

Figure 3 is a rear perspective view of a grain bagging apparatus in a second position according to one aspect of the invention;

10 **Figure 4** is a front perspective view of a grain bagging apparatus in a second position according to one aspect of the invention;

Figure 5 is a rear perspective view of a portion of a grain bagging apparatus in a second position according to another aspect of the invention;

15 **Figure 6** is a rear perspective view of the portion of the grain bagging apparatus illustrated in Figure 5 in a third position;

Figure 7 is a front perspective view of a grain bagging apparatus according to a further aspect of the invention; and

Figure 8 is a front perspective view of a grain bagging apparatus according to a further aspect of the invention.

20 **DETAILED DESCRIPTION**

The terms "coupled" and "connected", along with their derivatives, may be used herein. It should be understood that these terms are not intended as synonyms for each other. Rather, in particular embodiments, "connected" may be used to indicate that two or more elements are in direct physical contact with each other. "Coupled" 25 may be used to indicated that two or more elements are in either direct or indirect

(with other intervening elements between them) physical contact with each other, or that the two or more elements co-operate or interact with each other (e.g. as in a cause and effect relationship).

5 Referring now to **Figure 1**, the rear side (*i.e.*, the side where the grain is being loaded into the grain bag) of a grain bagging apparatus **100** in a first position is shown. The grain bagging apparatus **100** comprises an inlet **110**, a conduit **115**, an outlet **120**, an expandable grain discharge tunnel **130**, and a mobile chassis **140**. The grain bagging apparatus **100** is in a first position when the expandable grain discharge tunnel **130** has not been expanded outwardly to have a larger width (*i.e.*,
10 the grain discharge tunnel **130** is in a first position).

The expandable grain discharge tunnel **130** in the first position is for accommodating and bagging grain in smaller grain bags. Additionally, the grain bagging apparatus **100** is easier to transport or store in the first position. The expandable grain discharge tunnel **130** can then be expanded outwardly into a second position. The width of the
15 expandable grain discharge tunnel **130** is larger in the second position than in the first position. Accordingly, the expandable grain discharge tunnel **130** in the second position is for accommodating and bagging grain in larger grain bags. The second position may be the fully expanded position (*i.e.*, the flanking sides being moved outwardly from the stationary section to the flanking side's fullest extent).

20 Alternatively, the second position may be a mid-way position such that the width of the expandable grain discharge tunnel **130** can be further expanded (*i.e.*, the flanking side(s) can move further away from the stationary section in an outwardly direction) into additional positions. Accordingly, the grain bagging apparatus **100** may accommodate more than two (2) sizes of grain bags.

25 A grain bag that is folded in an accordion-like fashion is loaded onto the expandable grain discharge tunnel **130**. The grain bag is then secured to the expandable grain discharge tunnel **130**. Once secured to the expandable grain discharge tunnel **130**, the grain bag is sealed at one end. Grain is then deposited into the inlet **110**, flows through the conduit **115** to the outlet **120**. The conduit **115** is coupled to the

expandable grain discharge tunnel **130** at the outlet **120** such that the grain flows out the outlet **120** and into the grain bag.

5 As the grain is being fed into the grain bag, the grain bagging apparatus **100** moves away from the sealed end of the grain bag on the mobile chassis **140** as the pressure from the grain loaded into the grain bag pushes on the back shield and moves the grain bagging apparatus **100** forward along with the neutral geared power source (*i.e.*, the mover in neutral). The movement of the grain bagging apparatus **100** away from the sealed end allows the bottom of the grain bag to remain stationary on the ground and facilitates uniform loading of the grain into the grain bag.

10 The main body of the expandable grain discharge tunnel **130** is comprised of a stationary shield **150** coupled to a stationary plate **160** (as shown in Figure 3) and two (2) flanking shields **170**, each coupled to a flanking frame **180**. The stationary shield **150** and stationary plate **160** collectively form a stationary section. The left flanking shield **170** and the left flanking frame **180** sections collectively form a first flank. Similarly, the right flanking shield **170** and the right flanking frame **180** collectively form a second flank. In operation, the width of the expandable grain discharge tunnel **130** increases when the first flank and/or the second flank moves in an outwardly direction away from the stationary section (*i.e.*, moves from the first position to the second position). Similarly, the width of the expandable grain discharge tunnel **130** decreases when the first flank and/or the second flank moves in an inwardly direction toward the stationary section (*i.e.*, moves from the second position to the first position).

20 An expandable loading tray **190** may be coupled to the bottom edge of the stationary shield **150** and/or the flanking shields **170** to assist in securing the grain bag to the expandable grain discharge tunnel **130**. Similarly to the stationary section and flanking sides, the expandable loading tray **190** has flanking portions that are slidably coupled to a stationary portion. When the expandable grain discharge tunnel **130** moves from the first position to additional positions (*i.e.*, second, third, fourth, *etc.* positions), the flanking portions of the expandable loading tray **190** in an

outwardly direction also move in an outwardly direction from the stationary portion to increase the width of the expandable loading tray **190**. The width of the expandable loading tray **190** expands to be approximately equal to the width of the expandable grain discharge tunnel **130** in the additional position.

5 In a further embodiment, a rubber flap may be coupled to the bottom edge of the stationary shield **150** and/or the flanking shields **170**. The rubber flap prevents grain from pouring into the unused portion of the grain bag, when the grain bag is being loaded into the grain bag.

10 The conduit **115** is coupled to the stationary shield **150** at the outlet **120**, such that the grain is loaded near the center of the expandable grain discharge tunnel **130**. However, the expandable grain discharge tunnel **130** could be offset to either side of the conduit **115** such that the conduit **115** is coupled to either of the flanking shields **170**. The stationary shield **150** and the flanking shields **170** collectively form a back shield of the expandable grain discharge tunnel **130** to ensure that the grain exiting the outlet **120** moves in the direction of the grain bag.

15 The stationary shield **150** may be coupled perpendicular or near perpendicular to the stationary plate **160** at any point along the bottom side of the stationary plate **160**. In a preferred embodiment, the stationary plate **160** is coupled to the stationary shield **150** on the front side end of the stationary plate **160** (as shown in Figures 5 and 6).

20 Similarly, each of the flanking shields **170** may be coupled perpendicular to or near perpendicular to each flanking frame **180** at any point along the bottom side of the flanking frame **180**. In a referred embodiment, the flanking frames **180** are each coupled to their respective flanking shield **170** on the front side end of the flanking frames **180**.

25 At least one of the flanking sides (*i.e.*, a flanking shield **170** coupled to a flanking frame **180**) is slidably coupled to the stationary section (*i.e.*, the stationary shield **150** and the stationary plate **160**), such that the flanking side(s) can slide outwardly from the stationary section to expand the outer perimeter of the expandable grain

5 discharge tunnel **130** into the second position. The width of the stationary section is such that the edge of the flanking side adjacent to the stationary section is still overlapping with the stationary section when in the fully expanded position. This overlap in the fully expanded position allows the stationary shield **150** to support the flanking shields **170** when pressure is applied against the back shield from the grain being discharged from the outlet **120**. Accordingly, there should not be an opening between the stationary section and the flanking sides when the expandable grain discharge tunnel **130** is in the fully expanded position. Accordingly, in the first position, there is a significant overlap between the slidable flanking side(s) and the stationary section.

10 In an embodiment where only one flanking frame **180** is slidably coupled to the stationary plate **160**, the other flanking frame **180** may be coupled to a side, top or bottom of the stationary plate **160**. Similarly, where only one flanking shield **170** is slidably coupled to the stationary shield **150**, the other flanking shield **170** may be coupled to the front or rear side of the stationary shield **150**.

15 Embodiments where only one flanking side is slidably coupled to the stationary section are discussed herein. However, to allow for an even distribution of grain flowing into the grain bag, the outlet **120** is preferably in the center of the expandable grain discharge tunnel **130**, when the expandable grain discharge tunnel **130** is in any position. Accordingly, for optimal results, the preferred embodiment has both flanking sides slidably coupled to the stationary section. An even distribution of grain is thus achieved by having both flanking sides move in an outwardly direction away from the stationary section an equal amount while the outlet **120** remains stationary. When only one flanking side moves, the outlet **120** remaining in the center of the expandable grain discharge tunnel **130** in an expanded position can be achieved by having the conduit **115** (and thus the outlet **120**) move a portion of the distance with the flanking side. Alternatively, an even distribution of grain can be achieved by diverting the grain from the outlet **120** to the center of the expandable grain discharge tunnel **130**, when the expandable grain discharge tunnel **130** is in an expanded position.

5 In Figure 1, the flanking shields **170** are slidably coupled to the rear side of the stationary shield **150** and the flanking frames **180** are slidably coupled to the top of the stationary plate **160**. Accordingly, there is a slit or gap **562** (as shown in Figure 6) in the stationary plate **160** for the flanking shields **170** to fit through and to couple to the flanking frames **180**. In this embodiment, the slit or gap **562** is a space on either side of the coupling point between the stationary shield **150** and the stationary plate **160**. The slit or gap **562** allows for a maximum overlap of the flanking shields **170** on the rear side of the stationary shield **150**, without the flanking shields' **160** movement being impeded by the stationary plate **160**.

10 However, in another embodiment, the flanking shields **170** may be slidably coupled to the front side of the stationary shield **150** and the flanking frames **180** may be slidably coupled to the bottom of the stationary plate **160**. A slit or gap **562** would not be necessary if the flanking shield **170** was coupled to the front side of the stationary shield **150** and if the flanking frame **180** was coupled on the top side of the stationary plate **160**. Similarly, a slit or gap **562** would not be necessary if the flanking shield **170** was coupled to the rear side of the stationary shield **150** and if the flanking frame **180** was coupled on the bottom side of the stationary plate **160**.

15 Referring now to **Figure 2**, the front side (*i.e.*, the side facing away from the grain being loaded into the grain bag) of the grain bagging apparatus **100** in the first position is shown.

20 As can be seen, the inlet **110** is for receiving the grain and is coupled to the conduit **115** such that the grain, when deposited in the inlet **110**, flows through the conduit **115** to the outlet **120**. A funnel may be coupled to the inlet **110**, as shown in Figure 2, for ease of depositing grain. A wider funnel allows for easier unloading of the grain transporting machine, such as a grain cart, chaser bin, or auger wagon, into the inlet **110** while the grain bagging apparatus **100** is moving. However, the inlet **110** may also be an opening in the conduit **115** without a funnel. The inlet **110** or funnel may also have a roll tarp cover coupled adjacent to the inlet **110** or funnel, respectively, to cover the inlet **110** or funnel when the grain bagging apparatus **100** is

not in use. A roll tarp cover protects the inlet **110** or funnel and prevents moisture from entering the conduit **115**.

5 The conduit **115** may be a pipe, tube, or other suitable means that facilitates the movement of the grain from the inlet **110** to the expandable grain discharge tunnel **130**. The conduit **115** is coupled to the expandable grain discharge tunnel **130** at the outlet **120**. The conduit **115** may be inclined in a manner such that the grain pours directly from the inlet **110**, through the conduit **115** and out the outlet **120** to the expandable grain discharge tunnel **130**. However, to facilitate proper and consistent movement of the grain while loading the grain bag, a power actuated means **116** of moving the grain may be used, such as an auger or a conveyor belt. The power actuated means **116** may be powered by an engine or battery on the grain bagging apparatus **100** or may be powered by the mover used to move the grain bagging apparatus **100** (such as through a drive shaft or power take-off (PTO)).

15 To facilitate the movement of the expandable grain discharge tunnel **130** from the first position to the second position, and *vice versa*, the stationary shield **150** and the flanking shields **170** may be coupled to a stationary framework **151** and a slidable framework **171**, respectively, on the front side of the expandable grain discharge tunnel **130**. When both flanking sides (*i.e.*, a flanking shield **170** and a flanking frame **180**) are slidably coupled on either side of the stationary section (*i.e.*, the stationary shield **150** and the stationary plate **160**), the slidable frameworks **171** are slidably coupled to either side of the stationary framework **151**. A drive means **131** is coupled to a stationary framework **151** at one end and to the slidable framework **171** at the other end. When the drive means **131** is actuated, the slidable framework **171** can move towards or away from the stationary framework **151** (*i.e.*, inwardly or outwardly with respect to a center of the expandable grain discharge tunnel **130**) such that the expandable grain discharge tunnel **130** is moved into either the first position or the second position, respectively.

25 Similarly, the expandable loading tray **190** has a stationary portion that is coupled to the stationary shield **150** and/or the stationary framework **151**. The stationary portion

is slidably coupled on either side to flanking portions such that the flanking portions can move towards or away from the stationary portion (*i.e.*, inwardly or outwardly with respect to a center of the expandable loading tray **190**). The flanking portions may be coupled to their respective flanking shield **170** and/or slidable framework **171**, such that when the drive means **131** moves a flanking shield from the first position to the second position, the respective flanking portion also moves from the first position to the second position. Accordingly, the width of the expandable loading tray **190** can be expanded to have substantially the same width as the expandable grain discharge tunnel **130** when in the second position. When only one flanking side is slidably coupled to the stationary section, the flanking portion of the expandable loading tray **190** would be slidably coupled to the stationary portion of the expandable loading tray **190** on the same side that the sliding flanking side is slidably coupled to the stationary section.

The flanking portions of the expandable loading tray **190** may have vertical guide plates coupled to their outer edges (*i.e.*, vertical guide plates on the outer edges of the expandable loading tray **190**). These vertical guide plates help shape the grain bag around the expandable grain discharge tunnel **130**. The expandable grain discharge tunnel **130** is coupled to or mounted onto the mobile chassis **140**, such that the grain bagging apparatus **100** can move forward when being used to bag grain. The mobile chassis **140** may have wheels **141** to facilitate mobility. However, the grain bagging apparatus **100** would work with other mobility means, such as a mobile chassis **140** with skis or tracks.

The mobile chassis **140** may have a solid or extendable tongue **142** for coupling to the mover. The mover may be a tractor, truck or other suitable machinery for pulling the grain bagger. Alternatively, the mover may be a self-propelling system coupled to the grain bagging apparatus **100**. In another embodiment, the mobile chassis **140** may be pivotally coupled to the tongue **142** for coupling to the mover. The wheels **141** may also be pivotally coupled to the mobile chassis **140**. Accordingly, when the grain bagging apparatus **100** is being transported or stored, the mobile chassis **140** can pivot approximately 90 degrees. Pivoting of the mobile chassis **140**

approximately 90 degrees allows the grain bagging apparatus **100** to have a narrower profile behind the mover.

In another embodiment, the mobile chassis **140** may have a hydraulic lift system to lift the expandable grain discharge tunnel **130** to a desirable height above the ground.

5 This lift system would assist in loading the grain into the grain bag.

Referring now to **Figure 3**, the rear side (*i.e.*, the side where the grain is being loaded into the grain bag) of the grain bagging apparatus **100** in the second position is shown. In **Figure 3**, the expandable grain discharge tunnel **130** has been moved into the second position by each flanking side moving in an outwardly direction away from the stationary section.

10

However, in an alternate embodiment, the expandable grain discharge tunnel **130** may be moved into the second position by only one flanking side moving in an outwardly direction away from the stationary section. Similarly, only one side of the expandable loading tray **190** would move in an outwardly direction away from the stationary portion. In this alternate embodiment, the other, non-moving flanking side and flanking tray portion would be in a fixed position relative to the stationary section and stationary portion, respectively.

15

The movement of the expandable grain discharge tunnel **130** into the second position (as shown in **Figures 3 and 4**), and the movement of the expandable grain discharge tunnel **130** back to the first position (as shown in **Figures 1 and 2**) is facilitated by a drive means **131**. The drive means **131** is for sliding the first flank and/or the second flank such that the expandable grain discharge tunnel **130** moves into the first position or the second position. The drive means **131** may be any manual or mechanical means of moving the first flank and/or the second flank, such as a hydraulic cylinder, electric motor, or power actuated or manual winch.

20

25

As can be seen, the flanking frames **180** slide from an overlapping position on a top side of the stationary plate **160** (first position), to a position adjacent to, yet still partially overlapping, the sides of the stationary plate **160** (second position). The

flanking shields **170** slide from an overlapping position on a rear side of the stationary shield **150** (first position), to a position adjacent to, yet still partially overlapping, the outward side edges of the stationary shield **150** (second position). For stability, portions of the flanking frames **180** and flanking shields **170** may still overlap the stationary plate **160** and stationary shield **150**, respectively, when in the fully expanded position.

The expandable grain discharge tunnel **130** may also have a lift cradle **310** coupled to the rear side of the expandable grain discharge tunnel **130**. In a preferred embodiment, the lift cradle **310** is coupled to the stationary shield **150**. The lift cradle **310** is used to assist the user in attaching the grain bag onto the expandable grain discharge tunnel **130**. The lift cradle **310** is coupled to a lifting means, such as a power actuated or manual winch, electric motor, hydraulic cylinder, or other suitable means for lifting both the lift cradle **310** and the grain bag.

Referring now to **Figure 4**, the front side (*i.e.*, the side facing away from the grain being loaded into the grain bag) of the grain bagging apparatus **100** in the second position is shown. As can be seen, the flanking shields **170** have moved in an outwardly direction away from the stationary shield **150**. The flanking frames **180** have also moved in an outwardly direction away from the stationary plate **160**.

While Figures 1 to 4 show the expandable grain discharge tunnel **130** as being comprised of distinct frames and shields, the skilled artisan would understand that these parts may be one integral piece. For example, one flanking side (*i.e.*, a flanking shield **170** and a flanking frame **180**) may be integrally formed with the stationary section (*i.e.*, the stationary shield **150** and the stationary plate **160**), to form a single stationary piece. In this embodiment, the other flanking side would be slidably coupled to the single, integral piece on one side. Similarly, one flanking portion of the expandable loading tray **190** may be integrally formed with the stationary portion. In this embodiment, the other flanking portion would be slidably coupled to the single, integral loading tray portion. Additionally, the stationary shield **150** and stationary plate **160** (*i.e.*, the stationary section) may form a single integral piece and

a flanking shield **170** and a flanking frame **180** (*i.e.*, a flanking side) may form a single integral piece. Figures 1 to 4 show flanking frames **180** that have substantially the same width as the stationary plate **160**. However, the flanking frames **180** may be narrower or wider than the stationary plate **160**.

5 Referring now to **Figure 5**, the rear side (*i.e.*, the side where the grain is being loaded into the grain bag) of a grain bagging apparatus **500** in a second position is shown. The grain bagging apparatus **500** comprises an inlet **510**, an outlet **520**, an expandable discharge tunnel and a chassis **540**. The expandable grain discharge tunnel is comprised of a stationary shield **550**, a stationary plate **560**, flanking shields
10 **570**, and a track **590**. The stationary shield **550** is coupled to a stationary framework **551** and the flanking shields **570** are each coupled to a slidable framework **571**.

The slidable frameworks **571** are capable of sliding towards the stationary framework **551** (*i.e.*, inwardly with respect to a center of the expandable grain discharge tunnel) to move the expandable grain discharge tunnel into a first position.
15 Furthermore, the slidable frameworks **571** are capable of sliding away from the stationary framework **551** (*i.e.*, outwardly with respect to a center of the expandable grain discharge tunnel) to move the expandable grain discharge into additional expanded positions. The slidable frameworks **571** may slide away from the stationary framework **551** only a portion of the fully expandable width into a second
20 position, to accommodate a grain bag that is larger than the grain bag that can be used with the first position. However, the slidable frameworks **571** may be slide further away from the stationary framework **551** to a third position, to accommodate a grain bag that is larger than the grain bags that can be used with the grain bagging apparatus **500** in either the first or second position. The width of the expandable
25 grain discharge tunnel may be expanded to any position between the first position and the fully expanded position, to accommodate multiple sizes of grain bags. Accordingly, the expandable grain discharge tunnel may be moved into multiple positions (*i.e.*, third, fourth, fifth, *etc.* positions).

5 In Figure 5, the stationary plate **560** is coupled to the top of the stationary shield **550**. The stationary plate **560** is supported by support bars **561** coupled to the stationary shield **550**. The flanking shields **570** are slidably coupled to the stationary shield **550** on the rear side of the stationary shield **550** by way of the slidable coupling between the slidable frameworks **571** and the stationary framework **551**. The slidable frameworks **571** and the stationary framework **551** are coupled to the front side of the flanking shields **570** and the stationary shield **550**, respectively. The track **590** facilitates the movement of the flanking shields **570** inwardly or outwardly from the stationary shield **550**.

10 The grain bagging apparatus **500** may have flanking frames (not shown) that cover the top and side edges of the flanking shields **570**, to facilitate the fitting and securing of the grain bag around the outer perimeter of the expandable grain discharge tunnel.

15 The grain bagging apparatus **500** may also have vent holes **572** in each of the flanking shields **570**. When the expandable grain discharge tunnel is in the first position, the vent holes **572** align with stationary vent holes **552** on the stationary shield **550**. Accordingly, the back shield in the grain bagging apparatus **500** may appear to have only two (2) vent holes **572** when in the first position, and would have two (2) vent holes **572** and two (2) stationary vent holes **552** when in the fully expanded position. In Figure 5, the width of the right flank has been temporarily expanded further outward from the stationary section than the left flank; accordingly, both the vent hole **572** and stationary vent hole **552** are visible on the right flank. However, the vent hole **572** and stationary vent hole **552** on the left flank are aligned with each other to show only one (1) hole. The vent holes **572** and the stationary vent holes **552** are preferably covered with a screen to prevent a loss of grain, while allowing air to escape.

25 The grain bagging apparatus **500** may also have a viewing hole **573** in at least one of the flanking shields **570** and the stationary shield **550** to allow the driver to see behind the grain bagging apparatus **500** during transport. The viewing holes **573** may

be aligned when the grain bagging apparatus **500** is in the first position. The viewing holes **573** may have a replaceable panel to cover the viewing holes **573** while bagging grain. Alternatively, the viewing holes **573** may be covered with a durable, transparent material, such as glass or an acrylic sheet.

5 Referring now to **Figure 6**, the rear side (*i.e.*, the side where the grain is being loaded into the grain bag) of the grain bagging apparatus **500** in a third position is shown. As can be seen, the flanking shields **570** have been moved in an outwardly direction away from the stationary shield **550** through the slit or gap **562**.

10 Referring now to **Figure 7**, the front side (*i.e.*, the side facing away from the grain being loaded into the grain bag) of a grain bagging apparatus **700** in a second position is shown. As can be seen, one end of a first drive means **731A** is coupled to a first slidable framework **771A**. The first slidable framework **771A** is coupled to a first flanking shield. The other end of the first drive means **731A** is coupled to the stationary framework **751**. The stationary framework **751** is coupled to a stationary shield **750**. The first drive means **731A**, when actuated, powers the first slidable framework **771A** to slide outwardly or inwardly with respect to the stationary framework **751**. Accordingly, the first flanking shield slides inwardly or outwardly with respect to the stationary shield **750** with the result that the width of the expandable grain discharge tunnel is contracted or expanded to the first position or
15
20 the second position, respectively.

Similarly, one end of a second drive means **731B** is coupled to a second slidable framework **771B**. The second slidable framework **771B** is coupled to a second flanking shield. The other end of the second drive means **731B** is coupled to the stationary framework **751** on an opposing side to the first drive means **731A**. The
25 second drive means **731B**, when actuated, powers the second slidable framework **771B** to either slide outwardly from the stationary framework **751** in a direction away from the first slidable framework **771B** (second position), or inwardly towards the stationary framework **751** (first position). Accordingly, the second flanking

shield slides outwardly from the stationary shield **750** in a direction away from the first flanking shield or inwardly towards the stationary shield **750**.

5 Referring now to **Figure 8**, the front side of a grain bagging apparatus **800** in a second position is shown. The grain bagging apparatus **800** is comprised of an inlet **810**, an outlet **820**, an expandable grain discharge tunnel (collectively, a stationary shield **850**, a stationary framework **851**, a stationary plate **860**, a flanking shield **870**, a slidable framework **871** and a flanking frame **880**), and a chassis **840**. The stationary shield **850** is coupled to a stationary framework **851** and the flanking shield **870** is coupled to a slidable framework **871**. One end of the drive means **831** is coupled to the stationary framework **851** and the other end of the drive means **831** is coupled to the slidable framework **871**. The drive means **831**, when actuated, powers the slidable framework **871** to slide outwardly or inwardly with respect to the stationary framework **851**. Accordingly, the flanking shield **870** slides inwardly or outwardly with respect to the stationary shield **850** and the width of the expandable grain discharge tunnel is thereby contracted or expanded to the first position or the second position, respectively.

10 In a preferred embodiment, the width of the expandable grain discharge tunnel in the first position is such that the expandable grain discharge tunnel is capable of receiving a 10-foot grain bag. In another preferred embodiment, the width of the expandable grain discharge tunnel in the second position is such that the expandable grain discharge tunnel is capable of receiving a 12-foot grain bag.

20 To load the grain bag onto the expandable grain discharge tunnel, the grain bag must be lifted onto the top of the stationary plate **160**, **560**, or **860** and the top of the flanking frames **180**, **580**, or **880**. This can be done with a loader or with other external lifting means. Alternatively, the grain bag may be placed on the lift cradle **310** and a lifting means can lift the lift cradle **310** and the grain bag upwards towards the top of the flanking frames **180**, **580**, or **880** and the top of the stationary plate **160**, **560**, or **860**. The lifting means is coupled to the lift cradle **310** and to the

stationary section. The lifting means may be an electric or manual winch or an electric or hydraulic cylinder.

5 The lift cradle **310** may be pivotally coupled to the stationary shield **150, 550, 750, or 850** such that the lifting means pivots the lifting cradle **310** into a position above and behind the stationary plate **160, 560, or 860** to facilitate the transfer of the grain bag to the grain discharge tunnel. The lift cradle **310** may also become the top portion of the outer perimeter of the expandable grain discharge tunnel (*i.e.*, the top of the grain bag is positioned around the lift cradle **310**).

10 Alternatively, the lifting means lifts the lift cradle **310** to a position that is aligned or essentially aligned with the top of the flanking frames **180, 580, or 880** and stationary plate **160, 560, or 860**. Afterwards, to load the grain bag onto the expandable grain discharge tunnel, the user would then manually slide the grain bag off of the lift cradle **310** and onto the top of the flanking frames **180, 580, or 880** and the top of the stationary plate **160, 560, or 860**. The remainder of the grain bag is then positioned around the flanking frames **180, 580, or 880**.

20 When the grain bag is loaded onto the expandable grain discharge tunnel, the bottom of the grain bag may be rested against the top of the expandable load tray **190**. The bottom of the grain bag may then be positioned inside the expandable loading tray **190**. The lifting means of the expandable loading tray **190** may be coupled to the expandable loading tray **190** and the stationary section. The lifting means lifts the expandable loading tray **190** to secure the grain bag around the outer perimeter of the expandable grain discharge tunnel by squeezing the grain bag between the top of the expandable loading tray **190** and a bottom edge of the expandable grain discharge tunnel.

25 Alternatively, the grain bag may be positioned around the outer perimeter of the expandable grain discharge tunnel in a first position. Once the grain bag has been secured on the expandable grain discharge tunnel, the drive means **131, 731A, 731B, or 831** can then be activated to expand the width of the expandable grain discharge tunnel into the second position. This allows the width of the expandable grain

discharge tunnel to expand into the inner circumference of the grain bag and thus the grain bag is secured around the outer perimeter of the expandable grain discharge tunnel.

5 Once the grain bag has been positioned on the expandable grain discharge tunnel, the grain bag is then secured to the expandable grain discharge tunnel using suitable securing means, such as tie cables or bungee cords. Once the bag is secured to the grain bagging apparatus, the end of the bag can be sealed to prevent grain from leaking out of the end of the grain bag and to avoid moisture from entering the grain bag. Expanding the width of the expandable grain discharge tunnel after the grain
10 bag is in position also allows for easier positioning of the grain bag.

A person understanding this invention may now conceive of alternative structures and embodiments or variations of the above all of which are intended to fall within the scope of the invention as defined in the claims that follow.

What is claimed is:

1. An expandable grain discharge tunnel for a grain bagging apparatus, the expandable grain discharge tunnel comprising:

a stationary section;

a first flank slidably coupled to the stationary section; and

a first drive means having a first end and a second end, the first end of the first drive means being coupled to the first flank and the second end of the drive means being coupled to the stationary section;

wherein the first drive means slidably transitions the expandable grain discharge tunnel from a first position to a second position by sliding the first flank in an outward direction away from the stationary section along a rectilinear path and the first drive means slidably transitions the expandable grain discharge tunnel from the second position to the first position by sliding the first flank in an inward direction towards the stationary section along the rectilinear path; and wherein the expandable grain discharge tunnel has a wider width in the second position than in the first position, such that differently sized grain bags are mountable with the grain discharge tunnel when the grain discharge tunnel is in different positions.

2. The expandable grain discharge tunnel according to claim 1, wherein the stationary section further comprises a stationary shield and a stationary plate, and the stationary plate is coupled to a top of the stationary shield.

3. The expandable grain discharge tunnel according to claim 1, wherein the first flank further comprises a first shield and a first frame, and the first frame is coupled to a top of the first shield.

4. The expandable grain discharge tunnel according to claim 1, wherein the expandable grain discharge tunnel further comprises a second flank and a second drive means, wherein the second flank is slidably coupled to the stationary section on an opposing side of the stationary section to the first flank and the second drive means is coupled at a first end to the second flank and the second drive means is coupled at a second end to the stationary section at an opposing side of the stationary section to the first drive means.

5. The expandable grain discharge tunnel according to claim 1, wherein the stationary section further comprises a stationary framework coupled to a front side of the stationary section and the first flank further comprises a first slidable framework coupled to a first front side of the first flank, wherein the first flank and the stationary section are slidably coupled to each other by way of the first slidable framework being slidably coupled to the stationary framework.

6. The expandable grain discharge tunnel according to claim 5, wherein the first end of the first drive means is coupled to the first slidable framework and the second end of the first drive means is coupled to the stationary framework.

7. The expandable grain discharge tunnel according to claim 4, wherein the stationary section further comprises a stationary framework coupled to a front side of the stationary section, the first flank further comprising a first slidable framework coupled to a first front side of the first flank and the second flank further comprising a second slidable framework coupled to a second front side of the second flank, and wherein the first flank and the stationary section are slidably coupled to each other by way of the first slidable framework being slidably coupled to the stationary framework, and wherein the second flank and the stationary section are slidably coupled to each other on an opposing side to the first drive means by way of the second slidable framework which is slidably coupled to the stationary framework.

8. The expandable grain discharge tunnel according to claim 7, wherein the first end of the second drive means is coupled to the second slidable framework and the second end of the second drive means is coupled to the stationary framework.

9. The expandable grain discharge tunnel according to claim 1, wherein when the expandable grain discharge tunnel is in the first position, the expandable grain discharge tunnel has a width to accommodate a ten-foot grain bag.

10. The expandable grain discharge tunnel according to claim 1, wherein when the expandable grain discharge tunnel is in the second position, the expandable grain discharge tunnel has a width to accommodate a twelve-foot grain bag.

11. The expandable grain discharge tunnel according to claim 1, wherein the first drive means is a hydraulic cylinder.

12. The expandable grain discharge tunnel according to claim 4, wherein the second drive means is a hydraulic cylinder.

13. The expandable grain discharge tunnel according to claim 1, further comprising an expandable loading tray comprising a first portion and a stationary portion, wherein the first portion is coupled to a bottom edge of the first flank and the stationary portion is coupled to a bottom side of the stationary section, and wherein the first portion is slidably coupled to the stationary portion.

14. The expandable grain discharge tunnel according to claim 4, further comprising an expandable loading tray with a first portion, a second portion, and a stationary portion, wherein the first portion is coupled to a bottom edge of the first flank, the second portion is coupled to a second bottom edge of the second flank, and the stationary portion is coupled to a bottom side of the stationary section, and wherein the first portion is slidably coupled to the stationary portion and the second portion is slidably coupled to the stationary portion on an opposite side of the expandable loading tray to the first portion.

15. The expandable grain discharge tunnel according to claim 1, wherein the expandable grain discharge tunnel is slidably adjustable to accommodate a plurality of sizes of grain bags, such that the second position of the expandable grain discharge tunnel is a partially expanded position and the first flank is slidably movable by the first drive means in an outward direction away from the stationary section along the rectilinear path to thereby transition the expandable discharge tunnel from the second position to at least one additional position.

16. The expandable grain discharge tunnel according to claim 4, wherein the expandable grain discharge tunnel is slidably adjustable to accommodate a plurality of sizes of grain bags, such that the second position of the expandable grain discharge tunnel is a partially expanded position and the expandable discharge tunnel is slidably transitioned from the second position to at least one additional position by the first drive means slidably moving the first flank in a first outward direction away from the stationary section along the rectilinear path and by the second drive means slidably moving the second flank in a second outward direction away from the stationary section along the rectilinear path, wherein the first outward direction is opposite the second outward direction.

17. A grain bagging apparatus for loading grain into a grain bag for storage, the grain bagging apparatus comprising an expandable grain discharge tunnel having:

a stationary section;

a first flank slidably coupled to the stationary section; and

a first drive means having a first end and a second end, the first end of the first drive means being coupled to the first flank and the second end of the drive means being coupled to the stationary section;

wherein the first drive means slidably transitions the expandable grain discharge tunnel from a first position to a second position by sliding the first flank in an outward direction away from the stationary section along a rectilinear path and the first drive means slidably transitions the expandable grain discharge tunnel from the second position to the first position by sliding the first flank in an inward direction towards the stationary section along the rectilinear path; and wherein the expandable grain discharge tunnel has a wider width in the second position than in the first position such that differently sized grain bags are mountable on the grain discharge tunnel.

18. The grain bagging apparatus according to claim 17, wherein the expandable grain discharge tunnel further comprises a second flank and a second drive means, wherein the second flank is slidably coupled to the stationary section on an opposing side of the stationary section to the first flank and the second drive means is coupled at one end to the second flank and the second drive

means is coupled at another end to the opposing side of the stationary section to the first drive means.

19. The grain bagging apparatus according to claim 17, wherein the first drive means is a hydraulic cylinder.

20. The grain bagging apparatus according to claim 18, wherein the first drive means is a hydraulic cylinder.

21. A method of loading a grain bag on a grain bagging apparatus having an expandable grain discharge tunnel, the method comprising the steps of:

providing the grain bagging apparatus, the grain bagging apparatus having the expandable grain discharge tunnel, the expandable grain discharge tunnel having a stationary section and at least one flank and the expandable grain discharge tunnel being configured to have a first position and a second position and the expandable grain discharge tunnel being configured to slidably transition from the first position to the second position by sliding the at least one flank in an outward direction away from the stationary section along a rectilinear path, the grain discharge tunnel having a larger width in the second position than in the first position;

securing the grain bag on the expandable grain discharge tunnel while the tunnel is in the first position; and

slidably transitioning the expandable grain discharge tunnel from the first position to the second position along the rectilinear path to thereby secure the grain bag around an outer perimeter of the expandable grain discharge tunnel.

22. The method according to claim 21, wherein the expandable grain discharge tunnel is slidably transitioned from the first position to the second position using a hydraulic cylinder.

23. The expandable grain discharge tunnel according to claim 1, wherein the stationary section is coupled to a rectilinear track and the first flank is slidably coupled to the rectilinear track, such that the first flank slides along the rectilinear track when the expandable grain discharge tunnel

slidably transitions between the first position and the second position, and such that the first flank overlaps the stationary section when the expandable grain discharge tunnel is in the first position.

24. The grain bagging apparatus according to claim 17, wherein the stationary section is coupled to a rectilinear track and the first flank is slidably coupled to the rectilinear track, such that the first flank slides along the rectilinear track when the expandable grain discharge tunnel slidably transitions between the first position and the second position, and such that the first flank overlaps the stationary section when the expandable grain discharge tunnel is in the first position.

25. The method according to claim 21, wherein the stationary section is coupled to a rectilinear track and the at least one flank is slidably coupled to the rectilinear track, such that the at least one flank slides along the rectilinear track when the expandable grain discharge tunnel slidably transitions between the first position and the second position, and such that the at least one flank overlaps the stationary section when the expandable grain discharge tunnel is in the first position.

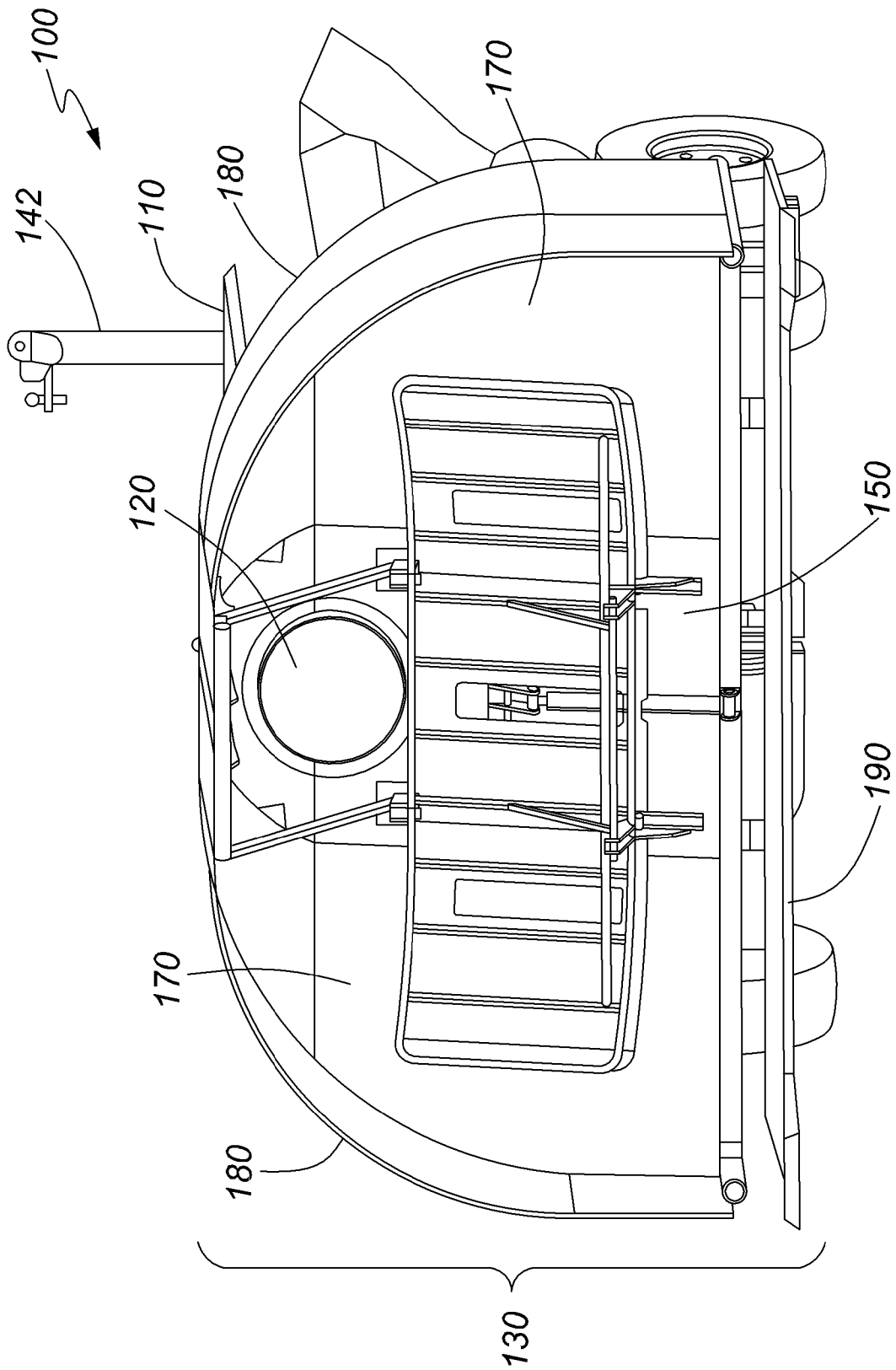

FIG. 1

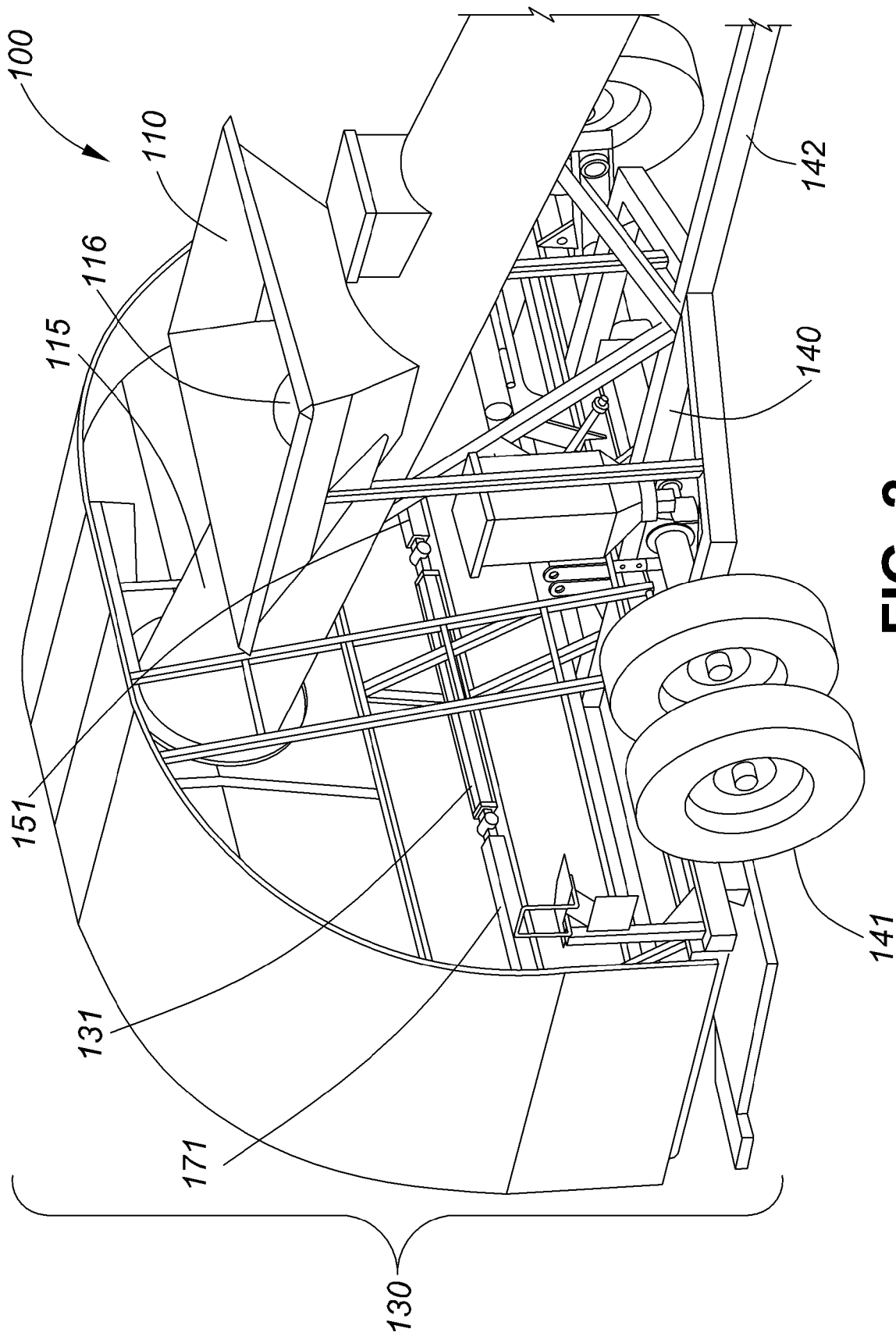

FIG. 2

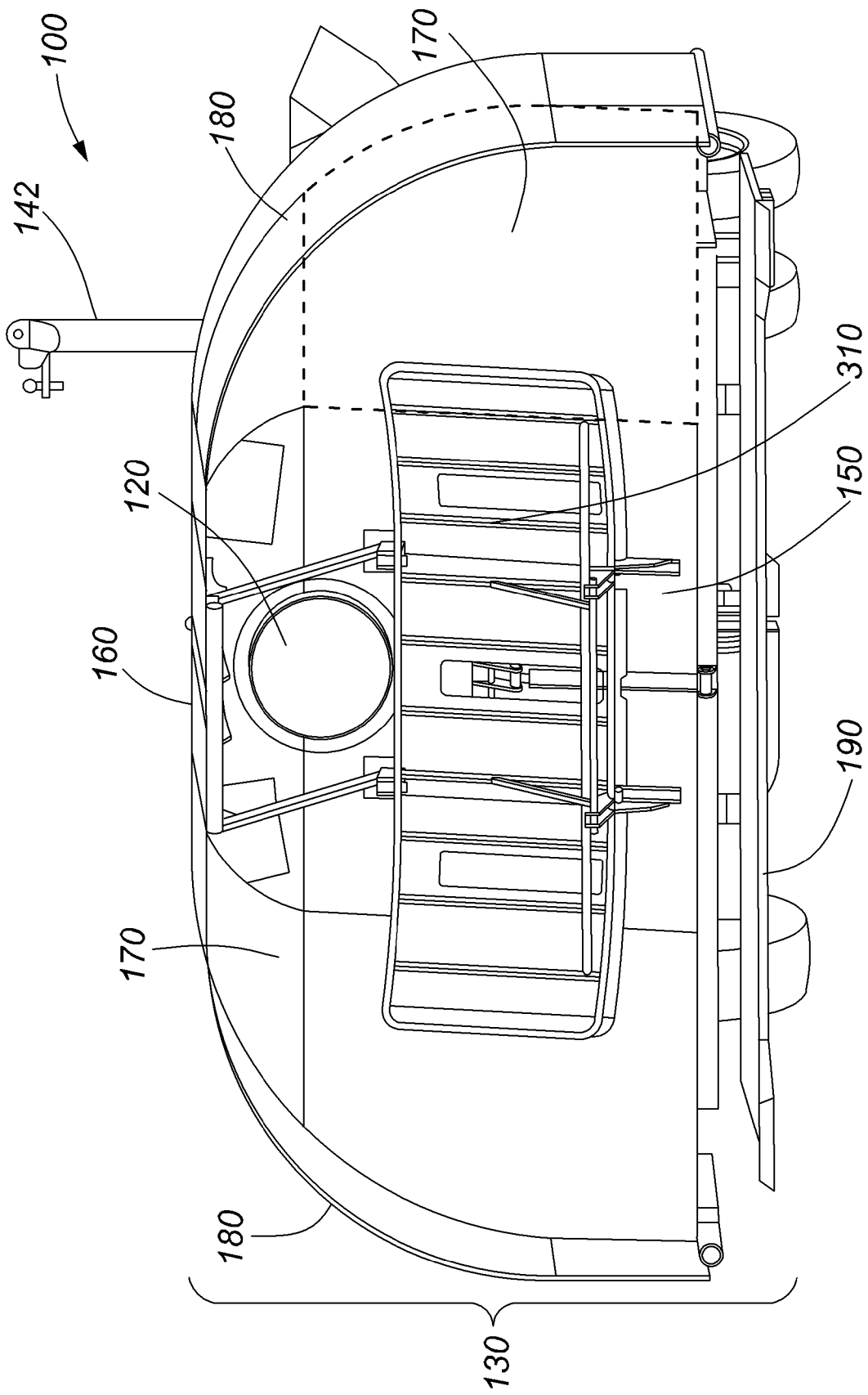

FIG. 3

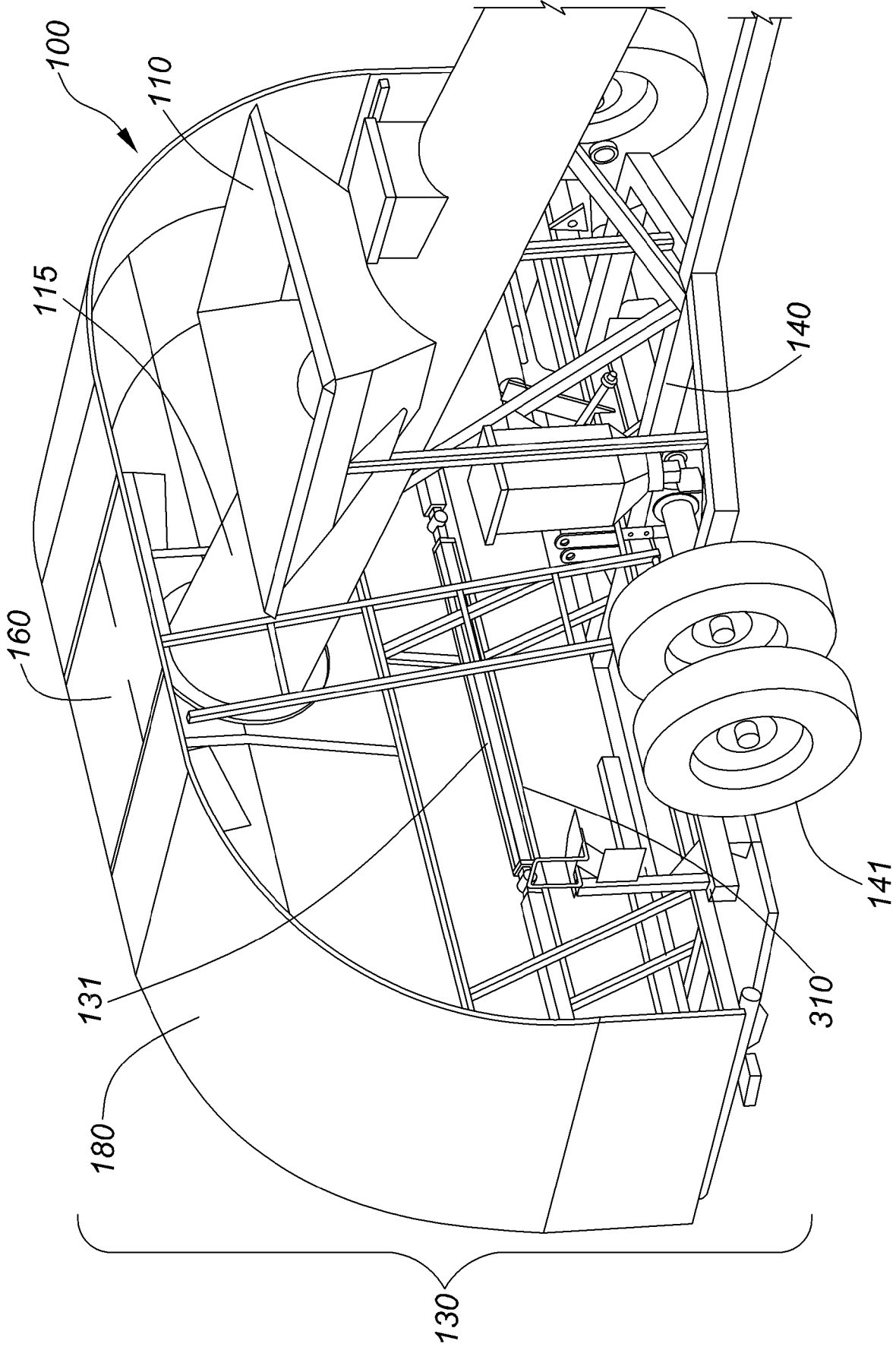

FIG. 4

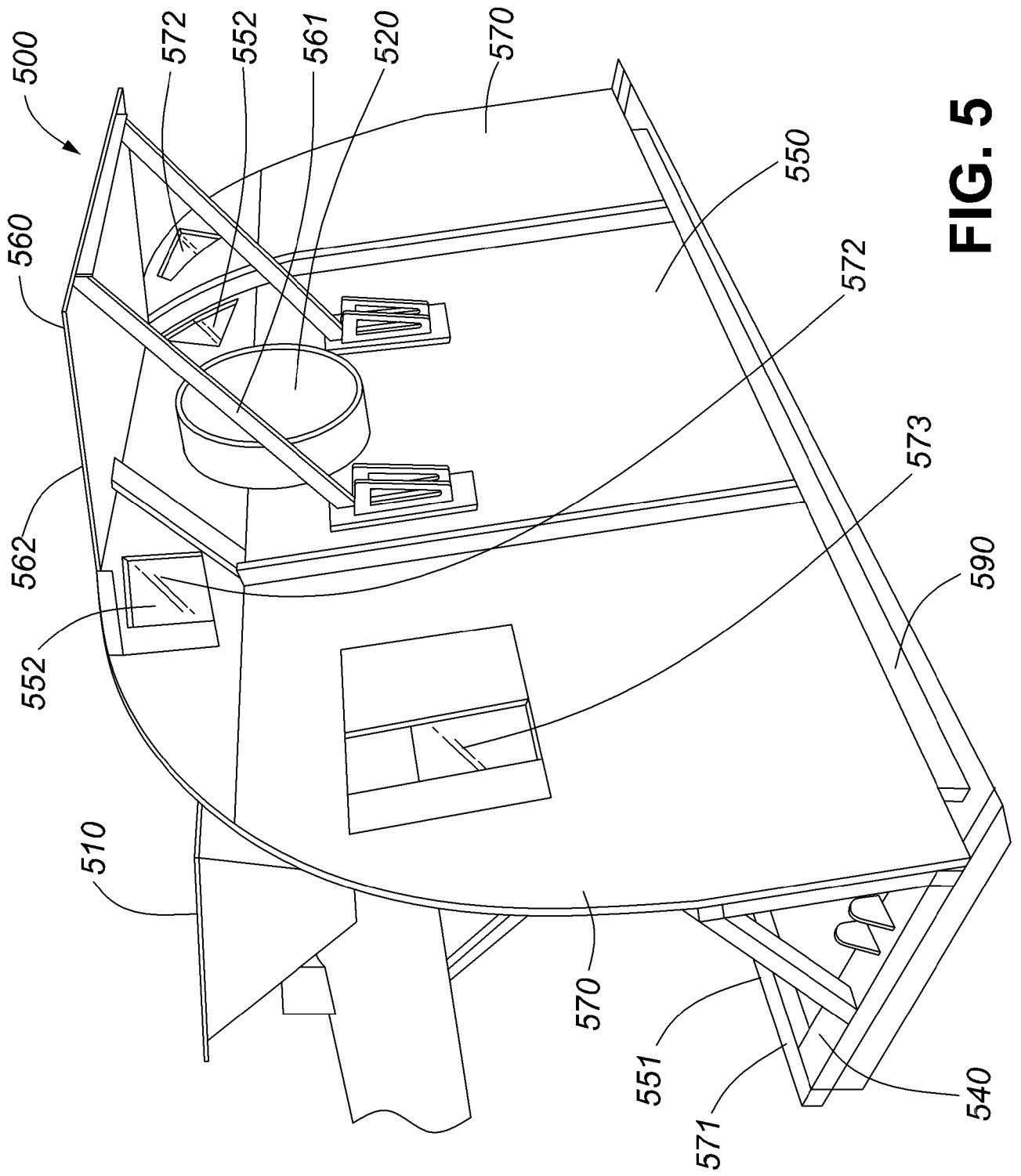

FIG. 5

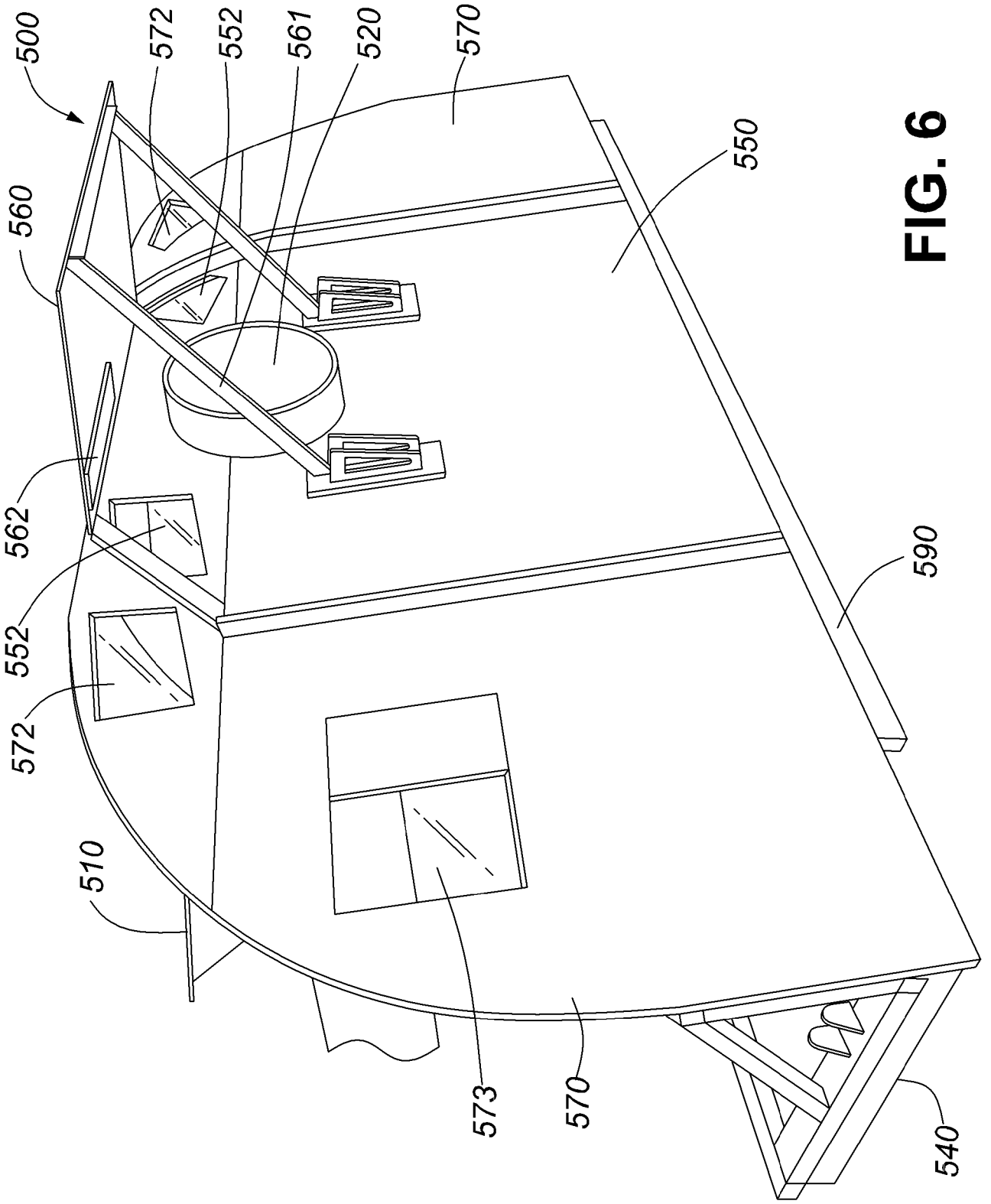

FIG. 6

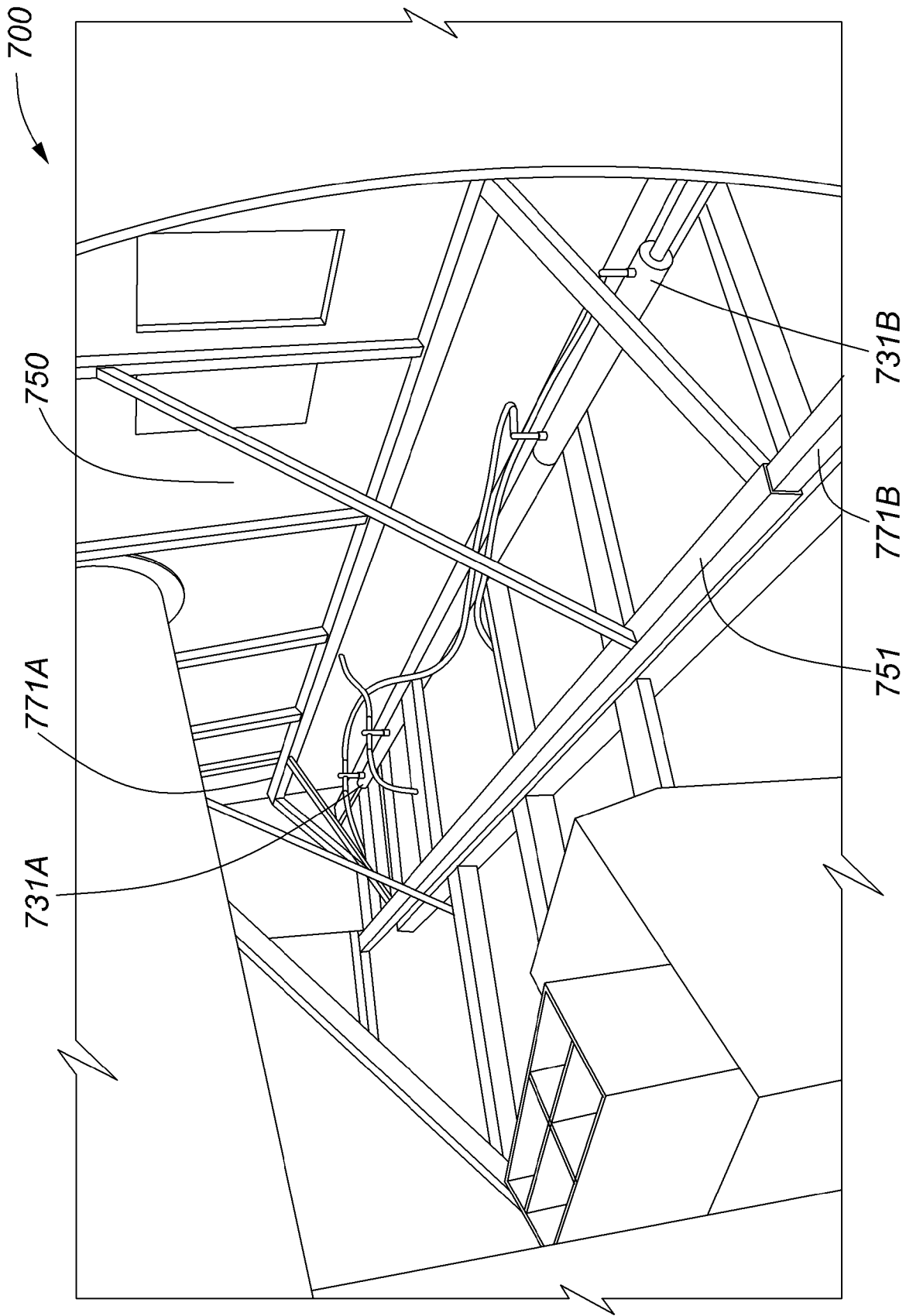

FIG. 7

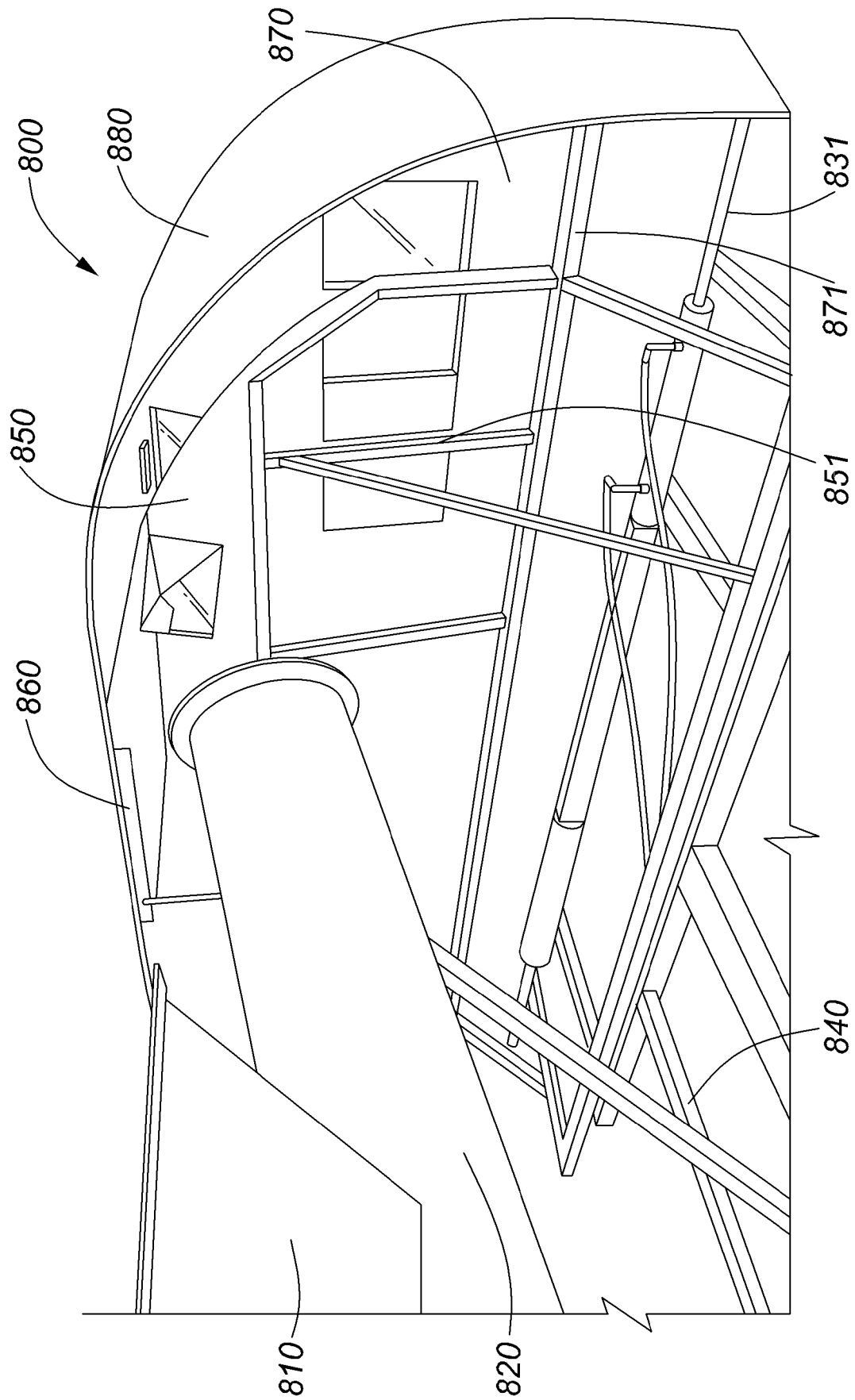

FIG. 8

