



US 20110167683A1

(19) **United States**

(12) **Patent Application Publication**  
**PAN**

(10) **Pub. No.: US 2011/0167683 A1**

(43) **Pub. Date: Jul. 14, 2011**

(54) **STEAM SUPPLY MECHANISM FOR BOILER IRON AND BOILER IRON**

(30) **Foreign Application Priority Data**

Jun. 13, 2008 (CN) ..... 200820102666.8

(75) Inventor: **Chienchih PAN, Taiwan (CN)**

**Publication Classification**

(73) Assignee: **TSANN KUEN(CHINA) ENTERPRISE CO., LTD, Fujian (CN)**

(51) **Int. Cl.**  
**D06F 75/00** (2006.01)

(52) **U.S. Cl.** ..... **38/75**

(57) **ABSTRACT**

(21) Appl. No.: **12/997,797**

An air-feed device and boiler iron has a three-station guiding valve. The body contains an air inlet linking boiler and two air outlets located in two sides of a guiding valve. The first outlet links wet vapor snoot of iron and the second links heating plate of boiler. One end of a valve rod of the guiding valve is in the valve body and links to a fixed valve plug. The other end is led outside through an opening in the top of body. When the valve rod rests at any one of the stations, the valve plug blocks a desired combination of air outlets and/or inlets.

(22) PCT Filed: **Jun. 11, 2009**

(86) PCT No.: **PCT/CN09/72233**

§ 371 (c)(1),  
(2), (4) Date: **Mar. 30, 2011**

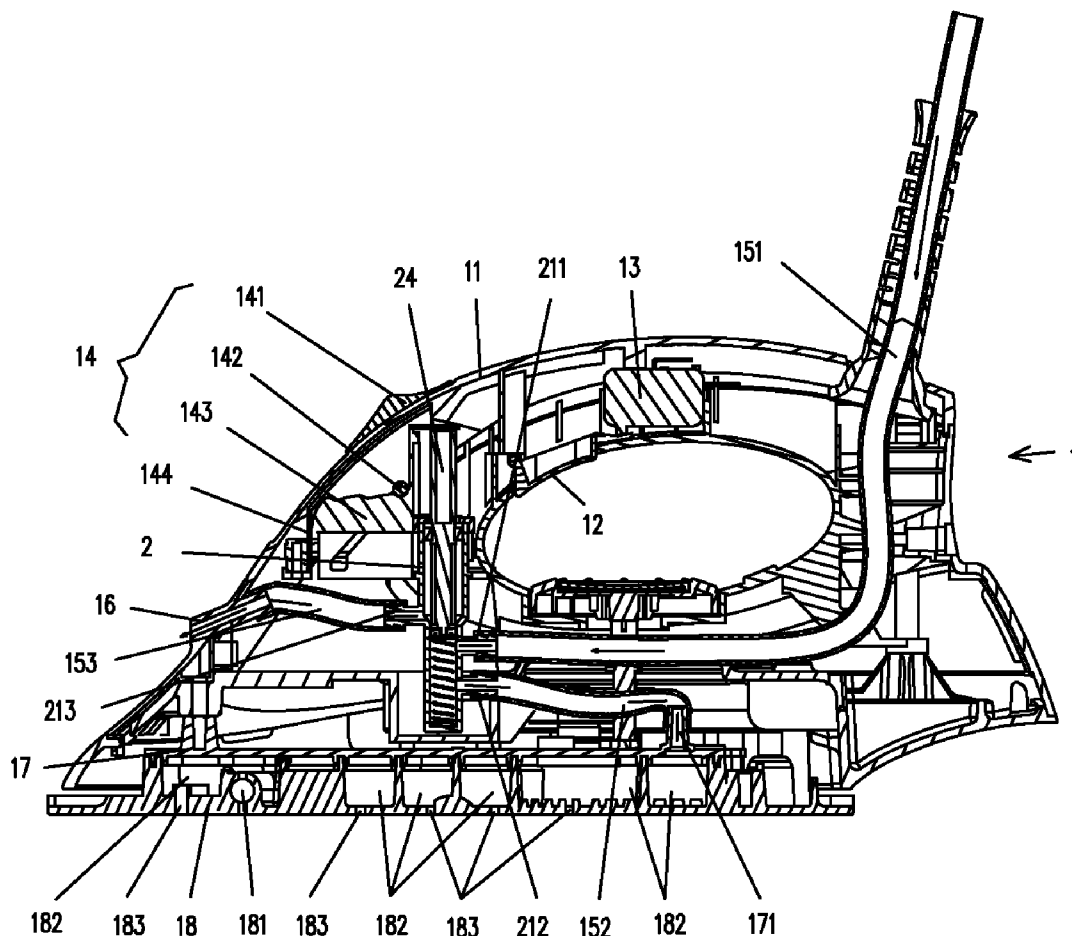

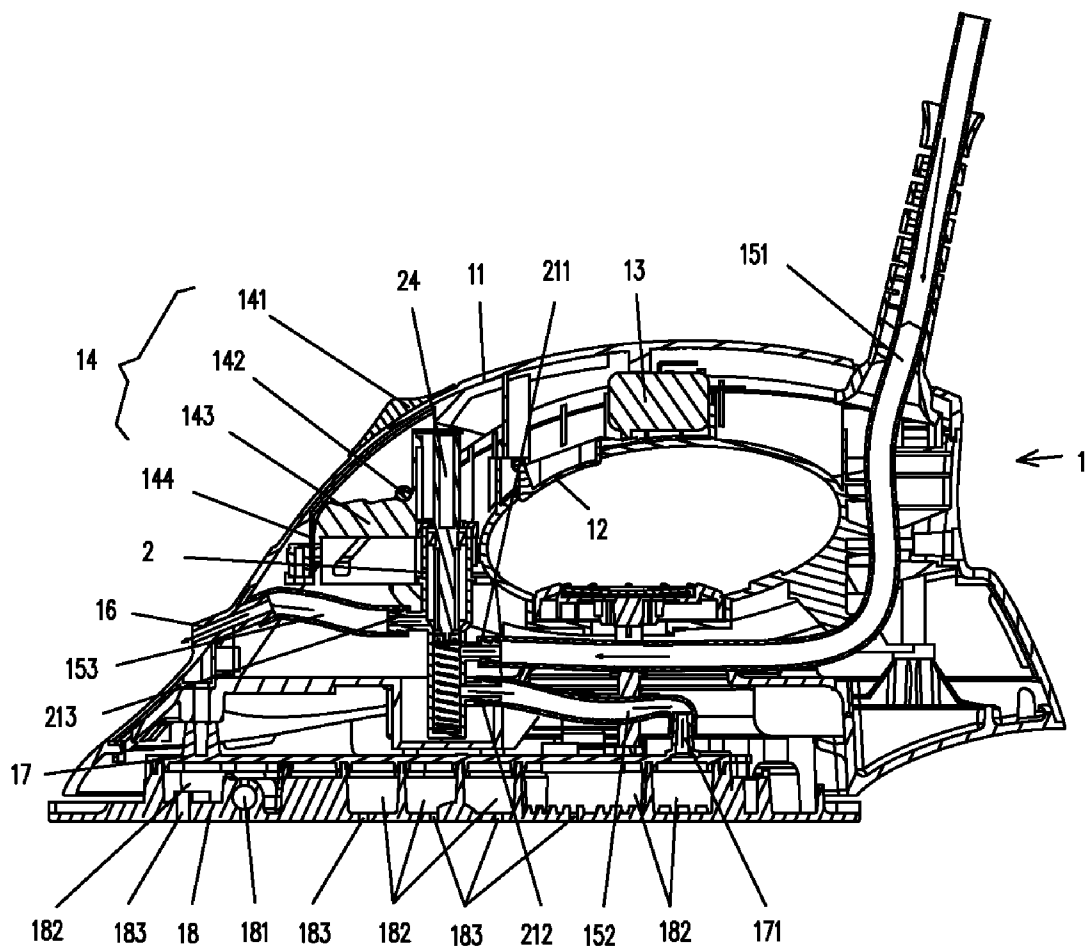

FIG.1

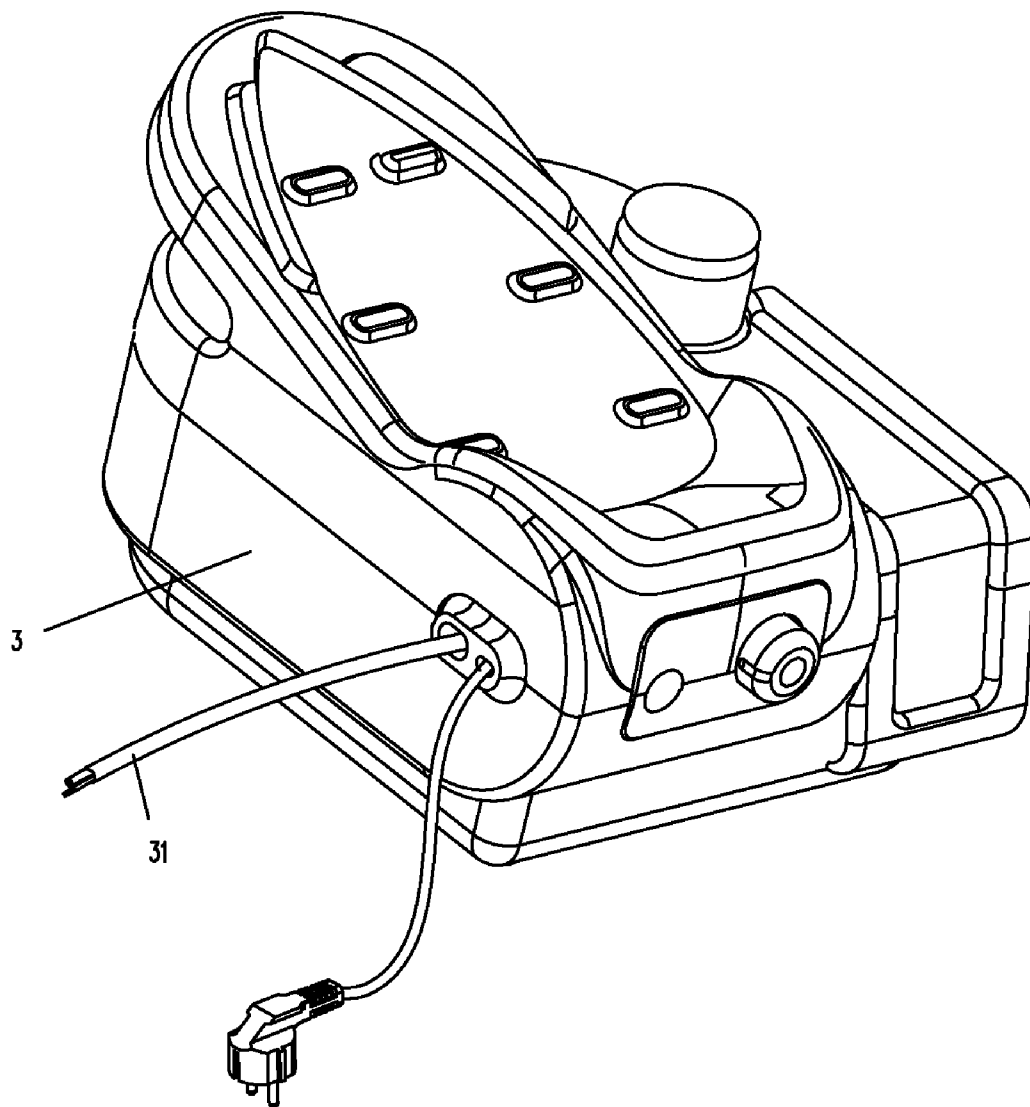

FIG.2

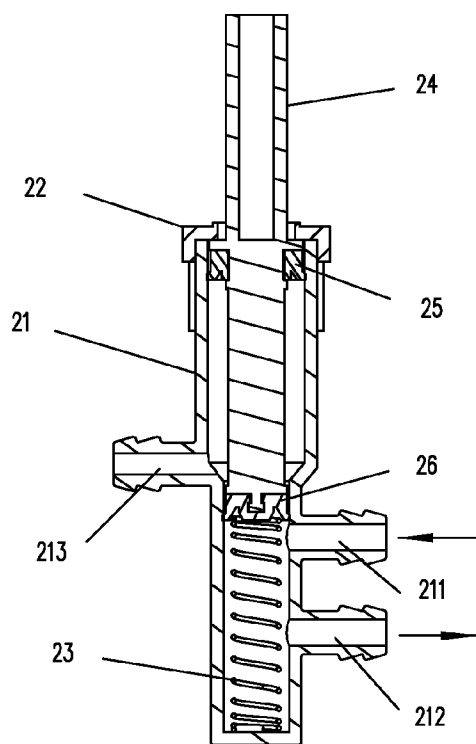

FIG. 3

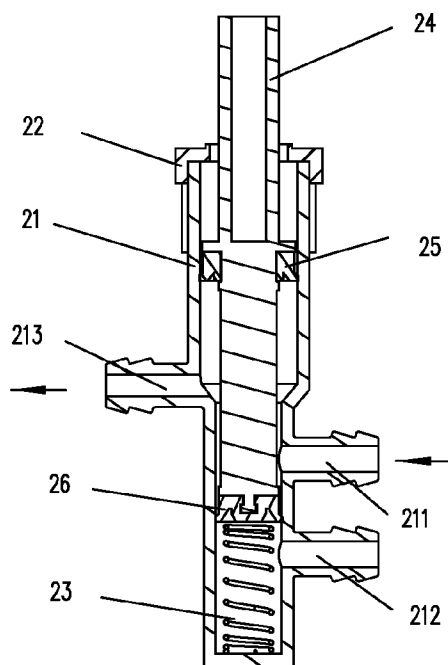

FIG. 4

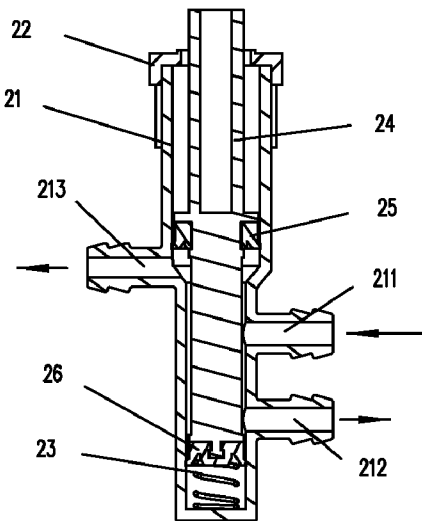

FIG. 5

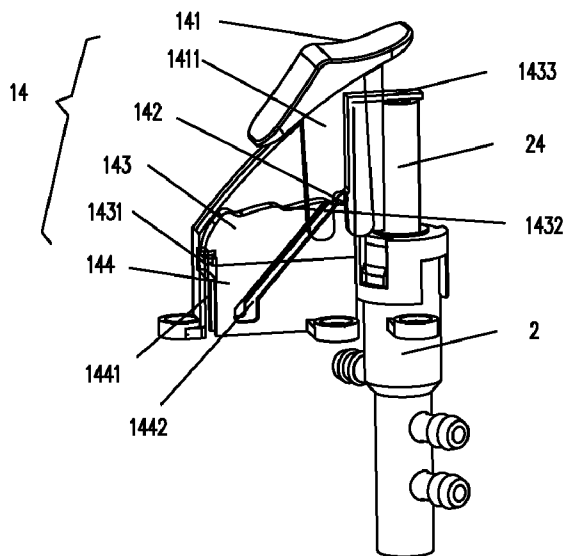

FIG. 6

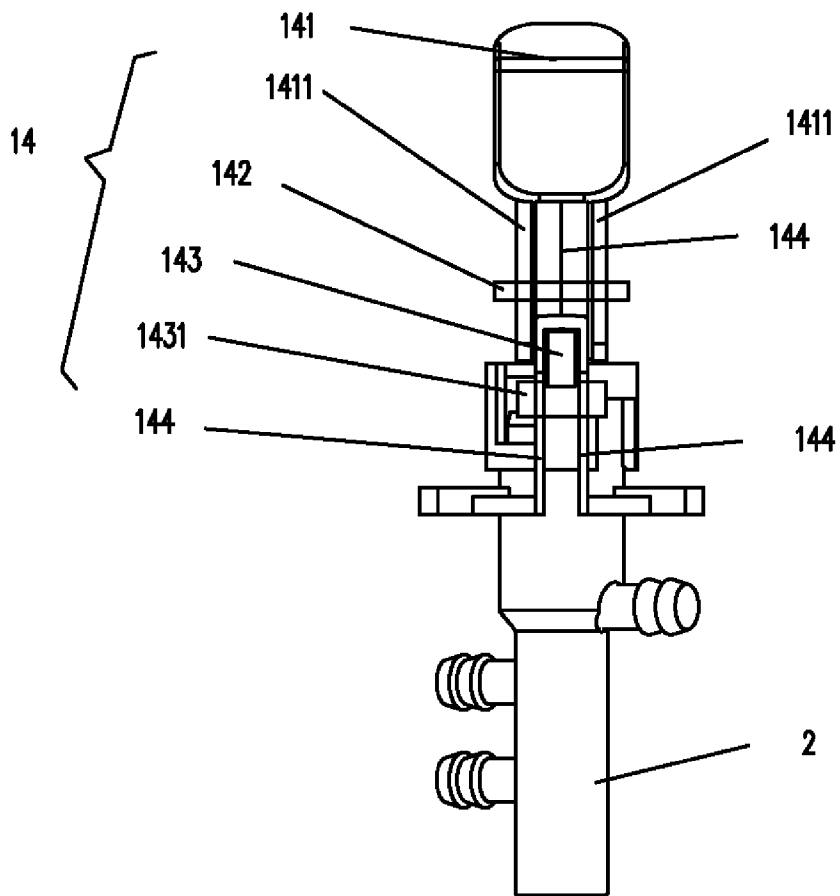

FIG.7

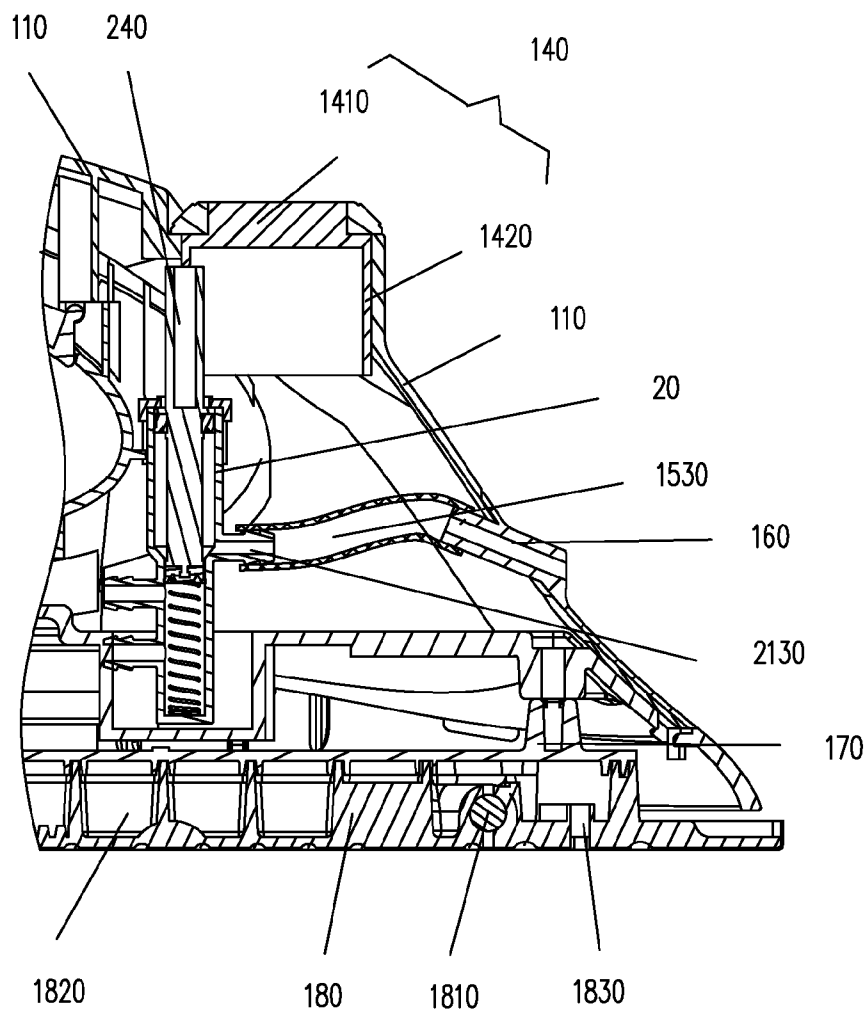

FIG. 8

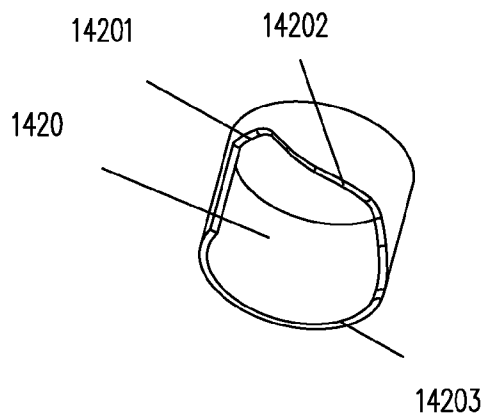

FIG. 9

## STEAM SUPPLY MECHANISM FOR BOILER IRON AND BOILER IRON

### FIELD OF THE INVENTION

**[0001]** The present invention relates to an accessory of iron, more particularly, an accessory, which is devised in boiler iron between the air outlet of boiler and the air outlet of iron, it can choose different ways of air feed; and the invention relates to boiler iron with this accessory.

### BACKGROUND OF THE INVENTION

**[0002]** Presently, boiler iron is provided wet vapor as air by boiler parts, wet vapor heated by heating plate forms dry vapor before it ejects to fabric, and boiler iron works. But, vapor is inapplicable to iron some fiber fabric because of high temperature, thus wet vapor provided by boiler should ejects directly to fabric, then boiler iron works. To choose between two ways of air-feed is impossible, because in boiler iron the air outlet of iron links the air outlet of boiler through hose directly.

### SUMMARY OF THE INVENTION

**[0003]** The primary object of the present invention is to provide an air-feed device of boiler iron, the device provides wet vapor directly or dry vapor which forms from wet vapor heated by heating board to fabric.

**[0004]** The another object of the present invention is a kind of boiler iron which works by means of choosing wet vapor and dry vapor effectively.

**[0005]** The technical proposal of the present invention: a air-feed device of boiler iron, it has a three-station guiding valve whose body contains an air inlet linking boiler and two air outlets located in two sides of guiding valve, the first air outlet links wet vapor snoot of iron and the second links heating plate of boiler; one end of valve rod of guiding valve is in valve body and links with a fixed valve plug, another end which is located relatively to the first end is led outside through an opening in the top of body; when valve rod lies the first station, the valve plug blocks between the first air outlet and the second air outlet, the second air outlet links the air inlet through inner air of valve body; when valve rod lies the second station, the valve plug blocks between the second air outlet and the air inlet, the first air outlet links the air inlet through inner air of body; when valve rod lies the third station, the valve plug blocks during the first air outlet, the second air outlet and the air inlet, the first air outlet, the second air outlet and the air inlet links each other through inner air of body.

**[0006]** A restoring spring used to push valve plug is located between the valve plug and the bottom of body in valve body.

**[0007]** The second end of valve rod is led outside through an opening in top of body of valve.

**[0008]** Valve rod is set a gland ring which seals the interval between valve rod and valve body.

**[0009]** Entocoele of valve body appears stepped foramen caecum states. The first end of valve rod and valve plug are located in small end all along; a salient shoulder with comparable size to inside diameters of big end is located in big end of body all along, and gland ring covers valve rod and presses against the inner circular face of salient shoulder.

**[0010]** A boiler iron comprises an iron, a vapor boiler and three stations guiding valve, valve body of guiding valve contains an air inlet linking boiler and two air outlet located in

two sides of guiding valve, the first air outlet links wet vapor snoot of iron and the second links heating plate of boiler; one end of the valve rod of guiding valve is in valve body and links with a fixed valve plug, another end which is located relatively to the first end is led outside through an opening in the top of body of valve; when valve rod lies the first station, the valve plug blocks between the first air outlet and the second air outlet, the second air outlet links the air inlet through inner air of body; when valve rod lies the second station, the valve plug blocks between the second air outlet and the air inlet, the first air outlet links the air inlet through inner air of body; when valve rod lies the third station, the valve plug blocks during the first air outlet, the second air outlet and the air inlet, the first air outlet, the second air outlet links the air inlet through inner air of body.

**[0011]** In preferred embodiment, guiding valve mentioned above is set in iron, and shift component which controls three stations to mutually shift and locate; the shift component presses against valve rod of guiding valve. It is easy to operator to use shift component of iron directly and adjust usage mode of boiler iron rapidly.

**[0012]** In an preferred embodiment structure, to fit operator who is fond of pushing to operation: shift component comprises horizontal axis which aslant moves when button is pressed and locating block of stalls which links valve rod of guiding valve, the locating block has wavy surface to sliding contact with the horizontal axis, three troughs correspond to three stalls in the wavy surface.

**[0013]** Or in another preferred embodiment structure, to fit operators who like rotating to operate: shift component has rotating locating bowl of stalls, there is a opening in side wall of locating bowl, surface of breach presses against valve rod of guiding valve and has two parallel lines at least, and rim linking locating block of stalls constitutes positioning surface corresponding to three stalls.

**[0014]** The present invention, air-feed device of boiler iron mentioned above drives the valve plug within valve body to stay in one of three-station through valve rod of guiding valve, supplies wet vapor by vapor boiler through air inlet of guiding valve and heats it by heating board to form dry vapor; or it ejects wet vapor provided by vapor boiler outwards directly from snoot of iron through the first air outlet of guiding valve; or it ejects wet vapor provided by vapor boiler outwards through the first gas outlet and snoot of iron, at the same time the wet vapor passes through the second air outlet and gets the heating plate of iron, then wet vapor forms dry vapor by heating plate before it ejects to fabric; thereby works in three way of air feed. The guiding valve has simple structure and is operated conveniently. To coordinate guiding valve to set up location and release of three stations, valve body adopts structure that restoring spring pushes valve plug in it. Valve rod has gland ring, which seals interval between valve rod and inner wall of body of valve, forbids wet vapor from air inlet to body of valve letting out through interval between valve deck and valve rod and improves safety of guiding valve. To maintain gland ring in optimal status when it is pushed by salient shoulder in big end of body, body of valve adopting stepped foramen caecum structure coordinates with valve rod with salient shoulder. The present invention, boiler iron with air feed device mentioned above, drives the valve plug within valve body to stay in one of three-station through valve rod of guiding valve, supplies wet vapor by vapor boiler through air inlet of guiding valve and heats wet vapor by heating plate to form dry vapor before it ejects outside; or it ejects wet vapor



provided by vapor boiler outwards directly from snoot of iron through the first gas outlet of guiding valve; or it ejects wet vapor provided by vapor boiler outwards through the first gas outlet and snoot of iron, at the same time the wet vapor passes through the second air outlet and gets the heating plate of iron, then wet vapor forms dry vapor by heated before it ejects to fabric; thereby works in three way of air feed. The present invention can cater all kind demand of fabric iron, it has simple structure and is operated conveniently, and is popularized to apply easily.

[0015] FIG. 1 is a profile view of preferred embodiment of present invention.

[0016] FIG. 2 is a view of boiler of preferred embodiment in FIG. 1.

[0017] FIG. 3 is a profile view of guiding valve of preferred embodiment in FIG. 1 in the first station.

[0018] FIG. 4 is a profile view of guiding valve of preferred embodiment in FIG. 1 in the second station.

[0019] FIG. 5 is a profile view of guiding valve of preferred embodiment in FIG. 1 in the third station.

[0020] FIG. 6 is a view of shift station structure of preferred embodiment.

[0021] FIG. 7 is another profile view of shift station structure

[0022] FIG. 8 is partial profile view of iron of another preferred embodiment of the present invention.

[0023] FIG. 9, which is sighted from underside, is a perspective view of locating bowl of stalls of preferred embodiment in FIG. 8.

#### DETAILED DESCRIPTION OF THE PREFERRED EMBODIMENT

[0024] The structure preferred embodiment of the present invention, refer to FIG. 1 and FIG. 2: a iron 1, a vapor boiler 2, a three-station guiding valve 3 and shift components 14. In preferred embodiment, guiding valve 3 and shift components 14 are installed within valve body 1. In others preferred embodiment, of course, guiding valve 3 and shift components 14 can be installed in vapor boiler 2, or guiding valve 3 and shift components 14 can keep away from iron 1 and vapor boiler 2 and be set up independent.

[0025] structure of iron parts 1, refer to FIG. 1: handle of shell 11 of iron parts 1 is set a switching push-button 12 and a micro-active switch 13. Back end of the switching push-button 12 withstands moving contacts of micro-active switch 13. Guiding valve 2 and shift component 14 are installed in anterior upside of shell 11. As soon as button 141 of shift component 14 is pushed, shift component 14 makes stalls of valve rod 24 of valve rod 2 change correspondingly, thereby valve rod 2 optionally stays some selected station and works according to status settled. Air inlet 211 of valve rod 2 links air inlet hose 151, the first air outlet 213 links the first air outlet hose 153, the second air outlet 212 of guiding valve 2 links the second air outlet hose 152. Snoot 16 which links the first air outlet hose 153 is installed in anterior part of shell 11 and links the first air outlet 213 of guiding valve 2 through the first air outlet hose 153. An insulating substrate 17, which has electric heating pipe 181 and heating board 18 with some gas groove 182 linking each other been fixed on the lower surface of insulating substrate 17, is fixed in the under part of shell 11. Heating board 18 and gas groove 182 are covered by insulating substrate 17, that forms air compartment. Upper part of air compartment links the second air outlet hose 152 through snoot 171 of insulating substrate 17, and links the second air

outlet 152 of valve rod 2 through the second air outlet hose 212. Lower part of the air compartment links external through the vapor hole 183 of heating board 18.

[0026] Structure of vapor boiler 3, refer to FIG. 2: vapor boiler 2 is set a compound pipe which comprises vapor pipe and electric cable 21. To deliver wet vapor to iron parts 1, the vapor pipe of compound pipe 21 links air inlet hose 151 of iron part 1. There are a pair control lines link micro-active switch 13 of iron 1 in electric cable within compound pipe 21. The micro-active switch 12 controls electromagnetic valve inside vapor boiler 2, in order to control wet vapor produced by vapor boiler 2 to deliver wet vapor to iron parts 1. Electric cable of compound pipe 21 has power line to link electric heating pipe 181 of heating plate 18 of iron parts 1.

[0027] Structure of valve rod 3, refer to FIG. 3: entocoele of body of valve appears stepped foramen caecum states, deepness of small end is comparable to deepness of big end. An air inlet 211 is made in side wall near upper end of valve body 21 to link vapor boiler 2; the second air outlet 212 is made in side wall near middle of valve body 21 to link air compartment 182 on heating plate 18; the first air outlet 213 is made in side wall near lower end of big end to link wet vapor snoot 16. A valve deck 22 with a center hole is set in opening of big end of valve body 21. A restoring spring is made in little end of valve body 21.

[0028] A salient shoulder with comparable size to inside diameters of big end is fixed on middle of valve rod 24 of valve rod 2, gland ring 25 covers valve rod and presses against the inner circular face of salient shoulder. Small end of valve rod 24 links valve plug 26 fixed. The inside end of valve rod 24 and valve plug 26 are located in small end of valve body all along; a restoring spring 23 used to push valve plug 26 is located between the valve plug 26 and the bottom of valve body 21. Salient shoulder and gland ring 25 are in big end of valve rod 24 all along, gland ring 25 seals the interval between the valve rod 24 and valve body 21. The outside end of valve rod 24 is led outside through a center hole in the top of valve body 21.

[0029] Guiding valve 2, refer to FIG. 3, valve rod lies the first station, restoring spring 23 is in the most stretched, salient shoulder 25 on valve rod 24 pressed against valve deck 22 on open end of big end of valve rod 24. Valve plug 26 in the upper part of small end of valve body 21 blocks between air outlet 213 and air inlet 211, air outlet 212 links air inlet 211 through internal air of body. Vapor boiler 2 delivers wet vapor to valve body 21 through air inlet 211 of valve rod 2 and provides wet vapor to iron parts 1 through air outlet 212, then this wet vapor is heated by heating plate and forms dry vapor, dry vapor ejects outside through the stream holes in bottom of heating plate 18 of iron parts 1, thereby this mode is used to iron wool, cotton and hemp.

[0030] Valve rod 24 is pushed to the second station, refer to FIG. 4: restoring spring 23 is pressed partly, valve plug 26 in small end of valve body 21 blocks between the second air outlet 212 and air inlet 211, the first air outlet 213 links air inlet 211 by air that come from lower part of bulk and upper part of small end of valve body 21. Vapor boiler 2 delivers wet vapor to valve body 21 through air inlet 211 of valve rod 2 and provides wet vapor to wet vapor snoot 16 through air outlet 213, then it ejects wet vapor outside by snoot 16. Since vapor boiler 3 refuses to supply power to electric heating pipe 18, this mode is used to iron composite fibrous fabric softly.

[0031] Valve rod 24 is pushed to the third station, refer to FIG. 5: restoring spring 23 is pressed totally; valve plug 26

lies outside the first air outlet **212**, the second air outlet **213** and air inlet **211**, air outlet **212**, air outlet **213** and air inlet **211** links each other through internal air that come from the lower part of bulk and the middle and upper part of small end of valve body **21**. Vapor boiler **2** delivers wet vapor to valve body **21** through air inlet **211** and provides wet vapor to wet vapor snoot **16** through air outlet **213**, then it ejects wet vapor outside by snoot **16**, and provides this wet vapor to heating plate **18**, then this wet vapor is heated by heating plate and forms dry vapor. dry vapor ejects outside through the stream holes **183** in bottom of heating plate **18** of iron parts **1**, thereby this mode is used to iron wool, cotton and hemp softly.

[0032] Structure of shift component **14**, refer to FIG. 6 and FIG. 7. Shift structure **14** has a bottom **141**, a copper axes **142**, a locating blocks of stalls **143** and a locating hood of stalls **144**. A pair forks, which thrust shell **11**, are located separately in two sides of locating hood of stalls **144** in the lower part of bottom **141**. Locating hood of stalls **144** is a twisted metal plate, the lower surface and the rear surface opens; a pair leading breach **1441** of locating blocks are set in anterior part of two profiles; a pair of inclined guide channel of copper axes **1442** is made in two sides of anterior end surface. Locating block of stall **143** appears like Z in general, the anterior part of lower horizontal edge has a plate; the upper surface of lower horizontal edge appears wavy. Three troughs correspond to three stalls. Locating blocks of stalls **143** conceals in locating hood of stall **144**, plate of locating block of stall **143** stretches outside from two leading breach **1441**; upper horizontal edge stretches backward and presses upon upper end of valve rod **24**. Copper axes **142** inserts two guide grooves **1442** of locating hood **144**, the middle of which contacts with upper surface **1432** of lower horizontal edge of locating block **143**; two sides of which are choked in opening of fork **1441**. Usually, restoring spring **23** pushes valve rod **24** upwards; valve rod **24** keeps locating block being shifted upwards. When bottom **141** of shift component **14** is pressed, fork **1411** presses copper axes **142** downwards and copper axes **142** pushes locating block **143** downwards. Bottom **131** moves along the declining surface of shell **11** upwards or downwards, at the same time copper axes **142** moves slantwise along two guide groove **1442** of bilateral surface of locating hood **144**, there are two motive constituents plumb mutually in this declining move, horizontal constituent changes the position of trough copper axes **142** in upper surface of locating block **143**, vertical constituent makes valve rod **24** change stall correspondingly, thereby guiding valve **2** stays optionally in some selected station and works according to planned states.

[0033] Another preferred embodiment of present invention, refer to FIG. 8, guiding valve **20** and shift component **140** are set in anterior and upper part of shell **11**. Shift component **140** adopts rotating structure, when shift component **1410** is rotary, the shift component **140** makes the valve rod **240** of valve rod **20** change stall correspondingly, thereby guiding valve **2** stays optionally in some selected station and works according to planned states. Air inlet **2110** of guiding valve **20** links inlet hose; the first air outlet **2130** links the first outlet hose **1530**; the second air outlet **2120** links the second outlet hose. A snoot, the internal end of which links the first outlet hose **1530**, is set in anterior part of shell **110** and links the first air outlet **2130** through the first outlet hose **1530**. An insulating substrate **170**, which has electric heating pipe **1810** and heating board **180** with some gas groove **1820** linking each other been fixed on the lower surface of insulating substrate **170**, is fixed in the lower part of shell **110**. Heating

board **180** and gas groove **1820** are covered by insulating substrate **170**, which forms air compartment. Upper part of air compartment links the second outlet hose through snoot of insulating substrate **170**, and links the second air outlet **2120** through the second air outlet hose. Lower part of the air compartment links external through the vapor hole **1830** of heating board **18**.

[0034] Shift component **140** has a knob **1410**, a locating bowl of stall **1420**. Knob is set outside the shell **110** and connects with bottom of locating bowl of stall **1420** steadily. Main body of locating bowl **1420** intercalate shell **110**, a breach in its side wall, the surface of breach presses against valve rod **24**. Refer to FIG. 9: there are a flat line **14201** near bottom of bowl and a flat line **14202** near middle of bowl in the surface of side wall breach of locating bowl **1420**, rim of locating bowl and both of them constitute three stalls. Usually, restoring spring **230** presses valve rod **240** upwards; owing to restraint from locating bowl **1420**, valve rod **240** keeps steadily. Locating bowl of stall **1420** turns when rotary knob is turned, flat line **14201**, flat line **14202** or rim **14203** of locating bowl **1420** turns at the same time, stall of valve rod **240** of guiding valve **20** shifts correspondingly, thereby guiding valve **2** stays optionally in some selected station and works according to planned states.

[0035] The above-mentioned is the optimal embodiment, while extension of present invention isn't restricted. Making equivalent change and modification according to technical proposal of present invention and explanation belong to extension of present invention.

#### INDUSTRIAL APPLICABILITY

[0036] The present invention is a air-feed device of boiler iron, it has three-station guiding valve and provides three way of air-feed, structure of guiding valve is easy, operates conveniently and safe. The boiler iron with air-feed device mentioned above drives the valve plug within valve body to stay in one of three-station through valve rod of guiding valve, supplies wet vapor by vapor boiler through air inlet of guiding valve and heats wet vapor by heating plate to form dry vapor, then it ejects outside. The present invention can cater all kind demand of fabric iron, it has simple structure and is operated conveniently, and is popularized to apply easily.

1. a air-feed device of boiler iron, it has a three-station guiding valve whose body contains an air inlet linking boiler and two air outlets located in two sides of guiding valve, the first air outlet links wet vapor snoot of iron and the second links heating plate of boiler; one end of valve rod of guiding valve is in valve body and links with a fixed valve plug, another end which is located relatively to the first end is led outside through an opening in the top of body; when valve rod lies the first station, the valve plug blocks between the first air outlet and the second air outlet, the second air outlet links the air inlet through inner air of valve body; when valve rod lies the second station, the valve plug blocks between the second air outlet and the air inlet, the first air outlet links the air inlet through inner air of body; when valve rod lies the third station, the valve plug blocks during the first air outlet, the second air outlet and the air inlet, the first air outlet, the second air outlet and the air inlet link each other through inner air of body.

2. Air-feed device according to claim 1: in valve body mentioned above, a restoring spring used to push valve plug is located between valve plug and the bottom of body.

3. Air-feed device according to claim 2: the second end of valve rod is led outside through an opening in the top of body of valve.

4. Air-feed device according to claim 1: valve rod is set a gland ring which seals the interval between the valve rod and valve body.

5. Air-feed device according to claim 4: entocoele of valve body appears stepped foramen caecum state. The first end of valve rod and valve plug are located in small end all along; a salient shoulder with comparable size to inside diameters of big end is located in big end of body all along, gland ring covers valve rod and presses against the inner circular face of salient shoulder.

6. A boiler iron comprises an iron, a vapor boiler and three stations guiding valve, valve body of guiding valve contains an air inlet linking boiler and two air outlet located in two sides of guiding valve, the first air outlet links wet vapor snoot of iron and the second links heating plate of boiler; one end of the valve rod of guiding valve is in valve body and links with a fixed valve plug, another end which is located relatively to the first end is led outside through an opening in the top of body of valve; when valve rod lies the first station, the valve plug blocks between the first air outlet and the second air outlet, the second air outlet links the air inlet through inner air of body; when valve rod lies the second station, the valve plug blocks between the second air outlet and the air inlet, the first air outlet links the air inlet through inner air of body; when valve rod lies the third station, the valve plug blocks during the first air outlet the second air outlet and the air inlet, the first air outlet, the second air outlet links the air inlet through inner air of body.

7. Boiler iron according to claim 6: guiding valve is set in iron, and shift component which controls three stations to mutually shift and locate; the shift component presses against valve rod of guiding valve.

8. Boiler iron according to claim 7: shift component comprises horizontal axis which aslant moves when button is pressed and locating block of stalls which links valve rod of guiding valve, the locating block has wavy surface to sliding contact with the horizontal axis, three troughs correspond to three stalls in the wavy surface.

9. Boiler iron according to claim 7: shift component has rotating locating bowl of stalls, there is an opening in side wall of locating bowl, surface of breach presses against valve rod of guiding valve and has two parallel lines at least, rim linking locating block of stalls constitutes positioning surface corresponding to three stalls.

10. Air-feed device according to claim 2: valve rod is set a gland ring which seals the interval between the valve rod and valve body.

11. Air-feed device according to claim 3: valve rod is set a gland ring which seals the interval between the valve rod and valve body.

12. Air-feed device according to claim 10: entocoele of valve body appears stepped foramen caecum state. The first end of valve rod and valve plug are located in small end all along; a salient shoulder with comparable size to inside diameters of big end is located in big end of body all along, gland ring covers valve rod and presses against the inner circular face of salient shoulder.

13. Air-feed device according to claim 11: entocoele of valve body appears stepped foramen caecum state. The first end of valve rod and valve plug are located in small end all along; a salient shoulder with comparable size to inside diameters of big end is located in big end of body all along, gland ring covers valve rod and presses against the inner circular face of salient shoulder.

\* \* \* \* \*