



US 20190086775A1

(19) **United States**

(12) **Patent Application Publication**
DeMers et al.

(10) **Pub. No.: US 2019/0086775 A1**

(43) **Pub. Date: Mar. 21, 2019**

(54) **TRAIL CAMERA MOUNTING SYSTEM**

A01M 31/00 (2006.01)

B25G 1/04 (2006.01)

(71) Applicants: **Michael S. DeMers**, Great Falls, MT (US); **Simon Evans**, Great Falls, MT (US)

(52) **U.S. Cl.**
CPC *G03B 17/561* (2013.01); *G03B 17/568* (2013.01); *A01G 3/083* (2013.01); *A01M 31/002* (2013.01); *B25G 1/04* (2013.01); *F16M 13/022* (2013.01)

(72) Inventors: **Michael S. DeMers**, Great Falls, MT (US); **Simon Evans**, Great Falls, MT (US)

(21) Appl. No.: **16/195,462**

(57) **ABSTRACT**

(22) Filed: **Nov. 19, 2018**

Related U.S. Application Data

(63) Continuation-in-part of application No. 15/709,276, filed on Sep. 19, 2017, which is a continuation-in-part of application No. 15/262,610, filed on Sep. 12, 2016, now Pat. No. 10,191,357.

(60) Provisional application No. 62/332,910, filed on May 6, 2016, provisional application No. 62/217,653, filed on Sep. 11, 2015.

Publication Classification

(51) **Int. Cl.**
G03B 17/56 (2006.01)
F16M 13/02 (2006.01)

The herein described invention is a camera mounting system where the user can safely install a camera high in a tree without having to leave the ground. The camera mounting system is comprised of a tree attachment, ball mount, and camera mount. The system is installed by using an extension pole with releasable capture means for installation and removal of the system. This system is also comprised of a multi-mount adapter, which allows a user to install multiple wire connected mounted components on one tree attachment, or in different elevated positions. Once installed, a camera can be accurately aimed by using a laser attachment and standard laser pen light. This system is further comprised of a saw attachment, which can be used to clear branches from the installation area of the tree being utilized.

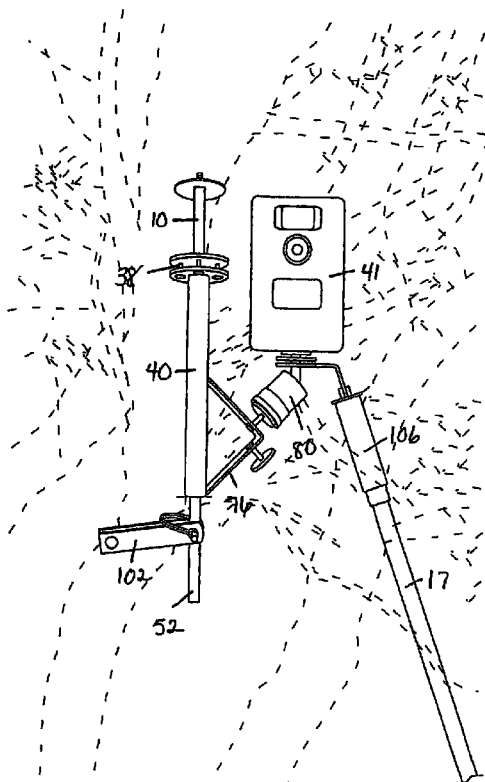

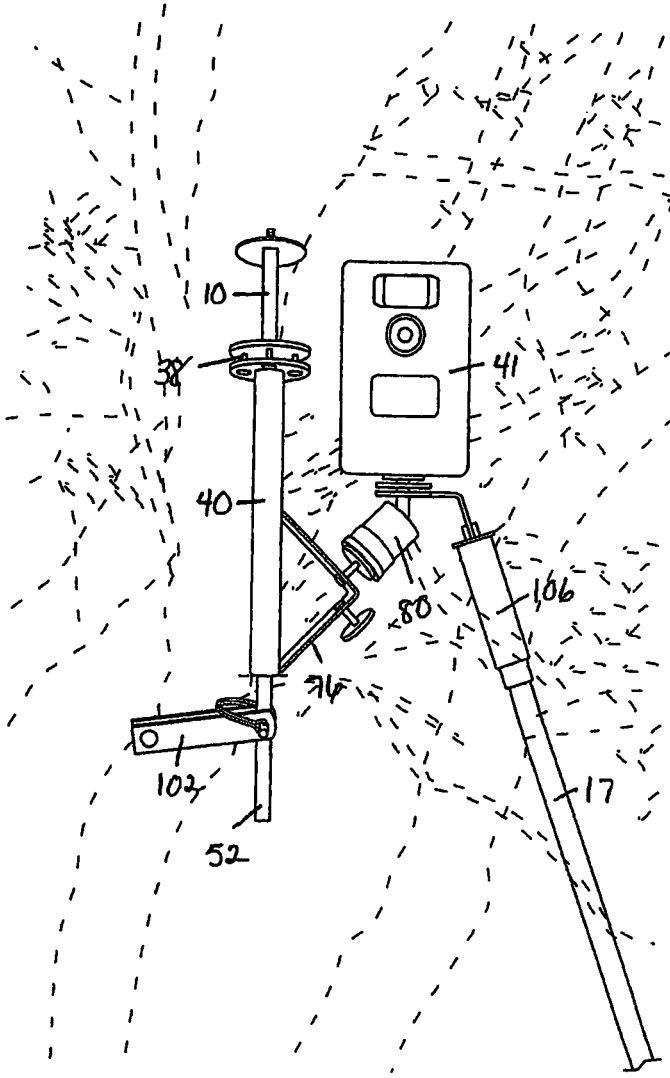

Fig. 1

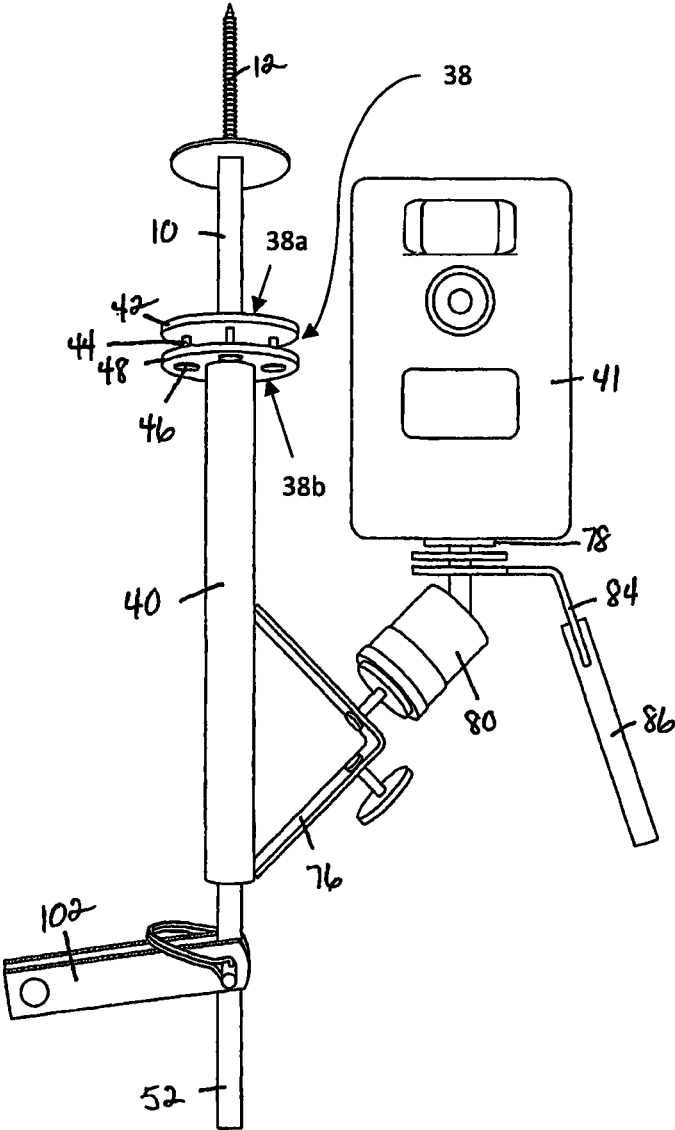

Fig. 2

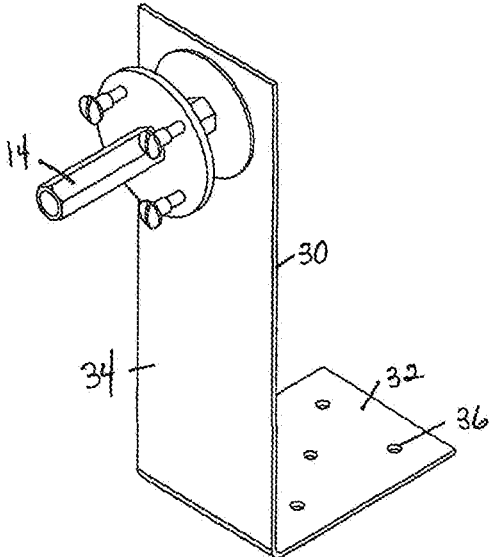

Fig. 3

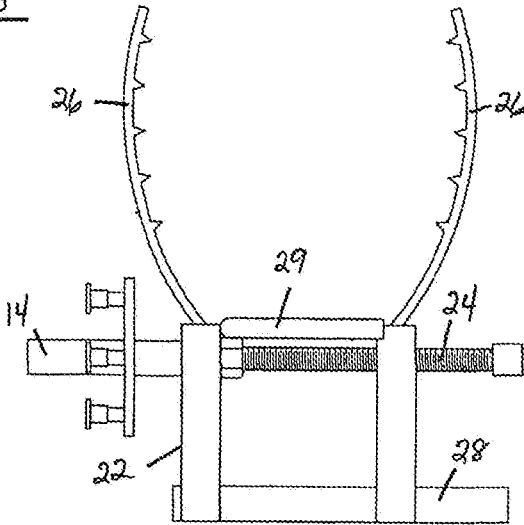

Fig. 4

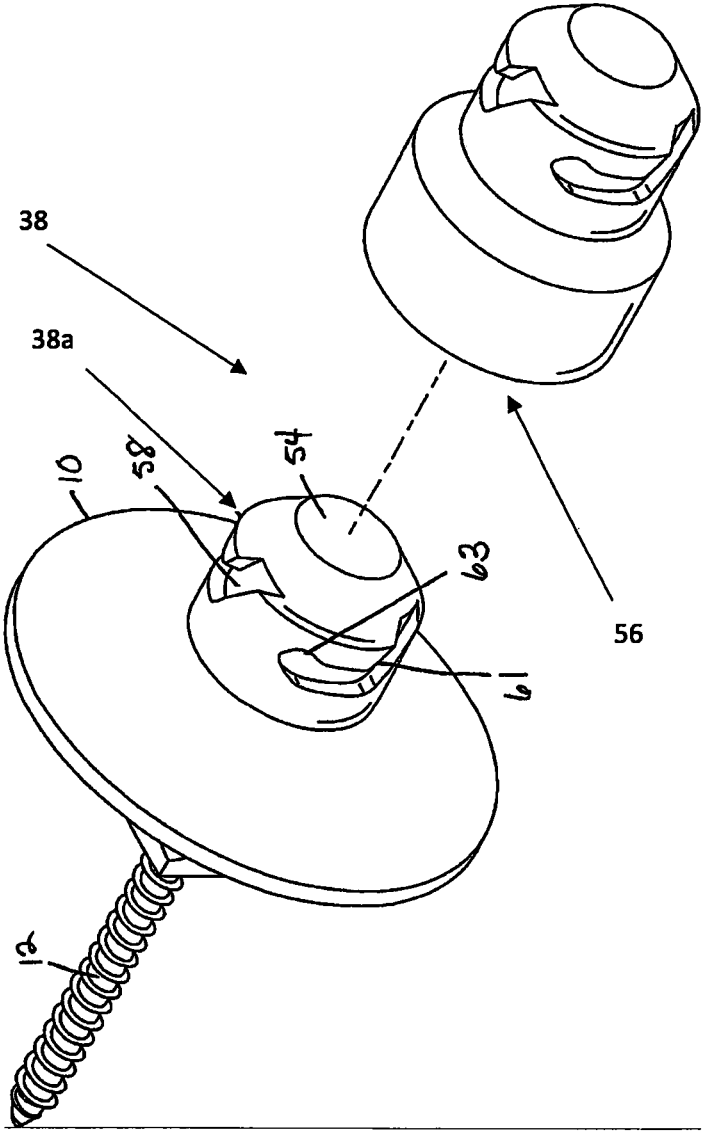

FIG. 5

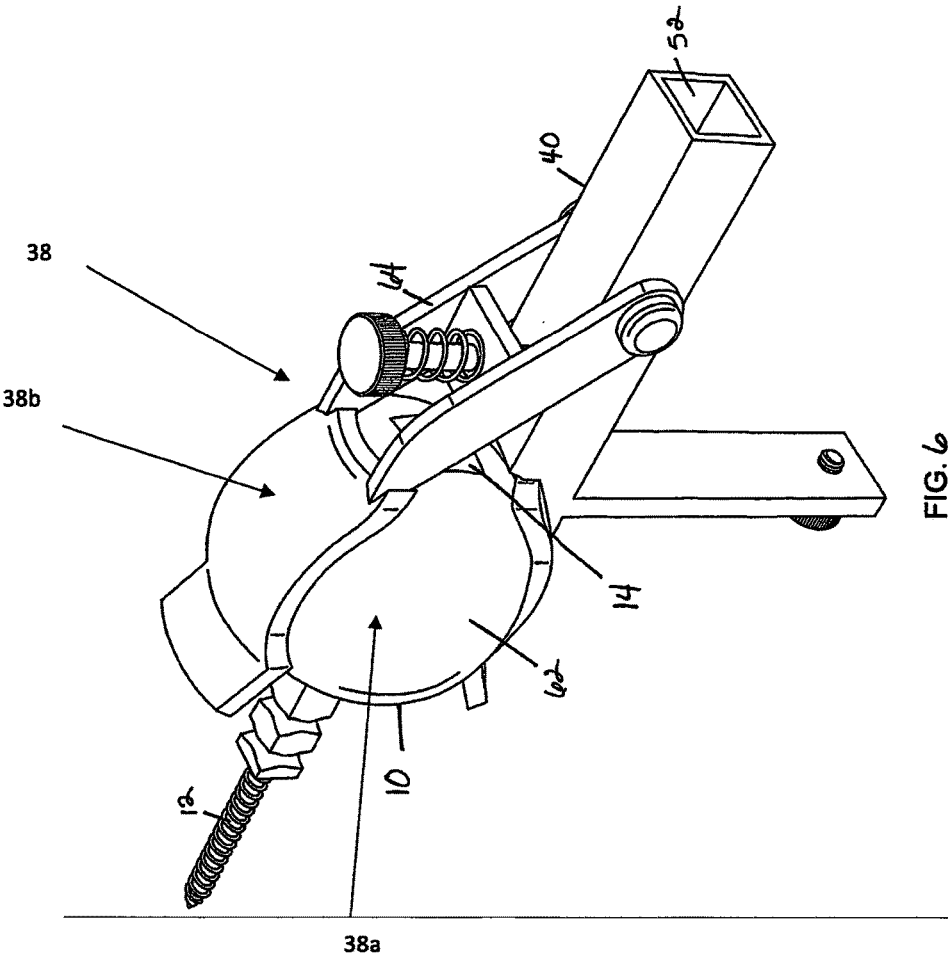

FIG. 6

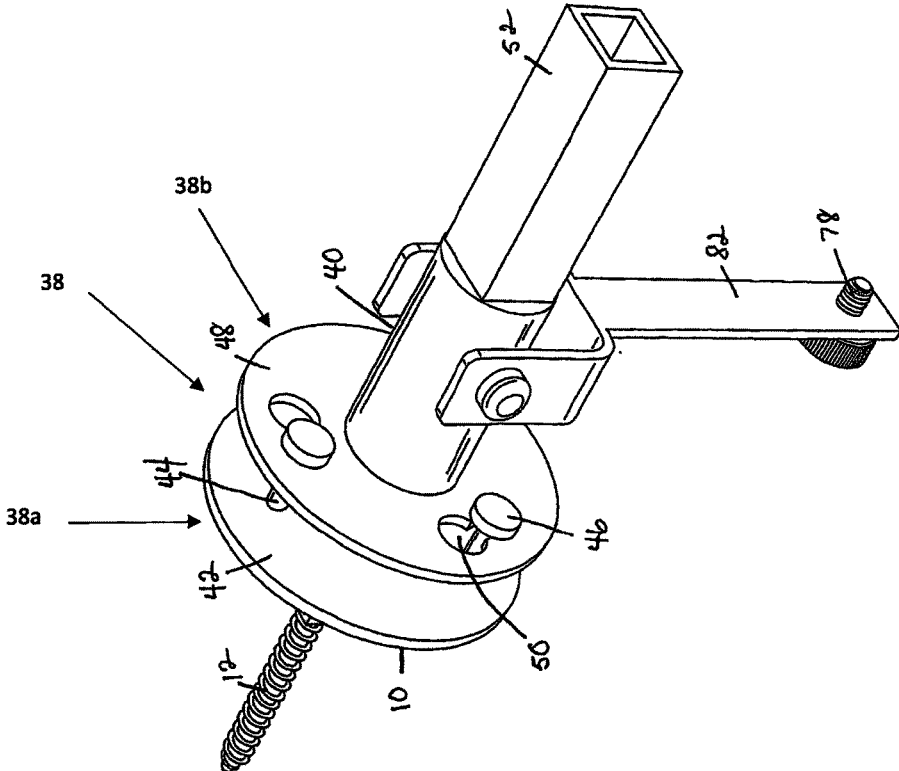

FIG. 7

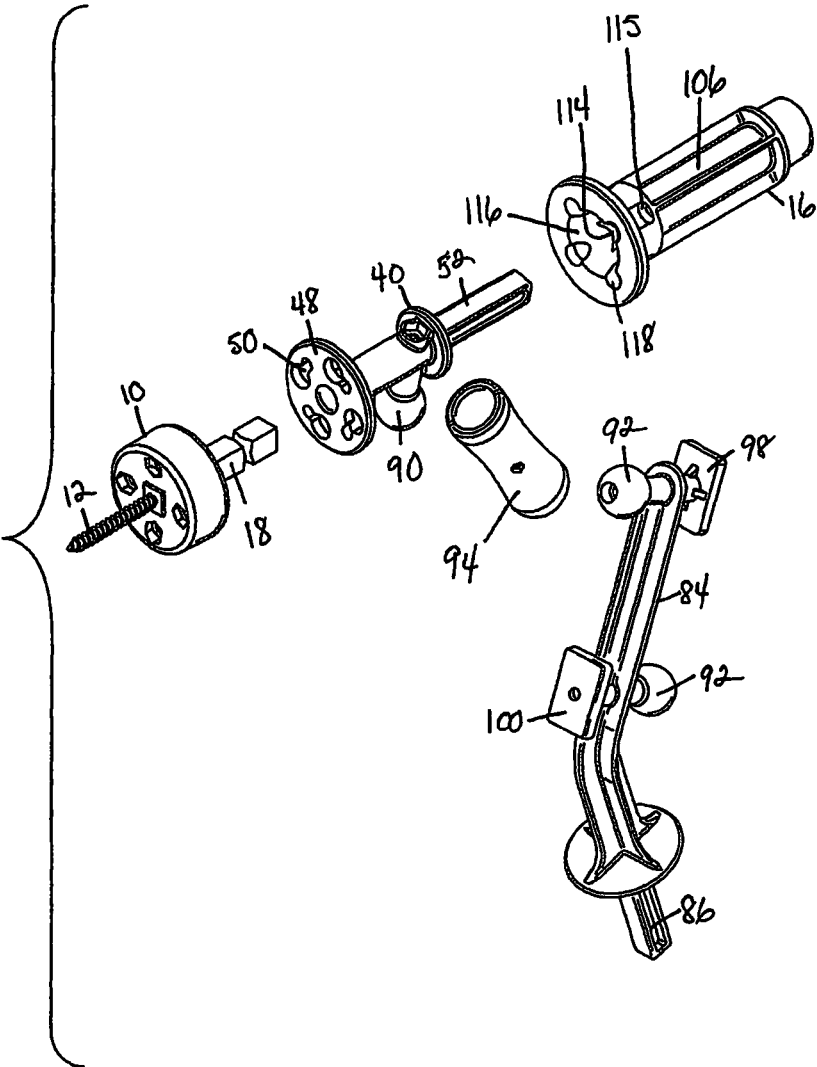

FIG. 8

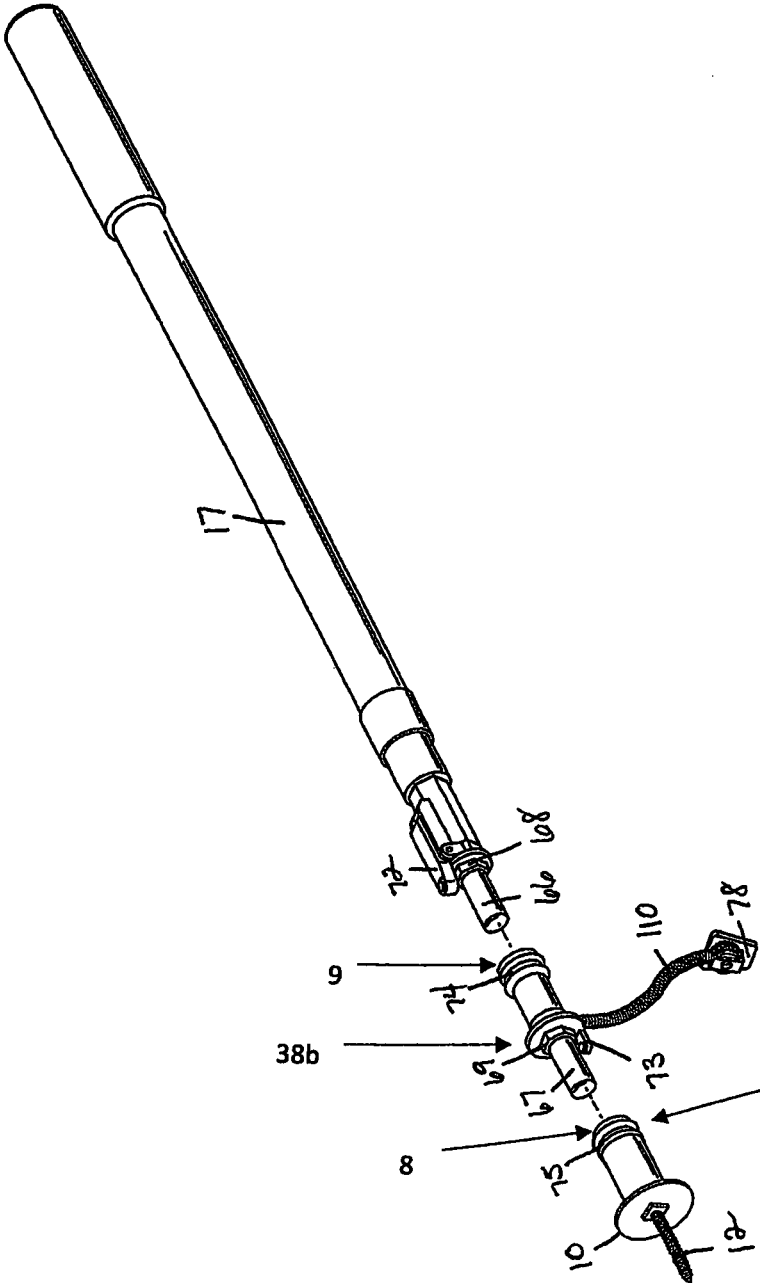

FIG. 9

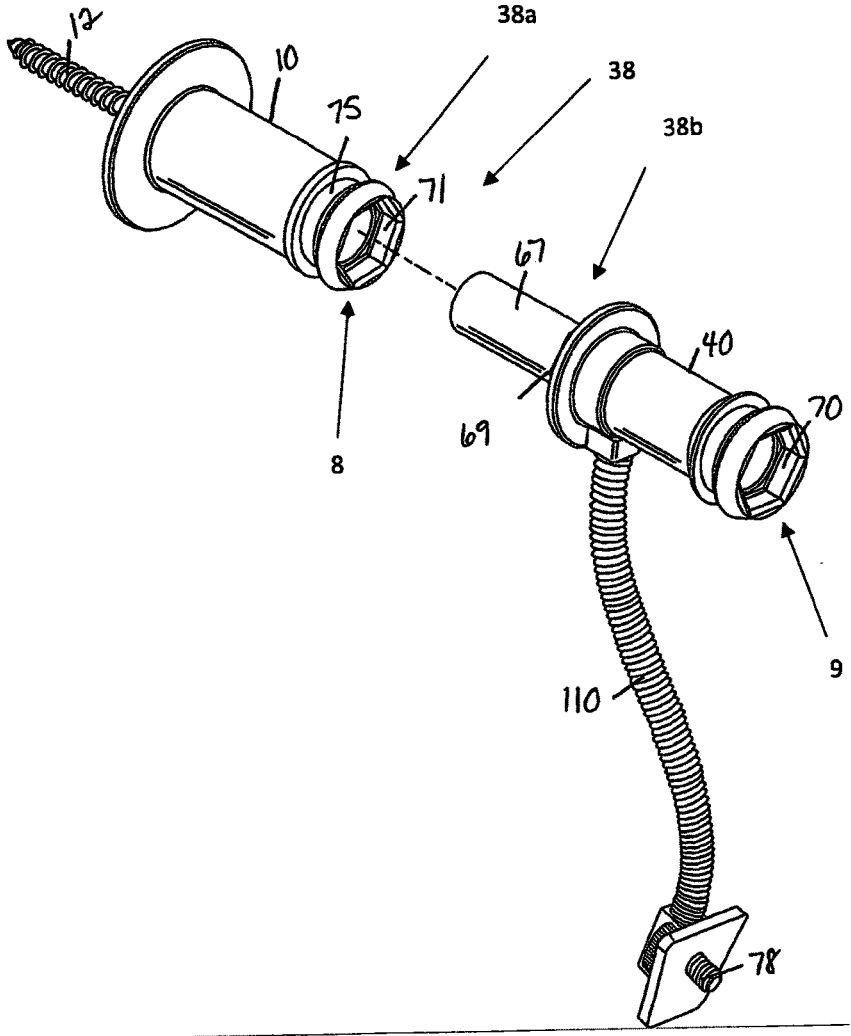

FIG. 10

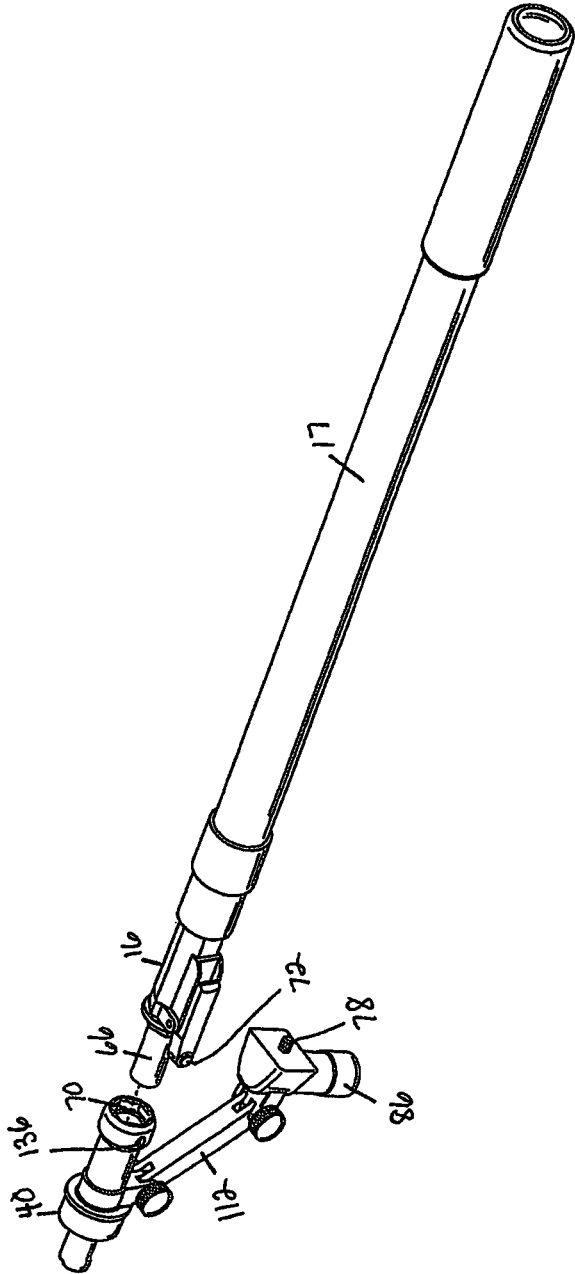

FIG. 11

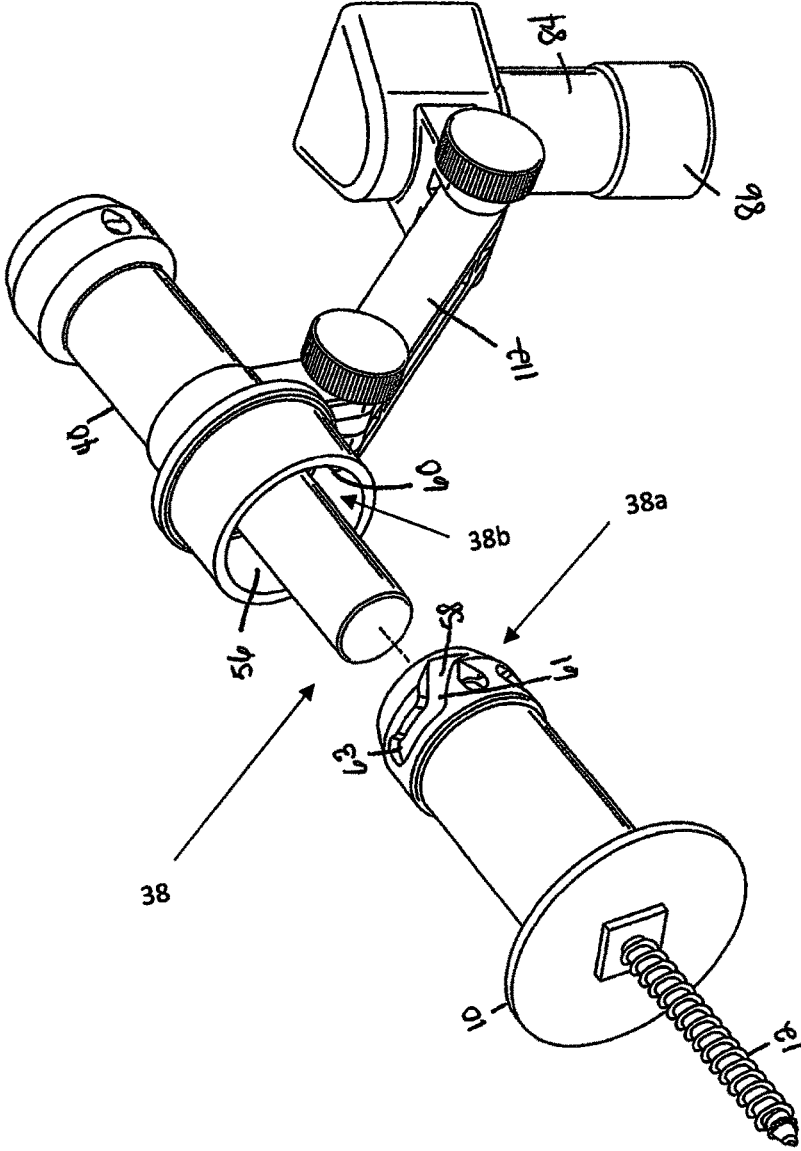
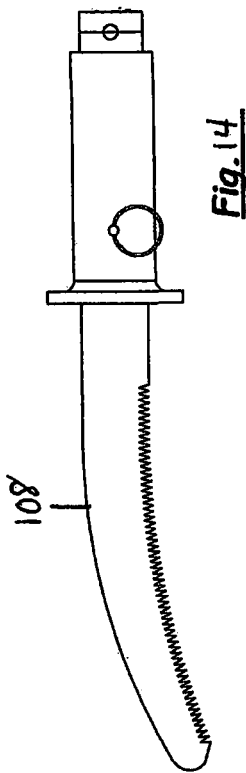
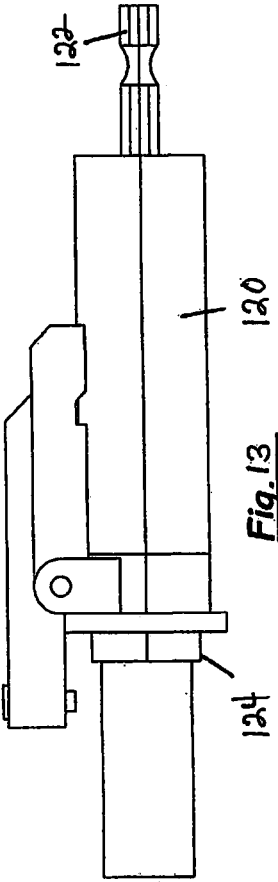

FIG. 12



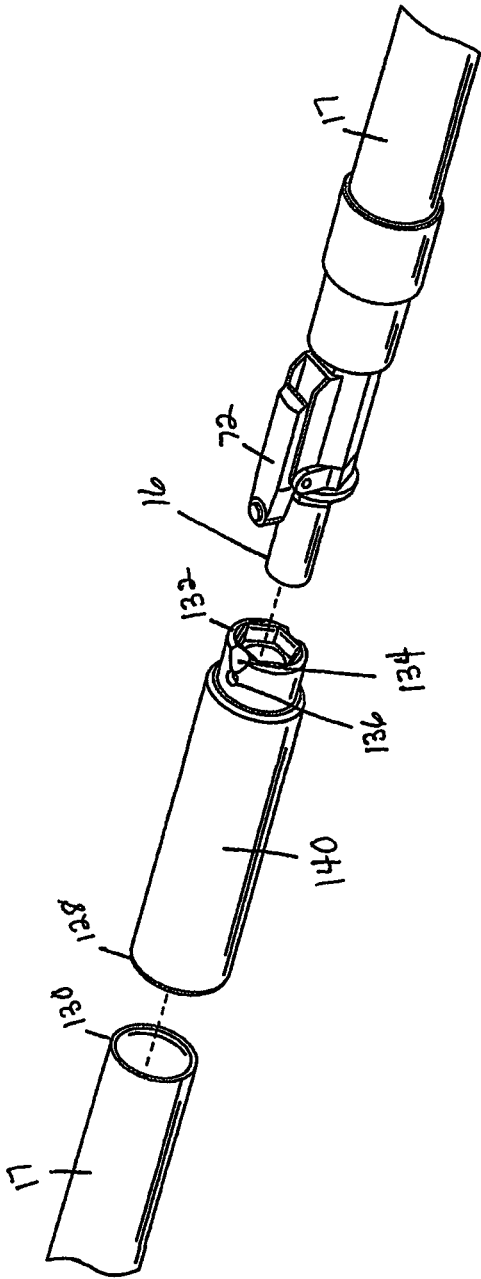

FIG. 15

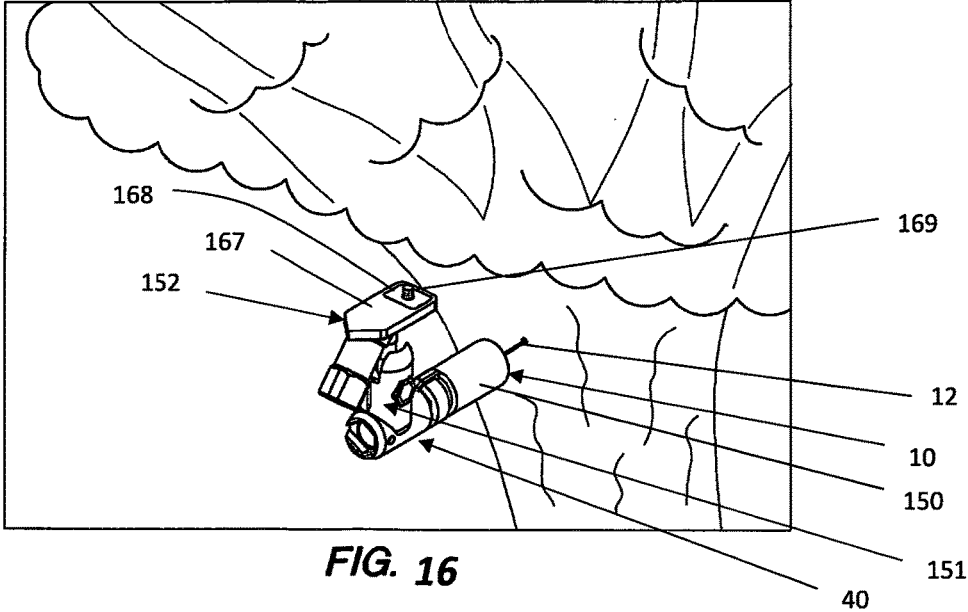

FIG. 16

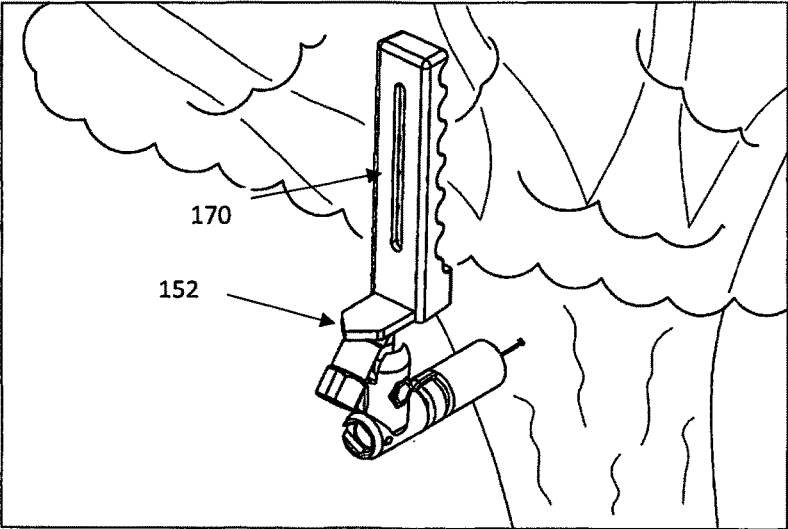

FIG. 17

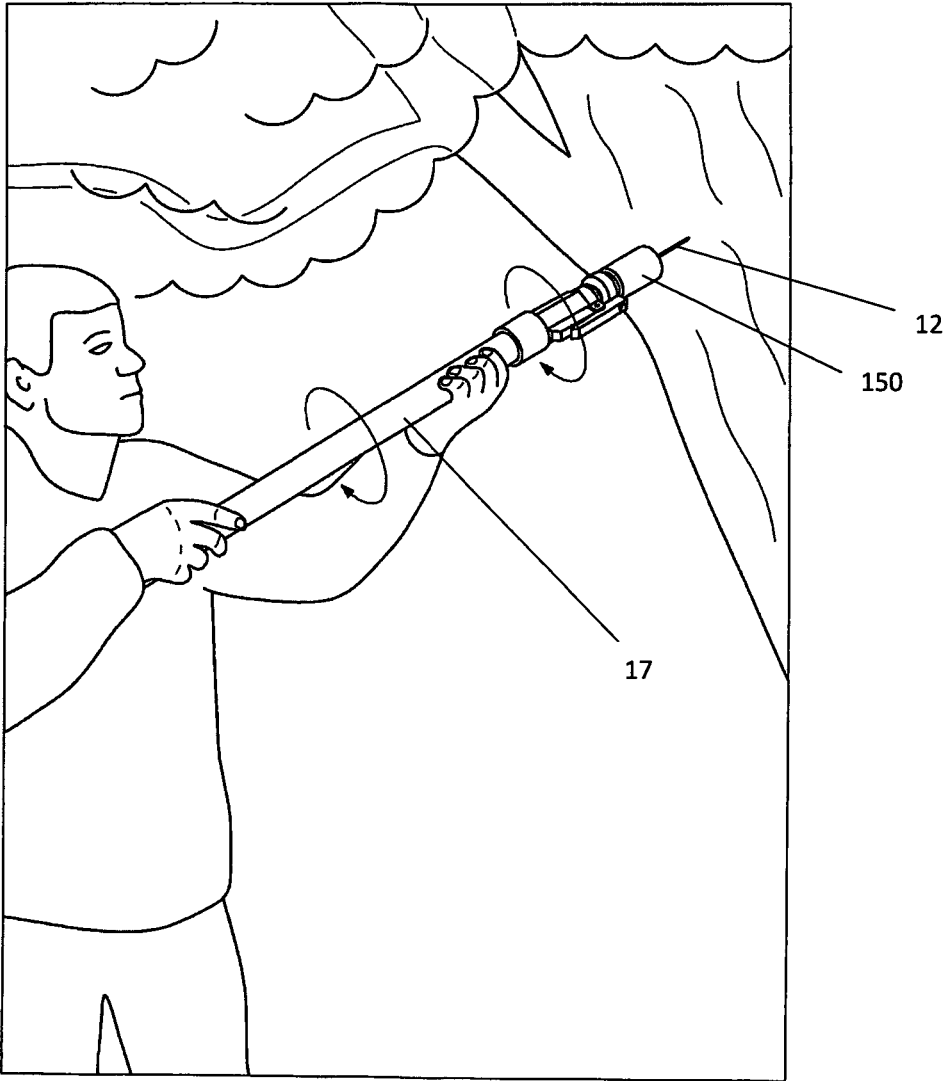

FIG. 18

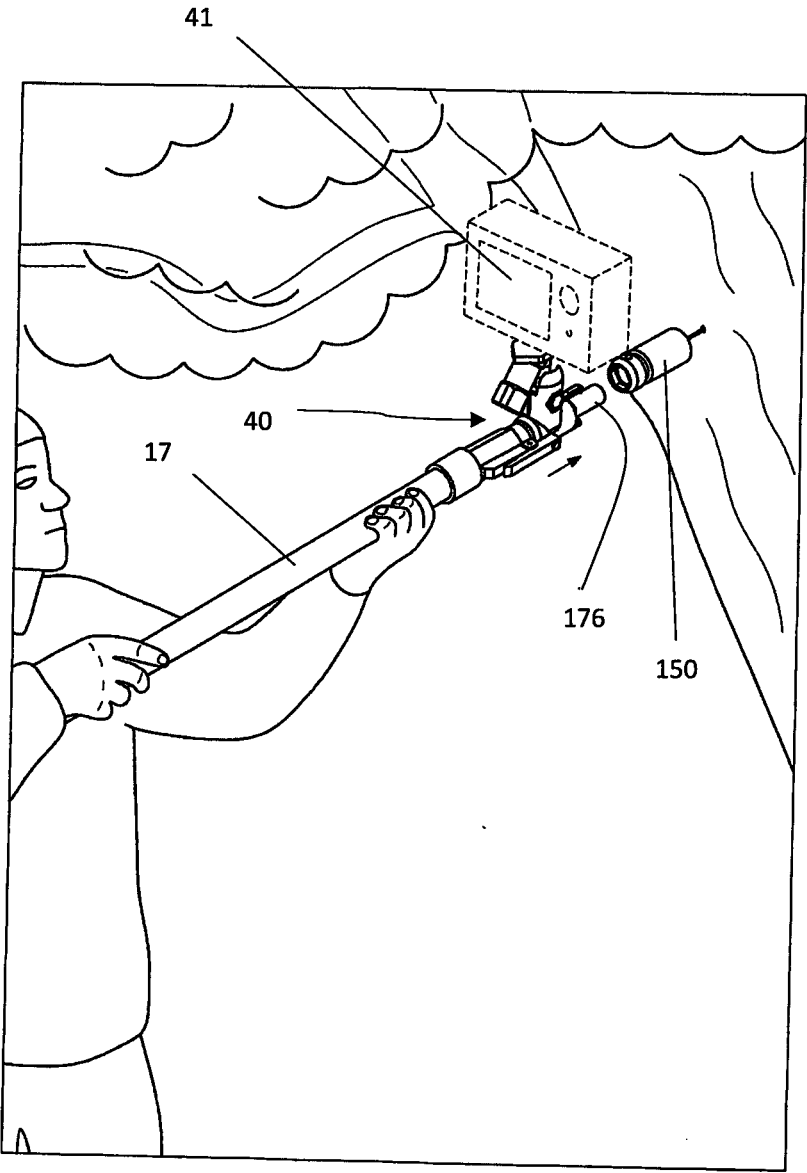

FIG. 19

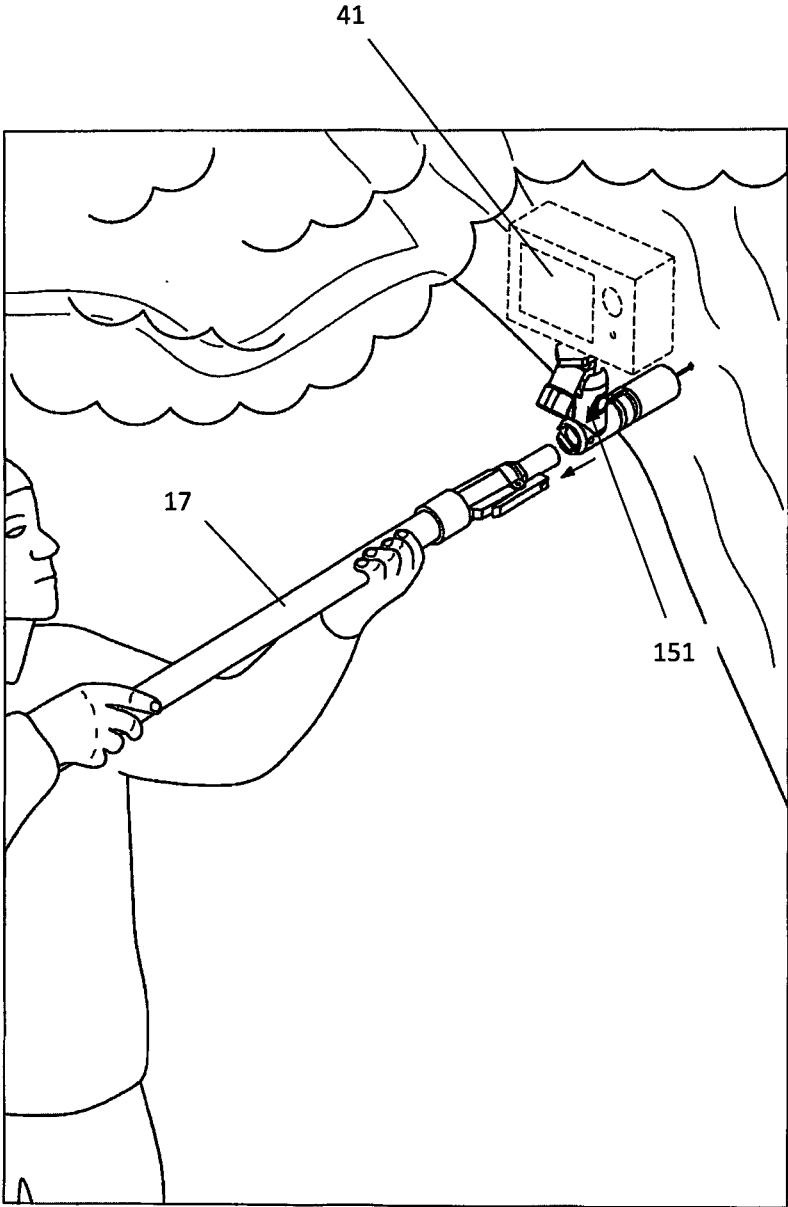

FIG. 20

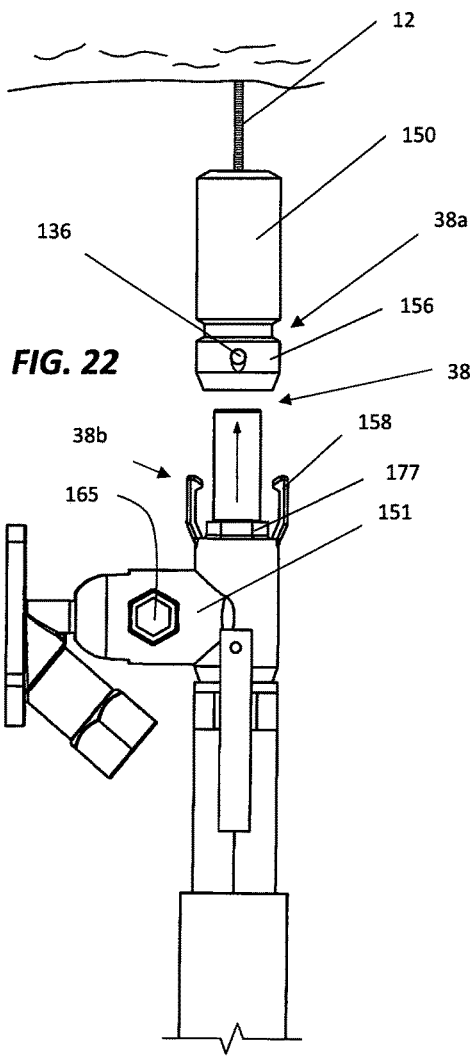
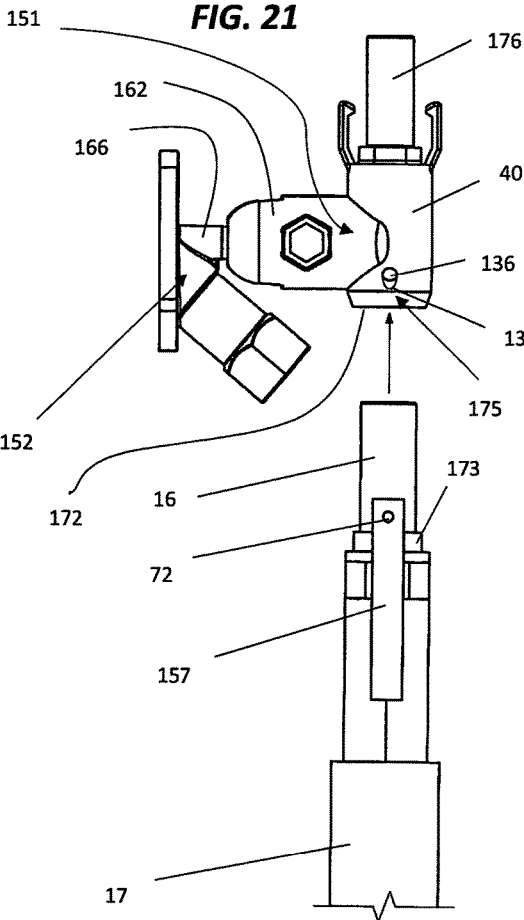

FIG. 23

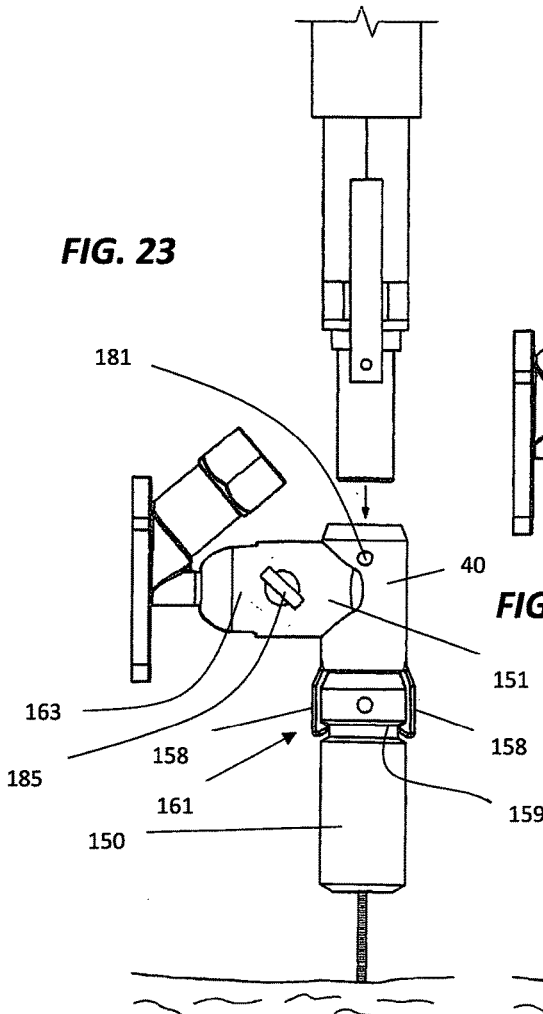
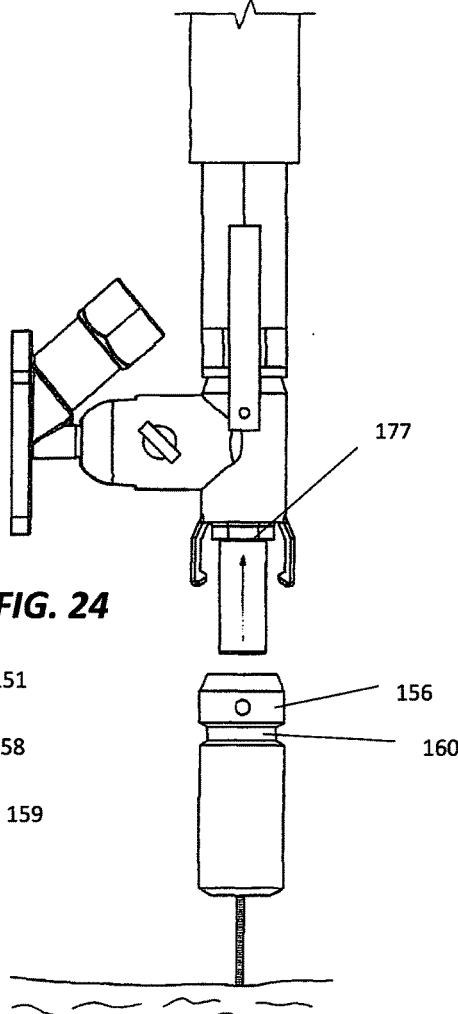
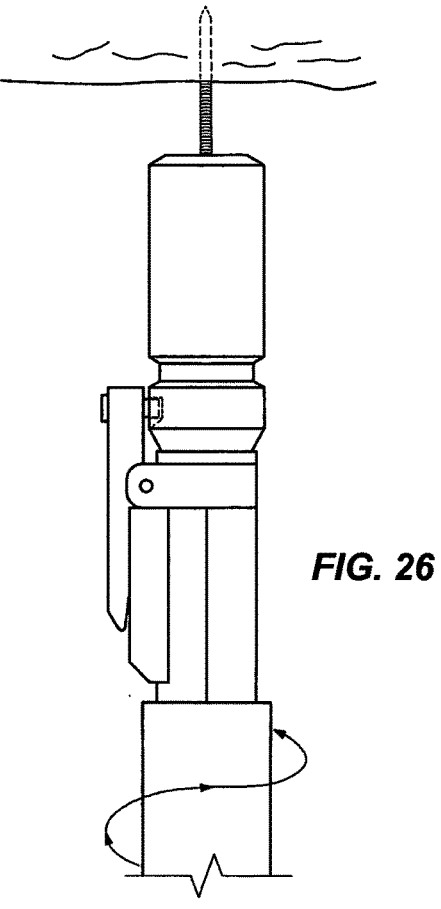
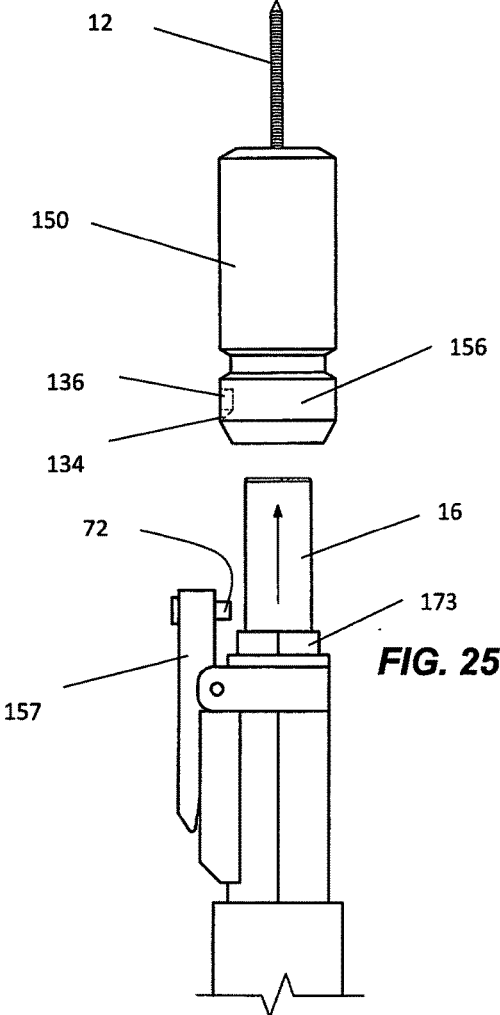
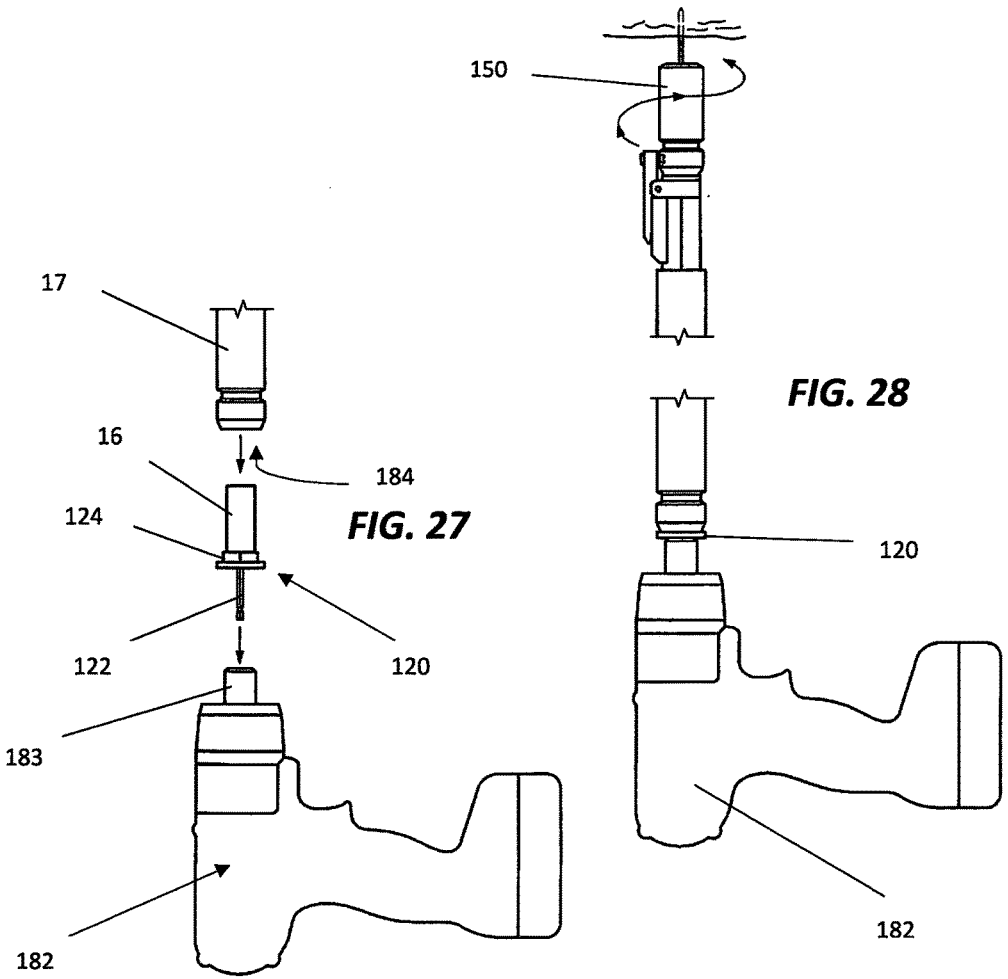
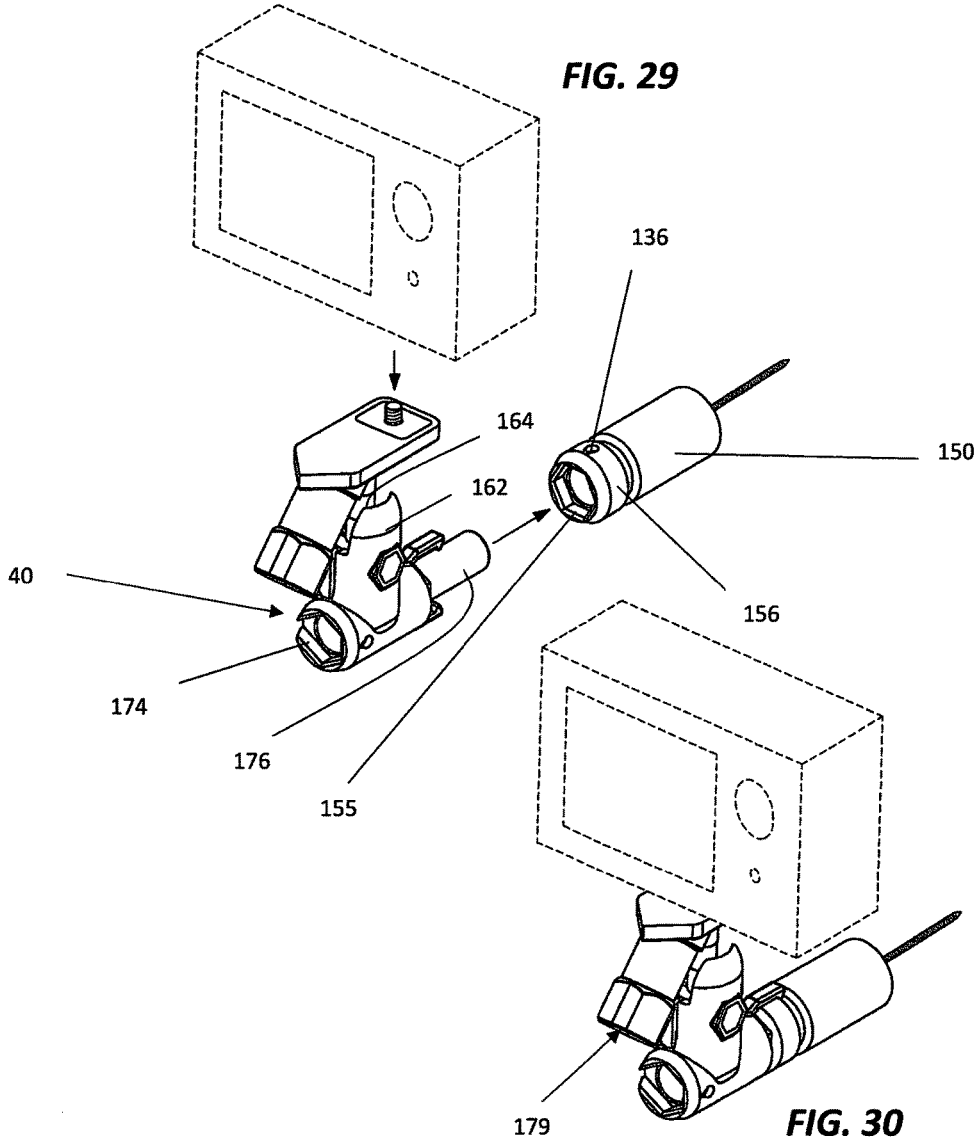

FIG. 24









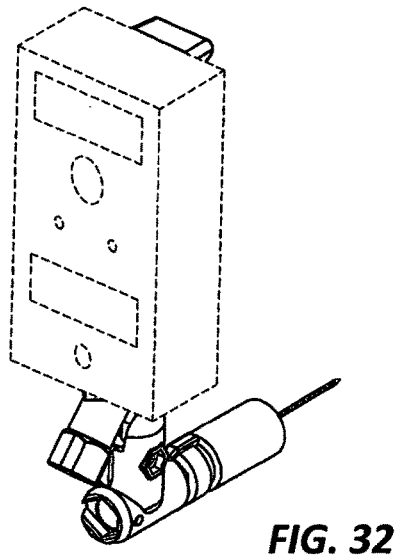
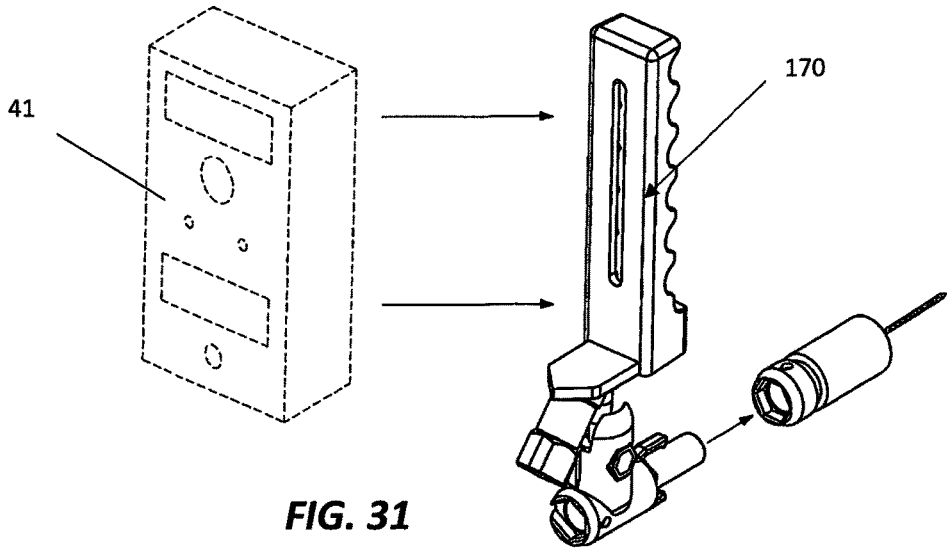

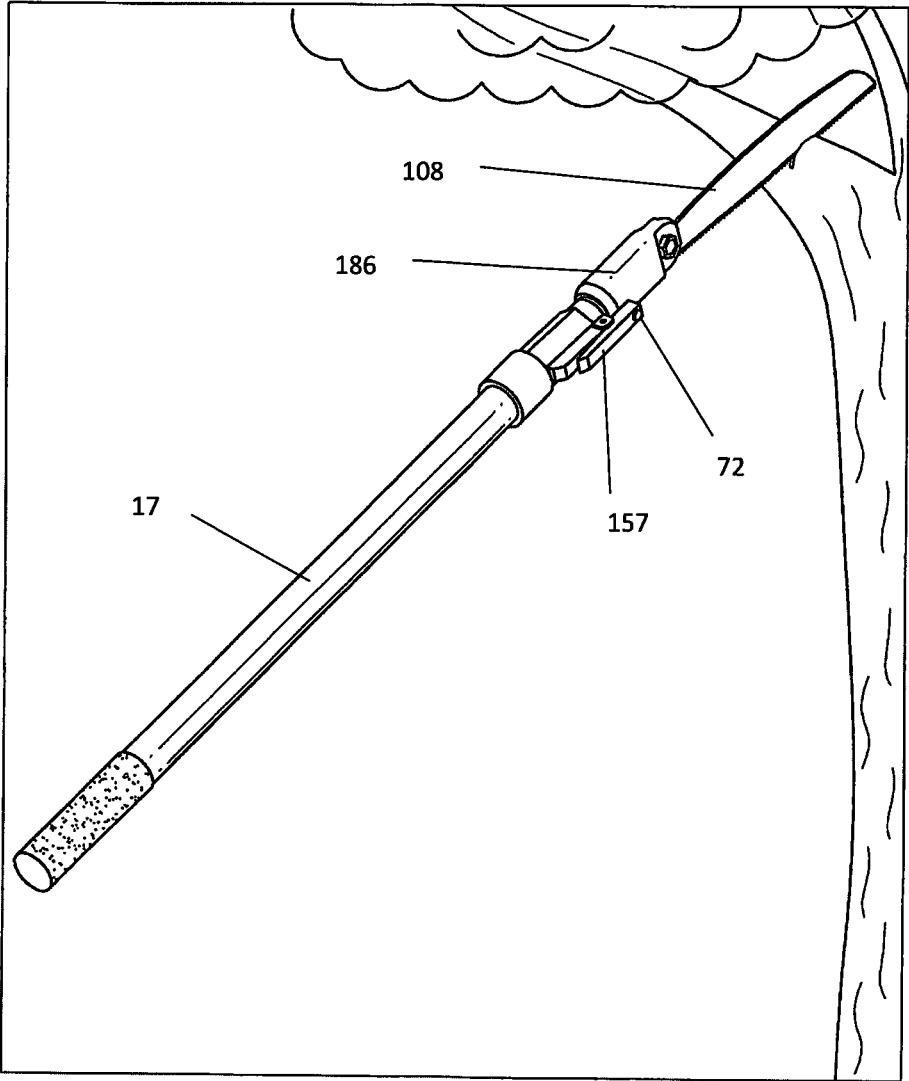

FIG. 33

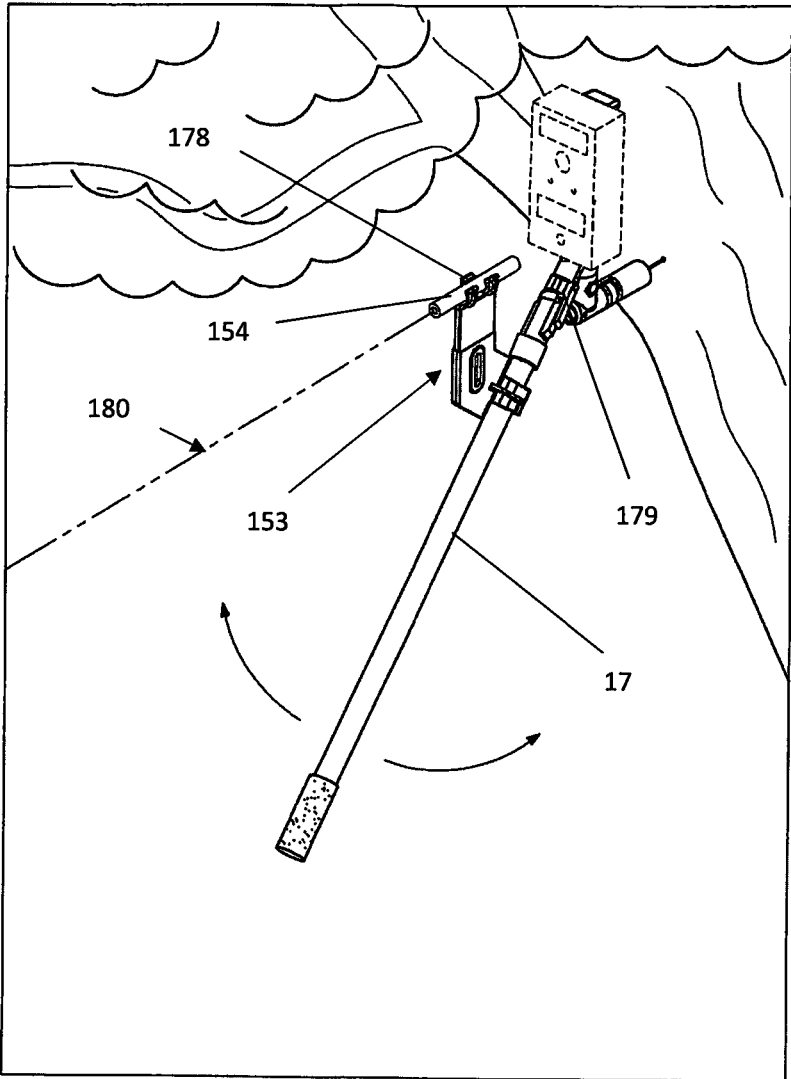

FIG. 34

FIG. 35

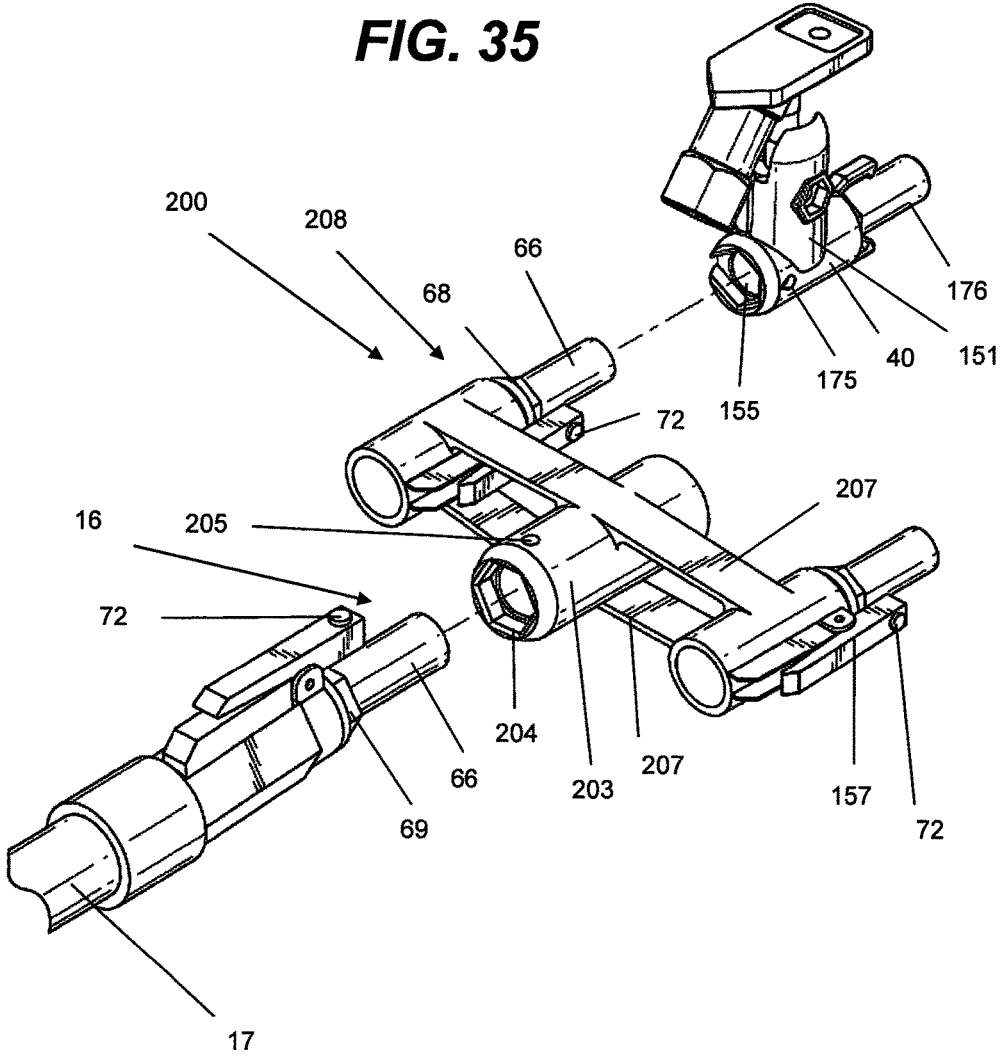

FIG. 36

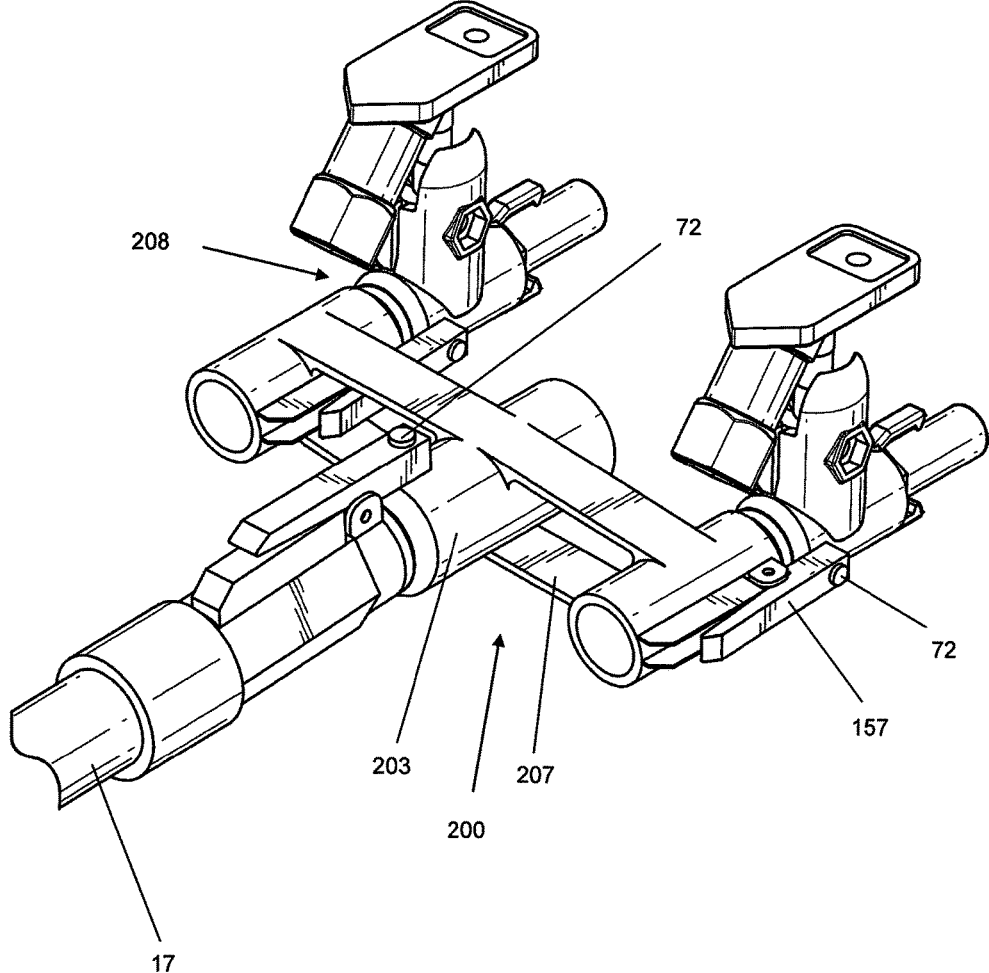

FIG. 37

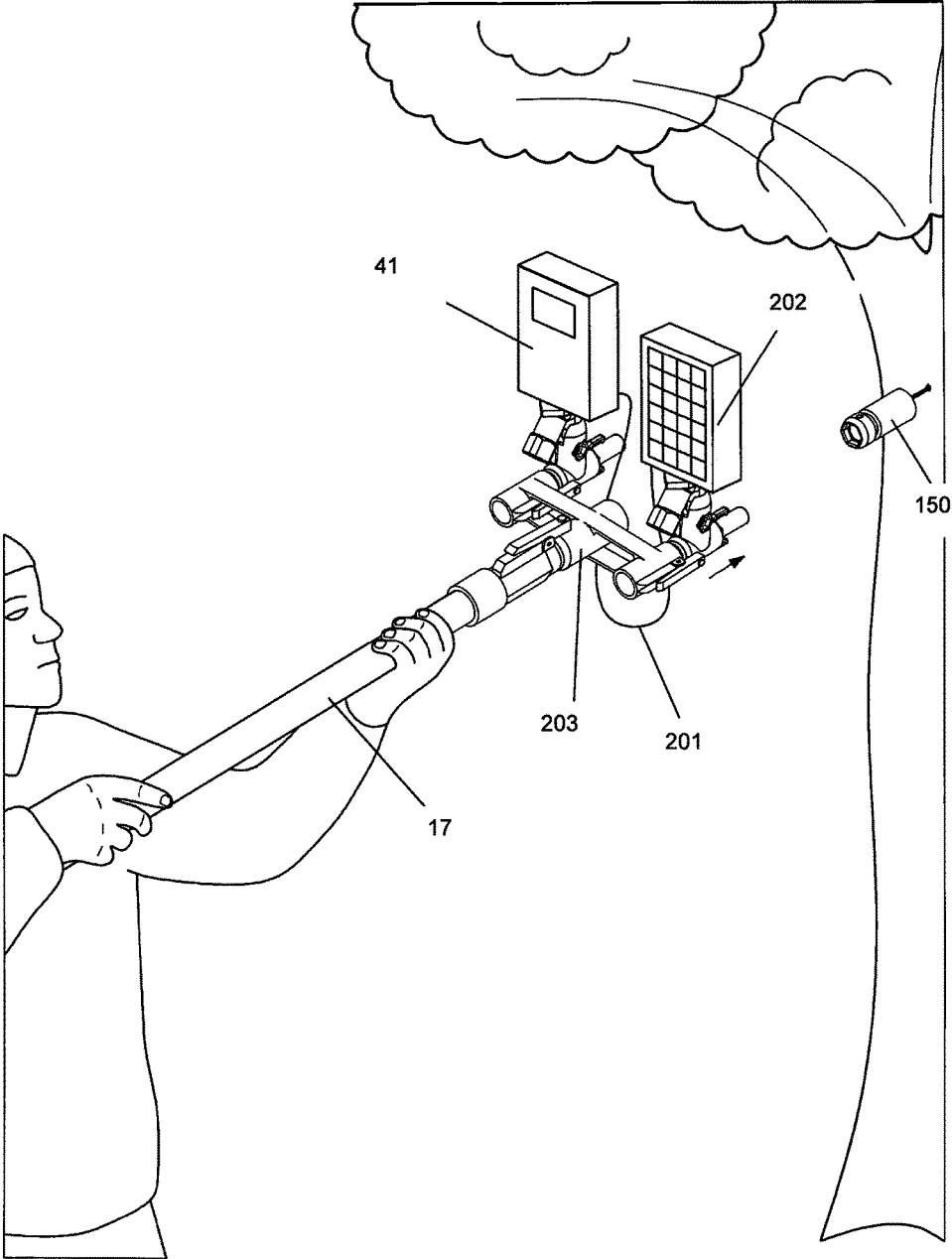

FIG. 38

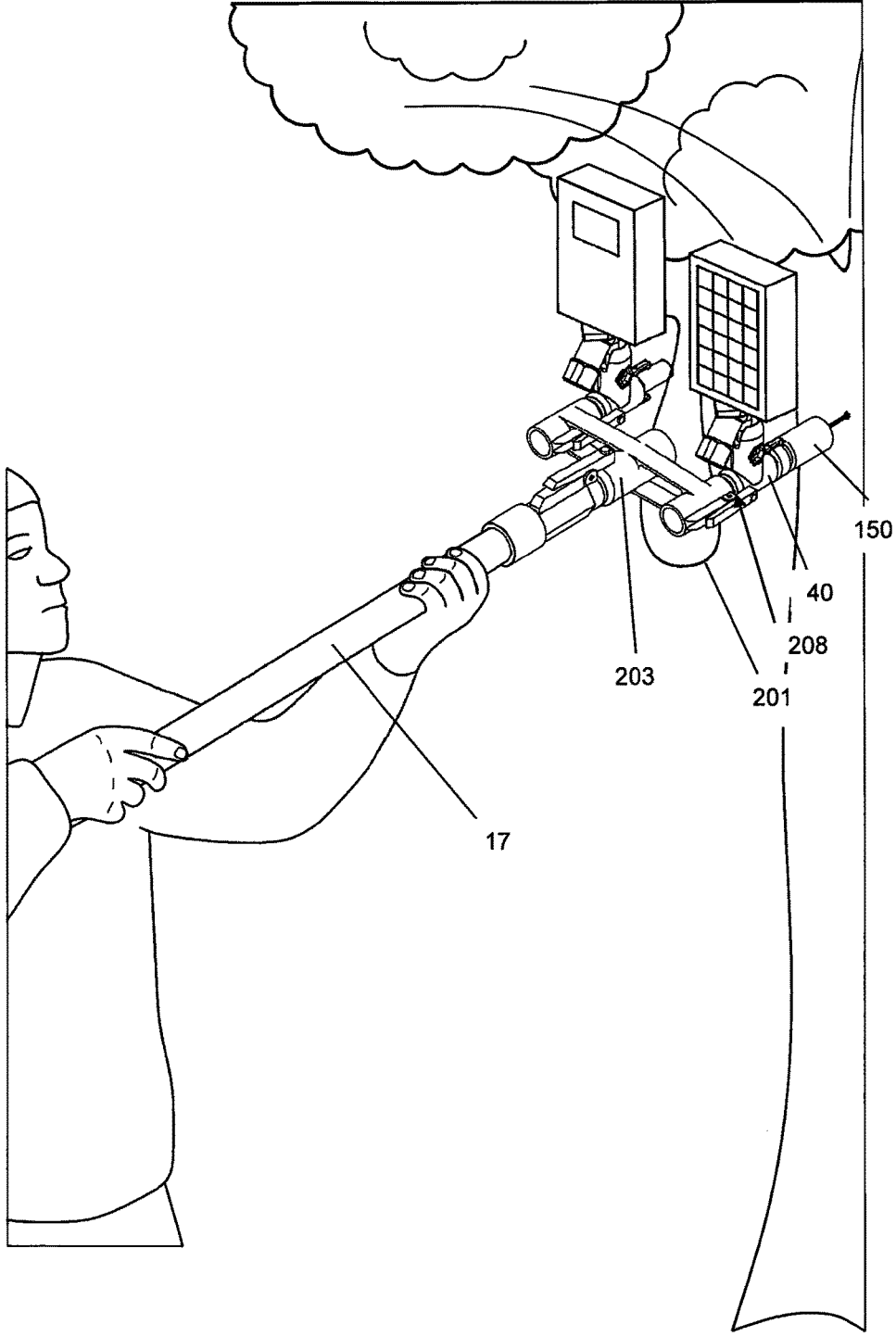

FIG. 39

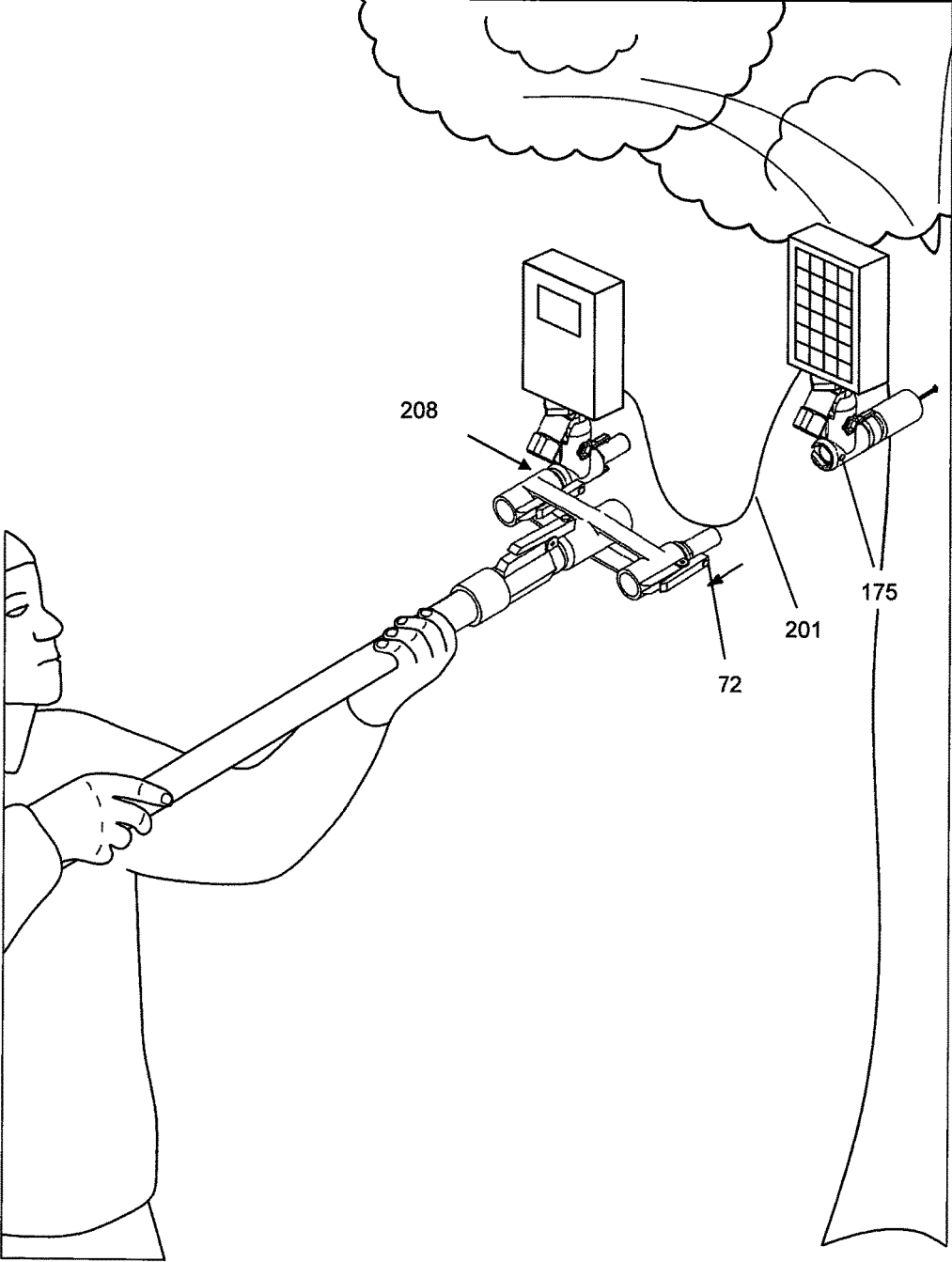

FIG. 40

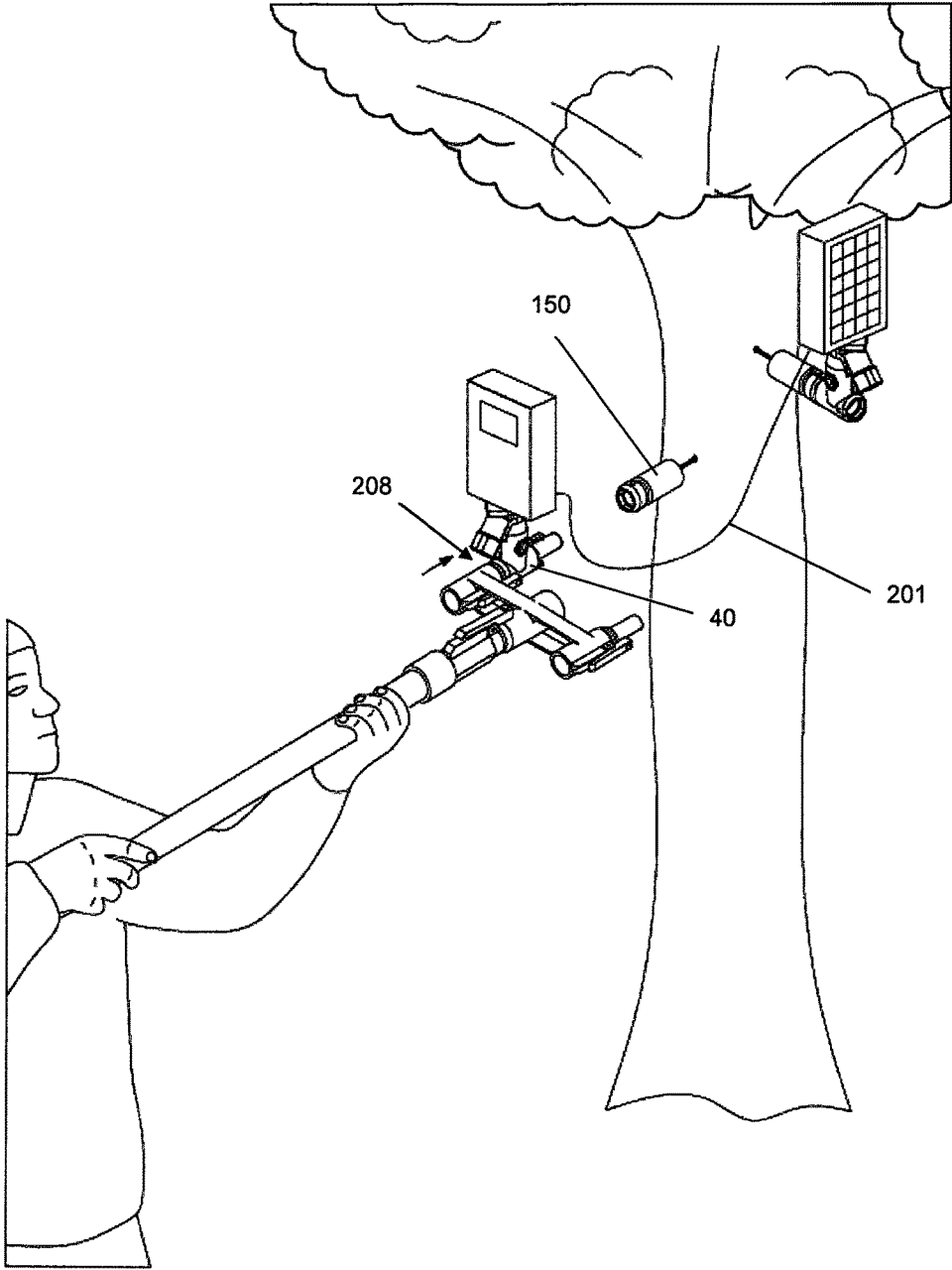

FIG. 41

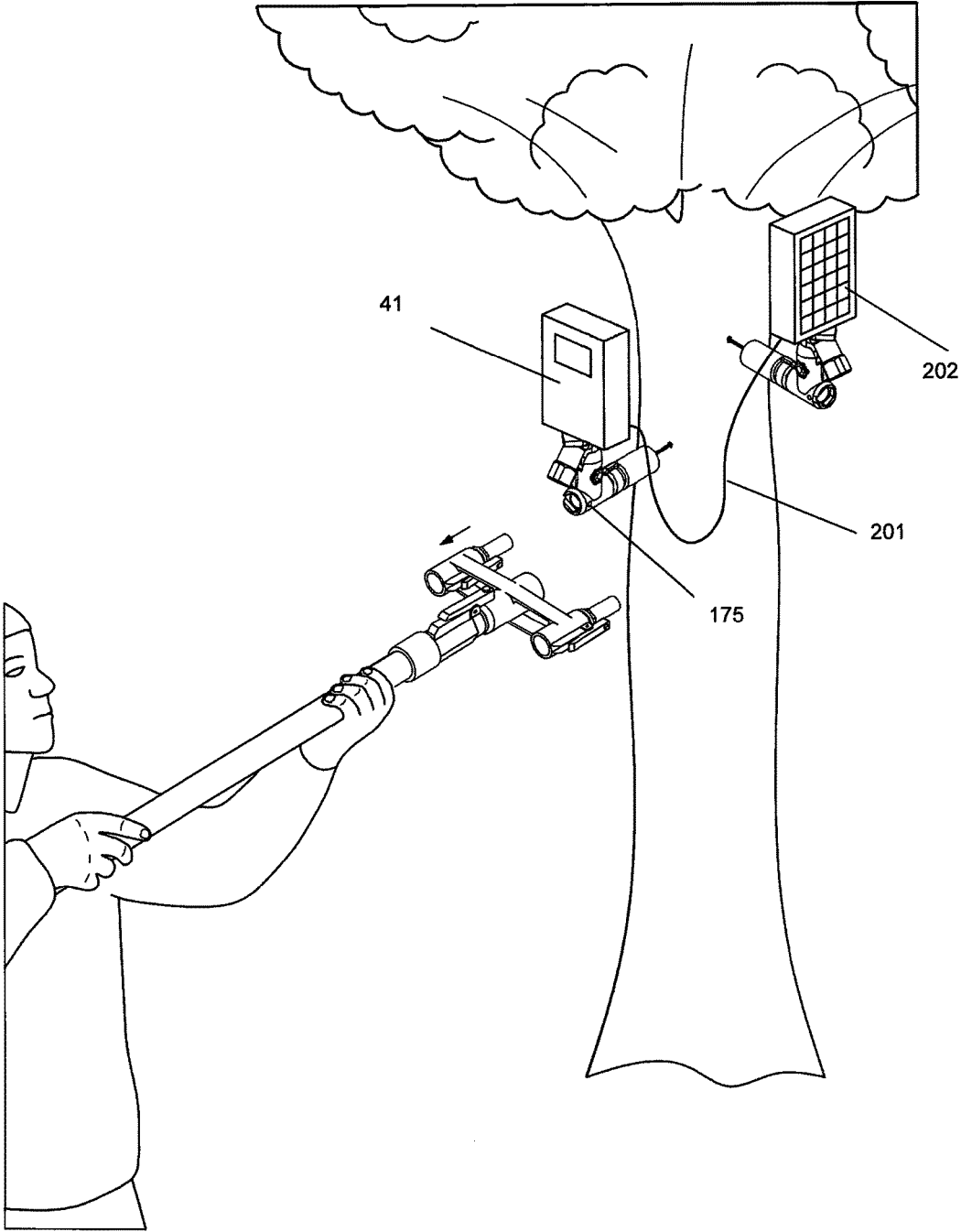

FIG. 42

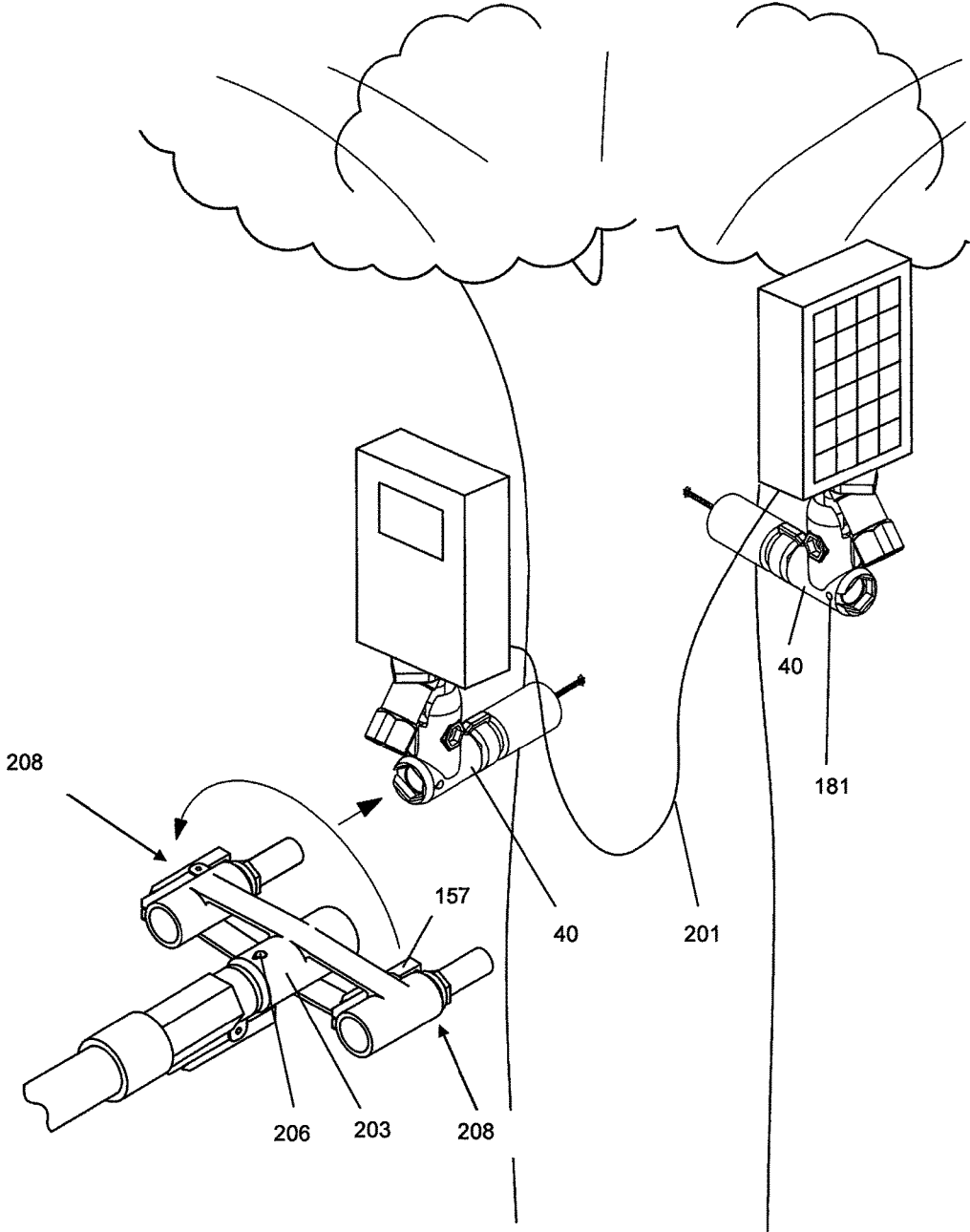
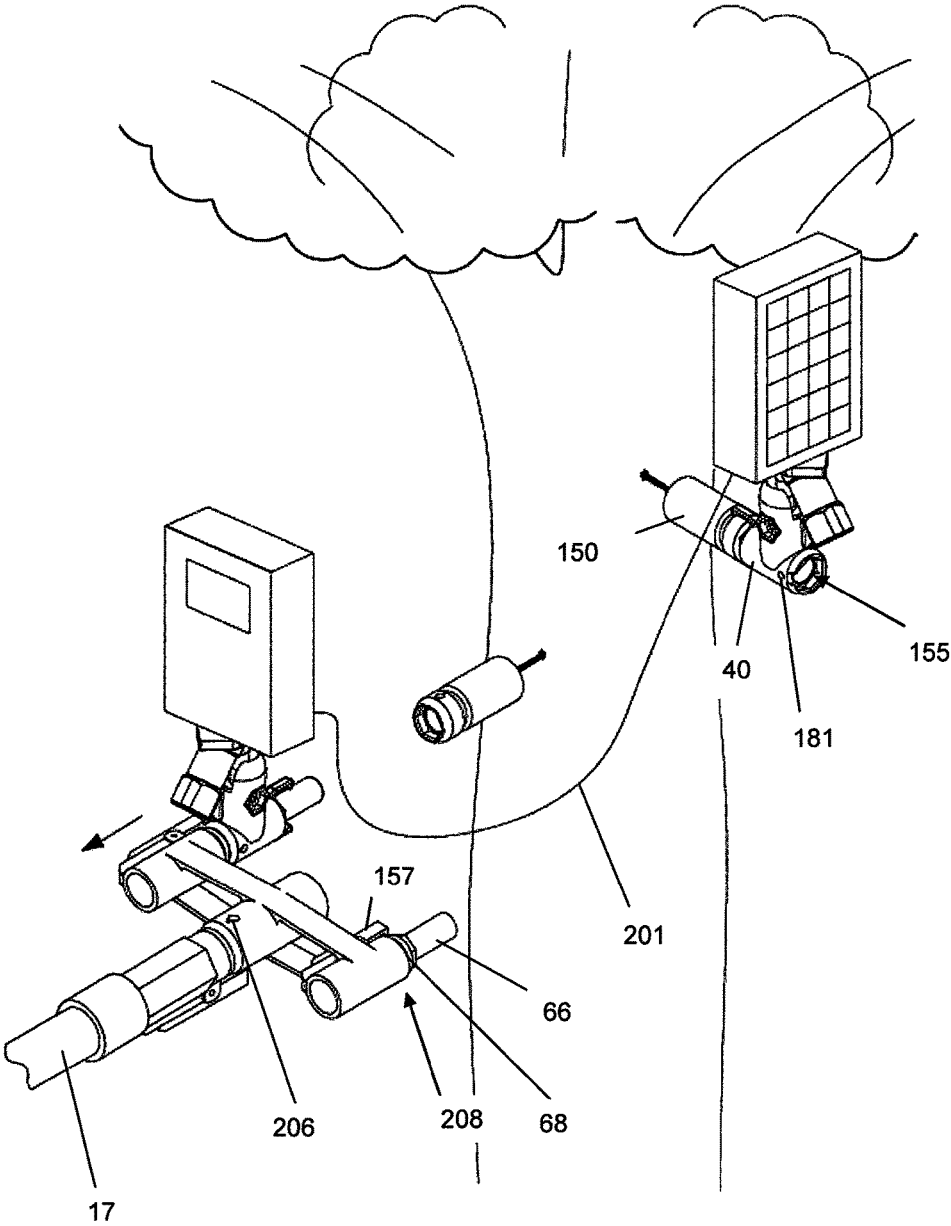

FIG. 43



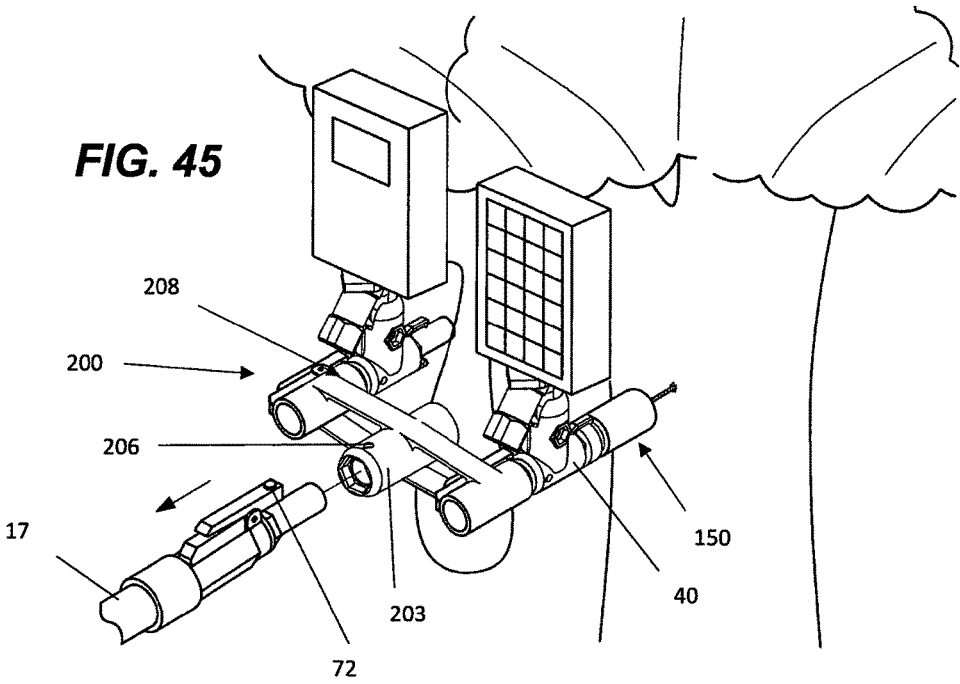
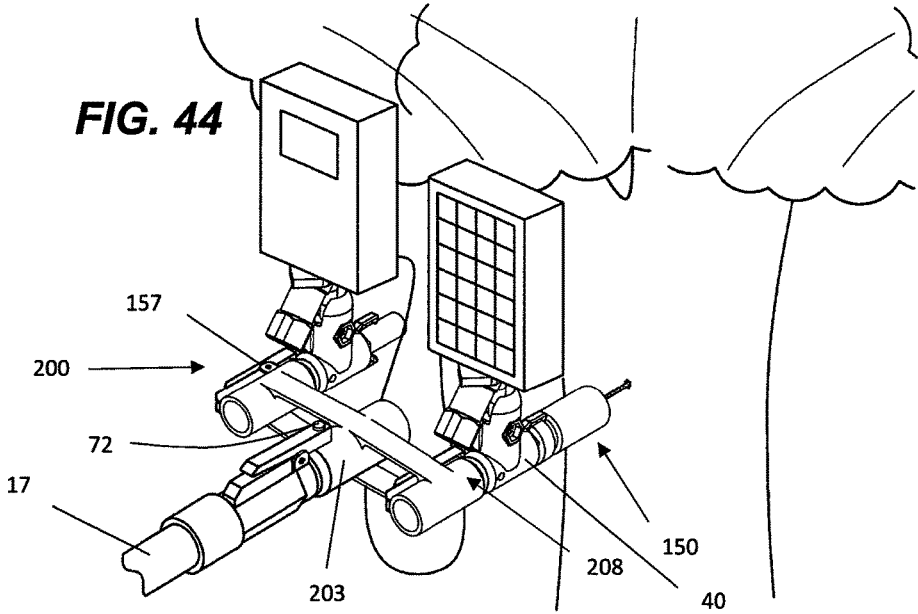
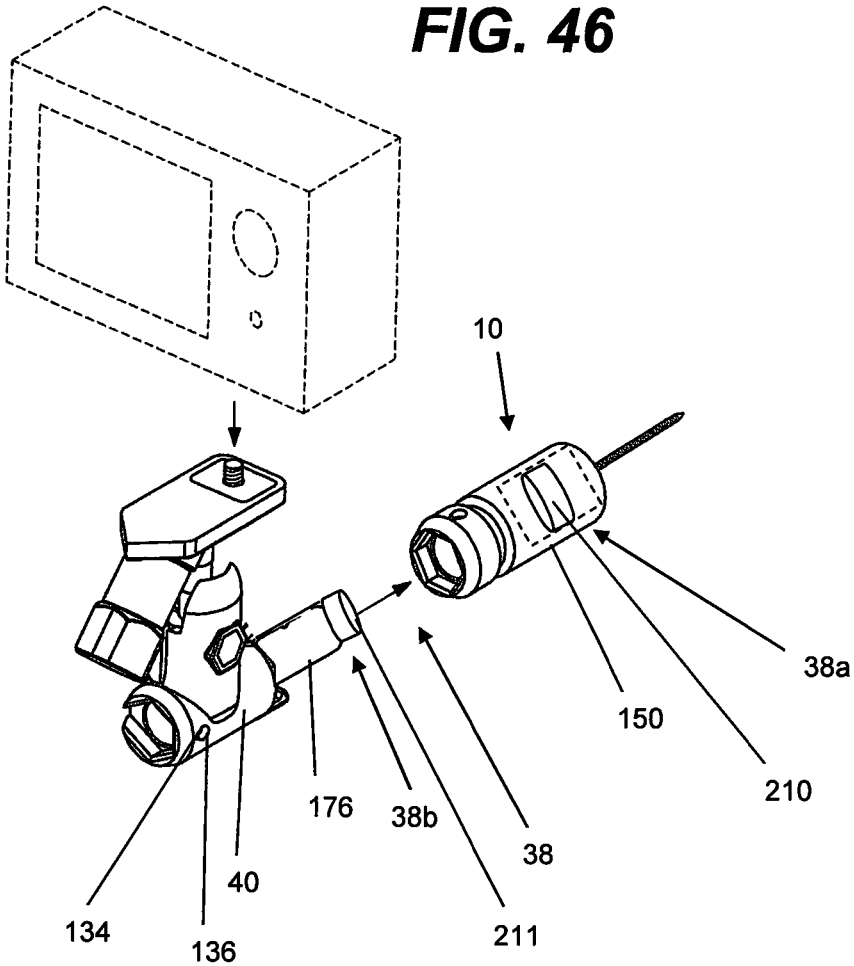

FIG. 46



TRAIL CAMERA MOUNTING SYSTEM**CROSS-REFERENCE TO RELATED APPLICATIONS**

[0001] This is a continuation-in-part of U.S. application Ser. No. 15/709,276 filed on Sep. 19, 2017, now pending, which is a continuation-in-part of U.S. Non-Provisional application Ser. No. 15/262,610, filed on Sep. 12, 2016, now pending, which application claims priority from U.S. Provisional Application No. 62/332,910, filed on May 6, 2016, and U.S. Provisional Application No. 62/217,653, filed on Sep. 11, 2015, the disclosures of which are hereby incorporated by reference in their entirety to provide continuity of disclosure.

STATEMENT REGARDING FEDERALLY SPONSORED RESEARCH OR DEVELOPMENT

[0002] Not applicable.

THE NAMES OF THE PARTIES TO A JOINT RESEARCH AGREEMENT

[0003] Not applicable.

REFERENCE TO SEQUENCE LISTING, A TABLE, OR A COMPUTER PROGRAM LISTING COMPACT DISC APPENDIX

[0004] Not applicable.

BACKGROUND OF THE INVENTION

[0005] Trail cameras expose the secrets of the wilderness to a curious man-kind. Hunters use trail cameras to identify game trails and wallows used by potential prey. Wildlife Biologists use trail cameras to track migration patterns and understand species population. Game Wardens use trail cameras to prevent poaching and the destruction of public land. Land owners use cameras for property surveillance and home security. Much of this information is often lost however because trail cameras are frequently stolen. Most trail cameras are placed at game height and are thus easily accessible. Placing a camera mount higher in a tree, out of reach, requires carrying a ladder deep into the woods and then making multiple trips up and down the ladder to aim the camera on the trail. Alternatively, one can shimmy up the tree while trying to carry and then position the delicate camera equipment. A number of trail camera mounting systems have been described (see, for example, U.S. Pat. Nos. 5,626,322; 5,669,592; and 7,975,973 B1, and U.S. Patent Application Publication Nos. 2003/0133708; 2008/0099655; and 2011/0116782, and UK Patent Application GB 2 445 173). Some of these systems have addressed the issue of theft yet none have described a system that can be installed and manipulated remotely. Extension rods and poles have been described to allow someone to extend a tool's reach and perhaps remotely trim a high tree branch (see, for example, U.S. Pat. Nos. 2,703,928; 2,986,054; 3,731,380; 4,607,974; 5,228,202; 5,288,161; 5,787,590; 7,721,391 B2; and 8,875,350 B2) but none have described placing and manipulating a tool or camera remotely.

[0006] A need remains for a trail camera mounting system that can be installed high into a tree without leaving the ground. The system should be easy to operate yet hold the equipment securely in the tree. Conveniently, the system

would allow for separate removal of the camera for maintenance. Furthermore, trail cameras have become more sophisticated. Some models of trail cameras require installation of multiple wire connected components such as solar collectors and antennae. As such, a need remains for a trail camera mounting system that is capable of installing multiple components high in a tree without leaving the ground. **[0007]** All patents, patent applications, provisional patent applications and publications referred to or cited herein, are incorporated by reference in their entirety to the extent they are not inconsistent with the teachings of the specification.

BRIEF SUMMARY OF THE INVENTION

[0008] One embodiment of the invention is a two-piece mounting system that can be manipulated high in a tree by an extension pole. A support attached to the tree connects to a utility bar which holds the camera. Each piece has a fitting that corresponds to a fitting on the extension pole that allows the pieces to be manipulated by the pole. A universal camera mount can be added to the utility bar to mount a trail camera. The universal camera mount is preferably mounted on a swivel so that an adjustment bar connected to the camera mount can be used to adjust the camera when mounted in the tree. The adjustment bar has a fitting that corresponds to the fitting on the extension pole.

[0009] In one embodiment, the support includes an auger that bores into a tree. The auger can be placed and turned to bore into the tree by the extension pole. Thus, the support is placed in the tree without having to climb into the tree. In another embodiment, the support includes a clamp that can be tightened around a tree branch. The clamp, like the auger, is placed in the tree without having to climb the tree. The jaws of the clamp are tightened around the tree branch from the ground by the extension pole. Another embodiment of the support of the mounting system of the subject invention includes a mounting plate. The plate can be attached to the side of a building. Although it is necessary to climb to attach the plate to a structure, the camera can be mounted to the plate, manipulated on the plate, and removed from the plate for maintenance by the extension pole without leaving the ground.

[0010] In other embodiments, lights or motion detecting lamps can also be mounted to the utility bar to illuminate camp or detect camp intruders. An aperture in an end of the utility bar receives a block and tackle that can be used to hoist loads from the ground. The hoist is useful for storing food away from bears or hanging game for processing.

[0011] In another preferred embodiment, the invention is comprised of an injection molded tree attachment, which is comprised of an auger tip screw at the distal end, and hexagon shaped receiving aperture at the proximal end. A cuff at the proximal receiving end of the tree attachment has a recess, which receives a spring loaded securing clasp. The hexagon shaped receiving end receives a correspondingly shaped distal end of an extension pole. The spring loaded securing clasp of the distal end of the extension pole simultaneously engages the cuff recess. Once the tree attachment is engaged on the distal end of the extension pole, the user can extend the pole and drive the tree attachment with auger tipped screw into a tree branch by rotating the extension pole clockwise. Once the tree attachment is placed in the tree, the remainder of the system can be mounted.

[0012] Once the tree attachment auger tip screw is driven a sufficient depth into the tree to achieve solid fixation, the

extension pole can be disengaged by the user by firmly pulling the extension pole away from the tree attachment. A detaching ramp of the cuff recess allows the extension pole securing clasp snap button to slide into and out of the cuff recess for installation and removal of the tree attachment. Once the tree attachment is placed in the tree, the remainder of the system can be mounted.

[0013] This embodiment is further comprised of a utility bar, which comprises a ball mount and a distal first end fitted with two tree attachment clasps, which provide a secure, but releasable capture means to secure the utility bar to the tree attachment. The tree attachment clasps clasp the ridge of the tree attachment receiving end cuff, which secures the utility bar to the tree attachment. Alternatively, the releasable capture means of the utility bar-support connection can be comprised of a magnetic disc disposed at the distal end of the utility bar, coupled with a corresponding magnet disposed on or within the support. The utility bar is further comprised of an upper camera mount ball housing and a ball mount cap, which house the camera mount ball. The camera mount ball housing and ball mount cap can be tensioned together to allow less or more movement of the camera mount ball. The tensioning means in this embodiment includes the use of a standard bolt installed through a corresponding hole in the camera mount ball housing and ball mount cap. A corresponding thumbscrew can then be tightened or loosened to allow movement of the camera mount ball to user preference.

[0014] The upper surface of the camera mount ball contains a hole, which accepts the camera mount post. Once the camera mount post is seated within the camera mount ball, the camera mount can be positioned to user preference. The top camera mounting surface of the camera mount is further comprised of a removable camera mount pad, which provides a level surface for camera mounting. A camera is mounted by utilizing the universal camera screw which protrudes upward from the camera mounting surface. A standard game camera can be mounted by first mounting a universal game camera bracket to said mounting surface with the camera mount screw. A game camera can then be mounted to the game camera bracket with standard mounting means.

[0015] Once the utility bar is ready for installation onto the tree attachment, the user inserts the distal post of the extension pole into the proximal receiving end of the so that the spring-loaded clasp and snap button of the distal extension pole engages the “install” recess of the proximal utility bar. The user can then extend the pole to install the utility bar onto the secured tree attachment. To install the utility bar, the user directs the distal end of the utility bar into the tree attachment receiving aperture until the tree attachment clasps engage the ridge of the tree attachment receiving end cuff.

[0016] Once the utility bar is installed onto the tree attachment, the user disengages the extension pole by firmly pulling the extension pole away from the utility bar. A recessed ramp of the “install” recess pit of the proximal utility bar allows the extension pole securing clasp snap button to slide into and out of the install recess pit for installation. The tree attachment clasps engage the tree attachment with more force than the longitudinal force generated when the extension pole clasp and snap button disengage from the “install” recess, thus allowing the utility bar to be retained on the tree attachment.

[0017] In another embodiment, the system is further comprised of a multi-mount adapter, which allows the user to install camera components requiring a wired connection such as a camera and solar collector, in different elevated locations to optimize placement of the components. To utilize the multi-mount adapter, the user installs two separate supports in the desired locations as previously described. Once the supports are installed, the user attaches the multi-mount adapter to the distal end of the extension pole via the complementary fittings. The user then attaches a utility bar to the first multi-mount adapter prong fitting, and a utility bar to the second multi-mount adapter prong fitting by engaging the corresponding multi-mount prong releasable capture means with the complimentary releasable capture means of each utility bar. The user then installs the utility bar onto the first support. Once the user disengages the extension pole from the first installed utility bar, the user can then install the second utility bar to the second support. The multi-mount adapter allows for the user to position a camera for optimal view, and a wire connected solar collector in a different position for optimal solar exposure. The multi-mount adapter can also be used to mount multiple components on one single support by utilizing the multi-mount adapter’s releasable capture means by disengaging the extension pole from the multi-mount adapter after the first utility bar is connected to the support.

[0018] Once the utility bar is secured onto the tree attachment, with mounted camera, the camera mount can be accurately aimed by using a laser attachment. Said laser attachment clips on to the distal end of the extension pole. A standard laser pen light is then placed in the pen light clasp and turned on. The distal end of the extension pole is then inserted into the proximal camera mount receiving end. The laser attachment with laser pen and mounted camera are then aligned so the projected laser dot shows the area where the camera will be recording. The user then manipulates the camera mount/laser attachment to achieve the desired recording area of the camera.

[0019] To remove the system, the user inserts the distal end post of the extension pole into the proximal utility bar receiver so the spring-loaded clasp of the extension pole clasps the “remove” recess pit of the proximal utility bar receiving end. The “remove” recess pit does not include a recess ramp, thus the extension pole spring loaded clasp cannot slide out of the “remove” recess pit. Therefore, the longitudinal force generated by the user by pulling the extension pole away from the utility bar, exceeds the holding capability of the tree attachment clasps, which allows the utility bar to disengage from the tree attachment.

[0020] To remove multiple components that were installed with the multi-mount adapter, the user simply configures the multi-mount adapter to engage the “remove” releasable capture means of the installed utility bars. The user can then remove the first utility bar utilizing the first dual mount prong. The user can then engage the second dual mount prong with the second utility bar to remove the wire connected camera components. If multiple components were installed on one tree attachment, the user can engage the “remove” releasable capture means of the multi-mount adapter with the extension pole fitting and disengage the connected utility bar from the support.

[0021] The tree attachment can be uninstalled from the tree by the user inserting the distal end post of the extension pole into the proximal receiving aperture of the tree attach-

ment so the spring-loaded clasp of the extension pole clasps the tree attachment cuff recess pit. The extension pole is then rotated counterclockwise to unscrew the auger tip from the tree.

[0022] In another embodiment, the proximal end of the extension pole accepts a drill attachment. Said drill attachment can receive any standard powered drill. Said drill can then be used to turn the extension pole clockwise during installation of the tree attachment, or counterclockwise for uninstalling the tree attachment.

BRIEF DESCRIPTION OF THE SEVERAL VIEWS OF THE DRAWINGS

[0023] FIG. 1 is an environmental view of a preferred embodiment of the mounting system of the subject invention.

[0024] FIG. 2 is a side elevational view of the preferred embodiment shown in FIG. 1.

[0025] FIG. 3 is a rear isometric view of another preferred embodiment of a support of the mounting system of the subject invention.

[0026] FIG. 4 is side elevational view of a preferred embodiment of a support of the mounting system of the subject invention.

[0027] FIG. 5 is a rear isometric view of another preferred embodiment of a support of the mounting system of the subject invention.

[0028] FIG. 6 is a rear isometric view of a preferred embodiment of a releasable capture means of the mounting system of the subject invention.

[0029] FIG. 7 is a rear isometric view of a preferred embodiment of a utility bracket of the mounting system of the subject invention.

[0030] FIG. 8 is a front isometric partial exploded view of another preferred embodiment of the mounting system of the subject invention.

[0031] FIG. 9 is a front isometric exploded view of another preferred embodiment of the mounting system of the subject invention.

[0032] FIG. 10 is a rear isometric partial exploded view of the support and utility bar connection of the preferred embodiment shown in FIG. 9.

[0033] FIG. 11 is a rear isometric partially exploded view of another preferred embodiment of the mounting system of the subject invention.

[0034] FIG. 12 is a front isometric exploded view of the support and utility bar connection of the mounting system shown in FIG. 11.

[0035] FIG. 13 is side elevational view of a preferred embodiment of a drill adapter for use with the mounting system of the subject invention.

[0036] FIG. 14 is side elevational view of a preferred embodiment a saw blade for use with the mounting system of the subject invention.

[0037] FIG. 15 is a rear isometric view of a preferred embodiment of a connector to connect two extension poles to one another.

[0038] FIG. 16 is an environmental perspective view of a preferred embodiment of the invention installed in a tree.

[0039] FIG. 17 is an environmental perspective view of a preferred embodiment of the invention installed in a tree with optional universal game camera bracket.

[0040] FIG. 18 is an environmental perspective view of a user installing the tree attachment of a preferred embodiment of the subject invention.

[0041] FIG. 19 is an environmental perspective view of a user installing the ball mount/camera mount to the tree attachment of a preferred embodiment of the subject invention.

[0042] FIG. 20 is an environmental perspective view of a user detaching extension pole from ball mount after installing the ball mount/camera mount to the tree attachment of a preferred embodiment of the subject invention.

[0043] FIG. 21 is a side elevational view of the distal extension pole engaging ball mount receiving aperture and "install" recess pit with recessed ramp.

[0044] FIG. 22 is a side elevational view of installation of ball mount on to proximal tree attachment.

[0045] FIG. 23 is a side elevational view of the distal extension pole engaging ball mount receiving aperture and "remove" recess without recessed ramp.

[0046] FIG. 24 is a side elevational view of removal of ball mount from proximal tree attachment.

[0047] FIG. 25 is a side elevational view demonstrating releasable capture means of distal extension pole and tree attachment.

[0048] FIG. 26 is a side elevational view showing releasable capture means engaged for installation of tree attachment.

[0049] FIG. 27 is a side elevational view of proximal extension pole drill attachment.

[0050] FIG. 28 is a side elevational view of proximal extension pole drill attachment turning tree attachment to bore auger tip into tree.

[0051] FIG. 29 is a perspective view of direct camera mounting on camera mount with mounting screw and attachment means of ball mount to tree attachment.

[0052] FIG. 30 is a perspective view of camera mounted on subject invention and ball mount installed on tree attachment.

[0053] FIG. 31 is a perspective view of universal game camera mounting bracket mounted on subject invention and attachment means of ball mount to tree attachment.

[0054] FIG. 32 is a perspective view of game camera mounted on universal game camera mounting bracket mounted on subject invention and ball mount installed on tree attachment.

[0055] FIG. 33 is an environmental perspective view of saw blade attachment in use with extension pole.

[0056] FIG. 34 is an environmental perspective view of laser attachment and manipulation of camera mount to aim camera to desired recording area.

[0057] FIG. 35 is a perspective view of the distal extension pole, multi-mount adapter and utility bar.

[0058] FIG. 36 is a perspective view of the distal extension pole, multi-mount adapter and utility bar connected and ready for installation.

[0059] FIG. 37 is an environmental view of user utilizing multi-mount adapter to install multiple components.

[0060] FIG. 38 is an environmental view of user connecting first utility bar to first tree attachment with multi-mount adapter.

[0061] FIG. 39 is an environmental view of user disengaging extension pole multi-mount adapter from first utility bar connected to tree attachment.

[0062] FIG. 40 is an environmental view of user connecting second utility bar to second tree attachment.

[0063] FIG. 41 is an environmental view of user disengaging extension pole and multi-mount adapter from second utility bar connected to tree attachment.

[0064] FIG. 42 is an environmental view of 180 degree rotation of multi-mount adapter in uninstalled configuration.

[0065] FIG. 43 is an environmental view of removal of utility bar from tree attachment with multi-mount adapter.

[0066] FIG. 44 is an environmental view of installation of multiple components onto one tree attachment with multi-mount adapter.

[0067] FIG. 45 is an environmental view of disengaging extension pole from multi-mount adapter installed onto one tree attachment.

[0068] FIG. 46 is a perspective view of magnetic releasable capture means with cutaway view of support magnetic connector.

DETAILED DESCRIPTION OF THE INVENTION

[0069] One embodiment of the invention involves a two-piece mounting system for a trail camera. Each piece is placed by an extension pole so the mount can be placed high into a tree. A support attaches to the tree. A utility bar connects to the support through a releasable capture means and holds a universal camera mount on a swivel with an adjustment bar.

[0070] The support of the two-piece mounting system of the subject invention has a fitting that corresponds to a fitting on the utility bar and the extension pole. This allows some embodiments of the support to be placed remotely using the extension pole. The fittings allow the utility bar to be placed on the support and manipulated remotely by the extension pole in all embodiments of the subject mounting system.

[0071] The support 10 has an anchoring means to attach the support to a surface. In a preferred embodiment, the anchoring means is an auger 12 that bores into a branch attaching the support to a tree. A support fitting 14 is on one end of the support opposite the auger. The support fitting 14 corresponds to a pole fitting 16 on the extension pole 17 which is used to drive the auger into the tree. The corresponding fittings can be any shape or configuration, it is only necessary that they possess the strength and stability to manipulate the mounting system pieces remotely. In an exemplified embodiment, the support fitting on the auger is a square tubular rod 18. The support fitting is inserted into a square companion fitting 114 of the extension pole fitting 16 (FIG. 8). The square shape allows the extension rod connected to the auger through the fitting to be twisted to drive the auger into the tree. In the embodiment shown in FIG. 8, the pole fitting 114 is created by an adapter 106 added to the end of the pole. The square companion fitting 114 receives the square rod 18 while a cup 116 near the top of the adapter 106 has divots 118 to accept the flattened heads of pins of the releasable attachment means described below. A spring tension ball 115 holds the square tubular rod 18 in the adapter 106 until sufficient downward force is applied to pull the fittings apart. The pole fitting 16 need not however be created by an adapter and can be a part of the pole (FIGS. 9 and 11). In the embodiment shown in FIGS. 1 and 2, the material, powder coated steel, and length of the fitting contribute to the needed strength of the fitting in this embodiment. Fittings can also be made of plastic or com-

posite. It would be apparent to one skilled in the art how to choose the proper configuration and materials for a fitting that possesses the necessary qualities to allow manipulation of system pieces by the extension pole. FIGS. 13, 27, and 28 show a drill adapter 120 to assist in driving the pieces of the subject invention. The drill adapter has a shank 122 and a drill adapter fitting 124 like the pole fitting 16. One skilled in the art would likewise understand that anticipating using a power drill with the subject system may require adjustment in the choice of material used for system components as well as choosing the size and shape of the fitting. The drill adapter shown in the exemplified embodiment hooks to the extension pole fitting allowing the drill to be used when placing the support remotely.

[0072] Pieces of the subject mounting system can be made of not only steel, but aluminum, plastics, or composites. The fittings can include adapters 106 made to convert available extension poles for use with the subject invention (FIG. 8) or the fittings on system pieces can be configured to complement the fittings on available poles (FIG. 12). Additionally, connectors can be used to connect two extension poles together allowing the subject system to be mounted higher in a tree.

[0073] In another preferred embodiment, a clamp 22 can be used as the anchoring means of the support of the two-piece mounting system of the subject invention (FIG. 4). The support fitting 14 is rigidly connected to a threaded bolt 24 that pulls the jaws 26 of the clamp together as the fitting is turned by the extension pole. Bar 28 keeps the jaws of the clamp in alignment as they are being drawn together. A stabilizing rod 29 captures the branch and prevents the clamp from spinning about the branch as the jaws are being tightened. Using the jaws to mount the system prevents the need to bore a deep, potentially damaging, and destabilizing hole into the tree branch.

[0074] Another preferred embodiment of the support for the two-piece mounting system of the subject invention is shown in FIG. 3. In this embodiment, the support includes a mounting plate 30. The plate has a support fitting 14 affixed to the plate to which the utility bar is mounted. In the exemplified embodiment, the plate has a back 32 used to attach the plate to the structure and a platform 34. The back has holes 36 so that the plate can be mounted to a vertical structure such as a building. In this embodiment, one must climb a ladder to position the plate. After the plate is attached to the building however the camera can be placed, positioned, and maintained from the ground using the extension pole.

[0075] The support also contains part of the releasable capture means 38 that connects the support 10 to the utility bar 40. An advantage of the two-piece system of the subject invention is that the utility bar can be released from the support. Therefore, anything attached to the utility bar, for example, a trail camera 41, can be brought down to check its condition or change its battery without having to remove the entire system from the tree. The support releasable capture means 38a captures and holds the complementary utility bar releasable capture means 38b during installation of the system and is releasable for uninstallation of the system. In one exemplified embodiment, the releasable capture means 38 is a simple spring-loaded twist-to-lock system. The support releasable capture means 38a is comprised of a support plate 42, which has pins 44 with flattened heads 46, for example, screw heads, protruding from the support plate

42 toward the corresponding fitting of the utility bar 40, which comprises the utility bar releasable capture means 38b. (FIG. 7). In this embodiment, the utility bar releasable capture means 38b is comprised of a utility bar plate 48, which has openings 50 to receive the flattened heads 46 that taper (FIG. 8) as the heads move within the openings 50 to hold the flattened heads to the utility bar plate 48 once received. A spring (not shown) provides the pressure to hold the flattened heads 46 in place and to connect the utility bar 40 to the support 10. In the exemplified embodiment, the support plate 42 has protruding pins with flattened heads 46 and is located on the support 10 while the utility bar plate with the openings 50 is located on the utility bar 40. It should be apparent however that this embodiment of the releasable capture means 38 would work equally as well if the position of each piece was reversed. This situation is likewise applicable for any of the releasable capture means discussed. In the present exemplified embodiment of the utility bar 40, the end opposite of the utility bar plate 48 has a utility bar fitting 52 that receives the extension pole fitting 16, the pole turns the utility bar 40 to capture the flattened heads 46 in the tapered ends of the openings 50. A preferred embodiment of the tapered openings 50 of this embodiment has a recessed shoulder so that the screw heads locked in the opening will be flush with the surface of the plate.

[0076] FIGS. 5 and 12 show another preferred embodiment of a releasable capture means 38 of the mounting system of the subject invention. In this embodiment, the releasable capture means 38 is a bayonet-type connection where the support releasable capture means 38a is comprised of a stub 54, which accepts a corresponding socket 56, which comprises the utility bar releasable capture means 38b. The stub 54 has grooves 58 that engage knobs 60 in the socket 56 (FIG. 12). The knobs 60 move along the grooves 58 as the stub 54 is twisted in the socket 56. In the exemplified embodiment, the grooves have an incline 61 that draws the stub 54 into the socket as it is twisted. The grooves terminate in a recess 63 as the grooves turn slightly back toward the entry of the grooves to lock the knobs 60 in the terminus of the grooves 58. The stub or socket can also be spring-loaded to assist in securing the stub within the socket. In this preferred embodiment, the stub 54 is located on the support 10 and accepts the corresponding socket 56, located on the utility bar 40. It should be apparent however that this embodiment of the releasable capture means 38 would work equally as well if the position of each piece was reversed.

[0077] Another preferred embodiment of the releasable capture means 38 used to connect the support 10 to the utility bar 40 of the mounting system of the subject invention is shown in FIG. 6. In this embodiment, the utility bar releasable capture means 38b is comprised of a spring-loaded clamp 64, which captures and holds a ball 62. The ball 62 comprises the support releasable capture means 38a. In FIG. 6 the ball 62 is connected to the support 10 and receives the clamp, which is connected to the utility bar. It would be apparent to one skilled in the art however that the means would work equally as well if the ball were on the utility bar and the clamp was on the support. It is also noted that in FIG. 6 the support fitting 14, and utility bar fitting 52 receive a square rod, the converse of FIG. 2, further illustrating that the positioning of the parts of the releasable

capture means as well as the parts of the complementary fittings can be reversed and still function within the subject mounting system.

[0078] FIGS. 9 and 10 show another preferred embodiment of the releasable capture means 38 of the subject mounting system. In this embodiment, the means mimics the fitting configuration of an available extension pole 17 shown in FIGS. 9 and 11. The distal end of the extension pole 17 fitting has a post 66 with a hexagonal neck 68 at its base. The post 66 is received by the complementary support fitting 8 and utility bar fitting 9, the neck 68 dropping into a hexagonal recess 70 in that fitting. A snap button 72 engages a utility bar collar 74 to hold the utility bar fitting 9 together. Likewise, the releasable capture means 38 connecting the utility bar 40 to the support (shown in FIGS. 9 and 10) includes a utility bar post 67 with a hexagonal neck 69 which drops into a complementary support fitting 8 with a hexagonal recess 71. A snap button 73 engages a collar 75 to hold the releasable capture means 38 together. The support releasable capture means 38a is comprised of a support fitting 8 with a hexagonal recess 71, and a collar 75. The utility bar releasable capture means 38b is comprised of a utility bar post 67 with a hexagonal neck 69, and a snap button 73, which engages the collar 75 of the support releasable capture means 38a. It may be necessary for the snap buttons 72, 73 to yield under different pressure since the snap button on the extension pole 17 is used to place the mounting system pieces and then be removed while the configuration used as a releasable capture means 38 connecting the utility bar 40 to the support 10 must maintain its connection after the pole is removed. Differing the pressure or yield angles on the collar are used to customize the release of the various snap buttons.

[0079] One skilled in the art would understand that a number of releasable capture means could be used on the subject invention. In an alternative embodiment, a releasable capture means includes a lever pivotally connected through a wall of the auger. The lever engages the spring-loaded fitting as it enters the end of the auger. To release the connection, a tab on the lever is pulled or pushed and the pieces are separated.

[0080] In yet another preferred embodiment of the releasable capture means 38 the support releasable capture means 38a is comprised of a first magnetic connector 210 disposed upon or within the support 10 tree attachment 150 and the utility bar releasable capture means 38b comprising a corresponding magnetic connector 211 disposed on the distal end 176 of the utility bar 40 as shown in FIG. 46.

[0081] The utility bar 40 connects to the support 10 by releasable capture means 38. The utility bar 40 can have a fitting at one end configured to engage the complementary fitting end of the support 10. The fitting end of the support 10 also contains part of the releasable capture means 38. A fitting to engage the extension pole 17 is disposed at the other end of the utility bar.

[0082] The utility bar 40 is used to mount accessories to the subject system. In FIG. 2 a bracket 76 positioned along the utility bar to which an accessory can be mounted. The system is used primarily as a trail camera mounting system that allows the user to mount a trail camera 41 high above the trail so it will not interfere or be detected by wildlife and also so it is out of the reach of thieves. One skilled in the art would realize that there are a number of camera mounts that can be used with the subject system. A preferred camera

mounting system includes a universal camera mount **78** atop a swivel **80**. The swivel allows the camera's angle to be adjusted so that the camera can capture movement from any set angle. Another embodiment that provides movement to the camera mount **78** is the U-bracket **82** shown in FIG. 7. An adjustment bar **84** on the camera mount allows the camera to be positioned after it is in the tree. The adjustment bar **84** has an adjustment bar fitting **86** that corresponds to the pole fitting **16**. Once positioned in the tree, the extension pole can be used to aim the camera where desired. To further assist in aiming the camera, a laser or other aiming device can be mounted on or near the camera and the laser can be used to determine the position of the camera's focus. The aiming device can be associated with mounting system pieces, for example the extension pole. Alternatively, the laser can clip to the camera or a clip can be provided to receive the laser.

[0083] FIG. 8 shows a sphere **90** mounted on the utility bar **40**. The sphere can be used with and received by a variety of camera mounts to allow full adjustability and positioning of the camera. While an adjustment bar with a universal camera mount could be mounted directly to the ball, the hook-up **94** shown in FIG. 8 can be used to connect the adjustment bar **84** to the utility bar to provide a stout mount that can be fully manipulated. The hook-up **94** receives the sphere **90** on the utility bar and a sphere **92** on the adjustment bar. This configuration provides full movement of a camera mounted on the device as device pieces move about the spheres. The adjustment bar in this embodiment is configured to support a camera with either a bottom camera mount or a back-camera mount (FIG. 8). The adjustment bar **84** platforms **98**, **100** on the top of the bar and on the bottom of the bar, respectively, to receive and support universal camera mounts including camera quick shoes. Other adjustable interfaces by which the camera can be mounted to the utility bar that provide full camera positioning include, but are not limited to, a flex arm **110** (FIG. 10) and an arm with meshed hinge compression style connections **112** (FIG. 12).

[0084] It is noted that although the subject mounting system is described for mounting a trail camera, the system can be used to mount other items. For example, flood lights can be mounted to the utility bar to illuminate an outdoor work area. Motion sensing lights can be mounted to illuminate a campsite and make late night relief trips into the bushes less dangerous. A rail **102** inserted into an aperture in the utility bar can support a block and tackle to allow the system to be used to hoist a load off the ground. The hoist does not interfere with the utility bar and thus the hoist can be used while a camera or light is in place.

[0085] In the exemplified embodiments, the extension pole **17** is one piece. It is noted however that the pole can telescope to reach and place the mounting system higher. Further, several poles can be connected together to create a longer pole. The telescoping connection and the pole need only be rigid enough to manipulate the pieces when assembling the system. FIG. 15 shows a preferred embodiment of a connector **140** that can be used to join two extension poles to one another. One end of the connector **128** is affixed to an end of one extension pole **130** opposite the pole fitting. The connector fitting end **132** of the connector engages the extension pole fitting **16** of a second extension pole. It is noted that in this embodiment the fitting that complements the fitting on the extension pole has a ramp **134** entering a pit **136** that is engaged by the snap button **72** on the

extension pole **17** unlike the embodiment shown in FIG. 9 where the snap button **72** engages a collar **74**. FIG. 11 shows an alternative embodiment in which the snap button **72** engages a pit **136**.

[0086] To mount the subject system a tree or tree part of suitable strength is chosen to support the system. A knife or saw **108** can be adapted to the fitting in the extension pole to allow the user to clear brush and prepare the area to mount the system (FIGS. 14 and 33). The support, with an auger anchoring means, for example, is then inserted into the extension pole. The auger is raised to the branch with the extension pole and driven into the branch by turning the extension pole. Once the auger is seated in the branch, the extension pole is removed. Any desired accessory is attached to the utility bar. The utility bar is inserted into the extension pole. The utility bar is connected to the auger by the releasable capture means. The extension pole is removed. At any time, the utility bar and its attached accessory can be removed for maintenance and replaced. To remove the system, the extension pole is raised to engage the fitting end of the utility bar and the utility bar is released from the auger by disconnecting the capture means and lowering it from the tree. The extension pole is then used to loosen the auger from the tree.

[0087] In another preferred embodiment, shown in FIGS. 16-34, the support **10** is comprised of an injection molded tree attachment **150**, a utility bar **40**, comprising a ball mount **151**, and camera mount **152**. The system is installed by using an extension pole **17** with releasable capture means. Once installed, a camera **41** can be accurately aimed by using a laser attachment **153** and standard laser pen light **154**. This system is further comprised of a saw **108** attachment, which can be used to clear branches from the installation area of the tree being utilized.

[0088] The injection molded tree attachment **150**, is comprised of an auger **12** tip screw at the distal end, and hexagon shaped receiving recess **155** at the proximal end. A cuff **156** at the proximal receiving end of the tree attachment **150** contains a pit **136**, which receives snap button **72** disposed on the distal portion of the spring loaded securing clasp **157** located at the distal end of the extension pole **17**. FIGS. 25-26. Said snap button **72** engages said pit **136** by entering the pit via a recessed ramp **134**. The hexagon shaped receiving recess **155** receives a post **66** with correspondingly shaped hexagonal neck **68** at its base. The snap button **72** of the spring loaded securing clasp **157** of the distal end of the extension pole **17** simultaneously engages the cuff **156** pit **136**. Once the tree attachment **150** is engaged on the distal end of the extension pole **17**, the user can extend the pole and drive the tree attachment with auger **12** tipped screw into a tree branch by rotating the extension pole clockwise as shown in FIGS. 18 and 26. Once the tree attachment **150** is placed in the tree, the remainder of the system can be mounted.

[0089] Once the tree attachment **150** auger **12** tip screw is driven a sufficient depth into the tree to achieve solid fixation, the extension pole **17** can be disengaged by the user by firmly pulling the extension pole away from the tree attachment **150**. The ramp **134** of the cuff **156** pit **136** allows the snap button **72** to slide out of the pit **136** thus disengaging the extension pole **17** from the installed tree attachment **150**.

[0090] This embodiment is comprised of a utility bar **40**, where the distal end comprises the utility bar releasable

capture means **38b** and is fitted with two tree attachment clasps **158**, which provide a secure, but releasable capture means **38** to secure the utility bar **40** to the support releasable capture means **38a** of the tree attachment **150**. The support releasable capture means **38a** are comprised of tree attachment clasps **158**, which clasp the shelf **159** formed by the receiving end cuff **156**, and tree attachment neck **160** which secures the utility bar **40** to the tree attachment **161** as shown in FIG. **23**.

[0091] In an alternative embodiment, As shown in FIG. **46**, the releasable capture means **38** is achieved by a magnetic connection. In this embodiment, the support releasable capture means **38a** is comprised of a first magnetic connector **210** disposed upon or within the tree attachment **150** and a corresponding utility bar releasable capture means **38b** comprised of a second magnetic connector **211** disposed on the distal end **176** of the utility bar **40**. Once the utility bar **40** and tree attachment **150** are connected by the magnetic releasable capture means **38**, the user then disengages the extension pole **17** from the utility bar **40**. The magnetic connection of the releasable capture means **38** is strong enough to withstand the longitudinal force exerted upon the utility bar **40** during disengagement of the extension pole **17** from the utility bar install ramp **134** and pit **136**, but able to disengage when the extension pole is engaging the “remove” recess pit **181** for disconnecting the system.

[0092] The utility bar **40** is further comprised of a ball mount **151**, an upper camera mount ball housing **162** and a ball mount cap **163**, which house the camera mount ball **164**. The camera mount ball housing **162** and ball mount cap **163** can be tensioned together to allow less or more movement of the camera mount ball **164**. The tensioning means in this embodiment includes the use of a standard bolt **165** installed through a corresponding hole in the camera mount ball housing **162** and ball mount cap **163**. A corresponding thumbscrew **185** can then be tightened or loosened to allow movement of the camera mount ball **164** to user preference.

[0093] The upper surface of the camera mount ball **164** contains a hole, which accepts the camera mount post **166**. Once the camera mount post **166** is seated within the camera mount ball **164**, the camera mount **152** can be positioned to user preference. The top camera mounting surface **167** of the camera mount **152** is further comprised of a removable camera mount pad **168**, which provides a level surface for camera mounting. A camera **41** is mounted by utilizing the universal camera screw **169** which protrudes upward from the camera mounting surface **167**. A standard game camera **41** can be mounted by first mounting a universal game camera bracket **170** to said mounting surface with the camera mount screw **169**. A game camera can then be mounted to the game camera bracket **170** with standard mounting means available on game cameras.

[0094] Once the utility bar **40** is ready for installation onto the tree attachment **150**, the user inserts the post **66** of the distal end of the extension pole **17** into the proximal receiving end **172** of the utility bar **40** as shown in FIG. **21**. The extension pole’s hexagonal neck **68** fully engages the utility bar hexagon receiving recess **174**. Simultaneously, snap button **72** of the spring-loaded clasp **157** of the distal extension pole engages the “install” recess pit **175** of the proximal utility bar. The user can then extend the pole to install the utility bar **40** onto the secured tree attachment as shown in FIG. **19**. To install the utility bar **40**, the user directs the distal end **176** of the utility bar into the tree

attachment **150** hexagon receiving recess **155** until the distal hexagonal neck **177** of the utility bar is fully engaged. Simultaneously, the tree attachment clasps **158** engage the shelf **159** formed by the receiving end cuff **156**, and tree attachment distal neck **160** which secures the utility bar **40** to the tree attachment **161** as shown in FIG. **22-23**.

[0095] Once the utility bar **40** is installed onto the tree attachment **150**, the user disengages the extension pole **17** by firmly pulling the extension pole away from the utility bar **40** as shown in FIG. **20**. The ramp **134** of the utility bar “install” recess pit **175** allows the extension pole snap button **72** to slide out of the utility bar “install” recess pit **175** because the tree attachment clasps **158**, clasp the tree attachment shelf **159** with more force than the longitudinal force generated when the extension pole snap button **72** clasp is disengaged from the utility bar “install” recess pit **175**, thus allowing the utility bar to be retained on the tree attachment **150**.

[0096] In another embodiment, the system is further comprised of a multi-mount adapter **200** (FIGS. **35-45**), which allows the user to install camera components requiring a wired connection **201** such as a camera **41** and solar collector **202**, in different elevated locations. The multi-mount adapter **200** is comprised of a central extension pole receiver fitting **203**, which is configured similar to the utility bar fitting. The extension pole receiver fitting **203** receives the distal post **66** of the extension pole **17** fitting **16** by accommodating the hexagonal neck **69** of the extension pole within the hexagonal recess **204** of the central receiver fitting **203**. The central extension pole receiver fitting **203** is further comprised of a snap button engaging pit **205** located on the top of the central receiver **203** fitting and a ramped snap button pit **206** located on the bottom side of the central receiver fitting **203**.

[0097] The multi-mount adapter **200** is further comprised of a plurality of arms **207** which protrude outward from the central receiver fitting **203**, which serve to anchor the individual prongs **208** of the multi-mount adapter **200**. Each prong fitting **208** comprises a releasable capture means comprised of a distal post **66**, hexagonal neck **68**, spring-loaded clasp **157**, and snap button **72**, which engage the corresponding utility bar **40**, releasable capture means.

[0098] To utilize the multi-mount adapter **200**, the user installs separate tree attachments **150** in the desired locations as previously described. FIG. **18**. Once the tree attachments **150** are installed, the user attaches the multi-mount adapter **200** to the extension pole **17** by fully engaging the hexagonal neck **69** of the extension pole within the hexagonal recess **204** of the central receiver fitting **203** and simultaneously engaging the extension pole snap button **72** in the central receiver fitting **203** snap button engaging pit **205**. The user then attaches a utility bar **40** to the first multi-mount adapter prong fitting **208**, and a utility bar **40** to a second multi-mount adapter prong fitting **208** by engaging the corresponding multi-mount prong fitting **208** snap buttons **72** with the respective “install” recess pit **175** of each utility bar **40**.

[0099] The user then uses the extension pole **17** to raise the multi-mount adapter **200** with attached utility bars **40** with mounted and wire connected **201** camera **41** and solar collector **202** up to the previously installed tree attachments **150** as shown in FIG. **37**. The user then installs the first utility bar **40** onto the first tree attachment **150** as shown in FIG. **38** by the means previously described and depicted in FIG. **22**. Once the user disengages and removes the extension pole **17** from the first connected utility bar **40**, as shown

in FIG. 39, the user can then install the second utility bar 40 to the second tree attachment 150 as shown in FIG. 40 by the means previously described and depicted in FIG. 22. After each utility bar 40 is installed, the mounted camera, and accessory solar collector 202 can be aimed by utilizing the laser attachment 153, described below and shown in FIG. 34. The multi-mount adapter 200 allows for the user to position a camera 41 for optimal view, and a wire connected 201 solar collector 202 in a different position for optimal solar exposure. FIG. 41.

[0100] The multi-mount adapter 200 can also be used to mount multiple camera components onto one tree attachment 150. To do so, the user orients the multi-mount adapter 200 so that the central receiver fitting 203 ramped snap button pit 206 is in the upward position. In this position, the spring-loaded clasps 157 and snap buttons 72 of each multi-mount prong fitting 208 are oriented to securely clasp the non-ramped “remove” recess pits 181 of each of the utility bars 40 to be installed. The user then connects the multi-mount adapter 200 to the extension pole 17 by directing the extension pole 17 snap button 72 to engage the upward oriented ramped snap button pit 206 of the multi-mount 200 central receiver 203. The user then installs the first utility bar 40 onto the first tree attachment 150. The user can then disengage the extension pole 17 snap button 72 from the central receiver 203 ramped snap button pit 206 while the utility bar 40 maintains its connection to the tree attachment 150.

[0101] Once the utility bar 40 is secured onto the tree attachment 150, with mounted camera 41, the camera mount 152 can be accurately aimed by using a laser attachment 153 as shown in FIG. 34. Said laser attachment 153 clips on to the distal end of the extension pole 17. A standard laser pen light 154 is then placed in the pen light clasp 178 and turned on. The distal post 66 of the extension pole 17 is then inserted into the proximal camera mount receiving recess 179. The laser attachment 153 with laser pen 154 and mounted camera 41 are then aligned so the projected laser dot 180 shows the area where the camera 41 will be recording. The user then manipulates the camera mount 152/laser attachment 153 to achieve the desired recording area of the camera.

[0102] To remove the system, the user inserts the distal post 66 of the extension pole 17 into the proximal receiving end 172 of the utility bar 40 until the snap button 72 of the spring-loaded clasp 157 of the extension pole clasps the “remove” recess pit 181 of the proximal utility bar receiver. The “remove” recess pit 181 does not contain a ramp 134, thus the snap button 72 cannot slide out of the “remove” recess pit 181. Therefore, the longitudinal force generated by the user by pulling the extension pole 17 away from the utility bar 40, exceeds the holding capability of the tree attachment clasps 158, which allows the utility bar 40 to disengage from the tree attachment 150.

[0103] If multiple utility bars need to be removed, the user simply rotates the multi-mount adapter 180 degrees so that the spring-loaded clasps 157 and snap buttons 72 of each multi-mount prong fitting 208 are positioned to clasp the “remove” recess pits 181 of each of the installed utility bars 40 proximal receiving ends. The user can then remove the first utility bar 40 utilizing the first dual mount prong fitting 208. FIG. 42-43. The user can then engage the second dual mount prong 208 with the second utility bar 40 to remove the wire connected 201 camera components.

[0104] If multiple utility bars were installed onto one tree attachment 150 via the multi-mount adapter 200, the user can uninstall the system by directing the extension pole 17 snap button 72 to engage the central receiver fitting 203 non-ramped snap button engaging pit 205, which will be oriented in the down position. Once the snap button engaging pit 205 is engaged, the user can then uninstall the system by longitudinally pulling away from the tree attachment 150. The holding strength of the engaged snap button engaging pit 205 exceeds the holding force of the utility bar and support releasable capture means 38, so the utility bar 40 and multi-mount adapter 200 can be disconnected from the tree attachment 150.

[0105] The tree attachment 150, or multiple tree attachments can be uninstalled from the tree by the user inserting the distal post 66 into proximal hexagon shaped receiving end 155 of the tree attachment 150 until the snap button 72 of the spring-loaded clasp 157 of the extension pole 17 clasps the tree attachment 150 cuff 156 pit 136. The extension pole 17 is then rotated counterclockwise to unscrew the auger 12 tip from the tree.

[0106] In another embodiment, the proximal end of the extension pole 17 receives a drill adapter 120, which allows the use of a powered drill 182 during installation and removal of the tree attachment 150. Said adapter is comprised of a post 66; hexagon shaped neck 124 at the base of said post 66; and a drill attachment post 122. FIGS. 27-28. To utilize the adapter 120, the user simply secures the drill attachment post 122 in a standard drill chuck 183 in the same manner any drill bit would be engaged for use in said drill. The user then inserts the adapter post 66 into the hexagon shaped receiving end 184 of the extension pole 17, until the hexagon shaped neck 124 fully engages the hexagon receiving shaped receiving end 184. When the adapter 120 is fully engaged, the drill 182 can be operated to install or remove the tree attachment as shown in FIG. 28.

[0107] In yet another embodiment a saw 108 can be mounted to an injection molded adapter 186, which connects to the distal end of the extension pole 17 to allow for clearing of branches from the installation site of the system as shown in FIG. 33. Said saw adapter 186 would engage the distal end of the extension pole 17 with the same means as already described for the tree attachment 150 above.

[0108] The mounting system of the subject invention safely installs a trail camera high in a tree. This not only protects the camera from damage and theft, but prevents the person installing the camera from dangerously climbing up and down the tree or balancing precariously on a ladder on unstable ground. The system is versatile and can be configured to support not only cameras, but lights or other accessories. It also can be used to hoist a load into the tree on which it is mounted.

[0109] It is understood that the foregoing examples are merely illustrative of the present invention. Certain modifications of the articles and/or methods may be made and still achieve the objectives of the invention. Such modifications are contemplated as within the scope of the claimed invention.

What is claimed is:

1. A mounting system comprising:
 - a support, the support comprising an anchoring means, which attaches the support to a surface, a support fitting, and a support releasable capture means;

- a utility bar, the utility bar comprising a utility bar fitting, a utility bar releasable capture means, wherein the utility bar releasable capture means are configured to engage and releasably capture the support releasable capture means;
- a pole, the pole comprising a pole fitting configured to complement the support fitting and the utility bar fitting, where said pole fitting engages the utility bar fitting to place the utility bar by connecting the utility bar releasable capture means to the support releasable capture means; whereby said pole fitting releases and is removed from said utility bar fitting while the connection between said utility bar releasable capture means and said support releasable capture means is maintained.
2. The mounting system of claim 1, wherein said support releasable capture means is comprised of a first magnetic connector disposed upon said support.
3. The mounting system of claim 1, wherein said support releasable capture means is comprised of a first magnetic connector disposed within said support.
4. The mounting system of claim 2, wherein said utility bar releasable capture means is comprised of a corresponding magnetic connector disposed on the distal end of said utility bar.
5. The mounting system of claim 3, wherein said utility bar releasable capture means is comprised of a corresponding magnetic connector disposed on the distal end of said utility bar.
6. A multi-mount adapter comprising:
- an extension pole receiver fitting,
 - a plurality of arms protruding from said central receiver fitting, which anchor at least one prong fitting; whereby
 - each prong fitting comprises a releasable capture means which engages a utility bar fitting.
7. The multi-mount adapter of claim 6 where said receiver fitting is further comprised of a snap button engaging pit located on the top of said receiver fitting and a ramped snap button pit located on the bottom side of said central receiver fitting.
8. The multi-mount adapter of claim 6 where each prong fitting is further comprised of a distal post, hexagonal neck, spring-loaded clasp, and snap button.
9. A mounting system comprising:
- a support, the support comprising an anchoring means, which attaches the support to a surface, a support fitting, and a support releasable capture means;
 - a utility bar, the utility bar comprising a utility bar fitting, a utility bar releasable capture means, wherein the utility bar releasable capture means are configured to engage and releasably capture the support releasable capture means;
 - a multi-mount adapter, the multi-mount adapter comprising a central extension pole receiver fitting, a plurality of arms protruding from said central receiver fitting, which anchor at least one prong fitting; whereby each prong fitting engages a utility bar fitting.
 - a pole, the pole comprising a pole fitting configured to complement the support fitting and the central extension pole receiver fitting, where said pole fitting engages the central extension pole receiver fitting to place the utility bar by connecting the utility bar releasable capture means to the support releasable capture means; whereby said prong fitting releases and is removed from said utility bar fitting while the connection between said utility bar releasable capture means and said support releasable capture means is maintained.
10. A mounting system comprising:
- a support, the support comprising an anchoring means, which attaches the support to a surface, a support fitting, and a support releasable capture means;
 - a utility bar, the utility bar comprising a utility bar fitting, a utility bar releasable capture means, wherein the utility bar releasable capture means are configured to engage and releasably capture the support releasable capture means;
 - a multi-mount adapter, the multi-mount adapter comprising a central extension pole receiver fitting, a plurality of arms protruding from said central receiver fitting, which anchor at least one prong fitting; whereby each prong fitting engages a utility bar fitting.
 - a pole, the pole comprising a pole fitting configured to complement the support fitting and the central extension pole receiver fitting, where said pole fitting engages the central extension pole receiver fitting to place the utility bar by connecting the utility bar releasable capture means to the support releasable capture means; whereby said pole fitting releases and is removed from said extension pole receiver fitting while the connection between said prong fitting and utility bar fitting is maintained.
11. A method for installing multiple camera components in an elevated location comprising the steps of:
- connecting a first support to the distal end of said extension pole with releasable capture means;
 - installing said first support to a first mounting surface;
 - releasing said extension pole from installed first support;
 - connecting a second support to the distal end of said extension pole with releasable capture means;
 - installing said second support to a second mounting surface;
 - connecting a multi-mount adapter to the distal end of said extension pole with releasable capture means;
 - connecting a first utility bar to a first multi-mount adapter prong fitting with releasable capture means;
 - connecting a second utility bar to a second multi-mount adapter prong fitting with releasable capture means;
 - connecting said first utility bar to said first support; and
 - connecting said second utility bar to said second support.
12. A method for installing multiple camera components in an elevated location comprising the steps of:
- connecting a support to the distal end of an extension pole with releasable capture means;
 - installing said support to a mounting surface;
 - releasing said extension pole from installed said support;
 - connecting a multi-mount adapter to the distal end of said extension pole with releasable capture means;
 - connecting a first utility bar to a first multi-mount adapter prong fitting with releasable capture means;
 - connecting a second utility bar to a second multi-mount adapter prong fitting with releasable capture means;

- g. connecting said first utility bar to said support; and
- h. releasing said extension pole from said multi-mount adapter.

* * * * *