



(11) **EP 4 400 398 A3**

(12) **EUROPEAN PATENT APPLICATION**

(88) Date of publication A3:
11.09.2024 Bulletin 2024/37

(43) Date of publication A2:
17.07.2024 Bulletin 2024/29

(21) Application number: **24173617.2**

(22) Date of filing: **08.10.2019**

(51) International Patent Classification (IPC):
B62K 15/00 (2006.01) B62J 1/08 (2006.01)
B62K 5/06 (2006.01) B62K 21/18 (2006.01)
B62K 5/025 (2013.01)

(52) Cooperative Patent Classification (CPC):
B62K 5/025; B62J 1/08; B62K 5/06; B62K 15/008;
B62K 21/18; B62K 2204/00; Y02T 10/70

(84) Designated Contracting States:
AL AT BE BG CH CY CZ DE DK EE ES FI FR GB
GR HR HU IE IS IT LI LT LU LV MC MK MT NL NO
PL PT RO RS SE SI SK SM TR

(30) Priority: **15.10.2018 CN 201811197522**

(62) Document number(s) of the earlier application(s) in accordance with Art. 76 EPC:
19874169.6 / 3 868 639

(71) Applicant: **Suntech UK Limited**
Holmethorpe Industrial Est.
Redhill, Surrey RH1 2LW (GB)

(72) Inventors:
• **The inventor has waived his right to be thus mentioned.**

(74) Representative: **Baldwin, Mark**
Firebird IP
27 Old Gloucester Street
London WC1N 3AX (GB)

(54) **DRAW-BAR BOX-TYPE QUICKLY FOLDING MICRO ELECTRIC VEHICLE**

(57) Disclosed is a draw-bar box-type quickly folding micro electric vehicle, comprising of a seat frame assembly (1) that is horizontally arranged, the top surface of which is provided with a foldable backrest. A pair of symmetrically arranged rear wheel assemblies (2) are arranged at a position, close to a rear of the vehicle, on the bottom surface of the seat frame assembly (1), and two vertically downward first connecting posts (101), which are provided near the front of the lower end of the seat frame assembly (1). A footrest assembly (4) is hinged to the lower ends of the two first connecting posts (101) through the first connecting assemblies (3). The footrest assembly (4) is arranged parallel to the seat frame assembly (1), and the plane of the footrest assembly (4) is lower than the plane of the seat frame assembly (1). A steering column assembly (5) is hinged at the end of the footrest assembly (4) away from the seat frame assembly (1), and a front wheel assembly (6), with a power device, is attached at the lower end of the steering column assembly (5). A very low footrest assembly (4) is hinged to the seta frame assembly (1) by means of the first connecting assembly (3), so that the user does not need to raise their legs to use the vehicle. Thus, use of the vehicle is convenient and safety risks are reduced.

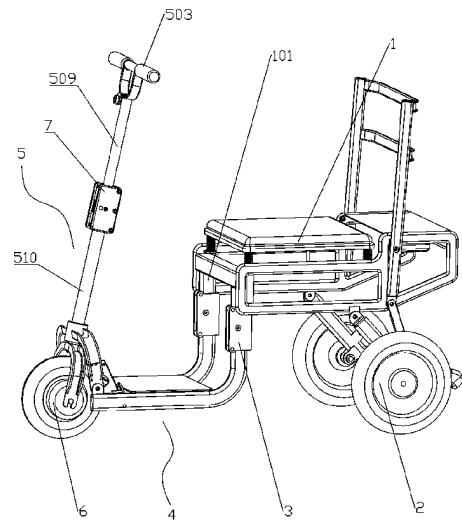

FIG 1

EP 4 400 398 A3



EUROPEAN SEARCH REPORT

Application Number

EP 24 17 3617

5

DOCUMENTS CONSIDERED TO BE RELEVANT

10

15

20

25

30

35

40

45

Category	Citation of document with indication, where appropriate, of relevant passages	Relevant to claim	CLASSIFICATION OF THE APPLICATION (IPC)
X	EP 2 623 407 A1 (BLASI IND SRL [IT]) 7 August 2013 (2013-08-07) * the whole document * -----	1-10	INV. B62K15/00 B62J1/08 B62K5/06
X	CN 201 347 167 Y (JINGYU HU [CN]) 18 November 2009 (2009-11-18) * the whole document * -----	1-10	B62K21/18 B62K5/025
X	EP 1 398 258 A2 (DI BLASI CARMELO [IT]; DI BLASI CARLO MARIA [IT]) 17 March 2004 (2004-03-17) * the whole document * -----	1-10	
X	CN 202 518 420 U (CHANGXIN DAI) 7 November 2012 (2012-11-07) * the whole document * -----	1-10	
X	CN 207 550 394 U (TANG MANLIN) 29 June 2018 (2018-06-29) * the whole document * -----	1-10	
			TECHNICAL FIELDS SEARCHED (IPC)
			B62J B62K

1

The present search report has been drawn up for all claims

50

Place of search The Hague	Date of completion of the search 30 July 2024	Examiner Baeza Féllez, Lluís
-------------------------------------	---	--

55

EPO FORM 1503 03.82 (F04C01)

CATEGORY OF CITED DOCUMENTS
 X : particularly relevant if taken alone
 Y : particularly relevant if combined with another document of the same category
 A : technological background
 O : non-written disclosure
 P : intermediate document

T : theory or principle underlying the invention
 E : earlier patent document, but published on, or after the filing date
 D : document cited in the application
 L : document cited for other reasons

 & : member of the same patent family, corresponding document

**ANNEX TO THE EUROPEAN SEARCH REPORT
ON EUROPEAN PATENT APPLICATION NO.**

EP 24 17 3617

5 This annex lists the patent family members relating to the patent documents cited in the above-mentioned European search report.
The members are as contained in the European Patent Office EDP file on
The European Patent Office is in no way liable for these particulars which are merely given for the purpose of information.

30-07-2024

Patent document cited in search report	Publication date	Patent family member(s)	Publication date
EP 2623407 A1	07-08-2013	NONE	

CN 201347167 Y	18-11-2009	NONE	

EP 1398258 A2	17-03-2004	EP 1398258 A2	17-03-2004
		US 2004130126 A1	08-07-2004

CN 202518420 U	07-11-2012	NONE	

CN 207550394 U	29-06-2018	NONE	

EPO FORM P0459

For more details about this annex : see Official Journal of the European Patent Office, No. 12/82