



US009566149B2

(12) **United States Patent**
Shaw

(10) **Patent No.:** **US 9,566,149 B2**

(45) **Date of Patent:** **Feb. 14, 2017**

(54) **DEVICES AND METHODS FOR IN SITU FENESTRATION OF A STENT-GRAFT AT THE SITE OF A BRANCH VESSEL**

(58) **Field of Classification Search**
CPC A61F 2002/068
See application file for complete search history.

(75) Inventor: **Edward E. Shaw**, Flagstaff, AZ (US)

(56) **References Cited**

(73) Assignee: **W. L. Gore & Associates, Inc.**,
Newark, DE (US)

U.S. PATENT DOCUMENTS

(*) Notice: Subject to any disclaimer, the term of this patent is extended or adjusted under 35 U.S.C. 154(b) by 0 days.

5,219,335 A	6/1993	Willard et al.
5,281,203 A	1/1994	Ressemann
5,632,762 A	5/1997	Myler
5,951,599 A	9/1999	McCrary
5,984,955 A	11/1999	Wisselink

(Continued)

(21) Appl. No.: **13/286,980**

FOREIGN PATENT DOCUMENTS

(22) Filed: **Nov. 1, 2011**

EP	1 487 380	2/2008
WO	02/15824	2/2002

(Continued)

(65) **Prior Publication Data**

US 2012/0130478 A1 May 24, 2012

Related U.S. Application Data

(60) Provisional application No. 61/414,065, filed on Nov. 16, 2010.

OTHER PUBLICATIONS

International Search Report and Written Opinion from PCT/US2011/058948, mailed Nov. 16, 2010, 14 pages.

Primary Examiner — Jacqueline Woznicki

(51) **Int. Cl.**

<i>A61F 2/06</i>	(2013.01)
<i>A61F 2/07</i>	(2013.01)
<i>A61F 2/82</i>	(2013.01)
<i>A61F 2/89</i>	(2013.01)
<i>A61F 2/90</i>	(2013.01)

(57) **ABSTRACT**

The present disclosure includes a stent-graft comprising a first portion that is configured to engage a vessel wall, a second portion that is configured not to engage the vessel wall, and a perfusion window that is configured to permit blood flow. The stent-graft may further comprise a transition portion between the first portion and the second portion, and the perfusion window may be formed in the first portion, the second portion, and/or the transition portion. In a variety of embodiments, one of the first and the second portion may have a smaller diameter than the other. Similarly, in a variety of embodiments, the transition portion may be frustoconically shaped.

(52) **U.S. Cl.**

CPC .. *A61F 2/07* (2013.01); *A61F 2/89* (2013.01); *A61F 2/90* (2013.01); *A61F 2002/061* (2013.01); *A61F 2002/068* (2013.01); *A61F 2002/821* (2013.01); *A61F 2220/0033* (2013.01); *A61F 2250/006* (2013.01); *A61F 2250/0023* (2013.01); *A61F 2250/0024* (2013.01); *A61F 2250/0039* (2013.01); *A61F 2250/0071* (2013.01); *A61F 2250/0096* (2013.01); *A61F 2250/0098* (2013.01)

8 Claims, 6 Drawing Sheets

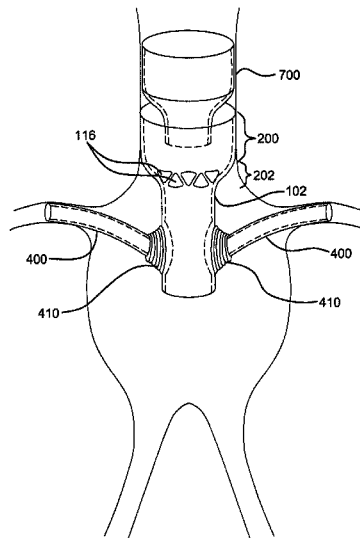

(56)

References Cited

U.S. PATENT DOCUMENTS

6,022,319 A 2/2000 Willard et al.
 6,066,100 A 5/2000 Willard et al.
 6,139,524 A 10/2000 Killion
 6,183,492 B1 2/2001 Hart et al.
 6,245,100 B1 6/2001 Davila et al.
 6,296,661 B1 10/2001 Davila et al.
 6,372,995 B1 4/2002 Mochizuki et al.
 6,432,127 B1 8/2002 Kim et al.
 6,458,153 B1 10/2002 Bailey et al.
 6,626,439 B1 9/2003 Forry et al.
 6,652,567 B1 11/2003 Deaton
 6,814,752 B1 11/2004 Chuter
 6,949,121 B1 9/2005 Laguna
 7,186,334 B1 3/2007 Barnes
 7,270,188 B2 9/2007 Cook et al.
 7,575,590 B2 8/2009 Watson
 7,600,956 B2 10/2009 McDuff et al.
 7,635,034 B2 12/2009 Williams
 7,670,369 B2 3/2010 Schaeffer
 7,682,383 B2 3/2010 Robin
 7,752,969 B2 7/2010 Stevens
 7,758,367 B2 7/2010 Siebens et al.
 2001/0025195 A1* 9/2001 Shaolian et al. 623/1.13
 2002/0032479 A1* 3/2002 Hankh et al. 623/1.16
 2002/0052643 A1* 5/2002 Wholey et al. 623/1.13
 2003/0144725 A1* 7/2003 Lombardi 623/1.13
 2003/0195609 A1 10/2003 Berenstein et al.
 2004/0059406 A1 3/2004 Cully et al.
 2004/0106972 A1 6/2004 Deaton
 2004/0106978 A1 6/2004 Greenberg et al.
 2005/0055082 A1* 3/2005 Ben Muvhar A61F 2/91
 623/1.15
 2005/0131519 A1 6/2005 Hartley
 2005/0149166 A1 7/2005 Schaeffer et al.
 2005/0267568 A1 12/2005 Berez et al.
 2006/0206200 A1 9/2006 Garcia et al.
 2006/0206201 A1 9/2006 Garcia et al.
 2006/0229704 A1 10/2006 Thistle et al.
 2006/0287704 A1 12/2006 Hartley

2007/0088425 A1 4/2007 Schaeffer
 2007/0173921 A1 7/2007 Wholey et al.
 2007/0219621 A1 9/2007 Hartley et al.
 2007/0225797 A1 9/2007 Krivoruhko
 2007/0244542 A1 10/2007 Greenan et al.
 2008/0228256 A1 9/2008 Erickson et al.
 2008/0262595 A1 10/2008 Chu et al.
 2009/0030502 A1 1/2009 Sun et al.
 2009/0149939 A1 6/2009 Godlewski et al.
 2009/0259290 A1 10/2009 Bruszewski et al.
 2009/0270971 A1 10/2009 Xiao
 2009/0270974 A1 10/2009 Berez et al.
 2009/0275974 A1 11/2009 Marchand et al.
 2009/0287288 A1 11/2009 Berez et al.
 2009/0292348 A1 11/2009 Berez et al.
 2009/0319017 A1 12/2009 Berez et al.
 2010/0010624 A1 1/2010 Berez et al.
 2010/0057186 A1 3/2010 West et al.
 2010/0082091 A1 4/2010 Berez et al.
 2010/0100055 A1 4/2010 Mustapha
 2010/0121429 A1 5/2010 Greenan et al.
 2010/0168837 A1 7/2010 Magnuson et al.

FOREIGN PATENT DOCUMENTS

WO 2005/007219 1/2005
 WO 2006/124824 11/2006
 WO 2007/028112 3/2007
 WO 2008/021555 2/2008
 WO WO-2008021557 A1 2/2008
 WO 2008/042270 4/2008
 WO 2008/057568 5/2008
 WO 2008/062405 5/2008
 WO 2008/112415 9/2008
 WO 2009/017632 2/2009
 WO 2009/052432 4/2009
 WO 2009/082718 7/2009
 WO 2009/134686 11/2009
 WO WO-2010024879 A1 3/2010
 WO 2011/047004 4/2011

* cited by examiner

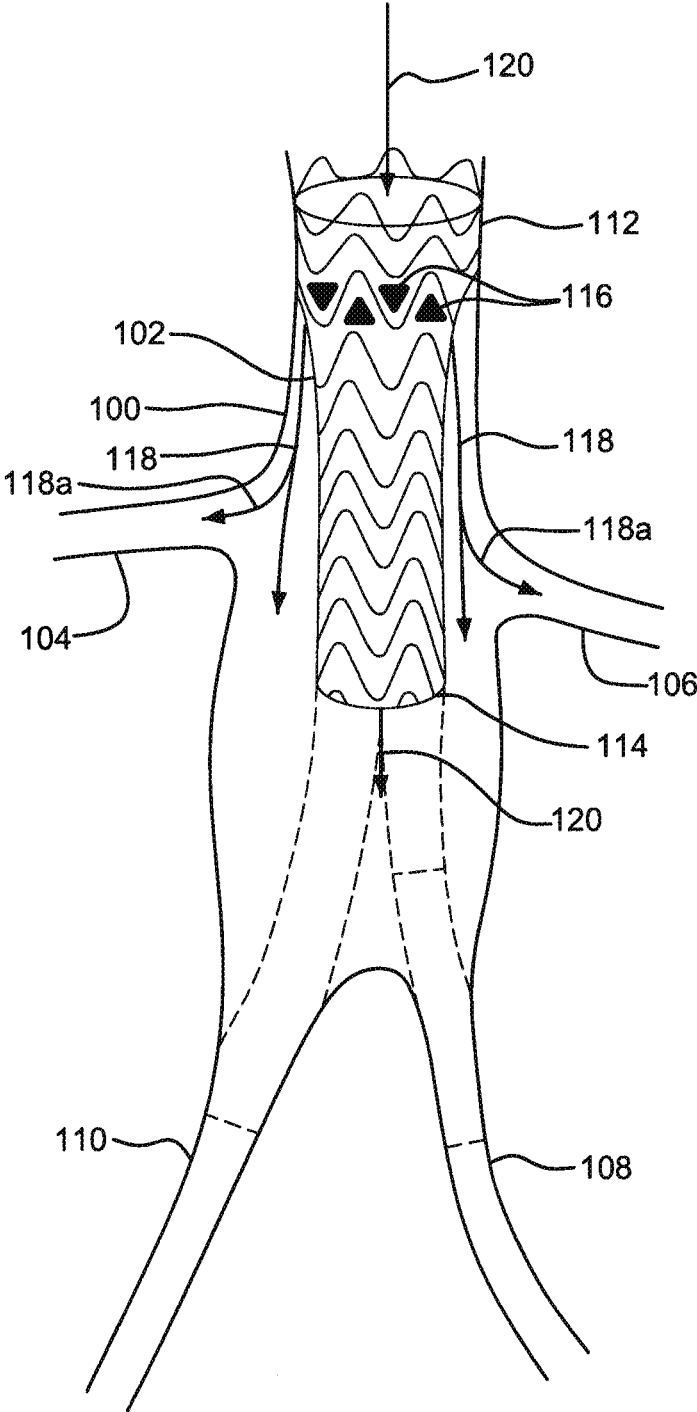

FIG. 1

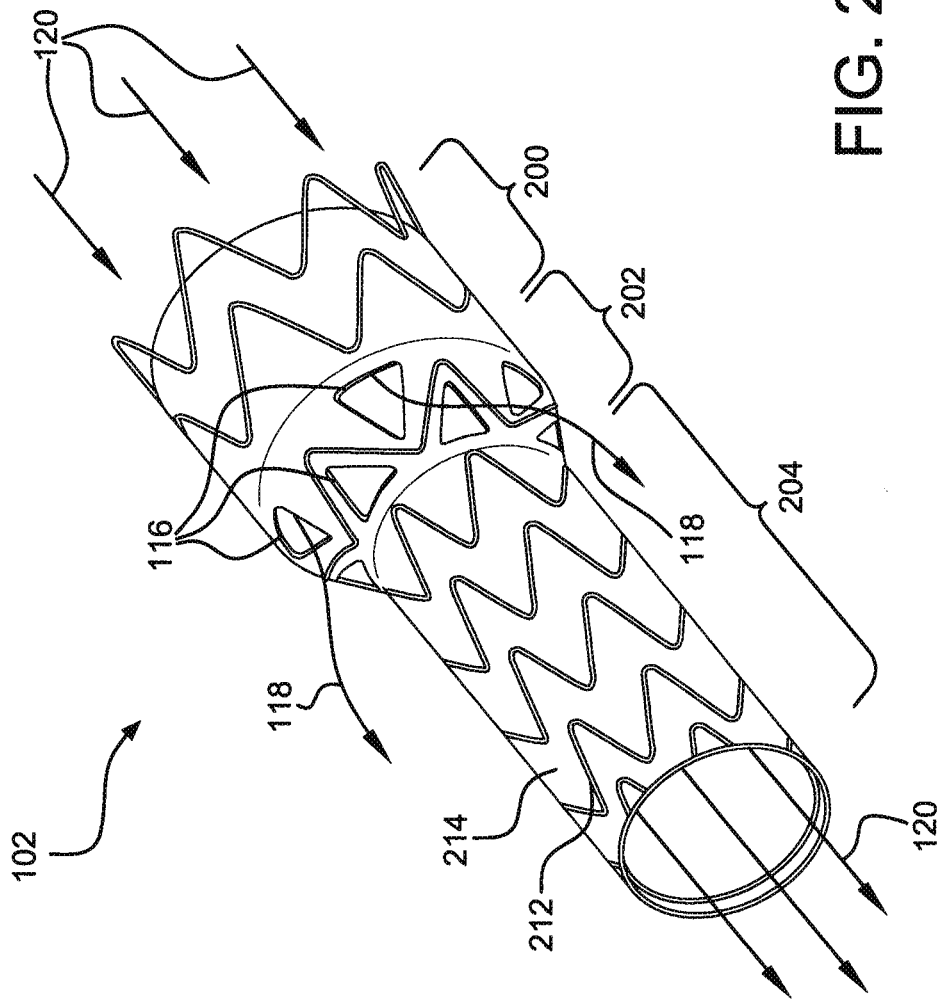

FIG. 2

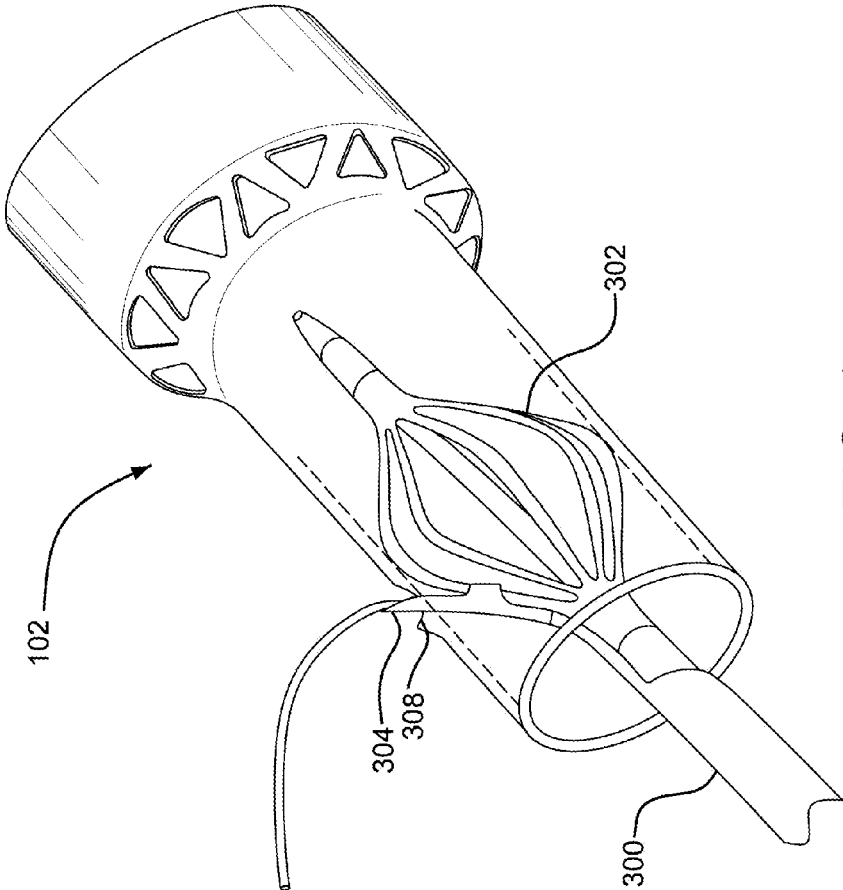

FIG. 3

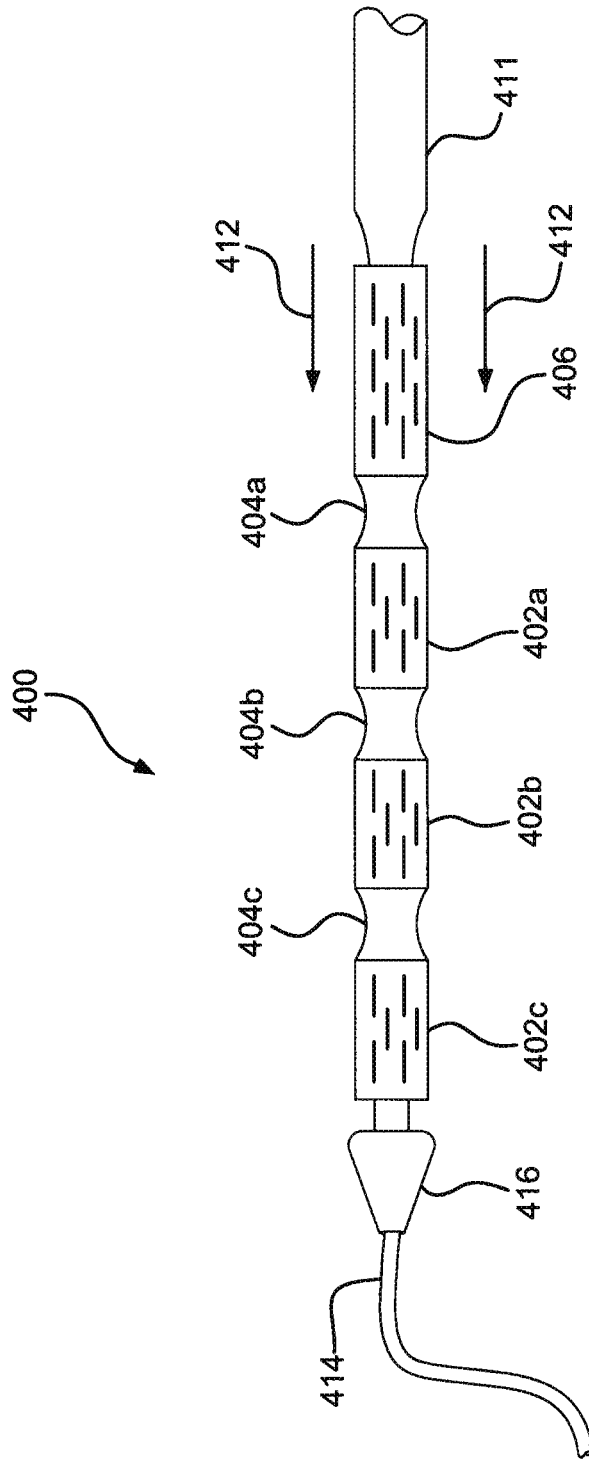

FIG. 4

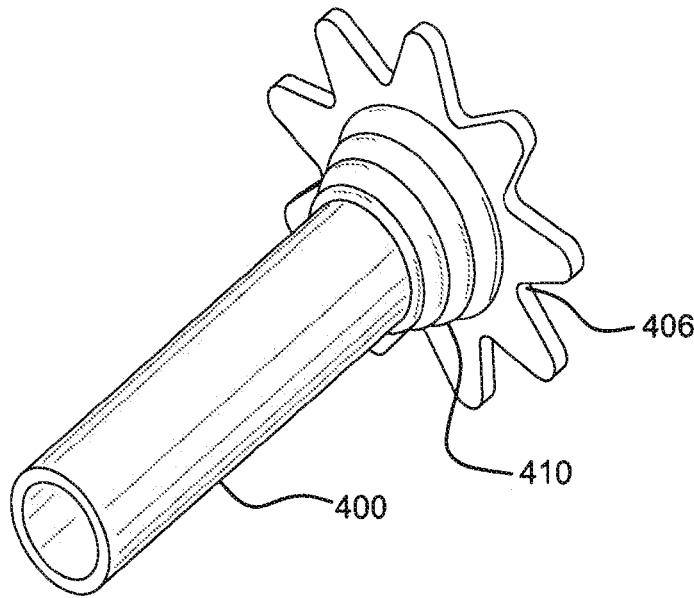

FIG. 5

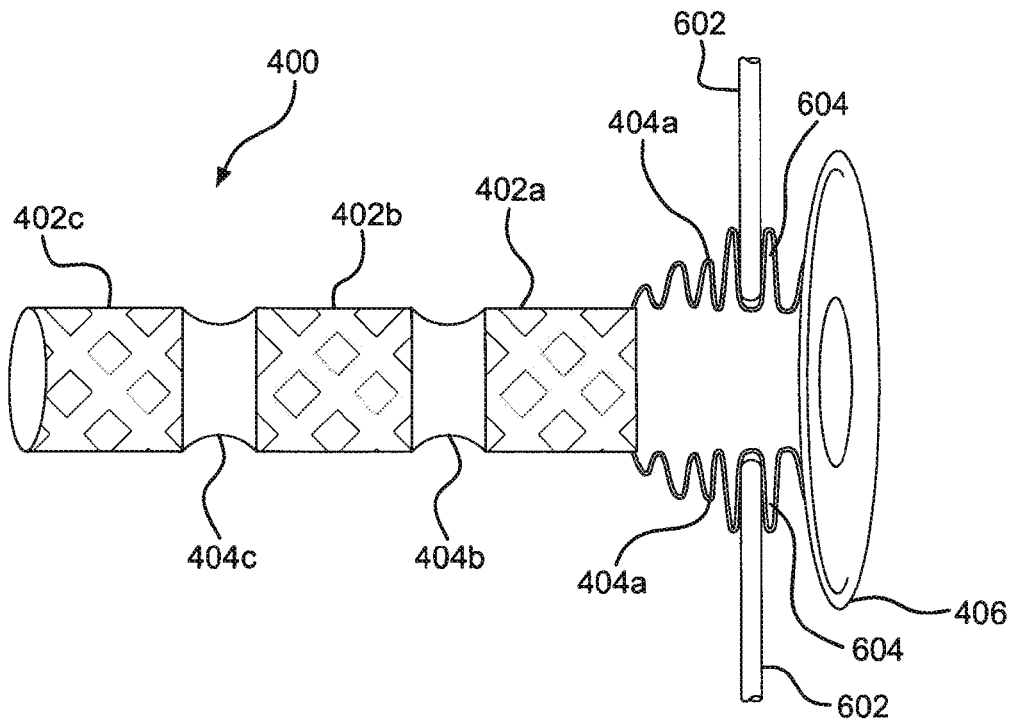

FIG. 6

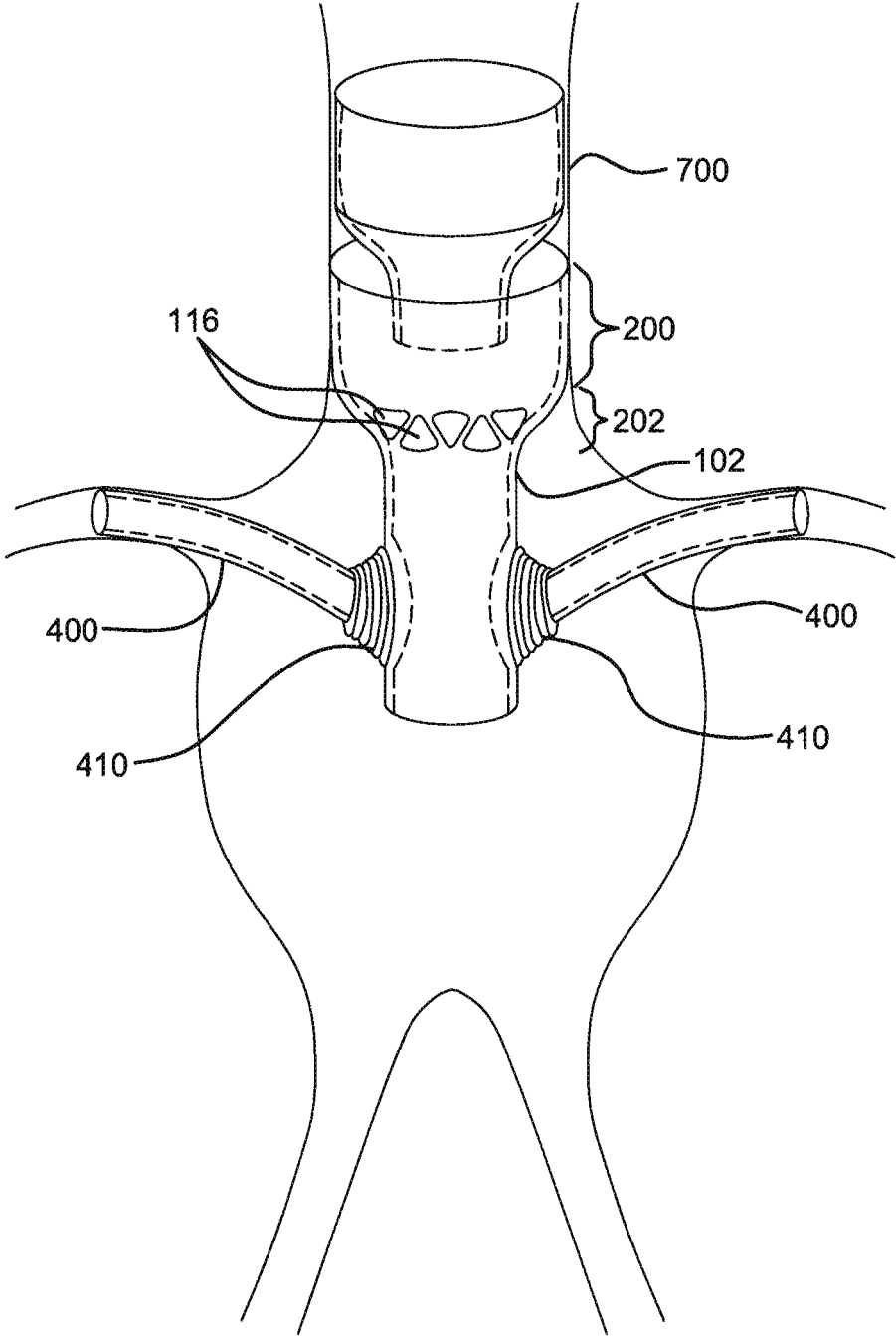

FIG. 7

1

DEVICES AND METHODS FOR IN SITU FENESTRATION OF A STENT-GRAFT AT THE SITE OF A BRANCH VESSEL

CROSS REFERENCE TO RELATED APPLICATIONS

This application is a non-provisional of, and claims priority to, U.S. Provisional Patent Application No. 61/414,065, entitled "Devices and Methods For in situ Fenestration of a Stent-Graft at the Site of a Branch Vessel," filed Nov. 16, 2010, which is hereby incorporated by reference in its entirety.

BACKGROUND

Field

The present disclosure generally relates to stent-grafts for treating diseases of the vasculature.

Discussion of the Related Art

Stent-grafts are medical devices constructed to reinforce, replace, or bridge, a part of a damaged, unhealthy, or diseased blood vessel. A stent-graft may thus guide blood flow through a lumen defined by its cylindrical interior. Where a stent-graft is implanted in a patient's body, however, blood is typically not permitted to leak or flow over an exterior portion of the stent-graft.

Occasionally, a stent-graft may be placed in a part of a patient's body such that it occludes or blocks one or more side-branch vessels (i.e., vessels that join the main vessel within which the stent-graft is implanted). For instance, patients who develop abdominal aortic aneurysms ("AAAs") are often implanted with stent-grafts. During a procedure of this type, a stent-graft may be implanted in a patient's abdominal aorta. However, such a stent-graft may partially or fully occlude blood flow to a patient's renal arteries, which branch away from the patient's abdominal aorta.

Commonly, in order to direct blood flow to a patient's side-branch vessels, stent-grafts, which may otherwise occlude these vessels, are manufactured with, or altered in situ to include, a fenestration or window near a location of one or more side-branch vessels. Thus, in operation, blood may escape through the fenestration and into one or more side-branch vessels.

Fenestrated stent-grafts have been manufactured with their fenestrations opened a priori of surgical implantation. More particularly, fenestrated stent-grafts have been manufactured as pre-sized commercial off the shelf components as well as more customized components fenestrated based upon preoperative anatomic information (e.g., imaging data collected via x-ray systems, etc.) In either instance, however, a fenestrated stent-graft may fit poorly within a patient's anatomy (either due to the pre-sized nature of the device and/or as a result of inadequate or imprecise preoperative anatomic data). Likewise, where stent-grafts have been fenestrated in situ, it has been similarly challenging to adjust the orientation of such stent-grafts to align with various anatomies.

In light of these shortcomings, physicians have struggled to ensure alignment between the fenestrations made in stent-grafts and the branch-vessels into which these fenestrations will ultimately direct blood flow. For example, until now, alignment has been accomplished (and/or attempted) largely through the use of multiple guidewires as well as, in some instances, an angiographic catheter. These measures have been necessary, because stent-grafts, as described

2

above, may fit only poorly into their respective anatomies. Moreover, where stent-grafts have been implanted near side-branch vessels, physicians have struggled, prior to alignment of one or more fenestrations with these vessels, with occlusion by the stent-graft of these vessels.

A more suitable fenestrated stent-graft is therefore desirable. More particularly, a stent graft suited to more careful placement in a patient's anatomy is desirable. A need similarly exists for the reduction of surgical equipment in a patient's anatomy. Likewise, there is a need for a stent-graft that does not occlude side-branch vessels prior to alignment.

SUMMARY

The present disclosure includes a stent-graft comprising a first portion that is configured to engage a vessel wall, a second portion that is configured not to engage the vessel wall, and a perfusion window that is configured to permit blood flow. The stent-graft may further comprise a transition portion between the first portion and the second portion, and the perfusion window may be formed in the first portion, the second portion, and/or the transition portion. In a variety of embodiments, one of the first and the second portion may have a smaller diameter than the other. Similarly, in a variety of embodiments, the transition portion may be frustoconically shaped.

Further, and in various embodiments, the stent-graft may comprise a fenestratable target portion that is fenestratable in such a manner that it can receive a side-branch stent-graft. The target portion may be visible in situ in the presence of a contrast media that perfuses through the perfusion window. More particularly, a fenestration device that fenestrates a target portion of the stent-graft and facilitates the installation of a side-branch stent-graft. In various embodiments, the stent-graft may be deployable for treating an iliac artery. An occluder may be provided that blocks the perfusion window.

BRIEF DESCRIPTION OF THE DRAWINGS

The features and advantages of the present disclosure will become more apparent from the detailed description set forth below when taken in conjunction with the drawings.

FIG. 1 illustrates an embodiment of a stent-graft deployed in a vessel.

FIG. 2 illustrates a perspective view of a stent-graft.

FIG. 3 illustrates a perspective view of a stent-graft and a fenestration tool within the stent-graft.

FIG. 4 illustrates a side view of a side-branch stent-graft mounted and constrained on a delivery catheter.

FIG. 5 illustrates a perspective view of a side-branch stent-graft when deployed.

FIG. 6 illustrates a side view of a side-branch stent-graft when deployed against the wall of a stent-graft.

FIG. 7 illustrates a fully assembled modular stent-graft including an occluder that blocks a plurality of perfusion windows.

DETAILED DESCRIPTION OF THE ILLUSTRATED EMBODIMENTS

Persons skilled in the art will readily appreciate that various aspects of the present disclosure may be realized by any number of methods and apparatuses configured to perform the intended functions. Stated differently, other methods and apparatuses may be incorporated herein to perform the intended functions. It should also be noted that the accompanying drawing figures referred to herein are not

all drawn to scale, but may be exaggerated to illustrate various aspects of the present disclosure, and in that regard, the drawing figures should not be construed as limiting. Finally, although the present disclosure may be described in connection with various principles and beliefs, the present disclosure should not be bound by theory.

Throughout this specification and in the claims, the term “distal” may refer to a location that is, or a portion of an intraluminal device (such as a stent-graft) that when implanted is, further downstream with respect to blood flow than another portion of the device. Similarly, the term “distally” may refer to the direction of blood flow or further downstream in the direction of blood flow.

The term “proximal” may refer to a location that is, or a portion of an intraluminal device that when implanted is, further upstream with respect to blood flow. Similarly, the term “proximally” may refer to the direction opposite to the direction of blood flow or upstream from the direction of blood flow.

With further regard to the terms proximal and distal, and because the present disclosure is not limited to peripheral and/or central approaches, this disclosure should not be narrowly construed with respect to these terms. Rather, the devices and methods described herein may be altered and/or adjusted relative to the anatomy of a patient.

The terms “branch vessel,” “side-branch” and/or “side-branch vessel” may refer to a vessel that branches off from a main vessel. For example, “branch vessels” of the thoracic and abdominal arteries include, but are not limited to, the celiac, inferior phrenic, superior mesenteric, lumbar, inferior mesenteric, middle sacral, middle suprarenal, renal, internal spermatic, ovarian (in the female), innominate, left carotid, and left subclavian arteries. As another example, the hypogastric artery is a branch vessel of the common iliac, which is a main vessel in this context. Thus, it should be seen that “branch vessel” and “main vessel” are relative terms.

While the specific embodiments are described in greater detail below, in general, the present disclosure will focus primarily upon devices and methods for treating disease of the ascending aorta, aortic arch, and descending aorta; however, these devices and methods may be applied to other diseases of the vasculature, including, for example, any disease where a larger vessel and one or more branch vessels are to be treated.

A stent-graft in accordance with various embodiments may have a first portion that is configured to engage a vessel wall and a second portion that is configured not to engage the vessel wall; and a perfusion window that is configured to permit blood flow. The stent-graft can include a transition portion between the first portion and the second portion. The perfusion window can be formed in one of the first portion, the second portion, and the transition portion. In various embodiments, one of the first and second portions of the stent-graft has a smaller diameter than the other. The stent-graft may include a transition portion between the first portion and the second portion that is frustoconically shaped.

A stent-graft in accordance with a number of embodiments can comprise a first portion that is configured to engage a vessel wall; and a second portion having a perfusion window through which blood flows in a first configuration and through which blood is prevented from flowing in a second configuration. The stent-graft can further include a transition portion between the first portion and the second portion. The perfusion window can be formed in one of the first portion, the second portion, and the transition portion. One of the first and second portions has a smaller diameter

than the other. The transition portion between the first portion and the second portion that can be frustoconically shaped.

Thus, various embodiments may comprise a stent-graft having a first portion that is configured to engage a vessel wall, a second portion that is configured not to engage a vessel wall, and a perfusion window that is configured to permit blood flow. In various embodiments, a first portion may engage, for example, a portion of a patient’s vessel (e.g., the patient’s aorta), while a second portion may extend distally (and taper radially) into the vessel in such a way that it does not engage or make contact with the vessel wall. Further, and in various embodiments, the first portion may be separated from the second portion by a transition portion, which may itself comprise one or more perfusion windows.

A perfusion window may permit blood and/or other fluids to flow from a region interior to the first portion of a stent-graft to a region exterior to the second portion of the stent-graft. For example, a perfusion window may, in various embodiments, permit blood, as well as one or more contrast media, to flow over an exterior surface of the second portion.

Contrast media may comprise, for example, fluoroscopic and/or radiopaque agents, dyes, and/or the like. With respect to contrast media, in general, these may be used to identify side-branch vessels (e.g., the renal arteries). More specifically, contrast media may be used to observe real time X-ray images of cardiovascular structures such as the renal arteries during implantation of a stent-graft. For example, contrast media may be permitted to flow through one or more perfusion windows and over a second portion of the stent-graft, whereupon fluoroscopic images of the contrast agent in the blood may be developed. These images may, in various embodiments, comprise still images and/or real time motion images. These images may further allow two-dimensional visualization, for example, of the location and/or anatomical disposition of a vessel (e.g., an aorta), any side-branch vessels (e.g., renal arteries), the second portion of the stent-graft (including, in various embodiments, a target portion of the stent-graft) and/or the prosthesis or stent-graft itself. Likewise, in various embodiments, one or more characteristics (e.g., location, orientation, etc.) of a stent-graft may be determined using one or more radiopaque or echogenic markers or indicators. These may be incorporated in or on the stent-graft. A radiopaque marker may comprise, in various embodiments, a radio-opaque element that enhances imaging and/or detection during and/or following delivery or deployment of the stent-graft. Radiopaque markers may comprise one or more of tungsten, gold, platinum, and/or any other material or combination of materials that is visible or detectable in the presence of radiation.

Having visualized one or more vessels, the location and/or orientation of a stent-graft implanted in one or more of the vessels, and/or a portion of the stent-graft, a physician may use a fenestration device to make a fenestration, in situ, in one or more portions of an implanted stent-graft. For instance, a physician may fenestrate a stent-graft in a location that is proximate to and/or spans a patient’s side-branch vessel or vessels (e.g., one or more renal arteries). Moreover, after a stent-graft is fenestrated, a physician may deliver and/or implant one or more side-branch stent-grafts, which may be coupled to the stent-graft at the one or more points of fenestration. Thus, a patient may be implanted with a first stent-graft, which may be visualized and fenestrated in situ, as well as one or more side-branch stent-grafts, which may be coupled to one or more points of fenestration.

5

With respect to FIG. 1, a stent-graft **102** having a proximal end **112** and a distal end **114** is shown implanted in an aorta **100**. More particularly, in FIG. 1, stent-graft **102** is shown positioned in aorta **100** proximal to iliac arteries **108** and **110**. In various embodiments, however, and as described elsewhere herein, stent-graft **102** may be implanted in any vessel (e.g., any main vessel) in a patient's body that includes one or more branch vessels.

With respect to FIG. 2, a perspective view of stent-graft **102** is shown. Stent-graft **102** may be divided into a plurality of sections or portions **200**, **202** and **204**. A first section **200** may comprise a larger diameter capable of engaging a vessel **100** wall. Engagement of a vessel **100** wall may hold stent-graft **102** in place so as to prevent movement of stent-graft **102** once it is deployed within vessel **100**. In various embodiments, first section **200** may engage vessel **100** by way of a friction fit, one or more hooks, one or more barbs, and/or one or more raised stent apices, which may assist in fastening or adhering stent-graft **102** to vessel **100**.

A transition section **202** may taper between first section **200** and smaller diameter second section **204**. Transition section **202** may comprise at least one perfusion window **116**, through which blood and/or other fluids (e.g., contrast media) may flow or perfuse. A direction and manner of fluid flow through perfusion windows **116** is depicted by arrows **118**. Although perfusion windows **116** are depicted in the Figures as triangles, perfusion windows **116**, may, in various embodiments, comprise any shape, e.g., circles, ovals, rectangles, squares, diamonds, polyhedrons, combinations of any of these, and the like. Perfusion windows **116** may be further manufactured by any method known in the art including using a laser to cut perfusion windows **116** through stent-graft **102**.

Second section **204** may comprise a smaller diameter than first section **200**. And, as described elsewhere herein, second section **204** may be configured to not engage vessel **100** wall. For instance, second section **204** may be smaller in diameter than either of first section **200** and/or transition section **202**. Thus, second section **204** does not engage vessel **100** wall, because it is spaced apart therefrom.

For a stent-graft **102** having the above described configuration, blood may perfuse through perfusion windows **116** and continue to flow into branch vessels **104** and **106** (i.e., prior to fenestration, as described elsewhere herein). Blood exiting perfusion windows **116** may further flow toward, for example, iliac arteries **108** and **110**. Further, as used elsewhere herein, where stent-graft **102** is implanted in a main vessel (see above) and/or configured with perfusion windows **116** and/or three sections **200**, **202**, **204**, stent-graft **102** may be referred to as a primary stent-graft (as opposed, for example, to a side-branch stent-graft).

In operation, stent-graft **102** may be deployed in a vessel **100** that comprises or meets with at least one branch vessel **104** and/or **106**. For example, stent-graft **102** may be deployed proximate to and/or spanning one or more branch vessels **104** and/or **106**. More particularly, first section **200** of stent-graft **102** may be deployed proximate to and/or spanning one or both of branch vessels **104** and/or **106**. Second section **204**, which may have a smaller diameter than first section **200**, may not fully (or partially) engage a wall of vessel **100**. Therefore, as blood flows into stent-graft **102**, as illustrated by arrow **120**, blood may flow through stent-graft **102**, from proximal end **112** to distal end **114**. As blood continues to flow in this direction, some blood may be diverted through perfusion windows **116**. This feature of stent-graft **102** may permit blood to continue to flow in the space between stent-graft **102** and vessel **100**. That is blood

6

may perfuse through perfusion windows **116** so that it flows between second section **204** and vessel **100**. Further, as mentioned above, as blood flows over the exterior surface of second section **204**, some may be diverted or perfuse branch vessels **104** and/or **106**, as illustrated by arrows **118a**.

In a variety of embodiments, contrast media may be delivered to proximal end **112** and/or distal end **114** of stent-graft **102** such that the contrast media passes into and/or mixes with the blood stream. Contrast media may, in addition, be delivered systemically into a patient's body. As blood carries the contrast media, some of the blood containing contrast media may be diverted into and through perfusion windows **116** and into the space between second section **204** and vessel **100**. More distally, and as blood continues to flow through the area between stent-graft **102** and vessel **100**, some of the blood and contrast media may be diverted into branch vessels **104** and/or **106**. A physician may, using a variety of fluoroscopic imaging techniques, detect the contrast media in a patient's branch vessels **104** and/or **106** in situ. In other words, a physician may take advantage of contrast media perfusing through perfusion windows **116** to image a portion of a patient's vasculature and/or a location, placement, and/or orientation of stent-graft **102**, in situ. Likewise, in various embodiments, one or more characteristics (e.g., location, orientation, etc.) of stent-graft **102** may be determined using one or more radiopaque or echogenic markers or indicators. These may be incorporated in or on stent-graft **102**.

Further, in various embodiments, a contrast media may illuminate or make visible one or more target portions of stent-graft **102**. A target portion may comprise, for example, an area of stent-graft **102** that is located proximate to and/or spanning one or more side-branch vessels and/or a portion of stent-graft **102** that is more easily fenestratable than, for example, a sturdier or more durable portion of stent-graft **102**. In various embodiments, a target portion may comprise a softer graft material and/or a graft material that is more visible, brighter, or otherwise distinguishable in the presence of a contrast media. For example, a target portion may comprise one or more radiopaque or echogenic markers or indicators. Having visualized stent-graft **102**, a physician may utilize the variety of detailed information obtained about stent-graft **102** (e.g., information about a patient's vasculature and/or the location, placement, orientation, and/or characteristics of stent-graft **102**), to manipulate, in great detail, stent-graft **102** (e.g., relative to, for example, the position or location of a patient's branch vessels **104** and/or **106**).

Turning now to FIG. 3, once stent-graft **102** is deployed and side-branch vessels **104** and **106** are visualized, as described above, a physician may insert a fenestration tool or device **300** to fenestrate stent-graft **102** at the location of one or more branch vessels **104** and/or **106** and/or at one or more target portions **308**. As described elsewhere herein, a patient's side-branch vessels **104** and/or **106** as well as a placement of stent-graft **102** relative to the patient's side-branch vessels **104** and/or **106** may be carefully and precisely visualized. Thus, a physician may more accurately fenestrate stent-graft **102** in one or more locations proximate to one or more side-branch vessels **104** and/or **106** to attach one or more side-branch stent-grafts, as described more fully below. To this end, in various embodiments, fenestration device **300** may comprise a locating or centering tool **302**, which may center, locate and/or engage a tip **304** of fenestration device **300** as well as provide leverage or a counterforce, so that tip **304** can be pushed through, or make a fenestration in, a side wall of stent-graft **102**.

Accordingly, once stent-graft **102** is fenestrated, one or more side-branch, or secondary, stent-grafts may be delivered and deployed within one or more side-branch vessels **104** and/or **106**. For example, and with particular reference to FIGS. **6** and **7**, a portion of a side-branch stent-graft **400** may be deployed within a side-branch vessel **104** and/or **106**. Further, during deployment, a portion of side-branch stent-graft **400** may be attached or coupled to stent-graft **102**. That is, for example, a portion of side-branch stent-graft **400** may be coupled to stent-graft **102** via, or through, one or more of the fenestrations made by fenestration device **300**. Moreover, in certain embodiments, after fenestration of stent-graft **102**, a balloon may be placed in the fenestration and inflated to further define and/or widen the fenestration before deploying side-branch stent-graft **400**.

Thus, one or more side-branch stent-grafts **400** may be precisely deployed within the vasculature of a patient. Each side-branch stent-graft **400** may be fastened or attached to stent-graft **102** at a fenestration point, which may be cut or made in situ based upon imaging data collected by a physician through the introduction of a contrast media in the patient's vasculature. That is, and in other words, side-branch stent-graft **400** may be attached, based upon imaging data, to stent-graft **102** precisely at a location of a patient's side-branch vessels **104** and/or **106**. Further, side-branch stent-graft **400** may be inserted in a patient's vasculature and coupled to stent-graft **102** using only a single fenestration device **300**. Thus, the disclosed devices and methods comprise a significant advantage over prior art devices and methods, which may not be fenestrated in situ to accommodate a patient's actual anatomy, which require, due to their inherent imprecision, a plurality of (e.g., percutaneous) installation devices (e.g., guidewires, catheters, and the like), and which may occlude a patient's side-branch vessels **104** and/or **106** during implantation.

Broadly, and with particular reference now to FIGS. **4**, **5**, and **6**, side-branch stent-graft **400** is depicted from a variety of perspectives and in a variety of configurations. For instance, with respect to FIG. **4**, side-branch stent-graft **400** is depicted in a restrained configuration on a delivery catheter **411**. Delivery catheter **411** may comprise an olive **416** and/or a guidewire **414**. In a restrained configuration, side-branch stent-graft **400** may further comprise a restraining sleeve, which may isolate or constrain side-branch stent-graft **400** in a restrained or constrained configuration.

With particular reference to FIG. **4**, and in various embodiments, side-branch stent-graft **400** may comprise a plurality of stent and/or stent-graft members **402a**, **b**, **c** and/or **406**. One or more graft members **404a**, **b**, **c** may interconnect one or more stent members **402a**, **b**, **c** and/or **406**. For example, stent members **402a**, **b**, **c** and/or **406** may comprise stent rings, and these may be interconnected by graft sections **404a**, **b**, **c**. This construction allows for a highly flexible side-branch stent-graft **400** (because graft sections **404a**, **b**, **c** may comprise a flexible material, such as ePTFE). Notwithstanding this construction, however, a variety of other constructions, as described herein and/or as known in the art, may be used. Further, and in a variety of embodiments, additional graft material and/or a cuff may be loosely placed on or coupled to at least a portion of an outer surface of stent member **402a**, **b**, **c**, **406** and/or graft section **404a**, **b**, **c**.

Continuing, and with reference to FIGS. **5** and **6**, side-branch stent-graft **400** is shown in an expanded configuration. As shown in FIG. **5**, when side-branch stent-graft **400** is expanded, stent member **406** may expand to form a flat disc shape (which may comprise, for example, a covered or

uncovered wire frame). In addition, as stent member **406** expands, graft **404a**, **b**, **c** and/or a cuff (which may comprise loosely placed graft material) may "scrunch" or move in the direction indicated by arrows **412** (see FIG. **4**).

This "scrunching" may form folds extending radially outward in the graft material of graft **404a**, **b**, **c** and/or the cuff. These folds may, in turn, help to seal side-branch stent-graft **400** against a wall **602** of stent-graft **102** through which fenestration device **300** has made a fenestration **604** or puncture. That is, and with attention to FIG. **6**, stent member **406** may form a flange-type seal as it lays flat against wall **602** of stent-graft **102**. In this configuration, and in various embodiments, no blood, or only a minimum amount of blood, may leak through the fenestration **604**. In addition, after graft **404a**, **b**, **c** and/or the material comprising the cuff "scrunches" and forms folds, the folds may form on the outer and/or inner walls of stent-graft **102** to create an additional seal around fenestration **604**.

In a variety of embodiments, once stent-graft **102** is fenestrated and one or more secondary stent-grafts **400** are delivered and deployed, it may be advantageous to block or otherwise occlude perfusion windows **116**. Accordingly, with reference now to FIG. **7**, a "window cover" or occluder **700** may be delivered to and/or deployed in stent-graft **102**. More particularly, occluder **700** may be deployed interior to or within first section **200** and/or interior to or within transition section **202** of stent-graft **102** to block or occlude perfusion windows **116**. Occluder **700** may, in various embodiments, have generally the same shape as first section **200** and/or transition section **202** of stent-graft **102**. That is, occluder **700** may conform to an interior surface of stent-graft **102**. However, occluder **700** does not have perfusion windows. Indeed, occluder **700** may comprise a solid or impermeable wall, which covers and/or occludes perfusion windows **116** entirely or in part.

With regard to delivery and deployment of occluder **700**, occluder **700** may be delivered in a constrained configuration and expanded within stent-graft **102**. Occluder **700** may be further released from a constrained position within stent-graft **102** to seal or occlude perfusion windows **116**. Thus, in a deployed configuration, occluder **700** may force or constrain blood to flow only through stent-graft **102** and/or one or more side-branch stent-grafts **400**.

Thus, in various embodiments, a method for in situ fenestration of a stent-graft **102** at the site of one or more side-branch vessels **104** and/or **106** is disclosed. The method may comprise deploying stent-graft **102** within a vessel **100**, in which the stent-graft **102** spans and/or extends at least partially distal to one or more side-branch vessels **104** and/or **106**. In various embodiments, the method may further comprise deploying at least one side-branch stent-graft **400** in at least one side-branch vessel **104** and/or **106** after fenestrating stent-graft **102**. Further still, the method may comprise covering at least one perfusion window **116** with an occluder **700**, which may comprise, in various embodiments, a stent-graft and/or a graft and/or graft material. In various embodiments, stent-graft **102** and/or side-branch stent-graft **400** may comprise a polymer, such as ePTFE, one or more self-expanding stents, a titanium-nickel alloy (e.g., nitinol), one or more stents with undulations, and the like. Further, in various embodiments, and as described elsewhere herein, the shape of one or more perfusion windows **116** may comprise a triangle, a circle, an oval, a rectangle, a square, a diamond, a polyhedron, combinations of these, and the like. Moreover, and in various embodiments, first section **200** of stent-graft **102** may comprise hooks, barbs

and/or raised stent apices that assist in fastening and/or adhering stent-graft **102** to vessel **100**.

Returning briefly to FIG. 2, a graft **214** comprising any of the grafts and/or stent-grafts described above may be made up of any material which is suitable for use as a graft in the chosen body lumen. A graft **214** may comprise one or a variety of materials. Furthermore, a graft **214** may comprise multiple layers of material, which can be the same material or different material. Although a graft **214** may have several layers of material, the graft may have a layer that is formed into a tube (innermost tube) and an outermost layer that is formed into a tube (outermost tube). In some embodiments, a graft **214** may be fenestrated with a fenestration tool.

Many graft materials are known, and in various embodiments, these materials can be used in combination and assembled together to comprise a graft. These materials may be further extruded, coated and/or formed from wrapped films, and/or a combination thereof. Polymeric materials, biodegradable materials, and/or natural materials can be used for specific applications.

In various embodiments, a graft may comprise synthetic polymers including nylon, polyacrylamide, polycarbonate, polyformaldehyde, polymethylmethacrylate, polytetrafluoroethylene, polytrifluorochlorethylene, polyvinylchloride, polyurethane, elastomeric organosilicon polymers, polyethylene, polypropylene, polyurethane, polyglycolic acid, polyesters, polyamides, their mixtures, blends, and copolymers. In a variety of embodiments, a graft may be made from a class of polyesters such as polyethylene terephthalate including DACRON® and MYLAR® and polyaramids such as KEVLAR®, polyfluorocarbons such as polytetrafluoroethylene (PTFE) with and without copolymerized hexafluoropropylene (TEFLON® or GORE-TEX®), and porous or nonporous polyurethanes. Further, in a variety of embodiments, a graft may comprise expanded fluorocarbon polymers (especially PTFE), materials described in British. Pat. Nos. 1,355,373; 1,506,432; or in U.S. Pat. Nos. 3,953,566; 4,187,390; or 5,276,276, all of which are incorporated by reference in their entireties.

In various embodiments, fluoropolymers may include polytetrafluoroethylene (PTFE), expanded PTFE (ePTFE), fluorinated ethylene propylene (FEP), copolymers of tetrafluoroethylene (TFE) and perfluoro (propyl vinyl ether) (PEA), homopolymers of polychlorotrifluoroethylene (PCTFE), and its copolymers with TFE, ethylene-chlorotrifluoroethylene (ECTFE), copolymers of ethylene-tetrafluoroethylene (ETFE), polyvinylidene fluoride (PVDF), and polyvinylfluoride (PVF). In various embodiments, a graft may comprise any combination of the materials listed above. Further, in various embodiments, a graft may be substantially impermeable and/or permeable to bodily fluids. A substantially impermeable graft may be made from materials that are substantially impermeable to bodily fluids or can be constructed from permeable materials treated or manufactured to be substantially impermeable to bodily fluids (e.g. by layering different types of materials described above or known in the art). In various embodiments, stent-graft **102**, side-branch stent-graft **400** and/or occluder **700**, as described above, may be made from any combination of the materials described above, including ePTFE.

Any stent, including stent **212** and/or stent members **402a**, **b**, **c**, and/or **406**, as described elsewhere herein, may be generally cylindrical when restrained and/or when unrestrained and may comprise helically arranged undulations having a plurality of helical turns. In a variety of embodiments, undulations may be aligned so that they are “in-phase” with each other, as shown, for example, in FIG. 1.

More specifically, undulations may comprise apices in opposing first and second directions. When these undulations are in-phase, apices in adjacent helical turns are aligned so that apices can be displaced into respective apices of a corresponding undulation in an adjacent helical turn. In certain embodiments, undulations may have a sinusoidal shape, a U shape, a V shape, and/or an ovaloid shape, as described in U.S. Pat. No. 6,042,605, both of which are incorporated by reference herein in their entireties.

In various embodiments, a stent may be fabricated from a variety of biocompatible materials including commonly known materials (or combinations of materials) used in the manufacture of implantable medical devices. Such materials may include 316L stainless steel, cobalt-chromium-nickel-molybdenum-iron alloy (“cobalt-chromium”), other cobalt alloys such as L605, tantalum, nitinol, or other biocompatible metals. In some embodiments, any stent and/or stent-graft described herein may comprise a balloon expandable stent and/or stent-graft and/or a self-expanding stent and/or stent-graft. Further, in certain embodiments, a stent may comprise a wire wound stent, which may or may not comprise undulations.

Numerous characteristics and advantages have been set forth in the preceding description, including various alternatives together with details of the structure and function of the devices and/or methods. The disclosure is intended as illustrative only and as such is not intended to be exhaustive. It will be evident to those skilled in the art that various modifications may be made, especially in matters of structure, materials, elements, components, shape, size, and arrangement of parts including combinations within the principles of the invention, to the full extent indicated by the broad, general meaning of the terms in which the appended claims are expressed. To the extent that these various modifications do not depart from the spirit and scope of the appended claims, they are intended to be encompassed therein.

What is claimed is:

1. A stent-graft comprising:

a stent-graft member including a stent and a graft, the graft defining a lumen for conveying blood flow, the stent-graft member including,

a first portion having a first diameter that is configured to engage a vessel wall of a vessel, the vessel wall defining a vessel lumen,

a second portion having a second diameter that is smaller than the first diameter of the first portion,

a transition portion that has an interior surface and extends between the first portion and the second portion, and

a perfusion window formed in the transition portion and oriented to permit blood flow through the transition portion and parallel to a longitudinal axis of the stent-graft member after deployment of the stent graft member in the vessel; and

an occluder free of any perfusion windows, such that the occluder has a continuous, impermeable wall, the occluder having generally the same shape as an interior surface of the transition portion and being inserted into the stent-graft member to block the perfusion window without blocking flow through the lumen of the stent-graft member.

2. The stent-graft of claim **1**, further comprising a target portion that is fenestratable to receive a side-branch stent-graft.

11

3. The stent-graft of claim 1, further comprising an iliac portion that couples to the second portion and is insertable into an iliac artery.

4. The stent-graft of claim 1, further comprising a target media that perfuses through the perfusion window. 5

5. The stent-graft of claim 1, wherein the stent-graft is configured to be fenestrated by a fenestration device and coupled to a side-branch stent-graft.

6. The stent-graft of claim 1, wherein the second portion of the stent-graft has a plurality of branch apertures each configured to receive a branch stent-graft, the stent-graft further comprising a plurality of branch stent-grafts received in respective ones of the plurality branch apertures, and further wherein the occluder is received in the body such that the occluder is engaged with the inner surface of the wall of the body such that substantially all blood entering the lumen of the body at the proximal end of the body passes through the lumen of the body out the distal end of the body and out of the branch stent-grafts without otherwise flowing through the wall of the body. 10 15 20

7. The stent-graft of claim 1, wherein the occluder conforms to the interior surface of stent-graft to block the perfusion window without interfering with blood flow through the lumen of the stent-graft member.

12

8. A stent-graft comprising:

a body including a stent structure and a graft structure, the body having a wall defining an outer surface and an inner surface forming a lumen, the body defining a proximal end and a distal end and including,
 a first portion having a perfusion aperture through the wall of body that is oriented to permit blood flow along the outer surface of the body during deployment of the body in the vessel, and
 a second portion having a plurality of branch apertures each configured to receive a branch stent-graft;
 a plurality of branch stent-grafts received in respective ones of the plurality branch apertures; and
 an occluder free of any perfusion windows, such that the occluder has a continuous, impermeable wall, the occluder being separate from the body and received in the body such that the occluder is engaged with the inner surface of the wall of the body to block flow through the perfusion aperture following deployment of the body such that substantially all blood entering the lumen of the body at the proximal end of the body passes through the lumen of the body out the distal end of the body and out of the branch stent-grafts without otherwise flowing through the wall of the body.

* * * * *