



US008137002B2

(12) **United States Patent**
Lu et al.

(10) **Patent No.:** **US 8,137,002 B2**
(45) **Date of Patent:** **Mar. 20, 2012**

(54) **MECHANICAL INTERFACE CONVERTER FOR MAKING NON-RUGGEDIZED FIBER OPTIC CONNECTORS COMPATIBLE WITH A RUGGEDIZED FIBER OPTIC ADAPTER**

(75) Inventors: **Yu Lu**, Eden Prairie, MN (US); **Randy Reagan**, Morristown, NJ (US); **Dennis Cheatham**, Richardson, TX (US)

(73) Assignee: **ADC Telecommunications, Inc.**, Eden Prairie, MN (US)

(*) Notice: Subject to any disclaimer, the term of this patent is extended or adjusted under 35 U.S.C. 154(b) by 150 days.

(21) Appl. No.: **12/725,151**

(22) Filed: **Mar. 16, 2010**

(65) **Prior Publication Data**

US 2010/0172616 A1 Jul. 8, 2010

Related U.S. Application Data

(63) Continuation of application No. 12/115,966, filed on May 6, 2008, now Pat. No. 7,677,814.

(60) Provisional application No. 60/916,295, filed on May 6, 2007, provisional application No. 60/948,781, filed on Jul. 10, 2007, provisional application No. 61/003,948, filed on Nov. 21, 2007.

(51) **Int. Cl.**
G02B 6/36 (2006.01)

(52) **U.S. Cl.** **385/78**

(58) **Field of Classification Search** 385/78,
385/53

See application file for complete search history.

(56) **References Cited**

U.S. PATENT DOCUMENTS

4,140,366 A 2/1979 Makuch et al.
4,140,367 A 2/1979 Makuch et al.

4,142,776 A 3/1979 Cherin et al.
4,174,882 A 11/1979 McCartney
4,225,214 A 9/1980 Hodge et al.
4,279,467 A 7/1981 Borsuk et al.
4,354,731 A 10/1982 Mouissie
4,684,205 A 8/1987 Margolin et al.
4,705,352 A 11/1987 Margolin et al.
4,715,675 A 12/1987 Kevern et al.
4,725,120 A 2/1988 Parzygnat
4,793,683 A 12/1988 Cannon, Jr. et al.

(Continued)

FOREIGN PATENT DOCUMENTS

DE 35 37 684 A1 4/1987

(Continued)

OTHER PUBLICATIONS

U.S. Appl. No. 12/115,982, filed May 6, 2008 entitled "Interface Converter for SC Fiber Optic Connectors".

(Continued)

Primary Examiner — Uyen Chau N Le

Assistant Examiner — Kajli Prince

(74) *Attorney, Agent, or Firm* — Merchant & Gould P.C.

(57) **ABSTRACT**

An interface converter is provided for mechanically and optically coupling a non-ruggedized fiber optic connector with a ruggedized adapter port. In a preferred embodiment, the interface converter attaches to an SC fiber optic connector and together form a converted fiber optic connector compatible with the ruggedized adapter port. In certain embodiments, a retractable release sleeve may be removed from the SC fiber optic connector prior to attaching the interface converter. In certain embodiments, the interface converter may be inserted into the ruggedized adapter port prior to being attached to the SC fiber optic connector.

26 Claims, 33 Drawing Sheets

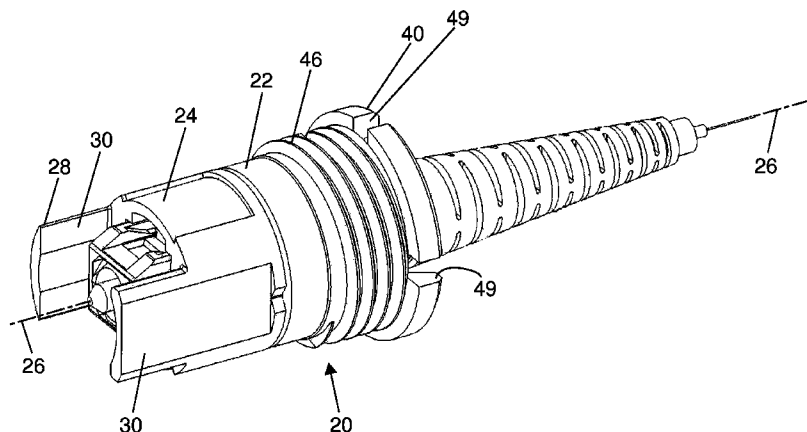

U.S. PATENT DOCUMENTS			FOREIGN PATENT DOCUMENTS			
			6,916,120	B2	7/2005	Zimmel et al.
4,820,185	A	4/1989	6,962,445	B2	11/2005	Zimmel et al.
4,902,238	A	2/1990	7,044,650	B1	5/2006	Tran et al.
4,907,853	A	3/1990	7,090,406	B2	8/2006	Melton et al.
4,961,623	A	10/1990	7,090,407	B2	8/2006	Melton et al.
5,042,901	A	8/1991	7,111,990	B2	9/2006	Melton et al.
5,104,242	A	4/1992	7,113,679	B2	9/2006	Melton et al.
5,212,752	A	5/1993	7,137,742	B2	11/2006	Theuerkorn et al.
5,214,830	A	6/1993	7,146,090	B2	12/2006	Vo et al.
5,267,342	A	11/1993	7,201,518	B2	4/2007	Holmquist
5,276,750	A	1/1994	7,204,644	B2	4/2007	Barnes et al.
5,283,848	A	2/1994	7,207,727	B2	4/2007	Tran et al.
5,317,663	A	5/1994	7,234,877	B2	6/2007	Sedor
5,465,313	A	11/1995	7,244,066	B2	7/2007	Theuerkorn
5,590,229	A	12/1996	7,264,402	B2	9/2007	Theuerkorn et al.
5,633,970	A	5/1997	7,292,763	B2	11/2007	Smith et al.
5,715,342	A	2/1998	7,317,863	B2	1/2008	Lu et al.
5,751,874	A	5/1998	7,331,719	B2	2/2008	Manning et al.
5,778,122	A	7/1998	7,346,256	B2	3/2008	Marrs et al.
5,887,095	A	3/1999	7,380,992	B2	6/2008	Kramer et al.
5,892,870	A	4/1999	7,614,797	B2*	11/2009	Lu et al. 385/53
5,920,669	A	7/1999	2001/0012428	A1	8/2001	Nakajima et al.
5,923,804	A	7/1999	2001/0036345	A1	11/2001	Gimblet et al.
5,940,559	A	8/1999	2002/0022392	A1	2/2002	Below et al.
5,946,436	A	8/1999	2002/0062978	A1	5/2002	Sakabe et al.
5,971,625	A	10/1999	2002/0081077	A1	6/2002	Nault
5,971,626	A	10/1999	2003/0063867	A1	4/2003	McDonald et al.
5,993,071	A	11/1999	2003/0094298	A1	5/2003	Morrow et al.
6,149,313	A	11/2000	2003/0095754	A1	5/2003	Matsumoto et al.
6,151,432	A	11/2000	2003/0095780	A1	5/2003	Chang
RE37,028	E	1/2001	2004/0017983	A1	1/2004	Chen et al.
6,179,475	B1	1/2001	2004/0033028	A1	2/2004	Cheng
6,186,670	B1	2/2001	2004/0038588	A1	2/2004	Bernardi et al.
6,188,822	B1	2/2001	2004/0047566	A1	3/2004	McDonald et al.
RE37,079	E	3/2001	2004/0120663	A1	6/2004	Lail et al.
RE37,080	E	3/2001	2004/0223699	A1	11/2004	Melton et al.
6,206,579	B1	3/2001	2004/0223720	A1	11/2004	Melton et al.
6,234,683	B1	5/2001	2004/0228589	A1	11/2004	Melton et al.
6,234,685	B1	5/2001	2005/0041928	A1	2/2005	Zimmel et al.
6,254,278	B1	7/2001	2005/0064752	A1	3/2005	Serino
6,264,374	B1	7/2001	2005/0117850	A1	6/2005	Milette
6,298,190	B2	10/2001	2005/0232553	A1	10/2005	Holmquist
6,305,849	B1	10/2001	2006/0056769	A1	3/2006	Khemakhem et al.
6,357,929	B1	3/2002	2006/0088247	A1	4/2006	Tran et al.
6,371,660	B1	4/2002	2006/0088248	A1	4/2006	Tran et al.
6,419,402	B1	7/2002	2006/0089049	A1	4/2006	Sedor
6,427,035	B1	7/2002	2006/0115219	A1	6/2006	Mudd et al.
6,428,215	B1	8/2002	2007/0025665	A1	2/2007	Dean, Jr. et al.
6,461,057	B2	10/2002	2007/0077010	A1	4/2007	Melton et al.
6,466,725	B2	10/2002	2008/0044137	A1	2/2008	Luther et al.
6,496,641	B1	12/2002	2008/0131132	A1	6/2008	Solheid et al.
6,522,804	B1	2/2003	2008/0175541	A1	7/2008	Lu et al.
6,539,147	B1	3/2003	2008/0175542	A1	7/2008	Lu et al.
6,540,410	B2	4/2003	2008/0175546	A1	7/2008	Lu et al.
6,542,674	B1	4/2003	2008/0226235	A1	9/2008	Luther et al.
6,546,175	B1	4/2003				
6,568,861	B2	5/2003				
6,579,014	B2	6/2003				
6,614,980	B1	9/2003				
6,619,697	B2	9/2003				
6,625,375	B1	9/2003				
6,629,782	B2	10/2003				
6,648,520	B2	11/2003				
6,652,156	B2	11/2003				
6,655,851	B1	12/2003				
6,668,127	B1	12/2003				
6,678,448	B2	1/2004				
6,685,361	B1	2/2004				
6,695,489	B2	2/2004				
6,702,478	B2	3/2004				
6,714,710	B2	3/2004				
6,739,759	B1	5/2004				
6,783,281	B2	8/2004				
6,785,450	B2	8/2004				
6,789,950	B1	9/2004				
6,817,902	B2	11/2004				
6,848,836	B2	2/2005				
6,899,467	B2	5/2005				
6,909,821	B2	6/2005				
			DE	10	2004	049 697 A1 4/2006
			EP	0	156 075 A2 10/1985	
			EP	0	547 778 A1 6/1993	
			EP	0	581 527 A1 2/1994	
			EP	0	689 069 A1 12/1995	
			EP	0	762 171 A1 3/1997	
			EP	0	855 610 A2 7/1998	
			EP	0	856 761 A1 8/1998	
			EP	0	940 700 A2 9/1999	
			EP	0	949 522 A2 10/1999	
			EP	0	997 757 A2 5/2000	
			EP	1	065 542 A1 1/2001	
			EP	1	258 758 A2 11/2002	
			EP	1	333 537 A1 8/2003	
			EP	1	457 793 A2 9/2004	
			EP	1	566 674 A1 8/2005	
			GB	2	154 333 A 9/1985	
			JP	62-54204	3/1987	
			JP	5-106765	4/1993	

JP	2001-116968	4/2001
WO	WO 94/15232	7/1994
WO	WO 00/31575	6/2000
WO	WO 03/073819 A2	9/2003
WO	WO 2005/072395 A2	8/2005

OTHER PUBLICATIONS

U.S. Appl. No. 12/203,508, filed Sep. 3, 2008 entitled "Hardened Fiber Optic Connector Compatible with Hardened and Non-Hardened Fiber Optic Adapters".

U.S. Appl. No. 12/203,522, filed Sep. 3, 2008 entitled "Hardened Fiber Optic Connection System".

U.S. Appl. No. 12/203,530, filed Sep. 3, 2008 entitled "Hardened Fiber Optic Connection System with Multiple Configurations".

U.S. Appl. No. 12/203,535, filed Sep. 3, 2008 entitled "Hardened Fiber Optic Connector and Cable Assembly with Multiple Configurations".

Delphi Connection Systems, "Harsh Environment Hermaphroditic Fiber Optic Connectors," 16 pages (© 2002).

International Search Report and Written Opinion mailed Aug. 20, 2008.

Opti Tap™ Connector. An Evolant Solutions Product, 2 pages (Sep. 2005).

Stratos Lightwave™ Brochure, "HDLC Hermaphroditic Butt Joint Connector," 2 pages (Undated).

Stratos Lightwave™ Brochure, "HQLC Hermaphroditic Butt Joint Connector," 2 pages (Undated).

* cited by examiner

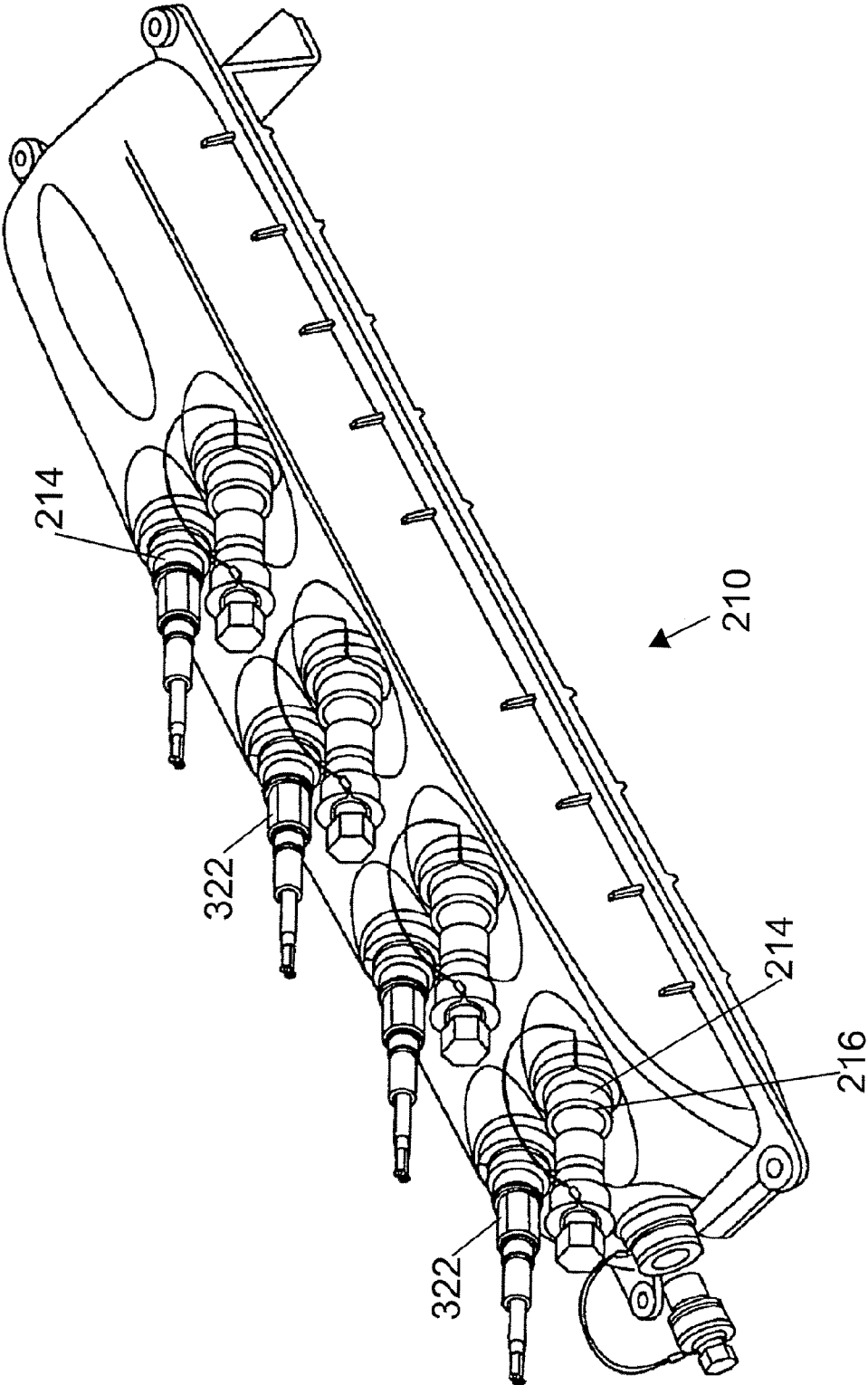

FIG. 1
PRIOR ART

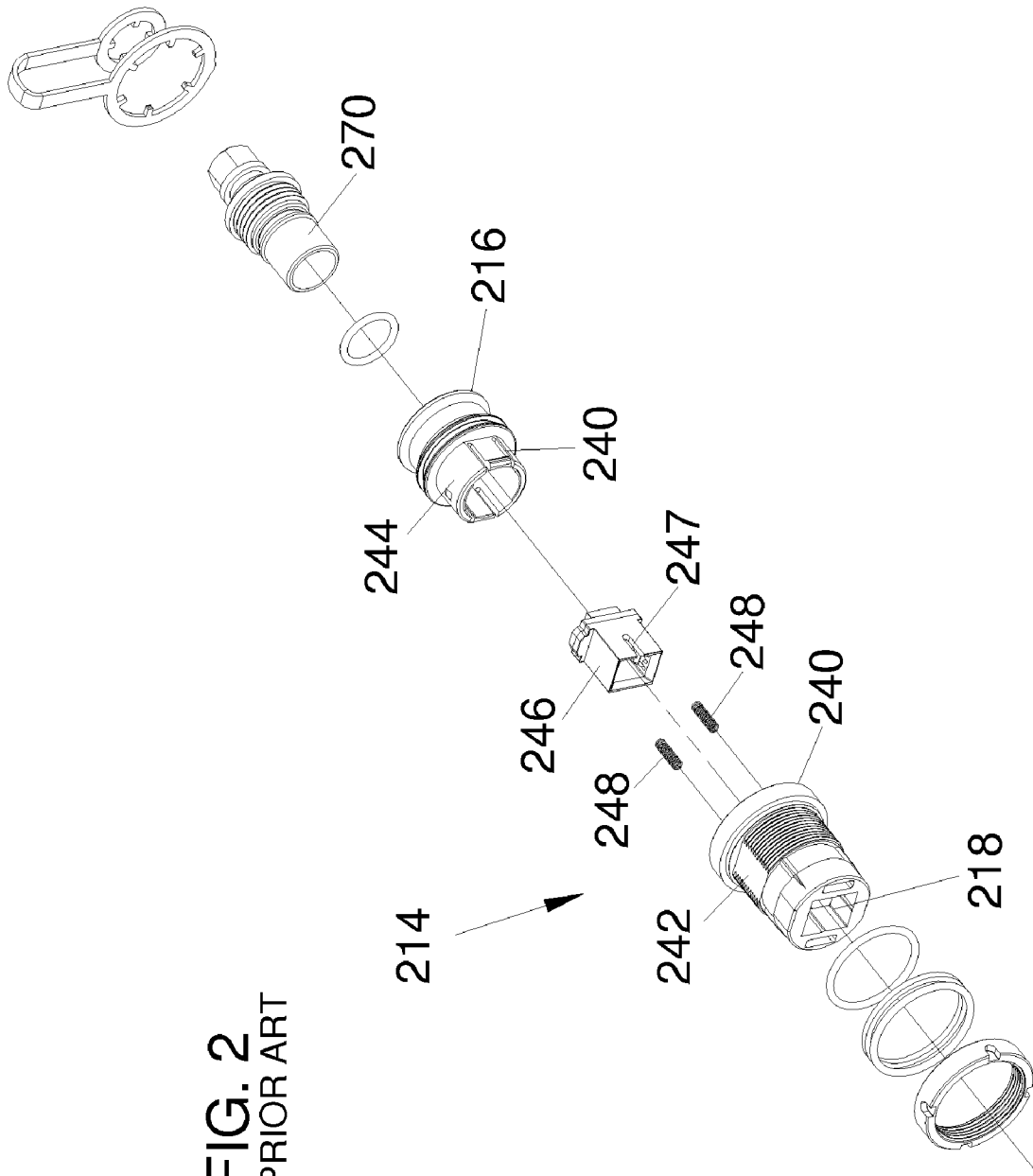

FIG. 2
PRIOR ART

FIG. 3
PRIOR ART

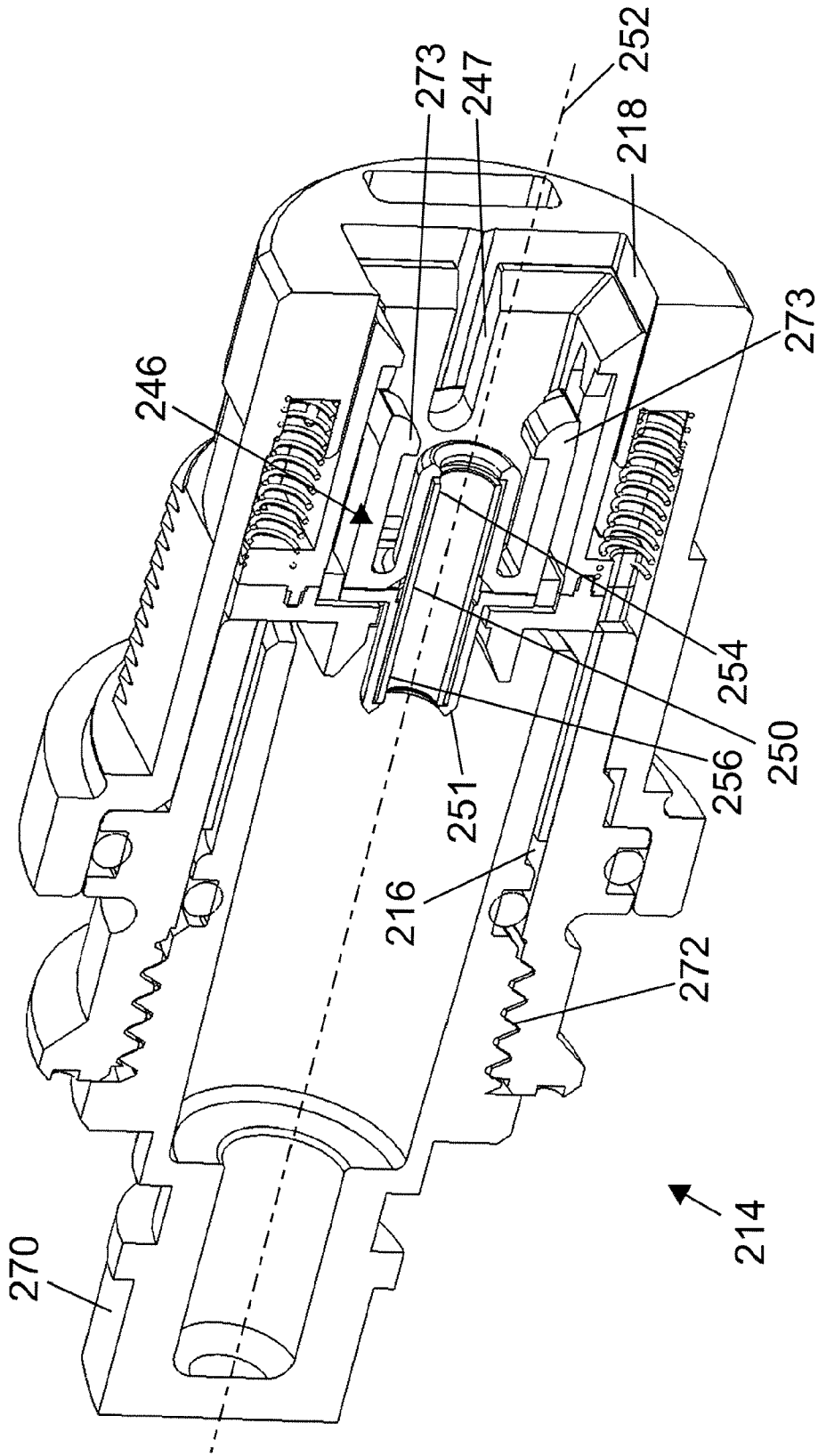
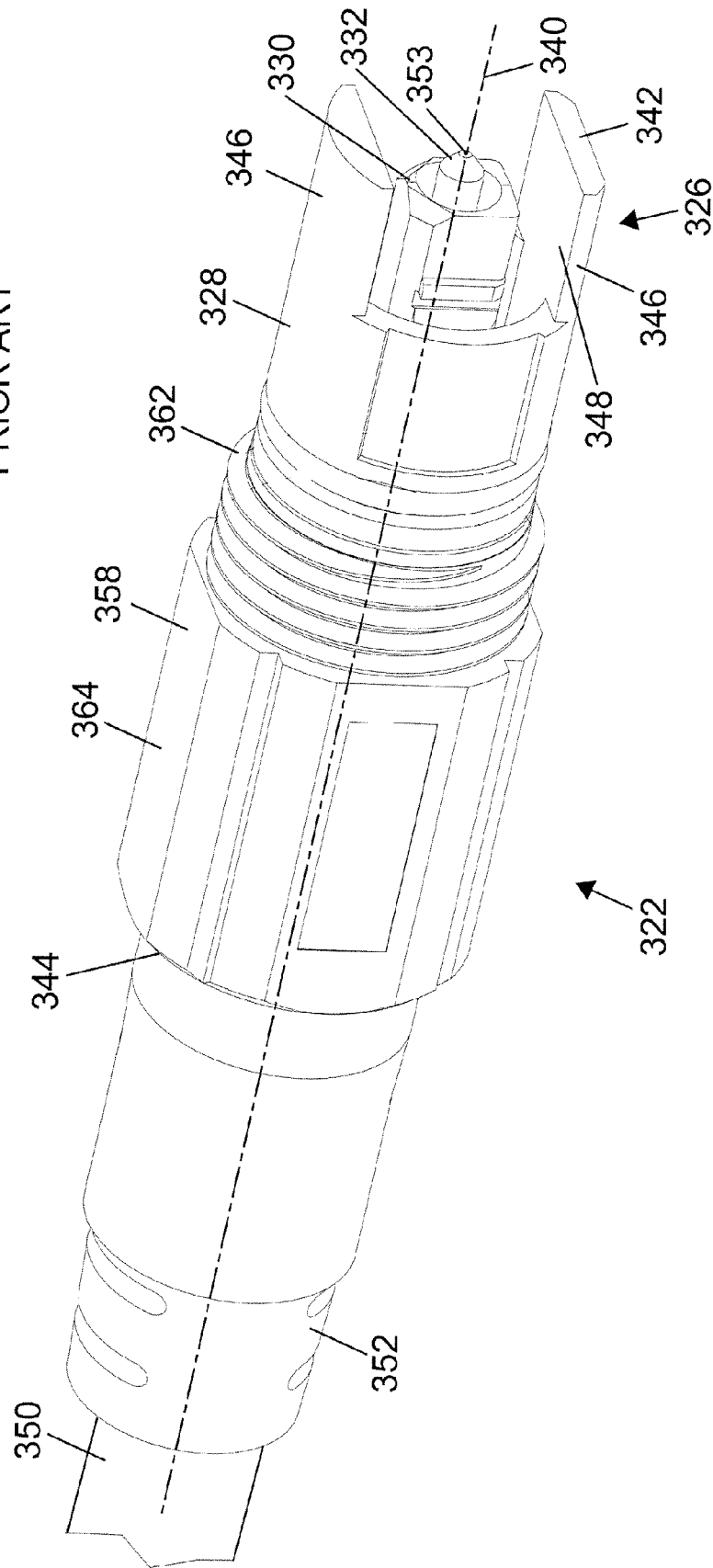

FIG. 4
PRIOR ART



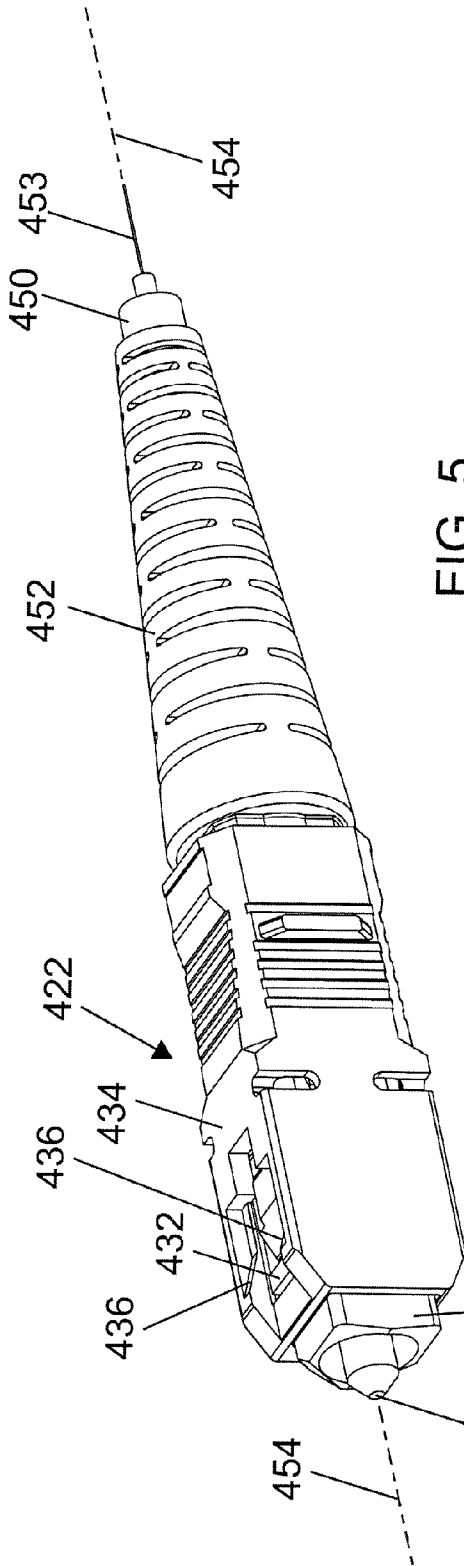

FIG. 5
PRIOR ART

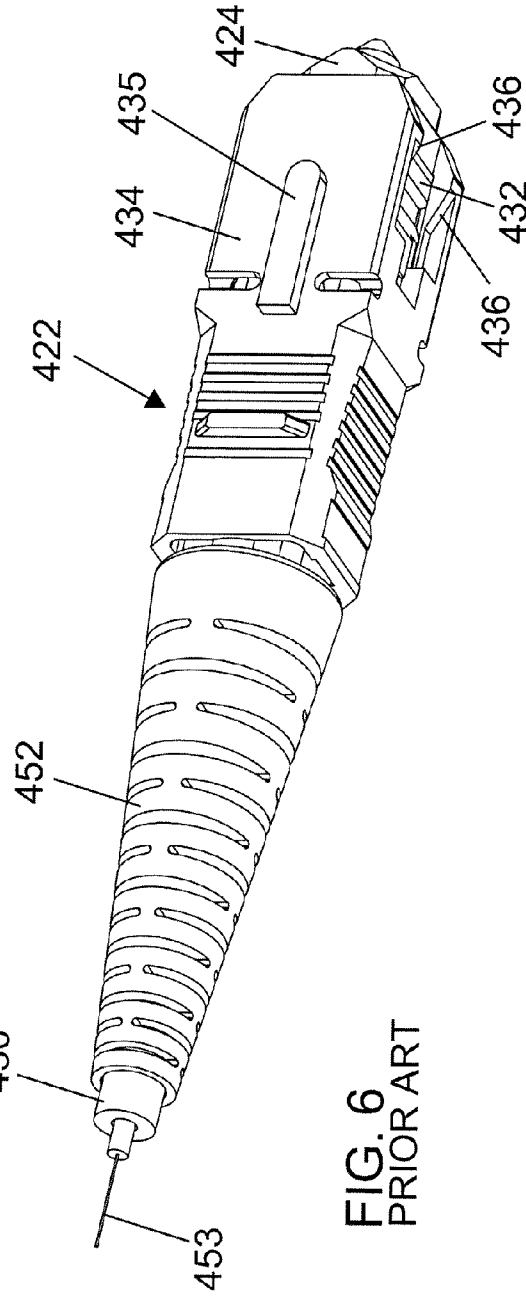
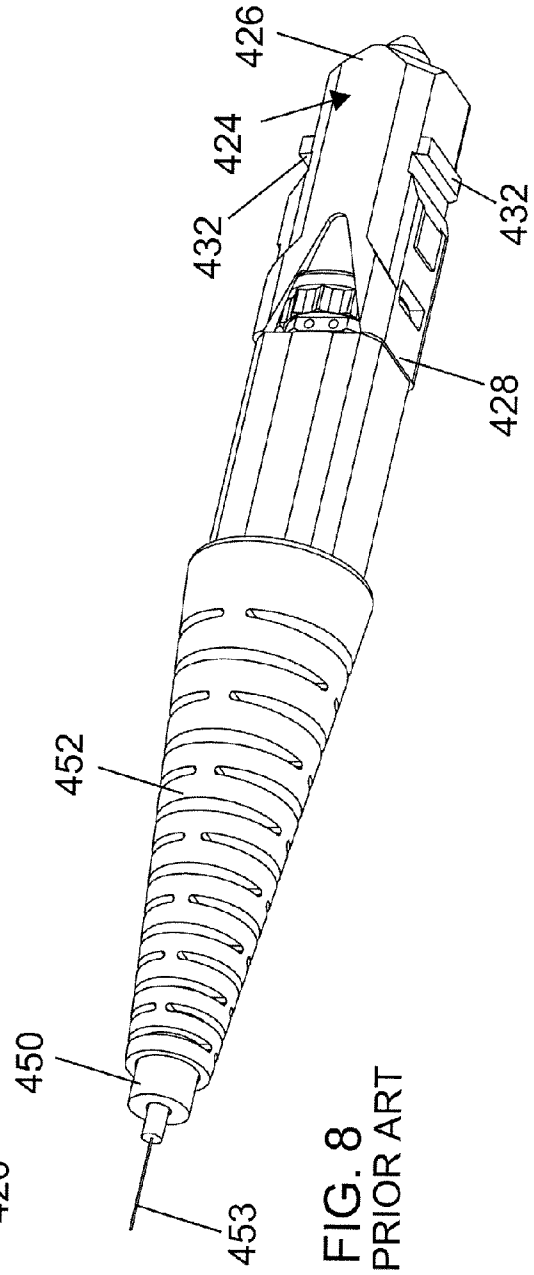
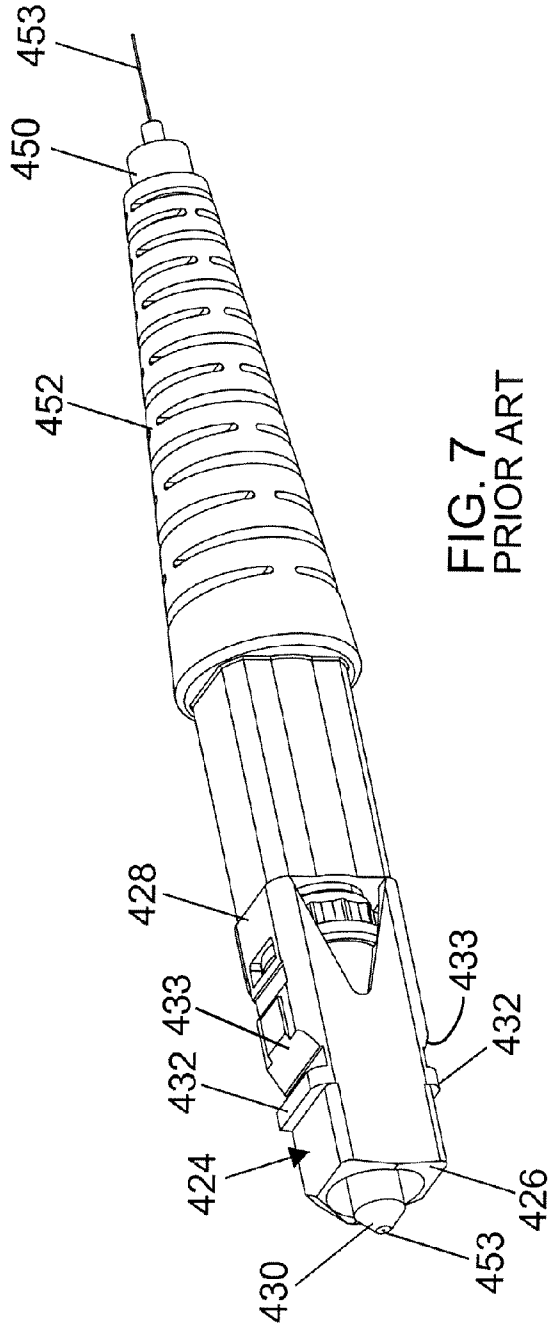

FIG. 6
PRIOR ART



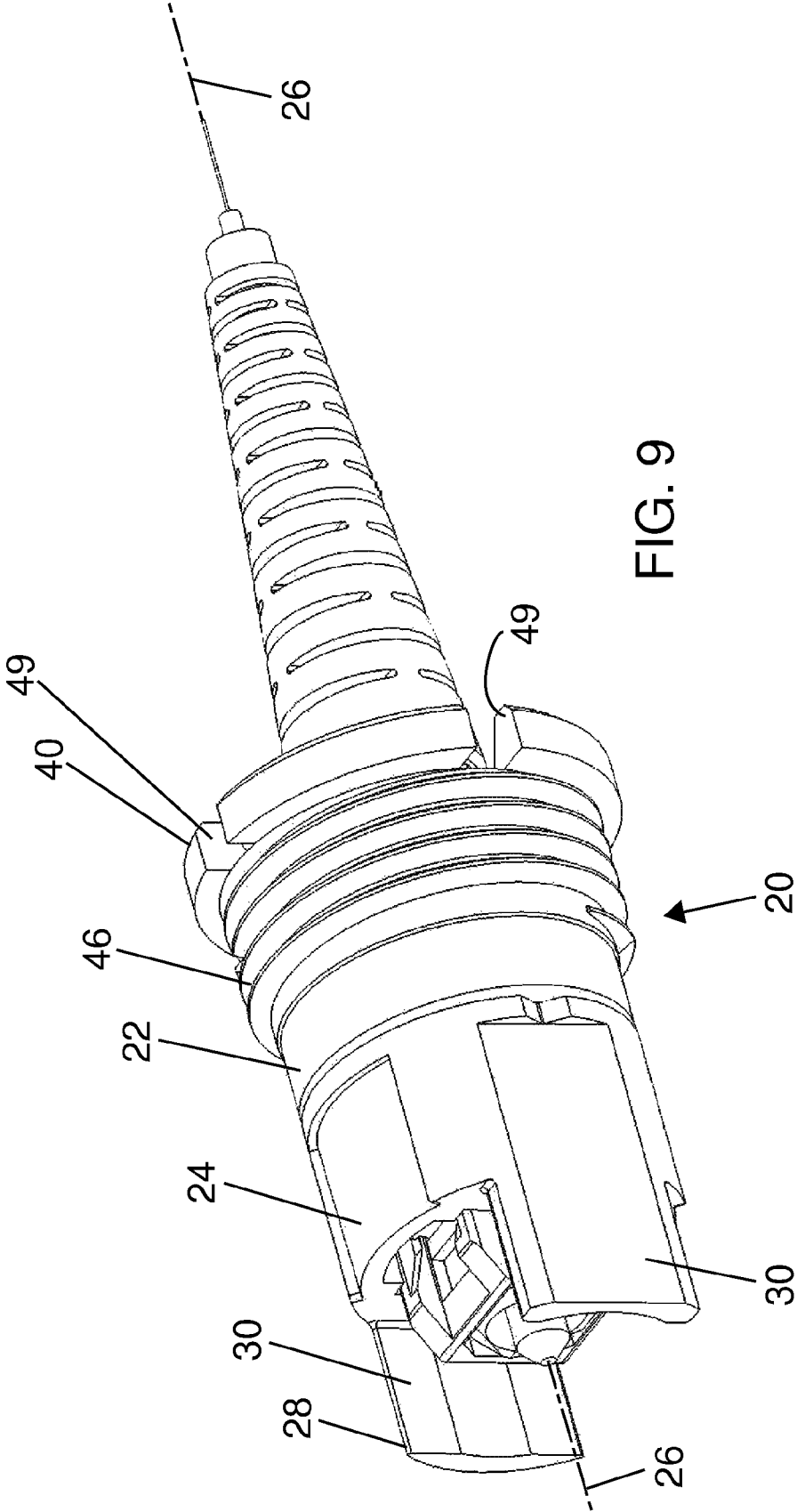

FIG. 9

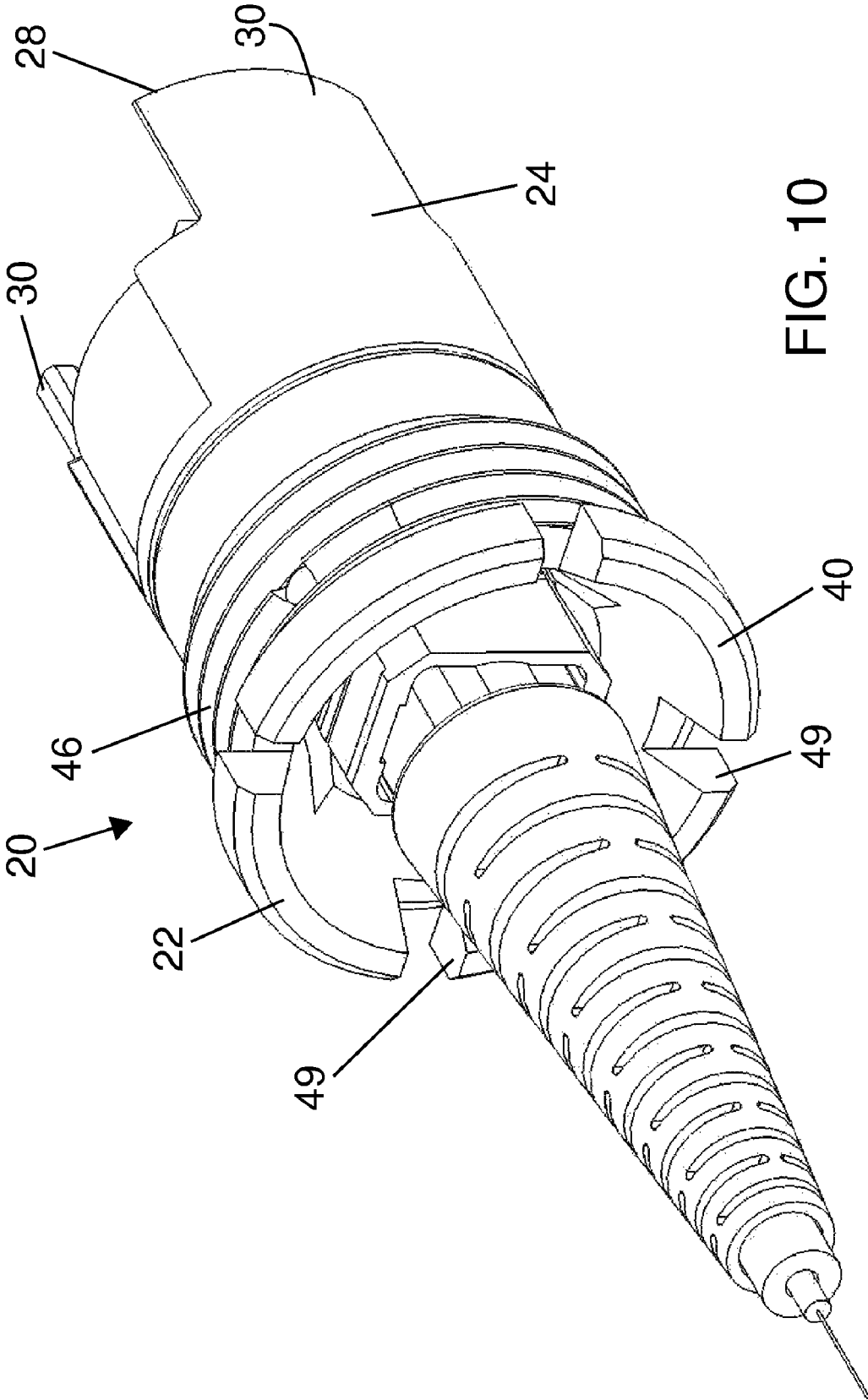
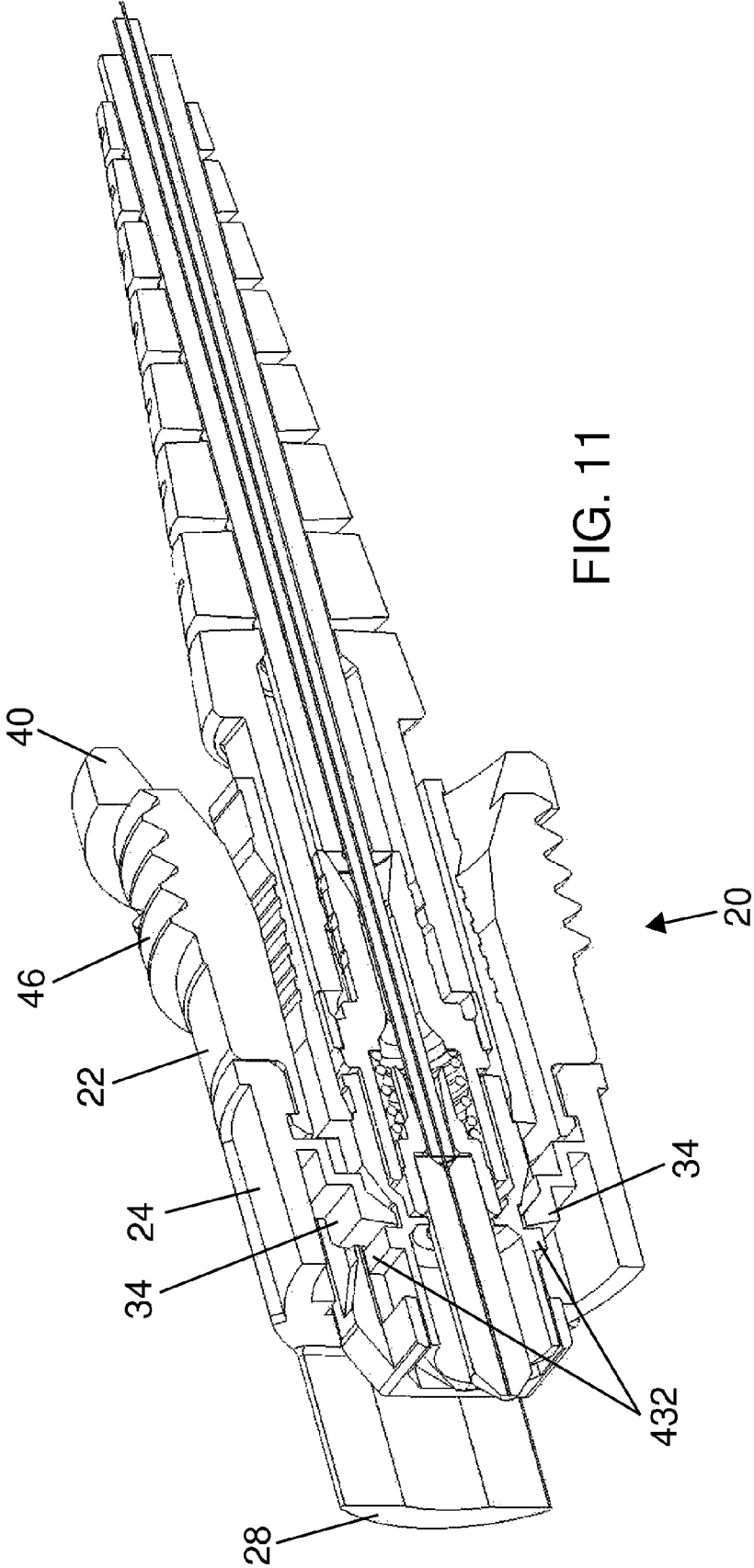
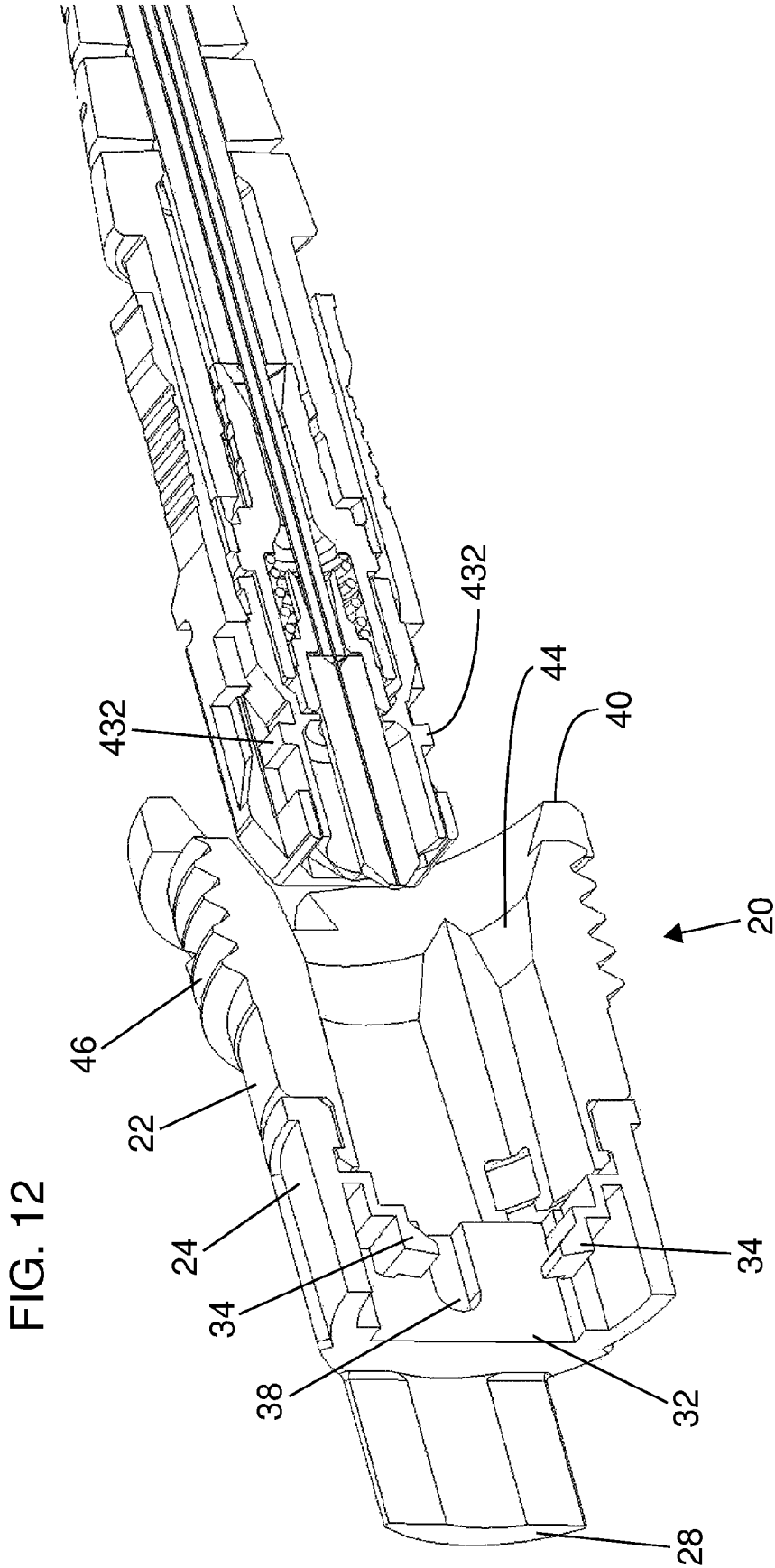
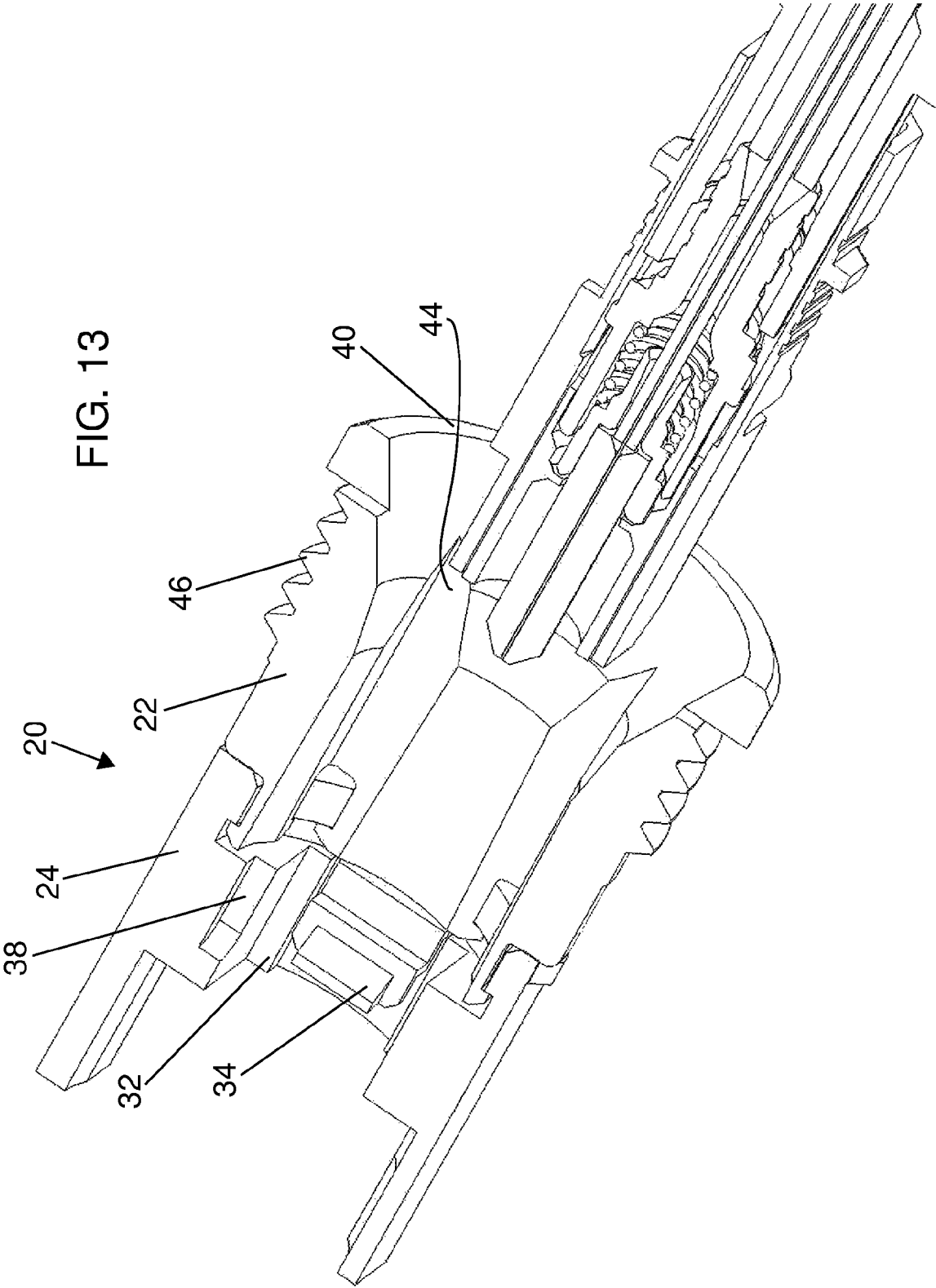
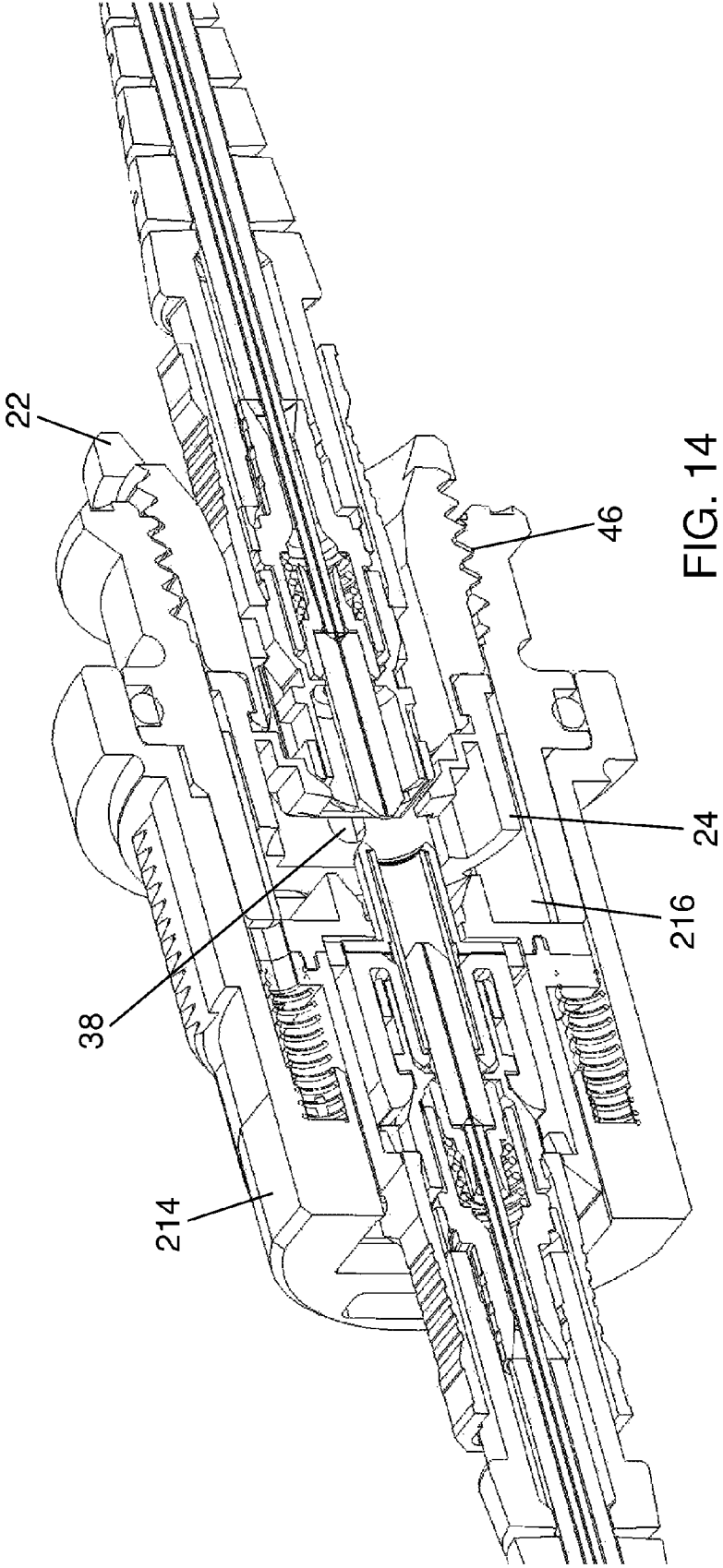

FIG. 10









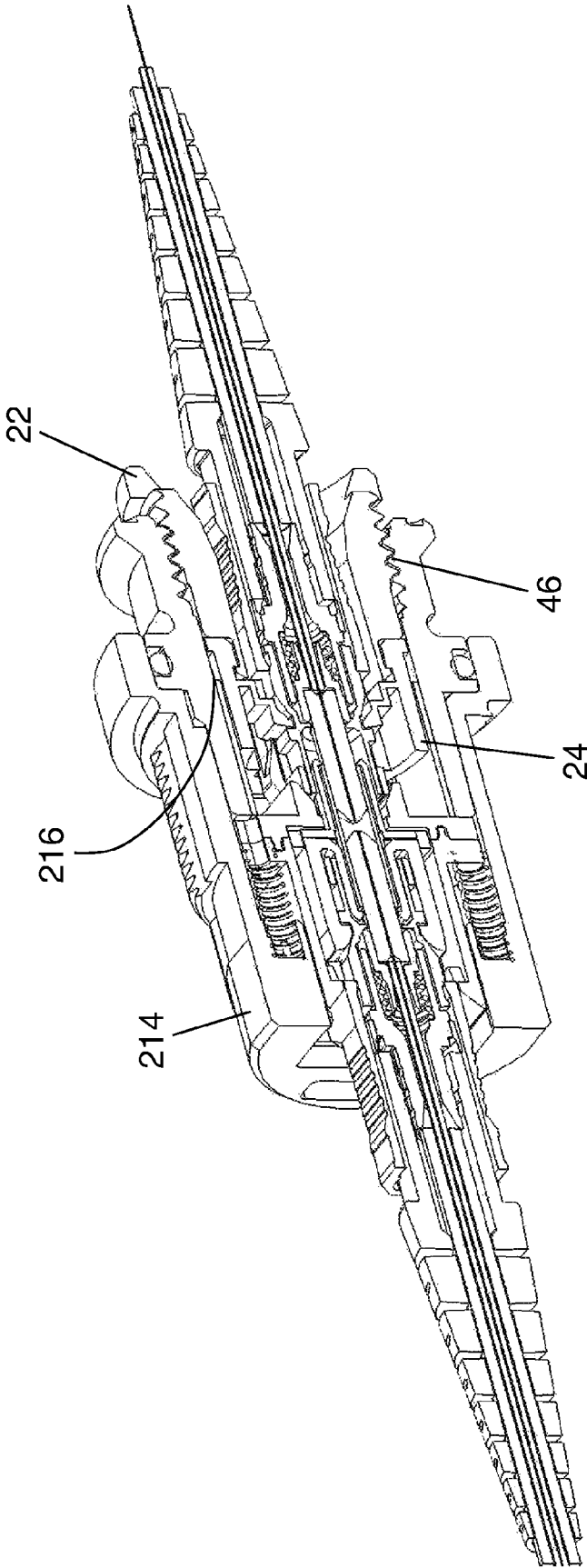

FIG. 15

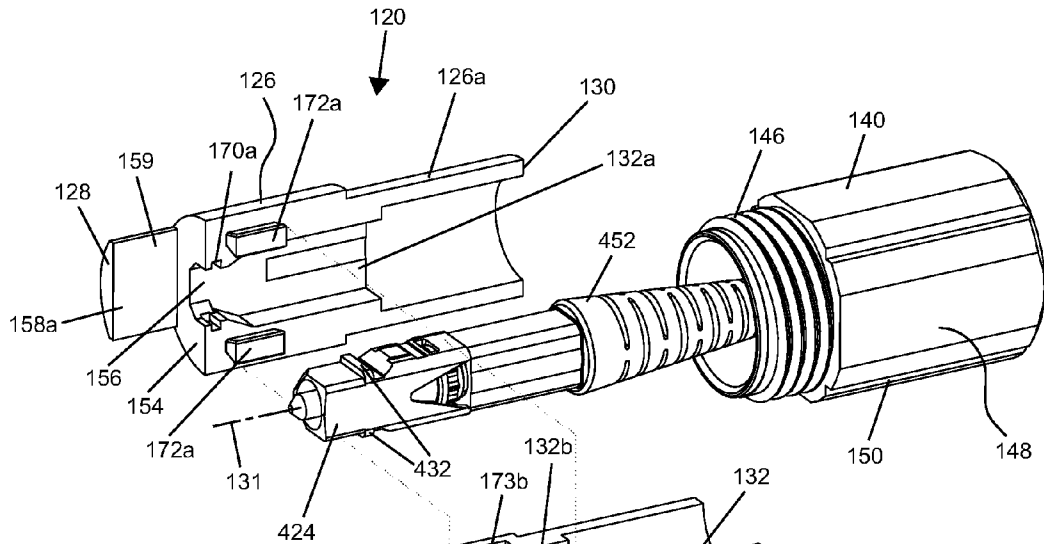

FIG. 16

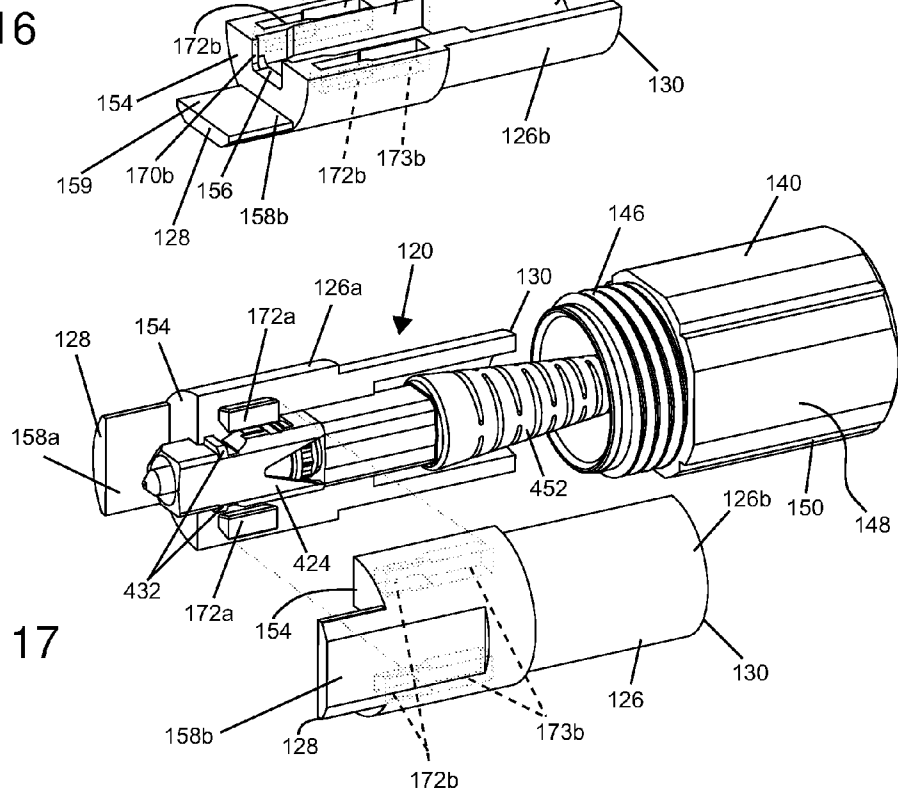
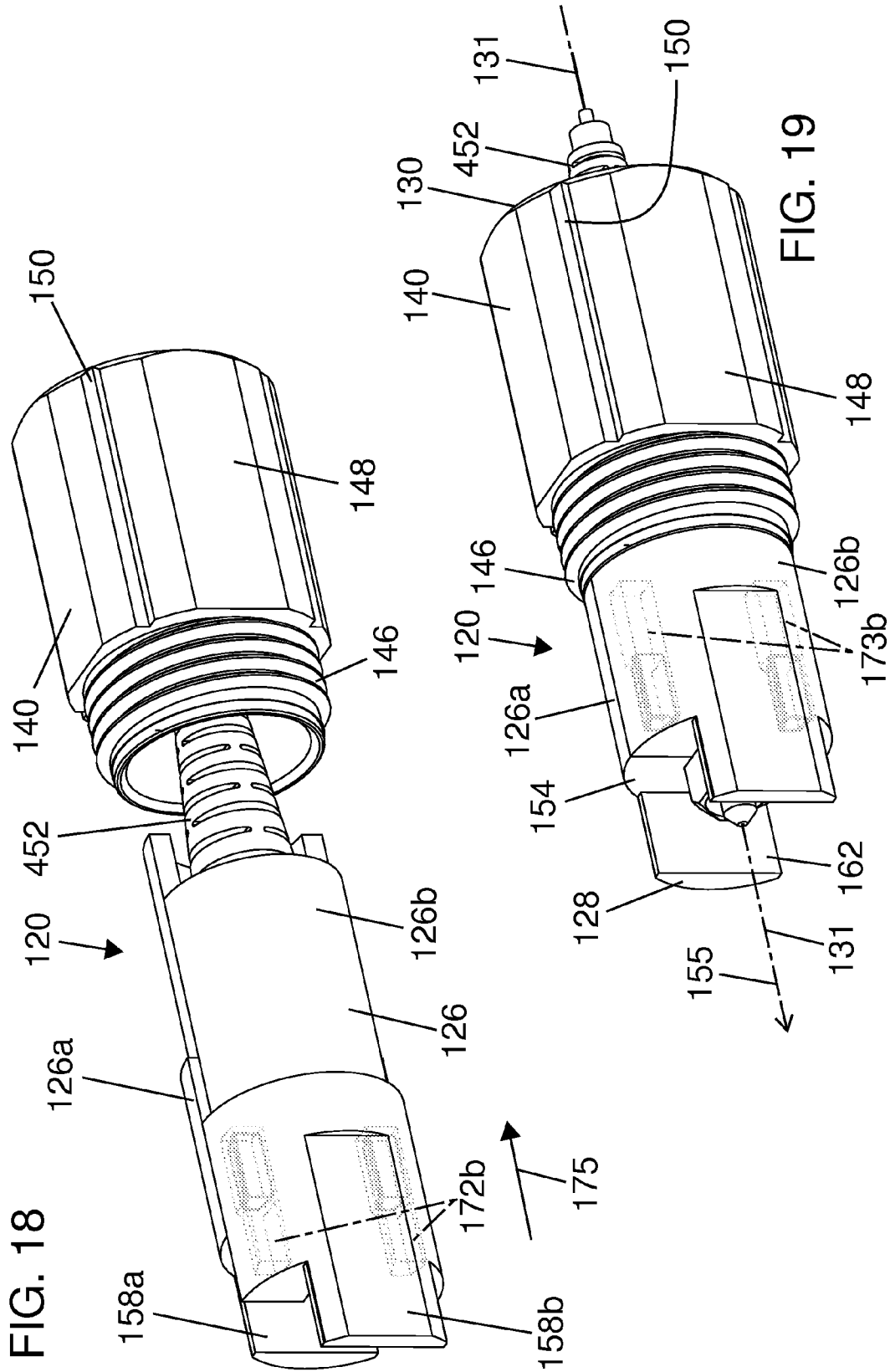

FIG. 17



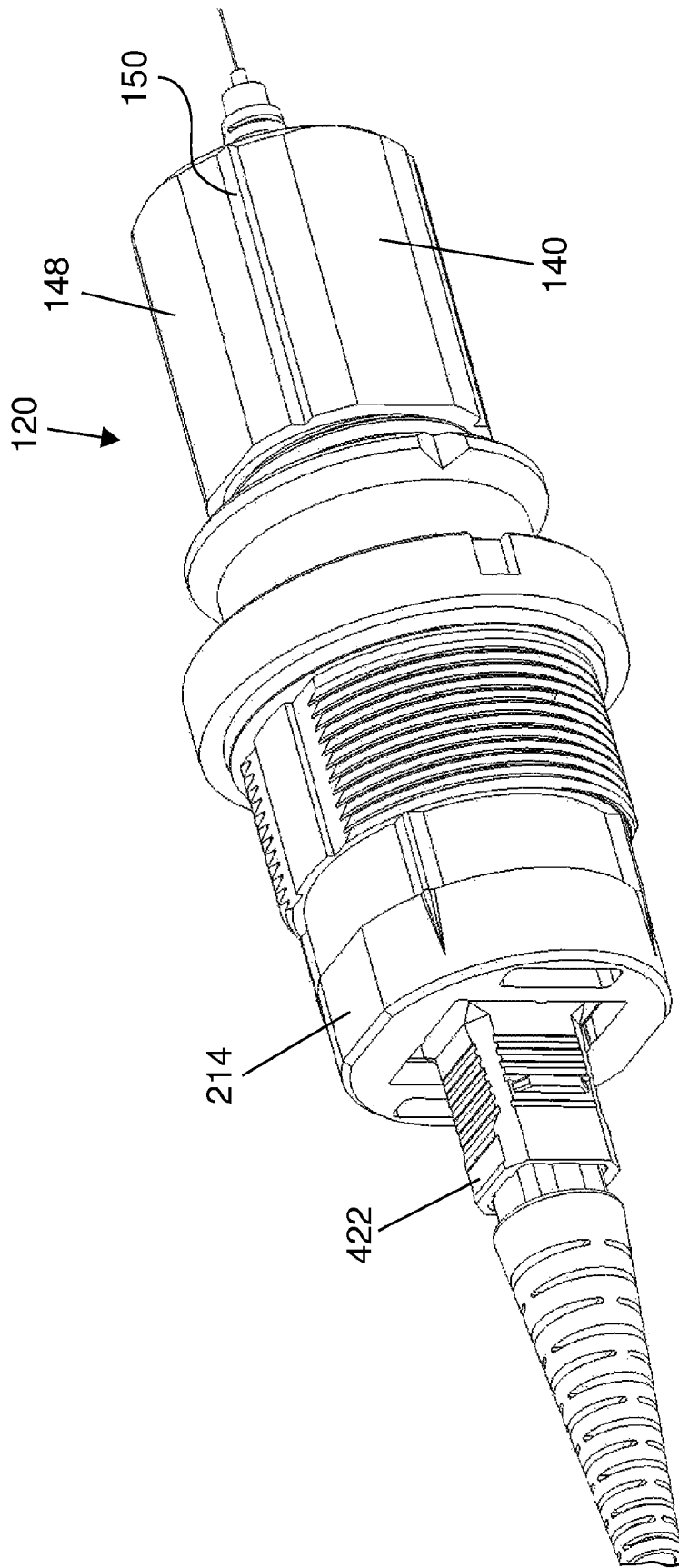

FIG. 20

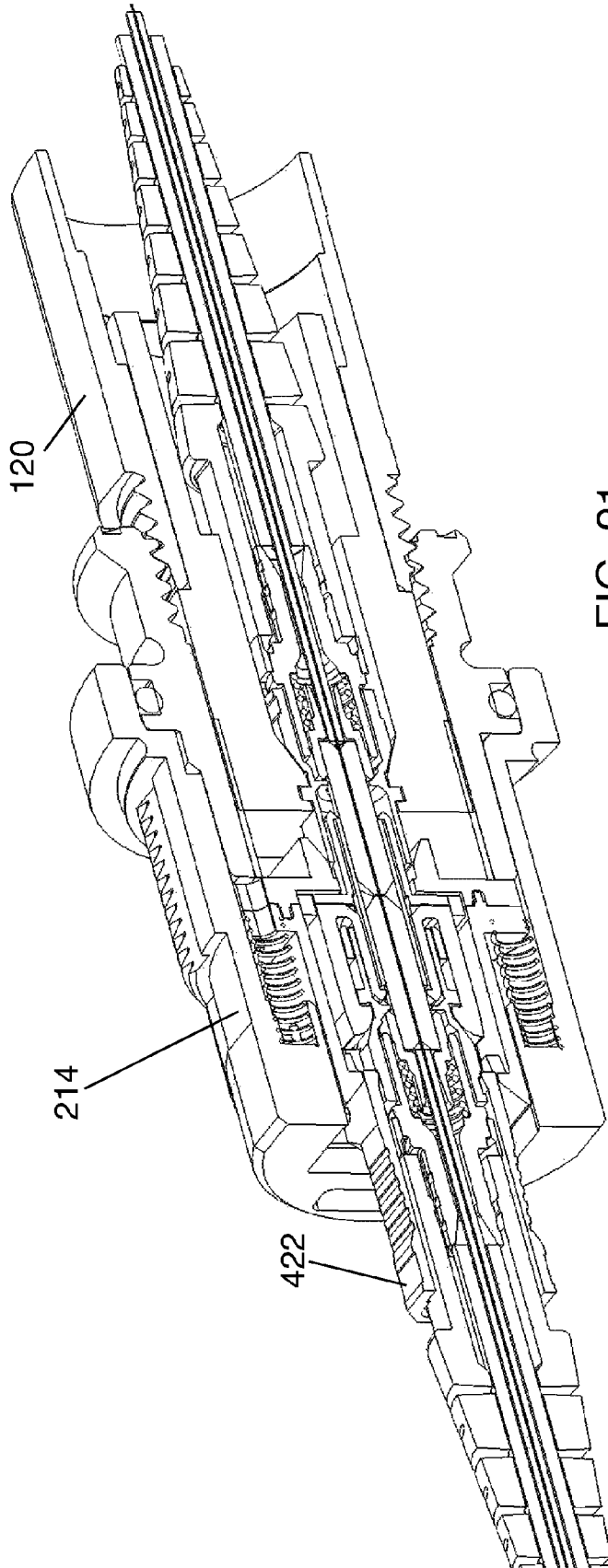

FIG. 21

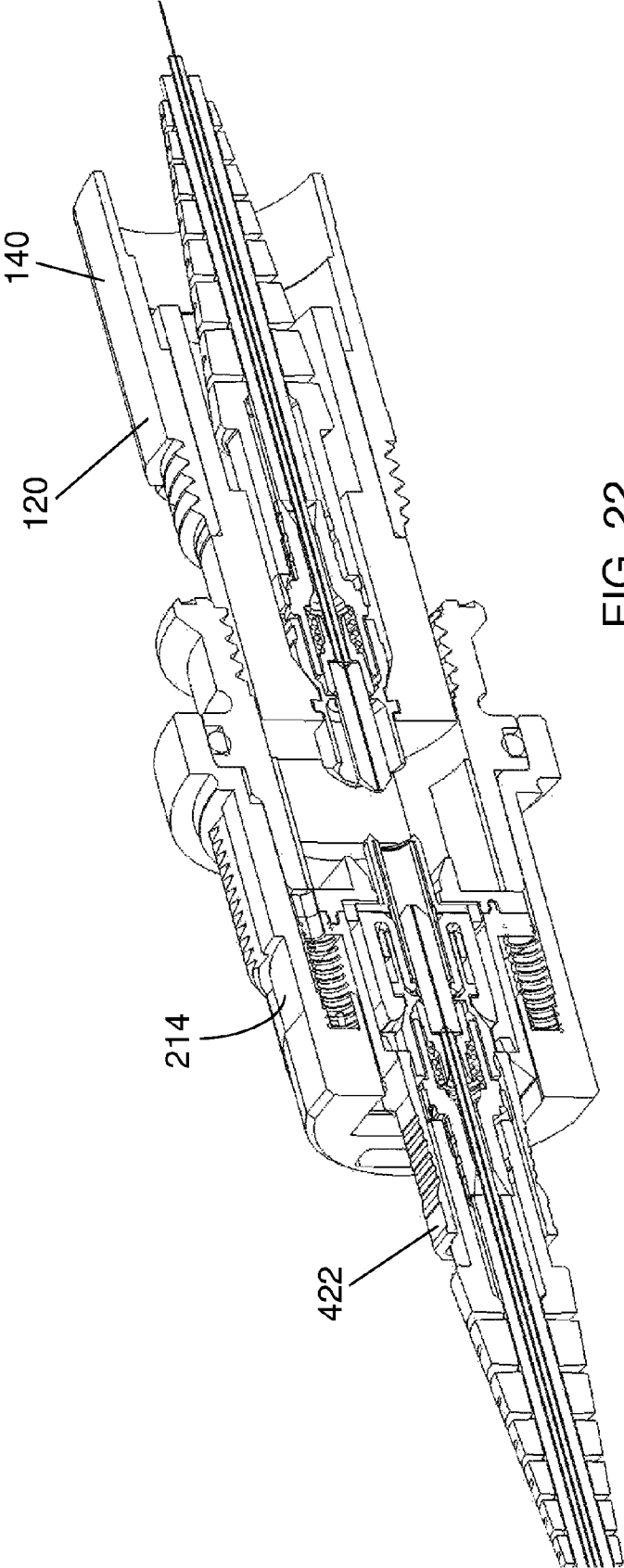

FIG. 22

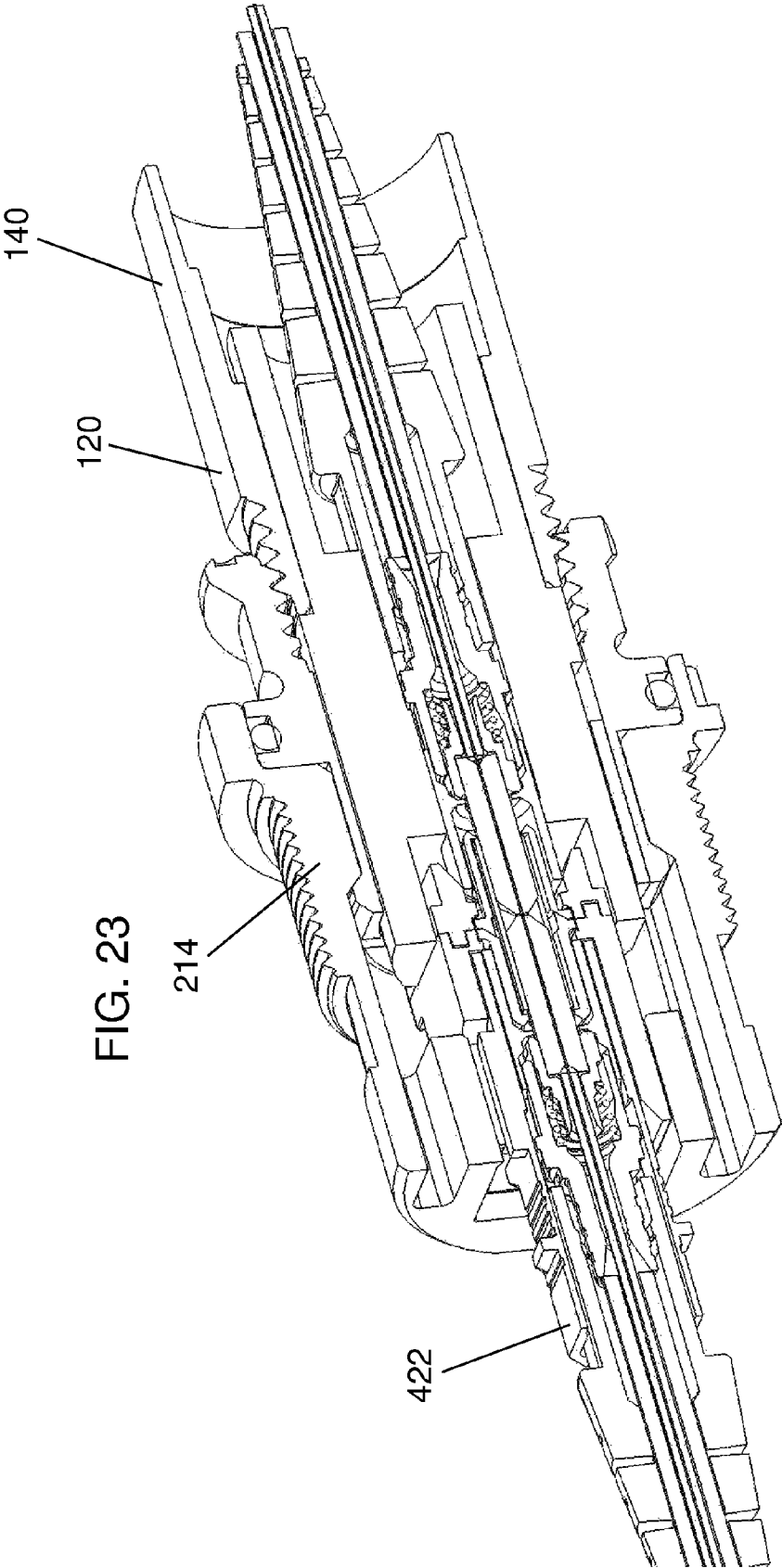

FIG. 23

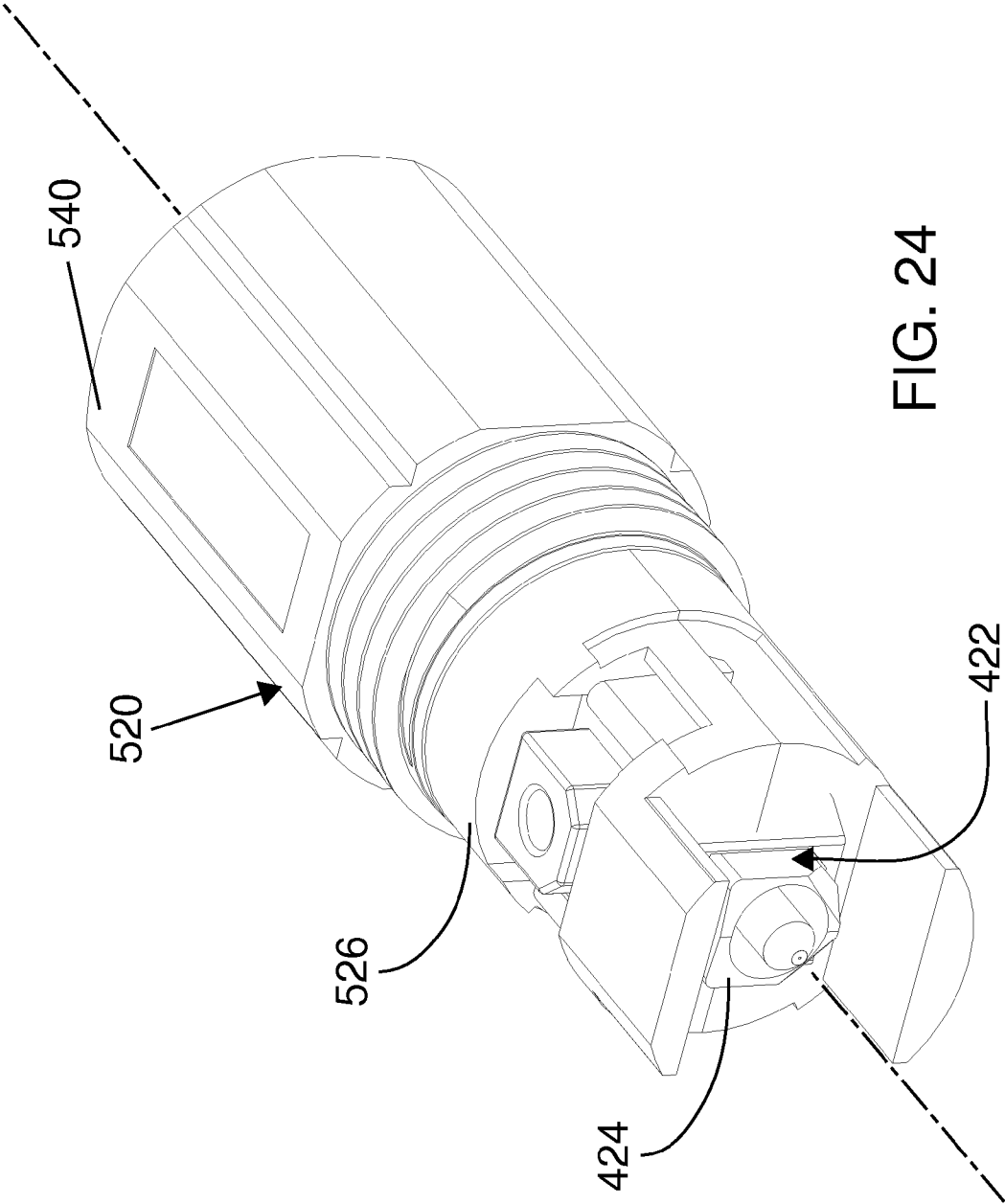

FIG. 24

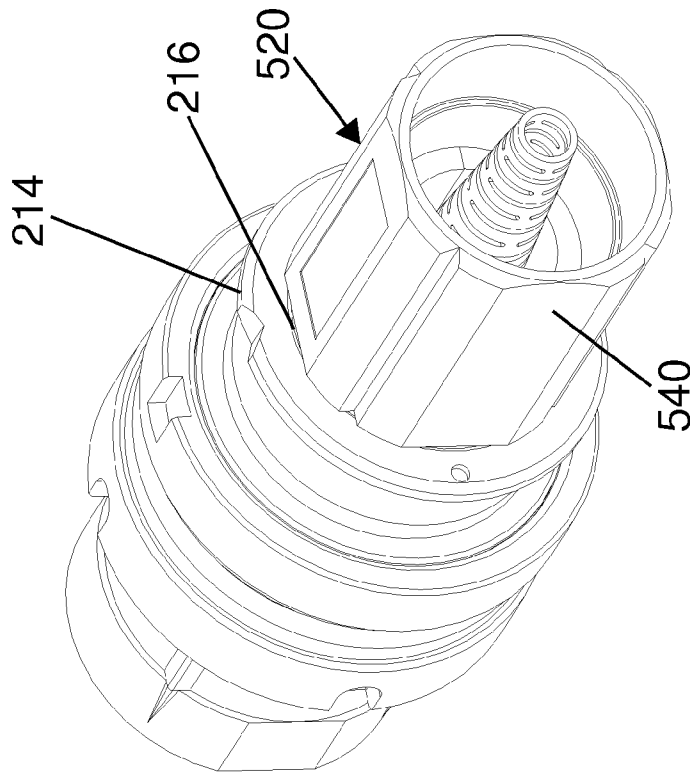

FIG. 26

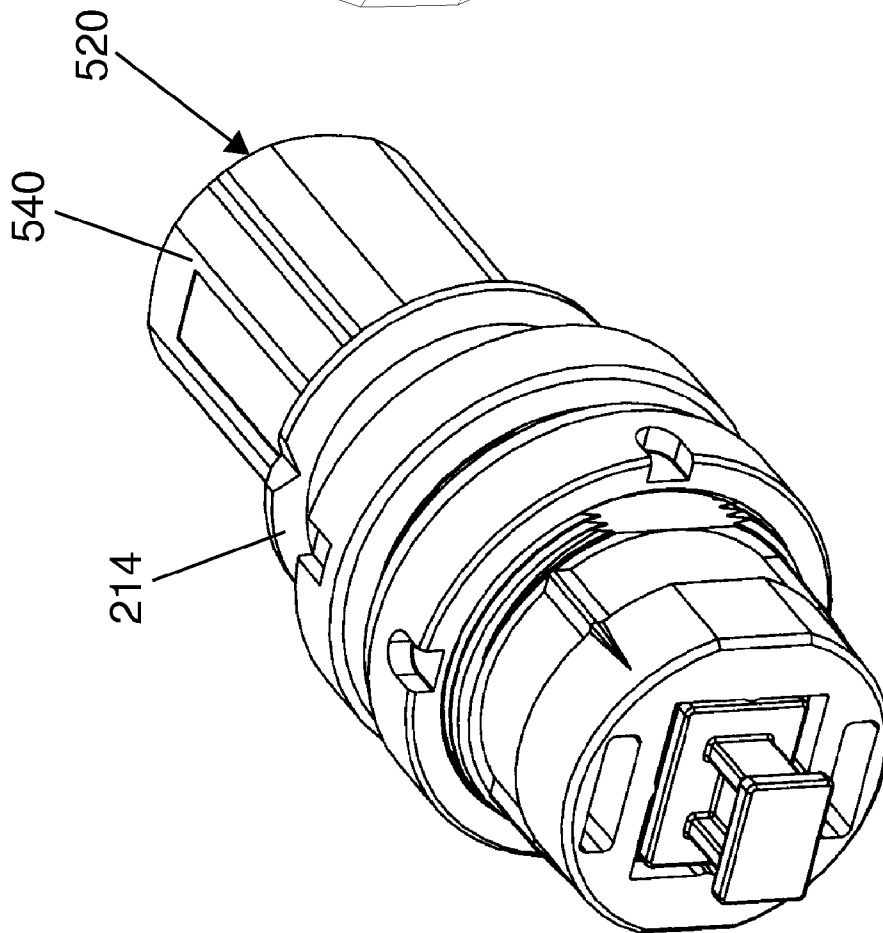

FIG. 25

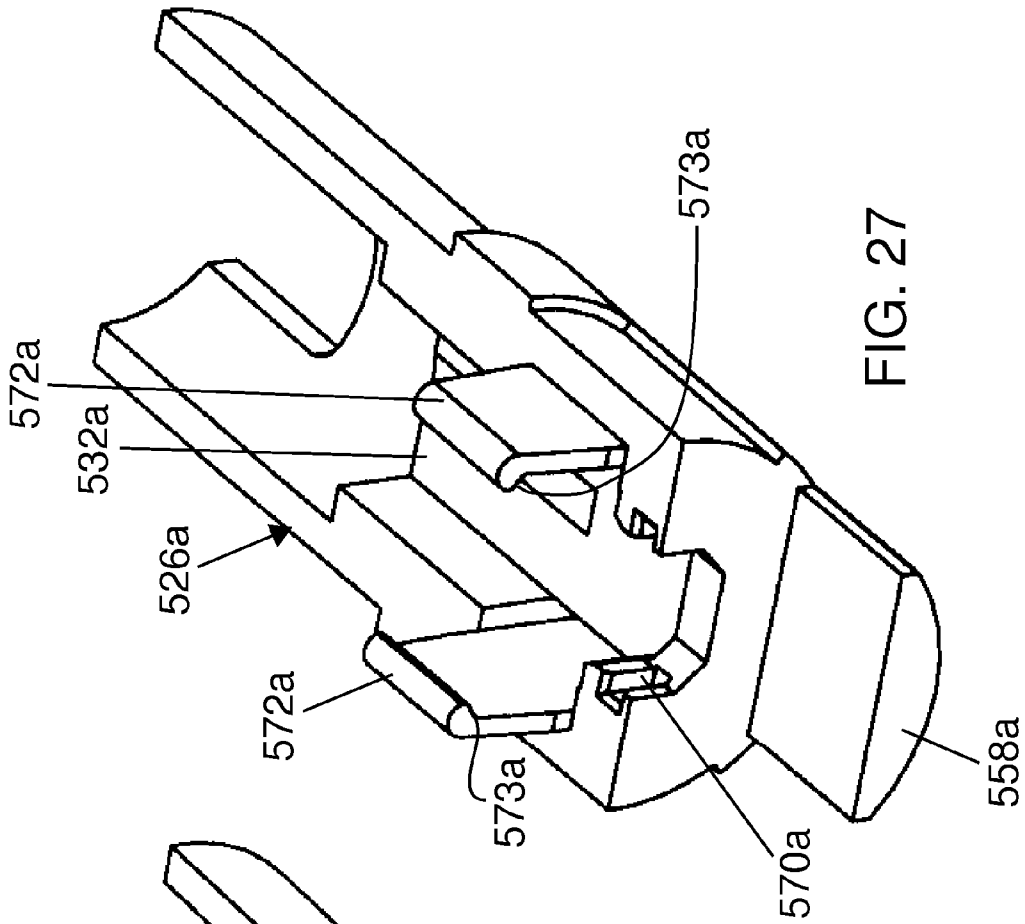

FIG. 27

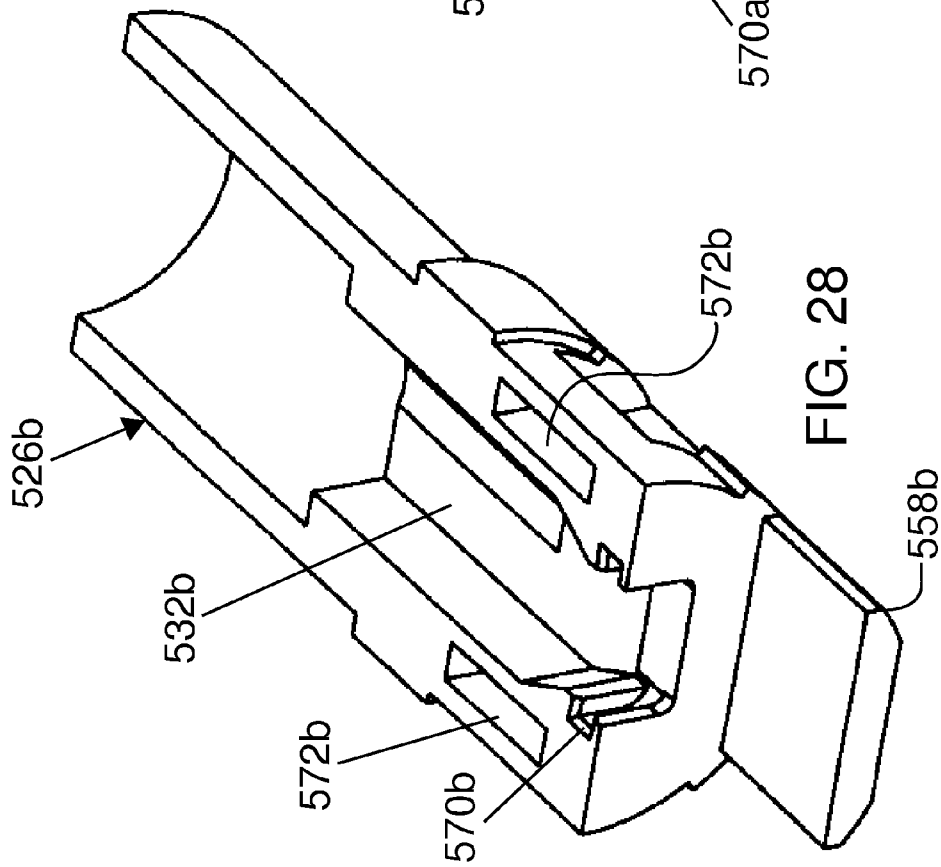

FIG. 28

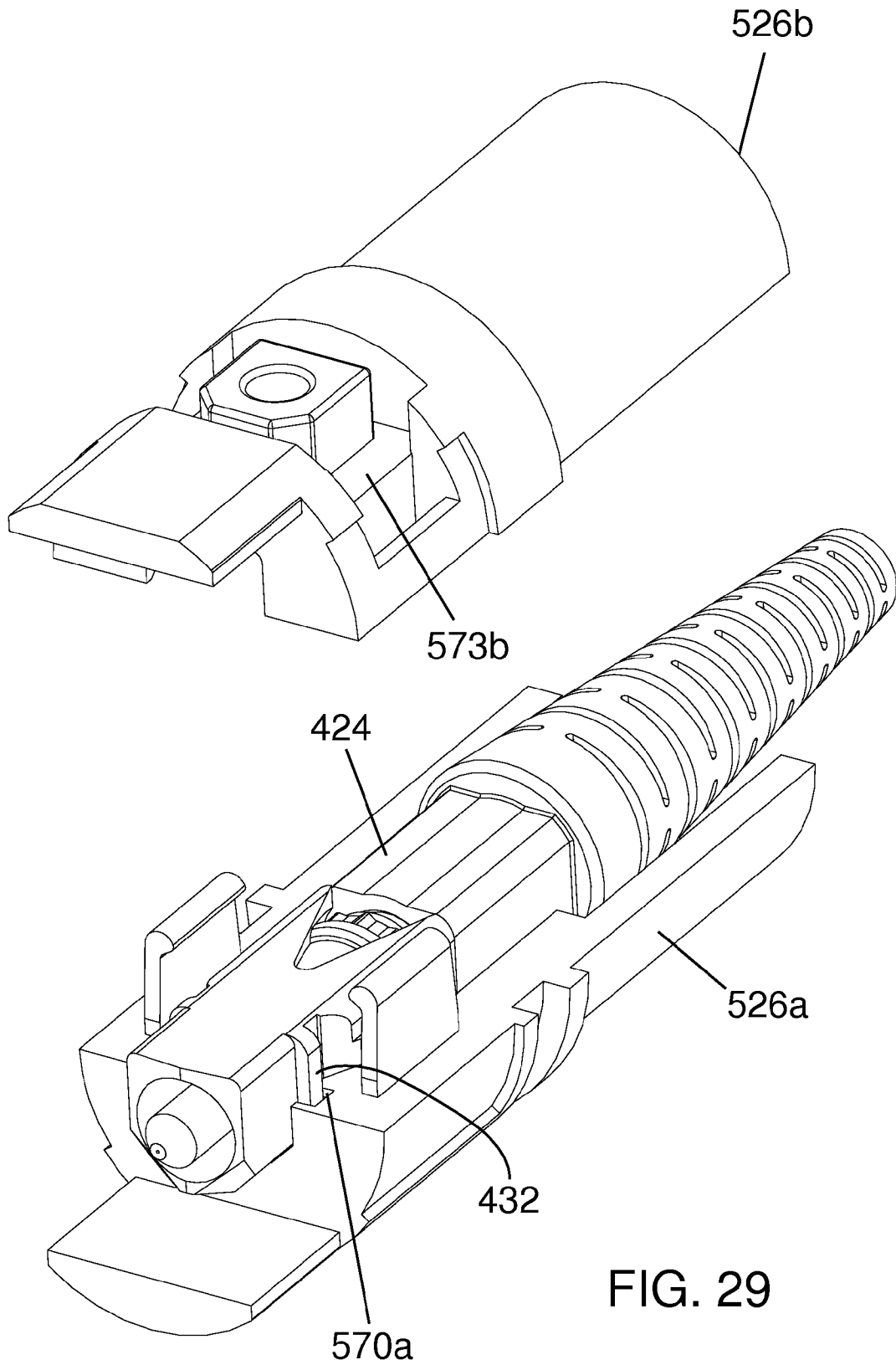

FIG. 29

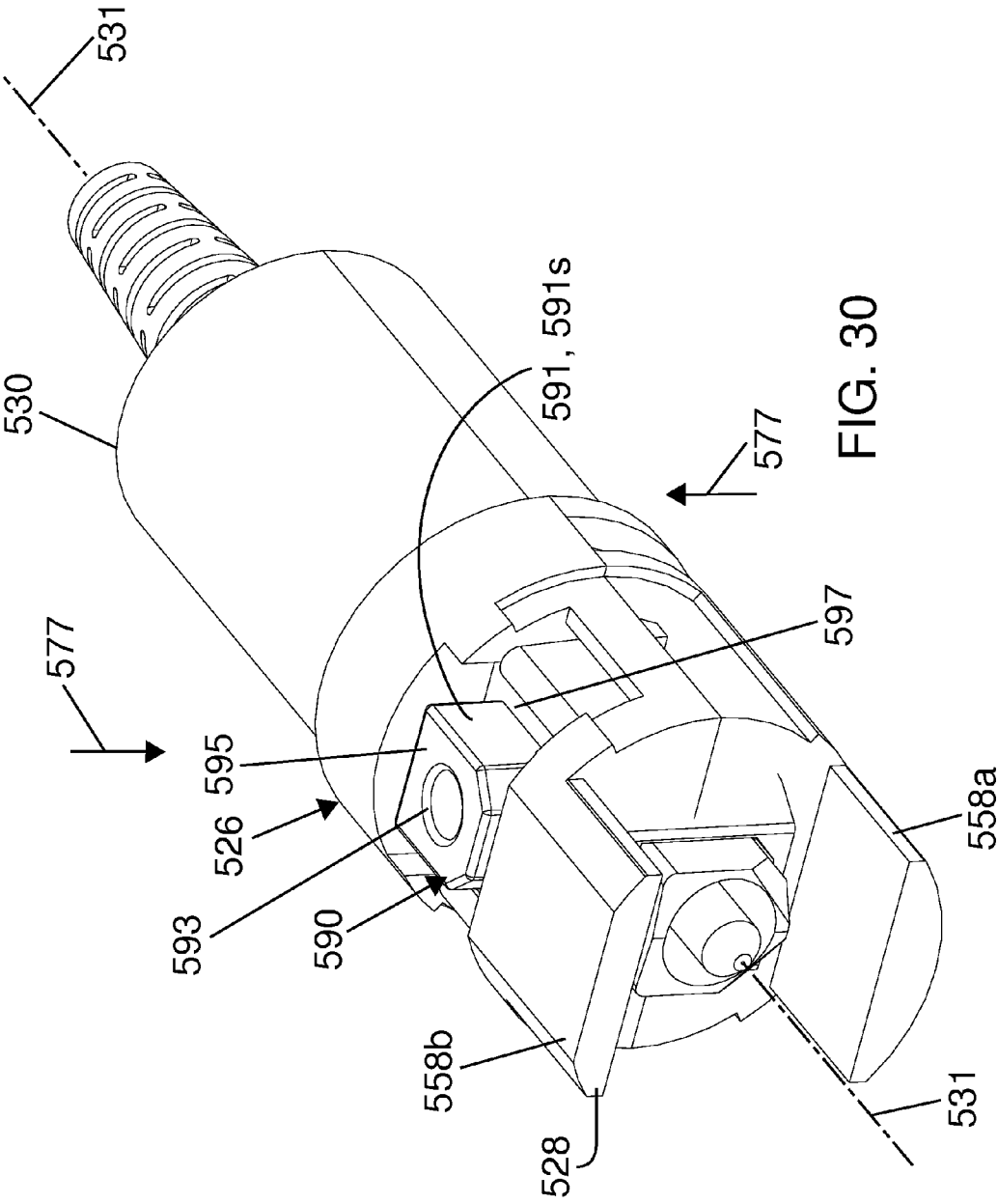

FIG. 30

FIG. 32

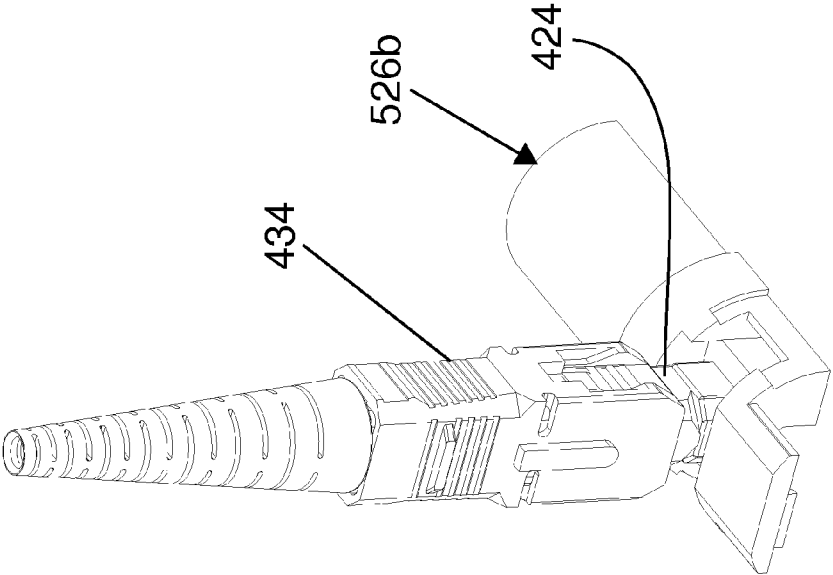
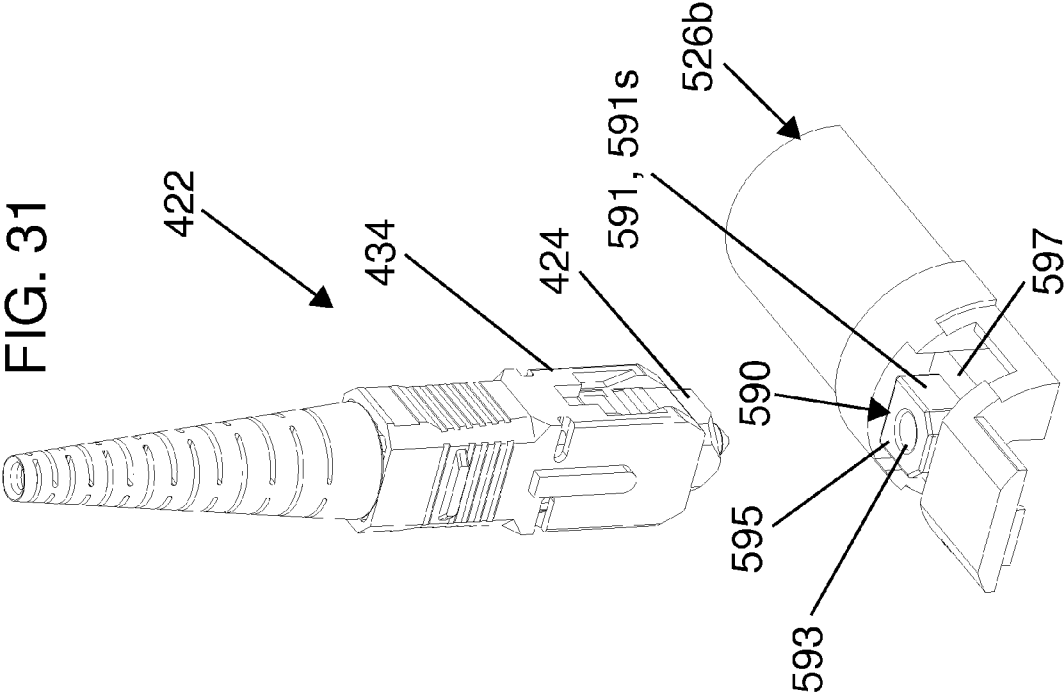
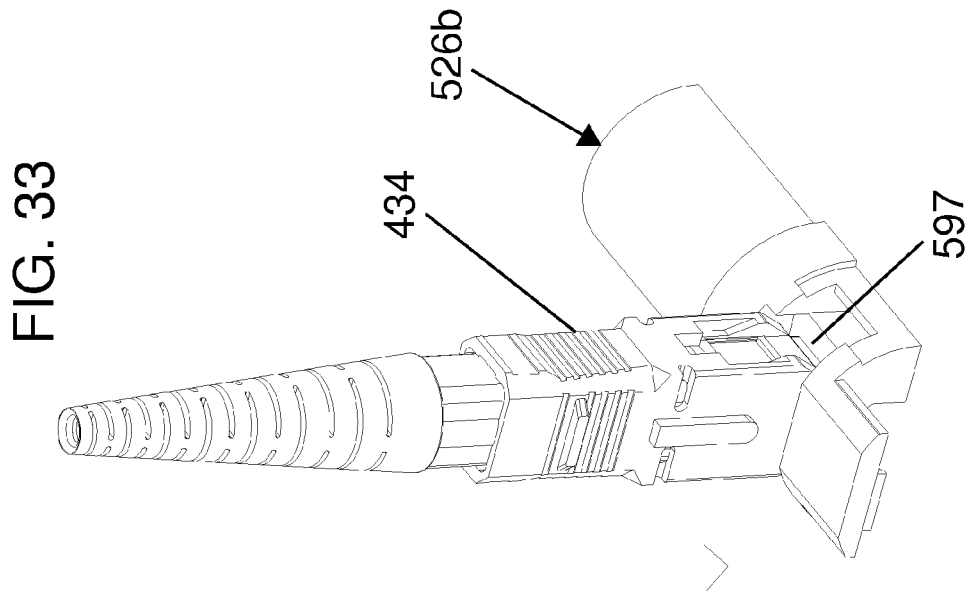
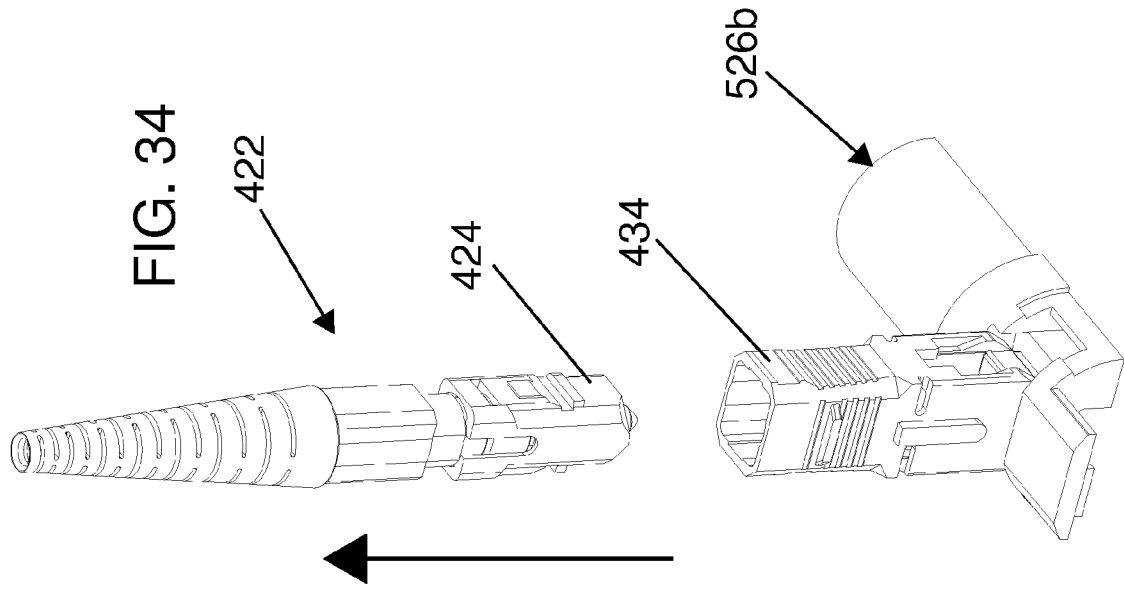
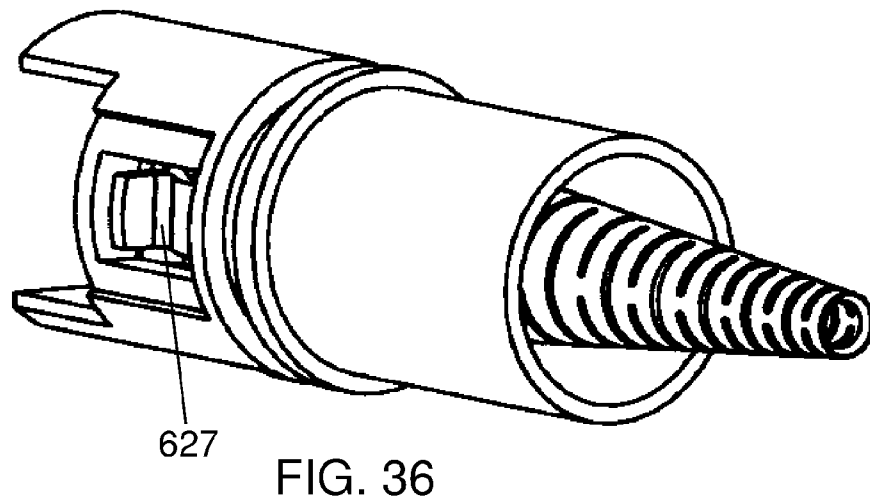
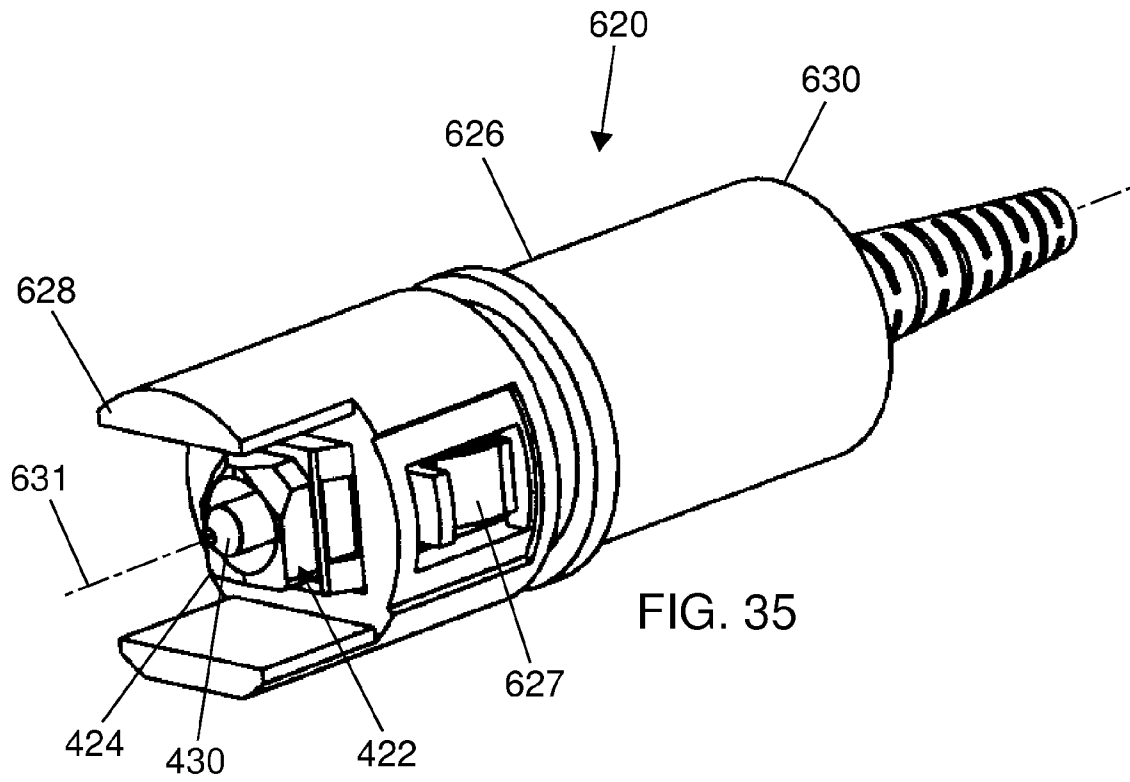

FIG. 31







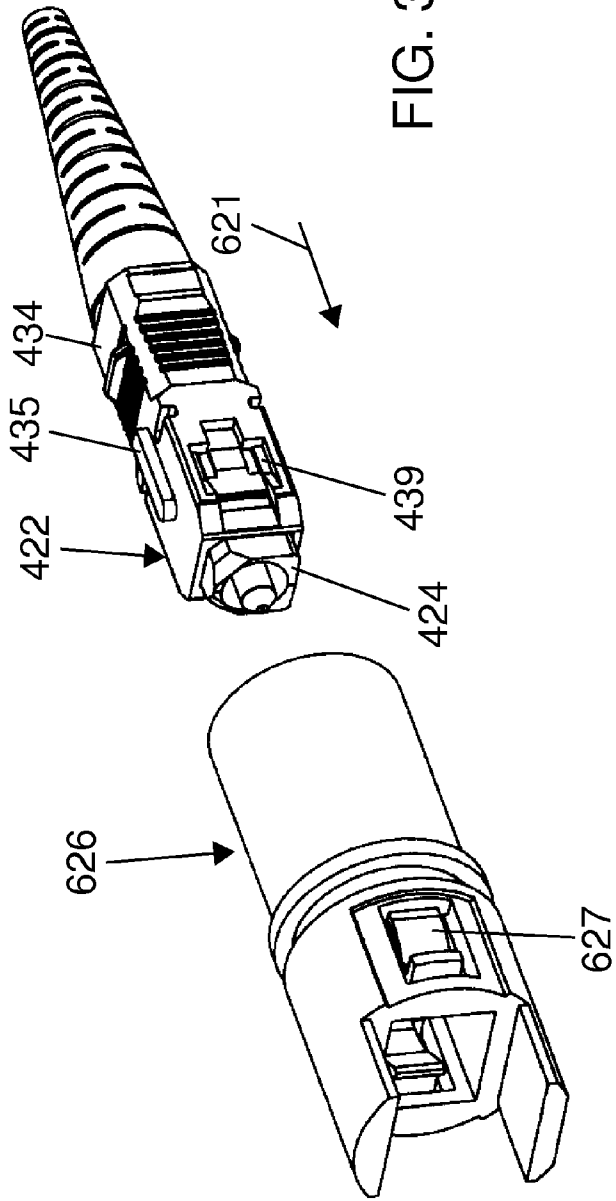

FIG. 37

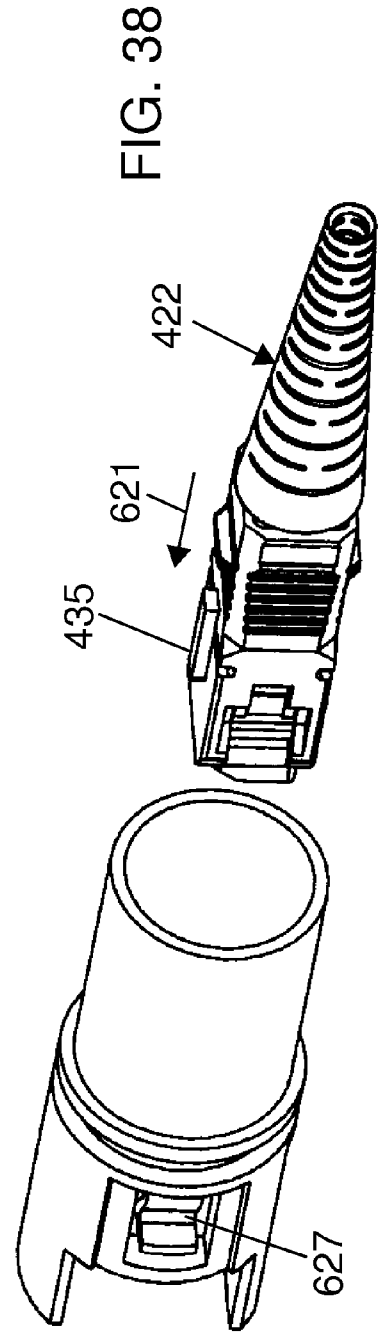

FIG. 38

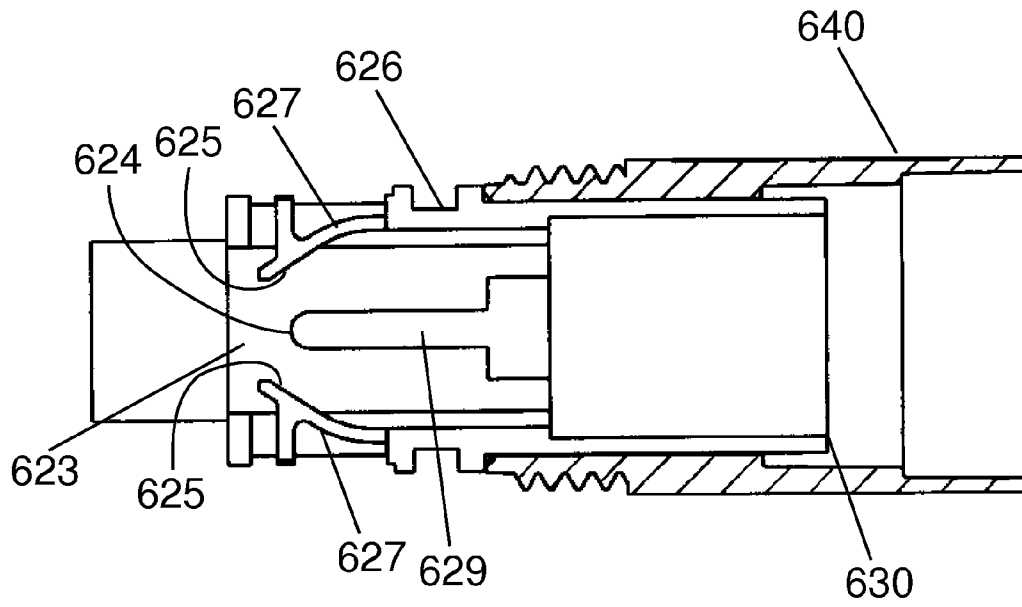

FIG. 39

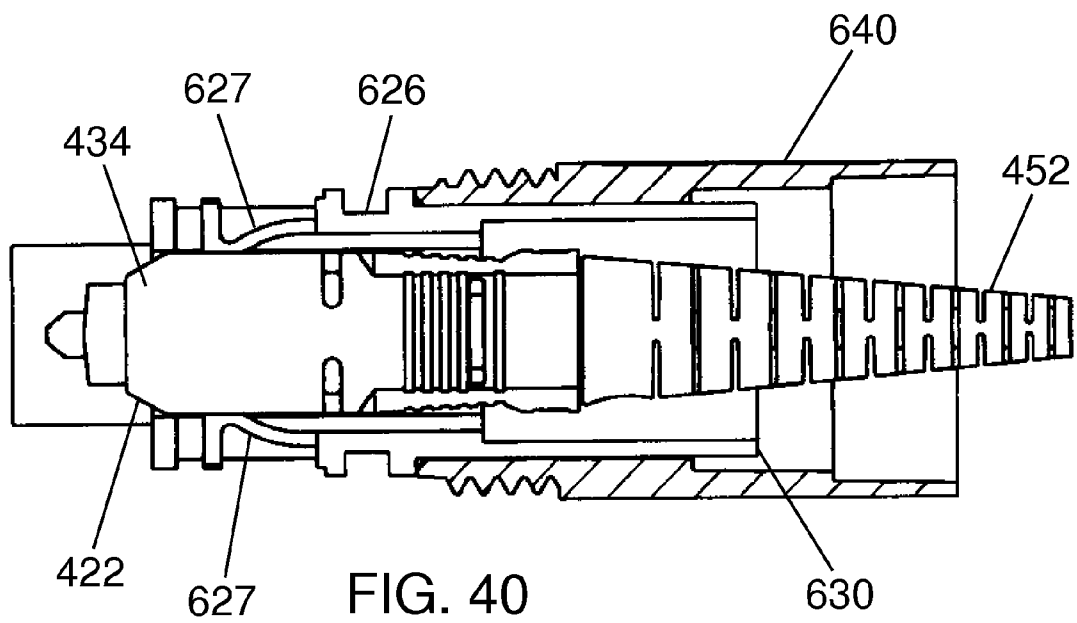

FIG. 40

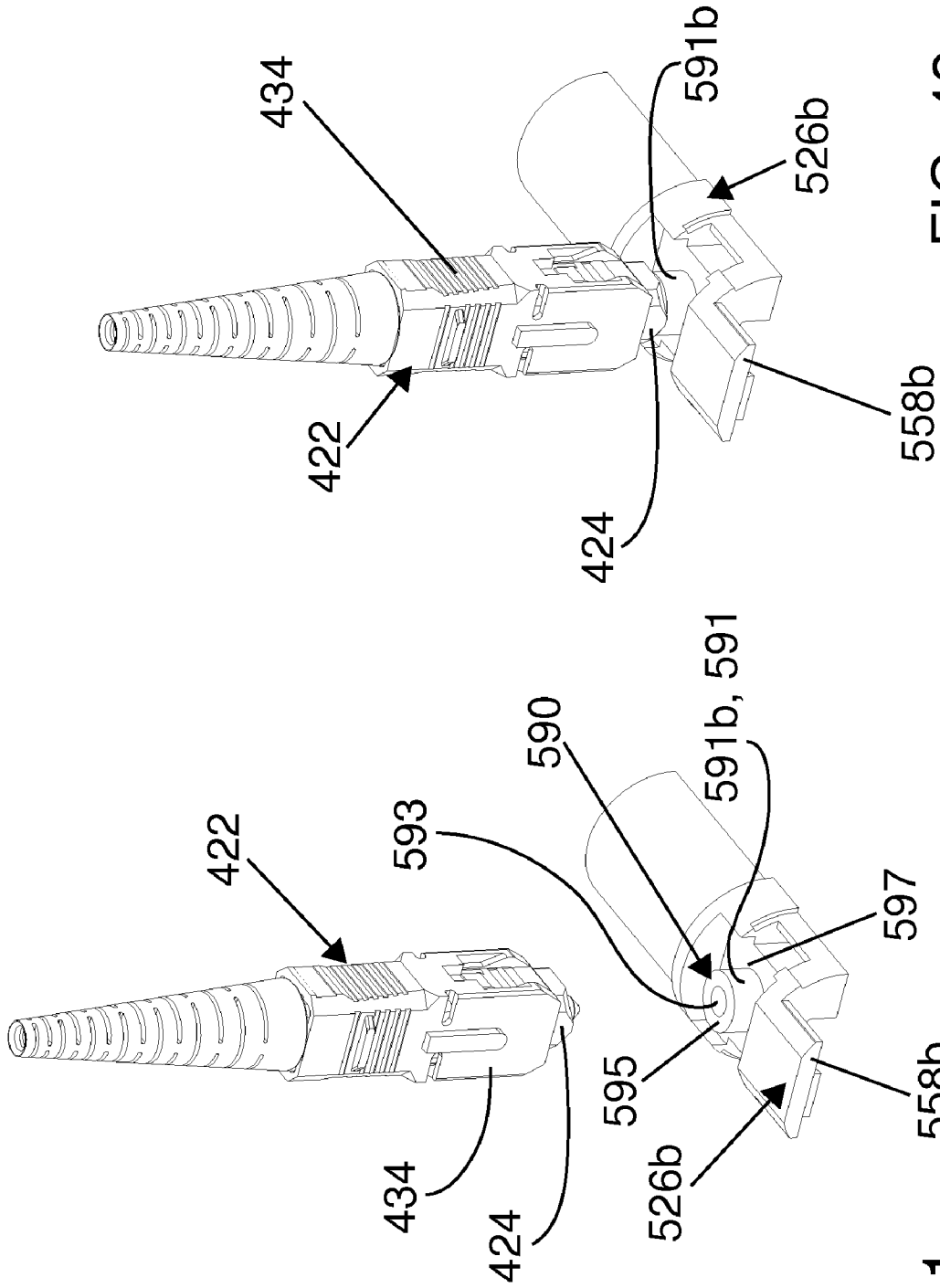

FIG. 41

FIG. 42

FIG. 45

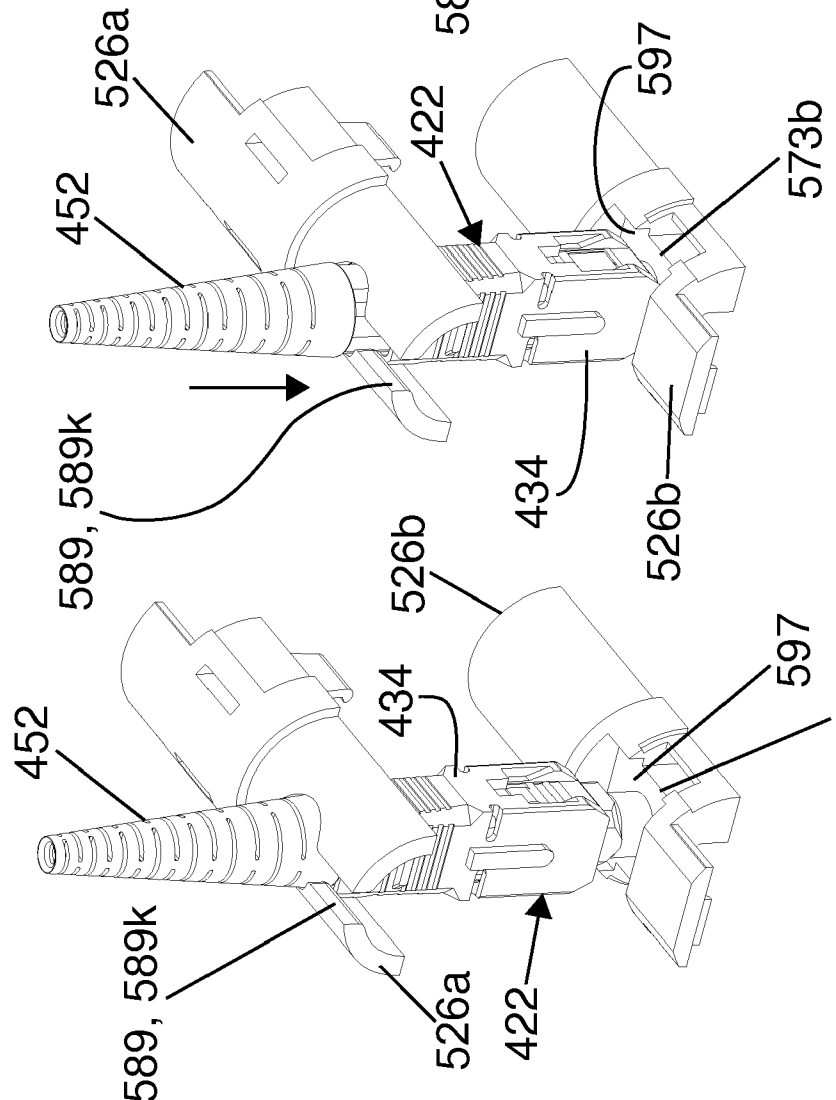
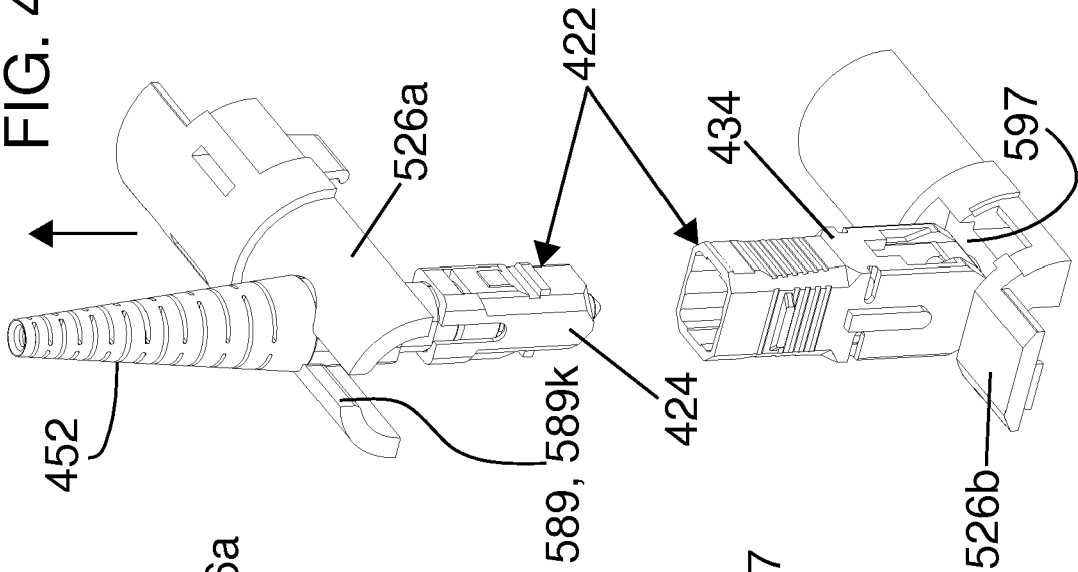

FIG. 44

FIG. 43

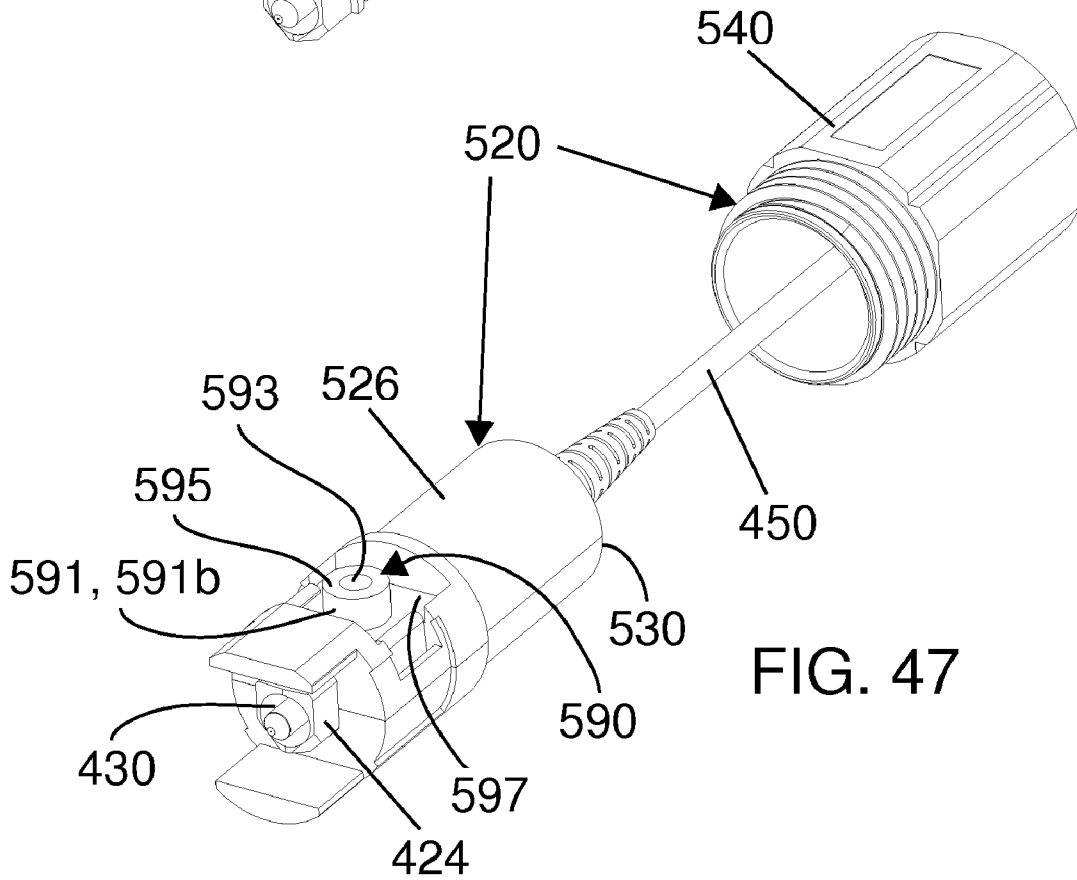
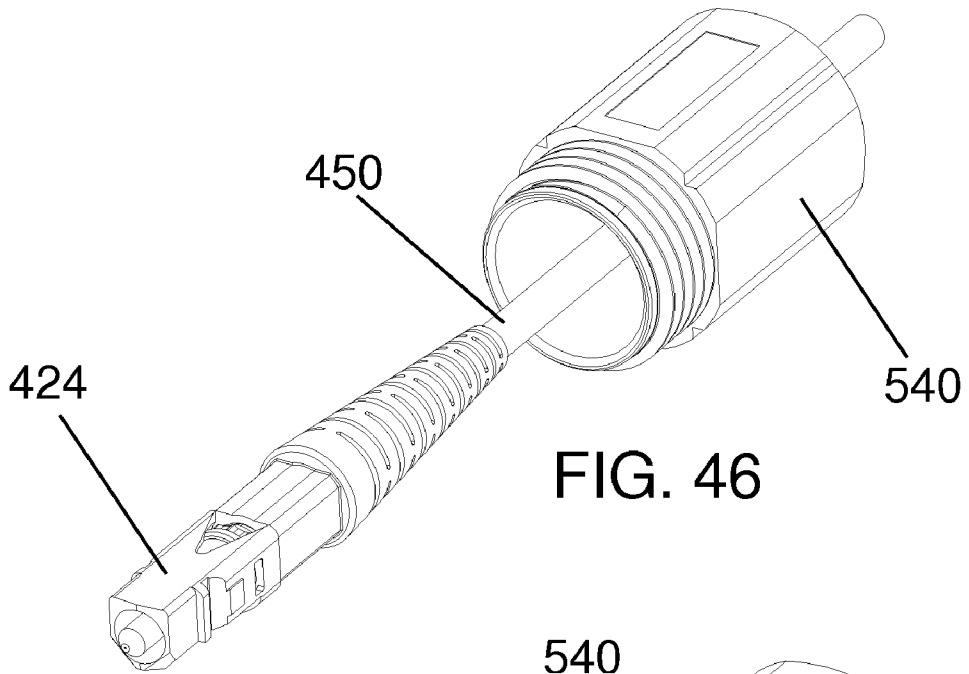

FIG. 48

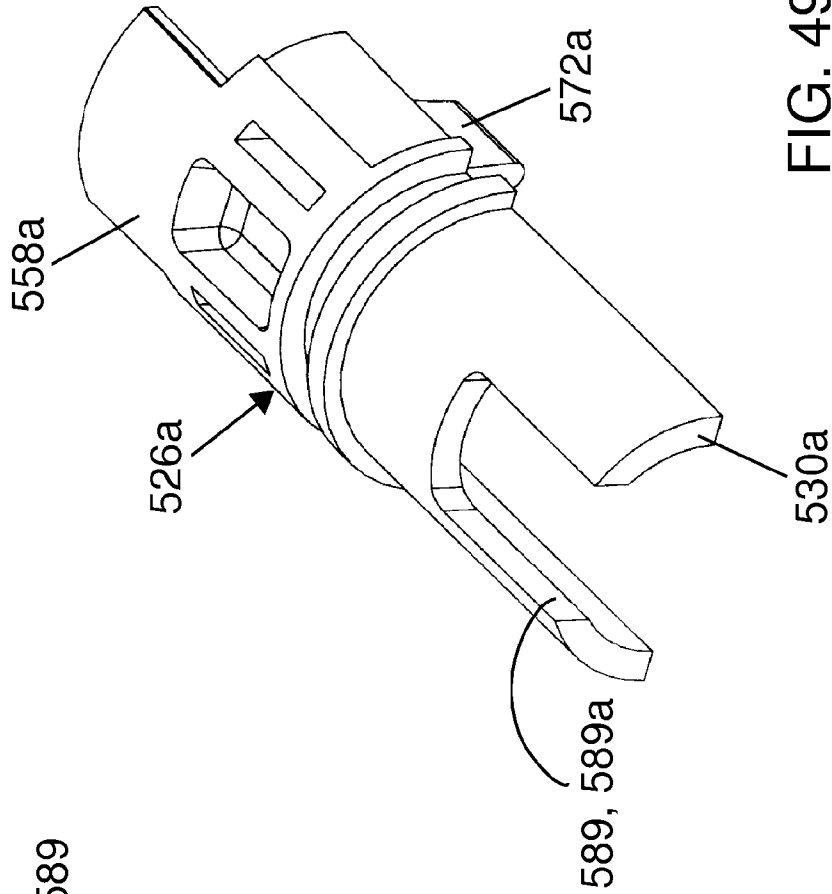
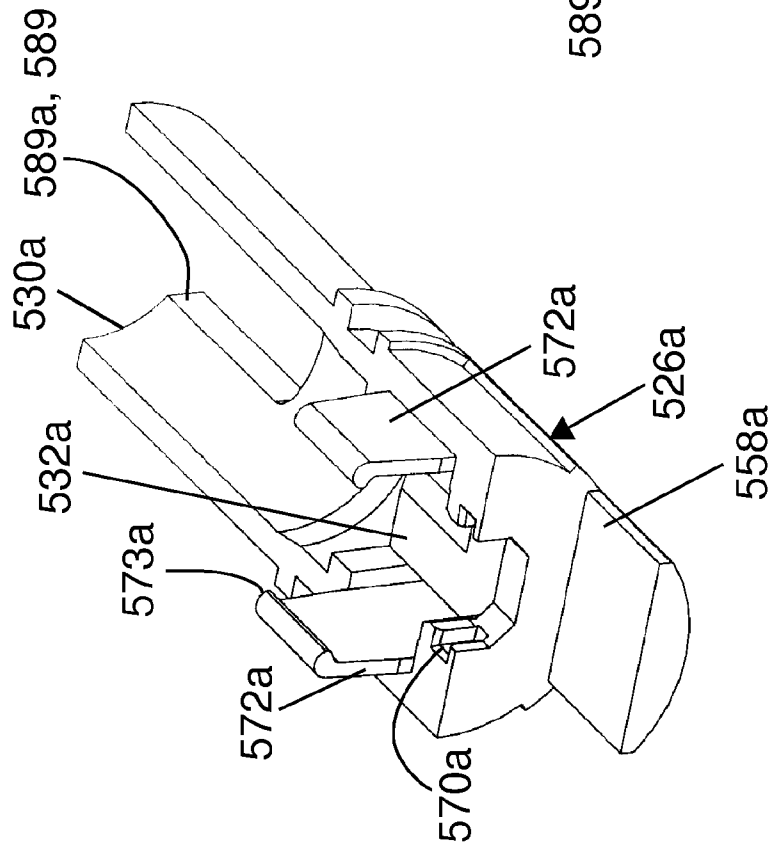

FIG. 49

**MECHANICAL INTERFACE CONVERTER
FOR MAKING NON-RUGGEDIZED FIBER
OPTIC CONNECTORS COMPATIBLE WITH
A RUGGEDIZED FIBER OPTIC ADAPTER**

CROSS-REFERENCE TO RELATED
APPLICATIONS

This application is a continuation of application Ser. No. 12/115,966, filed May 6, 2008, now U.S. Pat. No. 7,677,814, which claims the benefit of provisional application Ser. No. 60/916,295, filed May 6, 2007, provisional application Ser. No. 60/948,781, filed Jul. 10, 2007, and provisional application Ser. No. 61/003,948, filed Nov. 21, 2007, which applica-
tions are incorporated herein by reference in its entirety.

TECHNICAL FIELD

The present disclosure relates to fiber optic data transmission, and more particularly to fiber optic cable connection systems.

BACKGROUND

Fiber optic cables are widely used to transmit light signals for high speed data transmission. A fiber optic cable typically includes: (1) an optical fiber or optical fibers; (2) a buffer or buffers that surrounds the fiber or fibers; (3) a strength layer that surrounds the buffer or buffers; and (4) an outer jacket. Optical fibers function to carry optical signals. A typical optical fiber includes an inner core surrounded by a cladding that is covered by a coating. Buffers (e.g., loose or tight buffer tubes) typically function to surround and protect coated optical fibers. Strength layers add mechanical strength to fiber optic cables to protect the internal optical fibers against stresses applied to the cables during installation and thereafter. Example strength layers include aramid yarn, steel and epoxy reinforced glass roving. Outer jackets provide protection against damage caused by crushing, abrasions, and other physical damage. Outer jackets also provide protection against chemical damage (e.g., ozone, alkali, acids).

Fiber optic cable connection systems are used to facilitate connecting and disconnecting fiber optic cables in the field without requiring a splice. A typical fiber optic cable connection system for interconnecting two fiber optic cables includes fiber optic connectors mounted at the ends of the fiber optic cables, and an adapter for mechanically and optically coupling the fiber optic connectors together. Fiber optic connectors generally include ferrules that support the ends of the optical fibers of the fiber optic cables. The end faces of the ferrules are typically polished and are often angled. The adapter includes co-axially aligned ports (i.e., receptacles) for receiving the fiber optic connectors desired to be interconnected. The adapter includes an internal split sleeve that receives and aligns the ferrules of the fiber optic connectors when the connectors are inserted within the ports of the adapter. With the ferrules and their associated fibers aligned within the sleeve of the adapter, a fiber optic signal can pass from one fiber to the next. The adapter also typically has a mechanical fastening arrangement (e.g., a snap-fit arrangement) for mechanically retaining the fiber optic connectors within the adapter.

Certain fiber optic cable connection systems can be “ruggedized” or “hardened.” The terms “ruggedized” or “hardened” apply to systems that are robust and suitable for use in an outside environment. An example of an existing rugged-

dized fiber optic connection system is described in U.S. Pat. Nos. 6,579,014, 6,648,520, and 6,899,467.

Ruggedized fiber optic cable connection systems can include fiber optic adapters that are mounted to outside fiber optic enclosures such as drop terminals, network interface devices, splice enclosures or other housings/enclosures. FIG. 1 shows a fiber optic drop terminal **210** including a front face at which a plurality of ruggedized fiber optic adapters **214** are mounted. The ruggedized fiber optic adapters **214** include inner ports configured to receive non-ruggedized fiber optic connectors and outer ports **216** configured to receive ruggedized fiber optic connectors **322**. The inner ports are accessible from inside the drop terminal **210** and the outer ports **216** are accessible from outside the drop terminal **210**. Further details regarding drop terminals and their applications in fiber optic networks are disclosed at U.S. Pat. No. 7,292,763 and U.S. Pat. No. 7,489,849, that are hereby incorporated by reference in their entirety.

FIG. 2 illustrates one of the fiber optic adapters **214** in isolation from the drop terminal **210**. The fiber optic adapter **214** includes a ruggedized housing **240** having a first piece **242** that defines the inner port **218** of the fiber optic adapter **214** and a second piece **244** that defines the outer port **216** of the fiber optic adapter **214**. The first and second pieces **242**, **244** can be interconnected by a snap-fit connection to form the ruggedized housing **240**. An interior adapter housing **246** mounts inside the ruggedized housing **240**. Springs **248** bias the interior adapter housing **246** toward the outer port **216** and allow the interior adapter housing **246** to float within the interior of the ruggedized housing **240**. As shown at FIG. 3, the interior adapter housing **246** includes a cylindrical split sleeve holder **251** that houses a standard split sleeve **250**. The split sleeve **250** is coaxially aligned with a center axis **252** of the fiber optic adapter **214**. The split sleeve **250** includes an inner end **254** that faces toward the inner port **218** of the fiber optic adapter **214** and an outer end **256** that faces toward the outer port **216** of the fiber optic adapter **214**. The fiber optic adapter **214** defines a plurality of internal threads **272** within the outer port **216** for use in securing a ruggedized fiber optic connector within the outer port **216**. The fiber optic adapter **214** also includes resilient latches **273** for retaining a non-ruggedized fiber optic connector (e.g., a standard SC connector) within the inner port **218**. The latches **273** are located adjacent the inner port **218**. The interior adapter housing **246** also defines a keying slot **247** adjacent the inner port **218** for ensuring that the non-ruggedized fiber optic connector is inserted into the inner port **218** at the proper rotational orientation. Resilient latches are not provided at the outer port **216**. A dust plug **270** is mounted within the outer port **216** of the fiber optic adapter **214** to prevent the adapter from being contaminated when no connector is inserted in the outer port **216**.

FIG. 4 illustrates one of the ruggedized fiber optic connectors **322** adapted to be inserted in the outer port **216** of the fiber optic adapter **214**. The fiber optic adapter **322** includes an outer housing **328** and a connector body **330**. The connector body **330** supports a ferrule **332** located at a connector interface end **326** of the fiber optic connector **322**. The outer housing **328** of the fiber optic connector **322** is elongated along a central axis **340** and includes a first end **342** positioned opposite from a second end **344**. The first end **342** of the outer housing **328** is positioned at the connector interface end **326** of the fiber optic connector **322** and includes a pair of opposing extensions or paddles **346** positioned on opposite sides of the connector interface housing **330**. The paddles **346** are generally parallel to the central axis **340** and are separated from one another by a gap **348** in which the connector body

330 is located. The paddles **346** have different shapes and mate with corresponding regions of the outer port **216** to provide a keying function for ensuring that the fiber optic connector **322** is mounted at the proper rotational orientation within the outer port **216**. The second end **344** of the outer housing **328** is adapted to receive a fiber optic cable **350** having a fiber **353** that terminates in the ferrule **332**. A resilient boot **352** can be positioned over the second end **344** of the outer housing **328** to provide bend radius protection at the interface between the outer housing **328** and the fiber optic cable **350**.

Referring still to FIG. **4**, the fiber optic connector **322** also includes a retention nut **358** rotatably mounted about the exterior of the outer housing **328**. The retention nut **358** is free to be manually turned relative to the outer housing **328** about the central axis **340**. The retention nut **358** includes an externally threaded portion **362** and a gripping portion **364**. The gripping portion **364** includes a plurality of flats that allow the gripping portion **364** to be easily grasped to facilitate manually turning the retention nut **358** about the central axis **340**. To secure the fiber optic connector **322** within the outer port **216** of the fiber optic adapter **214**, the threaded portion **362** is threaded into the inner threads **272**. When the fiber optic connector **322** is secured within the outer port, the ferrule **332** fits within the outer end **256** of the split sleeve **250** of the fiber optic adapter **214**.

FIGS. **5** through **8** show a standard non-ruggedized SC fiber optic connector **422** adapted to be inserted in the inner port **218** of the fiber optic adapter **214**. The connector **422** includes a connector body **424** in which a ferrule assembly is mounted. The connector body **424** includes a first end **426** positioned opposite from a second end **428**. The first end **426** provides a connector interface at which a ferrule **430** of the ferrule assembly is supported. Adjacent the first end **426**, the connector body **424** includes retention shoulders **432** that are engaged by the resilient latches **273** of the adapter **214** when the connector **422** is inserted in the inner port **218**. The latches **273** function to retain the connector **422** within the inner port **218**. The second end **428** of the connector body **424** is adapted to receive a fiber optic cable **450** having a fiber **453** that terminates in the ferrule **430**. A resilient boot **452** can be positioned at the second end **428** of the connector body **424** to provide bend radius protection at the interface between the connector body **424** and the fiber optic cable **450**.

The connector **422** also includes a retractable release sleeve **434** that mounts over the connector body **424**. The release sleeve **434** can be slid back and forth relative to the connector body **424** through a limited range of movement that extends in a direction along a longitudinal axis **454** of the connector **422**. The release sleeve **434** includes release ramps **436** that are used to disengage the latches **273** from the retention shoulders **432** when it is desired to remove the connector **422** from the inner port **218**. For example, by pulling back (i.e., in a direction toward the second end **428** of the connector body **424**) on the retention sleeve **434** while the connector **422** is mounted in the inner port **218**, the release ramps **436** force the latches **273** apart from one another a sufficient distance to disengage the latches **273** from the retention shoulders **432** so that the connector **422** can be removed from the inner port **218**. The release sleeve **434** includes a keying rail **435** that fits within the keying slot **247** of the interior adapter housing **246** to ensure proper rotational alignment of the connector **422** within the inner port **218**. When the connector **422** is latched within the inner port **218**, the ferrule **430** fits within the inner end **254** of the split sleeve **250** of the fiber optic adapter **214**. Further details regarding SC type fiber optic connectors are

disclosed at U.S. Pat. No. 5,317,663, that is hereby incorporated by reference in its entirety.

For some applications, there exists a desire to insert non-ruggedized connectors into ruggedized adapter ports. A prior art technique for accommodating this need involves removing the interior adapter housing **246** from the ruggedized housing **240** and replacing the interior adapter housing **246** with a standard SC adapter housing (e.g., see U.S. Pat. No. 5,317,663, that was previously incorporated by reference in its entirety). The standard SC adapter housing is secured within the ruggedized housing **240** with a potting material. However, this process is time consuming and requires the fiber optic adapter **214** to be disassembled. There is a need for improved techniques for providing compatibility between ruggedized and non-ruggedized fiber optic components.

SUMMARY

One aspect of the present disclosure relates to an interface converter for allowing a non-ruggedized fiber optic connector to be compatible with a ruggedized adapter port.

A variety of additional inventive aspects will be set forth in the description that follows. The inventive aspects can relate to individual features and to combinations of features. It is to be understood that both the forgoing general description and the following detailed description are exemplary and explanatory only and are not restrictive of the broad inventive concepts upon which the embodiments disclosed herein are based.

BRIEF DESCRIPTION OF THE DRAWINGS

FIG. **1** is a perspective view of a prior art drop terminal having ruggedized fiber optic adapters;

FIG. **2** is an exploded view of a ruggedized fiber optic adapter of the type mounted on the drop terminal of FIG. **1**;

FIG. **3** is a perspective cut-away view cut lengthwise through the ruggedized fiber optic adapter of FIG. **2**;

FIG. **4** is a perspective view of a ruggedized fiber optic connector adapter to be inserted in an outer port of the ruggedized fiber optic adapter of FIGS. **2** and **3**;

FIG. **5** is a front, top perspective view of a standard non-ruggedized SC fiber optic connector adapted to be inserted in an inner port of the fiber optic adapter of FIGS. **2** and **3**;

FIG. **6** is a rear, bottom perspective view of the standard non-ruggedized SC fiber optic connector of FIG. **5**;

FIG. **7** is a front, top perspective view of the standard non-ruggedized SC fiber optic connector of FIGS. **5** and **6** with an outer release sleeve removed;

FIG. **8** is a rear, bottom perspective view of the standard non-ruggedized SC fiber optic connector of FIGS. **5** and **6** with the outer release sleeve removed;

FIG. **9** is a front, top perspective view of the standard non-ruggedized SC fiber optic connector inserted in an interface converter;

FIG. **10** is a rear, top perspective view of the standard non-ruggedized SC fiber optic connector inserted in the interface converter of FIG. **9**;

FIG. **11** is a front, top perspective cut-away view cut lengthwise through the standard non-ruggedized SC fiber optic connector inserted in the interface converter of FIG. **9**;

FIG. **12** is a front, top perspective cut-away view cut lengthwise through the standard non-ruggedized SC fiber optic connector withdrawn from the interface converter of FIG. **9**;

5

FIG. 13 is a rear, top perspective cut-away view cut lengthwise along the middle through the standard non-ruggedized SC fiber optic connector withdrawn from the interface converter of FIG. 9;

FIG. 14 is a front, top perspective cut-away view cut lengthwise through the standard non-ruggedized SC fiber optic connector partially inserted in the interface converter of FIG. 9 which in turn is inserted in the outer port of the ruggedized fiber optic adapter of FIGS. 2 and 3;

FIG. 15 is a front, top perspective cut-away view cut lengthwise through the standard non-ruggedized SC fiber optic connector inserted in the interface converter of FIG. 9 which in turn is inserted in the outer port of the ruggedized fiber optic adapter of FIGS. 2 and 3;

FIG. 16 is a front, side perspective view of another interface converter in an unassembled state having features that are examples of inventive aspects in accordance with the principles of the present disclosure and the standard non-ruggedized SC fiber optic connector of FIGS. 7 and 8;

FIG. 17 is a front, side perspective view showing a first assembly step of the interface converter of FIG. 16 and the standard non-ruggedized SC fiber optic connector of FIGS. 7 and 8;

FIG. 18 is a front, side perspective view showing a second assembly step of the interface converter of FIG. 16 and the standard non-ruggedized SC fiber optic connector of FIGS. 7 and 8;

FIG. 19 is a front, side perspective view showing a third assembly step of the interface converter of FIG. 16 and the standard non-ruggedized SC fiber optic connector of FIGS. 7 and 8;

FIG. 20 is a front, side perspective view of an assembly of the interface converter of FIG. 16, the standard non-ruggedized SC fiber optic connector of FIGS. 7 and 8, and the ruggedized fiber optic adapter of FIGS. 2 and 3;

FIG. 21 is a front, side perspective cut-away view cut lengthwise through the assembly of FIG. 20 with the interface converter partially withdrawn from the ruggedized fiber optic adapter;

FIG. 22 is a front, side perspective cut-away view cut lengthwise through the assembly of FIG. 20;

FIG. 23 is a front, top perspective cut-away view cut lengthwise along the middle through the assembly of FIG. 20;

FIG. 24 is a front, side perspective view of another interface converter having features that are examples of inventive aspects in accordance with the principles of the present disclosure;

FIG. 25 is a first end view of a fiber optic adapter with the interface converter of FIG. 24 inserted therein;

FIG. 26 is a second end view of the fiber optic adapter of FIG. 25 with the interface converter of FIG. 24 inserted therein;

FIG. 27 shows a first half-piece of the interface converter of FIG. 24;

FIG. 28 shows a second half-piece of the interface converter of FIG. 24;

FIG. 29 shows an interface converter housing of the converter of FIG. 24 in the process of being mounted over an SC connector body;

FIG. 30 shows the interface converter housing of FIG. 29 mounted over the SC connector body;

FIG. 31 shows an SC connector in alignment with a release sleeve removal tool that is integral with the interface converter housing of the interface converter;

FIG. 32 shows the SC connector of FIG. 31 with a ferrule of the connector inserted within a clearance opening of the release sleeve removal tool;

6

FIG. 33 shows the SC connector of FIG. 31 with a release sleeve being forced downwardly into a recess of the release sleeve removal tool to cause the release sleeve to disengage from the connector body of the SC connector;

FIG. 34 shows the SC connector of FIG. 31 with the connector body being withdrawn from the release sleeve;

FIG. 35 is a front, side perspective view of a further interface converter having features that are examples of inventive aspects in accordance with the principles of the present disclosure;

FIG. 36 is a rear, side perspective view of the interface converter of FIG. 35;

FIG. 37 is a front, side perspective view showing an SC connector in alignment behind the converter housing of FIG. 35;

FIG. 38 is a rear, side perspective view showing the SC connector in alignment behind the converter housing of FIG. 35;

FIG. 39 is a cross-sectional view cut lengthwise through the interface converter of FIG. 35;

FIG. 40 shows the cross-sectional view of FIG. 39 with an SC connector mounted within the interface converter;

FIG. 41 shows the SC connector of FIG. 31 in alignment with another release sleeve removal tool that is integral with the interface converter housing of the interface converter of FIG. 24;

FIG. 42 shows the SC connector of FIG. 31 with the ferrule of the connector inserted within a clearance opening of the release sleeve removal tool of FIG. 41;

FIG. 43 shows the SC connector of FIG. 31 with the ferrule of the connector inserted within the clearance opening of the release sleeve removal tool of FIG. 41 and a pushing tool mounted over the release sleeve;

FIG. 44 shows the SC connector of FIG. 31 with the release sleeve being forced downwardly by the pushing tool of FIG. 43 into a recess of the release sleeve removal tool of FIG. 41 to cause the release sleeve to disengage from the connector body of the SC connector;

FIG. 45 shows the SC connector of FIG. 31 with the connector body being withdrawn from the release sleeve by the pushing tool of FIG. 43;

FIG. 46 shows the SC connector of FIG. 31 with the release sleeve removed and a coupling nut positioned over a cable;

FIG. 47 shows the interface converter housing of FIG. 29 mounted over the SC connector body and the coupling nut positioned over the cable;

FIG. 48 is a predominantly interior perspective view of the first half-piece of the interface converter of FIG. 24 integrated with another pushing tool; and

FIG. 49 is a predominantly exterior perspective view of the first half-piece of the interface converter of FIG. 24 integrated with the pushing tool of FIG. 48.

DETAILED DESCRIPTION

FIGS. 9 through 15 show an interface converter 20 having features that are examples of inventive aspects in accordance with the principles of the present disclosure. The interface converter 20 is configured to make a non-ruggedized fiber optic connector (e.g., the fiber optic connector 422 of FIGS. 5 through 8) compatible with the ruggedized outer port 216 of the fiber optic adapter 214 of FIGS. 2 and 3. The interface converter 20 mounts within the ruggedized outer port 216 and provides a mechanical interface suitable for receiving and retaining the fiber optic connector 422 within the outer port 216. The interface converter 20 also functions to align the fiber optic connector 422 within the outer port 216 such that

the ferrule 430 fits within the outer end 256 of the split sleeve 250 of the fiber optic adapter 214. In addition, the interface converter 20 rotationally orients the fiber optic connector 422 within the outer port 216 such that the keying rail 435 is seated in a keying groove 38 of the interface converter 20 and opposing paddles 30 of the interface converter 20 fit within corresponding receivers defined within the outer port 216.

Referring to FIG. 9, the interface converter 20 includes an anchoring piece 22 connected to a connector holder 24 (e.g., by a snap fit connection). The anchoring piece 22 and the connector holder 24 are both aligned along a central longitudinal axis 26 of the interface converter 20. The anchoring piece 22 can be manually rotated relative to the connector holder 24 about the central longitudinal axis 26.

The connector holder 24 forms a first end 28 of the interface converter and is shaped with a mechanical interface that complements or is compatible with the inner shape defined within the ruggedized outer port 216 of the fiber optic adapter 214. For example, the connector holder 24 includes the opposing paddles 30 that fit within the corresponding receivers defined within the outer port 216 to ensure proper rotational alignment between the connector holder 24 and the outer port 216. The connector holder 24 is configured to receive and retain the fiber optic connector 422. For example, the connector holder 24 defines a central passage 32 shaped and sized to accommodate the outer shape of the release sleeve 434 of the fiber optic connector 422. In this way, the connector 422 can be received within the central passage 32. The connector holder 24 also includes structure for mechanically retaining the fiber optic connector 422 within the central passage 32. For example, as shown in FIGS. 11 through 13, the connector holder 24 includes opposing flexible latches 34 configured to interlock with the retention shoulders 432 of the fiber optic connector 422 when the fiber optic connector 422 is inserted in the central passage 32. The interlock between the latches 34 and the retention shoulders 432 functions to retain the fiber optic connector 422 within the central passage 32. The latches 34 can be disengaged from the retention shoulders 432 by pulling back on the release sleeve 434 thereby causing the ramped surfaces 436 (see FIG. 5) of the release sleeve 434 to force the latches 34 apart a sufficient distance to disengage the latches 34 from the retention shoulders 432.

The anchoring piece 22 forms a second end 40 of the interface converter 20. The second end 40 is positioned opposite from the first end 28. The anchoring piece 22 defines a central passage 44 that aligns with the central passage 32 of the connector holder 24. In one embodiment, the central passage 44 is tapered at the second end 40 to provide a transition or lead-in for facilitating inserting the fiber optic connector 422 into the central passage 44. The anchoring piece 22 also includes external threads 46 sized to match or intermate with the internal threads 272 provided within the outer port 216 of the fiber optic adapter 214. By threading the anchoring piece 22 within the internal threads 272, the interface converter can be anchored within the outer port 216 of the fiber optic adapter 214.

As shown in FIGS. 14 and 15, the interface converter 20 can be mounted within the outer port 216 of the fiber optic adapter 214 to make the port 216 compatible with the fiber optic connector 422. To mount the interface converter 20 within the outer port 216, the first end 28 of the interface converter 20 is inserted into the port 216 and is manipulated such that the paddles 30 of the connector holder 24 fit within the corresponding receivers/receptacles provided within the outer port 216. Once the connector holder 24 is properly positioned/seated within the port 216, the anchoring piece 22

is threaded into the internal threads 272 of the outer port 216 to secure the interface converter 20 in place within the outer port 216. When mounted within the outer port 216, the second end 40 of the interface converter 20 can be flush with the outer portion of the adapter 214. In other embodiments, the second end 40 may be recessed within the outer port 216 or may project slightly outwardly from the port 216. Notches 49 can be provided at the second end 40. The notches 49 can be sized to interlock with a tool such as a spanner wrench used to turn the anchoring piece 22 within the threads 272.

Once the interface converter 20 is mounted within the outer port 216, the port 216 can accommodate the fiber optic connector 422. For example, the fiber optic connector 422 can be axially inserted into the port 216 through the second end 40 of the interface converter 20. As shown in FIG. 14, when the connector 422 is inserted into the second end 40, the connector 422 passes through the central passages 44, 32 of the interface converter 20. Insertion continues until the latches 34 interlock with the retention shoulders 432 of the connector 422, as shown in FIG. 15. Once the latches 34 interlock with the shoulders 432, the connector 422 is retained at a location with the ferrule 430 positioned at an appropriate depth within the outer end 254 of the split sleeve 250. The connector 422 can be removed from the interface converter 20 by pulling back on the release sleeve 434. To facilitate grasping the release sleeve 434, an extender can be mounted to the back side of the release sleeve 434.

FIGS. 16 through 23 show another interface converter 120 having features that are examples of inventive aspects in accordance with the principles of the present disclosure. The interface converter 120 is also configured to make a non-ruggedized fiber optic connector (e.g., the fiber optic connector 422 of FIGS. 5 through 8) compatible with the outer port 216 of the ruggedized fiber optic adapter 214 of FIGS. 2 and 3. The interface converter 120 mounts over the connector body 424 (e.g., with the release sleeve 434 removed) of the connector 422 and provides a mechanical interface suitable for mating and retaining the fiber optic connector 422 within the outer port 216. Other embodiments of an interface converter may mount with the release sleeve 434 remaining on the connector 422.

Referring to FIGS. 16 and 17, the interface converter 120 includes a converter housing 126 defining a central passage 132 for receiving the connector body 424 of the fiber optic connector 422. The converter 120 also includes a coupling nut 140 rotatably mounted on the converter housing 126 for use in mechanically retaining the converter 120 within the outer port 216 of the fiber optic adapter 214.

The converter housing 126 of the converter 120 includes a first end 128 and an opposite second end 130. The converter housing 126 defines a central axis 131 that extends through the converter housing 126 from the first end 128 to the second end 130. The central passage 132 extends through the converter housing 126 along the central axis 131. The first end 128 of the converter housing 126 is configured to be mechanically compatible with the outer port 216 of the fiber optic adapter 214. For example, the first end 128 of the converter housing 126 can have a shape that complements, mates with or is otherwise mechanically compatible with the shape of the outer port 216 of the fiber optic adapter 214. The first end 128 is also configured to secure and support the connector body 424 of the fiber optic connector 422. The second end 130 of the converter housing 126 is configured to receive or accommodate the resilient boot 452 of the fiber optic connector 422.

As indicated above, the first end 128 of the converter housing 126 has mechanical characteristics that are compatible with the internal shape of the outer port 216 defined by the

fiber optic adapter 214. For example, the first end 128 includes an end wall 154 defining a first opening 156, and also includes a pair of paddles 158a, 158b that project outwardly from the end wall 154 along a direction of connector insertion 155 (see FIG. 19). The paddles 158a, 158b are positioned on opposite sides of the central axis 131 of the converter housing 126 and have inner surfaces 159 that oppose one another. Open side gaps 162 are defined between the paddles 158a, 158b. When the converter housing 126 is mounted over the connector body 424, the ferrule end of the connector body 424 extends through the first opening 156 and is positioned between the paddles 158a, 158b. The paddles 158a, 158b have slightly different shapes and when mated with corresponding structure in the port 216 provide a keying function that ensures that the converter housing 126 is inserted at the proper rotational orientation within the outer port 216.

The coupling nut 140 of the converter 120 is mounted at the second end 130 of the converter housing 126 and is free to rotate about the exterior of the converter housing 126 (e.g., about the central axis 131). The coupling nut 140 includes an externally threaded portion 146 and a gripping portion 148. The gripping portion 148 defines a plurality of longitudinal depressions or finger grooves 150 for facilitating grasping the gripping portion 148. The threaded portion 146 is sized to be threaded within the internal threads 272 defined within the outer port 216 of the fiber optic adapter 214 to secure the converter 120 within the port 216. As shown in FIGS. 21 and 22, a user can thread the threaded portion 146 of the coupling nut 140 into the internal threads 272 of the fiber optic adapter 214 by inserting the threaded portion 146 into the first port 216 of the fiber optic adapter 214 and manually turning the coupling nut 140 about the converter housing 126 to thread the threaded portion 146 into the first port 216. The gripping portion 148 facilitates gripping and manually turning the coupling nut 140.

The converter housing 126 has a configuration that facilitates mounting the housing 126 over the connector body 424. For example, the converter housing 126 includes first and second half-pieces 126a, 126b that meet at a plane that extends longitudinally along the central axis 131. The half-piece 126a defines a half-passage 132a sized to fit over one half of the connector body 424 and the half-piece 126b defines a half-passage 132b that fits over the other half of the connector body 424. The half-piece 126a includes one of the paddles 158a while the half-piece 126b includes the other paddle 158b, as shown in FIG. 17. In other embodiments, the split line of the housing 126 could be rotated 90 degrees about axis 131.

The half-piece 126a includes a slot arrangement 170a adapted to engage opposite sides of the retention shoulders 432 of the connector body 424 so that the shoulders 432 are captured within the slot arrangement 170a to resist or limit relative axial movement between the connector body 424 and the converter housing 126 in two directions. The half-piece 126b includes a stop surface 170b that abuts against the shoulders 432 but does not capture the shoulders 432. The half-pieces 126a, 126b are mechanically connected by an axial slide arrangement that includes a pair of tongues 172a provided on the half-piece 126a and a pair of grooves 172b provided on the half-piece 126b. The tongue and grooves are aligned parallel to the central axis 131 and are located at the interface between the half-pieces 126a, 126b. The half-piece 126b also includes enlarged access recesses 173b positioned at the ends of the grooves 172b for facilitating inserting the tongues 172a into the grooves 172b, as shown in FIGS. 18 and 19. By inserting the tongues 172a laterally into the recesses

173b, and then sliding the tongues 172a axially into the grooves 172b, the half-pieces 126a, 126b can be coupled together.

To mount the converter 120 on the fiber optic connector 422, the retention nut 140 is first slid over the connector 422 and onto the cable to which the connector 422 is terminated, as shown in FIG. 16. The release sleeve 434 of the connector 422 is then removed from the connector body 424. Once the release sleeve 434 has been removed, the half-piece 126a is inserted laterally over the connector body 424 such that the retention shoulders 432 are received within the slot arrangement 170a (see FIGS. 16 and 17). The half-piece 126b is then inserted laterally toward the half-piece 126a such that the connector body 424 is captured between the pieces 126a, 126b and the tongues 172a are received within the recesses 173b. The half-piece 126b is then slid axially relative to the half-piece 126a in the axial direction indicated by arrow 175 (see FIG. 18), to engage the tongues 172a with the grooves 172b. The half-piece 126b is slid axially in the direction 175 until the stop surface 170b engages the retention shoulders 432. Thereafter, the coupling nut 140 can be slid over the second end 130 of the converter 120, and the connector 422 is ready to be mounted in the outer port 216 of the adapter 214.

Once the fiber optic connector 422 is mounted within the converter 120, the combined components can be coupled to the fiber optic adapter 214, as shown in FIGS. 20 through 23. For example, the first end 128 of the converter 120 can be inserted within the outer port 216 of the fiber optic adapter 214. As so inserted, the ferrule 430 of the connector 422 is received within the split sleeve 250 positioned within the fiber optic adapter 214, and the paddles 158a, 158b are received within corresponding receptacles within the fiber optic adapter 214 as shown in FIGS. 22 and 23. To insure that the fiber optic connector 422 is fully inserted and secured within the port 216, the threaded portion 146 of the coupling nut 140 is preferably threaded into the internal threads 272 of the fiber optic adapter 214. Threading of the threaded portion 146 into the internal threads 272 can be done manually by grasping the gripping portion 148 and manually turning the coupling nut 140. By unthreading the coupling nut 140 from the fiber optic adapter 214, and axially pulling the converter 120 from the fiber optic adapter 214, the converter 120 and the fiber optic connector 422 can be disconnected from the fiber optic adapter 214.

FIG. 24 shows another interface converter 520 having features that are examples of inventive aspects in accordance with the principles of the present disclosure. The interface converter 520 is also configured to make a non-ruggedized fiber optic connector (e.g., the fiber optic connector 422 of FIGS. 5 through 8) compatible with the outer port 216 of the ruggedized fiber optic adapter 214 of FIGS. 2 and 3. As shown at FIG. 24, the interface converter 520 includes a converter housing 526 that mounts over the connector body 424 (e.g., with the release sleeve 434 removed) of the connector 422 and provides a mechanical interface suitable for mating the fiber optic connector 422 within the outer port 216. The converter 520 also includes a coupling nut 540 rotatably mounted on the converter housing 526 for use in mechanically retaining the converter 520 within the outer port 216 of the fiber optic adapter 214. FIGS. 25 and 26 show the interface converter 520 secured within the outer port 216 of the fiber optic adapter 214 by the coupling nut 540.

Referring to FIG. 30, the converter housing 526 of the converter 520 includes a first end 528 and an opposite second end 530. A central axis 531 extends through the converter housing 526 from the first end 528 to the second end 530. The first end 528 of the converter housing 526 is configured to be

mechanically compatible with the outer port 216 of the fiber optic adapter 214. For example, the first end 528 of the converter housing 526 can have the same configuration as the first end 128 of the converter 120 of FIGS. 16 through 23 (e.g., paddles 558a, 558b). The first end 528 is also configured to secure and support the connector body 424 of the fiber optic connector 422. The second end 530 of the converter housing 526 is configured to receive or accommodate the resilient boot 452 of the fiber optic connector 422.

The coupling nut 540 of the converter 520 is mounted at the second end 530 of the converter housing 526 and is free to rotate about the exterior of the converter housing 526 (e.g., about the central axis 531). The coupling nut 540 has the same configuration as the coupling nut 140 of the converter 120 and is configured to be manually threaded into the threaded portion 146 into the first port 216 of the fiber optic adapter 214 to secure the converter 520 within the first port 216.

The converter housing 526 has a configuration that facilitates mounting the housing 526 over the connector body 424. For example, the converter housing 126 includes first and second half-pieces 526a, 526b that meet at a plane that extends longitudinally along the central axis 531. The half-piece 526a (see FIG. 27) defines a half-passage 532a sized to fit over one half of the connector body 424 and the half-piece 526b (see FIG. 28) defines a half-passage 532b that fits over the other half of the connector body 424. The half-piece 526a includes one of the paddles 558a while the half-piece 526b includes the other paddle 558b. The half-pieces 526a, 526b include slot arrangements 570a, 570b adapted to engage opposite sides of the retention shoulders 432 of the connector body 424 so that the shoulders 432 are captured within the slot arrangements 570a, 570b to resist or limit relative movement between the connector body 424 and the converter housing 126 in either direction along the axis 531.

The half-pieces 526a, 526b are mechanically connected by a snap arrangement that includes a pair of latching clips 572a provided on the half-piece 526a and a pair of clip receivers 572b provided on the half-piece 526b. The latching clips 572a include tabs 573a that engage shoulders 573b (see FIG. 29) of the clip receivers 572b when the latching clips 572a are snapped within the clip receivers 572b. The latching clips 572a each have a cantilevered configuration having a base end and a free end. The tabs 573a are provided at the free ends and the base ends are integrally formed with a main body of the half-piece 526a. The latching clips 572a extend in a direction generally perpendicular to the central axis 531 as the latching clips 572a extend from the base ends to the free ends. By inserting the clips 572a into the receivers 572b and then pressing the half-pieces 526a, 526b together (as indicated by arrows 577 shown at FIG. 30) in a direction generally perpendicular to the axis 531, the half-pieces 526a, 526b can be coupled together by a snap-fit connection. By prying/flexing the clips 572a apart from one another, the tabs 573a can be disengaged from the shoulders 573b to allow the half-pieces 526a, 526b to be disassembled.

The half-piece 526b includes an integrated tool 590 for use in removing the release sleeve 434 from the connector body 424 of the connector 422 prior to mounting the converter 520 over the connector body 424. The integrated tool 590 includes a lateral projection 591 defining a clearance opening 593 sized for receiving the ferrule 430 of the connector 422. The projection 591 includes a bearing force surface 595 that surrounds the opening 593. In one embodiment, the projection 591s has an outer shape that generally matches the outer shape of the first end 426 of the connector body 424. In another embodiment, the projection 591b is cylindrical. A recessed region 597 surrounds the projection 591.

In use of the tool 590, the half-piece 526b is placed on a firm, flat surface with the bearing force surface 595 of the projection 591 facing upwardly (see FIGS. 31 and 41). A dust cap is then removed from the ferrule 430 of the connector 422 and the ferrule 430 inserted in the clearance opening 593 with the connector 422 extending vertically upwardly from the projection 591 (see FIGS. 32 and 42). If the outer shape of the projection 591s requires (see FIG. 32), the connector 422 is rotated about its central axis 454 (see FIG. 5) until the outer shape of the connector body 424 is in alignment with the outer shape of the projection 591s. If the outer shape of the projection 591b does not require (see FIG. 42), the connector 422 may assume any orientation about its central axis 454 so long as the outer shape of the release sleeve 434 fits within the recessed region 597.

In certain embodiments, a pushing tool 589 is integrated with the half-piece 526a. Certain forms of the pushing tool 589a have a slot shape, which both allows placement around the fiber optic cable 450 and engages the release sleeve 434 (see FIGS. 48 and 49). Other forms of the pushing tool 589k have a slot shape, which allows placement around the fiber optic cable 450, intersecting with a cylindrical shape, that engages the release sleeve 434 (see FIGS. 43 through 45). The pushing tool 589 may optionally be mounted over the release sleeve 434.

After properly positioning the connector 422, the release sleeve 434 is pushed downwardly (see FIGS. 33 and 44). As the release sleeve 434 is pushed downwardly, the end face of the connector body 424 bears against the bearing force surface 595 of the projection 591 and the release sleeve 434 slides over the projection 591 and into the recessed region 597. By this action, which generates relative linear movement between the release sleeve 434 and the connector body 424, the release sleeve 434 is disengaged from the connector body 424. The connector body 424 can then be drawn out from the release sleeve 434 by pulling up on the connector body 424 or optionally the pushing tool 589 (see FIGS. 34 and 45). The opening 593 is preferably deep enough to protect the end face of the ferrule 430 by preventing the end face from being pressed against another surface during removal of the release sleeve 434 (i.e., the ferrule does not "bottom-out" within the opening when the end face of the connector body 424 is seated on the bearing force surface 595).

To mount the converter 520 on the fiber optic connector 422, the release sleeve 434 of the connector 422 is removed from the connector body 424. The integrated tools 589 and 590 may be optionally used, as described above. Once the release sleeve 434 has been removed, the retention nut 540 is slid over the connector 422 and onto the cable 450 to which the connector 422 is terminated (see FIG. 46). The half-piece 526a is inserted laterally over the connector body 424 such that the retention shoulders 432 of the connector body 424 are received within the slot arrangement 570a (see FIG. 29). When fully inserted, about half of the shoulders 432 are held within the slot arrangement 570a. The half-piece 526b is then inserted laterally toward the half-piece 526a such that the other halves of the retention shoulders 432 of the connector body 424 are received within the slot arrangement 570b and the connector body 424 is captured between the pieces 526a and 526b (see FIGS. 30 and 47). Also, the latching clips 572a are received within the receivers 572b to provide a snap-fit connection between the pieces 526a, 526b as the pieces 526a, 526b are pushed laterally together. Preferably, the snap-fit latching arrangement provides both an audible indication (i.e., a "snap") and a visual indication that the pieces 526a, 526b are latched together. The retention nut 540 is then slid over the second end of the converter housing 526 to complete

the assembly process (see FIG. 24). Once the fiber optic connector 422 is mounted within the converter 520, the combined components can be coupled to and uncoupled from the fiber optic adapter 214 in the same manner described with respect to the converter 120.

FIGS. 35 through 40 show still another interface converter 620 having features that are examples of inventive aspects in accordance with the principles of the present disclosure. The interface converter 620 is also configured to make a non-ruggedized fiber optic connector (e.g., the fiber optic connector 422 of FIGS. 5 through 8) compatible with the outer port 216 of the ruggedized fiber optic adapter 214 of FIGS. 2 and 3. As shown at FIG. 35, the interface converter 620 includes a converter housing 626 that mounts over the connector 422 (e.g., with the release sleeve 434 in place on the connector body 424) and provides a mechanical interface suitable for mating the fiber optic connector 422 within the outer port 216. The converter 620 also includes a coupling nut 640 (see FIGS. 39 and 40) rotatably mounted on the converter housing 626 for use in mechanically retaining the converter 620 within the outer port 216 of the fiber optic adapter 214.

The converter housing 626 of the converter 620 includes a first end 628 and an opposite second end 630. A central axis 631 extends through the converter housing 626 from the first end 628 to the second end 630. The first end 628 of the converter housing 626 is configured to be mechanically compatible with the outer port 216 of the fiber optic adapter 214. For example, the first end 628 of the converter housing 626 can have the same configuration as the first end 128 of the converter 120 of FIGS. 16 through 23. The first end 628 is also configured to provide access to the ferrule 430 located at the end of the fiber optic connector 422. The second end 630 of the converter housing 626 is configured to receive or accommodate the resilient boot 452 of the fiber optic connector 422.

The coupling nut 640 of the converter 620 is mounted at the second end 630 of the converter housing 626 (see FIGS. 39 and 40) and is free to rotate about the exterior of the converter housing 626 (e.g., about the central axis 631). The coupling nut 640 has the same configuration as the coupling nut 140 of the converter 120 and is configured to be manually threaded into the threaded portion 272 within the first port 216 of the fiber optic adapter 214 to secure the converter 620 within the first port 216.

The converter housing 626 has a one-piece configuration and includes flexible, snap-fit latches 627 to secure the fiber optic connector 422 within the converter housing 626. To mount the converter 620 on the fiber optic connector 422, the fiber optic connector 422 is inserted axially into the converter housing 626 through the second end 630 as indicated by arrows 621 shown at FIGS. 37 and 38. The coupling nut 640 can be mounted at the second end 630 of the converter housing 626 at the time the connector 422 is inserted into the second end 630 of the converter housing 626. The housing 626 includes an internal axial slot 629 (see FIG. 39) sized for receiving the keying rail 435 of the release sleeve 434 and an internal passage 623 sized for receiving the release sleeve 434 when the fiber optic connector 422 is inserted into the converter housing 626. Mating of the keying rail 435 and the slot 629 insures that the connector 422 is oriented in the proper rotational position during insertion of the connector 422 into the converter housing 626. As the fiber optic connector 422 is inserted into the converter housing 626, ramped interior surfaces 625 of the snap-fit latches 627 are initially spread apart by the fiber optic connector 422 and flex to allow passage of the fiber optic connector 422. As the insertion continues, the latches 627 pass over openings 439 defined through the release sleeve 434. The openings 439 allow the latches 627 to

at least partially un-flex and project through the openings 439 and engage the retention shoulders 432 provided on the connector body 424. Sloping surfaces 433 (see FIG. 7) provide clearance for the ramped interior surfaces 625 as the snap-fit latches 627 un-flex and engage the retention shoulders 432. The insertion depth of the fiber optic connector 422 into the converter housing 626 is limited by the keying rail 435 of the release sleeve 434 bottoming out at an end 624 of the internal axial slot 629 of the housing 626. The connector 422 is thereby securely retained within the passage 623 between the end 624 of the internal axial slot 629 and the snap-fit latches 627 of the converter housing 626. Preferably, the snap-fit latching arrangement provides both an audible indication (i.e., a "snap") and a visual indication that the connector 422 is latched within the converter housing 626. Once the fiber optic connector 422 is mounted within the converter 520, the combined components can be coupled to and uncoupled from the fiber optic adapter 214 in the same manner described with respect to the converter 120. If desired, the connector 422 can be disconnected from the converter 620 by flexing the snap-fit latches 627 apart and withdrawing the connector 422.

From the forgoing detailed description, it will be evident that modifications and variations can be made in the devices of the disclosure without departing from the spirit or scope of the invention.

What is claimed is:

1. A method of converting a fiber optic connector adapted for mechanical connection at a retention shoulder included on the fiber optic connector to a converted fiber optic connector adapted for mechanical connection at threads included on the converted fiber optic connector, the method comprising:
 - providing the fiber optic connector and a converter;
 - mounting a first piece of the converter over a portion of the fiber optic connector;
 - mounting a second piece of the converter to the first piece of the converter;
 - engaging a slot of the converter with the retention shoulder of the fiber optic connector; and
 - positioning a threaded member of the converter at least partially over an exterior of the mounted first and second pieces of the converter;
 wherein the converter includes a first paddle that extends to a distal end of the converter.
2. The method of claim 1, wherein the slot of the converter is included on the first piece of the converter.
3. The method of claim 2, wherein the slot of the converter is also included on the second piece of the converter.
4. The method of claim 1, wherein the first piece of the converter includes the first paddle and the second piece of the converter includes a second paddle that extends to the distal end of the converter and wherein the first and the second paddles are generally positioned opposite each other about a ferrule of the fiber optic connector when the first piece is mounted to the portion of the fiber optic connector and the second piece is mounted to the first piece of the converter.
5. The method of claim 1, wherein the fiber optic connector includes a pair of the retention shoulders and the first piece of the converter includes a pair of the slots.
6. The method of claim 5, wherein the second piece of the converter also includes the pair of the slots.
7. The method of claim 1, wherein the first piece of the converter is a first half-piece and the second piece of the converter is a second half-piece and wherein the first and the second half-pieces abut each other at a plane extending parallel to a central axis of the fiber optic connector.

15

8. The method of claim 7, wherein the second half-piece of the converter is mounted to the first half-piece of the converter by a tongue-and-groove connection.

9. The method of claim 8, wherein a tongue of the tongue-and-groove connection is included on the first half-piece and a groove of the tongue-and-groove connection is included on the second half-piece.

10. The method of claim 8, wherein the tongue-and-groove connection between the first and the second half-pieces is made by relative movement between the first and the second half-pieces in a direction parallel to the central axis of the fiber optic connector.

11. The method of claim 7, wherein the second half-piece of the converter is mounted to the first half-piece of the converter by a latching clip and receiver connection.

12. The method of claim 11, wherein the slot of the converter includes a first slot portion on the first piece of the converter and includes a second slot portion on the second piece of the converter, wherein the first slot portion engages the retention shoulder of the fiber optic connector when the first piece of the converter is mounted over the portion of the fiber optic connector, and wherein the second slot portion engages the retention shoulder of the fiber optic connector when the second piece of the converter is mounted to the first piece of the converter.

13. The method of claim 11, wherein a latching clip of the latching clip and receiver connection is included on the first half-piece and a receiver of the latching clip and receiver connection is included on the second half-piece.

14. The method of claim 11, wherein the latching clip and receiver connection between the first and the second half-pieces is made by relative movement between the first and the second half-pieces in a direction perpendicular to the central axis of the fiber optic connector.

15. The method of claim 1, further comprising repositioning the threaded member of the converter over the fiber optic connector prior to the mounting of the first piece of the converter over the portion of the fiber optic connector.

16. The method of claim 1, further comprising removal of a release sleeve from the fiber optic connector prior to the mounting of the first piece of the converter over the portion of the fiber optic connector.

17. The method of claim 5, wherein the retention shoulders of the fiber optic connector extend in a direction perpendicular to a central axis of the fiber optic connector and the first piece of the converter is mounted to the portion of the fiber optic connector by relative movement between the first piece and the fiber optic connector in the direction perpendicular to the central axis of the fiber optic connector.

18. The method of claim 1, wherein a portion of the exterior of the mounted first and the second pieces of the converter defines a substantially cylindrical surface, wherein the threaded member includes a substantially cylindrical interior surface, and wherein the substantially cylindrical interior surface of the threaded member pilots the threaded member on the substantially cylindrical surface when the threaded member is positioned on the exterior of the mounted first and second pieces.

19. The method of claim 1, wherein the mounted first and second pieces of the converter define a shoulder, wherein the threaded member includes an abutting surface, and wherein the abutting surface of the threaded member is adapted to abut the shoulder defined by the mounted first and second pieces.

20. The method of claim 4, wherein the first and the second paddles are adapted to provide a keying function that rota-

16

tionally orients the converter and thereby orients the converted fiber optic connector when the converted fiber optic connector is connected to a port of a fiber optic adapter.

21. A method of converting a fiber optic connector that is adapted for connection to a first fiber optic adapter including a latch to a converted fiber optic connector that is adapted for connection to a second fiber optic adapter including threads, the fiber optic connector including a retention shoulder adapted to latch to the latch of the first fiber optic adapter, the method comprising:

providing the fiber optic connector and a converter; mounting a first piece of the converter over a first portion of the fiber optic connector, the first piece of the converter including a first paddle that extends to a distal end of the first piece;

mounting a second piece of the converter over a second portion of the fiber optic connector, the second piece of the converter including a second paddle that extends to a distal end of the second piece; and

positioning a threaded member of the converter over a portion of the mounted first and second pieces of the converter;

wherein the converter includes a slot that engages the retention shoulder of the fiber optic connector; and

wherein the first and the second paddles are generally positioned opposite each other about a ferrule of the fiber optic connector when the first and the second pieces are mounted over the first and the second portions of the fiber optic connector.

22. The method of claim 21, further comprising attaching the first and the second pieces of the converter to each other.

23. The method of claim 21, wherein the slot of the converter is included on the first piece of the converter.

24. The method of claim 23, wherein the slot of the converter is also included on the second piece of the converter.

25. A method of converting an SC fiber optic connector to a fiber optic connector that includes external threads, the method comprising:

providing the SC fiber optic connector and a converter; mounting a first piece of the converter over a portion of the SC fiber optic connector, the first piece of the converter including a slot that engages a retention shoulder of the SC fiber optic connector when the first piece is mounted over the portion of the SC fiber optic connector and the first piece of the converter including a first paddle that extends to a distal end of the first piece;

mounting a second piece of the converter to the first piece of the converter, the second piece of the converter including a second paddle that extends to a distal end of the second piece, the first and the second paddles generally positioned opposite each other about a ferrule of the SC fiber optic connector when the first piece is mounted to the portion of the SC fiber optic connector and the second piece is mounted to the first piece of the converter; and

positioning a threaded member of the converter over a portion of the mounted first and second pieces of the converter, the threaded member including the external threads.

26. The method of claim 25, further comprising removal of a release sleeve from the fiber optic connector prior to the mounting of the first piece of the converter over the portion of the SC fiber optic connector.