



US008360298B2

(12) **United States Patent**
Farascioni et al.

(10) **Patent No.:** **US 8,360,298 B2**
(45) **Date of Patent:** **Jan. 29, 2013**

(54) **SURGICAL INSTRUMENT AND LOADING UNIT FOR USE THEREWITH**

(75) Inventors: **David Farascioni**, Bethel, CT (US);
John W. Beardsley, Wallingford, CT (US)

(73) Assignee: **Covidien LP**, Mansfield, MA (US)

(*) Notice: Subject to any disclaimer, the term of this patent is extended or adjusted under 35 U.S.C. 154(b) by 364 days.

(21) Appl. No.: **12/759,897**

(22) Filed: **Apr. 14, 2010**

(65) **Prior Publication Data**

US 2010/0213238 A1 Aug. 26, 2010

Related U.S. Application Data

(63) Continuation-in-part of application No. 12/553,174, filed on Sep. 3, 2009, now Pat. No. 7,988,028, which is a continuation-in-part of application No. 12/235,751, filed on Sep. 23, 2008, now Pat. No. 7,896,214.

(51) **Int. Cl.**
A61B 17/068 (2006.01)

(52) **U.S. Cl.** **227/176.1; 227/19**

(58) **Field of Classification Search** **227/176.1, 227/19, 175.1**

See application file for complete search history.

(56) **References Cited**

U.S. PATENT DOCUMENTS

3,017,637 A	1/1962	Arnold
3,079,306 A	2/1963	Bobrov et al.
3,499,591 A	3/1970	Green
4,576,167 A	3/1986	Noiles
4,633,874 A	1/1987	Chow et al.
4,715,520 A	12/1987	Roehr, Jr. et al.
4,819,853 A	4/1989	Green
4,881,544 A	11/1989	Green et al.
4,924,864 A	5/1990	Danzig

5,014,899 A	5/1991	Presty et al.
5,071,430 A	12/1991	de Salis et al.
5,180,092 A	1/1993	Crainich
5,307,976 A	5/1994	Olson et al.
5,318,221 A	6/1994	Green et al.
5,358,506 A	10/1994	Green et al.
5,366,477 A	11/1994	LeMarie, III et al.
5,379,933 A	1/1995	Green et al.
5,389,098 A	2/1995	Tsuruta et al.
5,397,324 A	3/1995	Carroll et al.

(Continued)

FOREIGN PATENT DOCUMENTS

EP	0537498 A2	4/1993
EP	0600182 A	6/1994

(Continued)

OTHER PUBLICATIONS

European Search Report for EP 1025188.6-1269 date of completion is Feb. 25, 2011.

(Continued)

Primary Examiner — Brian D Nash

(57) **ABSTRACT**

A surgical instrument is disclosed. The surgical instrument includes a handle assembly having a movable handle; an endoscopic portion extending distally from the handle and defining a longitudinal axis; a pair of jaw members; and a drive assembly. The jaw members are disposed adjacent a distal end of the endoscopic portion and extend generally distally therefrom. Each jaw member is longitudinally curved with respect to the longitudinal axis. At least one jaw member is movable with respect to the other between open and approximated positions. A first jaw member includes a channel having a longitudinally-extending slot therein. The drive assembly is advanced distally through at least a portion of the length of the jaw members in response to at least a partial actuation of the movable handle. A lower portion of the drive assembly is configured and dimensioned to travel at least partially within the longitudinally-extending slot of the channel.

17 Claims, 22 Drawing Sheets

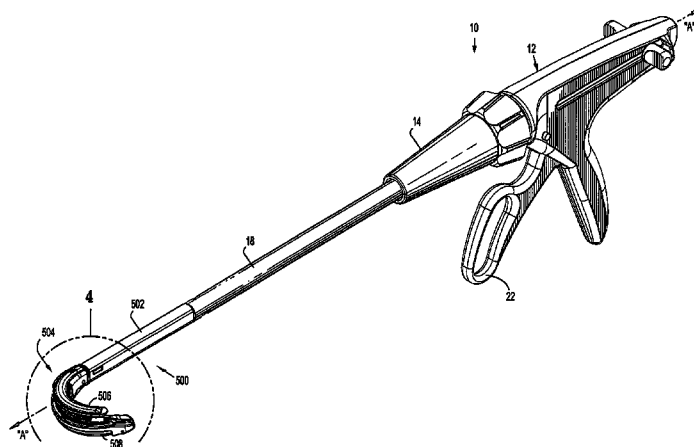

U.S. PATENT DOCUMENTS

5,403,312 A	4/1995	Yates et al.	7,451,904 B2	11/2008	Shelton, IV
5,413,268 A	5/1995	Green et al.	7,464,849 B2	12/2008	Shelton, IV et al.
5,415,334 A	5/1995	Williamson, IV et al.	7,503,474 B2	3/2009	Hillstead et al.
5,423,471 A	6/1995	Mastri et al.	2005/0070758 A1	3/2005	Wells et al.
5,452,837 A	9/1995	Williamson, IV et al.	2005/0139636 A1	6/2005	Schwemberger et al.
5,465,895 A	11/1995	Knodel et al.	2005/0145672 A1	7/2005	Schwemberger et al.
5,470,008 A	11/1995	Rodak	2005/0165415 A1*	7/2005	Wales 606/139
5,484,451 A	1/1996	Akopov et al.	2005/0247752 A1	11/2005	Kelly et al.
5,487,500 A	1/1996	Knodel et al.	2005/0247753 A1	11/2005	Kelly et al.
5,551,622 A	9/1996	Yoon	2006/0144898 A1	7/2006	Bilotti et al.
5,562,241 A	10/1996	Knodel et al.	2007/0029364 A1	2/2007	Kruszynski et al.
5,597,107 A	1/1997	Knodel et al.	2007/0034667 A1*	2/2007	Holsten et al. 227/176.1
5,601,573 A	2/1997	Fogelberg et al.	2007/0039995 A1	2/2007	Schwemberger et al.
5,634,584 A	6/1997	Okorocho et al.	2007/0039996 A1	2/2007	Mather et al.
5,651,491 A	7/1997	Heaton et al.	2007/0039997 A1	2/2007	Mather et al.
5,653,373 A	8/1997	Green et al.	2007/0114261 A1	5/2007	Ortiz et al.
5,655,698 A	8/1997	Yoon	2007/0131732 A1*	6/2007	Holsten et al. 227/179.1
5,662,258 A	9/1997	Knodel et al.	2007/0175950 A1	8/2007	Shelton, IV et al.
5,662,259 A	9/1997	Yoon	2007/0181631 A1	8/2007	Bilotti et al.
5,662,260 A	9/1997	Yoon	2007/0219563 A1	9/2007	Voegele
5,673,841 A	10/1997	Schulze et al.	2007/0221702 A1	9/2007	Kruszynski
5,680,982 A	10/1997	Schulze et al.	2007/0246508 A1	10/2007	Green
5,681,330 A	10/1997	Hughett et al.	2007/0255296 A1	11/2007	Sauer
5,794,834 A	8/1998	Hamblin et al.	2008/0027466 A1	1/2008	Vitali et al.
5,800,449 A	9/1998	Wales	2008/0093415 A1	4/2008	Bilotti
5,816,471 A	10/1998	Plyley et al.	2008/0169328 A1*	7/2008	Shelton 227/176.1
5,911,352 A	6/1999	Racenet et al.	2008/0169329 A1	7/2008	Shelton et al.
5,984,938 A	11/1999	Yoon	2008/0169330 A1	7/2008	Shelton et al.
5,988,479 A	11/1999	Palmer	2008/0169331 A1	7/2008	Shelton et al.
5,993,465 A	11/1999	Shipp et al.	2008/0169332 A1	7/2008	Shelton et al.
6,010,054 A	1/2000	Johnson et al.	2008/0169333 A1	7/2008	Shelton et al.
6,119,913 A	9/2000	Adams et al.	2008/0272171 A1	11/2008	Viola
6,131,789 A	10/2000	Schulze et al.	2009/0008424 A1	1/2009	Green
6,174,309 B1	1/2001	Wrublewski et al.	2009/0134199 A1	5/2009	Heinrich et al.
6,241,140 B1	6/2001	Adams et al.	2010/0072258 A1	3/2010	Farascioni et al.
6,601,749 B2	8/2003	Sullivan et al.	2010/0076459 A1*	3/2010	Farascioni 606/143
6,607,540 B1	8/2003	Shipp	2010/0213238 A1	8/2010	Farascioni et al.
6,755,338 B2	6/2004	Hahnen et al.			
6,805,273 B2	10/2004	Bilotti et al.			
6,978,921 B2	12/2005	Shelton, IV et al.			
6,988,650 B2	1/2006	Schwemberger et al.			
7,000,818 B2	2/2006	Shelton, IV et al.			
7,055,731 B2	6/2006	Shelton, IV et al.			
7,134,587 B2	11/2006	Schwemberger et al.			
7,147,139 B2	12/2006	Schwemberger et al.			
7,147,140 B2	12/2006	Wukusick et al.			
7,204,404 B2	4/2007	Nguyen et al.			
7,207,472 B2	4/2007	Wukusick et al.			
7,210,609 B2	5/2007	Leiboff et al.			
7,278,563 B1	10/2007	Green			
RE40,237 E	4/2008	Bilotti			
7,380,696 B2	6/2008	Shelton, IV et al.			
7,407,078 B2	8/2008	Shelton, IV et al.			
7,434,717 B2	10/2008	Shelton, IV et al.			

FOREIGN PATENT DOCUMENTS

EP	1550410 A2	7/2005
EP	1908413 A1	4/2008
EP	2 165 662 A1	3/2010
WO	WO 03/022133 A2	3/2003

OTHER PUBLICATIONS

European Search Report for EP 11250468.3-2319 date of completion is Aug. 10, 2011 (3 pages).

European Search Report for EP 11 25 0757.9-2310 date of completion is Feb. 7, 2012 (3 pages).

European Search Report for EP 11178544.0-1269 date of completion is Sep. 29, 2011 (3 pages).

* cited by examiner

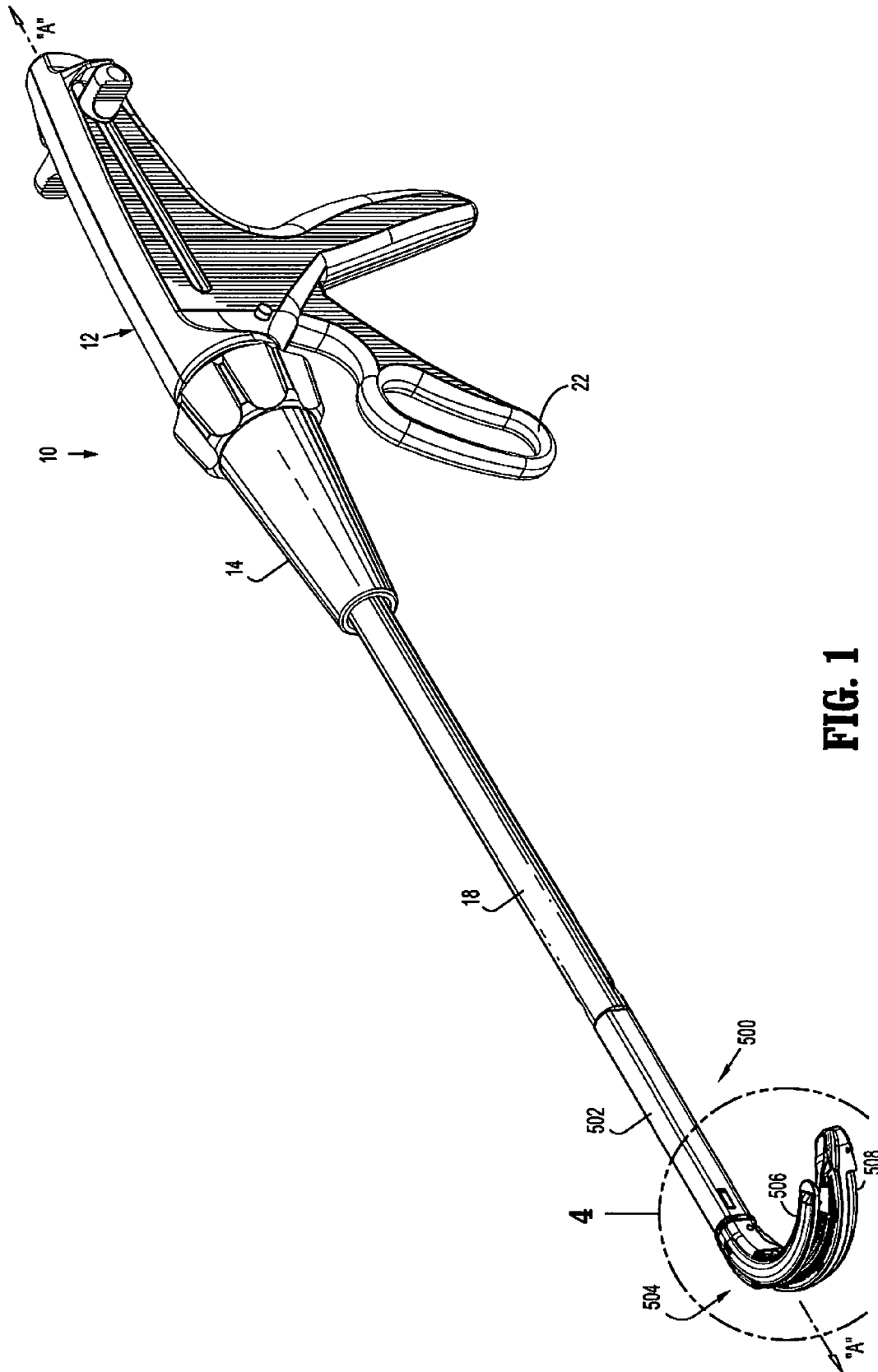

FIG. 1

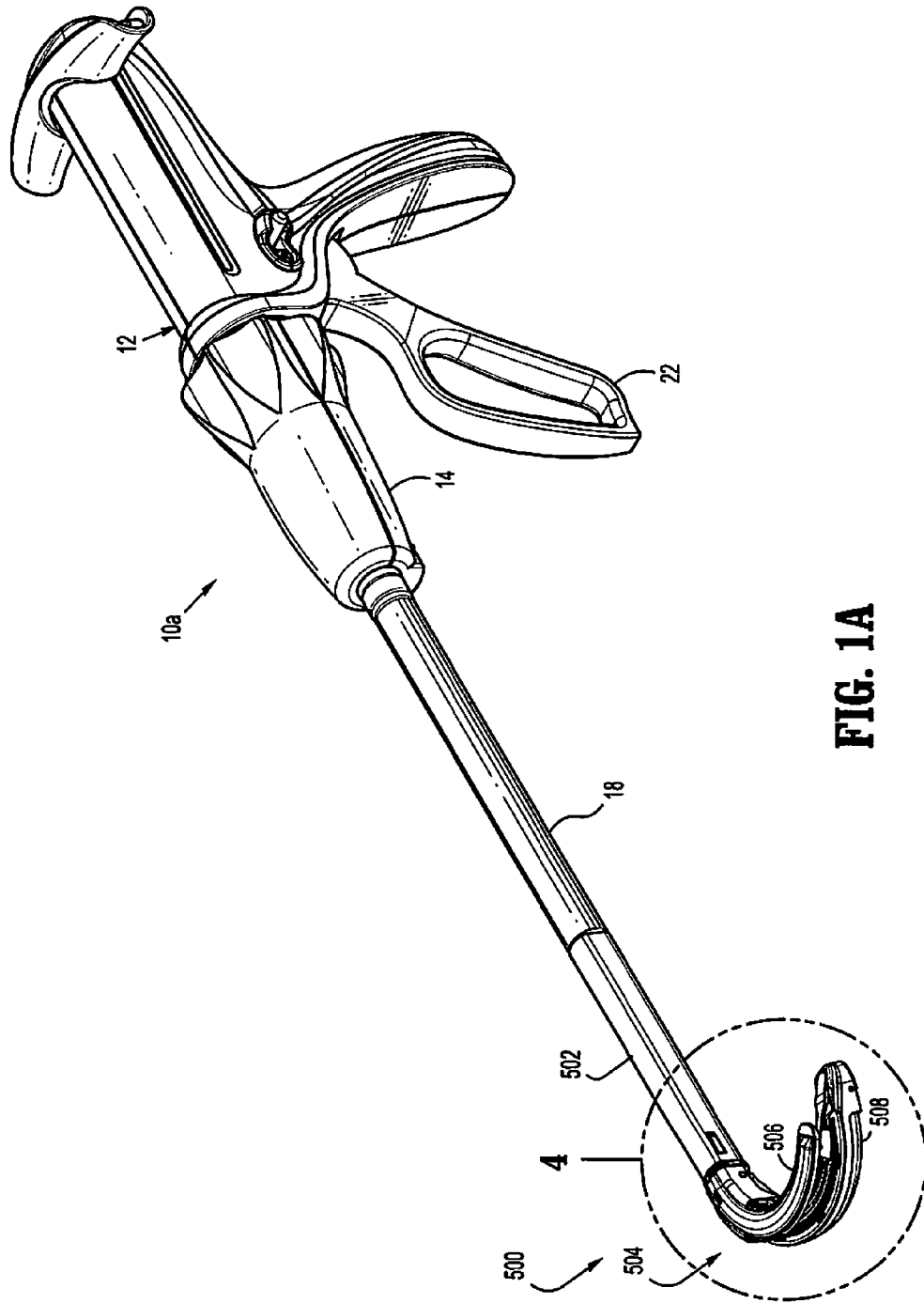

FIG. 1A

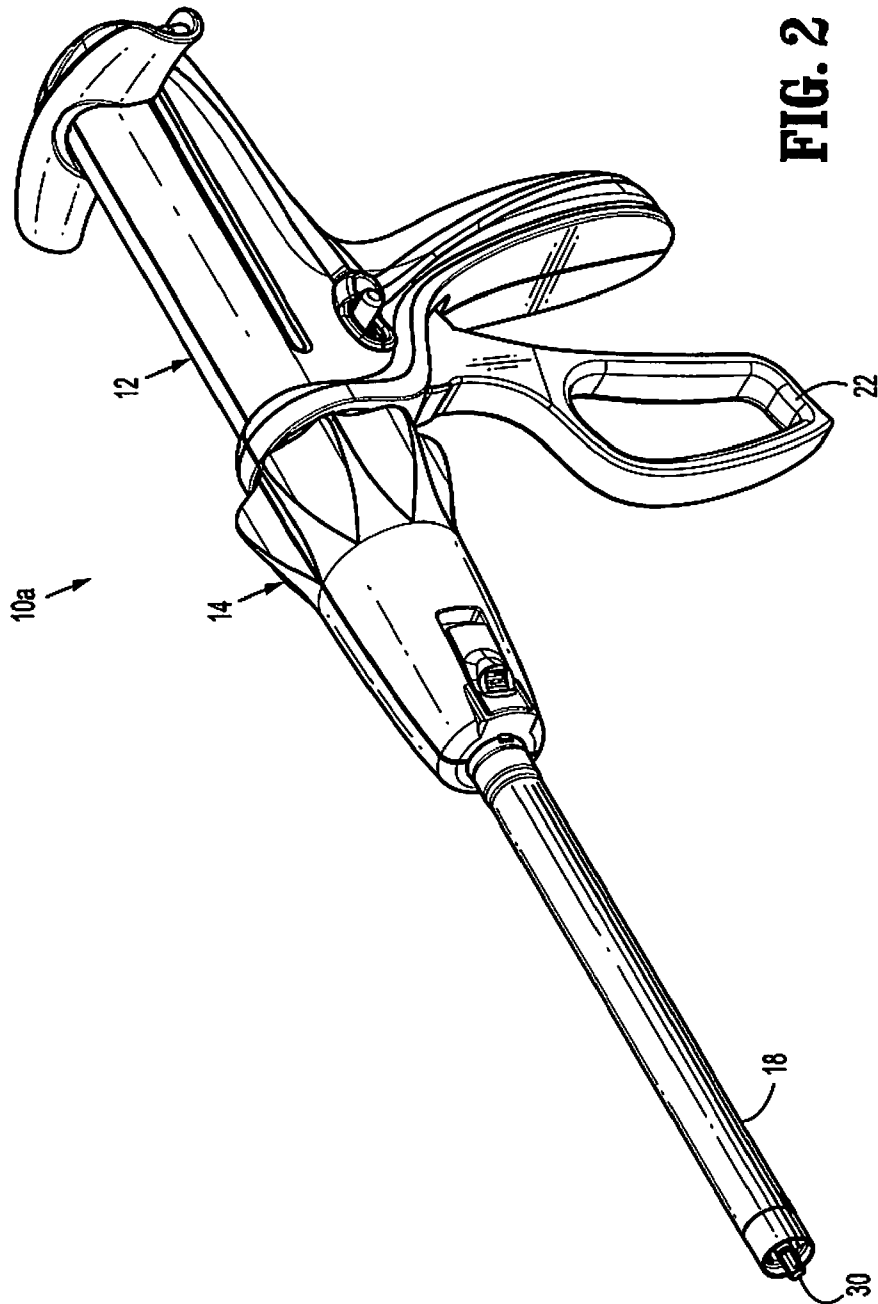

FIG. 2

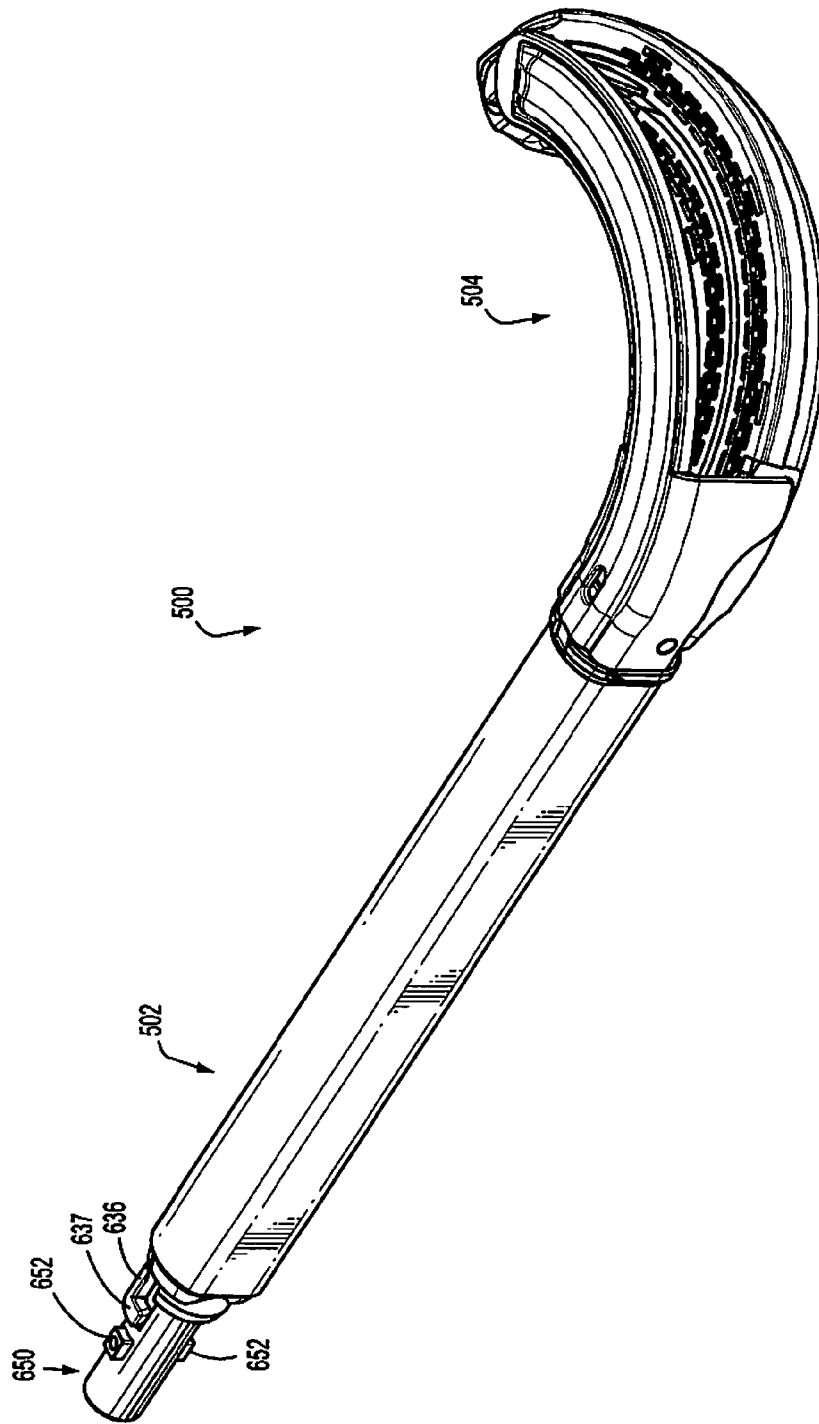

FIG. 3

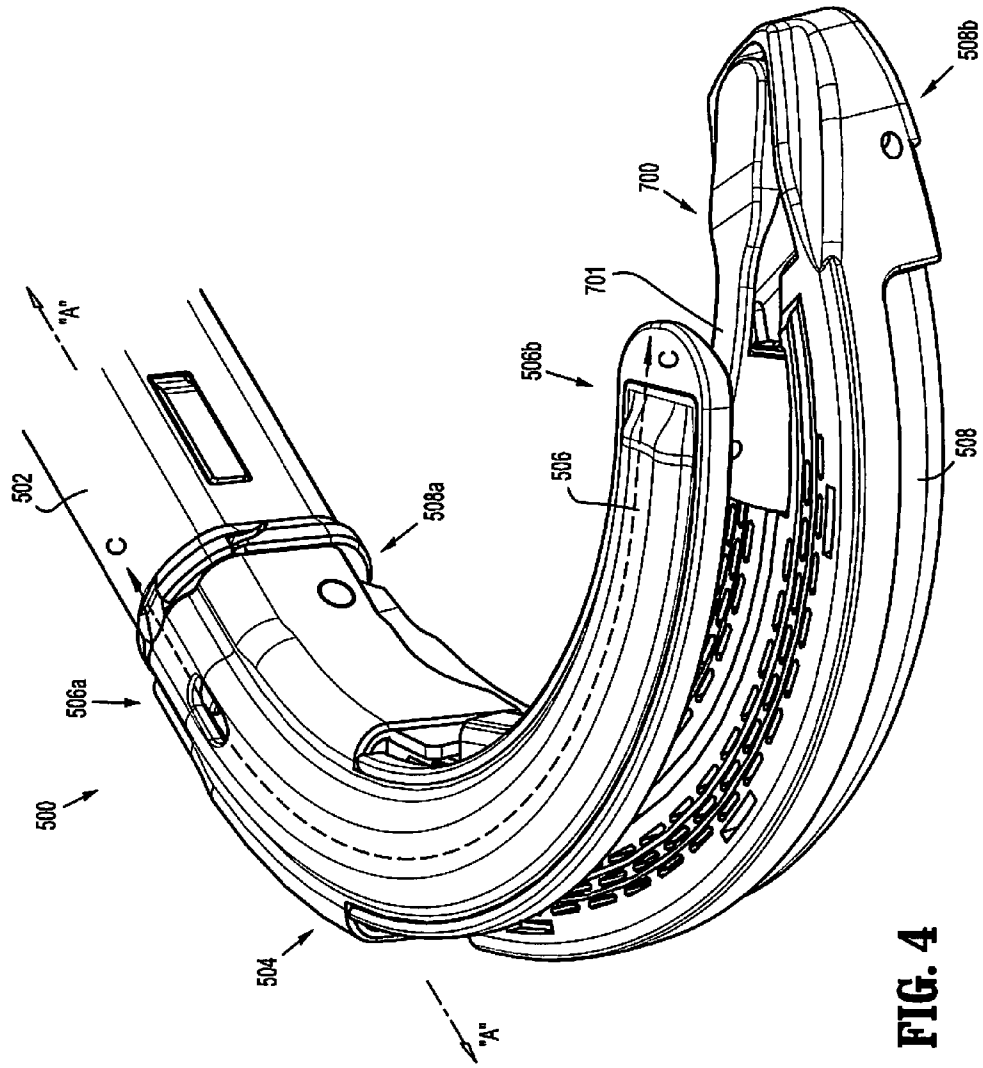

FIG. 4

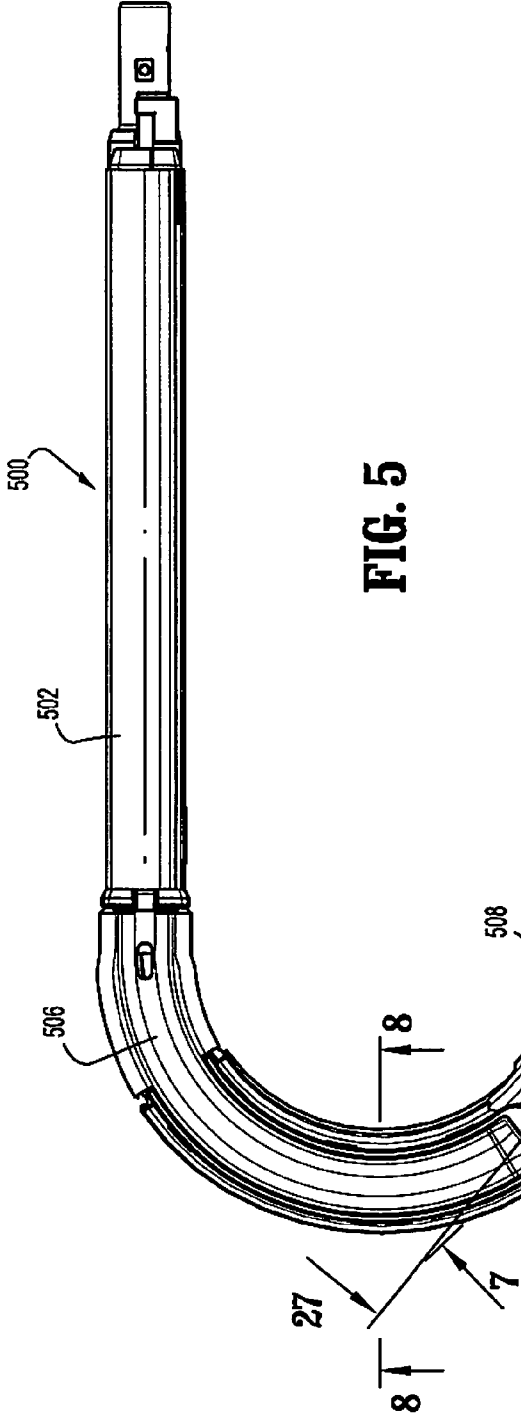

FIG. 5

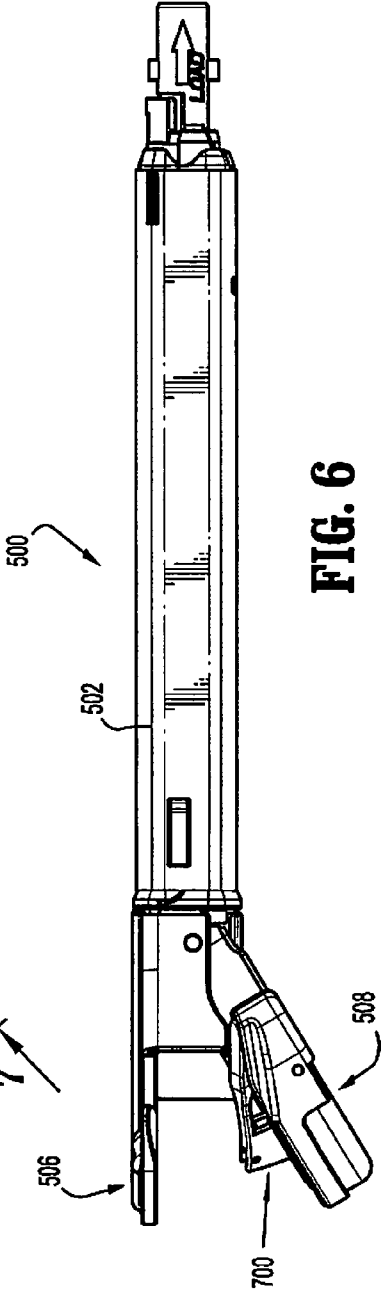

FIG. 6

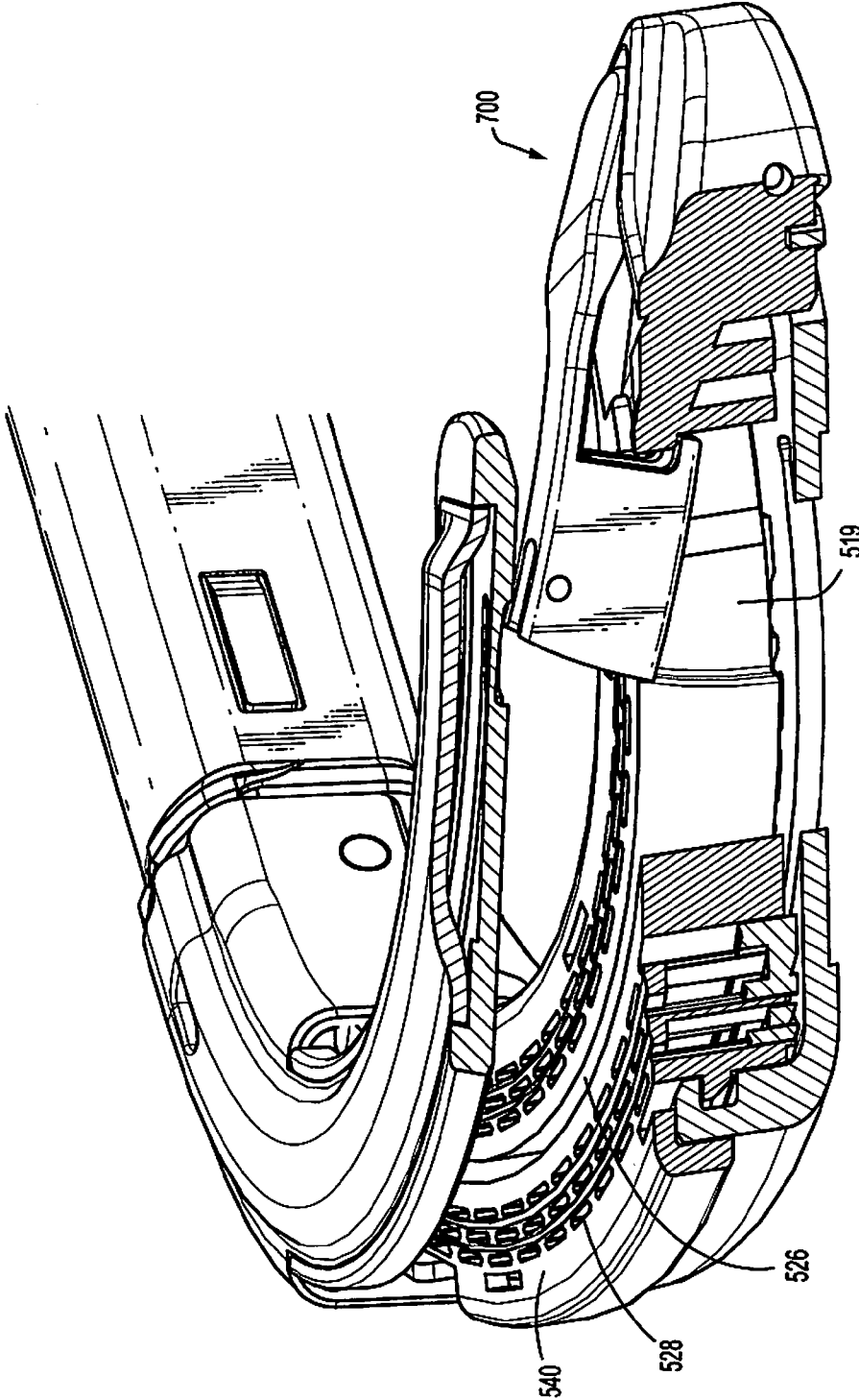

FIG. 7

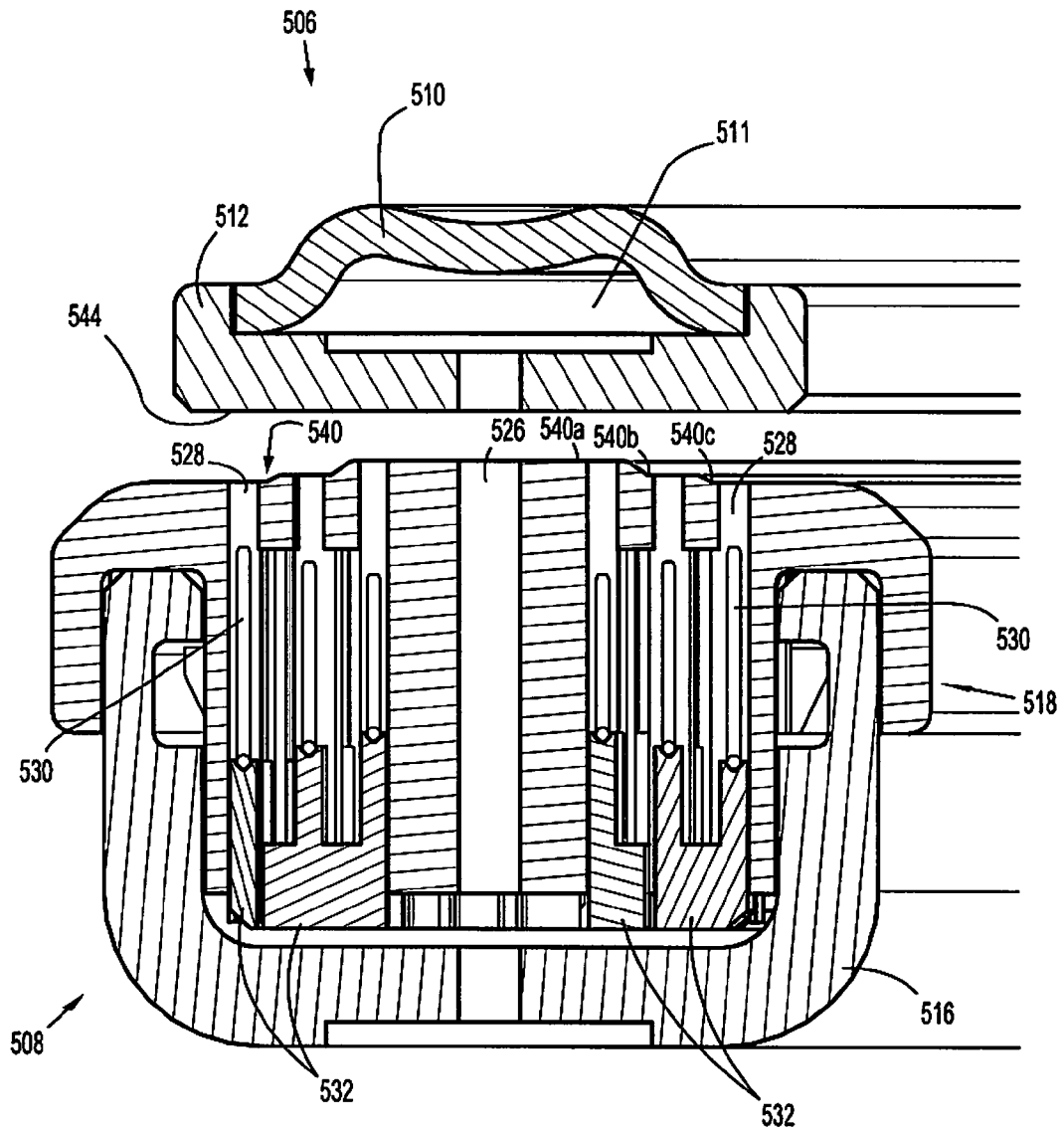

FIG. 8

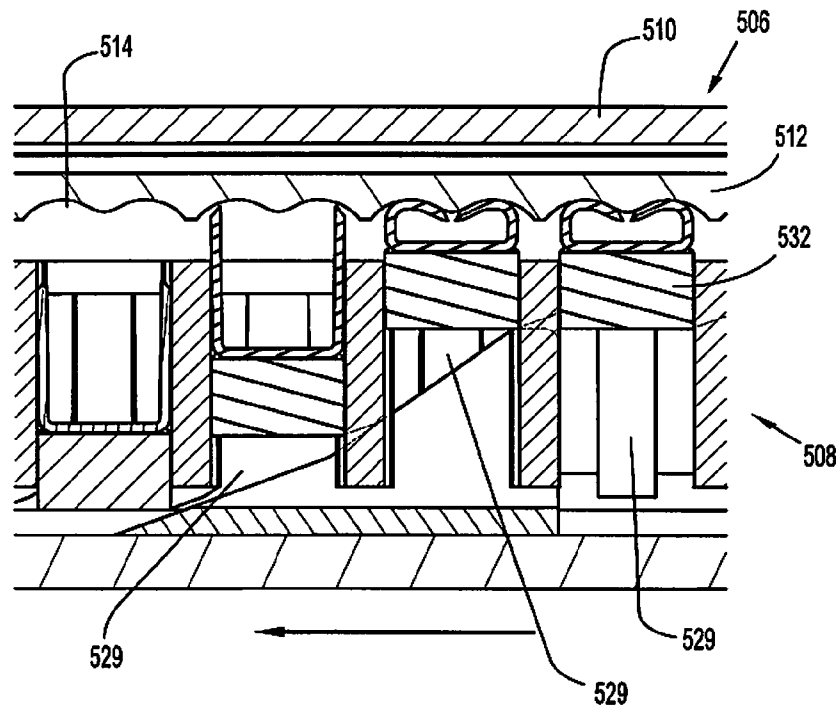

FIG. 9

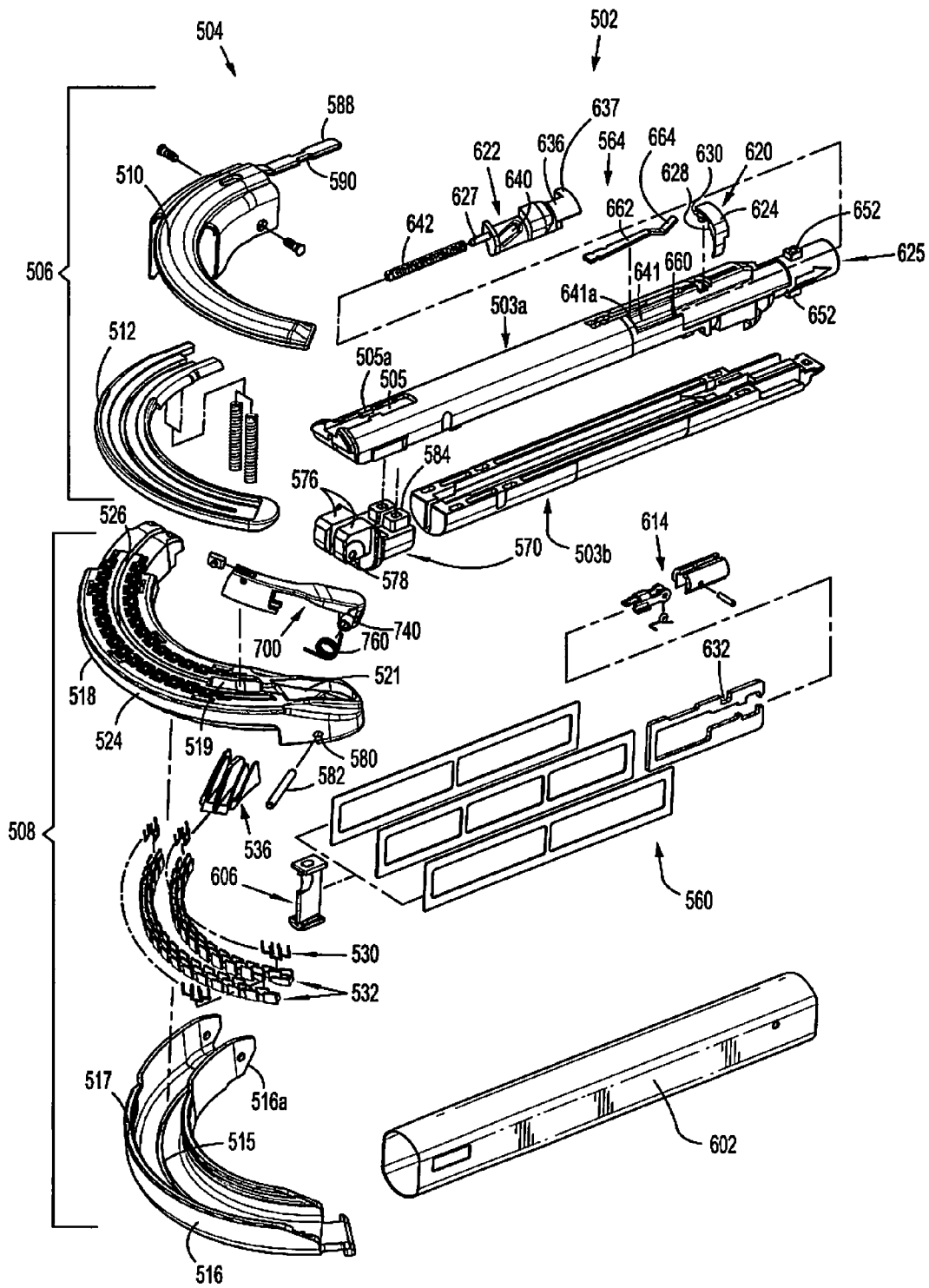

FIG. 10

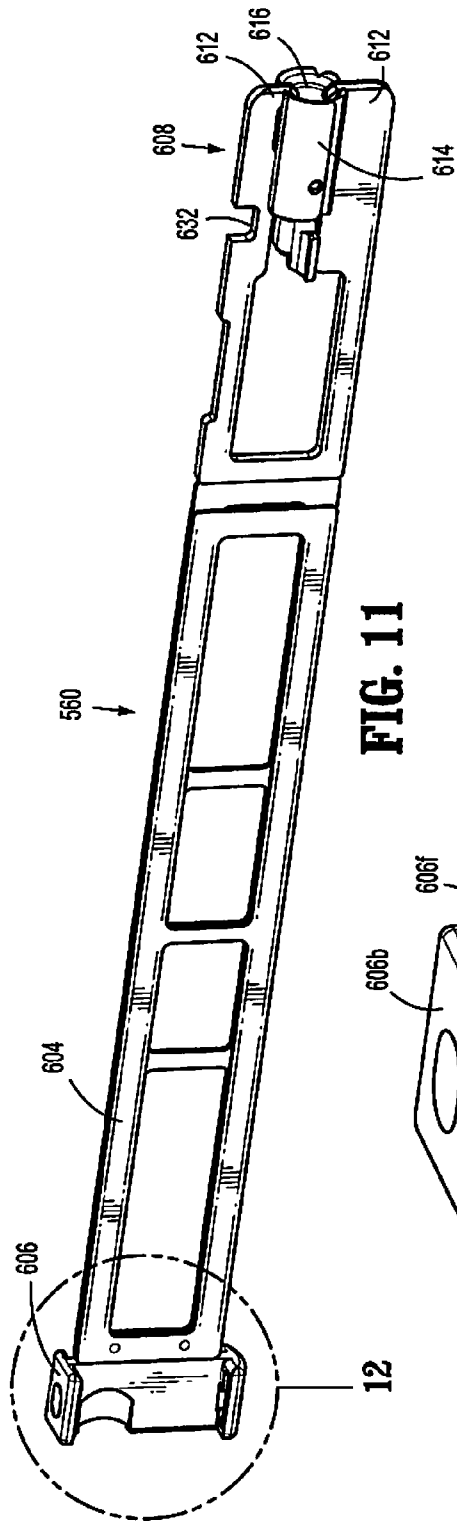

FIG. 11

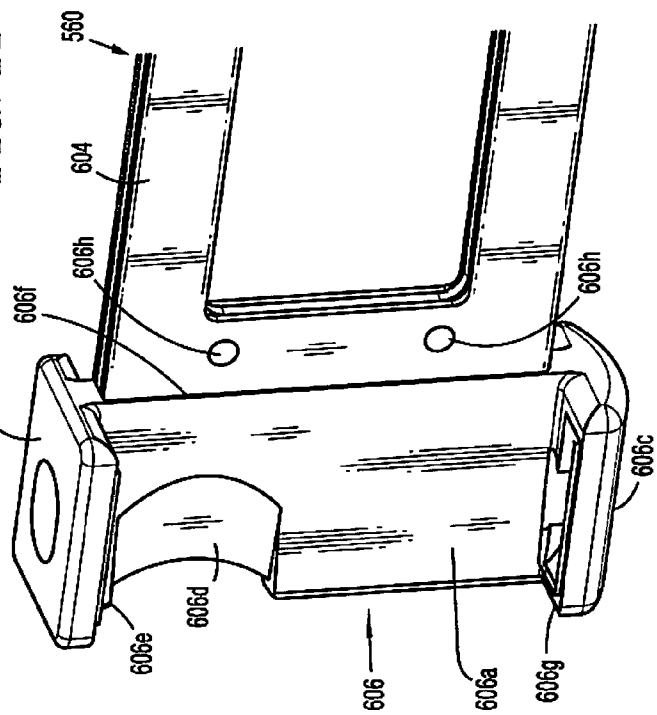

FIG. 12

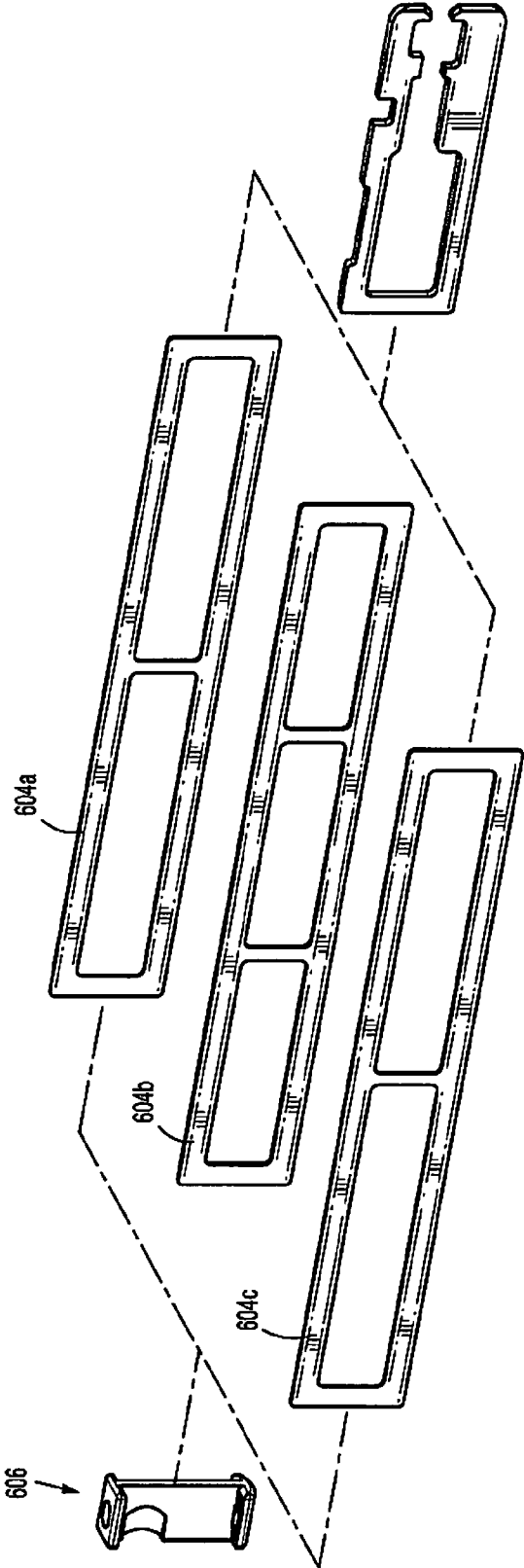

FIG. 13

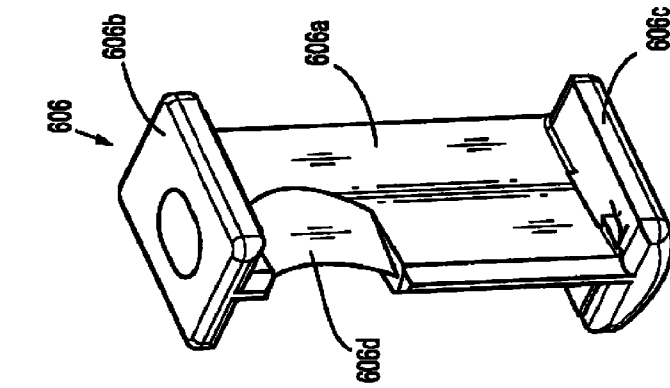

FIG. 14

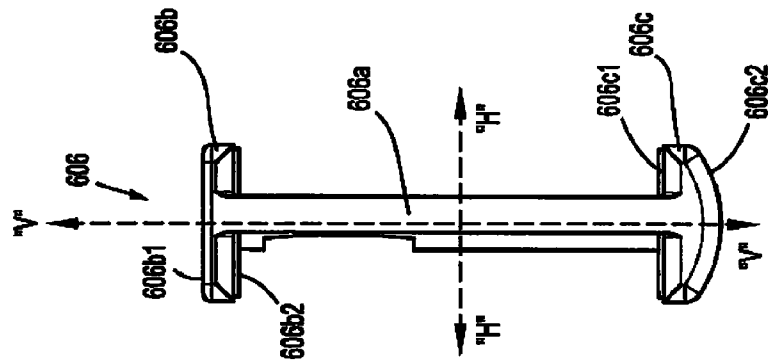

FIG. 17

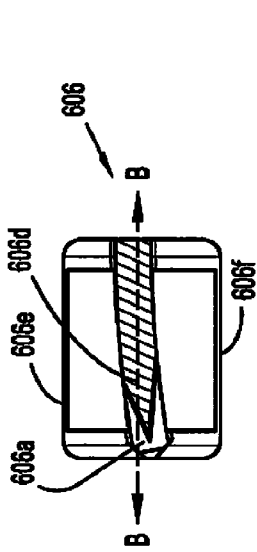

FIG. 16

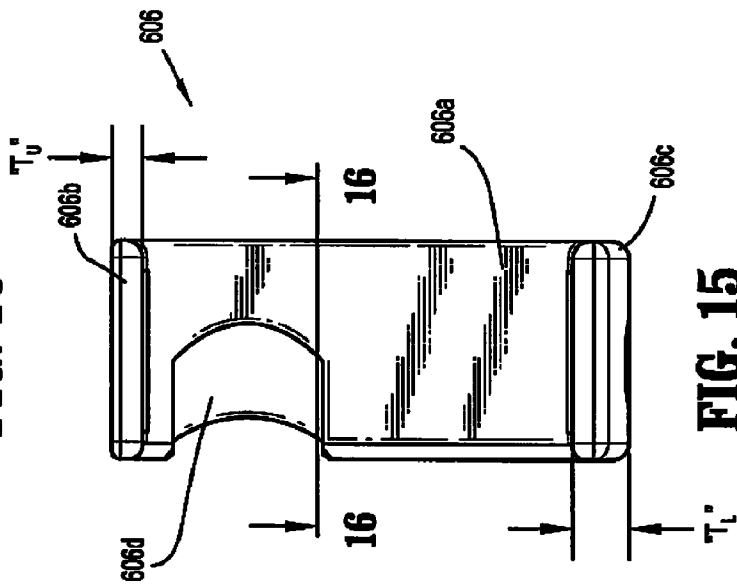

FIG. 15

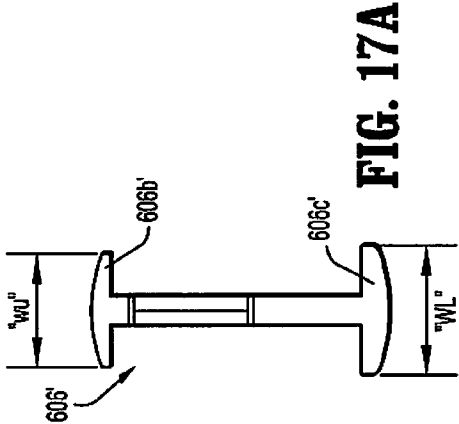

FIG. 17A

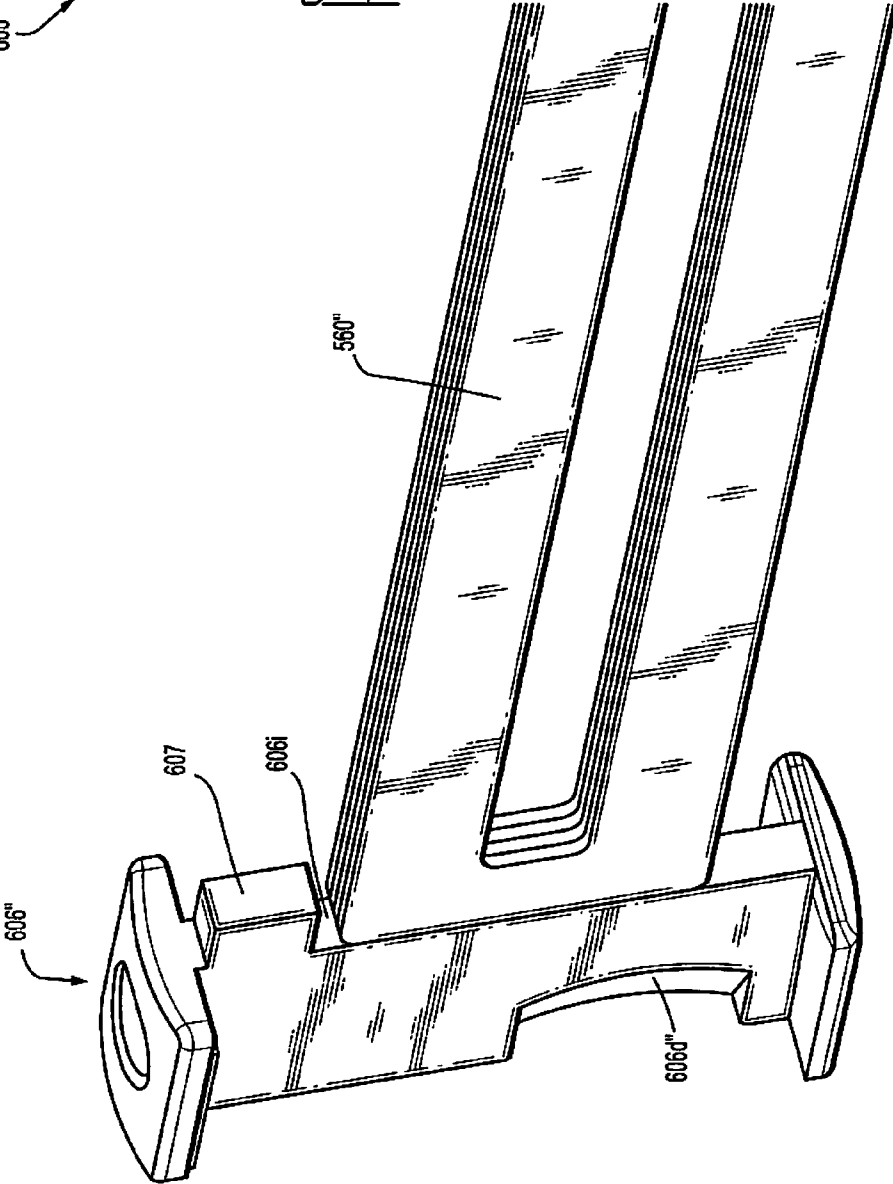

FIG. 17B

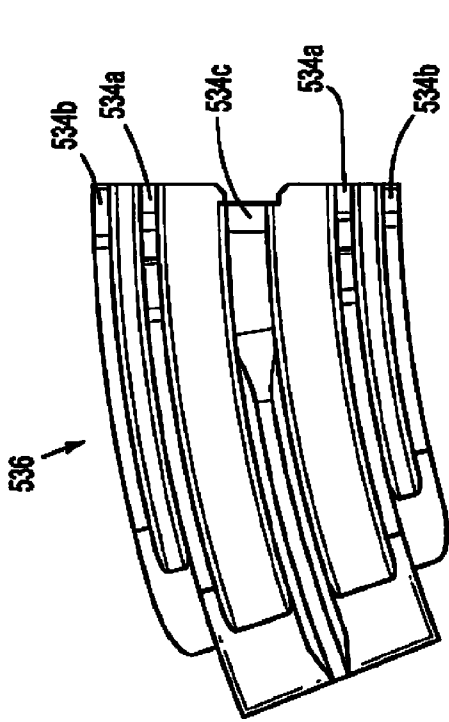

FIG. 19

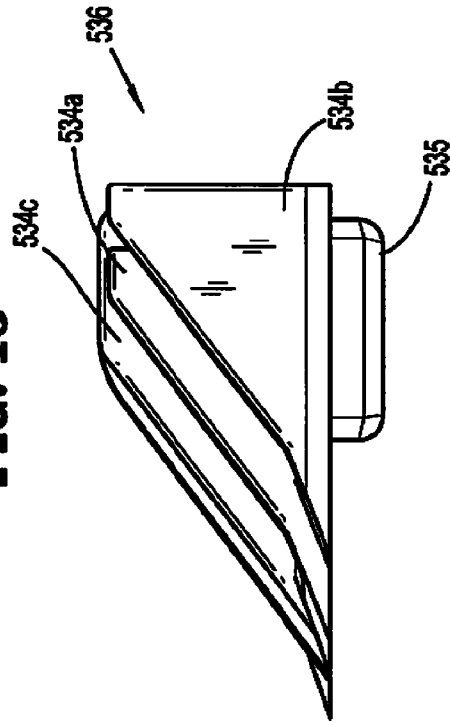

FIG. 20

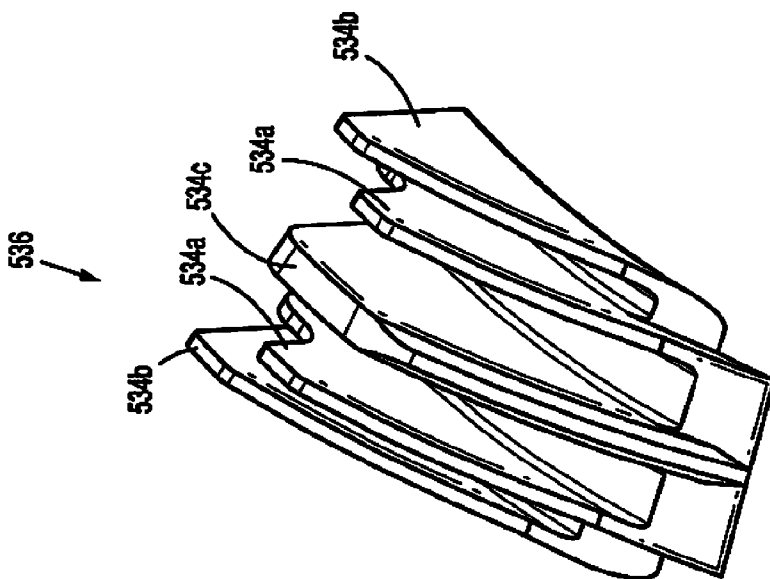

FIG. 18

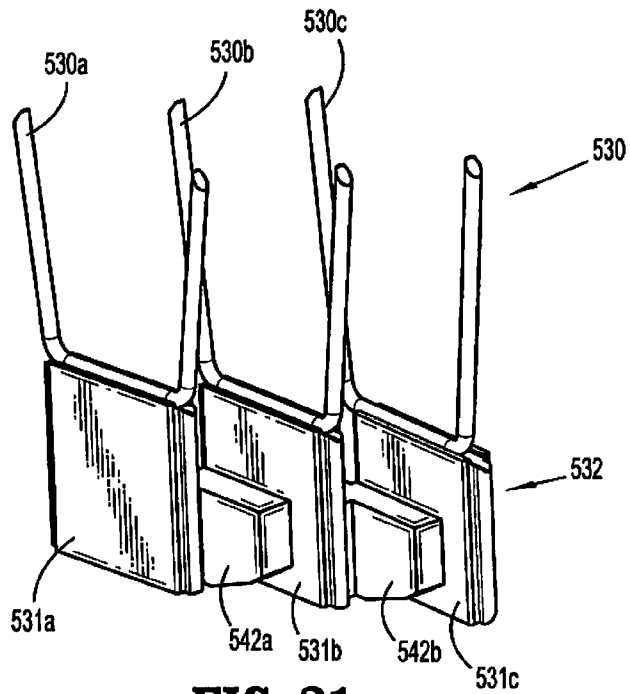

FIG. 21

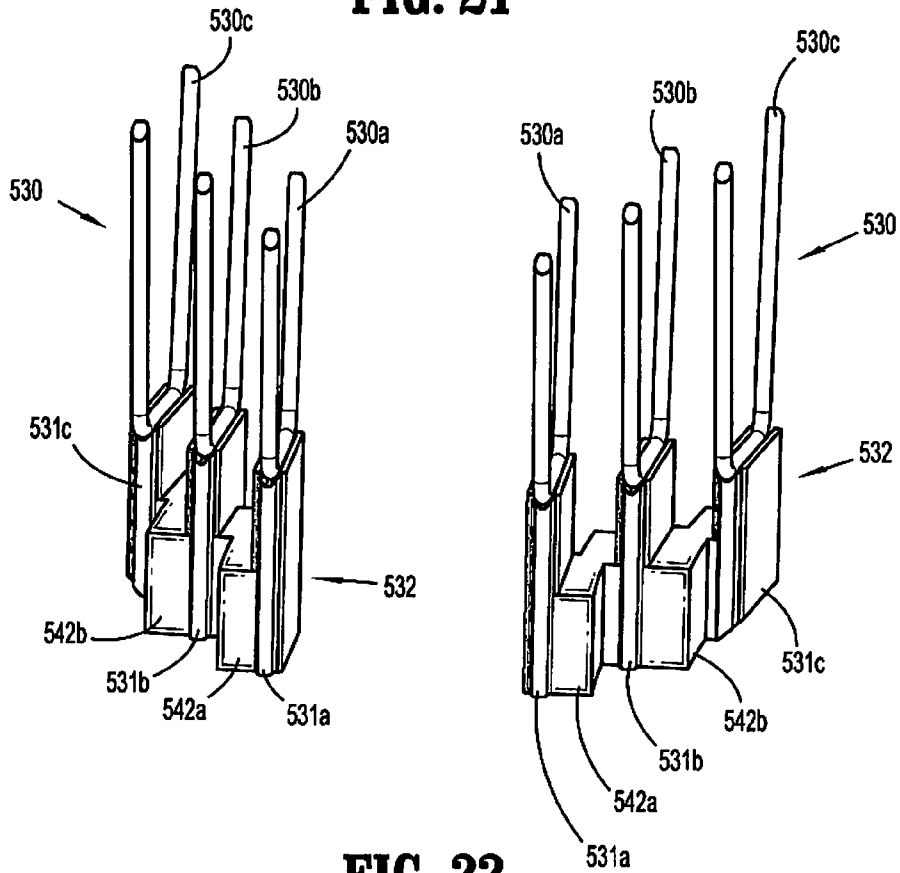

FIG. 22

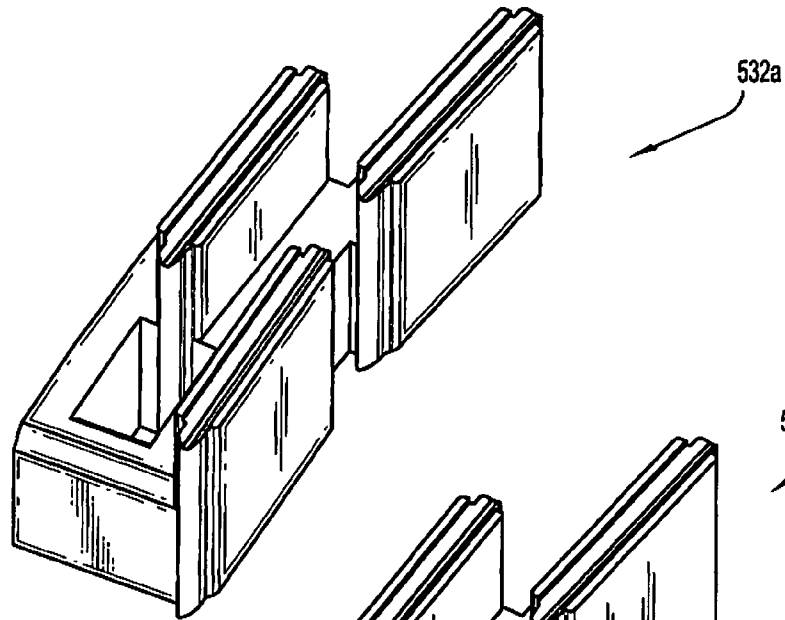

FIG. 23

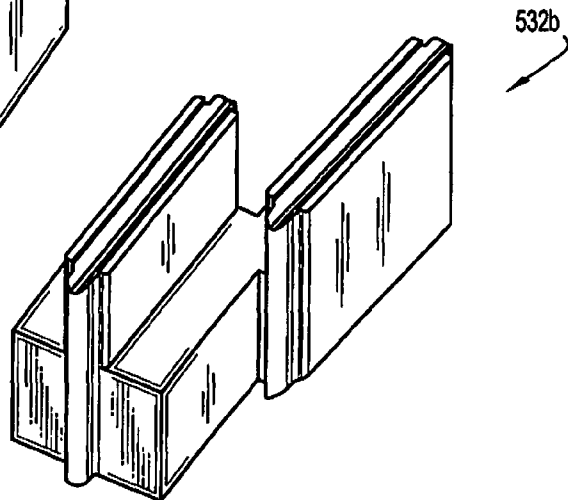

FIG. 24

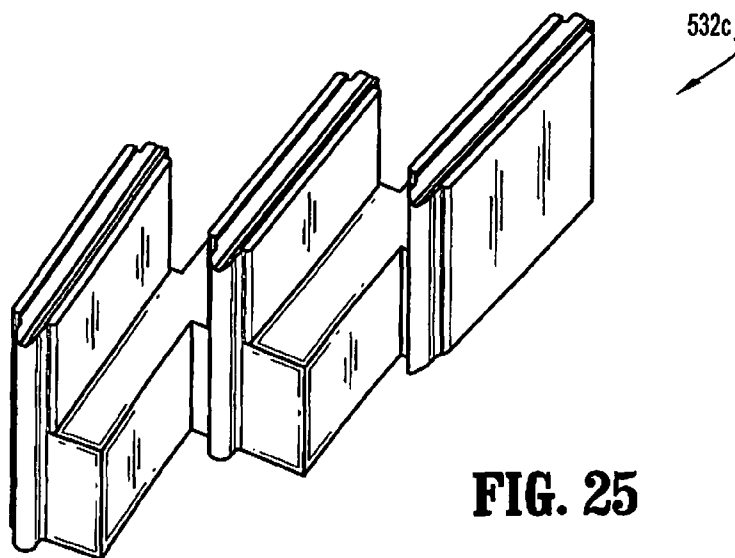

FIG. 25

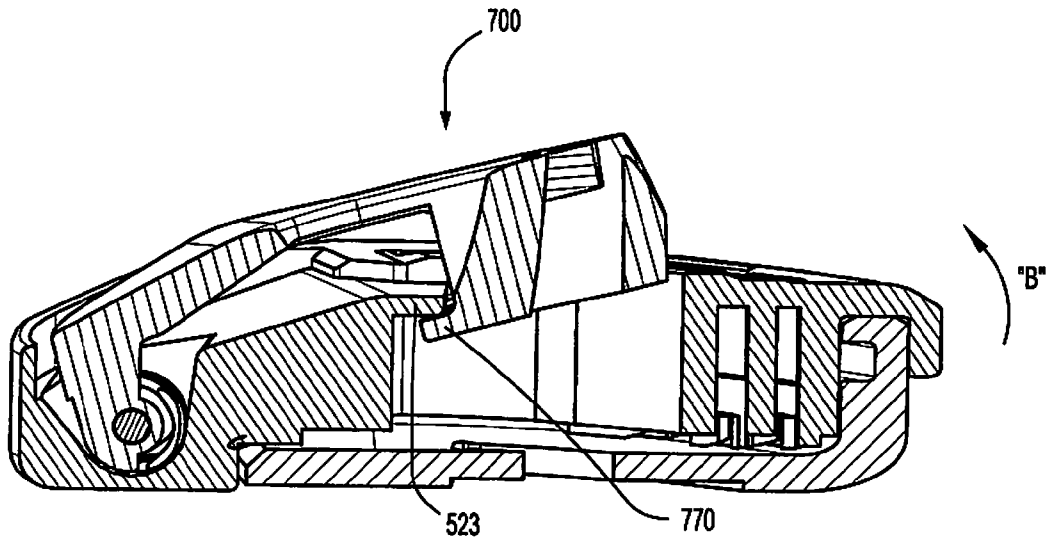

FIG. 27

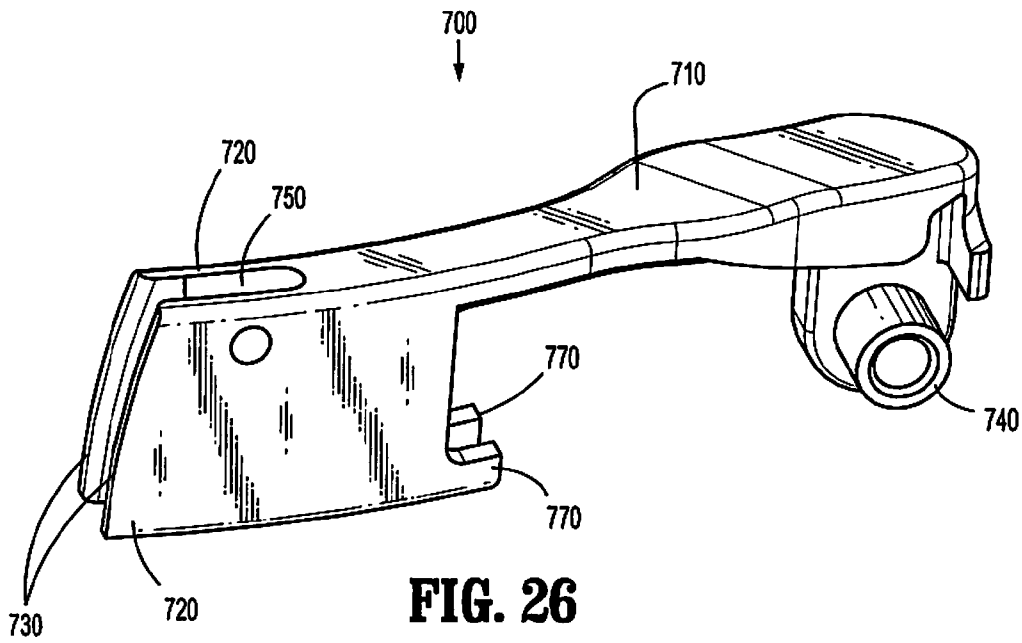

FIG. 26

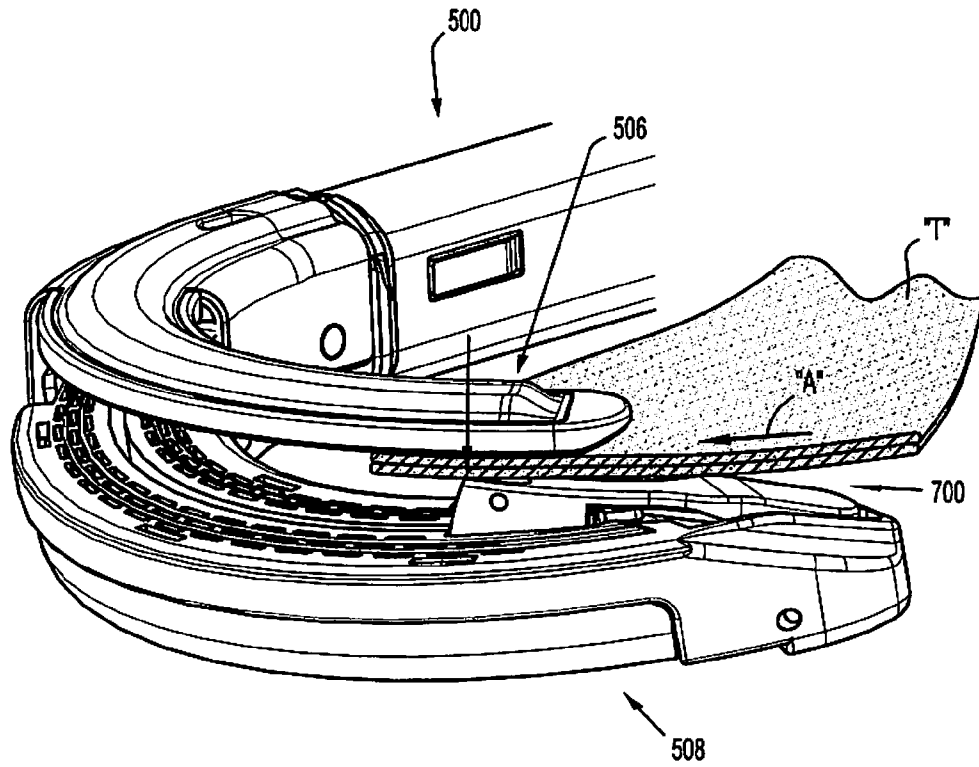

FIG. 28

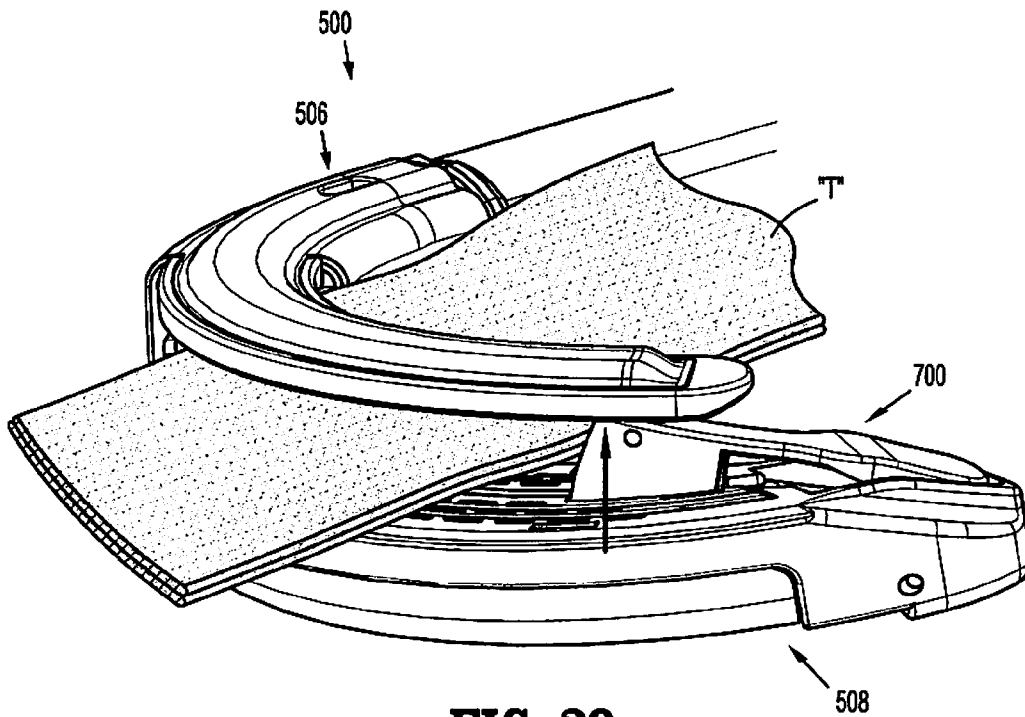

FIG. 29

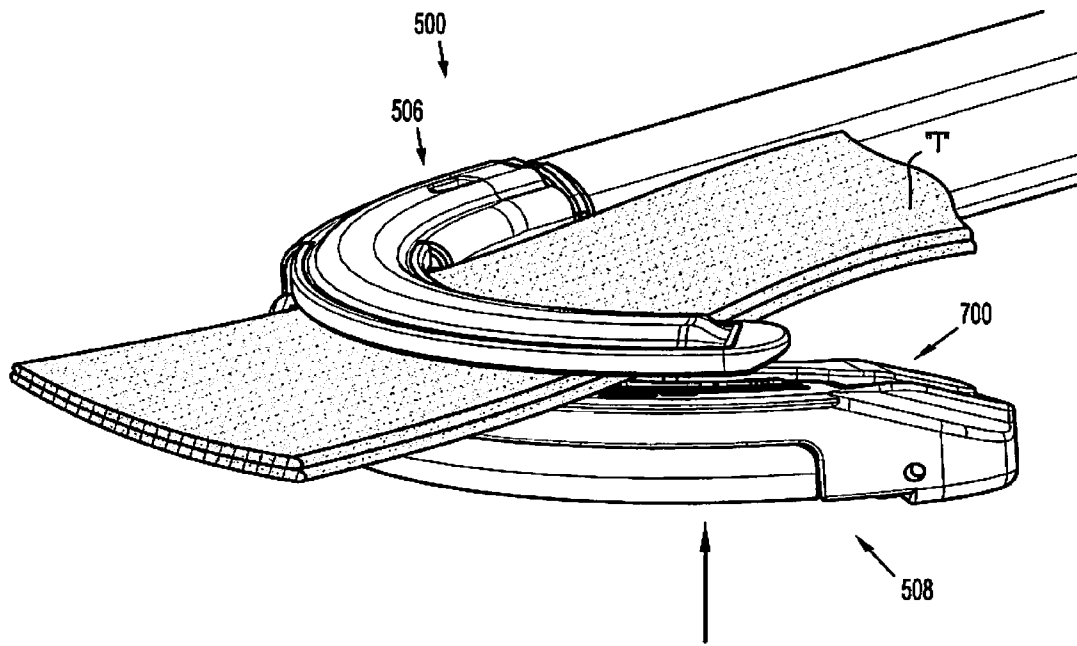

FIG. 30

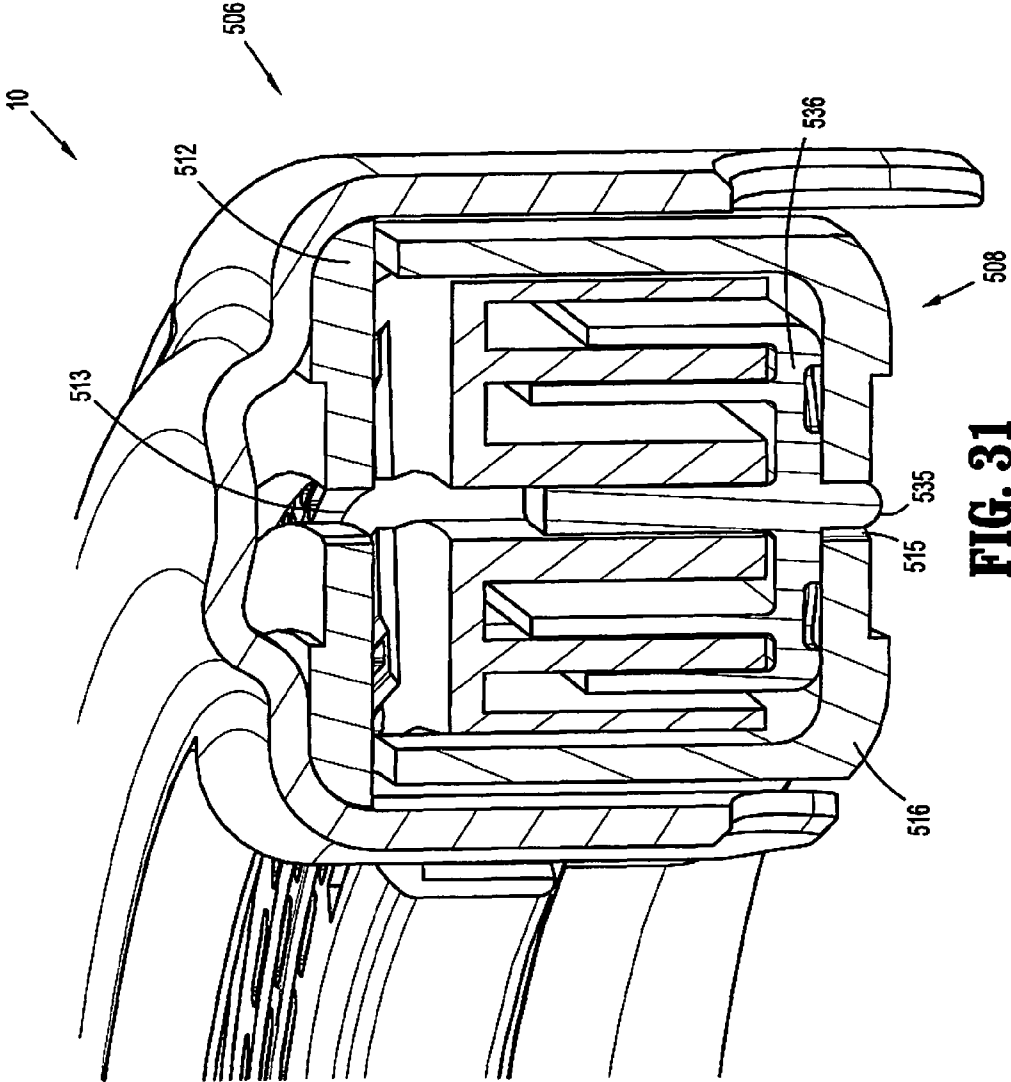

FIG. 31

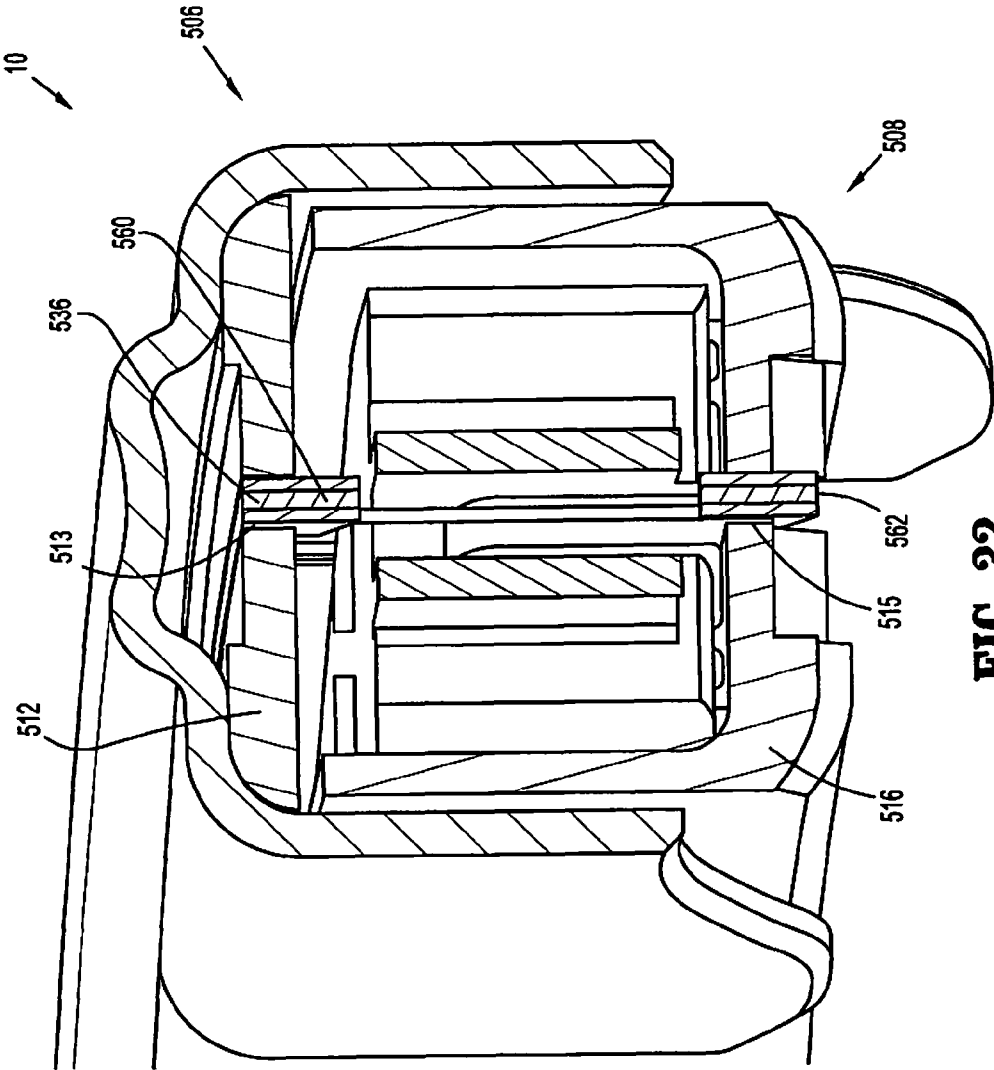

FIG. 32

SURGICAL INSTRUMENT AND LOADING UNIT FOR USE THEREWITH

CROSS-REFERENCE TO RELATED APPLICATION

The present application claims the benefits of, priority to, and is a Continuation-In-Part of U.S. patent application Ser. No. 12/553,174, now U.S. Pat. No. 7,988,028, which was filed on Sep. 3, 2009, which is a Continuation-In-Part of U.S. patent application Ser. No. 12/235,751, now U.S. Pat. No. 7,896,214, which was filed on Sep. 23, 2008, the entire contents of each of these applications are hereby incorporated by reference.

BACKGROUND

1. Technical Field

The present disclosure relates generally to instruments for surgically joining tissue and, more specifically, to surgical instruments having curved jaw members and loading units for use therewith.

2. Background of Related Art

Various types of surgical instruments used to surgically join tissue are known in the art, and are commonly used, for example, for closure of tissue or organs in transection, resection, anastomoses, for occlusion of organs in thoracic and abdominal procedures, and for electrosurgically fusing or sealing tissue.

One example of such a surgical instrument is a surgical stapling instrument, which may include an anvil assembly, a cartridge assembly for supporting an array of surgical staples, an approximation mechanism for approximating the cartridge and anvil assemblies, and a firing mechanism for ejecting the surgical staples from the cartridge assembly.

Using a surgical stapling instrument, it is common for a surgeon to approximate the anvil and cartridge members. Next, the surgeon can fire the instrument to emplace staples in tissue. Additionally, the surgeon may use the same instrument or a separate instrument to cut the tissue adjacent or between the row(s) of staples.

SUMMARY

The present disclosure relates to a surgical instrument for surgically joining tissue. The surgical instrument includes a handle assembly having a movable handle; an endoscopic portion extending distally from the handle and defining a longitudinal axis; a pair of jaw members; and a drive assembly. The jaw members are disposed adjacent a distal end of the endoscopic portion and extend generally distally therefrom. Each jaw member is longitudinally curved with respect to the longitudinal axis. At least one jaw member is movable with respect to the other between open and approximated positions. A first jaw member includes a channel having a longitudinally-extending slot being defined in the channel. The drive assembly has a drive bar and is advanced distally through at least a portion of the length of the jaw members in response to at least a partial actuation of the movable handle. A lower portion of the drive bar is configured and dimensioned to travel at least partially within the longitudinally-extending slot of the channel.

The surgical instrument may include a longitudinally-extending slot in the second jaw member; an upper portion of the drive assembly is configured and dimensioned to travel at least partially within the longitudinally-extending slot of the second jaw member.

In certain embodiments, a dynamic clamping member is disposed in mechanical cooperation with a distal portion of the drive bar, wherein the dynamic clamping member is advanced distally through at least a portion of the length of the jaw members in response to at least a partial actuation of the movable handle.

An actuation sled may be slidably disposed with respect to the first jaw member, the actuation sled including a projection depending from a lower surface thereof, the projection configured to travel at least partially within the longitudinally-extending slot of the channel.

At least a portion of the actuation sled may be longitudinally curved. The projection of the actuation sled may also be longitudinally curved.

The present disclosure also relates to a loading unit configured for releasable engagement with a surgical instrument. The loading unit includes a body portion, a pair of jaw members, and drive assembly. The body portion defines a longitudinal axis. A proximal portion of the body portion is configured for releasable engagement with an endoscopic portion of the surgical instrument. The jaw members extend generally distally from the body portion, and each of the jaw members is longitudinally curved with respect to the longitudinal axis. At least one of the jaw members is movable with respect to the other between an open position and an approximated position for engaging body tissue therebetween. The pair of jaw members includes a first jaw member and a second jaw member. The first jaw member includes a channel with a longitudinally-extending slot being defined in the channel. The drive assembly has a drive bar and is disposed at least partially within the body portion and is longitudinally translatable with respect to the body portion. A lower portion of the drive bar is configured and dimensioned to travel at least partially within the longitudinally-extending slot of the channel.

The surgical instrument may include a longitudinally-extending slot in the second jaw member; an upper portion of the drive assembly is configured and dimensioned to travel at least partially within the longitudinally-extending slot of the second jaw member.

In certain embodiments, a dynamic clamping member is disposed in mechanical cooperation with a distal portion of the drive bar, wherein the dynamic clamping member is advanced distally through at least a portion of the length of the jaw members in response to at least a partial actuation of the movable handle.

An actuation sled may be slidably disposed with respect to the first jaw member, the actuation sled including a projection depending from a lower surface thereof, the projection configured to travel at least partially within the longitudinally-extending slot of the channel.

At least a portion of the actuation sled may be longitudinally curved. The projection of the actuation sled may also be longitudinally curved.

BRIEF DESCRIPTION OF FIGURES

Various embodiments of the presently disclosed surgical instrument are disclosed herein with reference to the drawings, wherein:

FIG. 1 is a perspective view of a surgical stapling instrument including a loading unit in accordance with the present disclosure;

FIG. 1A is a perspective view of another type of surgical stapling instrument including the loading unit of FIG. 1 in accordance with an embodiment of the present disclosure;

FIG. 2 is a perspective view of a handle assembly of the surgical stapling instrument of FIG. 1A;

FIG. 3 is a perspective view of the loading unit of FIGS. 1 and 1A;

FIG. 4 is an enlarged view of the area of detail of FIGS. 1 and 1A;

FIG. 5 is a top view of the loading unit of FIGS. 3 and 4;

FIG. 6 is a side view of the loading unit of FIGS. 3-5, illustrated with a cartridge assembly in the open position;

FIG. 7 is a perspective, partial cross-sectional view of the loading unit of FIGS. 3-6;

FIG. 8 is a transverse cross-sectional view of the loading unit of FIGS. 3-7;

FIG. 9 is a longitudinal cross-sectional view of a portion of the loading unit of FIGS. 3-8;

FIG. 10 is a perspective assembly view of the loading unit of FIGS. 3-9;

FIG. 11 is a perspective view of a drive assembly and dynamic clamping member of the loading unit of FIGS. 3-10;

FIG. 12 is an enlarged view of the area of detail of FIG. 11;

FIG. 13 is a perspective assembly view of the drive assembly and dynamic clamping member of FIGS. 11 and 12;

FIGS. 14-17 are various views of the dynamic clamping member according to an embodiment of the present disclosure;

FIG. 17A is a rear view of another embodiment of a dynamic clamping member according to another embodiment of the present disclosure;

FIG. 17B is a perspective view of another embodiment of a dynamic clamping member according to another embodiment of the present disclosure;

FIGS. 18-20 are various views of an actuation sled in accordance with an embodiment of the present disclosure;

FIGS. 21 and 22 are perspective views of staples and staple pushers in accordance with embodiments of the present disclosure;

FIGS. 23-25 are perspective views of various staple pushers in accordance with embodiments of the present disclosure;

FIG. 26 is a perspective view of a tissue stop for use with the loading unit of FIGS. 3-10;

FIG. 27 is a cross-sectional view of the tissue stop of FIG. 26 coupled to the loading unit;

FIGS. 28-30 are perspective views of the loading unit of FIGS. 3-10 interacting with a layer of tissue at various stages of operation of the loading unit;

FIG. 31 is a transverse cross-sectional view of the surgical instrument taken across a portion of the actuation sled in accordance with an embodiment of the present disclosure; and

FIG. 32 is a transverse cross-sectional view of the surgical instrument of FIG. 30 taken across a portion of the drive assembly.

DETAILED DESCRIPTION

Embodiments of the presently disclosed surgical instrument, and loading unit for use therewith, are described in detail with reference to the drawings, wherein like reference numerals designate corresponding elements in each of the several views. As is common in the art, the term “proximal” refers to that part or component closer to the user or operator, e.g., surgeon or physician, while the term “distal” refers to that part or component farther away from the user.

A first type of surgical stapling instrument of the present disclosure is indicated as reference numeral 10 in FIG. 1. Another type of surgical stapling instrument of the present disclosure is indicated as reference numeral 10a in FIGS. 1A and 2. Additionally, while not explicitly shown, the present

application also relates to surgical stapling instruments having parallel jaw members and to electro-surgical instruments used to join tissue. Collectively, all surgical instruments (including surgical stapling instruments 10 and 10a) are referred to herein as “surgical instrument” and referred to as reference numeral 10. Similarly, several features that are common to both surgical stapling instruments are collectively referred to as the same reference number (e.g., handle assembly 12, rotation knob 14, and endoscopic portion 18). Further details of an endoscopic surgical stapling instrument are described in detail in commonly-owned U.S. Pat. No. 6,953,139 to Milliman et al., the entire contents of which are hereby incorporated by reference herein.

A loading unit (or “DLU”) 500 for use with surgical instrument 10 is shown in FIGS. 3-10 and 28-30. DLU 500 is attachable to an elongated or endoscopic portion 18 of surgical instrument 10, e.g., to allow surgical instrument 10 to have greater versatility. DLU 500 may be configured for a single use, and/or may be configured to be used more than once. Examples of loading units for use with a surgical stapling instrument are disclosed in commonly-owned U.S. Pat. No. 5,752,644 to Bolanos et al., the entire contents of which are hereby incorporated by reference herein. The loading unit shown includes a proximal body portion that is attachable to an elongated portion of a surgical instrument having a handle assembly. However, the tool assembly can be incorporated in a surgical instrument in which a staple cartridge is removable and replaceable and does not include a detachable portion of the elongated portion of the instrument.

DLU 500 includes a proximal body portion 502 and a tool assembly 504. Proximal body portion 502 defines a longitudinal axis “A-A,” and is releasably attachable to a distal end of elongated body portion 18 of surgical instrument 10. Tool assembly 504 includes a pair of jaw members including an anvil assembly 506 and a cartridge assembly 508. One jaw member is pivotal in relation to the other. In the illustrated embodiments, cartridge assembly 508 is pivotal in relation to anvil assembly 506 and is movable between an open or unclamped position (e.g., FIGS. 4 and 6) and a closed or approximated position (e.g., FIG. 8). Cartridge assembly 508 is urged in the open position via a biasing member, e.g., a pair of compression springs 533 disposed between anvil cover 510 and cartridge 518 (see FIG. 10).

With reference to FIGS. 1 and 10, for example, tool assembly 504 includes anvil assembly 506 and cartridge assembly 508. As shown, each of anvil assembly 506 and cartridge assembly 508 is longitudinally curved. That is, anvil assembly 506 and cartridge assembly 508 are curved with respect to the longitudinal axis “A-A” defined by proximal body portion 502. As used herein with respect to curved parts of the surgical instrument 10 of the present disclosure, the term “distal,” which typically refers to that part or component of the instrument that is farther away from the user, refers to the portion of the curved part that is farthest along an axis that follows the curve of the curved part. That is, while an intermediate portion of a curved part may be farther from the user during use, the portion of the curved part that is farthest along its axis is considered “distal.”

In disclosed embodiments, the radius of curvature of both anvil assembly 506 and cartridge assembly 508 is between about 1.00 inches and about 2.00 inches, and in particular, may be approximately 1.40 inches. The curved jaw members, as compared to straight jaw members, may help facilitate access to lower pelvis regions, e.g., during lower anterior resection (“LAR”). Additionally, the inclusion of curved jaw members may allow increased visualization to a surgical site

and may also allow more room for a surgeon to manipulate target tissue or the jaw members themselves with his or her hand.

With reference to FIG. 10, anvil assembly 506 includes a longitudinally curved anvil cover 510 and a longitudinally curved anvil plate 512, which includes a plurality of staple forming depressions 514 (FIG. 9). In disclosed embodiments, the radius of curvature of both anvil cover 510 and anvil plate 512 is between about 1.00 inches and about 2.00 inches, and in particular, may be approximately 1.40 inches. Anvil plate 512 is secured to an underside of anvil cover to define a channel 511 (FIG. 8) between plate 512 and cover 510. When tool assembly 504 is in the approximated position (FIG. 8), staple forming depressions 514 are positioned in juxtaposed alignment with cartridge assembly 508.

Cartridge assembly 508 includes a longitudinally curved channel or carrier 516 which receives and supports a longitudinally curved cartridge 518. The cartridge 518 can be attached to the channel or carrier by adhesives, a snap-fit connection, or other connection. In disclosed embodiments, the radius of curvature of both carrier 516 and cartridge 518 is between about 1.00 inches and about 2.00 inches, and in particular, may be approximately 1.40 inches. Cartridge 518 includes a pair of support struts 524 which rest on sidewalls 517 of carrier 516 to stabilize cartridge 518 on carrier 516. Support struts 524 also set the height or location of cartridge 518 with respect to anvil plate 512. An external surface of carrier 516 includes an angled cam surface 516a.

Cartridge 518 defines a plurality of laterally spaced staple retention slots 528, which are configured as holes in tissue contacting surface 540 (see FIG. 7). Each slot 528 is configured to receive a staple 530 therein. Cartridge 518 also defines a plurality of cam wedge slots 529 (see FIG. 9) which accommodate staple pushers 532 and which are open on the bottom (i.e., away from tissue contacting surface 540) to allow a longitudinally curved actuation sled 536 to pass therethrough.

Staple cartridge 518 includes a central longitudinally curved slot 526, and three longitudinally curved rows of staple retention slots 528 positioned on each side of curved longitudinal slot 526 (see FIGS. 7 and 8). In disclosed embodiments, the radius of curvature of both slot 526 and pusher 532 is between about 1.00 inches and about 2.00 inches, and in particular, may be approximately 1.40 inches. More specifically, actuation sled 536 passes through cam wedge slots 529 and forces staple pushers 532 towards respective staples 530. The staples are then forced out of their respective staple retention slots 528.

With reference to FIGS. 21 and 22, pushers 532 of the illustrated embodiments each engage two or more staples 530. Pushers 532 include a single distally-located triple pusher 532a (FIG. 23), a single proximally-located double pusher 532b (FIG. 24), and a series of triple pushers 532c (one triple pusher 532c is shown in FIG. 25) which extend between double pusher 532b and triple pusher 532a on each side of slot 526. In disclosed embodiments, portions of pushers 532a, 532b, 532c include various radii of curvature included therewith and are in the range of approximately 1.00 inches to about 1.50 inches. It is also disclosed that at least one pusher 532a, 532b, 532c includes no curved surfaces—only linearly angled surfaces.

During operation of stapler 10, actuation of its movable handle 22 through successive strokes causes distal advancement of its drive bar 30 (a distal portion of which is illustrated in FIG. 2), such that drive bar 30 pushes a drive assembly 560 through cartridge 518. (Further details of how actuation of movable handle 22 causes distal advancement of drive bar 30 are explained in U.S. Pat. No. 6,953,139 to Milliman et al.,

which has been incorporated by reference herein.) The movement of drive assembly 560, and in particular, a dynamic clamping member 606 affixed thereto, moves a longitudinally curved actuation sled 536 (see FIGS. 18-20) through cartridge 518. As sled 536 moves through cartridge 518, longitudinally curved cam wedges 534 of actuation sled 536 sequentially engage pushers 532 to move pushers 532 vertically within staple retention slots 528 and eject staples 530 into staple forming depressions 514 of anvil plate 512. Subsequent to the ejection of staples 530 from retention slots 528 (and into tissue), a cutting edge 606d of dynamic clamping member 606 severs the stapled tissue as cutting edge 606d travels through curved slot 526 of cartridge 518.

Referring to FIG. 8 and in accordance with embodiments of the present disclosure, cartridge 518 includes a tissue contacting surface 540 including surfaces 540a, 540b, and 540c. Surface 540a is adjacent longitudinal slot 526 and defines a first gap between tissue contacting surface 540 and a bottom surface 544 of anvil plate 512. Surface 540b is located adjacent surface 540a and defines a second gap between tissue contacting surface 540 and bottom surface 544. Surface 540c is located proximal to an outer perimeter of cartridge 518 and defines a third gap between tissue contacting surface 540 and bottom surface 544. The first gap is less than the second gap, which is less than the third gap. When anvil 506 is approximated towards cartridge 508, layers of tissue located between bottom surface 544 and tissue contacting surface 540 are compressed. Since the first gap is the smallest, tissue located between surface 540a and bottom surface 544 is compressed the most. Similarly, the tissue located between surface 540c and bottom surface 544 is compressed the least, with the tissue located between surface 540b and bottom surface 544 being compressed to an intermediate degree. The arrangement of surfaces 540a, 540b, 540c on tissue contacting surface 540 provides a tissue compression gradient extending transverse to a longitudinal axis of the cartridge 518.

Referring to FIGS. 8, 21 and 22 in conjunction with the stepped arrangement of tissue contacting surface 540, the illustrated embodiment of staples 530 include varying leg lengths for cooperating with the varying gaps. Staples 530a have the shortest leg length and are associated with surface 540a. Similarly, staples 530b have an intermediate leg length and are associated with surface 540b, while staples 530c have the longest leg length and are associated with surface 540c. The leg length of staples 530b is between the leg length of staples 530a and 530c. Since the tissue between surface 540a and bottom surface 544 has been compressed the most, the resulting thickness of the tissue is at a minimum, thereby allowing a staple having a shorter leg length (i.e. staple 530a) to be used to join the layers of tissue. The layers of tissue between surface 540b and bottom surface 544 are compressed to an intermediate degree of compression and the resulting thickness of the tissue layers allows a staple having an intermediate leg length (i.e. staple 530b) to be used when joining the layers of tissue. The layers of tissue between surface 540c and bottom surface 544 are compressed the least amount and are thicker than the other layers requiring staples that have the longest leg length (i.e. staples 530c) for joining the layers of tissue.

In particular, the illustrated embodiment of pusher 532 includes plates 531a, 531b, 531c, which cooperate with staples 530a, 530b, 530c, respectively. Plate 531a has a height which is greater than the height of plate 531b. Additionally, the height of plate 531b is greater than the height of plate 531c. Pusher 532 further includes cam members 542 that are longitudinally staggered. As sled 536 translates distally through cartridge 518, cam wedges 534 engage cam

members 542 of pusher 532, thereby urging pusher 532 in a direction transverse to the longitudinal axis of cartridge 518 and urging staples 530 towards staple forming depressions 514 of anvil plate 512. In particular, cam wedges 534 are longitudinally staggered such that when they engage staggered cam members 542, the resulting forces applied to move pusher 532 towards tissue contacting surface 540 are evenly applied.)

With continued reference to FIGS. 21 and 22, staples 530a, 530b, 530c ride on pusher 532 (for illustrative purposes, pusher 532c from FIG. 25 is shown). Additionally, cam members 542 of each pusher 532 include cam surfaces 542a and 542b. Each cam surface 542a, 542b is configured to be contacted by cam wedges 534. In particular, and with reference to FIGS. 21-25, cam wedges 534a are configured to cam surfaces 542a; cam wedges 534b are configured to engage cam surfaces 542b; central section 534c of sled 536 is configured to travel through slot 526.

Referring to FIG. 20, the illustrated embodiment of actuation sled 536 includes a longitudinally curved projection 535 depending from a lower surface thereof. Projection 535 is configured to travel within a slot 515 (FIG. 10) of channel or carrier 516. In disclosed embodiments, the radius of curvature of both cam wedges 534 and projection 535 is between about 1.00 inches and about 2.00 inches, and in particular, may be approximately 1.40 inches.

With reference to FIG. 10, proximal body portion 502 includes an inner body 503 formed from molded half-sections 503a and 503b, a drive assembly 560 and a drive locking assembly 564. Proximal body portion 502 is coupled to tool assembly 504 by a mounting assembly 570. Mounting assembly 570 has a pair of extensions 576 which extend into a proximal end of carrier 516. Each extension 576 has a transverse bore 578 which is aligned with a hole 580 in the cartridge 518 such that mounting assembly 570 is pivotally secured to cartridge 518 by pin 582. Mounting assembly 570 is fixedly secured to half-section 503a by a pair of vertical protrusions 584. Vertical protrusions 584 extend upwardly from mounting assembly 570 and frictionally fit into corresponding recesses (not shown) in half-section 503a.

With continued reference to FIG. 10, the illustrated embodiment of anvil cover 510 includes a proximally extending finger 588 having a pair of cutouts 590 formed therein. Cutouts 590 are positioned on each lateral side of finger 588 to help secure anvil cover 510 to half-section 503a. More particularly, half-section 503a includes a channel 505 therein, and channel 505 includes a pair of protrusions 505a. Finger 588 of anvil cover 510 mechanically engages channel 505 of half-section 503a, such that cutouts 590 are aligned with protrusions 505a. An outer sleeve 602 covers the finger and channel. The configuration of finger 588 and channel 505 facilitates a secure connection between anvil cover 510 and half-section 503a. Moreover, this connection results in a non-movable (e.g., non-pivotable) anvil assembly 506 with respect to proximal body portion 502.

Referring to FIGS. 11-13, drive assembly 560 includes a flexible drive beam 604 which is constructed from three stacked metallic sheets 604 a-c and a proximal engagement portion 608. At least a portion of drive beam 604 is sufficiently flexible to be advanced through the curvature of the tool assembly 504. Drive beam 604 has a distal end which is secured to a dynamic clamping member 606 via a butt weld 606f (FIG. 12). Spot welds 606h, which are configured to hold sheets 604 a-c together, are also shown in FIG. 12.

Engagement section 608 is fastened to a proximal portion of middle sheet 604b (e.g., via a butt weld) and includes a stepped portion defining a shoulder 610. A proximal end of

engagement section 608 includes diametrically opposed inwardly extending fingers 612. Fingers 612 engage a hollow drive member 614 to fixedly secure drive member 614 to the proximal end of beam 604. Drive member 614 defines a proximal porthole 616 which receives the distal end of a control rod of drive bar 30 (see FIG. 2) when DLU 500 is attached to surgical stapling instrument 10.

With reference to FIGS. 14-17, dynamic clamping member 606 includes a vertical strut 606a, an upper beam 606b and a lower beam 606c. A knife or cutting edge 606d is formed on a distal face of vertical strut 606a. As illustrated, the width of vertical strut 606a is equal to the width of drive beam 604 of drive assembly 560 (see FIG. 12). With particular reference to FIG. 16, vertical strut 606a and knife 606d are longitudinally curved from a first lateral side 606e of clamping member towards a second lateral side 606f of clamping member 606. Both upper beam 606b and lower beam 606c are linearly disposed with respect to longitudinal axis "A-A."

As illustrated in FIGS. 14-17A, the present disclosure includes embodiments of dynamic clamping member 606 that are asymmetrical. For instance, in the embodiment illustrated in FIGS. 15 and 17, lower beam 606c is thicker than upper beam 606b. In this embodiment, dynamic clamping member 606 is asymmetrical about horizontal axis "H-H" illustrated in FIG. 17. It is envisioned that lower beam 606c includes a thickness "T_L", which is between about 0.050 inches and about 0.100 inches, and in particular, may be approximately 0.068 inches. It is envisioned that upper beam 606b includes a thickness "T_U", which is between about 0.025 inches and about 0.050 inches, and in particular, is approximately 0.037 inches.

An additional example of an asymmetrical dynamic clamping member 606 is also illustrated in FIG. 17. In this embodiment, the transverse cross-sectional shape of upper beam 606b includes an upper planar surface 606b1 and a lower planar surface 606b2. The cross-sectional shape of lower beam 606c includes an upper planar surface 606c1 and a lower arcuate surface 606c2. In this embodiment, dynamic clamping member 606 is asymmetrical about the horizontal axis "H-H."

The embodiment shown in FIGS. 16 and 17 illustrates proximal portion of vertical strut 606a being off-center with respect to the remainder of clamping member 606. More particularly, it is envisioned that the center of vertical strut 606a is between about 0.070 inches and about 0.090 inches (e.g., approximately 0.080 inches) from first lateral side 606e of clamping member 606, and is between about 0.90 inches and about 0.110 inches (e.g., approximately 0.100 inches) from second lateral side 606f of clamping member 606. In this embodiment, dynamic clamping member 606 is asymmetrical about vertical axis "V-V" illustrated in FIG. 17.

With reference to FIG. 17A, dynamic clamping member 606' is shown. Lower beam 606c' is wider than upper beam 606b' of dynamic clamping member 606'. More particularly, it is envisioned that a width "wl" of lower beam 606c' is between about 0.180 inches and about 0.200 inches, and that a width "wu" of upper beam 606b' is between about 0.160 inches and about 0.180 inches. In this embodiment, dynamic clamping member 606' is asymmetrical about the horizontal axis "H-H." Further, while not explicitly shown, it is envisioned that upper beam 606b' is wider than lower beam 606c' of a dynamic clamping member 606 of the present disclosure. Additionally, dynamic clamping member 606' is shown as being longitudinally linear (vis-à-vis longitudinally curved), in accordance with embodiments of the present disclosure.

The asymmetrical embodiments of dynamic clamping member 606 of the present disclosure help ensure proper

orientation of dynamic clamping member 606 during assembly of surgical stapling instrument 10 or DLU 500. That is, the asymmetry of dynamic clamping member 606 prevents dynamic clamping member 606 from improper placement with respect to tool assembly 504, since dynamic clamping member 606 can only physically fit in a particular orientation. In particular, the asymmetry ensures that knife 606d faces distally and is positioned to travel through the space between cartridge assembly 508 and anvil assembly 506, for example.

With reference to FIG. 17B, the present disclosure includes another embodiment of a dynamic clamping member 606" that is also configured to help ensure proper orientation of dynamic clamping member 606" during assembly of surgical stapling instrument 10 or DLU 500. Dynamic clamping member 606" includes a protrusion 607 extending from a proximal surface 606i thereof. In the illustrated embodiment, a drive assembly 560" has a smaller height than embodiment of drive assembly 560' illustrated in FIGS. 10-13. Protrusion 607 is shown being disposed on a lower portion of dynamic clamping member 606" (i.e., on the opposite side as cutting edge 606a") and to one side of drive assembly 560", but it is envisioned that protrusion 607 is disposed on the other side of drive assembly 560".

As discussed above, the inclusion of protrusion 607 helps ensure proper orientation of dynamic clamping member 606". More particularly, it is envisioned that extensions 576 of mounting assembly 570 would physically prevent further assembly of dynamic clamping member 606" being incorrectly fastened to drive assembly 560" (e.g., when dynamic clamping member 606" is up-side-down with respect to drive assembly 560").

It is further envisioned that dynamic clamping member 606, 606' may include any combination of the asymmetrical features discussed herein and may also include protrusion 607 of dynamic clamping member 606".

With additional reference to dynamic clamping member 606 of FIGS. 14-17A, it is envisioned that each of upper beam 606b and 606c includes a plastic material or layer which is injection molded onto an outwardly facing surface of each beam 606b and 606c. Plastic layer provides reduced frictional engagement between dynamic clamping member 606 and cartridge and anvil assemblies 508 and 506, respectively, during actuation of tool assembly 504.

Referring back to FIG. 8, channel 511 is configured and dimensioned accordingly to accommodate a corresponding embodiment of upper beam 606b of clamping member 606; slot 526 is configured and dimensioned accordingly to accommodate a corresponding embodiment of vertical strut 606a of clamping member 606. As can be appreciated, when used with the embodiment of dynamic clamping member 606 of FIG. 17A, channel 511 is too narrow to accommodate lower beam 606c of dynamic clamping member 606.

With reference to FIG. 10, when drive assembly 560 is advanced distally within tool assembly 504, upper beam 606b moves within channel 511 defined between anvil plate 512 and anvil cover 510, and lower beam 606c moves over an exterior surface of carrier 516. When lower beam 606c engages and moves over cam surface 516a, cartridge assembly 508 pivots from the open position to the closed position. As dynamic clamping member 606 continues to move distally along and through tool assembly 504, the maximum gap between anvil plate 512 and cartridge 518 is defined by engagement of layer 606e on upper beam 606b (FIG. 12) and a lower surface defining channel 511, and engagement of a layer 606g on lower beam 606c with the external surface of

clearance between the upper surface of dynamic clamping member 606 and the anvil plate 512 so that upper beam 606b of dynamic clamping member 600 does not simultaneously engage the upper and lower surfaces of anvil channel 511.

With continued reference to FIG. 10, DLU 500 includes a locking mechanism 564 including a locking member 620 and a locking member actuator 622. Locking member 620 is rotatably supported within a longitudinal or axial slot 625 formed in a proximal portion of an upper housing half 503a of inner body 503 of DLU 500. Locking member 620 is movable from a first position, in which locking member 620 maintains drive assembly 560 in a prefired position, to a second position in which drive assembly 560 is free to move axially.

Locking member 620 includes a semi-cylindrical body 624 which is slidably positioned within transverse slot 625 formed in upper housing half 503a of body portion 503. Body 624 includes a radially inwardly extending cam member 628 and a radially inwardly extending finger 630. Finger 630 is dimensioned to be received within a notch 632 formed in drive assembly 560. Engagement of finger 630 in notch 632 of drive assembly 560 prevents drive assembly 560 from moving linearly within body portion 503 to prevent actuation of DLU 500 prior to attachment of DLU 500 to surgical instrument 10.

Locking member actuator 622 is slidably positioned within axial slot 625 formed in upper housing half section 503a of body portion 503 of DLU 500. Actuator 622 includes a proximal abutment member 636, a distal spring guide 627, and a central cam slot 640. Axial slot 641 in the housing half section 503a intersects transverse slot 625 such that cam member 628 of locking member 620 is slidably positioned within cam slot 640 of locking member actuator 622. A biasing member or spring 642 is positioned about spring guide 627 between a distal surface of actuator 622 and a wall 641a defining the distal end of axial slot 641. Spring 642 urges actuator 622 to a first position within axial slot 641. In the first position, abutment member 636 is positioned on insertion tip 650 of proximal body portion 502 (FIG. 3) and cam slot 640 is positioned to locate cam member 628 such that finger 630 of lock member 620 is positioned within notch 632 of drive assembly 560.

Prior to attachment of DLU 500 onto surgical instrument 10, spring 642 urges actuator 622 to the first position to maintain the lock member 620 in its first position as discussed above. When insertion tip 650 of DLU 500 is linearly inserted into the open end of the body portion 18 (FIG. 2) of surgical instrument 10, nubs 652 of insertion tip 650 (FIG. 3) move linearly through slots (not shown) formed in open end of body portion 18. As nubs 652 pass through the slots, the proximal end of abutment member 636, which is angularly offset from nubs 652, abuts a wall defining the slots for receiving nubs. As DLU 500 is moved farther into body portion, locking member actuator 622 is moved from its first position to its second position. As actuator 622 is moved to its second position, lock member 620 is cammed from its first position engaged with notch 632 of drive assembly 560 to its second position to move finger 630 from notch 632. The locking mechanism including locking member 620 and locking member actuator 622 prevents advancement of the drive assembly 560 of DLU 500 prior to loading of DLU 500 onto a surgical instrument 10.

In the embodiments illustrated in FIGS. 3 and 10, locking member actuator 622 includes an articulation lock portion 637 disposed thereon. In particular, articulation lock portion 637 extends in an approximate right angle from abutment member 636. Articulation lock portion 637 is configured to physically prevent the longitudinal translation of an articula-

tion member (not shown) of a handle portion of a surgical instrument having articulation capabilities. That is, even when DLU 500 is engaged with a surgical instrument 10 that is otherwise capable of articulation (i.e., pivotable movement of the jaw members with respect to the elongated portion 18), articulation lock portion 637 of DLU 500 prevents an articulation member from entering DLU 500.

Referring to FIG. 10, upper half-section 503a of proximal body portion 502 defines a longitudinal slot 660 which receives a leaf spring 662. Leaf spring 662 is confined within slot 660 by outer sleeve 602. Leaf spring 662 has an angled proximal end 664 which is positioned to abut shoulder 610 (FIG. 11) of engagement section 608 of drive beam 604 when drive beam 604 is in its retracted position. When drive beam 604 is advanced distally by advancing drive bar 30, as described above, leaf spring 662 is flexed upwardly by shoulder 610 of drive beam 604 to permit distal movement of drive beam 604.

Referring to FIGS. 4, 7, and 26-30, DLU 500 also includes a tissue stop 700. Tissue stop 700 includes a body 710, a pair of legs 720 extending proximally from the body 710, a stopping portion 730, a pair of laterally opposed protrusions 740 extending transversely from body 710 (See FIG. 26), and a knife channel 750 disposed between pair of legs 720. Tissue stop 700 is pivotally connected to a distal portion of cartridge assembly 508 via the engagement between protrusions 740 and a corresponding pair of apertures (not shown) disposed within cartridge assembly 508. Cartridge assembly 508 includes an opening 519 (FIGS. 7 and 10) adapted to receive both legs 720 of tissue stop 700. A recess 521 is positioned distally of opening 519 and is adapted to receive a portion of tissue stop 700 therein. The recess 521 and opening 519 are shown in FIG. 10.

Tissue stop 700 is movable between a first position (FIG. 4), which corresponds to when the jaw members are in an open position where an upper surface 701 thereof is disposed between cartridge assembly 508 and anvil assembly 506 (FIG. 4 illustrates the jaw members in a partially approximated position; FIG. 6 illustrates the jaw members in a fully opened position), and a second position (FIG. 30), which corresponds to when the jaw members are in the approximated position and where upper surface 701 of tissue stop 700 is substantially flush with tissue contacting surface 514 of cartridge 518. (In FIG. 30, upper surface 701 is hidden as upper surface 701 is within cartridge assembly 508.) A biasing member 760 (FIG. 10), a portion of which is disposed around protrusion 740, urges tissue stop 700 towards its first position. Tissue stop 700 also includes a finger 770 (FIG. 26) extending distally from each leg 720. With specific reference to FIG. 27, when the jaw members are in the open position, fingers 770 of tissue stop 700 engage a lip 523 disposed on cartridge assembly 508 to limit the amount of movement imparted by biasing member 760 in the general direction of arrow "B" in FIG. 27.

When tissue stop 700 is in its first position, tissue "T" is proximally insertable (in the general direction of arrow "A" in FIG. 28) from distally beyond tissue stop 700, to a location that is between anvil assembly 206 and cartridge assembly 508 and proximal of tissue stop 700 (see FIGS. 28 and 29). In this position, stopping portion 730, which is disposed at an oblique angle (e.g., between about 45° and about 90°) with respect to tissue contacting surface 540 of cartridge assembly 508, impedes tissue from distally escaping the tool assembly 504. When the jaw members are approximated (e.g., when cartridge assembly 508 is pivoted towards anvil assembly 506), tissue stop 700 (or tissue "T") contacts anvil assembly 506, thus causing tissue stop 700 to pivot from its first position

towards its second position. Legs 720 of tissue stop 700 are configured to lie within opening 519 (i.e., equal to or below the tissue contacting surface 540) of cartridge assembly 508 when tissue stop 700 is in its second position, such that legs 720 do not interfere with the location of the tissue with respect to the cartridge assembly 508 and respect to anvil assembly 506 (i.e., so that the staples can be deployed into tissue lying over the tissue stop). When the cartridge assembly 508 moves away from anvil assembly 506, tissue stop 700, under the influence of biasing member 760, returns to its first position.

With additional regard to knife channel 750, knife channel 750 is configured to allow vertical strut 606a (including cutting edge 606d) of dynamic clamping member 606 to travel distally past a portion of tissue stop 700 (i.e., at least to a location adjacent the distal-most longitudinal slot 528). Additionally, it is envisioned that at least a portion of knife channel 750 (e.g., the portion that is contacted by cutting edge 606d) is over molded with plastic or another suitable material.

While not explicitly illustrated, it is also envisioned that tissue stop 700 is usable with a surgical instrument having parallel jaws and/or an electrosurgical instrument. An example of a surgical instrument having parallel jaws is described in commonly-owned U.S. Pat. No. 7,237,708 to Guy et al., the entire contents of which are hereby incorporated by reference herein. An example of an electrosurgical instrument is described in commonly-owned patent application Ser. No. 10/369,894, filed on Feb. 20, 2003, entitled VESSEL SEALER AND DIVIDER AND METHOD OF MANUFACTURING THE SAME, the entire contents of which are hereby incorporated by reference herein.

The present disclosure also relates methods of using the described surgical instrument 10 or DLU 500 to perform a lower anterior resection. Such a method includes providing surgical instrument 10 or DLU 500, positioning jaw members adjacent tissue, approximating one jaw member (e.g., cartridge assembly 508) with respect to the other jaw member (e.g., anvil assembly 506), advancing drive assembly 560 such that dynamic clamping member 606 and at least a portion of drive assembly 560 move along a curvilinear path to cause staples 530 to be ejected into tissue "T" and to cut tissue "T." In certain embodiments, the jaw members are approximated, and the interior of the intestinal tissue is then washed out or otherwise cleansed. The tissue is then cut and stapled. In this way, the interior intestinal tissue is cleansed up to the location of the jaw members.

The present disclosure also relates to methods of assembling surgical instrument 10 or DLU 500. Such a method includes positioning asymmetrical dynamic clamping member 606, 606' in mechanical engagement with a portion of tool assembly 504, and wherein the positioning step automatically results in the proper positioning of asymmetrical dynamic clamping member 606. Another method includes attaching dynamic clamping member 606" to drive assembly 560" in a way that would enable fail-safe positioning of dynamic clamping member 606" with respect to tool assembly 504.

Other features of the present disclosure are shown in the cross-sectional views of FIGS. 31-32. Surgical instrument 10 includes the actuation sled 536 (FIG. 31) and drive assembly 560 (FIG. 32).

With particular reference to FIG. 31, a transverse cross-sectional view of surgical instrument 10 (e.g., loading unit) taken along a portion of actuation sled 536 is shown. The jaw members of surgical instrument 10 are shown and include an anvil assembly 506 and a cartridge assembly 508, which includes a channel or carrier 516. Here, actuation sled 536 includes a projection 535 depending from a lower surface thereof. (FIG. 20 also illustrates actuation sled 536 having

projection 535 depending from a lower surface thereof.) Projection 535 is configured to travel within a slot 515 of a carrier 516. As actuation sled 536 is translated distally, projection 535 helps ensure that actuation sled 536 follows the curvature of the jaw members.

With particular reference to FIG. 32, a transverse cross-sectional view of surgical instrument 10 taken along a portion of drive assembly 560 is shown. Here, drive assembly 560 includes a lower portion 562 that is configured to travel within slot 515 of carrier 516. Additionally, an upper portion 563 of drive assembly 560 is configured to travel with a slot 513 (see also FIG. 31, for example) in anvil plate 512. For example, the drive beam 604 extends into the slot 515 and may also extend into slot 513. Upon distal translation of drive assembly 560, the interaction between lower portion 562 and upper portion 563 of drive assembly 560 with slots 515 and 513, respectively, helps ensure that drive assembly 560 follows the curvature of the jaw members. It is also envisioned and within the scope of the present disclosure that drive assembly 560 only engages a single slot 513 or 515. As noted above, these structures can be incorporated in a surgical instrument that does not have a loading unit incorporating the jaws of the instrument in a replaceable assembly and in which the staple cartridge is removable and/or reloadable.

While the above description contains many specifics, these specifics should not be construed as limitations on the scope of the present disclosure, but merely as illustrations of various embodiments thereof. Therefore, the above description should not be construed as limiting, but merely as exemplifications of various embodiments. Those skilled in the art will envision other modifications within the scope and spirit of the claims appended hereto.

The invention claimed is:

1. A surgical instrument for surgically joining tissue comprising:

a handle assembly including a movable handle;

an endoscopic portion extending distally from the handle assembly and defining a first longitudinal axis;

a pair of jaw members disposed adjacent a distal end of the endoscopic portion and extending generally distally therefrom, each of the jaw members being longitudinally curved with respect to the first longitudinal axis, at least one of the jaw members being movable with respect to the other between an open position and an approximated position for engaging body tissue therebetween, the pair of jaw members including a first jaw member and a second jaw member, the first jaw member including a channel having a longitudinally-extending slot therein; and

a drive assembly disposed in mechanical cooperation with the movable handle, wherein the drive assembly is advanced distally through at least a portion of the length of the jaw members in response to at least a partial actuation of the movable handle;

the drive assembly having a drive bar with a lower portion that is configured and dimensioned to travel at least partially within the longitudinally-extending slot of the channel, and wherein the lower portion of the drive bar is elongated and substantially flat along a majority of the entire length of the drive bar.

2. The surgical instrument of claim 1, wherein the second jaw member includes a longitudinally-extending slot therein, and wherein an upper portion of the drive bar is configured and dimensioned to travel at least partially within the longitudinally-extending slot of the second jaw member.

3. The surgical instrument of claim 1, further comprising a dynamic clamping member disposed in mechanical cooperation

with a distal portion of the drive bar, wherein the dynamic clamping member is advanced distally through at least a portion of the length of the jaw members in response to at least a partial actuation of the movable handle, and wherein a portion of the dynamic clamping member is configured and dimensioned to travel at least partially within the longitudinally-extending slot of the channel.

4. The surgical instrument of claim 3, further comprising an actuation sled slidably disposed with respect to the first jaw member, the actuation sled being disposed distally of the dynamic clamping member and including a projection depending from a lower surface thereof, the projection configured to travel at least partially within the longitudinally-extending slot of the channel.

5. The surgical instrument of claim 4, wherein at least a portion of the actuation sled is longitudinally curved.

6. The surgical instrument of claim 4, wherein the projection of the actuation sled is longitudinally curved.

7. The surgical instrument of claim 1, wherein the drive bar includes an upper elongated surface and a lower elongated surface, the upper elongated surface being substantially parallel to the lower elongated surface along a majority of the entire length of the drive bar; and wherein the lower elongated surface is configured and dimensioned to travel at least partially within the longitudinally-extending slot of the channel.

8. The surgical instrument of claim 7, wherein the second jaw member includes a longitudinally-extending slot therein, and wherein the upper elongated surface of the drive bar is configured and dimensioned to travel at least partially within the longitudinally-extending slot of the second jaw member.

9. A loading unit configured for releasable engagement with a surgical instrument, the loading unit comprising:

a body portion defining a longitudinal axis, a proximal portion of the body portion configured for releasable engagement with an endoscopic portion of the surgical instrument;

a pair of jaw members extending generally distally from the body portion, each of the jaw members being longitudinally curved with respect to the longitudinal axis, at least one of the jaw members being movable with respect to the other between an open position and an approximated position for engaging body tissue therebetween, the pair of jaw members including a first jaw member and a second jaw member, the first jaw member including a channel with a longitudinally-extending slot therein; and

a drive assembly disposed at least partially within the body portion and being longitudinally translatable with respect to the body portion in response to actuation of a portion of the surgical instrument;

the drive assembly having a drive bar with an elongated and substantially flat lower portion that is configured and dimensioned to travel at least partially within the longitudinally-extending slot of the channel.

10. The loading unit of claim 9, wherein the second jaw member includes a longitudinally-extending slot therein, and wherein an upper portion of the drive bar is configured and dimensioned to travel at least partially within the longitudinally-extending slot of the second jaw member.

11. The loading unit of claim 9, further comprising a dynamic clamping member disposed in mechanical cooperation with a distal portion of the drive assembly, wherein the dynamic clamping member is distally advanceable through at least a portion of the length of the jaw members, and wherein a portion of the dynamic clamping member is configured and dimensioned to travel at least partially within the longitudinally-extending slot of the channel.

15

12. The loading unit of claim 11, further comprising an actuation sled slidingly disposed with respect to the first jaw member and disposed distally of the dynamic clamping member, the actuation sled including a projection depending from a lower surface thereof, the projection configured to travel at least partially within the longitudinally-extending slot of the first jaw member.

13. The loading unit of claim 12, wherein at least a portion of the actuation sled is longitudinally curved.

14. The loading unit of claim 12, wherein the projection of the actuation sled is longitudinally curved.

15. The loading unit of claim 9, wherein the drive bar includes an upper elongated surface and a lower elongated surface, the upper elongated surface being substantially parallel to the lower elongated surface along a majority of the entire length of the drive bar, and wherein the lower elongated surface is configured and dimensioned to travel at least partially within the longitudinally-extending slot of the channel.

16. The loading unit of claim 15, wherein the second jaw member includes a longitudinally-extending slot therein, and wherein the upper elongated surface of the drive bar is configured and dimensioned to travel at least partially within the longitudinally-extending slot of the second jaw member.

17. A surgical instrument for surgically joining tissue comprising:

- a handle assembly including a movable handle;
- an endoscopic portion extending distally from the handle assembly and defining a first longitudinal axis;

16

a pair of jaw members disposed adjacent a distal end of the endoscopic portion and extending generally distally therefrom, each of the jaw members being longitudinally curved with respect to the first longitudinal axis, at least one of the jaw members being movable with respect to the other between an open position and an approximated position for engaging body tissue therebetween, the pair of jaw members including a first jaw member and a second jaw member, each jaw member including a longitudinally-extending slot therein; and

a drive assembly including a drive bar, the drive assembly disposed in mechanical cooperation with the movable handle, wherein the drive assembly is advanced distally through at least a portion of the length of the jaw members in response to at least a partial actuation of the movable handle;

wherein the drive bar includes an elongated lower portion that is configured and dimensioned to travel at least partially within the longitudinally-extending slot of the first jaw member, wherein the drive bar includes an elongated upper portion that is configured and dimensioned to travel at least partially within the longitudinally-extending slot of the second jaw member, and wherein the elongated lower portion and the elongated upper portion are substantially parallel to each other along at least a majority of an entire length of the drive bar.

* * * * *