



US009513444B2

(12) **United States Patent**
Barnette, Jr. et al.

(10) **Patent No.:** **US 9,513,444 B2**
(45) **Date of Patent:** **Dec. 6, 2016**

(54) **FEMALE HARDENED OPTICAL CONNECTORS FOR USE WITH MALE PLUG CONNECTORS**

USPC 385/77, 134
See application file for complete search history.

(71) Applicant: **CORNING CABLE SYSTEMS LLC**, Hickory, NC (US)

(56) **References Cited**

(72) Inventors: **Robert Elvin Barnette, Jr.**, Hickory, NC (US); **Hieu Vinh Tran**, Charlotte, NC (US)

U.S. PATENT DOCUMENTS

(73) Assignee: **CORNING OPTICAL COMMUNICATIONS LLC**, Hickory, NC (US)

5,129,023 A	7/1992	Anderson et al.	385/70
5,214,732 A	5/1993	Beard et al.	385/78
7,090,406 B2	8/2006	Melton et al.	385/62
2005/0053342 A1	3/2005	Melton et al.	385/113
2006/0045430 A1	3/2006	Theuerkorn et al.	385/53

(Continued)

(*) Notice: Subject to any disclaimer, the term of this patent is extended or adjusted under 35 U.S.C. 154(b) by 583 days.

FOREIGN PATENT DOCUMENTS

EP	1258758 A2	11/2002	G02B 6/38
EP	1367419 A2	4/2003	G02B 6/36

(Continued)

(21) Appl. No.: **13/833,176**

OTHER PUBLICATIONS

(22) Filed: **Mar. 15, 2013**

Patent Cooperation Treaty International Search Report, Application No. PCT/US2014/017030, Jul. 7, 2014, 5 pages.

(65) **Prior Publication Data**

(Continued)

US 2014/0241670 A1 Aug. 28, 2014

Primary Examiner — Jerry Blevins

Related U.S. Application Data

(57) **ABSTRACT**

(60) Provisional application No. 61/769,251, filed on Feb. 26, 2013.

A female hardened fiber optic connector for terminating an end of a fiber optic cable that is suitable for making an optical connection with another hardened cable assembly and cable assemblies using the same are disclosed. The female hardened fiber optic connector includes a connector assembly, a crimp body, a connector sleeve, and female coupling housing. The connector sleeve has one or more orientation features that cooperate with one or more orientation features inside the female coupling housing. The crimp body has a first shell and a second shell for securing the connector assembly at a front end of the shells and a cable attachment region rearward of the front end for securing a cable.

(51) **Int. Cl.**
G02B 6/36 (2006.01)
G02B 6/00 (2006.01)
G02B 6/38 (2006.01)

(52) **U.S. Cl.**
CPC **G02B 6/3871** (2013.01); **G02B 6/387** (2013.01); **G02B 6/3887** (2013.01); **Y10T 29/49908** (2015.01)

(58) **Field of Classification Search**
CPC G02B 6/387; G02B 6/3871

25 Claims, 12 Drawing Sheets

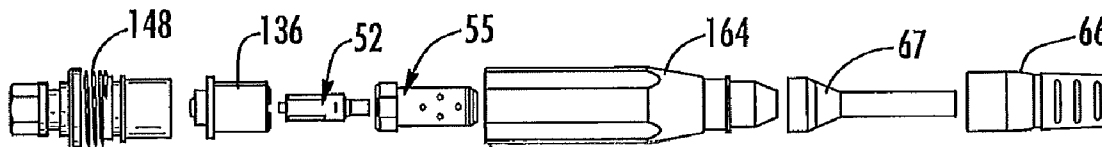

(56)

References Cited

U.S. PATENT DOCUMENTS

2008/0044137 A1* 2/2008 Luther G02B 6/3869
385/60
2008/0175541 A1 7/2008 Lu et al. 385/62
2008/0175546 A1 7/2008 Lu et al. 385/92
2008/0273837 A1* 11/2008 Margolin G02B 6/3825
385/62
2008/0273855 A1 11/2008 Bradley et al. 385/139
2008/0310796 A1* 12/2008 Lu G02B 6/3825
385/72
2008/0310798 A1 12/2008 Cody et al. 385/80
2009/0136184 A1* 5/2009 Abernathy G02B 6/381
385/80
2010/0284655 A1 11/2010 Nakano et al. 385/78
2010/0322563 A1 12/2010 Melton et al. 385/59

FOREIGN PATENT DOCUMENTS

EP 2159616 A1 3/2010 G02B 6/44
WO WO2008/021351 A2 2/2008
WO WO2009/073500 A1 6/2009 G02B 6/38
WO WO2009/131993 A1 10/2009 G02B 6/38

OTHER PUBLICATIONS

International Search Report and Written Opinion issued in corresponding Application PCT/US2014/017030, dated Jul. 7, 2014.
EP 161 Communication issued in corresponding EP Appln. No. 14708729, dated Nov. 3, 2015.

* cited by examiner

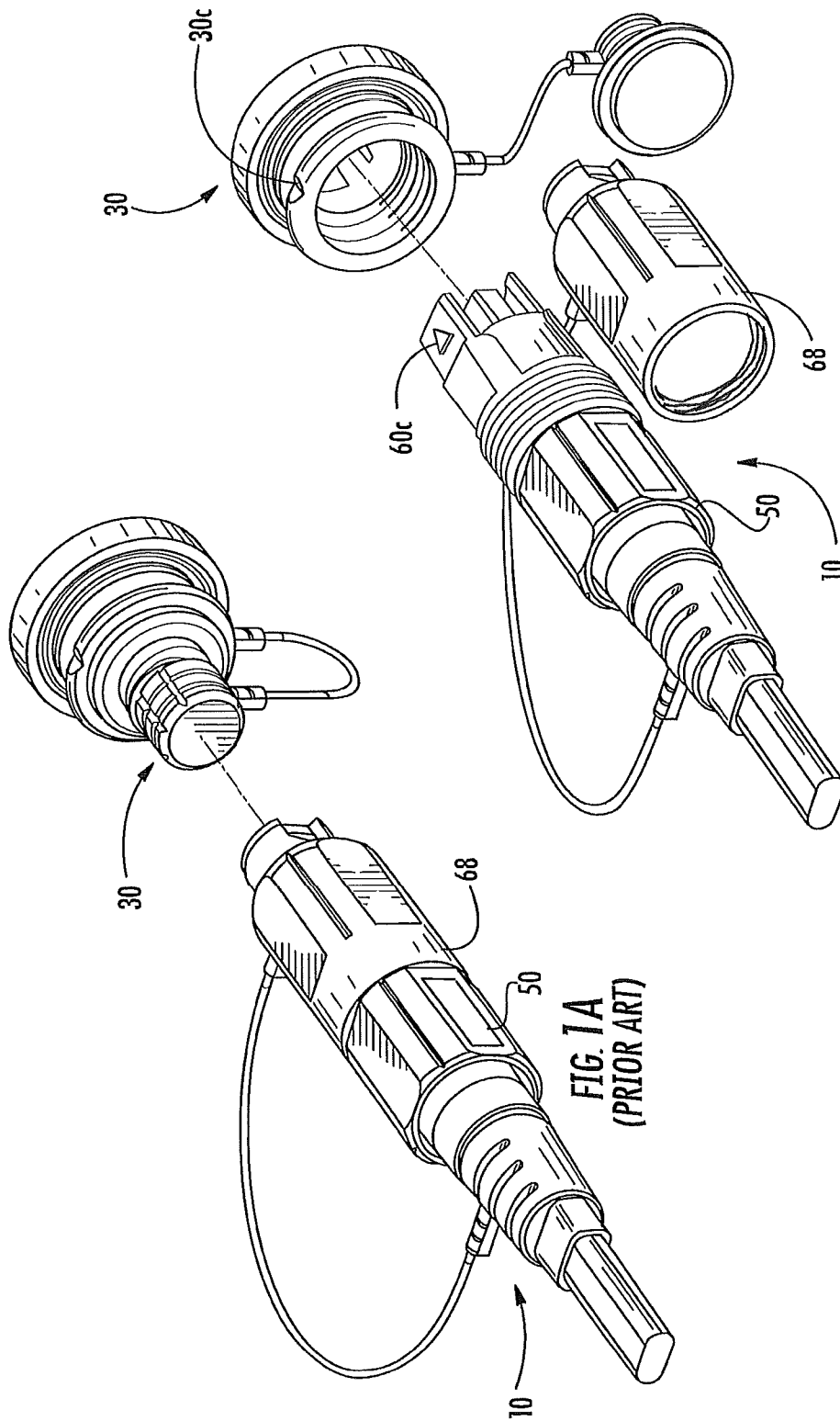

FIG. 1B
(PRIOR ART)

FIG. 1A
(PRIOR ART)

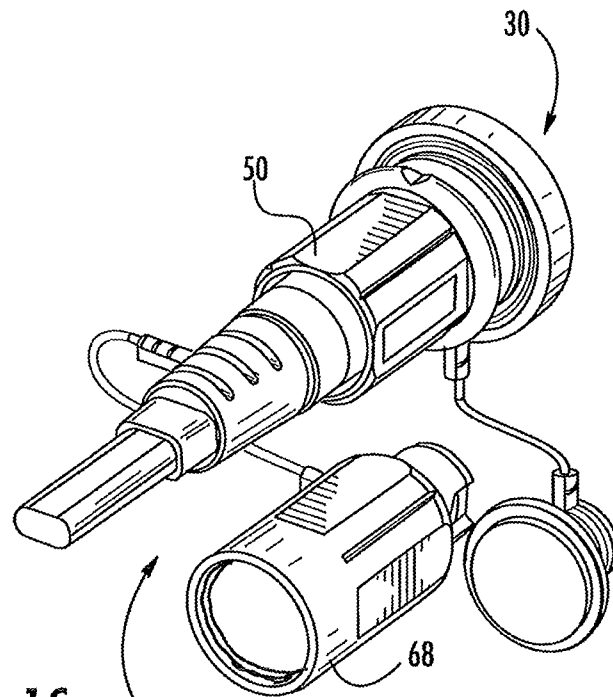

FIG. 1C
(PRIOR ART)

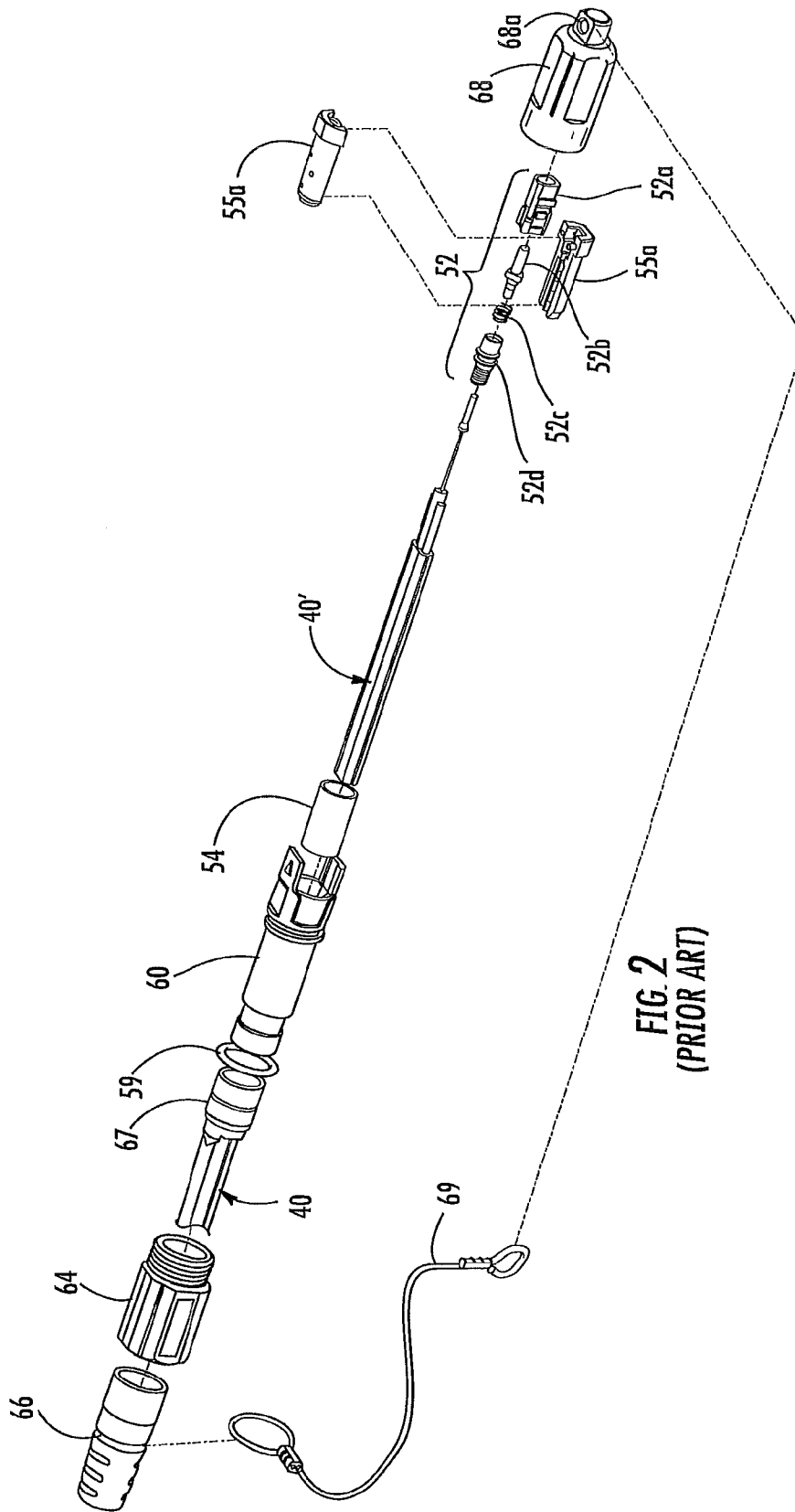
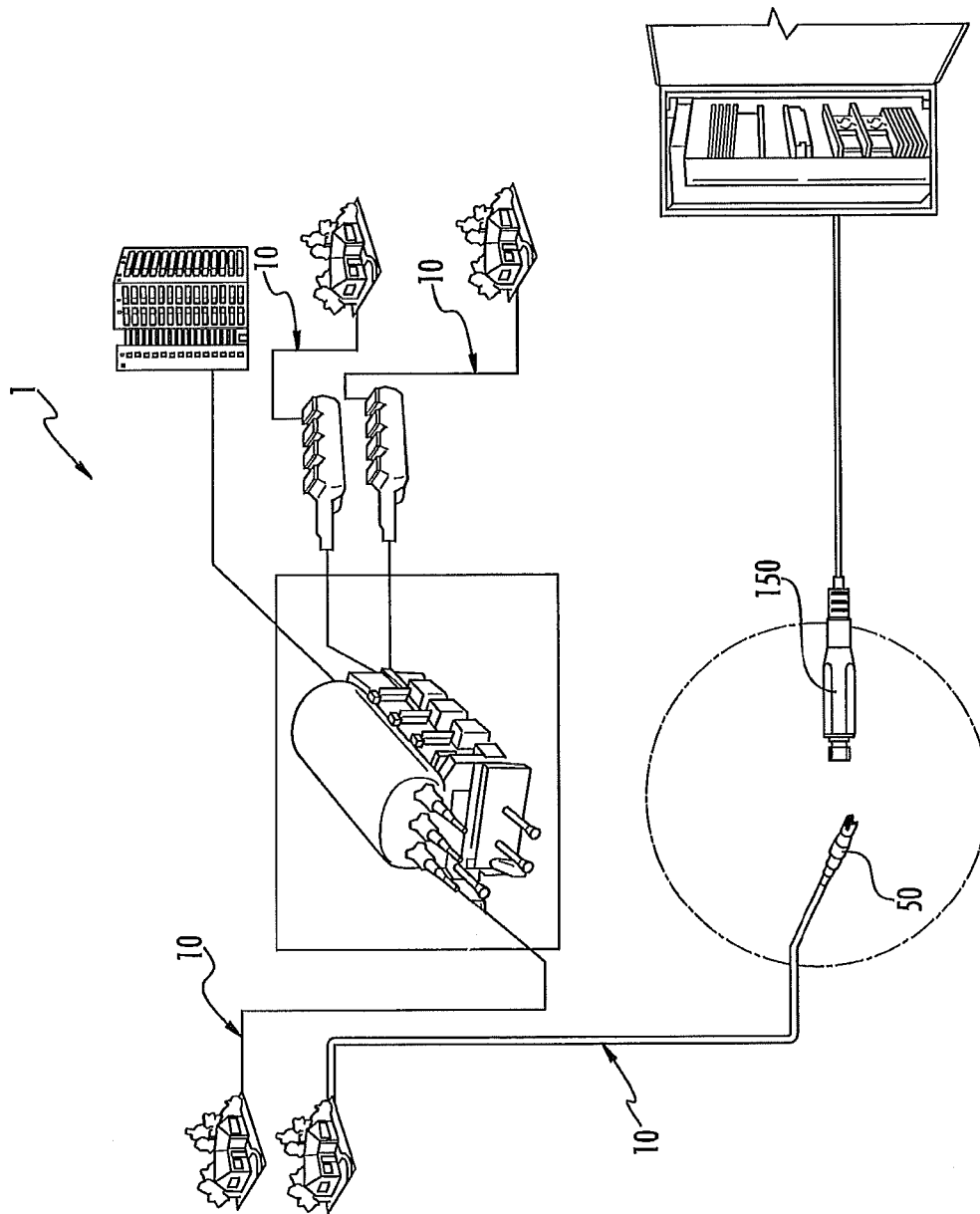

FIG. 2
(PRIOR ART)



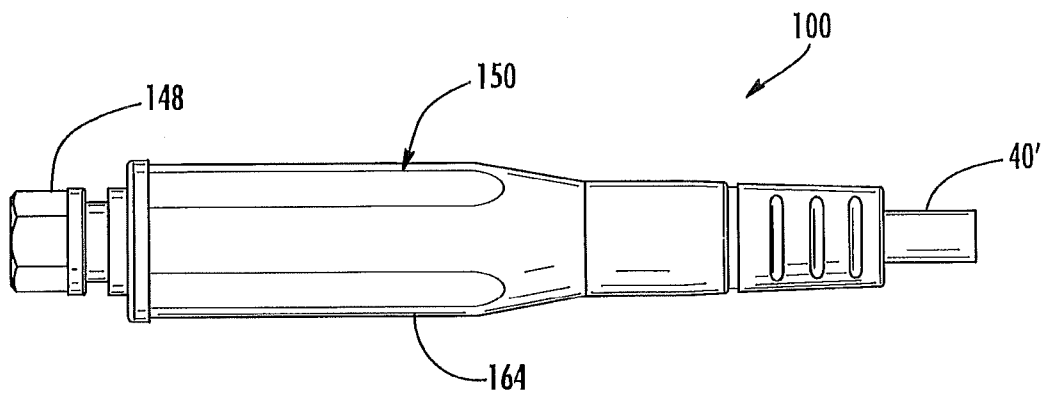

FIG. 4

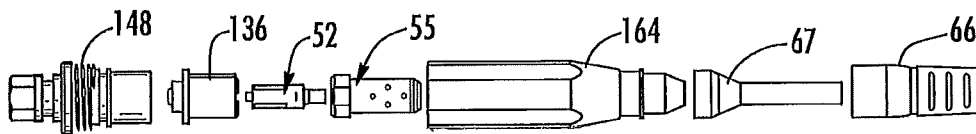

FIG. 5

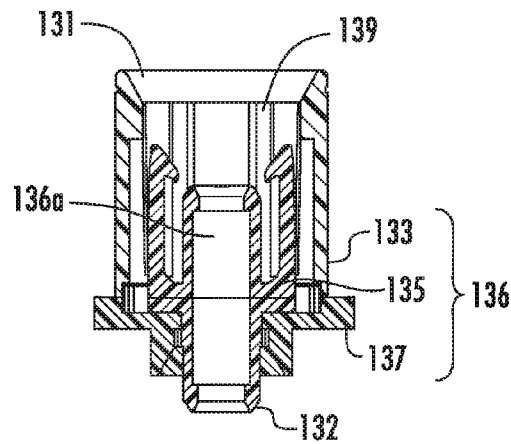
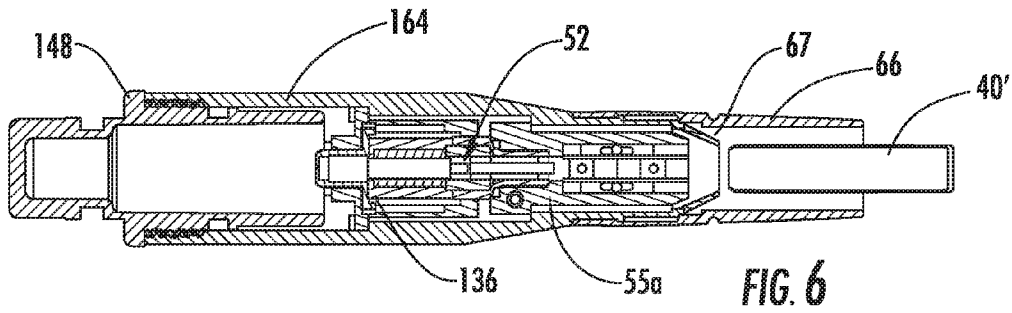

FIG. 7

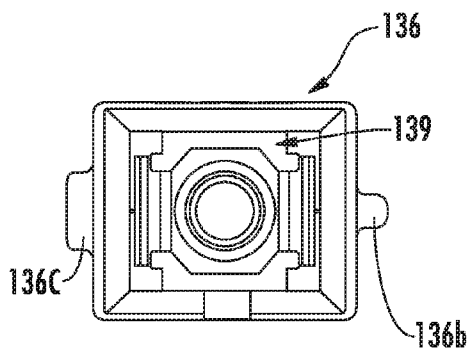

FIG. 8

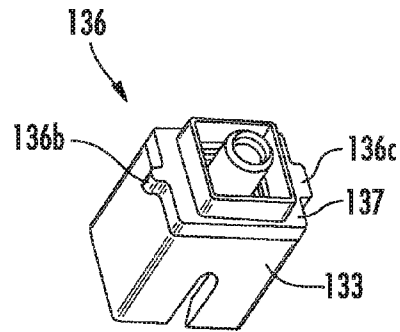

FIG. 9

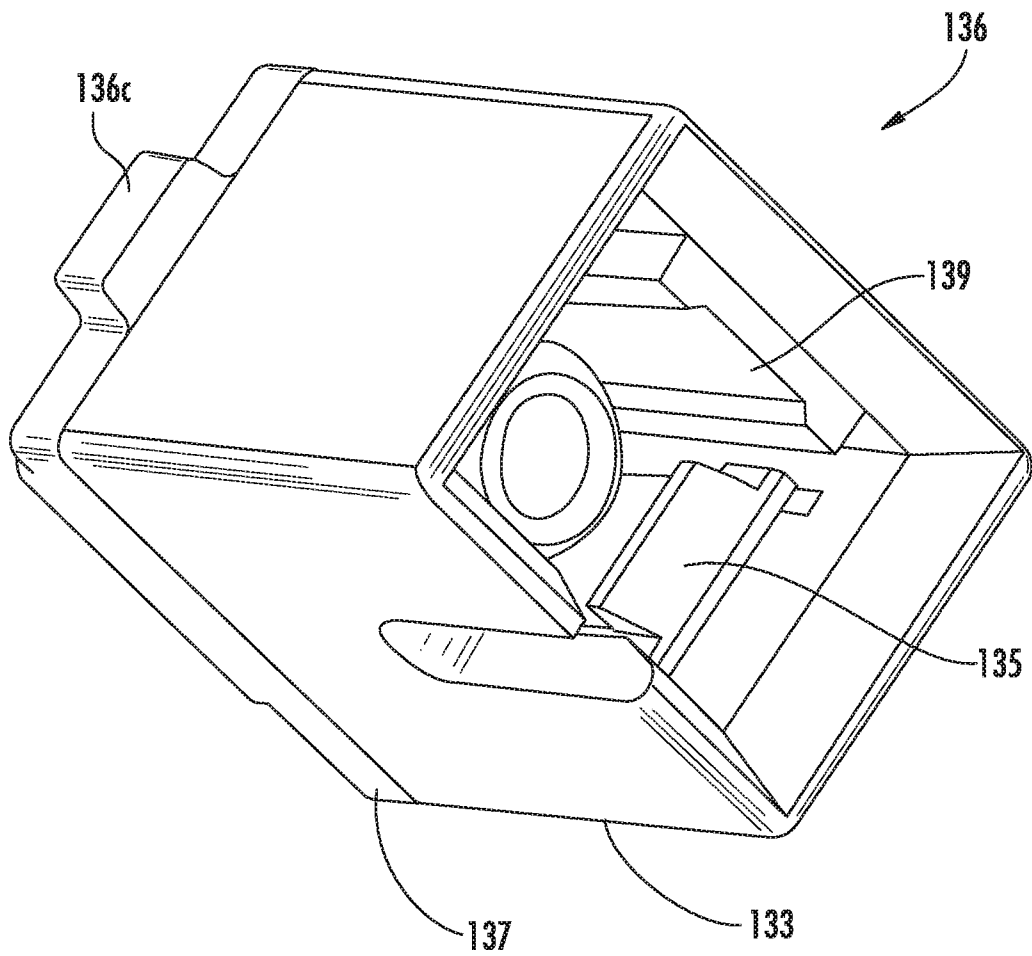
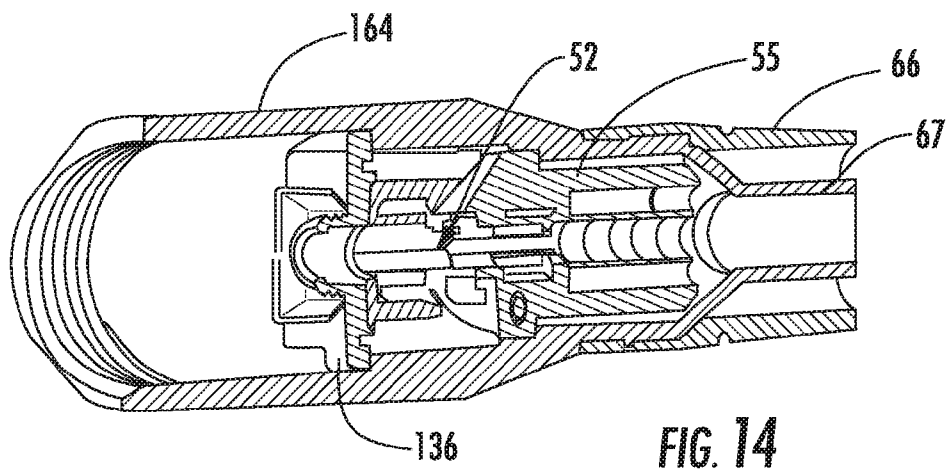
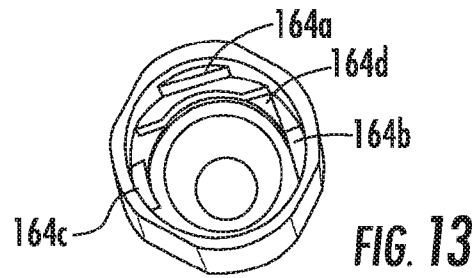
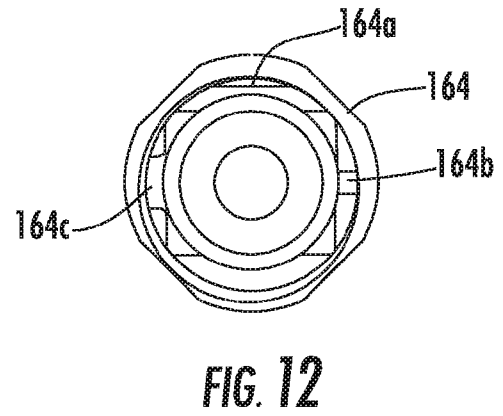
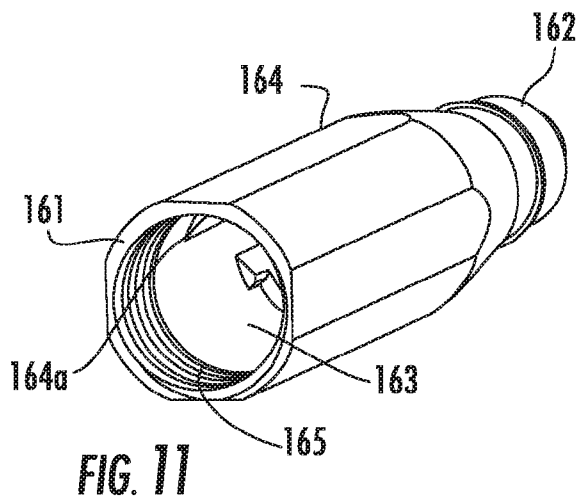

FIG. 10



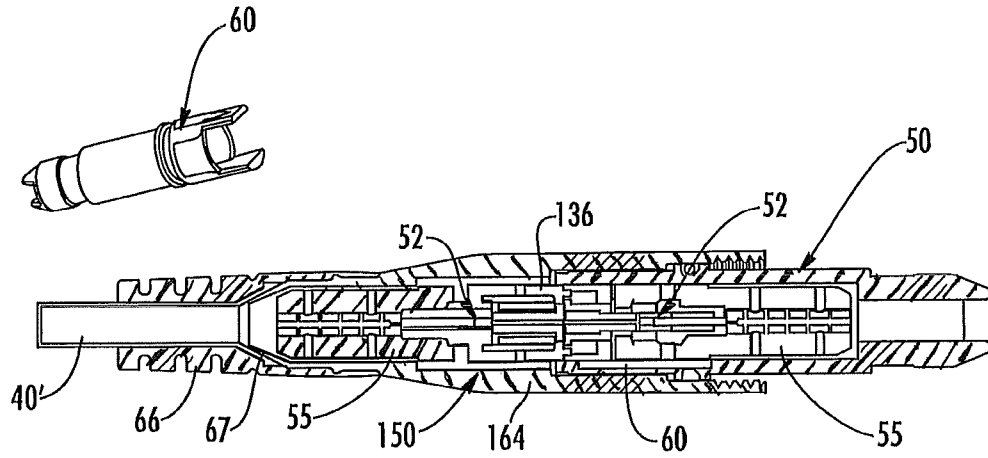

FIG. 15

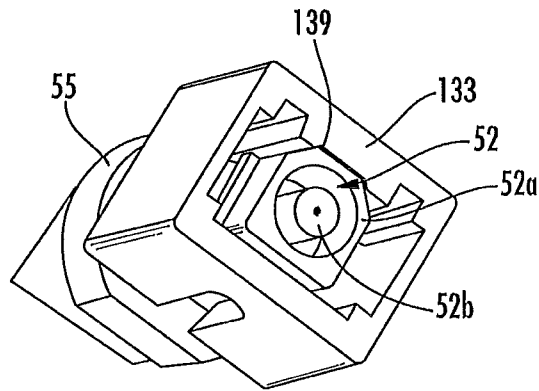
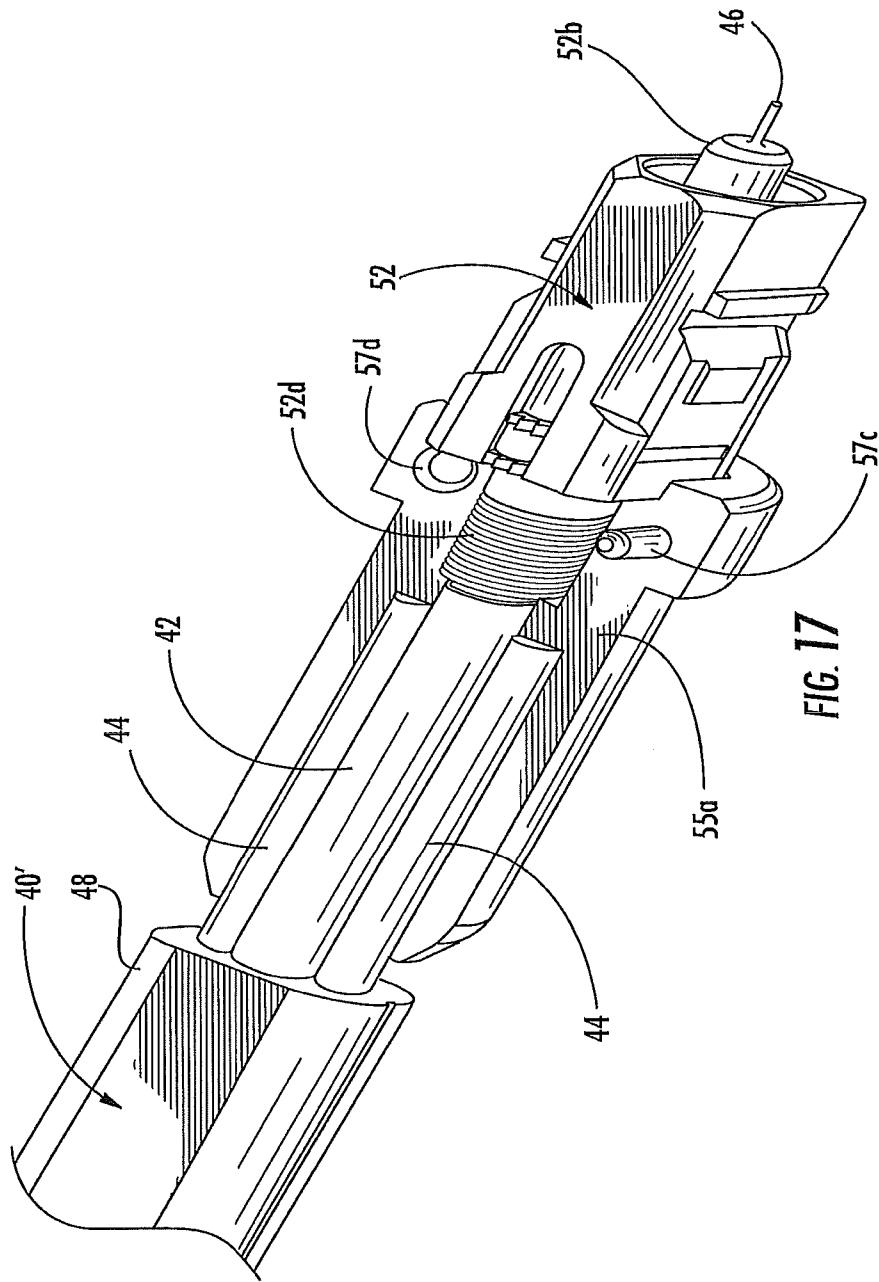

FIG. 16



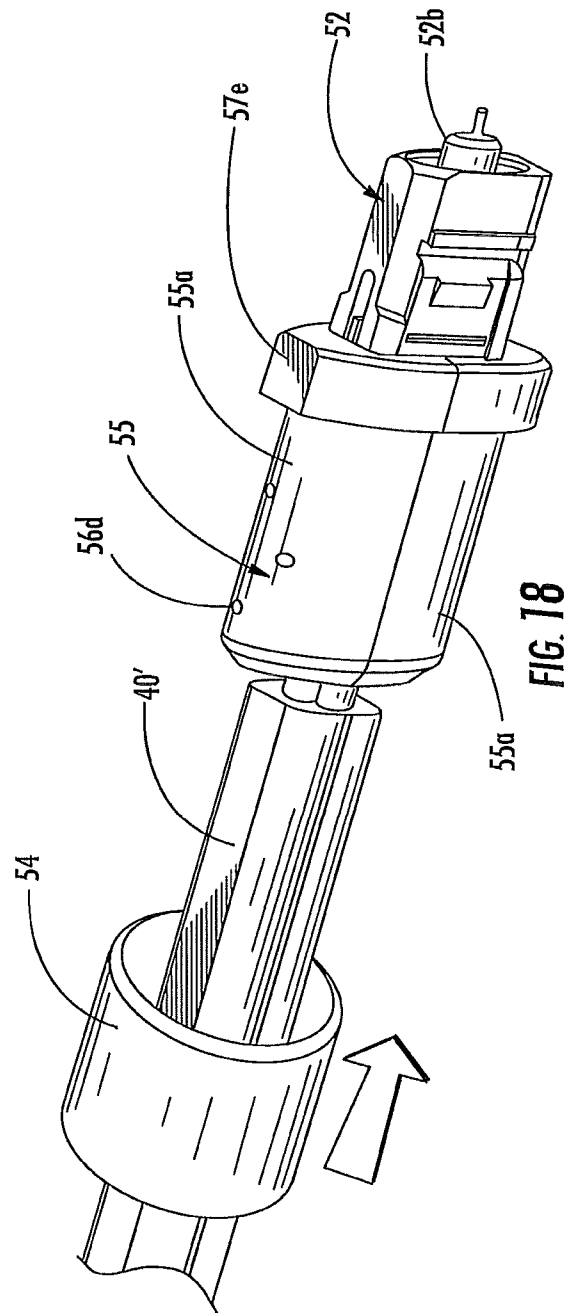
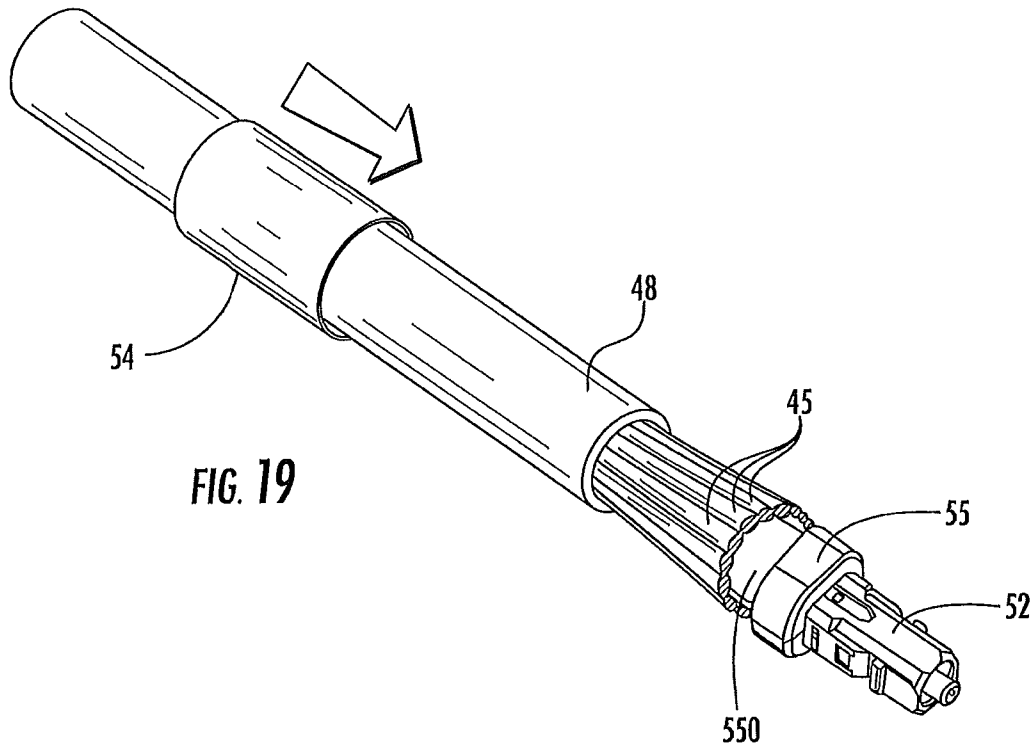

FIG. 78



1

**FEMALE HARDENED OPTICAL
CONNECTORS FOR USE WITH MALE
PLUG CONNECTORS**

PRIORITY

This application claims the benefit of priority under 35 U.S.C. §119 of U.S. Provisional Application Ser. No. 61/769,251 filed on Feb. 26, 2013 the content of which is relied upon and incorporated by reference in its entirety.

BACKGROUND

The disclosure is directed to female hardened optical connectors and cable assemblies using the same. More specifically, the disclosure is directed to female hardened optical connectors used for making an optical connection with a hardened male plug connector.

Optical fiber is increasingly being used for a variety of applications, including but not limited to broadband voice, video, and data transmission. As bandwidth demands increase optical fiber is migrating toward subscribers in outdoor communication networks such as in fiber to the premises applications such as FTTx and the like. To address this need for making optical connections in communication networks for the outside the plant environment hardened fiber optic connectors were developed. One of the most commercially successful hardened fiber optic connectors is the OptiTap® male plug connector sold by Corning Cable Systems, LLC of Hickory, N.C., such as disclosed in U.S. Pat. Nos. 7,090,406 and 7,113,679 (the '406 and '679 patents) and incorporated herein by reference. The Optitap® connector is a hardened male plug connector for terminating a cable that is configured for optical connection using a receptacle. As used herein, the term "hardened" describes a connector or receptacle port intended for making an environmentally sealed optical connection suitable for outdoor use, and the term "non-hardened" describes a connector or receptacle port that is not intended for making an environmentally sealed optical connection.

FIGS. 1A-1C are prior art depictions showing various stages of mating of a preconnectorized cable **10** having an OptiTap® male plug connector with a receptacle **30**. Receptacle **30** that receives the OptiTap® male plug connector has a first end (not visible) that receives a standard SC connector (i.e., a non-hardened receptacle port) and a second end (visible) having a hardened receptacle port for receiving the OptiTap® male plug connector, thereby making an optical connection between a hardened connector and a non-hardened connector. Receptacle **30** typically is mounted in a wall of an enclosure or the like with a first end typically disposed inside an enclosure for environmental protection and the second end extends outward of the enclosure for connectivity. Simply stated, receptacle **30** has a first side with a non-hardened receptacle port and a second side with a hardened receptacle port for receiving the OptiTap® male plug connector. Thus, receptacle **30** can optically connected the hardened OptiTap® male plug connector with a non-hardened connector such as a standard SC connector. Consequently, a network operator can make an optical connection between a robust outdoor fiber optic cable assembly to a less robust indoor cable assembly as known in the art.

Due to installation space available, right-of-way, complexity issues and the like, some installations require network providers to provide third party access to an existing network so the subscriber may choose among network operators (i.e., a multi-operator option), instead of running

2

entirely new cabling to the subscriber. Thus, a third party operator may need to connect a new subscriber to their network who already has an existing drop cable installed and routed to the premises of the subscriber. Consequently, there exists an unresolved need for hardened cable assemblies that can connector subscribers to third party network operators in a quick and reliable manner.

SUMMARY

The disclosure is directed to female hardened fiber optic connectors including a connector assembly, a body having first shell and a second shell for securing the connector assembly at a front end of the shells and a cable attachment region rearward of the front end, a connector sleeve having a passageway between a first end and a second end along with one or more connector sleeve orientation features and a female coupling housing. The female coupling housing has an opening with an internal attachment feature along with one or more coupling housing orientation features that cooperate with the one or more connector sleeve orientation features. The female hardened fiber optic connectors can be mated directly to a male hardened connector such as the OptiTap male plug connector.

The disclosure is also directed to a hardened fiber optic connector assembly including a fiber optic cable having at least one optical fiber and a female hardened fiber optic connector attached to the at least one optical fiber of the fiber optic cable. The female hardened fiber optic connector includes a connector assembly having a crimp body with a first shell and a second shell for securing a connector assembly at a front end of the shells and a cable attachment region rearward of the front end, a connector sleeve having a passageway between a first end and a second end and including one or more connector sleeve orientation features along with an orientation rail disposed within the passageway, and a female coupling housing having an opening with an internal attachment feature along with one or more female coupling housing orientation features that cooperate with the one or more connector sleeve orientation features for aligning the connector sleeve inside the female coupling housing.

The disclosure is further directed to a method of making a hardened fiber optic connector assembly, comprising the steps of providing a fiber optic cable having at least one optical fiber, providing a female hardened fiber optic connector that includes a connector assembly with a crimp body having a first shell and a second shell for securing the connector assembly at a front end of the shells and a cable attachment region rearward of the front end, providing a connector sleeve having a passageway between a first end and a second end and that includes one or more connector sleeve orientation features, attaching the at least one optical fiber to the connector assembly, securing the connector assembly between the first shell and second shell, and placing the connector assembly, crimp body and connector sleeve into a female coupling housing.

Additional features and advantages will be set forth in the detailed description which follows, and in part will be readily apparent to those skilled in the art from that description or recognized by practicing the same as described herein, including the detailed description that follows, the claims, as well as the appended drawings.

It is to be understood that both the foregoing general description and the following detailed description present embodiments that are intended to provide an overview or framework for understanding the nature and character of the

claims. The accompanying drawings are included to provide a further understanding of the disclosure, and are incorporated into and constitute a part of this specification. The drawings illustrate various embodiments and together with the description serve to explain the principles and operation.

BRIEF DESCRIPTION OF THE FIGURES

FIGS. 1A-1C show portions of a conventional preconnectorized fiber drop cable having an OptiTap® male plug connector being inserted into and connected with a conventional receptacle;

FIG. 2 is a partially exploded view of a preconnectorized cable assembly using the conventional OptiTap® male plug connector of FIGS. 1A-1C;

FIG. 3 is a simplified schematic of a portion of an optical network showing a preconnectorized female hardened connector that is suitable for optical connection with the conventional OptiTap® male plug connector;

FIG. 4 is a close-up side view of a female hardened connector attached to a fiber optic cable according to the concepts disclosed herein;

FIG. 5 is an exploded view of the female hardened connector of FIG. 4;

FIG. 6 is a cross-sectional view of the assembled female hardened connector depicted in FIGS. 4 and 5;

FIG. 7 is a cross-sectional view of the connector sleeve of the female hardened connector depicted in FIG. 5;

FIGS. 8 and 9 respectively are a front view and a front perspective view of the connector sleeve of the female hardened connector of FIGS. 4 and 5;

FIG. 10 is a rear perspective view of the connector sleeve of the female hardened connector of FIGS. 4 and 5;

FIG. 11 is a perspective view of the female coupling housing of the female hardened connector of FIGS. 4 and 5;

FIGS. 12 and 13 respectively are a front end view and a front perspective view of the female coupling housing of FIG. 11;

FIG. 14 is a perspective cut-away assembled view of the assembled female hardened connector of FIGS. 4 and 5 with the dust cap removed;

FIG. 15 is a cross-sectional view showing the female hardened connector of FIG. 4 connected to the conventional OptiTap® male plug connector;

FIG. 16 is a partial perspective view showing the orientation between a portion of the connector sleeve and the connector assembly of the female hardened connector; and

FIGS. 17-19 depict different methods for attaching strength members of fiber optic cables to the crimp body for making cable assemblies.

DETAILED DESCRIPTION

Reference will now be made in detail to the embodiments of the disclosure, examples of which are illustrated in the accompanying drawings. Whenever possible, like reference numbers will be used to refer to like components or parts.

The female hardened fiber optic connectors and cable assemblies described herein are suitable for making optical and/or optical-electrical connections (if electrical connections are included in the connectors) to a conventional male hardened connector such as the OptiTap® male plug connector. Although the concepts disclosed herein are explained with respect to a female hardened fiber optic connector used for optical connection with an OptiTap connector, the concepts disclosed may be used with other hardened connectors and are not limited to this particular optical connection. The

concepts of the disclosure advantageously allow the simple, quick, and economical cable assemblies for deployment by the craft in the field so a subscriber with an existing drop cable may be connected to a third party network for service or the like. Reference will now be made in detail to the embodiments, examples of which are illustrated in the accompanying drawings. Whenever possible, like reference numbers will be used to refer to like components or parts.

FIG. 2 depicts a partially exploded view of a preconnectorized cable assembly 10 having the conventional OptiTap® male plug connector 50 depicted in FIGS. 1A-1C for attachment to cable 40'. Fiber optic cable 40' is disclosed in U.S. Pat. No. 6,542,674, the contents of which are incorporated herein by reference. Conventional male plug connector 50 includes an industry standard SC type connector assembly 52 having a connector body 52a, a ferrule 52b in a ferrule holder (not numbered), a spring 52c, and a spring push 52d. Conventional male plug connector 50 also includes a crimp assembly (not numbered) that includes a crimp housing having at least one shell 55a and a crimp band 54, a shroud 60 having one or more O-rings 59, a coupling nut 64 having external threads, a cable boot 66, a heat shrink tube 67, and a protective cap 68 secured to boot 66 by a wire assembly 69. Male plug connector 50 is a typical hardened connector used for drop cable assemblies to subscribers.

FIG. 3 depicts a simplified schematic showing a portion of a multi-operator optical waveguide network 1 in an exemplary fiber to the location 'x' (FTTx). 'x' in the acronym represents the end location of the optical waveguide, for instance, FTTC is fiber to the curb. In this case, the network 1 is a fiber to the premises (FTTP) application. FTTP architectures advantageously route at least one optical waveguide to the premises, thereby providing a high bandwidth connection to the subscriber. Moreover, applications to locations other than to the curb or premises are also possible. Downstream from a central office CO, network 1 includes one or more links that connect to a network access point (NAP) in the network such as an aerial closure (such as depicted in the rectangle), multiport, or the like. As shown, drop link comprises a preconnectorized fiber optic drop cable 10 (hereinafter preconnectorized cable) suitable for outdoor environments that is routed to the NAP of a first service provider for optical connection. The NAP typical uses a receptacle having a first side with a hardened receptacle port that extends externally of NAP and a second side having a non-hardened receptacle port that extends within the NAP and is protected from the outdoor environment. However, a subscriber may wish to receive service from a different (i.e., second) service provider (i.e., a competitor installation) using the existing drop cable running to the premises, instead of the first service provider. Consequently, the OptiTap® male plug connector 50 of the drop link needs to be connected to a suitable interface. The concepts of the present application provide a female hardened optical connector 150 along with preconnectorized cable assemblies using the female hardened connector that efficiently and economically streamlines the deployment and installation for multi-operator solutions into the last mile of the fiber optic network such as to the premises so that the craft can easily change service providers. Although, network 1 shows a simplified configuration of one type of FTTx architecture, other networks can employ the concepts disclosed herein. Other networks may include other suitable components such as distribution closures, amplifiers, couplers, transducers, or the like. Likewise, other networks besides FTTx architectures can also benefit from the concepts disclosed.

5

As shown, FIG. 3 depicts preconnectorized cable assemblies 10 having conventional male plug connectors 50 as drop cable assemblies for optical connection to subscribers 5. For multi-operator networks, the third party operator may need to connect to an existing conventional male plug connector 50. The present application discloses female hardened connectors 150 suitable for optical connection with the male hardened connector 50 of preconnectorized cable assembly 10.

As depicted by FIG. 3, the third party operator may only have access to connect the new subscriber by making the optical connection with the existing male hardened connector that is already routed to the subscriber. In other words, the drop cable to the subscriber is disconnected (i.e., unplugged) from the first network operated by a first network operator at a NAP terminal such as a multi-port or aerial disclosure. Thereafter, if the subscriber wishes to use a different third-party network operator to provide new service they must connect to the existing drop due to right-of-way, convenience, or other concerns.

FIG. 4 is side view of a preconnectorized cable assembly having a female hardened connector 150 attached to a fiber optic cable 40', thereby forming a hardened fiber optic cable assembly 100. Female hardened connector 150 also has a dust cap 148 attached thereto via a female coupling housing 164. Consequently, the female hardened fiber optic cable assembly 100 may be optically coupled with an OptiTap® male plug connector if a change in service providers is desired. Simply stated, the existing drop link 10 of FIG. 3 may be disconnected from the NAP or other location and then the hardened male plug such as the OptiTap® male plug connector 50 or the like may be optically connected to the female hardened cable assembly 100 having the female hardened connector 150 of the present application by removing dust cap 148 and then directly attaching male plug connector 50. Stated another way, the female coupling housing 164 is sized for receiving the male OptiTap plug connector 50 within the front end opening for direct optical mating. Female hardened connector 150 has a relatively small form factor and aligns the male plug connector 50 in the proper orientation so it may only mates in one direction. Further, the optical coupling between the female hardened connector 50 and the male OptiTap plug connector 50 is environmentally sealed.

FIG. 5 is an exploded view and FIG. 6 is a cross-sectional view of the female hardened connector 150 of FIG. 4. Female hardened connector 150 includes connector assembly 52, a crimp body 55 having at least one shell 55a (as shown two shells 55a that form the crimp body) and an optional crimp band (not shown), a connector sleeve 136, a female coupling housing 164, along with a cable boot 66, and a heat shrink tube 67. For complexity reduction and simplification, the female hardened connector 150 can use many of the same parts as the OptiTap® male plug connector 50 or other standard parts as desired; however, certain components are specific female hardened connector 150. By way of example, female hardened connector 150 includes an industry standard SC type connector assembly 52 or the like having a connector body 52a, a ferrule 52b in a ferrule holder (not numbered), a spring 52c, and a spring push 52d, like to the OptiTap® male plug connector. Although, the term crimp body is used the body does not require crimp or crimp band and may use other securing means such as adhesive or the like for securing the shells 55a together. The connector may also include a dust cap 148, but other suitable configurations are possible using fewer or more components. For instance, female hardened connector 150 may

6

also include an optional lanyard for the dust cap 148 as desired so it is prevented from being lost or separated from the assembly.

Generally speaking, most of the components of female plug connector 150 are formed from a suitable polymer, but other materials such as metal are possible. In one example, the polymer is a UV stabilized polymer such as ULTEM 2210 available from GE Plastics if the component is exposed to the elements; however, other suitable polymer materials are possible. For instance, stainless steel or any other suitable metal may be used for various components as desired.

FIGS. 7-10 are various views of connector sleeve 136. Specifically, FIG. 7 is a cross-sectional view of connector sleeve 136 and FIGS. 8 and 9 respectively are front and perspective views of connector sleeve 136. FIG. 10 is a rear perspective view of the connector sleeve 136. Connector sleeve 136 may be formed as a single component or formed as an assembly of more than one component. In this embodiment, connector sleeve 136 is formed from several components, thereby making the features of the connector sleeve easier manufacture.

As shown in FIG. 7, connector sleeve 136 has a through passageway from a first end 131 to a second end 132 for receiving and aligning respective ferrules of the male plug connector 50 and the female hardened connector 150 when mated. Specifically, when assembled, connector sleeve 136 fits within female coupling housing 164 and is used for aligning ferrule 52b of the female hardened plug connector 150 with the corresponding ferrule of the male plug connector 50. As best shown in FIG. 7, connector sleeve 136 includes a body 133, an alignment sleeve 135, and a cap 137. As depicted, alignment sleeve 135 has a portion disposed within body 133 and is secured therein by cap 137. Specifically, a flange (not numbered) of alignment sleeve 135 is aligned to body 133 using a recess portion of body 133 and cap 137 is attached to the body 133 for capturing and securing the flange of the alignment sleeve 135 between the body 133 and cap 137.

In addition to the connector sleeve 136 having a passageway 136a between the first end 131 and the second end 132 it also includes one or more connector sleeve orientation features. Connector sleeve orientation features can have many different suitable constructions such as lugs, tabs, openings, etc. for cooperating with the one or more female coupling housing orientation features on the female coupling housing. In the embodiment illustrated, connector sleeve 136 includes a first lug and a second lug for fitting the connector sleeve 136 into the female coupling housing 164. Stated another way, connector sleeve 136 fits into female coupling housing 164 in only one orientation using first tab 136b and second tab 136c having different shapes as discussed below.

As best shown in FIG. 10, connector sleeve 136 optionally includes an orientation rail 139 for allowing connector assembly 52 of female hardened plug connector 150 to be assembled into the connector sleeve 136 in only a single orientation. As shown in FIG. 16, orientation rail 139 has a profile that only allows a narrow end of connector body 52a to abut the orientation rail 139 during assembly.

FIGS. 11-13 depict various views of female coupling housing 164. Specifically, FIGS. 11 and 12 respectively are perspective and front view of the female coupling housing 164 and FIG. 13 is perspective view looking into the front end opening for showing details inside the female coupling housing 164. Female coupling housing 164 has an elongate structure with a passageway 163 extending from the opening

at a front end **161** to a rear end **162** and sized so that the shroud **60** of OptiTap male plug connector **50** fits into the front end **161** of passageway **163** when properly aligned. Consequently, male plug connector **50** may be directly mated with the female hardened connector **150** for making an optical connection therebetween such as shown in FIG. **15**. As shown, female coupling housing **164** includes a first portion at the front end that necks down to a second portion at the rear end. The first portion includes the internal attachment feature such as internal threads **165** that cooperate directly with the complimentary external threads of male plug connector **50**. Once the male plug connector **50** is attached to the female hardened connector **150** the assembly is suitable for making an optical connection therebetween such as for a third-party network operator to provide service over a previously installed drop cable.

Female coupling housing **164** includes features for aligning and securing connector sleeve **136** along with alignment features for correctly orientating male plug connector **50**. As depicted, female coupling housing **164** includes a stop ledge **164a** integrally formed in a side wall (i.e., disposed on the side wall) that is disposed rearward of internal threads **165**. Stop ledge **164a** is configured so that it only allows the shroud **60** of male plug connector **50** to fully seat within the female coupling housing **164** in one orientation for keying the optical coupling. In other words, the shroud **60** of the OptiTap male plug connector **50** has alignment fingers having different shapes and the stop ledge **164a** only allows the male plug connector **50** to fully seat for optical coupling in one orientation by preventing insertion of the larger alignment finger into the female coupling housing **164** past the stop ledge **164a**. Female coupling housing **164** also includes a shelf (not numbered) within the passageway and disposed rearward of the stop ledge **164a**. Shelf **164d** has a complementary shape for receiving connector sleeve **136** and includes a first retention feature **164b** and a second retention feature **164c**. Shelf **164d** has a generally rectangular shape that cooperates with the generally rectangular shape of connector sleeve **136** so that it fits within the passageway of female coupling housing **164**. As best shown in FIG. **13**, first retention feature **164b** and second retention feature **164c** have different sizes that cooperate with tabs **136b**, **136c** disposed on connector sleeve **136** so that it may only fully seat into shelf **164d** in one orientation. Further, the stop ledge **164a** has a specific orientation relative to first retention feature **164b** and second retention feature **164c**.

FIG. **14** is a perspective cut-away assembled view of female hardened connector **150** with the dust cap removed for showing assembly details. When fully assembled the crimp body **55** fits into female coupling housing **164** and is keyed to direct the insertion of the same into the coupling housing **164** in the correct orientation. In this case, shells **55a** include planar surfaces on opposite sides of crimp body **55** to inhibit relative rotation between crimp body **55** and female coupling housing **164**. In other embodiments, the crimp body **55** may be keyed to the female coupling housing **164** using other configurations such as a complementary protrusion/groove or the like.

Rear end **162** of coupling housing **164** includes second portion (not numbered). The second portion is used for securing heat shrink tubing **67** for providing environmental protection between the coupling housing **164** and the fiber optic cable **40'** and weatherproofing the preconnectorized cable assembly. The other end of heat shrink tubing **67** is disposed about a portion of the cable jacket, thereby inhibiting water from entering female hardened connector **150**. Further, the second portion allows for the attachment of boot

66 to the rear end **162** of coupling housing **164**. After the heat shrink tubing **67** is attached, boot **66** may be slid over heat shrink tubing **67**. Specifically, boot **66** may be positioned over the shrink tubing **67** at rear end **162** of female coupling housing **164** for providing further bending strain relief for the cable assembly.

Boot **66** may be formed from a flexible material such as KRAYTON or the like. Heat shrink tubing **67** and boot **66** generally inhibit kinking and provide bending strain relief to the cable **40'** near female hardened connector **150**. Boot **66** has a longitudinal passageway (not visible) and may have a stepped profile therethrough. The first end of the boot passageway is sized to fit over the heat shrink tubing **67**. The first end of the boot passageway has a stepped down portion sized for cable **40'** or other suitable cable that may be used and the heat shrink tubing **67** and acts as stop for indicating that the boot is fully seated. Dust cap **68** has external threads for engaging the internal threads of female coupling housing **164** for attachment and thereby inhibit dirt and debris from entering the female hardened connector **150** via the front end **161** of female coupling housing **164**. Moreover, the cap may include an O-ring for providing a weatherproof seal between female hardened connector **150** and dust cap **68** when installed.

FIG. **15** is a cross-sectional view showing the female hardened connector **150** mated to the OptiTap® male plug connector **50**. As shown, the shroud **60** of the OptiTap male plug connector **50** has alignment fingers having different shapes and when mated the stop ledge **164a** only allows the male plug connector **50** to fully seat for optical coupling in one orientation by preventing insertion of the larger alignment finger into the female coupling housing **164** past the stop ledge **164a**. In one embodiment, the correct mating orientation is marked on the female coupling housing **164** such as an alignment indicia so that the craftsman can quickly and easily mate preconnectorized cable **100** with the male plug connector **50**. For instance, the alignment indicia may be an arrow or dot molded into the female coupling housing **164**, however, other suitable indicia may be used. Thereafter, the craftsman engages the internal attachment feature **165** such as internal threads of female coupling housing **164** with the complimentary external threads of male plug connector **50** as best shown in FIG. **6** for making the optical connection shown in FIG. **15**.

FIG. **16** is a partial perspective view showing a portion of the connector sleeve **136** having a connector assembly **52** disposed therein. Specifically, FIG. **16** shows body **133** of connector sleeve **136** having connector assembly **52** inserted therein. More specifically, a narrow side of connector body **52a** of connector assembly **52** abuts the orientation rail **139** of body **133**. Stated another way, orientation rail **139** of body **133** only allows connector assembly **52** to be orientated in one position for assembly. Likewise, the orientation features such as first tab **136b** and second tab **136c** of connector sleeve **136** only allow the connector sleeve **136** to be orientated in one position for assembly with the female coupling housing **164** having the cooperating female coupling housing orientation features **164b**, **164c**. Further, the edge stop feature of **164a** of female coupling housing **164** only allows the shroud **60** of the OptiTap male plug connector **50** to fully seat with the female hardened fiber optic connector **150** for optical coupling in one orientation by preventing insertion of the larger alignment finger into the female coupling housing **164** past the stop ledge **164a**. Consequently, the respective connector assemblies **52** of

OptiTap male plug connector **50** and female hardened fiber optic connector **150** are arranged in the same predetermined relationship.

Preconnectorized cable **100** may have any suitable length desired; however, preconnectorized cable **100** can have standardized lengths. Moreover, preconnectorized cable **100** may include a length marking indicia for identifying its length. For instance, the length marking indicia may be a marking located on the cable such as a colored stripe or denoted in a print statement. Likewise, the length marking indicia may be a marking located on female hardened connector **150**. In one embodiment, length marking indicia may be denoted by a marking on female coupling housing **164** such as a colored stripe. In any event, the length marking indicia should be easily visible so the craftsman may identify the preconnectorized cable length. By way of example, a red marking indicia on female coupling housing **164** denotes a length of about 50 feet while an orange marking indicia denotes a length of about 100 feet.

The described explanatory embodiment provides an optical connection that can be made in the field between a conventional OptiTap® male plug connector **50** and the female hardened connector **150** disclosed herein without any special tools, equipment, or training. Additionally, the optical connection is easily connected or disconnected by merely mating or unmating the connector on the ends of preconnectorized cable **10** with the female hardened connector assembly **100** by threadably engaging or disengaging the coupling nut on the OptiTap® male plug connector **50** with the attachment features **165** such as internal threads of the female coupling housing of the female hardened connector **150**. Thus, the female hardened connectors disclosed allow deployment of a third party network provider to an existing cable assembly having an OptiTap® male plug connector of the subscriber such as in fiber to the location ‘x’ in an easy and economical manner, thereby providing the end user with an option among service providers. Furthermore, the concepts disclosed can be practiced with other fiber optic cables, connectors and/or other preconnectorized cable configurations.

FIGS. **17-19** depict different methods for attaching tensile elements of fiber optic cables to the crimp body **55** for making cable assemblies using female hardened connector **150**. The female hardened connectors **150** disclosed herein are advantageous since they may connectorized various different types of cable constructions such as flat cables or round cables that may have different types of tensile elements. As used herein, the term “strength component” means the strength element has anti-buckling strength, while the term “strength member” means the strength element lacks anti-buckling strength. Furthermore, the term “tensile element” means either a strength component or a strength member. An example of a strength component is a glass-reinforced plastic (GRP) rod and an example of a strength member is a tensile yarn such as Kevlar® or the like.

FIGS. **17** and **18** depict fiber optic cable **40'** having one or more strength components **44** such as GRP rods disposed between a first shell **55a** and a second shell **55a** of crimp body **55**. As shown, cable **40'** has the optical fiber attached to the connector assembly **52** and is positioned within a first shell **55a**. In this explanatory embodiment, cable **40'** has a generally flat construction, but may have oval, trilobal or other suitable shapes with an optical component **42** having strength components **44** disposed on opposite sides of the optical component **42**, which are generally surrounded by a cable jacket **48**. As best shown in FIG. **17**, shells **55a** have recesses or passageways for receiving the strength compo-

ponents **44** therein and a first end for securing connector assembly **52** therebetween. The alignment of shells **55a** is accomplished by one or more pins **57c** that fit within one or more complementary bores **57d** that may be formed in the shells **55a** or the pins may be discrete components as desired. In advantageous embodiments, the shells can be symmetrical so only one mold is needed for making both shells. FIG. **18** depicts both shells disposed about the strength components **44** of cable **40'**. Shells **55a** may be secured in any suitable manner such as by a crimp band **54** and/or adhesive as desired. Shells **55a** may also include one or more bores **56d** so that excess adhesive may escape if used for securing the crimp body **55**. As shown, the optional crimp band **54** is slid onto cable **40'** prior to placing the cable in the shell **55a** and then can be slid over the crimp body as represented by the arrow before being deformed about the crimp body.

FIG. **19** depicts another type of cable construction that may be advantageously preconnectorized with the female hardened connector **150** disclosed herein. The fiber optic cable shown has an optical fiber (not visible) attached to the connector assembly **52**, a plurality of strength members **45** such as Kevlar® or the like, and a cable jacket **48** having a generally round cross-section. As shown, strength members **45** are disposed about an outer barrel **55o** of crimp body **55**. Thereafter, a crimp band **54** may be slid over the strength members **45** as represented by the arrow so that the strength members **45** are attached between outer barrel of the crimp body **55** and the crimp band **54** is deformed to secure the strength members **45**.

Still other cables are possible with the female hardened connector disclosed herein. For instance, cable assemblies disclosed herein may include a fiber optic cable having a subunit surrounded by an upjacketed portion. The subunit includes at least one optical fiber and a plurality of tensile yarns such as Kevlar, fiberglass, or the like disposed within a subunit jacket. In other words, the tensile yarns form a portion of the subunit and are internal to the subunit jacket. The upjacketed portion of fiber optic cable includes strength components such as GRP members having anti-buckling strength disposed about the subunit (i.e., disposed radially outward of the subunit) and within a jacket. In other words, the strength components are disposed on opposite sides of the subunit in a generally linear arrangement. Specifically, the subunit is round and the strength components are disposed on opposite sides of the subunit and jacket has a generally flat profile. Of course, variations on this cable are possible. By way of example, the at least one optical fiber can optionally include a buffer layer with a diameter greater than 250 microns for providing further protection to the optical fiber such as 500, 700 or 900 microns, but other nominal sizes are possible. As another example, the jacket of the upjacketed portion may have other cross-sectional profiles besides generally flat such as round, oval, tri-lobal, etc. Moreover, the female hardened connector may terminate more than one optical fiber.

Using cables with a subunit has advantages. For instance, the subunit of the cable may be broken out from the cable for attaching a second connector to a second end of the subunit. This ability to break-out the subunit and attach a different type of fiber optic connector is advantageous for routing the cable assembly from an indoor location such as the central office and to an outdoor location where a female hardened connector is desired. Simply stated, a portion of subunit is broken-out from the second end of the cable assembly and there is no need to strain-relieve (i.e., attach) the upjacketed portion of the cable since the tensile yarns of the subunit are

11

strain-relieved. Moreover, the subunit provides a much smaller and highly flexible fiber optic cable at the second end of the cable assembly for deployment. Further, any of the embodiments can use any suitable connector assembly such as a SC or a LC connector assembly having a ferrule and a connector housing along with other suitable components.

The strength components of the upjacketed portion are exposed from the upjacketed portion and then disposed between first shell 55a and second shell 55a as described and illustrated. An optional crimp band 54 may be used for securing the shells 55a of crimp body 55 as desired. Additionally, as discussed an adhesive or bonding agent may be used with or without crimp band 54 to attach or secure strength component disposed between shells 55a.

Also, the plurality of tensile yarns of subunit are attached to the crimp body 55. By way of example, some of the plurality of tensile yarns are attached between crimp body and crimp band as discussed herein. In other words, the ends of the tensile yarns are sandwiched/disposed between the outer barrel of the crimp body 55 and crimp band 54 and then the crimp band is secured (i.e., crimped) to strain-relieve the tensile yarns. As desired, the optical fiber of subunit may enter a protective tube at least partially disposed within the crimp body. Simply stated, a buffer layer on optical fiber is threaded through (i.e., enters) a protective tube and at least partially disposed within crimp body 55. Protective tube can have any suitable size, shape and/or length as desired that allows for suitable performance with optical fiber. The buffer layer may also enter the connector assembly 52 as desired, but the subunit jacket does not enter the crimp body 55. Moreover, the geometry of shells 55a of crimp body 55 can be modified for the particular embodiments shown to provide adequate sizing of passageways and the like for the various embodiments.

Although the disclosure has been illustrated and described herein with reference to explanatory embodiments and specific examples thereof, it will be readily apparent to those of ordinary skill in the art that other embodiments and examples can perform similar functions and/or achieve like results. All such equivalent embodiments and examples are within the spirit and scope of the disclosure and are intended to be covered by the appended claims. It will also be apparent to those skilled in the art that various modifications and variations can be made to the concepts disclosed without departing from the spirit and scope of the same. Thus, it is intended that the present application cover the modifications and variations provided they come within the scope of the appended claims and their equivalents.

We claim:

1. A female hardened fiber optic connector, comprising: a connector assembly;
- a crimp body comprising a first shell and a second shell for securing the connector assembly at a front end of the shells and a cable attachment region rearward of the front end;
- a connector sleeve comprising a passageway between a first end and a second end and one or more connector sleeve orientation features; and
- a female coupling housing comprising an opening with an internal attachment feature along with one or more female coupling housing orientation features that cooperate with the one or more connector sleeve orientation features.

12

2. The female hardened fiber optic connector of claim 1, wherein the one or more connector sleeve orientation features are a first tab and a second tab comprising different shapes.

3. The female hardened fiber optic connector of claim 1, wherein the one or more female coupling housing orientation features are a first pocket and a second pocket comprising different shapes.

4. The female hardened fiber optic connector of claim 1, the connector sleeve further including an orientation rail within the passageway.

5. The female hardened fiber optic connector of claim 1, wherein the female coupling housing includes a stop ledge disposed on an inner wall.

6. The female hardened fiber optic connector of claim 1, wherein the female coupling housing is sized for receiving a male OptiTap connector within the opening for optical mating.

7. The female hardened fiber optic connector of claim 1, further including a crimp band.

8. The female hardened fiber optic connector of claim 1, being a portion of a cable assembly further including a fiber optic cable attached to the hardened fiber optic connector.

9. The female hardened fiber optic connector of claim 8, wherein the fiber optic cable includes strength members secured to a cable attachment region.

10. The female hardened fiber optic connector of claim 8, a tensile element of the fiber optic cable being a plurality of tensile yarns attached between an outer barrel of the crimp body and a crimp band or one or more strength components disposed between a first shell and a second shell of the crimp body.

11. The female hardened fiber optic connector of claim 1, wherein the first shell and second shell are secured using a crimp band and/or an adhesive.

12. The female hardened fiber optic connector of claim 8, wherein the fiber optic cable has an optical fiber comprising a buffer layer that enters the crimp body and enters the connector assembly.

13. The female hardened fiber optic connector of claim 8, the cable assembly further includes a boot.

14. A method of making a hardened fiber optic connector assembly, comprising the steps of:

providing a fiber optic cable comprising at least one optical fiber;

providing a female hardened fiber optic connector that includes a connector assembly, a crimp body comprising a first shell and a second shell for securing the connector assembly at a front end of the shells and a cable attachment region rearward of the front end,

providing a connector sleeve comprising a passageway between a first end and a second end and including one or more connector sleeve orientation features;

attaching the at least one optical fiber to the connector assembly;

securing the connector assembly between the first shell and second shell; and

placing the connector assembly, crimp body and connector sleeve into a female coupling housing.

15. The method of claim 14, wherein the one or more connector sleeve orientation features are a first tab and a second tab comprising different shapes.

16. The method of claim 14, the female coupling housing comprising one or more female coupling nut orientation features comprising different shapes for cooperating with the first tab and second tab of the connector sleeve.

13

17. The method of claim 14, the connector sleeve further including an orientation rail within the passageway.

18. The method of claim 14, the female coupling housing further including attaching a stop ledge disposed on an inner wall.

19. The method of claim 14, further including one or more tensile elements in the fiber optic cable and strain-relieving at least some of the tensile elements of the fiber optic cable to the crimp body.

20. The method of claim 19, the one or more tensile elements being a plurality of tensile yarns attached between an outer barrel of the crimp body and a crimp band or one or more strength components disposed between a first shell and a second shell of the crimp body.

21. The method of claim 14, further including inserting a male OptiTap connector into an opening of the female coupling housing for optical mating.

22. A hardened fiber optic connector assembly, comprising:

a fiber optic cable comprising at least one optical fiber; and

a female hardened fiber optic connector attached to the at least one optical fiber of the fiber optic cable, the female hardened fiber optic connector, comprising:

a connector assembly;

14

a crimp body comprising a first shell and a second shell for securing the connector assembly at a front end of the shells and a cable attachment region rearward of the front end;

a connector sleeve comprising a passageway between a first end and a second end and including one or more connector sleeve orientation features, and an orientation rail disposed within the passageway; and

a female coupling housing comprising an opening with an internal attachment feature along with one or more female coupling housing orientation features that cooperate with the one or more connector sleeve orientation features for aligning the connector sleeve inside the female coupling housing.

23. The female hardened fiber optic connector of claim 22, the wherein the fiber optic cable includes one or more tensile elements secured to the cable attachment region.

24. The female hardened fiber optic connector of claim 23, the one or more tensile elements being a plurality of tensile yarns attached between an outer barrel of the crimp body and a crimp band or one or more strength components disposed between a first shell and a second shell of the crimp body.

25. The female hardened fiber optic connector of claim 22, wherein the first shell and second shell are secured using an adhesive and/or a crimp band.

* * * * *