



US009363944B2

(12) **United States Patent**  
**Shaffer**

(10) **Patent No.:** **US 9,363,944 B2**  
(45) **Date of Patent:** **Jun. 14, 2016**

(54) **GRANULAR FERTILIZER DISPENSER APPARATUS**

(71) Applicant: **Eric J. Shaffer**, Clinton, MI (US)

(72) Inventor: **Eric J. Shaffer**, Clinton, MI (US)

(\* ) Notice: Subject to any disclaimer, the term of this patent is extended or adjusted under 35 U.S.C. 154(b) by 0 days.

1,887,334	A *	11/1932	Spaeth	111/130
1,891,565	A *	12/1932	May et al.	222/615
2,242,227	A *	5/1941	Blue, Jr.	111/71
2,279,613	A *	4/1942	Blue	222/272
2,311,726	A *	2/1943	Blue	222/160
2,493,599	A *	1/1950	Schroeder	222/608
2,840,275	A *	6/1958	Liljenberg	222/625
3,187,952	A *	6/1965	Santarelli	222/129
3,270,879	A *	9/1966	De Pauw	B07B 4/02 209/136
4,029,237	A *	6/1977	Miconi	222/614

(Continued)

(21) Appl. No.: **14/460,544**

(22) Filed: **Aug. 15, 2014**

(65) **Prior Publication Data**

US 2014/0352584 A1 Dec. 4, 2014

**Related U.S. Application Data**

(63) Continuation-in-part of application No. 14/058,489, filed on Oct. 21, 2013, now abandoned.

(60) Provisional application No. 61/795,739, filed on Oct. 23, 2012.

(51) **Int. Cl.**  
**A01C 15/02** (2006.01)  
**B65G 65/46** (2006.01)

(52) **U.S. Cl.**  
CPC ..... **A01C 15/02** (2013.01); **B65G 65/46** (2013.01); **Y02P 60/214** (2015.11)

(58) **Field of Classification Search**  
USPC ..... 239/152, 154, 375, 376, 378, 525-532, 239/650, 664; 222/608-628  
See application file for complete search history.

(56) **References Cited**

**U.S. PATENT DOCUMENTS**

915,661	A *	3/1909	Covington	222/616
1,668,516	A *	5/1928	Litchfield	A01C 15/16 239/664

**FOREIGN PATENT DOCUMENTS**

FR	2649586	A1	1/1991
SU	822781		4/1981

**OTHER PUBLICATIONS**

International Search Report, International Application No. PCT/US2013/065861, May 15, 2014.

*Primary Examiner* — Alicia Torres

(74) *Attorney, Agent, or Firm* — Young Basile Hanlon & MacFarlane P.C.

(57) **ABSTRACT**

The fertilizer dispenser is used on a surface area to be treated. The fertilizer dispenser comprises a main body for storing the fertilizer, a rolling mechanism affixed to the main body, and a control mechanism cooperatively engaged with the main body. Tines extending radially from the rolling mechanism enable a targeted site to be exposed prior to fertilization. The rolling mechanism disrupts the surface area to be treated as the fertilizer dispenser apparatus rolls over the surface area to be treated. Then, a trigger mechanism is engaged by the user and a metering auger drops a controlled amount of granular fertilizer. The control mechanism is cooperatively engaged with the main body, the control mechanism enables the user to pinpoint an exact location where the dosage of fertilizer is dropped. Once the fertilizer is dropped, the surface is treated, via a back and forth motion of the rolling mechanism.

**13 Claims, 25 Drawing Sheets**

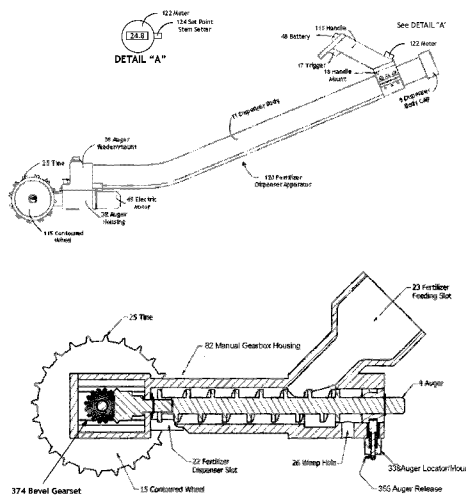

(56)

**References Cited**

U.S. PATENT DOCUMENTS

4,635,818	A *	1/1987	Glass	.....	222/41	6,138,927	A	10/2000	Spear et al.	
5,423,455	A *	6/1995	Ricciardi et al.	.....	222/1	6,450,268	B1 *	9/2002	Taylor	..... 172/354
5,800,116	A *	9/1998	Smith	.....	B60P 1/42	6,810,822	B1 *	11/2004	Chan	..... 111/130
					198/550.1	2003/0062389	A1 *	4/2003	Dopp	..... B29B 15/08
5,842,648	A	12/1998	Havlovitz et al.							..... 222/413
						2009/0014475	A1 *	1/2009	Yapaola et al.	..... 222/383.1
						2011/0061989	A1 *	3/2011	Thompson	..... B65G 33/14
										..... 198/311

\* cited by examiner

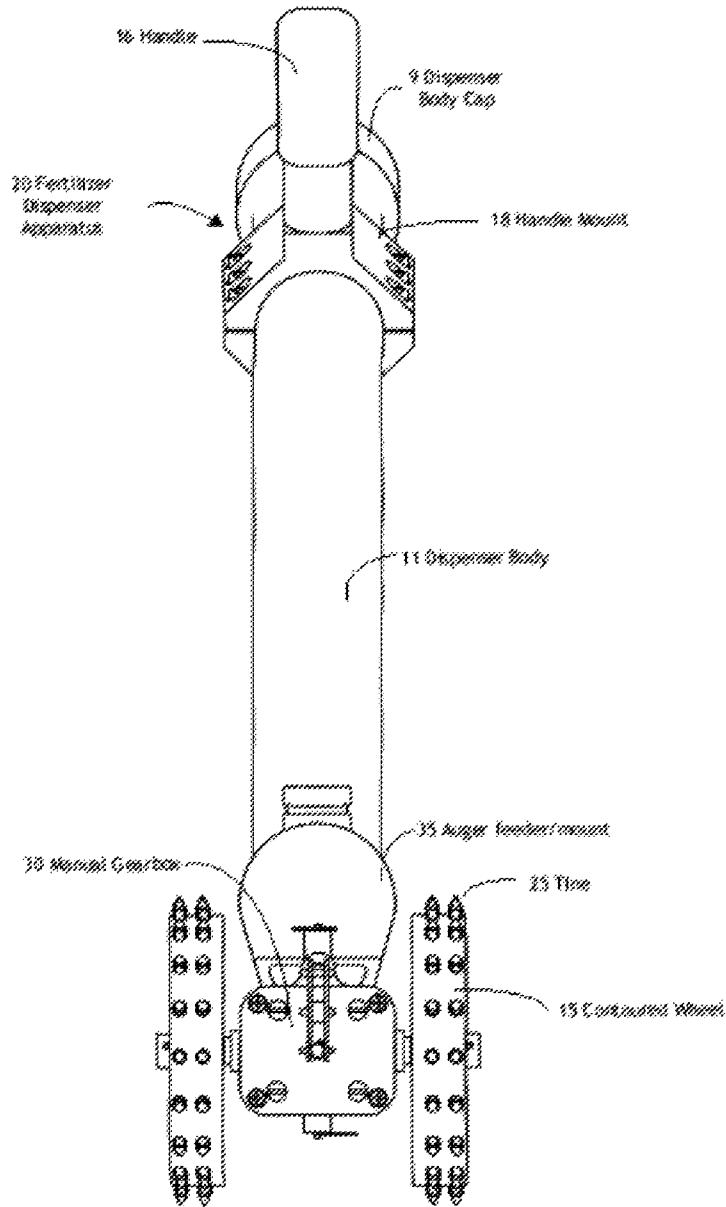

FIGURE 1

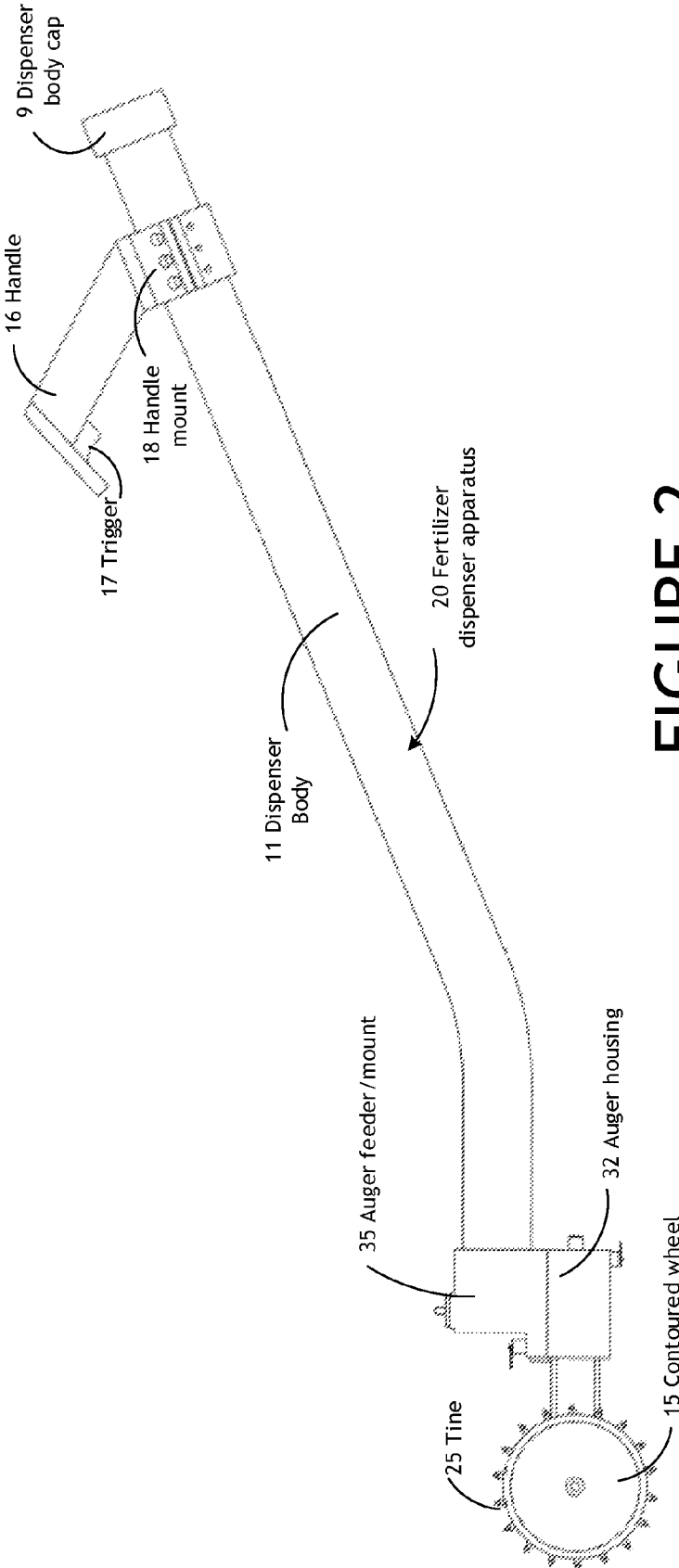

FIGURE 2



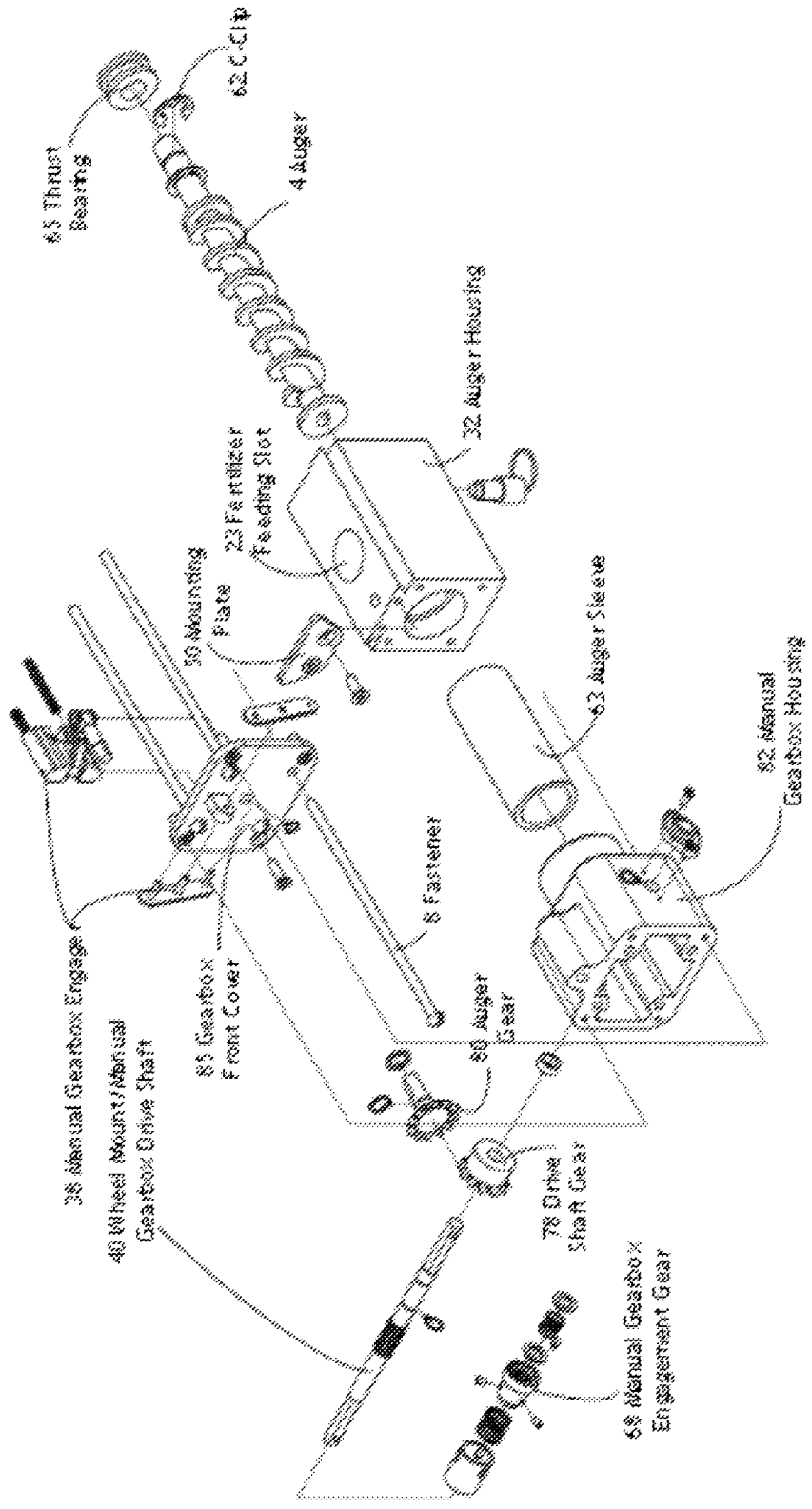

FIGURE 5

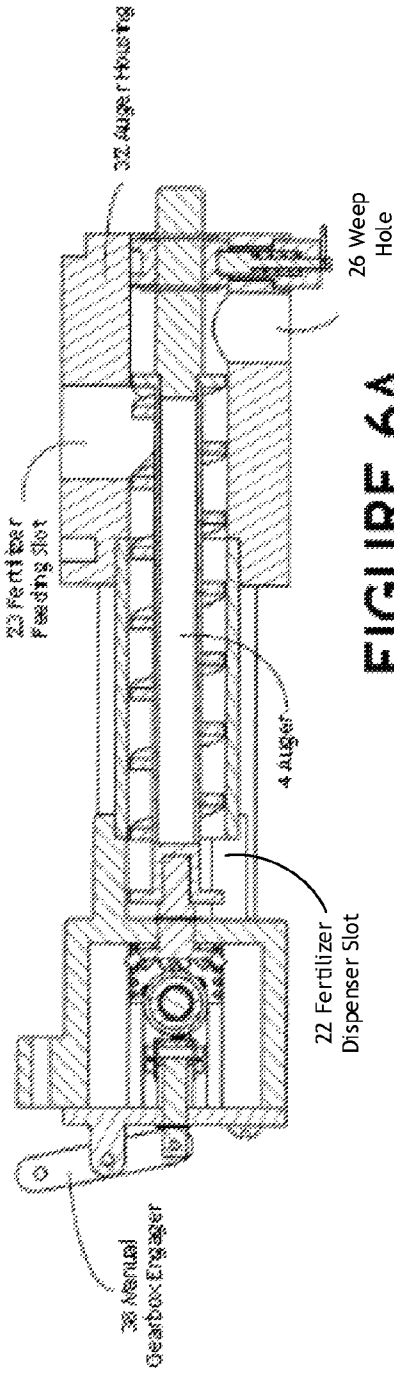

FIGURE 6A

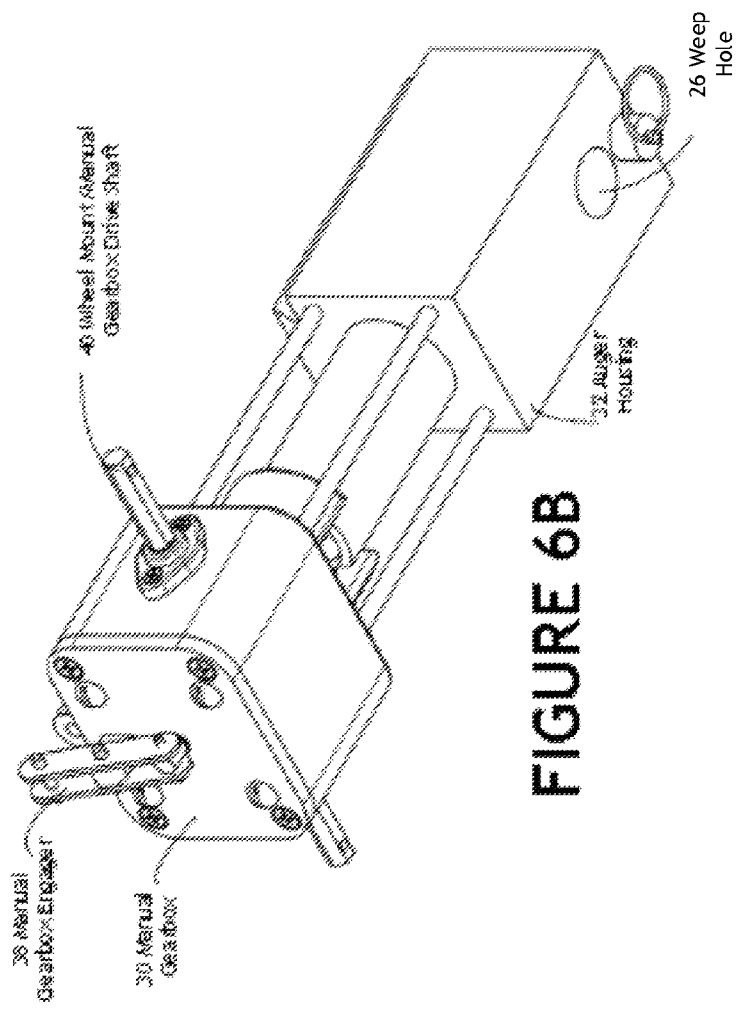

FIGURE 6B

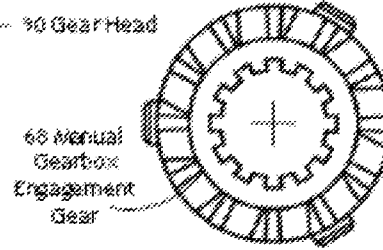
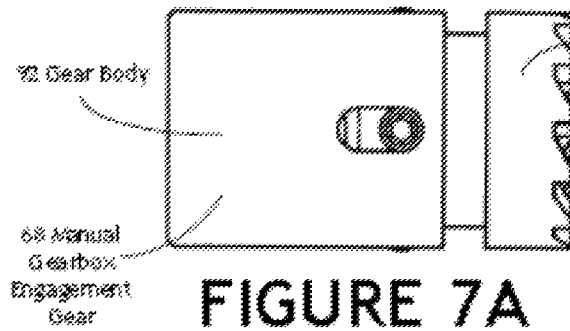

FIGURE 7A

FIGURE 7B

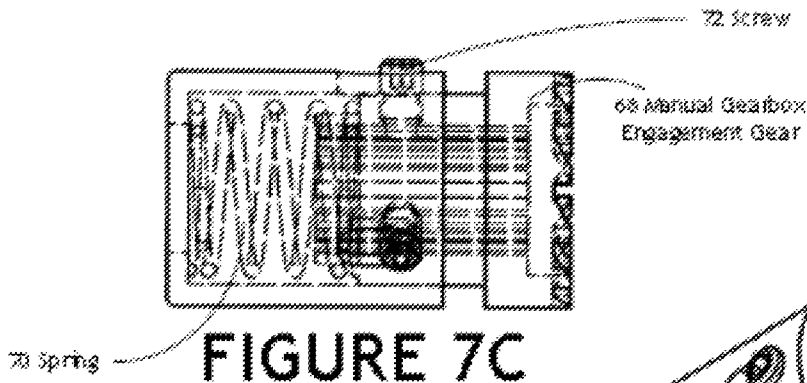

FIGURE 7C

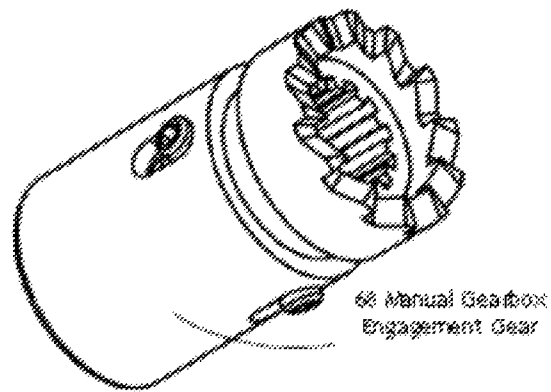

FIGURE 7D

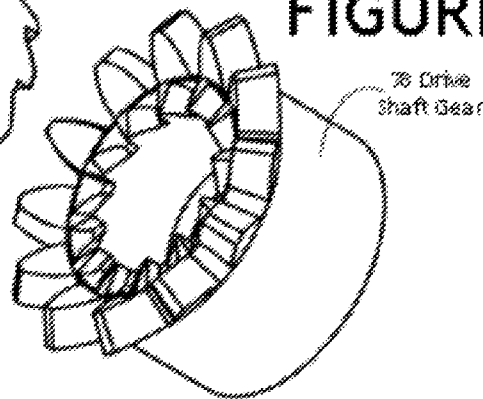
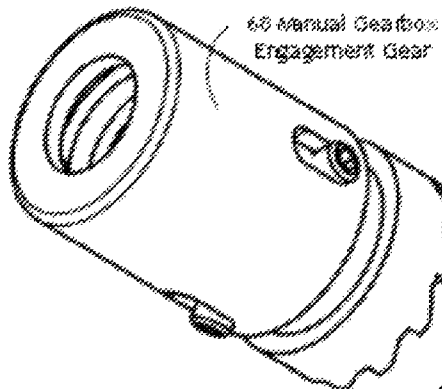
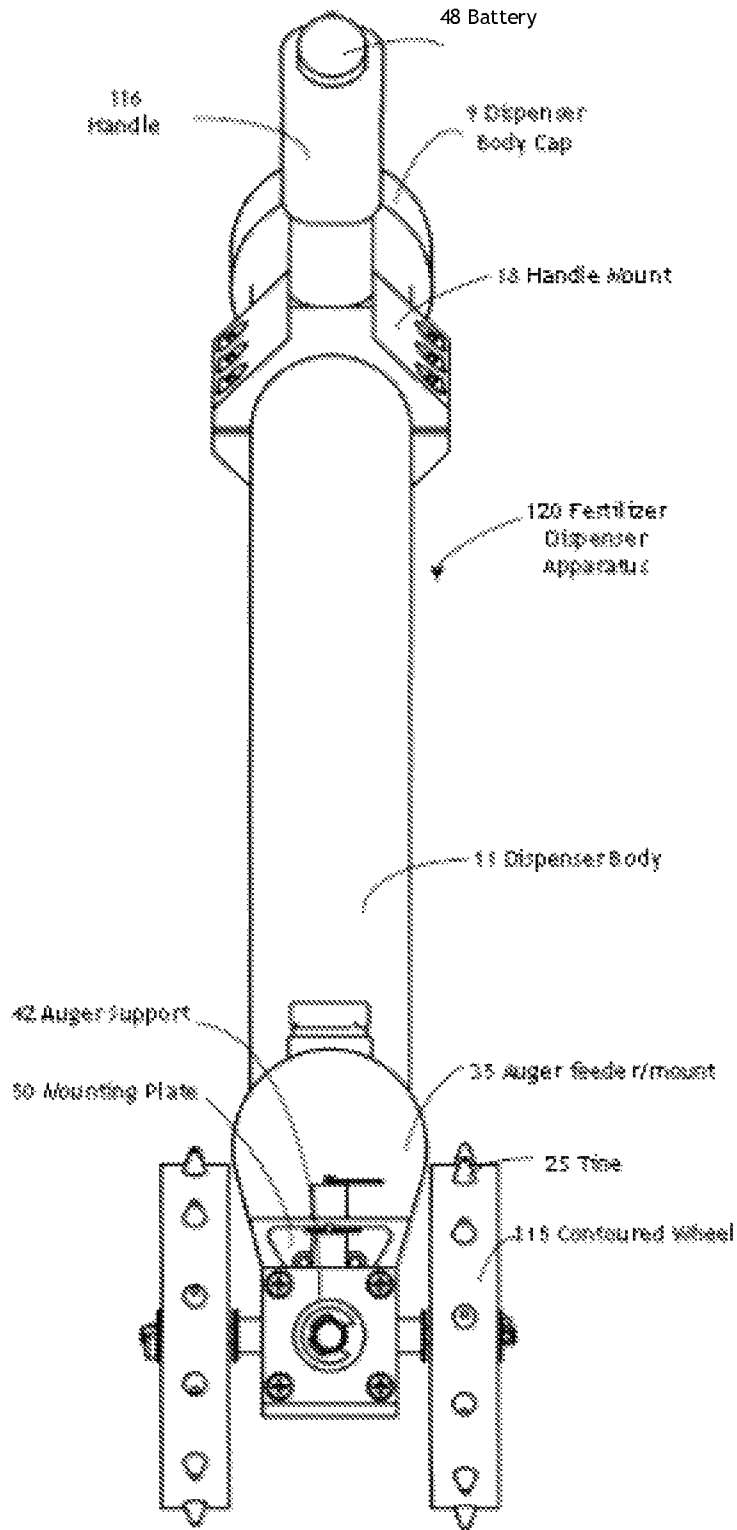

FIGURE 8





**FIGURE 9**

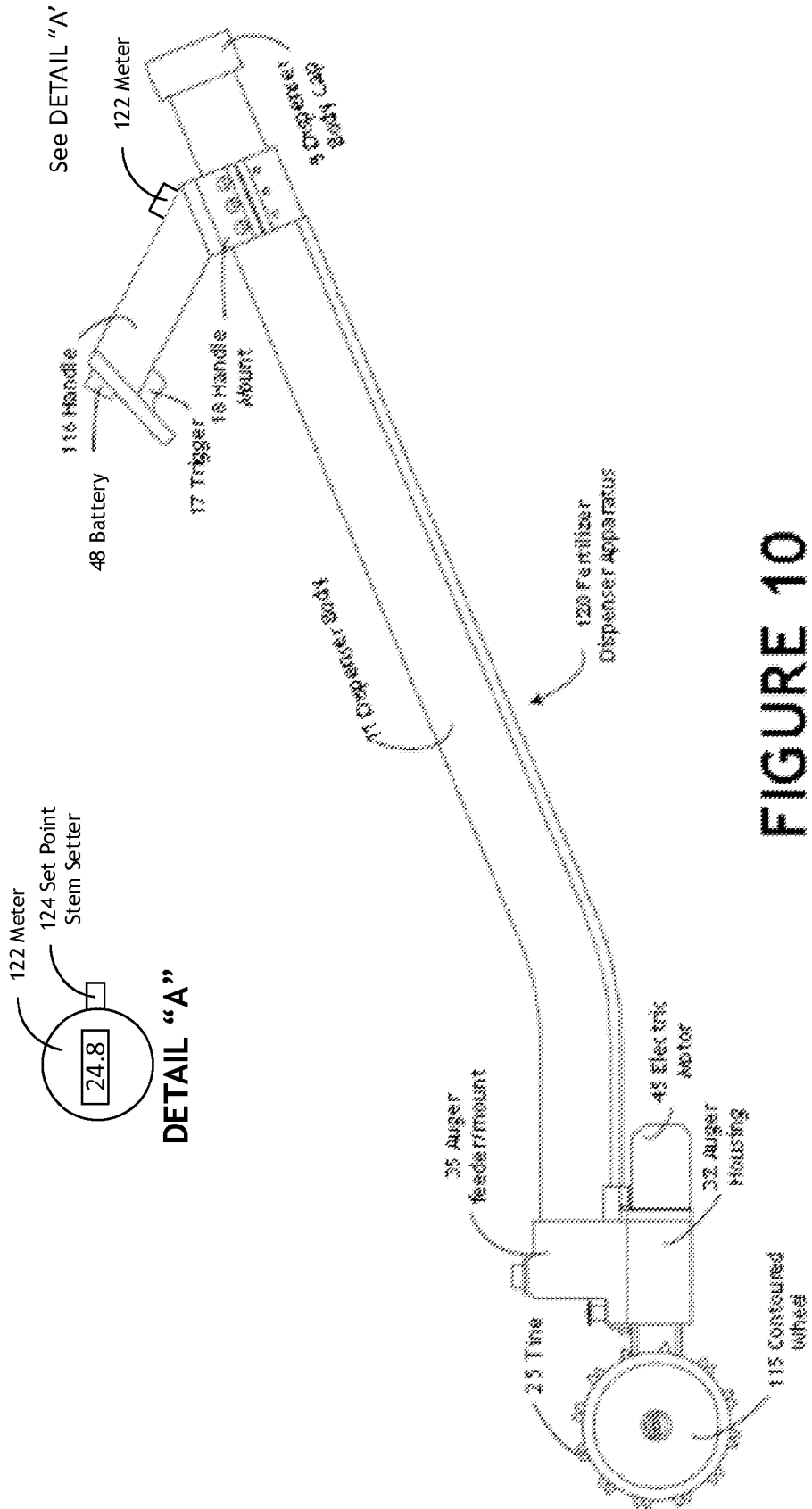

FIGURE 10

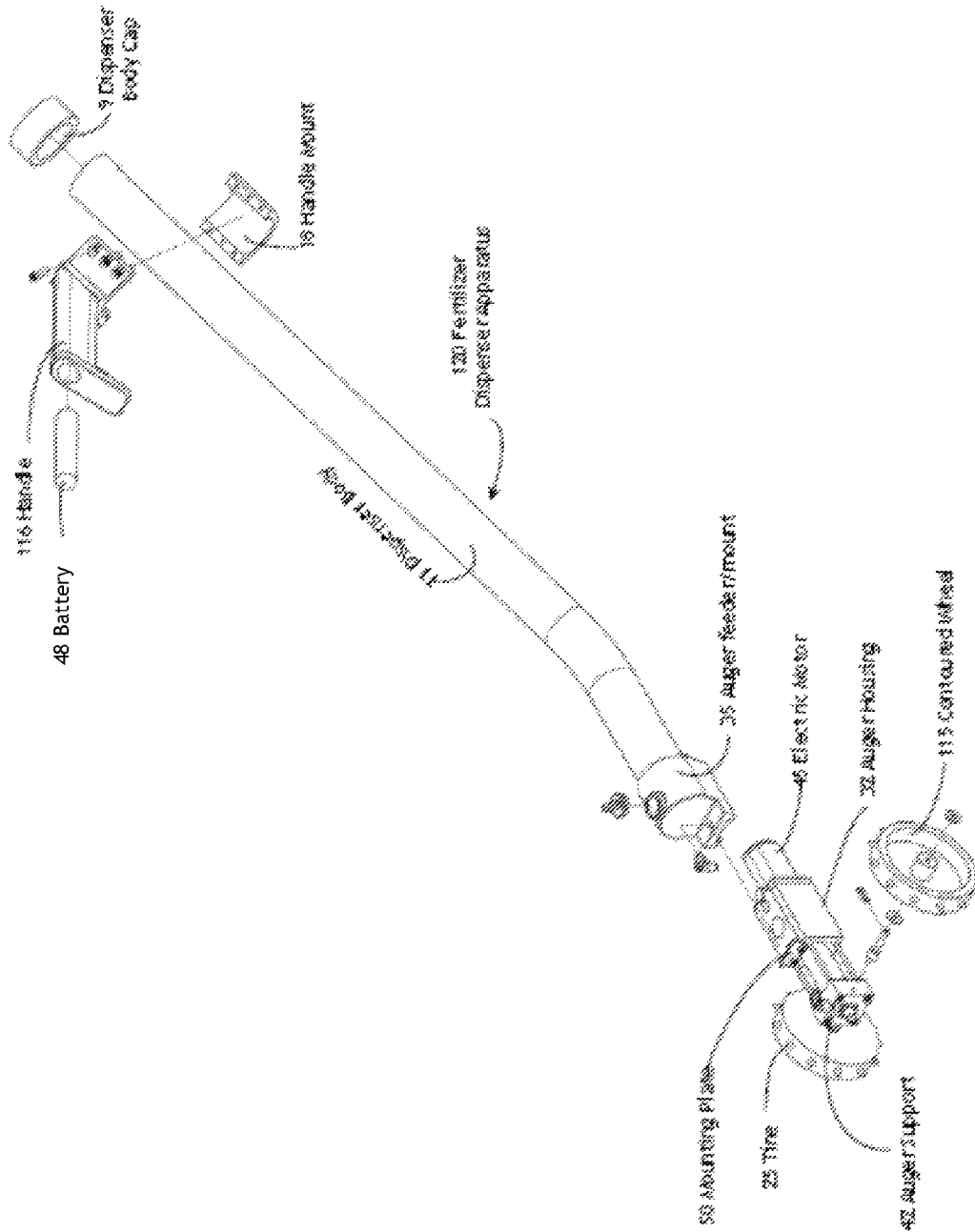

FIGURE 11

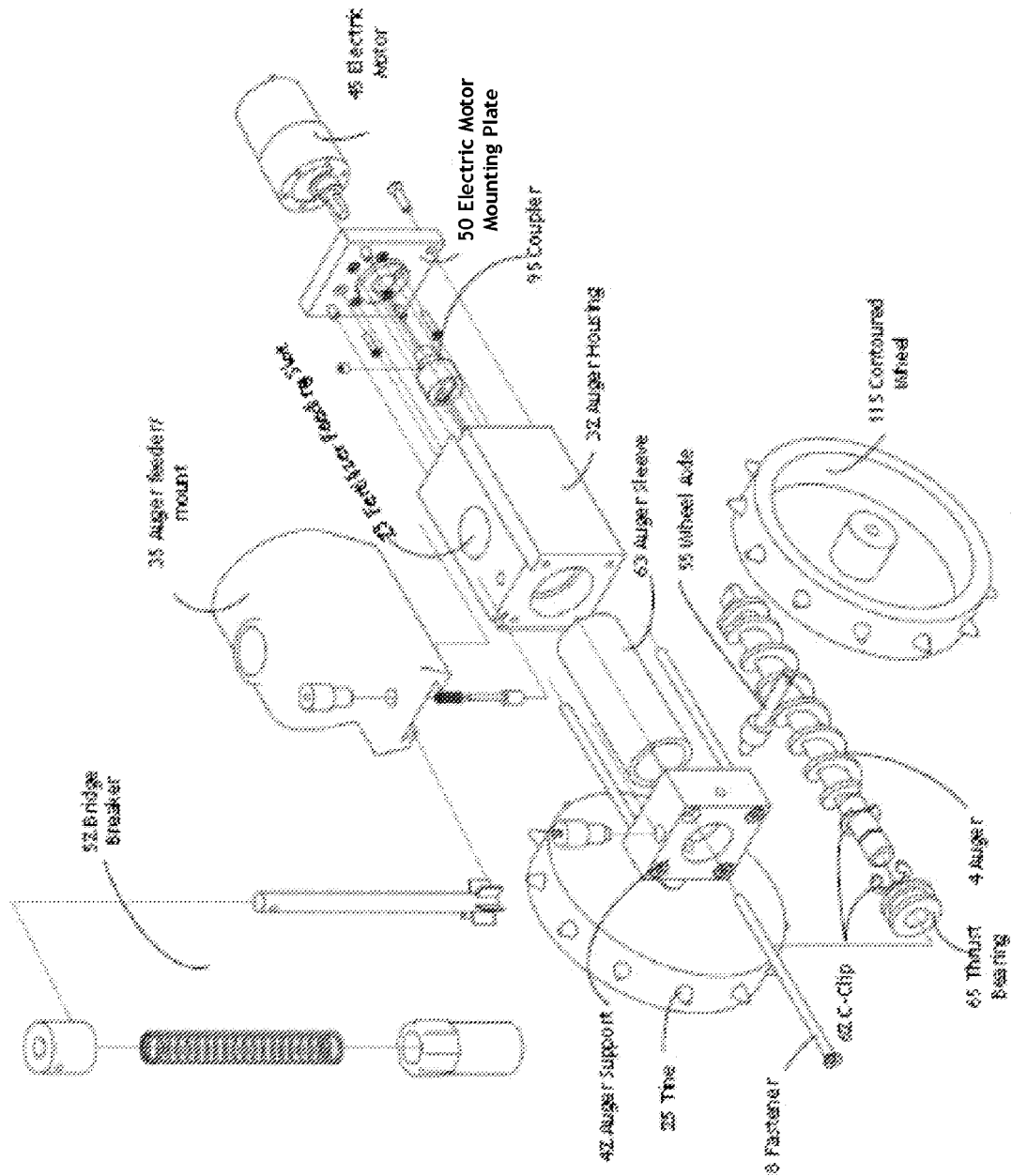

FIGURE 12

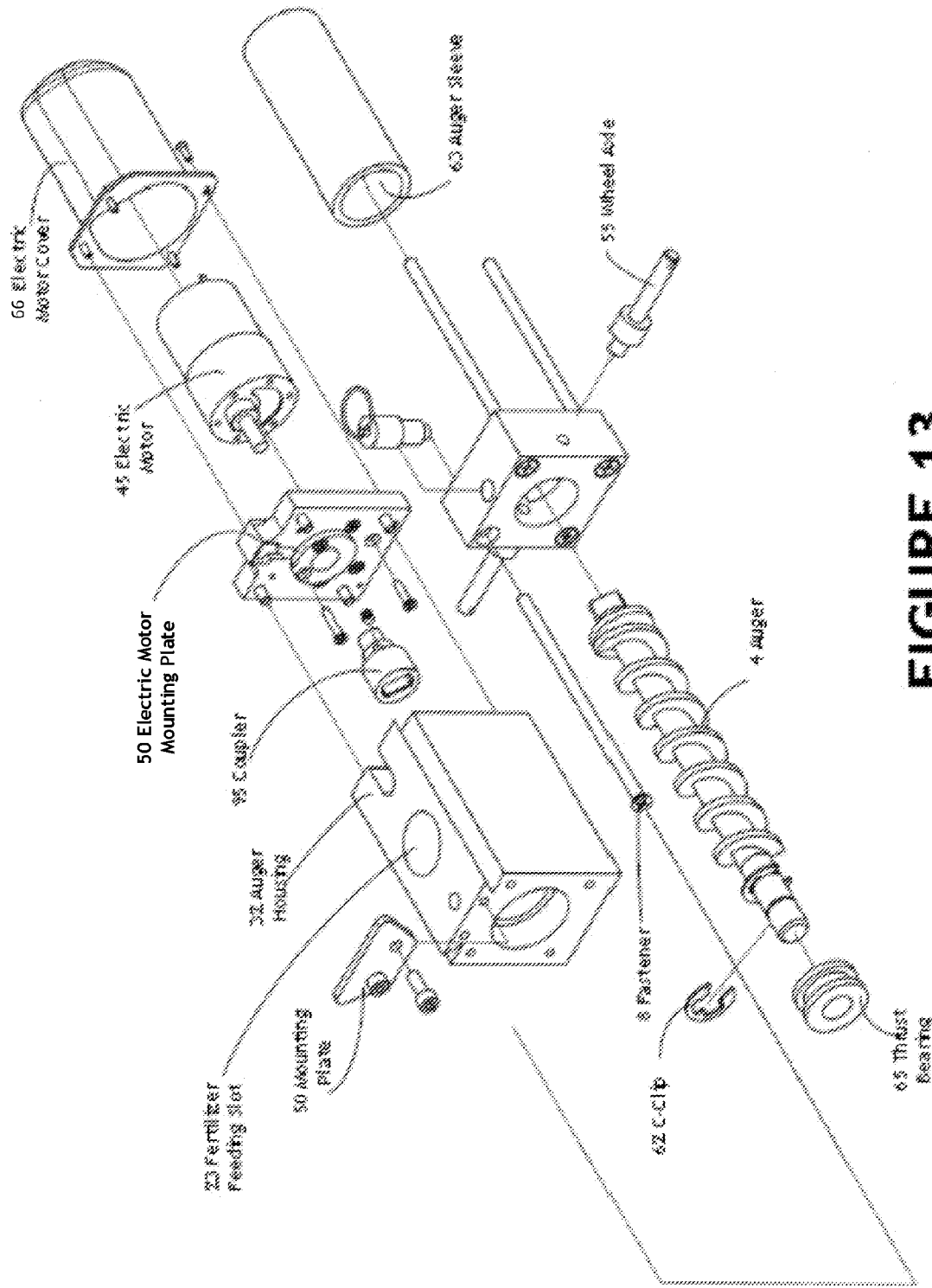

FIGURE 13

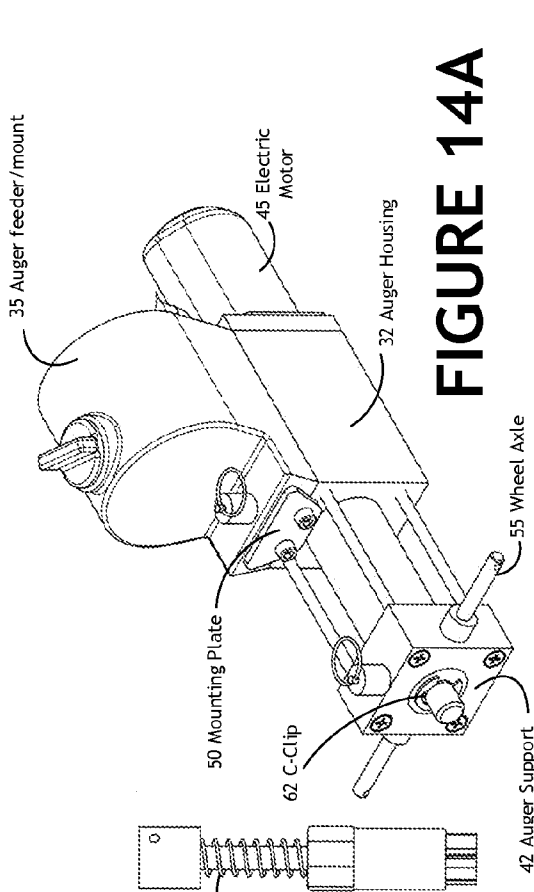
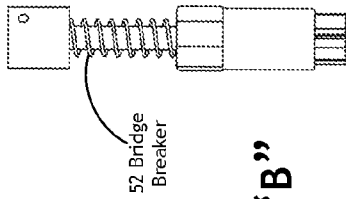

FIGURE 14A



DETAIL "B"

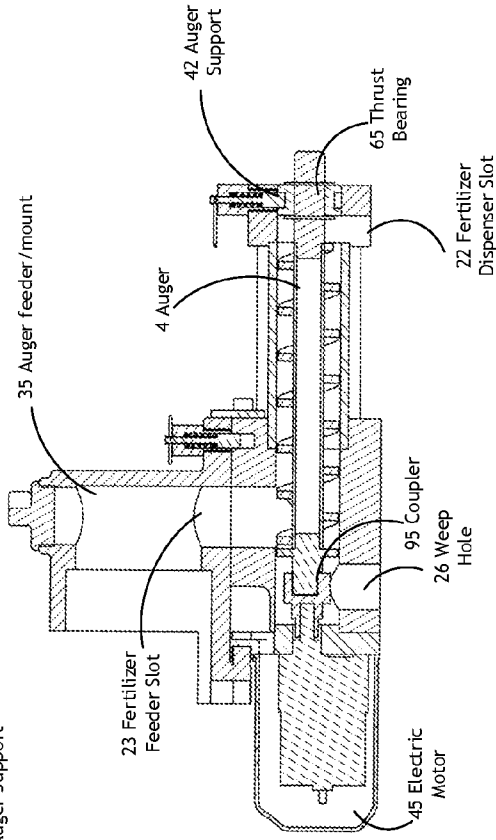
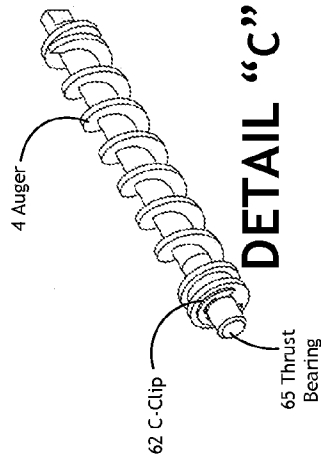

FIGURE 14B



DETAIL "C"

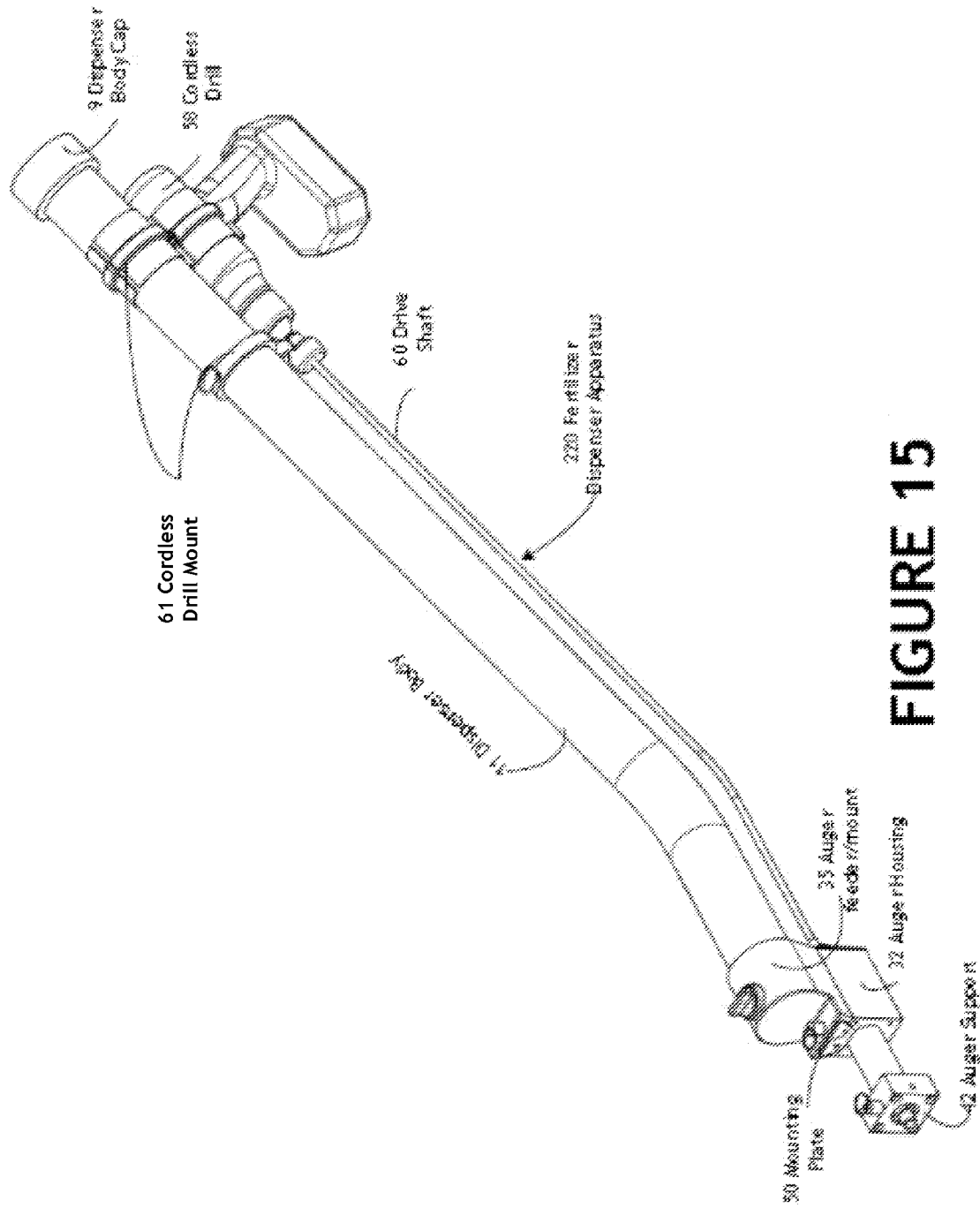

FIGURE 15

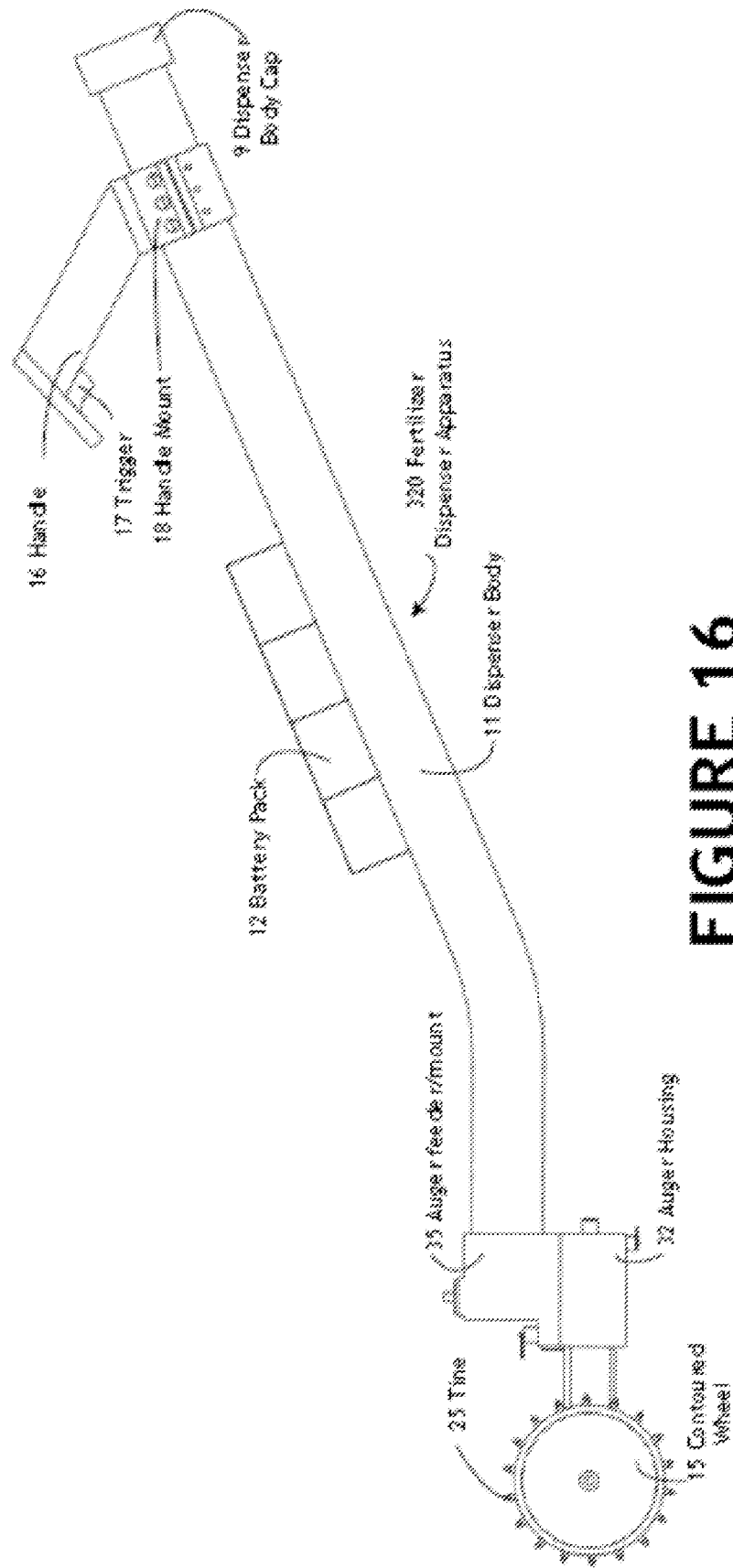

FIGURE 16



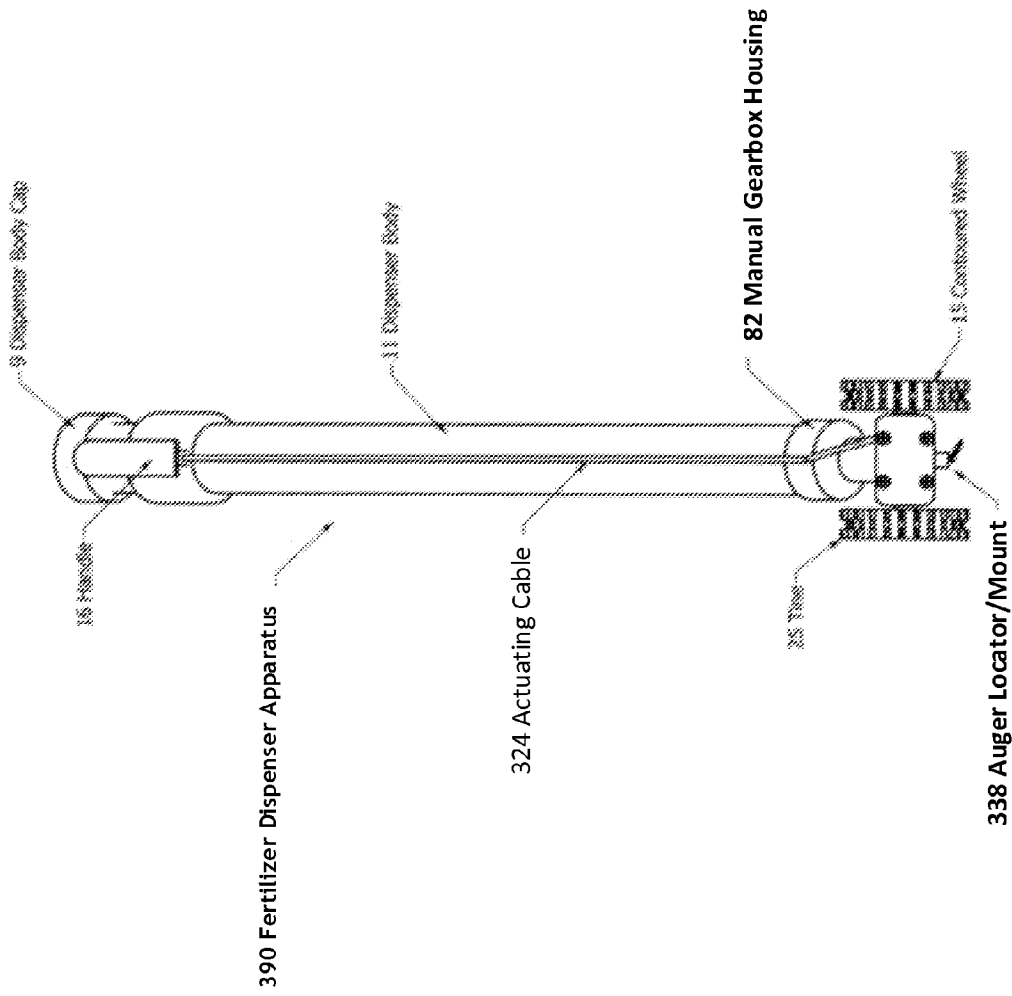

FIGURE 17

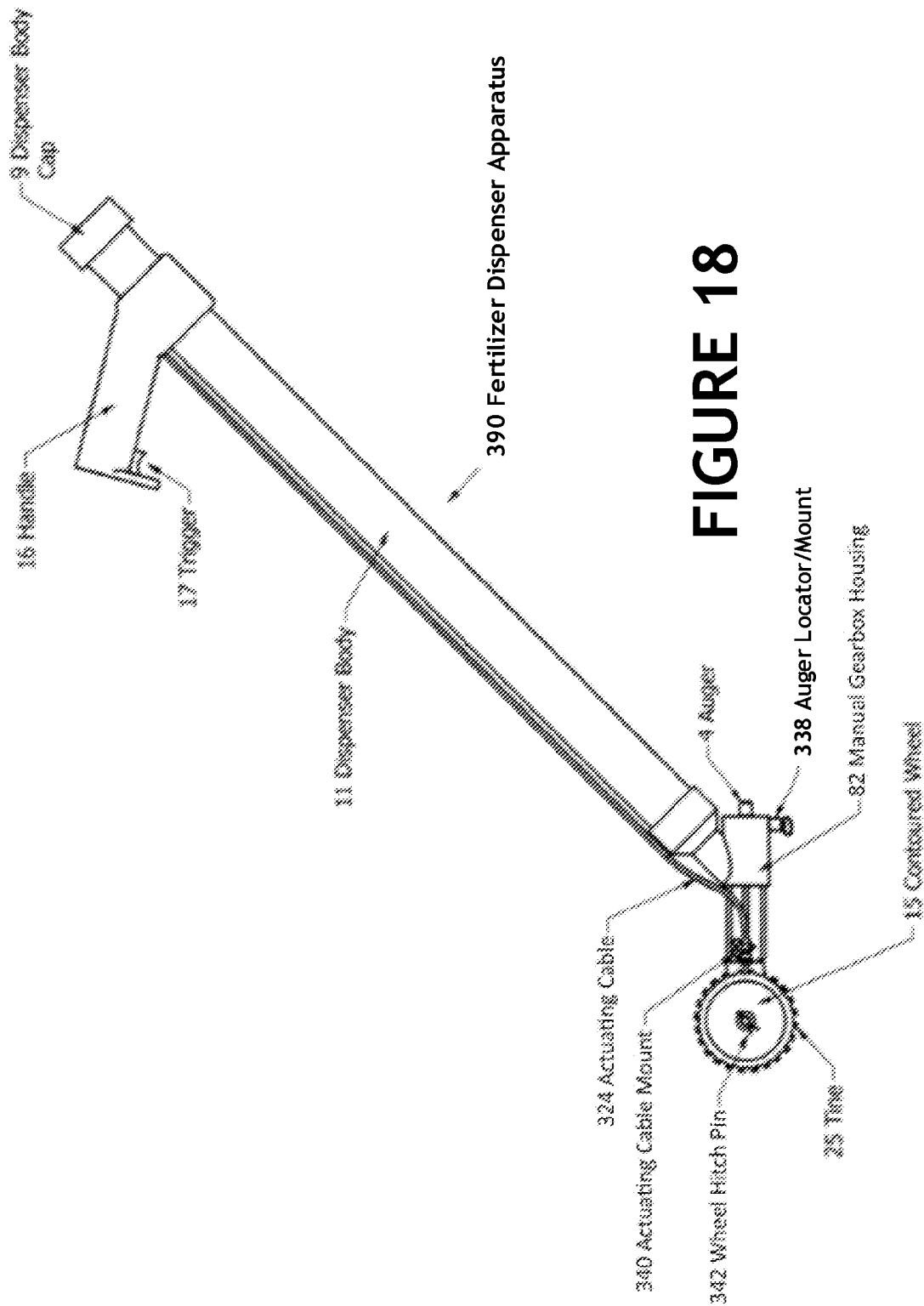

FIGURE 18

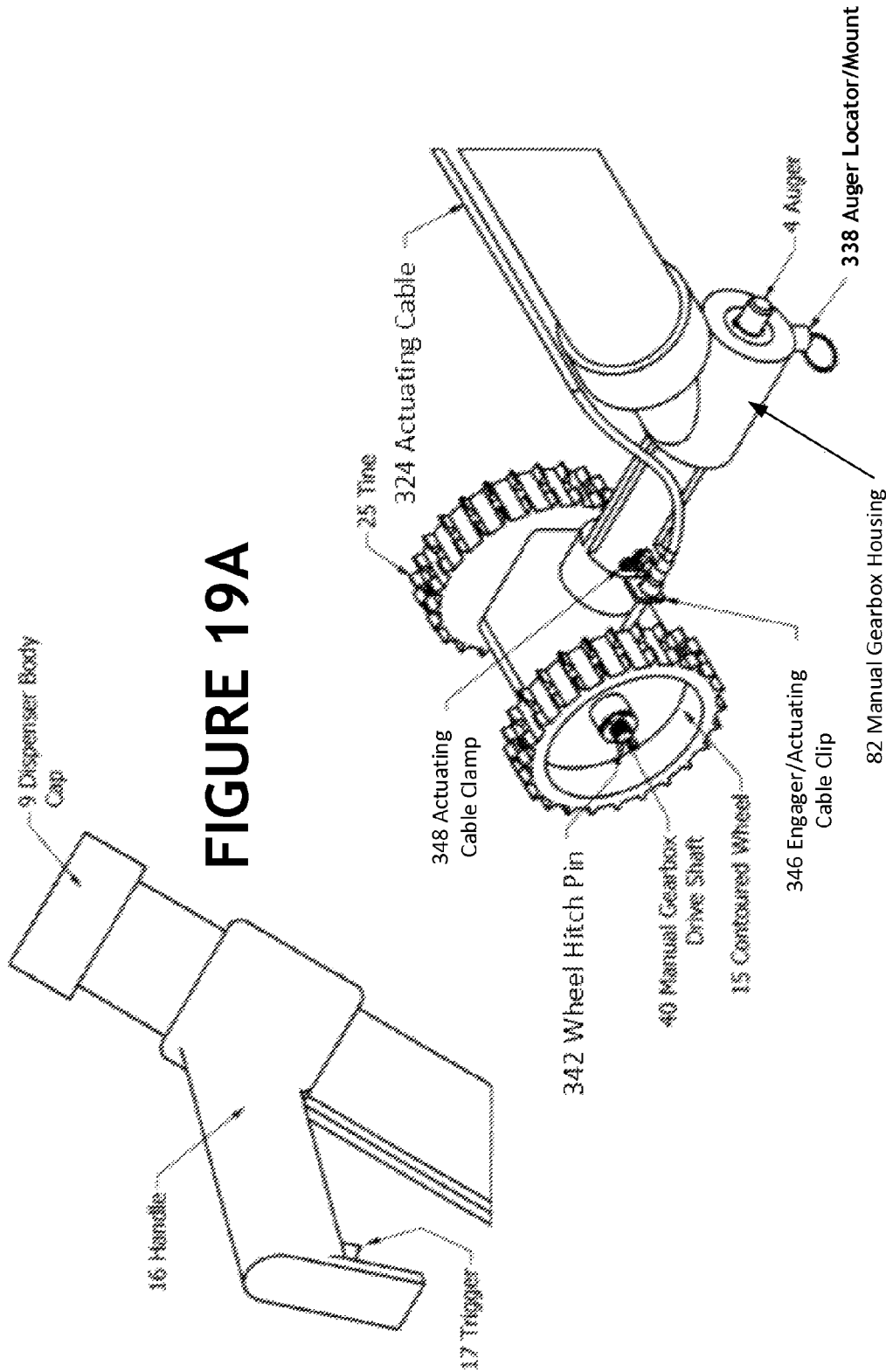

FIGURE 19A

FIGURE 19B

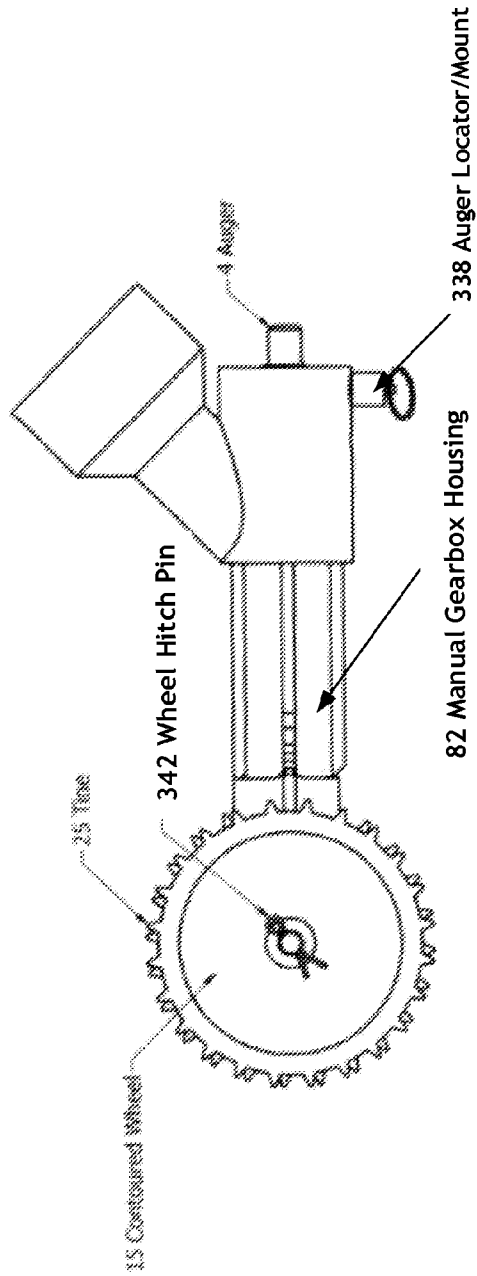

FIGURE 20A

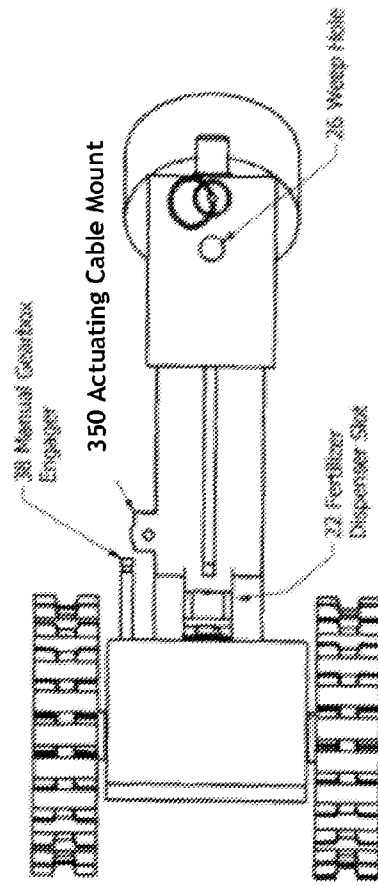

FIGURE 20B

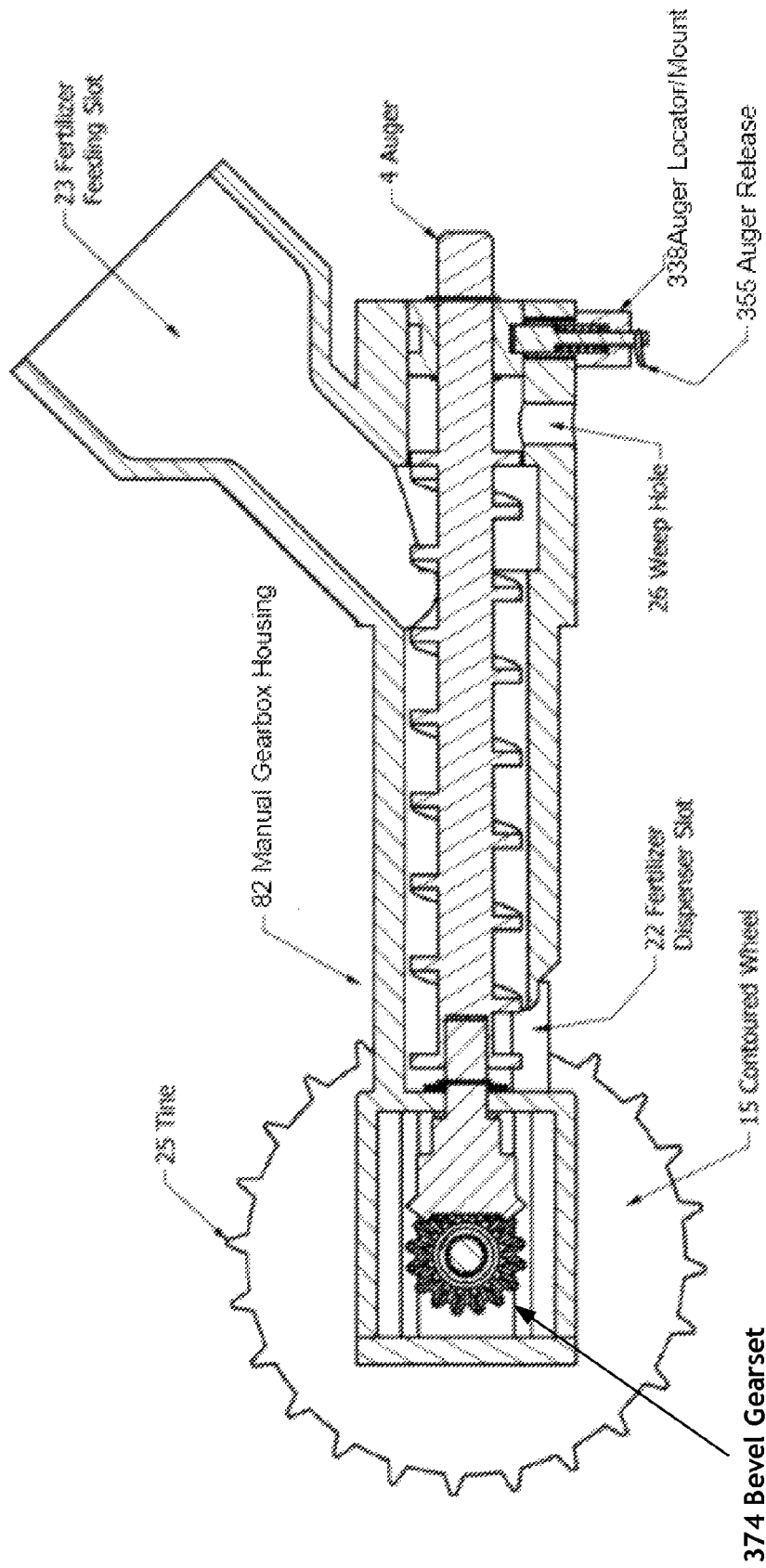

FIGURE 21

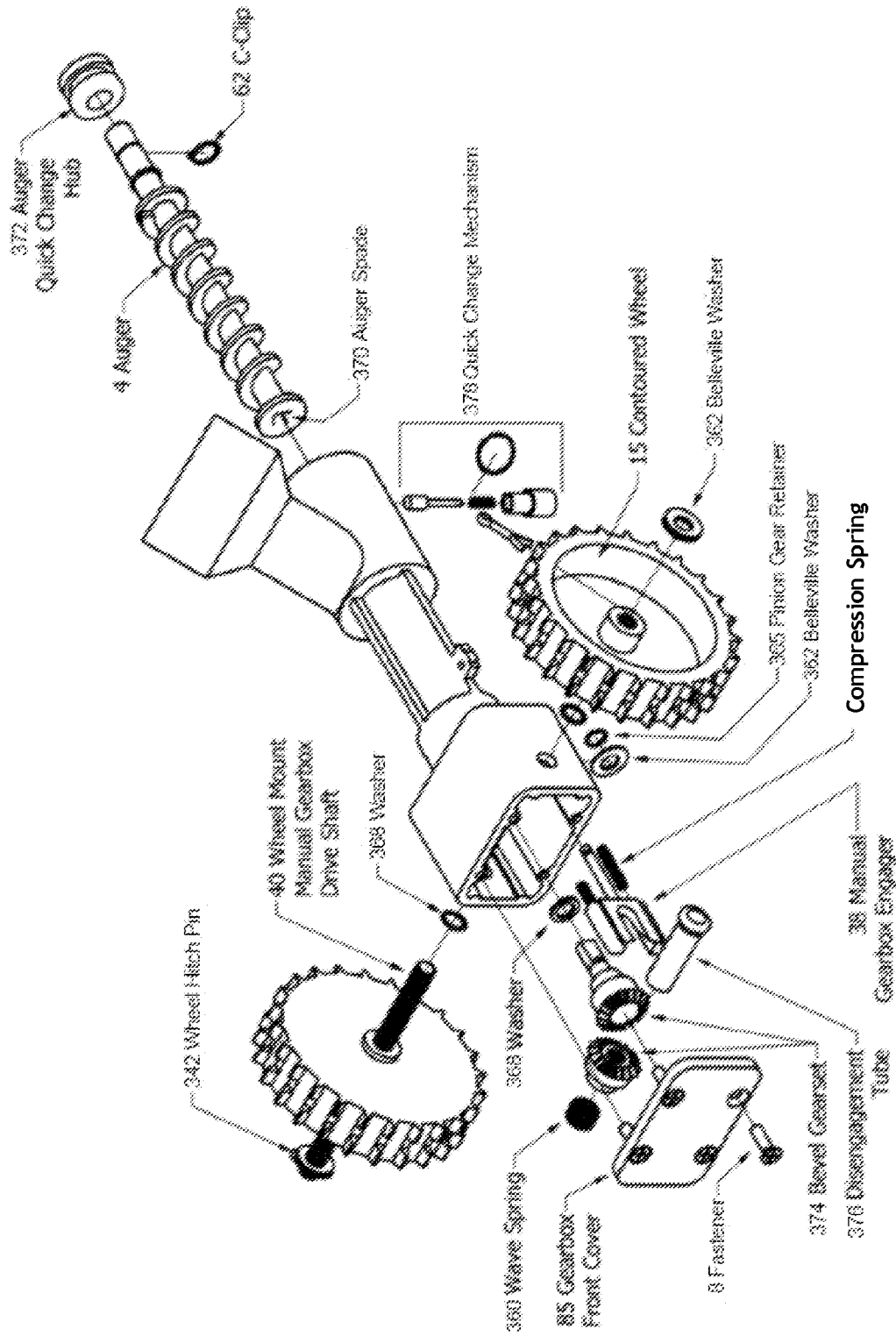

FIGURE 22

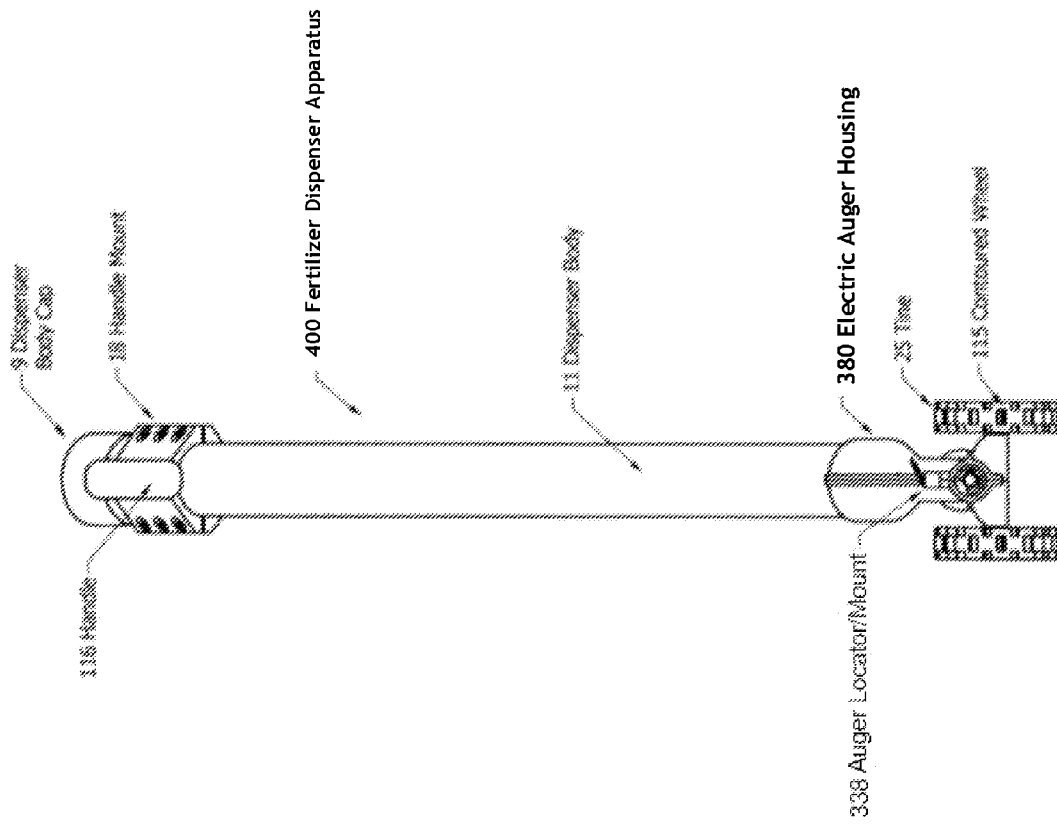

FIGURE 23

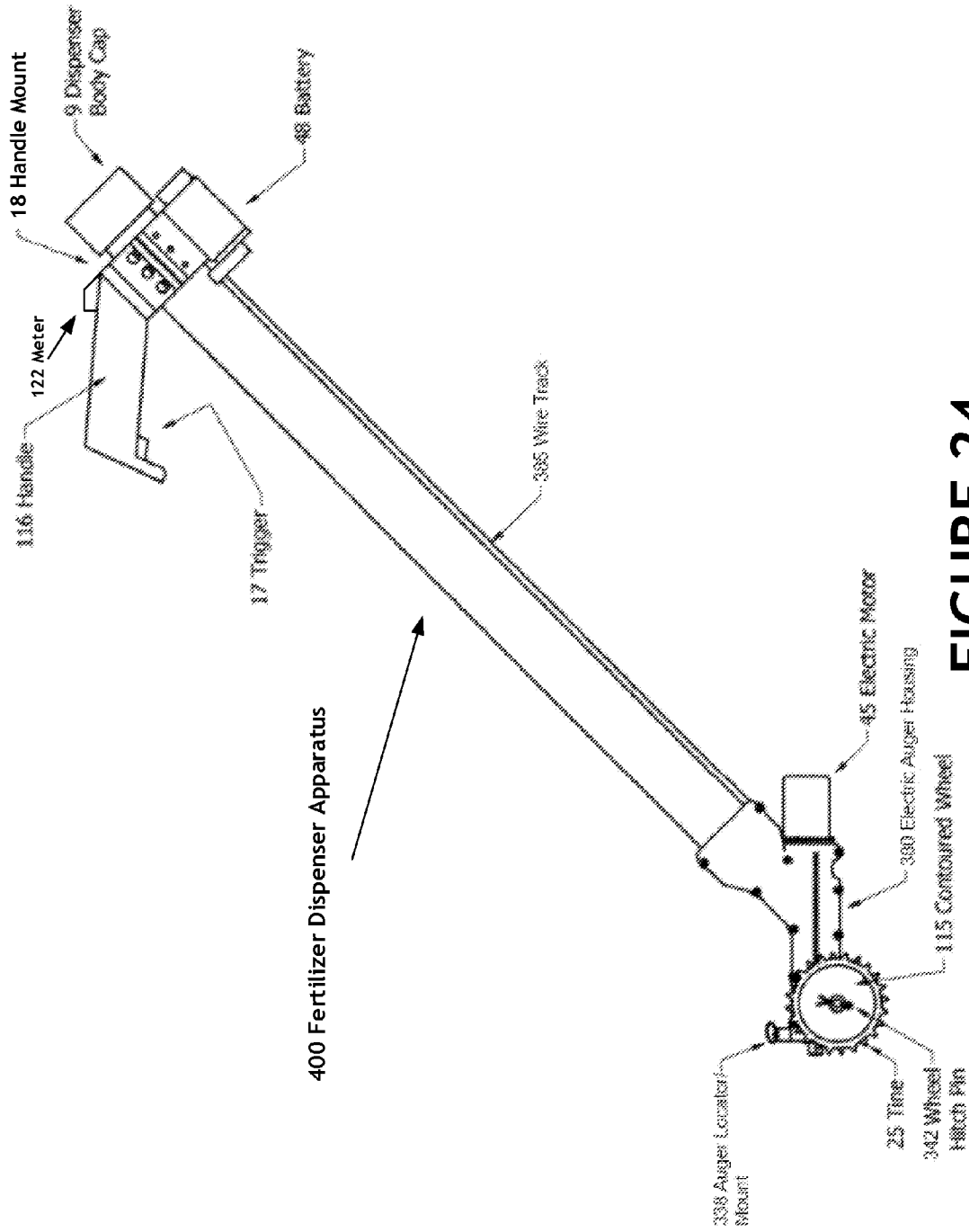

FIGURE 24



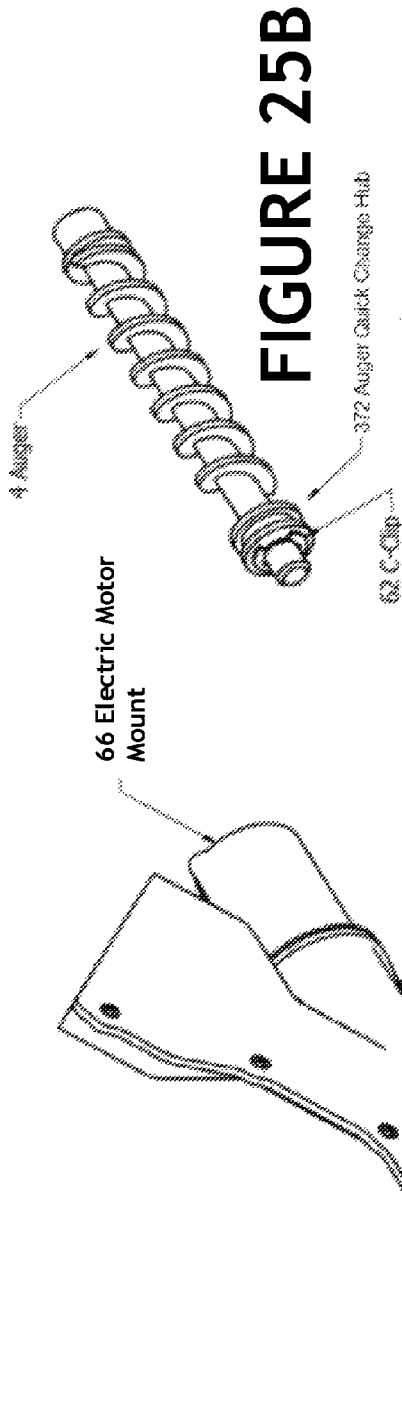

FIGURE 25B

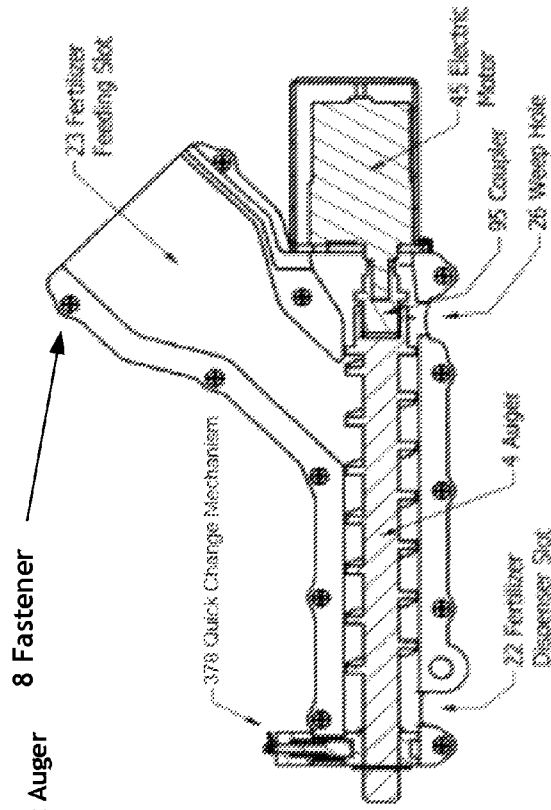

FIGURE 25C

FIGURE 25A

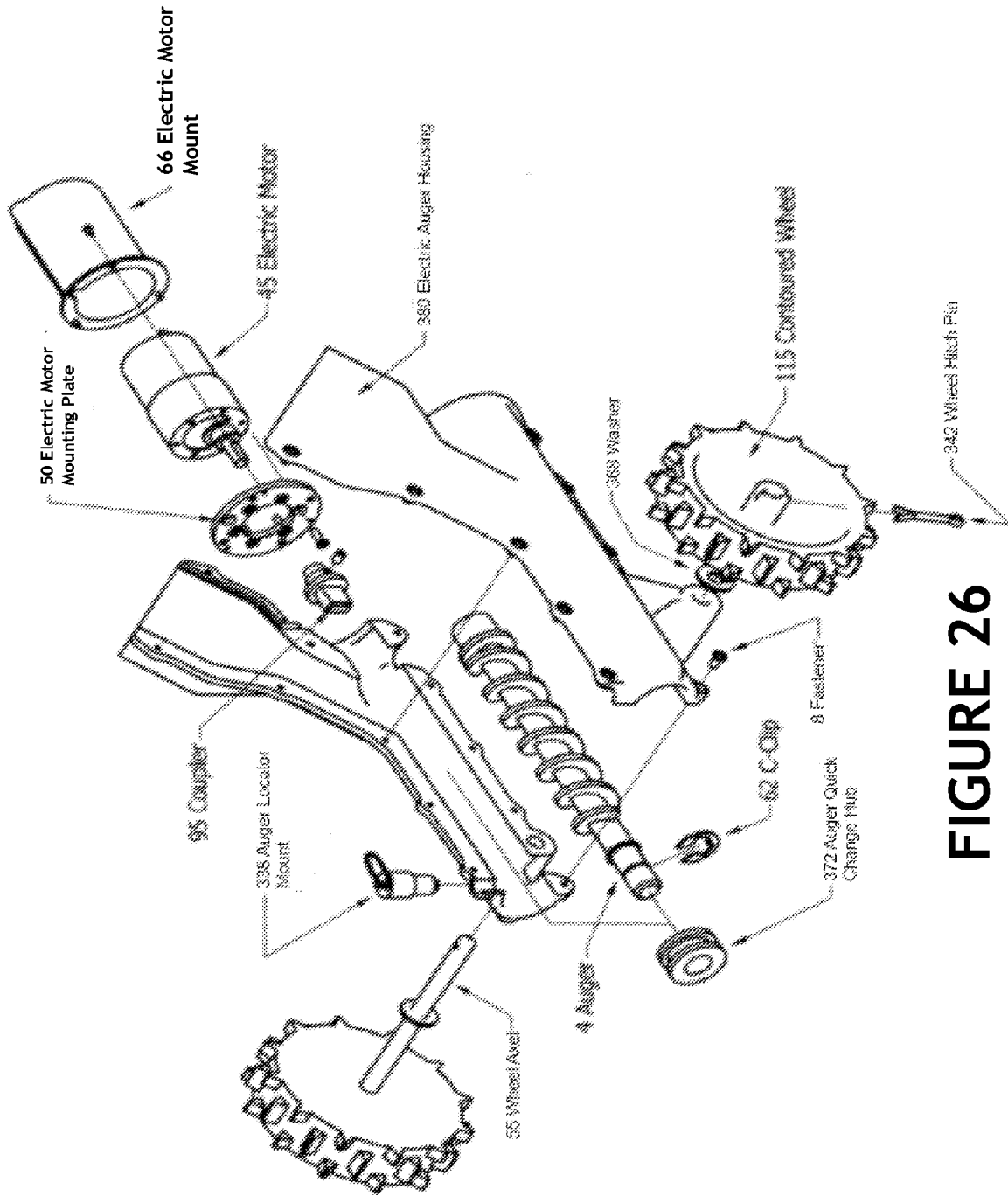
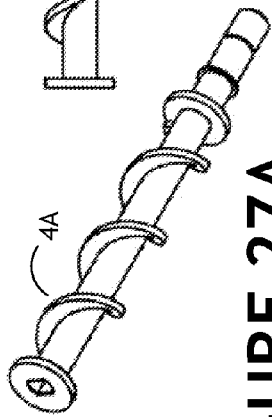

FIGURE 26



**FIGURE 27B**



**FIGURE 27A**

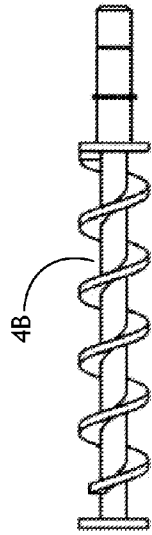

**FIGURE 27D**

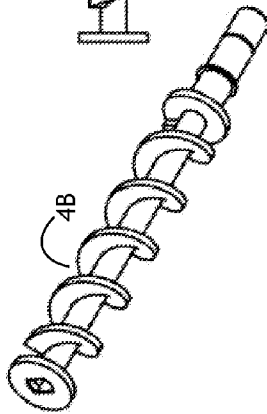

**FIGURE 27C**

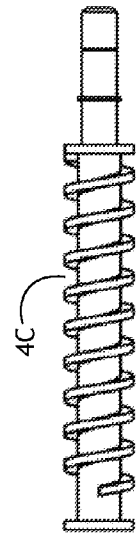

**FIGURE 27F**

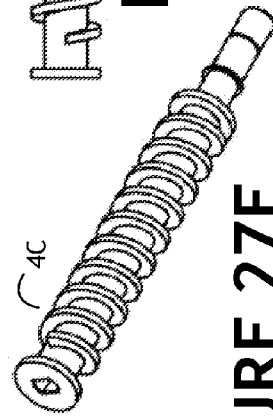

**FIGURE 27E**

## GRANULAR FERTILIZER DISPENSER APPARATUS

### CROSS-REFERENCE TO RELATED APPLICATIONS

This patent application is related to and claims priority to U.S. Provisional Application No. 61/795,739, entitled "Fertilizer Dispenser Apparatus", by Eric J. Shaffer, filed on Oct. 23, 2012, and is a Continuation-in-Part to U.S. patent application Ser. No. 14/058,489 (TRACKONE), entitled "Fertilizer Dispenser Apparatus" by Eric J. Shaffer, filed on Oct. 21, 2013.

### FIELD OF USE

The present invention relates to a portable granular fertilizer dispenser, typically used by home gardeners for accurately dispensing the granular fertilizer onto small areas, as well as preparing the soil surfaces prior to the application of the granular fertilizer and post application soil treatment.

### BACKGROUND OF THE INVENTION

In addition, blooms which have long been a concern of environmentalists are the result of the excessive growth of algae in lake areas and streams with high amounts of nitrogen and phosphorus. These chemicals are often the runoff of over-fertilized fields and lawns are a danger to our water supply.

Prior approaches to fertilizer dispensing have been large, stand along push dispensers, or tractor attachments, or attachments for lawn mowers, which dispense massive amounts of fertilizer over a large area. Even smaller, portable units tend towards the volume method of fertilizer dispensation and have no means to prepare the soil prior to the application of fertilizer, as well as no means of post application soil finishing. This wasted, unused fertilizer is harmful to the environment.

Some of the prior art includes the following:

U.S. Patent Document 20130068861 (Zwahlen; et al) discloses a portable scattering apparatus for storing and dispensing granular material, especially pourable bulk material on a surface, e.g. of grainy fertilizer on a lawn surface, or scattering material on slick roads or paths. The scattering apparatus contains a closable container and a handle part connected to the container for dispensing the granular material. The handle part comprises a lock chamber in the connecting region of the container for controlling the flow rate, and it is shaped into a distributor at the front end. A valve is arranged in the lock chamber, which valve can be actuated via a lever, which is pivotably held on the outside on the handle part. The lever is connected via a valve stem with the valve disk of the valve.

U.S. Patent Document No. 20070289511 (Chen; et al.) discloses a method for cutting sub-surface cavities into a region of soil and for delivering liquid fertilizer directly to each cavity while minimizing overflow or spillage of liquid fertilizer onto the surrounding surface soil. A cutting apparatus is described for creating sub-surface cavities the soil, each cavity is associated with an opening at the soil surface through which liquid fertilizer can be delivered to the cavity. A system for delivery of liquid fertilizer to the cavities is described, which includes a fertilizer dispenser including a metering valve assembly for delivery of liquid fertilizer to each cavity. A synchro-

nization system may be incorporated into the system for locating each cavity and directing the dispensing of liquid fertilizer.

U.S. Pat. No. 7,281,675 (Elrod; et al.) discloses a portable, user shoulder supported spreader/blower unit includes an ergonomically configured housing which includes a section defining a storage bin for holding a quantity of salt or like chemical particulate material for spreading onto ground surfaces to prevent icing thereon in winter. A centrifugal distributor disk is located in a housing space section below the bin and, a bin discharge aperture aligns over a peripheral area of the distributor disk. A user controllable closure member selectively alters bin discharge aperture size and, hence, outflow quantity from the bin onto the distributor disk, the distributor disk rotating at high speed propelling particulate material out of the housing through a discharge nozzle thereon at a high speed.

U.S. Pat. No. 6,729,557 (Dillon) discloses a portable particulate spreader comprising a container having a closed end, an open end and a storage chamber for holding particulate matter therein is disclosed. A first handle is attached to a side of the container proximate the closed end. A second handle is attached, preferably pivotally, to the same side, approximately midway between the closed end and the open end, allowing a person to conveniently grasp the spreader in either a vertical position for carrying or a horizontal position for use. An impeller at the open end disperses the particulate outwardly and downwardly from the spreader.

U.S. Pat. No. 5,944,264 (Truax; et. al.) discloses a portable seed spreader for distribution of bulky and irregular size seeds over a local area. The spreader includes a U-shaped frame that carries a housing having a first seed bin and a second seed bin. A first transverse shaft is mounted to legs of the frame and extends through the first seed bin. The first shaft carries agitators for mixing and stirring the seeds in the first seed bin. Discharge slots are located in a bottom wall of the first seed bin. A second transverse shaft is mounted on the frame and extends beneath the bottom wall of the first seed bin. The second transverse shaft carries picker wheels that extend through the discharge slots into the first seed bin to pick seeds therefrom and draw them through the discharge slot. The shafts are connected so that rotation of one transverse shaft as by a hand crank, an electric motor or a wheeled mechanism, results in rotation of the other.

U.S. Pat. No. 2,493,599 (Schroeder) discloses a single row fertilizer applicator where the flow of fertilizer leaving the hopper is steady and reliably constant but under operator control. The applicator has no means to prepare the soil prior to the application of fertilizer, as well as no means of post application soil finishing. Furthermore, the applicator lacks the ability to accurately meter for dispensing the rate of the fertilizer, resulting in the use of excessive fertilizer.

Conventional prior art fertilizer dispensers require the proper application of fertilizer to be applied in three distinct steps needed in order to achieve effective feed the targeted plants.

- (1) Coarsen the ground prior to applying the fertilizer by tilling, hoeing, raking, or some other suitable means of breaking up the surface of the soil.
- (2) Apply the granular fertilizer.
- (3) Work the newly applied granular fertilizer into the surface area and to coarsen the ground.

What is needed is a granular fertilizer dispensing apparatus that will perform all three tasks to optimize fertilizer utilization and reduce costs, time and effort, as well as being environmentally green and to reduce costs, time and labor.

The primary object of the fertilizer drop dispenser is to enable a user to apply a specified amount of fertilizer to a given area, instead of over large areas where fertilizer might not be needed. Also, the less fertilizer that is used, results in more saving on waste and cost.

The primary objective of the fertilizer drop dispenser is to enable a user to target individual plants for the most efficient application of granular fertilizer, instead of bulk dispensing over large areas where fertilizer may not be needed. Furthermore, less fertilizer is used in addition to reduced time of preparing the soil, resulting in saving on waste, cost, and time and less fertilizer introduced into the environment.

What is needed is a device that prepares the soil prior to the application of fertilizer, as well as post application soil finishing; a device that will target the base of the individual plant, conserving the fertilizer to sites where it is needed while avoiding dispensing said fertilizer in a wasteful manner, where said excess fertilizer is damaging and harmful to the environment.

What is needed is a device to save fertilizer, to enable a user to control a dosage of fertilizer dispensed at any time to any location, a device that is portable, and easy to operate, that will enable the user to operate easily, and efficiently measuring the amounts of fertilizer being applied to pre-selected areas, replacing large, space consuming, volume spreaders which cannot supply metered amounts of fertilizer to small areas.

What is needed is a device that will prepare the soil surface prior to the application of granular fertilizer, and enable the user to control the dosage of fertilizer at any time to any location, a device that is portable, easy to operate, and accurately measure the amount of fertilizer being dispensed to pre-selected areas as well as post application soil finishing. The soil finishing is necessary in urea based fertilizers to prevent volatilization. Small spreaders shown in the prior art incapable of pre-application soil treatment and do not afford the ability of post application soil finishing.

#### SUMMARY OF THE INVENTION

The fertilizer dispenser apparatus of the present invention addresses these objectives and these needs.

Granular fertilizer, as used herein, is any organic or inorganic granular or solid particulate material of natural or synthetic origin that is added to a soil to improve the quality or quantity of plant growth.

The fertilizer dispenser apparatus is for use over a surface area to be treated. The apparatus comprises a main body for storing the fertilizer, a rolling mechanism affixed to the main body, and a control mechanism cooperatively engaged with the main body.

The rolling mechanism disrupts the surface to be treated as the fertilizer dispenser apparatus rolls over the surface area to be treated.

The control mechanism enables the user to control the amount of fertilizer dispensed over any part of the surface area to be treated. The control mechanism enables the user to pinpoint an exact location where the dosage of fertilizer is dispensed.

The control mechanism is cooperatively engaged with the main body, the control mechanism enables the user to control a dosage of fertilizer dispensed over the surface area to be treated,

The control mechanism is cooperatively engaged with the main body, the control mechanism enables the user to control a location where the dosage of fertilizer is dispensed over the surface area to be treated. The control mechanism may include a meter which shows the user the amount or volume of fertilizer being used in each dose and the total amount of fertilizer used.

Once the surface of which fertilizer is to be applied is coarsened, via a back and forth motion of the present invention, the operator need only to depress the trigger or control mechanism to dispense a specific amount to the area to be fertilized.

The longer the trigger is held, the more fertilizer is dispensed. While the fertilizer is being dispensed, the unit is moved in a manner so as to fertilize the area desired. After the proper dosage of fertilizer has been applied, the apparatus of the present invention is manipulated in a similar back and forth motion that was previously performed to coarsen the surface, whereby fertilizer is worked into the ground reducing volatilization.

In another embodiment, the preferred embodiment of the present invention includes a receptacle for attachment of a grounded extension cord.

In a yet another embodiment of the present invention, a power cord is attached with a grounded extension cord plug.

In still another embodiment of the present invention, the apparatus is manually driven via a gear box attached to the front of the screw housing, which is driven by the motioned generated when the wheels turn in either the forward or backward direction with the trigger actuating an engagement mechanism inside of the gear box, allowing fertilizing agent to be metered out according to the users wishes.

Another embodiment will eliminate the trigger housing and, instead, have an attachment point for a drive mechanism, such as a cordless drill, which will be used in lieu of the trigger assembly. The drive mechanism will be connected to the dispensing mechanism via a drive shaft which will replace the electric drive motor.

The gear housing where the metering auger is housed includes a quick detach coupling so as to enable different augers with differing pitches to be used so as to change the amount of fertilizer deposited while the trigger is being depressed.

For a complete understanding of the granular fertilizer dispensing apparatus of the present invention, reference is made to the following summary of the invention detailed description and accompanying drawings in which the presently preferred embodiments of the invention are shown by way of example. As the invention may be embodied in many forms without departing from spirit of essential characteristics thereof, it is expressly understood that the drawings are for purposes of illustration and description only, and are not intended as a definition of the limits of the invention.

#### BRIEF DESCRIPTION OF THE DRAWINGS

FIG. 1 depicts the front view of the first preferred embodiment of the granular fertilizer dispensing apparatus of the present invention.

FIG. 2 depicts the side view of the first preferred embodiment of the granular fertilizer drop dispensing apparatus of FIG. 1.

FIG. 3 depicts a perspective view of the handle and trigger assembly of the granular fertilizer dispensing apparatus of FIG. 1.

FIG. 4 depicts a perspective view of the auger housing, manual gearbox and the contoured wheel assembly, the

5

manual gear box assembly attached to the auger which dispenses the granular fertilizer of the preferred embodiment of the granular fertilizer dispensing apparatus of FIG. 1.

FIG. 5 depicts an assembly view of the of the auger housing and manual gearbox of the granular fertilizer dispensing apparatus of FIG. 1.

FIG. 6B depicts a perspective view of the auger housing and manual gearbox of FIG. 4 of the granular fertilizer dispensing apparatus of the present invention, and FIG. 6A is a half-section the auger housing and manual gearbox of FIG. 6B.

FIGS. 7A, 7B, 7C, and 7D depict various views and details of the manual gearbox engagement gear of FIGS. 6A and 6B.

FIG. 8 depicts the drive shaft engagement with the manual gearbox engagement gear of FIG. 7D, the engaging gear located in the manual gear box which engages the auger to dispense fertilizing agent of the granular fertilizer dispensing apparatus of FIG. 1.

FIG. 9 depicts the front view of a second preferred embodiment of granular fertilizer dispensing apparatus, said apparatus deploying an electric motor and a rechargeable battery.

FIG. 10 depicts the side view of the power-operated granular fertilizer dispensing apparatus of FIG. 9, said apparatus using a rechargeable battery.

FIG. 11 depicts an assembly view of the power-operated granular fertilizer dispensing apparatus of FIG. 9.

FIG. 12 depicts an exploded assembly view of the auger feeder, bridge breaker, and the electric motor of the power-operated granular fertilizer dispensing apparatus of FIG. 9.

FIG. 13 depicts an exploded assembly view of the auger assembly as it would be attached to the auger housing of the granular fertilizer dispensing apparatus of FIG. 9.

FIG. 14A depicts the auger feeder/mount, and FIG. 14B depicts a sectional view of the auger feeder/mount, with DETAIL "B" depicting the bridge breaker assembly and DETAIL "C" depicting the auger assembly for the power-operated granular fertilizer dispensing apparatus of FIG. 9.

FIG. 15 depicts a third preferred embodiment of granular fertilizer dispensing apparatus of the present invention, the apparatus having an electric drill/driver attached to the body.

FIG. 16 depicts the front view of a fourth preferred embodiment of granular fertilizer of the present invention, the apparatus being powered by a self-contained battery pack.

FIG. 17 depicts the front view of a fifth preferred embodiment of the granular fertilizer dispensing apparatus of the present invention with an actuating cable running from the trigger to the gear box.

FIG. 18 depicts the side view of the fifth preferred embodiment of the granular fertilizer dispensing apparatus of FIG. 17.

FIG. 19A depicts the handle and trigger of the fifth preferred embodiment of the granular fertilizer dispensing apparatus of FIG. 17.

FIG. 19B depicts the wheels, and gearbox of the fifth preferred embodiment of the granular fertilizer dispensing apparatus of the present invention.

FIG. 20A depicts the side view of the gearbox, auger housing and wheels of the fifth embodiment of the granular fertilizer dispensing apparatus of the present invention; and FIG. 20B depicts the underside view of the fifth preferred embodiment of the granular fertilizer dispensing apparatus of the present invention.

FIG. 21 depicts a cut-away view of the gearbox of the fifth embodiment of the granular fertilizer dispensing apparatus of the present invention.

6

FIG. 22 depicts an exploded view of the gearbox assembly of the fifth embodiment of the manual granular fertilizer dispensing apparatus of the present invention.

FIG. 23 depicts front view of the sixth embodiment of the granular fertilizer dispensing apparatus of the present invention, this apparatus being powered via battery.

FIG. 24 depicts the side view of the sixth embodiment of the granular fertilizer dispensing apparatus of the present invention, this apparatus being powered via battery of the present invention.

FIG. 25A depicts the auger housing of the sixth embodiment of the battery powered granular fertilizer dispensing apparatus of the present invention.

FIG. 25B depicts the auger of the sixth embodiment of the granular fertilizer dispensing apparatus of the present invention, this apparatus being powered via battery.

FIG. 25C depicts a cutaway of the sixth embodiment of the granular fertilizer dispensing apparatus of the present invention, this apparatus being powered via battery.

FIG. 26 depicts an exploded view of the sixth embodiment of the granular fertilizer dispensing apparatus of the present invention, this apparatus being power via battery.

FIGS. 27A and 27B, 27C and 27D, and 27E and 27F depict three augers having varying pitch.

#### DETAILED DESCRIPTION OF THE PREFERRED EMBODIMENTS

Referring now to the drawings, FIGS. 1 and 2 depict the preferred embodiment of the manual fertilizer dispensing apparatus [20] of the present invention. Attached to the top of the dispenser body [11] is the handle [16] with trigger [17] which enables the user to operate fertilizer dispensing apparatus [20] of the present invention. Attaching the handle [16] to the dispenser body [11] is a handle mount [18] which is a compression style mount attached via fasteners. At the base of the dispenser body is the auger/feeder mount [35] which is attached to the fertilizer dispensing apparatus [20] and houses the auger [4] (FIG. 5). The contoured wheels [15] are attached to the auger housing [32] via a wheel mount/manual gearbox drive shaft [40] (as best depicted in FIG. 5), which are used for mobility, as well as to coarsen the ground prior to dispensing of the fertilizer.

FIGS. 3-4 depict an isometric view of the manual embodiment of the present invention in which the manual gearbox [30] with attached contoured wheels [15] and the handle [16], and handle mount are visibly attached to the dispenser body [11] via a wheel mount/manual gearbox drive shaft [40] (as best depicted in FIG. 5) with the dispenser cap [9] attached to the dispenser body [11] just above the handle [16].

FIG. 4 depicts the auger housing [32] attached to the front end of the manual gearbox [30] which is operated via the forward and rearward motion of the contoured wheels [15]. A plurality of tines [25] extends radially about each contoured wheel [15]. The tines [25] are generally equally spaced about the circumference of each wheel [15]. The purpose of the tines [25] is to coarsen or break up the surface crust of the area being fertilized. The tines [25] extends radially about each contoured wheel [15]. The tines [25] are generally equally spaced about the circumference of each wheel [15]. The purpose of the tines [25] is to coarsen or break up the surface crust of the area being fertilized.

As the surface is being dispersed, the trigger [17] is engaged and a metering auger dispenses a controlled amount of fertilizer. The surface treatment enables the fertilizer to be inserted into the soil close to the root system of the plants targeted for growth, rather than fertilizing the weed system

surrounding the plants which may eventually threaten the plants. After the fertilizer is inserted, the fertilizer dispenser apparatus is maneuvered in a fashion to cover the newly applied fertilizer with available soil that was previously dug up. Also, the surface treatment results in less handling of the fertilizer and a reduction in the overall amount of fertilizer

needed in the area of the plant system. FIG. 5 depicts a detailed assembly view of the manual gear box [30] and the auger housing [32] of the fertilizer dispensing apparatus of FIG. 1. Inside the manual gearbox [30] is the wheel mount/drive shaft [40] up which the engagement gear [68] is mounted which engages the drive shaft gear [78], which meshes with auger gear [80], which turns the auger [4], dispensing fertilizer. Locating the auger [4] in the auger housing [32] is a thrust bearing [65] and a pair of C-clips [62]. The manual gearbox [30] is attached to the end of the assembly by four fasteners with the auger [4] being positioned inside an auger sleeve [63]. Forward and rearward motion of the wheels [15] turns the gearbox [30] and when the trigger [17] is pulled, the gear box engager [38] engages the gears, turning the auger [4] and dispensing a metered amount of fertilizing agent.

FIGS. 6A and 6B depict the manual gearbox [30] attached to the auger housing [32]. FIG. 6A is a cutaway view and FIG. 6B is an isometric view of the preferred embodiment of the assembly. A drive shaft [40] is mounted inside the manual gearbox [30], which the wheels [15] are mounted to and when a rotational force is applied to them, the driveshaft [40] turns, which in turn turns the auger [4], dispensing fertilizing agent. The cutaway view shows the auger [4] and manual gear box [30]. Fertilizer is loaded into the fertilizer dispenser apparatus of the present invention [20] through a fertilizer feeding slot [23] disposed in the top of the auger housing [32]. A weep hole [26] is disposed on the underside of the auger housing [32]. The weep hole [26] is preferably positioned slightly upstream of fertilizer feeding slot [23] and is designed to drain off accumulated material from the auger [4]. The fertilizer dispensing slot is located downstream of the auger [4] and is positioned on the underside of the manual gearbox [30].

Referring now to FIGS. 7A, 7B, 7C, and 7D, when the operator pulls the trigger [17], the manual gearbox engager [38] engages the engagement gear [68], which in turn engages the driveshaft gear [78] of FIG. 8, and turns the auger [4], through the fertilizing dispensing slot [22] located on the underside of the manual gearbox [30]. The manual gearbox engagement gear [68] depicted in includes an internal spring [70] which aides in the seating and engagement of the gear during operation. In the body of the engagement gear [68] are a plurality of screws [72], which secure the gear head [90] to the gear body [92].

FIGS. 9 and 10 depict the front and profile view of the power version of the fertilizer dispensing apparatus [120] of the present invention, and FIG. 11 is an assembly view of the power version of the fertilizer dispensing apparatus [120]. The auger housing [32] which is mounted to the auger feeder/mount [35] is shown, which is mounted to the end of the dispenser body [11]. Mounted to the front of the auger housing [32] is the auger support [42] which is used to locate the auger [4] as well as being a mounting point for the wheels [115]. At the opposite end of the dispenser body [11] is the handle [116], which is mounted to a compression fit mount [18] via six fasteners. A rechargeable battery [48] is positioned inside the handle [116]. The rechargeable battery [48] is used to actuate the electric motor [45] which is mounted to the rear of the auger housing [32]. The dispenser body cap [9] is positioned just behind the handle [116] and is used for

loading the fertilizer into the fertilizer dispensing apparatus [120] of the present invention.

The meter [122] depicted in FIG. 10 is positioned in the handle [116] of the fertilizer dispensing apparatus [120] of the present invention. The meter [122] is preferably either a volume flow meter or a mass flow meter. The control mechanism [17] is cooperatively engaged with a main body [11]. The control mechanism [17] is also cooperatively engaged with the meter [122]. The meter [122] is a mass or volume flow meter displaying a dosage of fertilizer being dispensed. The user pinpoints a location where said dosage of fertilizer is to be dispensed by positioning said fertilizer dispensing apparatus [120]. The user uses the set point stem setter to advise the apparatus the dosage of fertilizer to be dispensed to the location selected. The control mechanism [17] and the flow meter [122] enable the user to control the dosage of fertilizer dispensed. In addition, the user can view the granular fertilizer being dispensed onto the targeted areas as he walks behind and pushes the granular fertilizer dispenser apparatus of the present invention.

FIGS. 12 and 13 depict the assembly view of the auger housing [32] auger support [42], wheels [115], electric motor [45], electric motor mount [50], and auger feeder/mount [35] of the fertilizer dispensing apparatus [120] of the present invention. The electric motor [45] is mounted to the back of the auger housing [32] via the electric motor mount [50], with the auger housing [32] being attached to the auger feeder/mount [35], which is, in turn, attached to the dispenser body [11]. The wheels [115] are attached to two wheel axles [55] which are attached to the auger support [42]. The auger [4] is supported by the auger support [42] and positioned via thrust bearing [65] and C-clips [62]. The auger/feeder mount [35] is disposed in the bridge breaker [52] (see DETAIL "B") which is used to break up any chunks of fertilizer or other material which may interfere with the function the fertilizer dispensing apparatus [120] of the present invention. A coupler [95] transfers rotational energy from the electric motor [45] to the auger [4] which is attached to the drive shaft of the electric motor [45] and to the end of auger [4].

FIGS. 14A and 14B depict the section and off-set view of the auger housing [32], auger feeder/mount [35] and auger support [42] assembly. In this embodiment, as opposed to the manual version described in FIG. 1, in place of the manual gear box [30] is the auger support [42] onto which the wheels [115] are mounted via wheel axles [55]. At the rear of the auger housing [32] is the electric motor [45] and electric motor cover [66] which protects the motor from debris and the elements. Attached to the top of the auger housing [32] is the auger feeder/mount [35] into which the dispenser body [11] is inserted. Insuring proper alignment between the auger feeder/mount [35] and the auger housing [32] is a mounting plate [50]. Visible in the cutaway is the coupler [95] which couples the electric motor [45] to the auger [4].

FIG. 15 depicts a third preferred embodiment of fertilizer dispensing apparatus of fertilizer dispensing apparatus [220] of the present invention in which in place of the trigger [17] is a cordless drill [58] mounted underneath the dispenser body [11] via a cordless drill mount [61] which attaches to the dispenser body [11] where the drive shaft [60] is connected to the drill with the drive shaft [60] connected to the auger housing [32] in place of the electric motor [45]. In this embodiment, the cordless drill [58] powers the unit. The fertilizer is added to the dispenser body [11] and is fed via gravity into the auger feeder mount 35 with fertilizer only being spread when the trigger [17] is depressed. The specially

contoured wheels help to coarsen the surface where the fertilizer is to be applied, making the application of the fertilizer more efficient.

FIG. 16 depicts the front view of a fourth preferred embodiment of fertilizer dispensing apparatus of fertilizer dispensing apparatus [320] of the present invention, said apparatus being powered by a self-contained battery pack. In this embodiment, along the dispenser body [11] is located battery compartments [12] which power the unit, with said battery compartments [12] preferably being removable and enabling the use of the cordless drill, rechargeable style batteries instead. The fertilizer is added to the dispenser body [11] and is fed via gravity into the auger feeder mount 35 with fertilizer only being spread when the trigger [17] is depressed. The specially contoured wheels help to coarsen the surface where the fertilizer is to be applied, making the application of the fertilizer more efficient. Battery-packs differ greatly in power and weight. The battery packs offered a range between 12 and 36 volts. The lower end of this range is appropriate for smaller applications.

FIGS. 17 and 18 depict the fifth embodiment of the manual fertilizer dispensing apparatus [390] of the present invention. Attached to the top of the dispenser body [11] is the handle [16] with trigger [17] which enables the user to operate fertilizer dispensing apparatus [390] of the present invention. Attached to the trigger [17] is an actuating cable [324] which runs the length of the dispenser body [11] and is connected to the gearbox [82]. Attaching the handle [16] to the dispenser body [11] is a handle mount [18] which is a compression style mount attached via fasteners. At the base of the dispenser body is the auger/feeder mount [35] which is attached to the fertilizer dispensing apparatus [390] and houses the auger [4]. The contoured wheels [15] are attached to the auger housing [32] via a wheel mount/manual gearbox drive shaft [40], which are used for mobility to coarsen the ground prior to dispensing of the fertilizer.

FIG. 19A depicts a perspective view of the trigger and handle as attached to the dispenser body [11]. FIG. 19B depicts a perspective view of the manual embodiment of the fifth preferred embodiment in which the manual gearbox [30] with attached contoured wheels [15] is visibly attached to the dispenser body [11] via a wheel mount/manual gearbox drive shaft [40]. The actuating cable [324] is connected to the gearbox [30] via actuating cable clamp [346]. Also, shown is the wheel hitch pin [342] which attaches the wheel [15] to the manual gearbox [30] via drive shaft [40]. The auger locator/mount [338] is also shown which holds the auger [4] in place and enables quick changes to augers of varying pitches as needed.

FIG. 19B depicts a preferred embodiment of the contoured wheel [15]. Each contoured wheel [15] includes multiple rows of projections, each row including a plurality of said projections or tines. A plurality of projections extending outward from each contoured wheel [15] the tines being designed to churn the soil, either exposing the root for the fertilizer dispenser apparatus [390] to drop fertilizer onto the root or subsequently cover said root with soil. While preferably this can be accomplished with a single pass, it may be necessary for the fertilizer dispenser apparatus [390] to pass the targeted area more than one time, initially to expose the root and subsequently to cover the fertilized root.

FIG. 20A depicts the side view of the manual gearbox housing [82]. Attached to the manual gearbox housing [82] are the contoured wheels [15] attached via wheel hitch pin [342]. At the rear of gearbox housing [82] is the auger locator/mount [338] which allows the user to quickly remove and replace the auger [4] with an auger of different pitch or for

maintenance. FIG. 20B depicts the underside of the fertilizer dispensing apparatus of FIG. 20A. Visible, is the weep hole [26] which is located at the rear of the manual gearbox [30] which allows any excess fertilizer of other debris to fall from the apparatus and prevent any buildup which would adversely affect the operation of the unit. Disposed in the front of the fertilizer dispensing apparatus [390] is the fertilizer dispensing slot [22] from which the fertilizer is dispensed. The manual gear engager [38] is also visible which the actuating cable [324] is connected to via the actuating cable mount [350].

FIG. 21 depicts a cutaway view of the fifth preferred embodiment of the fertilizer dispensing apparatus [390] with the auger [4] clearly visible. To release the auger [4] the auger release [355] is pulled and the auger [4] will then be able to be pulled from the gearbox housing [82] from the rear. Also visible, is the bevel gearset [374] which is at the front of the gearbox [82] and connected via the wheel mount manual gearbox drive shaft [40]. When dispensed, the fertilizer flows down the fertilizer feeding slot [23] and onto the auger [4] which then carries the fertilizer forward and out of the dispensing slot [22] with any excess as well as any other debris falling from the weep hole [26] located at the rear of the manual gearbox [82].

FIG. 22 depicts a detailed assembly view of the manual gear box [30] and the auger housing [32] of the fertilizer dispensing apparatus [390]. Inside the manual gearbox [30] is the wheel mount/drive shaft [40] upon which the bevel gearset [374] is attached, which turns the auger [4] when engaged via the actuating cable [324] which, in turn, actuates the engagement tube [376] which is connected to the gearbox engager [38], collapsing the compression springs that are interior to the manual gearbox engager [38], as well as allowing the wave spring [360] to decompress and extend, causing the bevel gearset [374] to connect, dispensing fertilizer. Locating the auger [4] in the auger housing [32] is a thrust bearing [65] and a pair of C-clips [62] and quick change mechanism [378]. At the rear of the auger [4] is the auger quick change hub [372] which has a channel in which the quick change mechanism 378 engages, holding the auger securely in the housing [82].

In this preferred embodiment the manual gearbox is an integral part of the manual gearbox housing. It is one piece and molded. The manual gearbox [30] is attached to the end of the assembly by four fasteners with the auger [4] being positioned inside manual housing [82]. Forward and rearward motion of the wheels [15] turns the gearbox [30] and when the trigger [17] is pulled, the gear box engager [38] engages the gears, turning the auger [4] and dispensing a metered amount of fertilizing agent. At the front of the gear box [82] is the gear box front cover [85] which is secured into place via four fasteners [8] and allows access to the bevel gearset [374] as well as the gearbox engager [38] and the engagement tube [376].

FIGS. 23 and 24 depict the front and profile view of the power version of the fertilizer dispensing apparatus [400] of the present invention, and FIGS. 25A, 25C, and 26 is an assembly view of the power version of the fertilizer dispensing apparatus [400]. The auger housing [32] which is mounted to the auger feeder/mount [35] is shown, which is mounted to the end of the dispenser body [11]. The auger housing [32] is comprised of two halves which are held together via multiple fasteners [8]. The rear of the housing [32] is attached the electric motor [45] with cover [66]. The electric motor [45] when the trigger [17] is depressed, the electric motor turns the auger [4]. In this embodiment, there is no gearbox connected to the wheels. The quick change



## 11

mechanism [378] is at the front of this embodiment, allowing the auger [4] to be removed from the front of the unit. At the opposite end of the dispenser body [11] is the handle [116], which is mounted to a compression fit mount [18] via six fasteners. FIG. 25B is the auger [4] with quick change hub [372] and c-clip [62] clearly shown. A rechargeable battery [48] is attached behind the handle with a wire track [385] running down to the electric motor [45]. The rechargeable battery [48] is used to actuate the electric motor [45] which is mounted to the rear of the auger housing [32]. The dispenser body cap [9] is positioned just behind the handle [116] and is used for loading the fertilizer into the fertilizer dispensing apparatus [400] of the present invention.

The meter [122] as depicted in FIG. 10 is positioned in the handle [116] of the fertilizer dispensing apparatus of the present invention. The meter [122] is preferably either a volume flow meter or a mass flow meter. The control mechanism [17] is cooperatively engaged with a main body [11]. The control mechanism [17] is also cooperatively engaged with the meter [122]. The meter [122] is a mass or volume flow meter displaying a dosage of fertilizer being dispensed. The user pinpoints a location where said dosage of fertilizer is to be dispensed by positioning said fertilizer dispensing apparatus [400]. The user uses the set point stem setter to advise the apparatus the dosage of fertilizer to be dispensed to the location selected. The control mechanism [17] and the flow meter [122] enable the user to control the dosage of fertilizer dispensed.

FIGS. 27A and 27B, 27C and 27D, and 27E and 27F depict three augers having varying pitch. FIGS. 27A and 27B depict a first and longer auger pitch [4A], FIGS. 27C and 27D depict a second and narrower auger pitch [4B], and FIGS. 27E and 27F depict a third and smallest auger pitch [4C]. The auger pitch [4C] enables the slowest rate of fertilizer to be applied through the granular fertilizer apparatus of the present invention.

The fertilizer dispenser apparatus of the present invention may be manual or powered as described above. In either event, the fertilizer dispenser apparatus is used by an operator that walks behind or alongside of the unit, deciding how much fertilizer to apply at any particular location.

In one preferred embodiment, the electric motor [45] has a variable speed type. This enables a pre-programmable system for the user to set the meter for various amounts of fertilizer to be dispensed, allowing different amounts to be dispensed when the trigger [17] is pressed.

Further, to allow for ease during usage in applications when the device would need to be used underneath foliage, removable fenders could be used so as to prevent any damage to sensitive foliage.

The longer the trigger is held, the more fertilizer is dispensed. While the fertilizer is being dispensed, the unit is moved in a manner so as to fertilize the area desired. After the proper dosage of fertilizer has been applied, the unit is manipulated in a similar back and forth motion that was previously performed to coarsen the surface prior to application.

The granular fertilizer dispensing apparatus of the present invention provides a user with a clear view of said root system within said surface area to be treated to monitor apparatus operation. The granular fertilizer dispensing apparatus of the present invention can accurately meter the rate to dispense onto an area as small as one square inch (7 square centimeters).

Throughout this application, various patents and applications are referenced by number and inventor. The disclosures of these documents in their entireties are hereby incorporated

## 12

by reference into this specification in order to more fully describe the state of the art to which this invention pertains.

It is evident that many alternatives, modifications, and variations of the granular fertilizer dispenser apparatus [20] of the present invention will be apparent to those skilled in the art in light of the disclosure herein. It is intended that the metes and bounds of the present invention be determined by the appended claims rather than by the language of the above specification, and that all such alternatives, modifications, and variations which form a conjointly cooperative equivalent are intended to be included within the spirit and scope of these claims.

## PARTS LIST

4. Auger—1<sup>st</sup> Embodiment
- 4A. Auger—2<sup>nd</sup> Embodiment
- 4B. Auger—3<sup>rd</sup> Embodiment
- 4C. Auger—4<sup>th</sup> Embodiment
9. Dispenser Body Cap
11. Dispenser Body
12. Battery Pack
15. Contoured Wheel
16. Handle
17. Trigger
18. Handle Mount
20. Fertilizer Dispenser Apparatus—1<sup>st</sup> Embodiment
22. Fertilizer Dispensing Slot
23. Fertilizer Feeding Slot
25. Tine
26. Weep Hole
30. Manual Gearbox
32. Auger Housing
35. Auger Mount/Feeder
38. Manual Gearbox Engager
40. Wheel Mount/Manual Gearbox Drive Shaft
42. Auger Support
45. Electric Motor
48. Battery
50. Mounting Plate
52. Ridge Breaker
55. Wheel Axles
58. Cordless Drill
60. Drive Shaft
61. Cordless Drill Mount
62. C-Clamp
63. Auger Sleeve
65. Thrust Bearing
66. Electric Motor Cover
68. Manual Gearbox Engagement Gear
70. Spring
72. Screw
78. Drive Shaft Gear
80. Auger Gear
82. Manual Gearbox Housing
85. Gearbox Front Cover
95. Coupler
115. Contoured wheels
116. Handle
117. Trigger
120. Fertilizer Dispenser Apparatus—2<sup>nd</sup> Embodiment
122. Meter
124. Set Point Stem Setter
220. Fertilizer Dispenser Apparatus—3<sup>rd</sup> Embodiment
320. Fertilizer Dispenser Apparatus—4<sup>th</sup> Embodiment
324. Actuating Cable
338. Auger Locator/Mount

- 340. Actuating Cable Mount
- 342. Wheel Hitch Pin
- 346. Engager/Actuating Cable Clip
- 348. Actuating Cable Clamp
- 350. Actuating Cable Mount
- 355. Auger Release
- 360. Wave Spring
- 362. Belleville Washer
- 365. Pinion Gear Retainer
- 368. Washer
- 370. Auger Spade
- 372. Auger Quick Change Hub
- 374. Bevel Gearset
- 376. Disengagement Tube
- 378. Quick Change Mechanism
- 380. Electric Auger Housing
- 385. Wire Track
- 390. Fertilizer Dispense Apparatus—5<sup>th</sup> Embodiment
- 400. Fertilizer Dispenser Apparatus—6<sup>th</sup> Embodiment

I claim:

1. A granular fertilizer dispensing apparatus for dispensing a granular fertilizer onto a surface, comprising:
  - a housing having a first end, a second end, an enclosed tubular bore that extends in a longitudinal direction, a first opening that faces generally upward and is positioned adjacent to the first end of the housing, and a second opening that faces generally downward, and is positioned adjacent to the second end of the housing, wherein the enclosed tubular bore is disposed between the first opening and the second opening and the enclosed tubular bore is free from openings between the first opening and the second opening;
  - one or more wheels that are connected to the housing for supporting the housing with respect to the surface;
  - an auger housed within the enclosed tubular bore of the housing, wherein rotation of the auger within the enclosed tubular bore of the housing transports the granular fertilizer along the enclosed tubular bore of the housing from the first opening of the housing to the second opening of the housing to control an amount of granular fertilizer that is dispensed from the second opening of the housing onto the surface, wherein the second opening faces the surface to allow the granular fertilizer to be dispensed directly onto the surface from the second opening;
  - an electric motor connected to the auger for rotating the auger;
  - a trigger that is moveable between a disengaged position and an engaged position, wherein the trigger is operably connected to the electric motor such that the electric motor rotates the auger to cause the granular fertilizer to be dispensed on the surface from the second opening when the trigger is in the engaged position and the electric motor does not rotate the auger when the trigger is in the disengaged position and the granular fertilizer is not dispensed;
  - an elongate tubular body that is adapted to store the granular fertilizer, the elongate tubular body having a first end that is connected to the housing for supplying the granular fertilizer to the first opening of the housing;
  - a handle connected to a second end of the elongate tubular body, wherein the trigger is mounted on the handle; and
  - a meter that displays an amount of fertilizer dispensed when the auger rotates to cause the granular fertilizer to be dispensed.

2. The granular fertilizer dispensing apparatus of claim 1, wherein the housing includes a weep hole that is formed at the first end of the housing and faces the surface.
3. The granular fertilizer dispensing apparatus of claim 1, wherein the one or more wheels includes a first wheel and a second wheel.
4. The granular fertilizer dispensing apparatus of claim 3, wherein the first wheel and the second wheel each include a plurality of tines that are equally spaced around a circumference of the first wheel and the second wheel, respectively, for disrupting the surface.
5. A granular fertilizer dispensing apparatus for dispensing a granular fertilizer onto a surface, comprising:
  - an elongate tubular body that is adapted to store the granular fertilizer, the elongate tubular body having a first end, a second end, and an outlet formed at the first end;
  - a housing having a first end, a second end, an enclosed tubular bore that extends in a longitudinal direction, a first opening that faces generally upward and is positioned adjacent to the first end of the housing, and a second opening that faces generally downward and is positioned adjacent to the second end of the housing, wherein the first opening is in communication with the outlet of the elongate tubular body, wherein the enclosed tubular bore is disposed between the first opening and the second opening and the enclosed tubular bore is free from openings between the first opening and the second opening;
  - at least one wheel connected to the housing for supporting the housing with respect to the surface;
  - an auger housed within the enclosed tubular bore of the housing, the auger having a pitch length, wherein the enclosed tubular bore has a longitudinal length that is greater than twice the pitch length of the auger, and the auger rotates within the enclosed tubular bore of the housing to transport the granular fertilizer along the enclosed tubular bore of the housing from the first opening of the housing to the second opening of the housing to control an amount of granular fertilizer that is dispensed from the second opening of the housing onto the surface;
  - an electric motor connected to the auger for rotating the auger;
  - a trigger that is moveable between a disengaged position and an engaged position, wherein the trigger is operably connected to the electric motor such that the electric motor rotates the auger to cause the granular fertilizer to be dispensed on the surface from the second opening when the trigger is in the engaged position and the electric motor does not rotate the auger when the trigger is in the disengaged position and the granular fertilizer is not dispensed; and
  - a meter that displays an amount of fertilizer dispensed when the auger rotates to cause the granular fertilizer to be dispensed.
6. The granular fertilizer dispensing apparatus of claim 5, wherein the second opening of the housing faces the surface and has a longitudinal length that is less than twice the pitch length.
7. The granular fertilizer dispensing apparatus of claim 5, wherein the housing includes a weep hole that is formed adjacent to the first end of the housing and faces the surface.
8. A granular fertilizer dispensing apparatus for dispensing a granular fertilizer onto a surface, comprising:
  - an elongate tubular body that is adapted to store the granular fertilizer, the elongate tubular body having a first end, a second end, and an outlet formed at the first end;

15

a handle connected to a second end of the elongate tubular body;

a housing having a first end, a second end, an enclosed tubular bore that extends in a longitudinal direction, an upward facing opening adjacent to the first end of the housing, and a downward facing opening that directly faces the surface, wherein the enclosed tubular bore is free from openings between the upward facing opening and the downward facing opening;

one or more wheels that are connected to the housing adjacent to the second end of the housing for supporting the housing with respect to the surface; and

an auger housed within the enclosed tubular bore of the housing, the auger having a pitch length, wherein the enclosed tubular bore has a longitudinal length that is greater than twice the pitch length of the auger, and the auger rotates to transport the granular fertilizer from the outlet of the elongate tubular body to the downward facing opening of the housing and to control an amount of granular fertilizer that is dispensed from the downward facing opening of the housing, wherein the second opening faces the surface to allow the granular fertilizer to be dispensed directly onto the surface from the second opening, and the upward facing opening and the downward facing opening each have a longitudinal length that is less than twice the pitch length.

9. The granular fertilizer dispensing apparatus of claim 8, further comprising:

an electric motor connected to the auger for rotating the auger;

a trigger that is mounted to the handle and is moveable between a disengaged position and an engaged position, wherein the trigger is operably connected to the electric

16

motor such that the electric motor rotates the auger to cause the granular fertilizer to be dispensed on the surface from the second opening when the trigger is in the engaged position and the electric motor does not rotate the auger when the trigger is in the disengaged position and the granular fertilizer is not dispensed; and

a meter that displays an amount of fertilizer dispensed when the auger rotates to cause the granular fertilizer to be dispensed.

10. The granular fertilizer dispensing apparatus of claim 1, wherein the second opening of the housing has a longitudinal length that is less than twice the pitch length.

11. The granular fertilizer dispensing apparatus of claim 1, wherein the meter is a volume flow meter.

12. The granular fertilizer dispensing apparatus of claim 1, wherein the meter is a mass flow meter.

13. The granular fertilizer dispensing apparatus of claim 8, further comprising:

an electric motor connected to the auger for rotating the auger;

a trigger that is mounted to the handle and is moveable between a disengaged position and an engaged position, wherein the trigger is operably connected to the electric motor such that the electric motor rotates the auger to cause the granular fertilizer to be dispensed on the surface from the second opening when the trigger is in the engaged position and the electric motor does not rotate the auger when the trigger is in the disengaged position and the granular fertilizer is not dispensed; and

a meter that displays an amount of fertilizer dispensed when the auger rotates to cause the granular fertilizer to be dispensed.

\* \* \* \* \*